

**REPORT OF ACTIVITIES
QUARTER 1, 1991**

**SHELL OIL COMPANY FACILITY
285 HEGENBERGER ROAD
OAKLAND, CALIFORNIA**

Prepared for:

Shell Oil Company
1390 Willow Pass Road, Suite 900
Concord, California 94524

Prepared by:

Converse Environmental West
55 Hawthorne, Suite 500
San Francisco, California 94105

March 29, 1991

CEW Project No. 88-44-359-20
WIC No. 204-5508-5504

TABLE OF CONTENTS

	<u>Page</u>
SECTION 1 INTRODUCTION	1
1.1 Background and Objectives	1
1.2 Scope of Activities	1
SECTION 2 WORK COMPLETED THIS QUARTER	3
2.1 Soil Sampling and Analyses	3
2.2 Groundwater Sampling and Analyses	4
2.3 Physical Monitoring Activities	4
SECTION 3 FINDINGS AND DISCUSSIONS	4
3.1 Soil	4
3.2 Groundwater	5
3.2.1 Elevation and Gradient	6
3.2.2 Results of Chemical Analyses	7
3.3 Discussion	10
SECTION 4 NEXT QUARTER ACTIVITIES	13
4.1 Work Plan Modifications	13
4.2 Proposed Activities	13

TABLE OF CONTENTS (cont'd)

BIBLIOGRAPHY

TABLES

DRAWINGS

APPENDICES

- A CHRONOLOGICAL SUMMARY
- B LABORATORY REPORTS AND CHAIN-OF-CUSTODY FORMSLIST OF

TABLES

<u>Table</u>	<u>Description</u>
1	Activity Summary - Quarter 1, 1991
2	Well Installation Information
3	Recommended Minimum Verification Analyses for Underground Tank Leaks
4	Results of Groundwater Chemical Analyses
5	Groundwater Monitoring Information

LIST OF DRAWINGS

<u>Drawing</u>	<u>Description</u>
1	Site Location Map
2	Plot Plan
3	Groundwater Elevation Map (Q1/91)

SECTION 1

INTRODUCTION

1.1 BACKGROUND AND OBJECTIVES

This report presents the results of investigative activities conducted by Converse Environmental West (CEW) during Quarter 1, 1991 (Q1/91) for the Shell Oil Company (Shell) station (site) at 285 Hegenberger Road, Oakland, California (Drawing 1). This report is prepared to fulfill the quarterly reporting requirements as specified in the Work Plan prepared by CEW dated February 3, 1989 and revised February 10, 1989 and June 12, 1989 for achievement of environmental closure of the site. The Work Plan is on file with the regulatory agencies of jurisdiction.

The site is located on the northeast corner of Hegenberger Road and Leet Drive in Oakland, California (Drawing 2). The site is approximately 235 feet long by 130 feet wide. Shell owns and operates a retail fuel sales station on the site.

Available data indicates that soil and groundwater containing petroleum hydrocarbons exist on the property. This condition has been established by preliminary investigations conducted by CEW since 1989. A chronological summary of environmental activities conducted at the site is presented in Appendix A.

1.2 SCOPE OF ACTIVITIES

The investigative activities conducted during Q1/91 were authorized under an existing purchase order and blanket number from Shell for environmental services at the facility. The work initiated and completed by CEW during Q1/91 consisted of the following:

- Collecting and sampling groundwater from monitoring wells MW-1 through MW-10,

- Evaluating the findings from the field activities and preparing this report.
Investigative activities conducted at the site to date are summarized in Table 1.

As a consultant to Shell on this project, CEW is contracted to perform specific activities related to acquiring data and information which will lead to the ultimate successful environmental closure of the facility under investigation. CEW's primary obligation is to collect information within proper standard of care and practice, and in accordance with protocols which have been created by CEW and which are on file with the regulatory agencies of jurisdiction. From time to time, because of site-specific conditions or limitations, CEW may find it necessary to deviate from these protocols. Under these conditions, CEW will describe in appropriate reports the rationale and necessities for the deviations which occurred, along with a statement of the possible impact these deviations may have on the database generated.

In interpreting its findings, CEW will follow the scientific method and develop multiple working hypotheses which explain site conditions and findings. CEW will not report and justify these multiple working hypotheses to the regulatory agencies for two principal reasons:

- (1) The number of assumptions and limitations that are part of the process are numerous and would require substantial discussion and justification, and
- (2) The multiple working hypothesis process is iterative to the time of closure. Closure documentation will provide a final, best hypothesis that is fully explained.

SECTION 2

WORK COMPLETED THIS QUARTER

Work initiated and completed during Q1/91 followed the task descriptions of the CEW Work Plan dated February 3, 1989 and revised February 10, 1989 and June 12, 1989, the project critical path and the CEW protocols are on file with the regulatory agencies of jurisdiction. No modifications were made to the revised Work Plan.

2.1 Soil Sampling and Analyses

No additional soil samples were collected during Q1/91. A summary of soil boring information and analyses were presented in previous quarterly reports on files with the regulatory agencies of jurisdiction.

2.2 Groundwater Sampling and Analysis

Groundwater samples were collected on January 3, 1991, from monitoring wells MW-1 through MW-10, following CEW protocols. These samples were submitted to NET Pacific, Inc., a California-certified laboratory in Santa Rosa, California. Samples were analyzed for total petroleum hydrocarbons as gasoline (TPH-g); total petroleum hydrocarbons as diesel (TPH-d); and benzene, toluene, ethylbenzene and xylenes (BTEX), following the recommended analytical methods listed in Table 3. Analytical data for the water samples collected from the monitoring wells are summarized in Table 4. Laboratory reports and chain-of-custody forms are provided in Appendix B.

2.3 Physical Monitoring Activities

During Q1/91, wells MW-1 through MW-10 were measured once for depth to water table and observed for floating product. A summary of these results is presented in Table 5.

SECTION 3

FINDINGS AND DISCUSSION

3.1 Soil

Stratigraphy and geologic setting are presented in previous progress reports on file with local agencies of jurisdiction.

3.2 Groundwater

3.2.1 Elevation and Gradient

Groundwater measurements ranged from 4.88 feet below grade surface (bgs) in well MW-1 to 7.54 feet bgs in MW-4 (Table 5). Groundwater flow direction and gradient varied across the site. Flow direction during Q1/91 was generally in a southerly direction. The variation in flow directions during this and previous quarterly monitoring periods is most likely due to tidal influence and due to differentiation in soil types and their respective response to water level changes.

3.2.2 Results of Chemical Analyses

The following is a list of the principal findings and conclusions from groundwater chemical monitoring at the site. Chemical data is summarized in Table 4.

- TPH-g was detected in all monitoring wells except wells MW-4 and MW-8.
- TPH-d was detected in all monitoring wells except wells MW-8. MW-4 was not analyzed for TPH-d.
- Benzene was detected in all monitoring wells except MW-4.

- Toluene was detected in all monitoring wells except MW-4 and MW-8.
- Ethylbenzene was detected in all monitoring wells except MW-3, MW-4, MW-8 and MW-10.
- Xylenes was detected in all monitoring wells except MW-4 and MW-8.

3.3 Discussion

SECTION 4

NEXT QUARTER ACTIVITIES

4.1 WORK PLAN MODIFICATIONS

No modifications were made to the workplan.

4.2 PROPOSED ACTIVITIES

The following activities will be conducted in Q2/91:

- (1) Continue quarterly monitoring and groundwater sampling.
- (2) Expand remedial investigation offsite.
- (3) Continue detailed cost and technical analyses and support for Shell to proceed with source area soils remedial activities.

CERTIFICATION

This report of activities for the Shell Oil Company facility at 285 Hegenberger Road, Oakland, California has been prepared by the staff of Converse Environmental West under the professional supervision of the Engineer and/or Geologist whose seal(s) and signature(s) appear hereon.

The findings, recommendations, specifications or professional opinions are presented, within the limits prescribed by the Client, after being prepared in accordance with generally accepted professional engineering and geologic practice. We make no other warranty, either expressed or implied.

Respectfully submitted,

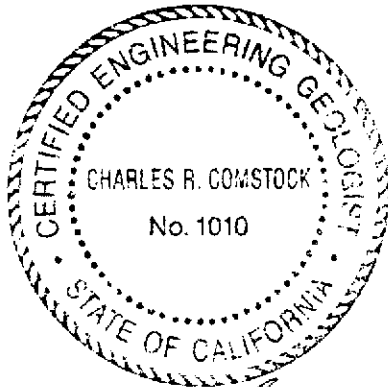

CHARLES R. COMSTOCK
Principal Geologist

PRIMARY CONTACTS

Shell Oil Company Facility
285 Hegenberger Road
Oakland, California

Quarter 1, 1991

Regional Water Quality Control
Board Representative:

Ms. Penny Silzer
San Francisco Bay Regional Water
Quality Control Board
1800 Harrison Street, Room 700
Oakland, California 94612

LIA Representative:

Mr. Rafat Shahid
Alameda County Health Care
Services Agency
80 Swan Way, Room 200
Oakland, California 94621

Shell Engineer:

Mr. Jack Brastad
Shell Oil Company
1390 Willow Pass Road, Suite 900
Concord, California 94524

Converse Project Manager:

Mr. Charles R. Comstock
Converse Environmental West
55 Hawthorne, Suite 500
San Francisco, California 94105

Registered Geologist in Charge:

Mr. Charles R. Comstock
Converse Environmental West
55 Hawthorne Street, Suite 500
San Francisco, California 94105

Site Owner:

Shell Oil Company

BIBLIOGRAPHY

California Regional Water Quality Control Board, San Francisco Bay Region, 1986, Water quality control plan, San Francisco Bay Basin Region (2), December.

California Regional Water Quality Control Board, 1988, Regional Board staff recommendations for initial evaluation and investigation of underground tanks, June 2, 1988.

California State Water Resources Control Board, 1985, California Administrative Code, Title 23 Waters, Chapter 3 Water Resources Control Board, Subchapter 16 Underground Tank Regulations, effective August 13, 1985.

_____, 1988, Leaking underground fuel tank field manual: guidelines for site assessment, cleanup, and underground storage tank closure, May 24, 1988.

_____, 1989, LUFT field manual revision, April 5, 1989.

CEW - see Converse Environmental West

Converse Environmental West, 1989a, Work Plan, Shell Oil Company facility, 285 Hegenberger Road, Oakland, California, dated February 3, 1989.

_____, 1989b, Revised work plan, 285 Hegenberger Road, Oakland, California, dated February 10, 1989.

Helley, E.J., La Joie, K.R., Spangle, W.E., and Blair, M.L., 1979, Flatland deposits of the San Francisco Bay Region, California - their geology and engineering properties, and their importance to comprehensive planning, U.S. Geological Survey Professional Paper 943, 88 p.

Hickenbottom, K., and Muir, K., 1988, Geohydrology and groundwater quality overview, of the East Bay Plain area, Alameda County, California, 205(j) Report, Alameda County Flood Control and Water Conservation District, 83p., appendix.

BIBLIOGRAPHY

APPENDIX A
CHRONOLOGICAL SUMMARY

CHRONOLOGICAL SUMMARY

The following chronological summary is based on information provided to Converse Environmental West (CEW) by Shell Oil Company (Shell). CEW was not provided with certain information related to the construction, operational, and environmental history of the facility. According to Shell, the following information is not available in Shell files: volume of contaminated soil removed at the time of tank removal, geometry of the excavation created during tank removal, if any, and date and volume of any possible releases at the facility.

Date	Description of Activity
1984	Underground storage tanks replaced with single-wall fiberglass tanks.
01/89	Shell transferred this case to CEW.
02/15/89	CEW drilled and sampled MW-1 to MW-3 and SB-1 and SB-2.
04/28/89	CEW installed MW-4 through MW-8.
05/26/89	CEW drilled, sampled and abandoned borings SB-3, SB-4 and SB-5.
07/13/89	CEW drilled, sampled and abandoned borings SB-6 through SB-11.
9/20-21/89	CEW conducted a tidal influence test.
10/17/89	Loma Prieta Earthquake struck.
10/26/89	CEW performed slug tests on existing wells.
11/16/89	CEW drilled, sampled and abandoned SB-12 and SB-13.
11/16/89	CEW installed MW-10.
12/15/89	CEW developed MW-10 and collected Q4/89 groundwater samples.
1/17/90 and 2/02/90	CEW performed offsite survey and survey calculations of property adjacent to site.
2/7/90	CEW sampled wells MW-1, MW-2, MW-5, MW-6, MW-7, MW-9.
2/8/90	CEW sampled wells MW-5, MW-7, MW-9.
3/8/90	CEW sampled wells MW-3, MW-4, MW-8, MW-10.
4/90	CEW applied for an encroachment permit from the City of Oakland.
4/18/90 and 4/19/90	CEW sampled wells MW-1, MW-2, MW-3, MW-5, MW-7, MW-9, MW-10.

CHRONOLOGICAL SUMMARY (continued)

Date	Description of Activity
7/24/90 and 7/25/90	CEW sampled wells MW-1, MW-2, MW-3, MW-4, MW-5, MW-6, MW-7, MW-8, MW-9 and MW-10.
8/06/90 and 8/07/90	CEW drilled and sampled SG-1 through SG-13.
9/07/90	CEW performed constant head test on monitoring wells MW-1, MW-5, MW-6, MW-7, MW-9, and MW-10.
9/13/90	CEW drilled and sampled SG-14 through SG-17.
9/27/90 - 10/01/90	CEW monitored and sampled monitoring wells MW-1 through MW-10.
1/2-3/91	CEW monitored and sampled monitoring wells MW-1 through MW-10.

Boldface items were conducted during this quarter

TABLE 1. ACTIVITY SUMMARY - QUARTER 1, 1991

**Shell Oil Company Facility
285 Hegenberger Road
Oakland, California**

Activity	PERCENT COMPLETE			
	Quarter 1, 1991		Total to Date	
	Onsite	Offsite	Onsite	Offsite
Soil Characterization	0	5%	60%	20%
Groundwater Characterization (Dissolved Product)	0	0	75%	0
Groundwater Characterization (Floating Product)	NA	NA	NA	NA
Soil Remediation	0	0	0	0
Groundwater Remediation (Dissolved Product)	0	0	0	0
Groundwater Remediation (Floating Product)	NA	NA	NA	NA

NOTE:

NA Not Applicable

TABLE 2. WELL INSTALLATION INFORMATION

**Shell Oil Company Facility
285 Hegenberger Road
Oakland, California**

Well No.	Date Installed	Well Diameter (Inches)	Total Depth of Well (ft bgs)	Screened Interval* (ft bgs)	Bentonite Seal Interval (ft bgs)	Grout Seal Interval (ft bgs)
MW-1	2/14/89	4	16.5	10.0 - 5.5	4.0 - 3.0	3.0 - 0
MW-2	2/15/89	4	16.5	10.0 - 5.5	4.0 - 3.0	3.0 - 0
MW-3	2/15/90	4	16.5	10.0 - 5.5	4.0 - 3.0	3.0 - 0
MW-4	4/28/89	4	14.0	10.0 - 5.5	5.0 - 4.0	4.0 - 0
MW-5	4/27/89	4	14.0	10.0 - 4.5	4.5 - 3.5	3.5 - 0
MW-6	4/28/89	4	12.0	11.0 - 5.0	5.0 - 4.0	4.0 - 0
MW-7	4/27/89	4	14.0	10.0 - 5.0	5.0 - 4.0	4.0 - 0
MW-8	4/28/89	4	12.0	10.0 - 5.0	5.0 - 4.0	4.0 - 0
MW-9	7/13/89	4	10.5	10.0 - 5.0	4.5 - 3.5	3.5 - 0
MW-10	11/16/89	4	13.0	10.0 - 5.0	4.5 - 4.0	4.0 - 0

NOTES:

- * Bentonite seals were placed from TDs to the base of the screened intervals.
- ft bgs Feet below ground surface
- MW Groundwater monitoring wells

TABLE 4. RESULTS OF GROUNDWATER CHEMICAL ANALYSES

**Shell Oil Company Facility
285 Hegenberger Road
Oakland, California**

Concentration (mg/L)

Well No.	Date Sampled	TPH-g	TPH-d	Benzene	Toluene	Ethyl-Benzene	Xylenes
MW-1	02/16/89	99.0	NA	20	23	5.7	23
MW-1	05/23/89	48.0	11.0	4.2	5.2	1.2	7.7
MW-1	08/04/89	63.0	11.0	5.5	5.5	3.2	9.5
MW-1	12/15/89	30.0	11.0	<0.005	<0.0005	<0.0005	<0.0005
MW-1	02/07/90	93.0	10.0	13.0	9.6	2.4	14.0
MW-1	04/18/90	55.0	8.7	14.0	8.4	3.2	13.0
MW-1	07/24/90	73.0	3.6	16.0	7.40	2.80	15.0
MW-1 ²	07/24/90	57.0	3.6	18.0	8.0	3.0	16.0
MW-1	10/01/90	45.0	1.7	8.0	4.3	2.0	11.0
MW-1	01/03/91	43.0	3.10	10.0	3.40	1.90	11.0
MW-2	02/16/89	20.0	NA	0.2	0.9	2.7	9.6
MW-2	05/23/89	1.5	1.6	0.0043	0.0029	0.011	0.15
MW-2	08/04/89	15.0	7.4	0.075	0.12	0.85	2.2
MW-2	12/15/89	5.0	2.6	0.052	0.013	0.0041	0.29
MW-2	02/07/90	13.0	4.8	0.032	0.034	0.23	0.640
MW-2	04/18/90	9.8	3.2	0.033	0.019	0.46	1.7
MW-2	07/24/90	9.6	2.7	0.041	0.027	0.540	0.940
MW-2	10/01/90	0.39	1.6	0.0034	0.015	0.0085	0.025
MW-2	01/03/91	1.80	0.83	0.056	0.0044	0.0048	0.092
MW-3	02/16/89	60.0	NA	5.5	0.2	3.2	5.2
MW-3	05/23/89	<0.05	1.5	<0.0005	<0.0005	<0.0015	<0.0015
MW-3	08/04/89	2.0	1.2	0.12	0.012	<0.0015	0.086
MW-3	12/15/89	5.2	1.7	0.38	0.047	0.017	0.410
MW-3	03/08/90	0.26	0.23	0.017	<0.0005	0.0054	0.0025
MW-3	04/19/90	0.26	<0.05	<0.0005	<0.0005	<0.0005	0.0094
MW-3	07/24/90	0.51	0.21	0.046	0.0012	<0.0005	0.0093
MW-3	09/28/90	0.46	0.35	0.0063	0.0017	<0.0005	0.015
MW-3	01/03/91	4.8	0.63	0.920	0.0088	<0.0005	0.190
MW-4	05/23/89	<0.05	NA	<0.0005	<0.0005	<0.0015	<0.0015
MW-4 [*]	08/04/89	<0.05	<0.05	<0.0005	<0.0005	<0.0015	<0.0015
MW-4	12/15/89	<0.05	0.09	<0.0005	<0.0005	<0.0005	<0.0005
MW-4 ¹	03/08/90	<0.05	<0.05	<0.0005	<0.0005	<0.0005	<0.0005
MW-4	07/25/90	<0.05	<0.05	<0.0005	<0.0005	<0.0005	<0.0005
MW-4	09/28/90	<0.05	NA	<0.0005	<0.0005	<0.0005	<0.0005
MW-4	01/03/91	<0.05	NA	<0.0005	<0.0005	<0.0005	<0.0005

TABLE 4 (cont'd). RESULTS OF GROUNDWATER CHEMICAL ANALYSES

**Shell Oil Company Facility
285 Hegenberger Road
Oakland, California**

Concentration (mg/L)

Well No.	Date Sampled	TPH-g	TPH-d	Benzene	Toluene	Ethyl-Benzene	Xylenes
MW-5	05/23/89	26.0	7.0	1.5	0.28	<0.0015	8.1
MW-5	08/04/89	12.0	8.7	0.86	0.094	<0.0015	2.6
MW-5	12/15/89	1.00	0.71	0.022	0.035	0.018	0.044
MW-5	02/08/90	<0.05	0.62	0.0008	<0.0005	<0.0005	<0.0005
MW-5	04/19/90	19.0	5.0	4.5	0.85	0.097	8.0
MW-5	07/24/90	23.0	2.7	3.6	0.400	0.160	6.50
MW-5	09/28/90	5.4	0.55	1.40	0.026	0.013	1.30
MW-5	01/03/91	0.86	0.56	0.280	0.0028	0.0008	0.045
MW-6	05/23/89	22.0	7.0	0.016	0.0065	0.0066	3.4
MW-6	08/04/89	28.0	8.8	1.2	0.13	2.1	2.8
MW-6	12/15/89	16.0	5.5	0.37	0.092	0.20	0.18
MW-6	02/07/90	22.0	2.6	0.52	0.085	0.63	0.77
MW-6	04/18/90	21.0	5.7	0.9	0.077	2.7	2.7
MW-6	07/24/90	24.0	3.0	1.00	0.094	3.40	2.70
MW-6	10/01/90	22.0	<0.05	0.70	0.093	2.50	2.40
MW-6	01/03/91	25.0	0.96	1.00	0.088	2.60	3.70
MW-7	05/23/89	47.0	11	3.5	5.0	1.5	7.8
MW-7	08/04/89	68.0	22	6.2	6.6	3.6	8.8
MW-7	12/15/89	100.0	12	4.5	5.3	1.3	5.3
MW-7	02/08/90	96.0	8.1	15.0	15.0	2.5	14.0
MW-7	04/19/90	94.0	10.0	25.0	13.0	3.3	13.0
MW-7	07/24/90	84.0	3.8	26.0	13.0	3.0	12.0
MW-7	09/28/90	43.0	<0.05	25.0	6.10	2.40	9.00
MW-7	01/03/91	78.0	3.10	26.0	16.0	3.00	14.00
MW-7 ²	01/03/91	77.0	3.60	29.00	19.00	3.00	15.00
MW-8	05/23/89	<0.05	0.10	<0.0005	<0.0005	<0.0015	<0.0015
MW-8	08/04/89	<0.05	0.075	<0.0005	<0.0005	<0.0015	<0.0015
MW-8	12/15/89	<0.05	<0.05	<0.0005	<0.0005	<0.0005	<0.0005
MW-8	03/08/90	<0.05	<0.05	<0.0005	<0.0005	<0.0005	<0.0005
MW-8	07/25/90	<0.05	<0.05	<0.0005	0.0013	<0.0005	<0.0005
MW-8	09/28/90	<0.05	1.1	<0.0005	<0.0005	<0.0005	<0.0005
MW-8	01/03/91	<0.05	<0.05	0.0013	<0.0005	<0.0005	<0.0005
MW-9	08/04/89	47.0	12.0	5.6	6.6	1.5	8.5
MW-9	12/15/89	88.0	9.2	4.3	5.4	0.14	5.6
MW-9	02/08/90	50.0	7.4	1.8	1.4	3.2	1.8
MW-9	04/19/90	50.0	7.5	14.0	11.0	0.73	10.0
MW-9	07/24/90	62.0	3.20	19.0	16.0	0.950	15.0
MW-9	09/28/90	30.0	2.70	16.0	6.50	0.980	11.0
MW-9	01/03/91	34.0	2.50	9.20	3.20	0.770	7.00

TABLE 4 (cont'd). RESULTS OF GROUNDWATER CHEMICAL ANALYSES

Shell Oil Company Facility
 285 Hegenberger Road
 Oakland, California

Concentration (mg/L)

Well No.	Date Sampled	TPH-g	TPH-d	Benzene	Toluene	Ethyl-Benzene	Xylenes
MW-10	12/15/89	<0.05	3.1	1.5	<0.0005	<0.0005	<0.0005
MW-10	03/08/90	25.0	1.8	17	0.330	2.1	1.4
MW-10	04/19/90	23.0	3.6	15.0	1.2	0.19	3.3
MW-10	07/25/90	18.0	1.9	12.0	0.380	<0.0005	1.40
MW-10	09/28/90	9.5	0.43	13.0	0.100	1.80	0.23
MW-10	01/03/91	4.3	0.63	3.70	0.0097	<0.0005	0.110

NOTES:

MW-4 Analysis 601 was ND for all compounds.
 TPH-g Total Petroleum Hydrocarbons of Gasoline (GCFID)
 TPH-d Total Petroleum Hydrocarbons of Diesel (GCFID)
Bold Indicates work completed this quarter

¹Analyzed semi-annually

²Duplicate sample

TABLE 5. GROUNDWATER MONITORING INFORMATION

**Shell Oil Company Facility
285 Hegenberger Road
Oakland, California**

Well No.	Date Monitored	Depth to Water (ft bgs)	Groundwater Elevation (msl)	Petroleum Odor In Water	Floating Product Thickness (Inches)	Comments
MW-1 El. 6.64	02/16/89	3.83	2.81	Slight	0	----
	05/23/89	3.59	3.05	Slight	0	No sheen
	08/03/89	4.04	2.06	Slight	0	----
	12/15/89	4.22	2.42	Slight	0	----
	02/07/90	4.60	2.58	Slight	0	----
	04/18/90	4.02	2.62	None	0	Yellow
	07/23/90	4.17	2.47	None	0	Floating sludge
	09/27/90	4.60	2.04	Slight	0	Yellow in color
	01/02/91	4.88	1.76	Slight	0	
MW-2 El. 7.68	02/16/89	5.33	2.35	Slight	0	----
	05/23/89	5.23	2.45	Slight	0	----
	08/03/89	6.03	1.65	Slight	0	----
	12/15/89	6.43	1.25	Strong	0	----
	02/07/90	5.82	1.86	Slight	0	No sheen
	04/18/90	5.88	1.80	None	0	Yellow
	07/23/90	6.05	1.63	Slight	0	
	09/27/90	6.82	0.86	Strong	0	None
	01/02/91	6.66	1.02	Slight	0	Yellow tint
MW-3 El. 7.81	02/16/89	5.17	2.64	None	0	----
	05/23/89	5.09	2.72	None	0	----
	08/03/89	5.34	2.47	Slight	0	----
	12/15/89	6.02	1.79	None	0	----
	02/07/90	4.95	2.86	Moderate	0	Cloudy
	04/18/90	5.55	2.26	Slight	0	Clear
	07/23/90	5.81	2.00	None	0	Floating sludge
	09/27/90	6.86	0.95	None	0	None
	01/02/91	6.84	0.97	None	0	Yellow tint
MW-4 El. 7.38	05/23/89	5.60	1.78	None	0	----
	08/03/89	6.37	1.01	None	0	----
	12/15/89	6.91	0.47	Slight	0	----
	03/08/90	6.06	1.32	Moderate	0	Greenish
	04/18/90	5.84	1.54	None	0	Clear
	07/23/90	6.92	0.46	None	0	No sample taken
	07/23/90	6.92	0.46	None	0	No sample taken
	09/27/90	8.03	-.065	None	0	None
	01/02/91	7.54	0.16	Slight	0	Yellow tint

TABLE 5 (cont'd). GROUNDWATER MONITORING INFORMATION

**Shell Oil Company Facility
285 Hegenberger Road
Oakland, California**

Well No.	Date Monitored	Depth to Water (ft bgs)	Groundwater Elevation (msl)	Petroleum Odor In Water	Floating Product Thickness (Inches)	Comments
MW-5 El. 8.18	05/23/89	5.47	2.71	Moderate	0	No sheen
	08/03/89	5.94	2.24	None	0	----
	12/15/89	6.75	1.43	None	0	----
	02/07/90	6.03	2.15	Slight	0	Clear
	04/18/90	5.80	2.38	Slight	0	Clear
	07/23/90	6.00	2.18	None	0	
	09/23/90	7.18	1.00	Slight	0	Putrid odor
	01/02/91	7.17	1.01	Slight	0	Putrid odor
MW-6 El. 8.21	05/23/89	5.47	2.74	Strong	0	Sheen
	08/03/89	5.91	2.30	None	0	
	12/15/89	5.98	2.23	Moderate	0	----
	02/07/90	5.47	2.74	Moderate	0	----
	04/18/90	5.80	2.41	Slight	0	Clear
	07/23/90	5.85	2.36	Slight	0	
	09/27/90	6.42	1.79	Slight	0	Putrid odor
	01/02/91	6.73	1.48	Slight	0	Putrid odor
MW-7 El. 744	05/23/89	5.48	1.96	Moderate	0	Slight sheen
	08/03/89	4.22	3.22	None	0	----
	12/15/89	4.58	2.86	Slight	0	----
	02/07/90	5.34	2.10	Slight	0	Brownish
	04/18/90	4.92	2.52	Slight	0	Organic, Dark Yellow
	07/23/90	4.99	2.45	Slight	0	Floating sludge, putrid odor
	09/27/90	6.16	1.28	Slight	0	Decaying odor
	01/02/91	4.96	2.48	Slight	0	Decaying odor
MW-8 El. 7.79	05/23/89	6.62	1.17	None	0	----
	08/03/89	6.62	1.17	None	0	----
	12/15/89	6.71	1.08	None	0	----
	03/08/90	4.95	2.84	Moderate	0	Milky
	04/18/90	6.40	1.89	None	0	No sample taken
	07/23/90	6.62	1.17	None	<0.25"	Floating sludge
	09/27/90	6.98	0.81	Slight	0	Decaying odor
	01/02/91	7.03	0.76	Slight	0	Decaying odor
MW-9 El. 7.63	08/03/89	5.78	1.85	None	0	----
	12/15/89	5.24	2.39	None	0	----
	02/07/90	5.23	2.40	Organic Odor	0	Yellow
	04/18/90	5.34	2.29	Slight	0	Yellowish
	07/23/90	5.65	1.98	Organic Odor	0	
	09/27/90	5.96	1.67	Organic Odor	0	Yellowish
	01/02/91	6.23	1.40	Organic Odor	0	Yellowish

TABLE 5 (cont'd). GROUNDWATER MONITORING INFORMATION

Shell Oil Company Facility
 285 Hegenberger Road
 Oakland, California

Well No.	Date Monitored	Depth to Water (ft bgs)	Groundwater Elevation (msl)	Petroleum Odor in Water	Floating Product Thickness (inches)	Comments
MW-10	12/15/89	6.33	0.82	None	0	----
El. 7.45	03/08/90	5.41	2.00	Strong	0	Clear
	04/18/90	5.60	1.85	Slight	0	No silt, Lt. Yellow
	07/23/90	5.81	1.64	None	0	Floating sludge
	09/27/90	6.64	0.81	Slight	0	Clear
	01/02/91	6.96	0.49	None	0	Yellow tint

NOTES:

ft bgs feet below ground surface
 Elevations are in feet above Mean Sea Level
Bold indicates work completed this quarter

DRAWINGS

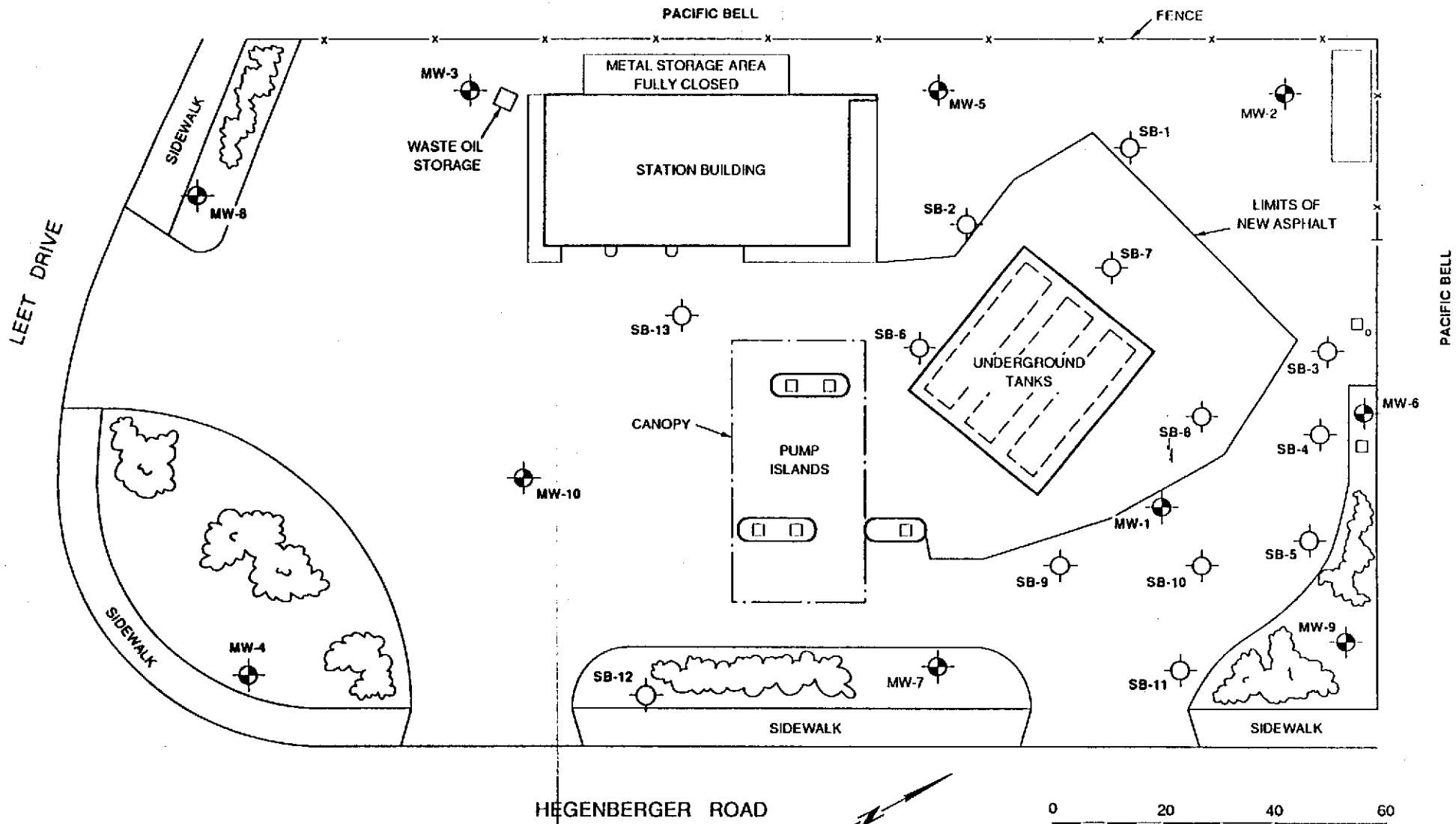

HEGENBERGER ROAD



Base Map: Surveyed with Electronic Distance Meter by CEW, 1989.

LEGEND

- SB-1 SOIL BORING (locations approximate)
- MW-1 GROUNDWATER MONITORING WELL

PLOT PLAN

SHELL OIL COMPANY
285 Hegenberger Road
Oakland, California



Converse Environmental West

Scale	AS SHOWN	Project No.	88-44-359-20
Prepared by	CRB	Date	3/18/91
Approved by	CRC	Drawing No.	2
WIC No.	204-5508-5504		

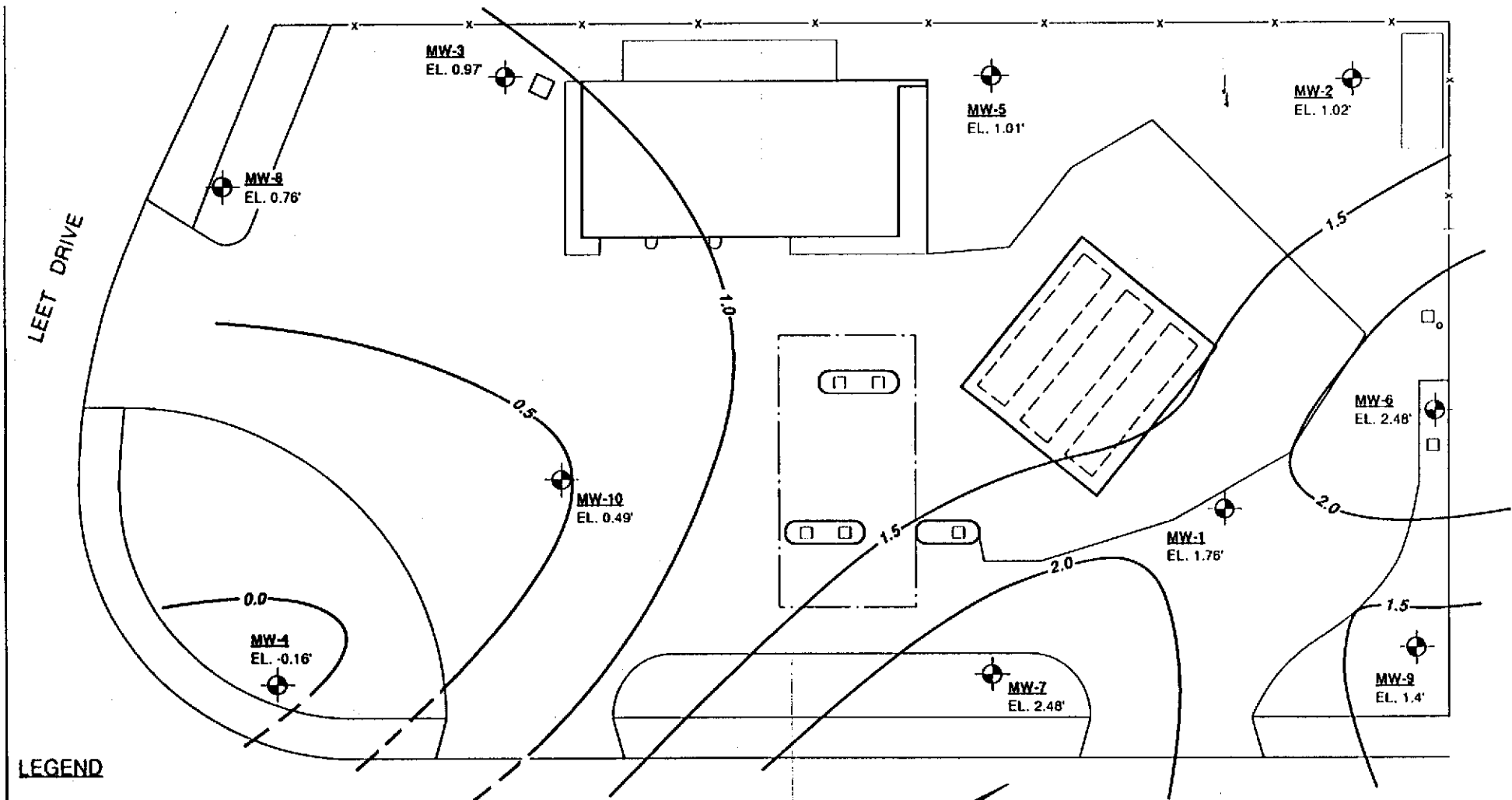

LEGEND

- GROUNDWATER CONTOUR (long dash where approximate, short dash where inferred)
- MW-1** GROUNDWATER MONITORING WELL SHOWING GROUNDWATER ELEVATION

- NOTES: 1. Groundwater elevations in feet above mean sea level.
2. Groundwater flow direction is not specified due to irregular response to tidal effects.

HEGENBERGER ROAD



Base Map: Surveyed with Electronic Distance Meter by CEW, 1989.

GROUNDWATER CONTOUR MAP Q1/91

SHELL OIL COMPANY
285 Hegenberger Road
Oakland, California

Scale	AS SHOWN	Project No.	88-44-359-20
Prepared by	CRB	Date	3/18/91
Approved by	CRC	Drawing No.	3
WIC No.	204-5508-5504		



Converse Environmental West

APPENDIX A
CHRONOLOGICAL SUMMARY

CHRONOLOGICAL SUMMARY

The following chronological summary is based on information provided to Converse Environmental West (CEW) by Shell Oil Company (Shell). CEW was not provided with certain information related to the construction, operational, and environmental history of the facility. According to Shell, the following information is not available in Shell files: volume of contaminated soil removed at the time of tank removal, geometry of the excavation created during tank removal, if any, and date and volume of any possible releases at the facility.

Date	Description of Activity
1984	Underground storage tanks replaced with single-wall fiberglass tanks.
01/89	Shell transferred this case to CEW.
02/15/89	CEW drilled and sampled MW-1 to MW-3 and SB-1 and SB-2.
04/28/89	CEW installed MW-4 through MW-8.
05/26/89	CEW drilled, sampled and abandoned borings SB-3, SB-4 and SB-5.
07/13/89	CEW drilled, sampled and abandoned borings SB-6 through SB-11.
9/20-21/89	CEW conducted a tidal influence test.
10/17/89	Loma Prieta Earthquake struck.
10/26/89	CEW performed slug tests on existing wells.
11/16/89	CEW drilled, sampled and abandoned SB-12 and SB-13.
11/16/89	CEW installed MW-10.
12/15/89	CEW developed MW-10 and collected Q4/89 groundwater samples.
1/17/90 and 2/02/90	CEW performed offsite survey and survey calculations of property adjacent to site.
2/7/90	CEW sampled wells MW-1, MW-2, MW-5, MW-6, MW-7, MW-9.
2/8/90	CEW sampled wells MW-5, MW-7, MW-9.
3/8/90	CEW sampled wells MW-3, MW-4, MW-8, MW-10.
4/90	CEW applied for an encroachment permit from the City of Oakland.
4/18/90 and 4/19/90	CEW sampled wells MW-1, MW-2, MW-3, MW-5, MW-7, MW-9, MW-10.

CHRONOLOGICAL SUMMARY (continued)

Date	Description of Activity
7/24/90 and 7/25/90	CEW sampled wells MW-1, MW-2, MW-3, MW-4, MW-5, MW-6, MW-7, MW-8, MW-9 and MW-10.
8/06/90 and 8/07/90	CEW drilled and sampled SG-1 through SG-13.
9/07/90	CEW performed constant head test on monitoring wells MW-1, MW-5, MW-6, MW-7, MW-9, and MW-10.
9/13/90	CEW drilled and sampled SG-14 through SG-17.
9/27/90 - 10/01/90	CEW monitored and sampled monitoring wells MW-1 through MW-10.
1/2-3/91	CEW monitored and sampled monitoring wells MW-1 through MW-10.

Boldface items were conducted during this quarter

APPENDIX B

**LABORATORY REPORTS AND
CHAIN-OF-CUSTODY FORMS**



NATIONAL
ENVIRONMENTAL
TESTING, INC.

NET Pacific, Inc.
435 Tesconi Circle
Santa Rosa, CA 95401
Tel: (707) 526-7200
Fax: (707) 526-9623

RECEIVED

JAN 16 1991

CONVERSE ENVIRONMENTAL

Chuck Comstock
Converse Consultants
55 Hawthorne St, Ste 500
San Francisco, CA 94105

Date: 01-15-91
NET Client Acct. No: 18.02
NET Pacific Log No: 5519
Received: 01-04-91 0800

Client Reference Information

SHELL, 285 Hegenberger; Project: 88-44-359-20

Sample analysis in support of the project referenced above has been completed and results are presented on following pages. Please refer to the enclosed "Key to Abbreviations" for definition of terms. Should you have questions regarding procedures or results, please feel welcome to contact Client Services.

Approved by:

Jules Skamarack
Laboratory Manager

Enclosure(s)



NET Pacific, Inc.

Client Acct: 18.02
Client Name: Converse Consultants
NET Log No: 5519

Date: 01-15-91
Page: 2

Ref: SHELL, 285 Hegenberger; Project: 88-44-359-20

SAMPLE DESCRIPTION: MW-4 01-03-91 0935
LAB Job No: (-71607)

Parameter	Method	Reporting Limit	Results	Units
PETROLEUM HYDROCARBONS			--	
VOLATILE (WATER)			--	
DILUTION FACTOR *			1	
DATE ANALYZED			01-07-91	
METHOD GC FID/5030			--	
as Gasoline			0.05	mg/L
METHOD 602			--	
DILUTION FACTOR *			1	
DATE ANALYZED			01-07-91	
Benzene			0.5	ug/L
Ethylbenzene			0.5	ug/L
Toluene			0.5	ug/L
Xylenes, total			0.5	ug/L



NET Pacific, Inc.

Client Acct: 18.02
Client Name: Converse Consultants
NET Log No: 5519

Date: 01-15-91
Page: 3

Ref: SHELL, 285 Hegenberger; Project: 88-44-359-20

SAMPLE DESCRIPTION: trip blank 01-03-91
LAB Job No: (-71608)

Parameter	Method	Reporting Limit	Results	Units
PETROLEUM HYDROCARBONS			--	
VOLATILE (WATER)			--	
DILUTION FACTOR *			1	
DATE ANALYZED			01-07-91	
METHOD GC FID/5030			--	
as Gasoline		0.05	ND	mg/L
METHOD 602			--	
DILUTION FACTOR *			1	
DATE ANALYZED			01-07-91	
Benzene		0.5	ND	ug/L
Ethylbenzene		0.5	ND	ug/L
Toluene		0.5	ND	ug/L
Xylenes, total		0.5	ND	ug/L
PETROLEUM HYDROCARBONS			--	
EXTRACTABLE (WATER)			--	
DILUTION FACTOR *			1	
DATE EXTRACTED			01-08-91	
DATE ANALYZED			01-09-91	
METHOD GC FID/3510			--	
as Diesel		0.05	ND	mg/L
as Motor Oil		0.5	ND	mg/L



NET Pacific, Inc.

Client Acct: 18.02
Client Name: Converse Consultants
NET Log No: 5519

Date: 01-15-91
Page: 4

Ref: SHELL, 285 Hegenberger; Project: 88-44-359-20

SAMPLE DESCRIPTION: MW-10 01-03-91 0950
LAB Job No: (-71609)

Parameter	Method	Reporting Limit	Results	Units
PETROLEUM HYDROCARBONS			--	
VOLATILE (WATER)			--	
DILUTION FACTOR *			10	
DATE ANALYZED			01-08-91	
METHOD GC FID/5030			--	
as Gasoline		0.05	4.3	mg/L
METHOD 602			--	
DILUTION FACTOR *			10	
DATE ANALYZED			01-08-91	
Benzene		0.5	3700	ug/L
Ethylbenzene		0.5	ND	ug/L
Toluene		0.5	9.7	ug/L
Xylenes, total		0.5	110	ug/L
PETROLEUM HYDROCARBONS			--	
EXTRACTABLE (WATER)			--	
DILUTION FACTOR *			1	
DATE EXTRACTED			01-08-91	
DATE ANALYZED			01-09-91	
METHOD GC FID/3510			--	
as Diesel		0.05	0.63	mg/L
as Motor Oil		0.5	ND	mg/L



NET Pacific, Inc.

Client Acct: 18.02
Client Name: Converse Consultants
NET Log No: 5519

Date: 01-15-91
Page: 5

Ref: SHELL, 285 Hegenberger; Project: 88-44-359-20

SAMPLE DESCRIPTION: MW-8 01-03-91 1010
LAB Job No: (-71610)

Parameter	Method	Reporting Limit	Results	Units
PETROLEUM HYDROCARBONS				
VOLATILE (WATER)			--	
DILUTION FACTOR *			1	
DATE ANALYZED			01-07-91	
METHOD GC FID/5030			--	
as Gasoline			0.05	mg/L
METHOD 602			--	
DILUTION FACTOR *			1	
DATE ANALYZED			01-07-91	
Benzene			0.5	ug/L
Ethylbenzene			0.5	ug/L
Toluene			0.5	ug/L
Xylenes, total			0.5	ug/L
PETROLEUM HYDROCARBONS				
EXTRACTABLE (WATER)			--	
DILUTION FACTOR *			1	
DATE EXTRACTED			01-08-91	
DATE ANALYZED			01-09-91	
METHOD GC FID/3510			--	
as Diesel			0.05	mg/L
as Motor Oil			0.5	mg/L



NET Pacific, Inc. Client Acct: 18.02
Client Name: Converse Consultants
NET Log No: 5519

Date: 01-15-91
Page: 6

Ref: SHELL, 285 Hegenberger; Project: 88-44-359-20

SAMPLE DESCRIPTION: MW-3 01-03-91 1025
LAB Job No: (-71611)

Parameter	Method	Reporting Limit	Results	Units
PETROLEUM HYDROCARBONS			--	
VOLATILE (WATER)			--	
DILUTION FACTOR *			10	
DATE ANALYZED			01-08-91	
METHOD GC FID/5030			--	
as Gasoline		0.05	4.8	mg/L
METHOD 602			--	
DILUTION FACTOR *			10	
DATE ANALYZED			01-08-91	
Benzene		0.5	920	ug/L
Ethylbenzene		0.5	ND	ug/L
Toluene		0.5	8.8	ug/L
Xylenes, total		0.5	190	ug/L
PETROLEUM HYDROCARBONS			--	
EXTRACTABLE (WATER)			--	
DILUTION FACTOR *			1	
DATE EXTRACTED			01-08-91	
DATE ANALYZED			01-09-91	
METHOD GC FID/3510			--	
as Diesel		0.05	0.63	mg/L
as Motor Oil		0.5	ND	mg/L



NET Pacific, Inc.

© Client Acct: 18.02
Client Name: Converse Consultants
NET Log No: 5519

Date: 01-15-91
Page: 7

Ref: SHELL, 285 Hegenberger; Project: 88-44-359-20

SAMPLE DESCRIPTION: MW-7 01-03-91 1040
LAB Job No: (-71612)

Parameter	Method	Reporting Limit	Results	Units
PETROLEUM HYDROCARBONS				--
VOLATILE (WATER)				--
DILUTION FACTOR *			100	
DATE ANALYZED			01-08-91	
METHOD GC FID/5030				--
as Gasoline		0.05	78	mg/L
METHOD 602				--
DILUTION FACTOR *			1,000	
DATE ANALYZED			01-09-91	
Benzene		0.5	26,000	ug/L
Ethylbenzene		0.5	3,000	ug/L
Toluene		0.5	16,000	ug/L
Xylenes, total		0.5	14,000	ug/L
PETROLEUM HYDROCARBONS				--
EXTRACTABLE (WATER)				--
DILUTION FACTOR *			1	
DATE EXTRACTED			01-08-91	
DATE ANALYZED			01-09-91	
METHOD GC FID/3510				--
as Diesel		0.05	3.1	mg/L
as Motor Oil		0.5	ND	mg/L



NET Pacific, Inc. Client Acct: 18.02
 Client Name: Converse Consultants
 NET Log No: 5519

Date: 01-15-91
 Page: 8

Ref: SHELL, 285 Hegenberger; Project: 88-44-359-20

SAMPLE DESCRIPTION: 910103 01-03-91 1045
 LAB Job No: (-71613)

Parameter	Method	Reporting Limit	Results	Units
PETROLEUM HYDROCARBONS				
VOLATILE (WATER)				
DILUTION FACTOR *			100	
DATE ANALYZED			01-08-91	
METHOD GC FID/5030				
as Gasoline		0.05	77	mg/L
METHOD 602				
DILUTION FACTOR *			1,000	
DATE ANALYZED			01-09-91	
Benzene		0.5	29,000	ug/L
Ethylbenzene		0.5	3,000	ug/L
Toluene		0.5	19,000	ug/L
Xylenes, total		0.5	15,000	ug/L
PETROLEUM HYDROCARBONS				
EXTRACTABLE (WATER)				
DILUTION FACTOR *			1	
DATE EXTRACTED			01-08-91	
DATE ANALYZED			01-09-91	
METHOD GC FID/3510				
as Diesel		0.05	3.6	mg/L
as Motor Oil		0.5	ND	mg/L



NET Pacific, Inc.

Client Acct: 18.02
Client Name: Converse Consultants
NET Log No: 5519

Date: 01-15-91
Page: 9

Ref: SHELL, 285 Hegenberger; Project: 88-44-359-20

SAMPLE DESCRIPTION: MW-9 01-03-91 1100
LAB Job No: (-71614)

Parameter	Method	Reporting Limit	Results	Units
PETROLEUM HYDROCARBONS				--
VOLATILE (WATER)				--
DILUTION FACTOR *				100
DATE ANALYZED				01-08-91
METHOD GC FID/5030				--
as Gasoline		0.05	34	mg/L
METHOD 602				--
DILUTION FACTOR *				100
DATE ANALYZED				01-08-91
Benzene		0.5	9,200	ug/L
Ethylbenzene		0.5	770	ug/L
Toluene		0.5	3200	ug/L
Xylenes, total		0.5	7000	ug/L
PETROLEUM HYDROCARBONS				--
EXTRACTABLE (WATER)				--
DILUTION FACTOR *				1
DATE EXTRACTED				01-08-91
DATE ANALYZED				01-09-91
METHOD GC FID/3510				--
as Diesel		0.05	2.5	mg/L
as Motor Oil		0.5	ND	mg/L



NET Pacific, Inc.

Client Acct: 18.02
Client Name: Converse Consultants
NET Log No: 5519

Date: 01-15-91
Page: 10

Ref: SHELL, 285 Hegenberger; Project: 88-44-359-20

SAMPLE DESCRIPTION: MW-1 01-03-91 1120
LAB Job No: (-71615)

Parameter	Method	Reporting Limit	Results	Units
PETROLEUM HYDROCARBONS			--	
VOLATILE (WATER)			--	
DILUTION FACTOR *			100	
DATE ANALYZED			01-08-91	
METHOD GC FID/5030			--	
as Gasoline		0.05	43	mg/L
METHOD 602			--	
DILUTION FACTOR *			100	
DATE ANALYZED			01-08-91	
Benzene		0.5	10,000	ug/L
Ethylbenzene		0.5	1900	ug/L
Toluene		0.5	3400	ug/L
Xylenes, total		0.5	11,000	ug/L
PETROLEUM HYDROCARBONS			--	
EXTRACTABLE (WATER)			--	
DILUTION FACTOR *			1	
DATE EXTRACTED			01-08-91	
DATE ANALYZED			01-09-91	
METHOD GC FID/3510			--	
as Diesel		0.05	3.1	mg/L
as Motor Oil		0.5	ND	mg/L



NET Pacific, Inc.

Client Acct: 18.02
Client Name: Converse Consultants
NET Log No: 5519

Date: 01-15-91
Page: 11

Ref: SHELL, 285 Hegenberger; Project: 88-44-359-20

SAMPLE DESCRIPTION: MW-6 01-03-91 1135
LAB Job No: (-71616)

Parameter	Method	Reporting Limit	Results	Units
PETROLEUM HYDROCARBONS			--	
VOLATILE (WATER)			--	
DILUTION FACTOR *			100	
DATE ANALYZED			01-08-91	
METHOD GC FID/5030			--	
as Gasoline		0.05	25	mg/L
METHOD 602			--	
DILUTION FACTOR *			100	
DATE ANALYZED			01-08-91	
Benzene		0.5	1000	ug/L
Ethylbenzene		0.5	2600	ug/L
Toluene		0.5	88	ug/L
Xylenes, total		0.5	3700	ug/L
PETROLEUM HYDROCARBONS			--	
EXTRACTABLE (WATER)			--	
DILUTION FACTOR *			1	
DATE EXTRACTED			01-08-91	
DATE ANALYZED			01-09-91	
METHOD GC FID/3510			--	
as Diesel		0.05	0.96	mg/L
as Motor Oil		0.5	ND	mg/L



NET Pacific, Inc.

Client Acct: 18.02
Client Name: Converse Consultants
NET Log No: 5519

Date: 01-15-91
Page: 12

Ref: SHELL, 285 Hegenberger; Project: 88-44-359-20

SAMPLE DESCRIPTION: MW-2 01-03-91 1200
LAB Job No: (-71617)

Parameter	Method	Reporting Limit	Results	Units
PETROLEUM HYDROCARBONS				
VOLATILE (WATER)			--	
DILUTION FACTOR *			2	
DATE ANALYZED			01-08-91	
METHOD GC FID/5030			--	
as Gasoline			0.05	1.8
METHOD 602			--	mg/L
DILUTION FACTOR *			2	
DATE ANALYZED			01-08-91	
Benzene			0.5	56
Ethylbenzene			0.5	48
Toluene			0.5	4.4
Xylenes, total			0.5	92
ug/L				
PETROLEUM HYDROCARBONS				
EXTRACTABLE (WATER)			--	
DILUTION FACTOR *			1	
DATE EXTRACTED			01-08-91	
DATE ANALYZED			01-09-91	
METHOD GC FID/3510			--	
as Diesel			0.05	0.83
as Motor Oil			0.5	ND
mg/L				mg/L



NET Pacific, Inc.

© Client Acct: 18.02
Client Name: Converse Consultants
NET Log No: 5519

Date: 01-15-91
Page: 13

Ref: SHELL, 285 Hegenberger; Project: 88-44-359-20

SAMPLE DESCRIPTION: MW-5 01-03-91 1220
LAB Job No: (-71618)

Parameter	Method	Reporting Limit	Results	Units
PETROLEUM HYDROCARBONS				
VOLATILE (WATER)			--	
DILUTION FACTOR *			1	
DATE ANALYZED			01-07-91	
METHOD GC FID/5030			--	
as Gasoline		0.05	0.86	mg/L
METHOD 602			--	
DILUTION FACTOR *			1	
DATE ANALYZED			01-07-91	
Benzene		0.5	280	ug/L
Ethylbenzene		0.5	0.8	ug/L
Toluene		0.5	2.8	ug/L
Xylenes, total		0.5	45	ug/L
PETROLEUM HYDROCARBONS				
EXTRACTABLE (WATER)			--	
DILUTION FACTOR *			1	
DATE EXTRACTED			01-08-91	
DATE ANALYZED			01-09-91	
METHOD GC FID/3510			--	
as Diesel		0.05	0.56	mg/L
as Motor Oil		0.5	ND	mg/L



NET Pacific, Inc.

Client Acct: 18.02
Client Name: Converse Consultants
NET Log No: 5519

Date: 01-11-91
Page: 14

Ref: SHELL, 285 Hegenberger; Project: 88-44-359-20

QUALITY CONTROL DATA

Parameter	Reporting Limits	Units	Cal Verf Stand % Recovery	Blank Data	Spike % Recovery	Duplicate Spike % Recovery	RPD
Diesel	0.05	mg/L	111	ND	46	46	< 1
Motor Oil	0.5	mg/L	72	ND	N/A	N/A	N/A
Gasoline	0.05	mg/L	87	ND	66	66	< 1
Benzene	0.5	ug/L	96	ND	88	86	2.3
Toluene	0.5	ug/L	96	ND	106	106	< 1
Gasoline	0.05	mg/L	89	ND	84	88	4.7
Benzene	0.5	ug/L	98	ND	100	100	< 1
Toluene	0.5	ug/L	100	ND	97	100	3.0
Gasoline	0.05	mg/L	92	ND	95	89	6.5
Toluene	0.5	ug/L	96	ND	107	100	6.8
Benzene	0.5	ug/L	92	ND	100	96	4.1
Benzene	0.5	ug/L	90	ND	96	100	4.1
Toluene	0.5	ug/L	90	ND	96	100	4.1

COMMENT: Blank Results were ND on other analytes tested.

- < : Less than; When appearing in results column indicates analyte not detected at the value following. This datum supercedes the listed Reporting Limit.
- * : Reporting Limits are a function of the dilution factor for any given sample. To obtain the actual reporting limits for this sample, multiply the stated Reporting Limits by the dilution factor (but do not multiply reported values).
- ICVS : Initial Calibration Verification Standard (External Standard).
- mean : Average; sum of measurements divided by number of measurements.
- mg/Kg (ppm) : Concentration in units of milligrams of analyte per kilogram of sample, wet-weight basis (parts per million).
- mg/L : Concentration in units of milligrams of analyte per liter of sample.
- mL/L/hr : Milliliters per liter per hour.
- MPN/100 mL : Most probable number of bacteria per one hundred milliliters of sample.
- N/A : Not applicable.
- NA : Not analyzed.
- ND : Not detected; the analyte concentration is less than applicable listed reporting limit.
- NTU : Nephelometric turbidity units.
- RPD : Relative percent difference, $100 \text{ [Value 1 - Value 2] / mean value}$.
- SNA : Standard not available.
- ug/Kg (ppb) : Concentration in units of micrograms of analyte per kilogram of sample, wet-weight basis (parts per billion).
- ug/L : Concentration in units of micrograms of analyte per liter of sample.
- umhos/cm : Micromhos per centimeter.

Method References

Methods 100 through 493: see "Methods for Chemical Analysis of Water & Wastes", U.S. EPA, 600/4-79-020, rev. 1983.

Methods 601 through 625: see "Guidelines Establishing Test Procedures for the Analysis of Pollutants" U.S. EPA, 40 CFR, Part 136, rev. 1988.

Methods 1000 through 9999: see "Test Methods for Evaluating Solid Waste", U.S. EPA SW-846, 3rd edition, 1986.

SM: see "Standard Methods for the Examination of Water & Wastewater, 16th Edition, APHA, 1985.



CONVERSE ENVIRONMENTAL

CHAIN OF CUSTODY RECORD

Afe # 204-5508-5504

Wic # 086662

P.M. = CRC

5519

ExpCode - 5440

PROJECT NO.:				PROJECT NAME / CROSS STREET:				NUMBER OF CONTAINERS	ANALYSES				REMARKS
88-44-359-20				285 Hegenberger SHELL					Tph-d	Tph-g	BTEX		
STATION NO.	DATE	TIME	COMP.	GRAB	STATION LOCATION								
MW-4	1/3/91	9:35		✓	40 ml. UOA	3		✓	✓			Standard Turnaround	
TRIP Blank				✓	1 litre Amber	1	✓						
TRIP Blank				✓	40 ml. UOA	1		✓	✓			Detection Limits	
MW-10		9:50		✓	1 litre Amber	2	✓						
MW-10		9:50		✓	40 ml. UOA	3		✓	✓			Tph-d = 0.05 ppm	
MW-8		10:10		✓	1 litre Amber	2	✓					Tph-g = 0.05 ppm	
MW-8		10:10		✓	40 ml. UOA	3		✓	✓			BTEX = 0.0005 ppm	
MW-3		10:25		✓	1 litre Amber	3	✓						
MW-3		10:25		✓	40 ml. UOA	4		✓	✓			Trip blanks have no prep. date.	
MW-7		10:40		✓	1 litre Amber	2	✓						
MW-7		10:40		✓	40 ml. UOA	3		✓	✓				
910103		10:45		✓	1 litre Amber	2	✓						
910103	✓	10:45		✓	40 ml. UOA	3		✓	✓				

CUSTODY SEALED 1/3/91

@ 19:00 J.W. in...

RELINQUISHED BY: (Signature) <i>Richard K. Weber</i>	DATE: 1/3/91 TIME: 14:50	RECEIVED BY: (Signature) <i>Jeff W. ...</i>	RELINQUISHED BY: (Signature) <i>Jeff W. ...</i>	DATE:	RECEIVED BY: (Signature)
RELINQUISHED BY: (Signature)	DATE:	RECEIVED BY: (Signature)	RELINQUISHED BY: (Signature)	DATE:	RECEIVED BY: (Signature)
RELINQUISHED BY COURIER: (Sign.)	DATE:	RECEIVED BY MOBILE LAB: (Sign.)	RELINQ. BY MOBILE LAB: (Signature)	DATE:	RECEIVED BY COURIER: (Signature)
METHOD OF SHIPMENT (VIALS)		SHIPPED BY: (Signature)	RECEIVED FOR LAB: (Signature) <i>Temple</i>	DATE: 1/4/91 TIME: 0800	COURIER FROM AIRPORT: (Signature)



CONVERSE ENVIRONMENTAL

CHAIN OF CUSTODY RECORD

Wic # 204-5508-5504
 AFe # 086662
 Exp Code 5440 (5519)
 P.M. - CRC

PROJECT NO.:				PROJECT NAME / CROSS STREET:				NUMBER OF CONTAINERS	ANALYSES				REMARKS	
88-44-359-20				285 Hegenberger SHELL					Tph-d	Tph-g	BTEX			
SAMPLERS: (Signature) Richard P. Cooper														
STATION NO.	DATE	TIME	COMP.	GRAB	STATION LOCATION									
MW-9	1/3/91	11:00			1 litre Amber	2	✓					standard Turnaround		
MW-9		11:00			40 ml. UOA	3		✓	✓					
MW-1		11:20			1 litre Amber	2	✓					Detection Limits		
MW-1		11:20			40 ml. UOA	3		✓	✓					
MW-6		11:35			1 litre Amber	2	✓					Tph-d = 0.05 ppm		
MW-6		1:35			40 ml. UOA	3		✓	✓			Tph-g = 0.05 ppm		
MW-2		12:00			1 litre Amber	2	✓					BTEX = 0.0005 ppm		
MW-2		12:00			40 ml. UOA	3		✓	✓					
MW-5		12:20			1 litre Amber	2	✓							
MW-5	✓	12:20			40 ml. UOA	3		✓	✓					

RELINQUISHED BY: (Signature) Richard P. Cooper	DATE: 1/3/91 TIME: 14:50	RECEIVED BY: (Signature) Jeff Wickler	RELINQUISHED BY: (Signature) Jeff Wickler	DATE: 1/3 TIME:	RECEIVED BY: (Signature)
RELINQUISHED BY: (Signature)	DATE: TIME:	RECEIVED BY: (Signature)	RELINQUISHED BY: (Signature)	DATE: TIME:	RECEIVED BY: (Signature)
RELINQUISHED BY COURIER: (Sign.)	DATE: TIME:	RECEIVED BY MOBILE LAB: (Sign.)	RELINQ. BY MOBILE LAB: (Signature)	DATE: TIME:	RECEIVED BY COURIER: (Signature)
METHOD OF SHIPMENT (VIALS)		SHIPPED BY: (Signature)	RECEIVED FOR LAB: (Signature) K. Sample	DATE: 1/4/91 TIME: 0800	COURIER FROM AIRPORT: (Signature)