



20217

Alameda County

OCT
NOV 01 2007

Environmental Health

September 28, 2007

Mr. Cleet Carlton
CALIFORNIA REGIONAL WATER QUALITY CONTROL BOARD
1515 Clay Street, Suite 1400
Oakland, California 94612

Bureau Veritas Project No. 33107-007514.03

**Subject: Requirement for Public Notification
Groth Brothers Chevrolet Site
57-59 South L Street
Livermore, Alameda County, California**

Dear Mr. Carlton:

This letter was prepared by Bureau Veritas North America, Inc. (Bureau Veritas) on behalf of Bordoni Ranch LLC and Green Valley Corporation Tenancy in Common (BGTIC) for the Groth Brothers Chevrolet facility located at 57-59 South L Street, in Livermore, Alameda County, California (the "Site" – Attachment 1, Figure 1). In a letter dated August 30, 2007, the San Francisco Bay Regional Water Quality Control Board (SFRWQCB) stated that the Water Boards are required to involve the public in site cleanup decisions under state law and that the board staff is increasing its efforts to provide public participation of its site cleanup programs. The SFRWQCB has requested the assistance of BGTIC as part of this effort with the items presented below, which are followed by a response.

"Specifically, you are required to submit a report by September 30, 2007, that includes a mailing list for surrounding property owners and resident/occupants within a 500-foot radius of the subject site ("radius list"). The mailing list should also include any other interested parties or groups, including relevant public agencies and environmental/community groups"

BGTIC has prepared a "radius list," which is included as an attachment to this letter. The "radius list" consists of 419 properties within a 500-foot radius of the Site (Attachment 3). The "radius list" includes the applicable assessors parcel number (APN), property owner, property address and current mailing address for each property owner.

"You are also requested to provide us with a draft notification for the subject site by the same date cited above. The draft notification should contain the following information:

- ***adequate information about the release and any site investigation, risk assessment, and interim remedial actions***
- ***description of pending technical reports and next steps***
- ***contact information for responsible party/parties and the Water Board***

Bureau Veritas North America, Inc.

6920 Koll Center Parkway, Suite 216
Pleasanton, CA 94566

Main (925) 426-2600

Fax (925) 426-0106

www.us.bureauveritas.com



Mr. Cleet Carlton
SFRWQCB
September 28, 2007

Page 2

Bureau Veritas Project Number. 33107-007514.03

• ***Water Board file number and where documents can be found***

Bureau Veritas has prepared the draft notification the SFRWQCB has requested, which is also included in this letter (Attachment 2). Please note that the "Draft Notification of Site Cleanup Oversight" has been submitted in an approved "fact sheet" format. Both a hard copy and an electronic copy of the draft notification have been submitted. Bureau Veritas and BGTIC understand that the SFRWQCB will use this draft notification in preparing a final notification to the property owners within the 500-foot radius of the Site.

If you have any questions, please contact me at 925.426.2607.

Sincerely,

Craig Pelletier, P.G.
Senior Project Manager
Environmental Services

CTP/lw

Attachments: Attachment 1 – Figure 1 - Site Location Map
Attachment 2 – Draft Notification of Site Cleanup Oversight Fact Sheet
Attachment 3 – 500-foot "Radius List"

cc: Mr. Michael Bordoni, BGTIC, 777 North First Street, San Jose, California 95112
Mr. Todd Trekell, BGTIC, 777 North First Street, San Jose, California 95112
Mr. Leroy Griffin, City of Oakland Hazardous Materials Unit, 250 Frank H. Ogawa Plaza, Suite 3341, Oakland, California 94612
Ms. Donna Drogos, Alameda County Environmental Health, 1131 Harbor Bay Parkway, Alameda, California 94502



ATTACHMENT 1

Figure 1 – Site Location Map

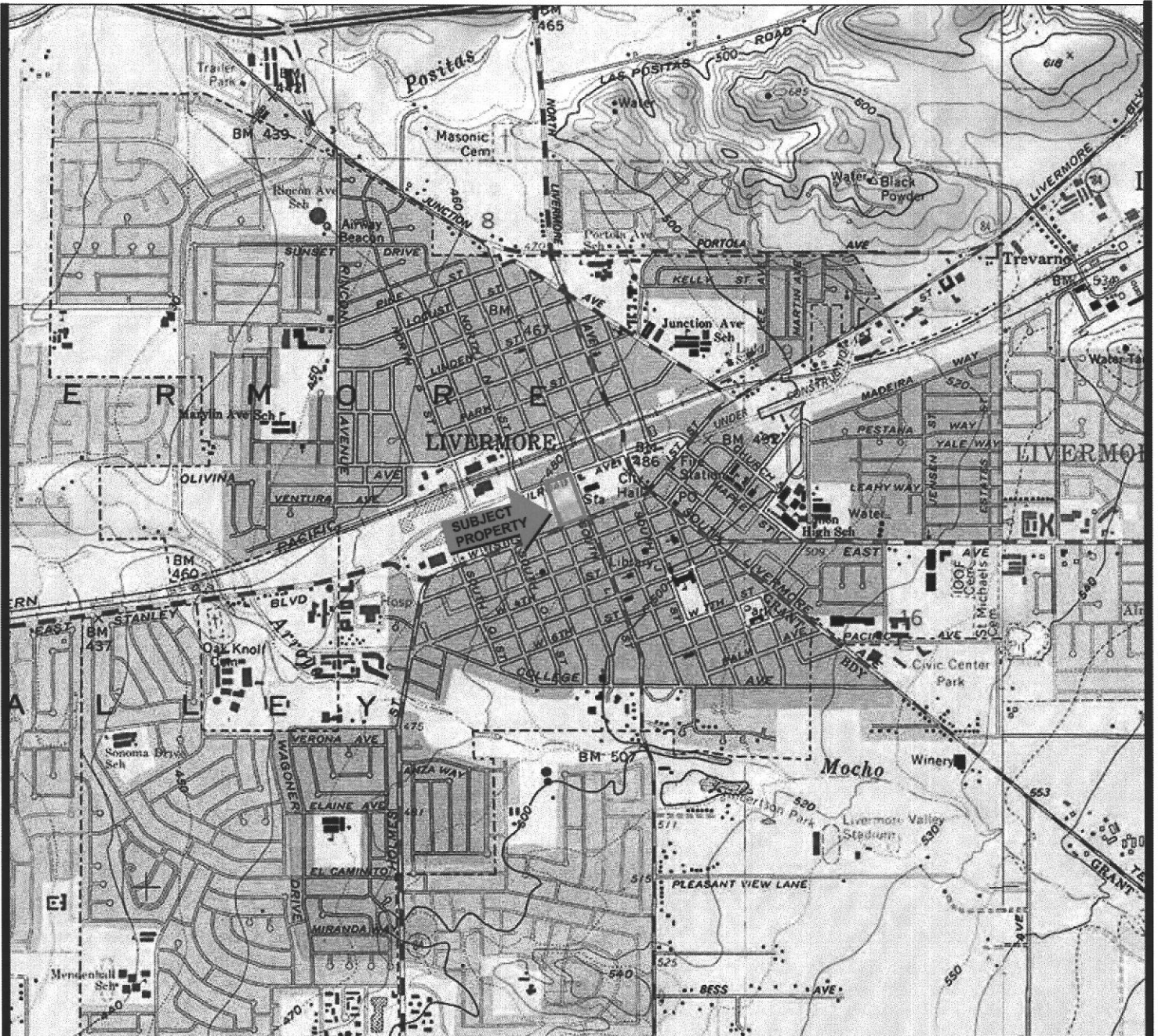

Source: TOPOI © 2000 National Geographic Holdings

Note: Location Information is Approximate

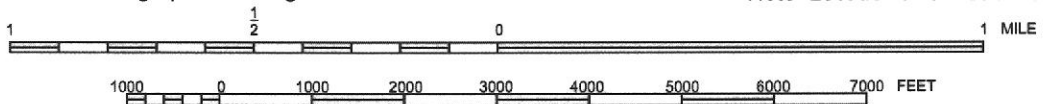

Portion of the 7.5-Minute Series Livermore, California
 Quadrangle Topographic Map (Datum: NAD 27)
 United States Department of the Interior
 Geological Survey
 1980 Photorevised from 1978



QUADRANGLE LOCATION

SUBJECT PROPERTY LOCATION	FIGURE	
57/59 South L Street Livermore, California	1	
Project No. 33107-007514.03		



ATTACHMENT 2

Draft Notification of Site Cleanup Oversight Fact Sheet

CALIFORNIA REGIONAL WATER QUALITY CONTROL BOARD
SAN FRANCISCO BAY REGION
1515 CLAY STREET, SUITE 1400
OAKLAND, CA 94612
(510) 622 - 2300 Fax: (510) 622 - 2460

FACT SHEET
For

**NOTIFICATION OF SITE CLEANUP OVERSIGHT for
GROTH BROTHERS CHEVROLET SITE
57-59 SOUTH L STREET
LIVERMORE, ALAMEDA COUNTY
WATER BOARD FILE NO. 01S0677 (CFC)**

PUBLIC NOTICE:

This Fact Sheet Notification of Site Cleanup Oversight is being provided to nearby landowners and residents /occupants as well as interested persons. It describes site background, past work to investigate and clean up site contaminants, next steps, the Water Board's oversight process for the Site, and how you can obtain more information.

Written Comments

- Interested persons are invited to submit written comments concerning this draft permit.
- Send comments to the Attention of Mr. Cleet Carlton, Regional Water Quality Control Board, 1515 Clay Street, Suite 1400, Oakland, CA 94612

Additional Information

For additional information about this matter, interested persons should contact:

- Mr. Cleet Carlton, Regional Water Quality Control Board, 1515 Clay Street, Suite 1400, Oakland, CA 94612

Other key contacts pertaining to this facility include the following personnel:

- Mr. Michael Bordoni, Bordoni Ranch LLC and Green Valley Corporation Tenancy in Common (BGTIC), 777 North 1st Street, San Jose, California 95112

SITE BACKGROUND

The Site is located at 57-59 South L Street within the downtown portion of the City of Livermore, which is primarily zoned as industrial and commercial. The Site is currently developed as a new and used auto dealership operated by Groth Brothers Chevrolet (Groth) and contains four buildings including an auto showroom, automotive service area, an auto body shop containing a paint booth and paint mixing room, and a used car sales offices containing an auto detailing and a wash rack. The remaining areas of the Site consist of asphalt-paved parking areas.

Historically, the Site has been developed for a mix of residential, commercial, and industrial activities since at least 1884. Railroad tracks crossed the northern portion of the Site from at least 1884 through the 1970s. Land use on the southern portion of the Site has included a number of retail facilities as well as a fuel and feed shop, print shop, gasoline service stations, and automobile repair and service shop. Properties in the surrounding area have been developed since the 1880s for mixed commercial and residential use, including gasoline stations, auto repair and dry cleaning facilities.

SITE INVESTIGATION AND REMEDIATION

The Site is located immediately down-gradient of the Valley Gas Petroleum (Valley Gas) facility, which is an underground storage tank (UST) release currently under the regulatory oversight of the Alameda County Environmental Health Services (ACEHS). Currently, an Environmental Remediation Agreement is in place to remediate the Valley Gas property. Several off-site investigations associated with the Valley Gas petroleum hydrocarbon release have been performed and include investigations on the Site.

Petroleum hydrocarbons including benzene, toluene, ethylbenzene and xylene (BTEX) compounds, methyl tert-butyl ether (MTBE), total petroleum hydrocarbons (TPH) and naphthalene have been identified in the groundwater beneath the Groth Site. The concentrations of petroleum hydrocarbons are above applicable California Department of Health Services (DHS) primary MCLs or San Francisco Bay Regional Water Quality Control Board (SFRQWCB) Environmental Screening Levels (ESLs). The petroleum hydrocarbons detected in the groundwater beneath the Site are associated with the up-gradient Valley Gas facility.

Additionally, groundwater beneath the Site contains concentrations of chlorinated volatile organic compounds (VOCs) including tetrachloroethene (PCE) and its' associated daughter compounds including trichloroethene (TCE), cis-1,2-dichloroethene (DCE), trans-1,2-DCE and vinyl chloride. The detected concentrations of chlorinated VOCs are above primary MCLs and/or ESLs. The origin of these chlorinated VOCs is likely from an off-site and up-gradient release.

Total lead and arsenic have been detected above ESLs in the near surface soils at the Site. The extent of these soils appears limited to the shallow soils within the northwest portion of the Groth Site. In addition, low-level petroleum hydrocarbons were detected in soil in the vicinity of the repair shops. The extent of these petroleum hydrocarbons appears limited.

NEXT STEPS

Currently, Valley Gas is performing a pilot study to evaluate the effectiveness of treating and remediating the associated off-site and on-site groundwater contamination. Based upon the findings of the pilot study, a remedial action plan will be developed and implemented to address the proposed planned redevelopment of the Site for mixed commercial and residential use. Additionally, excavation of near surface soils may take place as part of re-development activities at the Groth Site, which will address the associated near surface soil contamination at that time.

WATER BOARD OVERSIGHT PROCESS

The Water Board oversees more than 3,000 site cleanup cases in the Bay Area, including more than 2,000 leaking fuel tank cases. Water Board staff direct investigation or cleanup work and set cleanup standards under Water Code authority. Responsible parties (e.g., property owners or past operators)

propose specific measures, perform the actual work, and submit technical reports documenting task completion. As part of this process, we circulate key documents, such as draft cleanup plans, to interested persons and provide an opportunity for comment on these documents. Interested persons include other agencies, local officials, non-profit organizations, and interested landowners and residents/occupants in the Site vicinity.

DRAFT

1.1 PROJECT SIZE AND LOCATION

The Project Area, as illustrated in Figure A, encompasses approximately 189 acres along the southeastern edge of the City of Long Beach, that was recently annexed from unincorporated Los Angeles County into the corporate limits of the City of Long Beach.

Pacific Coast Highway — primarily a commercial strip — forms the western boundary of the property, along with the Market Place Shopping Center and Shopkeeper Road. The Project Area is bisected into northern and southern portions by Westminster Avenue. At the northerly edge, three relatively small, triangular-shaped parcels, formerly landfill sites, are separated from the larger parcels by the Los Cerritos Channel and Loynes Drive.

Landmarks in the area include the San Gabriel River to the south of the site, and Los Cerritos Channel to the north, Alamitos Bay/Marine Stadium and the communities of Belmont Shore and Naples to the west, and Edison Company's Regional Electrical Generating Plant to the east.

The Project Area has been extensively developed for oil production facilities that date back to the 1920's, and has been significantly affected by the construction of major adjoining roadways, as well as the diking, filing, and channelization of the San Gabriel River and Los Cerritos Channel.

Two landfills were historically operated within the area. The Studebaker-Loynes Landfill consists of two sites — one a triangular parcel north of the Los Cerritos Channel, the other a narrow rectangular parcel along Studebaker Road. The second landfill, the Market Place Landfill, is located in southern portion of the property, east of Coast Highway and north of the San Gabriel River.



ATTACHMENT 3
500-Foot "Radius List"

**500-Foot Radius List
57/59 South L Street
Livermore, California**

097 000101600
Nguyen Pham V & Nguyentran
Di T Trs
2265 Jeffrey St
Livermore Ca 94550

097 000101700
Occupant
2112 First St
Livermore Ca 94550-4544

097 000101800
Occupant
2086 First St
Livermore Ca 94550-4406

097 000102000
Occupant
2074 First St
Livermore Ca 94550-4406

097 000102100
Occupant
2068 First St
Livermore Ca 94550-4406

097 000102200
Occupant
2038 First St
Livermore Ca 94550-4406

097 000102300
Occupant
2032 First St
Livermore Ca 94550-4406

097 000102401
Occupant
2008 First St
Livermore Ca 94550-4406

097 000102601
Occupant
90 S L St
Livermore Ca 94550-3102

097 000101600
Occupant
2118 First St
Livermore Ca 94550-4544

097 000101700
Occupant
2106 First St
Livermore Ca 94550-4544

097 000102000
Hudson Lynne A & Richard
2794 West Rubyhill Dr
Pleasanton Ca 94566

097 000102100
Corbett Richard K & Pamela K
Trs
1453 First St
Livermore Ca 94550

097 000102100
Occupant
2056 First St
Livermore Ca 94550-4406

097 000102300
Bireley Jerry E Tr & Bireley
Kathleen A Tr
449 Encino Dr
Livermore Ca 94550

097 000102300
Occupant
2020 First St
Livermore Ca 94550-4406

097 000102601
Martin Family Trust
21095 Hemlock St
Groveland Ca 95321

097 000102601
Occupant
86 S L St
Livermore Ca 94550-3102

097 000101700
J V Properties
5955 Coronado Ln
Pleasanton Ca 94588

097 000101800
Chin Raymond
1067 Vienna St
Livermore Ca 94550

097 000102000
Occupant
2080 First St
Livermore Ca 94550-4406

097 000102100
Occupant
2062 First St
Livermore Ca 94550-4406

097 000102200
Bireley Jerry E Tr & Chance
Edna Tr Etal
449 Encino Dr
Livermore Ca 94550

097 000102300
Occupant
2026 First St
Livermore Ca 94550-4406

097 000102401
Angle Balaji S & Chhaya
35584 Conovan Ln
Fremont Ca 94536

097 000102601
Occupant
62 S L St
Livermore Ca 94550-3102

097 000102601
Occupant
74 S L St
Livermore Ca 94550-3102

097 000102602
Eidenmuller William C 3rd &
Gerald R Trs Etal
Po Box 572530
Salt Lake City Ut 84157

097 000102802
City Of Livermore
1052 S Livermore Ave
Livermore Ca 94550

097 000103000
Occupant
2048 First St
Livermore Ca 94550-4406

097 000300701
Occupant
1962 First St
Livermore Ca 94550

097 000400202
Boatright Marilyn L Tr
11354 Wild Oak Dr
Oakdale Ca 95361

097 000500110
Vine Partners Llc
P O Box 419127
Kansas City Mo 64141

097 001000101
Vadakkunnel Thomas T &
Celine T
4481 Peacock Ct
Dublin Ca 94568

097 001000203
Occupant
183 S N St
Livermore Ca 94550-4350

097 001100100
Occupant
161 S M St
Livermore Ca 94550-4400

097 001100100
Occupant
1820 Second St
Livermore Ca 94550-4425

097 000102602
Occupant
50 S L St
Livermore Ca 94550-3102

097 000103000
Bireley Jerry E Tr & Chance
Edna F Tr Etal
449 Encino Dr
Livermore Ca 94550

097 000300701
Groth Irene Tr & W M Jr & R G &
Rosalie B Trs
4420 Mines Rd
Livermore Ca 94550

097 000300701
Occupant
59 S L St
Livermore Ca 94550-3101

097 000400202
Occupant
1814 First St
Livermore Ca 94550-4402

097 000500110
Occupant
1790 First St
Livermore Ca 94550-4305

097 001000101
Occupant
1771 First St
Livermore Ca 94550-4304

097 001000203
Occupant
157 S N St
Livermore Ca 94550-4350

097 001100100
Occupant
1887 First St
Livermore Ca 94550-4401

097 001100301
Nigg John D & Marlys J Trs &
Nigg Timothy L Etal
1841 Fourth St
Livermore Ca 94550

097 000102801
Chiu Gabriel H & Laihar
11366 Village View Ct
Dublin Ca 94568

097 000103000
Occupant
2044 First St
Livermore Ca 94550-4406

097 000300701
Occupant
1934 First St
Livermore Ca 94550

097 000400102
Saccullo Dominick J & Martha A
Trs
1870 First St
Livermore Ca 94550

097 000400202
Occupant
1848 First St
Livermore Ca 94550-4402

097 000500110
Occupant
1780 First St
Livermore Ca 94550-4305

097 001000203
Atkinson Margery J Tr
2171 Jewell Dr
San Jose Ca 95124

097 001100100
Guaranty Bank
Po Box 684827
Austin Tx 78768

097 001100100
Occupant
1860 Second St
Livermore Ca 94550-4425

097 001100301
Occupant
1855 First St
Livermore Ca 94550-4401

097 001100301
Occupant
1859 First St
Livermore Ca 94550-4401

097 001100301
Occupant
1873 First St
Livermore Ca 94550-4401

097 001100503
Occupant
1817 First St
Livermore Ca 94550-4401

097 001200101
Occupant
1987 First St
Livermore Ca 94550-4403

097 001200201
Occupant
153 S L St
Livermore Ca 94550-4435

097 001200500
Davis Alta D Tr
1617 Regent Dr
San Leandro Ca 94577

097 001200500
Occupant
1917 First St
Livermore Ca 94550-4403

097 001300100
Occupant
2071 First St
Livermore Ca 94550-4405

097 001300200
Raboli Con F & Marlene J Trs &
Raboli Brent A Etal
3080 Rivera Dr
Burlingame Ca 94010

097 001300300
Raboli Con F & Marlene J Trs
Etal
3080 Rivera Dr
Burlingame Ca 94010

097 001100301
Occupant
1857 First St
Livermore Ca 94550-4401

097 001100400
Mccloskey John A
1845 1st St
Livermore Ca 94550

097 001200101;2-1
Nigg Daniel & Sherry
849 Bower Ct
Livermore Ca 94550

097 001200102
Maxwell Jack Tr
7960b Soquel Dr
Aptos Ca 95003

097 001200303
Occupant
1986 Second St
Livermore Ca 94550-4427

097 001200500
Occupant
1912 Second St
Livermore Ca 94550-4427

097 001300100
Bacharach Penny C Etal
40 Caribe Isle
Novato Ca 94949

097 001300100
Occupant
2083 First St
Livermore Ca 94550-4405

097 001300200
Occupant
2060 Second St
Livermore Ca 94550-4429

097 001300300
Occupant
2046 Second St
Livermore Ca 94550-4429

097 001100301
Occupant
1850 Second St
Livermore Ca 94550-4401

097 001100503
Wong Alan B & Yuet W Trs
922 Moraga Ct
Palo Alto Ca 94303

097 001200101
Occupant
1989 First St
Livermore Ca 94550-4403

097 001200102
Occupant
1931 First St
Livermore Ca 94550-4403

097 001200303
Occupant
1984 Second St
Livermore Ca 94550-4427

097 001200500
Occupant
1916 Second St
Livermore Ca 94550-4427

097 001300100
Occupant
123 K St 1
Livermore Ca 94550

097 001300100
Occupant
123 K St 2
Livermore Ca 94550

097 001300200
Occupant
2074 Second St
Livermore Ca 94550-4429

097 001300500
Picha Stephen L & Gayle
335 Covellite Ln
Livermore Ca 94550

097 001300500
Occupant
174 S L St
Livermore Ca 94550-4408

097 001300601
Occupant
136 S L St
Livermore Ca 94550-4408

097 001300601
Occupant
142 S L St
Livermore Ca 94550-4408

097 001300800
Henne Siegfried J & Helen L Trs
6021 Golden Center Ct 316
Placerville Ca 95667

097 001300900
Occupant
2047 First St
Livermore Ca 94550-4405

097 001301000
Occupant
2053 First St
Livermore Ca 94550-4405

097 001400601
Occupant
152 S K St
Livermore Ca 94550-4511

097 001400601
Occupant
184 S K St
Livermore Ca 94550-4511

097 001400700
Williford Commercial Properties
Po Box 2805
Livermore Ca 94551

097 001400802
Occupant
2121 First St
Livermore Ca 94550-4543

097 001300601
Seput Walter G & Jean R Trs
300 Montgomery St 800
San Francisco Ca 94104

097 001300601
Occupant
148 S L St
Livermore Ca 94550-4408

097 001300703
Janes Stanley C & Ethel A Trs
7221 Evan Ave
Sebastopol Ca 95472

097 001300800
Occupant
2041 First St
Livermore Ca 94550-4405

097 001301000
Bates Austin L & Patricia J Trs
1743 Buena Vista Ave
Livermore Ca 94550

097 001400601
Char Mar Llc
1897 College Ave
Livermore Ca 94550

097 001400601
Occupant
160 S K St
Livermore Ca 94550-4511

097 001400601
Occupant
174 S K St
Livermore Ca 94550-4511

097 001400700
Occupant
2115 First St
Livermore Ca 94550-4543

097 001900201
Metropolitan Life Insurance
Company
P.O. Box 4900
Scottsdale Az 85261

097 001300601
Occupant
2017 First St
Livermore Ca 94550-4405

097 001300601
Occupant
120 S L St
Livermore Ca 94550-4408

097 001300703
Occupant
2029 First St
Livermore Ca 94550-4405

097 001300900
City Livermore Redevelopment
1052 S Livermore Ave
Livermore Ca 94550

097 001301000
Occupant
2059 First St
Livermore Ca 94550-4405

097 001400601
Occupant
144 S K St
Livermore Ca 94550-4511

097 001400601
Occupant
186 S K St
Livermore Ca 94550-4511

097 001400601
Occupant
128 S K St
Livermore Ca 94550-4511

097 001400802
Sturman David & Celinda
1945 Carroll Ave
San Francisco Ca 94124

097 001900201
Occupant
275 S K St
Livermore Ca 94550-4512

097 001900402
Dairiki Mamie T & Richard S
Po Box 391622
Mountain View Ca 94039

097 001900500
Occupant
212 S L St
Livermore Ca 94550-4410

097 001900600
Wells Fargo Bank
P.O. Box 2609
Carlsbad Ca 92018

097 001900801
Occupant
235 S K St
Livermore Ca 94550-4512

097 002000704
Occupant
1919 Second St
Livermore Ca 94550-4426

097 002000704
Occupant
1959 Second St
Livermore Ca 94550-4426

097 002000704
Occupant
1947 Second St
Livermore Ca 94550-4426

097 002100301
Occupant
287 N M St
Livermore Ca 94551-2823

097 002100301
Occupant
1883 Second St
Livermore Ca 94550-4424

097 002100401
Occupant
1856 Third St
Livermore Ca 94550-4431

097 001900402
Occupant
282 S L St
Livermore Ca 94550-4410

097 001900500
Occupant
2011 Second St
Livermore Ca 94550-4428

097 001900600
Occupant
235 S K St
Livermore Ca 94550-4512

097 002000704
Eden Plaza Llc & Ku Kyoung J
Etal
P O Box 5159
Pleasanton Ca 94566

097 002000704
Occupant
1935 Second St
Livermore Ca 94550-4426

097 002000704
Occupant
1983 Second St
Livermore Ca 94550-4426

097 002000704
Occupant
1971 Second St
Livermore Ca 94550-4426

097 002100301
Occupant
1861 Second St
Livermore Ca 94550-4424

097 002100301
Occupant
1891 Second St
Livermore Ca 94550-4424

097 002100700
Society Of St Vincent De Paul
9235 San Leandro St
Oakland Ca 94603

097 001900500
Nguyen Pham V & Nguyentran
Di T Trs
2265 Jeffrey St
Livermore Ca 94550

097 001900500
Occupant
202 S L St
Livermore Ca 94550-4410

097 001900801
Atc Building Company
P.O. Box 2609
Carlsbad Ca 92018

097 002000704
Occupant
1911 Second St
Livermore Ca 94550-4426

097 002000704
Occupant
1923 Second St
Livermore Ca 94550-4426

097 002000704
Occupant
1983 Second St B
Livermore Ca 94550-4426

097 002100301
Potthoff Clifford M & Helen M Trs
2756 Kennedy St
Livermore Ca 94551

097 002100301
Occupant
1875 Second St
Livermore Ca 94550-4424

097 002100401
Mcgann Karen K & Michael J
1767 Tahoe Ct
Livermore Ca 94550

097 002100700
Occupant
1821 Second St
Livermore Ca 94550-4424

097 002100700
Occupant
1817 Second St
Livermore Ca 94550-4424

098 028200201
Acciaioli Ronald Tr
1363 S Livermore Ave
Livermore Ca 94550

098 028200201
Occupant
116 N L St
Livermore Ca 94550-2118

098 028901208
Livermore Village I Llc
6701 Center Drive West 710
Los Angeles Ca 90045

098 028901208
Occupant
29 S Livermore Ave
Livermore Ca 94550

098 028901208
Occupant
2033 Railroad Ave
Livermore Ca 94550-2019

098 028901208
Occupant
2105 Railroad Ave
Livermore Ca 94550-3121

098 028901208
Occupant
22 S L St
Livermore Ca 94550-3102

098 028901208
Occupant
2009 Railroad Ave
Livermore Ca 94550-2019

098 028901208
Occupant
2139 Railroad Ave
Livermore Ca 94550-3121

098 028901208
Occupant
20 S L St
Livermore Ca 94550-3102

098 028901208
Occupant
2089 Railroad Ave
Livermore Ca 94550-2019

098 028901208
Occupant
2111 Railroad Ave
Livermore Ca 94550-3121

098 028901208
Occupant
2051 Railroad Ave
Livermore Ca 94550-2019

098 028901208
Occupant
2091 Railroad Ave
Livermore Ca 94550-2019

098 028901208
Occupant
2093 Railroad Ave
Livermore Ca 94550-2019

098 028901208
Occupant
2097 Railroad Ave
Livermore Ca 94550-2019

098 028901208
Occupant
2085 Railroad Ave
Livermore Ca 94550-2019

098 028901208
Occupant
2073 Railroad Ave
Livermore Ca 94550-2019

098 028901208
Occupant
2041 Railroad Ave
Livermore Ca 94550-2019

098 040500300
Mill Springs Park Apartments Llc
One Lagoon Dr #300
Redwood City Ca 94065

098 040500300
Occupant
1867 Mill Springs Cmn #205
Livermore Ca 94550-6382

098 040500300
Occupant
1713 Mill Springs Cmn #311
Livermore Ca 94550-8725

098 040500300
Occupant
1843 Mill Springs Cmn #305
Livermore Ca 94550-4286

098 040500300
Occupant
1889 Mill Springs Cmn #303
Livermore Ca 94550-6386

098 040500300
Occupant
1713 Mill Springs Cmn #205
Livermore Ca 94550-8722

098 040500300
Occupant
1779 Mill Springs Cmn #309
Livermore Ca 94550-8711

098 040500300
Occupant
1713 Mill Springs Cmn #111
Livermore Ca 94550-8721

098 040500300
Occupant
1889 Mill Springs Cmn #215
Livermore Ca 94550-4293

098 040500300
Occupant
1779 Mill Springs Cmn #111
Livermore Ca 94550-8707

098 040500300
Occupant
1713 Mill Springs Cmn #305
Livermore Ca 94550-8724

098 040500300
Occupant
1713 Mill Springs Cmn #105
Livermore Ca 94550-8720

098 040500300
Occupant
1713 Mill Springs Cmn #303
Livermore Ca 94550-8724

098 040500300
Occupant
1843 Mill Springs Cmn #115
Livermore Ca 94550-4281

098 040500300
Occupant
1791 Mill Springs Cmn #115
Livermore Ca 94550-8713

098 040500300
Occupant
1735 Mill Springs Cmn #103
Livermore Ca 94550-8726

098 040500300
Occupant
1735 Mill Springs Cmn #107
Livermore Ca 94550-8726

098 040500300
Occupant
1821 Mill Springs Cmn #105
Livermore Ca 94550-4277

098 040500300
Occupant
1867 Mill Springs Cmn #307
Livermore Ca 94550-4289

098 040500300
Occupant
1779 Mill Springs Cmn #209
Livermore Ca 94550-8709

098 040500300
Occupant
1843 Mill Springs Cmn #107
Livermore Ca 94550-4284

098 040500300
Occupant
1821 Mill Springs Cmn #113
Livermore Ca 94550-6377

098 040500300
Occupant
1843 Mill Springs Cmn #113
Livermore Ca 94550-4281

098 040500300
Occupant
1867 Mill Springs Cmn #103
Livermore Ca 94550-4288

098 040500300
Occupant
1843 Mill Springs Cmn #215
Livermore Ca 94550-4282

098 040500300
Occupant
1757 Mill Springs Cmn #201
Livermore Ca 94550-8704

098 040500300
Occupant
1821 Mill Springs Cmn #205
Livermore Ca 94550-6378

098 040500300
Occupant
1843 Mill Springs Cmn #207
Livermore Ca 94550-4285

098 040500300
Occupant
1757 Mill Springs Cmn #113
Livermore Ca 94550-8700

098 040500300
Occupant
1843 Mill Springs Cmn #213
Livermore Ca 94550-4282

098 040500300
Occupant
1779 Mill Springs Cmn #201
Livermore Ca 94550-8708

098 040500300
Occupant
1757 Mill Springs Cmn #101
Livermore Ca 94550-8703

098 040500300
Occupant
1713 Mill Springs Cmn #213
Livermore Ca 94550-8723

098 040500300
Occupant
1779 Mill Springs Cmn #315
Livermore Ca 94550-8711

098 040500300
Occupant
1713 Mill Springs Cmn #201
Livermore Ca 94550-8722

098 040500300
Occupant
1821 Mill Springs Cmn #313
Livermore Ca 94550-4279

098 040500300
Occupant
1843 Mill Springs Cmn #111
Livermore Ca 94550-4281

098 040500300
Occupant
1821 Mill Springs Cmn #115
Livermore Ca 94550-6377

098 040500300
Occupant
1821 Mill Springs Cmn #109
Livermore Ca 94550-4278

098 040500300
Occupant
1713 Mill Springs Cmn #313
Livermore Ca 94550-8725

098 040500300
Occupant
1821 Mill Springs Cmn #211
Livermore Ca 94550-6378

098 040500300
Occupant
1821 Mill Springs Cmn #207
Livermore Ca 94550-6378

098 040500300
Occupant
1821 Mill Springs Cmn #311
Livermore Ca 94550-4279

098 040500300
Occupant
1791 Mill Springs Cmn #105
Livermore Ca 94550-8712

098 040500300
Occupant
1779 Mill Springs Cmn #301
Livermore Ca 94550-8710

098 040500300
Occupant
1821 Mill Springs Cmn #305
Livermore Ca 94550-4278

098 040500300
Occupant
1735 Mill Springs Cmn #303
Livermore Ca 94550-8730

098 040500300
Occupant
1843 Mill Springs Cmn #205
Livermore Ca 94550-4285

098 040500300
Occupant
1843 Mill Springs Cmn #211
Livermore Ca 94550-4282

098 040500300
Occupant
1779 Mill Springs Cmn #101
Livermore Ca 94550-8706

098 040500300
Occupant
1779 Mill Springs Cmn #103
Livermore Ca 94550-8706

098 040500300
Occupant
1821 Mill Springs Cmn #307
Livermore Ca 94550-4278

098 040500300
Occupant
1821 Mill Springs Cmn #215
Livermore Ca 94550-6380

098 040500300
Occupant
1867 Mill Springs Cmn #107
Livermore Ca 94550-4288

098 040500300
Occupant
1867 Mill Springs Cmn #211
Livermore Ca 94550-6382

098 040500300
Occupant
1791 Mill Springs Cmn #215
Livermore Ca 94550-8715

098 040500300
Occupant
1821 Mill Springs Cmn #201
Livermore Ca 94550-6377

098 040500300
Occupant
1843 Mill Springs Cmn #105
Livermore Ca 94550-4284

098 040500300
Occupant
1843 Mill Springs Cmn #209
Livermore Ca 94550-4282

098 040500300
Occupant
1889 Mill Springs Cmn #315
Livermore Ca 94550-6386

098 040500300
Occupant
1821 Mill Springs Cmn #107
Livermore Ca 94550-4277

098 040500300
Occupant
1713 Mill Springs Cmn #301
Livermore Ca 94550-8724

098 040500300
Occupant
1821 Mill Springs Cmn #101
Livermore Ca 94550-4277

098 040500300
Occupant
1757 Mill Springs Cmn #215
Livermore Ca 94550-8701

098 040500300
Occupant
1757 Mill Springs Cmn #115
Livermore Ca 94550-8700

098 040500300
Occupant
1843 Mill Springs Cmn #313
Livermore Ca 94550-4283

098 040500300
Occupant
1821 Mill Springs Cmn #301
Livermore Ca 94550-6380

098 040500300
Occupant
1867 Mill Springs Cmn #207
Livermore Ca 94550-6382

098 040500300
Occupant
1713 Mill Springs Cmn #309
Livermore Ca 94550-8725

098 040500300
Occupant
1735 Mill Springs Cmn #203
Livermore Ca 94550-8728

098 040500300
Occupant
1889 Mill Springs Cmn #213
Livermore Ca 94550-4293

098 040500300
Occupant
1867 Mill Springs Cmn #213
Livermore Ca 94550-6383

098 040500300
Occupant
1843 Mill Springs Cmn #101
Livermore Ca 94550-4284

098 040500300
Occupant
1757 Mill Springs Cmn #315
Livermore Ca 94550-8702

098 040500300
Occupant
1867 Mill Springs Cmn #111
Livermore Ca 94550-4289

098 040500300
Occupant
1779 Mill Springs Cmn #213
Livermore Ca 94550-8709

098 040500300
Occupant
1889 Mill Springs Cmn #209
Livermore Ca 94550-4293

098 040500300
Occupant
1843 Mill Springs Cmn #203
Livermore Ca 94550-4285

098 040500300
Occupant
1821 Mill Springs Cmn #315
Livermore Ca 94550-4279

098 040500300
Occupant
1713 Mill Springs Cmn #215
Livermore Ca 94550-8723

098 040500300
Occupant
1713 Mill Springs Cmn #315
Livermore Ca 94550-8725

098 040500300
Occupant
1735 Mill Springs Cmn #113
Livermore Ca 94550-8727

098 040500300
Occupant
1843 Mill Springs Cmn #201
Livermore Ca 94550-4285

098 040500300
Occupant
1821 Mill Springs Cmn #309
Livermore Ca 94550-4279

098 040500300
Occupant
1843 Mill Springs Cmn #103
Livermore Ca 94550-4284

098 040500300
Occupant
1713 Mill Springs Cmn #115
Livermore Ca 94550-8721

098 040500300
Occupant
1889 Mill Springs Cmn #109
Livermore Ca 94550-6385

098 040500300
Occupant
1843 Mill Springs Cmn #309
Livermore Ca 94550-4283

098 040500300
Occupant
1809 Railroad Ave
Livermore Ca 94550-4670

098 040500300
Occupant
1779 Mill Springs Cmn #115
Livermore Ca 94550-8707

098 040500300
Occupant
1757 Mill Springs Cmn #109
Livermore Ca 94550-8700

098 040500300
Occupant
1867 Mill Springs Cmn #209
Livermore Ca 94550-6382

098 040500300
Occupant
1757 Mill Springs Cmn #213
Livermore Ca 94550-8701

098 040500300
Occupant
1821 Mill Springs Cmn #209
Livermore Ca 94550-6378

098 040500300
Occupant
1713 Mill Springs Cmn #209
Livermore Ca 94550-8723

098 040500300
Occupant
1889 Mill Springs Cmn #309
Livermore Ca 94550-6386

098 040500300
Occupant
1779 Mill Springs Cmn #305
Livermore Ca 94550-8710

098 040500300
Occupant
1791 Mill Springs Cmn #311
Livermore Ca 94550-8716

098 040500300
Occupant
1757 Mill Springs Cmn #111
Livermore Ca 94550-8700

098 040500300
Occupant
1735 Mill Springs Cmn #215
Livermore Ca 94550-8729

098 040500300
Occupant
1843 Mill Springs Cmn #303
Livermore Ca 94550-4286

098 040500300
Occupant
1843 Mill Springs Cmn #109
Livermore Ca 94550-4281

098 040500300
Occupant
1889 Mill Springs Cmn #103
Livermore Ca 94550-6384

098 040500300
Occupant
1757 Mill Springs Cmn #207
Livermore Ca 94550-8704

098 040500300
Occupant
1779 Mill Springs Cmn #113
Livermore Ca 94550-8707

098 040500300
Occupant
1889 Mill Springs Cmn #101
Livermore Ca 94550-6384

098 040500300
Occupant
1779 Mill Springs Cmn #311
Livermore Ca 94550-8711

098 040500300
Occupant
1867 Mill Springs Cmn #309
Livermore Ca 94550-4289

098 040500300
Occupant
1735 Mill Springs Cmn #201
Livermore Ca 94550-8728

098 040500300
Occupant
1791 Mill Springs Cmn #305
Livermore Ca 94550-8716

098 040500300
Occupant
1757 Mill Springs Cmn #107
Livermore Ca 94550-8703

098 040500300
Occupant
1889 Mill Springs Cmn #115
Livermore Ca 94550-6385

098 040500300
Occupant
1889 Mill Springs Cmn #301
Livermore Ca 94550-4293

098 040500300
Occupant
1735 Mill Springs Cmn #309
Livermore Ca 94550-8731

098 040500300
Occupant
1757 Mill Springs Cmn #311
Livermore Ca 94550-8702

098 040500300
Occupant
1889 Mill Springs Cmn #307
Livermore Ca 94550-6386

098 040500300
Occupant
1713 Mill Springs Cmn #101
Livermore Ca 94550-8720

098 040500300
Occupant
1713 Mill Springs Cmn #307
Livermore Ca 94550-8724

098 040500300
Occupant
1735 Mill Springs Cmn #301
Livermore Ca 94550-8730

098 040500300
Occupant
1889 Mill Springs Cmn #311
Livermore Ca 94550-6386

098 040500300
Occupant
1791 Mill Springs Cmn #205
Livermore Ca 94550-8714

098 040500300
Occupant
1779 Mill Springs Cmn #211
Livermore Ca 94550-8709

098 040500300
Occupant
1791 Mill Springs Cmn #309
Livermore Ca 94550-8716

098 040500300
Occupant
1757 Mill Springs Cmn #305
Livermore Ca 94550-8705

098 040500300
Occupant
1889 Mill Springs Cmn #207
Livermore Ca 94550-4292

098 040500300
Occupant
1889 Mill Springs Cmn #201
Livermore Ca 94550-4292

098 040500300
Occupant
1889 Mill Springs Cmn #203
Livermore Ca 94550-4292

098 040500300
Occupant
1757 Mill Springs Cmn #309
Livermore Ca 94550-8702

098 040500300
Occupant
1735 Mill Springs Cmn #115
Livermore Ca 94550-8727

098 040500300
Occupant
1735 Mill Springs Cmn #209
Livermore Ca 94550-8729

098 040500300
Occupant
1843 Mill Springs Cmn #311
Livermore Ca 94550-4283

098 040500300
Occupant
1889 Mill Springs Cmn #111
Livermore Ca 94550-6385

098 040500300
Occupant
1713 Mill Springs Cmn #207
Livermore Ca 94550-8722

098 040500300
Occupant
1713 Mill Springs Cmn #107
Livermore Ca 94550-8720

098 040500300
Occupant
1735 Mill Springs Cmn #111
Livermore Ca 94550-8727

098 040500300
Occupant
1735 Mill Springs Cmn #311
Livermore Ca 94550-8731

098 040500300
Occupant
1713 Mill Springs Cmn #113
Livermore Ca 94550-8721

098 040500300
Occupant
1889 Mill Springs Cmn #211
Livermore Ca 94550-4293

098 040500300
Occupant
1791 Mill Springs Cmn #209
Livermore Ca 94550-8715

098 040500300
Occupant
1821 Mill Springs Cmn #213
Livermore Ca 94550-6380

098 040500300
Occupant
1821 Mill Springs Cmn #111
Livermore Ca 94550-4278

098 040500300
Occupant
1779 Mill Springs Cmn #307
Livermore Ca 94550-8710

098 040500300
Occupant
1735 Mill Springs Cmn #213
Livermore Ca 94550-8729

098 040500300
Occupant
1735 Mill Springs Cmn #313
Livermore Ca 94550-8731

098 040500300
Occupant
1867 Mill Springs Cmn #303
Livermore Ca 94550-6383

098 040500300
Occupant
1867 Mill Springs Cmn #113
Livermore Ca 94550-6381

098 040500300
Occupant
1713 Mill Springs Cmn #103
Livermore Ca 94550-8720

098 040500300
Occupant
1779 Mill Springs Cmn #109
Livermore Ca 94550-8707

098 040500300
Occupant
1735 Mill Springs Cmn #205
Livermore Ca 94550-8728

098 040500300
Occupant
1867 Mill Springs Cmn #105
Livermore Ca 94550-4288

098 040500300
Occupant
1867 Mill Springs Cmn #305
Livermore Ca 94550-6383

098 040500300
Occupant
1867 Mill Springs Cmn #115
Livermore Ca 94550-6381

098 040500300
Occupant
1779 Mill Springs Cmn #203
Livermore Ca 94550-8708

098 040500300
Occupant
1779 Mill Springs Cmn #303
Livermore Ca 94550-8710

098 040500300
Occupant
1779 Mill Springs Cmn #105
Livermore Ca 94550-8706

098 040500300
Occupant
1821 Mill Springs Cmn #203
Livermore Ca 94550-6377

098 040500300
Occupant
1713 Mill Springs Cmn #211
Livermore Ca 94550-8723

098 040500300
Occupant
1867 Mill Springs Cmn #311
Livermore Ca 94550-4290

098 040500300
Occupant
1843 Mill Springs Cmn #307
Livermore Ca 94550-4286

098 040500300
Occupant
1821 Mill Springs Cmn #103
Livermore Ca 94550-4277

098 040500300
Occupant
1791 Mill Springs Cmn #303
Livermore Ca 94550-8715

098 040500300
Occupant
1889 Mill Springs Cmn #305
Livermore Ca 94550-6386

098 040500300
Occupant
1779 Mill Springs Cmn #215
Livermore Ca 94550-8709

098 040500300
Occupant
1779 Mill Springs Cmn #207
Livermore Ca 94550-8708

098 040500300
Occupant
1757 Mill Springs Cmn #307
Livermore Ca 94550-8705

098 040500300
Occupant
1889 Mill Springs Cmn #113
Livermore Ca 94550-6385

098 040500300
Occupant
1867 Mill Springs Cmn #201
Livermore Ca 94550-6381

098 040500300
Occupant
1735 Mill Springs Cmn #207
Livermore Ca 94550-8728

098 040500300
Occupant
1757 Mill Springs Cmn #205
Livermore Ca 94550-8704

098 040500300
Occupant
1757 Mill Springs Cmn #105
Livermore Ca 94550-8703

098 040500300
Occupant
1791 Mill Springs Cmn #111
Livermore Ca 94550-8713

098 040500300
Occupant
1889 Mill Springs Cmn #205
Livermore Ca 94550-4292

098 040500300
Occupant
1791 Mill Springs Cmn #103
Livermore Ca 94550-8712

098 040500300
Occupant
1779 Mill Springs Cmn #107
Livermore Ca 94550-8706

098 040500300
Occupant
1791 Mill Springs Cmn #211
Livermore Ca 94550-8715

098 040500300
Occupant
1791 Mill Springs Cmn #201
Livermore Ca 94550-8714

098 040500300
Occupant
1735 Mill Springs Cmn #109
Livermore Ca 94550-8727

098 040500300
Occupant
1779 Mill Springs Cmn #313
Livermore Ca 94550-8711

098 040500300
Occupant
1713 Mill Springs Cmn #109
Livermore Ca 94550-8721

098 040500300
Occupant
1757 Mill Springs Cmn #303
Livermore Ca 94550-8705

098 040500300
Occupant
1779 Mill Springs Cmn #205
Livermore Ca 94550-8708

098 040500300
Occupant
1791 Mill Springs Cmn #101
Livermore Ca 94550-8712

098 040500300
Occupant
1867 Mill Springs Cmn #109
Livermore Ca 94550-4289

098 040500300
Occupant
1735 Mill Springs Cmn #315
Livermore Ca 94550-8731

098 040500300
Occupant
1791 Mill Springs Cmn #203
Livermore Ca 94550-8714

098 040500300
Occupant
1735 Mill Springs Cmn #105
Livermore Ca 94550-8726

098 040500300
Occupant
1735 Mill Springs Cmn #307
Livermore Ca 94550-8730

098 040500300
Occupant
1735 Mill Springs Cmn #211
Livermore Ca 94550-8729

098 040500300
Occupant
1889 Mill Springs Cmn #313
Livermore Ca 94550-6386

098 040500300
Occupant
1757 Mill Springs Cmn #203
Livermore Ca 94550-8704

098 040500300
Occupant
1757 Mill Springs Cmn #103
Livermore Ca 94550-8703

098 040500300
Occupant
1757 Mill Springs Cmn #211
Livermore Ca 94550-8701

098 040500300
Occupant
1735 Mill Springs Cmn #101
Livermore Ca 94550-8726

098 040500300
Occupant
1791 Mill Springs Cmn #213
Livermore Ca 94550-8715

098 040500300
Occupant
1757 Mill Springs Cmn #209
Livermore Ca 94550-8701

098 040500300
Occupant
1867 Mill Springs Cmn #313
Livermore Ca 94550-4290

098 040500300
Occupant
1735 Mill Springs Cmn #305
Livermore Ca 94550-8730

098 040500300
Occupant
1791 Mill Springs Cmn #107
Livermore Ca 94550-8712

098 040800200
Tarantino Christopher M & Lori A
1984 Railroad Ave
Livermore Ca 94550

098 040802100
Balin Michael J
1926 Railroad Ave #100
Livermore Ca 94550

098 040500300
Occupant
1757 Mill Springs Cmn #301
Livermore Ca 94550-8705

098 040500300
Occupant
1791 Mill Springs Cmn #307
Livermore Ca 94550-8716

098 040500300
Occupant
1791 Mill Springs Cmn #113
Livermore Ca 94550-8713

098 040500300
Occupant
1821 Mill Springs Cmn #303
Livermore Ca 94550-6380

098 040500300
Occupant
1867 Mill Springs Cmn #101
Livermore Ca 94550-4288

098 040500300
Occupant
1757 Mill Springs Cmn #313
Livermore Ca 94550-8702

098 040500300
Occupant
1791 Mill Springs Cmn #313
Livermore Ca 94550-8716

098 040500400
Groth William M Jr Etal
4446 Edgewood Dr
Livermore Ca 94550

098 040800200
Occupant
1980 Railroad Ave
Livermore Ca 94550-3135

098 040802200
Nop Mony
1976 Railroad Ave #102
Livermore Ca 94550

098 040500300
Occupant
1791 Mill Springs Cmn #207
Livermore Ca 94550-8714

098 040500300
Occupant
1867 Mill Springs Cmn #215
Livermore Ca 94550-6383

098 040500300
Occupant
1791 Mill Springs Cmn #109
Livermore Ca 94550-8713

098 040500300
Occupant
1713 Mill Springs Cmn #203
Livermore Ca 94550-8722

098 040500300
Occupant
1867 Mill Springs Cmn #203
Livermore Ca 94550-6381

098 040500300
Occupant
1889 Mill Springs Cmn #105
Livermore Ca 94550-6384

098 040500300
Occupant
1889 Mill Springs Cmn #107
Livermore Ca 94550-6384

098 040500400
Occupant
57 S L St
Livermore Ca 94550-3101

098 040800500
Signature Station Square Llc
4670 Willow Rd #200
Pleasanton Ca 94588

098 040802300
Willis Corrigan J
1926 Railroad Ave #104
Livermore Ca 94550

098 040802400
Andrews Diane
1926 Railroad Ave #106
Livermore Ca 94550

098 040802500
Newton Merlin J & Travis B
1926 Railroad Ave #108
Livermore Ca 94550

098 040802600
Bueno Rafael
1926 Railroad Ave #110
Livermore Ca 94550

098 040802700
Matheson Keri M & Peter M
1926 Railroad Ave #112
Livermore Ca 94550

098 040802800
Wilson Robert & Mary L
1926 Railroad Ave #114
Livermore Ca 94550

098 040802900
Enriquez Susan
1926 Railroad Ave #116
Livermore Ca 94550

098 040803000
Widmayer Clifford C & Jo D
1926 Railroad Ave ##118
Livermore Ca 94550

098 040803100
Busch Jennifer & Christopher
1926 Railroad Ave #120
Livermore Ca 94550

098 040803200
Coler Alyson M
1926 Railroad Ave #122
Livermore Ca 94550

098 040803300
Occupant
1926 Railroad Ave
Livermore Ca 94550-3135

098 040803400
Jew Reyna S & Robert M Etal
608 Southgate Ave
Daly City Ca 94015

098 040803400
Occupant
1948 Railroad Ave #100
Livermore Ca 94550-3135

098 040803500
Agosta Antonio O & Greenman
Christopher Etal
1358 Lennox Ln
Livermore Ca 94550

098 040803500
Occupant
1948 Railroad Ave #102
Livermore Ca 94550-3135

098 040803600
Perlin Thomas & Allison
1948 Railroad Ave #104
Livermore Ca 94550

098 040803700
Hilke Lisa F
1948 Railroad Ave #106
Livermore Ca 94550

098 040803800
Araya Sachiko
1948 Railroad Ave #108
Livermore Ca 94550

098 040803900
Randhawa Harkiran S & Prabhjot
K Etal
1948 Railroad Ave #110
Livermore Ca 94550

098 040804000
Occupant
1948 Railroad Ave
Livermore Ca 94550-3135

098 040804100
Occupant
161 L St 101
Livermore Ca 94550

098 040804900
Occupant
161 N L St
Livermore Ca 94550-2017

098 040813300
Occupant
1874 Railroad Ave #102
Livermore Ca 94550

098 040813500
Occupant
1874 Railroad Ave #106
Livermore Ca 94550

098 040813600
Occupant
1874 Railroad Ave #108
Livermore Ca 94550

098 040813700
Plunkett Michael E
1874 Railroad Ave #110
Livermore Ca 94550

098 040813800
Mckinzie Eric & Monique
1759 Altamont Cir
Livermore Ca 94551

098 040813800
Occupant
1874 Railroad Ave #112
Livermore Ca 94550

098 040813900
Alexander Brad A
1874 Railroad Ave #114
Livermore Ca 94550

098 040814000
Padillo Erlynn S
1874 Railroad Ave #116
Livermore Ca 94550

098 040814100
Ring Debra K & Meridith M Etal
1874 Railroad Ave #118
Livermore Ca 94550

▲
:
▼ 098 040814200
Quinn Gregory
1874 Railroad Ave #120
Livermore Ca 94550

098 040814300
Occupant
1874 Railroad Ave
Livermore Ca 94550