

Ultramar

Ultramar Inc.
P.O. Box 466
525 W. Third Street
Hanford, CA 93232-0466
(209) 582-0241

Telecopy: 209-585-5685 Credit
209-583-3330 Administrative
209-583-3302 Information Services
209-583-3358 Accounting

ENVIRONMENTAL PROJECT QUARTERLY STATUS REPORT

DATE REPORT SUBMITTED: July 27, 1998
QUARTER ENDING: June 30, 1998

SERVICE STATION NO.: 720
ADDRESS: 1088 Marina Blvd., San Leandro, CA
COUNTY: Alameda

ULTRAMAR CONTACT: Terrence A. Fox **TEL. NO:** 209-583-3345

BACKGROUND:

In January 1987, three underground gasoline storage tanks and one waste oil tank were excavated and removed from two tank cavities. Samples collected from beneath the former tanks indicated that hydrocarbons were present in the soil. In March 1987, five monitoring wells (MW-1 through MW-5) were installed by Conoco. Hydrocarbons were detected in soil and ground-water samples collected from the wells with the highest concentrations being detected in the area of MW-4. In July 1987, four soil borings were drilled in the vicinity of MW-4 to further characterize the soil contamination in that area. TPH concentrations above 100 ppm were detected in each boring. The site has been on a monitoring program since June 1987.

In July 1990, the site was purchased by Ultramar Inc. from Conoco. The monitoring program has continued.

In August 1991, perform shallow ground water study as screening tool to locate wells.

In October 1991, installed three additional wells to further define the extent of the dissolved hydrocarbon plume.

In October 1993, performed a ground-water pump test, a vapor extraction test, and a air sparging test.

In May 1994, submitted Problem Assessment Report/Remedial Action Plan.

In December 1994, installed one additional monitoring well, six air sparging points, and one vapor extraction well.



A Member of the Ultramar Group of Companies

BEACON
#1 Quality And Service

In June 1997, began operation of vapor extraction system.

In July 1997, the ground water recovery system and the air sparging system began operation.

SUMMARY OF THIS QUARTER'S ACTIVITIES:

Performed quarterly monitoring on May 28, 1998. Continued to operate the vapor extraction and air sparging systems. The ground-water system did not operate during the second quarter.

RESULT OF QUARTERLY MONITORING:

Monitoring data indicates that the benzene concentrations were not detected in MW-1, MW-2, MW-3, MW-4, MW-6, MW-7, and MW-8. Benzene concentrations were detected in MW-5 and MW-9.

The ground water extraction system has processed approximately 228,400 gallons of water. **Approximately 1,715 pounds of hydrocarbons have been removed by the vapor extraction system.**

PROPOSED ACTIVITY OR WORK FOR NEXT QUARTER:

<u>ACTIVITY</u>	<u>ESTIMATED COMPLETION DATE</u>
Continue quarterly monitoring program.	
Continue operation of the vapor extraction and air sparging remediation systems.	



3164 Gold Camp Drive
Suite 200
Rancho Cordova, CA 95670
916/638-2085
FAX: 916/638-8385

July 22, 1998

Mr. Terrence A. Fox
Ultramar, Inc.
525 West Third Street
Hanford, California 93230

Subject: *Quarterly Ground Water Monitoring and
Remediation System Status Report, Second Quarter 1998*
Beacon Station No. 720
1088 Marina Boulevard
San Leandro, California
Delta Project No. D095-971

Dear Mr. Fox:

Delta Environmental Consultants, Inc. (Delta), has been authorized by Ultramar, Inc. (Ultramar), to perform quarterly ground water monitoring reporting for the subject site (Figure 1). The quarterly ground water monitoring is intended to evaluate the distribution of dissolved petroleum hydrocarbons in ground water beneath the site. ~~This report summarizes ground water monitoring activities performed by Doulos Environmental Company (Doulos) at the site on May 28, 1998, and reports remediation system activities performed by Delta.~~

Ground Water Elevation Measurements, Flow Direction, and Hydraulic Gradient

Depth to ground water measurements were recorded by Doulos on May 28, 1998, in monitoring wells MW-1 through MW-9. The location of the wells are shown on Figure 2. On May 28, 1998, ground water was present between 10.40 (MW-4) and 12.14 (MW-8) feet below the top of the monitoring well casings. ~~The ground water level decreased approximately 0.10 feet since the previous quarterly monitoring event on March 12, 1998.~~ Ground water level data for the May 28, 1998, monitoring event is presented in Table 1. Ground water sampling information sheets recorded by Doulos are included in Enclosure A. Cumulative ground water level data reported previously by El Dorado Environmental, Inc. (El Dorado) are included in Enclosure B. The air sparging and soil vapor extraction (SVE) systems were operating. ~~The ground water pumping system was not operating on May 28, 1998.~~

The ground water elevation measurements recorded on May 28, 1998, were used to construct a ground water elevation contour map (Figure 3). The ground water table elevations indicate a flow direction off-site, generally toward the south with an average hydraulic gradient of approximately 0.01. Historically, ground water generally flows toward the south under non-pumping conditions.

Ground Water Analytical Results

Ground water samples were collected from monitoring wells MW-1 through MW-9 on May 28, 1998. Ground water samples were submitted to Kiff Analytical (Kiff), a California-certified laboratory in Davis, California, for analysis of benzene, toluene, ethylbenzene, and total xylenes (BTEX), and methyl tertiary butyl ether (MTBE) by EPA Method 8020, and total petroleum hydrocarbons (TPH) as gasoline by EPA Method 8015 Modified. Ground water sampling information sheets for the second quarter 1998 sampling event are included in Enclosure A.

No free product or sheen was detected in the wells during the May 1998 sampling event. Benzene was reported in the ground water samples collected from monitoring wells MW-5 and MW-9 at concentrations of 480 micrograms per liter ($\mu\text{g/L}$) and 110 $\mu\text{g/L}$, respectively. Benzene was not detected in monitoring wells MW-2, MW-3, and MW-4. Ground water samples collected from MW-1, and MW-6 through MW-8 were reported below the laboratory's limits of detection for all analytes. A benzene isoconcentration map for the May 28, 1998 sampling event is included as Figure 4. Ground water analytical results for the samples collected during the May 28, 1998, monitoring event are summarized in Table 1. Cumulative ground water analytical results reported previously by El Dorado are included in Enclosure B. A copy of the certified laboratory analytical report for the second quarter 1998 sampling event with chain-of-custody documentation is included in Enclosure C.

Status of Ground Water Remediation, Soil Vapor Extraction, and Air Sparging Systems

The ground water treatment system consists of monitoring wells MW-4, MW-5, and MW-9, a 250-gallon surge tank, a diffused aeration tank (DAT), two transfer pumps, two 200-pound aqueous phase granular activated carbon (GAC) columns placed in series, a 500-gallon holding tank and a flow totalizer meter. Ground water is pumped from the recovery wells to the surge tank, and is then gravity fed to the DAT. The DAT strips the dissolved petroleum hydrocarbons from the ground water. From the DAT, the ground water is pumped through the two GAC columns in series to the holding tank where the treated ground water is pumped to the sanitary sewer. The GAC columns adsorb dissolved petroleum hydrocarbons that are not removed by the DAT. The effluent air stream from the DAT containing petroleum hydrocarbon vapors stripped from the ground water stream is routed through the SVE system prior to atmospheric discharge.

The current SVE system consists of monitoring wells MW-1 through MW-5, MW-8 and MW-9, SVE well VW-1, and the effluent vapor stream from the diffused aeration tank which are manifolded to a 250 standard cubic feet per minute vacuum blower, and two Calgon 600 pound vapor phase GAC columns which replaced a 250 standard cubic feet per minute EVAX catalytic oxidizer. The EVAX catalytic oxidizer was disconnected in February 1998 due to low TPH as gasoline vapor concentrations and the GAC columns were delivered during March 1998. The SVE system was restarted during April 1998. The air discharge is permitted under Bay Area Air Quality Management District (BAAQMD) permit to operate No. 25627.

The air sparging system consists of air sparging wells SP-1 through SP-6, a GAST Model No. P6066 compressor, and six air rotometers. The compressor injects air through the air rotometers and then into air sparging wells SP-1 through SP-6.

Mr. Terrence A. Fox
Ultramar, Inc.
July 22, 1998
Page 3

The locations of the SVE well, monitoring wells, air sparging wells, and equipment compound are illustrated on Figure 2. The remediation equipment layout is illustrated on Figure 5, and the remediation system schematic is presented on Figure 6.

Delta collects monthly influent, mid-carbon, and effluent samples from the ground water treatment system during the months the system is operating and submits them to Kiff for analysis of BTEX and TPH as gasoline. Cumulative analytical results are summarized in Table 2, and copies of laboratory analytical reports for the second quarter 1998 are included in Enclosure D. As of July 7, 1998, the ground water treatment system has processed and discharged approximately 228,610 gallons of water to the sanitary sewer. The ground water treatment system did not operate during the second quarter 1998, except during system sampling events. The cumulative volume of ground water treated is summarized in Table 3.

During the operation of the SVE system with GAC, Delta collects monthly influent, mid-carbon, and effluent vapor samples. The samples were submitted to Kiff for analysis of BTEX and TPH as gasoline. Cumulative sampling results for air samples collected from the SVE system during its operation are summarized in Table 4. Copies of laboratory analytical reports for the second quarter 1998 are included in Enclosure E.

Remarks/Signature

The interpretations contained in this report represent our professional opinions, and are based in part, on information supplied by the client. These opinions are based on currently available information and are arrived at in accordance with currently accepted hydrogeologic and engineering practices at this time and location. Other than this, no warranty is implied or intended.

Delta recommends that a copy of this report be forwarded to:

Mr. Scott Seery
Department of Environmental Health
Alameda County Health Care Agency
1131 Harbor Parkway, Room 250
Alameda, California 94502-6577

Santa Clara County Program Coordinator
California Regional Water Quality Control Board,
San Francisco Bay Region
2101 Webster Street, Room 500
Oakland, California 94612

Mr. Terrence A. Fox
Ultramar, Inc.
July 22, 1998
Page 4

If you have any questions concerning this project, please contact Richard Munsch at (916) 638-2164.

Sincerely,

DELTA ENVIRONMENTAL CONSULTANTS, INC.



William L. Brattain
Project Engineer

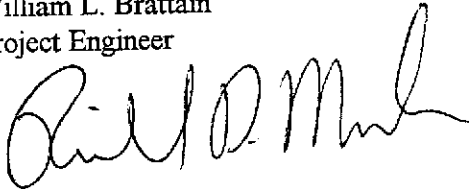

Richard D. Munsch
Project Manager

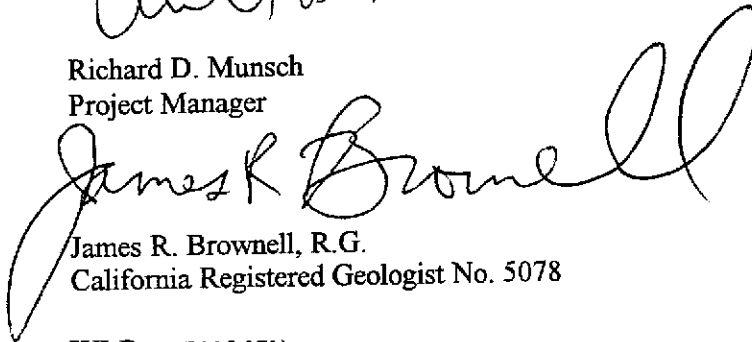

James R. Brownell, R.G.
California Registered Geologist No. 5078

WLB (LRP005.971)
Enclosures

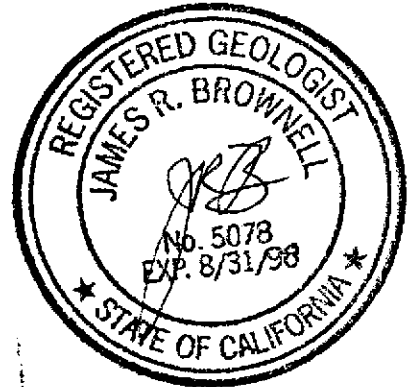

TABLE 3**GROUND WATER TREATMENT SYSTEM
CUMULATIVE DISCHARGE VOLUMES**

Beacon Station No. 720
1088 Marina Boulevard
San Leandro, California

Date	Cumulative Discharge Volume (gallons)
07/03/97	550
07/22/97	1,470
08/07/97	3,180
08/18/97	11,690
09/04/97	72,710
09/17/97	88,990
09/18/97	91,280
10/09/97	136,130
10/24/97	153,370
11/06/97	153,370
11/26/97	153,370
12/10/97	153,370
12/29/97	188,870
01/12/98	200,280
01/26/98	206,490
02/19/98	217,210
02/23/98	219,900
03/09/98	228,400
03/23/98	228,400
04/06/98	228,400
04/24/98	228,400
05/12/98	228,400
05/21/98	228,400
06/09/98	228,400
07/07/98	228,610

TABLE 4

SVE SYSTEM ANALYTICAL RESULTS

Beacon Station No. 720
1088 Marina Boulevard
San Leandro, California

Sample ID	Date	Benzene (ppmv)	Toluene (ppmv)	Ethyl- benzene (ppmv)	Total Xylenes (ppmv)	TPH as gasoline (ppmv)
Influent	06/05/97	3.2	0.72	1.2	2.5	220
	07/03/97	0.30	0.67	0.23	1.8	86
	07/22/97	0.76	1.6	0.92	5.3	270
	08/07/97	2.0	1.3	0.53	2.7	130
	09/04/97	1.8	0.73	1.3	5.9	190
	10/24/97	0.49	0.52	0.35	2.3	54
	11/26/97	0.13	0.43	0.072	0.35	9.2
	12/10/97	<0.05	0.44	0.076	0.37	5.8
	12/12/97	0.59	0.17	0.49	2.0	26
	01/12/98	<0.05	<0.05	<0.05	<0.05	<5.0
	04/23/98	0.18	0.32	0.072	0.47	18
06/09/98	<0.05	<0.05	<0.05	<0.05	<5.0	
Mid-Carbon	04/23/98	<0.05	<0.05	<0.05	<0.05	<5.0
	06/09/98	<0.05	<0.05	<0.05	<0.05	<5.0
Effluent	06/05/97	<0.05	<0.05	<0.05	<0.05	<5.0
	07/03/97	<0.05	0.054	<0.05	0.13	<5.0
	07/22/97	<0.05	<0.05	<0.05	<0.05	<5.0
	08/07/97	<0.05	<0.05	<0.05	<0.05	<5.0
	09/04/97	<0.05	<0.05	<0.05	<0.05	<5.0
	10/24/97	<0.05	<0.05	<0.05	0.057	<5.0
	11/26/97	0.094	0.089	<0.05	0.062	5.3
	12/10/97	<0.05	0.062	<0.05	<0.05	<5.0
	12/12/97	<0.05	<0.05	<0.05	<0.05	<5.0
	01/12/98	<0.05	<0.05	<0.05	<0.05	<5.0
	04/13/98	<0.05	<0.05	<0.05	<0.05	<5.0
06/09/98	<0.05	<0.05	<0.05	<0.05	<5.0	

TPH = Total petroleum hydrocarbons.

µg/L = Micrograms per liter.

ppmv = parts per million by volume.



GENERAL NOTES:
 BASE MAP FROM U.S.G.S.
 SAN LEANDRO, CA.
 7.5 MINUTE TOPOGRAPHIC
 PHOTOREVISED 1980



R.3 W.

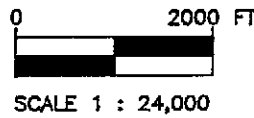

FIGURE 1
 SITE LOCATION MAP
 BEACON STATION NO. 720
 1088 MARINA BOULEVARD
 SAN LEANDRO, CA.

PROJECT NO. D096-971	DRAWN BY I.H. 5/30/96
FILE NO. 95-971-1	PREPARED BY SWM
REVISION NO. 1	REVIEWED BY <i>[Signature]</i>



JOE'S
TIRE
STORE

WAYNE AVENUE

MW-7

ART
SUPPLY

MARINA BOULEVARD

MW-6

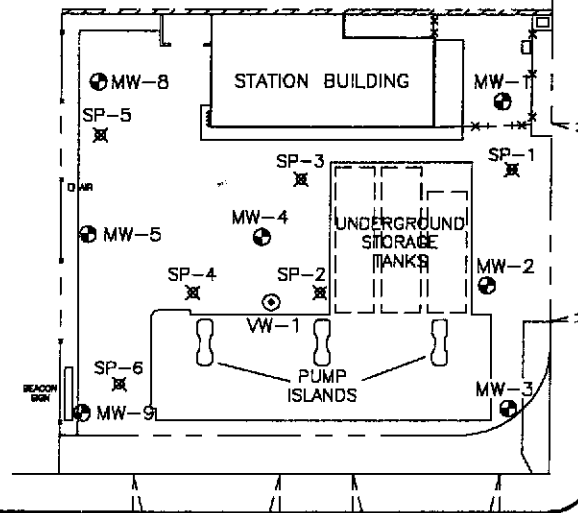

EVELETH AVENUE

LEGEND:

- PROPERTY LINE
- *-*- FENCE
- ⊕ MW-1 MONITORING WELL LOCATION
- ⊙ VW-1 VAPOR EXTRACTION WELL LOCATION
- ⊗ SP-1 AIR SPARGING WELL LOCATION

NOTES:

1. BASE MAP ADAPTED FROM FUGRO FIGURE DATED 10/24/95
SITE DIMENSIONS AND FACILITY LOCATIONS NOT VERIFIED.
2. MONITORING WELLS MW-6 AND MW-7 ARE OFF-SITE.



FIGURE 2
SITE MAP
BEACON STATION NO. 720
1088 MARINA BOULEVARD
SAN LEANDRO, CA.

PROJECT NO. D095-971	DRAWN BY M.L. 4/8/98
FILE NO. 95-971-5	PREPARED BY MAB
REVISION NO. 5	REVIEWED BY <i>[Signature]</i>



JOE'S
TIRE
STORE

WAYNE AVENUE

MW-7
(20.27)

ART
SUPPLY

21.0

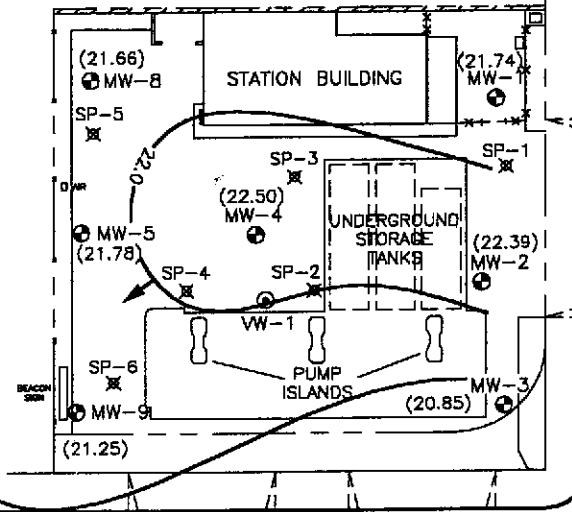

EVELETH AVENUE

LEGEND:

- PROPERTY LINE
- FENCE
- ⊙ MW-1 MONITORING WELL LOCATION
- ⊙ VW-1 VAPOR EXTRACTION WELL LOCATION
- ⊙ SP-1 AIR SPARGING WELL LOCATION
- (21.78) GROUND WATER ELEVATION IN FEET RELATIVE TO MEAN SEA LEVEL
- 21.0- WATER ELEVATION CONTOUR IN FEET RELATIVE TO MEAN SEA LEVEL
- ← GROUND WATER FLOW DIRECTION

NOTES:

1. BASE MAP ADAPTED FROM FUGRO FIGURE DATED 10/24/95. SITE DIMENSIONS AND FACILITY LOCATIONS NOT VERIFIED.
2. MONITORING WELLS MW-6 AND MW-7 ARE OFF-SITE.

MARINA BOULEVARD

20.0

MW-6
(19.82)



FIGURE 3
GROUND WATER ELEVATION CONTOUR MAP
5/28/98
BEACON STATION NO. 720
1088 MARINA BOULEVARD
SAN LEANDRO, CA.

PROJECT NO. D095-971	DRAWN BY M.L. 7/15/98
FILE NO. 95-971-5	PREPARED BY WLB
REVISION NO. 1	REVIEWED BY <i>[Signature]</i>



JOE'S
TIRE
STORE

WAYNE AVENUE

MW-7
(<0.5)

ART
SUPPLY

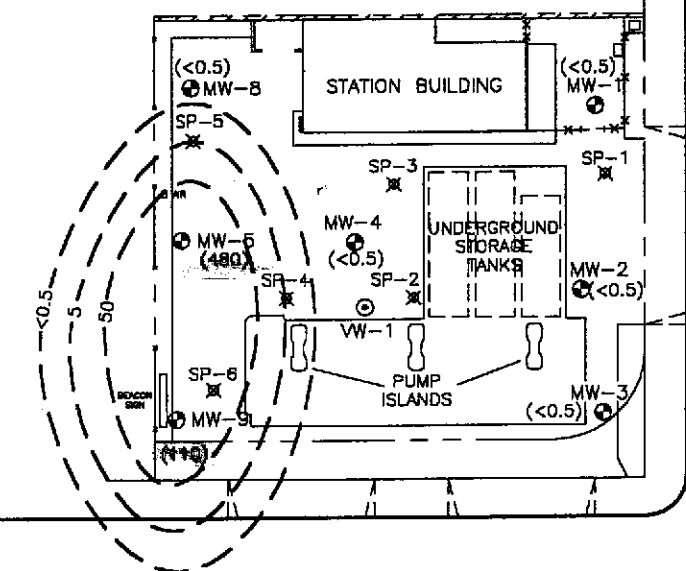

EVELETH AVENUE

MARINA BOULEVARD

MW-6
(<0.5)

LEGEND:

- PROPERTY LINE
- x-x- FENCE
- ⊕ MW-1 MONITORING WELL LOCATION
- ⊙ VW-1 VAPOR EXTRACTION WELL LOCATION
- ⊗ SP-1 AIR SPARGING WELL LOCATION
- (110) BENZENE CONCENTRATION IN MICROGRAMS PER LITER

NOTES:

1. BASE MAP ADAPTED FROM FUGRO FIGURE DATED 10/24/95. SITE DIMENSIONS AND FACILITY LOCATIONS NOT VERIFIED.
2. MONITORING WELLS MW-6 AND MW-7 ARE OFF-SITE.

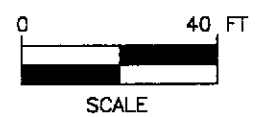
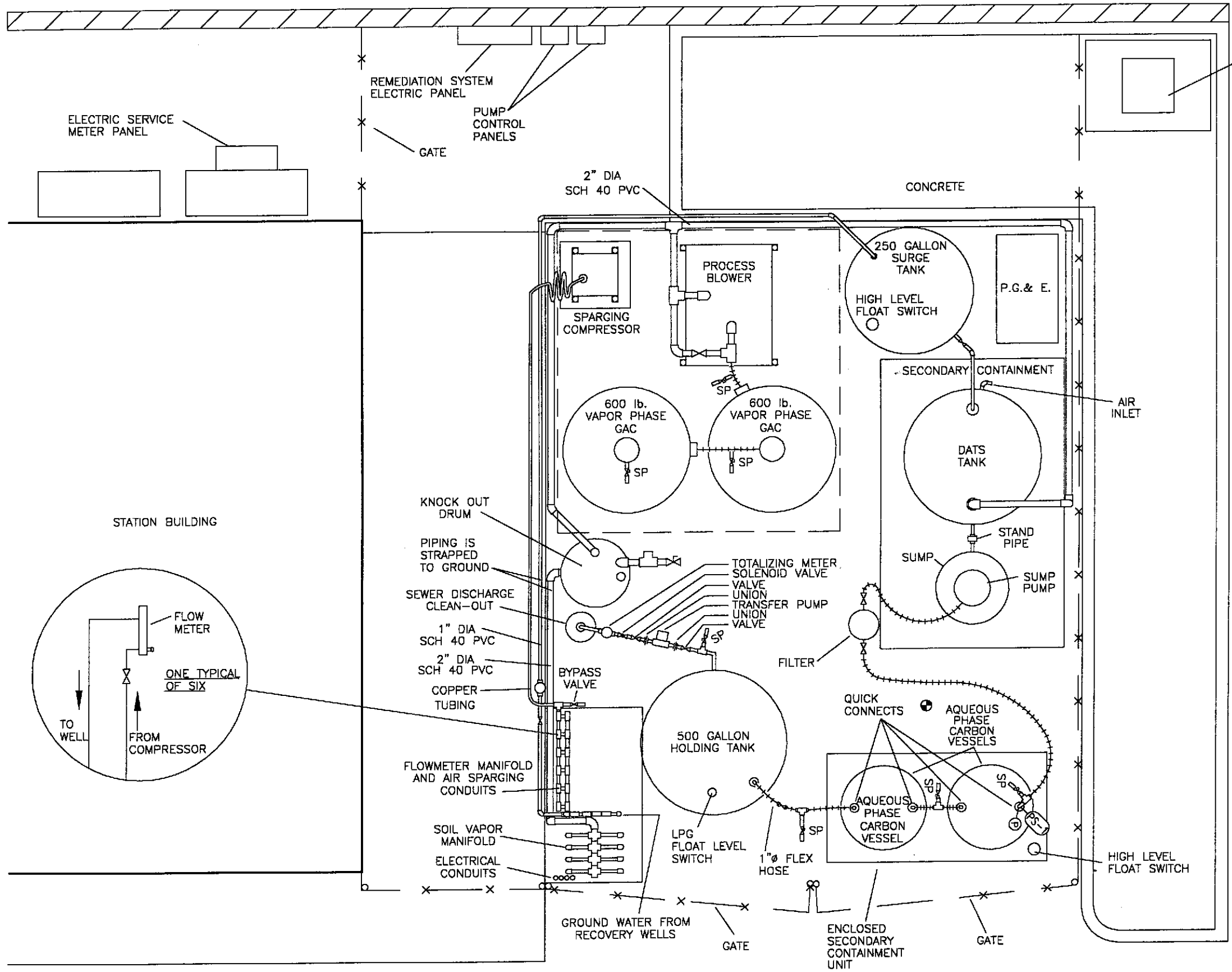

FIGURE 4
BENZENE ISOCONCENTRATION MAP
5/28/98
BEACON STATION NO. 720
1088 MARINA BOULEVARD
SAN LEANDRO, CA.

PROJECT NO. D095-971	DRAWN BY M.L. 7/15/98	
FILE NO. 95-971-5	PREPARED BY WLB	
REVISION NO. 1	REVIEWED BY <i>[Signature]</i>	



NATURAL GAS METER

North

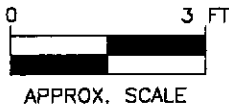

FIGURE 5
 REMEDIATION EQUIPMENT LAYOUT
 BEACON STATION NO. 720
 1088 MARINA BOULEVARD
 SAN LEANDRO, CA.

PROJECT NO. 0095-971	DRAWN BY M.L. 4/8/98
FILE NO. 95-971-2	PREPARED BY SWM
REVISION NO. 4	REVIEWED BY

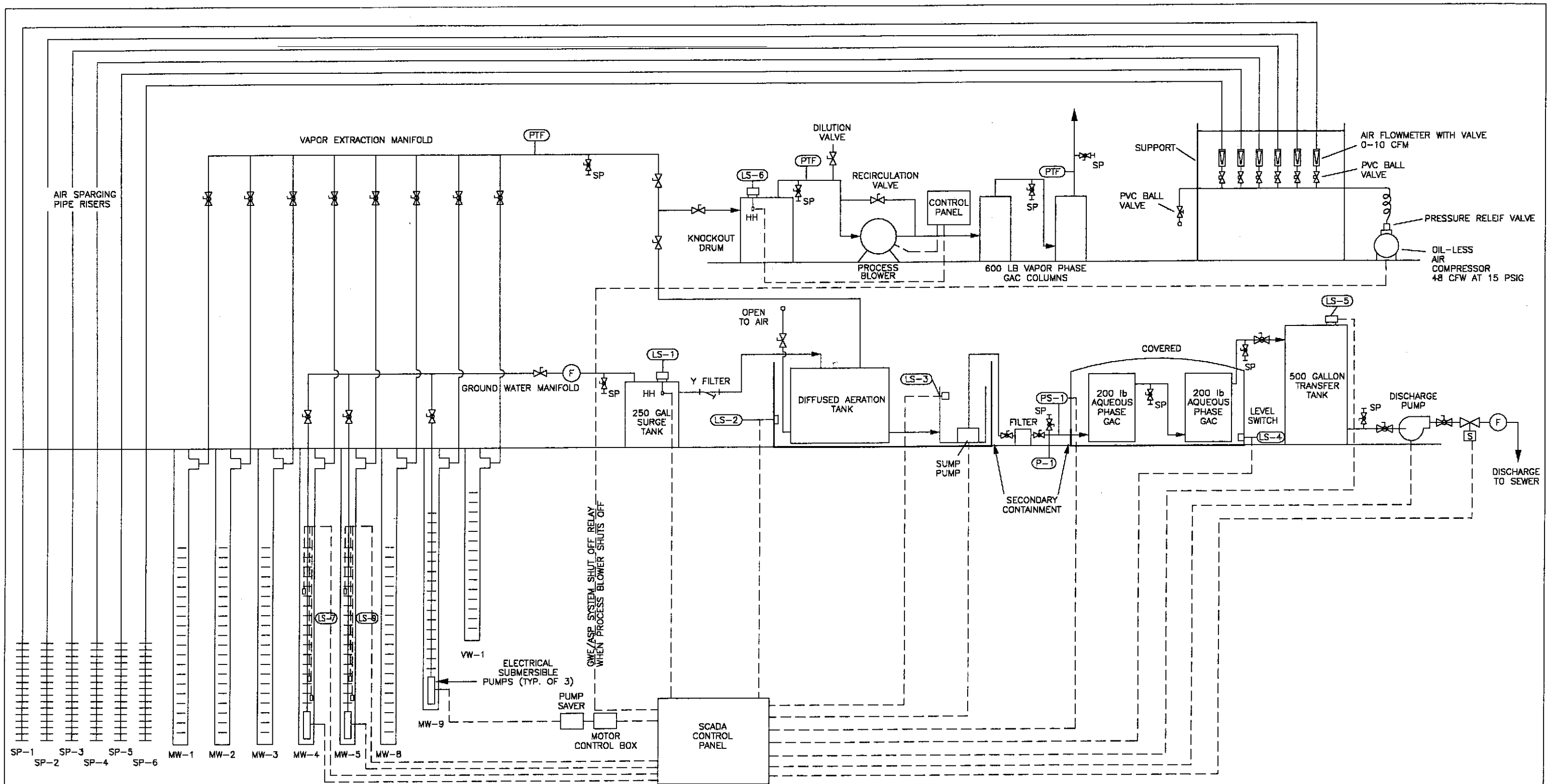

FIGURE 6
SOIL VAPOR EXTRACTION, AIR SPARGING,
& GROUNDWATER PUMPING SYSTEM SCHEMATIC
BEACON STATION 720
1088 MARINA BLVD.
SAN LEANDRO, CA.

PROJECT NO. D095-971	DRAWN BY M.L. 4/8/98
FILE NO. 95-971-3	PREPARED BY SWM
REVISION NO. 3	REVIEWED BY

LEGEND:

- BALL VALVE
- GATE VALVE
- SOLENOID VALVE
- SAMPLE PORT
- PRESSURE, TEMPERATURE, FLOW MONITORING POINT
- FLOW TOTALIZER
- PRESSURE GAUGE
- AQUEOUS PHASE CARBON PRESSURE SWITCH--PRESSURE SWITCH--SHUTS DATS/SUMP PUMP AND WELL PUMPS (W/REMOTE RESET)

- SURGE TANK:
HIGH HIGH--SHUTS OFF WELL PUMPS (W/REMOTE RESET)
- SECONDARY CONTAINMENT VESSEL FOR DATS:
HIGH HIGH SHUTS OFF WELL PUMPS
- DATS/SUMP:
HIGH HIGH--SHUTS OFF WELL PUMPS
HIGH--TURNS ON DATS SUMP PUMP
LOW--TURNS OFF DATS SUMP PUMP
- SECONDARY CONTAINMENT VESSEL FOR AQUEOUS PHASE CARBON:
HIGH HIGH--SHUTS OFF DATS/SUMP PUMP AND WELL PUMPS

- DISCHARGE HOLDING TANK:
HIGH HIGH--SHUTS OFF DATS SUMP PUMP (W/REMOTE RESET)
HIGH--TURNS ON TRANSFER PUMP AND OPENS SEWER SOLENOID VALVE
LOW--TURNS OFF TRANSFER PUMP AND CLOSES SEWER SOLENOID VALVE
- RECOVERY WELL PROBES:
HIGH--TURNS ON SUBMERSIBLE WELL PUMP (MW-4)--TO BE CONTROLLED BY RELAY IN PANEL
LOW--TURNS OFF SUBMERSIBLE WELL PUMP (MW-4)--TO BE CONTROLLED BY RELAY IN PANEL
- RECOVERY WELL PROBES:
HIGH--TURNS ON SUBMERSIBLE WELL PUMP (MW-5)--TO BE CONTROLLED BY RELAY IN PANEL
LOW--TURNS OFF SUBMERSIBLE WELL PUMP (MW-5)--TO BE CONTROLLED BY RELAY IN PANEL

ENCLOSURE A

Ground Water Sampling Information Sheets by Doulos

DOULOS ENVIRONMENTAL COMPANY
GROUNDWATER/LIQUID LEVEL DATA
 (measurements in feet)

Project Address: Beacon #720, 1088 Marina Blvd.

Date: 5-28-98

San Leandro, CA

Project No.: 94-720-01

Recorded by: Hal Hansen

Well No	Time	Well Elev. TOC	Depth to Gr. Water	Measured Total Depth	Gr. Water Elevation	Depth to Product	Product Thickness	Comments
MW-1	12:41		11.36	17.10				no odor no sheen UNDER VAC.
MW-2	12:38		10.41	22.71				no odor no sheen UNDER VAC.
MW-3	12:35		11.45	28.40				slight odor no sheen UNDER VAC.
MW-4	12:54		10.40	27.46				petroleum odor no sheen UNDER VAC.
MW-5	12:51		10.92	28.85				petroleum odor no sheen UNDER VAC.
MW-6	12:31		10.58	14.93				no odor no sheen
MW-7	12:29		10.93	25.51				no odor no sheen
MW-8	12:45		12.14	27.90				slight odor no sheen UNDER VAC.
MW-9	12:48		11.31	24.68				petroleum odor no sheen UNDER VAC.

Notes:

DOULOS ENVIRONMENTAL COMPANY

SAMPLING INFORMATION SHEET

Client: Ultramar

Sampling Date: 5-28-98

Site: Beacon #720

Project No.: 94-720-01

1088 Marina Boulevard

Well Designation: MW-1

San Leandro, CA

Is setup of traffic control devices required? NO YES time: _____ hours
 Is there standing water in well box? NO YES Above TOC Below TOC
 Is top of casing cut level? NO YES If no, see remarks
 Is well cap sealed and locked? NO YES If no, see remarks
 Height of well casing riser (in inches): _____
 Well cover type: 8" UV _____ 12" UV _____ 12" EMCO _____ 8" BK _____
 12" BK _____ 12" DWP _____ 12" CNI 36" CNI _____ Other _____
 General condition of wellhead assembly: Excellent Good Fair Poor

Purging Equipment: _____ 2" disposable bailer _____ Submersible pump
 _____ 2" PVC bailer _____ Dedicated bailer
 _____ 4" PVC bailer Centrifugal pump

Sampled with: Disposable bailer: Teflon bailer: _____

Well Diameter: 2" 4" _____ 6" _____ 8" _____

Purge Vol. Multiplier: 0.16 0.65 1.47 2.61 gal/ft.
 Initial Measurement
 Time: 12:41 17:10
 Depth of well: _____
 Depth to water: 11.36
 Recharge Measurement
 Time: 2:19
 Depth to water: 11.50
 Calculated purge: 3.6 gal
 Actual purge: 3.6 gal

Start purge: 2:09 Sampling time: 2:20

Time	Temp.	E.C.	pH	Turbidity	Volume
2:10	63.7	1291	7.41	—	1
2:11	64.9	1280	7.30	—	2
2:13	65.0	1140	7.24	—	3
2:14	65.7	1110	7.20	—	4

Sample appearance: (Clear) Lock: None

Equipment replaced: (Check all that apply) Note condition of replaced item
 2" Locking Cap: _____ Lock #3753: _____ 7/32 Allenhead: _____
 4" Locking Cap: _____ Lock-Dolphin: _____ 9/16 Bolt: _____
 6" Locking Cap: _____ Pinned Allenhead (DWP): _____

Remarks: _____

[Handwritten signature]

DOULOS ENVIRONMENTAL COMPANY

SAMPLING INFORMATION SHEET

Client: Ultramar

Sampling Date: 5-28-98

Site: Beacon #720

Project No.: 94-720-01

1088 Marina Boulevard

Well Designation: MW-2

San Leandro, CA

Is setup of traffic control devices required? NO YES time: _____ hours
 Is there standing water in well box? NO YES Above TOC Below TOC
 Is top of casing cut level? NO YES If no, see remarks
 Is well cap sealed and locked? NO YES If no, see remarks
 Height of well casing riser (in inches): 3
 Well cover type: 8" UV _____ 12" UV _____ 12" EMCO _____ 8" BK _____
 12" BK _____ 12" DWP _____ 12" CNI 36" CNI _____ Other _____
 General condition of wellhead assembly: Excellent Good Fair Poor

Purging Equipment: _____ 2" disposable bailer _____ Submersible pump
 _____ 2" PVC bailer _____ Dedicated bailer
 _____ 4" PVC bailer Centrifugal pump

Sampled with: Disposable bailer: Teflon bailer: _____

Well Diameter: 2" 4" _____ 6" _____ 8" _____

Purge Vol. Multiplier: 0.16 0.65 1.47 2.61 gal/ft.
 Initial Measurement Recharge Measurement
 Time: 12:38 Time: 2:04
 Depth of well: 22.71 Depth to water: 10.58 Calculated purge: 7.8
 Depth to water: 10.41 Actual purge: 7.8

Start purge: 1:50 Sampling time: 2:05

Time	Temp.	E.C.	pH	Turbidity	Volume
1:52	65.0	1340	7.38	—	1
1:53	66.1	1210	7.31	—	2
1:55	66.4	1184	7.28	—	3
1:56	66.0	1170	7.20	—	4

Sample appearance: Clear Lock: Do not return

Equipment replaced: (Check all that apply) Note condition of replaced item
 2" Locking Cap: _____ Lock #3753: _____ 7/32 Allenhead: _____
 4" Locking Cap: _____ Lock-Dolphin: _____ 9/16 Bolt: _____
 6" Locking Cap: _____ Pinned Allenhead (DWP): _____

Remarks: _____

DOULOS ENVIRONMENTAL COMPANY

SAMPLING INFORMATION SHEET

Client: Ultramar

Sampling Date: 5-28-98

Site: Beacon #720

Project No.: 94-720-01

1088 Marina Boulevard

Well Designation: MW-3

San Leandro, CA

Is setup of traffic control devices required? NO YES time: _____ hours
 Is there standing water in well box? NO YES Above TOC Below TOC
 Is top of casing cut level? NO YES If no, see remarks
 Is well cap sealed and locked? NO YES If no, see remarks
 Height of well casing riser (in inches): _____ 12" EMCO _____ 8" BK _____
 Well cover type: 8" UV _____ 12" UV _____ 36" CNI _____ Other _____
 12" BK _____ 12" DWP _____ 12" CNI Excellent Good Fair Poor
 General condition of wellhead assembly:

Purging Equipment: _____ 2" disposable bailer _____ Submersible pump
 _____ 2" PVC bailer _____ Dedicated bailer
 _____ 4" PVC bailer Centrifugal pump

Sampled with: Disposable bailer: Teflon bailer: _____

Well Diameter: 2" 4" _____ 6" _____ 8" _____

Purge Vol. Multiplier: 0.16 0.65 1.47 2.61 gal/ft.
 Initial Measurement Recharge Measurement
 Time: 12:35 Time: 1:44 Calculated purge: 10.8 gal
 Depth of well: 28.40 Depth to water: 11.70 Actual purge: 10.8 gal
 Depth to water: 11.45

Start purge: 1:36 Sampling time: 1:45

Time	Temp.	E.C.	pH	Turbidity	Volume
1:37	64.7	1440	7.41	—	1
1:38	65.0	1310	7.38	—	2
1:40	65.8	1240	7.30	—	3
1:41	65.9	1210	7.28	—	4

Sample appearance: Clear Lock: Dolphin

Equipment replaced: (Check all that apply) Note condition of replaced item
 2" Locking Cap: _____ Lock #3753: _____ 7/32 Allenhead: _____
 4" Locking Cap: _____ Lock-Dolphin: _____ 9/16 Bolt: _____
 6" Locking Cap: _____ Pinned Allenhead (DWP): _____

Remarks: _____

DOULOS ENVIRONMENTAL COMPANY

SAMPLING INFORMATION SHEET

Client: Ultramar

Sampling Date: 5-28-98

Site: Beacon #720

Project No.: 94-720-01

1088 Marina Boulevard

Well Designation: MW-4

San Leandro, CA

Is setup of traffic control devices required? NO YES
 Is there standing water in well box? NO YES
 Is top of casing cut level? NO YES
 Is well cap sealed and locked? NO YES
 Height of well casing riser (in inches): _____
 Well cover type: 8" UV _____ 12" UV _____ 12" EMCO _____ 8" BK _____
 12" BK _____ 12" DWP _____ 12" CNI _____ 36" CNI _____ Other _____
 General condition of wellhead assembly: Excellent Good Fair Poor

Purging Equipment: _____ 2" disposable bailer _____ Submersible pump
 _____ 2" PVC bailer _____ Dedicated bailer
 _____ 4" PVC bailer Centrifugal pump

Sampled with: Disposable bailer: Teflon bailer: _____

Well Diameter: 2" 4" _____ 6" _____ 8" _____

Purge Vol. Multiplier: 0.16 0.65 1.47 2.61 gal/ft.
 Initial Measurement Time: 12:54 Recharge Measurement Time: 3:30
 Depth of well: 27.46 Depth to water: 11.91 Calculated purge: 10.9 gal
 Depth to water: 10.40 Actual purge: 10.9 gal

Start purge: 3:19 Sampling time: 3:32

Time	Temp.	E.C.	pH	Turbidity	Volume
3:21	64.1	1410	7.40	—	1
3:22	64.7	1340	7.10	—	2
3:23	64.8	1291	6.99	—	3
3:24	65.1	1280	6.99	—	4

Sample appearance: Clear Lock: NONE

Equipment replaced: (Check all that apply) Note condition of replaced item
 2" Locking Cap: _____ Lock #3753: _____ 7/32 Allenhead: _____
 4" Locking Cap: _____ Lock-Dolphin: _____ 9/16 Bolt: _____
 6" Locking Cap: _____ Pinned Allenhead (DWP): _____

Remarks: _____

DOULOS ENVIRONMENTAL COMPANY

SAMPLING INFORMATION SHEET

Client: Ultramar

Sampling Date: 5-28-98

Site: Beacon #720

Project No.: 94-720-01

1088 Marina Boulevard

Well Designation: MW-5

San Leandro, CA

Is setup of traffic control devices required? NO YES time: _____ hours
 Is there standing water in well box? NO YES Above TOC Below TOC
 Is top of casing cut level? NO YES If no, see remarks
 Is well cap sealed and locked? NO YES If no, see remarks
 Height of well casing riser (in inches): 6
 Well cover type: 8" UV _____ 12" UV _____ 12" EMCO _____ 8" BK _____
 12" BK _____ 12" DWP _____ 12" CNI 36" CNI _____ Other _____
 General condition of wellhead assembly: Excellent Good Fair Poor

Purging Equipment: _____ 2" disposable bailer _____ Submersible pump
 _____ 2" PVC bailer _____ Dedicated bailer
 _____ 4" PVC bailer Centrifugal pump

Sampled with: Disposable bailer: Teflon bailer: _____

Well Diameter: 2" 4" _____ 6" _____ 8" _____

Purge Vol. Multiplier: 0.16 0.65 1.47 2.61 gal/ft.
 Initial Measurement Recharge Measurement
 Time: 12:51 Time: 3:15 Calculated purge: 11.4 gal
 Depth of well: 28.85 Depth to water: 11.40 Actual purge: 11.4 gal
 Depth to water: 10.92

Start purge: 3:06 Sampling time: 3:16

Time	Temp.	E.C.	pH	Turbidity	Volume
3:07	65.7	1410	7.46	—	1
3:08	65.8	1340	7.40	—	2
3:09	66.1	1298	7.10	—	3
3:11	66.4	1290	6.99	—	4

Sample appearance: (Clear) Lock: NONE

Equipment replaced: (Check all that apply) Note condition of replaced item
 2" Locking Cap: _____ Lock #3753: _____ 7/32 Allenhead: _____
 4" Locking Cap: _____ Lock-Dolphin: _____ 9/16 Bolt: _____
 6" Locking Cap: _____ Pinned Allenhead (DWP): _____

Remarks: _____
[Signature]

DOULOS ENVIRONMENTAL COMPANY

SAMPLING INFORMATION SHEET

Client: Ultramar

Sampling Date: 5-28-98

Site: Beacon #720

Project No.: 94-720-01

1088 Marina Boulevard

Well Designation: MW-6

San Leandro, CA

Is setup of traffic control devices required? NO YES time: _____ hours
 Is there standing water in well box? NO YES Above TOC Below TOC
 Is top of casing cut level? NO YES If no, see remarks
 Is well cap sealed and locked? NO YES If no, see remarks
 Height of well casing riser (in inches): _____
 Well cover type: 8" UV _____ 12" UV _____ 12" EMCO _____ 8" BK _____
 12" BK _____ 12" DWP _____ 12" CNI _____ 36" CNI _____ Other 12" POMECO
 General condition of wellhead assembly: Excellent Good Fair Poor

Purging Equipment: _____ 2" disposable bailer _____ Submersible pump
 _____ 2" PVC bailer _____ Dedicated bailer
 _____ 4" PVC bailer Centrifugal pump

Sampled with: Disposable bailer: Teflon bailer: _____

Well Diameter: 2" 4" _____ 6" _____ 8" _____

Purge Vol. Multiplier: 0.16 0.65 1.47 2.61 gal/ft.
 Initial Measurement
 Time: 12:31 14.93 Recharge Measurement
 Depth of well: _____ Time: 1:30
 Depth to water: 10.58 Depth to water: 10.61 Calculated purge: 2.7 gal
 Actual purge: 2.7 gal

Start purge: 1:10 Sampling time: 1:31

Time	Temp.	E.C.	pH	Turbidity	Volume
1:12	66.1	1160	7.31	—	1
1:13	66.0	1140	7.24	—	2
1:14	65.8	1090	7.20	—	3
1:15	65.7	1081	7.18	—	4

Sample appearance: Clear Lock: Dolphin

Equipment replaced: (Check all that apply) Note condition of replaced item
 2" Locking Cap: _____ Lock #3753: _____ 7/32 Allenhead: _____
 4" Locking Cap: _____ Lock-Dolphin: _____ 9/16 Bolt: _____
 6" Locking Cap: _____ Pinned Allenhead (DWP): _____

Remarks: _____

DOULOS ENVIRONMENTAL COMPANY

SAMPLING INFORMATION SHEET

Client: Ultramar

Sampling Date: 5-28-98

Site: Beacon #720

Project No.: 94-720-01

1088 Marina Boulevard

Well Designation: MW-7

San Leandro, CA

Is setup of traffic control devices required? NO YES time: _____ hours
 Is there standing water in well box? NO YES Above TOC Below TOC
 Is top of casing cut level? NO YES If no, see remarks
 Is well cap sealed and locked? NO YES If no, see remarks
 Height of well casing riser (in inches): 6
 Well cover type: 8" UV _____ 12" UV _____ 12" EMCO _____ 8" BK _____
 12" BK _____ 12" DWP _____ 12" CNI _____ 36" CNI _____ other 12" POMTECO
 General condition of wellhead assembly: Excellent Good Fair Poor

Purging Equipment: _____ 2" disposable bailer _____ Submersible pump
 _____ 2" PVC bailer _____ Dedicated bailer
 _____ 4" PVC bailer Centrifugal pump

Sampled with: Disposable bailer: Teflon bailer: _____

Well Diameter: 2" 4" _____ 6" _____ 8" _____

Purge Vol. Multiplier: 0.16 0.65 1.47 2.61 gal/ft.
 Initial Measurement Time: 12:29 Recharge Measurement Time: 1:05 Calculated purge: 9.3 gal
 Depth of well: 25.51 Depth to water: 11.10 Actual purge: 9.3 gal
 Depth to water: 10.93

Start purge: 12:59 Sampling time: 1:06

Time	Temp.	E.C.	pH	Turbidity	Volume
1:00	62.7	1340	7.46	—	1
1:01	63.4	1241	7.41	—	2
1:02	64.7	1198	7.31	—	3
1:02	64.9	1190	7.28	—	4

Sample appearance: Clear Lock: Dial Action

Equipment replaced: (Check all that apply) Note condition of replaced item
 2" Locking Cap: _____ Lock #3753: _____ 7/32 Allenhead: _____
 4" Locking Cap: _____ Lock-Dolphin: _____ 9/16 Bolt: _____
 6" Locking Cap: _____ Pinned Allenhead (DWP): _____

Remarks: _____
[Signature]

DOULOS ENVIRONMENTAL COMPANY

SAMPLING INFORMATION SHEET

Client: Ultramar

Sampling Date: 5-28-98

Site: Beacon #720

Project No.: 94-720-01

1088 Marina Boulevard

Well Designation: MW-8

San Leandro, CA

Is setup of traffic control devices required? NO YES
 Is there standing water in well box? NO YES
 Is top of casing cut level? NO YES
 Is well cap sealed and locked? NO YES
 Height of well casing riser (in inches):
 Well cover type: 8" UV _____ 12" UV _____ 12" EMCO _____ 8" BK _____
 12" BK _____ 12" DWP _____ 12" CNI 36" CNI _____ Other _____
 General condition of wellhead assembly: Excellent Good Fair Poor

time: _____ hours
 Above TOC Below TOC
 If no, see remarks
 If no, see remarks

Purging Equipment: _____ 2" disposable bailer _____ Submersible pump
 _____ 2" PVC bailer _____ Dedicated bailer
 _____ 4" PVC bailer Centrifugal pump

Sampled with: Disposable bailer: Teflon bailer: _____

Well Diameter: 2" 4" _____ 6" _____ 8" _____

Purge Vol. Multiplier: 0.16 0.65 1.47 2.61 gal/ft.
 Initial Measurement
 Time: 12:45 Recharge Measurement
 Depth of well: 27.90 Time: 2:31 Calculated purge: 10 gal
 Depth to water: 12.14 Depth to water: 12.40 Actual purge: 10 gal

Start purge: 2:24 Sampling time: 2:33

Time	Temp.	E.C.	pH	Turbidity	Volume
2:25	63.8	1250	7.51	—	1
2:26	64.7	1140	7.44	—	2
2:27	65.8	1090	7.40	—	3
2:29	66.0	1081	7.33	—	4

Sample appearance: Clear Lock: Dolphin

Equipment replaced: (Check all that apply) Note condition of replaced item
 2" Locking Cap: _____ Lock #3753: _____ 7/32 Allenhead: _____
 4" Locking Cap: _____ Lock-Dolphin: _____ 9/16 Bolt: _____
 6" Locking Cap: _____ Pinned Allenhead (DWP): _____

Remarks: _____

[Handwritten signature]

Client: Ultramar

Sampling Date: 5-28-98

Site: Beacon #720

Project No.: 94-720-01

1088 Marina Boulevard

Well Designation: MW-9

San Leandro, CA

Is setup of traffic control devices required? NO YES time: _____ hours
 Is there standing water in well box? NO YES Above TOC Below TOC
 Is top of casing cut level? NO YES If no, see remarks
 Is well cap sealed and locked? NO YES If no, see remarks
 Height of well casing riser (in inches): _____
 Well cover type: 8" UV _____ 12" UV _____ 12" EMCO _____ 8" BK _____
 12" BK _____ 12" DWP _____ 12" CNI 36" CNI _____ Other _____
 General condition of wellhead assembly: Excellent Good Fair Poor

Purging Equipment: _____ 2" disposable bailer _____ Submersible pump
 _____ 2" PVC bailer _____ Dedicated bailer
 _____ 4" PVC bailer Centrifugal pump

Sampled with: Disposable bailer: Teflon bailer: _____

Well Diameter: 2" _____ 4" 6" _____ 8" _____

Purge Vol. Multiplier: 0.16 0.65 1.47 2.61 gal/ft.
 Initial Measurement Time: 12:48 Recharge Measurement Time: 2:59
 Depth of well: 24.68 Depth to water: 11.40 Calculated purge: 34.7 gal
 Depth to water: 11.31 Actual purge: 34.7 gal

Start purge: 2:38 Sampling time: 3:02

Time	Temp.	E.C.	pH	Turbidity	Volume
2:40	63.7	1410	7.40	—	1
2:44	64.9	1350	7.30	—	2
2:47	64.8	1340	7.21	—	3
2:51	65.7	1214	7.19	—	4

Sample appearance: Clear Lock: NONE

Equipment replaced: (Check all that apply) Note condition of replaced item
 2" Locking Cap: _____ Lock #3753: _____ 7/32 Allenhead: _____
 4" Locking Cap: _____ Lock-Dolphin: _____ 9/16 Bolt: _____
 6" Locking Cap: _____ Pinned Allenhead (DWP): _____

Remarks: _____

[Handwritten signature]

ENCLOSURE B

**Cumulative Ground Water Level Data and Analytical
Results previously Reported by El Dorado Environmental**

TABLE 1
GROUND WATER ELEVATION DATA
BEACON STATION #720
1088 MARINA BOULEVARD, SAN LEANDRO, CALIFORNIA
(Measurements in feet)

Monitoring Well	Date	Reference Elevation (top of casing) ¹	Depth to Ground Water ¹	Ground Water Elevation ²	Well Depth	Comments		
MW-1	03/30/92	33.10	13.58	19.52	—			
	07/01/92		14.80	18.30	—			
	09/30/92		16.12	16.98	—			
	11/19/92		16.34	16.76	27.76			
	02/03/93		12.61	20.49	27.72			
	05/25/93		13.12	19.98	27.70			
	09/22/93		14.18	18.92	27.73			
	12/21/93		14.36	18.74	27.70			
	03/18/94		13.64	19.46	27.67			
	06/15/94		14.30	18.80	27.69			
	09/14/94		15.18	17.92	27.66			
	12/19/94		13.79	19.31	27.70			
	12/21/95		13.86	19.24	—			
	03/07/95		12.74	20.36	29.51			
	06/08/95		12.95	20.15	29.54			
	09/22/95		13.94	19.16	29.54			
	12/27/95		13.57	19.53	29.92			
	03/26/96		12.13	20.97	29.90			
	06/13/96		13.10	20.00	17.02			
	09/10/96		14.08	19.02	17.03			
	12/05/96		13.41	19.69	17.05			
	03/10/97		12.70	20.40	17.04			
	06/12/97		13.68	19.42	17.04			
	08/19/97		14.31	18.79	17.01			
	12/13/97		13.19	19.91	17.01			
	MW-2		03/30/92	32.80	13.32	19.48	—	
			07/01/92		14.42	18.38	—	
			09/30/92		15.78	17.02	—	
11/19/92		15.99	16.81		24.56			
02/03/93		12.31	20.49		25.37			
05/25/93		12.97	19.83		25.31			
09/22/93		14.32	18.48		25.34			
12/21/93		14.52	18.28		25.31			
03/18/94		13.45	19.35		25.49			
06/15/94		14.07	18.73		25.50			
09/14/94		14.96	17.84		25.50			
12/19/94		13.64	19.16		25.52			
12/21/95		13.71	19.09		—			
03/07/95		12.54	20.26		25.87			
06/08/95		12.81	19.99		25.86			
09/22/95		13.66	19.14		25.80			
12/27/95		13.42	19.38		25.83			
03/26/96		12.05	20.75		25.83			
06/13/96		12.79	20.01		26.39			
09/10/96		13.73	19.07		26.43			
12/05/96		13.29	19.51		26.45			
03/10/97		12.42	20.38		26.48			
06/12/97		13.18	19.62		26.50			
08/19/97		13.94	18.86		26.52			
12/13/97		12.91	19.89		19.02			

NOTES: 1 = Measurement and reference elevation taken from notch/mark on top north side of well casing.
2 = Elevation referenced to mean sea level.
Well Depth = Measurement from top of casing to bottom of well.
— = Not measured.
* = Well paved over.

TABLE 1
GROUND WATER ELEVATION DATA
BEACON STATION #720
1088 MARINA BOULEVARD, SAN LEANDRO, CALIFORNIA
(Measurements in feet)

Monitoring Well	Date	Reference Elevation (top of casing) ¹	Depth to Ground Water ¹	Ground Water Elevation ²	Well Depth	Comments
MW-3	03/30/92	32.30	12.96	19.34	—	
	07/01/92		14.00	18.30	—	
	09/30/92		15.36	16.94	—	
	11/19/92		15.57	16.73	24.45	
	02/03/93		11.96	20.34	24.54	
	05/25/93		14.12	18.18	24.50	
	09/22/93		13.88	18.42	24.50	
	12/21/93		14.12	18.18	24.50	
	03/18/94		13.04	19.26	24.57	
	06/15/94		13.65	18.65	24.78	
	09/14/94		14.54	17.76	24.59	
	12/19/94		13.28	19.02	24.71	
	12/21/95		13.30	19.00	—	
	03/07/95		12.26	20.04	26.03	
	06/08/95		12.42	19.88	26.02	
	09/22/95		13.25	19.05	26.00	
	12/27/95		13.04	19.26	26.00	
	03/26/96		11.62	20.68	26.01	
	06/13/96		12.61	19.69	28.45	
	09/10/96		13.49	18.81	28.42	
12/05/96	13.07	19.23	28.42			
03/10/97	12.23	20.07	28.41			
06/12/97	12.94	19.36	28.44			
08/19/97	12.85	19.45	28.45			
12/13/97	12.45	19.85	28.43			
MW-4	03/30/92	32.90	13.60	19.30	—	
	07/01/92		15.72	17.18	—	
	09/30/92		16.04	16.86	—	
	11/19/92		16.21	16.69	26.92	
	02/03/93		12.70	20.20	27.00	
	05/25/93		12.97	19.93	26.88	
	09/22/93		14.51	18.39	26.90	
	12/21/93		14.75	18.15	26.90	
	03/18/94		13.68	19.22	27.24	
	06/15/94		14.37	18.53	28.54	
	09/14/94		15.23	17.67	27.25	
	12/19/94		13.93	18.97	28.61	
	12/21/95		13.99	18.91	—	
	03/07/95		12.86	20.04	28.64	
	06/08/95		13.10	19.80	28.68	
	09/22/95		13.98	18.92	28.71	
	12/27/95		13.74	19.16	28.71	
	03/26/96		12.30	20.60	28.70	
	06/13/96		13.18	19.72	27.86	
	09/10/96		14.22	18.68	27.40	
12/05/96	13.65	19.25	27.40			
03/10/97	12.79	20.11	27.42			
06/12/97	13.51	19.39	27.40			
08/19/97	14.29	18.61	27.40			
12/13/97	13.43	19.47	27.43			

NOTES: 1 = Measurement and reference elevation taken from notch/mark on top north side of well casing.
2 = Elevation referenced to mean sea level.
Well Depth = Measurement from top of casing to bottom of well.
— = Not measured.
. = Well paved over.

TABLE 1
GROUND WATER ELEVATION DATA
BEACON STATION #720
1088 MARINA BOULEVARD, SAN LEANDRO, CALIFORNIA
(Measurements in feet)

Monitoring Well	Date	Reference Elevation (top of casing) ¹	Depth to Ground Water ¹	Ground Water Elevation ²	Well Depth	Comments
MW-5	03/30/92	32.70	13.48	19.22	—	
	07/01/92		14.58	18.12	—	
	09/30/92		15.82	16.88	—	
	11/19/92		16.00	16.70	27.56	
	02/03/93		12.40	20.30	27.61	
	05/25/93		13.01	19.69	27.61	
	09/22/93		14.37	18.33	27.64	
	12/21/93		14.58	18.12	27.01	
	03/18/94		13.53	19.17	28.70	
	06/15/94		14.18	18.52	28.74	
	09/14/94		15.07	17.63	28.70	
	12/19/94		13.74	18.96	28.76	
	12/21/95		13.84	18.86	—	
	03/07/95		12.73	19.97	28.88	
	06/08/95		12.99	19.71	28.87	
	09/22/95		13.83	18.87	28.85	
	12/27/95		13.59	19.11	28.85	
	03/26/96		12.20	20.50	28.84	
	06/13/96		12.98	19.72	28.84	
	09/10/96		13.96	18.74	28.87	
12/05/96	13.36	19.34	28.87			
03/10/97	12.74	19.96	28.86			
06/12/97	13.06	19.64	28.83			
08/19/97	14.21	18.49	28.82			
12/13/97	13.51	19.19	28.85			
MW-6	03/30/92	30.40	12.62	17.78	—	
	07/01/92		12.70	17.70	—	
	09/30/92		13.40	17.00	—	
	11/19/92		13.59	16.81	15.10	
	02/03/93		12.43	17.97	15.01	
	05/25/93		—	—	—	
	10/11/93		12.82	17.58	15.10	
	12/21/93		13.06	17.34	15.10	
	03/18/94		12.16	18.24	15.16	
	06/15/94		12.59	17.81	15.17	
	09/14/94		12.86	17.54	14.97	
	12/19/94		12.48	17.92	15.19	
	12/21/95		11.61	18.79	—	
	03/07/95		12.37	18.03	14.98	
	06/08/95		11.14	19.26	15.00	
	09/22/95		12.44	17.96	15.00	
	12/27/95		12.21	18.19	14.98	
	03/26/96		12.26	18.14	14.97	
	06/13/96		12.55	17.85	14.98	
	09/10/96		12.31	18.09	15.01	
12/05/96	12.22	18.18	15.00			
03/10/97	12.19	18.21	15.01			
06/12/97	12.28	18.12	14.97			
08/19/97	12.30	18.10	14.98			
12/13/97	11.93	18.47	14.93			

NOTES: 1 = Measurement and reference elevation taken from notch/mark on top north side of well casing.
2 = Elevation referenced to mean sea level.
Well Depth = Measurement from top of casing to bottom of well.
— = Not measured.
= Well paved over.

TABLE 1
GROUND WATER ELEVATION DATA
BEACON STATION #720
1088 MARINA BOULEVARD, SAN LEANDRO, CALIFORNIA
(Measurements in feet)

Monitoring Well	Date	Reference Elevation (top of casing) ¹	Depth to Ground Water ²	Ground Water Elevation ²	Well Depth	Comments
MW-7	03/30/92	31.20	12.34	18.86	—	
	07/01/92		15.54	15.66	—	
	09/30/92		14.64	16.56	—	
	11/19/92		14.80	16.40	25.10	
	02/03/93		11.36	19.84	25.02	
	05/25/93		—	—	—	
	09/22/93		13.18	18.02	25.01	
	12/21/93		13.42	17.78	25.02	
	03/18/94		12.36	18.84	25.13	
	06/15/94		13.01	18.19	25.21	
	09/14/94		13.88	17.32	25.13	
	12/19/94		12.61	18.59	25.23	
	12/21/95		12.38	18.82	—	
	03/07/95		11.56	19.64	25.22	
	06/08/95		11.82	19.38	25.20	
	09/22/95		12.67	18.53	25.23	
	12/27/95		12.34	18.86	25.23	
	03/26/96		11.03	20.17	25.21	
	06/13/96		11.76	19.44	25.20	
	09/10/96		12.71	18.49	24.56	
12/05/96	12.32	18.88	24.56			
03/10/97	11.38	19.82	24.53			
06/12/97	12.28	18.92	24.52			
08/19/97	12.92	18.28	24.52			
12/13/97	11.69	19.51	24.50			
MW-8	03/30/92	33.80	14.66	19.14	—	
	07/01/92		15.74	18.06	—	
	09/30/92		17.00	16.80	—	
	11/19/92		17.01	16.79	29.75	
	02/03/93		13.83	19.97	29.88	
	05/25/93		13.01	20.79	29.86	
	09/22/93		15.81	17.99	24.52	
	12/21/93		16.05	17.75	29.86	
	03/18/94		14.62	19.18	29.87	
	06/15/94		15.29	18.51	30.07	
	09/14/94		16.22	17.58	29.87	
	12/19/94		14.81	18.99	30.05	
	12/21/95		14.89	18.91	—	
	03/07/95		13.75	20.05	29.94	
	06/08/95		13.98	19.82	29.93	
	09/22/95		14.92	18.88	29.95	
	12/27/95		14.61	19.19	29.92	
	03/26/96		13.09	20.71	29.73	
	06/13/96		13.81	19.99	27.92	
	09/10/96		14.80	19.00	27.95	
12/05/96	14.05	19.75	27.96			
03/10/97	13.40	20.40	27.98			
06/12/97	14.31	19.49	27.95			
08/19/97	13.85	19.95	27.94			
12/13/97	13.92	19.88	27.93			

NOTES: 1 = Measurement and reference elevation taken from notch/mark on top north side of well casing.
2 = Elevation referenced to mean sea level.
Well Depth = Measurement from top of casing to bottom of well.
— = Not measured.
= Well caved over.

TABLE 1
GROUND WATER ELEVATION DATA
BEACON STATION #720
1088 MARINA BOULEVARD, SAN LEANDRO, CALIFORNIA
(Measurements in feet)

Monitoring Well	Date	Reference Elevation (top of casing) ¹	Depth to Ground Water ¹	Ground Water Elevation ²	Well Depth	Comments
MW-9	12/21/95	32.56	13.76	18.80	—	
	03/07/95		12.79	19.77	24.71	
	06/08/95		12.96	19.60	24.70	
	09/22/95		13.73	18.83	24.72	
	12/27/95		13.53	19.03	24.71	
	03/26/96		12.27	20.29	24.70	
	06/13/96		12.84	19.72	24.53	
	09/10/96		13.49	19.07	24.58	
	12/05/96		13.18	19.38	24.60	
	03/10/97		12.25	20.31	24.66	
	06/12/97		12.70	19.86	24.66	
	08/19/97		17.89	14.67	24.68	
	12/13/97		15.79	16.77	24.68	

NOTES: 1 = Measurement and reference elevation taken from notch/mark on top north side of well casing.
2 = Elevation referenced to mean sea level.
Well Depth = Measurement from top of casing to bottom of well.
— = Not measured.
. = Well paved over.

TABLE 2
GROUND WATER ANALYTICAL RESULTS
BEACON STATION #720
1088 MARINA BOULEVARD, SAN LEANDRO, CALIFORNIA
(All results in micrograms per Liter)

Monitoring Well	Date Collected	Total Petroleum Hydrocarbons	Aromatic Volatile Organics				
			Gasoline	MTBE ¹	Benzene	Toluene	Ethylbenzene
MW-1	03/30/92	27,000		630	550	540	1,900
	07/01/92	55,000		840	1,000	830	3,600
	09/30/92	6,400		150	95	120	470
	11/19/92	1,300		90	11	50	87
	02/03/93	53,000		750	560	950	5,700
	05/25/93	9,400		200	86	470	1,500
	09/22/93	41,000		1,000	510	850	1,100
	12/21/93	41,000		1,000	490	2,700	13,000
	03/18/94	9,500		320	160	830	2,900
	06/15/94	8,000		310	80	990	2,300
	09/14/94	3,600		130	31	390	630
	12/19/94	17,000		350	150	1,500	5,200
	03/07/95	12,000		180	62	1,200	3,200
	06/08/95	6,300		76	8.0	560	860
	09/22/95	12,000		140	55	1,500	2,500
	12/27/95	3,900		60	13	480	870
	03/26/96	6,400		42	4.9	560	600
	06/13/96	9,600	<50	86	39	1,100	1,700
	09/10/96	16,000	<50	65	35	1,500	2,700
	12/05/96	6,400	<25	25		570	930
03/10/97	15,000	<50	42	<5.0	1,400	1,500	
06/12/97	16,000	<100	33	34	1,100	1,700	
08/19/97	17,000	<100	47	14	1,300	2,200	
12/13/97	5,300	<100	20	35	360	470	
MW-2	03/30/92	52,000		2,300	1,700	940	3,300
	07/01/92	130,000		3,500	2,900	1,900	7,900
	09/30/92	24,000		890	350	500	1,700
	11/19/92	32,000		1,900	1,700	870	3,400
	02/03/93	64,000		1,900	2,200	860	4,100
	05/25/93	34,000		3,300	1,500	1,300	5,900
	09/22/93	8,000		640	150	270	2,000
	12/21/93	18,000		1,500	410	1,300	5,000
	03/18/94	14,000		1,600	790	1,100	3,700
	06/15/94	13,000		1,600	580	1,200	4,100
	09/14/94	20,000		1,600	560	1,800	6,400
	12/19/94	19,000		1,700	750	1,600	5,800
	03/07/95	17,000		1,900	930	1,300	5,100
	06/08/95	19,000		2,100	740	1,500	4,900
	09/22/95	12,000		340	170	1,100	3,400
	12/27/95	16,000		1,100	540	1,400	5,100
	03/26/96	11,000		930	520	970	3,000
	06/13/96	11,000	1,200	1,800	1,400	1,500	4,500
	09/10/96	19,000	1,100	1,600	600	1,600	5,000
	12/05/96	12,000	180	650	180	1,000	2,300
03/10/97	6,800	69	430	95	590	1,800	
06/12/97	20,000	100	610	140	1,500	4,300	
08/19/97	3,600	<100	250	10	250	250	
12/13/97	8,300	75	370	150	450	1,600	

NOTES: * = Below indicated detection limit.
 NS = Reported as "nondetect" by previous consultant.
 " = Not sampled.

TABLE 2
GROUND WATER ANALYTICAL RESULTS
BEACON STATION #720
1088 MARINA BOULEVARD, SAN LEANDRO, CALIFORNIA
(All results in micrograms per Liter)

Monitoring Well	Date Collected	Total Petroleum Hydrocarbons	Aromatic Volatile Organics					
			Gasoline	MTBE ¹	Benzene	Toluene	Ethylbenzene	Total Xylenes
MW-3	03/30/92	21,000			560	50	630	980
	07/01/92	13,000			150	20	22	300
	09/30/92	4,500			53	2.6	84	96
	11/19/92	4,700			73	6.2	140	120
	02/03/93	23,000			220	40	430	740
	05/25/93	9,900			120	26	370	520
	09/22/93	10,000			370	71	320	640
	12/21/93	7,800			130	8.5	430	380
	03/18/94	3,100			22	1.3	78	41
	06/15/94	1,700			8.6	1.4	22	15
	09/14/94	1,400			3.8	<1.3	13	18
	12/19/94	3,800			70	1.7	140	110
	03/07/95	2,200			9.4	<1.3	30	21
	06/08/95	1,700			5.8	<1.3	2.3	14
	09/22/95	1,200			<1.3	<1.3	1.3	<1.3
	12/27/95	1,300			2.4	<1.3	3.3	3.6
	03/26/96	1,200			4.3	<1.3	4.2	2.0
	06/13/96	1,300		28	5.1	<0.50	21	6.5
	09/10/96	810		<5.0	1.4	4.8	1.6	2.1
	12/05/96	590		<5.0	<0.50	3.2	0.79	0.52
03/10/97	650		<5.0	0.73	3.8	2.4	1.6	
06/12/97	710		<5.0	<0.50	3.5	2.9	3.6	
08/19/97	1,400		13	2.2	0.58	11	34	
12/13/97	810		<5.0	0.96	<0.50	0.54	1.8	
MW-4	03/30/92	76,000			8,000	4,400	730	2,500
	07/01/92	95,000			6,900	2,200	70	330
	09/30/92	58,000			7,100	1,500	650	2,700
	11/19/92	33,000			5,500	840	400	1,400
	02/03/93	130,000			8,200	6,700	940	4,400
	05/25/93	63,000			16,000	6,600	1,700	8,100
	09/22/93	23,000			6,900	940	150	3,000
	12/21/93	28,000			6,900	1,900	1,100	5,500
	03/18/94	58,000			17,000	6,300	2,500	10,000
	06/15/94	59,000			20,000	4,900	2,500	9,100
	09/14/94	73,000			22,000	6,800	2,700	10,000
	12/19/94	67,000			20,000	8,300	2,300	9,100
	03/07/95	57,000			19,000	7,900	2,200	8,700
	06/08/95	61,000			17,000	6,300	2,700	9,000
	09/22/95	37,000			12,000	2,200	1,400	3,500
	12/27/95	39,000			12,000	6,000	1,800	5,800
	03/26/96	31,000			9,600	3,700	2,300	6,200
	06/13/96	240		89	64	0.93	1.8	2.7
	09/10/96	91,000		2,900	13,000	20,000	3,200	16,000
	12/05/96	16,000		1,200	3,700	3,100	580	2,800
03/10/97	630		530	91	<0.50	<0.50	0.80	
06/12/97	36,000		1,100	4,600	5,300	1,200	5,500	
08/19/97	12,000		390	420	88	61	520	
12/13/97	4,300		360	560	740	130	1,100	

NOTES: < = Below indicated detection limit.
 NO = Reported as "nondetect" by previous consultant.
 NS = Not sampled.

TABLE 2
GROUND WATER ANALYTICAL RESULTS
BEACON STATION #720
1088 MARINA BOULEVARD, SAN LEANDRO, CALIFORNIA
(All results in micrograms per Liter)

Monitoring Well	Date Collected	Total Petroleum Hydrocarbons	Aromatic Volatile Organics					
			Gasoline	MTBE ¹	Benzene	Toluene	Ethylbenzene	Total Xylenes
MW-5	03/30/92	29,000			2,600	980	390	1,100
	07/01/92	52,000			2,400	1,000	5,200	2,000
	09/30/92	32,000			1,800	780	370	1,700
	11/19/92	7,800			1,000	280	120	370
	02/03/93	74,000			3,500	3,000	780	3,200
	05/25/93	57,000			7,900	4,700	1,900	7,800
	09/22/93	52,000			7,600	2,400	1,200	8,800
	12/21/93	23,000			3,600	1,200	970	3,600
	03/13/94	47,000			8,200	5,000	1,400	6,100
	06/15/94	28,000			7,900	4,000	1,200	5,200
	09/14/94	32,000			8,000	5,100	1,400	5,600
	12/19/94	29,000			7,000	3,400	1,200	5,200
	03/07/95	36,000			9,800	5,800	1,800	7,800
	06/08/95	33,000			7,700	3,800	1,500	6,200
	09/22/95	39,000			9,500	3,800	1,900	7,000
	12/27/95	42,000			9,700	5,000	2,200	8,800
	03/26/96	37,000			9,800	4,900	2,300	8,800
	06/13/96	18,000		1,400	5,500	2,200	1,500	5,300
	09/10/96	22,000		860	5,600	1,400	1,100	3,500
	12/05/96	24,000		650	5,100	2,500	1,400	4,700
	03/10/97	28,000		760	6,800	2,700	1,300	5,700
06/12/97	49,000		700	7,500	3,200	2,300	9,200	
08/19/97	24,000		1,600	4,700	990	1,400	4,500	
12/13/97	18,000		360	2,700	760	630	4,200	
MW-6	03/30/92	73			2.1	1.1	ND	0.6
	07/01/92	ND			ND	ND	ND	ND
	09/30/92	ND			0.73	ND	ND	0.58
	11/19/92	96			1.5	<0.5	<0.5	0.9
	02/03/93	73			0.6	<0.5	<0.5	<0.5
	05/25/93	NS			NS	NS	NS	NS
	10/11/93	<50			<0.5	<0.5	<0.5	<0.5
	12/21/93	<50			<0.5	<0.5	<0.5	<0.5
	03/13/94	<50			<0.5	<0.5	<0.5	<0.5
	06/15/94	<50			<0.5	<0.5	<0.5	<0.5
	09/14/94	<50			<0.5	<0.5	<0.5	<0.5
	12/19/94	<50			<0.5	<0.5	<0.5	<0.5
	03/07/95	<50			<0.5	<0.5	<0.5	<0.5
	06/08/95	<50			<0.5	<0.5	<0.5	<0.5
	09/22/95	<50			<0.50	<0.50	<0.50	<0.50
	12/27/95	<50			<0.50	<0.50	<0.50	<0.50
	03/26/96	<50			<0.50	<0.50	<0.50	<0.50
	06/13/96	<50		<5.0	<0.50	<0.50	<0.50	<0.50
	09/10/96	<50		<5.0	<0.50	<0.50	<0.50	<0.50
	12/05/96	<50		<5.0	<0.50	<0.50	<0.50	<0.50
	03/10/97	<50		<5.0	<0.50	<0.50	<0.50	<0.50
06/12/97	<50		<5.0	<0.50	<0.50	<0.50	<0.50	
08/19/97	<50		<5.0	<0.50	<0.50	<0.50	<0.50	
12/13/97	<50		<5.0	<0.50	<0.50	<0.50	<0.50	

NOTES: < = Below indicated detection limit.
 < ND = Reported as "nondetect" by previous consultant.
 NS = Not sampled.

TABLE 2
GROUND WATER ANALYTICAL RESULTS
BEACON STATION #720
1088 MARINA BOULEVARD, SAN LEANDRO, CALIFORNIA
(All results in micrograms per Liter)

Monitoring Well	Date Collected	Total Petroleum Hydrocarbons	Aromatic Volatile Organics				
		Gasoline	MTBE ¹	Benzene	Toluene	Ethyl-benzene	Total Xylenes
MW-7	03/30/92	ND		ND	ND	ND	ND
	07/01/92	ND		ND	ND	ND	ND
	09/30/92	ND		ND	ND	ND	ND
	11/19/92	<50		<0.5	<0.5	<0.5	<0.5
	02/03/93	<50		<0.5	<0.5	<0.5	<0.5
	05/25/93	NS		NS	NS	NS	NS
	09/22/93	<50		0.51	0.82	<0.5	0.81
	12/21/93	<50		<0.5	<0.5	<0.5	<0.5
	03/18/94	<50		<0.5	<0.5	<0.5	<0.5
	06/15/94	<50		<0.5	<0.5	<0.5	<0.5
	09/14/94	<50		<0.5	<0.5	<0.5	<0.5
	12/19/94	<50		<0.5	<0.5	<0.5	<0.5
	03/07/95	<50		<0.5	<0.5	<0.5	<0.5
	06/08/95	<50		<0.5	<0.5	<0.5	<0.5
	09/22/95	<50		<0.50	<0.50	<0.50	<0.50
	12/27/95	<50		<0.50	<0.50	<0.50	<0.50
	03/26/96	<50		<0.50	<0.50	<0.50	<0.50
	06/13/96	<50	<5.0	<0.50	<0.50	<0.50	<0.50
	09/10/96	<50	<5.0	<0.50	<0.50	<0.50	<0.50
	12/05/96	<50	<5.0	<0.50	<0.50	<0.50	<0.50
	03/07/97	<50	<5.0	<0.50	<0.50	<0.50	<0.50
06/12/97	<50	<5.0	<0.50	<0.50	<0.50	<0.50	
08/19/97	<50	<5.0	<0.50	<0.50	<0.50	<0.50	
12/13/97	<50	<5.0	<0.50	<0.50	<0.50	<0.50	
MW-8	03/30/92	3,000		1,700	330	970	1,900
	07/01/92	72,000		1,800	550	520	2,200
	09/30/92	12,000		680	140	140	560
	11/19/92	9,600		530	310	130	560
	02/03/93	44,000		1,500	1,300	490	2,300
	05/25/93	7,400		580	160	170	480
	09/22/93	2,400		490	45	37	140
	12/21/93	1,400		240	7.5	<2.5	82
	03/18/94	8,600		1,600	680	470	1,900
	06/15/94	4,800		980	380	260	1,200
	09/14/94	6,600		1,200	280	330	1,100
	12/19/94	8,400		1,800	390	500	2,000
	03/07/95	7,400		1,400	370	440	2,000
	06/08/95	6,000		790	220	290	1,400
	09/22/95	4,100		750	93	230	860
	12/27/95	5,400		860	140	350	1,400
	03/26/96	1,700		130	27	100	370
	06/13/96	2,400	42	500	67	220	350
	09/10/96	7,000	<50	1,300	100	410	1,600
	12/05/96	6,300	<50	1,100	78	410	1,600
	03/07/97	6,500	<130	840	67	330	1,500
06/12/97	7,500	<50	1,000	79	390	1,400	
08/19/97	1,100	<20	170	14	38	220	
12/13/97	4,100	24	300	29	190	860	

NOTES: < = Below indicated detection limit.
 NO = Reported as "nondetect" by previous consultant.
 NS = Not sampled.

TABLE 2
GROUND WATER ANALYTICAL RESULTS
BEACON STATION #720
1088 MARINA BOULEVARD, SAN LEANDRO, CALIFORNIA
(All results in micrograms per Liter)

Monitoring Well	Date Collected	Total Petroleum Hydrocarbons	Aromatic Volatile Organics				
		Gasoline	MTBE ¹	Benzene	Toluene	Ethyl-benzene	Total Xylenes
MW-9	12/20/94	16,000		2,500	1,400	690	2,300
	03/07/95	5,200		1,600	250	320	520
	06/08/95	4,900		1,000	98	300	200
	09/22/95	4,000		1,100	82	190	200
	12/27/95	2,300		960	100	200	250
	03/26/96	1,600		380	44	96	110
	06/13/96	1,300	750	540	71	140	130
	09/10/96	2,400	810	860	70	190	210
	12/05/96	5,500	960	2,100	420	380	720
	03/07/97	4,200	720	1,300	170	260	440
	06/12/97	11,000	1,000	2,500	490	560	1,300
	08/19/97	42,000	<1,000	7,700	3,500	2,000	3,300
	12/13/97	13,000	710	1,300	280	960	3,100

NOTES:
 = Below indicated detection limit.
 = Reported as "nondetect" by previous consultant.
 = Not sampled.

TABLE 1

GROUNDWATER ELEVATIONS

Page 1 of 5

Date Sampled	Depth to Groundwater (Feet)	Groundwater Elevation (Feet)
Groundwater Monitoring Well MW-1:		Elevation of Top of Casing = 29.89 feet
June 23, 1987	14.79	15.10
July 06, 1987	14.93	14.96
August 06, 1987	14.22	15.67
November 04, 1987	15.74	14.15
February 02, 1988	13.99	15.90
May 02, 1988	14.99	14.90
November 21, 1988	13.03	16.86
February 14, 1989	15.86	14.03
May 02, 1989	14.77	15.12
August 10, 1989	16.35	13.54
November 08, 1989	16.46	13.43
February 20, 1990	15.58	14.31
May 18, 1990	16.40	13.49
September 15, 1990	16.83	13.06
November 26, 1990	17.16	12.73
February 07, 1991	16.43	13.46
May 14, 1991	14.93	14.96
August 16, 1991	16.35	13.54
Groundwater Monitoring Well MW-1:		New Elevation of Top of Casing = 33.10 feet
December 24, 1991	17.20	15.90
March 30, 1992	13.58	19.52
Groundwater Monitoring Well MW-2:		Elevation of Top of Casing = 29.57 feet
June 23, 1987	14.51	15.06

TABLE 1

GROUNDWATER ELEVATIONS
Page 2 of 5

Date Sampled	Depth to Groundwater (Feet)	Groundwater Elevation (Feet)
July 06, 1987	14.63	14.94
August 06, 1987	14.95	14.62
November 04, 1987	15.45	14.12
February 02, 1988	13.74	15.83
May 02, 1988	14.63	14.94
November 21, 1988	12.99	16.58
February 14, 1989	15.66	13.91
May 02, 1989	14.56	15.01
August 10, 1989	16.22	13.35
November 08, 1989	16.19	13.38
February 20, 1990	15.34	14.23
May 18, 1990	16.20	13.37
September 15, 1990	16.42	13.05
November 26, 1990	16.83	12.74
February 07, 1991	16.13	13.44
May 14, 1991	14.62	14.95
August 16, 1991	16.00	13.57
Groundwater Monitoring Well MW-2:		New Elevation of Top of Casing = 32.80 feet
December 24, 1991	16.90	15.90
March 30, 1992	13.32	19.48
Groundwater Monitoring Well MW-3:		Elevation of Top of Casing = 29.13 feet
June 23, 1987	14.13	15.00
July 06, 1987	14.24	14.89
August 06, 1987	14.52	14.61
November 04, 19887	15.09	14.04
February 02, 1988	13.37	15.76

TABLE 1

GROUNDWATER ELEVATIONS

Page 3 of 5

Date Sampled	Depth to Groundwater (Feet)	Groundwater Elevation (Feet)
May 02, 1988	14.22	14.91
November 21, 1988	13.01	16.12
February 14, 1989	15.22	13.91
May 02, 1989	14.16	14.97
August 10, 1989	15.61	13.52
November 08, 1989	15.75	13.38
February 20, 1990	14.95	14.18
May 18, 1990	15.79	13.34
September 15, 1990	16.07	13.06
November 26, 1990	16.36	12.77
February 07, 1991	15.74	13.39
May 14, 1991	14.19	14.94
August 16, 1991	15.55	13.58
Groundwater Monitoring Well MW-3:		New Elevation of Top of Casing = 32.30 feet
December 24, 1991	16.40	15.90
March 30, 1992	12.96	19.34
Groundwater Monitoring Well MW-4:		Elevation of Top of Casing = 29.72 feet
June 23, 1987	14.77	14.95
July 06, 1987	14.91	14.81
August 06, 1987	15.19	14.53
November 04, 1987	15.72	14.00
February 02, 1988	14.03	15.69
May 02, 1988	14.39	14.83
November 21, 1988	12.38	16.84
February 14, 1989	15.83	13.89
May 02, 1989	14.75	14.97

TABLE 1
GROUNDWATER ELEVATIONS
Page 4 of 5

Date Sampled	Depth to Groundwater (Feet)	Groundwater Elevation (Feet)
August 10, 1989	16.30	13.42
November 08, 1989	16.29	13.43
February 20, 1990	15.62	14.10
May 18, 1990	16.34	13.38
September 15, 1990	16.79	12.93
November 26, 1990	17.08	12.64
February 07, 1991	16.37	13.35
May 14, 1991	14.87	14.85
August 16, 1991	16.25	13.47
Groundwater Monitoring Well MW-4:		New Elevation of Top of Casing = 32.90 feet
December 24, 1991	17.10	15.80
March 30, 1992	13.60	19.30
Groundwater Monitoring Well MW-5:		Elevation of Top of Casing = 29.55 feet
June 23, 1987	14.63	14.92
July 06, 1987	14.79	14.76
August 06, 1987	15.07	14.48
November 04, 1987	15.61	13.94
February 02, 1988	13.84	15.71
May 02, 1988	14.77	14.78
November 21, 1988	12.84	16.71
February 14, 1989	15.72	13.83
May 02, 1989	14.68	14.87
August 10, 1989	16.03	13.52
November 08, 1989	16.33	13.22
February 20, 1990	15.44	14.11

TABLE 1
GROUNDWATER ELEVATIONS
Page 5 of 5

Date Sampled	Depth to Groundwater (Feet)	Groundwater Elevation (Feet)
May 18, 1990	16.22	13.33
September 15, 1990	16.65	12.90
November 26, 1990	16.95	12.60
February 07, 1991	16.20	13.35
May 14, 1991	14.72	14.38
August 16, 1991	16.10	13.45
Groundwater Monitoring Well MW-5:		New Elevation of Top of Casing = 32.70 feet
December 24, 1991	16.92	15.78
March 30, 1992	13.48	19.22
Groundwater Monitoring Well MW-6:		Elevation of Top of Casing = 30.40 feet
December 24, 1991	14.12	16.28
March 30, 1992	12.62	17.78
Groundwater Monitoring Well MW-7:		Elevation of Top of Casing = 31.20 feet
December 24, 1991	15.70	15.50
March 30, 1992	12.34	18.86
Groundwater Monitoring Well MW-8:		Elevation of Top of Casing = 33.80 feet
December 24, 1991	18.00	15.80
March 30, 1992	14.66	19.14
Notes:		
1)	All elevations surveyed to an arbitrary datum	
2)	Elevations and depths are given in feet	
3)	Groundwater Technology, Inc., made measurements until February 1989	
4)	Du Pont Environmental Services collected samples from February 1989 through February 1991	
5)	Environmental Geotechnical Consultants, Inc., made measurements beginning in May 1991	

TABLE 2

SUMMARY OF GROUNDWATER ANALYTICAL RESULTS

Page 1 of 5

Well No.	Date Sampled	Benzene (µg/L)	Toluene (µg/L)	Ethylbenzene (µg/L)	Xylenes (µg/L)	TPH-G (µg/L)	Comments
MW-1	Apr. 16, 1987	2,313	3,770	664.1	3,331	17,276	
	June 23, 1987	1,887	2,141	466.7	1,652	26,027	
	July 06, 1987	778.2	943.7	133.2	422.1	3,938	
	Aug. 06, 1987	1,270	1,576	288.7	873.7	6,079	
	Nov. 04, 1987	1,700	4,000	720	2,200	15,000	
	Feb. 02, 1988	1,500	1,700	230	740	14,000	
	May 02, 1988	3,500	700	4,900	2,700	33,000	
	Nov. 21, 1988	2,200	560	2,800	2,200	15,000	
	Feb. 14, 1989	1,700	1,700	340	1,500	12,000	Odor
	May 02, 1989	1,500	2,400	510	2,400	18,000	Odor, Slight Sheen
	Aug. 10, 1989	1,400	1,500	360	1,600	10,000	Odor
	Nov. 08, 1989	920	470	190	360	7,200	Odor
	Feb. 20, 1990	810	540	270	800	3,300	
	May 18, 1990	1,900	500	560	1,600	5,600	
	Sep. 15, 1990	320	110	150	520	5,200	Odor
	Nov. 26, 1990	370	59	150	370	3,000	Odor
	Feb. 07, 1991	750	570	480	1,800	14,000	
	May 14, 1991	1,000	1,400	600	2,500	41,000	
	Aug. 16, 1991	310	210	150	480	4,000	Odor
	Dec. 24, 1991	530	95	310	680	11,000	Moderate Odor
	Mar. 30, 1992	630	550	540	1,900	27,000	Odor
MW-2	Apr. 16, 1987	3,131	4,239	1,067	4,608	17,920	
	June 23, 1987	2,188	2,622	1,047	4,699	49,354	
	July 06, 1987	1,575	1,729	457	1,702	8,676	
	Aug. 06, 1987	2,623	3,722	702	2,882	14,376	
	Nov. 04, 1987	2,200	4,100	900	3,500	19,000	

TABLE 2

SUMMARY OF GROUNDWATER ANALYTICAL RESULTS
Page 2 of 5

Well No.	Date Sampled	Benzene (µg/L)	Toluene (µg/L)	Ethylbenzene (µg/L)	Xylenes (µg/L)	TPH-G (µg/L)	Comments
MW-2	Feb. 02, 1988	6,200	6,500	1,000	4,000	54,000	
	May 02, 1988	6,800	1,300	7,100	5,400	53,000	
	Nov. 21, 1988	--	--	--	--	--	Free product
	Feb. 14, 1989	6,900	4,300	1,100	5,200	48,000	Film of free product
	May 02, 1989	6,100	8,800	2,100	16,000	111,000	Odor, sheen
	Aug. 10, 1989	4,200	2,900	1,000	5,800	39,000	Odor, sheen
	Nov. 08, 1989	3,700	1,500	740	2,200	45,000	Odor, heavy sheen
	Feb. 20, 1990	5,000	8,200	1,600	11,000	60,000	
	May 18, 1990	6,200	1,900	1,300	610	19,000	
	Sep. 15, 1990	1,400	820	660	3,000	27,000	Odor, sheen
	Nov. 26, 1990	1,100	880	700	3,800	28,000	Odor, sheen
	Feb. 07, 1991	2,100	1,900	1,300	6,200	63,000	Odor, sheen
	May 14, 1991	2,200	2,700	1,100	5,900	100,000	Moderate odor Slight sheen
	Aug. 16, 1991	1800	950	990	3900	32,000	Slight odor, sheen
	Dec. 24, 1991	1,100	550	750	2,700	30,000	Odor, sheen
	Mar. 30, 1992	2,300	1,700	940	3,300	52,000	Odor, sheen
MW-3	Apr. 16, 1987	1,371	2,438	472.3	2,617	9,967	
	June 23, 1987	646.2	822.9	320.9	1,280	16,824	
	July 06, 1987	340.3	384.2	116.5	420.2	3,395	
	Aug. 06, 1987	441.9	436.3	118.2	417.3	3,107	
	Nov. 04, 1987	320	280	74	250	2,600	
	Feb. 02, 1988	2,200	2,300	500	2,300	44,000	
	May 02, 1988	1,600	450	840	1,700	14,000	
	Nov. 21, 1988	1,200	220	560	810	8,100	
	Feb. 14, 1989	1,500	220	220	500	5,500	Odor

TABLE 2

SUMMARY OF GROUNDWATER ANALYTICAL RESULTS

Page 3 of 5

Well No.	Date Sampled	Benzene (µg/L)	Toluene (µg/L)	Ethylbenzene (µg/L)	Xylenes (µg/L)	TPH-G (µg/L)	Comments
	Aug. 10, 1989	750	10	190	210	2,700	Odor
	Nov. 08, 1989	370	90	NO	58	2,400	Odor
	Feb. 20, 1990	1,200	810	77	460	3,700	
	May 18, 1990	980	NO	330	250	2,300	
	Sep. 15, 1990	240	36	150	230	4,700	Odor
	Nov. 26, 1990	170	8.4	86	120	1,400	Odor
	Feb. 07, 1991	220	20	120	230	2,900	
	May 14, 1991	370	39	220	820	15,000	
	Aug. 16, 1991	480	50	360	680	7,200	Slight Odor
	Dec. 24, 1991	150	20	100	140	4,900	Slight Odor
	Mar. 30, 1992	560	50	630	980	21,000	Odor
MW-4	Apr. 16, 1987	5,896	3,797	893.9	4,106	19,309	
	June 23, 1987	4,030	1,842	850.0	3,254	31,429	
	July 06, 1987	2,710	1,247	308.2	1,312	8,117	
	Aug. 06, 1987	3,992	1,539	447.9	1,611	10,464	
	Nov. 04, 1987	9,500	17,000	2,800	11,000	55,000	
	Feb. 02, 1988	11,000	7,400	1,400	6,200	47,000	
	May 02, 1988	9,200	1,300	6,100	6,400	58,000	
	Nov. 21, 1988	5,700	1,600	3,100	7,600	48,000	
	Feb. 14, 1989	8,700	2,500	900	3,800	29,000	Odor & sheen
	May 02, 1989	4,800	5,600	1,800	8,800	69,000	Odor, slight sheen
	Aug. 10, 1989	15,000	6,600	1,800	12,000	67,000	Odor, slight sheen
	Nov. 08, 1989	11,000	3,200	1,100	4,400	71,000	Odor, slight sheen
	Feb. 20, 1990	8,100	4,500	930	3,500	19,000	
	May 18, 1990	45,000	12,000	5,000	27,000	100,000	
	Sep. 15, 1990	4,200	1,200	740	3,000	38,000	

TABLE 2

SUMMARY OF GROUNDWATER ANALYTICAL RESULTS

Page 4 of 5

Well No.	Date Sampled	Benzene (µg/L)	Toluene (µg/L)	Ethylbenzene (µg/L)	Xylenes (µg/L)	TPH-G (µg/L)	Comments
MW-4	Nov. 26, 1990	2,800	650	810	2,600	19,000	Odor
	Feb. 07, 1991	4,600	1,100	1,600	4,600	41,000	Odor, sheen
	May 14, 1991	7,300	830	3,900	3,600	100,000	Slight odor, sheen
	Aug. 16, 1991	8,000	2,500	1,100	4,000	45,000	Strong odor, sheen
	Dec. 24, 1991	6,000	1,200	1,100	3,700	79,000	Odor, sheen
	Mar. 30, 1992	8,000	4,400	730	2,500	76,000	Odor, sheen
MW-5	Apr. 16 1987	2,267	921.2	3,277	4,536	17,733	
	June 23, 1987	2,239	516.8	953.9	1,587	19,555	
	July 06, 1987	1,335	313.7	799.2	923.9	5,631	
	Aug. 06, 1987	1,890	881.2	576.8	93.4	6,450	
	Nov. 04, 1987	1,300	500	270	640	4,600	
	Feb. 02, 1988	3,100	1,500	550	1,400	24,000	
	May 02, 1988	4,400	490	1,200	1,500	17,000	
	Nov. 21, 1988	5,600	590	870	2,200	19,000	
	Feb. 14, 1989	4,300	810	410	1,300	13,000	Odor
	May 02, 1989	2,900	1,500	690	3,200	24,000	Odor, slight sheen
	Aug. 10, 1989	6,700	2,300	860	4,700	36,000	Odor, slight sheen
	Nov. 08, 1989	5,300	860	460	600	30,000	Odor
	Feb. 20, 1990	1,700	220	120	370	3,400	
	May 18, 1990	18,000	2,000	1,500	5,600	24,000	
	Sep. 15, 1990	2,600	2,200	1,000	4,900	42,000	Odor, sheen
	Nov. 26, 1990	1,900	280	260	800	8,500	Odor, sheen

TABLE 2

SUMMARY OF GROUNDWATER ANALYTICAL RESULTS

Page 5 of 5

Well No.	Date Sampled	Benzene (µg/L)	Toluene (µg/L)	Ethylbenzene (µg/L)	Xylenes (µg/L)	TPH-G (µg/L)	Comments
	Feb. 07, 1991	1,500	1,200	610	2,700	24,000	Odor
	May 14, 1991	3,800	4,400	1,400	6,400	120,000	Odor, sheen
	Aug. 16, 1991	4,200	1,900	760	2,900	29,000	Moderate odor, sheen
	Dec. 24, 1991	3,900	1,500	880	3,200	63,000	Odor, sheen
	Mar. 30, 1992	2,600	980	390	1,100	29,000	Odor, sheen
MW-6	Dec. 24, 1991	ND	ND	ND	ND	79	
	Mar. 30, 1992	2.1	1.1	ND	0.6	73	
MW-7	Dec. 24, 1991	ND	ND	ND	ND	ND	
	Mar. 30, 1992	ND	ND	ND	ND	ND	
MW-8	Dec. 24, 1991	1,700	2,400	1,200	6,100	81,000	Odor, sheen
	Mar. 30, 1992	1,700	880	970	1,900	3,000	Odor, sheen

- Notes:
- 1) TPH-G = Total Petroleum Hydrocarbons as gasoline
 - 2) Odor refers to petroleum hydrocarbon odor
 - 3) All results are presented in parts per billion
 - 4) Groundwater Technology, Inc., collected samples prior to February 1989
 - 5) Du Pont Environmental Services collected samples from February 1989 through February 1991
 - 6) Environmental Geotechnical Consultants, Inc. collected samples beginning in May 1991
 - 7) ND = Non Detect
 - 8) See analytical results for detection limits (Appendix B)

ENCLOSURE C

Ground Water Monitoring Analytical Results

Richard Munsch
Delta Environmental Consultants, Inc.
3164 Gold Camp Drive, Suite 200
Rancho Cordova, CA 95670

Subject : 9 Water Samples
Project Name : Beacon 720
Project Number : 94-720-01



Dear Mr. Munsch,

Chemical analysis of the samples referenced above has been completed. Summaries of the data are contained on the following pages. Sample(s) were received under documented chain-of-custody. US EPA protocols for sample storage and preservation were followed.

Kiff Analytical is certified by the State of California (# 2236). If you have any questions regarding procedures or results, please call me at 530-297-4800.

Sincerely,

Joel Kiff



Report Number : 11689

Date : 06/10/98

Project Name : **Beacon 720**

Project Number : **94-720-01**

Sample : **MW-1**

Matrix : Water

Sample Date :05/28/98

Parameter	Measured Value	Method Reporting Limit	Units	Analysis Method	Date Analyzed
Benzene	< 0.50	0.50	ug/L	EPA 8020	06/07/98
Toluene	< 0.50	0.50	ug/L	EPA 8020	06/07/98
Ethylbenzene	< 0.50	0.50	ug/L	EPA 8020	06/07/98
Total Xylenes	< 0.50	0.50	ug/L	EPA 8020	06/07/98
Methyl-t-butyl ether	< 5.0	5.0	ug/L	EPA 8020	06/07/98
TPH as Gasoline	< 50	50	ug/L	M EPA 8015	06/07/98
aaa-Trifluorotoluene (8020 Surrogate)	103		% Recovery	EPA 8020	06/07/98
aaa-Trifluorotoluene (Gasoline Surrogate)	95.2		% Recovery	M EPA 8015	06/07/98

Sample : **MW-2**

Matrix : Water

Sample Date :05/28/98

Parameter	Measured Value	Method Reporting Limit	Units	Analysis Method	Date Analyzed
Benzene	< 0.50	0.50	ug/L	EPA 8020	06/07/98
Toluene	< 0.50	0.50	ug/L	EPA 8020	06/07/98
Ethylbenzene	< 0.50	0.50	ug/L	EPA 8020	06/07/98
Total Xylenes	< 0.50	0.50	ug/L	EPA 8020	06/07/98
Methyl-t-butyl ether	27	5.0	ug/L	EPA 8020	06/07/98
TPH as Gasoline	< 50	50	ug/L	M EPA 8015	06/07/98
aaa-Trifluorotoluene (8020 Surrogate)	102		% Recovery	EPA 8020	06/07/98
aaa-Trifluorotoluene (Gasoline Surrogate)	95.9		% Recovery	M EPA 8015	06/07/98

Approved By:  Joel Kiff

Project Name : **Beacon 720**Project Number : **94-720-01**Sample : **MW-3**

Matrix : Water

Sample Date :05/28/98

Parameter	Measured Value	Method Reporting Limit	Units	Analysis Method	Date Analyzed
Benzene	< 0.50	0.50	ug/L	EPA 8260B	06/09/98
Toluene	0.50	0.50	ug/L	EPA 8260B	06/09/98
Ethylbenzene	< 0.50	0.50	ug/L	EPA 8260B	06/09/98
Total Xylenes	< 0.50	0.50	ug/L	EPA 8260B	06/09/98
Methyl-t-butyl ether	< 5.0	5.0	ug/L	EPA 8260B	06/09/98
TPH as Gasoline	350	50	ug/L	EPA 8260B	06/09/98
Toluene - d8 (Surr)	104		% Recovery	EPA 8260B	06/09/98
4-Bromofluorobenzene (Surr)	101		% Recovery	EPA 8260B	06/09/98

Sample : **MW-4**

Matrix : Water

Sample Date :05/28/98

Parameter	Measured Value	Method Reporting Limit	Units	Analysis Method	Date Analyzed
Benzene	< 0.50	0.50	ug/L	EPA 8020	06/08/98
Toluene	0.75	0.50	ug/L	EPA 8020	06/08/98
Ethylbenzene	0.68	0.50	ug/L	EPA 8020	06/08/98
Total Xylenes	6.9	0.50	ug/L	EPA 8020	06/08/98
Methyl-t-butyl ether	26	5.0	ug/L	EPA 8020	06/08/98
TPH as Gasoline	67	50	ug/L	M EPA 8015	06/08/98
aaa-Trifluorotoluene (8020 Surrogate)	104		% Recovery	EPA 8020	06/08/98
aaa-Trifluorotoluene (Gasoline Surrogate)	98.0		% Recovery	M EPA 8015	06/08/98

Approved By:  Joel Kiff

Project Name : **Beacon 720**Project Number : **94-720-01**Sample : **MW-5**

Matrix : Water

Sample Date :05/28/98

Parameter	Measured Value	Method Reporting Limit	Units	Analysis Method	Date Analyzed
Benzene	480	25	ug/L	EPA 8020	06/08/98
Toluene	99	25	ug/L	EPA 8020	06/08/98
Ethylbenzene	160	25	ug/L	EPA 8020	06/08/98
Total Xylenes	730	25	ug/L	EPA 8020	06/08/98
Methyl-t-butyl ether	< 250	250	ug/L	EPA 8020	06/08/98
TPH as Gasoline	4700	2500	ug/L	M EPA 8015	06/08/98
aaa-Trifluorotoluene (8020 Surrogate)	102		% Recovery	EPA 8020	06/08/98
aaa-Trifluorotoluene (Gasoline Surrogate)	96.7		% Recovery	M EPA 8015	06/08/98

Sample : **MW-6**

Matrix : Water

Sample Date :05/28/98

Parameter	Measured Value	Method Reporting Limit	Units	Analysis Method	Date Analyzed
Benzene	< 0.50	0.50	ug/L	EPA 8020	06/06/98
Toluene	< 0.50	0.50	ug/L	EPA 8020	06/06/98
Ethylbenzene	< 0.50	0.50	ug/L	EPA 8020	06/06/98
Total Xylenes	< 0.50	0.50	ug/L	EPA 8020	06/06/98
Methyl-t-butyl ether	< 5.0	5.0	ug/L	EPA 8020	06/06/98
TPH as Gasoline	< 50	50	ug/L	M EPA 8015	06/06/98
aaa-Trifluorotoluene (8020 Surrogate)	102		% Recovery	EPA 8020	06/06/98
aaa-Trifluorotoluene (Gasoline Surrogate)	93.9		% Recovery	M EPA 8015	06/06/98

Approved By:  Joe Kiff

Project Name : **Beacon 720**Project Number : **94-720-01**Sample : **MW-7**

Matrix : Water

Sample Date :05/28/98

Parameter	Measured Value	Method Reporting Limit	Units	Analysis Method	Date Analyzed
Benzene	< 0.50	0.50	ug/L	EPA 8020	06/06/98
Toluene	< 0.50	0.50	ug/L	EPA 8020	06/06/98
Ethylbenzene	< 0.50	0.50	ug/L	EPA 8020	06/06/98
Total Xylenes	< 0.50	0.50	ug/L	EPA 8020	06/06/98
Methyl-t-butyl ether	< 5.0	5.0	ug/L	EPA 8020	06/06/98
TPH as Gasoline	< 50	50	ug/L	M EPA 8015	06/06/98
aaa-Trifluorotoluene (8020 Surrogate)	101		% Recovery	EPA 8020	06/06/98
aaa-Trifluorotoluene (Gasoline Surrogate)	93.1		% Recovery	M EPA 8015	06/06/98

Sample : **MW-8**

Matrix : Water

Sample Date :05/28/98

Parameter	Measured Value	Method Reporting Limit	Units	Analysis Method	Date Analyzed
Benzene	< 0.50	0.50	ug/L	EPA 8260B	06/07/98
Toluene	< 0.50	0.50	ug/L	EPA 8260B	06/07/98
Ethylbenzene	< 0.50	0.50	ug/L	EPA 8260B	06/07/98
Total Xylenes	< 0.50	0.50	ug/L	EPA 8260B	06/07/98
Methyl-t-butyl ether	< 5.0	5.0	ug/L	EPA 8260B	06/07/98
TPH as Gasoline	< 50	50	ug/L	EPA 8260B	06/07/98
Toluene - d8 (Surr)	99.2		% Recovery	EPA 8260B	06/07/98
4-Bromofluorobenzene (Surr)	100		% Recovery	EPA 8260B	06/07/98

Approved By:  Joel Kiff



Report Number : 11689

Date : 06/10/98

Project Name : **Beacon 720**

Project Number : **94-720-01**

Sample : **MW-9**

Matrix : Water

Sample Date :05/28/98

Parameter	Measured Value	Method Reporting Limit	Units	Analysis Method	Date Analyzed
Benzene	110	0.50	ug/L	EPA 8020	06/08/98
Toluene	6.4	0.50	ug/L	EPA 8020	06/08/98
Ethylbenzene	87	0.50	ug/L	EPA 8020	06/08/98
Total Xylenes	300	0.50	ug/L	EPA 8020	06/08/98
Methyl-t-butyl ether	220	5.0	ug/L	EPA 8020	06/08/98
TPH as Gasoline	2200	50	ug/L	M EPA 8015	06/08/98
aaa-Trifluorotoluene (8020 Surrogate)	104		% Recovery	EPA 8020	06/08/98
aaa-Trifluorotoluene (Gasoline Surrogate)	112		% Recovery	M EPA 8015	06/08/98

Approved By:  _____
Joel Kiff



Ultramar Inc.
CHAIN OF CUSTODY REPORT

11689

BEACON

Beacon Station No. 720	Sampler (Print Name) Hal Hansen			ANALYSES				Date 5-28-98	Form No. 1 of 2
Project No. 94-720-01	Sampler (Signature) Hal Hansen			BTEX	TPH (gasoline)	TPH (diesel)	No. of Containers	REMARKS Standard TAT	
Project Location San Leandro	Affiliation Doulos Env								
Sample No./Identification	Date	Time	Lab No.						
MW-1	5-28-98	220	-01	X	X		2		
MW-2		205	-02						
MW-3		145	-03						
MW-4		332	-04						
MW-5		316	-05						
MW-6		131	-06						
MW-7		106	-07						
MW-8	✓	233	-08	✓	✓		✓		
Relinquished by: (Signature/Affiliation) Hal Hansen Doulos Env			Date	Time	Received by: (Signature/Affiliation)			Date	Time
Relinquished by: (Signature/Affiliation)			Date	Time	Received by: (Signature/Affiliation)			Date	Time
Relinquished by: (Signature/Affiliation)			Date	Time	Received by: (Signature/Affiliation) Justin Dusch			Date 6/2/98	Time 1320
Report To: Richard Munsch					Bill to: ULTRAMAR INC. 525 West Third Street Hanford, CA 93230 Attention: Terry Fox				



Ultramar Inc.
CHAIN OF CUSTODY REPORT

11689

BEACON

Beacon Station No. <i>720</i>		Sampler (Print Name) <i>Hal Hansen</i>			ANALYSES						Date <i>5-28-98</i>	Form No. <i>2 of 2</i>
Project No. <i>94-720-01</i>		Sampler (Signature) <i>Hal Hansen</i>			BTEX	TPH (gasoline)	TPH (diesel)				No. of Containers	<i>Standard TAT</i>
Project Location <i>San. Leandro</i>		Affiliation <i>Doulos Env.</i>										
Sample No./Identification <i>MW-9</i>		Date <i>5-28-98</i>	Time <i>302</i>	Lab No. <i>-09</i>								
Relinquished by: (Signature/Affiliation) <i>Hal Hansen Doulos Env.</i>		Date	Time	Received by: (Signature/Affiliation)						Date	Time	
Relinquished by: (Signature/Affiliation)		Date	Time	Received by: (Signature/Affiliation)						Date	Time	
Relinquished by: (Signature/Affiliation)		Date	Time	Received by: (Signature/Affiliation) <i>Justin Rensch</i>						Date <i>6/2/98</i>	Time <i>1320</i>	
Report To: <i>Richard Munsch</i>				Bill to: ULTRAMAR INC. 525 West Third Street Hanford, CA 93230 Attention: <i>Terry Fot</i>								

WHITE: Return to Client with Report

YELLOW: Laboratory Copy

PINK: Originator Copy

ENCLOSURE D

Ground Water Treatment System Analytical Results

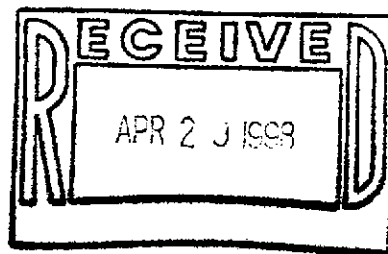

Joel Kiff
Kiff Analytical
720 Olive Drive, Suite D
Davis, CA 95616

Subject : 1 Water sample
Project Name : Beacon 720
Project Number : 11311
P.O. Number : 11311

Dear Mr. Kiff,

Chemical analysis on the samples referenced above has been completed. Summaries of the data are contained on the following pages. Sample(s) were received under documented chain-of-custody. USEPA protocols for sample storage and preservation were followed.

WEST Laboratory is certified by the State of California (# 1346). If you have any questions regarding procedures or results, please call me at 530-757-0920.

Sincerely,

Stewart Podolsky

EPA 8270Sample Name : **Effluent**Project Name : Beacon 720
Project Number : 11311
Sample Date : 03/23/98
Date Extracted : 03/26/98
Extr. Method : EPA 3510Date Analyzed : 03/31/98
Analysis Method : EPA 8270
Date Received : 03/25/98
Dilution : 1:1
Sample Matrix : Water
Lab Number : 18212-01

Parameter	MRL	Measured Conc.	Units
N-Nitrosodimethylamine	10	<10	ug/L
Phenol	10	<10	ug/L
Aniline	10	<10	ug/L
bis(2-Chloroethyl)ether	10	<10	ug/L
2-Chlorophenol	10	<10	ug/L
1,3-Dichlorobenzene	10	<10	ug/L
1,4-Dichlorobenzene	10	<10	ug/L
Benzyl Alcohol	20	<20	ug/L
1,2-Dichlorobenzene	10	<10	ug/L
2-Methylphenol	10	<10	ug/L
bis(2-Chloroisopropyl)ether	10	<10	ug/L
4-Methylphenol	10	<10	ug/L
N-Nitroso-di-n-propylamine	10	<10	ug/L
Hexachloroethane	10	<10	ug/L
Nitrobenzene	10	<10	ug/L
Isophorone	10	<10	ug/L
2-Nitrophenol	10	<10	ug/L
2,4-Dimethylphenol	10	<10	ug/L
bis(2-Chloroethoxy)methane	10	<10	ug/L
2,4-Dichlorophenol	10	<10	ug/L
Benzoic Acid	50	<50	ug/L
1,2,4-Trichlorobenzene	10	<10	ug/L
Naphthalene	10	<10	ug/L
4-Chloroaniline	20	<20	ug/L
Hexachlorobutadiene	10	<10	ug/L
4-Chloro-3-methylphenol	20	<20	ug/L
2-Methylnaphthalene	10	<10	ug/L
Hexachlorocyclopentadiene	10	<10	ug/L
2,4,6-Trichlorophenol	10	<10	ug/L
2,4,5-Trichlorophenol	10	<10	ug/L
2-Chloronaphthalene	10	<10	ug/L
2-Nitroaniline	50	<50	ug/L
Dimethylphthalate	10	<10	ug/L

MRL = Method Reporting Limit

Conc. = Concentration

E = Concentration exceeded calibration range.

Approved By :

John Medina 

EPA 8270Sample Name : **Effluent**Project Name : Beacon 720
Project Number : 11311
Sample Date : 03/23/98
Date Extracted : 03/26/98
Extr. Method : EPA 3510Date Analyzed : 03/31/98
Analysis Method : EPA 8270
Date Received : 03/25/98
Dilution : 1:1
Sample Matrix : Water
Lab Number : 18212-01

Parameter	MRL	Measured Conc.	Units
2,6-Dinitrotoluene	10	<10	ug/L
Acenaphthylene	10	<10	ug/L
3-Nitroaniline	50	<50	ug/L
Acenaphthene	10	<10	ug/L
2,4-Dinitrophenol	50	<50	ug/L
4-Nitrophenol	50	<50	ug/L
Dibenzofuran	10	<10	ug/L
2,4-Dinitrotoluene	10	<10	ug/L
Diethylphthalate	10	<10	ug/L
4-Chlorophenyl-phenylether	10	<10	ug/L
Fluorene	10	<10	ug/L
4-Nitroaniline	50	<50	ug/L
4,6-Dinitro-2-methylphenol	50	<50	ug/L
N-Nitrosodiphenylamine	10	<10	ug/L
Azobenzene	10	<10	ug/L
4-bromophenyl Phenyl Ether	10	<10	ug/L
Hexachlorobenzene	10	<10	ug/L
Pentachlorophenol	50	<50	ug/L
Phenanthrene	10	<10	ug/L
Anthracene	10	<10	ug/L
Di-n-butylphthalate	10	<10	ug/L
Fluoranthene	10	<10	ug/L
Benzidine	20	<20	ug/L
Pyrene	10	<10	ug/L
Butylbenzylphthalate	10	<10	ug/L
Benzo(a)anthracene	10	<10	ug/L
3-3'-Dichlorobenzidine	20	<20	ug/L
Chrysene	10	<10	ug/L
bis(2-Ethylhexyl)phthalate	10	<10	ug/L
Di-n-octylphthalate	10	<10	ug/L
Benzo(b)fluoranthene	10	<10	ug/L
Benzo(k)fluoranthene	10	<10	ug/L
Benzo(a)pyrene	10	<10	ug/L

MRL = Method Reporting Limit

Conc. = Concentration

E = Concentration exceeded calibration range.

Approved By :

John Medina 

EPA 8270Sample Name : **Effluent**Project Name : Beacon 720
Project Number : 11311
Sample Date : 03/23/98
Date Extracted : 03/26/98
Extr. Method : EPA 3510Date Analyzed : 03/31/98
Analysis Method : EPA 8270
Date Received : 03/25/98
Dilution : 1:1
Sample Matrix : Water
Lab Number : 18212-01

<u>Parameter</u>	<u>MRL</u>	<u>Measured Conc.</u>	<u>Units</u>
Indeno(1,2,3-c,d)pyrene	10	<10	ug/L
Dibenzo(a,h)anthracene	10	<10	ug/L
Benzo(g,h,i)perylene	10	<10	ug/L
2-Fluorophenol		45	% Recovery
Phenol-d5		25	% Recovery
Nitrobenzene-d5		97	% Recovery
2-Fluorobiphenyl		84	% Recovery
2,4,6-Tribromophenol		99	% Recovery
Terphenyl-d14		103	% Recovery

MRL = Method Reporting Limit

Conc. = Concentration

E = Concentration exceeded calibration range.

Approved By :

John Medina



Alpha

Alpha Analytical Laboratories Inc. • 860 Waugh Lane, H-1, Ukiah, California 95482
(707) 468-0401

CHEMICAL EXAMINATION REPORT

Kiff Analytical
720 Olive Drive
Suite D
Davis, CA 95616
Attn: Joel Kiff

Date Printed
4/07/98

Page
1

Batch Number 98-0325-019 Receipt Date 03/25/98 12:10 Client KIFFLAB Client P.O. Send Via Mail

Batch 98-0325-019 consisted of 1 Sample and 17 Tests

Sample 1 Effluent Beacon 720
Sample Type: Water Sampled by: Sampled: 3/23/98 07:30

Metals Analyses by ICP and GFAA

	METHOD	EXTRACTED	TEST DATE	RESULT	UNITS	PQL	DILUTION
Antimony	6010		4/07/98	ND	mg/l	.02	
Arsenic GF	7060		3/31/98	ND	mg/l	0.05	
Barium	6010		4/07/98	ND	mg/l	1.00	
Beryllium	6010		4/07/98	ND	mg/l	0.02	
Cadmium	6010		4/07/98	ND	mg/l	0.01	
Chromium	6010		4/07/98	ND	mg/l	0.05	
Cobalt	6010		4/07/98	ND	mg/l	0.50	
Copper	6010		4/07/98	ND	mg/l	0.10	
Lead	6010		3/27/98	ND	mg/l	0.05	
Mercury	7470		3/30/98	ND	mg/l	.002	
Molybdenum	6010		4/07/98	ND	mg/l	1.00	
Nickel	6010		4/07/98	ND	mg/l	0.10	
Selenium GF	7740		4/01/98	ND	mg/l	0.05	
Silver	6010		4/07/98	ND	mg/l	0.05	
Thallium	6010		4/03/98	ND	mg/l	0.40	
Vanadium	6010		4/07/98	ND	mg/l	0.50	
Zinc	6010		4/07/98	ND	mg/l	0.10	

PQL - Practical Quantitation Limit ND - None Detected
* - Indicates Detection Limit altered due to Sample Dilution

NOTES:

Bruce L. Gove
Laboratory Director

Bruce L. Gove
Date Printed: 4/07/98



720 Olive Drive, Suite D
Davis, CA 95616

Lab: 916.297.4800
Fax: 916.297.4808

4/7

Project Manager:
Joel Kiff

Phone No.:

Chain-of-Custody Record and Analysis Request

Company/Address:

FAX No.:

Analysis Request

For Lab Use Only

Project Number:

PO. No.:

Project Name:
Beacon 720

Project Location:

Sampler Signature:

Sample Designation

Sampling		Container (Type/Amount)			Method Preserved				Matrix	
Date	Time	VOA	SLEEVE	1L GLASS	500 ml	HCl	HNO ₃	ICE	NONE	WATER/SOIL

BTEX (8020)	BTEX/TPH Gas/MTBE (8020/M8015)	TPH as Diesel (M8015)	TPH as Motor Oil (M8015)	EPA8010	EPA 8080 - Pesticides	EPA 8080 - PCBs	EPA 8240	EPA 8270	CAM - 17 Metals	WE.T. (X)
									Lead (7421/239.2)	
									Cd, Cr, Pb, Zn, Ni	
TOTAL (X)										

12 hr/24 hr/48 hr/72 hr/1 wk/2 wk

Effluent

<i>3/23/08</i>										

98-0325-19-1

X

Relinquished by:
Joel Kiff

Date: *3/24/08* Time: *1700*

Received by:

Remarks:

Relinquished by:

Date: *3/25/08* Time: *1310*

Received by:
Lisa Miller

Email address:
 .doc .xls .txt other

Relinquished by:

Date:

Received by Laboratory:

Bill to:

Richard Munsch
Delta Environmental Consultants, Inc.
3164 Gold Camp Drive, Suite 200
Rancho Cordova, CA 95670

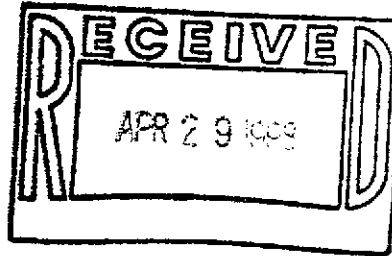

Subject : 1 Water Sample
Project Name : Beacon 720
Project Number : D095-97

Dear Mr. Munsch,

Chemical analysis of the samples referenced above has been completed. Summaries of the data are contained on the following pages. Sample(s) were received under documented chain-of-custody. US EPA protocols for sample storage and preservation were followed.

Kiff Analytical is certified by the State of California (# 2236). If you have any questions regarding procedures or results, please call me at 916-297-4800.

Sincerely,

Joel Kiff



Report Number : 11311

Date : 04/01/98

Project Name : **Beacon 720**

Project Number : **D095-97**

Sample : **EFFLUENT**

Matrix : Water

Sample Date :03/23/98

Parameter	Measured Value	Method Reporting Limit	Units	Analysis Method	Date Analyzed
Benzene	< 0.50	0.50	ug/L	EPA 8020	03/26/98
Toluene	< 0.50	0.50	ug/L	EPA 8020	03/26/98
Ethylbenzene	< 0.50	0.50	ug/L	EPA 8020	03/26/98
Total Xylenes	< 0.50	0.50	ug/L	EPA 8020	03/26/98
TPH as Gasoline	64	50	ug/L	M EPA 8015	03/26/98
aaa-Trifluorotoluene (8020 Surrogate)	104		% Recovery	EPA 8020	03/26/98
aaa-Trifluorotoluene (Gasoline Surrogate)	84.4		% Recovery	M EPA 8015	03/26/98
Dichlorodifluoromethane	< 0.50	0.50	ug/L	EPA 8260B	03/31/98
Chloromethane	< 0.50	0.50	ug/L	EPA 8260B	03/31/98
Vinyl Chloride	< 0.50	0.50	ug/L	EPA 8260B	03/31/98
Bromomethane	< 0.50	0.50	ug/L	EPA 8260B	03/31/98
Chloroethane	< 0.50	0.50	ug/L	EPA 8260B	03/31/98
Trichlorofluoromethane	< 0.50	0.50	ug/L	EPA 8260B	03/31/98
1,1-Dichloroethene	< 0.50	0.50	ug/L	EPA 8260B	03/31/98
Methylene Chloride	< 0.50	0.50	ug/L	EPA 8260B	03/31/98
trans-1,2-Dichloroethene	< 0.50	0.50	ug/L	EPA 8260B	03/31/98
1,1-Dichloroethane	< 0.50	0.50	ug/L	EPA 8260B	03/31/98
2,2-Dichloropropane	< 0.50	0.50	ug/L	EPA 8260B	03/31/98
cis-1,2-Dichloroethene	< 0.50	0.50	ug/L	EPA 8260B	03/31/98
Chloroform	10	0.50	ug/L	EPA 8260B	03/31/98
Bromochloromethane	< 0.50	0.50	ug/L	EPA 8260B	03/31/98
1,1,1-Trichloroethane	< 0.50	0.50	ug/L	EPA 8260B	03/31/98
1,1-Dichloropropene	< 0.50	0.50	ug/L	EPA 8260B	03/31/98
1,2-Dichloroethane	< 0.50	0.50	ug/L	EPA 8260B	03/31/98
Carbon Tetrachloride	< 0.50	0.50	ug/L	EPA 8260B	03/31/98
Benzene	< 0.50	0.50	ug/L	EPA 8260B	03/31/98
Trichloroethene	< 0.50	0.50	ug/L	EPA 8260B	03/31/98
1,2-Dichloropropane	< 0.50	0.50	ug/L	EPA 8260B	03/31/98
Bromodichloromethane	0.63	0.50	ug/L	EPA 8260B	03/31/98
Dibromomethane	< 0.50	0.50	ug/L	EPA 8260B	03/31/98
cis-1,3-Dichloropropene	< 0.50	0.50	ug/L	EPA 8260B	03/31/98
Toluene	< 0.50	0.50	ug/L	EPA 8260B	03/31/98

Approved By:  Joel Kiff

Project Name : **Beacon 720**Project Number : **D095-97**Sample : **EFFLUENT**Matrix : **Water**Sample Date : **03/23/98**

Parameter	Measured Value	Method Reporting Limit	Units	Analysis Method	Date Analyzed
trans-1,3-Dichloropropene	< 0.50	0.50	ug/L	EPA 8260B	03/31/98
1,1,2-Trichloroethane	< 0.50	0.50	ug/L	EPA 8260B	03/31/98
1,3-Dichloropropane	< 0.50	0.50	ug/L	EPA 8260B	03/31/98
Tetrachloroethene	< 0.50	0.50	ug/L	EPA 8260B	03/31/98
Dibromochloromethane	< 0.50	0.50	ug/L	EPA 8260B	03/31/98
1,2-Dibromoethane	< 0.50	0.50	ug/L	EPA 8260B	03/31/98
Chlorobenzene	< 0.50	0.50	ug/L	EPA 8260B	03/31/98
1,1,1,2-Tetrachloroethane	< 0.50	0.50	ug/L	EPA 8260B	03/31/98
Ethylbenzene	< 0.50	0.50	ug/L	EPA 8260B	03/31/98
P,M-Xylene	< 0.50	0.50	ug/L	EPA 8260B	03/31/98
O-Xylene	< 0.50	0.50	ug/L	EPA 8260B	03/31/98
Styrene	< 0.50	0.50	ug/L	EPA 8260B	03/31/98
Isopropyl benzene	< 0.50	0.50	ug/L	EPA 8260B	03/31/98
Bromoform	< 0.50	0.50	ug/L	EPA 8260B	03/31/98
1,1,2,2-Tetrachloroethane	< 0.50	0.50	ug/L	EPA 8260B	03/31/98
1,2,3-Trichloropropane	< 0.50	0.50	ug/L	EPA 8260B	03/31/98
n-Propylbenzene	< 0.50	0.50	ug/L	EPA 8260B	03/31/98
Bromobenzene	< 0.50	0.50	ug/L	EPA 8260B	03/31/98
1,3,5-Trimethylbenzene	< 0.50	0.50	ug/L	EPA 8260B	03/31/98
2-Chlorotoluene	< 0.50	0.50	ug/L	EPA 8260B	03/31/98
4-Chlorotoluene	< 0.50	0.50	ug/L	EPA 8260B	03/31/98
tert-Butylbenzene	< 0.50	0.50	ug/L	EPA 8260B	03/31/98
1,2,4-Trimethylbenzene	< 0.50	0.50	ug/L	EPA 8260B	03/31/98
sec-Butylbenzene	< 0.50	0.50	ug/L	EPA 8260B	03/31/98
p-Isopropyltoluene	< 0.50	0.50	ug/L	EPA 8260B	03/31/98
1,3-Dichlorobenzene	< 0.50	0.50	ug/L	EPA 8260B	03/31/98
1,4-Dichlorobenzene	< 0.50	0.50	ug/L	EPA 8260B	03/31/98
n-Butylbenzene	< 0.50	0.50	ug/L	EPA 8260B	03/31/98
1,2-Dichlorobenzene	< 0.50	0.50	ug/L	EPA 8260B	03/31/98
1,2-Dibromo-3-chloropropane	< 0.50	0.50	ug/L	EPA 8260B	03/31/98
1,2,4-Trichlorobenzene	< 0.50	0.50	ug/L	EPA 8260B	03/31/98
Hexachlorobutadiene	< 0.50	0.50	ug/L	EPA 8260B	03/31/98
Naphthalene	< 0.50	0.50	ug/L	EPA 8260B	03/31/98
1,2,3-Trichlorobenzene	< 0.50	0.50	ug/L	EPA 8260B	03/31/98

Approved By:  Joel Kiff



Report Number : 11311

Date : 04/01/98

Project Name : **Beacon 720**

Project Number : **D095-97**

Sample : **EFFLUENT**

Matrix : Water

Sample Date :03/23/98

Parameter	Measured Value	Method Reporting Limit	Units	Analysis Method	Date Analyzed
Dibromofluoromethane (Surr)	109		% Recovery	EPA 8260B	03/31/98
1,2-Dichloroethane-d4 (Surr)	99.6		% Recovery	EPA 8260B	03/31/98
Toluene - d8 (Surr)	98.7		% Recovery	EPA 8260B	03/31/98
4-Bromofluorobenzene (Surr)	104		% Recovery	EPA 8260B	03/31/98

Approved By: 
Joel Kiff



Ultramar Inc.
CHAIN OF CUSTODY REPORT

BEACON

11311

Beacon Station No. 720		Sampler (Print Name) Martin W. Morgan			ANALYSES					Date 3/23/98	Form No. 1 of 1														
Project No. D095-97		Sampler (Signature) 			<table border="1"> <tr> <td>BTEX</td> <td>TPH (gasoline)</td> <td>TPH (diesel)</td> <td>TIC/HC</td> <td>TID</td> <td>CAM 17</td> <td rowspan="2">No. of Containers 6</td> <td rowspan="2">REMARKS Standard TAT</td> </tr> <tr> <td>XX</td> <td>XX</td> <td>X</td> <td>XX</td> <td>XX</td> <td></td> </tr> </table>					BTEX	TPH (gasoline)	TPH (diesel)	TIC/HC	TID	CAM 17	No. of Containers 6	REMARKS Standard TAT	XX	XX	X	XX	XX		Kiff Analytical 916 297 4800	
BTEX	TPH (gasoline)	TPH (diesel)	TIC/HC	TID						CAM 17	No. of Containers 6	REMARKS Standard TAT													
XX	XX	X	XX	XX																					
Project Location San Leandro		Affiliation Delta Env. Cons.																							
Sample No./Identification		Date	Time	Lab No.																					
effluent		3/23/98	0730	-01																					
				02																					
Relinquished by: (Signature/Affiliation) / Delta		Date 3/23/98	Time 1045	Received by: (Signature/Affiliation) 					Date	Time															
Relinquished by: (Signature/Affiliation)		Date	Time	Received by: (Signature/Affiliation)					Date	Time															
Relinquished by: (Signature/Affiliation)		Date	Time	Received by: (Signature/Affiliation) / Kiff					Date 3-23-98	Time 1045															
Report To: Richard Munsch 916 638-2085 fax 8385				Bill to: ULTRAMAR INC. 525 West Third Street Hanford, CA 93230 Attention: Terry FOX																					

WHITE: Return to Client with Report

YELLOW: Laboratory Copy

PINK: Originator Copy

ENCLOSURE E

SVE System Analytical Reports

Todd Galati
Delta Environmental Consultants, Inc.
3164 Gold Camp Drive, Suite 200
Rancho Cordova, CA 95670

Subject : 3 Air Samples
Project Name : Beacon 720
Project Number : D095-971

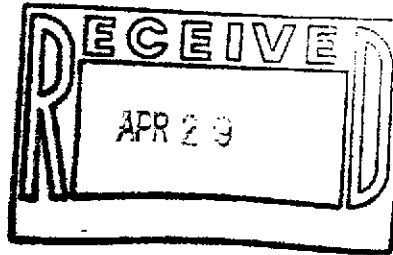

Dear Mr. Galati,

Chemical analysis of the samples referenced above has been completed. Summaries of the data are contained on the following pages. Sample(s) were received under documented chain-of-custody. US EPA protocols for sample storage and preservation were followed.

Kiff Analytical is certified by the State of California (# 2236). If you have any questions regarding procedures or results, please call me at 916-297-4800.

Sincerely,

Joel Kiff



Report Number : 11454

Date : 04/24/98

Project Name : **Beacon 720**

Project Number : **D095-971**

Sample : **INF AIR**

Matrix : Air

Sample Date :04/23/98

Parameter	Measured Value	Method Reporting Limit	Units	Analysis Method	Date Analyzed
Benzene	0.18	0.050	Molar ppm	EPA 8020	04/23/98
Toluene	0.32	0.050	Molar ppm	EPA 8020	04/23/98
Ethylbenzene	0.072	0.050	Molar ppm	EPA 8020	04/23/98
Total Xylenes	0.47	0.050	Molar ppm	EPA 8020	04/23/98
TPH as Gasoline	18	5.0	Molar ppm	M EPA 8015	04/23/98
aaa-Trifluorotoluene (8020 Surrogate)	93.1		% Recovery	EPA 8020	04/23/98
aaa-Trifluorotoluene (Gasoline Surrogate)	94.2		% Recovery	M EPA 8015	04/23/98

Sample : **MID AIR**

Matrix : Air

Sample Date :04/23/98

Parameter	Measured Value	Method Reporting Limit	Units	Analysis Method	Date Analyzed
Benzene	< 0.050	0.050	Molar ppm	EPA 8020	04/23/98
Toluene	< 0.050	0.050	Molar ppm	EPA 8020	04/23/98
Ethylbenzene	< 0.050	0.050	Molar ppm	EPA 8020	04/23/98
Total Xylenes	< 0.050	0.050	Molar ppm	EPA 8020	04/23/98
TPH as Gasoline	< 5.0	5.0	Molar ppm	M EPA 8015	04/23/98
aaa-Trifluorotoluene (8020 Surrogate)	102		% Recovery	EPA 8020	04/23/98
aaa-Trifluorotoluene (Gasoline Surrogate)	87.9		% Recovery	M EPA 8015	04/23/98

Approved By:  Joel Kiff



Report Number : 11454

Date : 04/24/98

Project Name : **Beacon 720**

Project Number : **D095-971**

Sample : **EFF AIR**

Matrix : Air

Sample Date :04/23/98

Parameter	Measured Value	Method Reporting Limit	Units	Analysis Method	Date Analyzed
Benzene	< 0.050	0.050	Molar ppm	EPA 8020	04/23/98
Toluene	< 0.050	0.050	Molar ppm	EPA 8020	04/23/98
Ethylbenzene	< 0.050	0.050	Molar ppm	EPA 8020	04/23/98
Total Xylenes	< 0.050	0.050	Molar ppm	EPA 8020	04/23/98
TPH as Gasoline	< 5.0	5.0	Molar ppm	M EPA 8015	04/23/98
aaa-Trifluorotoluene (8020 Surrogate)	102		% Recovery	EPA 8020	04/23/98
aaa-Trifluorotoluene (Gasoline Surrogate)	89.4		% Recovery	M EPA 8015	04/23/98

Approved By:  Joel Kiff



Ultramar Inc.
CHAIN OF CUSTODY REPORT

BEACON

11454

Beacon Station No. 720		Sampler (Print Name) Chris Hill			ANALYSES				Date 4-23-98	Form No. 1 of 1
Project No. D095-971		Sampler (Signature) <i>[Signature]</i>			BTEX	TPH (gasoline)	TPH (diesel)			No. of Containers
Project Location SAN Leandro		Affiliation <i>[Signature]</i>								
Sample No./Identification	Date	Time	Lab No.							REMARKS
INF Air	4-23-98	0728	-01	X						
MID Air	-	0724	-02	X						
LEFF Air	4-23-98	0722	-03	X						
										Want results expedited - Steve Meeks
										4-23-98 11:10 AM
										request cancelled by Steve Meeks 11:22 AM
Relinquished by: (Signature/Affiliation) <i>[Signature]</i>		Date 4-23-98	Time 0430	Received by: (Signature/Affiliation) <i>[Signature]</i>				Date	Time	
Relinquished by: (Signature/Affiliation)		Date	Time	Received by: (Signature/Affiliation)				Date	Time	
Relinquished by: (Signature/Affiliation)		Date	Time	Received by: (Signature/Affiliation) Richard Brown - Kitt				Date 4/23/98	Time 0930	
Report To: Todd Conarty De Ha				Bill to: ULTRAMAR INC. 525 West Third Street Hanford, CA 93230 Attention: Tony Fox						

WHITE: Return to Client with Report

YELLOW: Laboratory Copy

PINK: Originator Copy

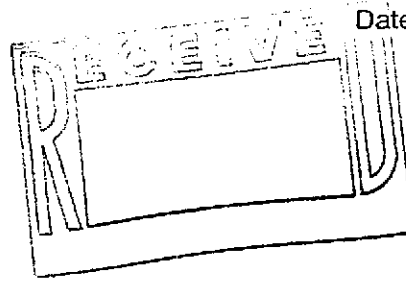

Richard Munsch
Delta Environmental Consultants, Inc.
3164 Gold Camp Drive, Suite 200
Rancho Cordova, CA 95670

Subject : 3 Air Samples
Project Name : Beacon 720
Project Number : D095-971

Dear Mr. Munsch,

Chemical analysis of the samples referenced above has been completed. Summaries of the data are contained on the following pages. Sample(s) were received under documented chain-of-custody. US EPA protocols for sample storage and preservation were followed.

Kiff Analytical is certified by the State of California (# 2236). If you have any questions regarding procedures or results, please call me at 530-297-4800.

Sincerely,

Joel Kiff



Report Number : 11724

Date : 06/16/98

Project Name : **Beacon 720**

Project Number : **D095-971**

Sample : **EFFLUENT AIR**

Matrix : Air

Sample Date :06/09/98

Parameter	Measured Value	Method Reporting Limit	Units	Analysis Method	Date Analyzed
Benzene	< 0.050	0.050	Molar ppm	EPA 8020	06/11/98
Toluene	< 0.050	0.050	Molar ppm	EPA 8020	06/11/98
Ethylbenzene	< 0.050	0.050	Molar ppm	EPA 8020	06/11/98
Total Xylenes	< 0.050	0.050	Molar ppm	EPA 8020	06/11/98
TPH as Gasoline	< 5.0	5.0	Molar ppm	M EPA 8015	06/11/98
aaa-Trifluorotoluene (8020 Surrogate)	101		% Recovery	EPA 8020	06/11/98
aaa-Trifluorotoluene (Gasoline Surrogate)	92.3		% Recovery	M EPA 8015	06/11/98

Sample : **MID AIR**

Matrix : Air

Sample Date :06/09/98

Parameter	Measured Value	Method Reporting Limit	Units	Analysis Method	Date Analyzed
Benzene	< 0.050	0.050	Molar ppm	EPA 8020	06/11/98
Toluene	< 0.050	0.050	Molar ppm	EPA 8020	06/11/98
Ethylbenzene	< 0.050	0.050	Molar ppm	EPA 8020	06/11/98
Total Xylenes	< 0.050	0.050	Molar ppm	EPA 8020	06/11/98
TPH as Gasoline	< 5.0	5.0	Molar ppm	M EPA 8015	06/11/98
aaa-Trifluorotoluene (8020 Surrogate)	99.8		% Recovery	EPA 8020	06/11/98
aaa-Trifluorotoluene (Gasoline Surrogate)	90.2		% Recovery	M EPA 8015	06/11/98

Approved By:  Joel Kiff



Report Number : 11724

Date : 06/16/98

Project Name : **Beacon 720**

Project Number : **D095-971**

Sample : **INFLUENT AIR**

Matrix : Air

Sample Date :06/09/98

Parameter	Measured Value	Method Reporting Limit	Units	Analysis Method	Date Analyzed
Benzene	< 0.050	0.050	Molar ppm	EPA 8020	06/11/98
Toluene	< 0.050	0.050	Molar ppm	EPA 8020	06/11/98
Ethylbenzene	< 0.050	0.050	Molar ppm	EPA 8020	06/11/98
Total Xylenes	< 0.050	0.050	Molar ppm	EPA 8020	06/11/98
TPH as Gasoline	< 5.0	5.0	Molar ppm	M EPA 8015	06/11/98
aaa-Trifluorotoluene (8020 Surrogate)	101		% Recovery	EPA 8020	06/11/98
aaa-Trifluorotoluene (Gasoline Surrogate)	90.6		% Recovery	M EPA 8015	06/11/98

Approved By:  Joel Kiff



Ultramar Inc.
CHAIN OF CUSTODY REPORT

BEACON

11724

Beacon Station No. 720		Sampler (Print Name) Martin Morgan			ANALYSES							Date 6/9/98	Form No. 1 of 1
Project No. D095-971		Sampler (Signature) <i>[Signature]</i>			BTEX	TPH (gasoline)	TPH (diesel)					No. of Containers	Kiff Analytical 530 277 4800
Project Location San Leandro, CA		Affiliation Delta											
Sample No./Identification		Date	Time	Lab No.									
effluent Air		6/9/98	0930	-01	X	X						1	
Mid Air		6/9/98	0932	-02	X	X						1	
influent Air		6/9/98	0934	-03	X	X						1	
Relinquished by: (Signature/Affiliation)		Date	Time	Received by: (Signature/Affiliation)							Date	Time	
<i>[Signature]</i> / Delta		6/9/98	1425	<i>[Signature]</i>									
Relinquished by: (Signature/Affiliation)		Date	Time	Received by: (Signature/Affiliation)							Date	Time	
<i>[Signature]</i>				<i>[Signature]</i>									
Relinquished by: (Signature/Affiliation)		Date	Time	Received by: (Signature/Affiliation)							Date	Time	
<i>[Signature]</i>				<i>[Signature]</i> / Kiff							6-9-98	1425	
Report To: Richard Munsch				Bill to: ULTRAMAR INC. 525 West Third Street Hanford, CA 93230 Attention: Terry Fox									
916 638 2164													

WHITE: Return to Client with Report

YELLOW: Laboratory Copy

PINK: Originator Copy