



Brian Waite
Project Manager
Marketing Business Unit

**Chevron Environmental
Management Company**
6101 Bollinger Canyon Road
San Ramon, CA 94583
Tel (925) 790-6486
BWaite@Chevron.com

May 29, 2015



Alameda County Environmental Health
1131 Harbor Bay Parkway, Suite 250
Alameda, CA 94502-6577

Re: Chevron Facility # 95542

Address: 7007 San Ramon Road, Dublin, CA

I have reviewed the attached report titled Well Destruction Report dated May 29, 2015.

I agree with the conclusions and recommendations presented in the referenced report. The information in this report is accurate to the best of my knowledge and all local Agency/Regional Board guidelines have been followed. This report was prepared by Conestoga-Rovers & Associates, upon whose assistance and advice I have relied.

This letter is submitted pursuant to the requirements of California Water Code Section 13267(b)(1) and the regulating implementation entitled Appendix A pertaining thereto.

I declare under penalty of perjury that the foregoing is true and correct.

Sincerely,

Brian A. Waite

Digitally signed by Brian A. Waite
DN: cn=Brian A. Waite, o=Chevron Environmental Management
Company, ou, email=bwaite@chevron.com, c=US
Date: 2015.05.29 14:02:55 -07'00'

Brian Waite
Project Manager

Enclosure: Report



**CONESTOGA-ROVERS
& ASSOCIATES**

10969 Trade Center Drive, Suite 107
Rancho Cordova, California 95670
Telephone: (916) 889-8900 Fax: (916) 889-8999
www.CRAworld.com

May 29, 2015

Reference No. 611969D

Mr. Matthew Soby
Alameda County Environmental Health Services (ACEH)
1131 Harbor Bay Parkway
Alameda, California 94502

Re: Well Destruction Report
Chevron Service Station 95542
7007 San Ramon Road
Dublin, California
ACEH Case RO0000206

Dear Mr. Soby:

Conestoga-Rovers & Associates (CRA) is submitting this *Well Destruction Report* for the site referenced above (Figure 1) on behalf of Chevron Environmental Management Company (Chevron). In letters dated October 15, 2014 and March 23, 2015, Alameda County Environmental Health (ACEH) approved the destruction of all active and inactive site wells and Chevron's request for an extension of the well destruction activities and subsequent submittal of a well destruction report (Attachment A). The locations of the former wells are shown on Figure 2.

On April 29 and 30, 2015, CRA staff observed Gregg Drilling and Testing (C-57 License 485165) destroy monitoring wells MW-1 through MW-4, MW-11, and vadose monitoring wells VW-1 and VW-2 by pressure grouting. The wells were filled with Portland I/II cement and 25 pounds per square inch (PSI) of pressure was applied to the top of each well casing for approximately five minutes. The well casing was hand cut to approximately 1 foot below grade. Soil vapor probes VP-1 through VP-3 were destroyed by pulling the 1/4 -inch tubing out of the well and filling the resulting cavity with Portland I/II cement. With the exception of well MW-1, all well boxes were removed. The well box for well MW-1 was left in place due to its close proximity to an underground utility. Wells MW-2 through MW-4 were finished to grade with soil. Well MW-11 was finished to grade with hot asphalt. The remaining wells were finished to grade with concrete.

Monitoring well MW-5 was located offsite, along the southern side of Dublin Boulevard (Figure 2). The well was paved over in 1995. In March 2009, CRA attempted to locate the well. No survey data was available so a metal detector was used to try to locate the well. Two metallic anomalies were identified. The asphalt was removed above the anomalies in order to search for the well. Neither anomaly was the missing well. No additional anomalies were identified. Well MW-5 could not be located and is considered abandoned.

Equal
Employment Opportunity
Employer



**CONESTOGA-ROVERS
& ASSOCIATES**

May 29, 2015

2

Reference No. 611969D

Well completion reports (Department of Water Resources [DWR] form 188) for the destruction of site wells were submitted to the Zone 7 Water Agency on May 15, 2015, as stated in the well destruction permit. A copy of Zone 7 Water Agency well destruction permit 2015044, and City of Dublin encroachment permit number PWEN-2015-00038 are included as Attachment B.

One drum of waste (construction debris) was generated during well destruction activities. The waste was removed on May 26, 2015 and is currently in transit to the Altamont Landfill and Resource Recovery Facility in Livermore, California for disposal. The Generator's/Shipper's Initial Copy of the manifest is included as Attachment C. CRA will notify ACEH when the waste has been received by the disposal facility.



**CONESTOGA-ROVERS
& ASSOCIATES**

May 29, 2015

3

Reference No. 611969D

We appreciate your assistance with this project. Please contact Morgan Hargrave at (530) 553-4136 if you have any questions or need any additional information.

Sincerely,

CONESTOGA-ROVERS & ASSOCIATES

Morgan Hargrave

Greg Barclay, PG 6260

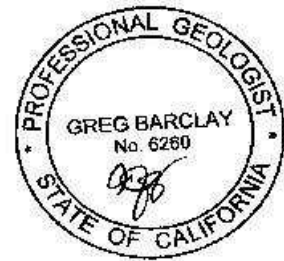

BRS/de/14

Figure 1 Vicinity Map
Figure 2 Site Plan

Attachment A ACEH Correspondence
Attachment B Permits
Attachment C Waste Manifest

cc: Mr. Brian Waite, Chevron (electronic copy)
Mr. Tim Johnson, property owner

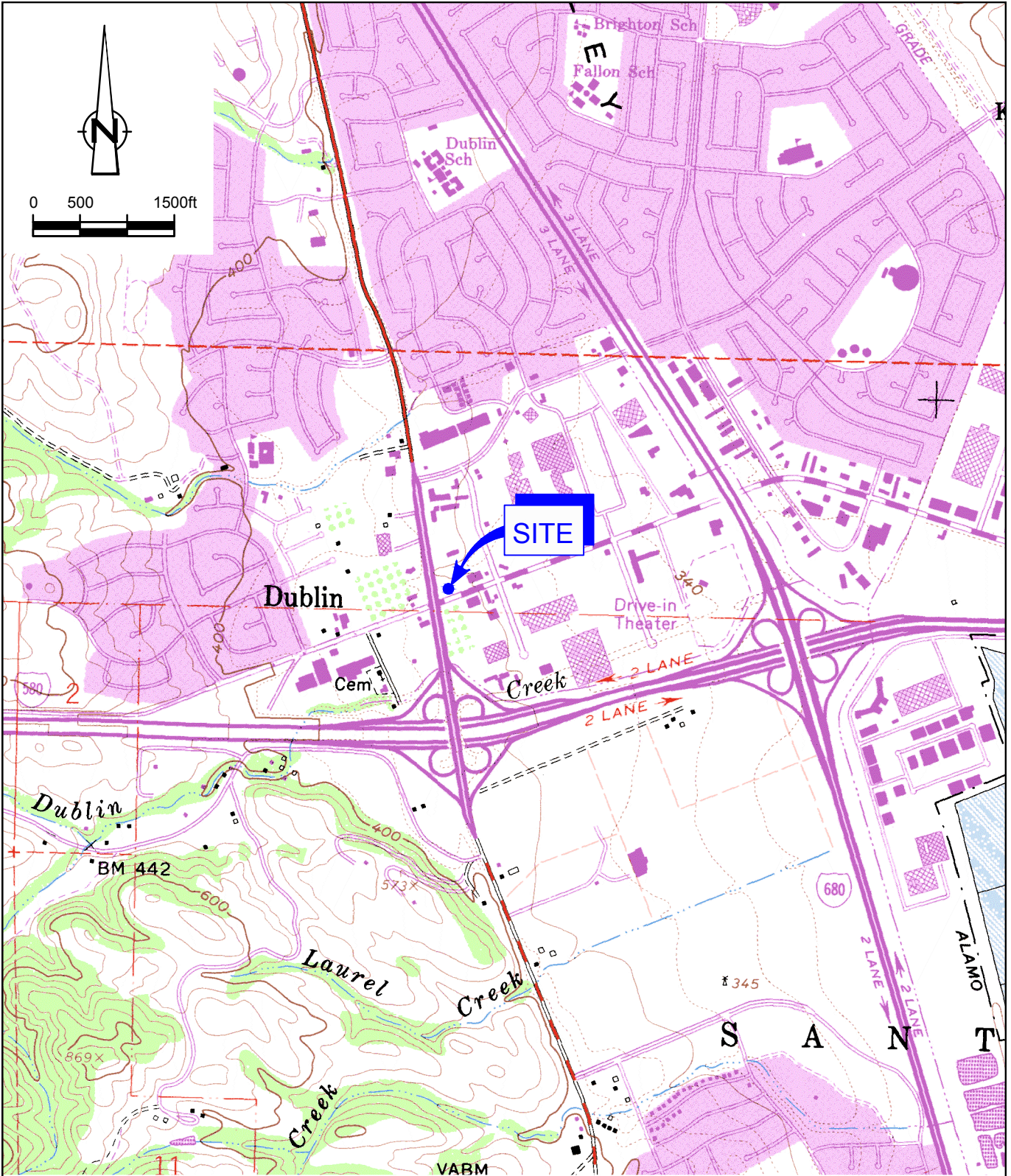

figure 1
 VICINITY MAP
 CHEVRON SERVICE STATION 95542
 7007 SAN RAMON ROAD
 Dublin, California



SOURCE: TOPO! MAPS

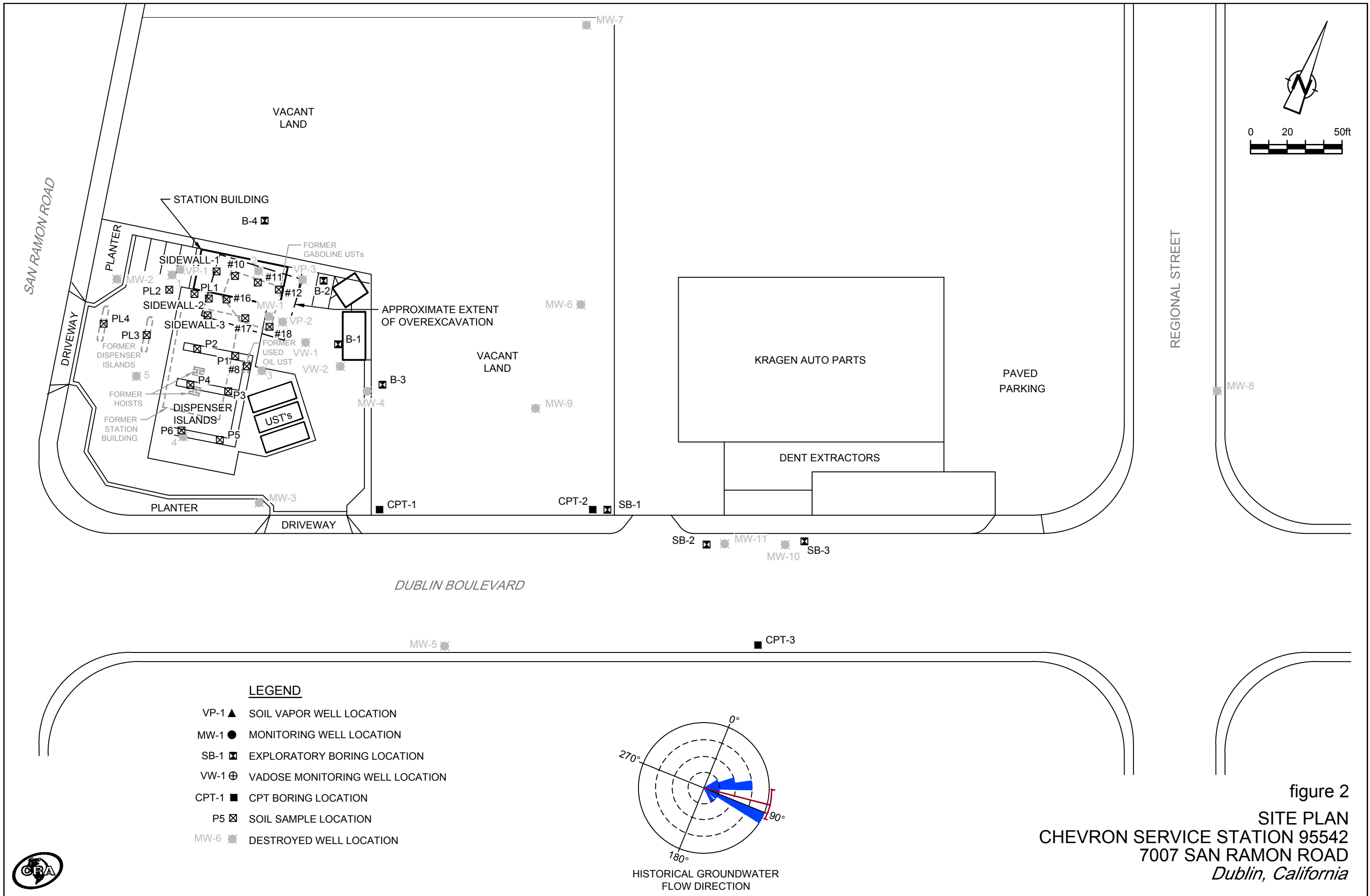

figure 2
SITE PLAN
CHEVRON SERVICE STATION 9542
7007 SAN RAMON ROAD
Dublin, California



Attachment A

ACEH Correspondence



ENVIRONMENTAL HEALTH SERVICES
ENVIRONMENTAL PROTECTION
1131 Harbor Bay Parkway, Suite 250
Alameda, CA 94502-6577
(510) 567-6700
FAX (510) 337-9335

October 15, 2014

T. W. Johnson
7007 San Ramon Road
Dublin, CA 94568-3239

Chevron Environmental Management Company
Attn: Brian A. Waite
6101 Bollinger Canyon Road
San Ramon, CA 94583
(sent via e-mail to: BWaite@chevron.com)

Subject: Monitoring Well Decommissioning for Fuel Leak Case No. RO0000206 and GeoTracker
Global ID T0600100354, Chevron #9-5542, 7007 San Ramon Road, Dublin, CA 94568

Dear Responsible Parties:

Alameda County Environmental Health (ACEH) staff have reviewed the fuel leak case file and case closure summary for the above-referenced site and concur that no further action related to the underground storage tank fuel release is required at this time. Prior to issuance of a remedial action completion certificate, the monitoring wells (MWs) and vadose monitoring wells (VWs) at the site must be properly destroyed, per California Water Code.

ACEH requests that you address the following technical comments, perform the proposed work, and send us the technical report requested below. Upon receipt of the requested documents a remedial action completion certificate will be sent to the responsible parties.

TECHNICAL COMMENTS

1. **Monitoring Well Destruction** – ACEH is requesting that you contact Zone 7 Water Agency (<http://www.zone7water.com/permits-a-fees/64-well-drilling-and-destruction-permits>) or (925-454-5056), obtain the necessary permits, decommission the well, and electronically upload the well destruction report to ACEH's ftp server (<http://www.acgov.org/aceh/lop/lop.htm>) and the State Water Resources Control Board's GeoTracker website (<https://geotracker.waterboards.ca.gov/>) within ninety (90) days from the date of this letter (January 15, 2015). Electronic reporting is described in detail below.
 - a. Wells to be destroyed include all active and inactive wells. Existing monitoring wells MW-1, MW-2, MW-3, MW-4, and MW-11 appear active as of the latest groundwater monitoring report. Potentially inactive wells present a vertical migration conduit and should be properly destroyed: monitoring well MW-5 and vadose monitoring wells VW-1 and VW-2.

Upon our receipt of the completed report of well decommissioning, (which includes confirmation of investigation derived waste disposal) this office will issue you the remedial action completion certificate.

NOTIFICATION OF FIELDWORK ACTIVITIES

Please schedule and complete the fieldwork activities by the date specified below and provide ACEH with at least three (3) business days notification prior to conducting the fieldwork.

TECHNICAL REPORT REQUEST

Please submit technical reports to ACEH (Attention: Matthew Soby), according to the following schedule:

- **January 15, 2015** – Well Decommissioning Report

Thank you for your cooperation. Should you have any questions or concerns regarding this correspondence or your case, please call me at (510) 567-6725 or send me an electronic mail message at matthew.soby@acgov.org.

Sincerely,

Matthew Soby
Hazardous Materials Technician

Enclosures: Responsible Party(ies) Legal Requirements/Obligations
ACEH Electronic Report Upload (ftp) Instructions

cc:

Leroy Griffin, Oakland Fire Department, 250 Frank H. Ogawa Plaza, Ste. 3341, Oakland, CA 94612-2032
(Sent via E-mail to: lgriffin@oaklandnet.com)

Morgan Hargrave, Conestoga-Rovers & Associates, 10969 Trade Center Drive, Suite 107, Rancho Cordova, CA 95670 (Sent via e-mail to: mhargrave@CRAworld.com)

Dilan Roe, ACEH (Sent via E-mail to: dilan.roe@acgov.org)

Matthew Soby, ACEH (Sent via E-mail to: matthew.soby@acgov.org)

GeoTracker, e-File

Attachment 1

Responsible Party(ies) Legal Requirements / Obligations

REPORT REQUESTS

These reports are being requested pursuant to California Health and Safety Code Section 25296.10. 23 CCR Sections 2652 through 2654, and 2721 through 2728 outline the responsibilities of a responsible party in response to an unauthorized release from a petroleum UST system, and require your compliance with this request.

ELECTRONIC SUBMITTAL OF REPORTS

ACEH's Environmental Cleanup Oversight Programs (LOP and SLIC) require submission of reports in electronic form. The electronic copy replaces paper copies and is expected to be used for all public information requests, regulatory review, and compliance/enforcement activities. Instructions for submission of electronic documents to the Alameda County Environmental Cleanup Oversight Program FTP site are provided on the attached "Electronic Report Upload Instructions." Submission of reports to the Alameda County FTP site is an addition to existing requirements for electronic submittal of information to the State Water Resources Control Board (SWRCB) GeoTracker website. In September 2004, the SWRCB adopted regulations that require electronic submittal of information for all groundwater cleanup programs. For several years, responsible parties for cleanup of leaks from underground storage tanks (USTs) have been required to submit groundwater analytical data, surveyed locations of monitoring wells, and other data to the GeoTracker database over the Internet. Beginning July 1, 2005, these same reporting requirements were added to Spills, Leaks, Investigations, and Cleanup (SLIC) sites. Beginning July 1, 2005, electronic submittal of a complete copy of all reports for all sites is required in GeoTracker (in PDF format). Please visit the SWRCB website for more information on these requirements (http://www.waterboards.ca.gov/water_issues/programs/ust/electronic_submittal/).

PERJURY STATEMENT

All work plans, technical reports, or technical documents submitted to ACEH must be accompanied by a cover letter from the responsible party that states, at a minimum, the following: "I declare, under penalty of perjury, that the information and/or recommendations contained in the attached document or report is true and correct to the best of my knowledge." This letter must be signed by an officer or legally authorized representative of your company. Please include a cover letter satisfying these requirements with all future reports and technical documents submitted for this fuel leak case.

PROFESSIONAL CERTIFICATION & CONCLUSIONS/RECOMMENDATIONS

The California Business and Professions Code (Sections 6735, 6835, and 7835.1) requires that work plans and technical or implementation reports containing geologic or engineering evaluations and/or judgments be performed under the direction of an appropriately registered or certified professional. For your submittal to be considered a valid technical report, you are to present site specific data, data interpretations, and recommendations prepared by an appropriately licensed professional and include the professional registration stamp, signature, and statement of professional certification. Please ensure all that all technical reports submitted for this fuel leak case meet this requirement.

UNDERGROUND STORAGE TANK CLEANUP FUND

Please note that delays in investigation, later reports, or enforcement actions may result in your becoming ineligible to receive grant money from the state's Underground Storage Tank Cleanup Fund (Senate Bill 2004) to reimburse you for the cost of cleanup.

AGENCY OVERSIGHT

If it appears as though significant delays are occurring or reports are not submitted as requested, we will consider referring your case to the Regional Board or other appropriate agency, including the County District Attorney, for possible enforcement actions. California Health and Safety Code, Section 25299.76 authorizes enforcement including administrative action or monetary penalties of up to \$10,000 per day for each day of violation.

Alameda County Environmental Cleanup Oversight Programs (LOP and SLIC)	REVISION DATE: May 15, 2014
	ISSUE DATE: July 5, 2005
	PREVIOUS REVISIONS: October 31, 2005; December 16, 2005; March 27, 2009; July 8, 2010, July 25, 2010
SECTION: Miscellaneous Administrative Topics & Procedures	SUBJECT: Electronic Report Upload (ftp) Instructions

The Alameda County Environmental Cleanup Oversight Programs (LOP and SLIC) require submission of all reports in electronic form to the county's ftp site. Paper copies of reports will no longer be accepted. The electronic copy replaces the paper copy and will be used for all public information requests, regulatory review, and compliance/enforcement activities.

REQUIREMENTS

- **Please do not submit reports as attachments to electronic mail.**
- Entire report including cover letter must be submitted to the ftp site as **a single portable document format (PDF) with no password protection.**
- It is **preferable** that reports be converted to PDF format from their original format, (e.g., Microsoft Word) rather than scanned.
- **Signature pages and perjury statements must be included and have either original or electronic signature.**
- **Do not password protect the document.** Once indexed and inserted into the correct electronic case file, the document will be secured in compliance with the County's current security standards and a password. **Documents with password protection will not be accepted.**
- Each page in the PDF document should be rotated in the direction that will make it easiest to read on a computer monitor.
- Reports must be named and saved using the following naming convention:

RO#_Report Name_Year-Month-Date (e.g., RO#5555_WorkPlan_2005-06-14)

Submission Instructions

- 1) Obtain User Name and Password
 - a) Contact the Alameda County Environmental Health Department to obtain a User Name and Password to upload files to the ftp site.
 - i) Send an e-mail to deh.loptoxic@acgov.org
 - b) In the subject line of your request, be sure to include "**ftp PASSWORD REQUEST**" and in the body of your request, include the **Contact Information, Site Addresses**, and the **Case Numbers (RO# available in Geotracker) you will be posting for.**
- 2) Upload Files to the ftp Site
 - a) Using Internet Explorer (IE4+), go to <ftp://alcoftp1.acgov.org>
 - (i) Note: Netscape, Safari, and Firefox browsers will not open the FTP site as they are NOT being supported at this time.
 - b) Click on Page located on the Command bar on upper right side of window, and then scroll down to Open FTP Site in Windows Explorer.
 - c) Enter your User Name and Password. (Note: Both are Case Sensitive.)
 - d) Open "My Computer" on your computer and navigate to the file(s) you wish to upload to the ftp site.
 - e) With both "My Computer" and the ftp site open in separate windows, drag and drop the file(s) from "My Computer" to the ftp window.
- 3) Send E-mail Notifications to the Environmental Cleanup Oversight Programs
 - a) Send email to deh.loptoxic@acgov.org notify us that you have placed a report on our ftp site.
 - b) Copy your Caseworker on the e-mail. Your Caseworker's e-mail address is the entire first name then a period and entire last name @acgov.org. (e.g., firstname.lastname@acgov.org)
 - c) The subject line of the e-mail must start with the RO# followed by **Report Upload**. (e.g., Subject: RO1234 Report Upload) If site is a new case without an RO#, use the street address instead.
 - d) If your document meets the above requirements and you follow the submission instructions, you will receive a notification by email indicating that your document was successfully uploaded to the ftp site.



ENVIRONMENTAL HEALTH SERVICES
ENVIRONMENTAL PROTECTION
1131 Harbor Bay Parkway, Suite 250
Alameda, CA 94502-6577
(510) 567-6700
FAX (510) 337-9335

March 23, 2015

T. W. Johnson
7007 San Ramon Road
Dublin, CA 94568-3239

Chevron Environmental Management Company
Attn: Brian A. Waite
6101 Bollinger Canyon Road
San Ramon, CA 94583
(sent via e-mail to: BWaite@chevron.com)

Subject: Approval of Time Extension for Monitoring Well Destruction and Waste Removal Report for Fuel Leak Case No. RO0000206 and GeoTracker Global ID T0600100354, Chevron #9-5542, 7007 San Ramon Road, Dublin, CA 94568

Dear Responsible Parties:

Alameda County Environmental Health (ACEH) approves Chevron Environmental Management Company (Chevron) March 23, 2015 e-mail request for a time extension for monitoring well destructions and submittal of the technical report required in ACEH's October 15, 2014 directive letter and December 16, 2014 extension approval letter.

ACEH's directive letter dated October 15, 2014 required that the Responsible Parties submit a report documenting that all active and inactive groundwater and vadose zone monitoring wells be destroyed. Additionally, the directive required documentation that investigation derived waste (IDW) (all piles, drums, and other IDW) was removed from the site and properly disposed. This technical report was due to our office on January 15, 2015. The October 15, 2014 extension request granted approval of said technical report until March 16, 2015. These actions are required prior to closure under the Low-Threat Underground Storage Tank Closure Policy (LTCP).

Chevron requested a second time extension based on delays:

- Due to staffing/project load issues;
- Chevron safety stand-down during December; and
- Evaluation of the use of blast perforation to plug and abandon wells at active service station sites.

ACEH understands that Chevron is working to gain approval of blast perforation technology with well permitting agencies in Alameda County. However, as previously discussed in conversation with you and Dilan Roe, ACEH's LOP Program Manager, blast perforation technology has not been approved in Alameda County, and therefore, Chevron is required to destroy wells using approved conventional technologies for well destruction.

Upon ACEH's receipt of the completed report of well decommissioning, (which includes confirmation of investigation derived waste disposal) ACEH will issue Chevron a remedial action completion certificate per Section 25296.10 of the Health and Safety Code.

Please note, failure to meet the May 29, 2015 compliance date, identified below, will result in the issuance of a Notice to Comply letter to Chevron for monitoring well destruction.

TECHNICAL REPORT REQUEST

ACEH hereby approves your request for a time extension.

Please submit technical reports to ACEH (Attention: Matthew Soby), according to the following schedule:

- **May 29, 2015** – Well Decommissioning Report
 - File to be named: RO206_WELL_DCM_yyy-mm-dd

Thank you for your cooperation. Should you have any questions or concerns regarding this correspondence or your case, please call me at (510) 567-6725 or send me an electronic mail message at matthew.soby@acgov.org.

Sincerely,

Matthew Soby
Hazardous Materials Technician

Enclosures: Responsible Party(ies) Legal Requirements/Obligations
ACEH Electronic Report Upload (ftp) Instructions

cc:

Morgan Hargrave, Conestoga-Rovers & Associates, 10969 Trade Center Drive, Suite 107, Rancho Cordova, CA 95670 (Sent via e-mail to: mhargrave@CRAworld.com)

Dilan Roe, ACEH (Sent via E-mail to: dilan.roe@acgov.org)

Matthew Soby, ACEH (Sent via E-mail to: matthew.soby@acgov.org)

GeoTracker, e-File

Attachment 1

Responsible Party(ies) Legal Requirements / Obligations

REPORT REQUESTS

These reports are being requested pursuant to California Health and Safety Code Section 25296.10. 23 CCR Sections 2652 through 2654, and 2721 through 2728 outline the responsibilities of a responsible party in response to an unauthorized release from a petroleum UST system, and require your compliance with this request.

ELECTRONIC SUBMITTAL OF REPORTS

ACEH's Environmental Cleanup Oversight Programs (LOP and SLIC) require submission of reports in electronic form. The electronic copy replaces paper copies and is expected to be used for all public information requests, regulatory review, and compliance/enforcement activities. Instructions for submission of electronic documents to the Alameda County Environmental Cleanup Oversight Program FTP site are provided on the attached "Electronic Report Upload Instructions." Submission of reports to the Alameda County FTP site is an addition to existing requirements for electronic submittal of information to the State Water Resources Control Board (SWRCB) GeoTracker website. In September 2004, the SWRCB adopted regulations that require electronic submittal of information for all groundwater cleanup programs. For several years, responsible parties for cleanup of leaks from underground storage tanks (USTs) have been required to submit groundwater analytical data, surveyed locations of monitoring wells, and [other](#) data to the GeoTracker database over the Internet. Beginning July 1, 2005, these same reporting requirements were added to Spills, Leaks, Investigations, and Cleanup (SLIC) sites. Beginning July 1, 2005, electronic submittal of a complete copy of all reports for all sites is required in GeoTracker (in PDF format). Please visit the SWRCB website for more information on these requirements (http://www.waterboards.ca.gov/water_issues/programs/ust/electronic_submittal/).

PERJURY STATEMENT

All work plans, technical reports, or technical documents submitted to ACEH must be accompanied by a cover letter from the responsible party that states, at a minimum, the following: "I declare, under penalty of perjury, that the information and/or recommendations contained in the attached document or report is true and correct to the best of my knowledge." This letter must be signed by an officer or legally authorized representative of your company. Please include a cover letter satisfying these requirements with all future reports and technical documents submitted for this fuel leak case.

PROFESSIONAL CERTIFICATION & CONCLUSIONS/RECOMMENDATIONS

The California Business and Professions Code (Sections 6735, 6835, and 7835.1) requires that work plans and technical or implementation reports containing geologic or engineering evaluations and/or judgments be performed under the direction of an appropriately registered or certified professional. For your submittal to be considered a valid technical report, you are to present site specific data, data interpretations, and recommendations prepared by an appropriately licensed professional and include the professional registration stamp, signature, and statement of professional certification. Please ensure all that all technical reports submitted for this fuel leak case meet this requirement.

UNDERGROUND STORAGE TANK CLEANUP FUND

Please note that delays in investigation, later reports, or enforcement actions may result in your becoming ineligible to receive grant money from the state's Underground Storage Tank Cleanup Fund (Senate Bill 2004) to reimburse you for the cost of cleanup.

AGENCY OVERSIGHT

If it appears as though significant delays are occurring or reports are not submitted as requested, we will consider referring your case to the Regional Board or other appropriate agency, including the County District Attorney, for possible enforcement actions. California Health and Safety Code, Section 25299.76 authorizes enforcement including administrative action or monetary penalties of up to \$10,000 per day for each day of violation.

Alameda County Environmental Cleanup Oversight Programs (LOP and SLIC)	REVISION DATE: May 15, 2014
	ISSUE DATE: July 5, 2005
	PREVIOUS REVISIONS: October 31, 2005; December 16, 2005; March 27, 2009; July 8, 2010, July 25, 2010
SECTION: Miscellaneous Administrative Topics & Procedures	SUBJECT: Electronic Report Upload (ftp) Instructions

The Alameda County Environmental Cleanup Oversight Programs (LOP and SLIC) require submission of all reports in electronic form to the county's ftp site. Paper copies of reports will no longer be accepted. The electronic copy replaces the paper copy and will be used for all public information requests, regulatory review, and compliance/enforcement activities.

REQUIREMENTS

- **Please do not submit reports as attachments to electronic mail.**
- Entire report including cover letter must be submitted to the ftp site as **a single portable document format (PDF) with no password protection.**
- It is **preferable** that reports be converted to PDF format from their original format, (e.g., Microsoft Word) rather than scanned.
- **Signature pages and perjury statements must be included and have either original or electronic signature.**
- **Do not password protect the document.** Once indexed and inserted into the correct electronic case file, the document will be secured in compliance with the County's current security standards and a password. **Documents with password protection will not be accepted.**
- Each page in the PDF document should be rotated in the direction that will make it easiest to read on a computer monitor.
- Reports must be named and saved using the following naming convention:

RO#_Report Name_Year-Month-Date (e.g., RO#5555_WorkPlan_2005-06-14)

Submission Instructions

- 1) Obtain User Name and Password
 - a) Contact the Alameda County Environmental Health Department to obtain a User Name and Password to upload files to the ftp site.
 - i) Send an e-mail to deh.loptoxic@acgov.org
 - b) In the subject line of your request, be sure to include "**ftp PASSWORD REQUEST**" and in the body of your request, include the **Contact Information, Site Addresses**, and the **Case Numbers (RO# available in Geotracker) you will be posting for.**
- 2) Upload Files to the ftp Site
 - a) Using Internet Explorer (IE4+), go to <ftp://alcoftp1.acgov.org>
 - (i) Note: Netscape, Safari, and Firefox browsers will not open the FTP site as they are NOT being supported at this time.
 - b) Click on Page located on the Command bar on upper right side of window, and then scroll down to Open FTP Site in Windows Explorer.
 - c) Enter your User Name and Password. (Note: Both are Case Sensitive.)
 - d) Open "My Computer" on your computer and navigate to the file(s) you wish to upload to the ftp site.
 - e) With both "My Computer" and the ftp site open in separate windows, drag and drop the file(s) from "My Computer" to the ftp window.
- 3) Send E-mail Notifications to the Environmental Cleanup Oversight Programs
 - a) Send email to deh.loptoxic@acgov.org notify us that you have placed a report on our ftp site.
 - b) Copy your Caseworker on the e-mail. Your Caseworker's e-mail address is the entire first name then a period and entire last name @acgov.org. (e.g., firstname.lastname@acgov.org)
 - c) The subject line of the e-mail must start with the RO# followed by **Report Upload**. (e.g., Subject: RO1234 Report Upload) If site is a new case without an RO#, use the street address instead.
 - d) If your document meets the above requirements and you follow the submission instructions, you will receive a notification by email indicating that your document was successfully uploaded to the ftp site.

Attachment B

Permits



ZONE 7 WATER AGENCY

100 NORTH CANYONS PARKWAY, LIVERMORE, CALIFORNIA 94551 VOICE (925) 454-5000 FAX (925) 245-9306
E-MAIL whong@zone7water.com

DRILLING PERMIT APPLICATION

FOR APPLICANT TO COMPLETE

FOR OFFICE USE

LOCATION OF PROJECT 2007 San Ramon Rd.
Dublin, CA 94568

PERMIT NUMBER 2015044
WELL NUMBER see attached
APN 941-0305-007-02

Coordinates Source _____ ft. Accuracy _____ ft.
LAT: _____ ft. LONG: _____ ft.
APN 941-0305-007-02

PERMIT CONDITIONS
(Circled Permit Requirements Apply)

CLIENT
Name Cherxon Environmental Management Company
Address _____ Phone _____
City _____ Zip _____

- A. GENERAL
 1. A permit application should be submitted so as to arrive at the Zone 7 office five days prior to your proposed starting date.
 2. Submit to Zone 7 within 60 days after completion of permitted work the original Department of Water Resources Water Well Drillers Report (DWR Form 188), signed by the driller.
 3. Permit is void if project not begun within 90 days of approval date.
 4. **Notify Zone 7 at least 24 hours before the start of work.**

APPLICANT
Name Conestoga-Rovers & Associates
Email csandora@conrow.com Fax 916-889-8999
Address 10969 Trade Center Dr. Ste. 107 Phone 916-889-8916
City Rancho Cordova, CA Zip 95670

- B. WATER SUPPLY WELLS
 1. Minimum surface seal diameter is four inches greater than the well casing diameter.
 2. Minimum seal depth is 50 feet for municipal and industrial wells or 20 feet for domestic and irrigation wells unless a lesser depth is specially approved.
 3. Grout placed by tremie.
 4. An access port at least 0.5 inches in diameter is required on the wellhead for water level measurements.
 5. A sample port is required on the discharge pipe near the wellhead.

TYPE OF PROJECT:
Well Construction _____
Well Destruction 3 monitoring wells
Cathodic Protection _____ 3 vapor probes
Geotechnical Investigation _____
Contamination Investigation _____
Other _____

PROPOSED WELL USE:
Domestic _____ Irrigation _____
Municipal _____ Remediation _____
Industrial _____ Groundwater Monitoring
Dewatering _____ Other soil vapor probes

- C. GROUNDWATER MONITORING WELLS INCLUDING PIEZOMETERS
 1. Minimum surface seal diameter is four inches greater than the well or piezometer casing diameter.
 2. Minimum seal depth for monitoring wells is the maximum depth practicable or 20 feet.
 3. Grout placed by tremie.

DRILLING METHOD:
Mud Rotary _____ Air Rotary _____ Hollow Stem Auger _____
Cable Tool _____ Direct Push _____ Other pressure grout

DRILLING COMPANY Vapor Tech Services Gregy
Drilling and Testing
DRILLER'S LICENSE NO. 416235485165

4-20-15 email approval from Wyman Hong to update company drilling info.

WELL SPECIFICATIONS:
Drill Hole Diameter _____ in. Maximum _____
Casing Diameter _____ in. Depth _____ ft.
Surface Seal Depth _____ ft. Number _____

SOIL BORINGS:
Number of Borings _____ Maximum _____
Hole Diameter _____ in. Depth _____ ft.

Please see attached boring logs

ESTIMATED STARTING DATE 4/20/2015
ESTIMATED COMPLETION DATE 4/22/2015

- D. GEOTECHNICAL. Backfill bore hole with compacted cuttings or heavy bentonite and upper two feet with compacted material. In areas of known or suspected contamination, tremied cement grout shall be used in place of compacted cuttings.
- E. CATHODIC. Fill hole above anode zone with concrete placed by tremie.
- F. WELL DESTRUCTION. See attached.
- G. SPECIAL CONDITIONS. Submit to Zone 7 within 60 days after completion of permitted work the well installation report including all soil and water laboratory analysis results.

I hereby agree to comply with all requirements of this permit and Alameda County Ordinance No. 73-68.

APPLICANT'S SIGNATURE [Signature] Date 3/20/2015

Approved [Signature] Date 4/16/15
Wyman Hong

ATTACH SITE PLAN OR SKETCH

April 16, 2015

**Zone 7
Water Resources Engineering
Groundwater Protection Ordinance**

Chevron Environmental Management Company
7007 San Ramon Road
Dublin

Wells 3S/1W-2H10 to 3S/1W-2H13 (MW-1 to MW-4), 3S/1W-2H18 (MW-5), 3S/1W-2H23 (VW-1), 3S/1W-2H24 (VW-2), 3S/1W-2H36 (MW-11) and 3S/1W-2H37 to 3S/1W-2H39 (VP-1 to VP-3)
Permit 2015044

Destruction Requirements:

1. Remove from the well any pump, appurtenances, debris, or other materials.
2. Sound the well as deeply as practicable and record for your report.
3. Fill casing with neat cement or cement grout sealing material to two feet below the finished grade and pressurize to 25 psi and maintain for 5 minutes, forcing the sealing material through the existing perforations and into the surrounding formation.
4. Release the pressure and refill the empty portion of the casing with grouting material allowing it to spill over the top of the casing to form a cap.
5. Cut and remove any casing(s) to two feet below the finished grade or original ground, whichever is the lower elevation (optional).
6. After seal has set, backfill the remaining hole with compacted material.

TABLE 1
WELL CONSTRUCTION DETAILS
CHEVRON SERVICE STATION 95542
7007 SAN RAMON ROAD, DUBLIN, CALIFORNIA

Boring ID	Installation Date	Well		Screen		Screen Length (feet)	Status
		Depth (fbg)	Diameter (inches)	Top (fbg)	Bottom (fbg)		
MW-1	03/27/90	35	2	20	35	15	Overdrilled to new depth
35/W-2H10 MW-1	11/25/92	51.5	4	30	50	20	Active
35/W-2H11 MW-2	03/26/90	37	2	22	37	15	Active
35/W-2H12 MW-3	03/26/90	35	2	20	35	15	Active
13 MW-4	03/28/90	35	2	20	35	15	Active
35/W-2H18 MW-5	06/11/91	36	2	21	36	15	Paved Over in 1995 / Inactive
MW-6	06/11/91	35	2	20	35	15	Properly Destroyed in January 2006
MW-7	06/12/91	35	2	20	35	15	Properly Destroyed in January 2006
MW-8	12/06/91	35	2	15	35	20	Properly Destroyed in January 2006
35/W-2H23 VW-1	11/24/92	31.5	2	25	30	5	Inactive
24 VW-2	11/25/92	30	2	25	29.5	4.5	Inactive
MW-9	06/08/94	34.5	2	19	34.5	15.5	Properly Destroyed in January 2006
MW-10	06/12/96	35	2	15	35	20	Properly Destroyed in January 2006
35/W-2H30 MW-11	11/30/06	55	2	45	55	10	Active
35/W-2H37 VP-1	10/15/09	6	0.25	5.25	5.75	0.5	Active
38 VP-2	10/15/09	4.9	0.25	4.25	4.75	0.5	Active
39 VP-3	10/15/09	6	0.25	5.25	5.75	0.5	Active

fbg = feet below grade

8 wells
3 vps

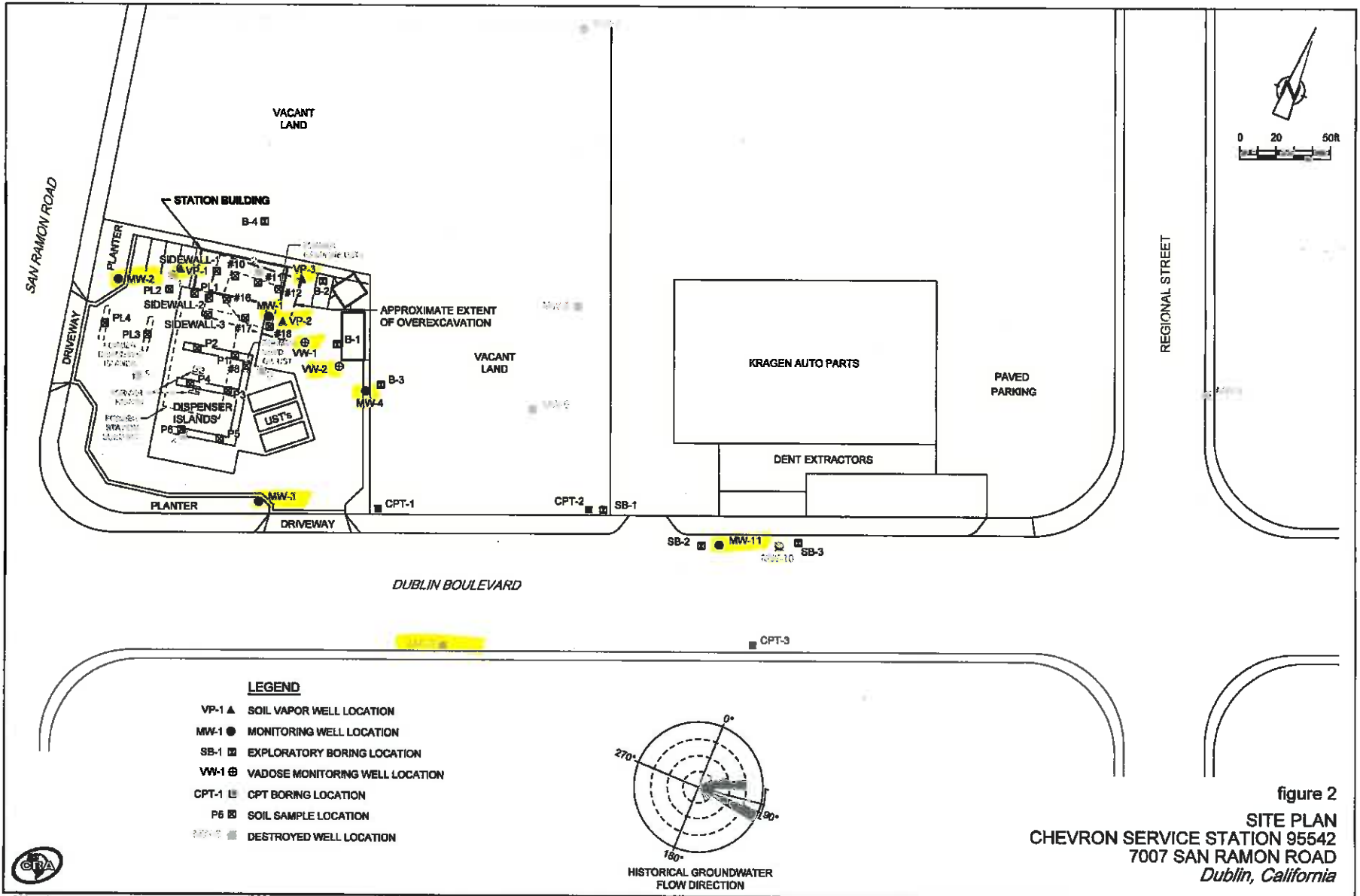

figure 2
SITE PLAN
CHEVRON SERVICE STATION 95542
7007 SAN RAMON ROAD
Dublin, California

CHEVRON - 7007 SAN RAMON RD, DUBLIN

PERMIT 2015044





**CITY OF DUBLIN
 Public Works**

Permit No.: **PWEN-2015-00038**

Application Date: **04/15/2015**

Issue Date: **04/15/2015**

Permit Type: **PW ENCROACHMENT PERMIT**

Inspection Requests Require 24 Hour Notice
 BLD (925) 833-6620 FIRE (925) 833-6606 PUBLIC WORKS (925) 833-6630

Site Address:	0 DUBLIN BLVD DUBLIN CA 94568	Parcel / APN:	
Owner:	CITY OF DUBLIN - PUBLIC WORKS	Phone:	(925) 833-6630
Address:	100 CIVIC PLZ DUBLIN CA 94568-2658	Fax:	(925) 829-9248
Contractor:	CONESTOGA - ROVERS & ASSOCIATES I	Phone:	(707) 935-4850
Address:	2055 NIAGRA FALLS BLVD 3 NIAGARA FALLS, NY 14304	Fax:	(707) 935-6649
Contact:	EDWARD ROBERTS	Lic. Exp. Date:	09/30/2015
		Business Lic#:	BL-107338
		Phone:	(707) 935-4850
Description:	Two locations: 1) North side of Dublin Blvd, approximately 400ft e/o San Ramon Rd 2) South side of Dublin Blvd, approximately 250ft e/o San Ramon Rd		
	Destroy monitoring wells, MW-5 & MW-11. The well boxes will be removed and the excavated areas backfilled with hot asphalt. Conditions: All traffic control shall comply with current Caltrans standards per approved plans. Work hours as follows: MW-5 has work hours of 7:00am - 11:30am. MW-11 has work hours of 9:30am to 11:30am and 1:30pm to 3:30pm. Flashing Arrow Board sign needs to be placed before or at beginning of lane taper.		

SUPPLEMENTAL INFORMATION:	
ASPHALT SQUARE FOOTAGE	8
TEMP STREET/LANE CLOSURE	Y
MISC WORK HOURS	1
PW INSPECTOR	ROEHL- (925)766-1152

FEES:	
ENCROACHMENT FEE	104.00
ADDITIONAL ENCROACHMENT FEE	287.00
TOTAL FEES: 391.00	

I hereby have read and agree to the City of Dublin provisions and conditions outlined in this permit:

Signature of Permittee

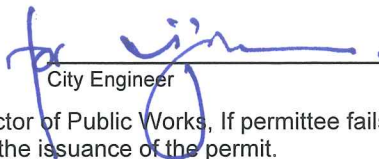

City Engineer

This permit may be revoked at any time at the option of the Director of Public Works, If permittee fails to comply with or violate any City Ordinance, City Standard, safety regulations or any condition of the issuance of the permit.

CONDITIONS

1. Permittee shall provide and keep a current certificate of Public Liability and Workers Compensation Insurance which names the City of Dublin and its employees and its agents as additional insured.
2. Worksites left in an unsafe condition will be secured by the City Maintenance Department and the cost will be charged to the permittee.
3. Permittee shall remove all U.S.A markings upon completion of the project.
4. All traffic control shall meet current City of Dublin and Caltrans standards and needs approval prior to start of the project.
5. Permittee shall contact Public Works Inspector for all required inspections (i.e. traffic control, backfill, concrete form, etc.)
6. Prosecution of Work: All work authorized by the permit shall be performed in a workman like, diligent, and expeditious manner, and must be complete to the satisfaction of the City Engineer.
7. Liability and Damage: The permittee shall be responsible for all liability imposed by law for personal injury or damage which may arise out of the work permitted and done by permittee under this permit, or which arise out of failure on the part of the permittee to perform his obligations under said permit in respect to maintenance and encroachment. The permittee shall protect and indemnify the City of Dublin, its officers and employees, and save them harmless in every way from all action by law for damage or injury to persons or property that may arise out of or be occasioned in any way because of his operations as provided in this permit.
8. The permittee shall begin work as authorized under this permit within 90 days from the start of issuance, unless a different date is stated in the permit. If the work is not begun within 90 days of the time stated in the permit, the permit shall become void. The permit shall be valid for a term of one year from the date of issuance, or as otherwise stated on the permit unless discontinued by the use or removal of the encroachment for which the permit was issued. (City of Dublin Municipal Code Chapter 7.04)
9. This permit is issued only for that portion of work in the City of Dublin right-of-way.
10. The permittee shall notify Underground Service Alert (U.S.A.) at 800/227-2600 prior to excavation. All underground contractors must have U.S.A. inquiry identification number.
11. Permittee is hereby cautioned that unless otherwise noted herein, traffic signal detector loops, wiring, etc., and irrigation facilities shall not be disturbed. Request marking from City of Dublin Public Works Department at 925/833-6630.
12. All excavations shall conform to the requirements of the State of California Division of Industrial Safety.
13. Permittee shall furnish all safeguards for pedestrians and post warning signs in advance of work area for vehicular traffic and shall clear the roadway of any obstructions or debris at the end of each work day. All safety devised shall conform to the latest edition of the State of California "Manual of Warning Signs, Lights, and Devices for Use in Performance.
14. No public road under the jurisdiction of the City of Dublin shall be closed to travel by the general public without special permission of the City Engineer in writing. No lane closures will be allowed between 6:00 a.m. and 9:00 a.m. or between 3:30 p.m. and 6:30 p.m. At other times, at least one lane of traffic shall be kept open to the general public.
15. The pavement shall be sawed 12" outside the edges of the trench excavation in order to leave a smooth contour of the pavement surface. Cutting with air tools or other devices leaving jagged edges shall not be permitted.
16. No more than 300 linear feet of continuous excavation shall be opened at one time.
 - a. Excavate only that length of trench which can be backfilled the same day.
 - b. Except for bedding or shading requirements by utilities Class II Aggregate Base is the only acceptable backfill material.
17. Backfill shall be placed in accordance with the current "State of California Department of Transportation Standard Specification." The structural section of the upper _____ inches of the trench backfill within the paved areas shall be _____ inches A.C. on _____ inches A.B. on _____ inches A.S.B.
18. Metal plates of sufficient thickness for legal load traffic or temporary paving 1-1/2" minimum thickness shall be placed at the end of each work day. Sidewalk construction areas shall be left in a safe condition.
19. Material excavated from within the City road right-of-way under this permit shall be removed from within the right-of-way and disposed of in a legal manner.
20. The right-of-way shall be left clean and orderly to the satisfaction of the City Engineer or his representative. The permittee shall give particular attention to maintaining the project in a dust-free condition while performing the various items of work and during non-working periods, including weekends.
21. All work shall be done in accordance with the provisions of the Clean Water Act, which protects the storm drain system. No dirt, rock debris, concrete or other materials or fluids will be allowed to enter the storm drain system during the course of work on this permit.
22. Final asphalt concrete surfacing shall be placed within 5 days of completion of each 300 lineal feet of excavation. If the edges of the trench have raveled prior to final surfacing, the edges shall be resawn.
23. Line and grade shall be left to the satisfaction of the City Engineer. All work shall conform to the current "State of California Department of Transportation Standard Specifications" and City requirements, and the City Inspector shall be notified at 925/833-6630 24 hours prior to pouring concrete.
 - a. Line and grade shall conform to grade of existing curb.
 - b. Line and grade shall conform to adjacent sidewalk.
 - c. Line and grade shall conform to plans prepared by _____ attached hereto and made a part hereof.
 - d. No concrete shall be poured until forms have been inspected and approved.
 - e. Where concrete is to be removed, the edges are to be sawn at the nearest joint or score mark.
24. Where concrete is poured in a planter striping, score lines, construction joints, expansion joints, shall be continued across entire sidewalk area. Where curb, gutter, and sidewalk are poured monolithically, the "back edge" of the curb shall be scored.
25. The permittee shall notify the proper utilities or persons that the location of an existing utility pole, fire hydrant, tree or other encroachment at the side or within the traveled way is such that relocation is necessary for proper execution of the work and/or safety of the general public. Said relocation shall be made at no expense to the City of Dublin. In the event such encroachment is not removed, the permittee will be permitted to construct a blockout with doweled bars in a location and in a manner satisfactory to the inspector. Upon completion of the relocation of each encroachment, permittee shall complete construction of curb, gutter, and/or sidewalk within 90 days.
26. No culverts or storm drains are to be cut or disturbed. Direction of flow and capacity of existing surface water drainage facilities shall no be materially changed.
27. Access to public and private properties adjacent to the public road in which work is authorized shall not be denied by reason of

such work. Special measures shall be taken to ensure passage of emergency vehicles over and at the side of work at all times.

28. In the event that any future improvement of the road right-of-way necessitates the relocation of the encroachment for which this permit is issued, the permittee shall relocate same at his sole expense.

29. Priority shall be given to operations preformed under contract let by the City of Dublin for certain work at this location. Coordination shall be effected through said Contractor and the Project Representative for the City.

30. Any existing facilities damaged or removed in the course of the work shall be replaced in kind or better, including ground and pavement surface, signs, striping, markers, curb, gutter, survey monuments, trees, and other vegetation, etc., to the satisfaction of the owner of said facility.

31. The cash bond placed for this work will be held for six (6) months after the final inspection; however, in the event the permittee does not give the City the notice required and the work is performed without inspection, the cash bond will be held for one year after the final inspection.

PERMITTEE SHALL NOTIFY CITY INSPECTOR AT 925/833-6630 WITHIN 3 DAYS AFTER WORK IS COMPLETE.

FAILURE TO COMPLY WITH THESE PROVISIONS WILL RESULT IN THE CITY'S TAKING WHATEVER MEASURES ARE NECESSARY TO CONFORM TO SAID PROVISIONS AND BILLING THE PERMITTEE FOR ALL EXPENSES INCURRED.



Encroachment Permit Application

Permit to do work in accordance with the City of Dublin Municipal Code Chapter 7.04 and any special requirements shown or listed herein.

Applicant/Permittee:

Name: Conestoga-Rovers & Associates - Laura Heberle
Address: 10969 Trade Center Drive, Suite 107, Rancho Cordova, CA 95670
Phone: 916 889-8918 Email: lheberle@croworld.com

Please read this permit carefully. Keep this permit at the work site. To arrange for inspection, call 925-833-6630 at least 48 hours prior to start of work.

Job location: Well MW-11 - north side of Dublin Blvd, approx. 400 ft east of San Ramon Rd, Dublin. Well MW-5 - south side of Dublin Blvd, approx. 250 ft. east of San Ramon Rd., Dublin.

Description of work: (Attach 3 copies of plans) Destroy monitoring wells MW-5 and MW-11.

Well boxes will be removed and excavated areas backfilled with hot asphalt.

Length of Excavation 2 l.f. Width: 2 l.f. Depth: 1 l.f.

Attention is directed to the general provisions printed on the reverse side of this permit and to the following special requirements:

1. All work shall be consistent with City of Dublin standards and specifications.
2. Permittee shall provide and keep a current certificate of Public Liability and Workers Compensation Insurance, which names the City of Dublin and its employees and agents as additionally insured.
3. Worksites left in an unsafe condition will be secured by the City Maintenance Department and the cost will be charged to the permittee.
4. Permittee shall remove all U.S.A. markings upon completion of the project.
5. All traffic control shall meet current City of Dublin and Caltrans standards and shall be approved by the City Engineer prior to start of the project.
6. Permittee shall contact Public Works Inspector for all required inspections.
7. No public road under the jurisdiction of the City of Dublin shall be closed to travel by the general public without special permission of the City Engineer in writing. No lane closures will be allowed between 6:00 a.m. and 9:00 a.m. or between 3:30 p.m. and 6:30 p.m. At other times, lane closures will be at the discretion of the City Engineer. At least one lane of traffic shall be kept open to the general public.
8. Construction operations shall be limited to week (Monday through Friday) and non-City holidays between the hours of 7:30 a.m. and 5:00 p.m.
9. Compaction test results will be required for all backfill performed.
10. For all other provisions and conditions, see back side of this form.

Prosecution of work: All work authorized by the permit shall be performed in a workmanlike, diligent, and expeditious manner, and must be complete to the satisfaction of the City Engineer.

Liability and Damages: The Permittee shall be responsible for all liability imposed by law for personal injury or property damage which may arise out of the work permitted and done by permittee under this permit, or which may arise out of failure on the part of the permittee to perform his obligations under said permit in respect to maintenance and encroachment. The permittee shall protect and indemnify the City of Dublin, its officers and employees, and save them harmless in every way from all action by law for damage or injury to persons or property that may arise out of or be occasioned in any way because of his operations as provided in this permit.

I hereby have read and agree to the City of Dublin general provisions and conditions outlined in this permit.

Signature of Permittee: Date: 4-10-15

Signature of City Engineer: _____ Date: _____

*This permit may be revoked at any time at the option of the Director of Public Works, if permittee fails to comply with or violates any City Ordinance, City Standard, safety regulations or any condition of the issuance of the permit.

Traffic Speed MPH	Taper Length Each Lane			Cone Spacing		Sign
	Merging	Shifting	Shoulder	Taper	Tangent	Spacing
25 MPH	125 FT	63 FT	42 FT	25 FT	50 FT	150 FT
30 MPH	180 FT	90 FT	60 FT	30 FT	60 FT	200 FT
35 MPH	245 FT	123 FT	82 FT	35 FT	70 FT	250 FT
40 MPH	320 FT	160 FT	107 FT	40 FT	80 FT	350 FT
45 MPH	540 FT	270 FT	180 FT	45 FT	90 FT	550 FT
50 MPH	600 FT	300 FT	200 FT	50 FT	100 FT	600 FT
65 + MPH	660 FT	330 FT	220 FT	50 FT	100 FT	1000 FT

Staging Area
7007 San Ramon Road Dublin Ca

Work Hours
_____ am to _____ pm

24 Hour Contact
Mike Franceschi
(916) 606-7514

LEGEND
W20-1 Road Work Ahead
C20 Right Lane Closed Ahead
C30 Lane Closed

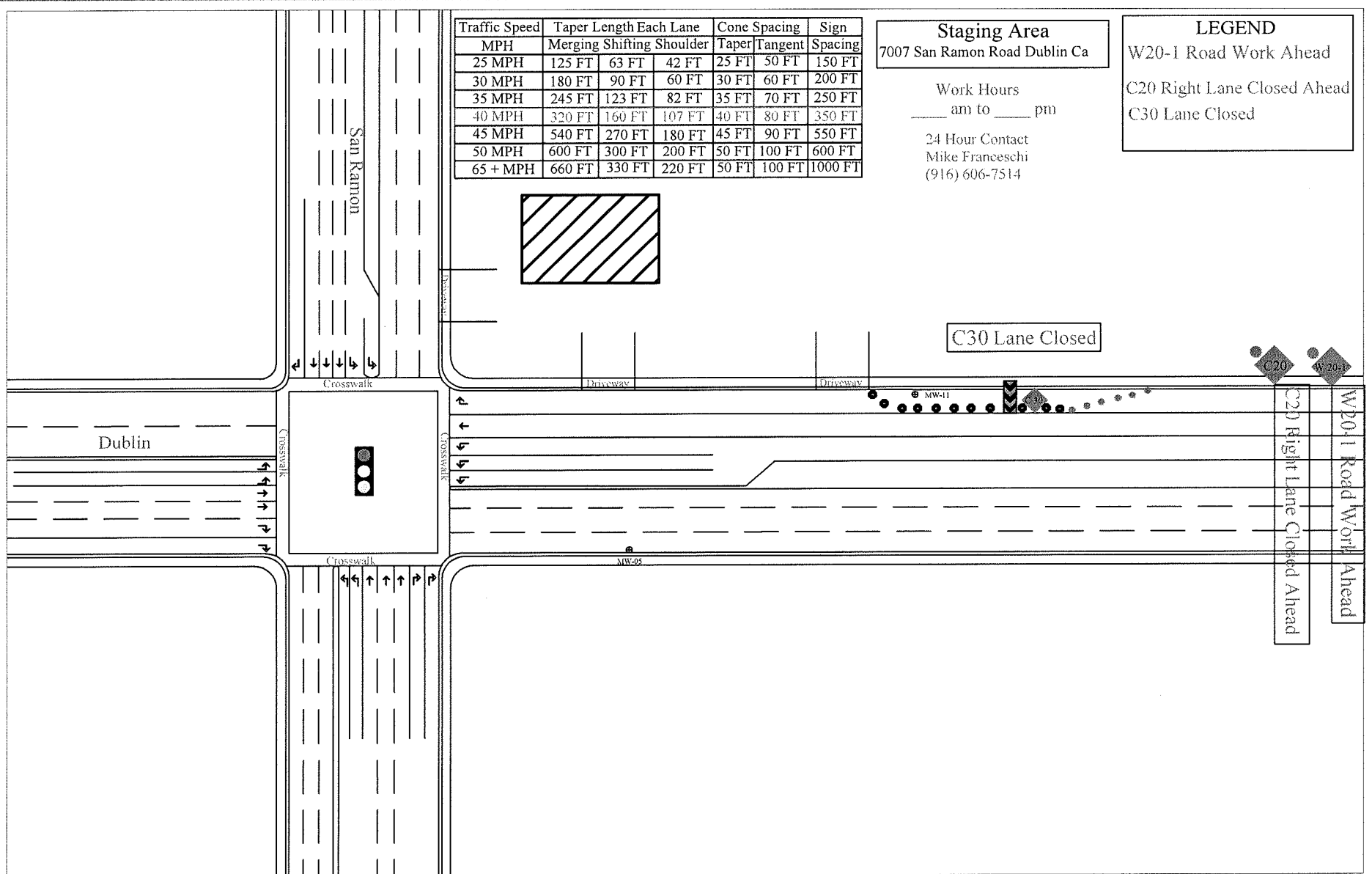
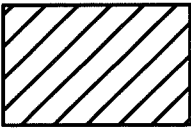

DIRECT TRAFFIC CONTROL
PO BOX 1822
DIAMOND SPRINGS C.A 95619
PHONE (530) 677-9239
FAX (530) 672-1185
MOBILE: (916) 606-7514
IDTC@SBCGLOBAL.NET

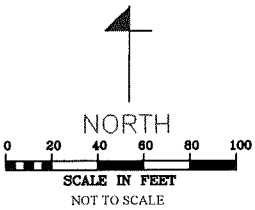

LEGEND

- 40' TAPER SIGN W/PS AU
- 25' CONE
- 40' SIGN & SIGN
- 35' BARRICADE
- 40' SIGN W/PS AU
- Traffic Signal

Conestoga-Rovers & Associates
10969 Trade Center Drive Suite # 106
Rancho Cordova CA 95670

TRAFFIC CONTROL SITE MAP

MPH. 35	TL.	S.S.	B.S.
DRAWN BY	DATE	PROJECT NUMBER	
B FRANCESCHI	04/01/2015	311969	

Staging Area
7007 San Ramon Road Dublin Ca

Work Hours
___ am to ___ pm

24 Hour Contact
Mike Franceschi
(916) 606-7514

Traffic Speed MPH	Taper Length Each Lane			Cone Spacing		Sign
	Merging	Shifting	Shoulder	Taper	Tangent	Spacing
25 MPH	125 FT	63 FT	42 FT	25 FT	50 FT	150 FT
30 MPH	180 FT	90 FT	60 FT	30 FT	60 FT	200 FT
35 MPH	245 FT	123 FT	82 FT	35 FT	70 FT	250 FT
40 MPH	320 FT	160 FT	107 FT	40 FT	80 FT	350 FT
45 MPH	540 FT	270 FT	180 FT	45 FT	90 FT	550 FT
50 MPH	600 FT	300 FT	200 FT	50 FT	100 FT	600 FT
65 + MPH	660 FT	330 FT	220 FT	50 FT	100 FT	1000 FT

W20-1 Road Work Ahead

LEGEND
W20-1 Road Work Ahead
C20 Right Lane Closed Ahead
C30 Lane Closed

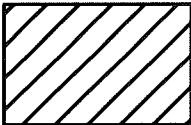
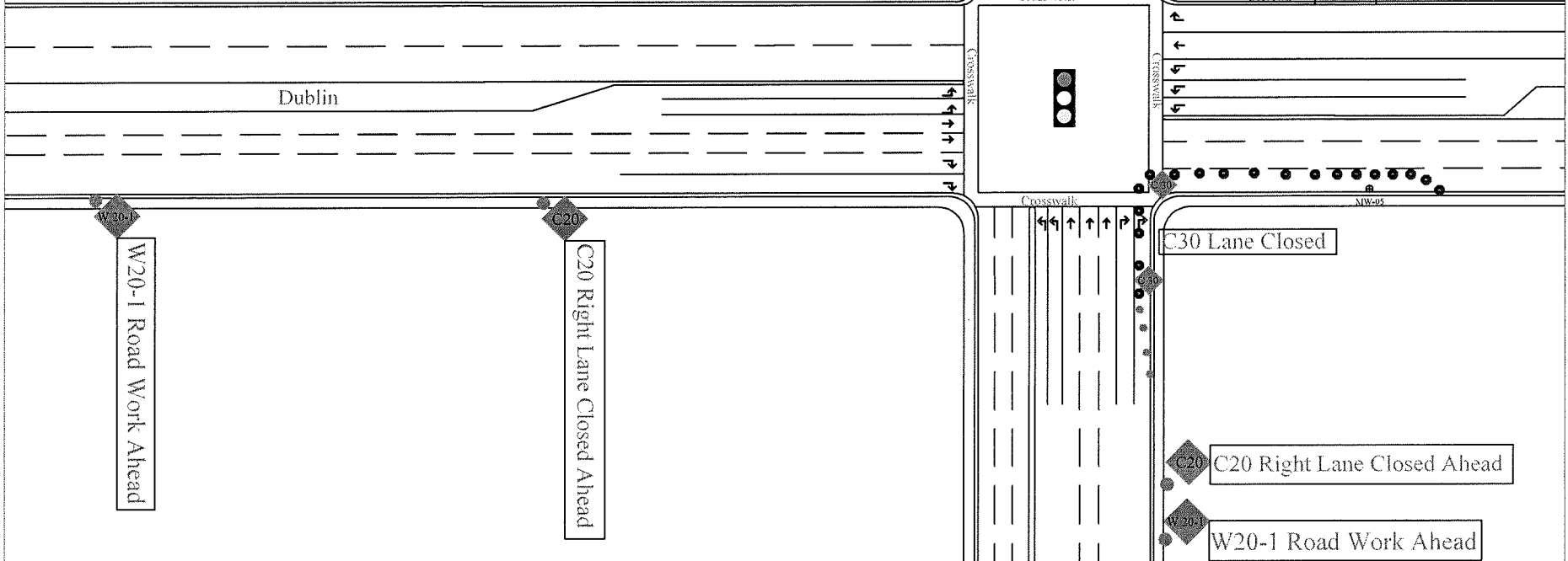
DIRECT TRAFFIC CONTROL
PO BOX 1822
DIAMOND SPRINGS C.A 95619
PHONE (530) 677-9239
FAX (530) 672-1185
MOBILE: (916) 606-7514
IDTC@SBCGLOBAL.NET

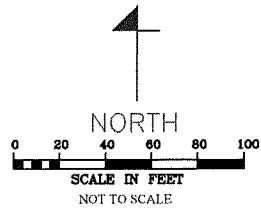

LEGEND

- 18" DIA. PNEUMATIC CONE
- 25" CONE
- 36" SIGNS & SIGNS
- 36" BARRICADE
- 48" CONES
- Traffic Signal

Conestoga-Rovers & Associates
10969 Trade Center Drive Suite # 106
Rancho Cordova CA 95670

TRAFFIC CONTROL SITE MAP

MPH 35	TL	S.S	B.S
DRAWN BY	DATE	PROJECT NUMBER	
B FRANCESCHI	04/01/2015	311969	

Attachment C

Waste Manifest

NON-HAZARDOUS WASTE MANIFEST

1. Generator ID Number

CAR000118123

2. Page 1 of 1

3. Emergency Response Phone (800) 424-9300

4. Waste Tracking Number WP2995-001

5. Generator's Name and Mailing Address

Chevron Environmental Management Co. do Chevron Products Company Waste Desk P.O. Box 8004 San Ramon, CA 94583

Generator's Phone:

(877) 386-6044

Generator's Site Address (if different than mailing address)

Chevron 95542 7007 San Ramon Valley Boulevard Dublin, CA 94568

6. Transporter 1 Company Name

BELSHIRE

U.S. EPA ID Number

CAR000183813

7. Transporter 2 Company Name

U.S. EPA ID Number

8. Designated Facility Name and Site Address

Altamont Landfill and Resource Recovery Fac. 10840 Altamont Pass Road Livermore, CA 94550

Facility's Phone:

(925) 455-7300

U.S. EPA ID Number

CAD981382732

9. Waste Shipping Name and Description

10. Containers

11. Total Quantity

12. Unit Wt./Vol.

No.

Type

1. Non DOT Regulated material (construction, demolition debris, and soil from well abandonment activities, non-hazardous)

1

DM

150

P

2.

3.

4.

13. Special Handling Instructions and Additional Information

WM SO# 0015171384

BESI:255189

ERG: N/A

SITE ID: 95542

WR2985

PROFILE #: 622823CA

WEAR LEVEL D PPE & SPLASH PROTECTION (IF APPLICABLE)

14. GENERATOR'S/OFFEROR'S CERTIFICATION: I hereby declare that the contents of this consignment are fully and accurately described above by the proper shipping name, and are classified, packaged, marked and labeled/placarded, and are in all respects in proper condition for transport according to applicable international and national governmental regulations.

Generator's/Offeror's Printed/Typed Name

Larry Moothart of BESI on behalf of generator

Signature

Month Day Year

5 26 15

15. International Shipments

Import to U.S.

Export from U.S.

Port of entry/exit:

Transporter Signature (for exports only):

Date leaving U.S.:

16. Transporter Acknowledgment of Receipt of Materials

Transporter 1 Printed/Typed Name

Dylan Todd

Signature

Dylan Todd

Month Day Year

5 26 15

Transporter 2 Printed/Typed Name

Signature

Month Day Year

17. Discrepancy

17a. Discrepancy Indication Space

Quantity

Type

Residue

Partial Rejection

Full Rejection

Manifest Reference Number:

17b. Alternate Facility (or Generator)

U.S. EPA ID Number

Facility's Phone:

17c. Signature of Alternate Facility (or Generator)

Month Day Year

18. Designated Facility Owner or Operator. Certification of receipt of materials covered by the manifest except as noted in Item 17a

Printed/Typed Name

John Schaeffle

Signature

[Signature]

Month Day Year

5 26 15

GENERATOR

INT'L

TRANSPORTER

DESIGNATED FACILITY