



GETTLER-RYAN INC.

TRANSMITTAL

August 8, 2000
G-R #180063

TO: Mr. David B. De Witt
Tosco Marketing Company
2000 Crow Canyon Place, Suite 400
San Ramon, California 94583

CC: Mr. Doug Lee
Gettler-Ryan Inc.
Dublin, California

FROM: Deanna L. Harding
Project Coordinator
Gettler-Ryan Inc.
6747 Sierra Court, Suite J
Dublin, California 94568

RE: Tosco (Unocal) SS #0746
3943 Broadway
Oakland, California

UNOCAL
OPERATIONAL
PRODUCTION
08 AUG 21 PM 4:27

WE HAVE ENCLOSED THE FOLLOWING:

COPIES	DATED	DESCRIPTION
1	August 7, 2000	Groundwater Monitoring and Sampling Report Semi-Annual 2000 - Event of May 22, 2000 Monthly Events of December 20, 1999, January 20, February 26, March 31, and April 13, 2000

COMMENTS:

This report is being sent to you for your review/comment, prior to being distributed on your behalf. If no comments are received by **August 18, 2000**, this report will be distributed to the following:

Enclosure

cc: Ms. Eva Chu, Alameda County Health Care Services, 1131 Harbor Bay Parkway, Alameda, CA 94502

trans/0746.dbd



GETTLER - RYAN INC.

August 7, 2000
G-R Job #180063

Mr. David B. De Witt
Tosco Marketing Company
2000 Crow Canyon Place, Suite 400
San Ramon, California 94583

RE: Semi-Annual 2000 Groundwater Monitoring & Sampling Report
Tosco (Unocal) Service Station #0746
3943 Broadway
Oakland, California

Dear Mr. De Witt:

This report documents the monthly and semi-annual groundwater monitoring and sampling event performed by Gettler-Ryan Inc. (G-R). On December 20, 1999, January 20, 2000, February 26, 2000, March 31, 2000 and April 13, 2000, field personnel monitored one well (MW-5). In addition, on May 22, 2000, field personnel monitored twelve wells (MW-1 through MW-12) and sampled seven wells (MW-1, MW-3, MW-4, MW-5, MW-8, MW-9, and MW-11) at the above referenced site.

Static groundwater levels were measured and all wells were checked for the presence of separate-phase hydrocarbons. Separate-phase hydrocarbons were not present in any wells. Static water level data and groundwater elevations are summarized in Table 1. Product Thickness/Removal Data are presented in Table 3. Dissolved Oxygen Concentrations are summarized in Table 2. A Potentiometric Map is included as Figure 1.

Groundwater samples were collected from the monitoring wells as specified by G-R Standard Operating Procedure - Groundwater Sampling (attached). The field data sheets are also attached. The samples were analyzed by Sequoia Analytical. Analytical results are summarized in Tables 1 and 4. A Concentration Map is included as Figure 2. The chain of custody document and laboratory analytical reports are also attached.

Sincerely,

Deanna L. Harding
Deanna L. Harding
Project Coordinator

Douglas J. Lee
Douglas J. Lee
Senior Geologist, R.G. No. 6882

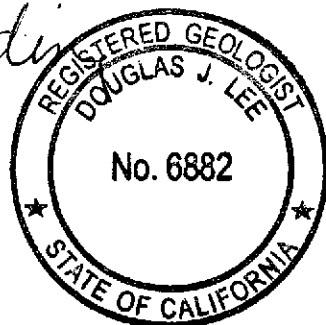
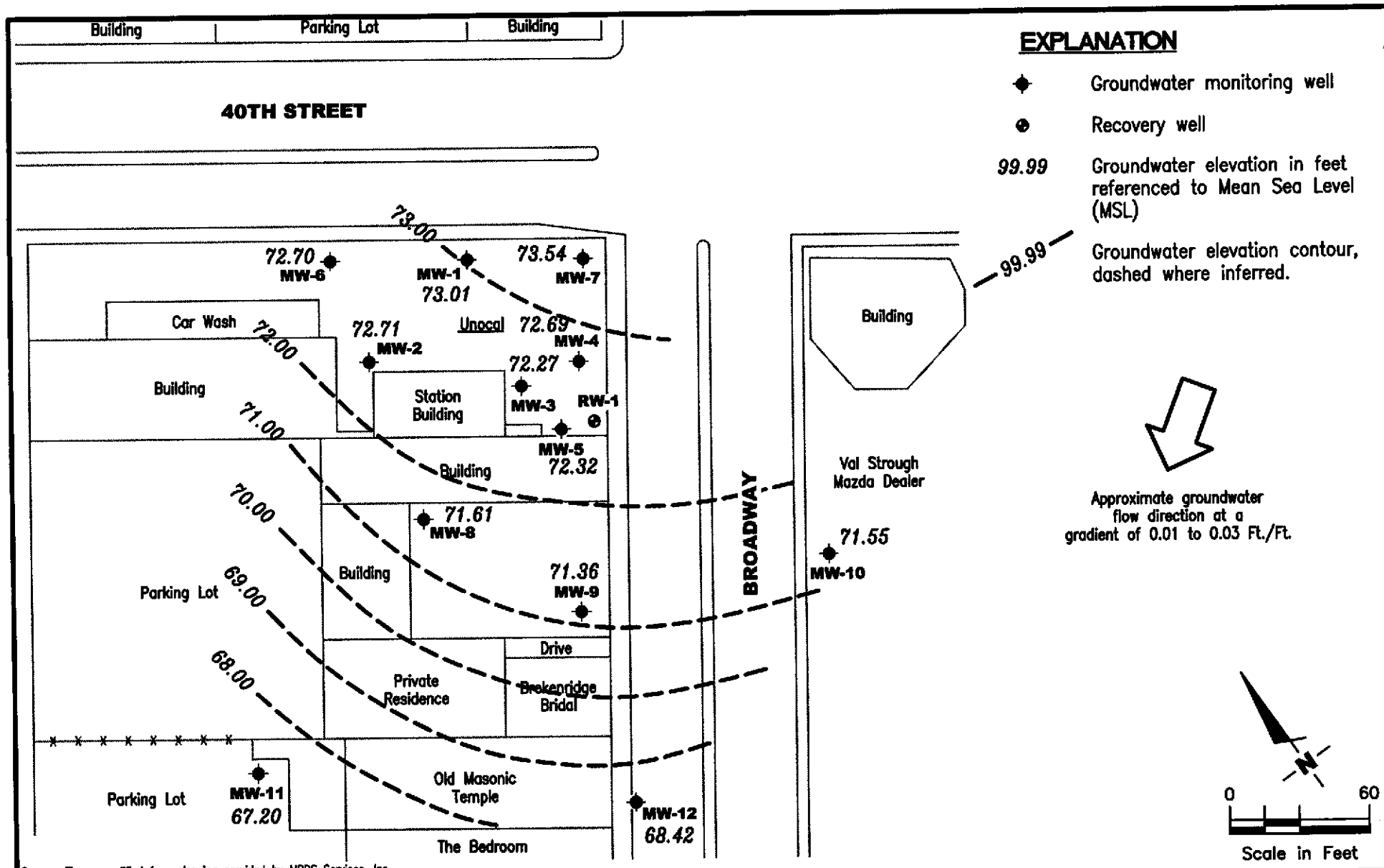

Figure 1: Potentiometric Map
Figure 2: Concentration Map
Table 1: Groundwater Monitoring Data and Analytical Results
Table 2: Dissolved Oxygen Concentrations
Table 3: Product Thickness/Removal Data
Table 4: Oxygenate Compounds
Attachments: Standard Operating Procedure - Groundwater Sampling
Field Data Sheets
Chain of Custody Document and Laboratory Analytical Reports

0746.qml



Source: Figure modified from drawing provided by MPDS Services, Inc.



Gettler - Ryan Inc.

6747 Sierra Ct., Suite J
Dublin, CA 94568 (925) 551-7555

POTENTIOMETRIC MAP
Tosco (Unocal) Service Station #0746
3943 Broadway
Oakland, California

FIGURE

1

JOB NUMBER
180063

REVIEWED BY

DATE
May 22, 2000

REVISED DATE

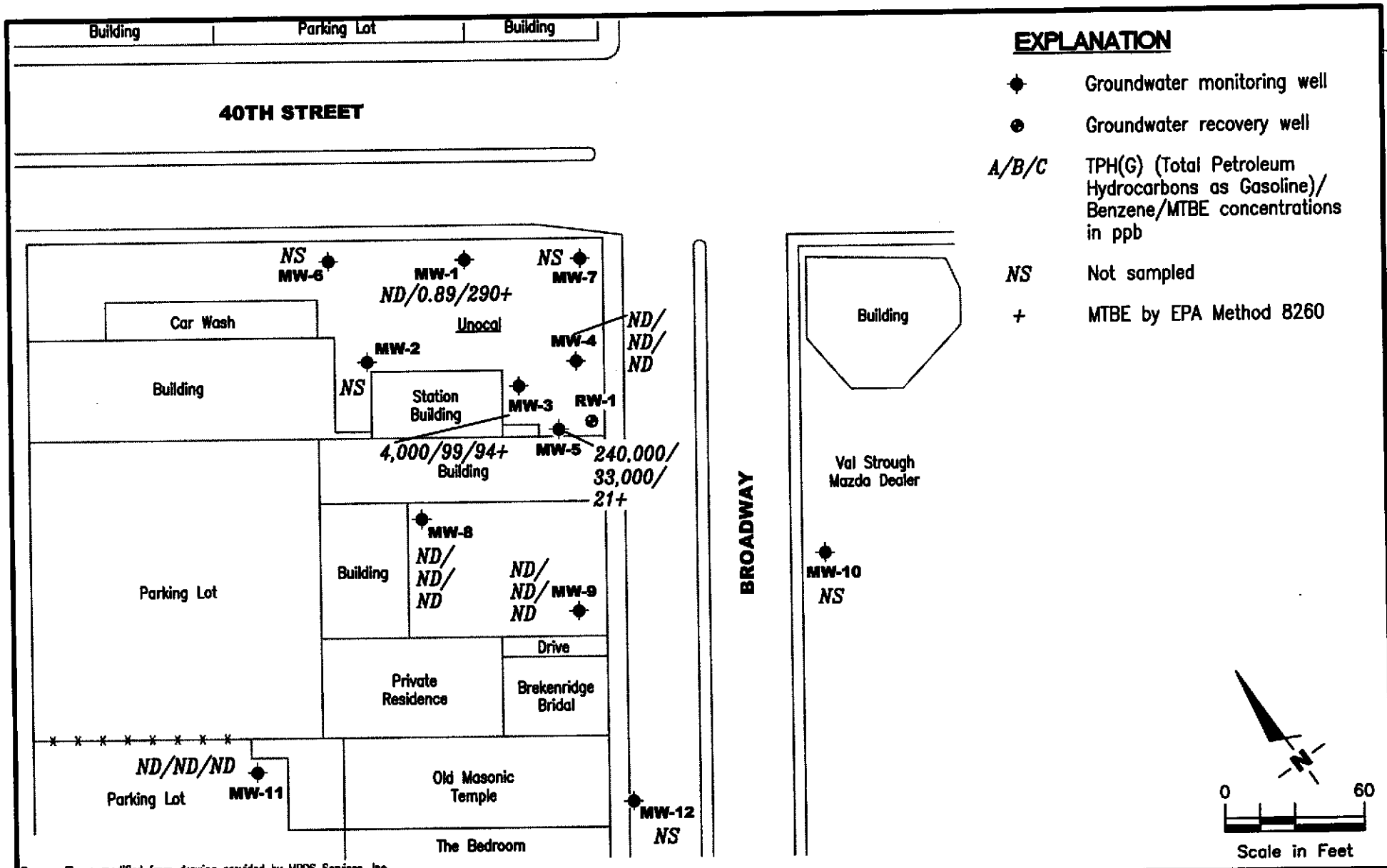

Source: Figure modified from drawing provided by MPDS Services, Inc.



Gettler - Ryan Inc.

6747 Sierra Ct., Suite J
 Dublin, CA 94568 (925) 551-7555

CONCENTRATION MAP

Tosco (Unocal) Service Station #0746
 3943 Broadway
 Oakland, California

JOB NUMBER
 180063

REVIEWED BY

DATE
 May 22, 2000

REVISED DATE

Table 1
Groundwater Monitoring Data and Analytical Results
 Tosco (Unocal) Service Station #0746
 3943 Broadway
 Oakland, California

WELL ID/ TOC*	DATE	DTW (ft.)	GWE (msl)	Product Thickness (ft.)	TPH(G) (ppb)	B (ppb)	T (ppb)	E (ppb)	X (ppb)	MTBE (ppb)
MW-1	11/01/89	--	--	--	ND	ND	ND	ND	0.3	--
	02/15/90	--	--	--	170	7.9	ND	2.2	2.8	--
	08/16/90	--	--	--	ND	ND	ND	ND	ND	--
	11/07/90	--	--	--	45	ND	ND	ND	ND	--
	02/25/91	--	--	--	ND	ND	ND	ND	ND	--
	05/28/91	--	--	--	ND	ND	ND	ND	ND	--
	08/28/91	--	--	--	ND	ND	ND	ND	ND	--
	11/19/91	--	--	--	ND	ND	ND	ND	ND	--
	02/06/92	--	--	--	ND	ND	ND	ND	ND	--
	05/23/92	--	--	--	ND	ND	ND	ND	ND	--
	08/26/92	--	--	--	ND	ND	ND	ND	ND	--
11/20/92	--	--	--	ND	0.75	ND	ND	ND	--	
81.07	12/21/92	8.12	72.95	0.00	--	--	--	--	--	--
	01/30/93	7.63	73.44	0.00	--	--	--	--	--	--
	02/24/93	7.16	73.91	0.00	1,100	280	4.9	120	140	--
	03/22/93	6.26	74.81	0.00	--	--	--	--	--	--
	04/28/93	7.91	73.16	0.00	--	--	--	--	--	--
05/25/93	7.87	73.20	0.00	260	27	4.9	2.6	54	--	
80.54	06/23/93	7.66	72.88	0.00	--	--	--	--	--	--
	07/22/93	7.87	72.67	0.00	--	--	--	--	--	--
	08/25/93	8.00	72.54	0.00	ND	ND	ND	ND	ND	--
	09/22/93	8.10	72.44	0.00	--	--	--	--	--	--
	10/28/93	8.15	72.39	0.00	--	--	--	--	--	--
	11/30/93	7.65	72.89	0.00	SAMPLED SEMI-ANNUALLY		--	--	--	--
	02/16/94	7.46	73.08	0.00	ND	0.84	ND	ND	0.59	--
	05/31/94	7.80	72.74	0.00	--	--	--	--	--	--
	08/31/94	8.27	72.27	0.00	ND	ND	0.98	ND	0.84	--
	09/27/94	8.37	72.17	0.00	--	--	--	--	--	--
	10/11/94	8.36	72.18	0.00	--	--	--	--	--	--
	11/10/94	6.43	74.11	0.00	--	--	--	--	--	--
	02/07/95	7.06	73.48	0.00	6,100	670	ND	120	60	--
05/03/95	6.85	73.69	0.00	260	21	39	17	24	--	
08/03/95	7.69	72.85	0.00	--	--	--	--	--	--	

Table 1
Groundwater Monitoring Data and Analytical Results
 Tosco (Unocal) Service Station #0746
 3943 Broadway
 Oakland, California

WELL ID/ TOC*	DATE	DTW (ft.)	GWE (msl)	Product							
				Thickness (ft.)	TPH(G) (ppb)	B (ppb)	T (ppb)	E (ppb)	X (ppb)	MTBE (ppb)	
MW-1	11/07/95	8.15	72.39	0.00	ND	ND	ND	ND	ND	ND	--
(cont)	05/06/96	7.40	73.14	0.00	170	1.0	20	2.3	17	55	
	11/05/96	7.90	72.64	0.00	ND	ND	ND	ND	ND	5.2	
	05/15/97	7.77	72.77	0.00	ND	ND	ND	ND	ND	16	
	11/12/97	7.48	73.06	0.00	ND	ND	ND	ND	ND	11	
NP	05/04/98	7.39	73.15	0.00	ND	ND	ND	ND	ND	320	
NP	11/11/98	7.37	73.17	0.00	ND	ND	ND	ND	ND	200	
NP	05/20/99	7.41	73.13	0.00	ND	ND	ND	ND	ND	89/47 ^{7,8,9}	
	11/15/99	7.84	72.70	0.00	ND	ND	ND	ND	ND	8.12/7.19 ¹²	
	05/22/00	7.53	73.01	0.00	ND	0.89	ND	ND	ND	220/290 ¹²	
MW-2	11/01/89	--	--	--	200	ND	ND	3.0	1.2	--	
	02/15/90	--	--	--	ND	ND	ND	ND	ND	--	
	08/16/90	--	--	--	ND	ND	6.7	ND	ND	--	
	11/07/90	--	--	--	ND	ND	ND	ND	ND	--	
	02/25/91	--	--	--	ND	0.68	0.42	ND	0.86	--	
	05/28/91	--	--	--	ND	ND	ND	ND	ND	--	
	08/28/91	--	--	--	ND	ND	ND	ND	ND	--	
	11/19/91	--	--	--	ND	ND	ND	ND	ND	--	
	02/06/92	--	--	--	ND	0.36	0.66	ND	0.62	--	
	05/23/92	--	--	--	ND	ND	ND	ND	ND	--	
	08/26/92	--	--	--	ND	ND	ND	ND	ND	--	
	11/20/92	--	--	--	510 ¹	ND	ND	ND	ND	--	
81.62	12/21/92	9.14	72.48	0.00	--	--	--	--	--	--	
	01/30/93	8.99	72.63	0.00	--	--	--	--	--	--	
	02/24/93	8.03	73.59	0.00	11,000 ¹	ND	ND	ND	ND	--	
	03/22/93	9.50	72.12	0.00	--	--	--	--	--	--	
	04/28/93	8.87	72.75	0.00	--	--	--	--	--	--	
	05/25/93	9.04	72.58	0.00	1,300 ¹	ND	ND	ND	ND	2,700	
81.32	06/23/93	9.17	72.15	0.00	--	--	--	--	--	--	
	07/22/93	9.42	71.90	0.00	--	--	--	--	--	--	
	08/25/93	9.53	71.79	0.00	190 ¹	ND	ND	ND	ND	--	

Table 1
Groundwater Monitoring Data and Analytical Results
 Tosco (Unocal) Service Station #0746
 3943 Broadway
 Oakland, California

WELL ID/ TOC*	DATE	DTW (ft.)	GWE (msl)	Product		B (ppb)	T (ppb)	E (ppb)	X (ppb)	MTBE (ppb)
				Thickness (ft.)	TPH(G) (ppb)					
MW-2	09/22/93	9.67	71.65	0.00	--	--	--	--	--	--
(cont)	10/28/93	9.65	71.67	0.00	--	--	--	--	--	--
	11/30/93	9.18	72.14	0.00	480 ¹	ND	ND	ND	ND	--
	02/16/94	8.91	72.41	0.00	3,200 ¹	ND	ND	ND	ND	--
	05/31/94	9.36	71.96	0.00	1,100 ¹	ND	ND	ND	ND	--
	08/31/94	9.85	71.47	0.00	310 ¹	ND	ND	ND	ND	--
	09/27/94	9.95	71.37	0.00	--	--	--	--	--	--
	10/11/95	9.95	71.37	0.00	--	--	--	--	--	--
	11/10/94	7.47	73.85	0.00	95 ²	ND	ND	ND	ND	--
	02/07/95	8.29	73.03	0.00	1,600 ¹	ND	ND	ND	ND	--
	05/03/95	8.12	73.20	0.00	ND	ND	ND	ND	ND	--
	08/03/95	9.35	71.97	0.00	ND	ND	ND	ND	ND	--
	11/07/95	9.65	71.67	0.00	ND	ND	ND	ND	ND	160 ³
	05/06/96	8.90	72.42	0.00	SAMPLING DISCONTINUED ⁴		--	--	--	--
	11/05/96	10.98	70.34	0.00	--	--	--	--	--	--
	05/15/97	9.13	72.19	0.00	--	--	--	--	--	--
	11/12/97	9.84	71.48	0.00	--	--	--	--	--	--
	05/04/98	9.26	72.06	0.00	--	--	--	--	--	--
	11/11/98	8.88	72.44	0.00	--	--	--	--	--	--
	05/20/99	8.68	72.64	0.00	--	--	--	--	--	--
	11/15/99	8.91	72.41	0.00	--	--	--	--	--	--
	05/22/00	8.61	72.71	0.00	--	--	--	--	--	--
MW-3	11/01/89	--	--	--	13,000	57	48	1.7	120	--
	02/15/90	--	--	--	20,000	1,700	2,100	750	3,100	--
	08/16/90	--	--	--	6,800	600	660	760	160	--
	11/07/90	--	--	--	42,000	1,400	5,000	1,800	7,500	--
	02/25/91	--	--	--	37,000	730	2,900	1,300	7,300	--
	05/28/91	--	--	--	24,000	570	1,100	810	4,200	--
	08/28/91	--	--	--	16,000	650	2,200	1,100	5,400	--
	11/19/91	--	--	--	22,000	250	440	660	3,000	--
	02/06/92	--	--	--	24,000	600	1,800	1,200	5,800	--

Table 1
Groundwater Monitoring Data and Analytical Results
 Tosco (Unocal) Service Station #0746
 3943 Broadway
 Oakland, California

WELL ID/ TOC*	DATE	DTW (ft.)	GWE (msl)	Product Thickness (ft.)	TPH(G) (ppb)	B (ppb)	T (ppb)	E (ppb)	X (ppb)	MTBE (ppb)
MW-3	05/23/92	--	--	--	25,000	300	130	880	4,900	--
(cont)	08/26/92	--	--	--	20,000	690	1,900	1,300	5,700	--
	11/20/92	--	--	--	1,100,000 ²	1,800	6,400	3,000	15,000	--
82.01	12/04/92	10.30	71.71**	0.00	--	--	--	--	--	--
	12/21/92	9.78	72.23	Trace	--	--	--	--	--	--
	01/09/93	8.55	73.46	0.00	--	--	--	--	--	--
	01/30/93	8.90	73.11	0.00	--	--	--	--	--	--
	02/10/93	9.01	73.01**	0.01	--	--	--	--	--	--
	02/24/93	8.26	73.76**	0.01	NOT SAMPLED DUE TO THE PRESENCE OF FREE PRODUCT				--	--
	03/09/93	9.18	72.85**	0.02	--	--	--	--	--	--
	03/22/93	8.81	73.22**	0.02	--	--	--	--	--	--
	04/08/93	9.14	72.89**	0.02	--	--	--	--	--	--
	04/28/93	9.44	72.59**	0.03	--	--	--	--	--	--
	05/12/93	9.57	72.46**	0.03	--	--	--	--	--	--
	05/25/93	9.45	72.58**	0.03	NOT SAMPLED DUE TO THE PRESENCE OF FREE PRODUCT				--	--
81.41	06/07/93	8.94	72.47	<0.01	--	--	--	--	--	--
	06/23/93	9.20	72.23**	0.02	--	--	--	--	--	--
	07/08/93	9.31	72.12**	0.03	--	--	--	--	--	--
	07/22/93	9.47	71.94	<0.01	--	--	--	--	--	--
	08/11/93	9.59	71.82	<0.01	--	--	--	--	--	--
	08/25/93	9.67	71.76**	0.03	NOT SAMPLED DUE TO THE PRESENCE OF FREE PRODUCT				--	--
	09/08/93	10.34	71.07	<0.01	--	--	--	--	--	--
	09/22/93	9.84	71.59**	0.02	--	--	--	--	--	--
	10/07/93	9.87	71.54	<0.01	--	--	--	--	--	--
	10/28/93	10.03	71.38	0.00	--	--	--	--	--	--
	11/12/93	9.76	71.65	<0.01	--	--	--	--	--	--
	11/30/93	9.66	71.77**	0.02	NOT SAMPLED DUE TO THE PRESENCE OF FREE PRODUCT				--	--
	02/16/94	8.87	72.54	Sheen	57,000	910	2,500	2,100	9,000	--
	05/31/94	9.48	71.93	<0.01	39,000	670	630	1,500	6,200	--
	08/31/94	10.08	71.33	0.00	44,000	500	240	1,400	5,700	--
	09/24/94	10.22	71.19	0.00	--	--	--	--	--	--
	10/11/94	10.41	71.01**	0.01	--	--	--	--	--	--
	11/10/94	7.47	73.94	Sheen	86,000	3,300	3,800	1,800	8,300	--

Table 1
Groundwater Monitoring Data and Analytical Results
 Tosco (Unocal) Service Station #0746
 3943 Broadway
 Oakland, California

WELL ID/ TOC*	DATE	DTW (ft.)	GWE (msl)	Product						
				Thickness (ft.)	TPH(G) (ppb)	B (ppb)	T (ppb)	E (ppb)	X (ppb)	MTBE (ppb)
MW-3	02/07/95	8.05	73.36	0.00	45,000	1,400	1,300	1,500	5,600	--
(cont)	03/14/95	7.05	74.36	0.00	--	--	--	--	--	--
	05/03/95	7.91	73.50	0.00	26,000	740	990	1,100	4,400	--
	08/03/95	9.28	72.13	0.00	18,000	59	ND	530	1,900	--
	11/07/95	10.79	70.62	0.00	17,000	110	26	400	1,500	880 ³
	05/06/96	9.44	71.97	Sheen	5,100	48	ND	87	210	370
	11/05/96	10.64	70.77	0.00	35,000	2,200	ND	1,200	2,800	460
	05/15/97	9.61	71.80	0.00	2,400	110	ND	ND	140	100
	11/12/97	9.18	72.23	0.00	29,000	2,000	ND	1,800	3,000	ND
NP	05/04/98	9.50	71.91	0.00	8,200	430	ND ⁵	310	320	ND ⁵
NP	11/11/98	9.25	72.16	0.00	8,700	500	ND ⁵	330	310	ND ⁵
NP	05/20/99	8.95	72.46	0.00	4,300	250	ND ⁵	ND ⁵	86	ND ⁵
	11/15/99	10.35	71.06	0.00	6,720 ¹¹	326	ND ⁵	398	226	120/45.1 ¹²
	05/22/00	9.14	72.27	0.00	4,000 ¹¹	99	4.5	190	75	100/94 ¹²
MW-4	02/15/90	--	--	--	150	8.0	8.0	10	45	--
	08/16/90	--	--	--	3,600	480	17	230	260	--
	11/07/90	--	--	--	180	1.5	0.37	6.3	26	--
	02/25/91	--	--	--	22,000	600	1,300	780	2,800	--
	05/28/91	--	--	--	38	ND	ND	ND	1.9	--
	08/28/91	--	--	--	2,000	1,500	20	120	300	--
	11/19/91	--	--	--	55	9.2	4.5	1.4	6.7	--
	02/06/92	--	--	--	5,700	2,200	140	57	980	--
	05/23/92	--	--	--	ND	ND	ND	ND	ND	--
	08/26/92	--	--	--	120	86	0.52	0.57	1.6	--
	11/20/92	--	--	--	ND	6.2	ND	1.2	0.52	--
81.48	12/21/93	9.10	72.38	0.00	--	--	--	--	--	--
	01/30/93	8.35	73.13	0.00	--	--	--	--	--	--
	02/24/93	8.17	73.31	0.00	140	12	0.64	9.4	3.7	--
	03/22/93	8.12	73.36	0.00	--	--	--	--	--	--

Table 1
Groundwater Monitoring Data and Analytical Results
 Tosco (Unocal) Service Station #0746
 3943 Broadway
 Oakland, California

WELL ID/ TOC*	DATE	DTW (ft.)	GWE (msl)	Product Thickness (ft.)	TPH(G) (ppb)	B (ppb)	T (ppb)	E (ppb)	X (ppb)	MTBE (ppb)
MW-4	04/28/93	9.36	72.12	0.00	--	--	--	--	--	--
(cont)	05/25/93	8.75	72.73	0.00	74	10	ND	4.6	1.8	--
81.29	06/23/93	8.90	72.39	0.00	--	--	--	--	--	--
	07/22/93	9.26	72.03	0.00	--	--	--	--	--	--
	08/25/93	9.45	71.84	0.00	640	100	1.1	100	22	--
	09/22/93	9.63	71.66	0.00	--	--	--	--	--	--
	10/28/93	9.62	71.67	0.00	--	--	--	--	--	--
	11/30/93	9.40	71.89	0.00	200	28	ND	17	8.1	--
	02/16/94	9.21	72.08	0.00	190	11	0.98	21	6.6	--
	05/31/94	9.11	72.18	0.00	1,100	190	ND	100	58	--
	08/31/94	10.01	71.28	0.00	400	17	0.94	14	5.2	--
	09/27/94	10.09	71.20	0.00	--	--	--	--	--	--
	10/11/94	11.50	69.79	0.00	--	--	--	--	--	--
	11/10/94	9.21	72.08	0.00	7,700	1,800	280	460	1,300	--
	02/07/95	7.66	73.63	0.00	540	47	ND	17	2.5	--
	05/03/95	8.29	73.00	0.00	160	8.3	0.52	1.5	3.7	--
	08/03/95	8.60	72.69	0.00	57	2.0	ND	ND	ND	--
	11/07/95	10.28	71.01	0.00	ND	0.71	ND	ND	ND	0.86
	05/06/96	8.70	72.59	0.00	1,200	12	11	15	36	ND
	11/05/96	10.00	71.29	0.00	700	32	0.71	1.8	1.3	6.5
	05/15/97	9.37	71.92	0.00	51	ND	ND	ND	ND	ND
	11/12/97	8.92	72.37	0.00	74	1.7	ND	ND	ND	ND
NP	05/04/98	9.48	71.81	0.00	ND	ND	ND	ND	ND	ND
NP	11/11/98	9.13	72.16	0.00	ND	0.63	ND	ND	ND	ND
NP	05/20/99	8.41	72.88	0.00	ND	ND	ND	ND	ND	ND
	11/15/99	9.68	71.61	0.00	ND	ND	ND	ND	ND	ND
	05/22/00	8.60	72.69	0.00	ND	ND	ND	ND	ND	ND
MW-5	02/15/90	--	--	--	24,000	1,500	1,700	260	3,600	--
	08/16/90	--	--	--	16,000	1,400	1,900	2,800	660	--
	11/07/90	--	--	--	20,000	640	1,100	670	3,000	--
	02/25/91	--	--	--	25,000	950	1,300	900	3,500	--

Table 1
Groundwater Monitoring Data and Analytical Results
 Tosco (Unocal) Service Station #0746
 3943 Broadway
 Oakland, California

WELL ID/ TOC*	DATE	DTW (ft.)	GWE (msl)	Product		B (ppb)	T (ppb)	E (ppb)	X (ppb)	MTBE (ppb)
				Thickness (ft.)	TPH(G) (ppb)					
MW-5	05/28/91	--	--	--	24,000	2,300	3,400	1,300	6,000	--
(cont)	08/28/91	--	--	--	NOT SAMPLED DUE TO THE PRESENCE OF FREE PRODUCT					--
	11/19/91	--	--	--	NOT SAMPLED DUE TO THE PRESENCE OF FREE PRODUCT					--
	02/06/92	--	--	--	NOT SAMPLED DUE TO THE PRESENCE OF FREE PRODUCT					--
	05/23/92	--	--	--	NOT SAMPLED DUE TO THE PRESENCE OF FREE PRODUCT					--
	08/26/92	--	--	--	NOT SAMPLED DUE TO THE PRESENCE OF FREE PRODUCT					--
	11/20/92	--	--	--	NOT SAMPLED DUE TO THE PRESENCE OF FREE PRODUCT					--
81.59	12/04/92	10.03	71.62**	0.08	--	--	--	--	--	--
	12/21/92	9.50	72.10**	0.01	--	--	--	--	--	--
	01/09/93	8.22	73.37	0.00	--	--	--	--	--	--
	01/30/93	8.58	73.01	Trace	--	--	--	--	--	--
	02/10/93	8.68	72.91	Trace	--	--	--	--	--	--
	02/24/93	7.91	73.69**	0.01	NOT SAMPLED DUE TO THE PRESENCE OF FREE PRODUCT					--
	03/09/93	8.87	72.73**	0.01	--	--	--	--	--	--
	03/22/93	8.46	73.14**	0.01	--	--	--	--	--	--
	04/08/93	8.84	72.76**	0.01	--	--	--	--	--	--
	04/28/93	9.14	72.47**	0.02	--	--	--	--	--	--
	05/12/93	9.28	72.33**	0.02	--	--	--	--	--	--
	05/25/93	9.63	72.06**	0.13	NOT SAMPLED DUE TO THE PRESENCE OF FREE PRODUCT					--
81.38	06/07/93	9.75	71.64**	0.01	--	--	--	--	--	--
	06/23/93	9.32	72.08**	0.03	--	--	--	--	--	--
	07/08/93	9.48	71.93**	0.04	--	--	--	--	--	--
	07/22/93	9.73	71.77**	0.16	--	--	--	--	--	--
	08/11/93	9.84	71.57**	0.04	--	--	--	--	--	--
	08/25/93	9.81	71.59**	0.02	NOT SAMPLED DUE TO THE PRESENCE OF FREE PRODUCT					--
	09/08/93	10.09	71.31**	0.03	--	--	--	--	--	--
	09/22/93	10.01	71.41**	0.05	--	--	--	--	--	--
	10/07/93	9.94	71.46**	0.03	--	--	--	--	--	--
	10/28/93	10.04	71.36**	0.02	--	--	--	--	--	--
	11/12/93	9.79	71.59	<0.01	--	--	--	--	--	--
	11/30/93	9.62	71.76	<0.01	NOT SAMPLED DUE TO THE PRESENCE OF FREE PRODUCT					--
	02/16/94	8.95	72.45**	0.02	NOT SAMPLED DUE TO THE PRESENCE OF FREE PRODUCT					--
	05/31/94	9.63	71.75	<0.01	43,000	1,500	1,200	1,600	6,700	--

Table 1
Groundwater Monitoring Data and Analytical Results
 Tosco (Unocal) Service Station #0746
 3943 Broadway
 Oakland, California

WELL ID/ TOC*	DATE	DTW (ft.)	GWE (msl)	Product	TPH(G) (ppb)	B (ppb)	T (ppb)	E (ppb)	X (ppb)	MTBE (ppb)	
				Thickness (ft.)							
MW-5	08/31/94	10.25	71.15**	0.02	NOT SAMPLED DUE TO THE PRESENCE OF FREE PRODUCT					--	--
(cont)	09/27/94	10.38	71.00	<0.01	--	--	--	--	--	--	--
	10/11/94	10.45	70.95**	0.02	--	--	--	--	--	--	--
	11/10/94	7.54	73.90**	0.08	NOT SAMPLED DUE TO THE PRESENCE OF FREE PRODUCT					--	--
	02/07/95	8.10	73.28	0.00	25,000	1,400	740	990	3,000	--	--
	03/14/95	7.04	74.34	0.00	--	--	--	--	--	--	--
	05/03/95	7.98	73.40	0.00	12,000	680	160	600	1,800	--	--
	08/03/95	9.25	72.13	0.00	23,000	940	280	810	2,700	--	--
	11/07/95	10.00	71.38	0.00	40,000	510	280	1,000	5,700	630 ³	--
	05/06/96	9.03	72.35	Sheen	13,000	200	ND	180	610	170	--
	11/05/96	10.41	70.97	0.00	35,000	1,800	ND	1,300	4,900	580	--
	05/15/97	9.41	71.97	Sheen	10,000	490	ND	ND	1,300	ND	--
	11/12/97	9.27	72.11	0.00	100	5.1	ND	ND	ND	74	--
NP	05/04/98	9.18	72.20	0.00	39,000	1,600	230	1,000	3,200	ND ⁵	--
	11/11/98	9.23	72.43**	0.37	NOT SAMPLED DUE TO THE PRESENCE OF FREE PRODUCT					--	--
	02/22/99	7.69	73.88**	0.25	--	--	--	--	--	--	--
	04/02/99 ⁶	8.19	73.40**	0.28	--	--	--	--	--	--	--
	05/04/99	8.44	72.95**	0.01	--	--	--	--	--	--	--
	05/20/99	8.73	72.68**	0.04	--	--	--	--	--	--	--
	06/29/99	8.91	72.51**	0.05	--	--	--	--	--	--	--
	07/29/99	9.12	72.31**	0.07	--	--	--	--	--	--	--
	08/24/99	9.37	72.08**	0.09	--	--	--	--	--	--	--
	09/27/99	9.51	71.92**	0.06	--	--	--	--	--	--	--
	10/28/99	--	--	0.05	--	--	--	--	--	--	--
	11/15/99	9.29	72.09	Sheen	--	--	--	--	--	--	--
	12/20/99 ¹³	9.14	72.24	0.00	--	--	--	--	--	--	--
	01/20/00 ¹³	9.08	72.30	0.00	--	--	--	--	--	--	--
	02/26/00 ¹³	8.69	72.69	0.00	--	--	--	--	--	--	--
	03/31/00 ¹³	8.48	72.90	0.00	--	--	--	--	--	--	--
	04/13/00	8.66	72.72	0.00	--	--	--	--	--	--	--
	05/22/00 ¹⁴	9.06	72.32	0.00	240,000 ¹¹	33,000	5,000	18,000	59,000	640/21 ¹²	--

Table 1
Groundwater Monitoring Data and Analytical Results
 Tosco (Unocal) Service Station #0746
 3943 Broadway
 Oakland, California

WELL ID/ TOC*	DATE	DTW (ft.)	GWE (msl)	Product Thickness (ft.)	TPH(G) (ppb)	B (ppb)	T (ppb)	E (ppb)	X (ppb)	MTBE (ppb)
MW-6	11/07/90	--	--	--	ND	ND	ND	ND	ND	--
	02/25/91	--	--	--	ND	0.37	0.4	0.35	1.5	--
	05/28/91	--	--	--	ND	ND	ND	ND	0.42	--
	08/28/91	--	--	--	ND	ND	ND	ND	ND	--
	11/19/91	--	--	--	ND	ND	ND	ND	ND	--
	02/06/92	--	--	--	ND	ND	ND	ND	ND	--
	05/23/92	--	--	--	ND	ND	ND	ND	ND	--
	08/26/92	--	--	--	ND	ND	ND	ND	ND	--
	11/20/92	--	--	--	ND	ND	ND	ND	ND	--
80.47	12/21/92	7.71	72.76	0.00	--	--	--	--	--	--
	01/30/93	7.25	73.22	0.00	--	--	--	--	--	--
	02/24/93	6.74	73.73	0.00	ND	ND	ND	ND	ND	--
	03/22/93	5.85	74.62	0.00	--	--	--	--	--	--
	04/28/93	7.58	72.89	0.00	--	--	--	--	--	--
79.94	05/25/93	7.48	72.99	0.00	ND	ND	ND	ND	ND	--
	06/23/93	7.34	72.60	0.00	--	--	--	--	--	--
	07/22/93	7.53	72.41	0.00	--	--	--	--	--	--
	08/25/93	7.66	72.28	0.00	ND	ND	ND	ND	ND	--
	09/22/93	7.76	72.18	0.00	--	--	--	--	--	--
	10/28/93	8.30	71.64	0.00	--	--	--	--	--	--
	11/30/93	7.40	72.54	0.00	SAMPLED SEMI-ANNUALLY		--	--	--	--
	02/16/94	7.13	72.81	0.00	ND	ND	ND	ND	ND	--
	05/31/94	7.49	72.45	0.00	--	--	--	--	--	--
	08/31/94	7.93	72.01	0.00	ND	ND	1.5	ND	1.6	--
	09/27/94	8.03	71.91	0.00	--	--	--	--	--	--
	10/11/94	8.05	71.89	0.00	--	--	--	--	--	--
	11/10/94	6.12	73.82	0.00	--	--	--	--	--	--
02/07/95	6.65	73.29	0.00	ND	ND	ND	ND	ND	--	
05/03/95	6.47	73.47	0.00	ND	ND	ND	ND	1.0	--	
08/03/95	7.28	72.66	0.00	--	--	--	--	--	--	
11/07/95	7.98	71.96	0.00	ND	ND	ND	ND	ND	--	
05/06/96	7.80	72.14	0.00	SAMPLING DISCONTINUED ⁴		--	--	--	--	
11/05/96	7.63	72.31	0.00	--	--	--	--	--	--	

Table 1
Groundwater Monitoring Data and Analytical Results
 Tosco (Unocal) Service Station #0746
 3943 Broadway
 Oakland, California

WELL ID/ TOC*	DATE	DTW (ft.)	GWE (msl)	Product Thickness (ft.)	TPH(G) (ppb)	B (ppb)	T (ppb)	E (ppb)	X (ppb)	MTBE (ppb)
MW-6 (cont)	05/15/97	7.41	72.53	0.00	--	--	--	--	--	--
	11/12/97	7.51	72.43	0.00	--	--	--	--	--	--
	05/04/98	7.15	72.79	0.00	--	--	--	--	--	--
	11/11/98	7.04	72.90	0.00	--	--	--	--	--	--
	05/20/99	7.00	72.94	0.00	--	--	--	--	--	--
	11/15/99	7.42	72.52	0.00	--	--	--	--	--	--
	05/22/00	7.24	72.70	0.00	--	--	--	--	--	--
MW-7	11/07/90	--	--	--	ND	ND	ND	ND	ND	--
	02/25/91	--	--	--	70	ND	ND	ND	0.52	--
	05/28/91	--	--	--	39	ND	ND	ND	0.73	--
	08/28/91	--	--	--	ND	ND	ND	ND	ND	--
	11/19/91	--	--	--	32	ND	ND	ND	ND	--
	02/06/92	--	--	--	ND	ND	ND	ND	ND	--
	05/23/92	--	--	--	ND	ND	ND	ND	ND	--
	08/26/92	--	--	--	ND	ND	ND	0.73	ND	--
	11/20/92	--	--	--	ND	ND	ND	ND	ND	--
81.83	12/21/92	8.42	73.41	0.00	--	--	--	--	--	--
	01/30/93	8.21	73.62	0.00	--	--	--	--	--	--
	02/24/93	7.85	73.98	0.00	ND	ND	ND	ND	ND	--
	03/22/93	6.97	74.86	0.00	--	--	--	--	--	--
	04/28/93	8.39	73.44	0.00	--	--	--	--	--	--
	05/25/93	8.43	73.40	0.00	ND	ND	ND	ND	ND	--
81.64	06/23/93	8.47	73.17	0.00	--	--	--	--	--	--
	07/22/93	8.83	72.81	0.00	--	--	--	--	--	--
	08/25/93	8.81	72.83	0.00	ND	ND	ND	ND	ND	--
	09/22/93	8.96	72.68	0.00	--	--	--	--	--	--
	10/28/93	8.98	72.66	0.00	--	--	--	--	--	--
	11/30/93	8.65	72.99	0.00	SAMPLED SEMI-ANNUALLY			--	--	--
	02/16/94	8.36	73.28	0.00	ND	ND	ND	ND	0.7	--
	05/31/94	8.67	72.97	0.00	--	--	--	--	--	--
	08/31/94	9.12	72.52	0.00	ND	ND	0.8	ND	0.75	--

Table 1
Groundwater Monitoring Data and Analytical Results
 Tosco (Unocal) Service Station #0746
 3943 Broadway
 Oakland, California

WELL ID/ TOC*	DATE	DTW (ft.)	GWE (mst)	Product Thickness (ft.)	TPH(G) (ppb)	B (ppb)	T (ppb)	E (ppb)	X (ppb)	MTBE (ppb)
MW-7	09/27/94	9.22	72.42	0.00	--	--	--	--	--	--
(cont)	10/11/94	9.23	72.41	0.00	--	--	--	--	--	--
	11/10/94	7.66	73.98	0.00	--	--	--	--	--	--
	02/07/95	7.88	73.76	0.00	ND	ND	ND	ND	ND	--
	05/03/95	7.71	73.93	0.00	ND	ND	ND	ND	1.0	--
	08/03/95	8.40	73.24	0.00	--	--	--	--	--	--
	11/07/95	8.95	72.69	0.00	ND	ND	ND	ND	ND	--
	05/06/96	8.15	73.49	0.00	--	--	--	--	--	--
	11/05/96	8.67	72.97	0.00	--	--	--	--	--	--
	05/15/97	8.47	73.17	0.00	--	--	--	--	--	--
	11/12/97	7.88	73.76	0.00	--	--	--	--	--	--
	05/04/98	7.93	73.71	0.00	--	--	--	--	--	--
	11/11/98	8.20	73.44	0.00	--	--	--	--	--	--
	05/20/99	8.04	73.60	0.00	--	--	--	--	--	--
	11/15/99	8.17	73.47	0.00	--	--	--	--	--	--
NP	05/22/00	8.10	73.54	0.00	--	--	--	--	--	--
MW-8	11/07/90	--	--	--	4,700	28	38	86	7,200	--
	02/25/91	--	--	--	5,300	17	6.1	53	300	--
	05/28/91	--	--	--	4,800	4.2	1.3	5.1	170	--
	08/28/91	--	--	--	1,800	3.2	1.9	19	74	--
	11/19/91	--	--	--	1,600	8.1	1.8	19	52	--
	02/06/92	--	--	--	2,600	4.1	7.0	31	93	--
	05/23/92	--	--	--	2,100	8.6	1.6	1.7	28	--
	08/26/92	--	--	--	1,800	12	8.0	4.0	13	--
	11/20/92	INACCESSIBLE	--	--	--	--	--	--	--	--
81.71	12/21/92	INACCESSIBLE	--	--	--	--	--	--	--	--
	01/09/93	INACCESSIBLE	--	--	--	--	--	--	--	--
	01/30/93	INACCESSIBLE	--	--	--	--	--	--	--	--
	02/10/93	INACCESSIBLE	--	--	--	--	--	--	--	--
	02/24/93	INACCESSIBLE	--	--	--	--	--	--	--	--
	03/09/93	INACCESSIBLE	--	--	--	--	--	--	--	--

Table 1
Groundwater Monitoring Data and Analytical Results
 Tosco (Unocal) Service Station #0746
 3943 Broadway
 Oakland, California

WELL ID/ TOC*	DATE	DTW (ft.)	GWE (msl)	Product						
				Thickness (ft.)	TPH(G) (ppb)	B (ppb)	T (ppb)	E (ppb)	X (ppb)	MTBE (ppb)
MW-8	03/22/93	INACCESSIBLE	--	--	--	--	--	--	--	--
(cont)	04/08/93	INACCESSIBLE	--	--	--	--	--	--	--	--
	04/28/93	INACCESSIBLE	--	--	--	--	--	--	--	--
	05/12/93	INACCESSIBLE	--	--	--	--	--	--	--	--
	05/25/93	10.12	71.59	0.00	1,200	5.4	ND	9.0	21	--
81.41	06/07/93	9.98	71.43	0.00	--	--	--	--	--	--
	06/23/93	10.36	71.05	0.00	--	--	--	--	--	--
	07/08/93	10.52	70.89	0.00	--	--	--	--	--	--
	07/22/93	INACCESSIBLE	--	--	--	--	--	--	--	--
	08/11/93	INACCESSIBLE	--	--	--	--	--	--	--	--
	08/25/93	10.95	70.46	0.00	1,800	11	17	8.9	29	--
	09/08/93	11.34	70.07	0.00	--	--	--	--	--	--
	09/22/93	11.13	70.28	0.00	--	--	--	--	--	--
	10/07/93	10.96	70.45	0.00	--	--	--	--	--	--
	10/28/93	11.19	70.22	0.00	--	--	--	--	--	--
	11/12/93	INACCESSIBLE	--	--	--	--	--	--	--	--
	11/30/93	10.42	70.99	0.00	3,500	18	ND	ND	ND	--
	02/16/94	9.86	71.55	0.00	990	4.9	1.8	2.4	4.5	--
	05/31/94	10.61	70.80	0.00	350	3.0	1.0	0.73	1.7	--
	08/31/94	11.37	70.04	0.00	1,800 ¹	ND	ND	ND	ND	--
	09/27/94	INACCESSIBLE (PARKED OVER)	--	--	--	--	--	--	--	--
	10/11/94	11.50	69.91	0.00	--	--	--	--	--	--
	11/10/94	7.81	73.60	0.00	940	6.7	6.3	ND	16	--
	02/07/95	8.69	72.72	0.00	230	1.4	0.95	0.9	1.1	--
	05/03/95	8.60	72.81	0.00	75	ND	ND	ND	1.0	--
	08/03/95	INACCESSIBLE (PARKED OVER)	--	--	--	--	--	--	--	--
	11/07/95	11.05	70.36	0.00	210	1.3	1.2	ND	ND	-- ³
	05/06/96	INACCESSIBLE (PARKED OVER)	--	--	--	--	--	--	--	--
	11/05/96	INACCESSIBLE (PARKED OVER)	--	--	--	--	--	--	--	--
	05/15/97	10.46	70.95	0.00	ND	ND	ND	ND	ND	43
	11/12/97	INACCESSIBLE (PARKED OVER)	--	--	--	--	--	--	--	--
	05/04/98	INACCESSIBLE (PARKED OVER)	--	--	--	--	--	--	--	--
	11/11/98	INACCESSIBLE (PARKED OVER)	--	--	--	--	--	--	--	--

Table 1
Groundwater Monitoring Data and Analytical Results
 Tosco (Unocal) Service Station #0746
 3943 Broadway
 Oakland, California

WELL ID/ TOC*	DATE	DTW (ft.)	GWE (msl)	Product Thickness (ft.)	TPH(G) (ppb)	B (ppb)	T (ppb)	E (ppb)	X (ppb)	MTBE (ppb)
MW-8	NP 05/20/99	9.75	71.66	0.00	ND	ND	ND	ND	ND	23/10 ^{7,8,10}
(cont)	11/15/99	INACCESSIBLE (PARKED OVER)		--	--	--	--	--	--	--
	NP 05/22/00	9.80	71.61	0.00	ND	ND	1.9	ND	3.3	ND
MW-9	11/07/90	--	--	--	480	7.8	1.2	13	47	--
	02/25/91	--	--	--	390	13	1.1	2.8	14	--
	05/28/91	--	--	--	590	6.0	0.43	6.8	1.4	--
	08/28/91	--	--	--	450	17	0.9	13	14	--
	11/19/91	--	--	--	360	17	0.45	15	11	--
	02/06/92	--	--	--	660	41	1.0	33	15	--
	05/23/92	--	--	--	460	18	0.66	1.4	3.2	--
	08/26/92	--	--	--	250	13	ND	8.6	3.8	--
	11/20/92	INACCESSIBLE		--	--	--	--	--	--	--
81.13	12/21/92	INACCESSIBLE		--	--	--	--	--	--	--
	01/30/93	INACCESSIBLE		--	--	--	--	--	--	--
	02/24/93	INACCESSIBLE		--	--	--	--	--	--	--
	03/22/93	INACCESSIBLE		--	--	--	--	--	--	--
	04/28/93	INACCESSIBLE		--	--	--	--	--	--	--
	05/25/93	11.50	69.63	0.00	160	6.1	ND	7.4	1.1	--
80.53	06/23/93	9.78	70.75	0.00	--	--	--	--	--	--
	07/22/93	10.10	70.43	0.00	--	--	--	--	--	--
	08/25/93	10.44	70.09	0.00	220	10	ND	6.8	1.4	--
	09/22/93	10.64	69.89	0.00	--	--	--	--	--	--
	10/28/93	10.68	69.85	0.00	--	--	--	--	--	--
	11/30/93	9.87	70.66	0.00	200	5.6	ND	2.9	2.7	--
	02/16/94	9.21	71.32	0.00	250	5.1	1.3	4.4	1.5	--
	05/31/94	10.15	70.38	0.00	360	7.8	0.97	4.6	2.2	--
	08/31/94	10.97	69.56	0.00	650	7.7	2.8	4.4	5.0	59
	09/27/94	11.10	69.43	0.00	--	--	--	--	--	--
	10/11/94	11.20	69.33	0.00	--	--	--	--	--	--
	11/10/94	7.25	73.28	0.00	ND	ND	ND	ND	ND	--
	02/07/95	7.76	72.77	0.00	57	0.7	ND	0.86	ND	--

Table 1
Groundwater Monitoring Data and Analytical Results
 Tosco (Unocal) Service Station #0746
 3943 Broadway
 Oakland, California

WELL ID/ TOC*	DATE	DTW (ft.)	GWE (msl)	Product Thickness (ft.)	TPH(G) (ppb)	B (ppb)	T (ppb)	E (ppb)	X (ppb)	MTBE (ppb)
MW-9	05/03/95	7.82	72.71	0.00	ND	0.85	0.67	1.3	1.0	--
(cont)	08/03/95	9.70	70.83	0.00	91	1.1	ND	ND	ND	--
	11/07/95	10.64	69.89	0.00	130	1.5	0.62	0.71	ND	60 ³
	05/06/96	9.01	71.52	0.00	860	6.1	13	6.0	25	ND
	11/05/96	11.42	69.11	0.00	84	0.74	ND	1.2	4.5	ND
	05/15/97	9.89	70.64	0.00	ND	ND	ND	ND	ND	ND
	11/12/97	10.22	70.31	0.00	ND	0.55	ND	ND	ND	74
NP	05/04/98	10.05	70.48	0.00	ND	ND	ND	ND	ND	45
NP	11/11/98	9.23	71.30	0.00	ND	ND	ND	ND	ND	ND
NP	05/20/99	8.78	71.75	0.00	ND	ND	ND	ND	ND	ND
	11/15/99	9.12	71.41	0.00	ND	ND	ND	ND	ND	ND
	05/22/00	9.17	71.36	0.00	ND	ND	1.9	ND	3.5	ND
MW-10	02/06/92	--	--	--	ND	ND	ND	ND	ND	--
	05/23/92	--	--	--	ND	ND	ND	ND	ND	--
	08/26/92	--	--	--	ND	ND	ND	ND	ND	--
	11/20/92	--	--	--	ND	ND	ND	ND	ND	--
81.90	12/21/92	13.41	68.49	0.00	--	--	--	--	--	--
	01/30/93	11.60	70.30	0.00	--	--	--	--	--	--
	02/24/93	11.23	70.67	0.00	ND	ND	ND	ND	ND	--
	03/22/93	10.89	71.01	0.00	--	--	--	--	--	--
	04/28/93	12.11	69.79	0.00	--	--	--	--	--	--
	05/25/93	12.02	69.88	0.00	ND	ND	ND	ND	ND	--
81.61	06/23/93	12.11	69.50	0.00	--	--	--	--	--	--
	07/22/93	12.49	69.12	0.00	--	--	--	--	--	--
	08/25/93	12.78	68.83	0.00	ND	ND	ND	ND	ND	--
	09/22/93	13.06	68.55	0.00	--	--	--	--	--	--
	10/28/93	13.23	68.38	0.00	--	--	--	--	--	--
	11/30/93	INACCESSIBLE	--	--	--	--	--	--	--	--
	02/16/94	12.43	69.18	0.00	ND	ND	ND	ND	ND	--
	05/31/94	12.69	68.92	0.00	ND	ND	0.9	ND	0.91	--
	08/31/94	13.47	68.14	0.00	ND	ND	0.64	ND	0.54	--

Table 1
Groundwater Monitoring Data and Analytical Results
 Tosco (Unocal) Service Station #0746
 3943 Broadway
 Oakland, California

WELL ID/ TOC*	DATE	DTW (ft.)	GWE (msl)	Product Thickness (ft.)	TPH(G) (ppb)	B (ppb)	T (ppb)	E (ppb)	X (ppb)	MTBE (ppb)
MW-10	09/27/94	13.72	67.89	0.00	--	--	--	--	--	--
(cont)	10/11/94	14.80	66.81	0.00	--	--	--	--	--	--
	11/10/94	12.64	68.97	0.00	ND	ND	ND	ND	ND	--
	02/07/95	10.29	71.32	0.00	SAMPLED SEMI-ANNUALLY		--	--	--	--
	05/03/95	10.22	71.39	0.00	ND	ND	ND	ND	0.65	--
	08/03/95	11.73	69.88	0.00	--	--	--	--	--	--
	11/07/95	12.98	68.63	0.00	ND	ND	ND	ND	ND	--
	05/06/96	10.90	70.71	0.00	SAMPLING DISCONTINUED ⁴		--	--	--	--
	11/05/96	11.96	69.65	0.00	--	--	--	--	--	--
	05/15/97	10.79	70.82	0.00	--	--	--	--	--	--
	11/12/97	10.07	71.54	0.00	--	--	--	--	--	--
	05/04/98	10.01	71.60	0.00	--	--	--	--	--	--
	11/11/98	12.03	69.58	0.00	--	--	--	--	--	--
	05/20/99	10.05	71.56	0.00	--	--	--	--	--	--
	11/15/99	10.16	71.45	0.00	--	--	--	--	--	--
	05/22/00	10.06	71.55	0.00	--	--	--	--	--	--
MW-11	02/06/92	--	--	--	ND	ND	ND	ND	ND	--
	05/23/92	--	--	--	ND	ND	ND	ND	ND	--
	08/26/92	--	--	--	ND	ND	ND	ND	ND	--
	11/20/92	--	--	--	ND	ND	ND	ND	ND	--
78.43	12/21/92	12.34	66.09	0.00	--	--	--	--	--	--
	01/30/93	14.17	64.26	0.00	--	--	--	--	--	--
	02/24/93	12.70	65.73	0.00	ND	ND	ND	ND	ND	--
	03/22/93	8.95	69.48	0.00	--	--	--	--	--	--
	04/28/93	13.87	64.56	0.00	--	--	--	--	--	--
	05/25/93	15.14	63.29	0.00	ND	ND	0.75	ND	1.0	--
78.18	06/23/93	15.08	63.10	0.00	--	--	--	--	--	--
	07/22/93	15.46	62.72	0.00	--	--	--	--	--	--
	08/25/93	14.10	64.08	0.00	ND	ND	ND	ND	ND	--
	09/22/93	15.03	63.15	0.00	--	--	--	--	--	--
	10/28/93	13.84	64.34	0.00	--	--	--	--	--	--

Table 1
Groundwater Monitoring Data and Analytical Results
 Tosco (Unocal) Service Station #0746
 3943 Broadway
 Oakland, California

WELL ID/ TOC*	DATE	DTW (ft.)	GWE (mst)	Product Thickness (ft.)	TPH(G) (ppb)	B (ppb)	T (ppb)	E (ppb)	X (ppb)	MTBE (ppb)
MW-11	11/30/93	13.04	65.14	0.00	ND	ND	ND	ND	ND	--
(cont)	02/16/94	12.76	65.42	0.00	ND	ND	ND	ND	ND	--
	05/31/94	12.79	65.39	0.00	ND	ND	ND	ND	ND	--
	08/31/94	12.97	65.21	0.00	ND	ND	1.5	ND	1.8	--
	09/27/94	14.88	63.30	0.00	--	--	--	--	--	--
	10/11/94	13.40	64.78	0.00	--	--	--	--	--	--
	11/10/94	13.57	64.61	0.00	ND	ND	ND	ND	ND	--
	02/07/95	12.28	65.90	0.00	SAMPLED SEMI-ANNUALLY		--	--	--	--
	05/03/95	9.28	68.90	0.00	ND	ND	ND	ND	ND	--
	08/03/95	12.67	65.51	0.00	--	--	--	--	--	--
	11/07/95	12.28	65.90	0.00	ND	ND	ND	ND	ND	--
	05/06/96	13.30	64.88	0.00	SAMPLING DISCONTINUED ⁴		--	--	--	--
	11/05/96	10.90	67.28	0.00	--	--	--	--	--	--
	05/15/97	11.65	66.53	0.00	--	--	--	--	--	--
	11/12/97	9.66	68.52	0.00	--	--	--	--	--	--
	05/04/98	10.87	67.31	0.00	--	--	--	--	--	--
	11/11/98	11.40	66.78	0.00	--	--	--	--	--	--
NP	05/20/99	10.71	67.47	0.00	ND	ND	ND	ND	ND	ND
	11/15/99	11.32	66.86	0.00	ND	ND	1.04	ND	ND	ND
	05/22/00	10.98	67.20	0.00	ND	ND	ND	ND	ND	ND
MW-12	08/26/92	--	--	--	ND	ND	ND	ND	ND	--
	11/20/92	--	--	--	ND	ND	ND	ND	ND	--
79.89	12/21/92	12.11	67.78	0.00	--	--	--	--	--	--
	01/30/93	13.18	66.71	0.00	--	--	--	--	--	--
	02/24/93	12.13	67.76	0.00	ND	ND	ND	ND	ND	--
	03/22/93	11.22	68.67	0.00	--	--	--	--	--	--
	04/28/93	13.42	66.47	0.00	--	--	--	--	--	--
	05/25/93	13.68	66.21	0.00	ND	ND	ND	ND	ND	--
79.61	06/23/93	14.56	65.05	0.00	--	--	--	--	--	--
	07/22/93	14.96	64.65	0.00	--	--	--	--	--	--
	08/25/93	13.61	66.00	0.00	ND	ND	ND	ND	ND	--

Table 1
Groundwater Monitoring Data and Analytical Results
 Tosco (Unocal) Service Station #0746
 3943 Broadway
 Oakland, California

WELL ID/ TOC*	DATE	DTW (ft.)	GWE (msl)	Product Thickness (ft.)	TPH(G) (ppb)	B (ppb)	T (ppb)	E (ppb)	X (ppb)	MTBE (ppb)
MW-12	09/22/93	15.02	64.59	0.00	--	--	--	--	--	--
(cont)	10/28/93	14.04	65.57	0.00	--	--	--	--	--	--
	11/30/93	13.28	66.33	0.00	ND	ND	ND	ND	ND	--
	02/16/94	12.76	66.85	0.00	ND	ND	ND	ND	ND	--
	08/31/94	12.82	66.79	0.00	ND	ND	1.0	ND	1.0	ND
	05/31/94	12.64	66.97	0.00	ND	ND	0.81	ND	0.82	--
	09/27/94	14.66	64.95	0.00	--	--	--	--	--	--
	10/11/94	14.25	65.36	0.00	--	--	--	--	--	--
	11/10/94	13.40	66.21	0.00	ND	ND	ND	ND	ND	--
	02/07/95	11.72	67.89	0.00	SAMPLED SEMI-ANNUALLY			--	--	--
	05/03/95	13.38	66.23	0.00	ND	ND	ND	ND	ND	--
	08/03/95	13.47	66.14	0.00	--	--	--	--	--	--
	11/07/95	12.78	66.83	0.00	ND	ND	ND	ND	ND	--
	05/06/96	13.25	66.36	0.00	SAMPLING DISCONTINUED ⁴			--	--	--
	11/05/96	11.88	67.73	0.00	--	--	--	--	--	--
	05/15/97	11.72	67.89	0.00	--	--	--	--	--	--
	11/12/97	10.01	69.60	0.00	--	--	--	--	--	--
	05/04/98	10.96	68.65	0.00	--	--	--	--	--	--
	11/11/98	11.53	68.08	0.00	--	--	--	--	--	--
	05/20/99	10.84	68.77	0.00	--	--	--	--	--	--
	11/15/99	11.36	68.25	0.00	--	--	--	--	--	--
	05/22/00	11.19	68.42	0.00	--	--	--	--	--	--
RW-1										
81.20	02/24/93	7.19	74.01	0.00	--	--	--	--	--	--
	05/12/93	8.82	72.38	0.00	--	--	--	--	--	--
	05/25/93	8.58	72.62	0.00	--	--	--	--	--	--
80.63	06/07/93	8.16	72.47	0.00	--	--	--	--	--	--
	06/23/93	8.53	72.10	0.00	--	--	--	--	--	--
	07/08/93	8.69	71.94	0.00	--	--	--	--	--	--
	08/11/93	9.00	71.63	0.00	--	--	--	--	--	--
	08/25/93	9.07	71.56	0.00	--	--	--	--	--	--

Table 1
Groundwater Monitoring Data and Analytical Results
 Tosco (Unocal) Service Station #0746
 3943 Broadway
 Oakland, California

WELL ID/ TOC*	DATE	DTW (ft.)	GWE (msl)	Product						
				Thickness (ft.)	TPH(G) (ppb)	B (ppb)	T (ppb)	E (ppb)	X (ppb)	MTBE (ppb)
RW-1	09/08/93	9.71	70.92	0.00	--	--	--	--	--	--
(cont)	09/22/93	9.25	71.38	0.00	--	--	--	--	--	--
	11/12/93	9.00	71.63	<0.01	--	--	--	--	--	--
	02/16/94	7.82	72.81	0.00	--	--	--	--	--	--
	05/31/94	8.81	71.82	0.00	--	--	--	--	--	--
	08/31/94	9.61	71.02	0.00	--	--	--	--	--	--
	11/10/94	6.34	74.29	0.00	--	--	--	--	--	--
	02/07/95	7.18	73.45	0.00	--	--	--	--	--	--
	03/14/95	6.01	74.62	0.00	--	--	--	--	--	--
Trip Blank										
TB-LB	05/04/98	--	--	--	ND	ND	ND	ND	ND	ND
	11/11/98	--	--	--	ND	ND	ND	ND	ND	ND
	05/20/99	--	--	--	ND	ND	ND	ND	ND	ND
	11/15/99	--	--	--	ND	ND	1.12	ND	ND	ND
	05/22/00	--	--	--	ND	ND	ND	ND	ND	ND

Table 1
Groundwater Monitoring Data and Analytical Results
 Tosco (Unocal) Service Station #0746
 3943 Broadway
 Oakland, California

EXPLANATIONS:

Groundwater monitoring data and laboratory analytical results prior to May 4, 1998, were compiled from reports prepared by MPDS Services, Inc.

TOC = Top of Casing	B = Benzene	ppb = Parts per billion
DTW = Depth to Water	T = Toluene	ND = Not Detected
(ft.) = Feet	E = Ethylbenzene	-- = Not Measured/Not Analyzed
GWE = Groundwater Elevation	X = Xylenes	NP = No Purge
msl = Relative to mean sea level	MTBE = Methyl tertiary butyl ether	
TPH(G) = Total Petroleum Hydrocarbons as Gasoline		

- * TOC elevations have been surveyed relative to mean sea level (msl) per the City of Oakland Benchmark BM#1336 (Elevation = 82.28 feet msl).
 Prior to June 7, 1993, DTW measurements were taken from the top of well covers.
- ** Groundwater elevation corrected due to the presence of free product; correction factor: $[(TOC-DTW)+(Product\ Thickness\ x\ 0.75)]$.
- ¹ Laboratory report indicates the hydrocarbons detected did not appear to be gasoline.
- ² Laboratory report indicates the hydrocarbons detected appeared to be a gasoline and non-gasoline mixture.
- ³ Laboratory has identified the presence of MTBE at a level greater than or equal to the taste and odor threshold of 40 ppb in the sample collected from this well.
- ⁴ Sampling discontinued per Alameda County Health Care Services' letter dated January 24, 1996.
- ⁵ Detection limit raised. Refer to analytical reports.
- ⁶ Twelve minutes after water/product was bailed, well was monitored again, (DTW = 8.06 ft. and Product Thickness 0.04 ft.).
- ⁷ MTBE by EPA Method 8260.
- ⁸ Sample analyzed past hold time (June 9, 1999).
- ⁹ First run on MTBE by EPA Method 8260 was 92 ppb and analyzed past hold time (June 9, 1999).
- ¹⁰ First run on MTBE by EPA Method 8260 was 12 ppb and analyzed past hold time (June 9, 1999).
- ¹¹ Laboratory report indicates gasoline C6-C12.
- ¹² MTBE by EPA Method 8260 analyzed outside the EPA recommended holding time.
- ¹³ Less than 1 ounce of product found in skimmer.
- ¹⁴ 1.5 ounces of product found in skimmer.

Table 2
Dissolved Oxygen Concentrations
 Tosco (Unocal) Service Station #0746
 3943 Broadway
 Oakland, California

WELL ID	DATE	Before Purging (mg/L)	After Purging (mg/L)
MW-1	05/06/96	5.21	4.13
	11/05/96	3.12	-- ¹
	05/15/97	3.92	-- ¹
	11/12/97	4.16	-- ¹
	05/04/98	3.84	-- ¹
	11/11/98	2.85	-- ¹
	05/20/99	3.30	-- ¹
MW-2	08/19/95	--	2.77
	05/15/97	3.01	-- ¹
	11/12/97	3.27	-- ¹
	05/04/98	3.63	-- ¹
MW-3	08/19/95	--	2.06
	11/07/95	--	1.68
	05/06/96	3.18	3.40
	11/05/96	2.03	-- ¹
	05/15/97	3.08	-- ¹
	05/04/98	2.98	-- ¹
	11/11/98	2.22	-- ¹
MW-4	05/20/99	2.60	-- ¹
	08/19/95	--	2.19
	11/07/95	--	8.43
	05/06/96	3.75	5.97
	11/05/96	2.11	-- ¹
	05/15/97	3.24	-- ¹
	11/12/97	3.11	-- ¹
	05/04/98	3.73	-- ¹
	11/11/98	4.33	-- ¹
05/20/99	3.90	-- ¹	
MW-5	08/19/95	--	2.09
	11/07/95	--	1.79
	05/06/96	2.91	1.80
	11/05/96	1.85	-- ¹
	05/15/97	2.10	-- ¹
	11/12/97	1.98	-- ¹
	05/04/98	1.69	-- ¹
MW-6	05/15/97	2.90	-- ¹
	05/04/98	3.57	-- ¹

Table 2
Dissolved Oxygen Concentrations
 Tosco (Unocal) Service Station #0746
 3943 Broadway
 Oakland, California

WELL ID	DATE	Before Purging (mg/L)	After Purging (mg/L)
MW-7	05/15/97	2.21	-- ¹
	05/04/98	3.09	-- ¹
MW-8	11/05/96	INACCESSIBLE (PARKED OVER)	
	05/15/97	2.88	-- ¹
	11/12/97	INACCESSIBLE (PARKED OVER)	
	05/04/98	INACCESSIBLE (PARKED OVER)	
	11/11/98	INACCESSIBLE (PARKED OVER)	
	05/20/99	3.55	-- ¹
MW-9	05/06/96	4.23	3.25
	11/05/96	2.98	-- ¹
	05/15/97	3.04	-- ¹
	11/12/97	4.02	-- ¹
	05/04/98	3.41	-- ¹
	11/11/98	5.19	-- ¹
	05/20/99	4.46	-- ¹
MW-10	05/15/97	1.61	-- ¹
	05/04/98	2.85	-- ¹
MW-11	05/15/97	1.68	-- ¹
	05/04/98	2.94	-- ¹
	05/20/99	3.22	-- ¹
MW-12	05/15/97	2.10	-- ¹
	05/04/98	3.41	-- ¹
RW-1	11/07/95	--	2.13

EXPLANATIONS:

Dissolved oxygen concentrations prior to May 4, 1998, were compiled from reports prepared by MPDS Services, Inc.

mg/L = milligrams per liter

-- = Not Measured

¹ Wells were not purged prior to sampling.

Note : Measurements were taken using a LaMotte DO4000 dissolved oxygen meter.

Table 3
Product Thickness/Removal Data
 Tosco (Unocal) Service Station #0746
 3943 Broadway
 Oakland, California

WELL ID	DATE	DTW (ft.)	Product Thickness (ft.)	Amount Bailed		Amount Bailed (Product + Water)
				Product	Water	
MW-5	11/11/98	9.23	0.37	--	--	0.25 gallons
	02/22/99	7.69	0.25	5 oz.	3 gallons	--
	04/02/99 ^{1,2}	8.19	0.28	9 oz.	20 oz.	29 oz.
	05/04/99	8.44	0.01	--	--	--
	05/20/99	8.73	0.04	--	--	1 oz.
	06/29/99	8.91	0.05	--	--	4 oz.
	07/29/99	9.12	0.07	4 oz.	8 oz.	12 oz.
	08/24/99	9.37	0.09	--	--	4 oz.
	09/27/99	9.51	0.06	--	--	3.5 oz.
	10/28/99 ³	--	0.05	--	--	3.0 oz.
	11/15/99	9.29	Sheen	--	--	16 oz.
	12/20/99	9.14	0.00	-- ⁴	--	<1.0 oz
	01/20/00	9.08	0.00	-- ⁴	--	<1.0 oz
	02/26/00	8.69	0.00	-- ⁴	--	<1.0 oz
	03/31/00	8.48	0.00	-- ⁴	--	<1.0 oz
	04/13/00	8.66	0.00	0.00	0.00	0.00
	05/22/00	9.06	0.00	-- ⁵	--	1.5 oz.

EXPLANATIONS:

DTW = Depth to water

(ft.) = Feet

oz. = ounces

-- = Not Measured

¹ A new skimmer (Petro Trap) was installed.

² Twelve minutes after water/product was bailed, well was monitored again, (DTW = 8.06 ft. and Product Thickness 0.04 ft.).

³ Replaced skimmer.

⁴ Less than 1 oz. Of product found in skimmer.

⁵ 1.5 oz. of product found in skimmer.

Table 4
Groundwater Analytical Results - Oxygenate Compounds
 Tosco (Unocal) Service Station #0746
 3943 Broadway
 Oakland, California

WELL ID	DATE	ETHANOL (ppb)	TBA (ppb)	MTBE (ppb)	DIPE (ppb)	ETBE (ppb)	TAME (ppb)
MW-1	05/20/99 ^{1,3}	ND	ND	² 92/47	ND	ND	ND
	11/15/99 ⁴	ND	ND	7.19	ND	ND	ND
	05/22/00 ⁴	ND	130	290	ND	ND	ND
MW-3	05/22/00 ⁴	ND	ND	94	ND	ND	ND
MW-5	05/22/00 ⁴	ND ⁵	ND ⁵	21	ND ⁵	ND ⁵	ND ⁵
MW-8	05/20/99 ^{1,3}	ND	ND	² 12/10	ND	ND	ND
	11/15/99 ⁴	ND ⁵	ND ⁵	45.1	ND ⁵	ND ⁵	ND ⁵

EXPLANATIONS:

TBA = Tertiary butyl alcohol
 MTBE = Methyl tertiary butyl ether
 DIPE = Di-isopropyl ether
 ETBE = Ethyl tertiary butyl ether
 TAME = Tertiary amyl methyl ether
 ppb = Parts per billion
 ND = Not Detected

- ¹ Analyzed past hold time (June 9, 1999).
- ² First run MTBE was for qualitative use only.
- ³ Report revised July 6, 1999.
- ⁴ Laboratory report indicates sample was analyzed past holding time.
- ⁵ Detection limit raised. Refer to analytical reports.

ANALYTICAL METHOD:

EPA Method 8260 for Oxygenate Compounds

STANDARD OPERATING PROCEDURE - GROUNDWATER SAMPLING

Gettler-Ryan Inc. field personnel adhere to the following procedures for the collection and handling of groundwater samples prior to analysis by the analytical laboratory. Prior to sample collection, the type of analysis to be performed is determined. Loss prevention of volatile compounds is controlled and sample preservation for subsequent analysis is maintained.

Prior to sampling, the presence or absence of free-phase hydrocarbons is determined using an interface probe. Product thickness, if present, is measured to the nearest 0.01 foot and is noted in the field notes. In addition, static water level measurements are collected with the interface probe and are also recorded in the field notes.

After water levels are collected and prior to sampling, temperature, pH and electrical conductivity are measured. If purging is to occur, each well is purged a minimum of three well casing volumes of water using pre-cleaned pumps (stack, suction, Grundfos), or polyvinyl chloride bailers. The measurements are taken a minimum of three times during the purging. Purging continues until these parameters stabilize.

Groundwater samples are collected using disposable bailers. The water samples are transferred from the bailer into appropriate containers. Pre-preserved containers, supplied by analytical laboratories, are used when possible. When pre-preserved containers are not available, the laboratory is instructed to preserve the sample as appropriate. Duplicate samples are collected for the laboratory to use in maintaining quality assurance/quality control standards. The samples are labeled to include the job number, sample identification, collection date and time, analysis, preservation (if any), and the sample collector's initials. The water samples are placed in a cooler, maintained at 4°C for transport to the laboratory. Once collected in the field, all samples are maintained under chain of custody until delivered to the laboratory.

The chain of custody document includes the job number, type of preservation, if any, analysis requested, sample identification, date and time collected, and the sample collector's name. The chain of custody is signed and dated (including time of transfer) by each person who receives or surrenders the samples, beginning with the field personnel and ending with the laboratory personnel.

A laboratory supplied trip blank accompanies each sampling set. For sampling sets greater than 20 samples, 5% trip blanks are included. The trip blank is analyzed for some or all of the same compounds as the groundwater samples.

As requested by Tosco Marketing Company, the purge water and decontamination water generated during sampling activities is transported to Tosco - San Francisco Area Refinery, located in Rodeo, California.

**TOSCO (UNOCAL) SS #0746
OAKLAND, CA**

**MONITORING
EVENT OF DECEMBER 20, 1999**

**WELL MONITORING/SAMPLING
FIELD DATA SHEET**

Client/
Facility # 0746
Address: 3943 Broadway
City: Oakland, CA.

Job#: 180063
Date: 12-20-99
Sampler: Soc

Well ID MW-5
Well Diameter 2 in.
Total Depth 20.18 ft.
Depth to Water 9.14 ft.

Well Condition: O.K.

Hydrocarbon Thickness:	<u>0</u> (feet)	Amount Bailed (product/water):	<u>< than 1 ounce of FP in 100 gallons</u> (Gallons) Skimmer
Volume Factor (VF)	2" = 0.17	3" = 0.38	4" = 0.66
	6" = 1.50	12" = 5.80	

_____ X VF _____ = _____ X 3 (case volume) = Estimated Purge Volume: _____ (gal.)

Purge Equipment: Disposable Bailer
Bailer
Stack
Suction
Grundfos
Other: _____

Sampling Equipment: Disposable Bailer
Bailer
Pressure Bailer
Grab Sample
Other: _____

Starting Time: _____ Weather Conditions: _____
Sampling Time: _____ Water Color: _____ Odor: _____
Purging Flow Rate: _____ gpm. Sediment Description: _____
Did well de-water? _____ If yes; Time: _____ Volume: _____ (gal.)

Time	Volume (gal.)	pH	Conductivity μ mhos/cm	Temperature $^{\circ}$ F	D.O. (mg/L)	ORP (mV)	Alkalinity (ppm)

LABORATORY INFORMATION

SAMPLE ID	(#) - CONTAINER	REFRIG.	PRESERV. TYPE	LABORATORY	ANALYSES
		<u>Y</u>		<u>SEQUOIA</u>	<u>TPHIG/btex/mtbe</u>

COMMENTS: Less than 1 ounce of FP found in 100 gallon skimmer.
No product found in well.

**TOSCO (UNOCAL) SS #0746
OAKLAND, CA**

**MONITORING
EVENT OF JANUARY 20, 2000**

**WELL MONITORING/SAMPLING
FIELD DATA SHEET**

Client/
Facility #0746
Address: 3943 Broadway
City: Oakland, CA.

Job#: 180063
Date: 1-20-00
Sampler: Joc

Well ID mw-5
Well Diameter 2 in.
Total Depth 20.18 ft.
Depth to Water 9.08 ft.

Well Condition: O.K.
Hydrocarbon Thickness: 0 (feet)
Amount Bailed (product/water): 0 (Gallons)
< than 1 ounce of FP found in skimmer.

Volume Factor (VF)	2" = 0.17	3" = 0.38	4" = 0.66
	6" = 1.50	12" = 5.80	

_____ X VF _____ = _____ X 3 (case volume) = Estimated Purge Volume: _____ (gal.)

Purge Equipment: Disposable Bailer
Bailer
Stack
Suction
Grundfos
Other: _____

Sampling Equipment: Disposable Bailer
Bailer
Pressure Bailer
Grab Sample
Other: _____

Starting Time: _____
Sampling Time: _____
Purging Flow Rate: _____ gpm.
Did well de-water? _____

Weather Conditions: _____
Water Color: _____ Odor: _____
Sediment Description: _____
If yes; Time: _____ Volume: _____ (gal.)

Time	Volume (gal.)	pH	Conductivity μ mhos/cm	Temperature $^{\circ}$ F	D.O. (mg/L)	ORP (mV)	Alkalinity (ppm)

LABORATORY INFORMATION

SAMPLE ID	(#) - CONTAINER	REFRIG.	PRESERV. TYPE	LABORATORY	ANALYSES
		Y		SEQUOIA	TPH(G)/btex/mtbe

COMMENTS: < than 1 ounce of FP found in skimmer. No product in well itself.

**TOSCO (UNOCAL) SS #0746
OAKLAND, CA**

**MONITORING
EVENT OF FEBRUARY 26, 2000**

**WELL MONITORING/SAMPLING
FIELD DATA SHEET**

Client/
Facility # 0746
Address: 3943 Broadway
City: Oakland

Job#: 180063
Date: 2-26-00
Sampler: Joe

Well ID mw-5
Well Diameter 2 in.
Total Depth 20.18 ft.
Depth to Water 8.69 ft.

Well Condition: O.K.
Hydrocarbon Thickness: 0 (feet) Amount Bailed < than 1 ounce of FF found in skimmer (product/water): (Gallons)

Volume Factor (VF)	2" = 0.17	3" = 0.38	4" = 0.66
	6" = 1.50	12" = 5.80	

_____ X VF _____ = _____ X 3 (case volume) = Estimated Purge Volume: _____ (gal.)

Purge Equipment: Disposable Bailer
Bailer
Stack
Suction
Grundfos
Other: _____

Sampling Equipment: Disposable Bailer
Bailer
Pressure Bailer
Grab Sample
Other: _____

Starting Time: _____
Sampling Time: _____
Purging Flow Rate: _____ gpm.
Did well de-water? _____

Weather Conditions: _____
Water Color: _____ Odor: _____
Sediment Description: _____
If yes; Time: _____ Volume: _____ (gal.)

Time	Volume (gal.)	pH	Conductivity μ mhos/cm	Temperature $^{\circ}$ F	D.O. (mg/L)	ORP (mV)	Alkalinity (ppm)

LABORATORY INFORMATION

SAMPLE ID	(#) - CONTAINER	REFRIG.	PRESERV. TYPE	LABORATORY	ANALYSES
				SECQUOTA	TPH(GI)/benc/mtbs

COMMENTS: No product itself was found in well. Very little in the skimmer. Took FP to lab in an amber bottle.

**TOSCO (UNOCAL) SS #0746
OAKLAND, CA**

**MONITORING
EVENT OF MARCH 31, 2000**

WELL MONITORING/SAMPLING FIELD DATA SHEET

Client/
Facility # 0746
Address: 3943 Broadway
City: Oakland

Job#: 180063
Date: 3-31-00
Sampler: Joe

Well ID: MW-5
Well Diameter: 2 in.
Total Depth: 20.18 ft.
Depth to Water: 8.48 ft.

Well Condition: O.K.
Amount Bailed (none in well) < than 1 ounce of FP in skin

Hydrocarbon Thickness:	<u>0</u> in.	Amount Bailed (product/water):	<u>(none in well)</u> (gal.)
Volume Factor (VF)	2" = 0.17	3" = 0.38	4" = 0.66
	6" = 1.50	12" = 5.80	

_____ X VF _____ = _____ X 3 (case volume) = Estimated Purge Volume: _____ (gal.)

Purge Equipment: Disposable Bailer
Bailer
Stack
Suction
Grundfos
Other: _____

Sampling Equipment: Disposable Bailer
Bailer
Pressure Bailer
Grab Sample
Other: _____

Starting Time: _____
Sampling Time: _____
Purging Flow Rate: _____ gpm.
Did well de-water? _____

Weather Conditions: _____
Water Color: _____ Odor: _____
Sediment Description: _____
If yes; Time: _____ Volume: _____ (gal.)

Time	Volume (gal.)	pH	Conductivity μ mhos/cm	Temperature $^{\circ}$ F	D.O. (mg/L)	ORP (mV)	Alkalinity (ppm)

LABORATORY INFORMATION

SAMPLE ID	(#) - CONTAINER	REFRIG.	PRESERV. TYPE	LABORATORY	ANALYSES
	<u>3VCA</u>	<u>Y</u>	<u>HCL</u>	<u>Sequoia</u>	<u>TPH, BTEX, MTBE</u>

COMMENTS: Took small amount of FP to lab for disposal

**TOSCO (UNOCAL) SS #0746
OAKLAND, CA**

**MONITORING
EVENT OF APRIL 13, 2000**

WELL MONITORING/SAMPLING FIELD DATA SHEET

Client/
Facility # 0746
Address: 3943 Broadway
City: Oakland, CA.

Job#: 180063
Date: 4-13-00
Sampler: Joc

Well ID MW-5
Well Diameter 2 in.
Total Depth 20.18 ft.
Depth to Water 8.66 ft.

Well Condition: OK

Hydrocarbon Thickness:	<u>2</u> in.	Amount Bailed (product/water):	<u>0</u> (gal.)
Volume Factor (VF)	2" = 0.17	3" = 0.38	4" = 0.66
	6" = 1.50	12" = 5.80	

_____ X VF _____ = _____ X 3 (case volume) = Estimated Purge Volume: _____ (gal.)

Purge Equipment: Disposable Bailer
Bailer
Stack
Suction
Grundfos
Other: _____

Sampling Equipment: Disposable Bailer
Bailer
Pressure Bailer
Grab Sample
Other: _____

Starting Time: _____
Sampling Time: _____
Purging Flow Rate: _____ gpm.
Did well de-water? _____

Weather Conditions: _____
Water Color: _____ Odor: _____
Sediment Description: _____
If yes; Time: _____ Volume: _____ (gal.)

Time	Volume (gal.)	pH	Conductivity μ mhos/cm	Temperature $^{\circ}$ F	D.O. (mg/L)	ORP (mV)	Alkalinity (ppm)

LABORATORY INFORMATION

SAMPLE ID	(#) - CONTAINER	REFRIG.	PRESERV. TYPE	LABORATORY	ANALYSES
	<u>3YCA</u>	<u>Y</u>	<u>HCL</u>	<u>Sequoia</u>	<u>TPHG, BTEX, MTBE</u>

COMMENTS: No product found in either skimmer or well.

**TOSCO (UNOCAL) SS #0746
OAKLAND, CA**

**MONITORING
EVENT OF MAY 22, 2000**

**WELL MONITORING/SAMPLING
FIELD DATA SHEET**

Client/
Facility # 0746
Address: 3943 Broadway
City: Oakland

Job#: 180063
Date: 5-22-00
Sampler: Joc

Well ID MW-1
Well Diameter 19.90 ² in
Total Depth 102.37 ft
Depth to Water 7.53 ft

Well Condition: O.K.
Hydrocarbon Thickness: 0 in Amount Bailed (product/water): 0 (gal)

Volume Factor (VF)	2" = 0.17	3" = 0.38	4" = 0.66
	6" = 1.50	12" = 5.50	

12.37 x VF 0.17 = 2.10 x 3 (case volume) = Estimated Purge Volume: 6.5 (gal)

Purge Equipment: Disposable Bailer
Bailer
Stack
Suction
Grundfos
Other: _____

Sampling Equipment: Disposable Bailer
Bailer
Pressure Bailer
Grab Sample
Other: _____

Starting Time: 8:32
Sampling Time: 9:15 A.M.
Purging Flow Rate: 1 gpm
Did well de-water? _____

Weather Conditions: clear/hot
Water Color: clear Odor: None
Sediment Description: clear
if yes; Time: _____ Volume: _____ (gal)

Time	Volume (gal)	pH	Conductivity ¹⁰⁰ μ mhos/cm	Temperature F	D.O. (mg/L)	ORP (mV)	Alkalinity (ppm)
<u>8:42</u>	<u>2</u>	<u>7.36</u>	<u>4.88</u>	<u>75.0</u>	_____	_____	_____
<u>8:43</u>	<u>4</u>	<u>7.35</u>	<u>5.19</u>	<u>74.2</u>	_____	_____	_____
<u>8:44</u>	<u>6.5</u>	<u>7.19</u>	<u>5.22</u>	<u>74.1</u>	_____	_____	_____
_____	_____	_____	_____	_____	_____	_____	_____

LABORATORY INFORMATION

SAMPLE ID	(#) - CONTAINER	REFRIG.	PRESERV. TYPE	LABORATORY	ANALYSES
<u>MW-1</u>	<u>3VSA</u>	<u>Y</u>	<u>HCL</u>	<u>Sequoia</u>	<u>TPHG, BTEX, MTBE</u>
_____	_____	_____	_____	_____	_____
_____	_____	_____	_____	_____	_____

COMMENTS: _____

**WELL MONITORING/SAMPLING
FIELD DATA SHEET**

Client/
Facility # 0746
Address: 3943 Broadway
City: Oakland

Job#: 180063
Date: 5-22-00
Sampler: Joc

Well ID: MW-2
Well Diameter: 2 in
Total Depth: 19.96 ft
Depth to Water: 8.61 ft

Well Condition: O.K. - Monitor only

Hydrocarbon Thickness: 0 in Amount Bailed (product/water): 0 (gal.)

Volume Factor (VF)	2" = 0.17	3" = 0.38	4" = 0.66
	6" = 1.50	12" = 5.50	

 x VF 0.17 = X 3 (case volume) = Estimated Purge Volume: (gal.)

Purge Equipment: Disposable Bailer
Bailer
Stack
Suction
Grundfos
Other:

Sampling Equipment: Disposable Bailer
Bailer
Pressure Bailer
Grab Sample
Other:

Starting Time:
Sampling Time:
Purging Flow Rate: gpm
Did well de-water?

Weather Conditions: clear/hot
Water Color: clear Odor:
Sediment Description: clear
If yes; Time: Volume: (gal.)

Time	Volume (gal.)	pH	Conductivity (µmhos/cm)	Temperature (F)	D.O. (mg/L)	ORP (mV)	Alkalinity (ppm)

LABORATORY INFORMATION

SAMPLE ID	(#) - CONTAINER	REFRIG.	PRESERV. TYPE	LABORATORY	ANALYSES
	<u>3VGA</u>	<u>Y</u>	<u>HCL</u>	<u>Sequoia</u>	<u>TPHG, BTEX, MTBE</u>

COMMENTS: "M. only"

**WELL MONITORING/SAMPLING
FIELD DATA SHEET**

Client/
Facility # 0746
Address: 3943 Broadway
City: Oakland

Job#: 180063
Date: 5-22-00
Sampler: Joe

Well ID MW-3
Well Diameter 2 in
Total Depth 22.43 ft
Depth to Water 9.14 ft

Well Condition: O.K.

Hydrocarbon Thickness: 0 in Amount Bailed (product/water): 0 gal

Volume Factor (VF)	2" = 0.17	3" = 0.38	4" = 0.66
	6" = 1.50	12" = 5.50	

13.29 x VF 0.17 = 2.26 x 3 (case volume) = Estimated Purge Volume: 7 gal

Purge Equipment: Disposable Bailer
Bailer
Stack
Suction
Grundfos
Other: _____

Sampling Equipment: Disposable Bailer
Bailer
Pressure Bailer
Grab Sample
Other: _____

Starting Time: 12:15
Sampling Time: 12:38
Purging Flow Rate: 1 gpm
Did well de-water? _____

Weather Conditions: clear/hot
Water Color: clear Odor: yes
Sediment Description: clear
If yes; Time: _____ Volume: _____ gal

Time	Volume (gal.)	pH	Conductivity $\mu\text{mhos/cm}$	Temperature $^{\circ}\text{F}$	D.O. (mg/L)	ORP (mV)	Alkalinity (ppm)
<u>12:22</u>	<u>2.5</u>	<u>7.10</u>	<u>2.85</u>	<u>74.2</u>			
<u>12:24</u>	<u>5</u>	<u>6.94</u>	<u>2.80</u>	<u>73.9</u>			
<u>12:25</u>	<u>7</u>	<u>6.90</u>	<u>2.89</u>	<u>74.4</u>			

LABORATORY INFORMATION

SAMPLE ID	(#) - CONTAINER	REFRIG.	PRESERV. TYPE	LABORATORY	ANALYSES
<u>MW-3</u>	<u>3VCA</u>	<u>Y</u>	<u>HCL</u>	<u>Sequoia</u>	<u>TPNG, BTEX, MTBG</u>

COMMENTS: _____

**WELL MONITORING/SAMPLING
FIELD DATA SHEET**

Client/
Facility # 0746
Address: 3943 Broadway
City: Oakland

Job#: 180063
Date: 5-22-00
Sampler: Joc

Well ID MW-4
Well Diameter 2 in.
Total Depth 20.03 ft
Depth to Water 8.60 ft

Well Condition: O.K.
Hydrocarbon Thickness: 0 in. Amount Bailed (product/water): 0 (gal.)

Volume Factor (VF)	2" = 0.17	3" = 0.38	4" = 0.66
	6" = 1.50	12" = 5.50	

11.43 x VF 0.17 = 1.94 x 3 (case volume) = Estimated Purge Volume: 6 (gal.)

Purge Equipment: Disposable Bailer
Bailer
Stack
Suction
Grundfos
Other: _____

Sampling Equipment: Disposable Bailer
Bailer
Pressure Bailer
Grab Sample
Other: _____

Starting Time: 9:20
Sampling Time: 9:40 AM
Purging Flow Rate: 1 gpm
Did well de-water? _____

Weather Conditions: clear/hot
Water Color: clear Odor: none
Sediment Description: clear
If yes; Time: _____ Volume: _____ (gal.)

Time	Volume (gal)	pH	Conductivity μ mhos/cm X	Temperature F	D.O. (mg/L)	ORP (mV)	Alkalinity (ppm)
<u>9:30</u>	<u>2</u>	<u>7.95</u>	<u>7.42</u>	<u>75.5</u>			
<u>9:31</u>	<u>4</u>	<u>7.55</u>	<u>6.58</u>	<u>75.2</u>			
<u>9:32</u>	<u>6</u>	<u>7.59</u>	<u>6.51</u>	<u>74.9</u>			

LABORATORY INFORMATION

SAMPLE ID	(#) - CONTAINER	REFRIG.	PRESERV. TYPE	LABORATORY	ANALYSES
<u>MW-4</u>	<u>3VSA</u>	<u>Y</u>	<u>HCL</u>	<u>Sequoia</u>	<u>TPHG, BTEX, MTBG</u>

COMMENTS: _____

**WELL MONITORING/SAMPLING
FIELD DATA SHEET**

Client/
Facility # 0746
Address: 3943 Broadway
City: Oakland

Job#: 180063
Date: 5-22-00
Sampler: Joe

Well ID MW-5
Well Diameter 2 in.
Total Depth 20.18 ft.
Depth to Water 9.06 ft.

Well Condition: O.K.
Hydrocarbon No production in well, but 1.5 ounces found in
Thickness: 0 in. (product/water): 0 (gal.)
Skimmer

Volume	2" = 0.17	3" = 0.38	4" = 0.66
Factor (VF)	6" = 1.50	12" = 5.50	

11.12 x VF 0.17 = 1.89 x 3 (case volume) = Estimated Purge Volume: 5.5 (gal.)

Purge Equipment:

- Disposable Bailer
- Bailer
- Stack
- Sequoia
- Grundfos
- Other: _____

Sampling Equipment:

- Disposable Bailer
- Bailer
- Pressure Bailer
- Grab Sample
- Other: _____

Starting Time: 12:45
Sampling Time: 1:10 A.M.
Purging Flow Rate: _____ gpm
Did well de-water? _____

Weather Conditions: clear/hot
Water Color: clear Odor: _____
Sediment Description: clear
If yes; Time: _____ Volume: _____ (gal.)

Time	Volume (gal.)	pH	Conductivity μ mhos/cm ¹⁰⁰⁰	Temperature F	D.O. (mg/L)	ORP (mV)	Alkalinity (ppm)
<u>12:52</u>	<u>1.5</u>	<u>6.80</u>	<u>1.12</u>	<u>66.5</u>	_____	_____	_____
<u>12:55</u>	<u>3</u>	<u>6.86</u>	<u>1.15</u>	<u>66.2</u>	_____	_____	_____
<u>1:58</u>	<u>5.5</u>	<u>6.84</u>	<u>1.17</u>	<u>66.4</u>	_____	_____	_____
_____	_____	_____	_____	_____	_____	_____	_____

LABORATORY INFORMATION

SAMPLE ID	(#) - CONTAINER	REFRIG.	PRESERV. TYPE	LABORATORY	ANALYSES
<u>MW-5</u>	<u>3VSA</u>	<u>Y</u>	<u>HCL</u>	<u>Sequoia</u>	<u>TPH, BTEX, MTBE</u>
_____	_____	_____	_____	_____	_____
_____	_____	_____	_____	_____	_____

COMMENTS: Sampled well after talking to Doug Lee.

**WELL MONITORING/SAMPLING
FIELD DATA SHEET**

Client/
Facility # 0746
Address: 3943 Broadway
City: Oakland

Job#: 180063
Date: 5-22-00
Sampler: Joe

Well ID MW-6
Well Diameter 2 in.
Total Depth 19.78 ft.
Depth to Water 7.24 ft.

Well Condition: O.K.
Hydrocarbon Thickness: 0 in. Amount Bailed (product/water): 0 (gal.)

Volume Factor (VF)	2" = 0.17	3" = 0.38	4" = 0.66
	6" = 1.50	12" = 5.50	

 X VF 0.17 = X 3 (case volume) = Estimated Purge Volume: (gal.)

Purge Equipment: Disposable Bailer
Bailer
Stack
Suction
Grundfos
Other:

Sampling Equipment: Disposable Bailer
Bailer
Pressure Bailer
Grab Sample
Other:

Starting Time:
Sampling Time:
Purging Flow Rate: gpm
Did well de-water?

Weather Conditions: clear/hot
Water Color: clear Odor:
Sediment Description: clear
If yes; Time: Volume: (gal.)

Time	Volume (gal.)	pH	Conductivity μ mhos/cm	Temperature F	D.O. (mg/L)	ORP (mV)	Alkalinity (ppm)

LABORATORY INFORMATION

SAMPLE ID	(#) - CONTAINER	REFRIG.	PRESERV. TYPE	LABORATORY	ANALYSES
	<u>3 YCA</u>	<u>Y</u>	<u>HCL</u>	<u>Sequoia</u>	<u>TPHG, BTEX, MTBG</u>

COMMENTS: M. only (monitor only)

**WELL MONITORING/SAMPLING
FIELD DATA SHEET**

Client/
Facility # 0746
Address: 3943 Broadway
City: Oakland

Job#: 180063
Date: 5-22-00
Sampler: Joe

Well ID MW-7
Well Diameter 2 in
Total Depth 18.50 ft
Depth to Water 8.10 ft

Well Condition: O.K.
Hydrocarbon Thickness: 0 in. Amount Bailed (product/water): 0 (gal)

Volume Factor (VF)	2" = 0.17	3" = 0.38	4" = 0.66
	6" = 1.50	12" = 5.50	

 X VF 0.17 = X 3 (case volume) = Estimated Purge Volume: (gal)

Purge Equipment: Disposable Bailer
Bailer
Stack
Suction
Grundfos
Other:

Sampling Equipment: Disposable Bailer
Bailer
Pressure Bailer
Grab Sample
Other:

Starting Time:
Sampling Time:
Purging Flow Rate: gpm
Did well de-water?

Weather Conditions: clear/hot
Water Color: clear Odor:
Sediment Description: clear
If yes; Time: Volume: (gal)

Time	Volume (gal)	pH	Conductivity μ mhos/cm	Temperature $^{\circ}$ F	D.O. (mg/L)	ORP (mV)	Alkalinity (ppm)

LABORATORY INFORMATION

SAMPLE ID	(#) - CONTAINER	REFRIG.	PRESERV. TYPE	LABORATORY	ANALYSES
	<u>3VCA</u>	<u>Y</u>	<u>HCL</u>	<u>Sequoia</u>	<u>TPHG, BTEX, MTBE</u>

COMMENTS: M. only

**WELL MONITORING/SAMPLING
FIELD DATA SHEET**

Client/
Facility # 0746
Address: 3943 Broadway
City: Oakland

Job#: 180063
Date: 5-22-00
Sampler: Joc

Well ID: MW-8
Well Diameter: 2 in
Total Depth: 21.40 +
Depth to Water: 9.80 +

Well Condition: O.K.
Hydrocarbon Thickness: 0 in
Amount Bailed (product/water): 0 (gal.)
Volume Factor (VF):
2" = 0.17 3" = 0.38 4" = 0.66
6" = 1.50 12" = 5.50

_____ X VF 0.17 = _____ X 3 (case volume) = Estimated Purge Volume: _____ (gal.)

Purge Equipment:
Disposable Bailer
Bailer
Stack
Suction
Grundfos
Other: _____

Sampling Equipment:
Disposable Bailer
Bailer
Pressure Bailer
Grab Sample
Other: _____

Starting Time: _____
Sampling Time: 10:45A.M.
Purging Flow Rate: _____ gpm
Did well de-water? _____

Weather Conditions: clear/hot
Water Color: clear Odor: none
Sediment Description: clear
If yes; Time: _____ Volume: _____ (gal.)

Time	Volume (gal.)	pH	Conductivity μ mhos/cm	Temperature F	D.O. (mg/L)	ORP (mV)	Alkalinity (ppm)

LABORATORY INFORMATION

SAMPLE ID	(#) - CONTAINER	REFRIG.	PRESERV. TYPE	LABORATORY	ANALYSES
<u>MW-8</u>	<u>3YCA</u>	<u>Y</u>	<u>HCL</u>	<u>Sequoia</u>	<u>TPHG, BTEX, MTBE</u>

COMMENTS: Could only get a grab sample. Owner refuses to remove cars.

**WELL MONITORING/SAMPLING
FIELD DATA SHEET**

Client/
Facility # 0746
Address: 3943 Broadway
City: Oakland

Job#: 180063
Date: 5-22-00
Sampler: Joe

Well ID MW-9
Well Diameter 2 in
Total Depth 21.93 ft
Depth to Water 9.17 ft

Well Condition: O.K.
Hydrocarbon Thickness: 0 in Amount Bailed (product/water): 0 (gal)

Volume Factor (VF)	2" = 0.17	3" = 0.38	4" = 0.66
	6" = 1.50	12" = 5.50	

12.76 x VF 0.17 = 2.17 x 3 (case volume) = Estimated Purge Volume: 6.5 (gal)

Purge Equipment:

Disposable Bailer
Bailer
Stack
Suction
Grundfos
Other: _____

Sampling Equipment:

Disposable Bailer
Bailer
Pressure Bailer
Grab Sample

Other: _____

Starting Time: 11:10
Sampling Time: 11:25 AM
Purging Flow Rate: 1 gpm
Did well de-water? _____

Weather Conditions: clear/hot
Water Color: clear Odor: none
Sediment Description: clear
If yes; Time: _____ Volume: _____ (gal)

Time	Volume (gal)	pH	Conductivity $\mu\text{mhos/cm}^{\circ}$	Temperature F	D.O. (mg/L)	ORP (mV)	Alkalinity (ppm)
<u>11:10</u>	<u>2</u>	<u>7.47</u>	<u>7.39</u>	<u>74.2</u>	_____	_____	_____
<u>11:12</u>	<u>4</u>	<u>7.42</u>	<u>7.33</u>	<u>74.0</u>	_____	_____	_____
<u>11:13</u>	<u>6.5</u>	<u>7.46</u>	<u>7.39</u>	<u>74.9</u>	_____	_____	_____
_____	_____	_____	_____	_____	_____	_____	_____

LABORATORY INFORMATION

SAMPLE ID	(#) - CONTAINER	REFRIG.	PRESERV. TYPE	LABORATORY	ANALYSES
<u>MW-9</u>	<u>3VCA</u>	<u>Y</u>	<u>HCL</u>	<u>Sequoia</u>	<u>TPHG, BTEX, MTBE</u>
_____	_____	_____	_____	_____	_____
_____	_____	_____	_____	_____	_____

COMMENTS: _____

**WELL MONITORING/SAMPLING
FIELD DATA SHEET**

Client/
Facility # 0746
Address: 3943 Broadway
City: Oakland

Job#: 180063
Date: 5-22-00
Sampler: Jac

Well ID MW-10
Well Diameter 2 in.
Total Depth 21.78 ft.
Depth to Water 10.06 ft.

Well Condition: O.K.

Hydrocarbon Thickness:	<u>0</u> in.	Amount Bailed (product/water):	<u>0</u> (gal)
Volume Factor (VF)	2" = 0.17	3" = 0.38	4" = 0.66
	6" = 1.50	12" = 5.50	

_____ X VF 0.17 = _____ X 3 (case volume) = Estimated Purge Volume: _____ (gal)

Purge Equipment: Disposable Bailer
Bailer
Stack
Suction
Grundfos
Other: _____

Sampling Equipment: Disposable Bailer
Bailer
Pressure Bailer
Grab Sample
Other: _____

Starting Time: _____
Sampling Time: _____
Purging Flow Rate: _____ gpm
Did well de-water? _____

Weather Conditions: clear/hot
Water Color: clear Odor: _____
Sediment Description: clear
If yes; Time: _____ Volume: _____ (gal)

Time	Volume (gal.)	pH	Conductivity μ mhos/cm	Temperature F	D.O. (mg/L)	ORP (mV)	Alkalinity (ppm)

LABORATORY INFORMATION

SAMPLE ID	(#) - CONTAINER	REFRIG.	PRESERV. TYPE	LABORATORY	ANALYSES
<u>MW-10</u>	<u>3 YCA</u>	<u>Y</u>	<u>HCL</u>	<u>Sequoia</u>	<u>TPHG, BTEX, MTBE</u>

COMMENTS: no. only

**WELL MONITORING/SAMPLING
FIELD DATA SHEET**

Client/
Facility # 0746
Address: 3943 Broadway
City: Oakland

Job#: 180063
Date: 5-22-00
Sampler: Joe

Well ID MW-11
Well Diameter 2 in.
Total Depth 19.20 ft
Depth to Water 10.98 ft

Well Condition: O.K.

Hydrocarbon Thickness:	<u>0</u> in.	Amount Bailed (product/water):	<u>0</u> (gal)
Volume Factor (VF)	2" = 0.17	3" = 0.38	4" = 0.66
	6" = 1.50	12" = 5.50	

8.22 X VF 0.17 = 1.40 X 3 (case volume) = Estimated Purge Volume: 4.5 (gal)

Purge Equipment: Disposable Bailer
Bailer
Stack
Suction
Grundfos
Other: _____

Sampling Equipment: Disposable Bailer
Bailer
Pressure Bailer
Grab Sample
Other: _____

Starting Time: 10:00
Sampling Time: 10:30 a.m.
Purging Flow Rate: 0.5 gpm
Did well de-water? _____

Weather Conditions: clear/hot
Water Color: clear Odor: none
Sediment Description: clear
If yes; Time: _____ Volume: _____ (gal)

Time	Volume (gal)	pH	Conductivity μ mhos/cm	Temperature F	D.O. (mg/L)	ORP (mV)	Alkalinity (ppm)
<u>10:10</u>	<u>1.5</u>	<u>7.72</u>	<u>8.58</u>	<u>67.2</u>	_____	_____	_____
<u>10:12</u>	<u>3</u>	<u>7.59</u>	<u>9.11</u>	<u>68.0</u>	_____	_____	_____
<u>10:14</u>	<u>4.5</u>	<u>7.61</u>	<u>9.14</u>	<u>67.1</u>	_____	_____	_____
_____	_____	_____	_____	_____	_____	_____	_____

LABORATORY INFORMATION

SAMPLE ID	(#) - CONTAINER	REFRIG.	PRESERV. TYPE	LABORATORY	ANALYSES
<u>MW-11</u>	<u>3YCA</u>	<u>Y</u>	<u>HCL</u>	<u>Sequoia</u>	<u>TPHG, BTEX, MTBE</u>
_____	_____	_____	_____	_____	_____
_____	_____	_____	_____	_____	_____

COMMENTS: _____

**WELL MONITORING/SAMPLING
FIELD DATA SHEET**

Client/
Facility # 0746
Address: 3943 Broadway
City: Oakland

Job#: 180063
Date: 5-22-00
Sampler: Joc

Well ID MW-12
Well Diameter 2 in.
Total Depth 17.65 ft.
Depth to Water 11.19 ft.

Well Condition: O.K.
Hydrocarbon Thickness: 0 in. Amount Bailed (product/water): 0 (gal.)
Volume Factor (VF) 2" = 0.17 3" = 0.38 4" = 0.66
6" = 1.50 12" = 5.50

_____ X VF 0.17 = _____ X 3 (case volume) = Estimated Purge Volume: _____ (gal.)

Purge Equipment: Disposable Bailer
Bailer
Stack
Suction
Grundfos
Other: _____

Sampling Equipment: Disposable Bailer
Bailer
Pressure Bailer
Grab Sample
Other: _____

Starting Time: _____
Sampling Time: _____
Purging Flow Rate: _____ gpm
Did well de-water? _____

Weather Conditions: clear/hot
Water Color: clear Odor: _____
Sediment Description: clear
If yes; Time: _____ Volume: _____ (gal.)

Time	Volume (gal.)	pH	Conductivity μ mhos/cm	Temperature $^{\circ}$ F	D.O. (mg/L)	ORP (mV)	Alkalinity (ppm)

LABORATORY INFORMATION

SAMPLE ID	(#) - CONTAINER	REFRIG.	PRESERV. TYPE	LABORATORY	ANALYSES
	<u>3 YEA</u>	<u>Y</u>	<u>HCL</u>	<u>Sequoia</u>	<u>TPHG, BTEX, MTBE</u>

COMMENTS: W. only



Tosco Marketing Company
2020 Colton Canyon Pl., Ste. 200
San Ramon, California 94583

Facility Number: UNOCAL SS#BP0746
Facility Address: 3943 BROADWAY, OAKLAND, CA
Consultant Project Number: 180063.85
Consultant Name: Gettler-Ryan Inc. (G-R Inc.)
Address: 6747 Sierra Court, Suite I, Dublin, CA 94568
Project Contact (Name): Deanna L. Harding
(Phone) 510-551-7555 (Fax Number) 510-551-7888

Contact (Name): DAVE DeWitt
(Phone) 925-277-2384
Laboratory Name: Sequoia Analytical
Laboratory Release Number: W02593
Sample Collected by (Name): JOE ASEMIAN
Collection Date: 5-22-00
Signature: [Signature]

Sample Number	Lab Sample Number	Number of Containers	Matrix S = Soil A = Air W = Water C = Charcoal	Type G = Grab C = Composite D = Discrete	Time	Sample Preservation	Iod (Yes or No)	Analysis To Be Performed														
								TPH Gas + BTEX w/MTBE (8015)	TPH Diesel (8015)	Oil and Grease (5520)	Purgeable Hydrocarbons (8010)	Purgeable Aromatics (8020)	Purgeable Organics (8240)	Extractable Organics (8270)	Metals Cd,Cr,Pb,Zn,NI (ICAP or AA)							
TB-LB	01A	1	W	G	-	HCL	✓	✓														
MW-1	02A-C	3	W	✓	9:40		✓	✓														
MW-3	03	"	W	✓	12:55		✓	✓														
MW-4	04	"	W	✓	9:40		✓	✓														
MW-5	05	"	W	✓	1:10		✓	✓														
MW-8	06	"	W	✓	10:45		✓	✓														
MW-9	07	"	W	✓	11:25		✓	✓														
MW-11	08	"	W	✓	10:30		✓	✓														

DO NOT BILL
TB-LB ANALYSIS
* CONFIRM
ANY MTBE HIT
BY RUNNING
(6) Oxygenate
Remarks 826
Comproach

Relinquished By (Signature) <u>[Signature]</u>	Organization G-R Inc.	Date/Time 5-22-00	Received By (Signature) <u>Mark Collier</u>	Organization Sequoia	Date/Time 5-23/12:10	Turn Around Time (Circle Choice) 24 Hrs. 48 Hrs. 5 Days 10 Days <u>As Contracted</u>
Relinquished By (Signature) <u>[Signature]</u>	Organization Sequoia	Date/Time 5-23/13:00	Received By (Signature)	Organization	Date/Time	
Relinquished By (Signature)	Organization	Date/Time	Received For Laboratory By (Signature) <u>[Signature]</u>		Date/Time 5/23/00 13:00	



Sequoia Analytical

404 N. Wiget Lane
Walnut Creek, CA 94598
(925) 988-9600
FAX (925) 988-9673
www.sequoialabs.com

12 June, 2000

Deanna L. Harding
Gettler Ryan, Inc. - Dublin
6747 Sierra Court Suite J
Dublin, CA 94568

RE: Unocal
Sequoia Report: W005593

Enclosed are the results of analyses for samples received by the laboratory on 23-May-00 13:00. If you have any questions concerning this report, please feel free to contact me.

Sincerely,

Charlie Westwater
Project Manager

CA ELAP Certificate #1271





Gettler Ryan, Inc. - Dublin
6747 Sierra Court Suite J
Dublin CA, 94568

Project: Unocal
Project Number: Unocal # BP0746
Project Manager: Deanna L. Harding

Reported:
12-Jun-00 08:00

ANALYTICAL REPORT FOR SAMPLES

Sample ID	Laboratory ID	Matrix	Date Sampled	Date Received
TB-LB	W005593-01	Water	22-May-00 00:00	23-May-00 13:00
MW-1	W005593-02	Water	22-May-00 09:00	23-May-00 13:00
MW-3	W005593-03	Water	22-May-00 12:35	23-May-00 13:00
MW-4	W005593-04	Water	22-May-00 09:40	23-May-00 13:00
MW-5	W005593-05	Water	22-May-00 13:10	23-May-00 13:00
MW-8	W005593-06	Water	22-May-00 10:45	23-May-00 13:00
MW-9	W005593-07	Water	22-May-00 11:25	23-May-00 13:00
MW-11	W005593-08	Water	22-May-00 10:30	23-May-00 13:00

Sequoia Analytical - Walnut Creek

The results in this report apply to the samples analyzed in accordance with the chain of custody document. This analytical report must be reproduced in its entirety.

Charlie Westwater, Project Manager





Gettler Ryan, Inc. - Dublin
6747 Sierra Court Suite J
Dublin CA, 94568

Project: Unocal
Project Number: Unocal # BP0746
Project Manager: Deanna L. Harding

Reported:
12-Jun-00 08:00

**Total Purgeable Hydrocarbons (C6-C12), BTEX and MTBE by DHS LUFT
Sequoia Analytical - Walnut Creek**

Analyte	Result	Reporting Limit	Units	Dilution	Batch	Prepared	Analyzed	Method	Notes
TB-LB (W005593-01) Water Sampled: 22-May-00 00:00 Received: 23-May-00 13:00									
Purgeable Hydrocarbons	ND	50	ug/l	1	0F01002	01-Jun-00	01-Jun-00	EPA 8015M/8020	
Benzene	ND	0.50	"	"	"	"	"	"	
Toluene	ND	0.50	"	"	"	"	"	"	
Ethylbenzene	ND	0.50	"	"	"	"	"	"	
Xylenes (total)	ND	0.50	"	"	"	"	"	"	
Methyl tert-butyl ether	ND	2.5	"	"	"	"	"	"	
<i>Surrogate: a,a,a-Trifluorotoluene</i>		102 %	70-130		"	"	"	"	
MW-1 (W005593-02) Water Sampled: 22-May-00 09:00 Received: 23-May-00 13:00									
Purgeable Hydrocarbons	ND	50	ug/l	1	0F01002	01-Jun-00	01-Jun-00	EPA 8015M/8020	
Benzene	0.89	0.50	"	"	"	"	"	"	
Toluene	ND	0.50	"	"	"	"	"	"	
Ethylbenzene	ND	0.50	"	"	"	"	"	"	
Xylenes (total)	ND	0.50	"	"	"	"	"	"	
Methyl tert-butyl ether	220	2.5	"	"	"	"	"	"	
<i>Surrogate: a,a,a-Trifluorotoluene</i>		99.3 %	70-130		"	"	"	"	
MW-3 (W005593-03) Water Sampled: 22-May-00 12:35 Received: 23-May-00 13:00 P-01									
Purgeable Hydrocarbons	4000	250	ug/l	5	0F01002	01-Jun-00	01-Jun-00	EPA 8015M/8020	
Benzene	99	2.5	"	"	"	"	"	"	
Toluene	4.5	2.5	"	"	"	"	"	"	
Ethylbenzene	190	2.5	"	"	"	"	"	"	
Xylenes (total)	75	2.5	"	"	"	"	"	"	
Methyl tert-butyl ether	100	13	"	"	"	"	"	"	
<i>Surrogate: a,a,a-Trifluorotoluene</i>		103 %	70-130		"	"	"	"	





Gettler Ryan, Inc. - Dublin
6747 Sierra Court Suite J
Dublin CA, 94568

Project: Unocal
Project Number: Unocal # BP0746
Project Manager: Deanna L. Harding

Reported:
12-Jun-00 08:00

Total Purgeable Hydrocarbons (C6-C12), BTEX and MTBE by DHS LUFT

Sequoia Analytical - Walnut Creek

Analyte	Result	Reporting Limit	Units	Dilution	Batch	Prepared	Analyzed	Method	Notes
MW-4 (W005593-04) Water Sampled: 22-May-00 09:40 Received: 23-May-00 13:00									
Purgeable Hydrocarbons	ND	50	ug/l	1	0F01002	01-Jun-00	01-Jun-00	EPA 8015M/8020	
Benzene	ND	0.50	"	"	"	"	"	"	
Toluene	ND	0.50	"	"	"	"	"	"	
Ethylbenzene	ND	0.50	"	"	"	"	"	"	
Xylenes (total)	ND	0.50	"	"	"	"	"	"	
Methyl tert-butyl ether	ND	2.5	"	"	"	"	"	"	

<i>Surrogate: a,a,a-Trifluorotoluene</i>									
		105 %	70-130		"	"	"	"	
MW-5 (W005593-05) Water Sampled: 22-May-00 13:10 Received: 23-May-00 13:00 P-01									

Purgeable Hydrocarbons	240000	10000	ug/l	200	0F01004	01-Jun-00	02-Jun-00	EPA 8015M/8020	
Benzene	33000	100	"	"	"	"	"	"	
Toluene	5000	100	"	"	"	"	"	"	
Ethylbenzene	18000	100	"	"	"	"	"	"	
Xylenes (total)	59000	100	"	"	"	"	"	"	
Methyl tert-butyl ether	640	500	"	"	"	"	"	"	

<i>Surrogate: a,a,a-Trifluorotoluene</i>									
		73.3 %	70-130		"	"	"	"	
MW-8 (W005593-06) Water Sampled: 22-May-00 10:45 Received: 23-May-00 13:00									

Purgeable Hydrocarbons	ND	50	ug/l	1	0F01002	01-Jun-00	01-Jun-00	EPA 8015M/8020	
Benzene	ND	0.50	"	"	"	"	"	"	
Toluene	1.9	0.50	"	"	"	"	"	"	
Ethylbenzene	ND	0.50	"	"	"	"	"	"	
Xylenes (total)	3.3	0.50	"	"	"	"	"	"	
Methyl tert-butyl ether	ND	2.5	"	"	"	"	"	"	

<i>Surrogate: a,a,a-Trifluorotoluene</i>									
		93.3 %	70-130		"	"	"	"	





Gettler Ryan, Inc. - Dublin 6747 Sierra Court Suite J Dublin CA, 94568	Project: Unocal Project Number: Unocal # BP0746 Project Manager: Deanna L. Harding	Reported: 12-Jun-00 08:00
--	--	------------------------------

Total Purgeable Hydrocarbons (C6-C12), BTEX and MTBE by DHS LUFT
Sequoia Analytical - Walnut Creek

Analyte	Result	Reporting Limit	Units	Dilution	Batch	Prepared	Analyzed	Method	Notes
MW-9 (W005593-07) Water Sampled: 22-May-00 11:25 Received: 23-May-00 13:00									
Purgeable Hydrocarbons	ND	50	ug/l	1	0F01002	01-Jun-00	01-Jun-00	EPA 8015M/8020	
Benzene	ND	0.50	"	"	"	"	"	"	
Toluene	1.9	0.50	"	"	"	"	"	"	
Ethylbenzene	ND	0.50	"	"	"	"	"	"	
Xylenes (total)	3.5	0.50	"	"	"	"	"	"	
Methyl tert-butyl ether	ND	2.5	"	"	"	"	"	"	
<i>Surrogate: a,a,a-Trifluorotoluene</i>		91.0 %	70-130		"	"	"	"	
MW-11 (W005593-08) Water Sampled: 22-May-00 10:30 Received: 23-May-00 13:00									
Purgeable Hydrocarbons	ND	50	ug/l	1	0F02001	02-Jun-00	02-Jun-00	EPA 8015M/8020	
Benzene	ND	0.50	"	"	"	"	"	"	
Toluene	ND	0.50	"	"	"	"	"	"	
Ethylbenzene	ND	0.50	"	"	"	"	"	"	
Xylenes (total)	ND	0.50	"	"	"	"	"	"	
Methyl tert-butyl ether	ND	2.5	"	"	"	"	"	"	
<i>Surrogate: a,a,a-Trifluorotoluene</i>		110 %	70-130		"	"	"	"	





Gettler Ryan, Inc. - Dublin
6747 Sierra Court Suite J
Dublin CA, 94568

Project: Unocal
Project Number: Unocal # BP0746
Project Manager: Deanna L. Harding

Reported:
12-Jun-00 08:00

**Volatile Organic Compounds by EPA Method 8260A
Sequoia Analytical - Walnut Creek**

Analyte	Result	Reporting Limit	Units	Dilution	Batch	Prepared	Analyzed	Method	Notes
MW-1 (W005593-02) Water Sampled: 22-May-00 09:00 Received: 23-May-00 13:00 O-04									
Ethanol	ND	500	ug/l	1	0F09018	09-Jun-00	09-Jun-00	EPA 8260A	
tert-Butyl alcohol	130	100	"	"	"	"	"	"	
Methyl tert-butyl ether	290	2.0	"	"	"	"	"	"	
Di-isopropyl ether	ND	2.0	"	"	"	"	"	"	
Ethyl tert-butyl ether	ND	2.0	"	"	"	"	"	"	
tert-Amyl methyl ether	ND	2.0	"	"	"	"	"	"	
<i>Surrogate: Dibromofluoromethane</i>		92.0 %		50-150	"	"	"	"	
<i>Surrogate: 1,2-Dichloroethane-d4</i>		88.0 %		50-150	"	"	"	"	
MW-3 (W005593-03) Water Sampled: 22-May-00 12:35 Received: 23-May-00 13:00 O-04									
Ethanol	ND	500	ug/l	1	0F09018	09-Jun-00	09-Jun-00	EPA 8260A	
tert-Butyl alcohol	ND	100	"	"	"	"	"	"	
Methyl tert-butyl ether	94	2.0	"	"	"	"	"	"	
Di-isopropyl ether	ND	2.0	"	"	"	"	"	"	
Ethyl tert-butyl ether	ND	2.0	"	"	"	"	"	"	
tert-Amyl methyl ether	ND	2.0	"	"	"	"	"	"	
<i>Surrogate: Dibromofluoromethane</i>		94.0 %		50-150	"	"	"	"	
<i>Surrogate: 1,2-Dichloroethane-d4</i>		92.0 %		50-150	"	"	"	"	
MW-5 (W005593-05) Water Sampled: 22-May-00 13:10 Received: 23-May-00 13:00 O-04,R-05									
Ethanol	ND	2500	ug/l	5	0F09018	09-Jun-00	09-Jun-00	EPA 8260A	
tert-Butyl alcohol	ND	500	"	"	"	"	"	"	
Methyl tert-butyl ether	21	10	"	"	"	"	"	"	
Di-isopropyl ether	ND	10	"	"	"	"	"	"	
Ethyl tert-butyl ether	ND	10	"	"	"	"	"	"	
tert-Amyl methyl ether	ND	10	"	"	"	"	"	"	
<i>Surrogate: Dibromofluoromethane</i>		92.0 %		50-150	"	"	"	"	
<i>Surrogate: 1,2-Dichloroethane-d4</i>		84.0 %		50-150	"	"	"	"	





Gettler Ryan, Inc. - Dublin
6747 Sierra Court Suite J
Dublin CA, 94568

Project: Unocal
Project Number: Unocal # BP0746
Project Manager: Deanna L. Harding

Reported:
12-Jun-00 08:00

**Total Purgeable Hydrocarbons (C6-C12), BTEX and MTBE by DHS LUFT - Quality Control
Sequoia Analytical - Walnut Creek**

Analyte	Result	Reporting Limit	Units	Spike Level	Source Result	%REC	%REC Limits	RPD	RPD Limit	Notes
---------	--------	-----------------	-------	-------------	---------------	------	-------------	-----	-----------	-------

Batch 0F01002 - EPA 5030B [P/T]

Blank (0F01002-BLK1)

Prepared & Analyzed: 01-Jun-00

Purgeable Hydrocarbons	ND	50	ug/l							
Benzene	ND	0.50	"							
Toluene	ND	0.50	"							
Ethylbenzene	ND	0.50	"							
Xylenes (total)	ND	0.50	"							
Methyl tert-butyl ether	ND	2.5	"							
<i>Surrogate: a,a,a-Trifluorotoluene</i>	30.9		"	30.0		103	70-130			

LCS (0F01002-BS1)

Prepared & Analyzed: 01-Jun-00

Benzene	16.2	0.50	ug/l	20.0		81.0	70-130			
Toluene	18.1	0.50	"	20.0		90.5	70-130			
Ethylbenzene	20.7	0.50	"	20.0		104	70-130			
Xylenes (total)	59.6	0.50	"	60.0		99.3	70-130			
<i>Surrogate: a,a,a-Trifluorotoluene</i>	27.3		"	30.0		91.0	70-130			

Matrix Spike (0F01002-MS1)

Source: W005593-04

Prepared & Analyzed: 01-Jun-00

Benzene	17.6	0.50	ug/l	20.0	ND	88.0	70-130			
Toluene	19.3	0.50	"	20.0	ND	96.5	70-130			
Ethylbenzene	23.0	0.50	"	20.0	ND	115	70-130			
Xylenes (total)	64.5	0.50	"	60.0	ND	108	70-130			
<i>Surrogate: a,a,a-Trifluorotoluene</i>	26.0		"	30.0		86.7	70-130			

Matrix Spike Dup (0F01002-MSD1)

Source: W005593-04

Prepared & Analyzed: 01-Jun-00

Benzene	17.5	0.50	ug/l	20.0	ND	87.5	70-130	0.570	20	
Toluene	19.6	0.50	"	20.0	ND	98.0	70-130	1.54	20	
Ethylbenzene	20.9	0.50	"	20.0	ND	104	70-130	9.57	20	
Xylenes (total)	63.1	0.50	"	60.0	ND	105	70-130	2.19	20	
<i>Surrogate: a,a,a-Trifluorotoluene</i>	26.3		"	30.0		87.7	70-130			





Gettler Ryan, Inc. - Dublin 6747 Sierra Court Suite J Dublin CA, 94568	Project: Unocal Project Number: Unocal # BP0746 Project Manager: Deanna L. Harding	Reported: 12-Jun-00 08:00
--	--	------------------------------

Total Purgeable Hydrocarbons (C6-C12), BTEX and MTBE by DHS LUFT - Quality Control
Sequoia Analytical - Walnut Creek

Analyte	Result	Reporting Limit	Units	Spike Level	Source Result	%REC	%REC Limits	RPD	RPD Limit	Notes
---------	--------	-----------------	-------	-------------	---------------	------	-------------	-----	-----------	-------

Batch 0F01004 - EPA 5030B [P/T]

Blank (0F01004-BLK1)

Prepared & Analyzed: 01-Jun-00

Purgeable Hydrocarbons	ND	50	ug/l							
Benzene	ND	0.50	"							
Toluene	ND	0.50	"							
Ethylbenzene	ND	0.50	"							
Xylenes (total)	ND	0.50	"							
Methyl tert-butyl ether	ND	2.5	"							
<i>Surrogate: a,a,a-Trifluorotoluene</i>	31.3		"	30.0		104	70-130			

LCS (0F01004-BS1)

Prepared & Analyzed: 01-Jun-00

Benzene	23.0	0.50	ug/l	20.0		115	70-130			
Toluene	23.3	0.50	"	20.0		116	70-130			
Ethylbenzene	23.5	0.50	"	20.0		118	70-130			
Xylenes (total)	68.0	0.50	"	60.0		113	70-130			
<i>Surrogate: a,a,a-Trifluorotoluene</i>	28.1		"	30.0		93.7	70-130			

Matrix Spike (0F01004-MS1)

Source: W005592-05

Prepared & Analyzed: 01-Jun-00

Benzene	20.9	0.50	ug/l	20.0	ND	104	70-130			
Toluene	21.2	0.50	"	20.0	ND	106	70-130			
Ethylbenzene	21.4	0.50	"	20.0	ND	107	70-130			
Xylenes (total)	61.9	0.50	"	60.0	ND	103	70-130			
<i>Surrogate: a,a,a-Trifluorotoluene</i>	27.7		"	30.0		92.3	70-130			

Matrix Spike Dup (0F01004-MSD1)

Source: W005592-05

Prepared & Analyzed: 01-Jun-00

Benzene	21.6	0.50	ug/l	20.0	ND	108	70-130	3.29	20	
Toluene	21.8	0.50	"	20.0	ND	109	70-130	2.79	20	
Ethylbenzene	22.2	0.50	"	20.0	ND	111	70-130	3.67	20	
Xylenes (total)	64.0	0.50	"	60.0	ND	107	70-130	3.34	20	
<i>Surrogate: a,a,a-Trifluorotoluene</i>	28.5		"	30.0		95.0	70-130			





Gettler Ryan, Inc. - Dublin 6747 Sierra Court Suite J Dublin CA, 94568	Project: Unocal Project Number: Unocal # BP0746 Project Manager: Deanna L. Harding	Reported: 12-Jun-00 08:00
--	--	------------------------------

Total Purgeable Hydrocarbons (C6-C12), BTEX and MTBE by DHS LUFT - Quality Control
Sequoia Analytical - Walnut Creek

Analyte	Result	Reporting Limit	Units	Spike Level	Source Result	%REC	%REC Limits	RPD	RPD Limit	Notes
---------	--------	-----------------	-------	-------------	---------------	------	-------------	-----	-----------	-------

Batch 0F02001 - EPA 5030B [P/T]

Blank (0F02001-BLK1) Prepared & Analyzed: 02-Jun-00										
Purgeable Hydrocarbons	ND	50	ug/l							
Benzene	ND	0.50	"							
Toluene	ND	0.50	"							
Ethylbenzene	ND	0.50	"							
Xylenes (total)	ND	0.50	"							
Methyl tert-butyl ether	ND	2.5	"							
<i>Surrogate: a, a, a-Trifluorotoluene</i>	28.9		"	30.0		96.3	70-130			

LCS (0F02001-BS1) Prepared & Analyzed: 02-Jun-00										
Benzene	17.5	0.50	ug/l	20.0		87.5	70-130			
Toluene	19.7	0.50	"	20.0		98.5	70-130			
Ethylbenzene	20.2	0.50	"	20.0		101	70-130			
Xylenes (total)	63.7	0.50	"	60.0		106	70-130			
<i>Surrogate: a, a, a-Trifluorotoluene</i>	27.0		"	30.0		90.0	70-130			

Matrix Spike (0F02001-MS1) Source: W005644-09 Prepared & Analyzed: 02-Jun-00										
Benzene	16.5	0.50	ug/l	20.0	ND	82.5	70-130			
Toluene	17.6	0.50	"	20.0	ND	88.0	70-130			
Ethylbenzene	18.8	0.50	"	20.0	ND	94.0	70-130			
Xylenes (total)	50.8	0.50	"	60.0	0.68	83.5	70-130			
<i>Surrogate: a, a, a-Trifluorotoluene</i>	27.6		"	30.0		92.0	70-130			

Matrix Spike Dup (0F02001-MSD1) Source: W005644-09 Prepared & Analyzed: 02-Jun-00										
Benzene	16.0	0.50	ug/l	20.0	ND	80.0	70-130	3.08	20	
Toluene	16.9	0.50	"	20.0	ND	84.5	70-130	4.06	20	
Ethylbenzene	19.3	0.50	"	20.0	ND	96.5	70-130	2.62	20	
Xylenes (total)	50.4	0.50	"	60.0	0.68	82.9	70-130	0.791	20	
<i>Surrogate: a, a, a-Trifluorotoluene</i>	26.2		"	30.0		87.3	70-130			





Gettler Ryan, Inc. - Dublin
6747 Sierra Court Suite J
Dublin CA, 94568

Project: Unocal
Project Number: Unocal # BP0746
Project Manager: Deanna L. Harding

Reported:
12-Jun-00 08:00

**Volatile Organic Compounds by EPA Method 8260A - Quality Control
Sequoia Analytical - Walnut Creek**

Analyte	Result	Reporting Limit	Units	Spike Level	Source Result	%REC	%REC Limits	RPD	RPD Limit	Notes
---------	--------	-----------------	-------	-------------	---------------	------	-------------	-----	-----------	-------

Batch 0F09018 - EPA 5030B [P/T]

Blank (0F09018-BLK1)

Prepared & Analyzed: 09-Jun-00

Ethanol	ND	500	ug/l							
tert-Butyl alcohol	ND	100	"							
Methyl tert-butyl ether	ND	2.0	"							
Di-isopropyl ether	ND	2.0	"							
Ethyl tert-butyl ether	ND	2.0	"							
tert-Amyl methyl ether	ND	2.0	"							
<i>Surrogate: Dibromofluoromethane</i>	45.0		"	50.0		90.0	50-150			
<i>Surrogate: 1,2-Dichloroethane-d4</i>	44.0		"	50.0		88.0	50-150			

Blank (0F09018-BLK2)

Prepared & Analyzed: 10-Jun-00

Ethanol	ND	500	ug/l							
tert-Butyl alcohol	ND	100	"							
Methyl tert-butyl ether	ND	2.0	"							
Di-isopropyl ether	ND	2.0	"							
Ethyl tert-butyl ether	ND	2.0	"							
tert-Amyl methyl ether	ND	2.0	"							
<i>Surrogate: Dibromofluoromethane</i>	51.0		"	50.0		102	50-150			
<i>Surrogate: 1,2-Dichloroethane-d4</i>	45.0		"	50.0		90.0	50-150			

Blank (0F09018-BLK3)

Prepared & Analyzed: 11-Jun-00

Ethanol	ND	500	ug/l							
tert-Butyl alcohol	ND	100	"							
Methyl tert-butyl ether	ND	2.0	"							
Di-isopropyl ether	ND	2.0	"							
Ethyl tert-butyl ether	ND	2.0	"							
tert-Amyl methyl ether	ND	2.0	"							
<i>Surrogate: Dibromofluoromethane</i>	50.0		"	50.0		100	50-150			
<i>Surrogate: 1,2-Dichloroethane-d4</i>	45.0		"	50.0		90.0	50-150			





Gettler Ryan, Inc. - Dublin 6747 Sierra Court Suite J Dublin CA, 94568	Project: Unocal Project Number: Unocal # BP0746 Project Manager: Deanna L. Harding	Reported: 12-Jun-00 08:00
--	--	------------------------------

Volatile Organic Compounds by EPA Method 8260A - Quality Control
Sequoia Analytical - Walnut Creek

Analyte	Result	Reporting Limit	Units	Spike Level	Source Result	%REC	%REC Limits	RPD	RPD Limit	Notes
Batch 0F09018 - EPA 5030B [P/T]										
LCS (0F09018-BS1)				Prepared & Analyzed: 09-Jun-00						
Methyl tert-butyl ether	39.4	2.0	ug/l	50.0		78.8	70-130			
Surrogate: Dibromofluoromethane	45.0		"	50.0		90.0	50-150			
Surrogate: 1,2-Dichloroethane-d4	42.0		"	50.0		84.0	50-150			
LCS (0F09018-BS2)				Prepared & Analyzed: 10-Jun-00						
Methyl tert-butyl ether	50.1	2.0	ug/l	50.0		100	70-130			
Surrogate: Dibromofluoromethane	50.0		"	50.0		100	50-150			
Surrogate: 1,2-Dichloroethane-d4	44.0		"	50.0		88.0	50-150			
LCS (0F09018-BS3)				Prepared & Analyzed: 11-Jun-00						
Methyl tert-butyl ether	47.8	2.0	ug/l	50.0		95.6	70-130			
Surrogate: Dibromofluoromethane	50.0		"	50.0		100	50-150			
Surrogate: 1,2-Dichloroethane-d4	43.0		"	50.0		86.0	50-150			
Matrix Spike (0F09018-MS1)				Source: W006189-01		Prepared: 09-Jun-00 Analyzed: 10-Jun-00				
Methyl tert-butyl ether	55.8	2.0	ug/l	50.0	ND	112	60-150			
Surrogate: Dibromofluoromethane	52.0		"	50.0		104	50-150			
Surrogate: 1,2-Dichloroethane-d4	46.0		"	50.0		92.0	50-150			
Matrix Spike Dup (0F09018-MSD1)				Source: W006189-01		Prepared: 09-Jun-00 Analyzed: 11-Jun-00				
Methyl tert-butyl ether	56.1	2.0	ug/l	50.0	ND	112	60-150	0.536	25	
Surrogate: Dibromofluoromethane	54.0		"	50.0		108	50-150			
Surrogate: 1,2-Dichloroethane-d4	48.0		"	50.0		96.0	50-150			





Gettler Ryan, Inc. - Dublin
6747 Sierra Court Suite J
Dublin CA, 94568

Project: Unocal
Project Number: Unocal # BP0746
Project Manager: Deanna L. Harding

Reported:
12-Jun-00 08:00

Notes and Definitions

- O-04 This sample was analyzed outside the EPA recommended holding time.
- P-01 Chromatogram Pattern: Gasoline C6-C12
- R-05 The reporting limit(s) for this sample have been raised due to high levels of non-target compounds.
- DET Analyte DETECTED
- ND Analyte NOT DETECTED at or above the reporting limit
- NR Not Reported
- dry Sample results reported on a dry weight basis
- RPD Relative Percent Difference

