

Broadbent & Associates, Inc.  
1324 Mangrove Ave., Suite 212  
Chico, CA 95926  
Voice (530) 566-1400  
Fax (530) 566-1401



July 28, 2008

Atlantic Richfield Company  
P.O. Box 1257  
San Ramon, CA 94583  
Submitted via ENFOS

**RECEIVED**

2:26 pm, Jul 31, 2008

Alameda County  
Environmental Health

Project No. 06-02-608

Attn.: Mr. Paul Supple

Re: Second Quarter, 2008 Status Report, Atlantic Richfield Company (a BP affiliated company) Station #771, 899 Rincon Avenue, Livermore, California. ACEH Case No. RO0000200.

Dear Mr. Supple:

Attached is the *Second Quarter, 2008 Status Report* for Atlantic Richfield Company Station #771 (herein referred to as Station #771) located at 899 Rincon Avenue, Livermore, California (Property).

Should you have questions please do not hesitate to contact us at (530) 566-1400.

Sincerely,

BROADBENT & ASSOCIATES, INC.

Matthew G. Herrick, P.G.  
Senior Hydrogeologist

Robert H. Miller, P.G., C.HG.  
Principal Hydrogeologist

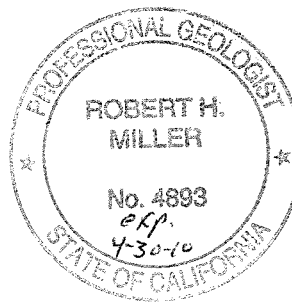

Enclosures

cc: Mr. Paresh Khatri, Alameda County Environmental Health, 1131 Harbor Bay Parkway, Suite 250, Alameda, CA, 94502 (Submitted via ACEH ftp Site)  
Mr. Paul M. Smith, Livermore-Pleasanton Fire Department, 3560 Nevada St., Pleasanton, CA 94566  
Mr. Chuck Headlee, RWQCB, 1515 Clay St. Suite 1400, Oakland, CA 94612 (Submitted via GeoTracker)  
GeoTracker

## STATION #771 QUARTERLY STATUS REPORT

Facility: #771	Address:	899 Rincon Avenue, Livermore, California
Station #771	Environmental Business	
Manager:		Mr. Paul Supple
Consulting Co./Contact Persons:		Broadbent & Associates, Inc. (BAI) / Rob Miller & Matt Herrick
Primary Agency/Regulatory ID No.:		Alameda County Environmental Health (ACEH) / ACEH Case No. RO0000200
Consultant Project No.:		06-02-608
Facility Permits/Permitting Agency.:		NA

### WORK PERFORMED THIS QUARTER (Second Quarter, 2008):

1. Submit First Quarter, 2008 Semi-Annual Ground-Water Monitoring Report. Report completed by BAI.
2. No ground-water monitoring/sampling work activities were completed on the Property during the Second Quarter, 2008

### WORK PROPOSED FOR NEXT QUARTER (Third Quarter, 2008):

1. Submit Second Quarter, 2007 Status Report (contained herein).
2. Conduct ground-water monitoring/sampling for Third Quarter, 2008.

### QUARTERLY RESULTS SUMMARY:

Current phase of project:	<b>Ground-water monitoring/sampling</b>
Frequency of ground-water sampling:	<b>MW-4, MW-7, RW-1 = Semi-Annual (1Q and 3Q) MW-2, MW-5, MW-6, MW-11, VW-1, = Annual (3Q)</b>
Frequency of ground-water monitoring:	<b>Semi-annual (1Q and 3Q)</b>
Is free product (FP) present on-site:	<b>No</b>
FP recovered this quarter:	<b>NA (FP last recovered in 1992)</b>
Cumulative FP recovered:	<b>3.06 gallons, Wells MW-1, MW-2, and MW-5</b>
Current remediation techniques:	<b>Air diffusion</b>
Depth to ground water (below TOC):	<b>NA</b>
General ground-water flow direction:	<b>NA</b>
Approximate hydraulic gradient:	<b>NA</b>

### DISCUSSION:

No ground-water monitoring/sampling activities took place at Station #771 during the Second Quarter, 2008. The attached Drawing 1 depicts the site and monitor well locations. The most recent quarterly data can be referenced in the First Quarter, 2008 Semi-Annual Ground-Water Monitoring Report.

### ATTACHMENTS:

Drawing 1. Site Map, Station #771, Livermore, CA

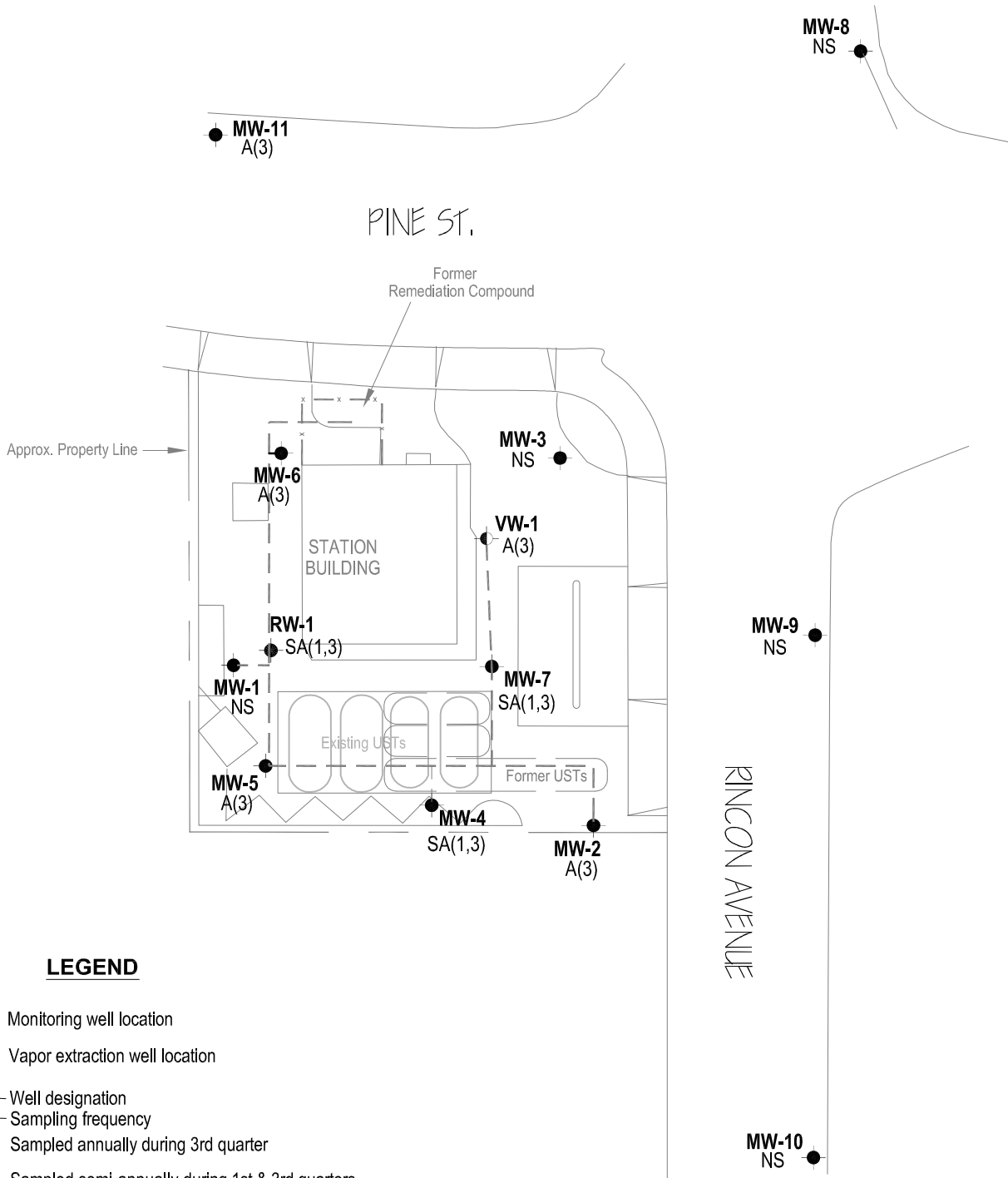

**LEGEND**

- Monitoring well location
- Vapor extraction well location

- Well** — Well designation  
 A,SA — Sampling frequency  
 A(3) — Sampled annually during 3rd quarter  
 SA(1,3) — Sampled semi-annually during 1st & 3rd quarters  
 NS — Not sampled  
 - - - Remediation piping

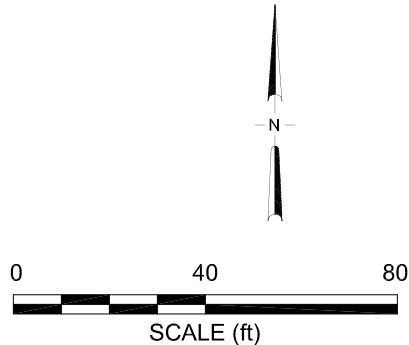

NOTE: SITE MAP ADAPTED FROM URS FIGURES.  
 SITE DIMENSIONS AND FACILITY LOCATIONS NOT VERIFIED.