

Broadbent & Associates, Inc.
1324 Mangrove Ave., Suite 212
Chico, CA 95926
Voice (530) 566-1400
Fax (530) 566-1401

RECEIVED

2:28 pm, Jan 31, 2008

Alameda County
Environmental Health



January 21, 2008

Project No. 06-02-608

Atlantic Richfield Company
P.O. Box 1257
San Ramon, CA 94583
Submitted via ENFOS

Attn.: Mr. Paul Supple

Re: Fourth Quarter, 2007 Status Report, Atlantic Richfield Company (a BP affiliated company) Station #771, 899 Rincon Avenue, Livermore, California. ACEH Case No. RO0000200.

Dear Mr. Supple:

Attached is the *Fourth Quarter, 2007 Status Report* for Atlantic Richfield Company Station #771 (herein referred to as Station #771) located at 899 Rincon Avenue, Livermore, California (Property).

Should you have questions please do not hesitate to contact us at (530) 566-1400.

Sincerely,

BROADBENT & ASSOCIATES, INC.

A handwritten signature in black ink, appearing to read 'M. G. Herrick'.

Matthew G. Herrick, P.G.
Project Hydrogeologist

A handwritten signature in black ink, appearing to read 'Robert H. Miller'.

Robert H. Miller, P.G., C.H.G.
Principal Hydrogeologist

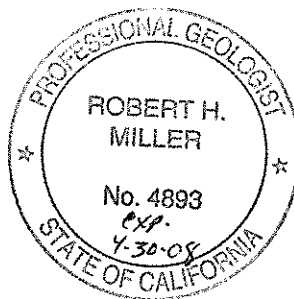

Enclosures

cc: Mr. Steven Plunkett, Alameda County Environmental Health, 1131 Harbor Bay Parkway, Suite 250, Alameda, CA, 94502 (Submitted via ACEH ftp Site)
Mr. Paul M. Smith, Livermore-Pleasanton Fire Department, 3560 Nevada St., Pleasanton, CA 94566
Mr. Chuck Headlee, RWQCB, 1515 Clay St. Suite 1400, Oakland, CA 94612
GeoTracker

STATION #771 QUARTERLY STATUS REPORT

Facility: #771	Address: 899 Rincon Avenue, Livermore, California
Station #771 Environmental Business Manager:	Mr. Paul Supple
Consulting Co./Contact Persons:	Broadbent & Associates, Inc. (BAI) / Rob Miller & Matt Herrick
Primary Agency/Regulatory ID No.:	Alameda County Environmental Health (ACEH) / ACEH Case No. RO0000200
Consultant Project No.:	06-02-608
Facility Permits/Permitting Agency.:	NA

WORK PERFORMED THIS QUARTER (Fourth Quarter, 2007):

1. Submit Third Quarter, 2007 Semi-Annual Ground-Water Monitoring Report. Report completed by BAI.
2. No ground-water monitoring/sampling work activities were completed on the Property during the Fourth Quarter, 2007

WORK PROPOSED FOR NEXT QUARTER (First Quarter, 2008):

1. Submit Fourth Quarter, 2007 Status Report (contained herein).
2. Conduct ground-water monitoring/sampling for First Quarter, 2008.

QUARTERLY RESULTS SUMMARY:

Current phase of project:	Ground-water monitoring/sampling
Frequency of ground-water sampling:	MW-4, MW-7, RW-1 = Semi-Annual (1Q and 3Q) MW-2, MW-5, MW-6, MW-11, VW-1, = Annual (3Q)
Frequency of ground-water monitoring:	Semi-annual (1Q and 3Q)
Is free product (FP) present on-site:	No
FP recovered this quarter:	NA (FP last recovered in 1992)
Cumulative FP recovered:	3.06 gallons, Wells MW-1, MW-2, and MW-5
Current remediation techniques:	Air diffusion
Depth to ground water (below TOC):	NA
General ground-water flow direction:	NA
Approximate hydraulic gradient:	NA

DISCUSSION:

No ground-water monitoring/sampling activities took place at Station #771 during the Fourth Quarter, 2007. The attached Drawing 1 depicts the site and monitor well locations. The most recent quarterly data can be referenced in the Third Quarter, 2007 Semi-Annual Ground-Water Monitoring Report.

ATTACHMENTS:

Drawing 1. Site Map, Station #771, Livermore, CA

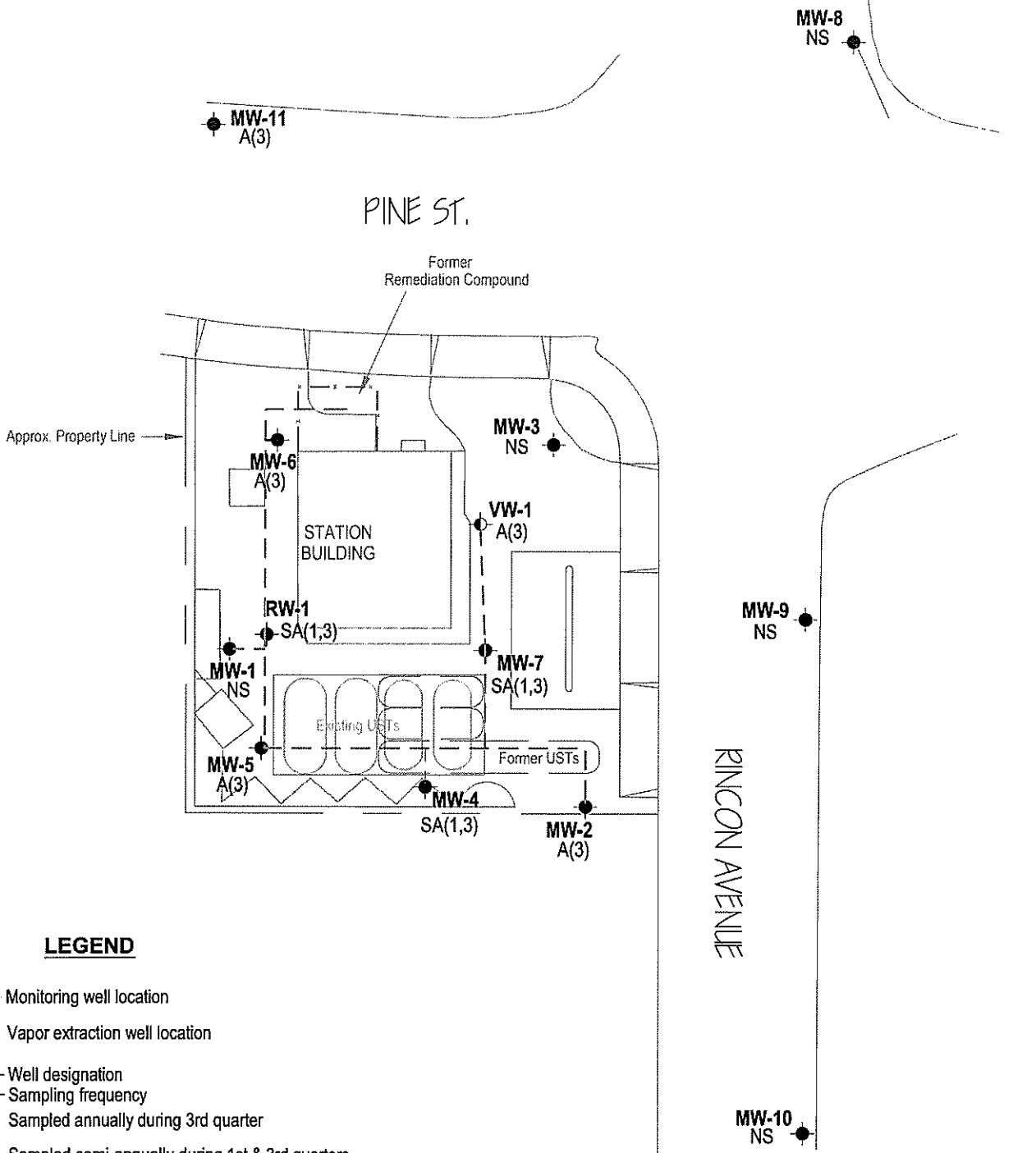

LEGEND

- Monitoring well location
- Vapor extraction well location

- Well** — Well designation
A,SA — Sampling frequency
 A(3) — Sampled annually during 3rd quarter
 SA(1,3) — Sampled semi-annually during 1st & 3rd quarters
 NS — Not sampled
 - - - Remediation piping

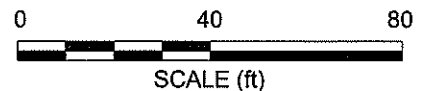
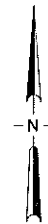

NOTE: SITE MAP ADAPTED FROM URS FIGURES.
 SITE DIMENSIONS AND FACILITY LOCATIONS NOT VERIFIED.