

July 23, 2001

Ms. Eva Chu  
Alameda County Health Care Services Agency  
1131 Harbor Bay Parkway, 2nd Floor  
Alameda, California 94502

Re: **Second Quarter 2001 Status Report**  
ARCO Service Station No. 0771  
899 Rincon Avenue  
Livermore, California  
Cambria Project #436-1607



Dear Ms. Chu:

On behalf of ARCO, Cambria Environmental Technology, Inc. (Cambria) is submitting the attached second quarter 2001 status report for ARCO Service Station No. 0771, located at 899 Rincon Avenue, Livermore, California. The monitoring program complies with ACHCSA requirements regarding underground tank investigations.

Please call if you have questions.

Sincerely,

**Cambria Environmental Technology, Inc.**

Ron Scheele, RG  
Senior Project Manager



Attachment: Second Quarter 2001 Status Report

cc: Paul Supple, ARCO, PO Box 6549 Moraga, CA 94570  
Danielle Stefani, City of Livermore Fire Dept., 4550 East Avenue, Livermore, CA 94550

Oakland, CA  
San Ramon, CA  
Sonoma, CA

**Cambria  
Environmental  
Technology, Inc.**

1144 65th Street  
Suite B  
Oakland, CA 94608  
Tel (510) 420-0700  
Fax (510) 420-9170

H:\ARCO\0771\QMR\0771Q300.doc

Date: July 23, 2001  
Quarter: 2<sup>nd</sup> Quarter, 2001

**ARCO QUARTERLY STATUS REPORT**

Station No.: 0771 Address: 899 Rincon Avenue, Livermore, California  
ARCO Environmental Engineer/Phone No.: Paul Supple /(925) 299-8891  
Consulting Co./Contact Person: Cambria Environmental Technology, Inc. / Ron Scheele, RG  
Consultant Project No.: 436-1607  
Primary Agency/Regulatory ID No.: ACHCSA

**WORK PERFORMED THIS QUARTER (SECOND - 2001):**



1. Submitted semi-annual groundwater monitoring report for first quarter 2001.
2. Performed product piping removal compliance sampling on June 15, 2001.

**WORK PROPOSED FOR NEXT QUARTER (THIRD - 2001):**

1. Prepare and submit quarterly status report for second quarter 2001.
2. Perform semi-annual groundwater monitoring and sampling for third quarter 2001.
3. Submit dispenser and product piping removal report.

**SEMI-ANNUAL MONITORING**

Current Phase of Project: Semi-Annual Groundwater Monitoring  
Frequency of Sampling: Annual (3rd Quarter): MW-2, MW-5, MW-11  
Semi-Annual (1st/3rd Quarter): MW-4, MW-6, MW-7, RW-1, VW-1

**DISCUSSION**

No groundwater sampling was performed this quarter according to the semi-annual sampling schedule. The site will be sampled during the third quarter, 2001.

**ATTACHMENT:**

- Figure 1 - Site Plan

H:\ARCO\0771\FIGURES\SITE\PLAN.DWG

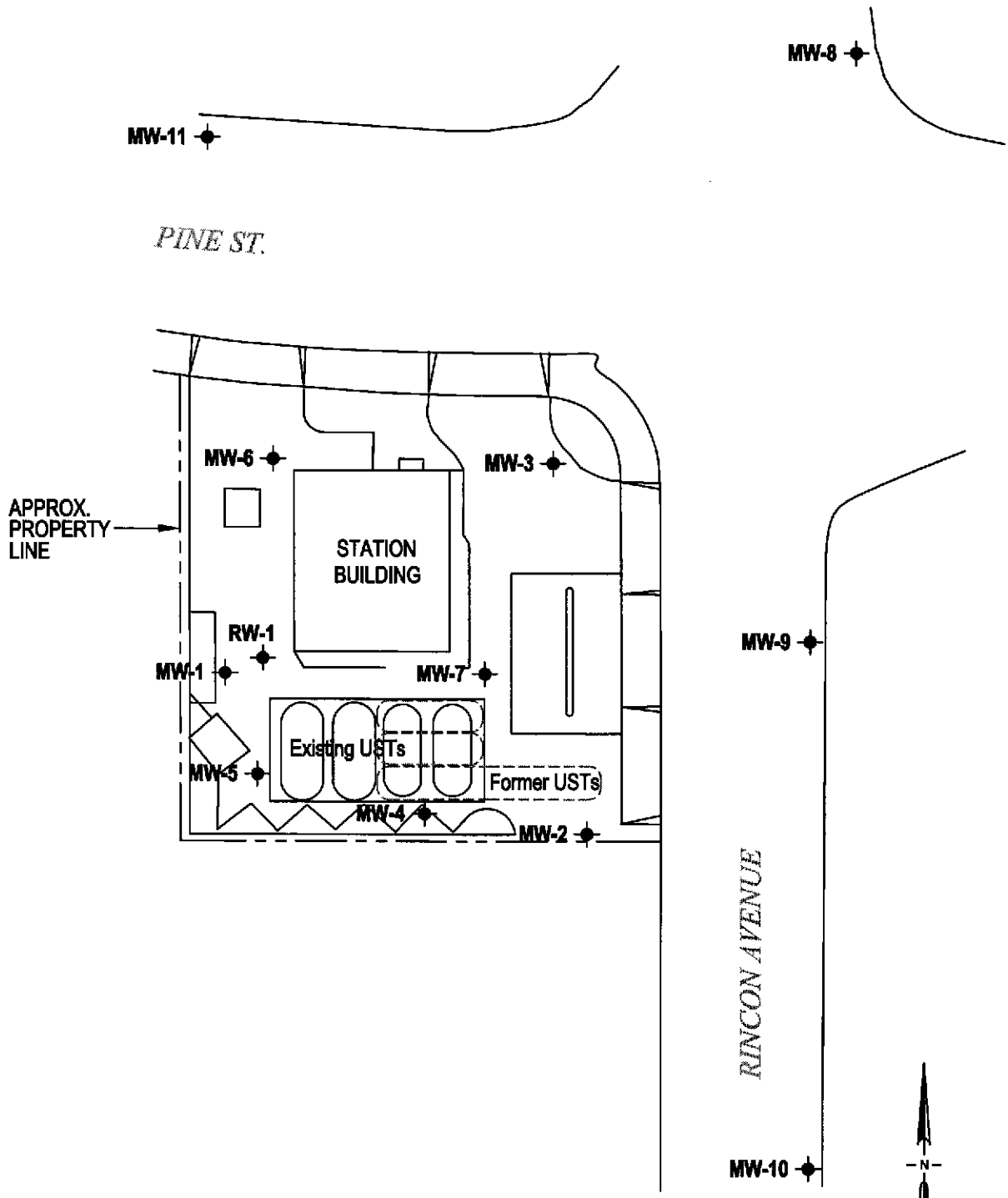

**EXPLANATION**

MW-1 ◆ Monitoring well location

FIGURE

**1**

**ARCO Service Station 0771**  
 899 Rincon Avenue  
 Livermore, California



**C A M B R I A**

**Site Plan**