

RECEIVED

By Alameda County Environmental Health at 3:08 pm, Feb 03, 2014

Atlantic Richfield Company

Chuck Carmel
Project Manager

PO Box 1257
San Ramon, CA 94583
Phone: (925) 275-3803
Fax: (925) 275-3815
E-Mail: charles.carmel@bp.com

January 27, 2014

Re: Fourth Quarter 2013 Status Report
Atlantic Richfield Company Station #771
899 Rincon Avenue
Livermore, California
ACEH Case RO0000200

"I declare, that to the best of my knowledge at the present time, that the information and/or recommendations contained in the attached document are true and correct.

Submitted by,



Chuck Carmel
Project Manager

Attachment



1370 Ridgewood Drive, Suite 5, Chico, CA 95973
[T] 530-566-1400 [F] 530-566-1401
broadbentinc.com

CREATING SOLUTIONS. BUILDING TRUST.

January 27, 2014

Project No. 06-82-608

Atlantic Richfield Company
P.O. Box 1257
San Ramon, CA 94583
Submitted via ENFOS

Attn.: Mr. Chuck Carmel

Re: Fourth Quarter 2013 Status Report, Atlantic Richfield Company Station #771, 899 Rincon Avenue, Livermore, California; ACEH Case No. RO0000200

Dear Mr. Carmel:

Provided herein is the *Fourth Quarter 2013 Status Report* for Atlantic Richfield Company (a BP affiliated company) Station #771 located at 899 Rincon Ave., Livermore, Alameda County, California (Site). This report presents a summary of current developments regarding the Site through the Fourth Quarter 2013.

Should you have questions regarding this submission, please do not hesitate to contact us at (530) 566-1400.

Sincerely,
BROADBENT & ASSOCIATES, INC.

Jason Duda
Project Scientist

Robert H. Miller, P.G., C.HG
Principal Hydrogeologist

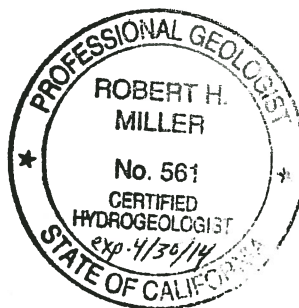

Enclosure

cc: Mr. Jerry Wickham, Alameda County Environmental Health (Submitted via ACEH ftp site)
Mr. Paul M. Smith, Livermore-Pleasanton Fire Department, 3560 Nevada St.,
Pleasanton, California 94566
Mr. Chuck Headlee, California Regional Water Quality Control Board – San Francisco
Region (Submitted via GeoTracker)
Electronic copy uploaded to GeoTracker

**FOURTH QUARTER 2013
STATUS REPORT
STATION #771, LIVERMORE, CALIFORNIA**

Broadbent & Associates, Inc. (Broadbent) is pleased to present this *Fourth Quarter 2013 Status Report* on behalf of Atlantic Richfield Company (a BP affiliated company) for Station #771 located in Livermore, Alameda County, California. Reporting is being submitted to Alameda County Environmental Health (ACEH) consistent with the requirements under the legal authority of the California Regional Water Quality Control Board, as codified by the California Code of Regulations Title 23, Section 2652(d). A summary description of current developments regarding the site is provided below.

Facility Name / Address:	Station #771 / 899 Rincon Avenue, Livermore, CA
Client Project Manager / Title:	Mr. Chuck Carmel / Project Manager
Broadbent Contact:	Jason Duda, (530) 566-1400
Broadbent Project No.:	06-82-608
Primary Regulatory Agency / ID No.:	ACEH / Case #RO0000200
Current phase of project:	Monitoring and Additional Site Assessment
List of Acronyms / Abbreviations:	See end of report text for list of acronyms/abbreviations used in report.

WORK PERFORMED THIS QUARTER (Fourth Quarter 2013):

1. Submitted *Third Quarter 2013 Monitoring Report* (Broadbent, 10/24/2013).
2. Conducted on-Site assessment activities between October 22 and 23, 2013.

WORK SCHEDULED FOR NEXT QUARTER (First Quarter 2014):

1. Prepared and submitted the *Updated Conceptual Site Model and Soil and Groundwater Investigation Report* (Broadbent, 1/17/2014).
2. Prepare and submit *Fourth Quarter 2013 Status Report* (contained herein).
3. Conduct First Quarter 2014 semi-annual groundwater monitoring and sampling.

GROUNDWATER MONITORING PLAN SUMMARY:

Groundwater level gauging:	MW-1 through MW-11, RW-1, VW-1	(1Q and 3Q)
Groundwater sample collection:	MW-4, MW-7, RW-1 MW-2, MW-5, MW-6, MW-11, VW-1	(1Q and 3Q) (3Q)
Biodegradation indicator parameter monitoring:	NA	

DISCUSSION:

On-Site CPT investigation activities were conducted between October 22 and 23, 2013. Results of the investigation including an updated CSM were submitted in the *Updated Conceptual Site Model and Soil and Groundwater Investigation Report* (Broadbent, 1/17/2014). Based on the results and current site conditions, it is anticipated that a case closure evaluation will be submitted following additional groundwater monitoring/sampling scheduled for conduct during First Quarter 2014.

For reference, a Site Location Map is provided as Drawing 1. Provided as Drawing 2 is the Groundwater Elevation Contour and Analytical Summary Map from the *Third Quarter 2013 Monitoring Report* (Broadbent, 10/24/2013). The next groundwater monitoring and sampling event is scheduled to be conducted during the First Quarter 2014.

ATTACHMENTS:

- Drawing 1: Site Location Map
Drawing 2: Groundwater Elevation Contour and Analytical Summary Map, July 25, 2013

LIST OF COMMONLY USED ACCRONYMS/ABBREVIATIONS:

ACEH:	Alameda County Environmental Health	gal:	Gallons
BTEX:	Benzene, Toluene, Ethylbenzene, Total Xylenes	GRO:	Gasoline-Range Organics
1,2-DCA:	1,2-Dichloroethane	LNAPL:	Light Non-Aqueous Phase Liquid
DIPE:	Di-Isopropyl Ether	MTBE:	Methyl Tertiary Butyl Ether
DO:	Dissolved Oxygen	NO ₃ :	Nitrate as Nitrogen
DRO:	Diesel-Range Organics	ppb:	parts per billion
EDB:	1,2-Dibromomethane	SO ₄ :	Sulfate
Eh:	Oxidation Reduction Potential	TAME:	Tert-Amyl Methyl Ether
EPA:	Environmental Protection Agency	TBA:	Tertiary Butyl Ether
ETBE:	Ethyl Tertiary Butyl Ether	TOC:	Top of Casing
Fe ²⁺ :	Ferrous Iron	µg/L:	micrograms per liter
ft/ft:	feet per foot		

DRAWINGS

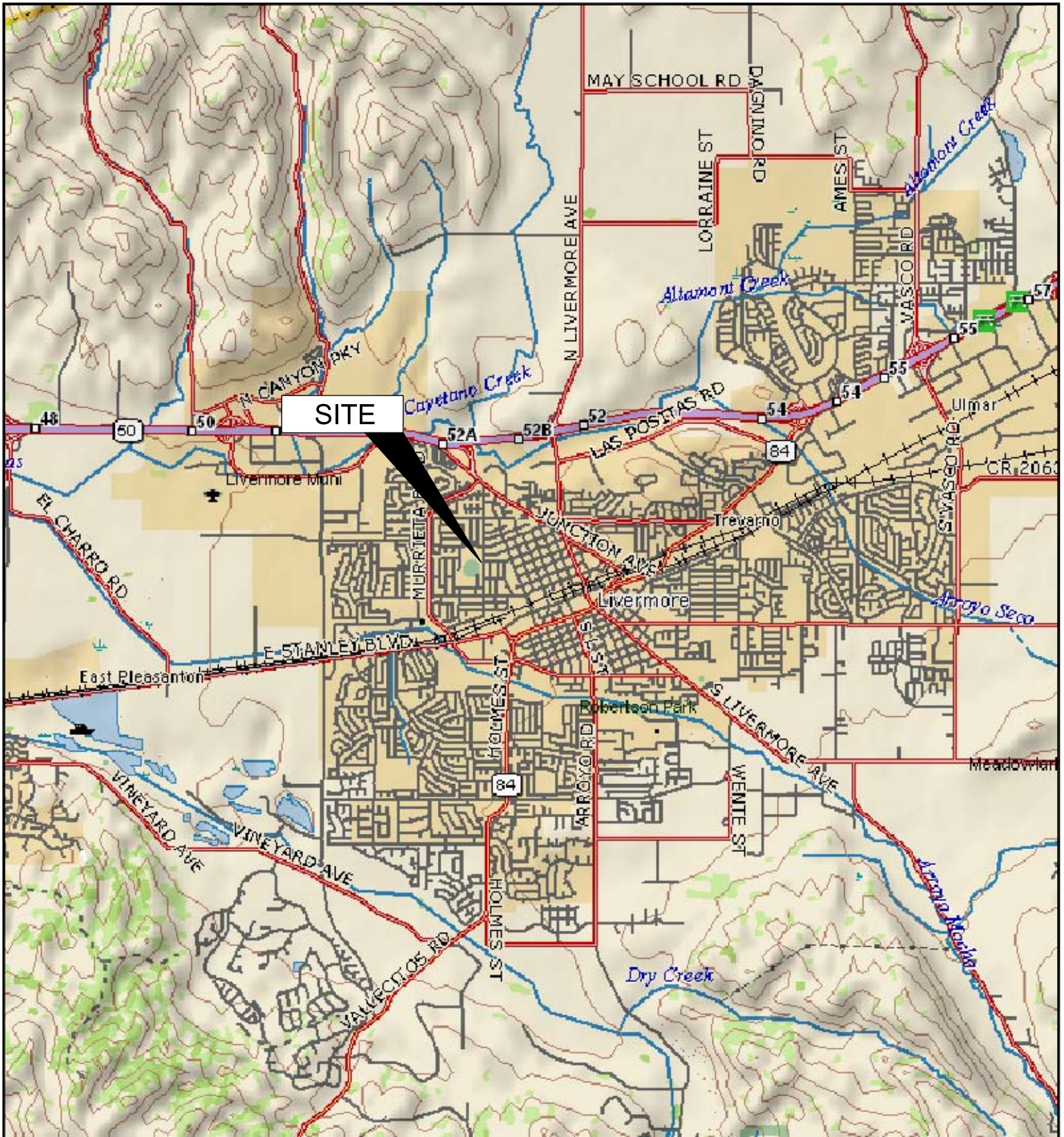

APPROXIMATE SCALE (mi)

IMAGE SOURCE: DELORME



1370 Ridgewood Drive, Suite 5
Chico, California 95973

Project No.: 06-82-608 Date: 9/6/2012

Station #771
899 Rincon Avenue
Livermore, California

Site Location Map

Drawing

1

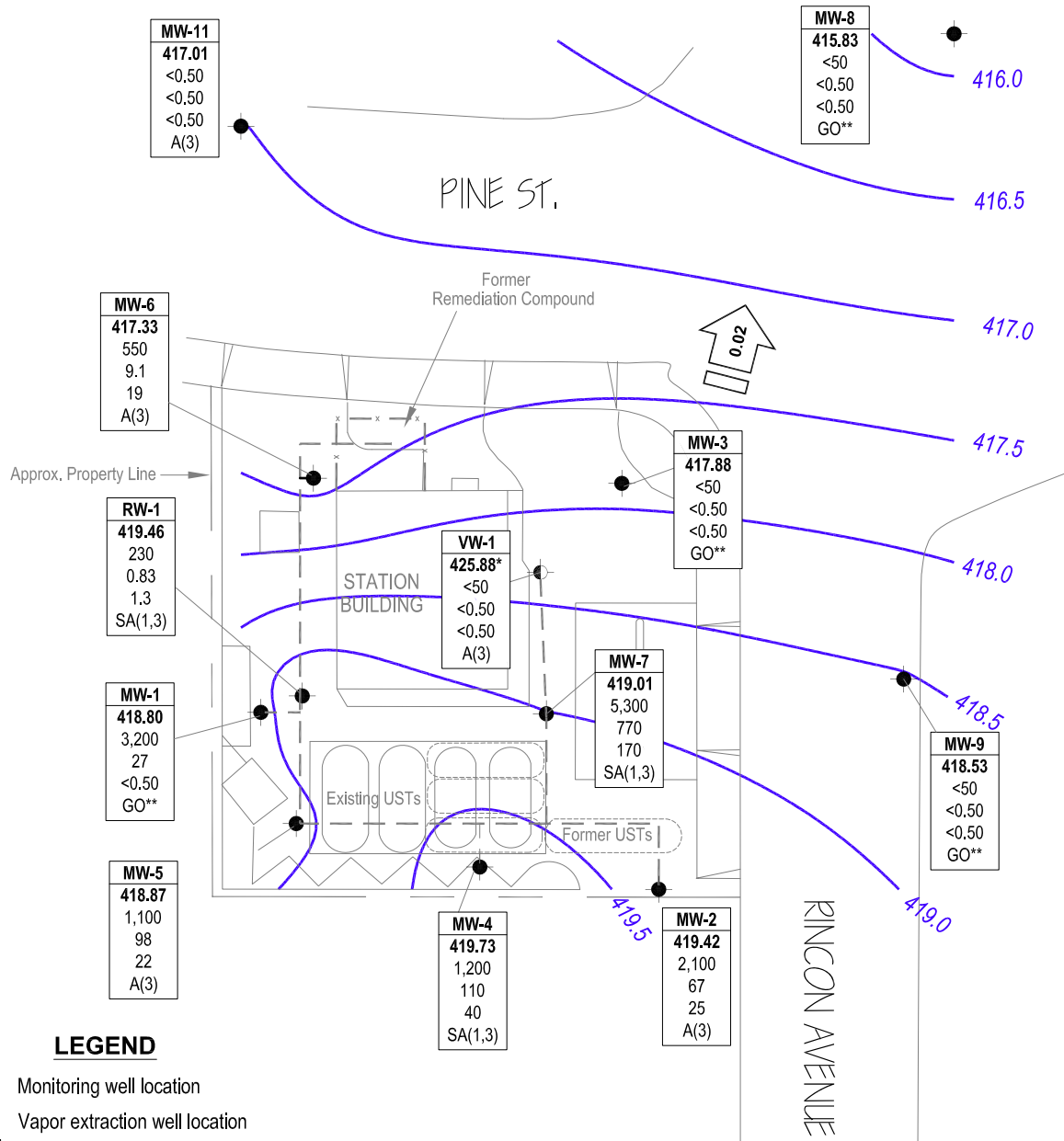

LEGEND

- Monitoring well location
- ◐ Vapor extraction well location
- Well ID** — Well designation
- ELEV** — Groundwater elevation (ft above MSL)
- GRO** — GRO, Benzene & MTBE concentrations (µg/L)
- MTBE** — Sampling frequency
- SA or A** — Sampling frequency
- < — Not detected at or above laboratory reporting limits
- * — Not used in contouring
- ** — Sampled during current event
- NG — Not gauged
- NS — Not sampled
- A(3) — Sampled annually during 3rd quarter
- GO — Not sampled, gauged only
- SA(1,3) — Sampled semi-annually, 1st & 3rd quarters
- 425.5 — Groundwater elevation contour (ft above MSL)
- ← 0.02 — Approximate groundwater flow direction and gradient (ft/ft)
- Remediation piping

MW-10
NG
NS
NS
NS
GO

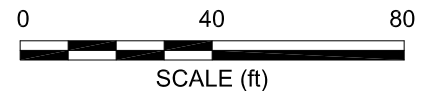

NOTE: SITE MAP ADAPTED FROM URS FIGURES. SITE DIMENSIONS AND FACILITY LOCATIONS NOT VERIFIED.