



Atlantic Richfield Company  
(a BP affiliated company)

P.O. Box 1257  
San Ramon, CA 94583  
Phone: (925) 275-3801  
Fax: (925) 275-3815

April 20, 2007

Re: First Quarter, 2007 Semi-Annual Ground-Water Monitoring Report  
Atlantic Richfield Company Station #771  
899 Rincon Avenue  
Livermore, California  
ACEH Case RO0000200

**RECEIVED**

1:05 pm, May 01, 2007

Alameda County  
Environmental Health



"I declare, that to the best of my knowledge at the present time, that the information and/or recommendations contained in the attached document are true and correct."

Submitted by:

Paul Supple  
Environmental Business Manger

**First Quarter, 2007 Semi-Annual  
Ground-Water Monitoring Report**  
Atlantic Richfield Company Station #771  
899 Rincon Avenue  
Livermore, California

Prepared for

Mr. Paul Supple  
Environmental Business Manager  
Atlantic Richfield Company  
P.O. Box 1257  
San Ramon, California 94583

Prepared by



1324 Mangrove Avenue, Suite 212  
Chico, California 95926  
(530) 566-1400  
[www.broadbentinc.com](http://www.broadbentinc.com)

April 2007

Project No. 06-02-608

Broadbent & Associates, Inc.  
1324 Mangrove Ave., Suite 212  
Chico, CA 95926  
Voice (530) 566-1400  
Fax (530) 566-1401



April 20, 2007

Project No. 06-02-608

Atlantic Richfield Company  
P.O. Box 1257  
San Ramon, CA 94583  
Submitted via ENFOS

Attn.: Mr. Paul Supple

Re: First Quarter, 2007 Semi-Annual Ground-Water Monitoring Report, Atlantic Richfield Company Station #771, 899 Rincon Avenue, Livermore California. ACEH Case RO0000200.

Dear Mr. Supple:

Attached is the *First Quarter, 2007 Semi-Annual Ground-Water Monitoring Report* for Atlantic Richfield Company Station #771 (herein referred to as Station #771) located at 899 Rincon Avenue, Livermore, California (Property). This report presents a summary of First Quarter, 2007 ground-water monitoring results.

Should you have questions regarding the work performed or results obtained, please do not hesitate to contact us at (530) 566-1400.

Sincerely,

BROADBENT & ASSOCIATES, INC.

A handwritten signature in black ink, appearing to read 'M. G. Herrick', with a long horizontal line extending to the right.

Matthew G. Herrick, P.G.  
Project Hydrogeologist

A handwritten signature in black ink, appearing to read 'Robert H. Miller', with a long horizontal line extending to the right.

Robert H. Miller, P.G., C.H.G.  
Principal Hydrogeologist

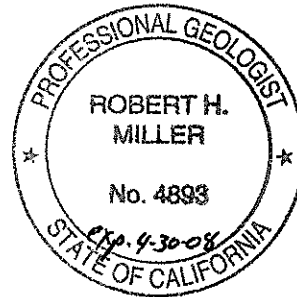

Enclosures

cc: Mr. Steven Plunkett, Alameda County Environmental Health, 1131 Harbor Bay Parkway, Suite 250, Alameda, CA, 94502 (Submitted via ACEH ftp Site)  
Mr. Paul M. Smith, Livermore-Pleasanton Fire Department, 3560 Nevada St., Pleasanton, CA 94566  
Mr. John Kaiser, RWQCB, 1515 Clay St. Suite 1400, Oakland, CA 94612

## STATION #771 SEMI-ANNUAL GROUND-WATER MONITORING REPORT

Facility: #771 Address: 899 Rincon Avenue, Livermore, CA  
Station #771 Environmental Business  
Manager: Mr. Paul Supple  
Consulting Co./Contact Persons: Broadbent & Associates, Inc. (BAI) / Rob Miller & Matt Herrick  
Primary Agency/Regulatory ID No.: Alameda County Environmental Health (ACEH)/ ACEH Case RO0000200  
Consultant Project No.: 06-02-608  
Facility Permits/Permitting Agency.: NA

### WORK PERFORMED THIS QUARTER (First Quarter, 2007):

1. Submitted Fourth Quarter, 2006 Status Report. Work performed by BAI.
2. Conducted ground-water monitoring/sampling for First Quarter, 2007. Work performed by Stratus Environmental, Inc.

### WORK PROPOSED FOR NEXT QUARTER (Second Quarter, 2007):

1. Submit First Quarter, 2007 Semi-Annual Ground-Water Monitoring Report (contained herein).
2. No environmental work activities are scheduled to be completed on the Property during the Second Quarter, 2007.

### QUARTERLY RESULTS SUMMARY:

Current phase of project:	<b>Monitoring</b>
Frequency of ground-water sampling:	<b>MW-4, MW-7, RW-1 = Semi-Annual (1Q and 3Q) MW-2, MW-5, MW-6, MW-11, VW-1, = Annual (3Q)</b>
Frequency of ground-water monitoring:	<b>Semi-annual (1Q and 3Q)</b>
Is free product (FP) present on-site:	<b>No</b>
FP recovered this quarter:	<b>NA (FP last recovered in 1992)</b>
Cumulative FP recovered:	<b>3.06 gallons, Wells MW-1, MW-2, and MW-5</b>
Current remediation techniques:	<b>Air Diffusion</b>
Depth to ground water (below TOC):	<b>21.67 (VW-1) to 33.20 (MW-8)</b>
General ground-water flow direction:	<b>North-Northeast and Southwest</b>
Approximate hydraulic gradient:	<b>0.03 and 0.02 feet per foot</b>

### DISCUSSION:

During First Quarter, 2007 gasoline range organics (GRO) were detected in two wells with concentrations of 5,600 micrograms per liter ( $\mu\text{g/L}$ ) in MW-7 and 6,900  $\mu\text{g/L}$  in RW-1. Benzene was detected in MW-7 and RW-1 at concentrations of 16  $\mu\text{g/L}$  and 17  $\mu\text{g/L}$ , respectively. Ethylbenzene was detected in wells MW-7 and RW-1 at concentrations of 26  $\mu\text{g/L}$  and 22  $\mu\text{g/L}$ , respectively. Toluene was detected in only one well (RW-1) at a concentration of 2.8  $\mu\text{g/L}$ . Xylenes were detected in MW-7 and RW-1 at concentrations of 12  $\mu\text{g/L}$  and 31  $\mu\text{g/L}$ , respectively. Methyl tert-butyl ether (MTBE) was detected in all three wells sampled with concentrations ranging from 2.6  $\mu\text{g/L}$  in RW-1 to 11  $\mu\text{g/L}$  in MW-4. No other analytes were detected during First Quarter, 2007.

Analytes detected during First Quarter, 2007 were all within the historic minimum and maximum concentration ranges recorded for each well, with the following exception: benzene in MW-7 is the lowest concentration historically detected in the well. Ground-water elevations for First Quarter, 2007 were within historic minimum and maximum ranges for each well.

Drawing 1 depicts a ground-water elevation contour and an analytical summary map for the First Quarter, 2007. Table 1 includes a summary of ground-water monitoring data including relative water elevations and laboratory analyses. Table 2 provides a summary of fuel additives analytical data. Table 3 lists historical ground-water flow direction and gradient data.

#### **CLOSURE:**

The findings presented in this report are based upon: observations of Stratus field personnel (see Appendix A), the points investigated, and results of laboratory tests performed by TestAmerica (Morgan Hill, CA). Our services were performed in accordance with the generally accepted standard of practice at the time this report was written. No other warranty, expressed or implied was made. This report has been prepared for the exclusive use of Atlantic Richfield Company. It is possible that variations in soil or ground-water conditions could exist beyond points explored in this investigation. Also, changes in site conditions could occur in the future due to variations in rainfall, temperature, regional water usage, or other factors.

#### **ATTACHMENTS:**

- Drawing 1. Ground-Water Elevation Contour and Analytical Summary Map, Station #771, Livermore, CA
- Table 1. Summary of Ground-Water Monitoring Data: Relative Water Elevations and Laboratory Analyses, Station #771, Livermore, CA
- Table 2. Summary of Fuel Additives Analytical Data, Station #771, Livermore, CA
- Table 3. Historical Ground-Water Flow Direction and Gradient, Station #771, Livermore, CA
- Appendix A. Stratus Environmental, Inc. Ground-Water Sampling Data Package (Includes Bill of Lading, Field Data Sheets, and Laboratory Report and Chain of Custody Documentation)
- Appendix B. GeoTracker Upload Confirmation

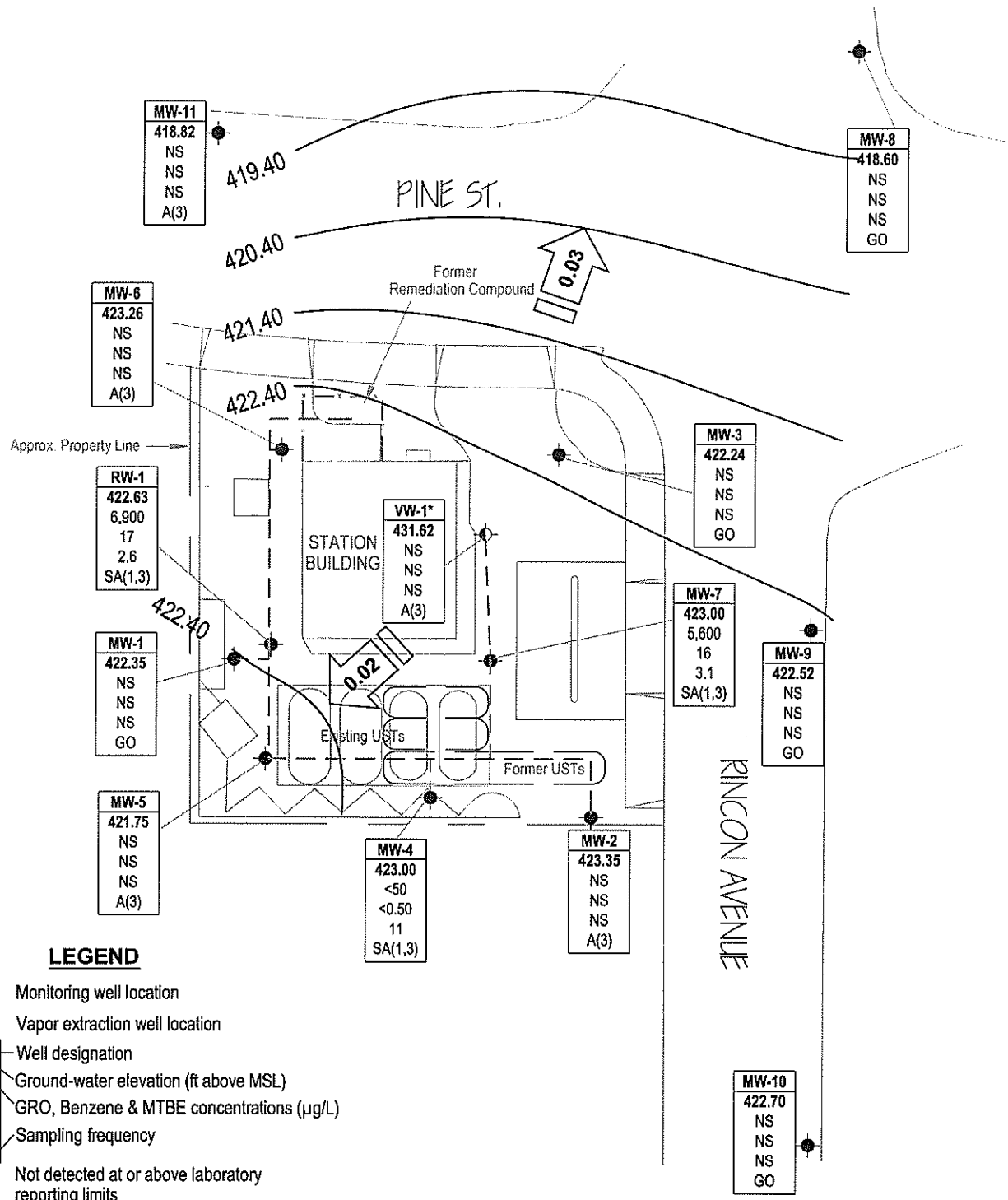

**LEGEND**

- Monitoring well location
- Vapor extraction well location
- Well ID** — Well designation
- ELEV** — Ground-water elevation (ft above MSL)
- GRO** — GRO, Benzene & MTBE concentrations (µg/L)
- Benzene** —
- MTBE** —
- SA or A** — Sampling frequency
- < — Not detected at or above laboratory reporting limits
- \* — Not used in contouring
- NS — Not sampled
- A(3) — Sampled annually during 3rd quarter
- GO — Not sampled, gauged only
- SA(1,3) — Sampled semi-annually, 1st & 3rd quarters
- 421.40 — Ground-water elevation contour (ft above MSL)
- Approximate ground-water flow direction and gradient (ft/ft)
- — Remediation piping

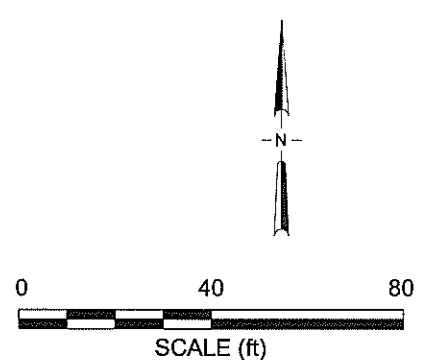

NOTE: SITE MAP ADAPTED FROM URS FIGURES. SITE DIMENSIONS AND FACILITY LOCATIONS NOT VERIFIED.

Table 1. Summary of Ground-Water Monitoring Data: Relative Water Elevations and Laboratory Analyses

Station #771, 899 Rincon Ave., Livermore, CA

Well and Sample Date	P/NP	Comments	TOC (feet msl)	Top of Screen (ft bgs)	Bottom of Screen (ft bgs)	DTW (feet bgs)	Water Level Elevation (feet msl)	Concentrations in (µg/L)						DO (mg/L)	pH
								GRO/TPHg	Benzene	Toluene	Ethyl-Benzene	Total Xylenes	MTBE		
MW-1															
3/20/1995	--		451.73	32.00	41.00	24.50	427.23	90,000	1,800	1,100	1,000	5,600	--	--	--
6/2/1995	--		451.73	32.00	41.00	25.60	426.13	81,000	2,000	1,400	990	4,600	--	--	--
8/23/1995	--		451.73	32.00	41.00	29.04	422.69	44,000	2,400	1,900	670	3,800	<300	--	--
12/4/1995	--		451.73	32.00	41.00	31.31	420.42	22,000	870	660	390	2,200	--	--	--
2/20/1996	--		451.73	32.00	41.00	22.26	429.47	21,000	1,500	1,200	650	3,500	<300	--	--
5/15/1996	--		451.73	32.00	41.00	23.42	428.31	36,000	3,000	2,500	960	5,700	<250	--	--
8/13/1996	--		451.73	32.00	41.00	26.83	424.90	19,000	730	580	450	2,500	<200	--	--
11/13/1996	--		451.73	32.00	41.00	31.05	420.68	6,600	47	16	74	160	<30	--	--
3/26/1997	--		451.73	32.00	41.00	26.29	425.44	1,900	100	55	37	200	<30	--	--
5/15/1997	--		451.73	32.00	41.00	28.65	423.08	16,000	490	250	250	1,100	<120	--	--
8/26/1997	--		451.73	32.00	41.00	31.53	420.20	190	6.7	3	6.3	25	<3	--	--
11/5/1997	--		451.73	32.00	41.00	33.93	417.80	63	0.5	<0.5	0.8	2.4	29	--	--
2/18/1998	--		451.73	32.00	41.00	20.46	431.27	23,000	1,500	610	550	3,000	<120	--	--
5/20/1998	--		451.73	32.00	41.00	23.84	427.89	50,000	4,400	1,900	1,400	80,000	<300	--	--
7/30/1998	P		451.73	32.00	41.00	26.94	424.79	150	<0.5	<0.5	<0.5	1.6	<3	8.74	--
10/29/1998	NP		451.73	32.00	41.00	32.58	419.15	<50	<0.5	<0.5	<0.5	1.8	<3	2.0	--
3/16/1999	P		451.73	32.00	41.00	26.20	425.53	3,200	160	32	89	390	270	2.0	--
5/5/1999	P		451.73	32.00	41.00	27.57	424.16	3,600	140	46	76	290	170	11.65	--
8/26/1999	P		451.73	32.00	41.00	30.25	421.48	3,200	210	29	100	220	120	1.43	--
12/3/1999	NP		451.73	32.00	41.00	32.70	419.03	53	<0.5	<0.5	<0.5	1	<3	2.12	--
3/13/2000	P		451.73	32.00	41.00	24.45	427.28	<50	<0.5	<0.5	<0.5	<1	<3	5.81	--
6/20/2000	--	b	451.73	32.00	41.00	--	--	67.4	3.88	<0.500	1.78	1.48	<2.50	--	--
6/20/2000	P		451.73	32.00	41.00	27.79	423.94	356	40.1	7.17	11.9	22.7	<2.50	5.1	--
8/31/2000	--		451.73	32.00	41.00	30.35	421.38	--	--	--	--	--	--	--	--
2/9/2001	--		451.73	32.00	41.00	30.95	420.78	--	--	--	--	--	--	--	--
9/17/2001	--		451.73	32.00	41.00	30.85	420.88	--	--	--	--	--	--	--	--
1/21/2002	--		451.73	32.00	41.00	30.61	421.12	--	--	--	--	--	--	--	--
7/19/2002	--		451.73	32.00	41.00	31.55	420.18	--	--	--	--	--	--	--	--
1/15/2003	--		451.73	32.00	41.00	22.99	428.74	--	--	--	--	--	--	--	--
7/9/2003	--		451.73	32.00	41.00	30.35	421.38	--	--	--	--	--	--	--	--
02/19/2004	--		451.73	32.00	41.00	26.24	425.49	--	--	--	--	--	--	--	--

Table 1. Summary of Ground-Water Monitoring Data: Relative Water Elevations and Laboratory Analyses

Station #771, 899 Rincon Ave., Livermore, CA

Well and Sample Date	P/NP	Comments	TOC (feet msl)	Top of Screen (ft bgs)	Bottom of Screen (ft bgs)	DTW (feet bgs)	Water Level Elevation (feet msl)	Concentrations in (µg/L)						DO (mg/L)	pH
								GRO/TPHg	Benzene	Toluene	Ethyl-Benzene	Total Xylenes	MTBE		
<b>MW-1 Cont.</b>															
08/04/2004	--		454.23	32.00	41.00	26.36	427.87	--	--	--	--	--	--	--	--
01/18/2005	--		454.23	32.00	41.00	24.47	429.76	--	--	--	--	--	--	--	--
07/15/2005	--		454.23	32.00	41.00	29.44	424.79	--	--	--	--	--	--	--	--
01/10/2006	--		454.23	32.00	41.00	22.58	431.65	--	--	--	--	--	--	--	--
7/21/2006	--		454.23	32.00	41.00	20.73	433.50	--	--	--	--	--	--	--	--
1/17/2007	--		454.23	32.00	41.00	31.88	422.35	--	--	--	--	--	--	--	--
<b>MW-2</b>															
3/20/1995	--		449.49	30.00	38.00	20.27	429.22	54,000	2,600	1,600	1,200	7,600	--	--	--
6/2/1995	--		449.49	30.00	38.00	22.32	427.17	37,000	2,200	800	980	4,800	--	--	--
8/23/1995	--		449.49	30.00	38.00	25.69	423.80	65,000	1,100	310	840	3,000	<500	--	--
12/4/1995	--		449.49	30.00	38.00	28.52	420.97	19,000	680	150	410	1,600	--	--	--
2/20/1996	--		449.49	30.00	38.00	19.00	430.49	22,000	1,200	240	590	2,200	<300	--	--
5/15/1996	--		449.49	30.00	38.00	20.03	429.46	25,000	1,200	240	610	2,100	<300	--	--
8/13/1996	--		449.49	30.00	38.00	24.44	425.05	19,000	640	110	420	1,200	<300	--	--
11/13/1996	--		449.49	30.00	38.00	28.42	421.07	15,000	260	52	220	640	<200	--	--
3/26/1997	--		449.49	30.00	38.00	22.98	426.51	17,000	580	120	360	980	<120	--	--
5/15/1997	--		449.49	30.00	38.00	25.40	424.09	18,000	420	63	340	730	<120	--	--
8/26/1997	--		449.49	30.00	38.00	28.38	421.11	5,300	210	26	140	270	<120	--	--
11/5/1997	--		449.49	30.00	38.00	31.93	417.56	560	42	2.6	7	9	<40	--	--
2/18/1998	--		449.49	30.00	38.00	16.87	432.62	18,000	710	120	480	1,100	130	--	--
5/20/1998	--		449.49	30.00	38.00	20.29	429.20	16,000	480	72	440	1,100	<120	--	--
7/30/1998	P		449.49	30.00	38.00	23.51	425.98	9,700	240	33	210	490	<120	9.21	--
10/29/1998	NP		449.49	30.00	38.00	30.08	419.41	58	<0.5	<0.5	<0.5	1.2	<3	1.0	--
3/16/1999	P		449.49	30.00	38.00	23.22	426.27	4,700	120	13	90	220	60	2.0	--
5/5/1999	P		449.49	30.00	38.00	24.05	425.44	5,500	58	7.1	58	98	17	9.09	--
8/26/1999	P		449.49	30.00	38.00	26.44	423.05	3,700	55	11	60	64	26	1.9	--
12/3/1999	NP		449.49	30.00	38.00	30.15	419.34	130	<0.5	<0.5	0.7	1.8	<3	1.96	--
3/13/2000	P		449.49	30.00	38.00	20.68	428.81	<50	<0.5	<0.5	<0.5	<1	<3	--	--
6/20/2000	P		449.49	30.00	38.00	23.08	426.41	226	2.2	<0.500	4.83	7.88	<2.50	4.9	--
8/31/2000	P		449.49	30.00	38.00	26.71	422.78	87.1	1.78	<0.500	1.33	1.15	<2.50	1.59	--



Table 1. Summary of Ground-Water Monitoring Data: Relative Water Elevations and Laboratory Analyses

Station #771, 899 Rincon Ave., Livermore, CA

Well and Sample Date	P/NP	Comments	TOC (feet msl)	Top of Screen (ft bgs)	Bottom of Screen (ft bgs)	DTW (feet bgs)	Water Level Elevation (feet msl)	Concentrations in (µg/L)						DO (mg/L)	pH
								GRO/TPHg	Benzene	Toluene	Ethyl-Benzene	Total Xylenes	MTBE		
<b>MW-2 Cont.</b>															
2/9/2001	--		449.49	30.00	38.00	29.65	419.84	--	--	--	--	--	--	--	--
9/17/2001	P		449.49	30.00	38.00	27.62	421.87	3,100	300	12	8.8	18	120	1.7	--
1/21/2002	--		449.49	30.00	38.00	27.09	422.40	--	--	--	--	--	--	--	--
7/19/2002	P	a	449.49	30.00	38.00	27.82	421.67	4,700	280	13	120	19	16	0.8	7.4
1/15/2003	--		449.49	30.00	38.00	22.18	427.31	--	--	--	--	--	--	--	--
7/9/2003	--		449.49	30.00	38.00	26.40	423.09	3,900	170	<5.0	100	19	39	2.5	7.0
02/19/2004	--		449.49	30.00	38.00	23.85	425.64	--	--	--	--	--	--	--	--
08/04/2004	P		452.05	30.00	38.00	24.71	427.34	5,400	650	21	160	56	78	0.8	7.2
01/18/2005	--		452.05	30.00	38.00	20.86	431.19	--	--	--	--	--	--	--	--
07/15/2005	P		452.05	30.00	38.00	25.92	426.13	5,200	160	5.3	56	10	46	3.1	6.9
01/10/2006	--		452.05	30.00	38.00	19.25	432.80	--	--	--	--	--	--	--	--
7/21/2006	P		452.05	30.00	38.00	25.73	426.32	120	0.90	<0.50	<0.50	<0.50	<0.50	6.08	8.3
1/17/2007	--		452.05	30.00	38.00	28.70	423.35	--	--	--	--	--	--	--	--
<b>MW-3</b>															
3/20/1995	--		450.28	32.00	40.00	22.19	428.09	94	<0.5	<0.5	<0.5	<0.5	--	--	--
6/2/1995	--		450.28	32.00	40.00	23.28	427.00	72	<0.5	<0.5	<0.5	<0.5	--	--	--
8/23/1995	--		450.28	32.00	40.00	26.55	423.73	98	<0.5	<0.5	<0.6	0.5	<3	--	--
12/4/1995	--		450.28	32.00	40.00	29.52	420.76	<50	<0.5	<0.5	<0.5	<0.5	--	--	--
2/20/1996	--		450.28	32.00	40.00	19.83	430.45	130	<0.5	<0.5	<0.5	<0.5	<3	--	--
5/15/1996	--		450.28	32.00	40.00	21.03	429.25	120	<0.5	<0.5	<0.5	<0.5	<0.5	--	--
8/13/1996	--		450.28	32.00	40.00	25.67	424.61	<50	<0.5	<0.5	<0.5	<0.5	<3	--	--
11/13/1996	--		450.28	32.00	40.00	21.57	428.71	<50	<0.5	<0.5	<0.5	<0.5	<3	--	--
3/26/1997	--		450.28	32.00	40.00	24.15	426.13	<50	1.1	<0.5	<0.5	<0.5	<3	--	--
5/15/1997	--		450.28	32.00	40.00	26.85	423.43	<50	<0.5	<0.5	<0.5	<0.5	<3	--	--
8/26/1997	--		450.28	32.00	40.00	30.07	420.21	<50	<0.5	<0.5	<0.5	<0.5	<3	--	--
11/5/1997	--		450.28	32.00	40.00	32.46	417.82	<50	<0.5	0.7	<0.5	<0.5	<3	--	--
2/18/1998	--		450.28	32.00	40.00	17.82	432.46	<50	<0.5	<0.5	<0.5	<0.5	<3	--	--
5/20/1998	--		450.28	32.00	40.00	21.41	428.87	<50	<0.5	<0.5	<0.5	<0.5	<3	--	--
7/30/1998	P		450.28	32.00	40.00	26.41	423.87	<50	<0.5	<0.5	<0.5	<0.5	<3	9.56	--
10/29/1998	P		450.28	32.00	40.00	31.33	418.95	<50	<0.5	<0.5	<0.5	<0.5	<3	1.0	--

Table 1. Summary of Ground-Water Monitoring Data: Relative Water Elevations and Laboratory Analyses

Station #771, 899 Rincon Ave., Livermore, CA

Well and Sample Date	P/NP	Comments	TOC (feet msl)	Top of Screen (ft bgs)	Bottom of Screen (ft bgs)	DTW (feet bgs)	Water Level Elevation (feet msl)	Concentrations in (µg/L)						DO (mg/L)	pH
								GRO/TPHg	Benzene	Toluene	Ethyl-Benzene	Total Xylenes	MTBE		
<b>MW-3 Cont.</b>															
3/16/1999	P		450.28	32.00	40.00	24.61	425.67	<50	<0.5	<0.5	<0.5	<0.5	<3	1.0	--
5/5/1999	P		450.28	32.00	40.00	25.75	424.53	140	<0.5	<0.5	0.6	<0.5	<3	4.43	--
8/26/1999	P		450.28	32.00	40.00	28.49	421.79	80	0.6	0.6	0.6	1	<3	1.69	--
12/3/1999	P		450.28	32.00	40.00	31.45	418.83	<50	<0.5	<0.5	<0.5	<1	<3	2.26	--
3/13/2000	P		450.28	32.00	40.00	22.18	428.10	<50	<0.5	<0.5	<0.5	<1	<3	4.41	--
6/20/2000	P		450.28	32.00	40.00	26.03	424.25	<50.0	<0.500	<0.500	<0.500	<0.500	<2.50	2.3	--
8/31/2000	--		450.28	32.00	40.00	28.75	421.53	--	--	--	--	--	--	--	--
2/9/2001	--		450.28	32.00	40.00	31.04	419.24	--	--	--	--	--	--	--	--
9/17/2001	--		450.28	32.00	40.00	29.04	421.24	--	--	--	--	--	--	--	--
1/21/2002	--		450.28	32.00	40.00	28.81	421.47	--	--	--	--	--	--	--	--
7/19/2002	--		450.28	32.00	40.00	28.92	421.36	--	--	--	--	--	--	--	--
1/15/2003	--		450.28	32.00	40.00	22.88	427.40	--	--	--	--	--	--	--	--
7/9/2003	--		450.28	32.00	40.00	28.00	422.28	--	--	--	--	--	--	--	--
02/19/2004	--		450.28	32.00	40.00	25.29	424.99	--	--	--	--	--	--	--	--
08/04/2004	--		452.75	32.00	40.00	27.40	425.35	--	--	--	--	--	--	--	--
01/18/2005	--		452.75	32.00	40.00	22.76	429.99	--	--	--	--	--	--	--	--
07/15/2005	--		452.75	32.00	40.00	25.95	426.80	--	--	--	--	--	--	--	--
01/10/2006	--		452.75	32.00	40.00	21.18	431.57	--	--	--	--	--	--	--	--
7/21/2006	--		452.75	32.00	40.00	25.73	427.02	--	--	--	--	--	--	--	--
1/17/2007	--		452.75	32.00	40.00	30.51	422.24	--	--	--	--	--	--	--	--
<b>MW-4</b>															
3/20/1995	--		451.09	26.00	42.00	22.68	428.41	12,000	1,000	100	450	700	--	--	--
6/2/1995	--		451.09	26.00	42.00	24.41	426.68	9,000	850	56	380	430	--	--	--
8/23/1995	--		451.09	26.00	42.00	27.72	423.37	5,300	400	25	240	170	<100	--	--
12/4/1995	--		451.09	26.00	42.00	29.85	421.24	6,700	100	<10	90	38	--	--	--
2/20/1996	--		451.09	26.00	42.00	21.16	429.93	7,000	360	22	180	160	<70	--	--
5/15/1996	--		451.09	26.00	42.00	22.18	428.91	--	--	--	--	--	--	--	--
8/13/1996	--		451.09	26.00	42.00	26.20	424.89	--	--	--	--	--	--	--	--
11/13/1996	--		451.09	26.00	42.00	29.72	421.37	--	--	--	--	--	--	--	--
3/26/1997	--		451.09	26.00	42.00	21.86	429.23	8,900	390	33	200	250	<70	--	--

Table 1. Summary of Ground-Water Monitoring Data: Relative Water Elevations and Laboratory Analyses

Station #771, 899 Rincon Ave., Livermore, CA

Well and Sample Date	P/NP	Comments	TOC (feet msl)	Top of Screen (ft bgs)	Bottom of Screen (ft bgs)	DTW (feet bgs)	Water Level Elevation (feet msl)	Concentrations in (µg/L)						DO (mg/L)	pH
								GRO/TPHg	Benzene	Toluene	Ethyl-Benzene	Total Xylenes	MTBE		
MW-4 Cont.															
5/15/1997	--		451.09	26.00	42.00	26.92	424.17	--	--	--	--	--	--	--	--
8/26/1997	--		451.09	26.00	42.00	29.30	421.79	--	--	--	--	--	--	--	--
11/5/1997	--		451.09	26.00	42.00	32.14	418.95	--	--	--	--	--	--	--	--
2/18/1998	--		451.09	26.00	42.00	19.30	431.79	5,300	220	19	160	130	120	--	--
5/20/1998	--		451.09	26.00	42.00	22.40	428.69	--	--	--	--	--	--	--	--
7/30/1998	--		451.09	26.00	42.00	25.74	425.35	--	--	--	--	--	--	--	--
10/29/1998	--		451.09	26.00	42.00	31.26	419.83	--	--	--	--	--	--	--	--
3/16/1999	P		451.09	26.00	42.00	25.05	426.04	1,900	49	<5	43	<5	82	1.5	--
5/5/1999	--		451.09	26.00	42.00	26.15	424.94	--	--	--	--	--	--	--	--
8/26/1999	--		451.09	26.00	42.00	28.60	422.49	--	--	--	--	--	--	1.43	--
12/3/1999	--		451.09	26.00	42.00	31.53	419.56	--	--	--	--	--	--	--	--
3/13/2000	P		451.09	26.00	42.00	23.61	427.48	<50	<0.5	<0.5	<0.5	<1	<3	3.82	--
6/20/2000	--		451.09	26.00	42.00	26.38	424.71	--	--	--	--	--	--	0.4	--
8/31/2000	NP		451.09	26.00	42.00	29.55	421.54	<50.0	<0.500	<0.500	<0.500	<0.500	<2.50	1.04	--
2/9/2001	NP		451.09	26.00	42.00	30.30	420.79	<50.0	<0.500	<0.500	<0.500	<0.500	<2.50	1.39	--
9/17/2001	NP		451.09	26.00	42.00	29.90	421.19	3,400	51	<5.0	16	23	360	0.92	--
1/21/2002	NP		451.09	26.00	42.00	29.51	421.58	1,900	140	12	27	48	300	1.03	--
7/19/2002	NP	a	451.09	26.00	42.00	30.77	420.32	2,700	150	9.9	<5.0	<5.0	130	1.0	7.3
1/15/2003	--	a	451.09	26.00	42.00	23.56	427.53	4,800	150	5.3	28	46	150	1.3	7.0
7/9/2003	--		451.09	26.00	42.00	29.50	421.59	3,000	210	9.4	6	20	150	2.0	6.9
02/19/2004	P	c	451.09	26.00	42.00	26.35	424.74	4,800	270	11	25	19	180	1.8	6.2
08/04/2004	NP		453.80	26.00	42.00	26.48	427.32	4,200	410	13	49	59	300	0.7	6.7
01/18/2005	P		453.80	26.00	42.00	23.15	430.65	4,500	250	9.5	62	22	160	1.2	6.9
07/15/2005	NP		453.80	26.00	42.00	28.13	425.67	3,500	230	6.1	19	15	230	0.5	7.0
01/10/2006	P		453.80	26.00	42.00	21.49	432.31	5,500	250	7.6	37	25	190	1.3	7.1
7/21/2006	NP		453.80	26.00	42.00	28.88	424.92	66	0.60	<0.50	0.52	0.82	3.1	4.75	8.3
1/17/2007	NP		453.80	26.00	42.00	30.80	423.00	<50	<0.50	<0.50	<0.50	<0.50	11	6.19	8.03
MW-5															
3/20/1995	--		451.40	31.50	41.00	23.20	428.20	26,000	1,300	180	890	2,900	--	--	--
6/2/1995	--		451.40	31.50	41.00	24.80	426.60	39,000	940	160	740	1,900	--	--	--

Table 1. Summary of Ground-Water Monitoring Data: Relative Water Elevations and Laboratory Analyses

Station #771, 899 Rincon Ave., Livermore, CA

Well and Sample Date	P/NP	Comments	TOC (feet msl)	Top of Screen (ft bgs)	Bottom of Screen (ft bgs)	DTW (feet bgs)	Water Level Elevation (feet msl)	Concentrations in (µg/L)						DO (mg/L)	pH
								GRO/TPHg	Benzene	Toluene	Ethyl-Benzene	Total Xylenes	MTBE		
MW-5 Cont.															
8/23/1995	--		451.40	31.50	41.00	28.10	423.30	14,000	490	74	250	890	<300	--	--
12/4/1995	--		451.40	31.50	41.00	29.83	421.57	7,600	230	13	61	80	--	--	--
2/20/1996	--		451.40	31.50	41.00	21.63	429.77	4,300	220	12	45	130	<50	--	--
5/15/1996	--		451.40	31.50	41.00	22.87	428.53	2,200	380	17	58	84	<40	--	--
8/13/1996	--		451.40	31.50	41.00	26.48	424.92	1,700	150	16	24	35	47	--	--
11/13/1996	--		451.40	31.50	41.00	29.68	421.72	850	150	11	19	37	66	--	--
3/26/1997	--		451.40	31.50	41.00	25.14	426.26	2,400	440	21	79	210	68	--	--
5/15/1997	--		451.40	31.50	41.00	27.38	424.02	3,900	510	19	140	240	48	--	--
8/26/1997	--		451.40	31.50	41.00	29.89	421.51	76	4.9	<0.5	1.5	2	9	--	--
11/5/1997	--		451.40	31.50	41.00	32.57	418.83	63	0.8	<0.5	<0.5	1.2	34	--	--
2/18/1998	--		451.40	31.50	41.00	19.99	431.41	6,200	630	70	320	640	320	--	--
5/20/1998	--		451.40	31.50	41.00	23.21	428.19	2,300	340	21	110	140	62	--	--
7/30/1998	P		451.40	31.50	41.00	26.19	425.21	<50	0.8	<0.5	0.6	0.9	<3	8.83	--
10/29/1998	NP		451.40	31.50	41.00	31.92	419.48	<50	<0.5	<0.5	<0.5	<0.5	<3	2.0	--
3/16/1999	P		451.40	31.50	41.00	25.80	425.60	1,300	170	8	59	65	120	2.0	--
5/5/1999	P		451.40	31.50	41.00	27.09	424.31	320	31	1.1	13	13	19	12.09	--
8/26/1999	P		451.40	31.50	41.00	29.67	421.73	260	13	1.7	4.2	6.3	150	1.31	--
12/3/1999	--	d	451.40	31.50	41.00	--	--	--	--	--	--	--	--	--	--
3/13/2000	P		451.40	31.50	41.00	24.51	426.89	<50	<0.5	<0.5	<0.5	<1	<3	4.41	--
6/20/2000	P		451.40	31.50	41.00	27.37	424.03	60.8	4.84	<0.500	1.9	1.59	<2.50	5.3	--
8/31/2000	P		451.40	31.50	41.00	30.21	421.19	<50.0	1.18	<0.500	<0.500	<0.500	3.83	0.97	--
2/9/2001	--		451.40	31.50	41.00	30.19	421.21	--	--	--	--	--	--	--	--
9/17/2001	P		451.40	31.50	41.00	30.71	420.69	2,700	120	10	90	77	330	0.81	--
1/21/2002	--		451.40	31.50	41.00	30.40	421.00	--	--	--	--	--	--	--	--
7/19/2002	P	a	451.40	31.50	41.00	31.93	419.47	1,600	170	7	120	<5.0	180	1.7	7.2
1/15/2003	--		451.40	31.50	41.00	23.12	428.28	--	--	--	--	--	--	--	--
7/9/2003	--		451.40	31.50	41.00	30.95	420.45	2,000	160	5.7	67	27	260	1.5	6.9
02/19/2004	--		451.40	31.50	41.00	26.73	424.67	--	--	--	--	--	--	--	--
08/04/2004	P		453.52	31.50	41.00	26.61	426.91	2,100	250	5.3	73	22	250	2.7	7.0
01/18/2005	--		453.52	31.50	41.00	24.10	429.42	--	--	--	--	--	--	--	--
07/15/2005	P		453.52	31.50	41.00	29.27	424.25	1,600	61	<5.0	8.7	<5.0	270	2.1	6.9

Table 1. Summary of Ground-Water Monitoring Data: Relative Water Elevations and Laboratory Analyses

Station #771, 899 Rincon Ave., Livermore, CA

Well and Sample Date	P/NP	Comments	TOC (feet msl)	Top of Screen (ft bgs)	Bottom of Screen (ft bgs)	DTW (feet bgs)	Water Level Elevation (feet msl)	Concentrations in (µg/L)						DO (mg/L)	pH
								GRO/ TPHg	Benzene	Toluene	Ethyl- Benzene	Total Xylenes	MTBE		
<b>MW-5 Cont.</b>															
01/10/2006	--		453.52	31.50	41.00	22.19	431.33	--	--	--	--	--	--	--	--
7/21/2006	P		453.52	31.50	41.00	30.36	423.16	2,100	29	<5.0	7.5	11	14	2.98	7.1
1/17/2007	--		453.52	31.50	41.00	31.77	421.75	--	--	--	--	--	--	--	--
<b>MW-6</b>															
3/20/1995	--		451.37	32.00	42.00	25.19	426.18	2,600	210	87	82	140	--	--	--
6/2/1995	--		451.37	32.00	42.00	25.75	425.62	1,600	55	7.9	40	26	--	--	--
8/23/1995	--		451.37	32.00	42.00	29.53	421.84	1,400	42	2.5	36	13	<20	--	--
12/4/1995	--		451.37	32.00	42.00	32.28	419.09	2,500	52	5.8	59	13	--	--	--
2/20/1996	--		451.37	32.00	42.00	22.27	429.10	2,500	120	16	73	12	<30	--	--
5/15/1996	--		451.37	32.00	42.00	23.86	427.51	2,000	71	6.4	47	25	<15	--	--
8/13/1996	--		451.37	32.00	42.00	28.55	422.82	3,800	91	8.2	69	25	<20	--	--
11/13/1996	--		451.37	32.00	42.00	32.04	419.33	1,900	55	3.3	55	8.5	16	--	--
3/26/1997	--		451.37	32.00	42.00	26.84	424.53	1,800	51	5	32	15	<30	--	--
5/15/1997	--		451.37	32.00	42.00	29.58	421.79	2,400	46	3	29	9	<12	--	--
8/26/1997	--		451.37	32.00	42.00	32.67	418.70	1,400	61	6	33	10	<12	--	--
11/5/1997	--		451.37	32.00	42.00	34.62	416.75	690	29	2.7	18	3.4	9	--	--
2/18/1998	--		451.37	32.00	42.00	20.09	431.28	1,800	74	5	24	12	19	--	--
5/20/1998	--		451.37	32.00	42.00	24.05	427.32	1,900	280	4	31	16	9	--	--
7/30/1998	P		451.37	32.00	42.00	28.72	422.65	2,300	110	7	36	20	<15	--	--
10/29/1998	P		451.37	32.00	42.00	32.77	418.60	2,500	14	13	17	12	<12	1.0	--
3/16/1999	P		451.37	32.00	42.00	26.45	424.92	1,200	65	4	27	13	18	0.5	--
5/5/1999	P		451.37	32.00	42.00	27.86	423.51	2,200	53	4	26	6	25	5.59	--
8/26/1999	P		451.37	32.00	42.00	30.49	420.88	1,100	11	6	10	4	13	2.35	--
12/3/1999	P		451.37	32.00	42.00	32.35	419.02	370	<0.5	<0.5	0.8	<1	4	2.36	--
3/13/2000	P		451.37	32.00	42.00	28.36	423.01	54	2.1	0.5	0.9	1.4	<3	4.22	--
6/20/2000	P		451.37	32.00	42.00	28.35	423.02	195	1.83	<0.500	0.528	<0.500	<2.50	3.5	--
8/31/2000	P		451.37	32.00	42.00	30.20	421.17	276	3.52	0.788	1.15	0.621	8.73	7.0	--
2/9/2001	--	b	451.37	32.00	42.00	--	--	222	4.49	2.73	0.579	0.523	57.1	--	--
2/9/2001	P		451.37	32.00	42.00	30.70	420.67	253	5.44	2.93	0.924	0.977	48.9	0.59	--
9/17/2001	P		451.37	32.00	42.00	30.94	420.43	<50	<0.50	<0.50	<0.50	<0.50	<2.5	2.79	--

**Table 1. Summary of Ground-Water Monitoring Data: Relative Water Elevations and Laboratory Analyses**  
**Station #771, 899 Rincon Ave., Livermore, CA**

Well and Sample Date	P/NP	Comments	TOC (feet msl)	Top of Screen (ft bgs)	Bottom of Screen (ft bgs)	DTW (feet bgs)	Water Level Elevation (feet msl)	Concentrations in (µg/L)						DO (mg/L)	pH
								GRO/ TPHg	Benzene	Toluene	Ethyl- Benzene	Total Xylenes	MTBE		
<b>MW-6 Cont.</b>															
9/17/2001	--	b	451.37	32.00	42.00	--	--	<50	<0.50	<0.50	<0.50	<0.50	<2.5	--	--
1/21/2002	P		451.37	32.00	42.00	30.55	420.82	<50	<0.50	<0.50	<0.50	<0.50	<5.0	1.9	--
7/19/2002	P	a	451.37	32.00	42.00	30.27	421.10	60	2	<0.50	<0.50	<0.50	<0.50	3.5	7.9
1/15/2003	--	a	451.37	32.00	42.00	22.86	428.51	83	9.1	<0.50	3.4	4.6	1	2.5	7.2
7/9/2003	P		451.37	32.00	42.00	29.41	421.96	110	<0.50	<0.50	<0.50	<0.50	0.98	2.6	7.1
02/19/2004	--		451.37	32.00	42.00	43.25	408.12	--	--	--	--	--	--	--	--
08/04/2004	P		453.83	32.00	42.00	27.71	426.12	540	36	3.8	17	24	5.2	3.5	7.1
01/18/2005	--		453.83	32.00	42.00	24.56	429.27	--	--	--	--	--	--	--	--
07/15/2005	P		453.83	32.00	42.00	27.61	426.22	4,600	210	44	150	670	32	3.5	7.1
01/10/2006	--		453.83	32.00	42.00	23.75	430.08	--	--	--	--	--	--	--	--
7/21/2006	P		453.83	32.00	42.00	27.96	425.87	260	<0.50	<0.50	<0.50	0.86	5.1	2.60	7.2
1/17/2007	--		453.83	32.00	42.00	30.57	423.26	--	--	--	--	--	--	--	--
<b>MW-7</b>															
3/20/1995	--		450.33	30.00	40.00	22.07	428.26	31,000	2,300	400	620	2,900	--	--	--
6/2/1995	--		450.33	30.00	40.00	23.42	426.91	40,000	1,400	280	610	2,400	--	--	--
8/23/1995	--		450.33	30.00	40.00	27.13	423.20	25,000	1,400	200	600	1,600	350	--	--
12/4/1995	--		450.33	30.00	40.00	29.45	420.88	23,000	1,100	74	490	720	--	--	--
2/20/1996	--		450.33	30.00	40.00	20.25	430.08	39,000	1,200	140	640	1,800	<400	--	--
5/15/1996	--		450.33	30.00	40.00	21.38	428.95	--	--	--	--	--	--	--	--
8/13/1996	--		450.33	30.00	40.00	25.52	424.81	--	--	--	--	--	--	--	--
11/13/1996	--		450.33	30.00	40.00	29.38	420.95	--	--	--	--	--	--	--	--
3/26/1997	--		450.33	30.00	40.00	24.36	425.97	35,000	1,100	180	460	1,700	<300	--	--
5/15/1997	--		450.33	30.00	40.00	26.90	423.43	--	--	--	--	--	--	--	--
8/26/1997	--		450.33	30.00	40.00	30.21	420.12	--	--	--	--	--	--	--	--
11/5/1997	--		450.33	30.00	40.00	32.49	417.84	--	--	--	--	--	--	--	--
2/18/1998	--		450.33	30.00	40.00	18.10	432.23	19,000	1,100	120	460	1,700	240	--	--
5/20/1998	--		450.33	30.00	40.00	21.68	428.65	--	--	--	--	--	--	--	--
7/30/1998	--		450.33	30.00	40.00	26.07	424.26	--	--	--	--	--	--	--	--
10/29/1998	--		450.33	30.00	40.00	31.13	419.20	--	--	--	--	--	--	--	--
3/16/1999	P		450.33	30.00	40.00	24.45	425.88	8,600	430	51	200	680	<120	1.5	--

Table 1. Summary of Ground-Water Monitoring Data: Relative Water Elevations and Laboratory Analyses

Station #771, 899 Rincon Ave., Livermore, CA

Well and Sample Date	P/NP	Comments	TOC (feet msl)	Top of Screen (ft bgs)	Bottom of Screen (ft bgs)	DTW (feet bgs)	Water Level Elevation (feet msl)	Concentrations in (µg/L)						DO (mg/L)	pH
								GRO/ TPHg	Benzene	Toluene	Ethyl- Benzene	Total Xylenes	MTBE		
<b>MW-7 Cont.</b>															
5/5/1999	--		450.33	30.00	40.00	25.84	424.49	--	--	--	--	--	--	--	--
8/26/1999	--		450.33	30.00	40.00	28.28	422.05	--	--	--	--	--	--	1.51	--
12/3/1999	--		450.33	30.00	40.00	31.57	418.76	--	--	--	--	--	--	--	--
3/13/2000	--	d	450.33	30.00	40.00	--	--	--	--	--	--	--	--	--	--
6/20/2000	--		450.33	30.00	40.00	25.91	424.42	--	--	--	--	--	--	5.4	--
8/31/2000	--		450.33	30.00	40.00	28.40	421.93	8,410	344	58.9	276	581	202	0.09	--
2/9/2001	--		450.33	30.00	40.00	30.04	420.29	2,030	203	12	17.9	49.4	128	1.55	--
9/17/2001	P		450.33	30.00	40.00	29.03	421.30	4,800	200	14	9.9	27	160	0.29	--
1/21/2002	P		450.33	30.00	40.00	28.98	421.35	4,200	350	20	52	63	99	0.81	--
1/21/2002	--	b	450.33	30.00	40.00	--	--	2,600	280	17	41	50	97	--	--
7/19/2002	P	a	450.33	30.00	40.00	28.70	421.63	5,700	630	31	330	160	64	0.7	7.3
1/15/2003	--	a	450.33	30.00	40.00	21.91	428.42	12,000	470	19	340	310	91	1.5	7.0
7/9/2003	P		450.33	30.00	40.00	27.88	422.45	6,700	590	23	280	92	110	1.0	6.9
02/19/2004	P	c	450.33	30.00	40.00	25.12	425.21	8,900	670	24	470	120	100	0.8	6.6
08/04/2004	P		452.70	30.00	40.00	25.92	426.78	9,100	930	29	460	130	140	0.6	7.2
01/18/2005	P		452.70	30.00	40.00	22.31	430.39	16,000	770	33	590	220	87	1.0	6.9
07/15/2005	P		452.70	30.00	40.00	27.20	425.50	12,000	1,000	38	490	220	150	1.5	6.9
01/10/2006	P		452.70	30.00	40.00	20.61	432.09	13,000	1,200	50	760	330	120	0.8	7.1
7/21/2006	P		452.70	30.00	40.00	28.10	424.60	8,000	110	<50	380	180	54	3.20	7.8
1/17/2007	P		452.70	30.00	40.00	29.70	423.00	5,600	16	<2.5	26	12	3.1	1.08	7.83
<b>MW-8</b>															
3/20/1995	--		449.43	27.50	42.50	24.75	424.68	<50	<0.5	<0.5	<0.5	<0.5	--	--	--
6/2/1995	--		449.43	27.50	42.50	24.95	424.48	--	--	--	--	--	--	--	--
8/23/1995	--		449.43	27.50	42.50	30.94	418.49	<50	<0.5	<0.5	<0.5	<0.5	<3	--	--
12/4/1995	--		449.43	27.50	42.50	31.99	417.44	--	--	--	--	--	--	--	--
2/20/1996	--		449.43	27.50	42.50	21.13	428.30	<50	<0.5	<0.5	<0.5	<0.5	<3	--	--
5/15/1996	--		449.43	27.50	42.50	21.96	427.47	--	--	--	--	--	--	--	--
8/13/1996	--		449.43	27.50	42.50	30.20	419.23	<50	<0.5	<0.5	<0.5	<0.5	<3	--	--
11/13/1996	--		449.43	27.50	42.50	33.24	416.19	--	--	--	--	--	--	--	--
3/26/1997	--		449.43	27.50	42.50	26.85	422.58	<50	<0.5	<0.5	<0.5	<0.5	<3	--	--

Table 1. Summary of Ground-Water Monitoring Data: Relative Water Elevations and Laboratory Analyses

Station #771, 899 Rincon Ave., Livermore, CA

Well and Sample Date	P/NP	Comments	TOC (feet msl)	Top of Screen (ft bgs)	Bottom of Screen (ft bgs)	DTW (feet bgs)	Water Level Elevation (feet msl)	Concentrations in (µg/L)						DO (mg/L)	pH
								GRO/TPHg	Benzene	Toluene	Ethyl-Benzene	Total Xylenes	MTBE		
MW-8 Cont.															
5/15/1997	--		449.43	27.50	42.50	29.69	419.74	--	--	--	--	--	--	--	--
8/26/1997	--		449.43	27.50	42.50	34.00	415.43	<50	<0.5	<0.5	<0.5	<0.5	<3	--	--
11/5/1997	--		449.43	27.50	42.50	35.94	413.49	--	--	--	--	--	--	--	--
2/18/1998	--		449.43	27.50	42.50	18.18	431.25	<50	0.6	0.6	<0.5	1.1	<3	--	--
5/20/1998	--		449.43	27.50	42.50	22.85	426.58	--	--	--	--	--	--	--	--
7/30/1998	NP		449.43	27.50	42.50	30.31	419.12	<50	<0.5	<0.5	<0.5	<0.5	<3	8.21	--
10/29/1998	--		449.43	27.50	42.50	35.88	413.55	--	--	--	--	--	--	--	--
3/16/1999	NP		449.43	27.50	42.50	28.50	420.93	<50	<0.5	<0.5	<0.5	<0.5	<3	1.0	--
5/5/1999	--		449.43	27.50	42.50	29.76	419.67	--	--	--	--	--	--	--	--
8/26/1999	P		449.43	27.50	42.50	33.51	415.92	<50	<0.5	<0.5	<0.5	<0.5	<3	4.93	--
12/3/1999	--		449.43	27.50	42.50	35.83	413.60	--	--	--	--	--	--	--	--
3/13/2000	P		449.43	27.50	42.50	26.12	423.31	<50	<0.5	<0.5	<0.5	<1	<3	2.81	--
6/20/2000	--		449.43	27.50	42.50	30.91	418.52	--	--	--	--	--	--	5.8	--
8/31/2000	--		449.43	27.50	42.50	33.70	415.73	--	--	--	--	--	--	--	--
2/9/2001	--		449.43	27.50	42.50	30.90	418.53	--	--	--	--	--	--	--	--
9/17/2001	--		449.43	27.50	42.50	33.95	415.48	--	--	--	--	--	--	--	--
1/21/2002	--		449.43	27.50	42.50	33.71	415.72	--	--	--	--	--	--	--	--
7/19/2002	--		449.43	27.50	42.50	35.30	414.13	--	--	--	--	--	--	--	--
1/15/2003	--		449.43	27.50	42.50	27.10	422.33	--	--	--	--	--	--	--	--
7/9/2003	--		449.43	27.50	42.50	33.10	416.33	--	--	--	--	--	--	--	--
02/19/2004	--		449.43	27.50	42.50	28.92	420.51	--	--	--	--	--	--	--	--
08/04/2004	--		451.80	27.50	42.50	34.28	417.52	--	--	--	--	--	--	--	--
01/18/2005	--		451.80	27.50	42.50	26.76	425.04	--	--	--	--	--	--	--	--
07/15/2005	--		451.80	27.50	42.50	31.14	420.66	--	--	--	--	--	--	--	--
01/10/2006	--		451.80	27.50	42.50	22.88	428.92	--	--	--	--	--	--	--	--
7/21/2006	--		451.80	27.50	42.50	30.84	420.96	--	--	--	--	--	--	--	--
1/17/2007	--		451.80	27.50	42.50	33.20	418.60	--	--	--	--	--	--	--	--
MW-9															
3/20/1995	--		449.21	29.50	39.50	19.11	430.10	<50	<0.5	<0.5	<0.5	<0.5	--	--	--
6/2/1995	--		449.21	29.50	39.50	21.23	427.98	--	--	--	--	--	--	--	--



Table 1. Summary of Ground-Water Monitoring Data: Relative Water Elevations and Laboratory Analyses

Station #771, 899 Rincon Ave., Livermore, CA

Well and Sample Date	P/NP	Comments	TOC (feet msl)	Top of Screen (ft bgs)	Bottom of Screen (ft bgs)	DTW (feet bgs)	Water Level Elevation (feet msl)	Concentrations in (µg/L)						DO (mg/L)	pH
								GRO/TPHg	Benzene	Toluene	Ethyl-Benzene	Total Xylenes	MTBE		
MW-9 Cont.															
8/23/1995	--		449.21	29.50	39.50	24.33	424.88	<50	<0.5	<0.5	<0.5	<0.5	<3	--	--
12/4/1995	--		449.21	29.50	39.50	27.90	421.31	--	--	--	--	--	--	--	--
2/20/1996	--		449.21	29.50	39.50	17.86	431.35	<50	<0.5	<0.5	<0.5	<0.5	<3	--	--
5/15/1996	--		449.21	29.50	39.50	18.69	430.52	--	--	--	--	--	--	--	--
8/13/1996	--		449.21	29.50	39.50	24.17	425.04	--	--	--	--	--	--	--	--
11/13/1996	--		449.21	29.50	39.50	28.01	421.20	--	--	--	--	--	--	--	--
3/26/1997	--		449.21	29.50	39.50	22.58	426.63	<50	<0.5	<0.5	<0.5	<0.5	<3	--	--
5/15/1997	--		449.21	29.50	39.50	25.12	424.09	--	--	--	--	--	--	--	--
8/26/1997	--		449.21	29.50	39.50	28.28	420.93	--	--	--	--	--	--	--	--
11/5/1997	--		449.21	29.50	39.50	31.18	418.03	--	--	--	--	--	--	--	--
2/18/1998	--		449.21	29.50	39.50	16.03	433.18	<50	0.6	0.5	<0.5	1	<3	--	--
5/20/1998	--		449.21	29.50	39.50	19.31	429.90	--	--	--	--	--	--	--	--
7/30/1998	--		449.21	29.50	39.50	24.90	424.31	--	--	--	--	--	--	--	--
10/29/1998	--		449.21	29.50	39.50	30.08	419.13	--	--	--	--	--	--	--	--
3/16/1999	P		449.21	29.50	39.50	22.68	426.53	<50	<0.5	<0.5	<0.5	<0.5	<3	1.0	--
5/5/1999	--		449.21	29.50	39.50	23.82	425.39	--	--	--	--	--	--	--	--
8/26/1999	--		449.21	29.50	39.50	26.57	422.64	--	--	--	--	--	--	5.08	--
12/3/1999	--	d	449.21	29.50	39.50	--	--	--	--	--	--	--	--	--	--
3/13/2000	P		449.21	29.50	39.50	25.62	423.59	<50	<0.5	<0.5	<0.5	<1	<3	5.43	--
6/20/2000	--		449.21	29.50	39.50	23.55	425.66	--	--	--	--	--	--	6.2	--
8/31/2000	--		449.21	29.50	39.50	27.39	421.82	--	--	--	--	--	--	--	--
2/9/2001	--		449.21	29.50	39.50	28.65	420.56	--	--	--	--	--	--	--	--
9/17/2001	--		449.21	29.50	39.50	27.51	421.70	--	--	--	--	--	--	--	--
1/21/2002	--		449.21	29.50	39.50	27.09	422.12	--	--	--	--	--	--	--	--
7/19/2002	--		449.21	29.50	39.50	27.06	422.15	--	--	--	--	--	--	--	--
1/15/2003	--		449.21	29.50	39.50	21.78	427.43	--	--	--	--	--	--	--	--
7/9/2003	--		449.21	29.50	39.50	26.18	423.03	--	--	--	--	--	--	--	--
02/19/2004	--		449.21	29.50	39.50	23.45	425.76	--	--	--	--	--	--	--	--
08/04/2004	--		451.63	29.50	39.50	29.24	422.39	--	--	--	--	--	--	--	--
01/18/2005	--		451.63	29.50	39.50	20.64	430.99	--	--	--	--	--	--	--	--
07/15/2005	--		451.63	29.50	39.50	25.72	425.91	--	--	--	--	--	--	--	--

Table 1. Summary of Ground-Water Monitoring Data: Relative Water Elevations and Laboratory Analyses

Station #771, 899 Rincon Ave., Livermore, CA

Well and Sample Date	P/NP	Comments	TOC (feet msl)	Top of Screen (ft bgs)	Bottom of Screen (ft bgs)	DTW (feet bgs)	Water Level Elevation (feet msl)	Concentrations in (µg/L)						DO (mg/L)	pH
								GRO/TPHg	Benzene	Toluene	Ethyl-Benzene	Total Xylenes	MTBE		
<b>MW-9 Cont.</b>															
01/10/2006	--		451.63	29.50	39.50	18.86	432.77	--	--	--	--	--	--	--	--
7/21/2006	--		451.63	29.50	39.50	25.58	426.05	--	--	--	--	--	--	--	--
<b>1/17/2007</b>	<b>--</b>		<b>451.63</b>	<b>29.50</b>	<b>39.50</b>	<b>29.11</b>	<b>422.52</b>	<b>--</b>	<b>--</b>	<b>--</b>	<b>--</b>	<b>--</b>	<b>--</b>	<b>--</b>	<b>--</b>
<b>MW-10</b>															
3/20/1995	--		449.22	29.00	37.00	20.96	428.26	--	--	--	--	--	--	--	--
6/2/1995	--		449.22	29.00	37.00	22.15	427.07	--	--	--	--	--	--	--	--
8/23/1995	--		449.22	29.00	37.00	24.47	424.75	<50	<0.5	<0.5	<0.5	<0.5	<3	--	--
12/4/1995	--		449.22	29.00	37.00	26.97	422.25	--	--	--	--	--	--	--	--
2/20/1996	--		449.22	29.00	37.00	18.40	430.82	<50	<0.5	<0.5	<0.5	<0.5	<3	--	--
5/15/1996	--	d	449.22	29.00	37.00	--	--	--	--	--	--	--	--	--	--
8/13/1996	--		449.22	29.00	37.00	23.70	425.52	--	--	--	--	--	--	--	--
11/13/1996	--		449.22	29.00	37.00	27.15	422.07	--	--	--	--	--	--	--	--
3/26/1997	--		449.22	29.00	37.00	22.23	426.99	<50	<0.5	<0.5	<0.5	<0.5	<3	--	--
5/15/1997	--		449.22	29.00	37.00	24.57	424.65	--	--	--	--	--	--	--	--
8/26/1997	--		449.22	29.00	37.00	27.62	421.60	--	--	--	--	--	--	--	--
11/5/1997	--		449.22	29.00	37.00	30.79	418.43	--	--	--	--	--	--	--	--
2/18/1998	--	d	449.22	29.00	37.00	--	--	--	--	--	--	--	--	--	--
5/20/1998	--		449.22	29.00	37.00	--	--	--	--	--	--	--	--	--	--
7/30/1998	--		449.22	29.00	37.00	23.90	425.32	--	--	--	--	--	--	--	--
10/29/1998	--		449.22	29.00	37.00	30.55	418.67	--	--	--	--	--	--	--	--
3/16/1999	P		449.22	29.00	37.00	23.05	426.17	<50	<0.5	<0.5	<0.5	<0.5	<3	1.0	--
5/5/1999	--		449.22	29.00	37.00	24.00	425.22	--	--	--	--	--	--	--	--
8/26/1999	--		449.22	29.00	37.00	26.50	422.72	--	--	--	--	--	--	5.15	--
12/3/1999	--		449.22	29.00	37.00	30.80	418.42	--	--	--	--	--	--	--	--
3/13/2000	--	d	449.22	29.00	37.00	26.21	423.01	--	--	--	--	--	--	--	--
6/20/2000	--		449.22	29.00	37.00	23.52	425.70	--	--	--	--	--	--	5.5	--
8/31/2000	--		449.22	29.00	37.00	27.52	421.70	--	--	--	--	--	--	--	--
2/9/2001	--		449.22	29.00	37.00	28.71	420.51	--	--	--	--	--	--	--	--
9/17/2001	--		449.22	29.00	37.00	27.94	421.28	--	--	--	--	--	--	--	--
1/21/2002	--		449.22	29.00	37.00	27.44	421.78	--	--	--	--	--	--	--	--

Table 1. Summary of Ground-Water Monitoring Data: Relative Water Elevations and Laboratory Analyses

Station #771, 899 Rincon Ave., Livermore, CA

Well and Sample Date	P/NP	Comments	TOC (feet msl)	Top of Screen (ft bgs)	Bottom of Screen (ft bgs)	DTW (feet bgs)	Water Level Elevation (feet msl)	Concentrations in (µg/L)						DO (mg/L)	pH
								GRO/TPHg	Benzene	Toluene	Ethyl-Benzene	Total Xylenes	MTBE		
<b>MW-10 Cont.</b>															
7/19/2002	--		449.22	29.00	37.00	27.80	421.42	--	--	--	--	--	--	--	--
1/15/2003	--		449.22	29.00	37.00	23.09	426.13	--	--	--	--	--	--	--	--
7/9/2003	--		449.22	29.00	37.00	26.87	422.35	--	--	--	--	--	--	--	--
02/19/2004	--		449.22	29.00	37.00	23.39	425.83	--	--	--	--	--	--	--	--
01/18/2005	--		451.65	29.00	37.00	21.40	430.25	--	--	--	--	--	--	--	--
07/15/2005	--		451.65	29.00	37.00	25.37	426.28	--	--	--	--	--	--	--	--
01/10/2006	--		451.65	29.00	37.00	19.81	431.84	--	--	--	--	--	--	--	--
7/21/2006	--		451.65	29.00	37.00	25.16	426.49	--	--	--	--	--	--	--	--
1/17/2007	--		451.65	29.00	37.00	28.95	422.70	--	--	--	--	--	--	--	--
<b>MW-11</b>															
3/20/1995	--		448.02	29.00	39.00	25.02	423.00	<50	<0.5	<0.5	<0.5	<0.5	--	--	--
6/2/1995	--		448.02	29.00	39.00	23.82	424.20	--	--	--	--	--	--	--	--
8/23/1995	--		448.02	29.00	39.00	30.15	417.87	<50	<0.5	<0.5	<0.5	<0.5	<3	--	--
12/4/1995	--		448.02	29.00	39.00	31.63	416.39	--	--	--	--	--	--	--	--
2/20/1996	--		448.02	29.00	39.00	20.94	427.08	<50	<0.5	<0.5	<0.5	<0.5	<3	--	--
5/15/1996	--		448.02	29.00	39.00	23.03	424.99	--	--	--	--	--	--	--	--
8/13/1996	--		448.02	29.00	39.00	29.19	418.83	<50	<0.5	<0.5	<0.5	<0.5	<3	--	--
11/13/1996	--		448.02	29.00	39.00	31.96	416.06	--	--	--	--	--	--	--	--
3/26/1997	--		448.02	29.00	39.00	26.61	421.41	<50	<0.5	<0.5	<0.5	<0.5	<3	--	--
5/15/1997	--		448.02	29.00	39.00	29.39	418.63	--	--	--	--	--	--	--	--
8/26/1997	--		448.02	29.00	39.00	33.47	414.55	<50	<0.5	<0.5	<0.5	<0.5	<3	--	--
11/5/1997	--		448.02	29.00	39.00	35.12	412.90	--	--	--	--	--	--	--	--
2/18/1998	--		448.02	29.00	39.00	18.03	429.99	<50	<0.5	<0.5	<0.5	1	<3	--	--
5/20/1998	--		448.02	29.00	39.00	23.00	425.02	--	--	--	--	--	--	--	--
7/30/1998	P		448.02	29.00	39.00	29.30	418.72	<50	<0.5	<0.5	<0.5	<0.5	<3	5.59	--
10/29/1998	--		448.02	29.00	39.00	34.47	413.55	--	--	--	--	--	--	--	--
3/16/1999	P		448.02	29.00	39.00	27.88	420.14	<50	<0.5	<0.5	<0.5	<0.5	<3	1.0	--
5/5/1999	--		448.02	29.00	39.00	26.85	421.17	--	--	--	--	--	--	--	--
8/26/1999	P		448.02	29.00	39.00	32.74	415.28	<50	<0.5	<0.5	<0.5	<0.5	<3	4.59	--
12/3/1999	--		448.02	29.00	39.00	34.70	413.32	--	--	--	--	--	--	--	--

Table 1. Summary of Ground-Water Monitoring Data: Relative Water Elevations and Laboratory Analyses

Station #771, 899 Rincon Ave., Livermore, CA

Well and Sample Date	P/NP	Comments	TOC (feet msl)	Top of Screen (ft bgs)	Bottom of Screen (ft bgs)	DTW (feet bgs)	Water Level Elevation (feet msl)	Concentrations in (µg/L)						DO (mg/L)	pH
								GRO/TPHg	Benzene	Toluene	Ethyl-Benzene	Total Xylenes	MTBE		
<b>MW-11 Cont.</b>															
3/13/2000	P		448.02	29.00	39.00	25.94	422.08	<50	<0.5	<0.5	<0.5	<1	<3	3.21	--
6/20/2000	--		448.02	29.00	39.00	30.40	417.62	--	--	--	--	--	--	3.3	--
8/31/2000	--	b	448.02	29.00	39.00	--	--	<50.0	<0.500	<0.500	<0.500	<0.500	<2.50	--	--
8/31/2000	NP		448.02	29.00	39.00	32.68	415.34	<50.0	<0.500	<0.500	<0.500	<0.500	<2.50	0.4	--
2/9/2001	--		448.02	29.00	39.00	31.17	416.85	--	--	--	--	--	--	--	--
9/17/2001	NP		448.02	29.00	39.00	32.98	415.04	<50	<0.50	<0.50	<0.50	<0.50	<2.5	0.62	--
1/21/2002	--		448.02	29.00	39.00	31.05	416.97	--	--	--	--	--	--	--	--
7/19/2002	P		448.02	29.00	39.00	31.67	416.35	<50	<0.50	<0.50	<0.50	<0.50	<0.50	3.7	7.7
1/15/2003	--		448.02	29.00	39.00	23.75	424.27	--	--	--	--	--	--	--	--
7/9/2003	P		448.02	29.00	39.00	31.06	416.96	<50	<0.50	<0.50	<0.50	<0.50	<0.50	2.4	6.6
02/19/2004	--		448.02	29.00	39.00	27.21	420.81	--	--	--	--	--	--	--	--
08/04/2004	P		450.41	29.00	39.00	31.71	418.70	<50	<0.50	<0.50	<0.50	<0.50	<0.50	3.3	7.1
01/18/2005	--		450.41	29.00	39.00	24.80	425.61	--	--	--	--	--	--	--	--
07/15/2005	P		450.41	29.00	39.00	29.15	421.26	<50	<0.50	<0.50	<0.50	<0.50	<0.50	2.7	7.1
01/10/2006	--		450.41	29.00	39.00	20.87	429.54	--	--	--	--	--	--	--	--
7/21/2006	P		450.41	29.00	39.00	29.30	421.11	<50	<0.50	<0.50	<0.50	<0.50	<0.50	2.7	7.2
1/17/2007	--		450.41	29.00	39.00	31.59	418.82	--	--	--	--	--	--	--	--
<b>RW-1</b>															
3/20/1995	--		451.67	25.50	40.50	23.76	427.91	15,000	1,000	140	310	950	--	--	--
6/2/1995	--		451.67	25.50	40.50	25.12	426.55	12,000	1,300	280	420	1,100	--	--	--
8/23/1995	--		451.67	25.50	40.50	28.80	422.87	8,200	520	190	240	610	<50	--	--
12/4/1995	--		451.67	25.50	40.50	31.15	420.52	2,600	140	59	83	210	--	--	--
2/20/1996	--		451.67	25.50	40.50	21.45	430.22	6,300	410	160	180	650	<40	--	--
5/15/1996	--		451.67	25.50	40.50	22.97	428.70	--	--	--	--	--	--	--	--
8/13/1996	--		451.67	25.50	40.50	24.74	426.93	--	--	--	--	--	--	--	--
11/13/1996	--		451.67	25.50	40.50	30.69	420.98	--	--	--	--	--	--	--	--
3/26/1997	--		451.67	25.50	40.50	25.69	425.98	500	57	3	6.4	18	54	--	--
5/15/1997	--		451.67	25.50	40.50	28.19	423.48	--	--	--	--	--	--	--	--
8/26/1997	--		451.67	25.50	40.50	31.21	420.46	--	--	--	--	--	--	--	--
11/5/1997	--		451.67	25.50	40.50	33.67	418.00	--	--	--	--	--	--	--	--

Table 1. Summary of Ground-Water Monitoring Data: Relative Water Elevations and Laboratory Analyses

Station #771, 899 Rincon Ave., Livermore, CA

Well and Sample Date	P/NP	Comments	TOC (feet msl)	Top of Screen (ft bgs)	Bottom of Screen (ft bgs)	DTW (feet bgs)	Water Level Elevation (feet msl)	Concentrations in (µg/L)						DO (mg/L)	pH
								GRO/TPHg	Benzene	Toluene	Ethyl-Benzene	Total Xylenes	MTBE		
<b>RW-1 Cont.</b>															
2/18/1998	--		451.67	25.50	40.50	20.14	431.53	9,400	200	70	190	710	<60	--	--
5/20/1998	--		451.67	25.50	40.50	23.43	428.24	--	--	--	--	--	--	--	--
7/30/1998	--		451.67	25.50	40.50	27.42	424.25	--	--	--	--	--	--	--	--
10/29/1998	--		451.67	25.50	40.50	32.47	419.20	--	--	--	--	--	--	--	--
3/16/1999	NP		451.67	25.50	40.50	25.45	426.22	1,100	140	19	45	83	530	1.0	--
5/5/1999	--		451.67	25.50	40.50	27.23	424.44	--	--	--	--	--	--	--	--
8/26/1999	--		451.67	25.50	40.50	29.98	421.69	--	--	--	--	--	--	1.39	--
12/3/1999	--		451.67	25.50	40.50	32.38	419.29	--	--	--	--	--	--	--	--
3/13/2000	NP		451.67	25.50	40.50	25.53	426.14	1,100	130	3.5	0.7	95	230	4.43	--
6/20/2000	--		451.67	25.50	40.50	28.31	423.36	--	--	--	--	--	--	1.9	--
8/31/2000	NP		451.67	25.50	40.50	30.61	421.06	<50.0	<0.500	<0.500	<0.500	<0.500	82.5	3.21	--
2/9/2001	NP		451.67	25.50	40.50	31.14	420.53	<50.0	<0.500	<0.500	<0.500	<0.500	<2.50	0.84	--
9/17/2001	NP		451.67	25.50	40.50	31.70	419.97	<50	<0.50	<0.50	<0.50	<0.50	<2.5	1.51	--
1/21/2002	NP		451.67	25.50	40.50	30.15	421.52	<50	7.7	<0.50	<0.50	1.5	18	0.63	--
7/19/2002	NP		451.67	25.50	40.50	31.15	420.52	<50	<0.50	<0.50	<0.50	<0.50	13	1.4	6.6
1/15/2003	--	a	451.67	25.50	40.50	22.20	429.47	860	9	1.6	17	42	1.5	2.8	7.2
7/9/2003	--		451.67	25.50	40.50	29.56	422.11	<50	<0.50	<0.50	<0.50	<0.50	<0.50	1.8	7.1
02/19/2004	NP	c	451.67	25.50	40.50	23.53	428.14	<50	<0.50	<0.50	<0.50	<0.50	<0.50	2.4	6.7
08/04/2004	P		454.11	25.50	40.50	22.45	431.66	600	<0.50	<0.50	3.3	3.4	<0.50	4.4	7.2
01/18/2005	P		454.11	25.50	40.50	23.57	430.54	1,400	8.0	1.9	22	68	<0.50	3.6	6.9
07/15/2005	NP		454.11	25.50	40.50	29.02	425.09	<50	<0.50	<0.50	<0.50	<0.50	2.0	1.1	7.8
01/10/2006	P		454.11	25.50	40.50	21.88	432.23	480	4.3	0.67	8.3	18	0.54	4.4	7.1
7/21/2006	--	d	454.11	25.50	40.50	--	--	--	--	--	--	--	--	--	--
1/17/2007	P		454.11	25.50	40.50	31.48	422.63	6,900	17	2.8	22	31	2.6	4.08	7.74
<b>VW-1</b>															
8/31/2000	P		--	18.50	28.50	20.61	--	<50.0	<0.500	<0.500	<0.500	<0.500	<2.50	10.08	--
2/9/2001	P		--	18.50	28.50	22.10	--	<50.0	<0.500	<0.500	<0.500	<0.500	<2.50	0.53	--
9/17/2001	P		--	18.50	28.50	21.99	--	<50	<0.50	<0.50	<0.50	<0.50	<2.5	6.59	--
1/21/2002	P		--	18.50	28.50	21.50	--	<50	<0.50	<0.50	<0.50	<0.50	<5.0	0.7	--
7/19/2002	P		--	18.50	28.50	22.42	--	<50	<0.50	<0.50	<0.50	<0.50	<0.50	4.9	7.1

Table 1. Summary of Ground-Water Monitoring Data: Relative Water Elevations and Laboratory Analyses

Station #771, 899 Rincon Ave., Livermore, CA

Well and Sample Date	P/NP	Comments	TOC (feet msl)	Top of Screen (ft bgs)	Bottom of Screen (ft bgs)	DTW (feet bgs)	Water Level Elevation (feet msl)	Concentrations in (µg/L)						DO (mg/L)	pH
								GRO/ TPHg	Benzene	Toluene	Ethyl- Benzene	Total Xylenes	MTBE		
VW-1 Cont.															
1/15/2003	--		--	18.50	28.50	22.59	--	<50	<0.50	<0.50	0.63	1.7	<0.50	5.4	7.2
7/9/2003	--		--	18.50	28.50	22.50	--	<50	<0.50	<0.50	<0.50	0.61	<0.50	2.0	7.0
02/19/2004	--		--	18.50	28.50	21.04	--	--	--	--	--	--	--	--	--
08/04/2004	P		453.29	18.50	28.50	20.48	432.81	<50	<0.50	<0.50	<0.50	<0.50	<0.50	5.7	7.0
01/18/2005	--		453.29	18.50	28.50	21.72	431.57	--	--	--	--	--	--	--	--
07/15/2005	P		453.29	18.50	28.50	22.50	430.79	<50	<0.50	<0.50	<0.50	<0.50	<0.50	5.1	7.4
01/10/2006	--		453.29	18.50	28.50	20.17	433.12	--	--	--	--	--	--	--	--
7/21/2006	P	e	453.29	18.50	28.50	22.50	430.79	220	<0.50	<0.50	<0.50	<0.50	<0.50	5.91	7.3
1/17/2007	--		453.29	18.50	28.50	21.67	431.62	--	--	--	--	--	--	--	--

SYMBOLS AND ABBREVIATIONS:

--/- = Not analyzed/applicable/sampled/measured  
< = Not detected at or above specified laboratory reporting limit  
DO = Dissolved oxygen  
DTW = Depth to water in ft bgs  
ft bgs = Feet below ground surface  
ft MSL = Feet above mean sea level  
GRO = Gasoline range organics, range C4-C12  
GWE = Groundwater elevation in ft MSL  
g/L = Micrograms per liter  
mg/L = Milligrams per liter  
MTBE = Methyl tert-butyl ether  
NP = Not purged before sampling  
P = Purged before sampling  
TPH-g = Total petroleum hydrocarbons as gasoline  
TOC = Top of casing elevation in ft MSL

FOOTNOTES:

a = Chromatogram Pattern: Gasoline C6-C10  
b = Duplicate sample  
c = GRO analyzed by EPA Method 8015B modified  
d = Well inaccessible  
e = Hydrocarbon result partly due to individ. peak(s) in quant. range.

NOTES:

For previous historical GWE and analytical data please refer to Fourth Quarter 1995 Groundwater Monitoring Program Results and Remediation System Performance Evaluation Report, ARCO Service Station 771, Livermore, California, (EMCON, March 1, 1996).

Please note that beginning in the fourth quarter 2003, the laboratory modified the reported analyte list. TPH-g was changed to GRO. The resulting data may be impacted by the potential inclusion of non-TPH-g analytes within the requested fuel range resulting in a higher concentration being reported.

All analytes unless otherwise notes utilized EPA Method 8260B, EPA method 8015B modified prior to 1/15/03, and EPA method 8020 prior to 12/03/99.

Site wells were resurveyed to NAVD '88 datum on March 8, 2004.

Top of screen and bottom of screen depths for MW-3 and MW-6 are estimated from cross-sections.

Note: The data within this table collected prior to April 2006 was provided to Broadbent & Associates, Inc. by Atlantic Richfield Company and their previous consultants. Broadbent & Associates, Inc. has not verified the accuracy of this information.

**Table 2. Summary of Fuel Additives Analytical Data**  
**Station #771, 899 Rincon Ave., Livermore, CA**

Well and Sample Date	Concentrations in (µg/L)								Comments
	Ethanol	TBA	MTBE	DIPE	ETBE	TAME	1,2-DCA	EDB	
<b>MW-1</b>									
02/19/2004	--	--	--	--	--	--	--	--	
08/04/2004	--	--	--	--	--	--	--	--	
01/18/2005	--	--	--	--	--	--	--	--	
07/15/2005	--	--	--	--	--	--	--	--	
01/10/2006	--	--	--	--	--	--	--	--	
<b>MW-2</b>									
7/9/2003	<1,000	<200	39	<5.0	<5.0	<5.0	<5.0	<5.0	
02/19/2004	--	--	--	--	--	--	--	--	
08/04/2004	<2,000	<400	78	<10	<10	<10	<10	<10	
01/18/2005	--	--	--	--	--	--	--	--	
07/15/2005	<500	120	46	<2.5	<2.5	<2.5	<2.5	<2.5	
01/10/2006	--	--	--	--	--	--	--	--	
7/21/2006	<300	<20	<0.50	<0.50	<0.50	<0.50	<0.50	<0.50	
<b>MW-3</b>									
02/19/2004	--	--	--	--	--	--	--	--	
08/04/2004	--	--	--	--	--	--	--	--	
01/18/2005	--	--	--	--	--	--	--	--	
07/15/2005	--	--	--	--	--	--	--	--	
01/10/2006	--	--	--	--	--	--	--	--	
<b>MW-4</b>									
7/9/2003	<1,000	750	150	<5.0	<5.0	<5.0	<5.0	<5.0	
02/19/2004	<1,000	630	180	<10	<10	<10	<5.0	<5.0	
08/04/2004	<2,000	1,300	300	<10	<10	<10	<10	<10	
01/18/2005	<1,000	630	160	<5.0	<5.0	<5.0	<5.0	<5.0	a
07/15/2005	<1,000	850	230	<5.0	<5.0	<5.0	<5.0	<5.0	
01/10/2006	<1,500	810	190	<2.5	<2.5	<2.5	<2.5	<2.5	
7/21/2006	<300	35	3:1	<0.50	<0.50	<0.50	<0.50	<0.50	
1/17/2007	<300	<20	11	<0.50	<0.50	<0.50	<0.50	<0.50	
<b>MW-5</b>									



**Table 2. Summary of Fuel Additives Analytical Data**  
**Station #771, 899 Rincon Ave., Livermore, CA**

Well and Sample Date	Concentrations in (µg/L)								Comments
	Ethanol	TBA	MTBE	DIPE	ETBE	TAME	1,2-DCA	EDB	
<b>MW-5 Cont.</b>									
7/9/2003	<1,000	1,100	260	<5.0	<5.0	<5.0	<5.0	<5.0	
02/19/2004	--	--	--	--	--	--	--	--	
08/04/2004	<1,000	850	250	<5.0	<5.0	<5.0	<5.0	<5.0	
01/18/2005	--	--	--	--	--	--	--	--	
07/15/2005	<1,000	720	270	<5.0	<5.0	<5.0	<5.0	<5.0	
01/10/2006	--	--	--	--	--	--	--	--	
7/21/2006	<3,000	<200	14	<5.0	<5.0	<5.0	<5.0	<5.0	
<b>MW-6</b>									
7/9/2003	<100	<20	0.98	<0.50	<0.50	<0.50	<0.50	<0.50	
02/19/2004	--	--	--	--	--	--	--	--	
08/04/2004	<100	<20	5.2	<0.50	<0.50	<0.50	<0.50	<0.50	
01/18/2005	--	--	--	--	--	--	--	--	
07/15/2005	<500	110	32	<2.5	<2.5	<2.5	<2.5	<2.5	
01/10/2006	--	--	--	--	--	--	--	--	
7/21/2006	<300	<20	5.1	<0.50	<0.50	<0.50	<0.50	<0.50	
<b>MW-7</b>									
7/9/2003	<1,000	350	110	<5.0	<5.0	<5.0	<5.0	<5.0	
02/19/2004	<1,000	420	100	<10	<10	<10	<5.0	<5.0	
08/04/2004	<5,000	<1,000	140	<25	<25	<25	<25	<25	
01/18/2005	<1,000	260	87	<5.0	<5.0	<5.0	<5.0	<5.0	a
07/15/2005	<5,000	<1,000	150	<25	<25	<25	<25	<25	
01/10/2006	<30,000	<2,000	120	<50	<50	<50	<50	<50	
7/21/2006	<30,000	<2,000	54	<50	<50	<50	<50	<50	
1/17/2007	<1,500	<100	3.1	<2.5	<2.5	<2.5	<2.5	<2.5	
<b>MW-8</b>									
02/19/2004	--	--	--	--	--	--	--	--	
08/04/2004	--	--	--	--	--	--	--	--	
01/18/2005	--	--	--	--	--	--	--	--	
07/15/2005	--	--	--	--	--	--	--	--	
01/10/2006	--	--	--	--	--	--	--	--	

**Table 2. Summary of Fuel Additives Analytical Data**  
**Station #771, 899 Rincon Ave., Livermore, CA**

Well and Sample Date	Concentrations in (µg/L)								Comments
	Ethanol	TBA	MTBE	DIPE	ETBE	TAME	1,2-DCA	EDB	
<b>MW-9</b>									
02/19/2004	--	--	--	--	--	--	--	--	
08/04/2004	--	--	--	--	--	--	--	--	
01/18/2005	--	--	--	--	--	--	--	--	
07/15/2005	--	--	--	--	--	--	--	--	
01/10/2006	--	--	--	--	--	--	--	--	
<b>MW-10</b>									
02/19/2004	--	--	--	--	--	--	--	--	
01/18/2005	--	--	--	--	--	--	--	--	
07/15/2005	--	--	--	--	--	--	--	--	
01/10/2006	--	--	--	--	--	--	--	--	
<b>MW-11</b>									
7/9/2003	<100	<20	<0.50	<0.50	<0.50	<0.50	<0.50	<0.50	
02/19/2004	--	--	--	--	--	--	--	--	
08/04/2004	<100	<20	<0.50	<0.50	<0.50	<0.50	<0.50	<0.50	
01/18/2005	--	--	--	--	--	--	--	--	
07/15/2005	<100	<20	<0.50	<0.50	<0.50	<0.50	<0.50	<0.50	
01/10/2006	--	--	--	--	--	--	--	--	
7/21/2006	<300	<20	<0.50	<0.50	<0.50	<0.50	<0.50	<0.50	
<b>RW-1</b>									
7/9/2003	<100	<20	<0.50	<0.50	<0.50	<0.50	<0.50	<0.50	
02/19/2004	<100	<20	<0.50	<1.0	<1.0	<1.0	<0.50	<0.50	
08/04/2004	<100	<20	<0.50	<0.50	<0.50	<0.50	<0.50	<0.50	
01/18/2005	<100	<20	<0.50	<0.50	<0.50	<0.50	<0.50	<0.50	a
07/15/2005	<100	<20	2.0	<0.50	<0.50	<0.50	<0.50	<0.50	
01/10/2006	<300	<20	0.54	<0.50	<0.50	<0.50	<0.50	<0.50	
1/17/2007	<1,500	<100	2.6	<2.5	<2.5	<2.5	<2.5	<2.5	
<b>VW-1</b>									
7/9/2003	<100	<20	<0.50	<0.50	<0.50	<0.50	<0.50	<0.50	
02/19/2004	--	--	--	--	--	--	--	--	

**Table 2. Summary of Fuel Additives Analytical Data**  
**Station #771, 899 Rincon Ave., Livermore, CA**

Well and Sample Date	Concentrations in (µg/L)								Comments
	Ethanol	TBA	MTBE	DIPE	ETBE	TAME	1,2-DCA	EDB	
VW-1 Cont.									
08/04/2004	<100	<20	<0.50	<0.50	<0.50	<0.50	<0.50	<0.50	
01/18/2005	--	--	--	--	--	--	--	--	
07/15/2005	<100	<20	<0.50	<0.50	<0.50	<0.50	<0.50	<0.50	
01/10/2006	--	--	--	--	--	--	--	--	
7/21/2006	<300	<20	<0.50	<0.50	<0.50	<0.50	<0.50	<0.50	

SYMBOLS AND ABBREVIATIONS:

< = Not detected at or above specified laboratory reporting limit

1,2-DCA = 1,2-Dichloroethane

DIPE = Di-isopropyl ether

EDB = 1,2-Dibromoethane

ETBE = Ethyl tert-butyl ether

MTBE = Methyl tert-butyl ether

µg/L = Micrograms per liter

TAME = tert-Amyl methyl ether

TBA = tert-Butyl alcohol

FOOTNOTES:

a = Calibration verification was within the method limits but outside the contract limits for ethanol.

Note: The data within this table collected prior to April 2006 was provided to Broadbent & Associates, Inc. by Atlantic Richfield Company and their previous consultants. Broadbent & Associates, Inc. has not verified the accuracy of this information.

**Table 3. Historical Ground-Water Flow Direction and Gradient**  
**Station #771, 899 Rincon Ave., Livermore, CA**

<b>Date Sampled</b>	<b>Approximate Flow Direction</b>	<b>Approximate Hydraulic Gradient</b>
3/20/1995	Northwest	0.030
6/2/1995	North-Northwest	0.014
8/23/1995	North-Northwest	0.030
12/4/1995	North-Northwest	0.030
2/20/1996	Northwest	0.016
5/15/1996	Northwest	0.024
8/13/1996	North-Northwest	0.030
11/13/1996	North-Northwest	0.031
3/26/1997	North-Northwest	0.044
5/15/1997	North-Northwest	0.031
8/26/1997	North-Northwest	0.042
11/5/1997	North-Northwest	0.030
2/18/1998	Northwest	0.010
5/20/1998	Northwest	0.030
7/30/1998	North	0.040
10/29/1998	North	0.005
3/16/1999	North-Northwest	0.030
5/5/1999	North	0.040
8/26/1999	North-Northwest	0.050
12/3/1999	North-Northeast	0.060
3/13/2000	North-Northwest	0.066
6/20/2000	North-Northwest	0.050
8/31/2000	North-Northwest	0.062
2/9/2001	North-Northeast	0.014
9/17/2001	North-Northwest	0.061
1/21/2002	North-Northwest	0.050
7/19/2002	North-Northwest	0.044
1/15/2003	Northeast to Southeast	0.038 - 0.016
7/9/2003	Northwest to North-Northwest	0.009 - 0.063
2/19/2004	North	0.044
8/4/2004	Northeast	0.071
1/18/2005	North-Northeast	0.04
7/15/2005	Northeast and Southwest	0.05 and 0.02
1/10/2006	North	0.02
7/21/2006	North and Southwest	0.05 and 0.02
1/17/2007	North-Northeast and Southwest	0.03 and 0.02

Note: The data within this table collected prior to April 2006 was provided to Broadbent & Associates, Inc. by Atlantic Richfield Company and their previous consultants. Broadbent & Associates, Inc. has not verified the accuracy of this information.

**APPENDIX A**

STRATUS ENVIRONMENTAL, INC. GROUND-WATER SAMPLING DATA PACKAGE  
(INCLUDES BILL OF LADING, FIELD DATA SHEETS, AND LABORATORY  
REPORT AND CHAIN OF CUSTODY DOCUMENTATION)



3330 Cameron Park Drive, Ste 550  
Cameron Park, California 95682  
(530) 676-6004 ~ Fax: (530) 676-6005

February 2, 2007

Mr. Rob Miller  
Broadbent & Associates  
2000 Kirman Ave.  
Reno, NV 89502

Re: Groundwater Sampling Data Package, BP Service Station No. 771, located at 899 Rincon Avenue, Livermore, California (Quarterly Monitoring performed on January 17, 2007)

### **General Information**

*Data Submittal Prepared / Reviewed by:* Sandy Hayes / Jay Johnson

*Phone Number:* (530) 676-6000

*On-Site Supplier Representative:* Vince Zalutka / Greg Wilkins

*Date:* January 17, 2007

*Arrival:* 06:45                      *Departure:* 10:30

*Weather Conditions:* Clear

*Unusual Field Conditions:* Clear

*Scope of Work Performed:* Quarterly monitoring and sampling

*Variations from Work Scope:* Wells MW-7 and RW-1 purged dry before three casing volumes could be removed.

This submittal presents the tabulation of data collected in association with routine groundwater monitoring. The attachments include bill of lading, field data sheets, chain of custody documentation, and certified analytical results. The information is being provided to BP-ARCO's Scoping Supplier for use in preparing a report for regulatory submittal. This submittal is limited to presentation of collected data and does not include data interpretation or conclusions or recommendations. Any questions concerning this submittal should be addressed to the Preparer/Reviewer identified above.

Sincerely,

**STRATUS ENVIRONMENTAL, INC.**

Jay R. Johnson

NO 5867

Jay R. Johnson, P.G.  
Project Manager



**Attachments:**

- Bill of Lading
- Field Data Sheets
- Chain of Custody Documentation
- Certified Analytical Results

CC: Mr. Paul Supple, BP/ARCO



BP GEM OIL COMPANY

TYPE **A** BILL OF LADING

**SOURCE RECORD BILL OF LADING** FOR NON-HAZARDOUS PURGEWATER RECOVERED FROM GROUNDWATER WELLS AT BP GEM OIL COMPANY FACILITIES IN THE STATE OF CALIFORNIA. THE NON-HAZARDOUS PURGEWATER WHICH HAS BEEN RECOVERED FROM GROUNDWATER WELLS IS COLLECTED BY THE CONTRACTOR, MADE UP INTO LOADS OF APPROPRIATE SIZE AND HAULED BY BELSHIRE ENVIRONMENTAL TO SEAPORT ENVIRONMENTAL IN REDWOOD CITY, CALIFORNIA.

The contractors performing this work are Stratus Environmental, Inc. [Stratus, 3330 Cameron Park Drive, Suite 550, Cameron Park, CA 95682, (530) 676-6004], and Dulous Environmental, Inc. [Dulous, PO Box 2559, Orangevale, CA 95662, (916) 990-0333]. Stratus is authorized by BP GEM OIL COMPANY to recover, collect, and apportion into loads the non-hazardous well purgewater that is drawn from wells at BP GEM Oil Company facilities and deliver that purgewater to BP GEM Oil Company facility 5786 located in West Sacramento, California. Dulous also performs these services under subcontract to Stratus. Transport routing of the non-hazardous well purgewater may be direct from one BP GEM facility to the designated destination point; from one BP GEM facility to the designated destination point via another BP GEM facility; from a BP GEM facility to the designated destination point via the contractor's facility, or any combination thereof. The non-hazardous well purgewater is and remains the property of BP GEM Oil Company.

This **Source Record BILL OF LADING** was initiated to cover the recovery of non-hazardous well purgewater from wells at the BP GEM Oil Company facility described below:

ARCO 771

Station #

899 Rincon Ave. Livermore, CA.

Station Address

Total Gallons Collected From Groundwater Monitoring Wells:

60

Added Equipment  
Rinse Water \_\_\_\_\_

Any Other  
Adjustments \_\_\_\_\_

**TOTAL GALS.  
RECOVERED** 60

loaded onto  
Stratus vehicle # \_\_\_\_\_

Stratus Project #

time date

E771

1030 01/17/07

Signature

\*\*\*\*\*

RECEIVED AT

time date

5786

1300 01/17/07

Unloaded by  
Signature

# STRATUS

ENVIRONMENTAL, INC.

**ORIGINAL**

Site Address: 899 Rincon Ave.  
 City Livermore CA  
 Sampled By G. Wilkins / V. Zalotka

Site Number: ARC0 771  
 Project No. E771  
 Project PM Jay Johnson  
 Date Sampled 01-17-07

Site Contact Phone No.

Water Level Data					Purge Volume Calculations					Well Purge Method				Sample Record			Field Data
Well ID	Time	Depth to water feet	Top of Screen feet	Total Depth of Well feet	Casing Water Column (A)	Well Diameter (inches)	Multiplier Value (B)	Three Casing Volumes (gallons)	Actual Water Purged (gallons)	No Purge	Bailer	Pump	Other	DTW At Sample Time	Sample I.D.	Sample Time	Dissolved Oxygen (mg/L)
MW-1	0809	31.88	32	36.55		4				X							
MW-2	0730	28.7	30	33.95	5.25	4				X							
MW-3	0744	30.51	32	39.46		4				X							
MW-4	0739	30.8	26	41.02	10.22	4	2	20	0	X	Sample Only			36.10	MW-4	1010	6.19
MW-5	0811	31.77	31.5	41.0		4				X							
MW-6	0712	30.57	32	43.08	12.51	4				X							
MW-7	0755	29.7	30	40.00	10.3	4	2	21	13			X	Dry @ 13	36.14	MW-7	0955	1.08
MW-8	0704	33.20	27.5	41.33		2				X							
MW-9	0700	29.11	29.5	38.87		2				X							
MW-10	0653	28.95	29	33.98		2				X							
MW-11	0708	31.59	29	38.45		2				X							
RW-1	0807	31.48	25.5	39.50	8.02	6	4.4	35.2	21			X	Dry @ 21	37.19	RW-1	0902	4.08
MW-1	0914	21.67	18.5	23.0		4				X							
<del>TB77101172007</del>																	
TB77101172007																	
															0916		

(A) Casing water Column  
 Depth wtr. Depth to Bottom

Multiplier Values  
 2"=0.5 4"=2.0 6"=4.4

# STRATUS

ENVIRONMENTAL, INC.

Site Address 899 Rincon Ave.  
 City Livermore, CA  
 Site Sampled by G. Wilkins / V. Zolothka

**ORIGINAL**

Site Number ARCO 771  
 Project No. E771  
 Project PM Jay Johnson  
 Date Sampled 01-17-07

Well ID <u>MW-4</u> <u>1010</u>					Well ID <u>MW-7</u> <u>0955</u>				
purge start time <u>Bailin</u> <u>Odor</u>					purge start time <u>0936</u> <u>Odor</u>				
	Temp C	pH	cond	gallons		Temp C	pH	cond	gallons
time	<u>19.9</u>	<u>8.03</u>	<u>715</u>	<u>0</u>	time	<u>19.1</u>	<u>8.32</u>	<u>601</u>	<u>0</u>
time					time	<u>19.5</u>	<u>7.96</u>	<u>618</u>	<u>10</u>
time					time		<u>Dry @ 13</u>		
time					time	<u>19.2</u>	<u>7.83</u>	<u>635</u>	<u>(13)</u>
purge stop time <u>No Purge / Sample only</u>					purge stop time				
Well ID <u>RW-1</u> <u>0902</u>					Well ID				
purge start time <u>0839</u> <u>No Odor</u>					purge start time				
	Temp C	pH	cond	gallons		Temp C	pH	cond	gallons
time	<u>18.0</u>	<u>7.81</u>	<u>611</u>	<u>0</u>	time				
time	<u>19.1</u>	<u>7.80</u>	<u>589</u>	<u>17</u>	time				
time	<u>18.6</u>	<u>7.74</u>	<u>604</u>	<u>(21)</u>	time				
time			<u>Dry @ 2 gal</u>		time				
purge stop time					purge stop time				
Well ID					Well ID				
purge start time					purge start time				
	Temp C	pH	cond	gallons		Temp C	pH	cond	gallons
time					time				
time					time				
time					time				
time					time				
purge stop time					purge stop time				
Well ID					Well ID				
purge start time					purge start time				
	Temp C	pH	cond	gallons		Temp C	pH	cond	gallons
time					time				
time					time				
time					time				
time					time				
purge stop time					purge stop time				



## Chain of Custody Record

**ORIGINAL**

Project Name: ARCO 771  
 BP BU/AR Region/Enfos Segment: BP > Americas > West > Retail > Alameda > 771  
 State or Lead Regulatory Agency: \_\_\_\_\_  
 Requested Due Date (mm/dd/yy): Std TAT

On-site Time: <u>0645</u>	Temp: <u>30</u>
Off-site Time: <u>1030</u>	Temp: <u>45</u>
Sky Conditions: <u>Clear</u>	
Meteorological Events: <u>-</u>	
Wind Speed: <u>-</u>	Direction: <u>-</u>

Lab Name: TestAmerica	BP/AR Facility No.: 771	Consultant/Contractor: Stratus Environmental, Inc.
Address: 885 Jarvis Drive	BP/AR Facility Address: 899 Rincon Ave., Livermore	Address: 3330 Cameron Park Drive, Suite 550
Morgan Hill, CA 95937	Site Lat/Long:	Cameron Park, CA 95682
Lab PM: Lisa Race	California Global ID No.: T0600100113	Consultant/Contractor Project No.:
Tele/Fax: 408-782-8156 408-782-6308 (fax)	Enfos Project No.: G0C1M-0020	Consultant/Contractor PM: Jay Johnson
BP/AR PM Contact: Paul Supple	Provision or OOC (circle one) Provision	Tele/Fax: (530) 676-6000 / (530) 676-6005
Address: 2010 Crow Canyon Place, Suite 150	Phase/WBS: 04-Monitoring	Report Type & QC Level: Level 1 with EDF
San Ramon, CA	Sub Phase/Task: 03-Analytical	E-mail EDD To: <u>cjewitt@stratusinc.net</u>
Tele/Fax: 925-275-3506	Cost Element: 01-Contractor labor	Invoice to: Atlantic Richfield Co.

Item No.	Sample Description	Time	Date	Matrix			Laboratory No.	No. of Containers	Preservative					Requested Analysis					Sample Point Lat/Long and Comments			
				Soil/Solid	Water/Liquid	Air			Unpreserved	H <sub>2</sub> SO <sub>4</sub>	HNO <sub>3</sub>	HCl	Methanol	GRO/BTEX/Oxy*	1,2-DCA	Ethanol	EDB	DRO				
1	MW-4	1010	01/17/07	X										X	X	X	X				All by 8260	
2	MW-7	0955																				
3	RW-1	0902																				*Oxy = MTBE, TAME, ETBE, DIPE, TBA
6	TB 77101172007			X																	On Hold	

Sampler's Name: <u>Call Wilkins</u>	Relinquished By / Affiliation: <u>Call Wilkins / Stratus</u>	Date: <u>01/17/07</u>	Time: <u>1328</u>	Accepted By / Affiliation: _____	Date: <u>1/17/07</u>	Time: <u>1328</u>
Sampler's Company: <u>Stratus</u>						
Shipment Date: <u>01-17-07</u>						
Shipment Method: <u>Stratus</u>						
Shipment Tracking No:						

Special Instructions: Please cc results to rmiller@broadbentinc.com

Custody Seals In Place: Yes / No | Temp Blank: Yes / No | Cooler Temp on Receipt: °F/C | Trip Blank: Yes / No | MS/MSD Sample Submitted: Yes / No

31 January, 2007

Jay Johnson  
Stratus Environmental Inc. [Arco]  
3330 Cameron Park Dr., Suite 550  
Cameron Park, CA 95682

RE: ARCO #0771, Livermore, CA  
Work Order: MQA0657

Enclosed are the results of analyses for samples received by the laboratory on 01/18/07 08:00. If you have any questions concerning this report, please feel free to contact me.

Sincerely,

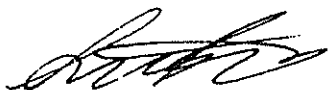

Lisa Race  
Senior Project Manager

CA ELAP Certificate # 1210

The results in this laboratory report pertain only to the samples tested in the laboratory. The analyses contained in this report were performed in accordance with the BPGCLN Technical Specifications, applicable Federal, State, local regulations and certification requirements as well as the methodologies as described in laboratory SOPs reviewed by the BPGCLN. This entire report was reviewed and approved for release.

Stratus Environmental Inc. [Arco] 3330 Cameron Park Dr., Suite 550 Cameron Park CA, 95682	Project: ARCO #0771, Livermore, CA Project Number: G0C1M-0020 Project Manager: Jay Johnson	MQA0657 Reported: 01/31/07 14:31
---	--	--

ANALYTICAL REPORT FOR SAMPLES

Sample ID	Laboratory ID	Matrix	Date Sampled	Date Received
MW-4	MQA0657-01	Water	01/17/07 10:10	01/18/07 08:00
MW-7	MQA0657-02	Water	01/17/07 09:55	01/18/07 08:00
RW-1	MQA0657-03	Water	01/17/07 09:02	01/18/07 08:00
TB 771 01172007	MQA0657-04	Water	01/17/07 00:00	01/18/07 08:00

The carbon range for the TPH-GRO has been changed from C6-C10 to C4-C12. The carbon range for TPH-DRO has been changed from C10-C28 to C10-C36. EPA 8015B has been modified to better meet the requirements of California regulatory agencies.

These samples were received with no custody seals.

Stratus Environmental Inc. [Arco]  
3330 Cameron Park Dr., Suite 550  
Cameron Park CA, 95682

Project: ARCO #0771, Livermore, CA  
Project Number: G0C1M-0020  
Project Manager: Jay Johnson

MQA0657  
Reported:  
01/31/07 14:31

**Total Purgeable Hydrocarbons by GC/MS (CA LUFT)**  
**TestAmerica - Morgan Hill, CA**

Analyte	Result	Reporting		Dilution	Batch	Prepared	Analyzed	Method	Notes
		Limit	Units						
<b>MW-4 (MQA0657-01) Water Sampled: 01/17/07 10:10 Received: 01/18/07 08:00</b>									
Gasoline Range Organics (C4-C12)	ND	50	ug/l	1	7A26027	01/26/07	01/27/07	LUFT GCMS	
Surrogate: 1,2-Dichloroethane-d4		104 %	60-145		"	"	"	"	
<b>MW-7 (MQA0657-02) Water Sampled: 01/17/07 09:55 Received: 01/18/07 08:00</b>									
Gasoline Range Organics (C4-C12)	5600	1200	ug/l	25	7A25001	01/25/07	01/25/07	LUFT GCMS	
Surrogate: 1,2-Dichloroethane-d4		111 %	60-145		"	"	"	"	
<b>RW-1 (MQA0657-03) Water Sampled: 01/17/07 09:02 Received: 01/18/07 08:00</b>									
Gasoline Range Organics (C4-C12)	6900	250	ug/l	5	7A26027	01/26/07	01/27/07	LUFT GCMS	
Surrogate: 1,2-Dichloroethane-d4		103 %	60-145		"	"	"	"	



Stratus Environmental Inc. [Arco]  
3330 Cameron Park Dr., Suite 550  
Cameron Park CA, 95682

Project: ARCO #0771, Livermore, CA  
Project Number: G0C1M-0020  
Project Manager: Jay Johnson

MQA0657  
Reported:  
01/31/07 14:31

**Volatile Organic Compounds by EPA Method 8260B**  
**TestAmerica - Morgan Hill, CA**

Analyte	Result	Reporting Limit	Units	Dilution	Batch	Prepared	Analyzed	Method	Notes
<b>MW-4 (MQA0657-01) Water</b> <b>Sampled: 01/17/07 10:10</b> <b>Received: 01/18/07 08:00</b>									
tert-Amyl methyl ether	ND	0.50	ug/l	1	7A26027	01/26/07	01/27/07	EPA 8260B	
Benzene	ND	0.50	"	"	"	"	"	"	
tert-Butyl alcohol	ND	20	"	"	"	"	"	"	
Di-isopropyl ether	ND	0.50	"	"	"	"	"	"	
1,2-Dibromoethane (EDB)	ND	0.50	"	"	"	"	"	"	
1,2-Dichloroethane	ND	0.50	"	"	"	"	"	"	
Ethanol	ND	300	"	"	"	"	"	"	
Ethyl tert-butyl ether	ND	0.50	"	"	"	"	"	"	
Ethylbenzene	ND	0.50	"	"	"	"	"	"	
Methyl tert-butyl ether	11	0.50	"	"	"	"	"	"	
Toluene	ND	0.50	"	"	"	"	"	"	
Xylenes (total)	ND	0.50	"	"	"	"	"	"	
<i>Surrogate: Dibromofluoromethane</i>		100 %		75-130	"	"	"	"	
<i>Surrogate: 1,2-Dichloroethane-d4</i>		104 %		60-145	"	"	"	"	
<i>Surrogate: Toluene-d8</i>		98 %		70-130	"	"	"	"	
<i>Surrogate: 4-Bromofluorobenzene</i>		90 %		60-120	"	"	"	"	
<b>MW-7 (MQA0657-02) Water</b> <b>Sampled: 01/17/07 09:55</b> <b>Received: 01/18/07 08:00</b>									
tert-Amyl methyl ether	ND	2.5	ug/l	5	7A26027	01/26/07	01/27/07	EPA 8260B	
<b>Benzene</b>	<b>16</b>	2.5	"	"	"	"	"	"	
tert-Butyl alcohol	ND	100	"	"	"	"	"	"	
Di-isopropyl ether	ND	2.5	"	"	"	"	"	"	
1,2-Dibromoethane (EDB)	ND	2.5	"	"	"	"	"	"	
1,2-Dichloroethane	ND	2.5	"	"	"	"	"	"	
Ethanol	ND	1500	"	"	"	"	"	"	
Ethyl tert-butyl ether	ND	2.5	"	"	"	"	"	"	
<b>Ethylbenzene</b>	<b>26</b>	2.5	"	"	"	"	"	"	
<b>Methyl tert-butyl ether</b>	<b>3.1</b>	2.5	"	"	"	"	"	"	
Toluene	ND	2.5	"	"	"	"	"	"	
<b>Xylenes (total)</b>	<b>12</b>	2.5	"	"	"	"	"	"	
<i>Surrogate: Dibromofluoromethane</i>		102 %		75-130	"	"	"	"	
<i>Surrogate: 1,2-Dichloroethane-d4</i>		102 %		60-145	"	"	"	"	
<i>Surrogate: Toluene-d8</i>		106 %		70-130	"	"	"	"	
<i>Surrogate: 4-Bromofluorobenzene</i>		101 %		60-120	"	"	"	"	

Stratus Environmental Inc. [Arco]  
3330 Cameron Park Dr., Suite 550  
Cameron Park CA, 95682

Project: ARCO #0771, Livermore, CA  
Project Number: G0C1M-0020  
Project Manager: Jay Johnson

MQA0657  
Reported:  
01/31/07 14:31

**Volatile Organic Compounds by EPA Method 8260B**  
**TestAmerica - Morgan Hill, CA**

Analyte	Result	Reporting Limit	Units	Dilution	Batch	Prepared	Analyzed	Method	Notes
<b>RW-1 (MQA0657-03) Water Sampled: 01/17/07 09:02 Received: 01/18/07 08:00</b>									
tert-Amyl methyl ether	ND	2.5	ug/l	5	7A26027	01/26/07	01/27/07	EPA 8260B	
<b>Benzene</b>	<b>17</b>	<b>2.5</b>	"	"	"	"	"	"	
tert-Butyl alcohol	ND	100	"	"	"	"	"	"	
Di-isopropyl ether	ND	2.5	"	"	"	"	"	"	
1,2-Dibromoethane (EDB)	ND	2.5	"	"	"	"	"	"	
1,2-Dichloroethane	ND	2.5	"	"	"	"	"	"	
Ethanol	ND	1500	"	"	"	"	"	"	
Ethyl tert-butyl ether	ND	2.5	"	"	"	"	"	"	
<b>Ethylbenzene</b>	<b>22</b>	<b>2.5</b>	"	"	"	"	"	"	
<b>Methyl tert-butyl ether</b>	<b>2.6</b>	<b>2.5</b>	"	"	"	"	"	"	
<b>Toluene</b>	<b>2.8</b>	<b>2.5</b>	"	"	"	"	"	"	
<b>Xylenes (total)</b>	<b>31</b>	<b>2.5</b>	"	"	"	"	"	"	
<i>Surrogate: Dibromofluoromethane</i>		<i>97 %</i>		<i>75-130</i>	"	"	"	"	
<i>Surrogate: 1,2-Dichloroethane-d4</i>		<i>103 %</i>		<i>60-145</i>	"	"	"	"	
<i>Surrogate: Toluene-d8</i>		<i>98 %</i>		<i>70-130</i>	"	"	"	"	
<i>Surrogate: 4-Bromofluorobenzene</i>		<i>100 %</i>		<i>60-120</i>	"	"	"	"	

Stratus Environmental Inc. [Arco]  
3330 Cameron Park Dr., Suite 550  
Cameron Park CA, 95682

Project: ARCO #0771, Livermore, CA  
Project Number: G0C1M-0020  
Project Manager: Jay Johnson

MQA0657  
Reported:  
01/31/07 14:31

**Total Purgeable Hydrocarbons by GC/MS (CA LUFT) - Quality Control**  
**TestAmerica - Morgan Hill, CA**

Analyte	Result	Reporting Limit	Units	Spike Level	Source Result	%REC	%REC Limits	RPD	RPD Limit	Notes
---------	--------	-----------------	-------	-------------	---------------	------	-------------	-----	-----------	-------

**Batch 7A25001 - EPA 5030B P/T / LUFT GCMS**

<b>Blank (7A25001-BLK1)</b>										
Prepared & Analyzed: 01/25/07										
Gasoline Range Organics (C4-C12)	ND	50	ug/l							
Surrogate: 1,2-Dichloroethane-d4	2.57		"	2.50		103	60-145			
<b>Laboratory Control Sample (7A25001-BS2)</b>										
Prepared & Analyzed: 01/25/07										
Gasoline Range Organics (C4-C12)	458	50	ug/l	500		92	75-140			
Surrogate: 1,2-Dichloroethane-d4	2.53		"	2.50		101	60-145			
<b>Laboratory Control Sample Dup (7A25001-BSD2)</b>										
Prepared & Analyzed: 01/25/07										
Gasoline Range Organics (C4-C12)	463	50	ug/l	500		93	75-140	1	20	
Surrogate: 1,2-Dichloroethane-d4	2.58		"	2.50		103	60-145			

**Batch 7A26027 - EPA 5030B P/T / LUFT GCMS**

<b>Blank (7A26027-BLK1)</b>										
Prepared & Analyzed: 01/26/07										
Gasoline Range Organics (C4-C12)	ND	50	ug/l							
Surrogate: 1,2-Dichloroethane-d4	2.48		"	2.50		99	60-145			
<b>Laboratory Control Sample (7A26027-BS2)</b>										
Prepared & Analyzed: 01/26/07										
Gasoline Range Organics (C4-C12)	571	50	ug/l	500		114	75-140			
Surrogate: 1,2-Dichloroethane-d4	2.58		"	2.50		103	60-145			
<b>Laboratory Control Sample Dup (7A26027-BSD2)</b>										
Prepared & Analyzed: 01/26/07										
Gasoline Range Organics (C4-C12)	600	50	ug/l	500		120	75-140	5	20	
Surrogate: 1,2-Dichloroethane-d4	2.63		"	2.50		105	60-145			

Stratus Environmental Inc. [Arco]  
3330 Cameron Park Dr., Suite 550  
Cameron Park CA, 95682

Project: ARCO #0771, Livermore, CA  
Project Number: G0CIM-0020  
Project Manager: Jay Johnson

MQA0657  
Reported:  
01/31/07 14:31

**Volatile Organic Compounds by EPA Method 8260B - Quality Control**  
**TestAmerica - Morgan Hill, CA**

Analyte	Result	Reporting Limit	Units	Spike Level	Source Result	%REC	%REC Limits	RPD	RPD Limit	Notes
---------	--------	-----------------	-------	-------------	---------------	------	-------------	-----	-----------	-------

**Batch 7A26027 - EPA 5030B P/T / EPA 8260B**

**Blank (7A26027-BLK1)**

Prepared & Analyzed: 01/26/07

tert-Amyl methyl ether	ND	0.50	ug/l							
Benzene	ND	0.50	"							
tert-Butyl alcohol	ND	20	"							
Di-isopropyl ether	ND	0.50	"							
1,2-Dibromoethane (EDB)	ND	0.50	"							
1,2-Dichloroethane	ND	0.50	"							
Ethanol	ND	300	"							
Ethyl tert-butyl ether	ND	0.50	"							
Ethylbenzene	ND	0.50	"							
Methyl tert-butyl ether	ND	0.50	"							
Toluene	ND	0.50	"							
Xylenes (total)	ND	0.50	"							
<i>Surrogate: Dibromofluoromethane</i>	2.53		"	2.50		101	75-130			
<i>Surrogate: 1,2-Dichloroethane-d4</i>	2.48		"	2.50		99	60-145			
<i>Surrogate: Toluene-d8</i>	2.34		"	2.50		94	70-130			
<i>Surrogate: 4-Bromofluorobenzene</i>	2.19		"	2.50		88	60-120			

**Laboratory Control Sample (7A26027-BS1)**

Prepared & Analyzed: 01/26/07

tert-Amyl methyl ether	9.22	0.50	ug/l	10.0		92	65-135			
Benzene	9.26	0.50	"	10.0		93	70-125			
tert-Butyl alcohol	179	20	"	200		90	60-135			
Di-isopropyl ether	9.12	0.50	"	10.0		91	70-130			
1,2-Dibromoethane (EDB)	9.75	0.50	"	10.0		98	80-125			
1,2-Dichloroethane	9.93	0.50	"	10.0		99	75-125			
Ethanol	211	300	"	200		106	15-150			
Ethyl tert-butyl ether	9.31	0.50	"	10.0		93	65-130			
Ethylbenzene	9.53	0.50	"	10.0		95	70-130			
Methyl tert-butyl ether	9.58	0.50	"	10.0		96	50-140			
Toluene	9.03	0.50	"	10.0		90	70-120			
Xylenes (total)	28.8	0.50	"	30.0		96	80-125			
<i>Surrogate: Dibromofluoromethane</i>	2.64		"	2.50		106	75-130			
<i>Surrogate: 1,2-Dichloroethane-d4</i>	2.55		"	2.50		102	60-145			
<i>Surrogate: Toluene-d8</i>	2.48		"	2.50		99	70-130			
<i>Surrogate: 4-Bromofluorobenzene</i>	2.53		"	2.50		101	60-120			

Stratus Environmental Inc. [Arco]  
3330 Cameron Park Dr., Suite 550  
Cameron Park CA, 95682

Project: ARCO #0771, Livermore, CA  
Project Number: G0C1M-0020  
Project Manager: Jay Johnson

MQA0657  
Reported:  
01/31/07 14:31

**Volatile Organic Compounds by EPA Method 8260B - Quality Control**  
**TestAmerica - Morgan Hill, CA**

Analyte	Result	Reporting Limit	Units	Spike Level	Source Result	%REC	%REC Limits	RPD	RPD Limit	Notes
---------	--------	-----------------	-------	-------------	---------------	------	-------------	-----	-----------	-------

**Batch 7A26027 - EPA 5030B P/T / EPA 8260B**

Matrix Spike (7A26027-MS1)	Source: MQA0657-01			Prepared & Analyzed: 01/26/07						
tert-Amyl methyl ether	9.68	0.50	ug/l	10.0	ND	97	65-135			
Benzene	10.6	0.50	"	10.0	ND	106	70-125			
tert-Butyl alcohol	217	20	"	200	ND	108	60-135			
Di-isopropyl ether	10.1	0.50	"	10.0	ND	101	70-130			
1,2-Dibromoethane (EDB)	10.3	0.50	"	10.0	ND	103	80-125			
1,2-Dichloroethane	11.0	0.50	"	10.0	ND	110	75-125			
Ethanol	264	300	"	200	ND	132	15-150			
Ethyl tert-butyl ether	9.75	0.50	"	10.0	ND	98	65-130			
Ethylbenzene	11.3	0.50	"	10.0	ND	113	70-130			
Methyl tert-butyl ether	20.8	0.50	"	10.0	11	98	50-140			
Toluene	10.4	0.50	"	10.0	ND	104	70-120			
Xylenes (total)	33.7	0.50	"	30.0	ND	112	80-125			
<i>Surrogate: Dibromofluoromethane</i>	2.55		"	2.50		102	75-130			
<i>Surrogate: 1,2-Dichloroethane-d4</i>	2.48		"	2.50		99	60-145			
<i>Surrogate: Toluene-d8</i>	2.40		"	2.50		96	70-130			
<i>Surrogate: 4-Bromofluorobenzene</i>	2.40		"	2.50		96	60-120			

Matrix Spike Dup (7A26027-MSD1)	Source: MQA0657-01			Prepared: 01/26/07 Analyzed: 01/27/07						
tert-Amyl methyl ether	10.4	0.50	ug/l	10.0	ND	104	65-135	7	25	
Benzene	9.92	0.50	"	10.0	ND	99	70-125	7	15	
tert-Butyl alcohol	198	20	"	200	ND	99	60-135	9	35	
Di-isopropyl ether	9.85	0.50	"	10.0	ND	98	70-130	3	35	
1,2-Dibromoethane (EDB)	10.6	0.50	"	10.0	ND	106	80-125	3	15	
1,2-Dichloroethane	10.9	0.50	"	10.0	ND	109	75-125	0.9	10	
Ethanol	200	300	"	200	ND	100	15-150	28	35	
Ethyl tert-butyl ether	9.88	0.50	"	10.0	ND	99	65-130	1	35	
Ethylbenzene	10.4	0.50	"	10.0	ND	104	70-130	8	15	
Methyl tert-butyl ether	22.9	0.50	"	10.0	11	119	50-140	10	25	
Toluene	9.68	0.50	"	10.0	ND	97	70-120	7	15	
Xylenes (total)	31.3	0.50	"	30.0	ND	104	80-125	7	15	
<i>Surrogate: Dibromofluoromethane</i>	2.53		"	2.50		101	75-130			
<i>Surrogate: 1,2-Dichloroethane-d4</i>	2.63		"	2.50		105	60-145			
<i>Surrogate: Toluene-d8</i>	2.49		"	2.50		100	70-130			
<i>Surrogate: 4-Bromofluorobenzene</i>	2.53		"	2.50		101	60-120			

Stratus Environmental Inc. [Arco]  
3330 Cameron Park Dr., Suite 550  
Cameron Park CA, 95682

Project: ARCO #0771, Livermore, CA  
Project Number: G0C1M-0020  
Project Manager: Jay Johnson

MQA0657  
Reported:  
01/31/07 14:31

**Notes and Definitions**

DET Analyte DETECTED  
ND Analyte NOT DETECTED at or above the reporting limit or MDL, if MDL is specified  
NR Not Reported  
dry Sample results reported on a dry weight basis  
RPD Relative Percent Difference



bp  
A BP affiliated company

### Chain of Custody Record

Project Name: ARCO 771  
 BP BU/AR Region/Enfos Segment: BP > Americas > West > Retail > Alameda > 771  
 State or Lead Regulatory Agency:  
 Requested Due Date (mm/dd/yy): Std TAT

On-site Time: <u>0645</u>	Temp: <u>30</u>
Off-site Time: <u>1030</u>	Temp: <u>45</u>
Sky Conditions: <u>Clear</u>	
Meteorological Events: <u>-</u>	
Wind Speed: <u>-</u>	Direction: <u>-</u>

Lab Name: <u>TestAmerica</u>	BP/AR Facility No.: <u>771</u>	Consultant/Contractor: <u>Stratus Environmental, Inc.</u>
Address: <u>885 Jarvis Drive</u>	BP/AR Facility Address: <u>899 Rincon Ave., Livermore</u>	Address: <u>3330 Cameron Park Drive, Suite 550</u>
<u>Morgan Hill, CA 95937</u>	Site Lat/Long:	<u>Cameron Park, CA 95682</u>
Lab PM: <u>Lisa Race</u>	California Global ID No.: <u>T0600100113</u>	Consultant/Contractor Project No.:
Tele/Fax: <u>408-782-8156 408-782-6308 (fax)</u>	Enfos Project No.: <u>GOCIM-0020</u>	Consultant/Contractor PM: <u>Jay Johnson</u>
BP/AR PM Contact: <u>Paul Supple</u>	Provision or OOC (circle one) <u>Provision</u>	Tele/Fax: <u>(530) 676-6000 / (530) 676-6005</u>
Address: <u>2010 Crow Canyon Place, Suite 150</u>	Phase/WBS: <u>04-Monitoring</u>	Report Type & QC Level: <u>Level 1 with EDF</u>
<u>San Ramon, CA</u>	Sub Phase/Task: <u>03-Analytical</u>	E-mail EDD To: <u>cjewitt@stratusinc.net</u>
Tele/Fax: <u>925-275-3506</u>	Cost Element: <u>01-Contractor labor</u>	Invoice to: <u>Atlantic Richfield Co.</u>

Item No.	Sample Description	Time	Date	Matrix			Laboratory No.	No. of Containers	Preservative					Requested Analysis					Sample Point Lat/Long and Comments			
				Soil/Solid	Water/Liquid	Air			Unpreserved	H <sub>2</sub> SO <sub>4</sub>	HNO <sub>3</sub>	HCl	Methanol	GRO/BTEX/Oxy*	1,2-DCA	Ethanol	EDB	DRO				
1	MW-4	1010	01/17/07	X			M9A0657						X	X	X	X					All by 8260	
2	MW-7	0955					02															
3	RW-1	0902					03															*Oxy = MTBE, TAME, ETBE, DIPE, TBA
4																						
5																						
6	TB 771 01172007			X			44															On Hold
7																						
8																						
9																						
10																						

Sampler's Name: <u>Col Williams</u>	Relinquished By / Affiliation: <u>Col Williams / Stratus</u>	Date: <u>01/17/07</u>	Time: <u>1328</u>	Accepted By / Affiliation: <u>Milee Ng. (MTH)</u>	Date: <u>1/17/07</u>	Time: <u>1328</u>
Sampler's Company: <u>Stratus</u>						
Shipment Date: <u>01-17-07</u>						
Shipment Method: <u>Stratus</u>						
Shipment Tracking No:						

Instructions: Please cc results to [rmiller@broadbentinc.com](mailto:rmiller@broadbentinc.com)

Custody Seals In Place: Yes /  No | Temp Blank:  No | Cooler Temp on Receipt: 4.3°F | Trip Blank:  No | MS/MSD Sample Submitted:  Yes / No

4.70

## TEST AMERICA SAMPLE RECEIPT LOG

**CLIENT NAME:** ARCO  
**REC. BY (PRINT)** JULIE NG.  
**WORKORDER:** 1740457

**DATE REC'D AT LAB:** 1/18/07  
**TIME REC'D AT LAB:** 0800  
**DATE LOGGED IN:** 1/18/07

For Regulatory Purposes?  
**DRINKING WATER** YES / NO  
**WASTE WATER** YES / NO

CIRCLE THE APPROPRIATE RESPONSE	LAB SAMPLE #	CLIENT ID	CONTAINER DESCRIPTION	PRESERVATIVE	pH	SAMPLE MATRIX	DATE SAMPLED	REMARKS: CONDITION (ETC.)
1. Custody Seal(s) Present / Absent Intact / Broken*	01	MW-4	B VOA	HCL	-	W	1/17	
	02	MW-7	3 ↓	↓	↓	↓	↓	
2. Chain-of-Custody Present / Absent*	03	RW-1	3 ↓	↓	↓	↓	↓	
3. Traffic Reports or Packing List: Present / Absent*	04	TB 77101172007	2 ↓	↓	↓	↓	↓	
4. Airbill: Airbill / Slicker Present / Absent								
5. Airbill #: <u>D10010117642549</u>								
6. Sample Labels: Present / Absent								
7. Sample IDs: Listed / Not Listed on Chain-of-Custody								
8. Sample Condition: Intact / Broken* / Leaking*								
9. Does information on chain-of-custody, traffic reports and sample labels agree? Yes / No*								
10. Sample received within hold time? Yes / No*								
11. Adequate sample volume received? Yes / No*								
12. Proper preservatives used? Yes / No*								
13. Trip Blank / Temp Blank Received? (circle which, if yes) Yes / No*								
14. Read Temp: <u>4.3°C</u> Corrected Temp: <u>↓</u> Is corrected temp 4 +/-2°C? Yes / No**								
<small>(Acceptance range for samples requiring thermal pres.)</small> Exception (if any): METALS / DFF ON ICE Problem COC								

\*IF CIRCLED, CONTACT PROJECT MANAGER AND ATTACH RECORD OF RESOLUTION.



**APPENDIX B**

**GEOTRACKER UPLOAD CONFIRMATION**

# Electronic Submittal Information

[Main Menu](#) | [View/Add Facilities](#) | [Upload EDD](#) | [Check EDD](#)

Your EDF file has been successfully uploaded!

**Confirmation Number:** 2347644269

**Date/Time of Submittal:** 3/28/2007 11:13:29 AM

**Facility Global ID:** T0600100113

**Facility Name:** ARCO #00771

**Submittal Title:** 1Q07 GW Monitoring

**Submittal Type:** GW Monitoring Report

[Click here to view the detections report for this upload.](#)

<b>ARCO #00771</b> 899 RINCON LIVERMORE, CA 94550	<b>Regional Board - Case #: 01-0121</b> SAN FRANCISCO BAY RWQCB (REGION 2) - (CM) <b>Local Agency (lead agency) - Case #: RO0000200</b> ALAMEDA COUNTY LOP - (SP)
---	--

<u>CONF #</u>	<u>TITLE</u>	<u>QUARTER</u>
2347644269	1Q07 GW Monitoring	Q1 2007
<u>SUBMITTED BY</u>	<u>SUBMIT DATE</u>	<u>STATUS</u>
Broadbent & Associates, Inc.	3/28/2007	PENDING REVIEW

## SAMPLE DETECTIONS REPORT

# FIELD POINTS SAMPLED	3
# FIELD POINTS WITH DETECTIONS	3
# FIELD POINTS WITH WATER SAMPLE DETECTIONS ABOVE MCL	2
SAMPLE MATRIX TYPES	WATER

## METHOD QA/QC REPORT

METHODS USED	8260FA,8260TPH
TESTED FOR REQUIRED ANALYTES?	Y
LAB NOTE DATA QUALIFIERS	N

## QA/QC FOR 8021/8260 SERIES SAMPLES

TECHNICAL HOLDING TIME VIOLATIONS	0
METHOD HOLDING TIME VIOLATIONS	0
LAB BLANK DETECTIONS ABOVE REPORTING DETECTION LIMIT	0
LAB BLANK DETECTIONS	0
DO ALL BATCHES WITH THE 8021/8260 SERIES INCLUDE THE FOLLOWING?	
- LAB METHOD BLANK	Y
- MATRIX SPIKE	N
- MATRIX SPIKE DUPLICATE	N
- BLANK SPIKE	Y
- SURROGATE SPIKE	Y

## WATER SAMPLES FOR 8021/8260 SERIES

MATRIX SPIKE / MATRIX SPIKE DUPLICATE(S) % RECOVERY BETWEEN 65-135%	Y
MATRIX SPIKE / MATRIX SPIKE DUPLICATE(S) RPD LESS THAN 30%	n/a
SURROGATE SPIKES % RECOVERY BETWEEN 85-115%	Y
BLANK SPIKE / BLANK SPIKE DUPLICATES % RECOVERY BETWEEN 70-130%	Y

**SOIL SAMPLES FOR 8021/8260 SERIES**

MATRIX SPIKE / MATRIX SPIKE DUPLICATE(S) % RECOVERY BETWEEN 65-135%	n/a
MATRIX SPIKE / MATRIX SPIKE DUPLICATE(S) RPD LESS THAN 30%	n/a
SURROGATE SPIKES % RECOVERY BETWEEN 70-125%	n/a
BLANK SPIKE / BLANK SPIKE DUPLICATES % RECOVERY BETWEEN 70-130%	n/a

**FIELD QC SAMPLES**

<u>SAMPLE</u>	<u>COLLECTED</u>	<u>DETECTIONS &gt; REPD</u>
QCTB SAMPLES	N	0
QCEB SAMPLES	N	0
QCAB SAMPLES	N	0

Logged in as BROADBENT-C (CONTRACTOR)

CONTACT SITE ADMINISTRATOR.

## Electronic Submittal Information

[Main Menu](#) | [View/Add Facilities](#) | [Upload EDD](#) | [Check EDD](#)

### UPLOADING A GEO\_WELL FILE

**Processing is complete. No errors were found!  
Your file has been successfully submitted!**

**Submittal Title:                   1Q07 GEO\_WELL 771**  
**Submittal Date/Time:        3/28/2007 11:11:39 AM**  
**Confirmation Number:       7647602915**

**[Back to Main Menu](#)**

Logged in as BROADBENT-C  
(CONTRACTOR)

[CONTACT SITE ADMINISTRATOR.](#)