

RECEIVED

By dehloptoxic at 2:19 pm, Oct 31, 2006



Atlantic Richfield Company
(a BP affiliated company)

P.O. Box 1257
San Ramon, CA 94583
Phone: (925) 275-3801
Fax: (925) 275-3815



October 31, 2006

Re: Third Quarter, 2006 Semi-Annual Report
Atlantic Richfield Company Station #771
899 Rincon Avenue
Livermore, California
ACEH Case RO0000200

"I declare, that to the best of my knowledge at the present time, that the information and/or recommendations contained in the attached document are true and correct."

Submitted by:

Paul Supple
Environmental Business Manger

Third Quarter, 2006 Semi-Annual Report
Atlantic Richfield Company Station #771
899 Rincon Avenue
Livermore, California

Prepared for

Mr. Paul Supple
Environmental Business Manager
Atlantic Richfield Company
P.O. Box 1257
San Ramon, California 94583

Prepared by



1324 Mangrove Avenue, Suite 212
Chico, California 95926
(530) 566-1400
www.broadbentinc.com

October 2006

Project No. 06-02-608

Broadbent & Associates, Inc.
1324 Mangrove Ave., Suite 212
Chico, CA 95926
Voice (530) 566-1400
Fax (530) 566-1401



October 31, 2006

Project No. 06-02-608

Atlantic Richfield Company
P.O. Box 1257
San Ramon, CA 94583
Submitted via ENFOS

Attn.: Mr. Paul Supple

Re: Third Quarter, 2006 Semi-Annual Report, Atlantic Richfield Company Station #771, 899 Rincon Avenue, Livermore California. ACEH Case RO0000200.

Dear Mr. Supple:

Attached is the *Third Quarter, 2006 Semi-Annual Report* for Atlantic Richfield Company Station #771 (herein referred to as Station #771) located at 899 Rincon Avenue, Livermore, California (Property). This report presents a summary of Third Quarter, 2006 ground-water monitoring results.

Should you have questions regarding the work performed or results obtained, please do not hesitate to contact us at (530) 566-1400.

Sincerely,

BROADBENT & ASSOCIATES, INC.

A handwritten signature in black ink, appearing to read 'Matt Herrick', written over a horizontal line.

Matthew G. Herrick, P.G.
Project Hydrogeologist

A handwritten signature in black ink, appearing to read 'Robert H. Miller', written over a horizontal line.

Robert H. Miller, P.G., C.HG.
Principal Hydrogeologist

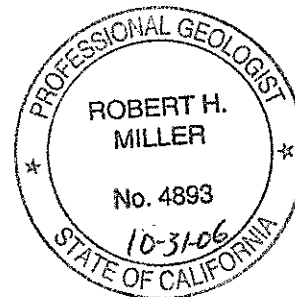

Enclosures

cc: Mr. Steven Plunkett, Alameda County Environmental Health, 1131 Harbor Bay Parkway, Suite 250, Alameda, CA, 94502 (Submitted via ACEH ftp Site)
Mr. Paul M. Smith, Livermore-Pleasanton Fire Department, 3560 Nevada St., Pleasanton, CA 94566
Mr. John Kaiser, RWQCB, 1515 Clay St. Suite 1400, Oakland, CA 94612

STATION #771 SEMI-ANNUAL GROUND-WATER MONITORING REPORT

Facility: #771 Address: 899 Rincon Avenue, Livermore, CA
Station #771 Environmental Business
Manager: Mr. Paul Supple
Consulting Co./Contact Persons: Broadbent & Associates, Inc. (BAI) /Rob Miller & Matt Herrick
Primary Agency/Regulatory ID No.: Alameda County Environmental Health (ACEH)/ ACEH Case RO0000200
Consultant Project No.: 06-02-608
Facility Permits/Permitting Agency.: NA

WORK PERFORMED THIS QUARTER (Third Quarter, 2006):

1. Submitted Second Quarter, 2006 Status Report. Work performed by BAI.
2. Conducted ground-water monitoring/sampling for Third Quarter, 2006. Work performed by URS.

WORK PROPOSED FOR NEXT QUARTER (Third Quarter, 2006):

1. Submit Third Quarter, 2006 Semi-Annual Report (contained herein).
2. No environmental work activities are scheduled to be completed on the Property during the Fourth Quarter, 2006.

QUARTERLY RESULTS SUMMARY:

Current phase of project:	<u>Monitoring</u>	(Assmnt., remed., etc.)
Frequency of ground-water sampling:	<u>MW-4, MW-7, RW-1 = Semi-Annual (1Q and 3Q)</u> <u>MW-2, MW-5, MW-6, MW-11, VW-1, = Annual (3Q)</u>	(Quarterly, annually, etc.)
Frequency of ground-water monitoring:	<u>Semi-annual (1Q and 3Q)</u>	(Monthly, etc.)
Is free product (FP) present on-site:	<u>No</u>	(Yes\ no)
FP recovered this quarter:	<u>NA (FP last recovered in 1992)</u>	(Gallons)
Cumulative FP recovered:	<u>3.06 gallons, Wells MW-1, MW-2, and MW-5</u>	(Gallons)
Current remediation techniques:	<u>Air Diffusion</u>	(SVET,AS, FP removal, etc.)
Depth to ground water (below TOC):	<u>20.73 (MW-1) to 30.36 (MW-5)</u>	(Measure feet below TOC)
General ground-water flow direction:	<u>North and Southwest</u>	(North, northwest, etc.)
Approximate hydraulic gradient:	<u>0.05 and 0.02</u>	(Feet per foot)

DISCUSSION:

During Third Quarter, 2006 gasoline range organics (GRO) were detected in six wells with concentration ranging from 66 µg/L in MW-4 to 8,000 µg/L in MW-7. Benzene was detected in four wells with concentrations ranging from 0.60 µg/L (MW-4) to 110 µg/L (MW-7). Ethylbenzene was detected in three wells with concentrations ranging from 0.52 µg/L in MW-4 to 380 µg/L in MW-7. Xylenes were detected in four wells with concentrations ranging from 0.82 µg/L (MW-4) to 180 µg/L (MW-7). Methyl tert-butyl ether (MTBE) was detected in four wells with concentrations ranging from

3.1 µg/L in MW-4 to 54 µg/L in MW-7. Tert-Butyl alcohol (TBA) was detected in MW-4 at 35 µg/L. No other analytes were detected during Third Quarter, 2006.

Drawing 1 depicts a ground-water elevation contour and an analytical summary map for the Third Quarter, 2006. Table 1 includes a summary of ground-water monitoring data including relative water elevations and laboratory analyses. Table 2 provides a summary of fuel additives analytical data. Table 3 lists historical ground-water flow direction and gradient data.

CLOSURE:

The findings presented in this report are based upon: observations of URS field personnel (see Appendix A), the points investigated, and results of laboratory tests performed by TestAmerica (Morgan Hill, CA). Our services were performed in accordance with the generally accepted standard of practice at the time this report was written. No other warranty, expressed or implied was made. This report has been prepared for the exclusive use of Atlantic Richfield Company. It is possible that variations in soil or ground-water conditions could exist beyond points explored in this investigation. Also, changes in site conditions could occur in the future due to variations in rainfall, temperature, regional water usage, or other factors.

ATTACHMENTS:

- Drawing 1. Ground-Water Elevation Contour and Analytical Summary Map, Station #771, Livermore, CA
- Table 1. Summary of Ground-Water Monitoring Data: Relative Water Elevations and Laboratory Analyses, Station #771, Livermore, CA
- Table 2. Summary of Fuel Additives Analytical Data, Station #771, Livermore, CA
- Table 3. Historical Ground-Water Flow Direction and Gradient, Station #771, Livermore, CA
- Appendix A. URS Ground-water Sampling Data Package (Includes Laboratory Report and Chain of Custody Documentation, Field and Laboratory Procedures, and Field Data Sheets)
- Appendix B. GeoTracker Upload Confirmation

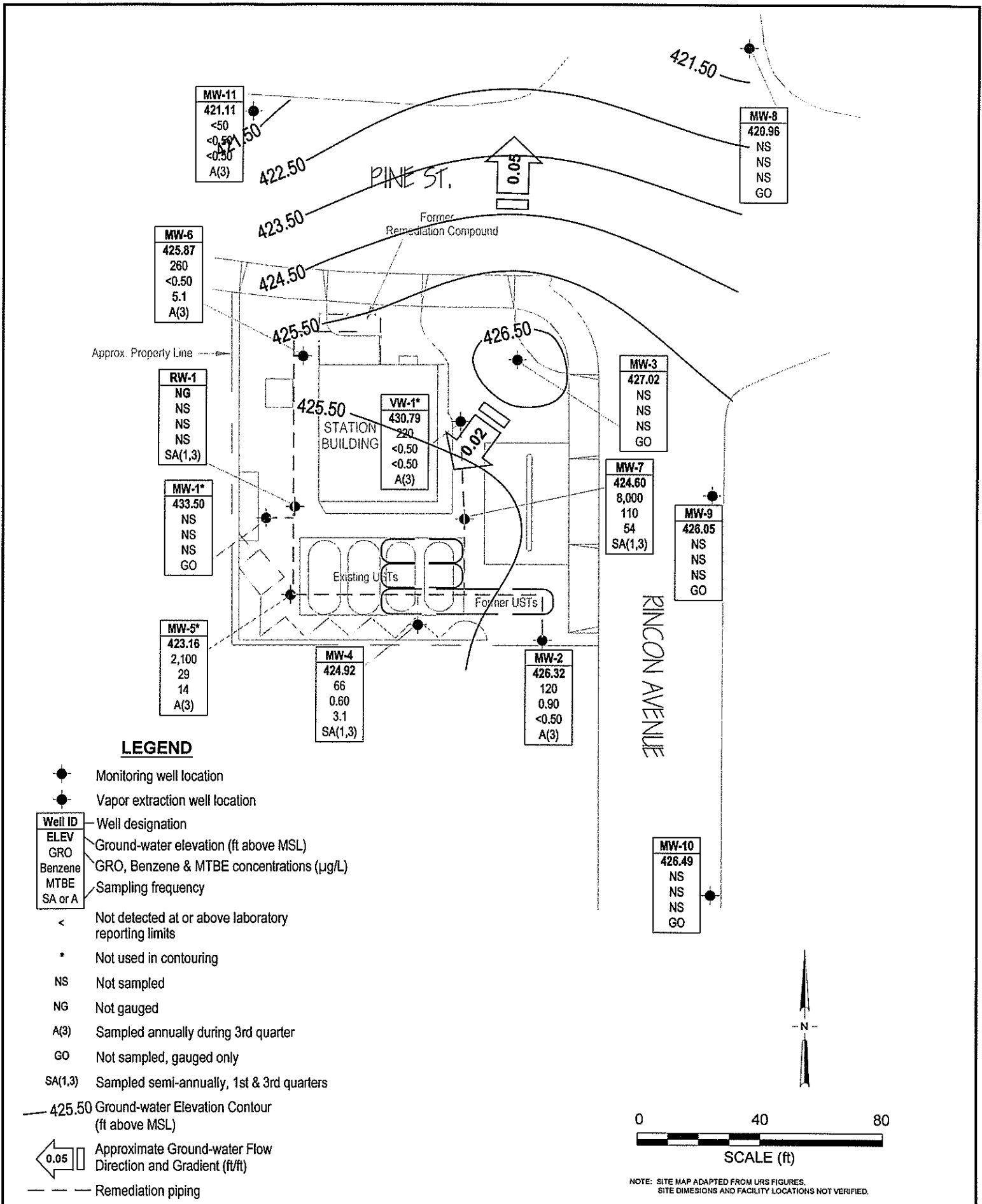

LEGEND

- Monitoring well location
- Vapor extraction well location

Well ID	Well designation
ELEV	Ground-water elevation (ft above MSL)
GRO	GRO, Benzene & MTBE concentrations (µg/L)
Benzene	
MTBE	
SA or A	Sampling frequency

- < Not detected at or above laboratory reporting limits
- * Not used in contouring
- NS Not sampled
- NG Not gauged
- A(3) Sampled annually during 3rd quarter
- GO Not sampled, gauged only
- SA(1,3) Sampled semi-annually, 1st & 3rd quarters

— 425.50 Ground-water Elevation Contour (ft above MSL)

← 0.05 Approximate Ground-water Flow Direction and Gradient (ft/ft)

--- Remediation piping

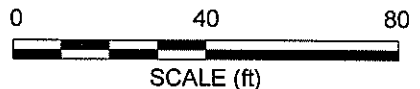

NOTE: SITE MAP ADAPTED FROM URS FIGURES. SITE DIMENSIONS AND FACILITY LOCATIONS NOT VERIFIED.

Table 1. Summary of Ground-Water Monitoring Data: Relative Water Elevations and Laboratory Analyses

Station #771, 899 Rincon Ave., Livermore, CA

Well and Sample Date	P/NP	Comments	TOC (feet msl)	Top of Screen (ft bgs)	Bottom of Screen (ft bgs)	DTW (feet bgs)	Water Level Elevation (feet msl)	Concentrations in (µg/L)					DO (mg/L)	pH
								GRO/TPHg	Benzene	Toluene	Ethyl-Benzene	Total Xylenes		
MW-1														
3/20/1995	--		451.73	32.00	41.00	24.5	427.23	90,000	1,800	1,100	1,000	5,600	--	--
6/2/1995	--		451.73	32.00	41.00	25.6	426.13	81,000	2,000	1,400	990	4,600	--	--
8/23/1995	--		451.73	32.00	41.00	29.04	422.69	44,000	2,400	1,900	670	3,800	<300	--
12/4/1995	--		451.73	32.00	41.00	31.31	420.42	22,000	870	660	390	2,200	--	--
2/20/1996	--		451.73	32.00	41.00	22.26	429.47	21,000	1,500	1,200	650	3,500	<300	--
5/15/1996	--		451.73	32.00	41.00	23.42	428.31	36,000	3,000	2,500	960	5,700	<250	--
8/13/1996	--		451.73	32.00	41.00	26.83	424.9	19,000	730	580	450	2,500	<200	--
11/13/1996	--		451.73	32.00	41.00	31.05	420.68	6,600	47	16	74	160	<30	--
3/26/1997	--		451.73	32.00	41.00	26.29	425.44	1,900	100	55	37	200	<30	--
5/15/1997	--		451.73	32.00	41.00	28.65	423.08	16,000	490	250	250	1,100	<120	--
8/26/1997	--		451.73	32.00	41.00	31.53	420.2	190	6.7	3	6.3	25	<3	--
11/5/1997	--		451.73	32.00	41.00	33.93	417.8	63	0.5	<0.5	0.8	2.4	29	--
2/18/1998	--		451.73	32.00	41.00	20.46	431.27	23,000	1,500	610	550	3,000	<120	--
5/20/1998	--		451.73	32.00	41.00	23.84	427.89	50,000	4,400	1,900	1,400	80,000	<300	--
7/30/1998	P		451.73	32.00	41.00	26.94	424.79	150	<0.5	<0.5	<0.5	1.6	<3	8.74
10/29/1998	NP		451.73	32.00	41.00	32.58	419.15	<50	<0.5	<0.5	<0.5	1.8	<3	2.0
3/16/1999	P		451.73	32.00	41.00	26.2	425.53	3,200	160	32	89	390	270	2.0
5/5/1999	P		451.73	32.00	41.00	27.57	424.16	3,600	140	46	76	290	170	11.65
8/26/1999	P		451.73	32.00	41.00	30.25	421.48	3,200	210	29	100	220	120	1.43
12/3/1999	NP		451.73	32.00	41.00	32.7	419.03	53	<0.5	<0.5	<0.5	1	<3	2.12
3/13/2000	P		451.73	32.00	41.00	24.45	427.28	<50	<0.5	<0.5	<0.5	<1	<3	5.81
6/20/2000	--	b	451.73	32.00	41.00	--	--	67.4	3.88	<0.500	1.78	1.48	<2.50	--
6/20/2000	P		451.73	32.00	41.00	27.79	423.94	356	40.1	7.17	11.9	22.7	<2.50	5.1
8/31/2000	--		451.73	32.00	41.00	30.35	421.38	--	--	--	--	--	--	--
2/9/2001	--		451.73	32.00	41.00	30.95	420.78	--	--	--	--	--	--	--
9/17/2001	--		451.73	32.00	41.00	30.85	420.88	--	--	--	--	--	--	--
1/21/2002	--		451.73	32.00	41.00	30.61	421.12	--	--	--	--	--	--	--
7/19/2002	--		451.73	32.00	41.00	31.55	420.18	--	--	--	--	--	--	--
1/15/2003	--		451.73	32.00	41.00	22.99	428.74	--	--	--	--	--	--	--
7/9/2003	--		451.73	32.00	41.00	30.35	421.38	--	--	--	--	--	--	--
02/19/2004	--		451.73	32.00	41.00	26.24	425.49	--	--	--	--	--	--	--

Table 1. Summary of Ground-Water Monitoring Data: Relative Water Elevations and Laboratory Analyses

Station #771, 899 Rincon Ave., Livermore, CA

Well and Sample Date	P/NP	Comments	TOC (feet msl)	Top of Screen (ft bgs)	Bottom of Screen (ft bgs)	DTW (feet bgs)	Water Level Elevation (feet msl)	Concentrations in (µg/L)						DO (mg/L)	pH
								GRO/TPHg	Benzene	Toluene	Ethyl-Benzene	Total Xylenes	MTBE		
MW-1 Cont.															
08/04/2004	--		454.23	32.00	41.00	26.36	427.87	--	--	--	--	--	--	--	--
01/18/2005	--		454.23	32.00	41.00	24.47	429.76	--	--	--	--	--	--	--	--
07/15/2005	--		454.23	32.00	41.00	29.44	424.79	--	--	--	--	--	--	--	--
01/10/2006	--		454.23	32.00	41.00	22.58	431.65	--	--	--	--	--	--	--	--
7/21/2006	--		454.23	32.00	41.00	20.73	433.50	--	--	--	--	--	--	--	--
MW-2															
3/20/1995	--		449.49	30.00	38.00	20.27	429.22	54,000	2,600	1,600	1,200	7,600	--	--	--
6/2/1995	--		449.49	30.00	38.00	22.32	427.17	37,000	2,200	800	980	4,800	--	--	--
8/23/1995	--		449.49	30.00	38.00	25.69	423.8	65,000	1,100	310	840	3,000	<500	--	--
12/4/1995	--		449.49	30.00	38.00	28.52	420.97	19,000	680	150	410	1,600	--	--	--
2/20/1996	--		449.49	30.00	38.00	19	430.49	22,000	1,200	240	590	2,200	<300	--	--
5/15/1996	--		449.49	30.00	38.00	20.03	429.46	25,000	1,200	240	610	2,100	<300	--	--
8/13/1996	--		449.49	30.00	38.00	24.44	425.05	19,000	640	110	420	1,200	<300	--	--
11/13/1996	--		449.49	30.00	38.00	28.42	421.07	15,000	260	52	220	640	<200	--	--
3/26/1997	--		449.49	30.00	38.00	22.98	426.51	17,000	580	120	360	980	<120	--	--
5/15/1997	--		449.49	30.00	38.00	25.4	424.09	18,000	420	63	340	730	<120	--	--
8/26/1997	--		449.49	30.00	38.00	28.38	421.11	5,300	210	26	140	270	<120	--	--
11/5/1997	--		449.49	30.00	38.00	31.93	417.56	560	42	2.6	7	9	<40	--	--
2/18/1998	--		449.49	30.00	38.00	16.87	432.62	18,000	710	120	480	1,100	130	--	--
5/20/1998	--		449.49	30.00	38.00	20.29	429.2	16,000	480	72	440	1,100	<120	--	--
7/30/1998	P		449.49	30.00	38.00	23.51	425.98	9,700	240	33	210	490	<120	9.21	--
10/29/1998	NP		449.49	30.00	38.00	30.08	419.41	58	<0.5	<0.5	<0.5	1.2	<3	1.0	--
3/16/1999	P		449.49	30.00	38.00	23.22	426.27	4,700	120	13	90	220	60	2.0	--
5/5/1999	P		449.49	30.00	38.00	24.05	425.44	5,500	58	7.1	58	98	17	9.09	--
8/26/1999	P		449.49	30.00	38.00	26.44	423.05	3,700	55	11	60	64	26	1.9	--
12/3/1999	NP		449.49	30.00	38.00	30.15	419.34	130	<0.5	<0.5	0.7	1.8	<3	1.96	--
3/13/2000	P		449.49	30.00	38.00	20.68	428.81	<50	<0.5	<0.5	<0.5	<1	<3	--	--
6/20/2000	P		449.49	30.00	38.00	23.08	426.41	226	2.2	<0.500	4.83	7.88	<2.50	4.9	--
8/31/2000	P		449.49	30.00	38.00	26.71	422.78	87.1	1.78	<0.500	1.33	1.15	<2.50	1.59	--
2/9/2001	--		449.49	30.00	38.00	29.65	419.84	--	--	--	--	--	--	--	--

Table 1. Summary of Ground-Water Monitoring Data: Relative Water Elevations and Laboratory Analyses

Station #771, 899 Rincon Ave., Livermore, CA

Well and Sample Date	P/NP	Comments	TOC (feet msl)	Top of Screen (ft bgs)	Bottom of Screen (ft bgs)	Water Level		Concentrations in (µg/L)						DO (mg/L)	pH
						DTW (feet bgs)	Elevation (feet msl)	GRO/TPHg	Benzene	Toluene	Ethyl-Benzene	Total Xylenes	MTBE		
MW-2 Cont.															
9/17/2001	P		449.49	30.00	38.00	27.62	421.87	3,100	300	12	8.8	18	120	1.7	--
1/21/2002	--		449.49	30.00	38.00	27.09	422.4	--	--	--	--	--	--	--	--
7/19/2002	P	a	449.49	30.00	38.00	27.82	421.67	4,700	280	13	120	19	16	0.8	7.4
1/15/2003	--		449.49	30.00	38.00	22.18	427.31	--	--	--	--	--	--	--	--
7/9/2003	--		449.49	30.00	38.00	26.4	423.09	3,900	170	<5.0	100	19	39	2.5	7.0
02/19/2004	--		449.49	30.00	38.00	23.85	425.64	--	--	--	--	--	--	--	--
08/04/2004	P		452.05	30.00	38.00	24.71	427.34	5,400	650	21	160	56	78	0.8	7.2
01/18/2005	--		452.05	30.00	38.00	20.86	431.19	--	--	--	--	--	--	--	--
07/15/2005	P		452.05	30.00	38.00	25.92	426.13	5,200	160	5.3	56	10	46	3.1	6.9
01/10/2006	--		452.05	30.00	38.00	19.25	432.80	--	--	--	--	--	--	--	--
7/21/2006	P		452.05	30.00	38.00	25.73	426.32	120	0.90	<0.50	<0.50	<0.50	<0.50	6.08	8.3
MW-3															
3/20/1995	--		450.28	32.00	40.00	22.19	428.09	94	<0.5	<0.5	<0.5	<0.5	--	--	--
6/2/1995	--		450.28	32.00	40.00	23.28	427	72	<0.5	<0.5	<0.5	<0.5	--	--	--
8/23/1995	--		450.28	32.00	40.00	26.55	423.73	98	<0.5	<0.5	<0.6	0.5	<3	--	--
12/4/1995	--		450.28	32.00	40.00	29.52	420.76	<50	<0.5	<0.5	<0.5	<0.5	--	--	--
2/20/1996	--		450.28	32.00	40.00	19.83	430.45	130	<0.5	<0.5	<0.5	<0.5	<3	--	--
5/15/1996	--		450.28	32.00	40.00	21.03	429.25	120	<0.5	<0.5	<0.5	<0.5	<0.5	--	--
8/13/1996	--		450.28	32.00	40.00	25.67	424.61	<50	<0.5	<0.5	<0.5	<0.5	<3	--	--
11/13/1996	--		450.28	32.00	40.00	21.57	428.71	<50	<0.5	<0.5	<0.5	<0.5	<3	--	--
3/26/1997	--		450.28	32.00	40.00	24.15	426.13	<50	1.1	<0.5	<0.5	<0.5	<3	--	--
5/15/1997	--		450.28	32.00	40.00	26.85	423.43	<50	<0.5	<0.5	<0.5	<0.5	<3	--	--
8/26/1997	--		450.28	32.00	40.00	30.07	420.21	<50	<0.5	<0.5	<0.5	<0.5	<3	--	--
11/5/1997	--		450.28	32.00	40.00	32.46	417.82	<50	<0.5	0.7	<0.5	<0.5	<3	--	--
2/18/1998	--		450.28	32.00	40.00	17.82	432.46	<50	<0.5	<0.5	<0.5	<0.5	<3	--	--
5/20/1998	--		450.28	32.00	40.00	21.41	428.87	<50	<0.5	<0.5	<0.5	<0.5	<3	--	--
7/30/1998	P		450.28	32.00	40.00	26.41	423.87	<50	<0.5	<0.5	<0.5	<0.5	<3	9.56	--
10/29/1998	P		450.28	32.00	40.00	31.33	418.95	<50	<0.5	<0.5	<0.5	<0.5	<3	1.0	--
3/16/1999	P		450.28	32.00	40.00	24.61	425.67	<50	<0.5	<0.5	<0.5	<0.5	<3	1.0	--
5/5/1999	P		450.28	32.00	40.00	25.75	424.53	140	<0.5	<0.5	0.6	<0.5	<3	4.43	--

Table I. Summary of Ground-Water Monitoring Data: Relative Water Elevations and Laboratory Analyses
Station #771, 899 Rincon Ave., Livermore, CA

Well and Sample Date	P/NP	Comments	TOC (feet msl)	Top of Screen (ft bgs)	Bottom of Screen (ft bgs)	Water Level		Concentrations in (µg/L)						DO (mg/L)	pH
						DTW (feet bgs)	Elevation (feet msl)	GRO/ TPHg	Benzene	Toluene	Ethyl- Benzene	Total Xylenes	MTBE		
MW-3 Cont.															
8/26/1999	P		450.28	32.00	40.00	28.49	421.79	80	0.6	0.6	0.6	1	<3	1.69	--
12/3/1999	P		450.28	32.00	40.00	31.45	418.83	<50	<0.5	<0.5	<0.5	<1	<3	2.26	--
3/13/2000	P		450.28	32.00	40.00	22.18	428.1	<50	<0.5	<0.5	<0.5	<1	<3	4.41	--
6/20/2000	P		450.28	32.00	40.00	26.03	424.25	<50.0	<0.500	<0.500	<0.500	<0.500	<2.50	2.3	--
8/31/2000	--		450.28	32.00	40.00	28.75	421.53	--	--	--	--	--	--	--	--
2/9/2001	--		450.28	32.00	40.00	31.04	419.24	--	--	--	--	--	--	--	--
9/17/2001	--		450.28	32.00	40.00	29.04	421.24	--	--	--	--	--	--	--	--
1/21/2002	--		450.28	32.00	40.00	28.81	421.47	--	--	--	--	--	--	--	--
7/19/2002	--		450.28	32.00	40.00	28.92	421.36	--	--	--	--	--	--	--	--
1/15/2003	--		450.28	32.00	40.00	22.88	427.4	--	--	--	--	--	--	--	--
7/9/2003	--		450.28	32.00	40.00	28	422.28	--	--	--	--	--	--	--	--
02/19/2004	--		450.28	32.00	40.00	25.29	424.99	--	--	--	--	--	--	--	--
08/04/2004	--		452.75	32.00	40.00	27.40	425.35	--	--	--	--	--	--	--	--
01/18/2005	--		452.75	32.00	40.00	22.76	429.99	--	--	--	--	--	--	--	--
07/15/2005	--		452.75	32.00	40.00	25.95	426.80	--	--	--	--	--	--	--	--
01/10/2006	--		452.75	32.00	40.00	21.18	431.57	--	--	--	--	--	--	--	--
7/21/2006	--		452.75	32.00	40.00	25.73	427.02	--	--	--	--	--	--	--	--
MW-4															
3/20/1995	--		451.09	26.00	42.00	22.68	428.41	12,000	1,000	100	450	700	--	--	--
6/2/1995	--		451.09	26.00	42.00	24.41	426.68	9,000	850	56	380	430	--	--	--
8/23/1995	--		451.09	26.00	42.00	27.72	423.37	5,300	400	25	240	170	<100	--	--
12/4/1995	--		451.09	26.00	42.00	29.85	421.24	6,700	100	<10	90	38	--	--	--
2/20/1996	--		451.09	26.00	42.00	21.16	429.93	7,000	360	22	180	160	<70	--	--
5/15/1996	--		451.09	26.00	42.00	22.18	428.91	--	--	--	--	--	--	--	--
8/13/1996	--		451.09	26.00	42.00	26.2	424.89	--	--	--	--	--	--	--	--
11/13/1996	--		451.09	26.00	42.00	29.72	421.37	--	--	--	--	--	--	--	--
3/26/1997	--		451.09	26.00	42.00	21.86	429.23	8,900	390	33	200	250	<70	--	--
5/15/1997	--		451.09	26.00	42.00	26.92	424.17	--	--	--	--	--	--	--	--
8/26/1997	--		451.09	26.00	42.00	29.3	421.79	--	--	--	--	--	--	--	--
11/5/1997	--		451.09	26.00	42.00	32.14	418.95	--	--	--	--	--	--	--	--

Table I. Summary of Ground-Water Monitoring Data: Relative Water Elevations and Laboratory Analyses
Station #771, 899 Rincon Ave., Livermore, CA

Well and Sample Date	P/NP	Comments	TOC (feet msl)	Top of Screen (ft bgs)	Bottom of Screen (ft bgs)	DTW (feet bgs)	Water Level Elevation (feet msl)	Concentrations in (µg/L)						DO (mg/L)	pH
								GRO/ TPHg	Benzene	Toluene	Ethyl- Benzene	Total Xylenes	MTBE		
MW-4 Cont.															
2/18/1998	--		451.09	26.00	42.00	19.3	431.79	5,300	220	19	160	130	120	--	--
5/20/1998	--		451.09	26.00	42.00	22.4	428.69	--	--	--	--	--	--	--	--
7/30/1998	--		451.09	26.00	42.00	25.74	425.35	--	--	--	--	--	--	--	--
10/29/1998	--		451.09	26.00	42.00	31.26	419.83	--	--	--	--	--	--	--	--
3/16/1999	P		451.09	26.00	42.00	25.05	426.04	1,900	49	<5	43	<5	82	1.5	--
5/5/1999	--		451.09	26.00	42.00	26.15	424.94	--	--	--	--	--	--	--	--
8/26/1999	--		451.09	26.00	42.00	28.6	422.49	--	--	--	--	--	--	1.43	--
12/3/1999	--		451.09	26.00	42.00	31.53	419.56	--	--	--	--	--	--	--	--
3/13/2000	P		451.09	26.00	42.00	23.61	427.48	<50	<0.5	<0.5	<0.5	<1	<3	3.82	--
6/20/2000	--		451.09	26.00	42.00	26.38	424.71	--	--	--	--	--	--	0.4	--
8/31/2000	NP		451.09	26.00	42.00	29.55	421.54	<50.0	<0.500	<0.500	<0.500	<0.500	<2.50	1.04	--
2/9/2001	NP		451.09	26.00	42.00	30.3	420.79	<50.0	<0.500	<0.500	<0.500	<0.500	<2.50	1.39	--
9/17/2001	NP		451.09	26.00	42.00	29.9	421.19	3,400	51	<5.0	16	23	360	0.92	--
1/21/2002	NP		451.09	26.00	42.00	29.51	421.58	1,900	140	12	27	48	300	1.03	--
7/19/2002	NP	a	451.09	26.00	42.00	30.77	420.32	2,700	150	9.9	<5.0	<5.0	130	1.0	7.3
1/15/2003	--	a	451.09	26.00	42.00	23.56	427.53	4,800	150	5.3	28	46	150	1.3	7.0
7/9/2003	--		451.09	26.00	42.00	29.5	421.59	3,000	210	9.4	6	20	150	2.0	6.9
02/19/2004	P	c	451.09	26.00	42.00	26.35	424.74	4,800	270	11	25	19	180	1.8	6.2
08/04/2004	NP		453.80	26.00	42.00	26.48	427.32	4,200	410	13	49	59	300	0.7	6.7
01/18/2005	P		453.80	26.00	42.00	23.15	430.65	4,500	250	9.5	62	22	160	1.2	6.9
07/15/2005	NP		453.80	26.00	42.00	28.13	425.67	3,500	230	6.1	19	15	230	0.5	7.0
01/10/2006	P		453.80	26.00	42.00	21.49	432.31	5,500	250	7.6	37	25	190	1.3	7.1
7/21/2006	NP		453.80	26.00	42.00	28.88	424.92	66	0.60	<0.50	0.52	0.82	3.1	4.75	8.3
MW-5															
3/20/1995	--		451.40	31.50	41.00	23.2	428.2	26,000	1,300	180	890	2,900	--	--	--
6/2/1995	--		451.40	31.50	41.00	24.8	426.6	39,000	940	160	740	1,900	--	--	--
8/23/1995	--		451.40	31.50	41.00	28.1	423.3	14,000	490	74	250	890	<300	--	--
12/4/1995	--		451.40	31.50	41.00	29.83	421.57	7,600	230	13	61	80	--	--	--
2/20/1996	--		451.40	31.50	41.00	21.63	429.77	4,300	220	12	45	130	<50	--	--
5/15/1996	--		451.40	31.50	41.00	22.87	428.53	2,200	380	17	58	84	<40	--	--

Table 1. Summary of Ground-Water Monitoring Data: Relative Water Elevations and Laboratory Analyses

Station #771, 899 Rincon Ave., Livermore, CA

Well and Sample Date	P/NP	Comments	TOC (feet msl)	Top of Screen (ft bgs)	Bottom of Screen (ft bgs)	Water Level DTW (feet bgs)	Water Level Elevation (feet msl)	Concentrations in (µg/L)					DO (mg/L)	pH	
								GRO/TPHg	Benzene	Toluene	Ethyl-Benzene	Total Xylenes			MTBE
MW-5 Cont.															
8/13/1996	--		451.40	31.50	41.00	26.48	424.92	1,700	150	16	24	35	47	--	--
11/13/1996	--		451.40	31.50	41.00	29.68	421.72	850	150	11	19	37	66	--	--
3/26/1997	--		451.40	31.50	41.00	25.14	426.26	2,400	440	21	79	210	68	--	--
5/15/1997	--		451.40	31.50	41.00	27.38	424.02	3,900	510	19	140	240	48	--	--
8/26/1997	--		451.40	31.50	41.00	29.89	421.51	76	4.9	<0.5	1.5	2	9	--	--
11/5/1997	--		451.40	31.50	41.00	32.57	418.83	63	0.8	<0.5	<0.5	1.2	34	--	--
2/18/1998	--		451.40	31.50	41.00	19.99	431.41	6,200	630	70	320	640	320	--	--
5/20/1998	--		451.40	31.50	41.00	23.21	428.19	2,300	340	21	110	140	62	--	--
7/30/1998	P		451.40	31.50	41.00	26.19	425.21	<50	0.8	<0.5	0.6	0.9	<3	8.83	--
10/29/1998	NP		451.40	31.50	41.00	31.92	419.48	<50	<0.5	<0.5	<0.5	<0.5	<3	2.0	--
3/16/1999	P		451.40	31.50	41.00	25.8	425.6	1,300	170	8	59	65	120	2.0	--
5/5/1999	P		451.40	31.50	41.00	27.09	424.31	320	31	1.1	13	13	19	12.09	--
8/26/1999	P		451.40	31.50	41.00	29.67	421.73	260	13	1.7	4.2	6.3	150	1.31	--
12/3/1999	--	d	451.40	31.50	41.00	--	--	--	--	--	--	--	--	--	--
3/13/2000	P		451.40	31.50	41.00	24.51	426.89	<50	<0.5	<0.5	<0.5	<1	<3	4.41	--
6/20/2000	P		451.40	31.50	41.00	27.37	424.03	60.8	4.84	<0.500	1.9	1.59	<2.50	5.3	--
8/31/2000	P		451.40	31.50	41.00	30.21	421.19	<50.0	1.18	<0.500	<0.500	<0.500	3.83	0.97	--
2/9/2001	--		451.40	31.50	41.00	30.19	421.21	--	--	--	--	--	--	--	--
9/17/2001	P		451.40	31.50	41.00	30.71	420.69	2,700	120	10	90	77	330	0.81	--
1/21/2002	--		451.40	31.50	41.00	30.4	421	--	--	--	--	--	--	--	--
7/19/2002	P	a	451.40	31.50	41.00	31.93	419.47	1,600	170	7	120	<5.0	180	1.7	7.2
1/15/2003	--		451.40	31.50	41.00	23.12	428.28	--	--	--	--	--	--	--	--
7/9/2003	--		451.40	31.50	41.00	30.95	420.45	2,000	160	5.7	67	27	260	1.5	6.9
02/19/2004	--		451.40	31.50	41.00	26.73	424.67	--	--	--	--	--	--	--	--
08/04/2004	P		453.52	31.50	41.00	26.61	426.91	2,100	250	5.3	73	22	250	2.7	7.0
01/18/2005	--		453.52	31.50	41.00	24.10	429.42	--	--	--	--	--	--	--	--
07/15/2005	P		453.52	31.50	41.00	29.27	424.25	1,600	61	<5.0	8.7	<5.0	270	2.1	6.9
01/10/2006	--		453.52	31.50	41.00	22.19	431.33	--	--	--	--	--	--	--	--
7/21/2006	P		453.52	31.50	41.00	30.36	423.16	2,100	29	<5.0	7.5	11	14	2.98	7.1
MW-6															

Table I. Summary of Ground-Water Monitoring Data: Relative Water Elevations and Laboratory Analyses

Station #771, 899 Rincon Ave., Livermore, CA

Well and Sample Date	P/NP	Comments	TOC (feet msl)	Top of Screen (ft bgs)	Bottom of Screen (ft bgs)	DTW (feet bgs)	Water Level Elevation (feet msl)	Concentrations in (µg/L)					DO (mg/L)	pH	
								GRO/TPHg	Benzene	Toluene	Ethyl-Benzene	Total Xylenes			MTBE
MW-6 Cont.															
3/20/1995	--		451.37	32.00	42.00	25.19	426.18	2,600	210	87	82	140	--	--	--
6/2/1995	--		451.37	32.00	42.00	25.75	425.62	1,600	55	7.9	40	26	--	--	--
8/23/1995	--		451.37	32.00	42.00	29.53	421.84	1,400	42	2.5	36	13	<20	--	--
12/4/1995	--		451.37	32.00	42.00	32.28	419.09	2,500	52	5.8	59	13	--	--	--
2/20/1996	--		451.37	32.00	42.00	22.27	429.1	2,500	120	16	73	12	<30	--	--
5/15/1996	--		451.37	32.00	42.00	23.86	427.51	2,000	71	6.4	47	25	<15	--	--
8/13/1996	--		451.37	32.00	42.00	28.55	422.82	3,800	91	8.2	69	25	<20	--	--
11/13/1996	--		451.37	32.00	42.00	32.04	419.33	1,900	55	3.3	55	8.5	16	--	--
3/26/1997	--		451.37	32.00	42.00	26.84	424.53	1,800	51	5	32	15	<30	--	--
5/15/1997	--		451.37	32.00	42.00	29.58	421.79	2,400	46	3	29	9	<12	--	--
8/26/1997	--		451.37	32.00	42.00	32.67	418.7	1,400	61	6	33	10	<12	--	--
11/5/1997	--		451.37	32.00	42.00	34.62	416.75	690	29	2.7	18	3.4	9	--	--
2/18/1998	--		451.37	32.00	42.00	20.09	431.28	1,800	74	5	24	12	19	--	--
5/20/1998	--		451.37	32.00	42.00	24.05	427.32	1,900	280	4	31	16	9	--	--
7/30/1998	P		451.37	32.00	42.00	28.72	422.65	2,300	110	7	36	20	<15	--	--
10/29/1998	P		451.37	32.00	42.00	32.77	418.6	2,500	14	13	17	12	<12	1.0	--
3/16/1999	P		451.37	32.00	42.00	26.45	424.92	1,200	65	4	27	13	18	0.5	--
5/5/1999	P		451.37	32.00	42.00	27.86	423.51	2,200	53	4	26	6	25	5.59	--
8/26/1999	P		451.37	32.00	42.00	30.49	420.88	1,100	11	6	10	4	13	2.35	--
12/3/1999	P		451.37	32.00	42.00	32.35	419.02	370	<0.5	<0.5	0.8	<1	4	2.36	--
3/13/2000	P		451.37	32.00	42.00	28.36	423.01	54	2.1	0.5	0.9	1.4	<3	4.22	--
6/20/2000	P		451.37	32.00	42.00	28.35	423.02	195	1.83	<0.500	0.528	<0.500	<2.50	3.5	--
8/31/2000	P		451.37	32.00	42.00	30.2	421.17	276	3.52	0.788	1.15	0.621	8.73	7.0	--
2/9/2001	--	b	451.37	32.00	42.00	--	--	222	4.49	2.73	0.579	0.523	57.1	--	--
2/9/2001	P		451.37	32.00	42.00	30.7	420.67	253	5.44	2.93	0.924	0.977	48.9	0.59	--
9/17/2001	--	b	451.37	32.00	42.00	--	--	<50	<0.50	<0.50	<0.50	<0.50	<2.5	--	--
9/17/2001	P		451.37	32.00	42.00	30.94	420.43	<50	<0.50	<0.50	<0.50	<0.50	<2.5	2.79	--
1/21/2002	P		451.37	32.00	42.00	30.55	420.82	<50	<0.50	<0.50	<0.50	<0.50	<5.0	1.9	--
7/19/2002	P	a	451.37	32.00	42.00	30.27	421.10	60	2	<0.50	<0.50	<0.50	<0.50	3.5	7.9
1/15/2003	--	a	451.37	32.00	42.00	22.86	428.51	83	9.1	<0.50	3.4	4.6	1	2.5	7.2
7/9/2003	P		451.37	32.00	42.00	29.41	421.96	110	<0.50	<0.50	<0.50	<0.50	0.98	2.6	7.1

Table 1. Summary of Ground-Water Monitoring Data: Relative Water Elevations and Laboratory Analyses
Station #771, 899 Rincon Ave., Livermore, CA

Well and Sample Date	P/NP	Comments	TOC (feet msl)	Top of Screen (ft bgs)	Bottom of Screen (ft bgs)	DTW (feet bgs)	Water Level Elevation (feet msl)	Concentrations in (µg/L)						DO (mg/L)	pH
								GRO/ TPHg	Benzene	Toluene	Ethyl- Benzene	Total Xylenes	MTBE		
MW-6 Cont.															
02/19/2004	--		451.37	32.00	42.00	43.25	408.12	--	--	--	--	--	--	--	--
08/04/2004	P		453.83	32.00	42.00	27.71	426.12	540	36	3.8	17	24	5.2	3.5	7.1
01/18/2005	--		453.83	32.00	42.00	24.56	429.27	--	--	--	--	--	--	--	--
07/15/2005	P		453.83	32.00	42.00	27.61	426.22	4,600	210	44	150	670	32	3.5	7.1
01/10/2006	--		453.83	32.00	42.00	23.75	430.08	--	--	--	--	--	--	--	--
7/21/2006	P		453.83	32.00	42.00	27.96	425.87	260	<0.50	<0.50	<0.50	0.86	5.1	2.60	7.2
MW-7															
3/20/1995	--		450.33	30.00	40.00	22.07	428.26	31,000	2,300	400	620	2,900	--	--	--
6/2/1995	--		450.33	30.00	40.00	23.42	426.91	40,000	1,400	280	610	2,400	--	--	--
8/23/1995	--		450.33	30.00	40.00	27.13	423.2	25,000	1,400	200	600	1,600	350	--	--
12/4/1995	--		450.33	30.00	40.00	29.45	420.88	23,000	1,100	74	490	720	--	--	--
2/20/1996	--		450.33	30.00	40.00	20.25	430.08	39,000	1,200	140	640	1,800	<400	--	--
5/15/1996	--		450.33	30.00	40.00	21.38	428.95	--	--	--	--	--	--	--	--
8/13/1996	--		450.33	30.00	40.00	25.52	424.81	--	--	--	--	--	--	--	--
11/13/1996	--		450.33	30.00	40.00	29.38	420.95	--	--	--	--	--	--	--	--
3/26/1997	--		450.33	30.00	40.00	24.36	425.97	35,000	1,100	180	460	1,700	<300	--	--
5/15/1997	--		450.33	30.00	40.00	26.9	423.43	--	--	--	--	--	--	--	--
8/26/1997	--		450.33	30.00	40.00	30.21	420.12	--	--	--	--	--	--	--	--
11/5/1997	--		450.33	30.00	40.00	32.49	417.84	--	--	--	--	--	--	--	--
2/18/1998	--		450.33	30.00	40.00	18.1	432.23	19,000	1,100	120	460	1,700	240	--	--
5/20/1998	--		450.33	30.00	40.00	21.68	428.65	--	--	--	--	--	--	--	--
7/30/1998	--		450.33	30.00	40.00	26.07	424.26	--	--	--	--	--	--	--	--
10/29/1998	--		450.33	30.00	40.00	31.13	419.2	--	--	--	--	--	--	--	--
3/16/1999	P		450.33	30.00	40.00	24.45	425.88	8,600	430	51	200	680	<120	1.5	--
5/5/1999	--		450.33	30.00	40.00	25.84	424.49	--	--	--	--	--	--	--	--
8/26/1999	--		450.33	30.00	40.00	28.28	422.05	--	--	--	--	--	--	1.51	--
12/3/1999	--		450.33	30.00	40.00	31.57	418.76	--	--	--	--	--	--	--	--
3/13/2000	--	d	450.33	30.00	40.00	--	--	--	--	--	--	--	--	--	--
6/20/2000	--		450.33	30.00	40.00	25.91	424.42	--	--	--	--	--	--	5.4	--
8/31/2000	--		450.33	30.00	40.00	28.4	421.93	8,410	344	58.9	276	581	202	0.09	--

Table 1. Summary of Ground-Water Monitoring Data: Relative Water Elevations and Laboratory Analyses

Station #771, 899 Rincon Ave., Livermore, CA

Well and Sample Date	P/NP	Comments	TOC (feet msl)	Top of Screen (ft bgs)	Bottom of Screen (ft bgs)	Water Level		Concentrations in (µg/L)					DO (mg/L)	pH	
						DTW (feet bgs)	Elevation (feet msl)	GRO/TPHg	Benzene	Toluene	Ethyl-Benzene	Total Xylenes			MTBE
MW-7 Cont.															
2/9/2001	--		450.33	30.00	40.00	30.04	420.29	2,030	203	12	17.9	49.4	128	1.55	--
9/17/2001	P		450.33	30.00	40.00	29.03	421.3	4,800	200	14	9.9	27	160	0.29	--
1/21/2002	--	b	450.33	30.00	40.00	--	--	2,600	280	17	41	50	97	--	--
1/21/2002	P		450.33	30.00	40.00	28.98	421.35	4,200	350	20	52	63	99	0.81	--
7/19/2002	P	a	450.33	30.00	40.00	28.7	421.63	5,700	630	31	330	160	64	0.7	7.3
1/15/2003	--	a	450.33	30.00	40.00	21.91	428.42	12,000	470	19	340	310	91	1.5	7.0
7/9/2003	P		450.33	30.00	40.00	27.88	422.45	6,700	590	23	280	92	110	1.0	6.9
02/19/2004	P	c	450.33	30.00	40.00	25.12	425.21	8,900	670	24	470	120	100	0.8	6.6
08/04/2004	P		452.70	30.00	40.00	25.92	426.78	9,100	930	29	460	130	140	0.6	7.2
01/18/2005	P		452.70	30.00	40.00	22.31	430.39	16,000	770	33	590	220	87	1.0	6.9
07/15/2005	P		452.70	30.00	40.00	27.20	425.50	12,000	1,000	38	490	220	150	1.5	6.9
01/10/2006	P		452.70	30.00	40.00	20.61	432.09	13,000	1,200	50	760	330	120	0.8	7.1
7/21/2006	P		452.70	30.00	40.00	28.10	424.60	8,000	110	<50	380	180	54	3.20	7.8
MW-8															
3/20/1995	--		449.43	27.50	42.50	24.75	424.68	<50	<0.5	<0.5	<0.5	<0.5	--	--	--
6/2/1995	--		449.43	27.50	42.50	24.95	424.48	--	--	--	--	--	--	--	--
8/23/1995	--		449.43	27.50	42.50	30.94	418.49	<50	<0.5	<0.5	<0.5	<0.5	<3	--	--
12/4/1995	--		449.43	27.50	42.50	31.99	417.44	--	--	--	--	--	--	--	--
2/20/1996	--		449.43	27.50	42.50	21.13	428.3	<50	<0.5	<0.5	<0.5	<0.5	<3	--	--
5/15/1996	--		449.43	27.50	42.50	21.96	427.47	--	--	--	--	--	--	--	--
8/13/1996	--		449.43	27.50	42.50	30.2	419.23	<50	<0.5	<0.5	<0.5	<0.5	<3	--	--
11/13/1996	--		449.43	27.50	42.50	33.24	416.19	--	--	--	--	--	--	--	--
3/26/1997	--		449.43	27.50	42.50	26.85	422.58	<50	<0.5	<0.5	<0.5	<0.5	<3	--	--
5/15/1997	--		449.43	27.50	42.50	29.69	419.74	--	--	--	--	--	--	--	--
8/26/1997	--		449.43	27.50	42.50	34	415.43	<50	<0.5	<0.5	<0.5	<0.5	<3	--	--
11/5/1997	--		449.43	27.50	42.50	35.94	413.49	--	--	--	--	--	--	--	--
2/18/1998	--		449.43	27.50	42.50	18.18	431.25	<50	0.6	0.6	<0.5	1.1	<3	--	--
5/20/1998	--		449.43	27.50	42.50	22.85	426.58	--	--	--	--	--	--	--	--
7/30/1998	NP		449.43	27.50	42.50	30.31	419.12	<50	<0.5	<0.5	<0.5	<0.5	<3	8.21	--
10/29/1998	--		449.43	27.50	42.50	35.88	413.55	--	--	--	--	--	--	--	--

Table I. Summary of Ground-Water Monitoring Data: Relative Water Elevations and Laboratory Analyses

Station #771, 899 Rincon Ave., Livermore, CA

Well and Sample Date	P/NP	Comments	TOC (feet msl)	Top of Screen (ft bgs)	Bottom of Screen (ft bgs)	DTW (feet bgs)	Water Level Elevation (feet msl)	Concentrations in (µg/L)					DO (mg/L)	pH	
								GRO/ TPHg	Benzene	Toluene	Ethyl- Benzene	Total Xylenes			MTBE
MW-8 Cont.															
3/16/1999	NP		449.43	27.50	42.50	28.5	420.93	<50	<0.5	<0.5	<0.5	<0.5	<3	1.0	--
5/5/1999	--		449.43	27.50	42.50	29.76	419.67	--	--	--	--	--	--	--	--
8/26/1999	P		449.43	27.50	42.50	33.51	415.92	<50	<0.5	<0.5	<0.5	<0.5	<3	4.93	--
12/3/1999	--		449.43	27.50	42.50	35.83	413.6	--	--	--	--	--	--	--	--
3/13/2000	P		449.43	27.50	42.50	26.12	423.31	<50	<0.5	<0.5	<0.5	<1	<3	2.81	--
6/20/2000	--		449.43	27.50	42.50	30.91	418.52	--	--	--	--	--	--	5.8	--
8/31/2000	--		449.43	27.50	42.50	33.7	415.73	--	--	--	--	--	--	--	--
2/9/2001	--		449.43	27.50	42.50	30.9	418.53	--	--	--	--	--	--	--	--
9/17/2001	--		449.43	27.50	42.50	33.95	415.48	--	--	--	--	--	--	--	--
1/21/2002	--		449.43	27.50	42.50	33.71	415.72	--	--	--	--	--	--	--	--
7/19/2002	--		449.43	27.50	42.50	35.3	414.13	--	--	--	--	--	--	--	--
1/15/2003	--		449.43	27.50	42.50	27.1	422.33	--	--	--	--	--	--	--	--
7/9/2003	--		449.43	27.50	42.50	33.1	416.33	--	--	--	--	--	--	--	--
02/19/2004	--		449.43	27.50	42.50	28.92	420.51	--	--	--	--	--	--	--	--
08/04/2004	--		451.80	27.50	42.50	34.28	417.52	--	--	--	--	--	--	--	--
01/18/2005	--		451.80	27.50	42.50	26.76	425.04	--	--	--	--	--	--	--	--
07/15/2005	--		451.80	27.50	42.50	31.14	420.66	--	--	--	--	--	--	--	--
01/10/2006	--		451.80	27.50	42.50	22.88	428.92	--	--	--	--	--	--	--	--
7/21/2006	--		451.80	27.50	42.50	30.84	420.96	--	--	--	--	--	--	--	--
MW-9															
3/20/1995	--		449.21	29.50	39.50	19.11	430.1	<50	<0.5	<0.5	<0.5	<0.5	--	--	--
6/2/1995	--		449.21	29.50	39.50	21.23	427.98	--	--	--	--	--	--	--	--
8/23/1995	--		449.21	29.50	39.50	24.33	424.88	<50	<0.5	<0.5	<0.5	<0.5	<3	--	--
12/4/1995	--		449.21	29.50	39.50	27.9	421.31	--	--	--	--	--	--	--	--
2/20/1996	--		449.21	29.50	39.50	17.86	431.35	<50	<0.5	<0.5	<0.5	<0.5	<3	--	--
5/15/1996	--		449.21	29.50	39.50	18.69	430.52	--	--	--	--	--	--	--	--
8/13/1996	--		449.21	29.50	39.50	24.17	425.04	--	--	--	--	--	--	--	--
11/13/1996	--		449.21	29.50	39.50	28.01	421.2	--	--	--	--	--	--	--	--
3/26/1997	--		449.21	29.50	39.50	22.58	426.63	<50	<0.5	<0.5	<0.5	<0.5	<3	--	--
5/15/1997	--		449.21	29.50	39.50	25.12	424.09	--	--	--	--	--	--	--	--

Table 1. Summary of Ground-Water Monitoring Data: Relative Water Elevations and Laboratory Analyses

Station #771, 899 Rincon Ave., Livermore, CA

Well and Sample Date	P/NP	Comments	TOC (feet msl)	Top of Screen (ft bgs)	Bottom of Screen (ft bgs)	DTW (feet bgs)	Water Level Elevation (feet msl)	Concentrations in (µg/L)					DO (mg/L)	pH	
								GRO/TPHg	Benzene	Toluene	Ethyl-Benzene	Total Xylenes			MTBE
MW-9 Cont.															
8/26/1997	--		449.21	29.50	39.50	28.28	420.93	--	--	--	--	--	--	--	--
11/5/1997	--		449.21	29.50	39.50	31.18	418.03	--	--	--	--	--	--	--	--
2/18/1998	--		449.21	29.50	39.50	16.03	433.18	<50	0.6	0.5	<0.5	1	<3	--	--
5/20/1998	--		449.21	29.50	39.50	19.31	429.9	--	--	--	--	--	--	--	--
7/30/1998	--		449.21	29.50	39.50	24.9	424.31	--	--	--	--	--	--	--	--
10/29/1998	--		449.21	29.50	39.50	30.08	419.13	--	--	--	--	--	--	--	--
3/16/1999	P		449.21	29.50	39.50	22.68	426.53	<50	<0.5	<0.5	<0.5	<0.5	<3	1.0	--
5/5/1999	--		449.21	29.50	39.50	23.82	425.39	--	--	--	--	--	--	--	--
8/26/1999	--		449.21	29.50	39.50	26.57	422.64	--	--	--	--	--	--	5.08	--
12/3/1999	--	d	449.21	29.50	39.50	--	--	--	--	--	--	--	--	--	--
3/13/2000	P		449.21	29.50	39.50	25.62	423.59	<50	<0.5	<0.5	<0.5	<1	<3	5.43	--
6/20/2000	--		449.21	29.50	39.50	23.55	425.66	--	--	--	--	--	--	6.2	--
8/31/2000	--		449.21	29.50	39.50	27.39	421.82	--	--	--	--	--	--	--	--
2/9/2001	--		449.21	29.50	39.50	28.65	420.56	--	--	--	--	--	--	--	--
9/17/2001	--		449.21	29.50	39.50	27.51	421.7	--	--	--	--	--	--	--	--
1/21/2002	--		449.21	29.50	39.50	27.09	422.12	--	--	--	--	--	--	--	--
7/19/2002	--		449.21	29.50	39.50	27.06	422.15	--	--	--	--	--	--	--	--
1/15/2003	--		449.21	29.50	39.50	21.78	427.43	--	--	--	--	--	--	--	--
7/9/2003	--		449.21	29.50	39.50	26.18	423.03	--	--	--	--	--	--	--	--
02/19/2004	--		449.21	29.50	39.50	23.45	425.76	--	--	--	--	--	--	--	--
08/04/2004	--		451.63	29.50	39.50	29.24	422.39	--	--	--	--	--	--	--	--
01/18/2005	--		451.63	29.50	39.50	20.64	430.99	--	--	--	--	--	--	--	--
07/15/2005	--		451.63	29.50	39.50	25.72	425.91	--	--	--	--	--	--	--	--
01/10/2006	--		451.63	29.50	39.50	18.86	432.77	--	--	--	--	--	--	--	--
7/21/2006	--		451.63	29.50	39.50	25.58	426.05	--	--	--	--	--	--	--	--
MW-10															
3/20/1995	--		449.22	29.00	37.00	20.96	428.26	--	--	--	--	--	--	--	--
6/2/1995	--		449.22	29.00	37.00	22.15	427.07	--	--	--	--	--	--	--	--
8/23/1995	--		449.22	29.00	37.00	24.47	424.75	<50	<0.5	<0.5	<0.5	<0.5	<3	--	--
12/4/1995	--		449.22	29.00	37.00	26.97	422.25	--	--	--	--	--	--	--	--

Table 1. Summary of Ground-Water Monitoring Data: Relative Water Elevations and Laboratory Analyses

Station #771, 899 Rincon Ave., Livermore, CA

Well and Sample Date	P/NP	Comments	TOC (feet msl)	Top of Screen (ft bgs)	Bottom of Screen (ft bgs)	DTW (feet bgs)	Water Level Elevation (feet msl)	Concentrations in (µg/L)					DO (mg/L)	pH	
								GRO/TPHg	Benzene	Toluene	Ethyl-Benzene	Total Xylenes			MTBE
MW-10 Cont.															
2/20/1996	--		449.22	29.00	37.00	18.4	430.82	<50	<0.5	<0.5	<0.5	<0.5	<3	--	--
5/15/1996	--	d	449.22	29.00	37.00	--	--	--	--	--	--	--	--	--	--
8/13/1996	--		449.22	29.00	37.00	23.7	425.52	--	--	--	--	--	--	--	--
11/13/1996	--		449.22	29.00	37.00	27.15	422.07	--	--	--	--	--	--	--	--
3/26/1997	--		449.22	29.00	37.00	22.23	426.99	<50	<0.5	<0.5	<0.5	<0.5	<3	--	--
5/15/1997	--		449.22	29.00	37.00	24.57	424.65	--	--	--	--	--	--	--	--
8/26/1997	--		449.22	29.00	37.00	27.62	421.6	--	--	--	--	--	--	--	--
11/5/1997	--		449.22	29.00	37.00	30.79	418.43	--	--	--	--	--	--	--	--
2/18/1998	--	d	449.22	29.00	37.00	--	--	--	--	--	--	--	--	--	--
5/20/1998	--		449.22	29.00	37.00	--	--	--	--	--	--	--	--	--	--
7/30/1998	--		449.22	29.00	37.00	23.9	425.32	--	--	--	--	--	--	--	--
10/29/1998	--		449.22	29.00	37.00	30.55	418.67	--	--	--	--	--	--	--	--
3/16/1999	P		449.22	29.00	37.00	23.05	426.17	<50	<0.5	<0.5	<0.5	<0.5	<3	1.0	--
5/5/1999	--		449.22	29.00	37.00	24	425.22	--	--	--	--	--	--	--	--
8/26/1999	--		449.22	29.00	37.00	26.5	422.72	--	--	--	--	--	--	5.15	--
12/3/1999	--		449.22	29.00	37.00	30.8	418.42	--	--	--	--	--	--	--	--
3/13/2000	--	d	449.22	29.00	37.00	26.21	423.01	--	--	--	--	--	--	--	--
6/20/2000	--		449.22	29.00	37.00	23.52	425.7	--	--	--	--	--	--	5.5	--
8/31/2000	--		449.22	29.00	37.00	27.52	421.7	--	--	--	--	--	--	--	--
2/9/2001	--		449.22	29.00	37.00	28.71	420.51	--	--	--	--	--	--	--	--
9/17/2001	--		449.22	29.00	37.00	27.94	421.28	--	--	--	--	--	--	--	--
1/21/2002	--		449.22	29.00	37.00	27.44	421.78	--	--	--	--	--	--	--	--
7/19/2002	--		449.22	29.00	37.00	27.8	421.42	--	--	--	--	--	--	--	--
1/15/2003	--		449.22	29.00	37.00	23.09	426.13	--	--	--	--	--	--	--	--
7/9/2003	--		449.22	29.00	37.00	26.87	422.35	--	--	--	--	--	--	--	--
02/19/2004	--		449.22	29.00	37.00	23.39	425.83	--	--	--	--	--	--	--	--
01/18/2005	--		451.65	29.00	37.00	21.40	430.25	--	--	--	--	--	--	--	--
07/15/2005	--		451.65	29.00	37.00	25.37	426.28	--	--	--	--	--	--	--	--
01/10/2006	--		451.65	29.00	37.00	19.81	431.84	--	--	--	--	--	--	--	--
7/21/2006	--		451.65	29.00	37.00	25.16	426.49	--	--	--	--	--	--	--	--

Table 1. Summary of Ground-Water Monitoring Data: Relative Water Elevations and Laboratory Analyses

Station #771, 899 Rincon Ave., Livermore, CA

Well and Sample Date	P/NP	Comments	TOC (feet msl)	Bottom of Screen			Water Level Elevation (feet msl)	Concentrations in (µg/L)					DO (mg/L)	pH	
				Top of Screen (ft bgs)	Screen (ft bgs)	DTW (feet bgs)		GRO/TPHg	Benzene	Toluene	Ethyl-Benzene	Total Xylenes			MTBE
MW-11															
3/20/1995	--		448.02	29.00	39.00	25.02	423	<0.5	<0.5	<0.5	<0.5	<0.5	<0.5	--	--
6/2/1995	--		448.02	29.00	39.00	23.82	424.2	--	--	--	--	--	--	--	--
8/23/1995	--		448.02	29.00	39.00	30.15	417.87	<0.5	<0.5	<0.5	<0.5	<0.5	<0.5	<3	--
12/4/1995	--		448.02	29.00	39.00	31.63	416.39	--	--	--	--	--	--	--	--
2/20/1996	--		448.02	29.00	39.00	20.94	427.08	<0.5	<0.5	<0.5	<0.5	<0.5	<0.5	<3	--
5/15/1996	--		448.02	29.00	39.00	23.03	424.99	--	--	--	--	--	--	--	--
8/13/1996	--		448.02	29.00	39.00	29.19	418.83	<0.5	<0.5	<0.5	<0.5	<0.5	<0.5	<3	--
11/13/1996	--		448.02	29.00	39.00	31.96	416.06	--	--	--	--	--	--	--	--
3/26/1997	--		448.02	29.00	39.00	26.61	421.41	<0.5	<0.5	<0.5	<0.5	<0.5	<0.5	<3	--
5/15/1997	--		448.02	29.00	39.00	29.39	418.63	--	--	--	--	--	--	--	--
8/26/1997	--		448.02	29.00	39.00	33.47	414.55	<0.5	<0.5	<0.5	<0.5	<0.5	<0.5	<3	--
11/5/1997	--		448.02	29.00	39.00	35.12	412.9	--	--	--	--	--	--	--	--
2/18/1998	--		448.02	29.00	39.00	18.03	429.99	<0.5	<0.5	<0.5	<0.5	<0.5	<0.5	<3	--
5/20/1998	--		448.02	29.00	39.00	23	425.02	--	--	--	--	--	--	--	--
7/30/1998	P		448.02	29.00	39.00	29.3	418.72	<0.5	<0.5	<0.5	<0.5	<0.5	<0.5	<3	5.59
10/29/1998	--		448.02	29.00	39.00	34.47	413.55	--	--	--	--	--	--	--	--
3/16/1999	P		448.02	29.00	39.00	27.88	420.14	<0.5	<0.5	<0.5	<0.5	<0.5	<0.5	<3	1.0
5/5/1999	--		448.02	29.00	39.00	26.85	421.17	--	--	--	--	--	--	--	--
8/26/1999	P		448.02	29.00	39.00	32.74	415.28	<0.5	<0.5	<0.5	<0.5	<0.5	<0.5	<3	4.59
12/3/1999	--		448.02	29.00	39.00	34.7	413.32	--	--	--	--	--	--	--	--
3/13/2000	P		448.02	29.00	39.00	25.94	422.08	<0.5	<0.5	<0.5	<0.5	<0.5	<0.5	<3	3.21
6/20/2000	--		448.02	29.00	39.00	30.4	417.62	--	--	--	--	--	--	--	3.3
8/31/2000	NP		448.02	29.00	39.00	32.68	415.34	<0.5	<0.5	<0.5	<0.5	<0.5	<0.5	<2.5	0.4
8/31/2000	--	b	448.02	29.00	39.00	--	--	<0.5	<0.5	<0.5	<0.5	<0.5	<0.5	<2.5	--
2/9/2001	--		448.02	29.00	39.00	31.17	416.85	--	--	--	--	--	--	--	--
9/17/2001	NP		448.02	29.00	39.00	32.98	415.04	<0.5	<0.5	<0.5	<0.5	<0.5	<0.5	<2.5	0.62
1/21/2002	--		448.02	29.00	39.00	31.05	416.97	--	--	--	--	--	--	--	--
7/19/2002	P		448.02	29.00	39.00	31.67	416.35	<0.5	<0.5	<0.5	<0.5	<0.5	<0.5	<0.5	3.7
1/15/2003	--		448.02	29.00	39.00	23.75	424.27	--	--	--	--	--	--	--	--
7/9/2003	P		448.02	29.00	39.00	31.06	416.96	<0.5	<0.5	<0.5	<0.5	<0.5	<0.5	<0.5	2.4
02/19/2004	--		448.02	29.00	39.00	27.21	420.81	--	--	--	--	--	--	--	6.6

Table 1. Summary of Ground-Water Monitoring Data: Relative Water Elevations and Laboratory Analyses
Station #771, 899 Rincon Ave., Livermore, CA

Well and Sample Date	P/NP	Comments	TOC (feet msl)	Top of Screen (ft bgs)	Bottom of Screen (ft bgs)	DTW (feet bgs)	Water Level Elevation (feet msl)	Concentrations in (µg/L)						DO (mg/L)	pH	
								GRO/TPHg	Benzene	Toluene	Ethyl-Benzene	Total Xylenes	MTBE			
MW-11 Cont.																
08/04/2004	P		450.41	29.00	39.00	31.71	418.70	<50	<0.50	<0.50	<0.50	<0.50	<0.50	<0.50	3.3	7.1
01/18/2005	--		450.41	29.00	39.00	24.80	425.61	--	--	--	--	--	--	--	--	--
07/15/2005	P		450.41	29.00	39.00	29.15	421.26	<50	<0.50	<0.50	<0.50	<0.50	<0.50	<0.50	2.7	7.1
01/10/2006	--		450.41	29.00	39.00	20.87	429.54	--	--	--	--	--	--	--	--	--
7/21/2006	P		450.41	29.00	39.00	29.30	421.11	<50	<0.50	<0.50	<0.50	<0.50	<0.50	<0.50	2.7	7.2
RW-1																
3/20/1995	--		451.67	25.50	40.50	23.76	427.91	15,000	1,000	140	310	950	--	--	--	--
6/2/1995	--		451.67	25.50	40.50	25.12	426.55	12,000	1,300	280	420	1,100	--	--	--	--
8/23/1995	--		451.67	25.50	40.50	28.8	422.87	8,200	520	190	240	610	<50	--	--	--
12/4/1995	--		451.67	25.50	40.50	31.15	420.52	2,600	140	59	83	210	--	--	--	--
2/20/1996	--		451.67	25.50	40.50	21.45	430.22	6,300	410	160	180	650	<40	--	--	--
5/15/1996	--		451.67	25.50	40.50	22.97	428.7	--	--	--	--	--	--	--	--	--
8/13/1996	--		451.67	25.50	40.50	24.74	426.93	--	--	--	--	--	--	--	--	--
11/13/1996	--		451.67	25.50	40.50	30.69	420.98	--	--	--	--	--	--	--	--	--
3/26/1997	--		451.67	25.50	40.50	25.69	425.98	500	57	3	6.4	18	54	--	--	--
5/15/1997	--		451.67	25.50	40.50	28.19	423.48	--	--	--	--	--	--	--	--	--
8/26/1997	--		451.67	25.50	40.50	31.21	420.46	--	--	--	--	--	--	--	--	--
11/5/1997	--		451.67	25.50	40.50	33.67	418	--	--	--	--	--	--	--	--	--
2/18/1998	--		451.67	25.50	40.50	20.14	431.53	9,400	200	70	190	710	<60	--	--	--
5/20/1998	--		451.67	25.50	40.50	23.43	428.24	--	--	--	--	--	--	--	--	--
7/30/1998	--		451.67	25.50	40.50	27.42	424.25	--	--	--	--	--	--	--	--	--
10/29/1998	--		451.67	25.50	40.50	32.47	419.2	--	--	--	--	--	--	--	--	--
3/16/1999	NP		451.67	25.50	40.50	25.45	426.22	1,100	140	19	45	83	530	1.0	--	--
5/5/1999	--		451.67	25.50	40.50	27.23	424.44	--	--	--	--	--	--	--	--	--
8/26/1999	--		451.67	25.50	40.50	29.98	421.69	--	--	--	--	--	--	1.39	--	--
12/3/1999	--		451.67	25.50	40.50	32.38	419.29	--	--	--	--	--	--	--	--	--
3/13/2000	NP		451.67	25.50	40.50	25.53	426.14	1,100	130	3.5	0.7	95	230	4.43	--	--
6/20/2000	--		451.67	25.50	40.50	28.31	423.36	--	--	--	--	--	--	1.9	--	--
8/31/2000	NP		451.67	25.50	40.50	30.61	421.06	<50.0	<0.500	<0.500	<0.500	<0.500	82.5	3.21	--	--
2/9/2001	NP		451.67	25.50	40.50	31.14	420.53	<50.0	<0.500	<0.500	<0.500	<0.500	<2.50	0.84	--	--

Table 1. Summary of Ground-Water Monitoring Data: Relative Water Elevations and Laboratory Analyses
Station #771, 899 Rincon Ave., Livermore, CA

Well and Sample Date	P/NP	Comments	TOC (feet msl)	Top of Screen (ft bgs)	Bottom of Screen (ft bgs)	DTW (feet bgs)	Water Level Elevation (feet msl)	Concentrations in (µg/L)						DO (mg/L)	pH	
								GRO/TPHg	Benzene	Toluene	Ethyl-Benzene	Total Xylenes	MTBE			
RW-1 Cont.																
9/17/2001	NP		451.67	25.50	40.50	31.7	419.97	<50	<0.50	<0.50	<0.50	<0.50	<0.50	<0.50	1.51	--
1/21/2002	NP		451.67	25.50	40.50	30.15	421.52	<50	7.7	<0.50	<0.50	<0.50	1.5	18	0.63	--
7/19/2002	NP		451.67	25.50	40.50	31.15	420.52	<50	<0.50	<0.50	<0.50	<0.50	<0.50	13	1.4	6.6
1/15/2003	--	a	451.67	25.50	40.50	22.2	429.47	860	9	1.6	17	42	1.5	1.5	2.8	7.2
7/9/2003	--		451.67	25.50	40.50	29.56	422.11	<50	<0.50	<0.50	<0.50	<0.50	<0.50	<0.50	1.8	7.1
02/19/2004	NP	c	451.67	25.50	40.50	23.53	428.14	<50	<0.50	<0.50	<0.50	<0.50	<0.50	<0.50	2.4	6.7
08/04/2004	P		454.11	25.50	40.50	22.45	431.66	600	<0.50	<0.50	3.3	3.4	<0.50	<0.50	4.4	7.2
01/18/2005	P		454.11	25.50	40.50	23.57	430.54	1,400	8.0	1.9	22	68	<0.50	<0.50	3.6	6.9
07/15/2005	NP		454.11	25.50	40.50	29.02	425.09	<50	<0.50	<0.50	<0.50	<0.50	<0.50	2.0	1.1	7.8
01/10/2006	P		454.11	25.50	40.50	21.88	432.23	480	4.3	0.67	8.3	18	0.54	0.54	4.4	7.1
7/21/2006	--	d	--	25.50	40.50	--	--	--	--	--	--	--	--	--	--	--
VW-1																
8/31/2000	P		--	18.50	28.50	20.61	--	<50.0	<0.500	<0.500	<0.500	<0.500	<0.500	<0.500	10.08	--
2/9/2001	P		--	18.50	28.50	22.1	--	<50.0	<0.500	<0.500	<0.500	<0.500	<0.500	<0.500	0.53	--
9/17/2001	P		--	18.50	28.50	21.99	--	<50	<0.50	<0.50	<0.50	<0.50	<0.50	<0.50	6.59	--
1/21/2002	P		--	18.50	28.50	21.5	--	<50	<0.50	<0.50	<0.50	<0.50	<0.50	<0.50	0.7	--
7/19/2002	P		--	18.50	28.50	22.42	--	<50	<0.50	<0.50	<0.50	<0.50	<0.50	<0.50	4.9	7.1
1/15/2003	--		--	18.50	28.50	22.59	--	<50	<0.50	<0.50	<0.50	<0.50	<0.50	<0.50	5.4	7.2
7/9/2003	--		--	18.50	28.50	22.5	--	<50	<0.50	<0.50	<0.50	<0.50	<0.50	<0.50	2.0	7.0
02/19/2004	--		--	18.50	28.50	21.04	--	--	--	--	--	--	--	--	--	--
08/04/2004	P		453.29	18.50	28.50	20.48	432.81	<50	<0.50	<0.50	<0.50	<0.50	<0.50	<0.50	5.7	7.0
01/18/2005	--		453.29	18.50	28.50	21.72	431.57	--	--	--	--	--	--	--	--	--
07/15/2005	P		453.29	18.50	28.50	22.50	430.79	<50	<0.50	<0.50	<0.50	<0.50	<0.50	<0.50	5.1	7.4
01/10/2006	--		453.29	18.50	28.50	20.17	433.12	--	--	--	--	--	--	--	--	--
7/21/2006	P	e	453.29	18.50	28.50	22.50	430.79	220	<0.50	<0.50	<0.50	<0.50	<0.50	<0.50	5.91	7.3

SYMBOLS AND ABBREVIATIONS:

--/- = Not analyzed/applicable/sampled/measured
< = Not detected at or above specified laboratory reporting limit
DO = Dissolved oxygen
DTW = Depth to water in ft bgs
ft bgs = Feet below ground surface
ft MSL = Feet above mean sea level
GRO = Gasoline range organics, range C4-C12
GWE = Groundwater elevation in ft MSL
g/L = Micrograms per liter
mg/L = Milligrams per liter
MTBE = Methyl tert-butyl ether
NP = Not purged before sampling
P = Purged before sampling
TPH-g = Total petroleum hydrocarbons as gasoline
TOC = Top of casing elevation in ft MSL

FOOTNOTES:

a = Chromatogram Pattern: Gasoline C6-C10
b = Duplicate sample
c = GRO analyzed by EPA Method 8015B modified
d = Well inaccessible
e = Hydrocarbon result partly due to individ. peak(s) in quant. range.

NOTES:

For previous historical GWE and analytical data please refer to Fourth Quarter 1995 Groundwater Monitoring Program Results and Remediation System Performance Evaluation Report, ARCO Service Station 771, Livermore, California, (EMCON, March 1, 1996).

Please note that beginning in the fourth quarter 2003, the laboratory modified the reported analyte list. TPH-g was changed to GRO. The resulting data may be impacted by the potential inclusion of non-TPH-g analytes within the requested fuel range resulting in a higher concentration being reported.

All analytes unless otherwise noted utilized EPA Method 8260B, EPA method 8015B modified prior to 1/15/03, and EPA method 8020 prior to 12/03/99.

Site wells were resurveyed to NAVD '88 datum on March 8, 2004.

Top of screen and bottom of screen depths for MW-3 and MW-6 are estimated from cross-sections.

Note: The data within this table collected prior to April 2006 was provided to Broadbent & Associates, Inc. by Atlantic Richfield Company and their previous consultants. Broadbent & Associates, Inc. has not verified the accuracy of this information.

Table 2. Summary of Fuel Additives Analytical Data
Station #771, 899 Rincon Ave., Livermore, CA

Well and Sample Date	Concentrations in (µg/L)								Comments	
	Ethanol	TBA	MTBE	DIPE	ETBE	TAME	1,2-DCA	EDB		
MW-1										
02/19/2004	--	--	--	--	--	--	--	--	--	
08/04/2004	--	--	--	--	--	--	--	--	--	
01/18/2005	--	--	--	--	--	--	--	--	--	
07/15/2005	--	--	--	--	--	--	--	--	--	
01/10/2006	--	--	--	--	--	--	--	--	--	
MW-2										
7/9/2003	<1,000	<200	39	<5.0	<5.0	<5.0	<5.0	<5.0	<5.0	
02/19/2004	--	--	--	--	--	--	--	--	--	
08/04/2004	<2,000	<400	78	<10	<10	<10	<10	<10	<10	
01/18/2005	--	--	--	--	--	--	--	--	--	
07/15/2005	<500	120	46	<2.5	<2.5	<2.5	<2.5	<2.5	<2.5	
01/10/2006	--	--	--	--	--	--	--	--	--	
7/21/2006	<300	<20	<0.50	<0.50	<0.50	<0.50	<0.50	<0.50	<0.50	
MW-3										
02/19/2004	--	--	--	--	--	--	--	--	--	
08/04/2004	--	--	--	--	--	--	--	--	--	
01/18/2005	--	--	--	--	--	--	--	--	--	
07/15/2005	--	--	--	--	--	--	--	--	--	
01/10/2006	--	--	--	--	--	--	--	--	--	
MW-4										
7/9/2003	<1,000	750	150	<5.0	<5.0	<5.0	<5.0	<5.0	<5.0	
02/19/2004	<1,000	630	180	<10	<10	<10	<5.0	<5.0	<5.0	
08/04/2004	<2,000	1,300	300	<10	<10	<10	<10	<10	<10	
01/18/2005	<1,000	630	160	<5.0	<5.0	<5.0	<5.0	<5.0	<5.0	a
07/15/2005	<1,000	850	230	<5.0	<5.0	<5.0	<5.0	<5.0	<5.0	
01/10/2006	<1,500	810	190	<2.5	<2.5	<2.5	<2.5	<2.5	<2.5	
7/21/2006	<300	35	3.1	<0.50	<0.50	<0.50	<0.50	<0.50	<0.50	
MW-5										
7/9/2003	<1,000	1,100	260	<5.0	<5.0	<5.0	<5.0	<5.0	<5.0	

Table 2. Summary of Fuel Additives Analytical Data
Station #771, 899 Rincon Ave., Livermore, CA

Well and Sample Date	Concentrations in (µg/L)								Comments
	Ethanol	TBA	MTBE	DIPE	ETBE	TAME	1,2-DCA	EDB	
MW-5 Cont.									
02/19/2004	--	--	--	--	--	--	--	--	
08/04/2004	<1,000	850	250	<5.0	<5.0	<5.0	<5.0	<5.0	
01/18/2005	--	--	--	--	--	--	--	--	
07/15/2005	<1,000	720	270	<5.0	<5.0	<5.0	<5.0	<5.0	
01/10/2006	--	--	--	--	--	--	--	--	
7/21/2006	<3,000	<200	14	<5.0	<5.0	<5.0	<5.0	<5.0	
MW-6									
7/9/2003	<100	<20	0.98	<0.50	<0.50	<0.50	<0.50	<0.50	
02/19/2004	--	--	--	--	--	--	--	--	
08/04/2004	<100	<20	5.2	<0.50	<0.50	<0.50	<0.50	<0.50	
01/18/2005	--	--	--	--	--	--	--	--	
07/15/2005	<500	110	32	<2.5	<2.5	<2.5	<2.5	<2.5	
01/10/2006	--	--	--	--	--	--	--	--	
7/21/2006	<300	<20	5.1	<0.50	<0.50	<0.50	<0.50	<0.50	
MW-7									
7/9/2003	<1,000	350	110	<5.0	<5.0	<5.0	<5.0	<5.0	
02/19/2004	<1,000	420	100	<10	<10	<10	<5.0	<5.0	
08/04/2004	<5,000	<1,000	140	<25	<25	<25	<25	<25	
01/18/2005	<1,000	260	87	<5.0	<5.0	<5.0	<5.0	<5.0	a
07/15/2005	<5,000	<1,000	150	<25	<25	<25	<25	<25	
01/10/2006	<30,000	<2,000	120	<50	<50	<50	<50	<50	
7/21/2006	<30,000	<2,000	54	<50	<50	<50	<50	<50	
MW-8									
02/19/2004	--	--	--	--	--	--	--	--	
08/04/2004	--	--	--	--	--	--	--	--	
01/18/2005	--	--	--	--	--	--	--	--	
07/15/2005	--	--	--	--	--	--	--	--	
01/10/2006	--	--	--	--	--	--	--	--	
MW-9									

Table 2. Summary of Fuel Additives Analytical Data
Station #771, 899 Rincon Ave., Livermore, CA

Well and Sample Date	Concentrations in (µg/L)								Comments	
	Ethanol	TBA	MTBE	DIPE	ETBE	TAME	1,2-DCA	EDB		
MW-9 Cont.										
02/19/2004	--	--	--	--	--	--	--	--	--	
08/04/2004	--	--	--	--	--	--	--	--	--	
01/18/2005	--	--	--	--	--	--	--	--	--	
07/15/2005	--	--	--	--	--	--	--	--	--	
01/10/2006	--	--	--	--	--	--	--	--	--	
MW-10										
02/19/2004	--	--	--	--	--	--	--	--	--	
01/18/2005	--	--	--	--	--	--	--	--	--	
07/15/2005	--	--	--	--	--	--	--	--	--	
01/10/2006	--	--	--	--	--	--	--	--	--	
MW-11										
7/9/2003	<100	<20	<0.50	<0.50	<0.50	<0.50	<0.50	<0.50	<0.50	
02/19/2004	--	--	--	--	--	--	--	--	--	
08/04/2004	<100	<20	<0.50	<0.50	<0.50	<0.50	<0.50	<0.50	<0.50	
01/18/2005	--	--	--	--	--	--	--	--	--	
07/15/2005	<100	<20	<0.50	<0.50	<0.50	<0.50	<0.50	<0.50	<0.50	
01/10/2006	--	--	--	--	--	--	--	--	--	
7/21/2006	<300	<20	<0.50	<0.50	<0.50	<0.50	<0.50	<0.50	<0.50	
RW-1										
7/9/2003	<100	<20	<0.50	<0.50	<0.50	<0.50	<0.50	<0.50	<0.50	
02/19/2004	<100	<20	<0.50	<1.0	<1.0	<1.0	<0.50	<0.50	<0.50	
08/04/2004	<100	<20	<0.50	<0.50	<0.50	<0.50	<0.50	<0.50	<0.50	
01/18/2005	<100	<20	<0.50	<0.50	<0.50	<0.50	<0.50	<0.50	<0.50	
07/15/2005	<100	<20	2.0	<0.50	<0.50	<0.50	<0.50	<0.50	<0.50	a
01/10/2006	<300	<20	0.54	<0.50	<0.50	<0.50	<0.50	<0.50	<0.50	
VW-1										
7/9/2003	<100	<20	<0.50	<0.50	<0.50	<0.50	<0.50	<0.50	<0.50	
02/19/2004	--	--	--	--	--	--	--	--	--	
08/04/2004	<100	<20	<0.50	<0.50	<0.50	<0.50	<0.50	<0.50	<0.50	

Table 2. Summary of Fuel Additives Analytical Data
Station #771, 899 Rincon Ave., Livermore, CA

Well and Sample Date	Concentrations in (µg/L)								Comments
	Ethanol	TBA	MTBE	DIPE	ETBE	TAME	1,2-DCA	EDB	
VW-1 Cont.									
01/18/2005	--	--	--	--	--	--	--	--	
07/15/2005	<100	<20	<0.50	<0.50	<0.50	<0.50	<0.50	<0.50	
01/10/2006	--	--	--	--	--	--	--	--	
7/21/2006	<300	<20	<0.50	<0.50	<0.50	<0.50	<0.50	<0.50	

SYMBOLS AND ABBREVIATIONS:

< = Not detected at or above specified laboratory reporting limit

1,2-DCA = 1,2-Dichloroethane

DIPE = Di-isopropyl ether

EDB = 1,2-Dibromoethane

ETBE = Ethyl tert-butyl ether

MTBE = Methyl tert-butyl ether

µg/L = Micrograms per liter

TAME = tert-Amyl methyl ether

TBA = tert-Butyl alcohol

FOOTNOTES:

a = Calibration verification was within the method limits but outside the contract limits for ethanol.

Note: The data within this table collected prior to April 2006 was provided to Broadbent & Associates, Inc. by Atlantic Richfield Company and their previous consultants. Broadbent & Associates, Inc. has not verified the accuracy of this information.

Table 3. Historical Ground-Water Flow Direction and Gradient
Station #771, 899 Rincon Ave., Livermore, CA

Date Sampled	Approximate Flow Direction	Approximate Hydraulic Gradient
3/20/1995	Northwest	0.030
6/2/1995	North-Northwest	0.014
8/23/1995	North-Northwest	0.030
12/4/1995	North-Northwest	0.030
2/20/1996	Northwest	0.016
5/15/1996	Northwest	0.024
8/13/1996	North-Northwest	0.030
11/13/1996	North-Northwest	0.031
3/26/1997	North-Northwest	0.044
5/15/1997	North-Northwest	0.031
8/26/1997	North-Northwest	0.042
11/5/1997	North-Northwest	0.030
2/18/1998	Northwest	0.010
5/20/1998	Northwest	0.030
7/30/1998	North	0.040
10/29/1998	North	0.005
3/16/1999	North-Northwest	0.030
5/5/1999	North	0.040
8/26/1999	North-Northwest	0.050
12/3/1999	North-Northeast	0.060
3/13/2000	North-Northwest	0.066
6/20/2000	North-Northwest	0.050
8/31/2000	North-Northwest	0.062
2/9/2001	North-Northeast	0.014
9/17/2001	North-Northwest	0.061
1/21/2002	North-Northwest	0.050
7/19/2002	North-Northwest	0.044
1/15/2003	Northeast to Southeast	0.038 - 0.016
7/9/2003	Northwest to North-Northwest	0.009 - 0.063
2/19/2004	North	0.044
8/4/2004	Northeast	0.071
1/18/2005	North-Northeast	0.04
7/15/2005	Northeast and Southwest	0.05 and 0.02
1/10/2006	North	0.02
7/21/2006	North and Southwest	0.05 and 0.02

Note: The data within this table collected prior to April 2006 was provided to Broadbent & Associates, Inc. by Atlantic Richfield Company and their previous consultants. Broadbent & Associates, Inc. has not verified the accuracy of this information.

APPENDIX A

URS GROUND-WATER SAMPLING DATA PACKAGE (INCLUDES LABORATORY
REPORT AND CHAIN OF CUSTODY DOCUMENTATION, FIELD AND
LABORATORY PROCEDURES, AND FIELD DATA SHEETS)

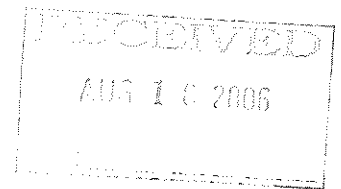

August 14, 2006

Mr. Rob Miller
Broadbent & Associates, Inc.
2000 Kirman Avenue
Reno, NV 89502

Groundwater Sampling Data Package

ARCO Service Station #771
899 Rincon Avenue
Livermore, CA
Field Work Performed: 07/21/06

General Information

Data Submittal Prepared/Reviewed by: Alok Kolekar

Phone Number: 510-874-3152

On-Site Supplier Representative: Blaine Tech

Scope of Work Performed: Groundwater Monitoring in accordance with 3rd Quarter 2006 protocols as identified in the Quarterly Monitoring Program Table in the Field and Laboratory Procedures Attachment.

Variations from Work Scope: Technician was unable to remove PVC casing cap on RW-1. Therefore, this well was not gauged or sampled.

Air Diffusion System Summary: An Air Diffusion system was installed at this site and was started-up on June 14, 2006. The system comprises of a 1.5 HP air compressor bleeding air to a network of wells on-site, to enhance bio remediation. The system is monitored on a monthly basis for general operation & maintenance.

This submittal presents the tabulation of data collected in association with routine groundwater monitoring. The attachments include, at a minimum, sampling procedures, field data collected, laboratory results, chain of custody documentation, and waste management activities. The information is being provided to BP-ARCO's Scoping Supplier for use in preparing a report for regulatory submittal. This submittal is limited to presentation of collected data and does not include data interpretation or conclusions or recommendations. Any questions concerning this submittal should be addressed to the Preparer/Reviewer identified above.

Alok D. Kolekar, P.E.
Project Manager



cc: Paul Supple, Atlantic Richfield Company (RM), electronic copy uploaded to ENFOS
URS Corporation
1333 Broadway, Suite 800
Oakland, CA 94612-1924
Tel: 510.893.3600
Fax: 510.874.3268



Attachments

Field and Laboratory Procedures

Laboratory Report

Chain of Custody Documentation

Field Data Sheets

Well Gauging Data

Well Monitoring Data Sheets

FIELD & LABORATORY PROCEDURES

Sampling Procedures

The sampling procedure for each well consists first of measuring the water level and depth to bottom, and checking for the presence of free phase petroleum product (free product), using either an electronic indicator and a clear Teflon™ bailer or an oil-water interface probe. Wells not containing free product are purged approximately three casing volumes of water (or until dewatered) using a centrifugal pump, gas displacement pump, or bailer. Equipment and purging method used for the current sampling event is noted on the attached field data sheets. During purging, temperature, pH, and electrical conductivity are monitored to document that these parameters are stable prior to collecting samples. After purging, water levels are allowed to partially (approximately 80%) recover. Groundwater samples (both purge and no purge) are collected using a Teflon bailer, placed into appropriate Environmental Protection Agency- (EPA) approved containers, labeled, logged onto chain-of-custody records, and transported on ice to a California State-certified laboratory. Wells with free product are not sampled and free product is removed according to California Code of Regulation, Title 23, Div. 3, Chap. 16, Section 2655, UST Regulations.

Laboratory Procedures

The groundwater samples were analyzed for the presence of the chemicals mentioned in the chain of custody using standard EPA methods. The methods of analysis for the groundwater samples are documented in the certified analytical report. The certified analytical reports and chain-of-custody record are presented in this attachment. The analytical data provided by the laboratory approved by RM have been reviewed and verified by that laboratory.

7 August, 2006

Alok Kolekar
URS Corporation [Arco]
1333 Broadway, Suite 800
Oakland, CA 94612

RE: ARCO #0771, Livermore, CA
Work Order: MPG0715

Enclosed are the results of analyses for samples received by the laboratory on 07/21/06 17:30. If you have any questions concerning this report, please feel free to contact me.

Sincerely,



Lisa Race
Senior Project Manager

CA ELAP Certificate # 1210

The results in this laboratory report pertain only to the samples tested in the laboratory. The analyses contained in this report were performed in accordance with the BPGCLN Technical Specifications, applicable Federal, State, local regulations and certification requirements as well as the methodologies as described in laboratory SOPs reviewed by the BPGCLN. This entire report was reviewed and approved for release.

URS Corporation [Arco] 1333 Broadway, Suite 800 Oakland CA, 94612	Project: ARCO #0771, Livermore, CA Project Number: G0CIM-0012 Project Manager: Alok Kolekar	MPG0715 Reported: 08/07/06 11:59
---	---	--

ANALYTICAL REPORT FOR SAMPLES

Sample ID	Laboratory ID	Matrix	Date Sampled	Date Received
MW-2	MPG0715-01	Water	07/21/06 14:07	07/21/06 17:30
MW-4	MPG0715-02	Water	07/21/06 11:40	07/21/06 17:30
MW-5	MPG0715-03	Water	07/21/06 13:45	07/21/06 17:30
MW-6	MPG0715-04	Water	07/21/06 13:26	07/21/06 17:30
MW-7	MPG0715-05	Water	07/21/06 14:24	07/21/06 17:30
MW-11	MPG0715-06	Water	07/21/06 13:00	07/21/06 17:30
VW-1	MPG0715-07	Water	07/21/06 13:11	07/21/06 17:30
TB-771-07212006	MPG0715-08	Water	07/21/06 00:00	07/21/06 17:30

The carbon range for the TPH-GRO has been changed from C6-C10 to C4-C12. The carbon range for TPH-DRO has been changed from C10-C28 to C10-C36. EPA 8015B has been modified to better meet the requirements of California regulatory agencies.

These samples were received with no custody seals.

8260B - The internal standard areas for ETOH and TBA for 6G30004-MS1 and 6G30004-MSD1 were outside of the method limits.

URS Corporation [Arco]
1333 Broadway, Suite 800
Oakland CA, 94612

Project: ARCO #0771, Livermore, CA
Project Number: G0C1M-0012
Project Manager: Alok Kolekar

MPG0715
Reported:
08/07/06 11:59

Total Purgeable Hydrocarbons by GC/MS (CA LUFT)
TestAmerica - Morgan Hill, CA

Analyte	Result	Reporting Limit	Units	Dilution	Batch	Prepared	Analyzed	Method	Notes
MW-2 (MPG0715-01) Water Sampled: 07/21/06 14:07 Received: 07/21/06 17:30									
Gasoline Range Organics (C4-C12)	120	50	ug/l	1	6G31005	07/31/06	07/31/06	LUFT GCMS	
Surrogate: 1,2-Dichloroethane-d4		98 %	60-145		"	"	"	"	
MW-4 (MPG0715-02) Water Sampled: 07/21/06 11:40 Received: 07/21/06 17:30									
Gasoline Range Organics (C4-C12)	66	50	ug/l	1	6H01027	08/01/06	08/02/06	LUFT GCMS	
Surrogate: 1,2-Dichloroethane-d4		90 %	60-145		"	"	"	"	
MW-5 (MPG0715-03) Water Sampled: 07/21/06 13:45 Received: 07/21/06 17:30									
Gasoline Range Organics (C4-C12)	2100	500	ug/l	10	6G30004	07/30/06	07/31/06	LUFT GCMS	
Surrogate: 1,2-Dichloroethane-d4		90 %	60-145		"	"	"	"	
MW-6 (MPG0715-04) Water Sampled: 07/21/06 13:26 Received: 07/21/06 17:30									
Gasoline Range Organics (C4-C12)	260	50	ug/l	1	6H01027	08/01/06	08/02/06	LUFT GCMS	
Surrogate: 1,2-Dichloroethane-d4		92 %	60-145		"	"	"	"	
MW-7 (MPG0715-05) Water Sampled: 07/21/06 14:24 Received: 07/21/06 17:30									
Gasoline Range Organics (C4-C12)	8000	5000	ug/l	100	6G30004	07/30/06	07/31/06	LUFT GCMS	
Surrogate: 1,2-Dichloroethane-d4		92 %	60-145		"	"	"	"	
MW-11 (MPG0715-06) Water Sampled: 07/21/06 13:00 Received: 07/21/06 17:30									
Gasoline Range Organics (C4-C12)	ND	50	ug/l	1	6G31005	07/31/06	07/31/06	LUFT GCMS	
Surrogate: 1,2-Dichloroethane-d4		99 %	60-145		"	"	"	"	
VW-1 (MPG0715-07) Water Sampled: 07/21/06 13:11 Received: 07/21/06 17:30									
Gasoline Range Organics (C4-C12)	220	50	ug/l	1	6G31005	07/31/06	07/31/06	LUFT GCMS	PV
Surrogate: 1,2-Dichloroethane-d4		99 %	60-145		"	"	"	"	

URS Corporation [Arco]
1333 Broadway, Suite 800
Oakland CA, 94612

Project: ARCO #0771, Livermore, CA
Project Number: G0CIM-0012
Project Manager: Alok Kolekar

MPG0715
Reported:
08/07/06 11:59

Volatile Organic Compounds by EPA Method 8260B
TestAmerica - Morgan Hill, CA

Analyte	Result	Reporting Limit	Units	Dilution	Batch	Prepared	Analyzed	Method	Notes
MW-2 (MPG0715-01) Water Sampled: 07/21/06 14:07 Received: 07/21/06 17:30									
tert-Amyl methyl ether	ND	0.50	ug/l	1	6G31005	07/31/06	07/31/06	EPA 8260B	
Benzene	0.90	0.50	"	"	"	"	"	"	
tert-Butyl alcohol	ND	20	"	"	"	"	"	"	
Di-isopropyl ether	ND	0.50	"	"	"	"	"	"	
1,2-Dibromoethane (EDB)	ND	0.50	"	"	"	"	"	"	
1,2-Dichloroethane	ND	0.50	"	"	"	"	"	"	
Ethanol	ND	300	"	"	"	"	"	"	
Ethyl tert-butyl ether	ND	0.50	"	"	"	"	"	"	
Ethylbenzene	ND	0.50	"	"	"	"	"	"	
Methyl tert-butyl ether	ND	0.50	"	"	"	"	"	"	
Toluene	ND	0.50	"	"	"	"	"	"	
Xylenes (total)	ND	0.50	"	"	"	"	"	"	
<i>Surrogate: 1,2-Dichloroethane-d4</i>		98 %	60-145		"	"	"	"	
<i>Surrogate: 4-Bromofluorobenzene</i>		86 %	60-115		"	"	"	"	
<i>Surrogate: Dibromofluoromethane</i>		102 %	75-130		"	"	"	"	
<i>Surrogate: Toluene-d8</i>		92 %	70-130		"	"	"	"	
MW-4 (MPG0715-02) Water Sampled: 07/21/06 11:40 Received: 07/21/06 17:30									
tert-Amyl methyl ether	ND	0.50	ug/l	1	6H01027	08/01/06	08/02/06	EPA 8260B	
Benzene	0.60	0.50	"	"	"	"	"	"	
tert-Butyl alcohol	35	20	"	"	"	"	"	"	
Di-isopropyl ether	ND	0.50	"	"	"	"	"	"	
1,2-Dibromoethane (EDB)	ND	0.50	"	"	"	"	"	"	
1,2-Dichloroethane	ND	0.50	"	"	"	"	"	"	
Ethanol	ND	300	"	"	"	"	"	"	
Ethyl tert-butyl ether	ND	0.50	"	"	"	"	"	"	
Ethylbenzene	0.52	0.50	"	"	"	"	"	"	
Methyl tert-butyl ether	3.1	0.50	"	"	"	"	"	"	
Toluene	ND	0.50	"	"	"	"	"	"	
Xylenes (total)	0.82	0.50	"	"	"	"	"	"	
<i>Surrogate: 1,2-Dichloroethane-d4</i>		90 %	60-145		"	"	"	"	
<i>Surrogate: 4-Bromofluorobenzene</i>		102 %	60-115		"	"	"	"	
<i>Surrogate: Dibromofluoromethane</i>		96 %	75-130		"	"	"	"	
<i>Surrogate: Toluene-d8</i>		100 %	70-130		"	"	"	"	

URS Corporation [Arco]
1333 Broadway, Suite 800
Oakland CA, 94612

Project: ARCO #0771, Livermore, CA
Project Number: G0C1M-0012
Project Manager: Alok Kolekar

MPG0715
Reported:
08/07/06 11:59

Volatile Organic Compounds by EPA Method 8260B
TestAmerica - Morgan Hill, CA

Analyte	Result	Reporting Limit	Units	Dilution	Batch	Prepared	Analyzed	Method	Notes
MW-5 (MPG0715-03) Water Sampled: 07/21/06 13:45 Received: 07/21/06 17:30									
tert-Amyl methyl ether	ND	5.0	ug/l	10	6G30004	07/30/06	07/31/06	EPA 8260B	
Benzene	29	5.0	"	"	"	"	"	"	
tert-Butyl alcohol	ND	200	"	"	"	"	"	"	
Di-isopropyl ether	ND	5.0	"	"	"	"	"	"	
1,2-Dibromoethane (EDB)	ND	5.0	"	"	"	"	"	"	
1,2-Dichloroethane	ND	5.0	"	"	"	"	"	"	
Ethanol	ND	3000	"	"	"	"	"	"	
Ethyl tert-butyl ether	ND	5.0	"	"	"	"	"	"	
Ethylbenzene	7.5	5.0	"	"	"	"	"	"	
Methyl tert-butyl ether	14	5.0	"	"	"	"	"	"	
Toluene	ND	5.0	"	"	"	"	"	"	
Xylenes (total)	11	5.0	"	"	"	"	"	"	
<i>Surrogate: 1,2-Dichloroethane-d4</i>		90 %	60-145	"	"	"	"	"	
<i>Surrogate: 4-Bromofluorobenzene</i>		97 %	60-115	"	"	"	"	"	
<i>Surrogate: Dibromofluoromethane</i>		90 %	75-130	"	"	"	"	"	
<i>Surrogate: Toluene-d8</i>		102 %	70-130	"	"	"	"	"	
MW-6 (MPG0715-04) Water Sampled: 07/21/06 13:26 Received: 07/21/06 17:30									
tert-Amyl methyl ether	ND	0.50	ug/l	1	6H01027	08/01/06	08/02/06	EPA 8260B	
Benzene	ND	0.50	"	"	"	"	"	"	
tert-Butyl alcohol	ND	20	"	"	"	"	"	"	
Di-isopropyl ether	ND	0.50	"	"	"	"	"	"	
1,2-Dibromoethane (EDB)	ND	0.50	"	"	"	"	"	"	
1,2-Dichloroethane	ND	0.50	"	"	"	"	"	"	
Ethanol	ND	300	"	"	"	"	"	"	
Ethyl tert-butyl ether	ND	0.50	"	"	"	"	"	"	
Ethylbenzene	ND	0.50	"	"	"	"	"	"	
Methyl tert-butyl ether	5.1	0.50	"	"	"	"	"	"	
Toluene	ND	0.50	"	"	"	"	"	"	
Xylenes (total)	0.86	0.50	"	"	"	"	"	"	
<i>Surrogate: 1,2-Dichloroethane-d4</i>		92 %	60-145	"	"	"	"	"	
<i>Surrogate: 4-Bromofluorobenzene</i>		106 %	60-115	"	"	"	"	"	
<i>Surrogate: Dibromofluoromethane</i>		94 %	75-130	"	"	"	"	"	
<i>Surrogate: Toluene-d8</i>		111 %	70-130	"	"	"	"	"	

URS Corporation [Arco]
1333 Broadway, Suite 800
Oakland CA, 94612

Project: ARCO #0771, Livermore, CA
Project Number: G0C1M-0012
Project Manager: Alok Kolekar

MPG0715
Reported:
08/07/06 11:59

Volatile Organic Compounds by EPA Method 8260B
TestAmerica - Morgan Hill, CA

Analyte	Result	Reporting Limit	Units	Dilution	Batch	Prepared	Analyzed	Method	Notes
MW-7 (MPG0715-05) Water Sampled: 07/21/06 14:24 Received: 07/21/06 17:30									
tert-Amyl methyl ether	ND	50	ug/l	100	6G30004	07/30/06	07/31/06	EPA 8260B	
Benzene	110	50	"	"	"	"	"	"	
tert-Butyl alcohol	ND	2000	"	"	"	"	"	"	
Di-isopropyl ether	ND	50	"	"	"	"	"	"	
1,2-Dibromoethane (EDB)	ND	50	"	"	"	"	"	"	
1,2-Dichloroethane	ND	50	"	"	"	"	"	"	
Ethanol	ND	30000	"	"	"	"	"	"	
Ethyl tert-butyl ether	ND	50	"	"	"	"	"	"	
Ethylbenzene	380	50	"	"	"	"	"	"	
Methyl tert-butyl ether	54	50	"	"	"	"	"	"	
Toluene	ND	50	"	"	"	"	"	"	
Xylenes (total)	180	50	"	"	"	"	"	"	
<i>Surrogate: 1,2-Dichloroethane-d4</i>		92 %	60-145	"	"	"	"	"	
<i>Surrogate: 4-Bromofluorobenzene</i>		94 %	60-115	"	"	"	"	"	
<i>Surrogate: Dibromofluoromethane</i>		92 %	75-130	"	"	"	"	"	
<i>Surrogate: Toluene-d8</i>		95 %	70-130	"	"	"	"	"	
MW-11 (MPG0715-06) Water Sampled: 07/21/06 13:00 Received: 07/21/06 17:30									
tert-Amyl methyl ether	ND	0.50	ug/l	1	6G31005	07/31/06	07/31/06	EPA 8260B	
Benzene	ND	0.50	"	"	"	"	"	"	
tert-Butyl alcohol	ND	20	"	"	"	"	"	"	
Di-isopropyl ether	ND	0.50	"	"	"	"	"	"	
1,2-Dibromoethane (EDB)	ND	0.50	"	"	"	"	"	"	
1,2-Dichloroethane	ND	0.50	"	"	"	"	"	"	
Ethanol	ND	300	"	"	"	"	"	"	
Ethyl tert-butyl ether	ND	0.50	"	"	"	"	"	"	
Ethylbenzene	ND	0.50	"	"	"	"	"	"	
Methyl tert-butyl ether	ND	0.50	"	"	"	"	"	"	
Toluene	ND	0.50	"	"	"	"	"	"	
Xylenes (total)	ND	0.50	"	"	"	"	"	"	
<i>Surrogate: 1,2-Dichloroethane-d4</i>		99 %	60-145	"	"	"	"	"	
<i>Surrogate: 4-Bromofluorobenzene</i>		87 %	60-115	"	"	"	"	"	
<i>Surrogate: Dibromofluoromethane</i>		104 %	75-130	"	"	"	"	"	
<i>Surrogate: Toluene-d8</i>		89 %	70-130	"	"	"	"	"	

URS Corporation [Arco]
1333 Broadway, Suite 800
Oakland CA, 94612

Project: ARCO #0771, Livermore, CA
Project Number: G0CIM-0012
Project Manager: Alok Kolekar

MPG0715
Reported:
08/07/06 11:59

Volatile Organic Compounds by EPA Method 8260B
TestAmerica - Morgan Hill, CA

Analyte	Result	Reporting		Units	Dilution	Batch	Prepared	Analyzed	Method	Notes
		Limit								
VW-1 (MPG0715-07) Water Sampled: 07/21/06 13:11 Received: 07/21/06 17:30										
tert-Amyl methyl ether	ND	0.50		ug/l	1	6G31005	07/31/06	07/31/06	EPA 8260B	
Benzene	ND	0.50		"	"	"	"	"	"	
tert-Butyl alcohol	ND	20		"	"	"	"	"	"	
Di-isopropyl ether	ND	0.50		"	"	"	"	"	"	
1,2-Dibromoethane (EDB)	ND	0.50		"	"	"	"	"	"	
1,2-Dichloroethane	ND	0.50		"	"	"	"	"	"	
Ethanol	ND	300		"	"	"	"	"	"	
Ethyl tert-butyl ether	ND	0.50		"	"	"	"	"	"	
Ethylbenzene	ND	0.50		"	"	"	"	"	"	
Methyl tert-butyl ether	ND	0.50		"	"	"	"	"	"	
Toluene	ND	0.50		"	"	"	"	"	"	
Xylenes (total)	ND	0.50		"	"	"	"	"	"	
<i>Surrogate: 1,2-Dichloroethane-d4</i>		99 %		60-145		"	"	"	"	
<i>Surrogate: 4-Bromofluorobenzene</i>		89 %		60-115		"	"	"	"	
<i>Surrogate: Dibromofluoromethane</i>		104 %		75-130		"	"	"	"	
<i>Surrogate: Toluene-d8</i>		83 %		70-130		"	"	"	"	

URS Corporation [Arco]
1333 Broadway, Suite 800
Oakland CA, 94612

Project: ARCO #0771, Livermore, CA
Project Number: G0C1M-0012
Project Manager: Alok Kolekar

MPG0715
Reported:
08/07/06 11:59

Total Purgeable Hydrocarbons by GC/MS (CA LUFT) - Quality Control
TestAmerica - Morgan Hill, CA

Analyte	Result	Reporting Limit	Units	Spike Level	Source Result	%REC	%REC Limits	RPD	RPD Limit	Notes
---------	--------	-----------------	-------	-------------	---------------	------	-------------	-----	-----------	-------

Batch 6G30004 - EPA 5030B P/T / LUFT GCMS

Blank (6G30004-BLK1)										
					Prepared: 07/30/06 Analyzed: 07/31/06					
Gasoline Range Organics (C4-C12)	ND	50	ug/l							
Surrogate: 1,2-Dichloroethane-d4	2.31		"	2.50		92	60-145			
Laboratory Control Sample (6G30004-BS1)										
					Prepared & Analyzed: 07/30/06					
Gasoline Range Organics (C4-C12)	465	50	ug/l	440		106	75-140			
Surrogate: 1,2-Dichloroethane-d4	2.17		"	2.50		87	60-145			
Matrix Spike (6G30004-MS1)										
		Source: MPG0715-03			Prepared & Analyzed: 07/30/06					
Gasoline Range Organics (C4-C12)	6960	500	ug/l	4400	2100	110	75-140			
Surrogate: 1,2-Dichloroethane-d4	2.10		"	2.50		84	60-145			
Matrix Spike Dup (6G30004-MSD1)										
		Source: MPG0715-03			Prepared & Analyzed: 07/30/06					
Gasoline Range Organics (C4-C12)	7110	500	ug/l	4400	2100	114	75-140	2	20	
Surrogate: 1,2-Dichloroethane-d4	2.10		"	2.50		84	60-145			

Batch 6G31005 - EPA 5030B P/T / LUFT GCMS

Blank (6G31005-BLK1)										
					Prepared & Analyzed: 07/31/06					
Gasoline Range Organics (C4-C12)	ND	50	ug/l							
Surrogate: 1,2-Dichloroethane-d4	2.58		"	2.50		103	60-145			
Laboratory Control Sample (6G31005-BS1)										
					Prepared & Analyzed: 07/31/06					
Gasoline Range Organics (C4-C12)	758	50	ug/l	700		108	75-140			
Surrogate: 1,2-Dichloroethane-d4	2.35		"	2.50		94	60-145			
Laboratory Control Sample (6G31005-BS2)										
					Prepared & Analyzed: 07/31/06					
Gasoline Range Organics (C4-C12)	485	50	ug/l	440		110	75-140			
Surrogate: 1,2-Dichloroethane-d4	2.37		"	2.50		95	60-145			

URS Corporation [Arco]
1333 Broadway, Suite 800
Oakland CA, 94612

Project: ARCO #0771, Livermore, CA
Project Number: G0CIM-0012
Project Manager: Alok Kolekar

MPG0715
Reported:
08/07/06 11:59

Total Purgeable Hydrocarbons by GC/MS (CA LUFT) - Quality Control
TestAmerica - Morgan Hill, CA

Analyte	Result	Reporting Limit	Units	Spike Level	Source Result	%REC	%REC Limits	RPD	RPD Limit	Notes
---------	--------	-----------------	-------	-------------	---------------	------	-------------	-----	-----------	-------

Batch 6G31005 - EPA 5030B P/T / LUFT GCMS

Matrix Spike (6G31005-MS1)		Source: MPG0716-02			Prepared & Analyzed: 07/31/06					
Gasoline Range Organics (C4-C12)	4980	500	ug/l	4400	260	107	75-140			
Surrogate: 1,2-Dichloroethane-d4	2.35		"	2.50		94	60-145			
Matrix Spike Dup (6G31005-MSD1)		Source: MPG0716-02			Prepared & Analyzed: 07/31/06					
Gasoline Range Organics (C4-C12)	5070	500	ug/l	4400	260	109	75-140	2	20	
Surrogate: 1,2-Dichloroethane-d4	2.21		"	2.50		88	60-145			

Batch 6H01027 - EPA 5030B P/T / LUFT GCMS

Blank (6H01027-BLK1)		Prepared: 08/01/06 Analyzed: 08/02/06								
Gasoline Range Organics (C4-C12)	ND	50	ug/l							
Surrogate: 1,2-Dichloroethane-d4	2.27		"	2.50		91	60-145			
Laboratory Control Sample (6H01027-BS1)		Prepared & Analyzed: 08/01/06								
Gasoline Range Organics (C4-C12)	441	50	ug/l	440		100	75-140			
Surrogate: 1,2-Dichloroethane-d4	2.09		"	2.50		84	60-145			
Matrix Spike (6H01027-MS1)		Source: MPG1153-11			Prepared & Analyzed: 08/01/06					
Gasoline Range Organics (C4-C12)	471	50	ug/l	440	17	103	75-140			
Surrogate: 1,2-Dichloroethane-d4	2.06		"	2.50		82	60-145			
Matrix Spike Dup (6H01027-MSD1)		Source: MPG1153-11			Prepared & Analyzed: 08/01/06					
Gasoline Range Organics (C4-C12)	458	50	ug/l	440	17	100	75-140	3	20	
Surrogate: 1,2-Dichloroethane-d4	2.03		"	2.50		81	60-145			

URS Corporation [Arco]
1333 Broadway, Suite 800
Oakland CA, 94612

Project: ARCO #0771, Livermore, CA
Project Number: GOCIM-0012
Project Manager: Alok Kolekar

MPG0715
Reported:
08/07/06 11:59

Volatile Organic Compounds by EPA Method 8260B - Quality Control
TestAmerica - Morgan Hill, CA

Analyte	Result	Reporting Limit	Units	Spike Level	Source Result	%REC	%REC Limits	RPD	RPD Limit	Notes
---------	--------	-----------------	-------	-------------	---------------	------	-------------	-----	-----------	-------

Batch 6G30004 - EPA 5030B P/T / EPA 8260B

Blank (6G30004-BLK1)

Prepared: 07/30/06 Analyzed: 07/31/06

tert-Amyl methyl ether	ND	0.50	ug/l							
Benzene	ND	0.50	"							
tert-Butyl alcohol	ND	20	"							
Di-isopropyl ether	ND	0.50	"							
1,2-Dibromoethane (EDB)	ND	0.50	"							
1,2-Dichloroethane	ND	0.50	"							
Ethanol	ND	300	"							
Ethyl tert-butyl ether	ND	0.50	"							
Ethylbenzene	ND	0.50	"							
Methyl tert-butyl ether	ND	0.50	"							
Toluene	ND	0.50	"							
Xylenes (total)	ND	0.50	"							
<i>Surrogate: 1,2-Dichloroethane-d4</i>	2.31		"	2.50		92	60-145			
<i>Surrogate: 4-Bromofluorobenzene</i>	2.17		"	2.50		87	60-115			
<i>Surrogate: Dibromofluoromethane</i>	2.44		"	2.50		98	75-130			
<i>Surrogate: Toluene-d8</i>	2.30		"	2.50		92	70-130			

Laboratory Control Sample (6G30004-BS1)

Prepared & Analyzed: 07/30/06

tert-Amyl methyl ether	14.9	0.50	ug/l	15.0		99	65-135			
Benzene	5.41	0.50	"	5.16		105	70-125			
tert-Butyl alcohol	143	20	"	143		100	60-135			
Di-isopropyl ether	15.3	0.50	"	15.1		101	70-130			
1,2-Dibromoethane (EDB)	14.7	0.50	"	14.9		99	85-125			
1,2-Dichloroethane	14.8	0.50	"	14.7		101	75-125			
Ethanol	98.5	300	"	142		69	15-150			
Ethyl tert-butyl ether	14.8	0.50	"	15.0		99	65-130			
Ethylbenzene	7.22	0.50	"	7.54		96	80-130			
Methyl tert-butyl ether	7.22	0.50	"	7.02		103	50-140			
Toluene	38.4	0.50	"	37.2		103	70-120			
Xylenes (total)	41.0	0.50	"	41.2		100	85-125			
<i>Surrogate: 1,2-Dichloroethane-d4</i>	2.17		"	2.50		87	60-145			
<i>Surrogate: 4-Bromofluorobenzene</i>	2.63		"	2.50		105	60-115			
<i>Surrogate: Dibromofluoromethane</i>	2.22		"	2.50		89	75-130			
<i>Surrogate: Toluene-d8</i>	2.47		"	2.50		99	70-130			

URS Corporation [Arco]
1333 Broadway, Suite 800
Oakland CA, 94612

Project: ARCO #0771, Livermore, CA
Project Number: G0C1M-0012
Project Manager: Alok Kolekar

MPG0715
Reported:
08/07/06 11:59

Volatile Organic Compounds by EPA Method 8260B - Quality Control
TestAmerica - Morgan Hill, CA

Analyte	Result	Reporting Limit	Units	Spike Level	Source Result	%REC	%REC Limits	RPD	RPD Limit	Notes
---------	--------	-----------------	-------	-------------	---------------	------	-------------	-----	-----------	-------

Batch 6G30004 - EPA 5030B P/T / EPA 8260B

Matrix Spike (6G30004-MS1)	Source: MPG0715-03			Prepared & Analyzed: 07/30/06						
tert-Amyl methyl ether	152	5.0	ug/l	150	ND	101	65-135			
Benzene	83.5	5.0	"	51.6	29	106	70-125			
tert-Butyl alcohol	1290	200	"	1430	ND	90	60-135			
Di-isopropyl ether	152	5.0	"	151	ND	101	70-130			
1,2-Dibromoethane (EDB)	148	5.0	"	149	ND	99	85-125			
1,2-Dichloroethane	142	5.0	"	147	ND	97	75-125			
Ethanol	826	3000	"	1420	ND	58	15-150			
Ethyl tert-butyl ether	148	5.0	"	150	ND	99	65-130			
Ethylbenzene	80.4	5.0	"	75.4	7.5	97	80-130			
Methyl tert-butyl ether	85.9	5.0	"	70.2	14	102	50-140			
Toluene	394	5.0	"	372	1.3	106	70-120			
Xylenes (total)	412	5.0	"	412	11	97	85-125			
<i>Surrogate: 1,2-Dichloroethane-d4</i>	<i>2.10</i>		<i>"</i>	<i>2.50</i>		<i>84</i>	<i>60-145</i>			
<i>Surrogate: 4-Bromofluorobenzene</i>	<i>2.64</i>		<i>"</i>	<i>2.50</i>		<i>106</i>	<i>60-115</i>			
<i>Surrogate: Dibromofluoromethane</i>	<i>2.18</i>		<i>"</i>	<i>2.50</i>		<i>87</i>	<i>75-130</i>			
<i>Surrogate: Toluene-d8</i>	<i>2.58</i>		<i>"</i>	<i>2.50</i>		<i>103</i>	<i>70-130</i>			

Matrix Spike Dup (6G30004-MSD1)	Source: MPG0715-03			Prepared & Analyzed: 07/30/06						
tert-Amyl methyl ether	154	5.0	ug/l	150	ND	103	65-135	1	25	
Benzene	83.7	5.0	"	51.6	29	106	70-125	0.2	15	
tert-Butyl alcohol	1350	200	"	1430	ND	94	60-135	5	35	
Di-isopropyl ether	152	5.0	"	151	ND	101	70-130	0	35	
1,2-Dibromoethane (EDB)	151	5.0	"	149	ND	101	85-125	2	15	
1,2-Dichloroethane	142	5.0	"	147	ND	97	75-125	0	10	
Ethanol	720	3000	"	1420	ND	51	15-150	14	35	
Ethyl tert-butyl ether	152	5.0	"	150	ND	101	65-130	3	35	
Ethylbenzene	78.8	5.0	"	75.4	7.5	95	80-130	2	15	
Methyl tert-butyl ether	88.4	5.0	"	70.2	14	106	50-140	3	25	
Toluene	391	5.0	"	372	1.3	105	70-120	0.8	15	
Xylenes (total)	405	5.0	"	412	11	96	85-125	2	15	
<i>Surrogate: 1,2-Dichloroethane-d4</i>	<i>2.10</i>		<i>"</i>	<i>2.50</i>		<i>84</i>	<i>60-145</i>			
<i>Surrogate: 4-Bromofluorobenzene</i>	<i>2.62</i>		<i>"</i>	<i>2.50</i>		<i>105</i>	<i>60-115</i>			
<i>Surrogate: Dibromofluoromethane</i>	<i>2.20</i>		<i>"</i>	<i>2.50</i>		<i>88</i>	<i>75-130</i>			
<i>Surrogate: Toluene-d8</i>	<i>2.59</i>		<i>"</i>	<i>2.50</i>		<i>104</i>	<i>70-130</i>			

URS Corporation [Arco]
1333 Broadway, Suite 800
Oakland CA, 94612

Project: ARCO #0771, Livermore, CA
Project Number: G0C1M-0012
Project Manager: Alok Kolekar

MPG0715
Reported:
08/07/06 11:59

Volatile Organic Compounds by EPA Method 8260B - Quality Control
TestAmerica - Morgan Hill, CA

Analyte	Result	Reporting Limit	Units	Spike Level	Source Result	%REC	%REC Limits	RPD	RPD Limit	Notes
---------	--------	-----------------	-------	-------------	---------------	------	-------------	-----	-----------	-------

Batch 6G31005 - EPA 5030B P/T / EPA 8260B

Blank (6G31005-BLK1)

Prepared & Analyzed: 07/31/06

tert-Amyl methyl ether	ND	0.50	ug/l							
Benzene	ND	0.50	"							
tert-Butyl alcohol	ND	20	"							
Di-isopropyl ether	ND	0.50	"							
1,2-Dibromoethane (EDB)	ND	0.50	"							
1,2-Dichloroethane	ND	0.50	"							
Ethanol	ND	300	"							
Ethyl tert-butyl ether	ND	0.50	"							
Ethylbenzene	ND	0.50	"							
Methyl tert-butyl ether	ND	0.50	"							
Toluene	ND	0.50	"							
Xylenes (total)	ND	0.50	"							
<i>Surrogate: 1,2-Dichloroethane-d4</i>	2.58		"	2.50		103	60-145			
<i>Surrogate: 4-Bromofluorobenzene</i>	1.87		"	2.50		75	60-115			
<i>Surrogate: Dibromofluoromethane</i>	2.61		"	2.50		104	75-130			
<i>Surrogate: Toluene-d8</i>	2.23		"	2.50		89	70-130			

Laboratory Control Sample (6G31005-BS1)

Prepared & Analyzed: 07/31/06

tert-Amyl methyl ether	8.77	0.50	ug/l	10.0		88	65-135			
Benzene	9.72	0.50	"	10.0		97	70-125			
tert-Butyl alcohol	169	20	"	200		84	60-135			
Di-isopropyl ether	9.62	0.50	"	10.0		96	70-130			
1,2-Dibromoethane (EDB)	9.73	0.50	"	10.0		97	85-125			
1,2-Dichloroethane	9.22	0.50	"	10.0		92	75-125			
Ethanol	205	300	"	200		102	15-150			
Ethyl tert-butyl ether	8.39	0.50	"	10.0		84	65-130			
Ethylbenzene	11.0	0.50	"	10.0		110	80-130			
Methyl tert-butyl ether	9.50	0.50	"	10.0		95	50-140			
Toluene	10.2	0.50	"	10.0		102	70-120			
Xylenes (total)	33.7	0.50	"	30.0		112	85-125			
<i>Surrogate: 1,2-Dichloroethane-d4</i>	2.35		"	2.50		94	60-145			
<i>Surrogate: 4-Bromofluorobenzene</i>	2.37		"	2.50		95	60-115			
<i>Surrogate: Dibromofluoromethane</i>	2.41		"	2.50		96	75-130			
<i>Surrogate: Toluene-d8</i>	2.61		"	2.50		104	70-130			

URS Corporation [Arco]
1333 Broadway, Suite 800
Oakland CA, 94612

Project: ARCO #0771, Livermore, CA
Project Number: G0C1M-0012
Project Manager: Alok Kolekar

MPG0715
Reported:
08/07/06 11:59

Volatile Organic Compounds by EPA Method 8260B - Quality Control
TestAmerica - Morgan Hill, CA

Analyte	Result	Reporting Limit	Units	Spike Level	Source Result	%REC	%REC Limits	RPD	RPD Limit	Notes
---------	--------	-----------------	-------	-------------	---------------	------	-------------	-----	-----------	-------

Batch 6G31005 - EPA 5030B P/T / EPA 8260B

Matrix Spike (6G31005-MS1)		Source: MPG0716-02			Prepared & Analyzed: 07/31/06					
tert-Amyl methyl ether	144	5.0	ug/l	150	ND	96	65-135			
Benzene	54.0	5.0	"	51.6	4.0	97	70-125			
tert-Butyl alcohol	1490	200	"	1430	ND	104	60-135			
Di-isopropyl ether	150	5.0	"	151	ND	99	70-130			
1,2-Dibromoethane (EDB)	148	5.0	"	149	ND	99	85-125			
1,2-Dichloroethane	144	5.0	"	147	ND	98	75-125			
Ethanol	2280	3000	"	1420	ND	161	15-150			LM
Ethyl tert-butyl ether	142	5.0	"	150	ND	95	65-130			
Ethylbenzene	92.2	5.0	"	75.4	19	97	80-130			
Methyl tert-butyl ether	85.6	5.0	"	70.2	9.0	109	50-140			
Toluene	358	5.0	"	372	ND	96	70-120			
Xylenes (total)	429	5.0	"	412	ND	104	85-125			
<i>Surrogate: 1,2-Dichloroethane-d4</i>	2.35		"	2.50		94	60-145			
<i>Surrogate: 4-Bromofluorobenzene</i>	2.29		"	2.50		92	60-115			
<i>Surrogate: Dibromofluoromethane</i>	2.42		"	2.50		97	75-130			
<i>Surrogate: Toluene-d8</i>	2.23		"	2.50		89	70-130			
Matrix Spike Dup (6G31005-MSD1)		Source: MPG0716-02			Prepared & Analyzed: 07/31/06					
tert-Amyl methyl ether	148	5.0	ug/l	150	ND	99	65-135	3	25	
Benzene	54.3	5.0	"	51.6	4.0	97	70-125	0.6	15	
tert-Butyl alcohol	1520	200	"	1430	ND	106	60-135	2	35	
Di-isopropyl ether	152	5.0	"	151	ND	101	70-130	1	35	
1,2-Dibromoethane (EDB)	150	5.0	"	149	ND	101	85-125	1	15	
1,2-Dichloroethane	139	5.0	"	147	ND	95	75-125	4	10	
Ethanol	1960	3000	"	1420	ND	138	15-150	15	35	
Ethyl tert-butyl ether	142	5.0	"	150	ND	95	65-130	0	35	
Ethylbenzene	93.8	5.0	"	75.4	19	99	80-130	2	15	
Methyl tert-butyl ether	89.9	5.0	"	70.2	9.0	115	50-140	5	25	
Toluene	354	5.0	"	372	ND	95	70-120	1	15	
Xylenes (total)	432	5.0	"	412	ND	105	85-125	0.7	15	
<i>Surrogate: 1,2-Dichloroethane-d4</i>	2.21		"	2.50		88	60-145			
<i>Surrogate: 4-Bromofluorobenzene</i>	2.32		"	2.50		93	60-115			
<i>Surrogate: Dibromofluoromethane</i>	2.40		"	2.50		96	75-130			
<i>Surrogate: Toluene-d8</i>	2.30		"	2.50		92	70-130			

URS Corporation [Arco]
1333 Broadway, Suite 800
Oakland CA, 94612

Project: ARCO #0771, Livermore, CA
Project Number: G0C1M-0012
Project Manager: Alok Kolekar

MPG0715
Reported:
08/07/06 11:59

Volatile Organic Compounds by EPA Method 8260B - Quality Control
TestAmerica - Morgan Hill, CA

Analyte	Result	Reporting Limit	Units	Spike Level	Source Result	%REC	%REC Limits	RPD	RPD Limit	Notes
---------	--------	-----------------	-------	-------------	---------------	------	-------------	-----	-----------	-------

Batch 6H01027 - EPA 5030B P/T / EPA 8260B

Blank (6H01027-BLK1)				Prepared: 08/01/06 Analyzed: 08/02/06						
tert-Amyl methyl ether	ND	0.50	ug/l							
Benzene	ND	0.50	"							
tert-Butyl alcohol	ND	20	"							
Di-isopropyl ether	ND	0.50	"							
1,2-Dibromoethane (EDB)	ND	0.50	"							
1,2-Dichloroethane	ND	0.50	"							
Ethanol	ND	300	"							
Ethyl tert-butyl ether	ND	0.50	"							
Ethylbenzene	ND	0.50	"							
Methyl tert-butyl ether	ND	0.50	"							
Toluene	ND	0.50	"							
Xylenes (total)	ND	0.50	"							
<i>Surrogate: 1,2-Dichloroethane-d4</i>	2.27		"	2.50		91	60-145			
<i>Surrogate: 4-Bromofluorobenzene</i>	2.34		"	2.50		94	60-115			
<i>Surrogate: Dibromofluoromethane</i>	2.53		"	2.50		101	75-130			
<i>Surrogate: Toluene-d8</i>	2.42		"	2.50		97	70-130			

Laboratory Control Sample (6H01027-BS1)				Prepared & Analyzed: 08/01/06						
tert-Amyl methyl ether	14.8	0.50	ug/l	15.0		99	65-135			
Benzene	5.42	0.50	"	5.16		105	70-125			
tert-Butyl alcohol	143	20	"	143		100	60-135			
Di-isopropyl ether	14.5	0.50	"	15.1		96	70-130			
1,2-Dibromoethane (EDB)	14.7	0.50	"	14.9		99	85-125			
1,2-Dichloroethane	13.4	0.50	"	14.7		91	75-125			
Ethanol	101	300	"	142		71	15-150			
Ethyl tert-butyl ether	14.4	0.50	"	15.0		96	65-130			
Ethylbenzene	7.20	0.50	"	7.54		95	80-130			
Methyl tert-butyl ether	7.20	0.50	"	7.02		103	50-140			
Toluene	39.2	0.50	"	37.2		105	70-120			
Xylenes (total)	40.2	0.50	"	41.2		98	85-125			
<i>Surrogate: 1,2-Dichloroethane-d4</i>	2.09		"	2.50		84	60-145			
<i>Surrogate: 4-Bromofluorobenzene</i>	2.63		"	2.50		105	60-115			
<i>Surrogate: Dibromofluoromethane</i>	2.29		"	2.50		92	75-130			
<i>Surrogate: Toluene-d8</i>	2.62		"	2.50		105	70-130			

URS Corporation [Arco]
1333 Broadway, Suite 800
Oakland CA, 94612

Project: ARCO #0771, Livermore, CA
Project Number: G0CIM-0012
Project Manager: Alok Kolekar

MPG0715
Reported:
08/07/06 11:59

Volatile Organic Compounds by EPA Method 8260B - Quality Control
TestAmerica - Morgan Hill, CA

Analyte	Result	Reporting Limit	Units	Spike Level	Source Result	%REC	%REC Limits	RPD	RPD Limit	Notes
---------	--------	-----------------	-------	-------------	---------------	------	-------------	-----	-----------	-------

Batch 6H01027 - EPA 5030B P/T / EPA 8260B

Matrix Spike (6H01027-MS1)	Source: MPG1153-11			Prepared & Analyzed: 08/01/06						
tert-Amyl methyl ether	15.1	0.50	ug/l	15.0	ND	101	65-135			
Benzene	6.09	0.50	"	5.16	0.46	109	70-125			
tert-Butyl alcohol	151	20	"	143	ND	106	60-135			
Di-isopropyl ether	14.9	0.50	"	15.1	ND	99	70-130			
1,2-Dibromoethane (EDB)	14.8	0.50	"	14.9	ND	99	85-125			
1,2-Dichloroethane	13.3	0.50	"	14.7	ND	90	75-125			
Ethanol	101	300	"	142	ND	71	15-150			
Ethyl tert-butyl ether	14.7	0.50	"	15.0	ND	98	65-130			
Ethylbenzene	7.60	0.50	"	7.54	0.36	96	80-130			
Methyl tert-butyl ether	7.31	0.50	"	7.02	0.19	101	50-140			
Toluene	41.1	0.50	"	37.2	0.61	109	70-120			
Xylenes (total)	42.2	0.50	"	41.2	1.5	99	85-125			
<i>Surrogate: 1,2-Dichloroethane-d4</i>	2.06		"	2.50		82	60-145			
<i>Surrogate: 4-Bromofluorobenzene</i>	2.68		"	2.50		107	60-115			
<i>Surrogate: Dibromofluoromethane</i>	2.29		"	2.50		92	75-130			
<i>Surrogate: Toluene-d8</i>	2.64		"	2.50		106	70-130			

Matrix Spike Dup (6H01027-MSD1)	Source: MPG1153-11			Prepared & Analyzed: 08/01/06						
tert-Amyl methyl ether	15.2	0.50	ug/l	15.0	ND	101	65-135	0.7	25	
Benzene	6.01	0.50	"	5.16	0.46	108	70-125	1	15	
tert-Butyl alcohol	151	20	"	143	ND	106	60-135	0	35	
Di-isopropyl ether	14.9	0.50	"	15.1	ND	99	70-130	0	35	
1,2-Dibromoethane (EDB)	14.8	0.50	"	14.9	ND	99	85-125	0	15	
1,2-Dichloroethane	13.3	0.50	"	14.7	ND	90	75-125	0	10	
Ethanol	95.8	300	"	142	ND	67	15-150	5	35	
Ethyl tert-butyl ether	14.8	0.50	"	15.0	ND	99	65-130	0.7	35	
Ethylbenzene	7.50	0.50	"	7.54	0.36	95	80-130	1	15	
Methyl tert-butyl ether	7.48	0.50	"	7.02	0.19	104	50-140	2	25	
Toluene	40.3	0.50	"	37.2	0.61	107	70-120	2	15	
Xylenes (total)	42.6	0.50	"	41.2	1.5	100	85-125	0.9	15	
<i>Surrogate: 1,2-Dichloroethane-d4</i>	2.03		"	2.50		81	60-145			
<i>Surrogate: 4-Bromofluorobenzene</i>	2.64		"	2.50		106	60-115			
<i>Surrogate: Dibromofluoromethane</i>	2.31		"	2.50		92	75-130			
<i>Surrogate: Toluene-d8</i>	2.59		"	2.50		104	70-130			

URS Corporation [Arco]
1333 Broadway, Suite 800
Oakland CA, 94612

Project: ARCO #0771, Livermore, CA
Project Number: G0C1M-0012
Project Manager: Alok Kolekar

MPG0715
Reported:
08/07/06 11:59

Notes and Definitions

PV Hydrocarbon result partly due to individ. peak(s) in quant. range
LM MS and/or MSD above acceptance limits. See Blank Spike(LCS).
DET Analyte DETECTED
ND Analyte NOT DETECTED at or above the reporting limit or MDL, if MDL is specified
NR Not Reported
dry Sample results reported on a dry weight basis
RPD Relative Percent Difference



Chain of Custody Record

Project Name: Analytical for QMR sampling
 BP BU/AR Region/Enfos Segment: BP > Americas > West Coast > Retail > WCBU > CA > Central > 771 > Historical/BL
 State or Lead Regulatory Agency: California Regional Water Quality Control Board - San Francisco
 Requested Due Date (mm/dd/yy): 10 Day TAT

On-site Time: <u>1030</u>	Temp: <u>mid 90's F</u>
Off-site Time: <u>1800</u>	Temp: <u>-</u>
Sky Conditions: <u>clear</u>	
Meteorological Events: <u>hot</u>	
Wind Speed: <u>-</u>	Direction: <u>-</u>

Lab Name: <u>Sequoia</u>	BP/AR Facility No.: <u>771</u>	Consultant/Contractor: <u>URS</u>
Address: <u>885 Jarvis Drive</u> <u>Morgan Hill, CA 95037</u>	BP/AR Facility Address: <u>899 Rincon Ave., Livermore, CA 94550</u>	Address: <u>1333 Broadway, Suite 800</u> <u>Oakland, CA 94612</u>
Lab PM: <u>Lisa Race/ Katt Min</u>	California Global ID No.: <u>T0600100113</u>	Consultant/Contractor Project No.: <u>38487523</u>
Tele/Fax: <u>408.782.8156 / 408.782.6308</u>	Enfos Project No.: <u>G0C1M-0012</u>	Consultant/Contractor PM: <u>Alok Kolekar</u>
BP/AR PM Contact: <u>Paul Supple</u>	Provision or RCOP: <u>Provision</u>	Tele/Fax: <u>510.874.3152 / 510.874.3268</u>
Address: <u>P.O. Box 6549</u> <u>Moraga, CA 94570</u>	Phase/WBS: <u>04 - Mon/Remed by Natural Attenuation</u>	Report Type & QC Level: <u>Level 1 with EDF</u>
Tele/Fax: <u>925.299.8891 / 925.299.8872</u>	Sub Phase/Task: <u>03 - Analytical</u>	E-mail BDD To: <u>jane_field@urscorp.com</u>
	Cost Element: <u>05 - Subcontracted Costs</u>	Invoice to: <u>Atlantic Richfield Company</u>

Item No.	Sample Description	Time	Date	Matrix			Laboratory No.	No. of Containers	Preservative					Requested Analysis						Sample Point Lat/Long and Comments		
				Soil/Solid	Water/Liquid	Air			Unpreserved	H ₂ SO ₄	HNO ₃	HCl	Methanol	GRX / BTEX (8260)	MTBE, TAME, ETBE	DPEL, TBA (8260)	EDB, 1,2-DCA (8260)	Ethanol (8260)				
1	MW-2	1407	7/21/06	X			MPG0715	3														
2	MW-4	1140					02	1														
3	MW-5	1345					03	1														
4	MW-6	1320					04	1														
5	MW-7	1424					05	1														
6	MW-11	1300					06	1														
7	UW-1	1311					07	1														
8	TB-771-0722006	-					08	2														on hold
9																						
10																						

Sampler's Name: <u>Will Cross</u>	Relinquished By / Affiliation	Date	Time	Accepted By / Affiliation	Date	Time
Sampler's Company: <u>Blaine Tech</u>	<u>[Signature]</u>	<u>7/21/06</u>	<u>1608</u>	<u>[Signature]</u>	<u>7/21/06</u>	<u>1608</u>
Shipment Date:		<u>7/21/06</u>	<u>1635</u>	<u>[Signature]</u>	<u>8/21</u>	<u>4:30</u>
Shipment Method:	<u>BY AIR</u>	<u>7/21</u>	<u>17:50</u>	<u>[Signature]</u>	<u>9/21</u>	<u>1730</u>
Shipment Tracking No:						

Special Instructions: CC to bpedf@broadbentinc.com

Place Yes No Temp Blank Yes No Cooler Temperature on Receipt 5.2 F/C Trip Blank Yes No

SEQUOIA ANALYTICAL SAMPLE RECEIPT LOG

CLIENT NAME: EP
 REC. BY (PRINT) EP
 WORKORDER: MPG0715

DATE REC'D AT LAB: 7/21/06
 TIME REC'D AT LAB: 1750
 DATE LOGGED IN: 7/23/06

For Regulatory Purposes?
 DRINKING WATER YES/NO NO
 WASTE WATER YES/NO NO

CIRCLE THE APPROPRIATE RESPONSE	LAB SAMPLE #	DASH #	CLIENT ID	CONTAINER DESCRIPTION	PRESERVATIVE	pH	SAMPLE MATRIX	DATE SAMPLED	REMARKS: CONDITION (ETC.)
1. Custody Seal(s) Present / <input checked="" type="radio"/> Absent Intact / Broken*									
2. Chain-of-Custody <input checked="" type="radio"/> Present / Absent*									
3. Traffic Reports or Packing List: Present / <input checked="" type="radio"/> Absent									
4. Airbill: Airbill / Sticker Present / <input checked="" type="radio"/> Absent									
5. Airbill #:									
6. Sample Labels: <input checked="" type="radio"/> Present / Absent									
7. Sample IDs: <input checked="" type="radio"/> Listed / Not Listed on Chain-of-Custody									
8. Sample Condition: <input checked="" type="radio"/> Intact / Broken* / Leaking*									
9. Does information on chain-of-custody, traffic reports and sample labels agree? <input checked="" type="radio"/> Yes / No*									
10. Sample received within hold time? <input checked="" type="radio"/> Yes / No*									
11. Adequate sample volume received? <input checked="" type="radio"/> Yes / No*									
12. Proper preservatives used? <input checked="" type="radio"/> Yes / No*									
13. Trip Blank / Temp Blank Received? (circle which, if yes) <input checked="" type="radio"/> Yes / No*									
14. Read Temp: <u>5.2°C</u> Corrected Temp: <u>5.2°C</u> Is corrected temp 4 +/- 2°C? <input checked="" type="radio"/> Yes / No** <small>(Acceptance range for samples requiring thermal pres.)</small>									
**Exception (if any): METALS / DFF ON ICE or Problem COC									

*IF CIRCLED, CONTACT PROJECT MANAGER AND ATTACH RECORD OF RESOLUTION.

WELL GAUGING DATA

Project # 060721-WC-2 Date 7/21/06 Client BPE 271

Site 899 Rincon Ave, Livermore

Well ID	Time	Well Size (in.)	Sheen / Odor	Depth to Immiscible Liquid (ft.)	Thickness of Immiscible Liquid (ft.)	Volume of Immiscibles Removed (ml)	Depth to water (ft.)	Depth to well bottom (ft.)	Survey Point: TOB or TOC	Notes
✓ MW-1	1115	4					20.73	36.65		G.O
MW-2	1127	4					25.73	34.10		
✓ MW-3	1055	4					25.73	39.68		G.O
✓ MW-4	1132	4					28.88	41.25		NPE 26'
MW-5	1121	4					30.36	40.17		
MW-6	1111	4					27.96	43.22		
MW-7	1150	4					28.10	39.60		
✓ MW-8	1045	2					30.84	41.71		SO/tr
✓ MW-9	1036	2					25.58	39.15		SO/tr
✓ MW-10	1032	2					25.16	34.15		G.O/tr
✓ MW-11	1234 1150	2					29.30	38.59		tr
RW-1	1059			unable to open PVC cap						NPE 25.5
VW-1	1059	4					22.50	28.22	✓	

ARCO / BP WELL MONITORING DATA SHEET

BTS #: <u>060721-WC-2</u>	Station # <u>771</u>
Sampler: <u>WC</u>	Date: <u>7/21/08</u>
Well I.D.: <u>MW-2</u>	Well Diameter: 2 3 <input checked="" type="checkbox"/> 4 6 8 <input type="checkbox"/>
Total Well Depth: <u>34.10</u>	Depth to Water: <u>25.73</u>
Depth to Free Product:	Thickness of Free Product (feet):
Referenced to: <u>PVC</u> Grade	D.O. Meter (if req'd): <u>YSI</u> HACH

Well Diameter	Multiplier	Well Diameter	Multiplier
1"	0.04	4"	0.65
2"	0.16	6"	1.47
3"	0.37	Other	radius ² * 0.163

Purge Method: <u>Bailer</u>	Sampling Method: <u>Bailer</u>
<input type="checkbox"/> Disposable Bailer <input type="checkbox"/> Positive Air Displacement <input checked="" type="checkbox"/> Electric Submersible <input type="checkbox"/> Extraction Pump Other: _____	<input checked="" type="checkbox"/> Disposable Bailer <input type="checkbox"/> Extraction Port Other: _____

Top of Screen: _____ If well is listed as a no-purge, confirm that water level is below the top of screen. Otherwise, the well must be purged.

<u>5.4</u>	x	<u>3</u>	=	<u>16.2</u>	Gals.
1 Case Volume (Gals.)		Specified Volumes		Calculated Volume	

Time	Temp (°F)	pH	Conductivity (mS or µS)	Gals. Removed	Observations
1401	80.7	7.4	908	5.4	clear color
1402	80.2	7.6	763	10.8	↓
1403	76.3	8.3	719	16.2	

Did well dewater? Yes <input type="checkbox"/> No <input checked="" type="checkbox"/>	Gallons actually evacuated: <u>16.2</u>	
Sampling Time: <u>1407</u>	Sampling Date: <u>7/21/08</u>	
Sample I.D.: <u>MW-2</u>	Laboratory: Pace Sequoia <input checked="" type="checkbox"/> Other _____	
Analyzed for: <u>GRO BTEX MTBE DRO</u>	Other: <u>see eee</u>	
D.O. (if req'd):	Pre-purge: _____ mg/L	Post-purge: <u>6.08</u> mg/L
O.R.P. (if req'd):	Pre-purge: _____ mV	Post-purge: _____ mV

WELL MONITORING DATA SHEET

Project #: <u>060721-WC-2</u>	Client: <u>BPC@771</u>
Sampler: <u>Wc</u>	Start Date: <u>7/21/06</u>
Well I.D.: <u>MW-4</u>	Well Diameter: 2 3 <u>4</u> 6 8 <u> </u>
Total Well Depth: <u>41.25</u>	Depth to Water: <u>28.88</u>
Before: After:	Before: After:
Depth to Free Product:	Thickness of Free Product (feet):
Referenced to: <u>PVC</u> Grade	D.O. Meter (if req'd): <u>YSI</u> HACH

Purge Method:

- Bailer
- Disposable Bailer
- Positive Air Displacement
- Electric Submersible

- Waterra
- Peristaltic
- Extraction Pump
- Other _____

Sampling Method:

- Bailer
- Disposable Bailer
- Extraction Port
- Dedicated Tubing
- Other: _____

NP@26'

	(Gals.) X _____ = _____ Gals.	
1 Case Volume	Specified Volumes	Calculated Volume

Well Diameter	Multiplier	Well Diameter	Multiplier
1"	0.04	4"	0.65
2"	0.16	6"	1.47
3"	0.37	Other	radius ² * 0.163

Time	Temp. (F or °C)	pH	Conductivity (mS or <u>µS</u>)	Turbidity (NTU)	Gals. Removed	Observations
<u>138</u>	<u>74.7</u>	<u>8.3</u>	<u>763</u>	<u> </u>	<u> </u>	<u>clear</u>

Did well dewater? Yes No Gallons actually evacuated:

Sampling Time: 1140 Sampling Date: 7/21/06

Sample I.D.: MW-4 Laboratory: STL TA

Analyzed for: TPH-G BTEX MTBE TPH-D Other: see cor

Equipment Blank I.D.: _____ @ _____ Time Duplicate I.D.: _____

Analyzed for: TPH-G BTEX MTBE TPH-D Other: _____

D.O. (if req'd):	Pre-purge:	mg/L	Post-purge:	<u>4.75</u> mg/L
ORP (if req'd):	Pre-purge:	mV	Post-purge:	mV

ARCO / BP WELL MONITORING DATA SHEET

BTS #: 060721-wc-2	Station # 771
Sampler: W	Date: 7/21/06
Well I.D.: mw-6	Well Diameter: 2 3 <u>4</u> 6 8
Total Well Depth: 43.22	Depth to Water: 27.96
Depth to Free Product:	Thickness of Free Product (feet):
Referenced to: <u>Free</u> Grade	D.O. Meter (if req'd): <u>YSI</u> HACH

Well Diameter	Multiplier	Well Diameter	Multiplier
1"	0.04	4"	0.65
2"	0.16	6"	1.47
3"	0.37	Other	radius ² * 0.163

Purge Method: <u>Bailer</u> Disposable Bailer Positive Air Displacement Electric <u>Submersible</u> Extraction Pump Other: _____	Sampling Method: <u>Bailer</u> Disposable <u>Bailer</u> Extraction Port Other: _____
---	---

Top of Screen: _____ If well is listed as a no-purge, confirm that water level is below the top of screen. Otherwise, the well must be purged.

9.9	x	3	=	29.7	Gals.
1 Case Volume (Gals.)		Specified Volumes		Calculated Volume	

Time	Temp (°F)	pH	Conductivity (mS or <u>µS</u>)	Gals. Removed	Observations
1318	76.1	7.7	739	10	odor / clear
1320	72.5	7.3	757	20	slight odor / clear
1322	71.3	7.2	879	30	"

Did well dewater? Yes <input checked="" type="checkbox"/>	Gallons actually evacuated: 30
Sampling Time: 1326	Sampling Date: 7/21/06
Sample I.D.: mw-6	Laboratory: Pace Sequoia <u>TH</u> Other _____

Analyzed for: <u>RO</u> BTEX MTBE DRO Oxy's 1,2-DCA EDB Ethanol Other: _____
D.O. (if req'd): Pre-purge: _____ mg/L Post-purge: 2.60 mg/L
O.R.P. (if req'd): Pre-purge: _____ mV Post-purge: _____ mV

ARCO / BP WELL MONITORING DATA SHEET

BTS #: <u>060721-we-2</u>	Station # <u>771</u>
Sampler: <u>W</u>	Date: <u>7/21/08</u>
Well I.D.: <u>MW-7</u>	Well Diameter: 2 3 <u>4</u> 6 8 <u> </u>
Total Well Depth: <u>39.60</u>	Depth to Water: <u>28.10</u>
Depth to Free Product:	Thickness of Free Product (feet):
Referenced to: <u>PVE</u> Grade	D.O. Meter (if req'd): <u>YSI</u> HACH

Well Diameter	Multiplier	Well Diameter	Multiplier
1"	0.04	4"	0.65
2"	0.16	6"	1.47
3"	0.37	Other	radius ² * 0.163

Purge Method:	Sampling Method:
<input type="checkbox"/> Bailer <input type="checkbox"/> Disposable Bailer <input type="checkbox"/> Positive Air Displacement <input checked="" type="checkbox"/> Electric Submersible <input type="checkbox"/> Extraction Pump Other: _____	<input type="checkbox"/> Bailer <input checked="" type="checkbox"/> Disposable Bailer <input type="checkbox"/> Extraction Port Other: _____

Top of Screen: _____ If well is listed as a no-purge, confirm that water level is below the top of screen. Otherwise, the well must be purged.

<u>7.5</u>	x	<u>3</u>	=	<u>22.5</u>	Gals.
1 Case Volume (Gals.)		Specified Volumes		Calculated Volume	

Time	Temp (°F)	pH	Conductivity (mS or µS)	Gals. Removed	Observations
<u>1414</u>	<u>75.2</u>	<u>8.3</u>	<u>906</u>	<u>7.5</u>	<u>clear</u>
<u>1416</u>	<u>72.7</u>	<u>8.1</u>	<u>922</u>	<u>15.0</u>	<u>↓</u>
<u>1418</u>	<u>72.3</u>	<u>7.8</u>	<u>940</u>	<u>22.5</u>	<u>↓</u>

Did well dewater? Yes <input type="checkbox"/> No <input checked="" type="checkbox"/>	Gallons actually evacuated: <u>22.5</u>	
Sampling Time: <u>1424</u>	Sampling Date: <u>7/21/08</u>	
Sample I.D.: <u>MW-7</u>	Laboratory: Pace Sequoia <u>TA</u> Other _____	
Analyzed for: <u>GRO BTEX MDE DRO</u> Other: <u>see COC</u>		
D.O. (if req'd):	Pre-purge: _____ mg/L	Post-purge: <u>3.20</u> mg/L
O.R.P. (if req'd):	Pre-purge: _____ mV	Post-purge: _____ mV

ARCO / BP WELL MONITORING DATA SHEET

BTS #: <u>060721-WC-2</u>	Station # <u>771</u>
Sampler: <u>WC</u>	Date: <u>7/21/06</u>
Well I.D.: <u>MW-11</u>	Well Diameter: <u>2</u> 3 4 6 8 <u> </u>
Total Well Depth: <u>38.59</u>	Depth to Water: <u>29.30</u>
Depth to Free Product:	Thickness of Free Product (feet):
Referenced to: <u>PVC</u> Grade	D.O. Meter (if req'd): <u>YSP</u> HACH

Well Diameter	Multiplier	Well Diameter	Multiplier
1"	0.04	4"	0.65
2"	0.16	6"	1.47
3"	0.37	Other	radius ² * 0.163

Purge Method: <input type="checkbox"/> Bailer <input checked="" type="checkbox"/> Disposable Bailer <input type="checkbox"/> Positive Air Displacement <input type="checkbox"/> Electric Submersible Extraction Pump Other: _____	Sampling Method: <input type="checkbox"/> Bailer <input checked="" type="checkbox"/> Disposable Bailer <input type="checkbox"/> Extraction Port Other: _____
---	---

Top of Screen: _____ If well is listed as a no-purge, confirm that water level is below the top of screen. Otherwise, the well must be purged.

<u>1.5</u>	x	<u>3</u>	=	<u>4.5</u>	Gals.
1 Case Volume (Gals.)		Specified Volumes		Calculated Volume	

Time	Temp (°F)	pH	Conductivity (mS or <u>µS</u>)	Gals. Removed	Observations
1249	72.8	7.5	871	1.5	clearly
1252	70.9	7.3	890	3.0	↓
1255	70.2	7.2	882	4.5	

Did well dewater? Yes <input type="checkbox"/> <input checked="" type="checkbox"/> No	Gallons actually evacuated: <u>4.5</u>
Sampling Time: <u>1300</u>	Sampling Date: <u>7/21/06</u>
Sample I.D.: <u>MW-11</u>	Laboratory: Pace <u>Sequoia</u> Other _____

Analyzed for: <u>GRO BTEX MTBE DRO Oxy's 1,2-DCA EDB Ethanol</u> Other: _____		
D.O. (if req'd):	Pre-purge: _____ mg/L	Post-purge: <u>2.7</u> mg/L
O.R.P. (if req'd):	Pre-purge: _____ mV	Post-purge: _____ mV

WELL MONITORING DATA SHEET

Project #: <u>06022wca</u>	Client: <u>771</u>
Sampler: <u>Cue</u>	Start Date: <u>7/21/06</u>
Well I.D.: <u>RW-1</u>	Well Diameter: 2 3 4 <u>6</u> 8
Total Well Depth:	Depth to Water:
Before: _____ After: _____	Before: _____ After: _____
Depth to Free Product:	Thickness of Free Product (feet):
Referenced to: <u>PVC</u> <u>Grade</u>	D.O. Meter (if req'd): <u>YSI</u> <u>HACH</u>

Purge Method: <input type="checkbox"/> Bailer <input type="checkbox"/> Disposable Bailer <input type="checkbox"/> Positive Air Displacement <input type="checkbox"/> Electric Submersible	Sampling Method: <input type="checkbox"/> Waterra <input type="checkbox"/> Peristaltic <input type="checkbox"/> Extraction Pump <input type="checkbox"/> Other: _____
<input type="checkbox"/> Bailer <input type="checkbox"/> Disposable Bailer <input type="checkbox"/> Positive Air Displacement <input type="checkbox"/> Electric Submersible	<input type="checkbox"/> Bailer <input type="checkbox"/> Disposable Bailer <input type="checkbox"/> Extraction Port <input type="checkbox"/> Dedicated Tubing <input type="checkbox"/> Other: _____

_____ (Gals.) X _____	=	_____ Gals.
1 Case Volume	Specified Volumes	Calculated Volume

Well Diameter	Multiplier	Well Diameter	Multiplier
1"	0.04	4"	0.65
2"	0.16	6"	1.47
3"	0.37	Other	radius ² * 0.163

Time	Temp. (°F or °C)	pH	Conductivity (mS or µS)	Turbidity (NTU)	Gals. Removed	Observations
Unable to remove PVC casing cap, no sample taken.						

Did well dewater?	Yes	No	Gallons actually evacuated:
Sampling Time:	Sampling Date:		
Sample I.D.:	Laboratory: <u>STL</u>		
Analyzed for:	TPH-G BTEX MTBE TPH-D Other:		
Equipment Blank I.D.:	@	Time Duplicate I.D.:	
Analyzed for:	TPH-G BTEX MTBE TPH-D Other:		
D.O. (if req'd):	Pre-purge:	mg/L	Post-purge: mg/L
ORP (if req'd):	Pre-purge:	mV	Post-purge: mV

ARCO / BP WELL MONITORING DATA SHEET

BTS #: 060721-WC-2	Station #: 771
Sampler: WC	Date: 7/21/06
Well I.D.: VW-1	Well Diameter: 2 3 ④ 6 8
Total Well Depth: 28.22	Depth to Water: 22.50
Depth to Free Product:	Thickness of Free Product (feet):
Referenced to: <u>VC</u> Grade	D.O. Meter (if req'd): <u>YSD</u> HACH

Well Diameter	Multiplier	Well Diameter	Multiplier
1"	0.04	4"	0.65
2"	0.16	6"	1.47
3"	0.37	Other	radius ² * 0.163

Purge Method: Bailer Sampling Method: Bailer
 Disposable Bailer Disposable Bailer
 Positive Air Displacement Extraction Port
 Electric Submersible Other: _____
 Extraction Pump
Other: _____

Top of Screen: _____ If well is listed as a no-purge, confirm that water level is below the top of screen. Otherwise, the well must be purged.

3.7	x	3	=	11.1	Gals.
1 Case Volume (Gals.)		Specified Volumes		Calculated Volume	

Time	Temp (°F)	pH	Conductivity (mS or µS)	Gals. Removed	Observations
1305	75.9	7.5	579	3.7	cloudy
1306	72.1	7.4	592	7.4	↓
1307	71.8	7.3	599	16.1	↓

Did well dewater? Yes No Gallons actually evacuated: 11.1

Sampling Time: 1311 Sampling Date: 7/21/06

Sample I.D.: VW-1 Laboratory: Pace Sequoia 771 Other: _____

Analyzed for: GRO BTEX MTBE DRG Oxy's 1,2-DCA EDB Ethanol Other: _____

D.O. (if req'd):	Pre-purge:	mg/L	Post-purge:	5.91	mg/L
	O.R.P. (if req'd):	Pre-purge:	mV	Post-purge:	mV

BP GEM OIL COMPANY TYPE **A** BILL OF LADING

SOURCE RECORD **BILL OF LADING** FOR NON-HAZARDOUS PURGEWATER RECOVERED FROM GROUNDWATER WELLS AT BP GEM OIL COMPANY FACILITIES IN THE STATE OF CALIFORNIA. THE NON-HAZARDOUS PURGE- WATER WHICH HAS BEEN RECOVERED FROM GROUND- WATER WELLS IS COLLECTED BY THE CONTRACTOR, MADE UP INTO LOADS OF APPROPRIATE SIZE AND HAULED BY DILLARD ENVIRONMENTAL TO THE ALTAMONT LANDFILL AND RESOURCE RECOVERY FACILITY IN LIVERMORE, CALIFORNIA.

The contractor performing this work is BLAINE TECH SERVICES, INC. (BTS), 1680 Rogers Avenue, San Jose, CA 95112 (phone [408] 573-0555). Blaine Tech Services, Inc. is authorized by BP GEM OIL COMPANY to recover, collect, apportion into loads the Non-Hazardous Well Purgewater that is drawn from wells at the BP GEM Oil Company facility indicated below and deliver that purgewater to BTS. Transport routing of the Non-Hazardous Well Purgewater may be direct from one BP GEM facility to the designated destination point; from one BP GEM facility to the designated destination point via another BP GEM facility; from a BP GEM facility to the designated destination point via the contractor's facility, or any combination thereof. The Non-Hazardous Well Purgewater is and remains the property of BP GEM Oil Company.

This **Source Record BILL OF LADING** was initiated to cover the recovery of Non-Hazardous Well Purgewater from wells at the BP GEM Oil Company facility described below:

771

Station #

899 Rincon Ave, Livermore

Station Address

Total Gallons Collected From Groundwater Monitoring Wells:

137.7 Gallons

added equip. 2.3 gal any other adjustments

TOTAL GALS. RECOVERED 140 gal loaded onto BTS vehicle # 64

BTS event # 060721-we-2 time 1545 date 7/21/06

signature Will Cren

REC'D AT Blaine Tech time 1545 date 7/21/06

unloaded by signature Will Cren

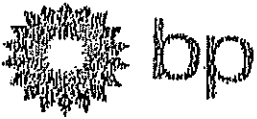

WELLHEAD INSPECTION CHECKLIST
BP / GEM

Date 7/21/06

Site Address 899 Rincon Ave, Livermore

Job Number 060721-we-2 Technician Will

Well ID	Well Inspected - No Corrective Action Required	Water Bailed From Wellbox	Wellbox Components Cleaned	Cap Replaced	Debris Removed From Wellbox	Lock Replaced	Other Action Taken (explain below)	Well Not Inspected (explain below)
mw-1		Severed 1/4" yellow air line					@ 15" below	TOC
mw-2								
mw-3		Both tabs stripped						
mw-4								
mw-5								
mw-6	x							
mw-7								
mw-8	e							
mw-9	x							
mw-10	x							
mw-11		Both tabs broken / lid broken @ 1 1/2 bolt holes						
RW-1		Unable to remove PVC casing cap						
VW-1								

NOTES: ~~See persistent deficiency~~

APPENDIX B

GEOTRACKER UPLOAD CONFIRMATION

Electronic Submittal Information

[Main Menu](#) |
 [View/Add Facilities](#) |
 [Upload EDD](#) |
 [Check EDD](#)

Your EDF file has been successfully uploaded!

Confirmation Number: 4626748383
Date/Time of Submittal: 10/24/2006 2:03:44 PM
Facility Global ID: T0600100113
Facility Name: ARCO #00771
Submittal Title: 3Q 06 GW Monitoring
Submittal Type: GW Monitoring Report

[Click here to view the detections report for this upload.](#)

ARCO #00771 899 RINCON LIVERMORE, CA 94550	Regional Board - Case #: 01-0121 SAN FRANCISCO BAY RWQCB (REGION 2) Local Agency (lead agency) - Case #: RO0000200 ALAMEDA COUNTY LOP - (SP)
---	---

CONF #	TITLE	QUARTER
4626748383	3Q 06 GW Monitoring	Q3 2006
SUBMITTED BY	SUBMIT DATE	STATUS
Broadbent & Associates, Inc.	10/24/2006	PENDING REVIEW

SAMPLE DETECTIONS REPORT

# FIELD POINTS SAMPLED	7
# FIELD POINTS WITH DETECTIONS	6
# FIELD POINTS WITH WATER SAMPLE DETECTIONS ABOVE MCL	5
SAMPLE MATRIX TYPES	WATER

METHOD QA/QC REPORT

METHODS USED	8260FA,8260TPH
TESTED FOR REQUIRED ANALYTES?	Y
LAB NOTE DATA QUALIFIERS	Y

QA/QC FOR 8021/8260 SERIES SAMPLES

TECHNICAL HOLDING TIME VIOLATIONS	0
METHOD HOLDING TIME VIOLATIONS	0
LAB BLANK DETECTIONS ABOVE REPORTING DETECTION LIMIT	0
LAB BLANK DETECTIONS	0
DO ALL BATCHES WITH THE 8021/8260 SERIES INCLUDE THE FOLLOWING?	
- LAB METHOD BLANK	Y
- MATRIX SPIKE	Y
- MATRIX SPIKE DUPLICATE	Y
- BLANK SPIKE	Y
- SURROGATE SPIKE	Y

WATER SAMPLES FOR 8021/8260 SERIES

MATRIX SPIKE / MATRIX SPIKE DUPLICATE(S) % RECOVERY BETWEEN 65-135%	Y
MATRIX SPIKE / MATRIX SPIKE DUPLICATE(S) RPD LESS THAN 30%	Y
SURROGATE SPIKES % RECOVERY BETWEEN 85-115%	Y
BLANK SPIKE / BLANK SPIKE DUPLICATES % RECOVERY BETWEEN 70-130%	Y

SOIL SAMPLES FOR 8021/8260 SERIES

MATRIX SPIKE / MATRIX SPIKE DUPLICATE(S) % RECOVERY BETWEEN 65-135% n/a
 MATRIX SPIKE / MATRIX SPIKE DUPLICATE(S) RPD LESS THAN 30% n/a
 SURROGATE SPIKES % RECOVERY BETWEEN 70-125% n/a
 BLANK SPIKE / BLANK SPIKE DUPLICATES % RECOVERY BETWEEN 70-130% n/a

FIELD QC SAMPLES

<u>SAMPLE</u>	<u>COLLECTED</u>	<u>DETECTIONS > REPD</u>
QCTB SAMPLES	N	0
QCEB SAMPLES	N	0
QCAB SAMPLES	N	0

Logged in as BROADBENT-C (CONTRACTOR)

CONTACT SITE ADMINISTRATOR.

771

Electronic Submittal Information	
Main Menu View/Add Facilities Upload EDD Check EDD	
UPLOADING A GEO_WELL FILE	
Processing is complete. No errors were found! Your file has been successfully submitted!	
Submittal Title:	3Q 06 GEO_WELL
Submittal Date/Time:	10/24/2006 2:00:09 PM
Confirmation Number:	7308257877
Back to Main Menu	

Logged in as BROADBENT-C
(CONTRACTOR)

[CONTACT SITE ADMINISTRATOR.](#)