

September 5, 2005

Ms. Donna Drogos
Alameda County Environmental Health (ACEH)
1131 Harbor Bay Parkway, Suite 250
Alameda, CA 94502

Alameda County
SEP 12 2005
Environmental Health

**Re: Second Semi-Annual 2005 Groundwater Monitoring Report
ARCO Service Station #0771
899 Rincon Avenue
Livermore, California
ACEH Case No. 3873**

Dear Ms. Drogos:

On behalf of Atlantic Richfield Company, a BP affiliated company, URS Corporation (URS) is submitting the *Second Semi-Annual 2005 Groundwater Monitoring Report* for ARCO Service Station #0771, located at 899 Rincon Avenue, Livermore, California.

If you have any questions regarding this submission, please call (510) 874-3280.

Sincerely,

URS CORPORATION

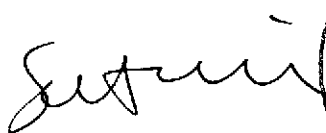

Scott Robinson, P.G.
Project Manager

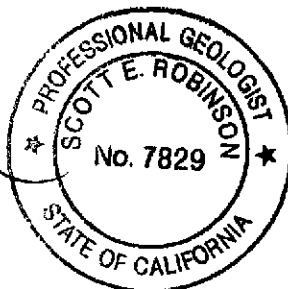

Enclosure: Second Semi-Annual 2005 Groundwater Monitoring Report

cc: Mr. Paul Supple, Atlantic Richfield Company (RM), electronic copy uploaded to ENFOS
Mr. Paul M. Smith, Livermore-Pleasanton Fire Department, 3560 Nevada Street, Pleasanton,
CA 94566
Mr. Chuck Headlee, Regional Water Quality Control Board (RWQCB), electronic copy
uploaded to RWQCB ftp site and to the GeoTracker database

REPORT

**SECOND SEMI-ANNUAL 2005
GROUNDWATER MONITORING
REPORT**

ARCO SERVICE STATION #0771
899 RINCON AVENUE
LIVERMORE, CALIFORNIA

Alameda County
SEP 12 2005
Environmental Health

Prepared for
RM

September 5, 2005

URS

URS Corporation
1333 Broadway, Suite 800
Oakland, California 94612

Date: September 5, 2005
Quarter: 3Q 05

SECOND SEMI-ANNUAL 2005 GROUNDWATER MONITORING REPORT

Facility No.: 0771 Address: 899 Rincon Avenue, Livermore, California
RM Environmental Business Manager: Paul Supple
Consulting Co./Contact Person: URS Corporation / Scott Robinson
Primary Agency: Alameda County Environmental Health (ACEH)
ACEH Case No.: 3873

WORK PERFORMED THIS QUARTER (Third – 2005):

1. Performed the third quarter 2005 groundwater monitoring event on July 15, 2005.
2. Prepared and submitted this Second Semi-Annual 2005 Groundwater Monitoring Report.

WORK PROPOSED FOR NEXT QUARTER (Fourth– 2005):

1. Prepare and submit the Fourth Quarter 2005 Status Report.

Current Phase of Project:	<u>GW monitoring/sampling</u>
Frequency of Groundwater Sampling:	<u>Semi-Annual (1st/3rd Qtr): MW-4, MW-7, RW-1</u> <u>Annual (3rd Qtr): MW-2, MW-5, MW-6, MW-11, VW-1</u>
Frequency of Groundwater Monitoring:	<u>Semi-annual</u>
Is Free Product (FP) Present On-Site:	<u>No</u>
Cumulative FP Recovered to Date :	<u>3.06 gallons, Wells MW-1, MW-2, and MW-5</u>
FP Recovered This Quarter :	<u>None (FP was last recovered in 1992)</u>
Bulk Soil Removed to Date :	<u>1,700 cubic yards of TPH-impacted soil</u>
Current Remediation Techniques:	<u>None</u>
Approximate Depth to Groundwater:	<u>22.50 (VW-1) to 31.14 (MW-8) feet</u>
Groundwater Gradient (direction):	<u>Northeast and Southwest</u>
Groundwater Gradient (magnitude):	<u>0.05 and 0.02 feet per foot</u>

DISCUSSION:

Gasoline range organics were detected at or above the laboratory reporting limit in five of the eight wells sampled this quarter at concentrations ranging from 1,600 µg/L (MW-5) to 12,000 µg/L (MW-7). Benzene was detected at or above the laboratory reporting limit in five wells at concentrations ranging from 61 µg/L (MW-5) to 1,000 µg/L (MW-7). Toluene was detected at or above the laboratory reporting limit in four wells at concentrations ranging from 5.3 µg/L (MW-2) to 44 µg/L (MW-6). Ethylbenzene was detected at or above the laboratory reporting limit in five wells at concentrations ranging from 8.7 µg/L (MW-5) to 490 µg/L (MW-7). Xylenes were detected at or above the laboratory reporting limit in four wells at concentrations ranging from 10 µg/L (MW-2) to 670 µg/L (MW-6). Methyl tert-butyl ether was detected at or above the laboratory reporting limit in six wells at concentrations ranging from 2.0 µg/L (RW-1) to 270 µg/L (MW-5). Tert-butyl alcohol was detected at or above the laboratory reporting limit in four wells at concentrations ranging from 110 µg/L (MW-6) to 850 µg/L (MW-4).

During purging before sampling the following wells dewatered: MW-2 at 10.5 gallons, MW-7 at 17 gallons, and VW-1 at 8 gallons.

ATTACHMENTS:

- Figure 1 – Groundwater Elevation Contour and Analytical Summary Map – July 15, 2005
- Table 1 – Groundwater Elevation and Analytical Data
- Table 2 – Fuel Additives Analytical Data
- Table 3 – Groundwater Gradient Data
- Attachment A - Field Procedures and Field Data Sheets
- Attachment B – Laboratory Procedures, Certified Analytical Reports and Chain-of-Custody Records
- Attachment C – Error Check Reports and EDF/Geowell Submittal Confirmation

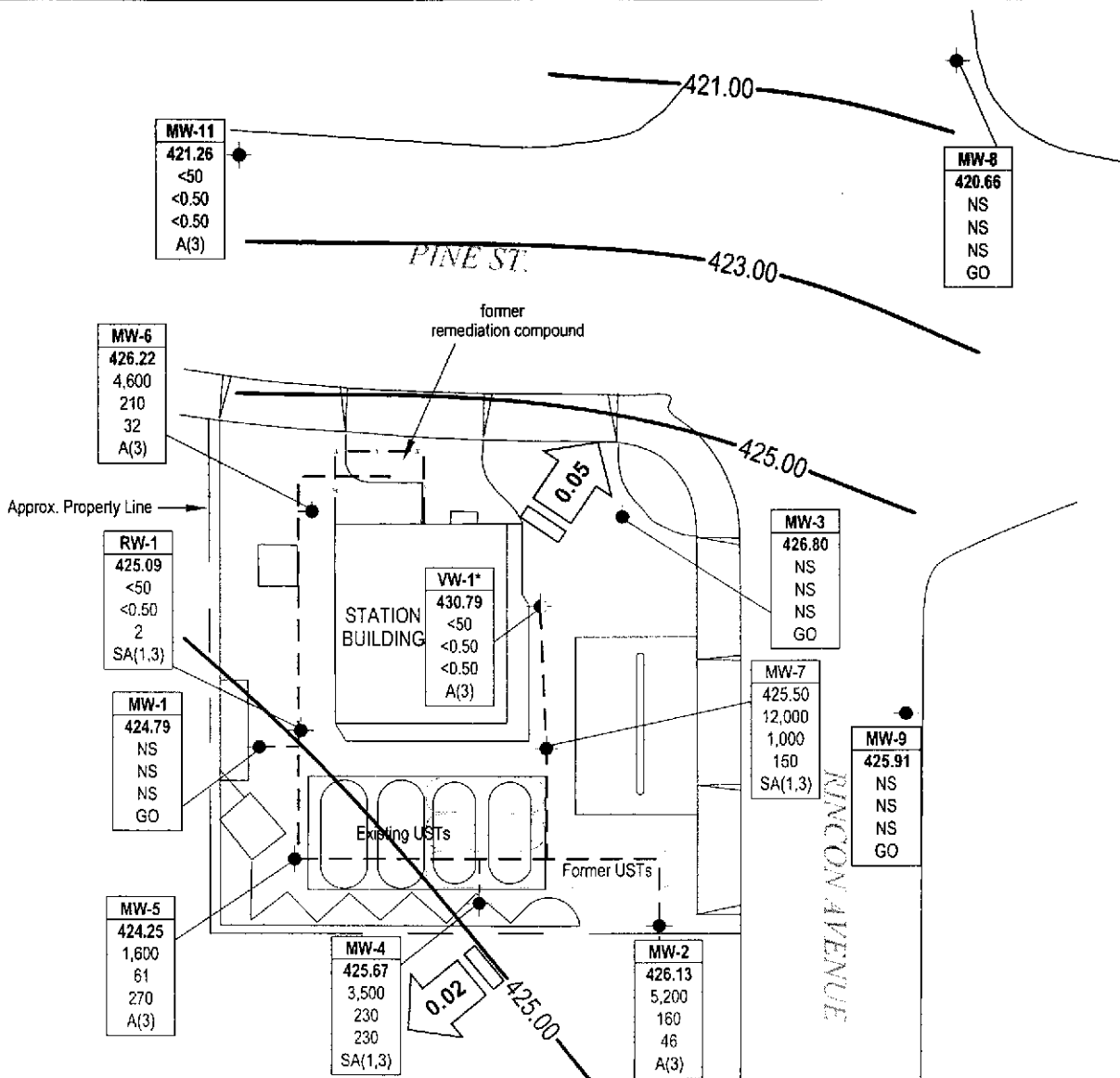

EXPLANATION	
	Monitoring well location
	Vapor extraction well location
Well	Well designation
ELEV	Groundwater elevation (ft above MSL)
GRO	GRO, Benzene & MTBE concentrations (µg/L)
Benzene	
MTBE	
SA or A	Sampling frequency
<	Not detected at or above laboratory reporting limits
*	Not used in contouring
NS	Not sampled
A(3)	Sampled annually during 3rd quarter
GO	Not sampled, gauged only
SA(1,3)	Sampled semi-annually, 1st & 3rd quarters
— 425.00	Groundwater Elevation Contour (ft above MSL)
	Approximate Groundwater Flow Direction and Gradient (ft/ft)
---	Remediation piping

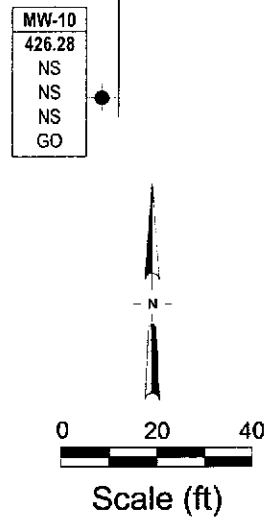

Sep 01, 2005 - 11:12am
 X:\x_env1_waste\BP_GEM sites\Scott_Robinson\Paul_Supple\0771\Monitoring_2005_Q3\Drawings\771-3\005-GWR.dwg

URS	Project No. 38487170	GROUNDWATER ELEVATION CONTOUR AND ANALYTICAL SUMMARY MAP Third Quarter 2005 (July 15, 2005)	FIGURE 1
	ARCO Service Station #0771 899 Rincon Avenue Livermore, California		

Table 1
Groundwater Elevation and Analytical Data
 ARCO Service Station #0771
 899 Rincon Ave., Livermore, CA

Well No.	Date	P/ NP	Footnotes/ Comments	TOC (ft MSL)	Top of Screen (ft bgs)	Bottom of Screen (ft bgs)	DTW (ft bgs)	GWE (ft MSL)	GRO/ TPH-g (µg/L)	Benzene (µg/L)	Toluene (µg/L)	Ethyl-benzene (µg/L)	Total Xylenes (µg/L)	MTBE (µg/L)	DO (mg/L)	pH
MW-1	3/20/1995	--		451.73	32.00	41.00	24.50	427.23	90,000	1,800	1,100	1,000	5,600	--	--	--
	6/2/1995	--		451.73	32.00	41.00	25.60	426.13	81,000	2,000	1,400	990	4,600	--	--	--
	8/23/1995	--		451.73	32.00	41.00	29.04	422.69	44,000	2,400	1,900	670	3,800	<300	--	--
	12/4/1995	--		451.73	32.00	41.00	31.31	420.42	22,000	870	660	390	2,200	--	--	--
	2/20/1996	--		451.73	32.00	41.00	22.26	429.47	21,000	1,500	1,200	650	3,500	<300	--	--
	5/15/1996	--		451.73	32.00	41.00	23.42	428.31	36,000	3,000	2,500	960	5,700	<250	--	--
	8/13/1996	--		451.73	32.00	41.00	26.83	424.90	19,000	730	580	450	2,500	<200	--	--
	11/13/1996	--		451.73	32.00	41.00	31.05	420.68	6,600	47	16	74	160	<30	--	--
	3/26/1997	--		451.73	32.00	41.00	26.29	425.44	1,900	100	55	37	200	<30	--	--
	5/15/1997	--		451.73	32.00	41.00	28.65	423.08	16,000	490	250	250	1,100	<120	--	--
	8/26/1997	--		451.73	32.00	41.00	31.53	420.20	190	6.7	3	6.3	25	<3	--	--
	11/5/1997	--		451.73	32.00	41.00	33.93	417.80	63	0.5	<0.5	0.8	2.4	29	--	--
	2/18/1998	--		451.73	32.00	41.00	20.46	431.27	23,000	1,500	610	550	3,000	<120	--	--
	5/20/1998	--		451.73	32.00	41.00	23.84	427.89	50,000	4,400	1,900	1,400	80,000	<300	--	--
	7/30/1998	P		451.73	32.00	41.00	26.94	424.79	150	<0.5	<0.5	<0.5	1.6	<3	8.74	--
	10/29/1998	NP		451.73	32.00	41.00	32.58	419.15	<50	<0.5	<0.5	<0.5	1.8	<3	2.0	--
	3/16/1999	P		451.73	32.00	41.00	26.20	425.53	3,200	160	32	89	390	270	2.0	--
	5/5/1999	P		451.73	32.00	41.00	27.57	424.16	3,600	140	46	76	290	170	11.65	--
	8/26/1999	P		451.73	32.00	41.00	30.25	421.48	3,200	210	29	100	220	120	1.43	--
	12/3/1999	NP		451.73	32.00	41.00	32.70	419.03	53	<0.5	<0.5	<0.5	1	<3	2.12	--
	3/13/2000	P		451.73	32.00	41.00	24.45	427.28	<50	<0.5	<0.5	<0.5	<1	<3	5.81	--
	6/20/2000	--	b	451.73	32.00	41.00	--	--	67.4	3.88	<0.500	1.78	1.48	<2.50	--	--
	6/20/2000	P		451.73	32.00	41.00	27.79	423.94	356	40.1	7.17	11.9	22.7	<2.50	5.1	--
	8/31/2000	--		451.73	32.00	41.00	30.35	421.38	--	--	--	--	--	--	--	--
	2/9/2001	--		451.73	32.00	41.00	30.95	420.78	--	--	--	--	--	--	--	--
	9/17/2001	--		451.73	32.00	41.00	30.85	420.88	--	--	--	--	--	--	--	--
	1/21/2002	--		451.73	32.00	41.00	30.61	421.12	--	--	--	--	--	--	--	--
	7/19/2002	--		451.73	32.00	41.00	31.55	420.18	--	--	--	--	--	--	--	--
	1/15/2003	--		451.73	32.00	41.00	22.99	428.74	--	--	--	--	--	--	--	--
	7/9/2003	--		451.73	32.00	41.00	30.35	421.38	--	--	--	--	--	--	--	--
	02/19/2004	--		451.73	32.00	41.00	26.24	425.49	--	--	--	--	--	--	--	--
	08/04/2004	--		454.23	32.00	41.00	26.36	427.87	--	--	--	--	--	--	--	--
	01/18/2005	--		454.23	32.00	41.00	24.47	429.76	--	--	--	--	--	--	--	--
	07/15/2005	--		454.23	32.00	41.00	29.44	424.79	--	--	--	--	--	--	--	--

Table 1

Groundwater Elevation and Analytical Data

ARCO Service Station #0771
899 Rincon Ave., Livermore, CA

Well No.	Date	P/ NP	Footnotes/ Comments	TOC (ft MSL)	Top of Screen (ft bgs)	Bottom of Screen (ft bgs)	DTW (ft bgs)	GWE (ft MSL)	GRO/TPH-g (µg/L)	Benzene (µg/L)	Toluene (µg/L)	Ethyl-benzene (µg/L)	Total Xylenes (µg/L)	MTBE (µg/L)	DO (mg/L)	pH
MW-2	3/20/1995	--		449.49	30.00	38.00	20.27	429.22	54,000	2,600	1,600	1,200	7,600	--	--	--
	6/2/1995	--		449.49	30.00	38.00	22.32	427.17	37,000	2,200	800	980	4,800	--	--	--
	8/23/1995	--		449.49	30.00	38.00	25.69	423.80	65,000	1,100	310	840	3,000	<500	--	--
	12/4/1995	--		449.49	30.00	38.00	28.52	420.97	19,000	680	150	410	1,600	--	--	--
	2/20/1996	--		449.49	30.00	38.00	19.00	430.49	22,000	1,200	240	590	2,200	<300	--	--
	5/15/1996	--		449.49	30.00	38.00	20.03	429.46	25,000	1,200	240	610	2,100	<300	--	--
	8/13/1996	--		449.49	30.00	38.00	24.44	425.05	19,000	640	110	420	1,200	<300	--	--
	11/13/1996	--		449.49	30.00	38.00	28.42	421.07	15,000	260	52	220	640	<200	--	--
	3/26/1997	--		449.49	30.00	38.00	22.98	426.51	17,000	580	120	360	980	<120	--	--
	5/15/1997	--		449.49	30.00	38.00	25.40	424.09	18,000	420	63	340	730	<120	--	--
	8/26/1997	--		449.49	30.00	38.00	28.38	421.11	5,300	210	26	140	270	<120	--	--
	11/5/1997	--		449.49	30.00	38.00	31.93	417.56	560	42	2.6	7	9	<40	--	--
	2/18/1998	--		449.49	30.00	38.00	16.87	432.62	18,000	710	120	480	1,100	130	--	--
	5/20/1998	--		449.49	30.00	38.00	20.29	429.20	16,000	480	72	440	1,100	<120	--	--
	7/30/1998	P		449.49	30.00	38.00	23.51	425.98	9,700	240	33	210	490	<120	9.21	--
	10/29/1998	NP		449.49	30.00	38.00	30.08	419.41	58	<0.5	<0.5	<0.5	1.2	<3	1.0	--
	3/16/1999	P		449.49	30.00	38.00	23.22	426.27	4,700	120	13	90	220	60	2.0	--
	5/5/1999	P		449.49	30.00	38.00	24.05	425.44	5,500	58	7.1	58	98	17	9.09	--
	8/26/1999	P		449.49	30.00	38.00	26.44	423.05	3,700	55	11	60	64	26	1.9	--
	12/3/1999	NP		449.49	30.00	38.00	30.15	419.34	130	<0.5	<0.5	0.7	1.8	<3	1.96	--
	3/13/2000	P		449.49	30.00	38.00	20.68	428.81	<50	<0.5	<0.5	<0.5	<1	<3	--	--
	6/20/2000	P		449.49	30.00	38.00	23.08	426.41	226	2.2	<0.500	4.83	7.88	<2.50	4.9	--
	8/31/2000	P		449.49	30.00	38.00	26.71	422.78	87.1	1.78	<0.500	1.33	1.15	<2.50	1.59	--
	2/9/2001	--		449.49	30.00	38.00	29.65	419.84	--	--	--	--	--	--	--	--
	9/17/2001	P		449.49	30.00	38.00	27.62	421.87	3,100	300	12	8.8	18	120	1.7	--
	1/21/2002	--		449.49	30.00	38.00	27.09	422.40	--	--	--	--	--	--	--	--
	7/19/2002	P	a	449.49	30.00	38.00	27.82	421.67	4,700	280	13	120	19	16	0.8	7.4
	1/15/2003	--		449.49	30.00	38.00	22.18	427.31	--	--	--	--	--	--	--	--
	7/9/2003	--		449.49	30.00	38.00	26.40	423.09	3,900	170	<5.0	100	19	39	2.5	7.0
	02/19/2004	--		449.49	30.00	38.00	23.85	425.64	--	--	--	--	--	--	--	--
	08/04/2004	P		452.05	30.00	38.00	24.71	427.34	5,400	650	21	160	56	78	0.80	7.2
	01/18/2005	--		452.05	30.00	38.00	20.86	431.19	--	--	--	--	--	--	--	--
	07/15/2005	P		452.05	30.00	38.00	25.92	426.13	5,200	160	5.3	56	10	46	3.10	6.9

Table 1

Groundwater Elevation and Analytical Data

ARCO Service Station #0771
899 Rincon Ave., Livermore, CA

Well No.	Date	P/ NP	Footnotes/ Comments	TOC (ft MSL)	Top of Screen (ft bgs)	Bottom of Screen (ft bgs)	DTW (ft bgs)	GWE (ft MSL)	GRO/ TPH-g (µg/L)	Benzene (µg/L)	Toluene (µg/L)	Ethyl-benzene (µg/L)	Total Xylenes (µg/L)	MTBE (µg/L)	DO (mg/L)	pH
MW-3	3/20/1995	--		450.28	32.00	40.00	22.19	428.09	94	<0.5	<0.5	<0.5	<0.5	--	--	--
	6/2/1995	--		450.28	32.00	40.00	23.28	427.00	72	<0.5	<0.5	<0.5	<0.5	--	--	--
	8/23/1995	--		450.28	32.00	40.00	26.55	423.73	98	<0.5	<0.5	<0.6	0.5	<3	--	--
	12/4/1995	--		450.28	32.00	40.00	29.52	420.76	<50	<0.5	<0.5	<0.5	<0.5	--	--	--
	2/20/1996	--		450.28	32.00	40.00	19.83	430.45	130	<0.5	<0.5	<0.5	<0.5	<3	--	--
	5/15/1996	--		450.28	32.00	40.00	21.03	429.25	120	<0.5	<0.5	<0.5	<0.5	<0.5	--	--
	8/13/1996	--		450.28	32.00	40.00	25.67	424.61	<50	<0.5	<0.5	<0.5	<0.5	<3	--	--
	11/13/1996	--		450.28	32.00	40.00	21.57	428.71	<50	<0.5	<0.5	<0.5	<0.5	<3	--	--
	3/26/1997	--		450.28	32.00	40.00	24.15	426.13	<50	1.1	<0.5	<0.5	<0.5	<3	--	--
	5/15/1997	--		450.28	32.00	40.00	26.85	423.43	<50	<0.5	<0.5	<0.5	<0.5	<3	--	--
	8/26/1997	--		450.28	32.00	40.00	30.07	420.21	<50	<0.5	<0.5	<0.5	<0.5	<3	--	--
	11/5/1997	--		450.28	32.00	40.00	32.46	417.82	<50	<0.5	0.7	<0.5	<0.5	<3	--	--
	2/18/1998	--		450.28	32.00	40.00	17.82	432.46	<50	<0.5	<0.5	<0.5	<0.5	<3	--	--
	5/20/1998	--		450.28	32.00	40.00	21.41	428.87	<50	<0.5	<0.5	<0.5	<0.5	<3	--	--
	7/30/1998	P		450.28	32.00	40.00	26.41	423.87	<50	<0.5	<0.5	<0.5	<0.5	<3	9.56	--
	10/29/1998	P		450.28	32.00	40.00	31.33	418.95	<50	<0.5	<0.5	<0.5	<0.5	<3	1.0	--
	3/16/1999	P		450.28	32.00	40.00	24.61	425.67	<50	<0.5	<0.5	<0.5	<0.5	<3	1.0	--
	5/5/1999	P		450.28	32.00	40.00	25.75	424.53	140	<0.5	<0.5	0.6	<0.5	<3	4.43	--
	8/26/1999	P		450.28	32.00	40.00	28.49	421.79	80	0.6	0.6	0.6	1	<3	1.69	--
	12/3/1999	P		450.28	32.00	40.00	31.45	418.83	<50	<0.5	<0.5	<0.5	<1	<3	2.26	--
	3/13/2000	P		450.28	32.00	40.00	22.18	428.10	<50	<0.5	<0.5	<0.5	<1	<3	4.41	--
	6/20/2000	P		450.28	32.00	40.00	26.03	424.25	<50.0	<0.500	<0.500	<0.500	<0.500	<2.50	2.3	--
	8/31/2000	--		450.28	32.00	40.00	28.75	421.53	--	--	--	--	--	--	--	--
	2/9/2001	--		450.28	32.00	40.00	31.04	419.24	--	--	--	--	--	--	--	--
	9/17/2001	--		450.28	32.00	40.00	29.04	421.24	--	--	--	--	--	--	--	--
	1/21/2002	--		450.28	32.00	40.00	28.81	421.47	--	--	--	--	--	--	--	--
	7/19/2002	--		450.28	32.00	40.00	28.92	421.36	--	--	--	--	--	--	--	--
	1/15/2003	--		450.28	32.00	40.00	22.88	427.40	--	--	--	--	--	--	--	--
	7/9/2003	--		450.28	32.00	40.00	28.00	422.28	--	--	--	--	--	--	--	--
	02/19/2004	--		450.28	32.00	40.00	25.29	424.99	--	--	--	--	--	--	--	--
	08/04/2004	--		452.75	32.00	40.00	27.40	425.35	--	--	--	--	--	--	--	--
	01/18/2005	--		452.75	32.00	40.00	22.76	429.99	--	--	--	--	--	--	--	--
	07/15/2005	--		452.75	32.00	40.00	25.95	426.80	--	--	--	--	--	--	--	--

Table 1
Groundwater Elevation and Analytical Data
 ARCO Service Station #0771
 899 Rincon Ave., Livermore, CA

Well No.	Date	P/ NP	Footnotes/ Comments	TOC (ft MSL)	Top of Screen (ft bgs)	Bottom of Screen (ft bgs)	DTW (ft bgs)	GWE (ft MSL)	GRO/TPH-g (µg/L)	Benzene (µg/L)	Toluene (µg/L)	Ethylbenzene (µg/L)	Total Xylenes (µg/L)	MTBE (µg/L)	DO (mg/L)	pH
MW-4	3/20/1995	--		451.09	26.00	42.00	22.68	428.41	12,000	1,000	100	450	700	--	--	--
	6/2/1995	--		451.09	26.00	42.00	24.41	426.68	9,000	850	56	380	430	--	--	--
	8/23/1995	--		451.09	26.00	42.00	27.72	423.37	5,300	400	25	240	170	<100	--	--
	12/4/1995	--		451.09	26.00	42.00	29.85	421.24	6,700	100	<10	90	38	--	--	--
	2/20/1996	--		451.09	26.00	42.00	21.16	429.93	7,000	360	22	180	160	<70	--	--
	5/15/1996	--		451.09	26.00	42.00	22.18	428.91	--	--	--	--	--	--	--	--
	8/13/1996	--		451.09	26.00	42.00	26.20	424.89	--	--	--	--	--	--	--	--
	11/13/1996	--		451.09	26.00	42.00	29.72	421.37	--	--	--	--	--	--	--	--
	3/26/1997	--		451.09	26.00	42.00	21.86	429.23	8,900	390	33	200	250	<70	--	--
	5/15/1997	--		451.09	26.00	42.00	26.92	424.17	--	--	--	--	--	--	--	--
	8/26/1997	--		451.09	26.00	42.00	29.30	421.79	--	--	--	--	--	--	--	--
	11/5/1997	--		451.09	26.00	42.00	32.14	418.95	--	--	--	--	--	--	--	--
	2/18/1998	--		451.09	26.00	42.00	19.30	431.79	5,300	220	19	160	130	120	--	--
	5/20/1998	--		451.09	26.00	42.00	22.40	428.69	--	--	--	--	--	--	--	--
	7/30/1998	--		451.09	26.00	42.00	25.74	425.35	--	--	--	--	--	--	--	--
	10/29/1998	--		451.09	26.00	42.00	31.26	419.83	--	--	--	--	--	--	--	--
	3/16/1999	P		451.09	26.00	42.00	25.05	426.04	1,900	49	<5	43	<5	82	1.5	--
	5/5/1999	--		451.09	26.00	42.00	26.15	424.94	--	--	--	--	--	--	--	--
	8/26/1999	--		451.09	26.00	42.00	28.60	422.49	--	--	--	--	--	--	1.43	--
	12/3/1999	--		451.09	26.00	42.00	31.53	419.56	--	--	--	--	--	--	--	--
	3/13/2000	P		451.09	26.00	42.00	23.61	427.48	<50	<0.5	<0.5	<0.5	<1	<3	3.82	--
	6/20/2000	--		451.09	26.00	42.00	26.38	424.71	--	--	--	--	--	--	0.4	--
	8/31/2000	NP		451.09	26.00	42.00	29.55	421.54	<50.0	<0.500	<0.500	<0.500	<0.500	<2.50	1.04	--
	2/9/2001	NP		451.09	26.00	42.00	30.30	420.79	<50.0	<0.500	<0.500	<0.500	<0.500	<2.50	1.39	--
	9/17/2001	NP		451.09	26.00	42.00	29.90	421.19	3,400	51	<5.0	16	23	360	0.92	--
	1/21/2002	NP		451.09	26.00	42.00	29.51	421.58	1,900	140	12	27	48	300	1.03	--
	7/19/2002	NP	a	451.09	26.00	42.00	30.77	420.32	2,700	150	9.9	<5.0	<5.0	130	1.0	7.3
	1/15/2003	--	a	451.09	26.00	42.00	23.56	427.53	4,800	150	5.3	28	46	150	1.3	7.0
	7/9/2003	--		451.09	26.00	42.00	29.50	421.59	3,000	210	9.4	6	20	150	2.0	6.9
	02/19/2004	P	c	451.09	26.00	42.00	26.35	424.74	4,800	270	11	25	19	180	1.80	6.2
	08/04/2004	NP		453.80	26.00	42.00	26.48	427.32	4,200	410	13	49	59	300	0.70	6.7
	01/18/2005	P		453.80	26.00	42.00	23.15	430.65	4,500	250	9.5	62	22	160	1.20	6.9
	07/15/2005	NP		453.80	26.00	42.00	28.13	425.67	3,500	230	6.1	19	15	230	0.50	7.0

Table 1
Groundwater Elevation and Analytical Data
 ARCO Service Station #0771
 899 Rincon Ave., Livermore, CA

Well No.	Date	P/ NP	Footnotes/ Comments	TOC (ft MSL)	Top of Screen (ft bgs)	Bottom of Screen (ft bgs)	DTW (ft bgs)	GWE (ft MSL)	GRO/ TPH-g (µg/L)	Benzene (µg/L)	Toluene (µg/L)	Ethyl-benzene (µg/L)	Total Xylenes (µg/L)	MTBE (µg/L)	DO (mg/L)	pH
MW-5	3/20/1995	--		451.40	31.50	41.00	23.20	428.20	26,000	1,300	180	890	2,900	--	--	--
	6/2/1995	--		451.40	31.50	41.00	24.80	426.60	39,000	940	160	740	1,900	--	--	--
	8/23/1995	--		451.40	31.50	41.00	28.10	423.30	14,000	490	74	250	890	<300	--	--
	12/4/1995	--		451.40	31.50	41.00	29.83	421.57	7,600	230	13	61	80	--	--	--
	2/20/1996	--		451.40	31.50	41.00	21.63	429.77	4,300	220	12	45	130	<50	--	--
	5/15/1996	--		451.40	31.50	41.00	22.87	428.53	2,200	380	17	58	84	<40	--	--
	8/13/1996	--		451.40	31.50	41.00	26.48	424.92	1,700	150	16	24	35	47	--	--
	11/13/1996	--		451.40	31.50	41.00	29.68	421.72	850	150	11	19	37	66	--	--
	3/26/1997	--		451.40	31.50	41.00	25.14	426.26	2,400	440	21	79	210	68	--	--
	5/15/1997	--		451.40	31.50	41.00	27.38	424.02	3,900	510	19	140	240	48	--	--
	8/26/1997	--		451.40	31.50	41.00	29.89	421.51	76	4.9	<0.5	1.5	2	9	--	--
	11/5/1997	--		451.40	31.50	41.00	32.57	418.83	63	0.8	<0.5	<0.5	1.2	34	--	--
	2/18/1998	--		451.40	31.50	41.00	19.99	431.41	6,200	630	70	320	640	320	--	--
	5/20/1998	--		451.40	31.50	41.00	23.21	428.19	2,300	340	21	110	140	62	--	--
	7/30/1998	P		451.40	31.50	41.00	26.19	425.21	<50	0.8	<0.5	0.6	0.9	<3	8.83	--
	10/29/1998	NP		451.40	31.50	41.00	31.92	419.48	<50	<0.5	<0.5	<0.5	<0.5	<3	2.0	--
	3/16/1999	P		451.40	31.50	41.00	25.80	425.60	1,300	170	8	59	65	120	2.0	--
	5/5/1999	P		451.40	31.50	41.00	27.09	424.31	320	31	1.1	13	13	19	12.09	--
	8/26/1999	P		451.40	31.50	41.00	29.67	421.73	260	13	1.7	4.2	6.3	150	1.31	--
	12/3/1999	--	d	451.40	31.50	41.00	--	--	--	--	--	--	--	--	--	--
	3/13/2000	P		451.40	31.50	41.00	24.51	426.89	<50	<0.5	<0.5	<0.5	<1	<3	4.41	--
	6/20/2000	P		451.40	31.50	41.00	27.37	424.03	60.8	4.84	<0.500	1.9	1.59	<2.50	5.3	--
	8/31/2000	P		451.40	31.50	41.00	30.21	421.19	<50.0	1.18	<0.500	<0.500	<0.500	3.83	0.97	--
	2/9/2001	--		451.40	31.50	41.00	30.19	421.21	--	--	--	--	--	--	--	--
	9/17/2001	P		451.40	31.50	41.00	30.71	420.69	2,700	120	10	90	77	330	0.81	--
	1/21/2002	--		451.40	31.50	41.00	30.40	421.00	--	--	--	--	--	--	--	--
	7/19/2002	P	a	451.40	31.50	41.00	31.93	419.47	1,600	170	7	120	<5.0	180	1.7	7.2
	1/15/2003	--		451.40	31.50	41.00	23.12	428.28	--	--	--	--	--	--	--	--
	7/9/2003	--		451.40	31.50	41.00	30.95	420.45	2,000	160	5.7	67	27	260	1.5	6.9
	02/19/2004	--		451.40	31.50	41.00	26.73	424.67	--	--	--	--	--	--	--	--
	08/04/2004	P		453.52	31.50	41.00	26.61	426.91	2,100	250	5.3	73	22	250	2.70	7.0
	01/18/2005	--		453.52	31.50	41.00	24.10	429.42	--	--	--	--	--	--	--	--
	07/15/2005	P		453.52	31.50	41.00	29.27	424.25	1,600	61	<5.0	8.7	<5.0	270	2.10	6.9

Table 1

Groundwater Elevation and Analytical Data

ARCO Service Station #0771
899 Rincon Ave., Livermore, CA

Well No.	Date	P/ NP	Footnotes/ Comments	TOC (ft MSL)	Top of Screen (ft bgs)	Bottom of Screen (ft bgs)	DTW (ft bgs)	GWE (ft MSL)	GRO/ TPH-g (µg/L)	Benzene (µg/L)	Toluene (µg/L)	Ethylbenzene (µg/L)	Total Xylenes (µg/L)	MTBE (µg/L)	DO (mg/L)	pH
MW-6	3/20/1995	--		451.37	32.00	42.00	25.19	426.18	2,600	210	87	82	140	--	--	--
	6/2/1995	--		451.37	32.00	42.00	25.75	425.62	1,600	55	7.9	40	26	--	--	--
	8/23/1995	--		451.37	32.00	42.00	29.53	421.84	1,400	42	2.5	36	13	<20	--	--
	12/4/1995	--		451.37	32.00	42.00	32.28	419.09	2,500	52	5.8	59	13	--	--	--
	2/20/1996	--		451.37	32.00	42.00	22.27	429.10	2,500	120	16	73	12	<30	--	--
	5/15/1996	--		451.37	32.00	42.00	23.86	427.51	2,000	71	6.4	47	25	<15	--	--
	8/13/1996	--		451.37	32.00	42.00	28.55	422.82	3,800	91	8.2	69	25	<20	--	--
	11/13/1996	--		451.37	32.00	42.00	32.04	419.33	1,900	55	3.3	55	8.5	16	--	--
	3/26/1997	--		451.37	32.00	42.00	26.84	424.53	1,800	51	5	32	15	<30	--	--
	5/15/1997	--		451.37	32.00	42.00	29.58	421.79	2,400	46	3	29	9	<12	--	--
	8/26/1997	--		451.37	32.00	42.00	32.67	418.70	1,400	61	6	33	10	<12	--	--
	11/5/1997	--		451.37	32.00	42.00	34.62	416.75	690	29	2.7	18	3.4	9	--	--
	2/18/1998	--		451.37	32.00	42.00	20.09	431.28	1,800	74	5	24	12	19	--	--
	5/20/1998	--		451.37	32.00	42.00	24.05	427.32	1,900	280	4	31	16	9	--	--
	7/30/1998	P		451.37	32.00	42.00	28.72	422.65	2,300	110	7	36	20	<15	--	--
	10/29/1998	P		451.37	32.00	42.00	32.77	418.60	2,500	14	13	17	12	<12	1.0	--
	3/16/1999	P		451.37	32.00	42.00	26.45	424.92	1,200	65	4	27	13	18	0.5	--
	5/5/1999	P		451.37	32.00	42.00	27.86	423.51	2,200	53	4	26	6	25	5.59	--
	8/26/1999	P		451.37	32.00	42.00	30.49	420.88	1,100	11	6	10	4	13	2.35	--
	12/3/1999	P		451.37	32.00	42.00	32.35	419.02	370	<0.5	<0.5	0.8	<1	4	2.36	--
	3/13/2000	P		451.37	32.00	42.00	28.36	423.01	54	2.1	0.5	0.9	1.4	<3	4.22	--
	6/20/2000	P		451.37	32.00	42.00	28.35	423.02	195	1.83	<0.500	0.528	<0.500	<2.50	3.5	--
	8/31/2000	P		451.37	32.00	42.00	30.20	421.17	276	3.52	0.788	1.15	0.621	8.73	7.0	--
	2/9/2001	--	b	451.37	32.00	42.00	--	--	222	4.49	2.73	0.579	0.523	57.1	--	--
	2/9/2001	P		451.37	32.00	42.00	30.70	420.67	253	5.44	2.93	0.924	0.977	48.9	0.59	--
	9/17/2001	--	b	451.37	32.00	42.00	--	--	<50	<0.50	<0.50	<0.50	<0.50	<2.5	--	--
	9/17/2001	P		451.37	32.00	42.00	30.94	420.43	<50	<0.50	<0.50	<0.50	<0.50	<2.5	2.79	--
	1/21/2002	P		451.37	32.00	42.00	30.55	420.82	<50	<0.50	<0.50	<0.50	<0.50	<5.0	1.9	--
	7/19/2002	P	a	451.37	32.00	42.00	30.27	421.10	60	2	<0.50	<0.50	<0.50	<0.50	3.5	7.9
	1/15/2003	--	a	451.37	32.00	42.00	22.86	428.51	83	9.1	<0.50	3.4	4.6	1	2.5	7.2
	7/9/2003	P		451.37	32.00	42.00	29.41	421.96	110	<0.50	<0.50	<0.50	<0.50	0.98	2.6	7.1
	02/19/2004	--		451.37	32.00	42.00	43.25	408.12	--	--	--	--	--	--	--	--
	08/04/2004	P		453.83	32.00	42.00	27.71	426.12	540	36	3.8	17	24	5.2	3.50	7.1
	01/18/2005	--		453.83	32.00	42.00	24.56	429.27	--	--	--	--	--	--	--	--

Table 1

Groundwater Elevation and Analytical Data

ARCO Service Station #0771
899 Rincon Ave., Livermore, CA

Well No.	Date	P/ NP	Footnotes/ Comments	TOC (ft MSL)	Top of Screen (ft bgs)	Bottom of Screen (ft bgs)	DTW (ft bgs)	GWE (ft MSL)	GRO/ TPH-g (µg/L)	Benzene (µg/L)	Toluene (µg/L)	Ethyl-benzene (µg/L)	Total Xylenes (µg/L)	MTBE (µg/L)	DO (mg/L)	pH
MW-6	07/15/2005	P		453.83	32.00	42.00	27.61	426.22	4,600	210	44	150	670	32	3.50	7.1
MW-7	3/20/1995	--		450.33	30.00	40.00	22.07	428.26	31,000	2,300	400	620	2,900	--	--	--
	6/2/1995	--		450.33	30.00	40.00	23.42	426.91	40,000	1,400	280	610	2,400	--	--	--
	8/23/1995	--		450.33	30.00	40.00	27.13	423.20	25,000	1,400	200	600	1,600	350	--	--
	12/4/1995	--		450.33	30.00	40.00	29.45	420.88	23,000	1,100	74	490	720	--	--	--
	2/20/1996	--		450.33	30.00	40.00	20.25	430.08	39,000	1,200	140	640	1,800	<400	--	--
	5/15/1996	--		450.33	30.00	40.00	21.38	428.95	--	--	--	--	--	--	--	--
	8/13/1996	--		450.33	30.00	40.00	25.52	424.81	--	--	--	--	--	--	--	--
	11/13/1996	--		450.33	30.00	40.00	29.38	420.95	--	--	--	--	--	--	--	--
	3/26/1997	--		450.33	30.00	40.00	24.36	425.97	35,000	1,100	180	460	1,700	<300	--	--
	5/15/1997	--		450.33	30.00	40.00	26.90	423.43	--	--	--	--	--	--	--	--
	8/26/1997	--		450.33	30.00	40.00	30.21	420.12	--	--	--	--	--	--	--	--
	11/5/1997	--		450.33	30.00	40.00	32.49	417.84	--	--	--	--	--	--	--	--
	2/18/1998	--		450.33	30.00	40.00	18.10	432.23	19,000	1,100	120	460	1,700	240	--	--
	5/20/1998	--		450.33	30.00	40.00	21.68	428.65	--	--	--	--	--	--	--	--
	7/30/1998	--		450.33	30.00	40.00	26.07	424.26	--	--	--	--	--	--	--	--
	10/29/1998	--		450.33	30.00	40.00	31.13	419.20	--	--	--	--	--	--	--	--
	3/16/1999	P		450.33	30.00	40.00	24.45	425.88	8,600	430	51	200	680	<120	1.5	--
	5/5/1999	--		450.33	30.00	40.00	25.84	424.49	--	--	--	--	--	--	--	--
	8/26/1999	--		450.33	30.00	40.00	28.28	422.05	--	--	--	--	--	--	1.51	--
	12/3/1999	--		450.33	30.00	40.00	31.57	418.76	--	--	--	--	--	--	--	--
	3/13/2000	--	d	450.33	30.00	40.00	--	--	--	--	--	--	--	--	--	--
	6/20/2000	--		450.33	30.00	40.00	25.91	424.42	--	--	--	--	--	--	5.4	--
	8/31/2000	--		450.33	30.00	40.00	28.40	421.93	8,410	344	58.9	276	581	202	0.09	--
	2/9/2001	--		450.33	30.00	40.00	30.04	420.29	2,030	203	12	17.9	49.4	128	1.55	--
	9/17/2001	P		450.33	30.00	40.00	29.03	421.30	4,800	200	14	9.9	27	160	0.29	--
	1/21/2002	--	b	450.33	30.00	40.00	--	--	2,600	280	17	41	50	97	--	--
	1/21/2002	P		450.33	30.00	40.00	28.98	421.35	4,200	350	20	52	63	99	0.81	--
	7/19/2002	P	a	450.33	30.00	40.00	28.70	421.63	5,700	630	31	330	160	64	0.7	7.3
	1/15/2003	--	a	450.33	30.00	40.00	21.91	428.42	12,000	470	19	340	310	91	1.5	7.0
	7/9/2003	P		450.33	30.00	40.00	27.88	422.45	6,700	590	23	280	92	110	1.0	6.9
	02/19/2004	P	c	450.33	30.00	40.00	25.12	425.21	8,900	670	24	470	120	100	0.80	6.6
	08/04/2004	P		452.70	30.00	40.00	25.92	426.78	9,100	930	29	460	130	140	0.60	7.2

Table 1

Groundwater Elevation and Analytical Data

ARCO Service Station #0771
899 Rincon Ave., Livermore, CA

Well No.	Date	P/ NP	Footnotes/ Comments	TOC (ft MSL)	Top of Screen (ft bgs)	Bottom of Screen (ft bgs)	DTW (ft bgs)	GWE (ft MSL)	GRO/ TPH-g (µg/L)	Benzene (µg/L)	Toluene (µg/L)	Ethyl-benzene (µg/L)	Total Xylenes (µg/L)	MTBE (µg/L)	DO (mg/L)	pH
MW-7	01/18/2005	P		452.70	30.00	40.00	22.31	430.39	16,000	770	33	590	220	87	1.0	6.9
	07/15/2005	P		452.70	30.00	40.00	27.20	425.50	12,000	1,000	38	490	220	150	1.50	6.9
MW-8	3/20/1995	--		449.43	27.50	42.50	24.75	424.68	<50	<0.5	<0.5	<0.5	<0.5	--	--	--
	6/2/1995	--		449.43	27.50	42.50	24.95	424.48	--	--	--	--	--	--	--	--
	8/23/1995	--		449.43	27.50	42.50	30.94	418.49	<50	<0.5	<0.5	<0.5	<0.5	<3	--	--
	12/4/1995	--		449.43	27.50	42.50	31.99	417.44	--	--	--	--	--	--	--	--
	2/20/1996	--		449.43	27.50	42.50	21.13	428.30	<50	<0.5	<0.5	<0.5	<0.5	<3	--	--
	5/15/1996	--		449.43	27.50	42.50	21.96	427.47	--	--	--	--	--	--	--	--
	8/13/1996	--		449.43	27.50	42.50	30.20	419.23	<50	<0.5	<0.5	<0.5	<0.5	<3	--	--
	11/13/1996	--		449.43	27.50	42.50	33.24	416.19	--	--	--	--	--	--	--	--
	3/26/1997	--		449.43	27.50	42.50	26.85	422.58	<50	<0.5	<0.5	<0.5	<0.5	<3	--	--
	5/15/1997	--		449.43	27.50	42.50	29.69	419.74	--	--	--	--	--	--	--	--
	8/26/1997	--		449.43	27.50	42.50	34.00	415.43	<50	<0.5	<0.5	<0.5	<0.5	<3	--	--
	11/5/1997	--		449.43	27.50	42.50	35.94	413.49	--	--	--	--	--	--	--	--
	2/18/1998	--		449.43	27.50	42.50	18.18	431.25	<50	0.6	0.6	<0.5	1.1	<3	--	--
	5/20/1998	--		449.43	27.50	42.50	22.85	426.58	--	--	--	--	--	--	--	--
	7/30/1998	NP		449.43	27.50	42.50	30.31	419.12	<50	<0.5	<0.5	<0.5	<0.5	<3	8.21	--
	10/29/1998	--		449.43	27.50	42.50	35.88	413.55	--	--	--	--	--	--	--	--
	3/16/1999	NP		449.43	27.50	42.50	28.50	420.93	<50	<0.5	<0.5	<0.5	<0.5	<3	1.0	--
	5/5/1999	--		449.43	27.50	42.50	29.76	419.67	--	--	--	--	--	--	--	--
	8/26/1999	P		449.43	27.50	42.50	33.51	415.92	<50	<0.5	<0.5	<0.5	<0.5	<3	4.93	--
	12/3/1999	--		449.43	27.50	42.50	35.83	413.60	--	--	--	--	--	--	--	--
3/13/2000	P		449.43	27.50	42.50	26.12	423.31	<50	<0.5	<0.5	<0.5	<1	<3	2.81	--	
6/20/2000	--		449.43	27.50	42.50	30.91	418.52	--	--	--	--	--	--	5.8	--	
8/31/2000	--		449.43	27.50	42.50	33.70	415.73	--	--	--	--	--	--	--	--	
2/9/2001	--		449.43	27.50	42.50	30.90	418.53	--	--	--	--	--	--	--	--	
9/17/2001	--		449.43	27.50	42.50	33.95	415.48	--	--	--	--	--	--	--	--	
1/21/2002	--		449.43	27.50	42.50	33.71	415.72	--	--	--	--	--	--	--	--	
7/19/2002	--		449.43	27.50	42.50	35.30	414.13	--	--	--	--	--	--	--	--	
1/15/2003	--		449.43	27.50	42.50	27.10	422.33	--	--	--	--	--	--	--	--	
7/9/2003	--		449.43	27.50	42.50	33.10	416.33	--	--	--	--	--	--	--	--	
02/19/2004	--		449.43	27.50	42.50	28.92	420.51	--	--	--	--	--	--	--	--	
08/04/2004	--		449.43	27.50	42.50	34.28	417.52	--	--	--	--	--	--	--	--	

Table 1
Groundwater Elevation and Analytical Data
 ARCO Service Station #0771
 899 Rincon Ave., Livermore, CA

Well No.	Date	P/ NP	Footnotes/ Comments	TOC (ft MSL)	Top of Screen (ft bgs)	Bottom of Screen (ft bgs)	DTW (ft bgs)	GWE (ft MSL)	GRO/ TPH-g (µg/L)	Benzene (µg/L)	Toluene (µg/L)	Ethyl-benzene (µg/L)	Total Xylenes (µg/L)	MTBE (µg/L)	DO (mg/L)	pH	
MW-8	01/18/2005	--		451.80	27.50	42.50	26.76	425.04	--	--	--	--	--	--	--	--	
	07/15/2005	--		451.80	27.50	42.50	31.14	420.66	--	--	--	--	--	--	--	--	
MW-9	3/20/1995	--		449.21	29.50	39.50	19.11	430.10	<50	<0.5	<0.5	<0.5	<0.5	--	--	--	
	6/2/1995	--		449.21	29.50	39.50	21.23	427.98	--	--	--	--	--	--	--	--	
	8/23/1995	--		449.21	29.50	39.50	24.33	424.88	<50	<0.5	<0.5	<0.5	<0.5	<3	--	--	
	12/4/1995	--		449.21	29.50	39.50	27.90	421.31	--	--	--	--	--	--	--	--	
	2/20/1996	--		449.21	29.50	39.50	17.86	431.35	<50	<0.5	<0.5	<0.5	<0.5	<3	--	--	
	5/15/1996	--		449.21	29.50	39.50	18.69	430.52	--	--	--	--	--	--	--	--	
	8/13/1996	--		449.21	29.50	39.50	24.17	425.04	--	--	--	--	--	--	--	--	
	11/13/1996	--		449.21	29.50	39.50	28.01	421.20	--	--	--	--	--	--	--	--	
	3/26/1997	--		449.21	29.50	39.50	22.58	426.63	<50	<0.5	<0.5	<0.5	<0.5	<3	--	--	
	5/15/1997	--		449.21	29.50	39.50	25.12	424.09	--	--	--	--	--	--	--	--	
	8/26/1997	--		449.21	29.50	39.50	28.28	420.93	--	--	--	--	--	--	--	--	
	11/5/1997	--		449.21	29.50	39.50	31.18	418.03	--	--	--	--	--	--	--	--	
	2/18/1998	--		449.21	29.50	39.50	16.03	433.18	<50	0.6	0.5	<0.5	1	<3	--	--	
	5/20/1998	--		449.21	29.50	39.50	19.31	429.90	--	--	--	--	--	--	--	--	
	7/30/1998	--		449.21	29.50	39.50	24.90	424.31	--	--	--	--	--	--	--	--	
	10/29/1998	--		449.21	29.50	39.50	30.08	419.13	--	--	--	--	--	--	--	--	
	3/16/1999	P		449.21	29.50	39.50	22.68	426.53	<50	<0.5	<0.5	<0.5	<0.5	<3	1.0	--	
	5/5/1999	--		449.21	29.50	39.50	23.82	425.39	--	--	--	--	--	--	--	--	
	8/26/1999	--		449.21	29.50	39.50	26.57	422.64	--	--	--	--	--	--	5.08	--	
	12/3/1999	--	d	449.21	29.50	39.50	--	--	--	--	--	--	--	--	--	--	
	3/13/2000	P		449.21	29.50	39.50	25.62	423.59	<50	<0.5	<0.5	<0.5	<0.5	<1	<3	5.43	--
	6/20/2000	--		449.21	29.50	39.50	23.55	425.66	--	--	--	--	--	--	--	6.2	--
	8/31/2000	--		449.21	29.50	39.50	27.39	421.82	--	--	--	--	--	--	--	--	
2/9/2001	--		449.21	29.50	39.50	28.65	420.56	--	--	--	--	--	--	--	--		
9/17/2001	--		449.21	29.50	39.50	27.51	421.70	--	--	--	--	--	--	--	--		
1/21/2002	--		449.21	29.50	39.50	27.09	422.12	--	--	--	--	--	--	--	--		
7/19/2002	--		449.21	29.50	39.50	27.06	422.15	--	--	--	--	--	--	--	--		
1/15/2003	--		449.21	29.50	39.50	21.78	427.43	--	--	--	--	--	--	--	--		
7/9/2003	--		449.21	29.50	39.50	26.18	423.03	--	--	--	--	--	--	--	--		
02/19/2004	--		449.21	29.50	39.50	23.45	425.76	--	--	--	--	--	--	--	--		
08/04/2004	--		449.21	29.50	39.50	29.24	422.39	--	--	--	--	--	--	--	--		

Table 1

Groundwater Elevation and Analytical Data

ARCO Service Station #0771
899 Rincon Ave., Livermore, CA

Well No.	Date	P/ NP	Footnotes/ Comments	TOC (ft MSL)	Top of Screen (ft bgs)	Bottom of Screen (ft bgs)	DTW (ft bgs)	GWE (ft MSL)	GRO/ TPH-g (µg/L)	Benzene (µg/L)	Toluene (µg/L)	Ethyl-benzene (µg/L)	Total Xylenes (µg/L)	MTBE (µg/L)	DO (mg/L)	pH	
MW-9	01/18/2005	--		451.63	29.50	39.50	20.64	430.99	--	--	--	--	--	--	--	--	
	07/15/2005	--		451.63	29.50	39.50	25.72	425.91	--	--	--	--	--	--	--	--	
MW-10	3/20/1995	--		449.22	29.00	37.00	20.96	428.26	--	--	--	--	--	--	--	--	
	6/2/1995	--		449.22	29.00	37.00	22.15	427.07	--	--	--	--	--	--	--	--	
	8/23/1995	--		449.22	29.00	37.00	24.47	424.75	<50	<0.5	<0.5	<0.5	<0.5	<3	--	--	
	12/4/1995	--		449.22	29.00	37.00	26.97	422.25	--	--	--	--	--	--	--	--	
	2/20/1996	--		449.22	29.00	37.00	18.40	430.82	<50	<0.5	<0.5	<0.5	<0.5	<3	--	--	
	5/15/1996	--	d	449.22	29.00	37.00	--	--	--	--	--	--	--	--	--	--	
	8/13/1996	--		449.22	29.00	37.00	23.70	425.52	--	--	--	--	--	--	--	--	
	11/13/1996	--		449.22	29.00	37.00	27.15	422.07	--	--	--	--	--	--	--	--	
	3/26/1997	--		449.22	29.00	37.00	22.23	426.99	<50	<0.5	<0.5	<0.5	<0.5	<3	--	--	
	5/15/1997	--		449.22	29.00	37.00	24.57	424.65	--	--	--	--	--	--	--	--	
	8/26/1997	--		449.22	29.00	37.00	27.62	421.60	--	--	--	--	--	--	--	--	
	11/5/1997	--		449.22	29.00	37.00	30.79	418.43	--	--	--	--	--	--	--	--	
	2/18/1998	--	d	449.22	29.00	37.00	--	--	--	--	--	--	--	--	--	--	
	5/20/1998	--		449.22	29.00	37.00	--	--	--	--	--	--	--	--	--	--	
	7/30/1998	--		449.22	29.00	37.00	23.90	425.32	--	--	--	--	--	--	--	--	
	10/29/1998	--		449.22	29.00	37.00	30.55	418.67	--	--	--	--	--	--	--	--	
	3/16/1999	P		449.22	29.00	37.00	23.05	426.17	<50	<0.5	<0.5	<0.5	<0.5	<3	1.0	--	
	5/5/1999	--		449.22	29.00	37.00	24.00	425.22	--	--	--	--	--	--	--	--	
	8/26/1999	--		449.22	29.00	37.00	26.50	422.72	--	--	--	--	--	--	--	5.15	--
	12/3/1999	--		449.22	29.00	37.00	30.80	418.42	--	--	--	--	--	--	--	--	--
	3/13/2000	--	d	449.22	29.00	37.00	26.21	423.01	--	--	--	--	--	--	--	--	--
	6/20/2000	--		449.22	29.00	37.00	23.52	425.70	--	--	--	--	--	--	--	5.5	--
	8/31/2000	--		449.22	29.00	37.00	27.52	421.70	--	--	--	--	--	--	--	--	--
	2/9/2001	--		449.22	29.00	37.00	28.71	420.51	--	--	--	--	--	--	--	--	--
	9/17/2001	--		449.22	29.00	37.00	27.94	421.28	--	--	--	--	--	--	--	--	--
	1/21/2002	--		449.22	29.00	37.00	27.44	421.78	--	--	--	--	--	--	--	--	--
	7/19/2002	--		449.22	29.00	37.00	27.80	421.42	--	--	--	--	--	--	--	--	--
1/15/2003	--		449.22	29.00	37.00	23.09	426.13	--	--	--	--	--	--	--	--	--	
7/9/2003	--		449.22	29.00	37.00	26.87	422.35	--	--	--	--	--	--	--	--	--	
02/19/2004	--		449.22	29.00	37.00	23.39	425.83	--	--	--	--	--	--	--	--	--	
01/18/2005	--		449.22	29.00	37.00	21.40	430.25	--	--	--	--	--	--	--	--	--	

Table 1
Groundwater Elevation and Analytical Data
 ARCO Service Station #0771
 899 Rincon Ave., Livermore, CA

Well No.	Date	P/ NP	Footnotes/ Comments	TOC (ft MSL)	Top of Screen (ft bgs)	Bottom of Screen (ft bgs)	DTW (ft bgs)	GWE (ft MSL)	GRO/ TPH-g (µg/L)	Benzene (µg/L)	Toluene (µg/L)	Ethyl-benzene (µg/L)	Total Xylenes (µg/L)	MTBE (µg/L)	DO (mg/L)	pH
MW-10	07/15/2005	--		451.65	29.00	37.00	25.37	426.28	--	--	--	--	--	--	--	--
MW-11	3/20/1995	--		448.02	29.00	39.00	25.02	423.00	<50	<0.5	<0.5	<0.5	<0.5	--	--	--
	6/2/1995	--		448.02	29.00	39.00	23.82	424.20	--	--	--	--	--	--	--	--
	8/23/1995	--		448.02	29.00	39.00	30.15	417.87	<50	<0.5	<0.5	<0.5	<0.5	<3	--	--
	12/4/1995	--		448.02	29.00	39.00	31.63	416.39	--	--	--	--	--	--	--	--
	2/20/1996	--		448.02	29.00	39.00	20.94	427.08	<50	<0.5	<0.5	<0.5	<0.5	<3	--	--
	5/15/1996	--		448.02	29.00	39.00	23.03	424.99	--	--	--	--	--	--	--	--
	8/13/1996	--		448.02	29.00	39.00	29.19	418.83	<50	<0.5	<0.5	<0.5	<0.5	<3	--	--
	11/13/1996	--		448.02	29.00	39.00	31.96	416.06	--	--	--	--	--	--	--	--
	3/26/1997	--		448.02	29.00	39.00	26.61	421.41	<50	<0.5	<0.5	<0.5	<0.5	<3	--	--
	5/15/1997	--		448.02	29.00	39.00	29.39	418.63	--	--	--	--	--	--	--	--
	8/26/1997	--		448.02	29.00	39.00	33.47	414.55	<50	<0.5	<0.5	<0.5	<0.5	<3	--	--
	11/5/1997	--		448.02	29.00	39.00	35.12	412.90	--	--	--	--	--	--	--	--
	2/18/1998	--		448.02	29.00	39.00	18.03	429.99	<50	<0.5	<0.5	<0.5	1	<3	--	--
	5/20/1998	--		448.02	29.00	39.00	23.00	425.02	--	--	--	--	--	--	--	--
	7/30/1998	P		448.02	29.00	39.00	29.30	418.72	<50	<0.5	<0.5	<0.5	<0.5	<3	5.59	--
	10/29/1998	--		448.02	29.00	39.00	34.47	413.55	--	--	--	--	--	--	--	--
	3/16/1999	P		448.02	29.00	39.00	27.88	420.14	<50	<0.5	<0.5	<0.5	<0.5	<3	1.0	--
	5/5/1999	--		448.02	29.00	39.00	26.85	421.17	--	--	--	--	--	--	--	--
	8/26/1999	P		448.02	29.00	39.00	32.74	415.28	<50	<0.5	<0.5	<0.5	<0.5	<3	4.59	--
	12/3/1999	--		448.02	29.00	39.00	34.70	413.32	--	--	--	--	--	--	--	--
	3/13/2000	P		448.02	29.00	39.00	25.94	422.08	<50	<0.5	<0.5	<0.5	<1	<3	3.21	--
	6/20/2000	--		448.02	29.00	39.00	30.40	417.62	--	--	--	--	--	--	3.3	--
	8/31/2000	--	b	448.02	29.00	39.00	--	--	<50.0	<0.500	<0.500	<0.500	<0.500	<2.50	--	--
	8/31/2000	NP		448.02	29.00	39.00	32.68	415.34	<50.0	<0.500	<0.500	<0.500	<0.500	<2.50	0.4	--
	2/9/2001	--		448.02	29.00	39.00	31.17	416.85	--	--	--	--	--	--	--	--
	9/17/2001	NP		448.02	29.00	39.00	32.98	415.04	<50	<0.50	<0.50	<0.50	<0.50	<2.5	0.62	--
	1/21/2002	--		448.02	29.00	39.00	31.05	416.97	--	--	--	--	--	--	--	--
	7/19/2002	P		448.02	29.00	39.00	31.67	416.35	<50	<0.50	<0.50	<0.50	<0.50	<0.50	3.7	7.7
	1/15/2003	--		448.02	29.00	39.00	23.75	424.27	--	--	--	--	--	--	--	--
	7/9/2003	P		448.02	29.00	39.00	31.06	416.96	<50	<0.50	<0.50	<0.50	<0.50	<0.50	2.4	6.6
	02/19/2004	--		448.02	29.00	39.00	27.21	420.81	--	--	--	--	--	--	--	--
	08/04/2004	P		450.41	29.00	39.00	31.71	418.70	<50	<0.50	<0.50	<0.50	<0.50	<0.50	3.30	7.1

Table 1

Groundwater Elevation and Analytical Data

ARCO Service Station #0771
899 Rincon Ave., Livermore, CA

Well No.	Date	P/ NP	Footnotes/ Comments	TOC (ft MSL)	Top of Screen (ft bgs)	Bottom of Screen (ft bgs)	DTW (ft bgs)	GWE (ft MSL)	GRO/ TPH-g (µg/L)	Benzene (µg/L)	Toluene (µg/L)	Ethyl-benzene (µg/L)	Total Xylenes (µg/L)	MTBE (µg/L)	DO (mg/L)	pH
MW-11	01/18/2005	--		450.41	29.00	39.00	24.80	425.61	--	--	--	--	--	--	--	--
	07/15/2005	P		450.41	29.00	39.00	29.15	421.26	<50	<0.50	<0.50	<0.50	<0.50	<0.50	2.70	7.1
RW-1	3/20/1995	--		451.67	25.50	40.50	23.76	427.91	15,000	1,000	140	310	950	--	--	--
	6/2/1995	--		451.67	25.50	40.50	25.12	426.55	12,000	1,300	280	420	1,100	--	--	--
	8/23/1995	--		451.67	25.50	40.50	28.80	422.87	8,200	520	190	240	610	<50	--	--
	12/4/1995	--		451.67	25.50	40.50	31.15	420.52	2,600	140	59	83	210	--	--	--
	2/20/1996	--		451.67	25.50	40.50	21.45	430.22	6,300	410	160	180	650	<40	--	--
	5/15/1996	--		451.67	25.50	40.50	22.97	428.70	--	--	--	--	--	--	--	--
	8/13/1996	--		451.67	25.50	40.50	24.74	426.93	--	--	--	--	--	--	--	--
	11/13/1996	--		451.67	25.50	40.50	30.69	420.98	--	--	--	--	--	--	--	--
	3/26/1997	--		451.67	25.50	40.50	25.69	425.98	500	57	3	6.4	18	54	--	--
	5/15/1997	--		451.67	25.50	40.50	28.19	423.48	--	--	--	--	--	--	--	--
	8/26/1997	--		451.67	25.50	40.50	31.21	420.46	--	--	--	--	--	--	--	--
	11/5/1997	--		451.67	25.50	40.50	33.67	418.00	--	--	--	--	--	--	--	--
	2/18/1998	--		451.67	25.50	40.50	20.14	431.53	9,400	200	70	190	710	<60	--	--
	5/20/1998	--		451.67	25.50	40.50	23.43	428.24	--	--	--	--	--	--	--	--
	7/30/1998	--		451.67	25.50	40.50	27.42	424.25	--	--	--	--	--	--	--	--
	10/29/1998	--		451.67	25.50	40.50	32.47	419.20	--	--	--	--	--	--	--	--
	3/16/1999	NP		451.67	25.50	40.50	25.45	426.22	1,100	140	19	45	83	530	1.0	--
	5/5/1999	--		451.67	25.50	40.50	27.23	424.44	--	--	--	--	--	--	--	--
	8/26/1999	--		451.67	25.50	40.50	29.98	421.69	--	--	--	--	--	--	1.39	--
	12/3/1999	--		451.67	25.50	40.50	32.38	419.29	--	--	--	--	--	--	--	--
	3/13/2000	NP		451.67	25.50	40.50	25.53	426.14	1,100	130	3.5	0.7	95	230	4.43	--
	6/20/2000	--		451.67	25.50	40.50	28.31	423.36	--	--	--	--	--	--	1.9	--
	8/31/2000	NP		451.67	25.50	40.50	30.61	421.06	<50.0	<0.500	<0.500	<0.500	<0.500	82.5	3.21	--
2/9/2001	NP		451.67	25.50	40.50	31.14	420.53	<50.0	<0.500	<0.500	<0.500	<0.500	<2.50	0.84	--	
9/17/2001	NP		451.67	25.50	40.50	31.70	419.97	<50	<0.50	<0.50	<0.50	<0.50	<2.5	1.51	--	
1/21/2002	NP		451.67	25.50	40.50	30.15	421.52	<50	7.7	<0.50	<0.50	1.5	18	0.63	--	
7/19/2002	NP		451.67	25.50	40.50	31.15	420.52	<50	<0.50	<0.50	<0.50	<0.50	13	1.4	6.6	
1/15/2003	--	a	451.67	25.50	40.50	22.20	429.47	860	9	1.6	17	42	1.5	2.8	7.2	
7/9/2003	--		451.67	25.50	40.50	29.56	422.11	<50	<0.50	<0.50	<0.50	<0.50	<0.50	1.8	7.1	
02/19/2004	NP	c	451.67	26.50	40.50	23.53	428.14	<50	<0.50	<0.50	<0.50	<0.50	<0.50	2.40	6.7	
08/04/2004	P		454.11	25.50	40.50	22.45	431.66	600	<0.50	<0.50	3.3	3.4	<0.50	4.40	7.2	

Table 1

Groundwater Elevation and Analytical Data

ARCO Service Station #0771
899 Rincon Ave., Livermore, CA

Well No.	Date	P/ NP	Footnotes/ Comments	TOC (ft MSL)	Top of Screen (ft bgs)	Bottom of Screen (ft bgs)	DTW (ft bgs)	GWE (ft MSL)	GRO/ TPH-g (µg/L)	Benzene (µg/L)	Toluene (µg/L)	Ethyl-benzene (µg/L)	Total Xylenes (µg/L)	MTBE (µg/L)	DO (mg/L)	pH
RW-1	01/18/2005	P		454.11	25.50	40.50	23.57	430.54	1,400	8.0	1.9	22	68	<0.50	3.60	6.9
	07/15/2005	NP		454.11	25.50	40.50	29.02	425.09	<50	<0.50	<0.50	<0.50	<0.50	2.0	1.10	7.8
VW-1	8/31/2000	P		--	18.50	28.50	20.61	--	<50.0	<0.500	<0.500	<0.500	<0.500	<2.50	10.08	--
	2/9/2001	P		--	18.50	28.50	22.10	--	<50.0	<0.500	<0.500	<0.500	<0.500	<2.50	0.53	--
	9/17/2001	P		--	18.50	28.50	21.99	--	<50	<0.50	<0.50	<0.50	<0.50	<2.5	6.59	--
	1/21/2002	P		--	18.50	28.50	21.50	--	<50	<0.50	<0.50	<0.50	<0.50	<5.0	0.7	--
	7/19/2002	P		--	18.50	28.50	22.42	--	<50	<0.50	<0.50	<0.50	<0.50	<0.50	4.9	7.1
	1/15/2003	--		--	18.50	28.50	22.59	--	<50	<0.50	<0.50	0.63	1.7	<0.50	5.4	7.2
	7/9/2003	--		--	18.50	28.50	22.50	--	<50	<0.50	<0.50	<0.50	0.61	<0.50	2.0	7.0
	02/19/2004	--		--	18.50	28.50	21.04	--	--	--	--	--	--	--	--	--
	08/04/2004	P		453.29	18.50	28.50	20.48	432.81	<50	<0.50	<0.50	<0.50	<0.50	<0.50	5.70	7.0
	01/18/2005	--		453.29	18.50	28.50	21.72	431.57	--	--	--	--	--	--	--	--
	07/15/2005	P		453.29	18.50	28.50	22.50	430.79	<50	<0.50	<0.50	<0.50	<0.50	<0.50	5.10	7.4

Table 1

Groundwater Elevation and Analytical Data

ARCO Service Station #0771
899 Rincon Ave., Livermore, CA

SYMBOLS AND ABBREVIATIONS:

-- = Not analyzed/applicable/sampled/measured
< = Not detected at or above the laboratory detection limit
DO = Dissolved Oxygen
DTW = Depth to water
ft bgs = feet below ground surface
ft MSL = feet above mean sea level
GRO = Gasoline range organics, range C4-C12
GWE = Groundwater elevation
µg/L = Micrograms per liter
mg/L = Milligrams per liter
MTBE = Methyl tert-butyl ether
NP = Not purged before sampling
P = Purged before sampling
TPH-g = Total petroleum hydrocarbons as gasoline
TOC = Top of casing

FOOTNOTES:

a = Chromatogram Pattern: Gasoline C6-C10
b = Duplicate sample
c = GRO analyzed by EPA Method 8015B modified
d = Well inaccessible

NOTES:

For previous historical groundwater elevation and analytical data please refer to Fourth Quarter 1995 Groundwater Monitoring Program Results and Remediation System Performance Evaluation Report, ARCO Service Station 771, Livermore, California, (EMCON, March 1, 1996).

Please note that beginning in the Fourth Quarter 2003, the laboratory modified the reported analyte list. TPH-g has been changed to GRO. The resulting data may be impacted by the potential inclusion of non-TPH-g analytes within the requested fuel range resulting in a higher concentration being reported.

All analytes unless otherwise notes utilized EPA Method 8260B, EPA method 8015B modified prior to 1/15/03, and EPA method 8020 prior to 12/03/99.

Site wells were resurveyed to NAVD '88 datum on March 8, 2004.

Top of screen and bottom of screen depths for MW-3 and MW-6 are estimated from cross-sections.

The data within this table collected prior to July 2002 was provided to URS by BP RM and their previous consultants. URS has not verified the accuracy of this information.

Table 2

Fuel Additives Analytical Data

ARCO Service Station #0771
899 Rincon Ave., Livermore, CA

Well Number	Date Sampled	Ethanol (µg/L)	TBA (µg/L)	MTBE (µg/L)	DIPE (µg/L)	ETBE (µg/L)	TAME (µg/L)	1,2-DCA (µg/L)	EDB (µg/L)	Footnotes/ Comments
MW-2	7/9/2003	<1,000	<200	39	<5.0	<5.0	<5.0	<5.0	<5.0	
	08/04/2004	<2,000	<400	78	<10	<10	<10	<10	<10	
	07/15/2005	<500	120	46	<2.5	<2.5	<2.5	<2.5	<2.5	
MW-4	7/9/2003	<1,000	750	150	<5.0	<5.0	<5.0	<5.0	<5.0	
	02/19/2004	<1,000	630	180	<10	<10	<10	<5.0	<5.0	
	08/04/2004	<2,000	1,300	300	<10	<10	<10	<10	<10	
	01/18/2005	<1,000	630	160	<5.0	<5.0	<5.0	<5.0	<5.0	a
	07/15/2005	<1,000	850	230	<5.0	<5.0	<5.0	<5.0	<5.0	
MW-5	7/9/2003	<1,000	1,100	260	<5.0	<5.0	<5.0	<5.0	<5.0	
	08/04/2004	<1,000	850	250	<5.0	<5.0	<5.0	<5.0	<5.0	
	07/15/2005	<1,000	720	270	<5.0	<5.0	<5.0	<5.0	<5.0	
MW-6	7/9/2003	<100	<20	0.98	<0.50	<0.50	<0.50	<0.50	<0.50	
	08/04/2004	<100	<20	5.2	<0.50	<0.50	<0.50	<0.50	<0.50	
	07/15/2005	<500	110	32	<2.5	<2.5	<2.5	<2.5	<2.5	
MW-7	7/9/2003	<1,000	350	110	<5.0	<5.0	<5.0	<5.0	<5.0	
	02/19/2004	<1,000	420	100	<10	<10	<10	<5.0	<5.0	
	08/04/2004	<5,000	<1,000	140	<25	<25	<25	<25	<25	
	01/18/2005	<1,000	260	87	<5.0	<5.0	<5.0	<5.0	<5.0	a
	07/15/2005	<5,000	<1,000	150	<25	<25	<25	<25	<25	
MW-11	7/9/2003	<100	<20	<0.50	<0.50	<0.50	<0.50	<0.50	<0.50	
	08/04/2004	<100	<20	<0.50	<0.50	<0.50	<0.50	<0.50	<0.50	
	07/15/2005	<100	<20	<0.50	<0.50	<0.50	<0.50	<0.50	<0.50	
RW-1	7/9/2003	<100	<20	<0.50	<0.50	<0.50	<0.50	<0.50	<0.50	
	02/19/2004	<100	<20	<0.50	<1.0	<1.0	<1.0	<0.50	<0.50	
	08/04/2004	<100	<20	<0.50	<0.50	<0.50	<0.50	<0.50	<0.50	
	01/18/2005	<100	<20	<0.50	<0.50	<0.50	<0.50	<0.50	<0.50	a
	07/15/2005	<100	<20	2.0	<0.50	<0.50	<0.50	<0.50	<0.50	
VW-1	7/9/2003	<100	<20	<0.50	<0.50	<0.50	<0.50	<0.50	<0.50	
	08/04/2004	<100	<20	<0.50	<0.50	<0.50	<0.50	<0.50	<0.50	
	07/15/2005	<100	<20	<0.50	<0.50	<0.50	<0.50	<0.50	<0.50	

Table 2

Fuel Additives Analytical Data

ARCO Service Station #0771
899 Rincon Ave., Livermore, CA

SYMBOLS AND ABBREVIATIONS:

< = Not detected at or above the laboratory reporting limit
1,2-DCA = 1,2 Di-chloroethane
DIPE = Di-isopropyl ether
EDB = Ethyl tert-butyl ether
ETBE = Ethyl tert butyl ether
MTBE = Methyl tert-butyl ether
ug/L = micrograms per liter
TAME = tert-Amyl methyl ether
TBA = tert-Butyl alcohol

FOOTNOTES:

a = Calibration verification is within the method limits but outside the contract limits for ethanol.

Table 3
Groundwater Gradient Data
 ARCO Service Station #0771
 899 Rincon Ave., Livermore, CA

Date Sampled	Approximate Flow Direction	Approximate Hydraulic Gradient
3/20/1995	Northwest	0.030
6/2/1995	North-Northwest	0.014
8/23/1995	North-Northwest	0.030
12/4/1995	North-Northwest	0.030
2/20/1996	Northwest	0.016
5/15/1996	Northwest	0.024
8/13/1996	North-Northwest	0.030
11/13/1996	North-Northwest	0.031
3/26/1997	North-Northwest	0.044
5/15/1997	North-Northwest	0.031
8/26/1997	North-Northwest	0.042
11/5/1997	North-Northwest	0.030
2/18/1998	Northwest	0.010
5/20/1998	Northwest	0.030
7/30/1998	North	0.040
10/29/1998	North	0.005
3/16/1999	North-Northwest	0.030
5/5/1999	North	0.040
8/26/1999	North-Northwest	0.050
12/3/1999	North-Northeast	0.060
3/13/2000	North-Northwest	0.066
6/20/2000	North-Northwest	0.050
8/31/2000	North-Northwest	0.062
2/9/2001	North-Northeast	0.014
9/17/2001	North-Northwest	0.061
1/21/2002	North-Northwest	0.050
7/19/2002	North-Northwest	0.044
1/15/2003	Northeast to Southeast	0.038 - 0.016
7/9/2003	Northwest to North-Northwest	0.009 - 0.063
2/19/2004	North	0.044
8/4/2004	Northeast	0.071
1/18/2005	North-Northeast	0.04
7/15/2005	Northeast and Southwest	0.05 and 0.02

The data within this table collected prior to July 2002 was provided to URS by BP Remediation Management and their previous consultants. URS has not verified the accuracy of this information.

ATTACHMENT A
FIELD PROCEDURES AND FIELD DATA SHEETS

FIELD PROCEDURES

Sampling Procedures

The sampling procedure for each well consists first of measuring the water level and depth to bottom, and checking for the presence of free phase petroleum product (free product), using either an electronic indicator and a clear TeflonTM bailer or an oil-water interface probe. Wells not containing free product are purged approximately three casing volumes of water (or until dewatered) using a centrifugal pump, gas displacement pump, or bailer. Equipment and purging method used for the current sampling event is noted on the attached field data sheets. During purging, temperature, pH, and electrical conductivity are monitored to document that these parameters are stable prior to collecting samples. After purging, water levels are allowed to partially (approximately 80%) recover. Groundwater samples (both purge and no purge) are collected using a Teflon bailer, placed into appropriate Environmental Protection Agency- (EPA) approved containers, labeled, logged onto chain-of-custody records, and transported on ice to a California State-certified laboratory. Wells with free product are not sampled and free product is removed according to California Code of Regulation, Title 23, Div. 3, Chap. 16, Section 2655, UST Regulations.

WELL GAUGING DATA

Project # 050715-MD3 Date 7/15/05 Client ARCO 771

Site 899 Rincon Ave., Livermore

Well ID	Well Size (in.)	Sheen / Odor	Depth to Immiscible Liquid (ft.)	Thickness of Immiscible Liquid (ft.)	Volume of Immiscibles Removed (ml)	Depth to water (ft.)	Depth to well bottom (ft.)	Survey Point: TOB or TOC
¹⁰⁵³ MW-1	4					25.92 29.44	36.65	9
MW-2	4					25.92	33.79	
MW-3	4					25.95	38.60	9
MW-4	4					28.13	-	N/A 26'
MW-5	4					29.27	40.00	
MW-6	4					27.61	43.18	
MW-7	4					27.20	39.59	
MW-8	2					31.14	41.40	9
MW-9	2					25.72	38.95	9
MW-10	2					25.37	34.00	9
MW-11	2					29.15	38.50	
RW-1	6					29.02	-	N/A 25.5'
VW-1	4					22.50	28.65	↓

ARCO / BP WELL MONITORING DATA SHEET

BTS #: <u>050715-M03</u>	Station # <u>771</u>
Sampler: <u>mg</u>	Date: <u>7/15/05</u>
Well I.D.: <u>MW-5</u>	Well Diameter: 2 3 <u>4</u> 6 8 <u> </u>
Total Well Depth: <u>40.00</u>	Depth to Water: <u>29.27</u>
Depth to Free Product:	Thickness of Free Product (feet):
Referenced to: <u>PVC</u> Grade	D.O. Meter (if req'd): <u>YSI</u> HACH

Well Diameter	Multiplier	Well Diameter	Multiplier
1"	0.04	4"	0.65
2"	0.16	6"	1.47
3"	0.37	Other	radius ² * 0.163

Purge Method: <u>Bailer</u>	Sampling Method: <u>Bailer</u>
<u>Disposible Bailer</u>	Disposible Bailer
<u>Positive Air Displacement</u>	<u>Extraction Port</u>
<u>Electric Submersible</u>	Other: _____
<u>Extraction Pump</u>	
Other: _____	

Top of Screen: _____ If well is listed as a no-purge, confirm that water level is below the top of screen. Otherwise, the well must be purged.

<u>7</u>	x	<u>3</u>	=	<u>21</u>	Gals.
1 Case Volume (Gals.)		Specified Volumes		Calculated Volume	

Time	Temp (°F)	pH	Conductivity (mS or μ S)	Gals. Removed	Observations
<u>1538</u>	<u>72.7</u>	<u>7.0</u>	<u>1054</u>	<u>7</u>	<u>clear, odor</u>
<u>1540</u>	<u>71.8</u>	<u>6.9</u>	<u>1071</u>	<u>14</u>	<u>" "</u>
<u>1542</u>	<u>71.9</u>	<u>6.9</u>	<u>1095</u>	<u>21</u>	<u>clear, odor</u>

Did well dewater? Yes <input type="checkbox"/> No <input checked="" type="checkbox"/>	Gallons actually evacuated: <u>21</u>
Sampling Time: <u>1545</u>	Sampling Date: <u>7/15/05</u>
Sample I.D.: <u>MW-5</u>	Laboratory: Pace <u>Sequora</u> Other _____
Analyzed for: GRO BTEX MTBE DRO	Other: <u>SC=SCDP</u>
D.O. (if req'd):	Pre-purge: _____ mg/L
	Post-purge: <u>2.1</u> mg/L
O.R.P. (if req'd):	Pre-purge: _____ mV
	Post-purge: _____ mV

ARCO / BP WELL MONITORING DATA SHEET

BTS #: <u>050715-MD3</u>	Station # <u>771</u>
Sampler: <u>MMU</u>	Date: <u>7/15/05</u>
Well I.D.: <u>MMU-6</u>	Well Diameter: 2 3 <u>4</u> 6 8 <u> </u>
Total Well Depth: <u>43.18</u>	Depth to Water: <u>27.61</u>
Depth to Free Product: <u> </u>	Thickness of Free Product (feet): <u> </u>
Referenced to: <u>PVC</u> Grade	D.O. Meter (if req'd): <u>YS</u> HACH

Well Diameter	Multiplier	Well Diameter	Multiplier
1"	0.04	4"	0.65
2"	0.16	6"	1.47
3"	0.37	Other	radius ² * 0.163

Purge Method: <u>Bailer</u> Disposable Bailer Positive Air Displacement <u>Electric Submersible</u> Extraction Pump Other: <u> </u>	Sampling Method: <u>Bailer</u> <u>Disposable Bailer</u> Extraction Port Other: <u> </u>
---	---

Top of Screen: If well is listed as a no-purge, confirm that water level is below the top of screen. Otherwise, the well must be purged.

<u>10.1</u>	x	<u>3</u>	=	<u>30.3</u>	Gals.
1 Case Volume (Gals.)		Specified Volumes		Calculated Volume	

Time	Temp (°F)	pH	Conductivity (mS or <u>µS</u>)	Gals. Removed	Observations
<u>1513</u>	<u>70.9</u>	<u>7.3</u>	<u>711</u>	<u>10.5</u>	<u>clear</u>
<u>1515</u>	<u>69.9</u>	<u>7.2</u>	<u>777</u>	<u>20.5</u>	<u> </u>
<u>1520</u>	<u>70.9</u>	<u>7.1</u>	<u>835</u>	<u>30.5</u>	<u>clear, odor</u>

Did well dewater? Yes <u> </u> No <u> </u>	Gallons actually evacuated: <u>30.5</u>	
Sampling Time: <u>1525</u>	Sampling Date: <u>7/15/05</u>	
Sample I.D.: <u>MMU-6</u>	Laboratory: Pace <u>Sequon</u> Other <u> </u>	
Analyzed for: GRO BTEX MTBE DRO Other: <u>SeScope</u>		
D.O. (if req'd):	Pre-purge: <u> </u> mg/L	Post-purge: <u>3.5</u> mg/L
O.R.P. (if req'd):	Pre-purge: <u> </u> mV	Post-purge: <u> </u> mV

ARCO / BP WELL MONITORING DATA SHEET

BTS #: <u>050715-MW 3</u>	Station # <u>771</u>
Sampler: <u>mw</u>	Date: <u>7/15/05</u>
Well I.D.: <u>MW-7</u>	Well Diameter: 2 3 <u>6</u> 8
Total Well Depth: <u>39.59</u>	Depth to Water: <u>27.20</u>
Depth to Free Product:	Thickness of Free Product (feet):
Referenced to: <u>PVC</u> Grade	D.O. Meter (if req'd): <u>YST</u> HACH

Well Diameter	Multiplier	Well Diameter	Multiplier
1"	0.04	4"	0.65
2"	0.16	6"	1.47
3"	0.37	Other	radius ² * 0.163

Purge Method: <u>Bailer</u>	Sampling Method: <u>Bailer</u>
<input type="checkbox"/> Disposable Bailer <input type="checkbox"/> Positive Air Displacement <input checked="" type="checkbox"/> <u>Electric Submersible</u> <input type="checkbox"/> Extraction Pump Other: _____	<input checked="" type="checkbox"/> <u>Disposable Bailer</u> <input type="checkbox"/> Extraction Port Other: _____

Top of Screen: _____ If well is listed as a no-purge, confirm that water level is below the top of screen. Otherwise, the well must be purged.

<u>8.1</u>	x	<u>3</u>	=	<u>24.3</u>	Gals.
1 Case Volume (Gals.)		Specified Volumes		Calculated Volume	

Time	Temp (°F)	pH	Conductivity (mS or µS)	Gals. Removed	Observations
1601	72.8	7.1	1134	8.5	clear, odor
1603	71.8	6.9	1127	16.5	" "
				well dewatered @ 17	
1620	71.5	6.9	1115	-	clear, odor

Did well dewater? <input checked="" type="checkbox"/> Yes <input type="checkbox"/> No	Gallons actually evacuated: <u>17</u>	
Sampling Time: <u>1620</u>	Sampling Date: <u>7/15/05</u>	
Sample I.D.: <u>MW-7</u>	Laboratory: <u>Pace Sequoia</u> Other _____	
Analyzed for: GRO BTEX MTBE DRO	Other: <u>See Scope</u>	
D.O. (if req'd):	Pre-purge: _____ mg/L	Post-purge: <u>1.5</u> mg/L
O.R.P. (if req'd):	Pre-purge: _____ mV	Post-purge: _____ mV

ARCO / BP WELL MONITORING DATA SHEET

BTS #: <u>050715-MD3</u>	Station # <u>771</u>
Sampler: <u>Me</u>	Date: <u>7/15/05</u>
Well I.D.: <u>MW-11</u>	Well Diameter: <u>2</u> 3 4 6 8 _____
Total Well Depth: <u>3850</u>	Depth to Water: <u>2915</u>
Depth to Free Product:	Thickness of Free Product (feet):
Referenced to: <u>PVC</u> Grade	D.O. Meter (if req'd): <u>XSI</u> HACH

Well Diameter	Multiplier	Well Diameter	Multiplier
1"	0.04	4"	0.65
2"	0.16	6"	1.47
3"	0.37	Other	radius ² * 0.163

Purge Method: <input type="checkbox"/> Bailer <input checked="" type="checkbox"/> Disposable Bailer <input type="checkbox"/> Positive Air Displacement <input type="checkbox"/> Electric Submersible <input type="checkbox"/> Extraction Pump Other: _____	Sampling Method: <input type="checkbox"/> Bailer <input checked="" type="checkbox"/> Disposable Bailer <input type="checkbox"/> Extraction Port Other: _____
---	---

Top of Screen: _____ If well is listed as a no-purge, confirm that water level is below the top of screen. Otherwise, the well must be purged.

<u>1.5</u>	X	<u>3</u>	=	<u>4.5</u>	Gals.
1 Case Volume (Gals.)		Specified Volumes		Calculated Volume	

Time	Temp (°F)	pH	Conductivity (mS or <u>µS</u>)	Gals. Removed	Observations
<u>1423</u>	<u>74.9</u>	<u>7.5</u>	<u>856</u>	<u>1.5</u>	<u>cloudy</u>
<u>1426</u>	<u>71.6</u>	<u>7.1</u>	<u>861</u>	<u>3</u>	<u>1</u>
<u>1428</u>	<u>70.9</u>	<u>7.1</u>	<u>865</u>	<u>4.5</u>	<u>cloudy</u>

Did well dewater? Yes <input checked="" type="checkbox"/> No <input type="checkbox"/>	Gallons actually evacuated: <u>4.5</u>
Sampling Time: <u>1430</u>	Sampling Date: <u>7/15/05</u>
Sample I.D.: <u>MW-11</u>	Laboratory: Pace <u>Sequoia</u> Other _____
Analyzed for: GRO BTEX MTBE DRO	Other: <u>See Scope</u>
D.O. (if req'd):	Pre-purge: _____ mg/L
	Post-purge: <u>2.7</u> mg/L
O.R.P. (if req'd):	Pre-purge: _____ mV
	Post-purge: _____ mV

ARCO / BP WELL MONITORING DATA SHEET

BTS #: <u>50715-MD3</u>	Station # <u>771</u>
Sampler: <u>MM</u>	Date: <u>7/15/85</u>
Well I.D.: <u>RW-1</u>	Well Diameter: 2 3 4 <u>6</u> 8
Total Well Depth: <u>-</u>	Depth to Water: <u>29.02</u>
Depth to Free Product:	Thickness of Free Product (feet):
Referenced to: <u>PVC</u> Grade	D.O. Meter (if req'd): <u>YSI</u> HACH

Well Diameter	Multiplier	Well Diameter	Multiplier
1"	0.04	4"	0.65
2"	0.16	6"	1.47
3"	0.37	Other	radius ² * 0.163

Purge Method: <input type="checkbox"/> Bailer <input checked="" type="checkbox"/> Disposable Bailer <input type="checkbox"/> Positive Air Displacement <input type="checkbox"/> Electric Submersible <input type="checkbox"/> Extraction Pump Other: _____	Sampling Method: <input type="checkbox"/> Bailer <input checked="" type="checkbox"/> Disposable Bailer <input type="checkbox"/> Extraction Port Other: _____
---	---

Top of Screen: _____ If well is listed as a no-purge, confirm that water level is below the top of screen. Otherwise, the well must be purged.

$\frac{N @ 25x}{1 \text{ Case Volume (Gals.)}} = \text{Gals.}$
Specified Volumes = Calculated Volume

Time	Temp (°F)	pH	Conductivity (mS or μS)	Gals. Removed	Observations
1340	80.0	7.8	668	-	cloudy, orange

Did well dewater? Yes <input type="checkbox"/> No <input checked="" type="checkbox"/>	Gallons actually evacuated: <u>-</u>
Sampling Time: <u>1340</u>	Sampling Date: <u>7/15/85</u>
Sample I.D.: <u>RW-1</u>	Laboratory: Pace <u>Sequoia</u> Other _____
Analyzed for: GRO BTEX MTBE DRO Other: <u>See Scope</u>	
D.O. (if req'd):	Pre-purge: _____ mg/L
	<u>Post-purge:</u> <u>1.1</u> mg/L
O.R.P. (if req'd):	Pre-purge: _____ mV
	Post-purge: _____ mV

ARCO / BP WELL MONITORING DATA SHEET

BTS #: <u>050715-MD3</u>	Station # <u>771</u>
Sampler: <u>MW</u>	Date: <u>7/15/05</u>
Well I.D.: <u>VW-1</u>	Well Diameter: 2 3 <u>4</u> 6 8
Total Well Depth: <u>28.15</u>	Depth to Water: <u>22.50</u>
Depth to Free Product:	Thickness of Free Product (feet):
Referenced to: <u>PVE</u> Grade	D.O. Meter (if req'd): <u>YSI</u> HACH

Well Diameter	Multiplier	Well Diameter	Multiplier
1"	0.04	4"	0.65
2"	0.16	6"	1.47
3"	0.37	Other	radius ² * 0.163

Purge Method: Bailer Sampling Method: Bailer
 Disposable Bailer Disposable Bailer
 Positive Air Displacement Extraction Port
 Electric Submersible Other: _____
 Extraction Pump
Other: _____

Top of Screen: _____ If well is listed as a no-purge, confirm that water level is below the top of screen. Otherwise, the well must be purged.

<u>3.7</u>	x	<u>3</u>	=	<u>11.1</u>	Gals.
1 Case Volume (Gals.)		Specified Volumes		Calculated Volume	

Time	Temp (°F)	pH	Conductivity (mS or <u>µS</u>)	Gals. Removed	Observations
<u>1448</u>	<u>77.8</u>	<u>7.3</u>	<u>672</u>	<u>4</u>	<u>cloudy</u>
<u>1449</u>	<u>73.8</u>	<u>7.3</u>	<u>663</u>	<u>8</u>	<u>"</u>
	<u>well dewatered</u>			<u>8</u>	<u>DTW = 26.10</u>
<u>1615</u>	<u>75.0</u>	<u>7.4</u>	<u>687</u>	<u>-</u>	<u>clear DTW = 25.44</u> <u>@ site</u>

Did well dewater? Yes No Gallons actually evacuated: 8

Sampling Time: 1615 Sampling Date: 7/15/05

Sample I.D.: VW-1 Laboratory: Pace Sequoia Other _____

Analyzed for: GRO BTEX MTBE DRO Other: See Script

D.O. (if req'd):	Pre-purge:	mg/L	Post-purge:	mg/L
			<u>5.1</u>	
O.R.P. (if req'd):	Pre-purge:	mV	Post-purge:	mV

BP GEM OIL COMPANY TYPE **A** BILL OF LADING

SOURCE RECORD **BILL OF LADING** FOR NON-HAZARDOUS PURGEWATER RECOVERED FROM GROUNDWATER WELLS AT BP GEM OIL COMPANY FACILITIES IN THE STATE OF CALIFORNIA. THE NON-HAZARDOUS PURGE- WATER WHICH HAS BEEN RECOVERED FROM GROUND- WATER WELLS IS COLLECTED BY THE CONTRACTOR, MADE UP INTO LOADS OF APPROPRIATE SIZE AND HAULED BY DILLARD ENVIRONMENTAL TO THE ALTAMONT LANDFILL AND RESOURCE RECOVERY FACILITY IN LIVERMORE, CALIFORNIA.

The contractor performing this work is BLAINE TECH SERVICES, INC. (BTS), 1680 Rogers Avenue, San Jose, CA 95112 (phone [408] 573-0555). Blaine Tech Services, Inc. is authorized by BP GEM OIL COMPANY to recover, collect, apportion into loads the Non-Hazardous Well Purgewater that is drawn from wells at the BP GEM Oil Company facility indicated below and deliver that purgewater to BTS. Transport routing of the Non-Hazardous Well Purgewater may be direct from one BP GEM facility to the designated destination point; from one BP GEM facility to the designated destination point via another BP GEM facility; from a BP GEM facility to the designated destination point via the contractor's facility, or any combination thereof. The Non-Hazardous Well Purgewater is and remains the property of BP GEM Oil Company.

This **Source Record BILL OF LADING** was initiated to cover the recovery of Non-Hazardous Well Purgewater from wells at the BP GEM Oil Company facility described below:

77H

Station #

899 Rincon Ave., Livermore

Station Address

Total Gallons Collected From Groundwater Monitoring Wells:

added equip.
rinse water _____

any other
adjustments _____

TOTAL GALS.
RECOVERED 1000

loaded onto
BTS vehicle # 57

BTS event #

time date

050715-MD3 1700 7/15/07

signature

[Handwritten Signature]

REC'D AT

time date

BTS 1800 7/15/07

unloaded by
signature

[Handwritten Signature]

ATTACHMENT B
LABORATORY PROCEDURES,
CERTIFIED ANALYTICAL REPORTS,
AND CHAIN-OF-CUSTODY RECORDS

LABORATORY PROCEDURES

Laboratory Procedures

The groundwater samples were analyzed for the presence of the chemicals mentioned in the chain of custody using standard EPA methods. The methods of analysis for the groundwater samples are documented in the certified analytical report. The certified analytical reports and chain-of-custody record are presented in this attachment. The analytical data provided by the laboratory approved by Atlantic Richfield Company have been reviewed and verified by that laboratory.



**Sequoia
Analytical**

885 Jarvis Drive
Morgan Hill, CA 95037
(408) 776-9600
FAX (408) 782-6308
www.sequoialabs.com

8 August, 2005

Scott Robinson
URS Corporation [Arco]
1333 Broadway, Suite 800
Oakland, CA 94612

RE: ARCO #0771, Livermore, CA
Work Order: MOG0601

Enclosed are the results of analyses for samples received by the laboratory on 07/18/05 09:40. If you have any questions concerning this report, please feel free to contact me.

Sincerely,

Jamshid Kekobad
Project Manager

CA ELAP Certificate #1210

URS Corporation [Arco]
1333 Broadway, Suite 800
Oakland CA, 94612

Project: ARCO #0771, Livermore, CA
Project Number: G0C1M-0004
Project Manager: Scott Robinson

MOG0601
Reported:
08/08/05 08:48

ANALYTICAL REPORT FOR SAMPLES

Sample ID	Laboratory ID	Matrix	Date Sampled	Date Received
MW-2	MOG0601-01	Water	07/15/05 16:55	07/18/05 09:40
MW-4	MOG0601-02	Water	07/15/05 13:55	07/18/05 09:40
MW-5	MOG0601-03	Water	07/15/05 15:45	07/18/05 09:40
MW-6	MOG0601-04	Water	07/15/05 15:25	07/18/05 09:40
MW-7	MOG0601-05	Water	07/15/05 16:20	07/18/05 09:40
MW-11	MOG0601-06	Water	07/15/05 14:30	07/18/05 09:40
RW-1	MOG0601-07	Water	07/15/05 13:40	07/18/05 09:40
VW-1	MOG0601-08	Water	07/15/05 16:15	07/18/05 09:40
TB-771-07152005	MOG0601-09	Water	07/15/05 00:00	07/18/05 09:40

The carbon range for the TPH-GRO has been changed from C6-C10 to C4-C12. The carbon range for TPH-DRO has been changed from C10-C28 to C10-C36. EPA 8015B has been modified to better meet the requirements of California regulatory agencies. These samples were received with no custody seals.

URS Corporation [Arco]
1333 Broadway, Suite 800
Oakland CA, 94612

Project: ARCO #0771, Livermore, CA
Project Number: G0C1M-0004
Project Manager: Scott Robinson

MOG0601
Reported:
08/08/05 08:48

**Volatile Organic Compounds by EPA Method 8260B
Sequoia Analytical - Morgan Hill**

Analyte	Result	Reporting Limit	Units	Dilution	Batch	Prepared	Analyzed	Method	Notes
MW-2 (MOG0601-01) Water Sampled: 07/15/05 16:55 Received: 07/18/05 09:40									
tert-Amyl methyl ether	ND	2.5	ug/l	5	5G26008	07/26/05	07/27/05	EPA 8260B	
Benzene	160	2.5	"	"	"	"	"	"	
tert-Butyl alcohol	120	100	"	"	"	"	"	"	
Di-isopropyl ether	ND	2.5	"	"	"	"	"	"	
1,2-Dibromoethane (EDB)	ND	2.5	"	"	"	"	"	"	
1,2-Dichloroethane	ND	2.5	"	"	"	"	"	"	
Ethanol	ND	500	"	"	"	"	"	"	
Ethyl tert-butyl ether	ND	2.5	"	"	"	"	"	"	
Ethylbenzene	56	2.5	"	"	"	"	"	"	
Methyl tert-butyl ether	46	2.5	"	"	"	"	"	"	
Toluene	5.3	2.5	"	"	"	"	"	"	
Xylenes (total)	10	2.5	"	"	"	"	"	"	
Gasoline Range Organics (C4-C12)	5200	250	"	"	"	"	"	"	
<i>Surrogate: 1,2-Dichloroethane-d4</i>		<i>99 %</i>	<i>60-135</i>						
MW-4 (MOG0601-02) Water Sampled: 07/15/05 13:55 Received: 07/18/05 09:40									
tert-Amyl methyl ether	ND	5.0	ug/l	10	5G26008	07/26/05	07/27/05	EPA 8260B	
Benzene	230	5.0	"	"	"	"	"	"	
tert-Butyl alcohol	850	200	"	"	"	"	"	"	
Di-isopropyl ether	ND	5.0	"	"	"	"	"	"	
1,2-Dibromoethane (EDB)	ND	5.0	"	"	"	"	"	"	
1,2-Dichloroethane	ND	5.0	"	"	"	"	"	"	
Ethanol	ND	1000	"	"	"	"	"	"	
Ethyl tert-butyl ether	ND	5.0	"	"	"	"	"	"	
Ethylbenzene	19	5.0	"	"	"	"	"	"	
Methyl tert-butyl ether	230	5.0	"	"	"	"	"	"	
Toluene	6.1	5.0	"	"	"	"	"	"	
Xylenes (total)	15	5.0	"	"	"	"	"	"	
Gasoline Range Organics (C4-C12)	3500	500	"	"	"	"	"	"	
<i>Surrogate: 1,2-Dichloroethane-d4</i>		<i>94 %</i>	<i>60-135</i>						



1885 Jarvis Drive
 Morgan Hill, CA 95037
 (408) 776-9600
 FAX (408) 782-6308
 www.sequoialabs.com

URS Corporation [Arco] 1333 Broadway, Suite 800 Oakland CA, 94612	Project: ARCO #0771, Livermore, CA Project Number: G0C1M-0004 Project Manager: Scott Robinson	MOG0601 Reported: 08/08/05 08:48
---	---	--

Volatile Organic Compounds by EPA Method 8260B
Sequoia Analytical - Morgan Hill

Analyte	Result	Reporting Limit	Units	Dilution	Batch	Prepared	Analyzed	Method	Notes
MW-5 (MOG0601-03) Water Sampled: 07/15/05 15:45 Received: 07/18/05 09:40									
tert-Amyl methyl ether	ND	5.0	ug/l	10	5G26008	07/26/05	07/27/05	EPA 8260B	
Benzene	61	5.0	"	"	"	"	"	"	
tert-Butyl alcohol	720	200	"	"	"	"	"	"	
Di-isopropyl ether	ND	5.0	"	"	"	"	"	"	
1,2-Dibromoethane (EDB)	ND	5.0	"	"	"	"	"	"	
1,2-Dichloroethane	ND	5.0	"	"	"	"	"	"	
Ethanol	ND	1000	"	"	"	"	"	"	
Ethyl tert-butyl ether	ND	5.0	"	"	"	"	"	"	
Ethylbenzene	8.7	5.0	"	"	"	"	"	"	
Methyl tert-butyl ether	270	5.0	"	"	"	"	"	"	
Toluene	ND	5.0	"	"	"	"	"	"	
Xylenes (total)	ND	5.0	"	"	"	"	"	"	
Gasoline Range Organics (C4-C12)	1600	500	"	"	"	"	"	"	
<i>Surrogate: 1,2-Dichloroethane-d4</i>		96 %	60-135	"	"	"	"	"	
MW-6 (MOG0601-04) Water Sampled: 07/15/05 15:25 Received: 07/18/05 09:40									
tert-Amyl methyl ether	ND	2.5	ug/l	5	5G26008	07/26/05	07/27/05	EPA 8260B	
Benzene	210	2.5	"	"	"	"	"	"	
tert-Butyl alcohol	110	100	"	"	"	"	"	"	
Di-isopropyl ether	ND	2.5	"	"	"	"	"	"	
1,2-Dibromoethane (EDB)	ND	2.5	"	"	"	"	"	"	
1,2-Dichloroethane	ND	2.5	"	"	"	"	"	"	
Ethanol	ND	500	"	"	"	"	"	"	
Ethyl tert-butyl ether	ND	2.5	"	"	"	"	"	"	
Ethylbenzene	150	2.5	"	"	"	"	"	"	
Methyl tert-butyl ether	32	2.5	"	"	"	"	"	"	
Toluene	44	2.5	"	"	"	"	"	"	
Xylenes (total)	670	2.5	"	"	"	"	"	"	
Gasoline Range Organics (C4-C12)	4600	250	"	"	"	"	"	"	
<i>Surrogate: 1,2-Dichloroethane-d4</i>		96 %	60-135	"	"	"	"	"	

Sequoia Analytical - Morgan Hill

The results in this report apply to the samples analyzed in accordance with the chain of custody document. Unless otherwise stated, results are reported on a wet weight basis. This analytical report must be reproduced in its entirety.

URS Corporation [Arco]
1333 Broadway, Suite 800
Oakland CA, 94612

Project: ARCO #0771, Livermore, CA
Project Number: G0C1M-0004
Project Manager: Scott Robinson

MOG0601
Reported:
08/08/05 08:48

Volatile Organic Compounds by EPA Method 8260B
Sequoia Analytical - Morgan Hill

Analyte	Result	Reporting		Units	Dilution	Batch	Prepared	Analyzed	Method	Notes
		Limit								
MW-7 (MOG0601-05) Water Sampled: 07/15/05 16:20 Received: 07/18/05 09:40										
tert-Amyl methyl ether	ND	25		ug/l	50	5G26008	07/26/05	07/27/05	EPA 8260B	
Benzene	1000	25		"	"	"	"	"	"	
tert-Butyl alcohol	ND	1000		"	"	"	"	"	"	
Di-isopropyl ether	ND	25		"	"	"	"	"	"	
1,2-Dibromoethane (EDB)	ND	25		"	"	"	"	"	"	
1,2-Dichloroethane	ND	25		"	"	"	"	"	"	
Ethanol	ND	5000		"	"	"	"	"	"	
Ethyl tert-butyl ether	ND	25		"	"	"	"	"	"	
Ethylbenzene	490	25		"	"	"	"	"	"	
Methyl tert-butyl ether	150	25		"	"	"	"	"	"	
Toluene	38	25		"	"	"	"	"	"	
Xylenes (total)	220	25		"	"	"	"	"	"	
Gasoline Range Organics (C4-C12)	12000	2500		"	"	"	"	"	"	
<i>Surrogate: 1,2-Dichloroethane-d4</i>		94 %		60-135		"	"	"	"	
MW-11 (MOG0601-06) Water Sampled: 07/15/05 14:30 Received: 07/18/05 09:40										
tert-Amyl methyl ether	ND	0.50		ug/l	1	5G26008	07/26/05	07/27/05	EPA 8260B	
Benzene	ND	0.50		"	"	"	"	"	"	
tert-Butyl alcohol	ND	20		"	"	"	"	"	"	
Di-isopropyl ether	ND	0.50		"	"	"	"	"	"	
1,2-Dibromoethane (EDB)	ND	0.50		"	"	"	"	"	"	
1,2-Dichloroethane	ND	0.50		"	"	"	"	"	"	
Ethanol	ND	100		"	"	"	"	"	"	
Ethyl tert-butyl ether	ND	0.50		"	"	"	"	"	"	
Ethylbenzene	ND	0.50		"	"	"	"	"	"	
Methyl tert-butyl ether	ND	0.50		"	"	"	"	"	"	
Toluene	ND	0.50		"	"	"	"	"	"	
Xylenes (total)	ND	0.50		"	"	"	"	"	"	
Gasoline Range Organics (C4-C12)	ND	50		"	"	"	"	"	"	
<i>Surrogate: 1,2-Dichloroethane-d4</i>		94 %		60-135		"	"	"	"	



URS Corporation [Arco] 1333 Broadway, Suite 800 Oakland CA, 94612	Project: ARCO #0771, Livermore, CA Project Number: G0C1M-0004 Project Manager: Scott Robinson	MOG0601 Reported: 08/08/05 08:48
---	---	--

Volatile Organic Compounds by EPA Method 8260B
Sequoia Analytical - Morgan Hill

Analyte	Result	Reporting Limit	Units	Dilution	Batch	Prepared	Analyzed	Method	Notes
RW-1 (MOG0601-07) Water Sampled: 07/15/05 13:40 Received: 07/18/05 09:40									
tert-Amyl methyl ether	ND	0.50	ug/l	1	5G26008	07/26/05	07/27/05	EPA 8260B	
Benzene	ND	0.50	"	"	"	"	"	"	
tert-Butyl alcohol	ND	20	"	"	"	"	"	"	
Di-isopropyl ether	ND	0.50	"	"	"	"	"	"	
1,2-Dibromoethane (EDB)	ND	0.50	"	"	"	"	"	"	
1,2-Dichloroethane	ND	0.50	"	"	"	"	"	"	
Ethanol	ND	100	"	"	"	"	"	"	
Ethyl tert-butyl ether	ND	0.50	"	"	"	"	"	"	
Ethylbenzene	ND	0.50	"	"	"	"	"	"	
Methyl tert-butyl ether	2.0	0.50	"	"	"	"	"	"	
Toluene	ND	0.50	"	"	"	"	"	"	
Xylenes (total)	ND	0.50	"	"	"	"	"	"	
Gasoline Range Organics (C4-C12)	ND	50	"	"	"	"	"	"	
<i>Surrogate: 1,2-Dichloroethane-d4</i>		94 %	60-135	"	"	"	"	"	
VW-1 (MOG0601-08) Water Sampled: 07/15/05 16:15 Received: 07/18/05 09:40									
tert-Amyl methyl ether	ND	0.50	ug/l	1	5G26008	07/26/05	07/27/05	EPA 8260B	
Benzene	ND	0.50	"	"	"	"	"	"	
tert-Butyl alcohol	ND	20	"	"	"	"	"	"	
Di-isopropyl ether	ND	0.50	"	"	"	"	"	"	
1,2-Dibromoethane (EDB)	ND	0.50	"	"	"	"	"	"	
1,2-Dichloroethane	ND	0.50	"	"	"	"	"	"	
Ethanol	ND	100	"	"	"	"	"	"	
Ethyl tert-butyl ether	ND	0.50	"	"	"	"	"	"	
Ethylbenzene	ND	0.50	"	"	"	"	"	"	
Methyl tert-butyl ether	ND	0.50	"	"	"	"	"	"	
Toluene	ND	0.50	"	"	"	"	"	"	
Xylenes (total)	ND	0.50	"	"	"	"	"	"	
Gasoline Range Organics (C4-C12)	ND	50	"	"	"	"	"	"	
<i>Surrogate: 1,2-Dichloroethane-d4</i>		96 %	60-135	"	"	"	"	"	

URS Corporation [Arco]
1333 Broadway, Suite 800
Oakland CA, 94612

Project: ARCO #0771, Livermore, CA
Project Number: G0C1M-0004
Project Manager: Scott Robinson

MOG0601
Reported:
08/08/05 08:48

**Volatile Organic Compounds by EPA Method 8260B - Quality Control
Sequoia Analytical - Morgan Hill**

Analyte	Result	Reporting Limit	Units	Spike Level	Source Result	%REC %REC	%REC Limits	RPD RPD	RPD Limit	Notes
---------	--------	--------------------	-------	----------------	------------------	--------------	----------------	------------	--------------	-------

Batch 5G26008 - EPA 5030B P/T / EPA 8260B

Blank (5G26008-BLK1)

Prepared & Analyzed: 07/26/05

tert-Amyl methyl ether	ND	0.50	ug/l							
Benzene	ND	0.50	"							
tert-Butyl alcohol	ND	20	"							
Di-isopropyl ether	ND	0.50	"							
1,2-Dibromoethane (EDB)	ND	0.50	"							
1,2-Dichloroethane	ND	0.50	"							
Ethanol	ND	100	"							
Ethyl tert-butyl ether	ND	0.50	"							
Ethylbenzene	ND	0.50	"							
Methyl tert-butyl ether	ND	0.50	"							
Toluene	ND	0.50	"							
Xylenes (total)	ND	0.50	"							
Gasoline Range Organics (C4-C12)	ND	50	"							
<i>Surrogate: 1,2-Dichloroethane-d4</i>	2.33		"	2.50		93	60-135			

Blank (5G26008-BLK2)

Prepared & Analyzed: 07/26/05

tert-Amyl methyl ether	ND	0.50	ug/l							
Benzene	ND	0.50	"							
tert-Butyl alcohol	ND	20	"							
Di-isopropyl ether	ND	0.50	"							
1,2-Dibromoethane (EDB)	ND	0.50	"							
1,2-Dichloroethane	ND	0.50	"							
Ethanol	ND	100	"							
Ethyl tert-butyl ether	ND	0.50	"							
Ethylbenzene	ND	0.50	"							
Methyl tert-butyl ether	ND	0.50	"							
Toluene	ND	0.50	"							
Xylenes (total)	ND	0.50	"							
Gasoline Range Organics (C4-C12)	ND	50	"							
<i>Surrogate: 1,2-Dichloroethane-d4</i>	2.42		"	2.50		97	60-135			

URS Corporation [Arco]
1333 Broadway, Suite 800
Oakland CA, 94612

Project: ARCO #0771, Livermore, CA
Project Number: G0C1M-0004
Project Manager: Scott Robinson

MOG0601
Reported:
08/08/05 08:48

**Volatile Organic Compounds by EPA Method 8260B - Quality Control
Sequoia Analytical - Morgan Hill**

Analyte	Result	Reporting Limit	Units	Spike Level	Source Result	%REC	%REC Limits	RPD	RPD Limit	Notes
---------	--------	-----------------	-------	-------------	---------------	------	-------------	-----	-----------	-------

Batch 5G26008 - EPA 5030B P/T / EPA 8260B

Laboratory Control Sample (5G26008-BS1)

Prepared & Analyzed: 07/26/05

tert-Amyl methyl ether	10.1	0.50	ug/l	10.0		101	80-115			
Benzene	9.89	0.50	"	10.0		99	65-115			
tert-Butyl alcohol	56.6	20	"	50.0		113	75-150			
Di-isopropyl ether	9.32	0.50	"	10.0		93	75-125			
1,2-Dibromoethane (EDB)	9.58	0.50	"	10.0		96	85-120			
1,2-Dichloroethane	8.50	0.50	"	10.0		85	85-130			
Ethanol	189	100	"	200		94	70-135			
Ethyl tert-butyl ether	9.52	0.50	"	10.0		95	75-130			
Ethylbenzene	10.8	0.50	"	10.0		108	75-135			
Methyl tert-butyl ether	8.69	0.50	"	10.0		87	65-125			
Toluene	10.1	0.50	"	10.0		101	85-120			
Xylenes (total)	32.6	0.50	"	30.0		109	85-125			

Surrogate: 1,2-Dichloroethane-d4 2.19 " 2.50 88 60-135

Laboratory Control Sample (5G26008-BS2)

Prepared & Analyzed: 07/26/05

Benzene	5.34	0.50	ug/l	6.08		88	65-115			
Ethylbenzene	8.55	0.50	"	7.84		109	75-135			
Methyl tert-butyl ether	7.70	0.50	"	9.60		80	65-125			
Toluene	32.4	0.50	"	32.9		98	85-120			
Xylenes (total)	40.7	0.50	"	38.5		106	85-125			
Gasoline Range Organics (C4-C12)	378	50	"	440		86	70-124			

Surrogate: 1,2-Dichloroethane-d4 2.25 " 2.50 90 60-135

Laboratory Control Sample Dup (5G26008-BSD1)

Prepared & Analyzed: 07/26/05

tert-Amyl methyl ether	10.6	0.50	ug/l	10.0		106	80-115	5	15	
Benzene	10.2	0.50	"	10.0		102	65-115	3	20	
tert-Butyl alcohol	52.4	20	"	50.0		105	75-150	8	25	
Di-isopropyl ether	9.69	0.50	"	10.0		97	75-125	4	15	
1,2-Dibromoethane (EDB)	10.3	0.50	"	10.0		103	85-120	7	15	
1,2-Dichloroethane	9.63	0.50	"	10.0		96	85-130	12	20	
Ethanol	172	100	"	200		86	70-135	9	35	
Ethyl tert-butyl ether	10.2	0.50	"	10.0		102	75-130	7	25	
Ethylbenzene	11.0	0.50	"	10.0		110	75-135	2	15	
Methyl tert-butyl ether	9.66	0.50	"	10.0		97	65-125	11	20	
Toluene	10.8	0.50	"	10.0		108	85-120	7	20	
Xylenes (total)	33.3	0.50	"	30.0		111	85-125	2	20	

Sequoia Analytical - Morgan Hill

The results in this report apply to the samples analyzed in accordance with the chain of custody document. Unless otherwise stated, results are reported on a wet weight basis. This analytical report must be reproduced in its entirety.

URS Corporation [Arco]
 1333 Broadway, Suite 800
 Oakland CA, 94612

 Project: ARCO #0771, Livermore, CA
 Project Number: G0C1M-0004
 Project Manager: Scott Robinson

 MOG0601
 Reported:
 08/08/05 08:48

Volatile Organic Compounds by EPA Method 8260B - Quality Control
Sequoia Analytical - Morgan Hill

Analyte	Result	Reporting Limit	Units	Spike Level	Source Result	%REC	%REC Limits	RPD	RPD Limit	Notes
---------	--------	-----------------	-------	-------------	---------------	------	-------------	-----	-----------	-------

Batch 5G26008 - EPA 5030B P/T / EPA 8260B
Laboratory Control Sample Dup (5G26008-BSD1)

Prepared & Analyzed: 07/26/05

Surrogate: 1,2-Dichloroethane-d4 2.37 ug/l 2.50 95 60-135

Matrix Spike (5G26008-MS1)

Source: MOG0642-06

Prepared & Analyzed: 07/26/05

Benzene	5110	100	ug/l	1220	3900	99	65-115			
Ethylbenzene	4850	100	"	1570	3100	111	75-135			
Methyl tert-butyl ether	1840	100	"	1920	220	84	65-125			
Toluene	18800	100	"	6580	12000	103	85-120			
Xylenes (total)	24600	100	"	7700	16000	112	85-125			
Gasoline Range Organics (C4-C12)	154000	10000	"	88000	78000	86	70-124			

Surrogate: 1,2-Dichloroethane-d4 2.41 " 2.50 96 60-135

Matrix Spike Dup (5G26008-MSD1)

Source: MOG0642-06

Prepared: 07/26/05 Analyzed: 07/27/05

Benzene	4980	100	ug/l	1220	3900	89	65-115	3	20	
Ethylbenzene	4650	100	"	1570	3100	99	75-135	4	15	
Methyl tert-butyl ether	1830	100	"	1920	220	84	65-125	0.5	20	
Toluene	18600	100	"	6580	12000	100	85-120	1	20	
Xylenes (total)	23400	100	"	7700	16000	96	85-125	5	20	
Gasoline Range Organics (C4-C12)	148000	10000	"	88000	78000	80	70-124	4	20	

Surrogate: 1,2-Dichloroethane-d4 2.38 " 2.50 95 60-135



URS Corporation [Arco]
1333 Broadway, Suite 800
Oakland CA, 94612

Project: ARCO #0771, Livermore, CA
Project Number: G0C1M-0004
Project Manager: Scott Robinson

MOG0601
Reported:
08/08/05 08:48

Notes and Definitions

DET Analyte DETECTED
ND Analyte NOT DETECTED at or above the reporting limit or MDL, if MDL is specified
NR Not Reported
dry Sample results reported on a dry weight basis
RPD Relative Percent Difference

SEQUOIA ANALYTICAL SAMPLE RECEIPT LOG

CLIENT NAME: URS
 REC. BY (PRINT) MARCOS
 WORKORDER: M066661

DATE REC'D AT LAB: 7-18-05
 TIME REC'D AT LAB: 09:40
 DATE LOGGED IN: 7-20-05

For Regulatory Purposes?
 DRINKING WATER YES / NO
 WASTE WATER YES / NO

(For clients requiring preservation checks at receipt, document here ↓)

CIRCLE THE APPROPRIATE RESPONSE		LAB SAMPLE #	DASH #	CLIENT ID	CONTAINER DESCRIPTION	PRESERVATIVE	pH	SAMPLE MATRIX	DATE SAMPLED	REMARKS: CONDITION (ETC.)
1. Custody Seal(s)	Present / Absent Intact / Broken*	01	A.C	MW-2	3-00A	HCL	-	L	7-15-05	
2. Chain-of-Custody	Present / Absent*	02		-4						
3. Traffic Reports or Packing List:	Present / Absent	03		-5						
4. Airbill:	Airbill / Sticker Present / Absent	04		-6						
5. Airbill #:		05		-7						
6. Sample Labels:	Present / Absent	06		-11						
7. Sample IDs:	Listed / Not Listed or Chain-of-Custody	07		RW-1						
8. Sample Condition:	Intact / Broken* / Leaking*	08		VW-1						
9. Does information on chain-of-custody, traffic reports and sample labels agree?	Yes / No*	09	A.B	TB771-0752005	2-00A					
10. Sample received within hold time?	Yes / No*									
11. Adequate sample volume received?	Yes / No*									
12. Proper Preservatives used?	Yes / No*									
13. Trip Blank / Temp Blank Received? (circle which, if yes)	Yes / No*									
14. Temp Rec. at Lab: Is temp 4 +/- 2°C?	Yes / No**									

MF 7/18/05

*IF CIRCLED, CONTACT PROJECT MANAGER AND ATTACH RECORD OF RESOLUTION.

ATTACHMENT C
ERROR CHECK REPORTS AND EDF/GEOWELL SUBMITTAL
CONFIRMATION

			geo_well.txt			
T0600100113	MW-1	ACT	7/15/2005	0	29.44 ✓	36.65 ✓
N						
T0600100113	MW-2	ACT	7/15/2005	0	25.92 ✓	33.79 ✓
N						
T0600100113	MW-3	ACT	7/15/2005	0	25.95 ✓	39.60 ✓
N						
T0600100113	MW-4	ACT	7/15/2005	0	28.13 ✓	
N						
T0600100113	MW-5	ACT	7/15/2005	0	29.27 ✓	40.00 ✓
N						
T0600100113	MW-6	ACT	7/15/2005	0	27.61 ✓	43.18 ✓
N						
T0600100113	MW-7	ACT	7/15/2005	0	27.20 ✓	39.59 ✓
N						
T0600100113	MW-8	ACT	7/15/2005	0	31.14 ✓	41.40 ✓
N						
T0600100113	MW-9	ACT	7/15/2005	0	25.72 ✓	38.95 ✓
N						
T0600100113	MW-10	ACT	7/15/2005	0	25.37 ✓	34.00 ✓
N						
T0600100113	MW-11	ACT	7/15/2005	0	29.15 ✓	38.50 ✓
N						
T0600100113	RW-1	ACT	7/15/2005	0	29.02 ✓	
N						
T0600100113	VW-1	ACT	7/15/2005	0	22.50 ✓	28.15 ✓
N						

Electronic Submittal Information

[Main Menu](#) | [View/Add Facilities](#) | [Upload EDD](#) | [Check EDD](#)

SUCCESSFUL GEO_WELL CHECK - NO ERRORS

<u>ORGANIZATION NAME:</u>	URS Corporation-Oakland Office
<u>USER NAME:</u>	URSCORP-OAKLAND
<u>DATE CHECKED:</u>	8/19/2005 11:03:34 AM

Processing is complete. No errors were found!
You may now proceed to the [upload](#) page.

[Back to Main Menu](#)

Logged in as URSCORP-OAKLAND (CONTRACTOR)

CONTACT SITE [ADMINISTRATOR](#).

Electronic Submittal Information

[Main Menu](#) | [View/Add Facilities](#) | [Upload EDD](#) | [Check EDD](#)

UPLOADING A GEO_WELL FILE

Processing is complete. No errors were found!
Your file has been successfully submitted!

Submittal Title: 3Q 2005 BP/ARCO 771
GOWELL

Submittal Date/Time: 8/19/2005 11:04:54 AM

Confirmation Number: 7897537052

[Back to Main Menu](#)

Logged in as URSCORP-OAKLAND
(CONTRACTOR)

CONTACT SITE [ADMINISTRATOR](#).

Electronic Submittal Information

[Main Menu](#) |
 [View/Add Facilities](#) |
 [Upload EDF](#) |
 [Check EDF](#)

SUCCESSFUL EDF CHECK - NO ERRORS

<u>ORGANIZATION NAME:</u>	URS Corporation-Oakland Office
<u>USER NAME:</u>	URSCORP-OAKLAND
<u>DATE CHECKED:</u>	8/19/2005 12:00:22 PM
<u>GLOBAL ID:</u>	T0600100113
<u>FILE UPLOADED:</u>	ARCO#0771-EDF-MOG0601.zip

No errors were found in your EDF upload file.

If you want to submit this file to the SWRCB, choose the "Upload EDF" option in the above menu and follow the instructions.

When you complete the submittal process, you will be given a confirmation number for your submittal.

[Click here to view the detections report for this upload.](#)

ARCO # 00771 899 RINCON AVE LIVERMORE, CA 94550	Regional Board - Case #: 01-0121 SAN FRANCISCO BAY RWQCB (REGION 2) - (BG) Local Agency (lead agency) - Case #: 3873 ALAMEDA COUNTY LOP - (RWS)
--	---

SAMPLE DETECTIONS REPORT

# FIELD POINTS SAMPLED	8
# FIELD POINTS WITH DETECTIONS	6
# FIELD POINTS WITH WATER SAMPLE DETECTIONS ABOVE MCL	5
SAMPLE MATRIX TYPES	WATER

METHOD QA/QC REPORT

METHODS USED	8260FA
TESTED FOR REQUIRED ANALYTES?	N
MISSING PARAMETERS NOT TESTED:	
- 8260FA REQUIRES DBFM TO BE TESTED	
- 8260FA REQUIRES BR4FBZ TO BE TESTED	
- 8260FA REQUIRES BZMED8 TO BE TESTED	
LAB NOTE DATA QUALIFIERS	N

QA/QC FOR 8021/8260 SERIES SAMPLES

TECHNICAL HOLDING TIME VIOLATIONS	0
METHOD HOLDING TIME VIOLATIONS	0
LAB BLANK DETECTIONS ABOVE REPORTING DETECTION LIMIT	0
LAB BLANK DETECTIONS	0
DO ALL BATCHES WITH THE 8021/8260 SERIES INCLUDE THE FOLLOWING?	
- LAB METHOD BLANK	Y
- MATRIX SPIKE	Y
- MATRIX SPIKE DUPLICATE	Y
- BLANK SPIKE	Y
- SURROGATE SPIKE	Y

WATER SAMPLES FOR 8021/8260 SERIES

MATRIX SPIKE / MATRIX SPIKE DUPLICATE(S) % RECOVERY BETWEEN 65-135%	Y
MATRIX SPIKE / MATRIX SPIKE DUPLICATE(S) RPD LESS THAN 30%	n/a
SURROGATE SPIKES % RECOVERY BETWEEN 85-115%	Y
BLANK SPIKE / BLANK SPIKE DUPLICATES % RECOVERY BETWEEN 70-130%	Y

SOIL SAMPLES FOR 8021/8260 SERIES

MATRIX SPIKE / MATRIX SPIKE DUPLICATE(S) % RECOVERY BETWEEN 65-135%	n/a
MATRIX SPIKE / MATRIX SPIKE DUPLICATE(S) RPD LESS THAN 30%	n/a
SURROGATE SPIKES % RECOVERY BETWEEN 70-125%	n/a
BLANK SPIKE / BLANK SPIKE DUPLICATES % RECOVERY BETWEEN 70-130%	n/a

FIELD QC SAMPLES

<u>SAMPLE</u>	<u>COLLECTED</u>	<u>DETECTIONS > REPD</u>
QCTB SAMPLES	N	0
QCEB SAMPLES	N	0
QCAB SAMPLES	N	0

Logged in as URSCORP-OAKLAND (CONTRACTOR)

CONTACT SITE ADMINISTRATOR.

Electronic Submittal Information

[Main Menu](#) |
 [View/Add Facilities](#) |
 [Upload EDD](#) |
 [Check EDD](#)

Your EDF file has been successfully uploaded!

Confirmation Number: 6057417213
Date/Time of Submittal: 8/19/2005 12:01:39 PM
Facility Global ID: T0600100113
Facility Name: ARCO # 00771
Submittal Title: 3Q 2005 BP/ARCO 771 EDF
Submittal Type: GW Monitoring Report

Click [here](#) to view the detections report for this upload.

ARCO # 00771 899 RINCON AVE LIVERMORE, CA 94550	Regional Board - Case #: 01-0121 SAN FRANCISCO BAY RWQCB (REGION 2) - (BG) Local Agency (lead agency) - Case #: 3873 ALAMEDA COUNTY LOP - (RWS)
--	--

CONF #	TITLE	QUARTER
6057417213	3Q 2005 BP/ARCO 771 EDF	Q3 2005
SUBMITTED BY	SUBMIT DATE	STATUS
Srijesh Thapa	8/19/2005	PENDING REVIEW

SAMPLE DETECTIONS REPORT

# FIELD POINTS SAMPLED	8
# FIELD POINTS WITH DETECTIONS	6
# FIELD POINTS WITH WATER SAMPLE DETECTIONS ABOVE MCL	5
SAMPLE MATRIX TYPES	WATER

METHOD QA/QC REPORT

METHODS USED	8260FA
TESTED FOR REQUIRED ANALYTES?	N
MISSING PARAMETERS NOT TESTED:	
- 8260FA REQUIRES DBFM TO BE TESTED	
- 8260FA REQUIRES BR4FBZ TO BE TESTED	
- 8260FA REQUIRES BZMED8 TO BE TESTED	
LAB NOTE DATA QUALIFIERS	N

QA/QC FOR 8021/8260 SERIES SAMPLES

TECHNICAL HOLDING TIME VIOLATIONS	0
METHOD HOLDING TIME VIOLATIONS	0
LAB BLANK DETECTIONS ABOVE REPORTING DETECTION LIMIT	0
LAB BLANK DETECTIONS	0
DO ALL BATCHES WITH THE 8021/8260 SERIES INCLUDE THE FOLLOWING?	
- LAB METHOD BLANK	Y
- MATRIX SPIKE	Y
- MATRIX SPIKE DUPLICATE	Y
- BLANK SPIKE	Y
- SURROGATE SPIKE	Y

WATER SAMPLES FOR 8021/8260 SERIES

MATRIX SPIKE / MATRIX SPIKE DUPLICATE(S) % RECOVERY BETWEEN 65-135%	Y
MATRIX SPIKE / MATRIX SPIKE DUPLICATE(S) RPD LESS THAN 30%	n/a
SURROGATE SPIKES % RECOVERY BETWEEN 85-115%	Y
BLANK SPIKE / BLANK SPIKE DUPLICATES % RECOVERY BETWEEN 70-130%	Y

SOIL SAMPLES FOR 8021/8260 SERIES

MATRIX SPIKE / MATRIX SPIKE DUPLICATE(S) % RECOVERY BETWEEN 65-135%	n/a
MATRIX SPIKE / MATRIX SPIKE DUPLICATE(S) RPD LESS THAN 30%	n/a
SURROGATE SPIKES % RECOVERY BETWEEN 70-125%	n/a
BLANK SPIKE / BLANK SPIKE DUPLICATES % RECOVERY BETWEEN 70-130%	n/a

FIELD QC SAMPLES

<u>SAMPLE</u>	<u>COLLECTED</u>	<u>DETECTIONS > REPDL</u>
QCTB SAMPLES	N	0
QCEB SAMPLES	N	0
QCAB SAMPLES	N	0

Logged in as URSCORP-OAKLAND (CONTRACTOR)

CONTACT SITE ADMINISTRATOR.