

## Wickham, Jerry, Env. Health

---

**From:** Wickham, Jerry, Env. Health  
**Sent:** Wednesday, October 16, 2013 3:10 PM  
**To:** 'Jason Duda'  
**Cc:** Rob Miller; Carmel, Charles  
**Subject:** RE: BP Station #771, Livermore (RO000200)

Hello Jason,

Eliminating boring B-3 due to utilities in the area is acceptable. The site characterization data will be reviewed following the onsite CPT investigation.

Regards,  
Jerry Wickham  
Alameda County Environmental Health  
1131 Harbor Bay Parkway  
Alameda, CA 94502-6577  
phone: 510-567-6791  
[jerry.wickham@acgov.org](mailto:jerry.wickham@acgov.org)

---

**From:** Jason Duda [<mailto:jduda@broadbentinc.com>]  
**Sent:** Tuesday, October 15, 2013 1:44 PM  
**To:** Wickham, Jerry, Env. Health  
**Cc:** Rob Miller; Carmel, Charles  
**Subject:** BP Station #771, Livermore (RO000200)

Hi Jerry,

I wanted to let you know that we have decided to eliminate boring B-3 (see attached Site Map) from the upcoming onsite CPT investigation at BP Station #771 located at 899 Rincon Ave., Livermore. After conducting the private utility locate yesterday, we discovered that the proposed area for B-3 is riddled with underground utilities, as is the area immediately south of the proposed location (see attached photos). I still believe that the other 3 proposed borings will provide us with adequate data to further evaluate onsite hydrogeology and potential contaminant concentrations. Please let me know if this decision appears appropriate. Thank you.

**Jason Duda**  
Project Scientist





1370 Ridgewood Dr., Suite 5, Chico, CA 95973  
[T] 530-566-1400 • [C] 530-592-6822 • [F] 530-566-1401  
[jduda@broadbentinc.com](mailto:jduda@broadbentinc.com)

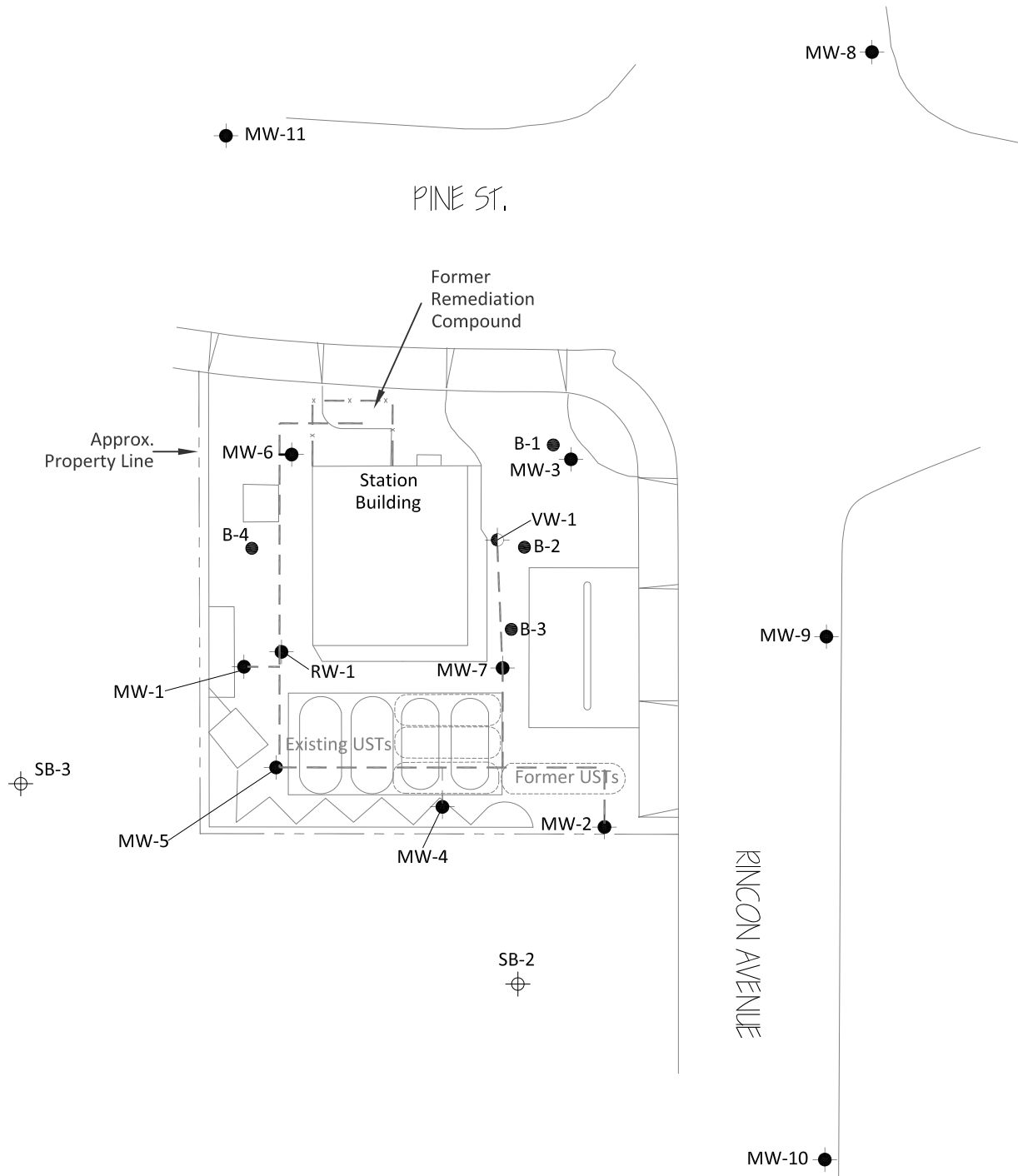

**CONFIDENTIALITY:** This communication, including attachments, is for the exclusive use of the addressee(s) and may contain proprietary, confidential or privileged information. If you are not the intended recipient, any use, copying, disclosure, or distribution or the taking of any action in reliance upon this information is strictly prohibited. If you are not the intended recipient, please notify the sender immediately and delete this communication and destroy all copies.



**LEGEND**

-  Monitoring Well Location
-  Vapor Extraction Well Location
-  Proposed CPT Boring Locations
-  Soil Boring Locations
-  Remediation Piping

NOTE: SITE MAP ADAPTED FROM URS FIGURES. SITE DIMENSIONS AND FACILITY LOCATIONS NOT VERIFIED.

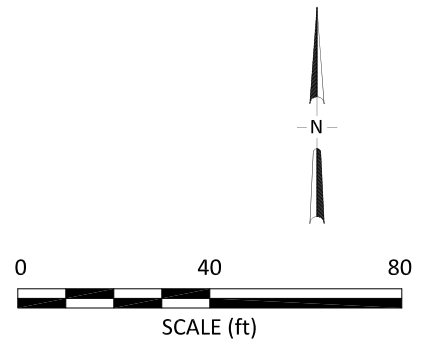



ARCO **ARCO**  
379¢  
389¢  
399¢

Worker in white hard hat and orange safety vest.



CASH  
OR  
ATM  
PAY  
HERE

EVERY WEEK  
FOR \$4