

RECEIVED

1:17 pm, Aug 23, 2007

**Alameda County
Environmental Health**



August 20 , 2007

VIA ALAMEDA COUNTY FTP SITE

Ms. Donna Drogos
Alameda County Environmental Health
1131 Harbor Bay Parkway, Suite 250
Alameda, California 94502

Re: **Groundwater Monitoring Report – Second Quarter 2007**
Connell Automobile Dealership
3093 Broadway
Oakland, California
ACEH Case No. 469

Dear Ms. Drogos:

On behalf of the Hill Family Trust and Linden Broadway Trust, Pangea Environmental Services, Inc., has prepared this *Groundwater Monitoring Report – Second Quarter 2007* for the subject site. This report describes groundwater monitoring, sampling and other site activities.

The report will be uploaded to the Alameda County ftp site and the SWRCB *Geotracker* database. As requested, Pangea will not submit a hard copy of this report to the ACEH.

If you have any questions or comments, please call me at (510) 435-8664.

Sincerely,
Pangea Environmental Services, Inc.

A handwritten signature in blue ink that reads "Bob Clark-Riddell". The signature is written in a cursive, flowing style.

Bob Clark-Riddell, P.E.
Principal Engineer

Attachments: *Groundwater Monitoring Report – Second Quarter 2007*

cc: Mr. George Hill, 305 Sheridan Avenue, Piedmont, California 94611
Mr. Gordon Linden, 150 La Salle Avenue, Piedmont, California 94611
Mr. Paul Kibel, Fitzgerald, Abbott & Beardsley, LLP, 1221 Broadway, 21st Floor, Oakland, California 94612
SWRCB Geotracker (electronic copy)

PANGEA Environmental Services, Inc.

1710 Franklin Street, Suite 200, Oakland, California 94612 Telephone 510.836.3700 Facsimile 510.836.3709 www.pangeaenv.com



GROUNDWATER MONITORING REPORT – SECOND QUARTER 2007

**Connell Automobile Dealership
3093 Broadway
Oakland, California
ACEH Case No. 469**

August 20, 2007

Prepared for:

Hill Family Trust
c/o Mr. George Hill
305 Sheridan Avenue
Piedmont, California 94611

and

Linden Broadway Trust
c/o Mr. Gordon Linden
150 La Salle Avenue
Piedmont, California 94611

Prepared by:

Pangea Environmental Services, Inc.
1710 Franklin Street, Suite 200
Oakland, California 94612

Written by:

Morgan Gillies
Project Manager



Bob Clark-Riddell, P.E.
Principal Engineer

PANGEA Environmental Services, Inc.

INTRODUCTION

As required by the Alameda County Environmental Health (ACEH), Pangea Environmental Services, Inc. (Pangea), has prepared this *Groundwater Monitoring Report –Second Quarter 2007* for the subject site. On behalf of the Hill Family Trust and Linden Broadway Trust, Pangea conducted groundwater monitoring, sampling, and inspected wells for separate-phase hydrocarbons (SPH) during this quarter at the site (Figure 1). The purpose of the monitoring and sampling is to evaluate groundwater flow direction, concentrations of dissolved hydrocarbons in groundwater, and the thickness of SPH. Current analytical data and groundwater elevations are shown on Figure 2. Current and historical data are summarized on Tables 1 and 2.

SITE DESCRIPTION AND BACKGROUND

The site is located on the east side of “Pill Hill” south of Hawthorne Avenue, between Broadway and Webster Street. The northern portion of the site is occupied by the auto repair shop, offices and showrooms of the Connell automobile dealership, while the southern portion of the site is occupied by parking lots. The ground surface elevation ranges from approximately 80 to 100 feet above mean sea level (msl) and slopes southeastwards towards the base of “Pill Hill” at Broadway. Three underground storage tanks (USTs) that previously contained gasoline, diesel, and waste oil were removed from the upper (northwest) portion of the site in December 1989. Soil and groundwater assessment have been ongoing since 1990.

Between October 1996 and March 1998, operation of a soil vapor extraction (SVE) remediation system removed approximately 1,421 pounds of hydrocarbons. Manual removal of separate-phase hydrocarbons (SPH) from monitoring wells has removed a total of approximately 950 pounds (156 gallons) of SPH since 1991. Chemicals of concern at the site are petroleum hydrocarbons (i.e. diesel and gasoline), 1, 2 dichloroethane, and fuel-related semi-volatile organic compounds (e.g., naphthalene). In some prior analytical results from the site, extractable hydrocarbons have been quantified as total petroleum hydrocarbons as motor oil (TPHmo), although these hydrocarbons may represent the heavier fraction of diesel contamination. Methyl tertiary butyl ether (MTBE) is not a constituent of concern at this site.

On February 27 through April 4, 2007, Pangea installed two groundwater monitoring wells (MW-16A and MW-16B) to monitor groundwater during remediation and fifteen installed remediation wells (AS-1A, AS-1B, AS-2A, AS-3A, AS-3B, AS-4A, RW-1, RW-2, RW-3A, RW-3B, RW-4, RW-5, MW-17A, MW-17B and VE-1) to implement air sparging (AS) and dual phase extraction (DPE). New wells installed at the site were categorized according to the depths of their screen intervals. Shallow (A-zone)

wells have screen intervals above approximately 30 feet below grade surface (bgs), which generally straddle the top of the water table, while deeper (B-zone) wells are screened below approximately 30 feet bgs to target deeper contamination.

GROUNDWATER MONITORING AND SAMPLING

On May 11, 2007, Pangea gauged depth-to-water and inspected for SPH in site monitoring wells in accordance with the well monitoring protocol in Appendix A. The well monitoring protocol consists of quarterly gauging and *annual* sampling (during the first quarter of each year) of source area groundwater monitoring wells (MW-1, MW-6, MW-14 and MW-15) and *quarterly* gauging and sampling of select downgradient and crossgradient groundwater monitoring wells (MW-4, MW-7, MW-8, MW-9, MW-13, MW-16A and MW-16B).

Prior to sampling the wells, groundwater levels and SPH thickness were measured to evaluate groundwater elevation and flow direction at the site. Before well purging, the dissolved oxygen (DO) concentration was measured in each well by lowering a down-well sensor to the approximate middle of the water column, and allowing the reading to stabilize during gentle height adjustment. Prior to sample collection, approximately three well-casing volumes of groundwater were purged using a disposable bailer, PVC bailer or electric submersible pump. During well purging, field technicians measured and recorded groundwater pH, conductivity, and temperature. Groundwater samples were collected from each well with a disposable bailer and decanted into the appropriate containers supplied by the analytical laboratory. Samples were labeled, placed in protective plastic bags, stored on crushed, water-based ice at or below 4 degrees Celsius, and transported under chain-of-custody to the laboratory. Groundwater monitoring field data sheets are presented as Appendix B.

MONITORING RESULTS

Current groundwater elevation and analytical data are summarized on Figure 2. Current and historical data are described below and summarized on Tables 1 and 2. In accordance with the approved sampling protocol, groundwater samples were analyzed for total petroleum hydrocarbons as gasoline (TPHg) by modified EPA Method 8015C; total petroleum hydrocarbons as diesel (TPHd) and TPHmo by EPA Method 8015C with silica gel cleanup; and benzene, toluene, ethylbenzene, xylenes (BTEX) and MTBE by EPA Method 8021B. During the first quarter of each year, groundwater samples are also analyzed for halogenated volatile organic compounds (HVOCs) by EPA Method 8010. Table 1 summarizes current

and historical analytical results for TPHg, BTEX and HVOCs and presents dissolved oxygen field measurement data. This quarter, DO concentrations ranged from 0.20 milligrams per liter (mg/L) in well MW-1 to 0.94 mg/L in well MW-16A. Table 2 summarizes extractable hydrocarbons (TPHd and TPHmo) and semi-volatile organic compounds (SVOCs). Laboratory analyses were performed by McCampbell Analytical of Pittsburg, California, a State-certified laboratory. The laboratory analytical report and chain of custody are included in Appendix C.

Groundwater Flow Direction

Based on depth-to-water measurements from May 11, 2007, the inferred groundwater flow direction beneath the site is eastwards, while groundwater beneath Broadway flows northwards to north-eastwards (Figure 2). These inferred flow directions are consistent with previous monitoring. Depth-to-water and groundwater elevation data are presented in Table 1.

Hydrocarbon Distribution in Groundwater

SPH were not measurable in any site wells this quarter. The distribution of petroleum hydrocarbons in groundwater this quarter is illustrated on Figure 2. Concentrations of detected hydrocarbons are consistent with prior monitoring results.

Initial analytical results from new monitoring wells MW-16A and MW-16B, installed a short distance downgradient from the contaminant source area, indicate that deeper horizons are more highly impacted than shallow horizons at this location. Well MW-16B, screened from 35-40 ft bgs, contains significantly higher concentrations of TPHd, TPHg, and BTEX than well MW-16A, screened from 20-30 ft bgs.

MTBE was not detected in any of the sampled wells this quarter and is not a compound of concern at this site.

OTHER SITE ACTIVITIES

Ongoing Monitoring

Pangea will continue quarterly groundwater monitoring in accordance with the approved monitoring protocol. To establish baseline conditions prior to remediation, all new wells installed in the Spring 2007 were sampled once in April. Newly installed monitoring wells MW-16A and MW-16B have been added to the protocol (Appendix A) for quarterly sampling. All program wells will be gauged for depth to water

and checked for SPH. For wells designated for sampling that do not contain SPH, Pangea will collect groundwater samples and measure dissolved oxygen. All groundwater samples will be analyzed for TPHg/BTEX/MTBE by EPA Method 8015Cm/8021B and for TPHd/TPHmo by EPA Method 8015C with silica gel cleanup. During the first quarter of each year, groundwater samples will also be analyzed for HVOCs by EPA Method 8010. Pangea will summarize groundwater monitoring activities and results in a groundwater monitoring report.

Interim Remedial Action

In a letter dated March 17, 2006, the ACEH authorized Pangea to commence implementation of dual-phase extraction and air sparging (DPE/AS), the approved remedial approach. Pangea has completed the installation and development of fifteen remediation wells and two monitoring wells, and has commenced system design. System startup is anticipated to occur during fall 2007. Pangea will submit a report detailing well installation and system design.

As proposed in Pangea's *Groundwater Monitoring Report – Fourth Quarter 2006* dated March 14, 2007, SPH removal activities have been discontinued due to the planned implementation of active remediation.

Electronic Reporting

This report will be uploaded to the Alameda County ftp site. The report, laboratory data, and other applicable information will also be uploaded to the State Water Resource Control Board's Geotracker database. As requested, report hard copies will no longer be provided to ACEH.

ATTACHMENTS

Figure 1 – Site Location Map

Figure 2 – Groundwater Elevation Contours and Hydrocarbon Concentration Map

Table 1 – Groundwater Elevation and Analytical Data: Volatile Hydrocarbons, HVOCs and DO

Table 2 – Groundwater Elevation and Analytical Data: Extractable Hydrocarbons and SVOCs

Table 3 – Well Construction Details

Appendix A – Well Monitoring Protocol

Appendix B – Groundwater Monitoring Field Data Sheets

Appendix C – Laboratory Analytical Report

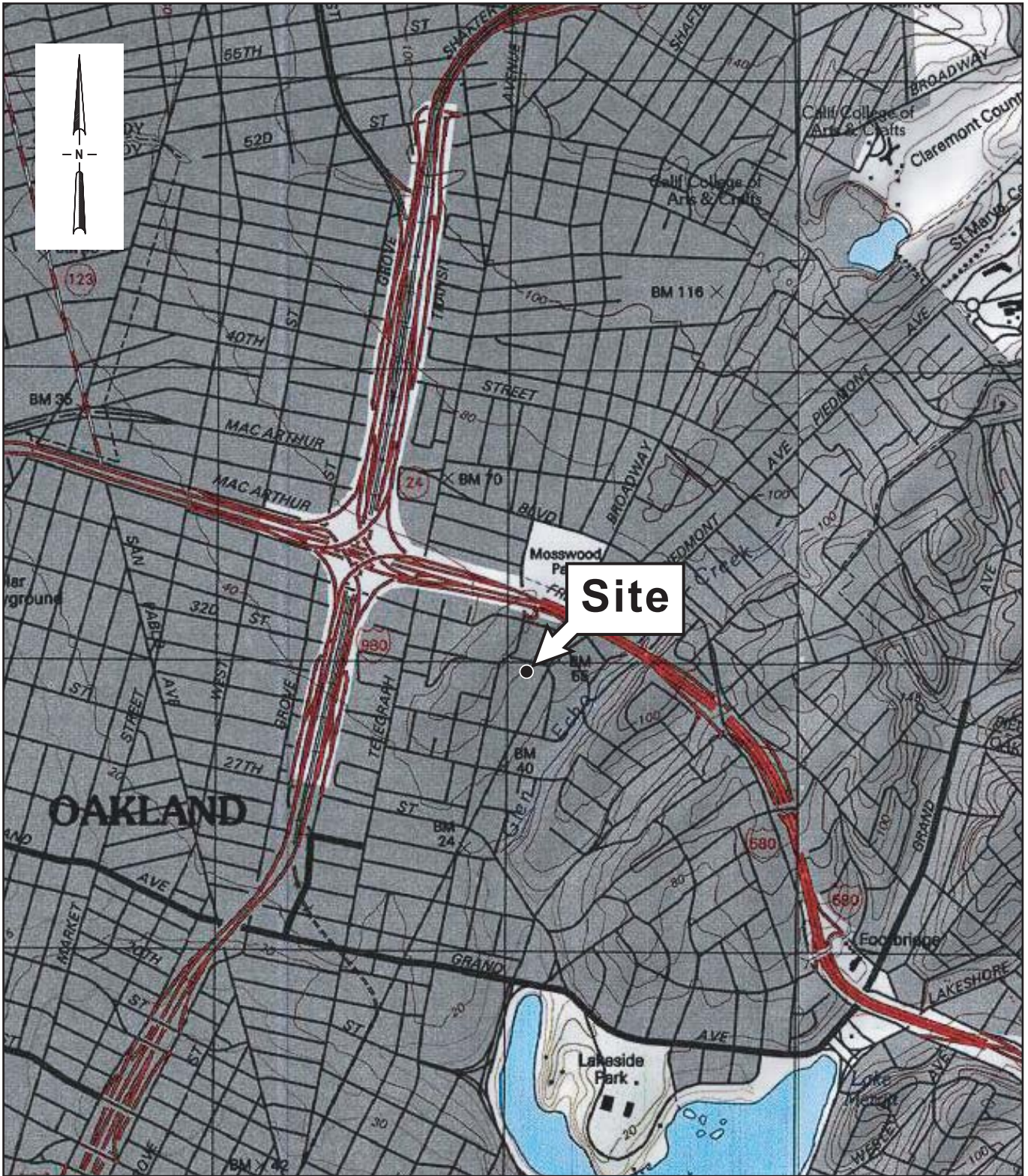

SOURCE: TOPOI MAPS



SCALE : 1" = 1/4 MILE

Figure 1

Connell Automobile Dealership
 3093 Broadway
 Oakland, California



Vicinity Map

WEBSTER STREET

HAWTHORNE STREET

BROOK STREET

BROADWAY

Basemap from Subsurface Consultants, Inc. and Cambria Environmental Technology, Inc.

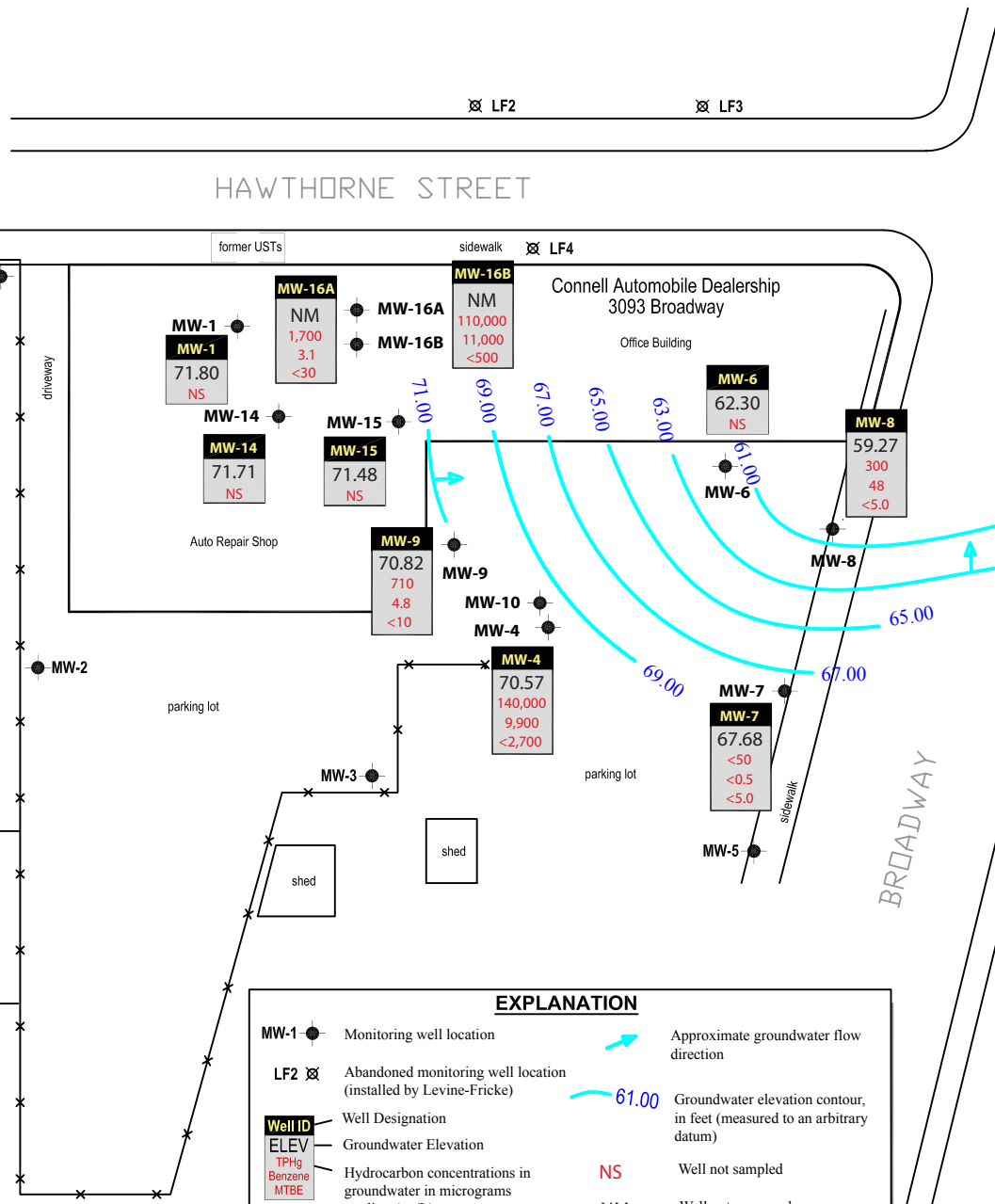

EXPLANATION

- MW-1 ● Monitoring well location
- LF2 ☒ Abandoned monitoring well location (installed by Levine-Fricke)
- Well ID Well Designation
- ELEV Groundwater Elevation
- TPHg Hydrocarbon concentrations in groundwater in micrograms per liter (ug/L)
- Benzene
- MTBE
- Approximate groundwater flow direction
- 61.00 Groundwater elevation contour, in feet (measured to an arbitrary datum)
- NS Well not sampled
- NM Well not measured

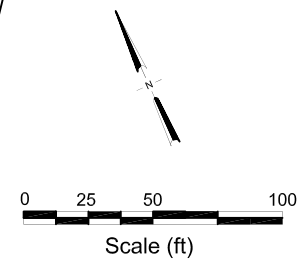

Figure 2

Connell Automobile Dealership
 3093 Broadway
 Oakland, California



Groundwater Elevation and Hydrocarbon Concentration Map

May 11, 2007

5/8/2007

Pangea

Table 1. Groundwater Elevation and Analytical Data: Volatile Hydrocarbons, HVOCs, and Dissolved Oxygen
Connell Automobile Dealership, 3093 Broadway, Oakland, California

Well ID <i>TOC Elev.</i> <i>(ft)</i>	Sampling Date	Depth to Groundwater <i>(ft)</i>	Groundwater Elevation <i>(ft)</i>	TVH/TPHg <i>(µg/L)</i>	Benzene <i>(µg/L)</i>	Toluene <i>(µg/L)</i>	Ethyl- benzene <i>(µg/L)</i>	Xylenes <i>(µg/L)</i>	MTBE <i>(µg/L)</i>	1,2-DCA <i>(µg/L)</i>	Other HVOCs <i>(µg/L)</i>	DO <i>(mg/L)</i>
Monitoring Well Data												
MW-1	10/5/1990	26.40	68.08	620,000	33,000	50,000	7,900	41,000	--	--	ND	--
94.48	3/1/1991	27.46	67.02	SPH	--	--	--	--	--	--	--	--
	10/12/1992	26.44	68.04	490,000	51,000	59,000	5,000	27,000	--	--	--	--
	11/24/1992	26.63	67.85	320,000	35,000	43,000	4,200	22,000	--	--	ND	--
	4/5/1993	23.77	70.71	270,000	50,000	58,000	4,600	25,000	--	--	ND	--
	7/21/1993	24.51	69.97	SPH	--	--	--	--	--	--	--	--
	11/9/1993	26.06	68.42	SPH	--	--	--	--	--	--	--	--
	8/30/1995	21.73	72.75	SPH	--	--	--	--	--	--	--	--
	12/4/1995	21.94	72.54	SPH	--	--	--	--	<200	--	--	--
	5/2/1996	20.65	73.83	340,000	57,000	73,000	7,200	38,000	--	--	--	--
	11/5/1996	24.29	70.19	270,000	43,000	56,000	4,500	34,000	--	--	--	--
	5/9/1997	22.79	71.69	240,000	36,000	45,000	3,300	17,900	--	--	--	--
	11/5/1997	25.06	69.42	240,000	42,000	48,000	3,600	18,800	<1,000	--	--	--
	2/9/1998	22.64	71.84	220,000	47,000	60,000	5,200	29,800	<1,000	--	ND	--
	5/1/1998	19.95	74.53	160,000	35,000	42,000	2,800	16,000	<1,000	--	ND	--
	11/3/1998	23.29	71.19	200,000	39,000	49,000	4,400	26,000	<500	--	ND	--
	3/24/1999	22.30	72.18	SPH	--	--	--	--	--	--	--	--
	7/1/1999	22.70	71.78	SPH	--	--	--	--	--	--	--	--
	9/21/1999	23.81	70.67	SPH	--	--	--	--	--	--	--	--
	2/9/2000	23.95	70.59	SPH	--	--	--	--	--	--	--	--
	5/31/2000	22.05	72.43	SPH	--	--	--	--	--	--	--	--
	8/8/2000	22.49	71.99	SPH	--	--	--	--	--	--	--	--
	11/14/2000	24.65	69.83	SPH	--	--	--	--	--	--	--	--
	3/1/2001	24.22	70.28	SPH	--	--	--	--	--	--	--	--
	5/7/2001	23.85	70.67	SPH (0.05)	--	--	--	--	--	--	--	--
	8/1/2001	23.91	70.64	SPH (0.09)	--	--	--	--	--	--	--	--
	11/5/2001	23.95	70.67	SPH (0.18)	--	--	--	--	--	--	--	--
	2/13/2002	23.15	71.39	SPH(0.07)	--	--	--	--	--	--	--	--
	5/2/2002	23.91	70.60	SPH (0.04)	--	--	--	--	--	--	--	--
	8/4/2002	24.02	70.48	SPH (0.03)	--	--	--	--	--	--	--	--
	11/26/2002	24.47	70.05	SPH (0.05)	--	--	--	--	--	--	--	--
	1/20/2003	22.37	72.14	SPH (0.04)	--	--	--	--	--	--	--	--
	5/28/2003	21.77	72.73	SPH (0.02)	--	--	--	--	--	--	--	--
	8/5/2003	23.07	71.44	SPH (0.04)	--	--	--	--	--	--	--	--
	11/10/2003	22.53	71.97	SPH (0.03)	--	--	--	--	--	--	--	--
	2/18/2004	22.61	71.91	SPH (0.05)	--	--	--	--	--	--	--	--
	5/27/2004	22.08	72.44	SPH (0.05)	--	--	--	--	--	--	--	--
	8/19/2004	24.35	70.43	SPH (0.38)	--	--	--	--	--	--	--	--
	12/27/2004	24.62	70.21	SPH (0.44)	--	--	--	--	--	--	--	--

Pangea

Table 1. Groundwater Elevation and Analytical Data: Volatile Hydrocarbons, HVOCs, and Dissolved Oxygen
 Connell Automobile Dealership, 3093 Broadway, Oakland, California

Well ID TOC Elev. (ft)	Sampling Date	Depth to Groundwater (ft)	Groundwater Elevation (ft)	TVH/TPHg (µg/L)	Benzene (µg/L)	Toluene (µg/L)	Ethyl- benzene (µg/L)	Xylenes (µg/L)	MTBE (µg/L)	1,2-DCA (µg/L)	Other HVOCs (µg/L)	DO (mg/L)
>>MW-1 (continued)	2/18/2005	23.14	71.37	SPH (0.04)	--	--	--	--	--	--	--	--
	5/11/2005	22.71	71.79	SPH (0.02)	--	--	--	--	--	--	--	--
	8/3/2005	23.03	71.50	SPH (0.06)	--	--	--	--	--	--	--	--
	11/30/2005	23.98	70.52	SPH (0.03)	--	--	--	--	--	--	--	--
	2/17/2006	23.81	70.68	SPH (0.01)	--	--	--	--	--	--	--	--
	5/12/2006	21.75	72.75	SPH (0.02)	--	--	--	--	--	--	--	--
	8/7/2006	21.35	73.14	SPH (0.01)	--	--	--	--	--	--	--	--
	11/21/2006	23.38	71.13	SPH (0.04)	--	--	--	--	--	--	--	--
	2/12/2007	23.18	71.32	SPH (0.03)	--	--	--	--	--	--	--	--
	5/11/2007	22.68	71.80	--	--	--	--	--	--	--	--	0.20
MW-2 94.85	3/1/1991	27.90	66.95	<50	<0.5	<0.5	<0.5	<0.5	--	--	ND	--
	11/24/1992	27.95	66.90	<50	<0.5	1.1	<0.5	1.5	--	--	ND	--
	4/5/1993	25.99	68.86	<50	<0.5	<0.5	<0.5	<0.5	--	--	ND	--
	7/21/1993	25.63	69.22	<50	<0.5	<0.5	<0.5	<0.5	--	--	ND	--
	11/10/1993	26.76	68.09	<50	<0.5	<0.5	<0.5	<0.5	--	--	ND	--
	8/30/1995	25.79	69.06	<50	<0.5	<0.5	<0.5	<0.5	--	--	--	--
	5/3/1996	23.32	71.53	<50	<0.5	<0.5	<0.5	<0.5	--	--	ND	--
	5/8/1997	24.62	70.23	<50	<0.5	0.7	<0.5	<0.5	--	--	--	--
	4/29/1998	22.22	72.63	<50	<0.5	<0.5	<0.5	<0.5	<2	--	ND	--
MW-3 90.08	3/1/1991	23.17	66.91	<50	<50	0.6	<0.5	<0.5	--	--	ND	--
	11/25/1992	23.01	67.07	50	<0.5	0.9	<0.5	2	--	--	ND	--
	4/5/1993	22.11	67.97	<50	<0.5	<0.5	<0.5	<0.5	--	--	ND	--
	7/21/1993	23.93	66.15	<50	<0.5	<0.5	<0.5	<0.5	--	--	ND	--
	11/10/1993	23.14	66.94	<50	<0.5	<0.5	<0.5	<0.5	--	--	ND	--
	8/30/1995	20.61	69.47	<50	<0.5	<0.5	<0.5	<0.5	--	--	--	--
	5/3/1996	18.43	71.65	<50	<0.5	<0.5	<0.5	<0.5	--	--	ND	--
	5/8/1997	19.77	70.31	<50	<0.5	0.7	<0.5	<0.5	--	--	--	--
4/29/1998	17.92	72.16	<50	<0.5	<0.5	<0.5	<0.5	<2	--	ND	--	
MW-4 88.84	3/1/1991	23.79	65.05	150,000	20,000	38,000	2,800	14,000	**	--	ND	--
	10/12/1992	22.48	66.36	230,000	15,000	32,000	2,500	14,000	--	--	--	--
	11/24/1992	22.60	66.24	210,000	14,000	31,000	2,500	14,000	--	--	ND	--
	4/2/1993	20.11	68.73	SPH	--	--	--	--	--	--	--	--
	7/21/1993	20.48	68.36	SPH	--	--	--	--	--	--	--	--
	11/9/1993	21.71	67.13	SPH	--	--	--	--	--	--	--	--
	8/30/1995	19.90	68.94	SPH	--	--	--	--	--	--	--	--
	12/1/1995	19.40	69.44	SPH	--	--	--	--	--	--	--	--
	5/2/1996	17.50	71.34	140,000	24,000	50,000	3,000	15,100	--	--	ND	--
	11/4/1996	20.13	68.71	160,000	16,000	38,000	2,700	14,000	--	--	ND	--
5/8/1997	18.63	70.21	170,000	16,000	37,000	2,400	15,900	--	--	--	--	
11/5/1997	20.19	68.65	190,000	15,000	31,000	2,200	14,600	<400	--	--	--	
2/9/1998	18.28	70.56	110,000	19,000	42,000	2,500	18,300	<500	--	--	--	

Pangea

Table 1. Groundwater Elevation and Analytical Data: Volatile Hydrocarbons, HVOCs, and Dissolved Oxygen
Connell Automobile Dealership, 3093 Broadway, Oakland, California

Well ID TOC Elev. (ft)	Sampling Date	Depth to Groundwater (ft)	Groundwater Elevation (ft)	TVH/TPHg (µg/L)	Benzene (µg/L)	Toluene (µg/L)	Ethyl- benzene (µg/L)	Xylenes (µg/L)	MTBE (µg/L)	1,2-DCA (µg/L)	Other HVOCs (µg/L)	DO (mg/L)
>>MW-4 (continued)	5/1/1998	16.11	72.73	130,000	15,000	31,000	2,000	13,400	<1,000	--	ND	--
	8/4/1998	17.54	71.30	130,000	16,000	34,000	2,400	15,700	<400	--	ND	--
	11/2/1998	19.21	69.63	140,000	16,000	32,000	2,300	15,500	<400	--	ND	--
	3/26/1999	17.51	71.33	110,000	15,000	30,000	1,600	15,000	450 ⁴	--	5	--
	7/1/1999	18.80	70.04	110,000	13,000	23,000	1,600	12,000	<83	--	5	--
	9/21/1999	19.85	68.99	140,000	16,000	31,000	2,400	14,800	ND	--	5	3.27
	2/9/2000	19.76	69.08	140,000	16,000	28,000	2,100	14,000	<400	--	DCB: 5.9, MCB: 5.9	--
	5/31/2000	17.90	70.94	15,000	17,000	28,000	2,400	14,000	<0.5 ⁶	--	ND	--
	8/8/2000	18.62	70.22	140,000	15,000	25,000	2,100	13,000	<300	--	ND	0.60
	11/14/2000	19.63	69.21	150,000	19,000	36,000	2,900	17,000	<200	--	ND	0.32
	3/1/2001	19.68	69.16	120,000	10,000	15,000	1,300	10,000	<2000	--	ND	0.13
	5/7/2001	18.60	70.24	210,000	12,000	19,000	1,900	12,000	<200	--	ND	0.23
	8/1/2001	18.73	70.11	160,000	13,000	21,000	2,200	13,000	<200	--	ND	--
	11/5/2001	18.97	69.87	220,000	15,000	26,000	3,100	16,000	<200	--	ND	--
	2/13/2002	18.59	70.25	180,000	6,100	11,000	1,400	13,000	<200	--	2-MNE: 620, NE: 1000	0.43
	5/2/2002	18.77	70.07	110,000	13,000	20,000	2,000	10,000	<1,200	--	ND	0.21
	8/4/2002	18.95	69.89	92,000	9,200	15,000	1,800	10,000	<2,000	--	ND	0.35
	11/26/2002	20.83	68.01	110,000	16,000	26,000	2,700	12,000	<1,000	--	ND	0.29
	1/20/2003	16.90	71.94	110,000	9,000	16,000	1,900	11,000	<1,200	--	ND	0.35
	5/28/2003	15.25	73.59	110,000	13,000	17,000	1,800	8,500	<1,000	--	ND	0.59
	8/5/2003	17.05	71.79	110,000	13,000	20,000	2,200	9,800	<1,000	--	<25	0.66
	11/10/2003	16.60	72.24	130,000	14,000	23,000	2,700	12,000	<2,700	--	--	0.74
88.84	2/18/2004	16.59	72.25	110,000	11,000	17,000	1,600	9,900	<3,500	--	--	0.46
	5/27/2004	15.97	72.87	97,000	12,000	18,000	2,100	8,900	<3,000	--	--	0.59
	8/19/2004	18.11	70.73	92,000	9,500	15,000	1,900	8,600	<2,500	--	--	0.77
	12/27/2004	19.53	69.31	120,000	16,000	28,000	2,800	12,000	<1,000	--	--	0.2
	2/18/2005	18.40	70.44	97,000	11,000	16,000	1,700	7,400	<4,000	<50	<50	0.89
	5/11/2005	17.93	70.91	110,000	10,000	16,000	1,900	8,400	<3,000	--	--	1.03
	8/3/2005	18.14	70.70	110,000	12,000	18,000	2,200	8,000	<3,600	--	--	0.77
	11/30/2005	19.70	69.14	100,000	12,000	18,000	2,200	9,400	<2700	--	--	0.39
	2/17/2006	17.63	71.21	100,000	12,000	17,000	2,100	7,800	<2500	39	<10	0.2
	5/12/2006	15.53	73.31	100,000	11,000	15,000	2,100	8,700	2,000	--	--	0.27
	8/7/2006	17.75	71.09	97,000	11,000	15,000	2,200	8,700	<1,500	--	--	0.47
	11/21/2006	19.14	69.70	99,000	9,200	13,000	2,000	8,100	<2,100	--	--	0.20
	2/12/2007	18.98	69.86	140,000	11,000	16,000	2,100	7,800	<3,600	32	<5 ⁷	0.20
	5/11/2007	18.27	70.57	140,000	9,900	15,000	2,000	7,200	<2,700	32	--	0.62

Pangea

Table 1. Groundwater Elevation and Analytical Data: Volatile Hydrocarbons, HVOCs, and Dissolved Oxygen
Connell Automobile Dealership, 3093 Broadway, Oakland, California

Well ID <i>TOC Elev.</i> <i>(ft)</i>	Sampling Date	Depth to Groundwater <i>(ft)</i>	Groundwater Elevation <i>(ft)</i>	TVH/TPHg <i>(µg/L)</i>	Benzene <i>(µg/L)</i>	Toluene <i>(µg/L)</i>	Ethyl- benzene <i>(µg/L)</i>	Xylenes <i>(µg/L)</i>	MTBE <i>(µg/L)</i>	1,2-DCA <i>(µg/L)</i>	Other HVOCs <i>(µg/L)</i>	DO <i>(mg/L)</i>
MW-5 84.84	3/15/1991	26.31	58.53	<50	<0.5	<0.5	<0.5	<0.5	--	--	ND	--
	11/10/1992	26.83	58.01	<50	<0.5	<0.5	<0.5	<0.5	--	--	ND	--
	4/2/1993	26.62	58.22	<50	<0.5	<0.5	<0.5	<0.5	--	--	ND	--
	7/21/1993	26.60	58.24	<50	<0.5	<0.5	<0.5	<0.5	--	--	ND	--
	11/9/1993	27.24	57.60	<50	<0.5	<0.5	<0.5	<0.5	--	--	ND	--
	8/30/1995	27.46	57.38	<50	<0.5	<0.5	<0.5	<0.5	--	--	--	--
	5/3/1996	26.02	58.82	<50	<0.5	<0.5	<0.5	<0.5	--	--	ND	--
	5/8/1997	26.76	58.08	<50	<0.5	0.5	<0.5	<0.5	--	--	--	--
	4/29/1998	26.55	58.29	<50	<0.5	0.5	<0.5	<0.5	<2	--	ND	--
										--		
MW-6 85.62	3/15/1991	25.82	59.80	80,000	12,000	13,000	1,100	5,400	--	--	DBCM: 160	--
	10/12/1992	25.02	60.60	19,000	3,200	1,400	200	560	--	--	--	--
	12/1/1992	28.87	56.75	SPH	--	--	--	--	--	--	--	--
	4/2/1993	26.96	58.66	SPH	--	--	--	--	--	--	--	--
	7/21/1993	26.17	59.45	SPH	--	--	--	--	--	--	--	--
	11/9/1993	27.51	58.11	SPH	--	--	--	--	--	--	--	--
	8/30/1995	28.00	57.62	SPH	--	--	--	--	--	--	--	--
	12/1/1995	27.58	58.04	SPH	--	--	--	--	<8,000,000	--	--	--
86.94	5/3/1996	28.15	58.79	130,000	37,000	50,000	3,200	14,200	--	--	ND	--
	5/9/1997	26.54	60.40	1,700,000	14,000	27,000	4,000	28,200	--	--	--	--
	11/5/1997	26.16	60.78	160,000	13,000	19,000	1,900	14,300	<200	--	--	--
	5/1/1998	22.96	62.86	130,000	15,000	23,000	1,700	13,200	<500	--	ND	--
85.82	11/3/1998	24.35	61.47	110,000	17,000	21,000	1,800	10,700	<200	--	ND	--
	3/26/1999	23.82	62.00	SPH	--	--	--	--	--	--	--	--
	7/1/1999	24.45	61.37	SPH	--	--	--	--	--	--	--	--
	9/21/1999	24.58	61.24	SPH	--	--	--	--	--	--	--	--
	2/9/2000	24.93	61.24	SPH	--	--	--	--	--	--	--	--
	5/31/2000	23.47	62.41	SPH	--	--	--	--	--	--	--	--
	8/8/2000	23.85	61.97	SPH	--	--	--	--	--	--	--	--
	11/14/2000	24.61	61.21	SPH	--	--	--	--	--	--	--	--
	3/1/2001	23.97	61.85	SPH	--	--	--	--	--	--	--	--
	5/7/2001	23.17	62.71	SPH	--	--	--	--	--	--	--	--
	8/1/2001	obstruction in well		--	--	--	--	--	--	--	--	--
	11/5/2001	obstruction in well		--	--	--	--	--	--	--	--	--
	2/13/2002	obstruction in well		--	--	--	--	--	--	--	--	--
	5/2/2002	23.25	62.41	SPH (0.05)	--	--	--	--	--	--	--	--
	8/4/2002	23.55	62.29	SPH (0.03)	--	--	--	--	--	--	--	--
	11/26/2002	24.22	61.62	SPH (0.03)	--	--	--	--	--	--	--	--
	1/20/2003	22.49	63.36	SPH (0.04)	--	--	--	--	--	--	--	--
	5/28/2003	21.92	63.93	SPH (0.04)	--	--	--	--	--	--	--	--

Pangea

Table 1. Groundwater Elevation and Analytical Data: Volatile Hydrocarbons, HVOCs, and Dissolved Oxygen
Connell Automobile Dealership, 3093 Broadway, Oakland, California

Well ID TOC Elev. (ft)	Sampling Date	Depth to Groundwater (ft)	Groundwater Elevation (ft)	TVH/TPHg (µg/L)	Benzene (µg/L)	Toluene (µg/L)	Ethyl- benzene (µg/L)	Xylenes (µg/L)	MTBE (µg/L)	1,2-DCA (µg/L)	Other HVOCs (µg/L)	DO (mg/L)	
>>MW-6 (continued)	8/5/2003	23.98	61.87	SPH (0.04)	--	--	--	--	--	--	--	--	
	11/10/2003	23.50	62.40	SPH (0.10)	--	--	--	--	--	--	--	--	
	2/18/2004	22.21	63.64	SPH (0.04)	--	--	--	--	--	--	--	--	
	5/27/2004	22.01	63.85	SPH (0.05)	--	--	--	--	--	--	--	--	
	8/19/2004	24.16	61.68	SPH (0.03)	--	--	--	--	--	--	--	--	
	12/27/2004	24.69	61.13	SPH (sheen)	--	--	--	--	--	--	--	--	
	2/18/2005	23.55	62.33	SPH (0.08)	--	--	--	--	--	--	--	--	
	5/11/2005	22.90	62.97	SPH (0.06)	--	--	--	--	--	--	--	--	
	8/3/2005	23.68	62.19	SPH (0.06)	--	--	--	--	--	--	--	--	
	11/30/2005	24.17	61.67	SPH (0.02)	--	--	--	--	--	--	--	--	
	2/17/2006	23.89	61.95	SPH (0.03)	--	--	--	--	--	--	--	--	
	5/12/2006	22.66	63.18	SPH (0.03)	--	--	--	--	--	--	--	--	
	8/7/2006	22.83	63.01	SPH (0.02)	--	--	--	--	--	--	--	--	
	11/21/2006	23.92	61.92	SPH (0.02)	--	--	--	--	--	--	--	--	
	2/12/2007	23.97	61.87	SPH (0.02)	--	--	--	--	--	--	--	--	
	5/11/2007	23.54	62.30	--	--	--	--	--	--	--	--	--	0.70
	MW-7 85.41	3/15/1991	21.63	63.78	<50	<0.5	<0.5	<0.5	<0.5	--	--	ND	--
11/24/1992		21.52	63.89	<50	<0.5	<0.5	<0.5	<0.5	--	--	ND	--	
4/2/1993		20.08	65.33	<50	<0.5	<0.5	<0.5	<0.5	--	--	ND	--	
7/21/1993		19.59	65.82	<50	<0.5	<0.5	<0.5	<0.5	--	--	ND	--	
11/9/1993		20.65	64.76	<50	<0.5	1	<0.5	1.7	--	--	ND	--	
8/30/1995		18.78	66.63	<50	<0.5	<0.5	<0.5	<0.5	--	--	--	--	
12/1/1995		19.47	65.94	<50	<0.5	<0.5	<0.5	<0.5	--	--	ND	--	
5/2/1996		17.15	68.26	<50	<0.5	<0.5	<0.5	<0.5	--	--	ND	--	
8/8/1996		18.48	66.93	<50	<0.5	<0.5	<0.5	<0.5	<2	--	ND	--	
11/4/1996		18.69	66.72	<50	<1	<1	<1	<1	--	--	ND	--	
2/6/1997		17.44	67.97	<50	<0.5	<0.5	<0.5	<0.5	<2	--	ND	--	
5/8/1997		17.72	67.69	<50	<0.5	<0.5	<0.5	<0.5	--	--	--	--	
8/7/1997		18.49	66.92	<50	<0.5	<0.5	<0.5	<0.5	<2	--	ND	--	
11/5/1997		18.86	66.55	<50	<0.5	<0.5	<0.5	<0.5	<2	--	--	--	
2/9/1998		17.56	67.85	<50	<0.5	<0.5	<0.5	<0.5	<2	--	--	--	
4/29/1998		16.23	69.18	<50	<0.5	<0.5	<0.5	<0.5	<2	--	ND	--	
8/4/1998		17.24	68.17	<50	<0.5	<0.5	<0.5	<0.5	<2	--	ND	--	
11/2/1998		17.91	67.50	<50	<0.5	<0.5	<0.5	<0.5	<2	--	ND	--	
3/26/1999		16.42	68.99	<50	<0.5	<0.5	<0.5	<0.5	<2	--	ND	--	
7/1/1999		17.90	67.51	85	<0.5	1.1	0.55	2.5	<0.5	--	ND ⁵	--	
9/21/1999	18.91	66.50	<50	0.7	1.8	<0.5	1.5	<5.0	--	ND	4.32		
2/9/2000	16.74	68.67	<50	<0.5	<0.5	<0.5	<0.5	<5.0	--	<0.5	--		
5/31/2000	16.21	69.20	<50	3	6	1	9	<0.5	--	ND	--		
8/8/2000	16.92	68.49	<50	<0.5	<0.5	<0.5	<0.5	<5.0	--	ND	0.43		
11/14/2000	17.00	68.41	<50	<0.5	0.63	<0.5	<0.5	<5.0	--	ND	0.44		
3/1/2001	17.09	68.32	<50	<0.5	<0.5	<0.5	<0.5	<5.0	--	ND	--		
5/7/2001	17.19	68.22	<50	<0.5	<0.5	<0.5	<0.5	<5.0	--	ND	0.51		

Pangea

Table 1. Groundwater Elevation and Analytical Data: Volatile Hydrocarbons, HVOCs, and Dissolved Oxygen
Connell Automobile Dealership, 3093 Broadway, Oakland, California

Well ID TOC Elev. (ft)	Sampling Date	Depth to Groundwater (ft)	Groundwater Elevation (ft)	TVH/TPHg (µg/L)	Benzene (µg/L)	Toluene (µg/L)	Ethyl- benzene (µg/L)	Xylenes (µg/L)	MTBE (µg/L)	1,2-DCA (µg/L)	Other HVOCs (µg/L)	DO (mg/L)
>>MW-7 (continued)	8/1/2001	17.25	68.16	<50	<0.5	<0.5	<0.5	<0.5	<5.0	--	ND	--
	11/5/2001	17.35	68.06	<50	<0.5	<0.5	<0.5	<0.5	<5.0	--	ND	--
	2/13/2002	17.50	67.91	<50	<0.5	<0.5	<0.5	<0.5	<5.0	--	ND	0.80
	5/2/2002	17.30	68.11	<50	<0.5	<0.5	<0.5	<0.5	<5.0	--	ND	0.31
	8/4/2002	17.58	67.83	<50	<0.5	<0.5	<0.5	<0.5	<5.0	--	ND	0.37
	11/26/2002	18.35	67.06	<50	<0.5	<0.5	<0.5	<0.5	<5.0	--	ND	0.28
	1/20/2003	15.84	69.57	<50	<0.5	<0.5	<0.5	<0.5	<5.0	--	ND	0.61
	5/28/2003	15.19	70.22	<50	<0.5	<0.5	<0.5	<0.5	<5.0	--	ND	0.74
	8/5/2003	17.00	68.41	<50	<0.5	<0.5	<0.5	<0.5	<5.0	--	<0.5	0.61
	11/10/2003	16.54	68.87	<50	<0.5	<0.5	<0.5	<0.5	<5.0	--	--	0.65
	2/18/2004	16.47	68.94	<50	<0.5	<0.5	<0.5	<0.5	<5.0	--	--	0.74
	5/27/2004	15.93	69.48	<50	<0.5	<0.5	<0.5	<0.5	<5.0	--	--	0.65
	8/19/2004	18.05	67.36	<50	<0.5	<0.5	<0.5	<0.5	<5.0	--	--	0.71
	12/27/2004	17.35	68.06	<50	<0.5	<0.5	<0.5	<0.5	<5.0	--	--	2.0
	2/18/2005	16.23	69.18	<50	<0.5	<0.5	<0.5	<0.5	<5.0	<0.5	<0.5	0.93
	5/11/2005	15.79	69.62	<50	<0.5	<0.5	<0.5	<0.5	<5.0	--	--	1.18
	8/3/2005	17.52	67.89	<50	<0.5	<0.5	<0.5	<0.5	<5.0	--	--	0.89
	11/30/2005	19.57	65.84	<50	<0.5	<0.5	<0.5	<0.5	<5.0	--	--	1.70
	2/17/2006	16.82	68.59	<50	<0.5	<0.5	<0.5	<0.5	<5.0	<0.5	<1.0	0.99
	5/12/2006	15.86	69.55	<50	<0.5	<0.5	<0.5	<0.5	<5.0	--	--	0.11
8/7/2006	17.52	67.89	<50	<0.5	<0.5	<0.5	<0.5	<5.0	--	--	0.33	
11/21/2006	18.67	66.74	<50	<0.5	<0.5	<0.5	<0.5	<5.0	--	--	0.39	
2/12/2007	18.20	67.21	<50	<0.5	<0.5	<0.5	<0.5	<5.0	<0.5	<0.5 ⁷	0.75	
5/11/2007	17.73	67.68	<50	<0.5	<0.5	<0.5	<0.5	<0.5	<5.0	--	--	0.93
MW-8	10/12/1992	27.70	57.80	70	20	1	1	3	--	--	--	--
85.50	11/25/1992	27.62	57.88	<50	<0.5	<0.5	<0.5	<0.5	--	--	ND	--
	4/8/1993	26.64	58.86	490	15	45	5.1	73	--	--	ND	--
	7/21/1993	26.60	58.90	180	2.5	3	<0.5	1.9	--	--	ND	--
	11/11/1993	27.18	58.32	310	23	<0.5	<0.5	<0.5	--	--	ND	--
	8/30/1995	26.35	59.15	660	360	6.8	13	2.8	--	--	--	--
	12/4/1995	26.72	58.78	250	46	0.9	4.9	<0.5	--	--	ND	--
	5/3/1996	25.47	60.03	69	110	<0.5	<0.5	1.5	--	--	ND	--
	8/8/1996	26.41	59.09	120	11	<0.5	<0.5	<0.5	<2	--	ND	--
	11/5/1996	26.77	58.73	110	20	<1	1	<1	--	--	ND	--
	2/6/1997	25.84	59.66	67	51	<0.5	0.56	<0.5	<2	--	ND	--
	5/9/1997	26.39	59.11	110	59	<0.5	<0.5	<0.5	--	--	--	--
	8/7/1997	26.72	58.78	<50	12	<0.5	<0.5	<0.5	<2	--	ND	--
	11/5/1997	26.82	58.68	<50	9.4	<0.5	<0.5	<0.5	<2	--	--	--
	2/9/1998	25.57	59.93	<50	6	<0.5	<0.5	<0.5	<2	--	--	--
	5/1/1998	25.64	59.86	430	490	7.1	27	26	<10	--	ND	--
	8/5/1998	25.96	59.54	140	19	<0.5	5.2	5.3	<2	--	ND	--
	11/3/1998	26.27	59.23	150	110	1.1	4.3	4.5	<2	--	ND	--
	3/31/1999	20.93	64.57	54	170	1.5	4.1	1.9	4.4	--	1,1 DCA: 0.7	--

Pangea

Table 1. Groundwater Elevation and Analytical Data: Volatile Hydrocarbons, HVOCs, and Dissolved Oxygen
Connell Automobile Dealership, 3093 Broadway, Oakland, California

Well ID TOC Elev. (ft)	Sampling Date	Depth to Groundwater (ft)	Groundwater Elevation (ft)	TVH/TPHg (µg/L)	Benzene (µg/L)	Toluene (µg/L)	Ethyl- benzene (µg/L)	Xylenes (µg/L)	MTBE (µg/L)	1,2-DCA (µg/L)	Other HVOCs (µg/L)	DO (mg/L)
>>MW-8	7/1/1999	26.59	58.91	140	58	0.9	3	2.3	<0.5	--	⁵	--
(continued)	9/21/1999	26.89	58.61	670	170	2.6	11	7.9	<5	--	ND	2.61
	2/9/2000	26.60	58.90	300	60	1.2	4.8	1.2	<5.0	--	<0.5	--
	8/8/2000	26.43	59.07	270	56	1.2	4.1	1.0	<5.0	--	ND	0.25
	11/14/2000	26.60	58.90	330	64	1.3	3.5	0.60	< 5.0	--	ND	0.51
	3/1/2001	26.41	59.09	400	140	<0.5	<0.5	0.55	<5.0	--	ND	--
	5/7/2001	26.55	58.95	240	37	0.71	2.5	0.77	<5.0	--	ND	0.49
	8/1/2001	26.71	58.79	130	5.2	<0.5	<0.5	<0.5	<5.0	--	ND	--
	11/5/2001	26.67	58.83	140	3.3	<0.5	<0.5	<0.5	<5.0	--	ND	--
	2/13/2002	26.15	59.35	1,100	440	0.087	0.66	2.0	<5.0	--	ND	0.71
	5/2/2002	26.63	58.87	90	3.9	<0.5	<0.5	<0.5	<5.0	--	ND	0.37
	8/4/2002	26.80	58.70	120	2.4	0.77	<0.5	<0.5	<5.0	--	ND	0.44
	11/26/2002	27.50	58.00	85	3.7	<0.5	<0.5	<0.5	<5.0	--	ND	0.48
	1/20/2003	24.93	60.57	90	3.9	0.67	<0.5	<0.5	<5.0	--	ND	0.65
	5/28/2003	24.28	61.22	120	1.4	<0.5	<0.5	<0.5	<5.0	--	ND	0.71
	8/5/2003	26.51	58.99	150 ^f	<0.5	<0.5	<0.5	<0.5	<5.0	--	<1.0	0.67
	11/10/2003	26.04	59.46	50	0.84	<0.5	<0.5	<0.5	<5.0	--	--	0.70
	2/18/2004	25.97	59.53	52	<0.5	<0.5	<0.5	<0.5	<5.0	--	--	0.69
	5/27/2004	25.31	60.19	75	0.76	<0.5	<0.5	<0.5	<5.0	--	--	0.98
	8/19/2004	27.55	57.95	72	1.7	<0.5	<0.5	<0.5	<5.0	--	--	1.41
	12/27/2004	26.50	59.00	160	22	0.74	2.2	0.55	<5.0	--	--	0.2
	2/18/2005	26.00	59.50	130	27	0.70	2.3	0.69	<5.0	47	<1.0	0.91
	5/11/2005	25.47	60.03	550	190	2.5	2.9	9.3	<5.0	--	--	1.22
	8/3/2005	26.31	59.19	240	36	0.86	3.1	1.2	<5.0	--	--	1.05
	11/30/2005	26.51	58.99	160	28	1.7	2.0	1.3	<5.0	--	--	0.71
	2/17/2006	26.11	59.39	200	39	0.67	2.7	1.6	<5.0	37	<1.0	0.64
	5/12/2006	25.38	60.12	770	260	7.40	5.1	5.8	<5.0	--	--	0.19
	8/7/2006	26.10	59.40	320	52	1.0	2.7	1.2	<5.0	--	--	0.17
	11/21/2006	26.43	59.07	54	9.2	<0.5	0.56	0.64	<5.0	--	--	0.22
	2/12/2007	26.29	59.21	1,000	310	5.1	25	27	<5.0	25	<0.5 ⁷	0.37
	5/11/2007	26.23	59.27	300	48	0.74	2.9	1.2	<5.0	--	--	0.55
MW-9	11/24/1992	23.51	66.86	19,000	180	590	23	2,000	--	--	TCM: 15	--
90.37	4/5/1993	21.14	69.23	2,300	48	4	0.6	13	--	--	TCM: 2	--
	7/21/1993	21.54	68.83	2,300	170	8.1	15	<0.5	--	--	ND	--
	11/10/1993	27.53	62.84	4,400	69	7.3	21	9.7	--	--	ND	--

Pangea

Table 1. Groundwater Elevation and Analytical Data: Volatile Hydrocarbons, HVOCs, and Dissolved Oxygen
Connell Automobile Dealership, 3093 Broadway, Oakland, California

Well ID <i>TOC Elev.</i> <i>(ft)</i>	Sampling Date	Depth to Groundwater <i>(ft)</i>	Groundwater Elevation <i>(ft)</i>	TVH/TPHg <i>(µg/L)</i>	Benzene <i>(µg/L)</i>	Toluene <i>(µg/L)</i>	Ethyl- benzene <i>(µg/L)</i>	Xylenes <i>(µg/L)</i>	MTBE <i>(µg/L)</i>	1,2-DCA <i>(µg/L)</i>	Other HVOCs <i>(µg/L)</i>	DO <i>(mg/L)</i>
>>MW-9	8/30/1995	19.59	70.78	3,200	3,900	49	80	22.8	--	--	--	--
<i>(continued)</i>	12/4/1995	20.65	69.72	--	--	--	--	--	<2	--	--	--
	5/2/1996	18.63	71.74	<1300	2,600	<13	200	<13	--	--	ND	--
	11/5/1996	20.69	69.68	1,800	280	<5	65	<5	--	--	ND	--
	5/9/1997	19.96	70.41	1,100	160	<0.5	42	<0.5	--	--	--	--
	8/8/1997	20.84	69.53	570 ^{1,2}	<0.5	<0.5	<0.5	0.78 ³	<2	--	ND	--
	11/5/1997	21.55	68.82	490 ¹	<0.5	<0.5	6	<0.5	<2	--	--	--
	2/9/1998	20.21	70.16	270 ¹	48	17	5.8	<0.5	<2	--	--	--
	5/1/1998	19.27	71.10	550	70	<0.5	22	2.2	<2	--	ND	--
	8/5/1998	19.35	71.02	550 ¹	88	<0.5	13	1.9 ³	<2	--	ND	--
	11/2/1998	20.43	69.94	580	<0.5	<0.5	7.5 ³	1.6 ³	<2	--	ND	--
	3/25/1999	18.46	71.91	1,100	160	<0.5	21	2.1 ³	5.7 ⁴	--	ND	--
	7/1/1999	19.95	70.42	540	100	7.4	26	16.9	<1.3	--	⁵	--
	9/21/1999	21.15	69.22	2,700	320	98	88	47	<20	--	ND	5.86
	2/9/2000	21.08	69.29	1,600	81	3.6	19	18	<5.0	--	<0.5	--
	5/31/2000	19.11	71.26	1,500	170	13	25	<1.0	<0.5	--	ND	--
	8/8/2000	19.86	70.51	1,300	140	2.1	19	<0.5	<5.0	--	ND	2.4
	11/14/2000	20.90	69.47	1,700	250	2.6	44	2.1	<5.0	--	ND	0.29
	3/1/2001	20.45	69.92	1,800	170	5.6	30	2.5	<20	--	ND	0.31
	5/7/2001	19.83	70.54	1,500	120	2.6	24	<0.5	<5.0	--	ND	0.18
	8/1/2001	20.02	70.35	2,600	280	4.8	50	<0.5	<5.0	--	ND	--
	11/5/2001	19.85	70.52	2,200	170	4.5	100	0.54	<5.0	--	ND	--
	2/13/2002	19.80	70.57	1,800	98	3	58	1.5	<5.0	--	ND	0.53
	5/2/2002	19.93	70.44	1,100	82	1.4	20	<0.5	<10	--	ND	0.28
	8/4/2002	20.20	70.17	1,200	130	2.5	50	0.58	<10	--	ND	0.51
	11/26/2002	20.37	70.00	1,200	150	3.3	48	<2.5	<25	--	ND	0.53
	1/20/2003	17.93	72.44	840	110	1.2	31	0.76	<5.0	--	ND	0.31
	5/28/2003	17.25	73.12	1,100	40	1.9	3.0	<0.5	<20	--	ND	0.60
	8/5/2003	19.03	71.34	1,100 ^a	62	0.99	25	<0.5	<5.0	--	<10	0.54
	11/10/2003	18.65	71.72	1,500	120	7.6	41	<1.0	<10	--	--	0.62
	2/18/2004	18.41	71.96	820	50	1.2	19	<0.5	<5.0	--	--	0.58
	5/27/2004	17.89	72.48	730	36	2.0	11	1.6	<5.0	--	--	0.90
	8/19/2004	20.14	70.23	1,200	95	2.5	24	<0.5	<25	--	--	0.98
	12/27/2004	21.65	68.72	720	25	14	2.0	3.5	<15	--	--	2.5
	2/18/2005	19.97	70.40	600	24	<0.5	3.8	<0.5	<5.0	220	<5.0	0.88
	5/11/2005	19.41	70.96	510	11	<0.5	1.6	<0.5	<5.0	--	--	0.95
	8/3/2005	19.35	71.02	620	26	5.7	4.0	<0.5	<5.0	--	--	0.65
	11/30/2005	20.96	69.41	1,300	120	2.9	22	<0.5	<10	--	--	0.49
	2/17/2006	19.13	71.24	540	11	<0.5	1.1	<0.5	<5.0	160	<10	0.70
	5/12/2006	17.70	72.67	600	12	0.54	1.7	<0.5	<5.0	--	--	0.30
	8/7/2006	18.82	71.55	600	31	1.8	4.2	<0.5	<5.0	--	--	0.24
	11/21/2006	20.10	70.27	670	32	2.6	3.4	<0.5	<5.0	--	--	0.25
	2/12/2007	20.48	69.89	520	14	0.74	1.2	<0.5	<5.0	210	<5 ⁷	0.51
	5/11/2007	19.55	70.82	710	4.8	1.8	<0.5	<0.5	<10	--	--	0.60

Pangea

Table 1. Groundwater Elevation and Analytical Data: Volatile Hydrocarbons, HVOCs, and Dissolved Oxygen
Connell Automobile Dealership, 3093 Broadway, Oakland, California

Well ID <i>TOC Elev.</i> <i>(ft)</i>	Sampling Date	Depth to Groundwater <i>(ft)</i>	Groundwater Elevation <i>(ft)</i>	TVH/TPHg <i>(µg/L)</i>	Benzene <i>(µg/L)</i>	Toluene <i>(µg/L)</i>	Ethyl- benzene <i>(µg/L)</i>	Xylenes <i>(µg/L)</i>	MTBE <i>(µg/L)</i>	1,2-DCA <i>(µg/L)</i>	Other HVOCs <i>(µg/L)</i>	DO <i>(mg/L)</i>
MW-10 88.60	10/12/1992	21.55	67.05	28,000	2,700	3,800	210	1,300	--	--	--	--
	11/24/1992	21.86	66.74	130,000	9,700	19,000	1,400	8,400	--	--	ND	--
	4/5/1993	19.14	69.46	63,000	6,300	14,000	1,100	7,500	--	--	ND	--
	7/21/1993	19.79	68.81	140,000	16,000	31,000	2,200	13,000	--	--	ND	--
	8/30/1995	17.99	70.61	92,000	13,000	24,000	1,800	9,100	--	--	--	--
	5/3/1996	17.04	71.56	81,000	17,000	29,000	2,100	8,500	--	--	ND	--
	5/9/1997	18.36	70.24	63,000	7,400	13,000	940	4,100	--	--	--	--
	5/1/1998	15.84	72.76	60,000	7,100	14,000	1,100	5,300	<250	--	ND	--
MW-11 102.06	11/24/1992	33.65	68.41	<50	<0.5	<0.5	<0.5	<0.5	--	--	ND	--
	12/8/92***	33.37	68.69	<50	<0.1	<0.1	<0.1	<0.1	--	--	--	--
	12/8/1992	33.37	68.69	<50	<0.5	<0.5	<0.5	<0.5	--	--	--	--
	4/5/1993	31.03	71.03	<50	<0.5	<0.5	<0.5	<0.5	--	--	ND	--
	7/21/1993	31.90	70.16	160	<0.5	1.8	<0.5	<0.5	--	--	ND	--
	11/9/1993	32.60	69.46	80	<0.5	<0.5	<0.5	<0.5	--	--	ND	--
	8/30/1995	28.92	73.14	<50	<0.5	<0.5	<0.5	<0.5	--	--	--	--
	5/3/1996	28.00	74.06	<50	<0.5	<0.5	<0.5	<0.5	--	--	ND	--
	5/8/1997	29.93	72.13	<50	<0.5	<0.5	<0.5	<0.5	--	--	--	--
	4/29/1998	27.22	74.84	<50	<0.5	<0.5	<0.5	<0.5	<2	--	ND	--
MW-13 84.06	11/24/1992	26.05	58.01	<50	<0.5	<0.5	<0.5	<0.5	--	--	ND	--
	12/8/92***	25.08	58.98	<50	<0.1	<0.1	<0.1	<0.1	--	--	--	--
	12/8/1992	25.08	58.98	<50	<0.5	<0.5	<0.5	<0.5	--	--	--	--
	4/5/1993	24.64	59.42	<50	<0.5	0.9	<0.5	<0.5	--	--	ND	--
	7/21/1993	24.29	59.77	<50	<0.5	<0.5	<0.5	<0.5	--	--	ND	--
	11/9/1993	24.23	59.83	<50	<0.5	<0.5	<0.5	<0.5	--	--	ND	--
	8/30/1995	23.30	60.76	<50	49	<0.5	<0.5	<0.5	--	--	--	--
	12/1/1995	23.80	60.26	<50	<0.5	<0.5	<0.5	<0.5	--	--	ND	--
	5/3/1996	23.19	60.87	<50	<0.5	<0.5	<0.5	<0.5	--	--	ND	--
	8/8/1996	23.44	60.62	<50	32	<0.5	<0.5	<0.5	<2	--	ND	--
	11/5/1996	24.04	60.02	<50	<1	<1	<1	<1	--	--	ND	--
	2/6/1997	23.24	60.82	<50	<0.5	<0.5	<0.5	<0.5	<2	--	ND	--
	5/8/1997	23.46	60.60	<50	81	<0.5	<0.5	<0.5	--	--	--	--
	8/8/1997	23.92	60.14	<50	<0.5	<0.5	<0.5	<0.5	<2	--	ND	--
	11/5/1997	24.27	59.79	<50	<0.5	<0.5	<0.5	<0.5	<2	--	--	--
	2/9/1998	22.89	61.17	<50	<0.5	<0.5	<0.5	<0.5	<2	--	--	--
4/29/1998	22.27	61.79	<50	24	<0.5	<0.5	<0.5	<2	--	ND	--	
8/4/1998	22.75	61.31	120	200	<1	<1	<1	<4	--	ND	--	
11/3/1998	23.90	60.16	59 ¹	33	<0.5	<0.5	<0.5	<2	--	ND	--	
3/31/1999	23.11	60.95	130	0.56	<0.5	<0.5	<0.5	<2	--	ND	--	

Pangea

Table 1. Groundwater Elevation and Analytical Data: Volatile Hydrocarbons, HVOCs, and Dissolved Oxygen
Connell Automobile Dealership, 3093 Broadway, Oakland, California

Well ID TOC Elev. (ft)	Sampling Date	Depth to Groundwater (ft)	Groundwater Elevation (ft)	TVH/TPHg (µg/L)	Benzene (µg/L)	Toluene (µg/L)	Ethyl- benzene (µg/L)	Xylenes (µg/L)	MTBE (µg/L)	1,2-DCA (µg/L)	Other HVOCs (µg/L)	DO (mg/L)
>>MW-13 (continued)	7/1/1999	23.40	60.66	160	370	19	1.2	3.5	<1	--	⁵	--
	9/21/1999	21.91	62.15	370	150	1.0	0.8	0.8	<5.0	--	ND	3.76
	2/9/2000	23.84	60.22	<50	<0.5	<0.5	<0.5	<0.5	<5.0	--	<0.5	--
	8/8/2000	23.31	60.75	<50	<0.5	<0.5	<0.5	<0.5	<5.0	--	ND	1.76
	11/14/2000	24.00	60.06	< 50	< 0.5	0.52	< 0.5	< 0.5	< 5.0	--	ND	0.49
	3/1/2001	23.93	60.13	< 50	< 0.5	<0.5	< 0.5	< 0.5	< 5.0	--	ND	--
	5/7/2001	23.93	60.13	<50	<0.5	<0.5	<0.5	<0.5	<5.0	--	ND	0.59
	8/1/2001	24.10	59.96	<50	<0.5	<0.5	<0.5	<0.5	<5.0	--	ND	--
	11/5/2001	24.02	60.04	<50	<0.5	<0.5	<0.5	<0.5	<5.0	--	ND	--
	2/13/2002	23.70	60.36	<50	<0.5	<0.5	<0.5	<0.5	<5.0	--	ND	0.55
	5/2/2002	23.97	60.09	<50	<0.5	<0.5	<0.5	<0.5	<5.0	--	ND	0.63
	8/4/2002	24.19	59.87	<50	<0.5	<0.5	<0.5	<0.5	<5.0	--	ND	0.31
	11/26/2002	24.78	59.28	<50	<0.5	<0.5	<0.5	<0.5	<5.0	--	ND	0.47
	1/20/2003	22.10	61.96	<50	<0.5	<0.5	<0.5	<0.5	<5.0	--	ND	0.53
	5/28/2003	21.72	62.34	<50	<0.5	<0.5	<0.5	<0.5	<5.0	--	ND	0.75
	8/5/2003	23.99	60.07	<50	<0.5	<0.5	<0.5	<0.5	<5.0	--	<0.5	0.59
	11/10/2003	23.47	60.59	<50	<0.5	<0.5	<0.5	<0.5	<5.0	--	--	0.70
	2/18/2004	22.58	61.48	<50	<0.5	<0.5	<0.5	<0.5	<5.0	--	--	0.52
	5/27/2004	21.95	62.11	<50	<0.5	<0.5	<0.5	<0.5	<5.0	--	--	0.84
	8/19/2004	24.29	59.77	<50	<0.5	<0.5	<0.5	<0.5	<5.0	--	--	0.98
	12/27/2004	23.70	60.36	<50	<0.5	<0.5	<0.5	<0.5	<5.0	--	--	5.5
	2/18/2005	23.15	60.91	<50	<0.5	<0.5	<0.5	<0.5	<5.0	<0.5	<0.5	0.97
	5/11/2005	22.68	61.38	<50	<0.5	<0.5	<0.5	<0.5	<5.0	--	--	1.05
	8/3/2005	23.04	61.02	<50	<0.5	<0.5	<0.5	<0.5	<5.0	--	--	1.12
	11/30/2005	23.65	60.41	<50	<0.5	<0.5	<0.5	<0.5	<5.0	--	--	2.28
	2/17/2006	23.07	60.99	<50	<0.5	<0.5	<0.5	<0.5	<5.0	<0.5	<1.0	1.35
	5/12/2006	22.02	62.04	<50	<0.5	<0.5	<0.5	<0.5	<5.0	--	--	0.39
	8/7/2006	22.61	61.45	<50	<0.5	<0.5	<0.5	<0.5	<5.0	--	--	0.24
11/21/2006	23.11	60.95	<50	<0.5	<0.5	<0.5	<0.5	<5.0	--	--	0.94	
2/12/2007	23.27	60.79	<50	<0.5	<0.5	<0.5	<0.5	<5.0	<0.5	<0.5 ⁷	0.52	
5/11/2007	23.07	60.99	<50	<0.5	<0.5	<0.5	<0.5	<0.5	<5.0	--	--	0.79
MW-14 94.66	5/26/1998	21.67	72.99	41,000	7,100	11,000	720	3,900	<1000	--	ND	--
	7/1/1999	22.95	71.71	SPH	--	--	--	--	--	--	--	--
	9/21/1999	24.26	70.40	SPH	--	--	--	--	--	--	--	--
	2/9/2000	24.13	70.53	92,000	12,000	17,000	1,300	8,700	<140	--	<0.5	--
	5/31/2000	22.09	72.57	SPH	--	--	--	--	--	--	--	--
	8/8/2000	22.88	71.78	SPH	--	--	--	--	--	--	--	--
	11/14/2000	23.90	70.76	SPH	--	--	--	--	--	--	--	--
	3/1/2001	23.97	70.69	SPH	--	--	--	--	--	--	--	--
	5/7/2001	23.45	71.23	SPH (sheen)	--	--	--	--	--	--	--	--
	8/1/2001	23.57	71.12	SPH (0.06)	--	--	--	--	--	--	--	--
	11/5/2001	23.50	71.18	SPH (0.03)	--	--	--	--	--	--	--	--
	2/13/2002	22.99	71.70	SPH (0.04)	--	--	--	--	--	--	--	--

Pangea

Table 1. Groundwater Elevation and Analytical Data: Volatile Hydrocarbons, HVOCs, and Dissolved Oxygen
Connell Automobile Dealership, 3093 Broadway, Oakland, California

Well ID <i>TOC Elev.</i> <i>(ft)</i>	Sampling Date	Depth to Groundwater <i>(ft)</i>	Groundwater Elevation <i>(ft)</i>	TVH/TPHg <i>(µg/L)</i>	Benzene <i>(µg/L)</i>	Toluene <i>(µg/L)</i>	Ethyl- benzene <i>(µg/L)</i>	Xylenes <i>(µg/L)</i>	MTBE <i>(µg/L)</i>	1,2-DCA <i>(µg/L)</i>	Other HVOCs <i>(µg/L)</i>	DO <i>(mg/L)</i>
>>MW-14 <i>(continued)</i>	5/2/2002	23.51	71.17	SPH (0.02)	--	--	--	--	--	--	--	--
	8/4/2002	23.61	71.06	SPH (0.01)	--	--	--	--	--	--	--	--
	1/20/2003	22.35	72.31	SPH (sheen)	--	--	--	--	--	--	--	--
	5/28/2003	21.95	72.74	SPH (0.04)	--	--	--	--	--	--	--	--
	8/5/2003	23.03	71.66	SPH (0.04)	--	--	--	--	--	--	--	--
	11/10/2003	22.70	72.02	SPH (0.07)	--	--	--	--	--	--	--	--
	2/18/2004	22.37	72.32	SPH (0.04)	--	--	--	--	--	--	--	--
	5/27/2004	21.78	72.92	SPH (0.05)	--	--	--	--	--	--	--	--
	8/19/2004	24.13	70.57	SPH (0.05)	--	--	--	--	--	--	--	--
	12/27/2004	24.19	70.47	SPH (sheen)	--	--	--	--	--	--	--	--
	2/18/2005	23.24	71.46	SPH (0.05)	--	--	--	--	--	--	--	--
	5/11/2005	22.77	71.92	SPH (0.04)	--	--	--	--	--	--	--	--
	8/3/2005	23.17	71.51	SPH (0.02)	--	--	--	--	--	--	--	--
	11/30/2005	24.02	70.66	SPH (0.02)	--	--	--	--	--	--	--	--
	2/17/2006	23.87	70.81	SPH (0.02)	--	--	--	--	--	--	--	--
	5/12/2006	21.74	72.93	SPH (0.01)	--	--	--	--	--	--	--	--
	8/7/2006	21.66	73.01	SPH (0.01)	--	--	--	--	--	--	--	--
	11/21/2006	23.41	71.27	SPH (0.03)	--	--	--	--	--	--	--	--
	2/12/2007	23.45	71.23	SPH (0.03)	--	--	--	--	--	--	--	--
		5/11/2007	22.95	71.71	--	--	--	--	--	--	--	--
MW-15 <i>94.76</i>	5/26/1998	21.87	72.89	130,000	30,000	38,000	2,500	12,600	<1000	--	ND	--
	7/1/1999	22.25	72.51	SPH	--	--	--	--	--	--	--	--
	9/21/1999	24.12	70.64	SPH	--	--	--	--	--	--	--	--
	2/9/2000	24.42	70.34	180,000	32,000	37,000	2,800	14,000	<200	--	<0.5	--
	5/31/2000	22.40	72.36	SPH	--	--	--	--	--	--	--	--
	8/8/2000	23.17	71.59	SPH	--	--	--	--	--	--	--	--
	11/14/2000	24.15	70.61	SPH	--	--	--	--	--	--	--	--
	3/1/2001	23.99	70.77	SPH	--	--	--	--	--	--	--	--
	5/7/2001	23.50	71.26	SPH (sheen)	--	--	--	--	--	--	--	--
	8/1/2001	23.62	71.14	SPH (sheen)	--	--	--	--	--	--	--	--
	11/5/2001	23.65	71.11	SPH (sheen)	--	--	--	--	--	--	--	--
	2/13/2002	23.09	71.67	68,000	9,300	8,500	760	2,600	<200	--	ND	0.59
	5/2/2002	23.59	71.17	SPH (sheen)	--	--	--	--	--	--	--	--
	8/4/2002	23.65	71.11	SPH (sheen)	--	--	--	--	--	--	--	--
	11/26/2002	24.59	70.17	SPH (sheen)	--	--	--	--	--	--	--	--
	1/20/2003	22.08	72.68	48,000	9,900	10,000	1,000	3,600	<1,200	--	ND	0.24
	5/28/2003	21.68	73.08	SPH (sheen)	--	--	--	--	--	--	--	--
	8/5/2003	24.05	70.71	SPH (sheen)	--	--	--	--	--	--	--	--
	11/10/2003	23.68	71.08	SPH (sheen)	--	--	--	--	--	--	--	--
	2/18/2004	23.51	71.25	25,000	5,200	3,600	390	1,100	<1,000	--	--	0.63
5/27/2004	22.98	71.78	SPH (sheen)	--	--	--	--	--	--	--	--	
8/19/2004	25.31	69.45	SPH (sheen)	--	--	--	--	--	--	--	0.42	
12/27/2004	24.46	70.30	SPH (sheen)	--	--	--	--	--	--	--	--	

Pangea

Table 1. Groundwater Elevation and Analytical Data: Volatile Hydrocarbons, HVOCs, and Dissolved Oxygen
Connell Automobile Dealership, 3093 Broadway, Oakland, California

Well ID TOC Elev. (ft)	Sampling Date	Depth to Groundwater (ft)	Groundwater Elevation (ft)	TVH/TPHg (µg/L)	Benzene (µg/L)	Toluene (µg/L)	Ethyl- benzene (µg/L)	Xylenes (µg/L)	MTBE (µg/L)	1,2-DCA (µg/L)	Other HVOCs (µg/L)	DO (mg/L)
>>MW-15	2/18/2005	23.27	71.57	SPH (0.10)	--	--	--	--	--	--	--	--
(continued)	5/11/2005	22.80	72.03	SPH (0.09)	--	--	--	--	--	--	--	--
	8/3/2005	23.29	71.48	SPH (0.01)	--	--	--	--	--	--	--	--
	11/30/2005	24.11	70.69	SPH (0.05)	--	--	--	--	--	--	--	--
	2/17/2006	23.91	70.89	SPH (0.03)	--	--	--	--	--	--	--	--
	5/12/2006	21.88	72.90	SPH (0.03)	--	--	--	--	--	--	--	--
	8/7/2006	22.05	72.73	SPH (0.01)	--	--	--	--	--	--	--	--
	11/21/2006	23.70	71.06	--	--	--	--	--	--	--	--	0.15
	2/12/2007	23.80	70.96	58,000	8,900	8,000	800	2,500	<1,000	99	<5'	0.22
	5/11/2007	23.28	71.48	--	--	--	--	--	--	--	--	0.49
MW-16A	5/17/2007	25.12	--	1,700	3.1	4.1	21	25	<30	--	--	0.94
MW-16B	5/17/2007	28.98	--	110,000	11,000	3,300	1,300	7,700	<500	--	--	0.65

Grab Sampling Data

Sample ID

CPT-1****	10/6/1992	--	--	490	20	60	10	60	--	1	--	--
CPT-3	10/6/1992	--	--	50	<0.4	<0.4	3	3	--	<4	--	--
CPT-4	10/6/1992	--	--	1,100	60	50	80	15	--	110	--	--
CPT-5	10/6/1992	--	--	600,000	2,300	53,000	8,000	43,000	--	730	--	--
CPT-7	10/6/1992	--	--	1,700,000	40,000	120,000	25,000	120,000	--	2,900	--	--
CPT-9	10/7/1992	--	--	2,100,000	49,000	140,000	28,000	145,000	--	620	--	--
CPT-10	10/7/1992	--	--	190,000	13,000	16,000	3,900	18,000	--	1,400	--	--
CPT-11	10/7/1992	--	--	2,000	200	50	30	70	--	11	--	--
CPT-12	10/7/1992	--	--	130,000	4,100	10,000	2,600	10,000	--	9	--	--
CPT-13(MW-10)	10/7/1992	--	--	28,000	2,700	3,800	210	1,300	--	150	--	--
CPT-17 (B-12)	10/6/1992	--	--	<50	<0.5	<0.5	<0.5	<0.5	--	<1	ND	--
B (boring)	5/16/1998	--	--	140	37	0.64	6.6	1.7	<2	17	--	--
C (boring)	5/16/1998	--	--	<50	0.72	<0.5	<0.5	<0.5	<2	210	--	--
G (boring)	5/16/1998	--	--	590,000	15,000	25,000	2,100	10,800	<500	880	--	--

Pangea

Table 1. Groundwater Elevation and Analytical Data: Volatile Hydrocarbons, HVOCs, and Dissolved Oxygen

Connell Automobile Dealership, 3093 Broadway, Oakland, California

Well ID	Sampling	Depth to	Groundwater				Ethyl-					
<i>TOC Elev.</i>	Date	Groundwater	Elevation	TVH/TPHg	Benzene	Toluene	benzene	Xylenes	MTBE	1,2-DCA	Other HVOCs	DO
(ft)		(ft)	(ft)	(µg/L)	(µg/L)	(µg/L)	(µg/L)	(µg/L)	(µg/L)	(µg/L)	(µg/L)	(mg/L)

Abbreviations and Notes:

TOC Elev. (ft) = Top of casing elevation, surveyed to an arbitrary datum (measured in feet)

µg/L = micrograms per liter = parts per billion = ppb

-- = Not measured or not analyzed

ND = Not detected above laboratory reporting limit; see laboratory reports for individual reporting limits.

SPH = Separate-phase hydrocarbons encountered in well (value in parentheses is thickness in feet)

TVH = Total Volatile Hydrocarbons

TPHg = Total petroleum hydrocarbons as gasoline by modified EPA Method 8015C

Benzene, toluene, ethylbenzene, and xylenes by EPA Method 8021B; value in parentheses by EPA Method 8260

MTBE = Methyl tertiary butyl ether by EPA Method 8021B; values in parentheses by EPA Method 8260

HVOCs = Halogenated volatile organic compounds by EPA Method 8010

1,2-DCA = 1,2 Dichloroethane by EPA Method 8010

DCB = 1, 3 Dichlorobenzene

DBCM = Dibromochloromethane

MCB = Chlorobenzene

NE = Naphthalene (results for MW-1 from 1995 through 1998 from SCI reporting of SVOC results)

TCM = Chloroform = trichloromethane

DO = Dissolved oxygen, measured in the field.

<n = Chemical not present at a concentration in excess of detection limit shown.

* = Suspect laboratory contamination contributing to test result.

** = Fuel fingerprint analysis indicates MTBE is not present in the free product sample collected from this well.

*** = Duplicate sample sent to a different chemical laboratory.

**** = CPT-2, 6, 8, 14, 15 and 16 were not sampled.

1 = Sample exhibits fuel pattern which does not resemble standard

2 = Lighter hydrocarbons than indicated standard

3 = Presence of this compound confirmed by second column, however, the confirmation concentration differed from the reported result by more than a factor of two.

4 = Detection may potentially be a false positive, to be checked during the next event.

5 = One or more of the following substances found: Acetone, 1,2-Dibromoethane, 1,3,5-Trimethylbenzene, 2-Chlorotoluene, 1,2,4-Trimethylbenzene, n-Butylbenzene, and Naphthalene.

See laboratory results for details.

6 = Confirmed by GC/MS.

7 = Detection levels for 2-chloroethyl vinyl ether are twice the indicated detection level which is applicable to all other target HVOCs.

Pangea

Table 2. Groundwater Elevation and Analytical Data: Extractable Hydrocarbons and SVOCs
Connell Automobile Dealership, 3093 Broadway, Oakland, California

Well ID <i>TOC Elev.</i> <i>(ft)</i>	Sampling Date	Depth to water <i>(ft)</i>	Groundwater Elevation <i>(ft)</i>	TEH <i>(µg/L)</i>	TPHd <i>(µg/L)</i>	TPHmo <i>(µg/L)</i>	2-Methyl naphthalene <i>(µg/L)</i>	Naphthalene <i>(µg/L)</i>	Other SVOCs <i>(µg/L)</i>
MW-1	10/5/1990	26.40	68.08	<500	--	--	--	--	--
94.48	3/1/1991	27.46	67.02	SPH	--	--	--	--	--
	10/12/1992	26.44	68.04	--	--	--	--	--	--
	11/24/1992	26.63	67.85	4,600	--	--	--	--	--
	4/5/1993	23.77	70.71	25,000	--	--	--	--	--
	7/21/1993	24.51	69.97	SPH	--	--	--	--	--
	11/9/1993	26.06	68.42	SPH	--	--	--	--	--
	8/30/1995	21.73	72.75	SPH	--	--	630	1,200	1
	12/4/1995	21.94	72.54	SPH	--	--	--	--	--
	5/2/1996	20.65	73.83	32,000	--	--	250	640	ND
	11/5/1996	24.29	70.19	--	--	--	--	--	--
	5/9/1997	22.79	71.69	28,000	--	--	280	650	2
	11/5/1997	25.06	69.42	28,000	--	--	720	1,500	ND
	2/9/1998	22.64	71.84	27,000	--	--	160	570	3
	5/1/1998	19.95	74.53	29,000	--	--	--	--	--
	5/27/1998	--	--	--	--	--	120	630	4
	11/3/1998	23.29	71.19	37,000	--	--	500	1,100	ND?
	3/24/1999	22.30	72.18	SPH	--	--	--	--	--
	7/1/1999	22.70	71.78	SPH	--	--	--	--	--
	9/21/1999	23.81	70.67	SPH	--	--	--	--	--
	2/9/2000	23.95	70.59	--	SPH	--	--	--	--
	5/31/2000	22.05	72.43	--	SPH	--	--	--	--
	11/14/2000	24.65	69.83	--	SPH	--	--	--	--
	3/1/2001	24.22	70.28	--	SPH	--	--	--	--
	5/7/2001	23.85	70.67	--	SPH	--	--	--	--
	8/1/2001	23.91	70.64	--	SPH	--	--	--	--
	11/5/2001	23.95	70.67	--	SPH	--	--	--	--
	2/13/2002	23.15	71.39	--	SPH (0.07)	--	--	--	--
	5/2/2002	23.91	70.60	--	SPH (0.04)	--	--	--	--
	8/4/2002	24.02	70.48	--	SPH (0.03)	--	--	--	--
	11/26/2002	24.47	70.05	--	SPH (0.05)	--	--	--	--
	1/20/2003	22.37	72.14	--	SPH (0.04)	--	--	--	--
	5/28/2003	21.77	72.73	--	SPH (0.02)	--	--	--	--
	8/5/2003	23.07	71.44	--	SPH (0.04)	--	--	--	--
	11/10/2003	22.53	71.97	--	SPH (0.03)	--	--	--	--

Pangea

Table 2. Groundwater Elevation and Analytical Data: Extractable Hydrocarbons and SVOCs
Connell Automobile Dealership, 3093 Broadway, Oakland, California

Well ID TOC Elev. (ft)	Sampling Date	Depth to water (ft)	Groundwater Elevation (ft)	TEH (µg/L)	TPHd (µg/L)	TPHmo (µg/L)	2-Methyl naphthalene (µg/L)	Naphthalene (µg/L)	Other SVOCs (µg/L)
MW-1 <i>(cont'd)</i>	2/18/2004	22.61	71.91	--	SPH (0.05)	--	--	--	--
	5/27/2004	22.08	72.44	--	SPH (0.05)	--	--	--	--
	8/19/2004	24.35	70.43	--	SPH (0.38)	--	--	--	--
	12/27/2004	24.62	70.21	--	SPH (0.44)	--	--	--	--
	2/18/2005	23.14	71.37	--	SPH (0.04)	--	--	--	--
	5/11/2005	22.71	71.79	--	SPH (0.02)	--	--	--	--
	8/3/2005	23.03	71.50	--	SPH (0.06)	--	--	--	--
	11/30/2005	23.98	70.52	--	SPH (0.03)	--	--	--	--
	2/17/2006	23.81	70.68	--	SPH (0.01)	--	--	--	--
	5/12/2006	21.75	72.75	--	SPH (0.02)	--	--	--	--
	8/7/2006	21.35	73.14	--	SPH (0.01)	--	--	--	--
	11/21/2006	23.38	71.13	--	SPH (0.04)	--	--	--	--
	2/12/2007	23.18	71.33	--	SPH (0.03)	--	--	--	--
	5/11/2007	22.68	71.80	--	--	--	--	--	--
MW-2 94.81	3/1/1991	27.86	66.95	<50	--	--	--	--	--
	11/24/1992	27.91	66.90	<50	--	--	--	--	--
	4/5/1993	25.95	68.86	870	--	--	--	--	--
	7/21/1993	25.59	69.22	<50	--	--	--	--	--
	11/10/1993	26.72	68.09	240	--	--	--	--	--
	8/30/1995	25.75	69.06	150	--	--	--	--	--
	5/3/1996	23.28	71.53	<50	--	--	--	--	--
	5/8/1997	24.58	70.23	<50	--	--	--	--	--
	4/29/1998	22.18	72.63	<47	--	--	--	--	--
MW-3 90.08	3/1/1991	23.17	66.91	<50	--	--	--	--	--
	11/25/1992	23.01	67.07	160	--	--	--	--	--
	4/5/1993	22.11	67.97	<50	--	--	--	--	--
	7/21/1993	23.93	66.15	<50	--	--	--	--	--
	11/10/1993	23.14	66.94	<50	--	--	--	--	--
	8/30/1995	20.61	69.47	<50	--	--	--	--	--
	5/3/1996	18.43	71.65	<50	--	--	--	--	--
	5/8/1997	19.77	70.31	<50	--	--	--	--	--
	4/29/1998	17.92	72.16	<47	--	--	--	--	--

Pangea

Table 2. Groundwater Elevation and Analytical Data: Extractable Hydrocarbons and SVOCs
Connell Automobile Dealership, 3093 Broadway, Oakland, California

Well ID <i>TOC Elev.</i> <i>(ft)</i>	Sampling Date	Depth to water <i>(ft)</i>	Groundwater Elevation <i>(ft)</i>	TEH <i>(µg/L)</i>	TPHd <i>(µg/L)</i>	TPHmo <i>(µg/L)</i>	2-Methyl naphthalene <i>(µg/L)</i>	Naphthalene <i>(µg/L)</i>	Other SVOCs <i>(µg/L)</i>
MW-4	3/1/1991	23.79	65.05	<500	--	--	--	--	--
88.84	10/12/1992	22.48	66.36	--	--	--	--	--	--
	11/24/1992	22.60	66.24	1,600	--	--	--	--	--
	4/2/1993	20.11	68.73	SPH	--	--	--	--	--
	7/21/1993	20.48	68.36	SPH	--	--	--	--	--
	11/9/1993	21.71	67.13	SPH	--	--	--	--	--
	8/30/1995	19.90	68.94	SPH	--	--	--	--	--
	12/1/1995	19.40	69.44	SPH	--	--	--	--	--
	5/2/1996	17.50	71.34	9,200	--	--	--	--	--
	11/4/1996	20.13	68.71	4,700	--	--	--	--	--
	5/8/1997	18.63	70.21	5,100	--	--	--	--	--
	11/5/1997	20.19	68.65	3,700	--	--	--	--	--
	2/9/1998	18.28	70.56	4,800	--	--	--	--	--
	5/1/1998	16.11	72.73	5,000	--	--	--	--	--
	8/4/1998	17.54	71.30	3,500	--	--	--	--	--
	11/2/1998	19.21	69.63	7,200	--	--	--	--	--
	3/26/1999	17.51	71.33	14,000	--	--	--	--	--
	7/1/1999	18.80	70.04	17,000	--	--	370	860	ND
	9/21/1999	19.85	68.99	14,000	--	--	360	820	ND
	2/9/2000	19.76	69.08	--	12,000	1,000	290	700	ND
	5/31/2000	17.90	70.94	--	14,000 **	<500	--	--	--
	11/14/2000	19.63	69.21	--	8,000	290	--	--	--
	3/1/2001	19.68	69.16	--	57,000	2,800	210	510	ND
	5/7/2001	18.60	70.24	--	56,000	3,600	--	--	--
	8/1/2001	18.73	70.11	--	42,000	6,700	--	--	--
	11/5/2001	18.97	69.87	--	49,000	14,000	--	--	--
	2/13/2002	18.59	70.25	--	140,000	11,000	620	1000	--
	5/2/2002	18.77	70.07	--	68,000	<25,000	--	--	--
	8/4/2002	18.95	69.89	--	58,000	<25,000	--	--	--
	11/26/2002	20.83	68.01	--	7,100	<250	--	--	--
	1/20/2003	16.90	71.94	--	29,000	<2500	--	--	--
	5/28/2003	15.25	73.59	--	12,000	300	--	--	--
	8/5/2003	17.05	71.79	--	6,600	<250	--	--	--
	11/10/2003	16.60	72.24	--	15,000	--	--	--	--
	2/18/2004	16.59	72.25	--	16,000	--	--	--	--

Pangea

Table 2. Groundwater Elevation and Analytical Data: Extractable Hydrocarbons and SVOCs
Connell Automobile Dealership, 3093 Broadway, Oakland, California

Well ID <i>TOC Elev.</i> (ft)	Sampling Date	Depth to water (ft)	Groundwater Elevation (ft)	TEH (µg/L)	TPHd (µg/L)	TPHmo (µg/L)	2-Methyl naphthalene (µg/L)	Naphthalene (µg/L)	Other SVOCs (µg/L)
MW-4	5/27/2004	15.97	72.87	--	23,000	<2,500	--	--	--
<i>(cont'd)</i>	8/19/2004	18.11	70.73	--	19,000	--	--	--	--
	12/27/2004	19.53	69.31	--	8,700	<2,500	--	--	--
	2/18/2005	18.40	70.44	--	13,000	<250	--	--	--
	5/11/2005	17.93	70.91	--	16,000	<1,200	--	--	--
	8/3/2005	18.14	70.70	--	20,000	<5,000	--	--	--
	11/30/2005	19.70	69.14	--	19,000	<2,500	--	--	--
	2/17/2006	17.63	71.21	--	10,000	340	--	--	--
	5/12/2006	15.53	73.31	--	7,500	<1200	--	--	--
	8/7/2006	17.75	71.09	--	17,000	440	--	--	--
	11/21/2006	19.14	69.70	--	21,000	540	--	--	--
	2/12/2007	18.98	69.86	--	16,000	460	--	--	--
	5/11/2007	18.27	70.57	--	23,000	--	--	--	--
MW-5	3/15/1991	26.31	58.53	<50	--	--	--	--	--
84.84	11/10/1992	26.83	58.01	50	--	--	--	--	--
	4/2/1993	26.62	58.22	<50	--	--	--	--	--
	7/21/1993	26.60	58.24	190	--	--	--	--	--
	11/9/1993	27.24	57.60	170	--	--	--	--	--
	8/30/1995	27.46	57.38	180	--	--	--	--	--
	5/3/1996	26.02	58.82	<50	--	--	--	--	--
	5/8/1997	26.76	58.08	<50	--	--	--	--	--
	4/29/1998	26.55	58.29	<47	--	--	--	--	--
MW-6	3/15/1991	25.82	59.80	<50	--	--	--	--	--
85.62	10/12/1992	25.02	60.60	--	--	--	--	--	--
	12/1/1992	28.87	56.75	SPH	--	--	--	--	--
	4/2/1993	26.96	58.66	SPH	--	--	--	--	--
	7/21/1993	26.17	59.45	SPH	--	--	--	--	--
	11/9/1993	27.51	58.11	SPH	--	--	--	--	--
	8/30/1995	28.00	57.62	SPH	--	--	--	--	--
	12/1/1995	27.58	58.04	SPH	--	--	--	--	--
	5/3/1996	26.83	58.79	9,000	--	--	--	--	--
86.94	5/9/1997	26.54	60.40	53,000	--	--	--	--	--
	11/5/1997	26.16	60.78	65,000	--	--	--	--	--
85.82	5/1/1998	22.96	62.86	25,000	--	--	--	--	--
	11/3/1998	24.35	61.47	30,000	--	--	--	--	--
	3/26/1999	23.82	62.00	SPH	--	--	--	--	--

Pangea

Table 2. Groundwater Elevation and Analytical Data: Extractable Hydrocarbons and SVOCs
Connell Automobile Dealership, 3093 Broadway, Oakland, California

Well ID <i>TOC Elev.</i> <i>(ft)</i>	Sampling Date	Depth to water <i>(ft)</i>	Groundwater Elevation <i>(ft)</i>	TEH <i>(µg/L)</i>	TPHd <i>(µg/L)</i>	TPHmo <i>(µg/L)</i>	2-Methyl naphthalene <i>(µg/L)</i>	Naphthalene <i>(µg/L)</i>	Other SVOCs <i>(µg/L)</i>
MW-6 <i>(cont'd)</i>	7/1/1999	24.45	61.37	SPH	--	--	--	--	--
	9/21/1999	24.58	61.24	SPH	--	--	--	--	--
	2/9/2000	24.93	61.24	--	SPH	--	--	--	--
	5/31/2000	23.47	62.41	--	SPH	--	--	--	--
	11/14/2000	24.61	61.21	--	SPH	--	--	--	--
	3/1/2001	23.97	61.85	--	SPH	--	--	--	--
	5/7/2001	23.17	62.71	--	SPH	--	--	--	--
	8/1/2001	obstruction in well		--	--	--	--	--	--
	11/5/2001	obstruction in well		--	--	--	--	--	--
	2/13/2002	obstruction in well		--	--	--	--	--	--
	5/2/2002	23.25	62.41	--	SPH (0.05)	--	--	--	--
	8/4/2002	23.55	62.29	--	SPH (0.03)	--	--	--	--
	11/26/2002	24.22	61.62	--	SPH (0.03)	--	--	--	--
	1/20/2003	22.49	63.36	--	SPH (0.04)	--	--	--	--
	5/28/2003	21.92	63.93	--	SPH (0.04)	--	--	--	--
	8/5/2003	23.98	61.87	--	SPH (0.04)	--	--	--	--
	11/10/2003	23.50	62.40	--	SPH (0.10)	--	--	--	--
	2/18/2004	22.21	63.64	--	SPH (0.04)	--	--	--	--
	5/27/2004	22.01	63.85	--	SPH (0.05)	--	--	--	--
	8/19/2004	24.16	61.68	--	SPH (0.03)	--	--	--	--
	12/27/2004	24.69	61.13	--	SPH (sheen)	--	--	--	--
	2/18/2005	23.55	62.33	--	SPH (0.08)	--	--	--	--
	5/11/2005	22.90	62.97	--	SPH (0.06)	--	--	--	--
	8/3/2005	23.68	62.19	--	SPH (0.06)	--	--	--	--
	11/30/2005	24.17	61.67	--	SPH (0.02)	--	--	--	--
	2/17/2006	23.89	61.95	--	SPH (0.03)	--	--	--	--
5/12/2006	22.66	63.18	--	SPH (0.03)	--	--	--	--	
8/7/2006	22.83	63.01	--	SPH (0.02)	--	--	--	--	
11/21/2006	23.92	61.92	--	SPH (0.02)	--	--	--	--	
2/12/2007	23.97	61.87	--	SPH (0.02)	--	--	--	--	
	5/11/2007	23.54	62.30	--	--	--	--	--	--
MW-7	3/15/1991	21.63	63.78	<50	--	--	--	--	--
85.41	11/24/1992	21.52	63.89	<50	--	--	--	--	--
	4/2/1993	20.08	65.33	<50	--	--	--	--	--
	7/21/1993	19.59	65.82	150	--	--	--	--	--
	11/9/1993	20.65	64.76	200	--	--	--	--	--
	8/30/1995	18.78	66.63	170	--	--	--	--	--

Pangea

Table 2. Groundwater Elevation and Analytical Data: Extractable Hydrocarbons and SVOCs
Connell Automobile Dealership, 3093 Broadway, Oakland, California

Well ID TOC Elev. (ft)	Sampling Date	Depth to water (ft)	Groundwater Elevation (ft)	TEH (µg/L)	TPHd (µg/L)	TPHmo (µg/L)	2-Methyl naphthalene (µg/L)	Naphthalene (µg/L)	Other SVOCs (µg/L)	
MW-7 (cont'd)	12/1/1995	19.47	65.94	<50	--	--	--	--	--	
	5/2/1996	17.15	68.26	<50	--	--	--	--	--	
	8/8/1996	18.48	66.93	<50	--	--	--	--	--	
	11/4/1996	18.69	66.72	<50	--	--	--	--	--	
	2/6/1997	17.44	67.97	<50	--	--	--	--	--	
	5/8/1997	17.72	67.69	<50	--	--	--	--	--	
	8/7/1997	18.49	66.92	<50	--	--	--	--	--	
	11/5/1997	18.86	66.55	<50	--	--	--	--	--	
	2/9/1998	17.56	67.85	<50	--	--	--	--	--	
	4/29/1998	16.23	69.18	<47	--	--	--	--	--	
	8/4/1998	17.24	68.17	<50	--	--	--	--	--	
	11/2/1998	17.91	67.50	<50	--	--	--	--	--	
	3/26/1999	16.42	68.99	<50	--	--	--	--	--	
	7/1/1999	17.90	67.51	<50	--	--	<10	<10	ND	
	9/21/1999	18.91	66.50	<48	--	--	<9.5	<9.5	ND	
	2/9/2000	16.74	68.67	68.67	--	<50	<250	<10	<10	ND
	5/31/2000	16.21	69.20	69.20	--	<50	<500	--	--	--
	11/14/2000	17.00	68.41	68.41	--	<50	<250	--	--	--
	3/1/2001	17.09	68.32	68.32	--	<50	<250	<10	<10	ND
	5/7/2001	17.19	68.22	68.22	--	<50	<250	--	--	--
	8/1/2001	17.25	68.16	68.16	--	<50	<250	--	--	--
	11/5/2001	17.35	68.06	68.06	--	<50	<250	--	--	--
	2/13/2002	17.50	67.91	67.91	--	<50	<250	--	--	--
	5/2/2002	17.30	68.11	68.11	--	<50	<250	--	--	--
	8/4/2002	17.58	67.83	67.83	--	<50	<250	--	--	--
	11/26/2002	18.35	67.06	67.06	--	<50	<250	--	--	--
	1/20/2003	15.84	69.57	69.57	--	83	<250	--	--	--
	5/28/2003	15.19	70.22	70.22	--	<50	<250	--	--	--
8/5/2003	17.00	68.41	68.41	--	<50	<250	--	--	--	
11/10/2003	16.54	68.87	68.87	--	<50	--	--	--	--	
2/18/2004	16.47	68.94	68.94	--	<50	--	--	--	--	
5/27/2004	15.93	69.48	69.48	--	<50	<250	--	--	--	
8/19/2004	18.05	67.36	67.36	--	<50	--	--	--	--	
12/27/2004	17.35	68.06	68.06	--	<50	<250	--	--	--	
2/18/2005	16.23	69.18	69.18	--	<50	<250	--	--	--	

Pangea

Table 2. Groundwater Elevation and Analytical Data: Extractable Hydrocarbons and SVOCs
Connell Automobile Dealership, 3093 Broadway, Oakland, California

Well ID <i>TOC Elev.</i> <i>(ft)</i>	Sampling Date	Depth to water <i>(ft)</i>	Groundwater Elevation <i>(ft)</i>	TEH <i>(µg/L)</i>	TPHd <i>(µg/L)</i>	TPHmo <i>(µg/L)</i>	2-Methyl naphthalene <i>(µg/L)</i>	Naphthalene <i>(µg/L)</i>	Other SVOCs <i>(µg/L)</i>
MW-7	5/11/2005	15.79	69.62	--	<50	<250	--	--	--
<i>(cont'd)</i>	8/3/2005	17.52	67.89	--	<50	<250	--	--	--
	11/30/2005	19.57	65.84	--	<50	<250	--	--	--
	2/17/2006	16.82	68.59	--	<50	<250	--	--	--
	5/12/2006	15.86	69.55	--	<50	<250	--	--	--
	8/7/2006	17.52	67.89	--	<50	<250	--	--	--
	11/21/2006	18.67	66.74	--	<50	<250	--	--	--
	2/12/2007	18.20	67.21	--	<50	<250	--	--	--
	5/11/2007	17.73	67.68	--	<50	--	--	--	--
MW-8	10/12/1992	27.70	57.80	--	--	--	--	--	--
85.50	11/25/1992	27.62	57.88	170	--	--	--	--	--
	4/8/1993	26.64	58.86	100	--	--	--	--	--
	7/21/1993	26.60	58.90	90	--	--	--	--	--
	11/11/1993	27.18	58.32	170	--	--	--	--	--
	8/30/1995	26.35	59.15	240	--	--	--	--	--
	12/4/1995	26.72	58.78	<50	--	--	--	--	--
	5/3/1996	25.47	60.03	94	--	--	--	--	--
	8/8/1996	26.41	59.09	250	--	--	--	--	--
	11/5/1996	26.77	58.73	<50	--	--	--	--	--
	2/6/1997	25.84	59.66	130	--	--	--	--	--
	5/9/1997	26.39	59.11	120	--	--	--	--	--
	8/7/1997	26.72	58.78	150	--	--	--	--	--
	11/5/1997	26.82	58.68	110	--	--	--	--	--
	2/9/1998	25.57	59.93	75	--	--	--	--	--
	5/1/1998	25.64	59.86	210	--	--	--	--	--
	8/5/1998	25.96	59.54	260	--	--	--	--	--
	11/3/1998	26.27	59.23	190	--	--	--	--	--
	3/31/1999	20.93	64.57	200	--	--	--	--	--
	7/1/1999	26.59	58.91	170	--	--	<9.6	<9.6	ND
	9/21/1999	26.89	58.61	420	--	--	<9.4	<9.4	ND
	2/9/2000	26.60	58.90	--	120	280	<10	<10	ND
	5/31/2000	26.16	59.34	--	160 **	<500	--	--	--
	11/14/2000	26.60	58.90	--	150	< 250	--	--	--
	3/1/2001	26.41	59.09	--	54	<250	<10	<10	Phenol: 25
	5/7/2001	26.55	58.95	--	<50	<250	--	--	--
	8/1/2001	26.71	58.79	--	58	<250	--	--	--
	11/5/2001	26.67	58.83	--	84	<250	--	--	--

Pangea

Table 2. Groundwater Elevation and Analytical Data: Extractable Hydrocarbons and SVOCs
Connell Automobile Dealership, 3093 Broadway, Oakland, California

Well ID <i>TOC Elev.</i> <i>(ft)</i>	Sampling Date	Depth to water <i>(ft)</i>	Groundwater Elevation <i>(ft)</i>	TEH <i>(µg/L)</i>	TPHd <i>(µg/L)</i>	TPHmo <i>(µg/L)</i>	2-Methyl naphthalene <i>(µg/L)</i>	Naphthalene <i>(µg/L)</i>	Other SVOCs <i>(µg/L)</i>
MW-8 <i>(cont'd)</i>	2/13/2002	26.15	59.35	--	83	<250	--	--	--
	5/2/2002	26.63	58.87	--	<50	<250	--	--	--
	8/4/2002	26.80	58.70	--	260	<250	--	--	--
	11/26/2002	27.50	58.00	--	<50	<250	--	--	--
	1/20/2003	24.93	60.57	--	63	<250	--	--	--
	5/28/2003	24.28	61.22	--	<50	<250	--	--	--
	8/5/2003	26.51	58.99	--	2,700	380	--	--	--
	11/10/2003	26.04	59.46	--	<50	--	--	--	--
	2/18/2004	25.97	59.53	--	<50	--	--	--	--
	5/27/2004	25.31	60.19	--	<50	<250	--	--	--
	8/19/2004	27.55	57.95	--	<50	--	--	--	--
	12/27/2004	26.50	59.00	--	<50	<250	--	--	--
	2/18/2005	26.00	59.50	--	<50	<250	--	--	--
	5/11/2005	25.47	60.03	--	<50	<250	--	--	--
	8/3/2005	26.31	59.19	--	53	<250	--	--	--
	11/30/2005	26.51	58.99	--	<50	<250	--	--	--
	2/17/2006	26.11	59.39	--	<50	<250	--	--	--
	5/12/2006	25.38	60.12	--	<50	<250	--	--	--
	8/7/2006	26.10	59.40	--	<50	<250	--	--	--
	11/21/2006	26.43	59.07	--	<50	<250	--	--	--
2/12/2007	26.29	59.21	--	120	<250	--	--	--	
	5/11/2007	26.23	59.27	--	<50	--	--	--	--
MW-9 <i>90.37</i>	11/24/1992	23.51	66.86	320	--	--	--	--	--
	4/5/1993	21.14	69.23	920	--	--	--	--	--
	7/21/1993	21.54	68.83	450	--	--	--	--	--
	11/10/1993	27.53	62.84	450	--	--	--	--	--
	8/30/1995	19.59	70.78	680	--	--	--	--	--
	12/4/1995	20.65	69.72	--	--	--	--	--	--
	5/2/1996	18.63	71.74	710	--	--	--	--	--
	11/5/1996	20.69	69.68	420	--	--	--	--	--
	5/9/1997	19.96	70.41	490	--	--	--	--	--

Pangea

Table 2. Groundwater Elevation and Analytical Data: Extractable Hydrocarbons and SVOCs
Connell Automobile Dealership, 3093 Broadway, Oakland, California

Well ID <i>TOC Elev.</i> <i>(ft)</i>	Sampling Date	Depth to water <i>(ft)</i>	Groundwater Elevation <i>(ft)</i>	TEH <i>(µg/L)</i>	TPHd <i>(µg/L)</i>	TPHmo <i>(µg/L)</i>	2-Methyl naphthalene <i>(µg/L)</i>	Naphthalene <i>(µg/L)</i>	Other SVOCs <i>(µg/L)</i>
MW-9	8/8/1997	20.84	69.53	480	--	--	--	--	--
<i>(cont'd)</i>	11/5/1997	21.55	68.82	370	--	--	--	--	--
	2/9/1998	20.21	70.16	410	--	--	--	--	--
	5/1/1998	19.27	71.10	450	--	--	--	--	--
	8/5/1998	19.35	71.02	630	--	--	--	--	--
	11/2/1998	20.43	69.94	500	--	--	--	--	--
	3/25/1999	18.46	71.91	630	--	--	--	--	--
	7/1/1999	19.95	70.42	570	--	--	<9.5	<9.5	ND
	9/21/1999	21.15	69.22	770	--	--	<9.4	<9.4	ND
	2/9/2000	21.08	69.29	--	320	<250	<10	<10	ND
	5/31/2000	19.11	71.26	--	390 **	<500	--	--	--
	11/14/2000	20.90	69.47	--	160	< 250	--	--	--
	3/1/2001	20.45	69.92	--	220	<250	<10	<10	ND
	5/7/2001	19.83	70.54	--	290	<250	--	--	--
	8/1/2001	20.02	70.35	--	460	<250	--	--	--
	11/5/2001	19.85	70.52	--	230	<250	--	--	--
	2/13/2002	19.80	70.57	--	210	<250	--	--	--
	5/2/2002	19.93	70.44	--	250	<250	--	--	--
	8/4/2002	20.20	70.17	--	300	<250	--	--	--
	11/26/2002	20.37	70.00	--	270	<250	--	--	--
	1/20/2003	17.93	72.44	--	350	<250	--	--	--
	5/28/2003	17.25	73.12	--	91	<250	--	--	--
	8/5/2003	19.03	71.34	--	210	<250	--	--	--
	11/10/2003	18.65	71.72	--	250	--	--	--	--
	2/18/2004	18.41	71.96	--	250	--	--	--	--
	5/27/2004	17.89	72.48	--	160	<250	--	--	--
	8/19/2004	20.14	70.23	--	160	--	--	--	--
	12/27/2004	21.65	68.72	--	91	<250	--	--	--
	2/18/2005	19.97	70.40	--	120	<250	--	--	--
	5/11/2005	19.41	70.96	--	76	<250	--	--	--
	8/3/2005	19.35	71.02	--	110	<250	--	--	--
	11/30/2005	20.96	69.41	--	210	<250	--	--	--
	2/17/2006	19.13	71.24	--	120	<250	--	--	--
	5/12/2006	17.70	72.67	--	88	<250	--	--	--
	8/7/2006	18.82	71.55	--	130	<250	--	--	--
	11/21/2006	20.10	70.27	--	110	<250	--	--	--
	2/12/2007	20.48	69.89	--	74	<250	--	--	--
	5/11/2007	19.55	70.82	--	57	--	--	--	--

Pangea

Table 2. Groundwater Elevation and Analytical Data: Extractable Hydrocarbons and SVOCs
Connell Automobile Dealership, 3093 Broadway, Oakland, California

Well ID <i>TOC Elev.</i> (ft)	Sampling Date	Depth to water (ft)	Groundwater Elevation (ft)	TEH (µg/L)	TPHd (µg/L)	TPHmo (µg/L)	2-Methyl naphthalene (µg/L)	Naphthalene (µg/L)	Other SVOCs (µg/L)
MW-10 <i>88.60</i>	10/12/1992	21.55	67.05	--	--	--	--	--	--
	11/24/1992	21.86	66.74	1,300	--	--	--	--	--
	4/5/1993	19.14	69.46	5,000	--	--	--	--	--
	7/21/1993	19.79	68.81	20,000	--	--	--	--	--
	8/30/1995	17.99	70.61	5,900	--	--	--	--	--
	5/3/1996	17.04	71.56	5,600	--	--	--	--	--
	5/9/1997	18.36	70.24	2,500	--	--	--	--	--
	5/1/1998	15.84	72.76	2,000	--	--	--	--	--
MW-11 <i>102.06</i>	11/24/1992	33.65	68.41	220	--	--	--	--	--
	12/8/92*	33.37	68.69	140	--	--	--	--	--
	12/8/1992	33.37	68.69	120	--	--	--	--	--
	4/5/1993	31.03	71.03	<50	--	--	--	--	--
	7/21/1993	31.90	70.16	150	--	--	--	--	--
	11/9/1993	32.60	69.46	60	--	--	--	--	--
	8/30/1995	28.92	73.14	240	--	--	--	--	--
	5/3/1996	28.00	74.06	<50	--	--	--	--	--
	5/8/1997	29.93	72.13	<50	--	--	--	--	--
4/29/1998	27.22	74.84	<47	--	--	--	--	--	
MW-13 <i>84.06</i>	11/24/1992	26.05	58.01	3,600	--	--	--	--	--
	12/8/92*	25.08	58.98	210	--	--	--	--	--
	12/8/1992	25.08	58.98	100	--	--	--	--	--
	4/5/1993	24.64	59.42	<50	--	--	--	--	--
	7/21/1993	24.29	59.77	<50	--	--	--	--	--
	11/9/1993	24.23	59.83	160	--	--	--	--	--
	8/30/1995	23.30	60.76	<50	--	--	--	--	--
	12/1/1995	23.80	60.26	<50	--	--	--	--	--
	5/3/1996	23.19	60.87	<50	--	--	--	--	--
	8/8/1996	23.44	60.62	<50	--	--	--	--	--
	11/5/1996	24.04	60.02	<50	--	--	--	--	--
	2/6/1997	23.24	60.82	<50	--	--	--	--	--
	5/8/1997	23.46	60.60	<50	--	--	--	--	--
	8/8/1997	23.92	60.14	<50	--	--	--	--	--
11/5/1997	24.27	59.79	<50	--	--	--	--	--	

Pangea

Table 2. Groundwater Elevation and Analytical Data: Extractable Hydrocarbons and SVOCs
Connell Automobile Dealership, 3093 Broadway, Oakland, California

Well ID <i>TOC Elev.</i> <i>(ft)</i>	Sampling Date	Depth to water <i>(ft)</i>	Groundwater Elevation <i>(ft)</i>	TEH <i>(µg/L)</i>	TPHd <i>(µg/L)</i>	TPHmo <i>(µg/L)</i>	2-Methyl naphthalene <i>(µg/L)</i>	Naphthalene <i>(µg/L)</i>	Other SVOCs <i>(µg/L)</i>
MW-13	2/9/1998	22.89	61.17	<50	--	--	--	--	--
<i>(cont'd)</i>	4/29/1998	22.27	61.79	<47	--	--	--	--	--
	8/4/1998	22.75	61.31	78	--	--	--	--	--
	11/3/1998	23.90	60.16	<50	--	--	--	--	--
	3/31/1999	23.11	60.95	<48	--	--	--	--	--
	7/1/1999	23.40	60.66	100	--	--	<9.6	<9.6	ND
	9/21/1999	21.91	62.15	<48	--	--	<9.4	<9.4	ND
	2/9/2000	23.84	60.22	--	<50	<250	<10	<10	ND
	5/31/2000	22.97	61.09	--	<50	<500	--	--	--
	11/14/2000	24.00	60.06	--	65	< 250	--	--	--
	3/1/2001	23.93	60.13	--	<50	<250	<10	<10	ND
	5/7/2001	23.93	60.13	--	<50	<250	--	--	--
	8/1/2001	24.10	59.96	--	<50	<250	--	--	--
	11/5/2001	24.02	60.04	--	350	610	--	--	--
	2/13/2002	23.70	60.36	--	<50	<250	--	--	--
	5/2/2002	23.97	60.09	--	<50	<250	--	--	--
	8/4/2002	24.19	59.87	--	810	310	--	--	--
	11/26/2002	24.78	59.28	--	66	<250	--	--	--
	1/20/2003	22.10	61.96	--	<50	<250	--	--	--
	5/28/2003	17.25	66.81	--	<50	<250	--	--	--
	8/5/2003	23.99	60.07	--	<50	<250	--	--	--
	11/10/2003	23.47	60.59	--	<50	--	--	--	--
	2/18/2004	22.58	61.48	--	<50	--	--	--	--
	5/27/2004	21.95	62.11	--	<50	<250	--	--	--
	8/19/2004	24.29	59.77	--	<50	--	--	--	--
	12/27/2004	23.70	60.36	--	<50	<250	--	--	--
	2/18/2005	23.15	60.91	--	<50	<250	--	--	--
	5/11/2005	22.68	61.38	--	<50	<250	--	--	--
	8/3/2005	23.04	61.02	--	56	<250	--	--	--
	11/30/2005	23.65	60.41	--	<50	<250	--	--	--
	2/17/2006	23.07	60.99	--	<50	<250	--	--	--
	5/12/2006	22.02	62.04	--	<50	<250	--	--	--
	8/7/2006	22.61	61.45	--	<50	<250	--	--	--
	11/21/2006	23.11	60.95	--	<50	<250	--	--	--
	2/12/2007	23.27	60.79	--	<50	<250	--	--	--
	5/11/2007	23.07	60.99	--	<50	--	--	--	--

Pangea

Table 2. Groundwater Elevation and Analytical Data: Extractable Hydrocarbons and SVOCs
Connell Automobile Dealership, 3093 Broadway, Oakland, California

Well ID <i>TOC Elev.</i> <i>(ft)</i>	Sampling Date	Depth to water <i>(ft)</i>	Groundwater Elevation <i>(ft)</i>	TEH <i>(µg/L)</i>	TPHd <i>(µg/L)</i>	TPHmo <i>(µg/L)</i>	2-Methyl naphthalene <i>(µg/L)</i>	Naphthalene <i>(µg/L)</i>	Other SVOCs <i>(µg/L)</i>
MW-14 94.66	5/26/1998	21.67	72.99	7,700	--	--	--	--	--
	7/1/1999	22.95	71.71	SPH	--	--	--	--	--
	9/21/1999	24.26	70.40	SPH	--	--	--	--	--
	2/9/2000	24.13	70.53	--	14,000	1,500	290	600	ND
	5/31/2000	22.09	72.57	--	SPH	--	--	--	--
	11/14/2000	23.90	70.76	--	SPH	--	--	--	--
	3/1/2001	23.97	70.69	--	SPH	--	--	--	--
	5/7/2001	23.45	71.23	--	SPH	--	--	--	--
	8/1/2001	23.57	71.12	--	SPH	--	--	--	--
	11/5/2001	23.50	71.18	--	SPH	--	--	--	--
	2/13/2002	22.99	71.70	--	SPH (0.04)	--	--	--	--
	5/2/2002	23.51	71.17	--	SPH (0.02)	--	--	--	--
	8/4/2002	23.61	71.06	--	SPH (0.01)	--	--	--	--
	11/26/2002	24.35	70.31	--	SPH (sheen)	--	--	--	--
	1/20/2003	22.35	72.31	--	SPH (sheen)	--	--	--	--
	5/28/2003	21.95	72.74	--	SPH (0.04)	--	--	--	--
	8/5/2003	23.03	71.66	--	SPH (0.04)	--	--	--	--
	11/10/2003	22.70	72.02	--	SPH (0.07)	--	--	--	--
	2/18/2004	22.37	72.32	--	SPH (0.04)	--	--	--	--
	5/27/2004	21.78	72.92	--	SPH (0.05)	--	--	--	--
	8/19/2004	24.13	70.57	--	SPH (0.05)	--	--	--	--
	12/27/2004	24.19	70.47	--	SPH (sheen)	--	--	--	--
	2/18/2005	23.24	71.46	--	SPH (0.05)	--	--	--	--
5/11/2005	22.77	71.92	--	SPH (0.04)	--	--	--	--	
8/3/2005	23.17	71.51	--	SPH (0.02)	--	--	--	--	
11/30/2005	24.02	70.66	--	SPH (0.02)	--	--	--	--	
2/17/2006	23.87	70.81	--	SPH (0.02)	--	--	--	--	
5/12/2006	21.74	72.93	--	SPH (0.01)	--	--	--	--	
8/7/2006	21.66	73.01	--	SPH (0.01)	--	--	--	--	
11/21/2006	23.41	71.27	--	SPH (0.03)	--	--	--	--	
2/12/2007	23.45	71.23	--	SPH (0.03)	--	--	--	--	
5/11/2007	22.95	71.71	--	--	--	--	--	--	
MW-15 94.76	5/26/1998	21.87	72.89	1,700	--	--	--	--	--
	7/1/1999	22.25	72.51	SPH	--	--	--	--	--
	9/21/1999	24.12	70.64	SPH	--	--	--	--	--
	2/9/2000	24.42	70.34	--	4,000	1,200	50	270	ND
	5/31/2000	22.40	72.36	--	SPH	--	--	--	--

Pangea

Table 2. Groundwater Elevation and Analytical Data: Extractable Hydrocarbons and SVOCs
Connell Automobile Dealership, 3093 Broadway, Oakland, California

Well ID <i>TOC Elev.</i> <i>(ft)</i>	Sampling Date	Depth to water <i>(ft)</i>	Groundwater Elevation <i>(ft)</i>	TEH <i>(µg/L)</i>	TPHd <i>(µg/L)</i>	TPHmo <i>(µg/L)</i>	2-Methyl naphthalene <i>(µg/L)</i>	Naphthalene <i>(µg/L)</i>	Other SVOCs <i>(µg/L)</i>
MW-15 <i>(cont'd)</i>	11/14/2000	24.15	70.61	--	SPH	--	--	--	--
	3/1/2001	23.99	70.77	--	SPH	--	--	--	--
	5/7/2001	23.50	71.26	--	SPH	--	--	--	--
	8/1/2001	23.62	71.14	--	SPH	--	--	--	--
	11/5/2001	23.65	71.11	--	SPH (sheen)	--	--	--	--
	2/13/2002	23.09	71.67	--	3,100	<250	17	68	5
	5/2/2002	23.59	71.17	--	SPH (sheen)	--	--	--	--
	8/4/2002	23.65	71.11	--	SPH (sheen)	--	--	--	--
	11/26/2002	24.59	70.17	--	SPH (sheen)	--	--	--	--
	1/20/2003	22.08	72.68	--	3,700	340	--	--	--
	5/28/2003	21.68	73.08	--	SPH (sheen)	--	--	--	--
	8/5/2003	24.05	70.71	--	SPH (sheen)	--	--	--	--
	11/10/2003	23.68	71.08	--	SPH (sheen)	--	--	--	--
	2/18/2004	23.51	71.25	--	1,100	--	--	--	--
	5/27/2004	22.98	71.78	--	SPH (sheen)	--	--	--	--
	8/19/2004	25.31	69.45	--	SPH (sheen)	--	--	--	--
	12/27/2004	24.46	70.30	--	SPH (sheen)	--	--	--	--
	2/18/2005	23.27	71.57	--	SPH (0.10)	--	--	--	--
	5/11/2005	22.80	72.03	--	SPH (0.09)	--	--	--	--
	8/3/2005	23.29	71.48	--	SPH (0.01)	--	--	--	--
11/30/2005	24.11	70.69	--	SPH (0.05)	--	--	--	--	
2/17/2006	23.91	70.89	--	SPH (0.05)	--	--	--	--	
5/12/2006	21.88	72.92	--	SPH (0.03)	--	--	--	--	
8/7/2006	22.05	72.75	--	SPH (0.01)	--	--	--	--	
11/21/2006	23.70	71.10	--	--	--	--	--	--	
2/12/2007	23.80	71.00	--	1,100	<250	--	--	--	
	5/11/2007	23.28	71.48	--	--	--	--	--	--
MW-16A	5/11/2007	25.12	--	--	760	--	--	--	--
MW-16B	5/11/2007	28.98	--	--	15,000	--	--	--	--
Grab Sampling Data									
B (boring)	5/16/1998	--	--	77**	--	--	--	--	--
C (boring)	5/16/1998	--	--	48**	--	--	--	--	--
G (boring)	5/16/1998	--	--	35,000**	--	--	--	--	--

Pangea

Table 2. Groundwater Elevation and Analytical Data: Extractable Hydrocarbons and SVOCs

Connell Automobile Dealership, 3093 Broadway, Oakland, California

Well ID <i>TOC Elev. (ft)</i>	Sampling Date	Depth to water (ft)	Groundwater Elevation (ft)	TEH (µg/L)	TPHd (µg/L)	TPHmo (µg/L)	2-Methyl naphthalene (µg/L)	Naphthalene (µg/L)	Other SVOCs (µg/L)
----------------------------------	------------------	---------------------------	----------------------------------	---------------	----------------	-----------------	-----------------------------------	-----------------------	-----------------------

Abbreviations and Notes:

TOC Elev. (ft) = Top of casing elevation, surveyed to an arbitrary datum

TEH = Total extractable hydrocarbons

TPHd = Total petroleum hydrocarbons as diesel

TPHmo = Total petroleum hydrocarbons as motor oil

SVOCs = Semi-volatile organic compounds

Other SVOC's = All other compounds analyzed by EPA Method 8270

µg/l = micrograms per liter = parts per billion = ppb

ND = None detected above laboratory reporting limit, see laboratory report for individual reporting limits

1 = ND except for 1,700 ug/l 2,4 dichlorophenol, 240 ug/l bis (2-ethyl hexyl) phthalate. Also 10 mg/l oil and grease.

2 = ND except for 570 ug/l benzoic acid and 93 ug/l phenol. Also 20 mg/l oil and grease.

3 = ND except for 700 ug/l benzoic acid, 92 ug/l phenol, and 52 ug/l 3,4 methyl phenol.

4 = ND except for 74 ug/l benzoic acid and 68 ug/l creosol.

5 = ND except for 480 ug/l phenol, 110 ug/l 2,4 dimethylphenol, 210 ug/l 2-methylphenol, 200 ug/l 3,4-methylphenol, and 5.7 mg/l oil and grease.

< n = Not detected above n ug/l

-- = Not analyzed/not available

* = Duplicate sample sent to a different chemical laboratory

** = Does not match TPHd or TEH pattern

Table 3 - Well Construction Details– 3093 Broadway, Oakland, CA

Well ID	Total Depth of Well (feet bgs)	Screened Interval (ft bgs)	Well Casing Nominal Diameter (inches)
MW-1	30	25-30	2
MW-2	40	25-40	2
MW-3	35	20-35	2
MW-4	30	15-30	2
MW-5	35	15-35	2
MW-6	35	15-35	2
MW-7	33	13-33	2
MW-8	40	20-40	6
MW-9	32	18-32	2
MW-10	36	17-36	6
MW-11	40	25-40	2
MW-13	40	25-40	2
MW-14	40	10-40	2
MW-15	40	15-40	2
MW-16A	30	20-30	2
MW-16B	40	35-40	2
MW-17A	30	27-30	2
MW-17B	40	35-40	2
RW-1	35	20-35	4
RW-2	30	15-30	2
RW-3A	26	16-26	4
RW-3B	37	32-37	4
RW-4	31	23-31	4
RW-5	34	24-34	4
AS-1A	30	27-30	2
AS-1B	38	35-38	2
AS-2A	32	29-32	2
AS-3A	29	26-29	2
AS-3B	36	33-36	2
AS-4A	29	26-29	2
VE-1	35	15-35	4

bgs = below ground surface

APPENDIX A

Well Monitoring Protocol

APPENDIX A

Well Monitoring Protocol

Well Monitoring Protocol			
Well	Gauging Frequency	Sampling Frequency	Analytes
Source Area Wells			
MW-1	Quarterly	Annually (1 st Qtr)	TPHd, TPHmo, TPHg, BTEX, MTBE, <i>HVOCs</i> , DO
MW-6			(SVOCs and LUFT Metals no longer required)
MW-14			
MW-15			
Down-Gradient/Cross-Gradient Wells			
MW-4	Quarterly	Quarterly	TPHd, TPHmo, TPHg, BTEX, MTBE, DO
MW-7			(<i>HVOCs</i> 1 st qtr only)
MW-8			
MW-9			(SVOCs and LUFT Metals no longer required)
MW-13			
MW-16A			
MW-16B			
<ol style="list-style-type: none"> 1. Per the May 3, 1999, ACHCSA letter to Messrs. Hill and Linden, monitoring wells MW-2, MW-3, MW-5, MW-10, and MW-11 were dropped from the monitoring program. 2. For cost control purposes, frequency for <i>HVOC</i> sample analysis for the cross/downgradient wells was reduced from quarterly to annually. 3. SVOCs and LUFT Metal analysis no longer required by ACHCSA for this site. 4. Wells will not be sampled if SPH is observed. 			

APPENDIX B

Groundwater Monitoring Field Data Sheets

Well Gauging Data Sheet

Project Task #: 1005.001 211				Project Name: Connell				
Address: 3093 Broadway, Oakland CA						Date: 5/11/07		
Name: Sanjiv Gill				Signature: 				
Well ID	Well Size (in.)	Time	Depth to Immiscible Liquid (ft)	Thickness of Immiscible Liquid (ft)	Depth to Water (ft)	Total Depth (ft)	Measuring Point	
MW-1	2"	10:47			22.68	34.64 ✓✓	TOC	
MW-4	2"	10:23			18.27	24.25		
MW-6	2"	10:55			23.54	32.30 ✓✓		
MW-7	2"	10:15			17.73	30.16		
MW-8	6"	10:18			26.23	39.30		
MW-9	2"	10:21			19.55	30.63		
MW-13	2"	10:11			23.07	39.50		
MW-14	2"	10:42			22.95	26.77 ✓✓		
MW-15	2"	10:38			23.28	37.15		
MW-16A	2"	10:30			25.12	30.03 ✓✓		
MW-16B	2"	10:36			28.98	40.08 ✓✓		X

Comments: DO = mg/l MW-1 = 0.20, MW-6 = 0.70
 MW-14 = 0.41, MW-15 = 0.49

MONITORING FIELD DATA SHEET

Well ID: MW-13

Project Task #: 1005.001 211				Project Name: Connell				
Address: 3093 Broadway, Oakland, CA								
Date: 5/11/07				Weather: <u>Cloudy</u>				
Well Diameter: <u>2"</u>				Volume/ft.	1" = 0.04	3" = 0.37	6" = 1.47	
				2" = 0.16	4" = 0.65	radius ² * 0.163		
Total Depth (TD): <u>39.50</u>				Depth to Product:				
Depth to Water (DTW): <u>23.07</u>				Product Thickness:				
Water Column Height: <u>16.43</u>				1 Casing Volume: <u>2.62</u>		gallons		
Reference Point: TOC				3 Casing Volumes: <u>7.88</u>		gallons		
Purging Device: Disposable Bailer								
Sampling Device: Disposable Bailer								
Time	Temp @	pH	Cond (µs)	NTU	DO(mg/L)	ORP (mV)	Vol(gal)	DTW
<u>11:55</u>	<u>19.8</u>	<u>6.70</u>	<u>798</u>				<u>2.5</u>	
<u>12:00</u>	<u>19.6</u>	<u>6.63</u>	<u>740</u>				<u>5</u>	
<u>12:05</u>	<u>19.7</u>	<u>6.67</u>	<u>770</u>				<u>8</u>	

Comments: Oakton DO meter pre purge DO = 0.79 mg/l
post purge DO = mg/l
very turbid

Sample ID: <u>MW-13</u>	Sample Time: <u>12:10</u>
Laboratory: <u>McCampbell Analytical, INC.</u>	Sample Date: <u>5/11/07</u>
Containers/Preservative: <u>Voal/HCL, Amber Liter/HCl</u>	
Analyzed for: <u>8015, 8021</u>	
Sampler Name: <u>Sanjiv Gill</u>	Signature: 

APPENDIX C

Laboratory Analytical Report



McC Campbell Analytical, Inc.

"When Quality Counts"

1534 Willow Pass Road, Pittsburg, CA 94565-1701
Web: www.mcccampbell.com E-mail: main@mcccampbell.com
Telephone: 877-252-9262 Fax: 925-252-9269

Pangea Environmental Svcs., Inc. 1710 Franklin Street, Ste. 200 Oakland, CA 94612	Client Project ID: #1005.001; Connell 3093 Broadway, Oakland, CA	Date Sampled: 05/11/07
		Date Received: 05/11/07
	Client Contact: Bob Clark-Riddell	Date Reported: 05/18/07
	Client P.O.:	Date Completed: 05/18/07

WorkOrder: 0705331

May 18, 2007

Dear Bob:

Enclosed are:

- 1). the results of **7** analyzed samples from your **#1005.001; Connell 3093 Broadway, Oakland, CA project,**
- 2). a QC report for the above samples
- 3). a copy of the chain of custody, and
- 4). a bill for analytical services.

All analyses were completed satisfactorily and all QC samples were found to be within our control limits.

If you have any questions please contact me. McC Campbell Analytical Laboratories strives for excellence in quality, service and cost. Thank you for your business and I look forward to working with you again.

Best regards,

Angela Rydelius, Lab Manager

McCampbell Analytical, Inc.



1534 Willow Pass Rd
Pittsburg, CA 94565-1701
(925) 252-9262

CHAIN-OF-CUSTODY RECORD

WorkOrder: 0705331

ClientID: PEO

EDF Excel Fax Email HardCopy ThirdParty

Report to:	Bob Clark-Riddell	Email: bcr@pangeaenv.com	Bill to:	Bob Clark-Riddell	Requested TAT: 5 days
	Pangea Environmental Svcs., Inc.	TEL: (510) 836-370 FAX: (510) 836-370		Pangea Environmental Svcs., Inc.	Date Received 05/11/2007
	1710 Franklin Street, Ste. 200	ProjectNo: #1005.001; Connell 3093 Broadway, O		1710 Franklin Street, Ste. 200	Date Printed: 05/11/2007
	Oakland, CA 94612	PO:		Oakland, CA 94612	

Sample ID	ClientSampID	Matrix	Collection Date	Hold	Requested Tests (See legend below)											
					1	2	3	4	5	6	7	8	9	10	11	12
0705331-001	MW-4	Water	5/11/07 2:50:00	<input type="checkbox"/>	A	A	B									
0705331-002	MW-7	Water	5/11/07 12:45:00	<input type="checkbox"/>	A		B									
0705331-003	MW-8	Water	5/11/07 2:10:00	<input type="checkbox"/>	A		B									
0705331-004	MW-9	Water	5/11/07 2:30:00	<input type="checkbox"/>	A		B									
0705331-005	MW-13	Water	5/11/07 12:10:00	<input type="checkbox"/>	A		B									
0705331-006	MW-16A	Water	5/11/07 3:23:00	<input type="checkbox"/>	A		B									
0705331-007	MW-16B	Water	5/11/07 3:45:00	<input type="checkbox"/>	A		B									

Test Legend:

1	G-MBTX_W	2	PREDF REPORT	3	TPH(D)WSG_W	4		5	
6		7		8		9		10	
11		12							

Prepared by: Melissa Valles

Comments:

NOTE: Samples are discarded 60 days after results are reported unless other arrangements are made. Hazardous samples will be returned to client or disposed of at client expense.



Sample Receipt Checklist

Client Name: **Pangea Environmental Svcs., Inc.** Date and Time Received: **5/11/07 6:41:32 PM**
Project Name: **#1005.001; Connell 3093 Broadway, Oakland, CA** Checklist completed and reviewed by: **Melissa Valles**
WorkOrder N°: **0705331** Matrix Water Carrier: Client Drop-In

Chain of Custody (COC) Information

Chain of custody present? Yes No
Chain of custody signed when relinquished and received? Yes No
Chain of custody agrees with sample labels? Yes No
Sample IDs noted by Client on COC? Yes No
Date and Time of collection noted by Client on COC? Yes No
Sampler's name noted on COC? Yes No

Sample Receipt Information

Custody seals intact on shipping container/cooler? Yes No NA
Shipping container/cooler in good condition? Yes No
Samples in proper containers/bottles? Yes No
Sample containers intact? Yes No
Sufficient sample volume for indicated test? Yes No

Sample Preservation and Hold Time (HT) Information

All samples received within holding time? Yes No
Container/Temp Blank temperature Cooler Temp: 4.2°C NA
Water - VOA vials have zero headspace / no bubbles? Yes No No VOA vials submitted
Sample labels checked for correct preservation? Yes No
TTLC Metal - pH acceptable upon receipt (pH<2)? Yes No NA

Client contacted: Date contacted: Contacted by:

Comments:



McC Campbell Analytical, Inc.

"When Quality Counts"

1534 Willow Pass Road, Pittsburg, CA 94565-1701
Web: www.mcccampbell.com E-mail: main@mcccampbell.com
Telephone: 877-252-9262 Fax: 925-252-9269

Pangea Environmental Svcs., Inc. 1710 Franklin Street, Ste. 200 Oakland, CA 94612	Client Project ID: #1005.001; Connell 3093 Broadway, Oakland, CA	Date Sampled: 05/11/07
	Client Contact: Bob Clark-Riddell	Date Received: 05/11/07
	Client P.O.:	Date Extracted: 05/14/07-05/16/07
		Date Analyzed 05/14/07-05/16/07

Gasoline Range (C6-C12) Volatile Hydrocarbons as Gasoline with BTEX and MTBE*

Extraction method SW5030B

Analytical methods SW8021B/8015Cm

Work Order: 0705331

Lab ID	Client ID	Matrix	TPH(g)	MTBE	Benzene	Toluene	Ethylbenzene	Xylenes	DF	% SS
001A	MW-4	W	140,000,a,h	ND<2700	9900	15,000	2000	7200	200	116
002A	MW-7	W	ND	ND	ND	ND	ND	ND	1	112
003A	MW-8	W	300,a	ND	48	0.74	2.9	1.2	1	101
004A	MW-9	W	710,a	ND<10	4.8	1.8	ND	ND	1	112
005A	MW-13	W	ND	ND	ND	ND	ND	ND	1	114
006A	MW-16A	W	1700,a,i	ND<30	3.1	4.1	21	25	2	117
007A	MW-16B	W	110,000,a,h,i	ND<500	11,000	3300	1300	7700	100	99

Reporting Limit for DF =1; ND means not detected at or above the reporting limit	W	50	5.0	0.5	0.5	0.5	0.5	1	µg/L
	S	NA	NA	NA	NA	NA	NA	1	mg/Kg

* water and vapor samples and all TCLP & SPLP extracts are reported in ug/L, soil/sludge/solid samples in mg/kg, wipe samples in µg/wipe, product/oil/non-aqueous liquid samples in mg/L.

cluttered chromatogram; sample peak coelutes with surrogate peak.

+The following descriptions of the TPH chromatogram are cursory in nature and McC Campbell Analytical is not responsible for their interpretation: a) unmodified or weakly modified gasoline is significant; b) heavier gasoline range compounds are significant(aged gasoline?); c) lighter gasoline range compounds (the most mobile fraction) are significant; d) gasoline range compounds having broad chromatographic peaks are significant; biologically altered gasoline?; e) TPH pattern that does not appear to be derived from gasoline (stoddard solvent / mineral spirit?); f) one to a few isolated non-target peaks present; g) strongly aged gasoline or diesel range compounds are significant; h) lighter than water immiscible sheen/product is present; i) liquid sample that contains greater than ~1 vol. % sediment; j) reporting limit raised due to high MTBE content; k) TPH pattern that does not appear to be derived from gasoline (aviation gas). m) no recognizable pattern; n) TPH(g) range non-target isolated peaks subtracted out of the TPH(g) concentration at the client's request; p) see attached narrative.



McC Campbell Analytical, Inc.

"When Quality Counts"

1534 Willow Pass Road, Pittsburg, CA 94565-1701
Web: www.mcccampbell.com E-mail: main@mcccampbell.com
Telephone: 877-252-9262 Fax: 925-252-9269

Pangea Environmental Svcs., Inc. 1710 Franklin Street, Ste. 200 Oakland, CA 94612	Client Project ID: #1005.001; Connell 3093 Broadway, Oakland, CA	Date Sampled: 05/11/07
	Client Contact: Bob Clark-Riddell	Date Received: 05/11/07
	Client P.O.:	Date Analyzed 05/12/07-05/18/07

Diesel Range (C10-C23) Extractable Hydrocarbons with Silica Gel Clean-Up*

Extraction method SW3510C/3630C

Analytical methods SW8015C

Work Order: 0705331

Lab ID	Client ID	Matrix	TPH(d)	DF	% SS
0705331-001B	MW-4	W	23,000,d,b,h	1	119
0705331-002B	MW-7	W	ND	1	116
0705331-003B	MW-8	W	ND	1	116
0705331-004B	MW-9	W	57,d	1	102
0705331-005B	MW-13	W	ND	1	115
0705331-006B	MW-16A	W	760,d,i	1	111
0705331-007B	MW-16B	W	15,000,d,h,i	1	114

Reporting Limit for DF =1; ND means not detected at or above the reporting limit	W	50	µg/L
	S	NA	NA

* water samples are reported in µg/L, wipe samples in µg/wipe, soil/solid/sludge samples in mg/kg, product/oil/non-aqueous liquid samples in mg/L, and all DISTLC / STLC / SPLP / TCLP extracts are reported in µg/L.

cluttered chromatogram resulting in coeluted surrogate and sample peaks, or; surrogate peak is on elevated baseline, or; surrogate has been diminished by dilution of original extract/matrix interference.

+The following descriptions of the TPH chromatogram are cursory in nature and McC Campbell Analytical is not responsible for their interpretation: a) unmodified or weakly modified diesel is significant; b) diesel range compounds are significant; no recognizable pattern; c) aged diesel? is significant; d) gasoline range compounds are significant; e) unknown medium boiling point pattern that does not appear to be derived from diesel; f) one to a few isolated peaks present; g) oil range compounds are significant; h) lighter than water immiscible sheen/product is present; i) liquid sample that contains greater than ~1 vol. % sediment; k) kerosene/kerosene range; l) bunker oil; m) fuel oil; n) stoddard solvent/mineral spirit; p) see attached narrative.



QC SUMMARY REPORT FOR SW8015C

W.O. Sample Matrix: Water

QC Matrix: Water

WorkOrder 0705331

EPA Method SW8015C	Extraction SW3510C/3630C			BatchID: 28003			Spiked Sample ID: N/A					
Analyte	Sample	Spiked	MS	MSD	MS-MSD	LCS	LCSD	LCS-LCSD	Acceptance Criteria (%)			
	µg/L	µg/L	% Rec.	% Rec.	% RPD	% Rec.	% Rec.	% RPD	MS / MSD	RPD	LCS/LCSD	RPD
TPH(d)	N/A	1000	N/A	N/A	N/A	91.6	90.7	0.971	N/A	N/A	70 - 130	30
%SS:	N/A	2500	N/A	N/A	N/A	103	103	0	N/A	N/A	70 - 130	30

All target compounds in the Method Blank of this extraction batch were ND less than the method RL with the following exceptions:

NONE

BATCH 28003 SUMMARY

Sample ID	Date Sampled	Date Extracted	Date Analyzed	Sample ID	Date Sampled	Date Extracted	Date Analyzed
0705331-001B	05/11/07 2:50 PM	05/11/07	05/12/07 6:22 AM	0705331-002B	05/11/07 12:45 PM	05/11/07	05/12/07 7:30 AM
0705331-003B	05/11/07 2:10 PM	05/11/07	05/12/07 11:52 AM				

MS = Matrix Spike; MSD = Matrix Spike Duplicate; LCS = Laboratory Control Sample; LCSD = Laboratory Control Sample Duplicate; RPD = Relative Percent Deviation.

% Recovery = 100 * (MS-Sample) / (Amount Spiked); RPD = 100 * (MS - MSD) / ((MS + MSD) / 2).

MS / MSD spike recoveries and / or %RPD may fall outside of laboratory acceptance criteria due to one or more of the following reasons: a) the sample is inhomogenous AND contains significant concentrations of analyte relative to the amount spiked, or b) the spiked sample's matrix interferes with the spike recovery.

N/A = not enough sample to perform matrix spike and matrix spike duplicate.

NR = analyte concentration in sample exceeds spike amount for soil matrix or exceeds 2x spike amount for water matrix or sample diluted due to high matrix or analyte content.



QC SUMMARY REPORT FOR SW8021B/8015Cm

W.O. Sample Matrix: Water

QC Matrix: Water

WorkOrder 0705331

Analyte	EPA Method SW8021B/8015Cm		Extraction SW5030B			BatchID: 28047			Spiked Sample ID: 0705327-002A			
	Sample	Spiked	MS	MSD	MS-MSD	LCS	LCSD	LCS-LCSD	Acceptance Criteria (%)			
	µg/L	µg/L	% Rec.	% Rec.	% RPD	% Rec.	% Rec.	% RPD	MS / MSD	RPD	LCS/LCSD	RPD
TPH(btex) [£]	ND	60	78.3	82.9	5.69	110	106	0.508	70 - 130	30	70 - 130	30
MTBE	ND	10	73.9	77.2	4.42	87.5	87.5	0	70 - 130	30	70 - 130	30
Benzene	ND	10	93.3	97.7	4.58	98.9	98	0.135	70 - 130	30	70 - 130	30
Toluene	ND	10	94.1	98	4.00	111	110	0.551	70 - 130	30	70 - 130	30
Ethylbenzene	ND	10	97.1	102	4.71	109	108	0.479	70 - 130	30	70 - 130	30
Xylenes	ND	30	107	113	6.06	120	120	0	70 - 130	30	70 - 130	30
%SS:	90	10	99	98	1.13	98	98	0	70 - 130	30	70 - 130	30

All target compounds in the Method Blank of this extraction batch were ND less than the method RL with the following exceptions:
NONE

BATCH 28047 SUMMARY

Sample ID	Date Sampled	Date Extracted	Date Analyzed	Sample ID	Date Sampled	Date Extracted	Date Analyzed
0705331-001A	05/11/07 2:50 PM	05/14/07	05/14/07 6:01 PM	0705331-002A	05/11/07 12:45 PM	05/14/07	05/14/07 7:03 PM

MS = Matrix Spike; MSD = Matrix Spike Duplicate; LCS = Laboratory Control Sample; LCSD = Laboratory Control Sample Duplicate; RPD = Relative Percent Deviation.

% Recovery = 100 * (MS-Sample) / (Amount Spiked); RPD = 100 * (MS - MSD) / ((MS + MSD) / 2).

MS / MSD spike recoveries and / or %RPD may fall outside of laboratory acceptance criteria due to one or more of the following reasons: a) the sample is inhomogenous AND contains significant concentrations of analyte relative to the amount spiked, or b) the spiked sample's matrix interferes with the spike recovery.

£ TPH(btex) = sum of BTEX areas from the FID.

cluttered chromatogram; sample peak coelutes with surrogate peak.



QC SUMMARY REPORT FOR SW8021B/8015Cm

W.O. Sample Matrix: Water

QC Matrix: Water

WorkOrder 0705331

EPA Method SW8021B/8015Cm	Extraction SW5030B			BatchID: 28050			Spiked Sample ID: 0705333-002A					
	Analyte	Sample	Spiked	MS	MSD	MS-MSD	LCS	LCSD	LCS-LCSD	Acceptance Criteria (%)		
	µg/L	µg/L	% Rec.	% Rec.	% RPD	% Rec.	% Rec.	% RPD	MS / MSD	RPD	LCS/LCSD	RPD
TPH(btex) [£]	ND	60	110	111	1.34	91.4	101	9.58	70 - 130	30	70 - 130	30
MTBE	ND	10	87.5	82.7	5.67	87.1	87.4	0.307	70 - 130	30	70 - 130	30
Benzene	ND	10	97.4	98.7	1.30	91.9	95.1	3.35	70 - 130	30	70 - 130	30
Toluene	ND	10	109	110	0.517	92.5	96	3.74	70 - 130	30	70 - 130	30
Ethylbenzene	ND	10	108	108	0	96.5	100	3.90	70 - 130	30	70 - 130	30
Xylenes	ND	30	120	120	0	107	110	3.08	70 - 130	30	70 - 130	30
%SS:	96	10	98	101	2.63	97	96	0.813	70 - 130	30	70 - 130	30

All target compounds in the Method Blank of this extraction batch were ND less than the method RL with the following exceptions:
NONE

BATCH 28050 SUMMARY

Sample ID	Date Sampled	Date Extracted	Date Analyzed	Sample ID	Date Sampled	Date Extracted	Date Analyzed
0705331-003A	05/11/07 2:10 PM	05/14/07	05/14/07 8:03 PM	0705331-004A	05/11/07 2:30 PM	05/14/07	05/14/07 9:04 PM
0705331-005A	05/11/07 12:10 PM	05/14/07	05/14/07 9:34 PM	0705331-006A	05/11/07 3:23 PM	05/16/07	05/16/07 4:15 PM
0705331-007A	05/11/07 3:45 PM	05/14/07	05/14/07 10:35 PM				

MS = Matrix Spike; MSD = Matrix Spike Duplicate; LCS = Laboratory Control Sample; LCSD = Laboratory Control Sample Duplicate; RPD = Relative Percent Deviation.

% Recovery = 100 * (MS-Sample) / (Amount Spiked); RPD = 100 * (MS - MSD) / ((MS + MSD) / 2).

MS / MSD spike recoveries and / or %RPD may fall outside of laboratory acceptance criteria due to one or more of the following reasons: a) the sample is inhomogenous AND contains significant concentrations of analyte relative to the amount spiked, or b) the spiked sample's matrix interferes with the spike recovery.

£ TPH(btex) = sum of BTEX areas from the FID.

cluttered chromatogram; sample peak coelutes with surrogate peak.



QC SUMMARY REPORT FOR SW8015C

W.O. Sample Matrix: Water

QC Matrix: Water

WorkOrder 0705331

Analyte	EPA Method SW8015C		Extraction SW3510C/3630C			BatchID: 28051			Spiked Sample ID: N/A			
	Sample	Spiked	MS	MSD	MS-MSD	LCS	LCSD	LCS-LCSD	Acceptance Criteria (%)			
	µg/L	µg/L	% Rec.	% Rec.	% RPD	% Rec.	% Rec.	% RPD	MS / MSD	RPD	LCS/LCSD	RPD
TPH(d)	N/A	1000	N/A	N/A	N/A	103	104	0.277	N/A	N/A	70 - 130	30
%SS:	N/A	2500	N/A	N/A	N/A	103	101	1.71	N/A	N/A	70 - 130	30

All target compounds in the Method Blank of this extraction batch were ND less than the method RL with the following exceptions:
NONE

BATCH 28051 SUMMARY

Sample ID	Date Sampled	Date Extracted	Date Analyzed	Sample ID	Date Sampled	Date Extracted	Date Analyzed
0705331-004B	05/11/07 2:30 PM	05/11/07	05/18/07 4:50 AM	0705331-005B	05/11/07 12:10 PM	05/11/07	05/12/07 1:04 PM
0705331-006B	05/11/07 3:23 PM	05/11/07	05/12/07 2:15 PM	0705331-007B	05/11/07 3:45 PM	05/11/07	05/12/07 3:26 PM

MS = Matrix Spike; MSD = Matrix Spike Duplicate; LCS = Laboratory Control Sample; LCSD = Laboratory Control Sample Duplicate; RPD = Relative Percent Deviation.

% Recovery = 100 * (MS-Sample) / (Amount Spiked); RPD = 100 * (MS - MSD) / ((MS + MSD) / 2).

MS / MSD spike recoveries and / or %RPD may fall outside of laboratory acceptance criteria due to one or more of the following reasons: a) the sample is inhomogenous AND contains significant concentrations of analyte relative to the amount spiked, or b) the spiked sample's matrix interferes with the spike recovery.

N/A = not enough sample to perform matrix spike and matrix spike duplicate.

NR = analyte concentration in sample exceeds spike amount for soil matrix or exceeds 2x spike amount for water matrix or sample diluted due to high matrix or analyte content.