

GETTLER-RYAN INC.

RECEIVED

10:01 am, Jul 28, 2008

Alameda County
Environmental Health

June 19, 2008

G-R #385280

TRANSMITTAL

TO: Ms. Charlotte Evans
Conestoga-Rovers & Associates
5900 Hollis Street, Suite A
Emeryville, CA 94608

CC: Mr. Aaron Costa
Chevron Environmental
Management Company
P.O. Box 6012, Room K2256
San Ramon, California 94583

FROM: Deanna L. Harding
Project Coordinator
Gettler-Ryan Inc.
6747 Sierra Court, Suite J
Dublin, California 94568

RE: **Chevron Service Station
#9-0290
1802 Webster Street
Alameda, California
RO 0000195**

WE HAVE ENCLOSED THE FOLLOWING:

COPIES	DATED	DESCRIPTION
1	June 16, 2008	Groundwater Monitoring and Sampling Report Second Quarter Event of May 14, 2008

COMMENTS:

Pursuant to your request, we are providing you with a copy of the above referenced report for **your use and distribution to the following (via PDF):**

Mr. Steven Plunkett, Alameda County Health Care Services, Dept. of Environmental Health, 1131 Harbor Bay Parkway, Suite 250, Alameda, CA 94502-6577 (Distributed by CRA via PDF)

Please provide any comments/changes and propose any groundwater monitoring modifications for the next event prior to **July 3, 2008**, at which time this final report will be distributed to the following:

cc: Mr. Arnold Cherry, 10 Kelsey Court, Pleasant Hill, CA 94523

Enclosures

trans/9-0290-AC

6747 Sierra Court, Suite J • Dublin, CA 94568 • (925) 551-7555 • Fax (925) 551-7888
3140 Gold Camp Drive, Suite 170 • Rancho Cordova, CA 95670 • (916) 631-1300 • Fax (916) 631-1317
1364 N. McDowell Blvd., Suite B2 • Petaluma, CA 94954 • (707) 789-3255 • Fax (707) 789-3218



Aaron Costa
Project Manager
Marketing Business Unit

**Chevron Environmental
Management Company**
6001 Bollinger Canyon Road
San Ramon, CA 94583
Tel (925) 842-0424
Fax (925) 842-8370
acosta@chevron.com

June 19, 2008

Alameda County Health Care Services
1131 Harbor Bay Parkway, Suite 250
Alameda, CA 94502-6577

Re: Chevron Service Station No. 9-0290
Address 1802 Webster Street

I have reviewed the attached routine groundwater monitoring report dated
June 19, 2008.

I agree with the conclusions and recommendations presented in the referenced report. The information in this report is accurate to the best of my knowledge and all local Agency/Regional Board guidelines have been followed. This report was prepared by Gettler-Ryan Inc., upon whose assistance and advice I have relied.

This letter is submitted pursuant to the requirements of California Water Code Section 13267(b)(1) and the regulating implementation entitled Appendix A pertaining thereto.

I declare under penalty of perjury that the foregoing is true and correct.

Sincerely,

A handwritten signature in black ink that reads "Aaron Costa". The signature is written in a cursive, flowing style.

Aaron Costa
Project Manager

Attachment: Report

WELL CONDITION STATUS SHEET

Client/Facility #: Chevron #9-0290
 Site Address: 1802 Webster Street
 City: Alameda, CA

Job # 385280
 Event Date: 5-14-08
 Sampler: Joe

WELL ID	Vault Frame Condition	Gasket/O-Ring (M)missing	BOLTS (M) Missing (R) Replaced	Bolt Flanges B= Broken S= Stripped R=Retap	APRON Condition C=Cracked B=Broken G=Gone	Grout Seal (Deficient) inches from TOC	Casing (Condition prevents tight cap seal)	REPLACE LOCK Y/N	REPLACE CAP Y/N	WELL VAULT Manufacture/Size/ # of Bolts	Pictures Taken Yes / No
A-1	O.K	O.K	O.K	(1) off (2) S	O.K	O.K	O.K	N	N	12" Morrison / 2	NO
B-1		O.K	N/A	N/A						14" (no name)	
B-5		O-ring (M)	O.K	O.K						8" Boert / 3	
B-6		O-ring (M)		O.K						8" Boert / 3	
B-7		O.K		Both S						12" Morrison / 2	
B-10		O-ring (M)		All (3) S						8" Boert / 3	
B-11		O.K		O.K						6" Morrison / 2	
B-12		O.K		Both S						6" Morrison / 2	
B-13		O-ring (M)		All (3) S						8" Boert / 2	
B-14		O.K		O.K						6" Morrison / 2	
B-15	↓	O.K	↓	O.K	↓	↓	↓	↓	↓	6" Morrison / 2	↓

Comments _____

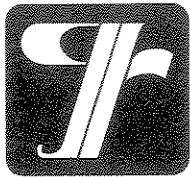

GETTLER - RYAN INC.

June 16, 2008
G-R Job #385280

Mr. Aaron Costa
Chevron Environmental Management Company
P.O. Box 6012, Room K2256
San Ramon, CA 94583

RE: Second Quarter Event of May 14, 2008
Groundwater Monitoring & Sampling Report
Chevron Service Station #9-0290
1802 Webster Street
Alameda, California

Dear Mr. Costa:

This report documents and the most recent groundwater monitoring and sampling event performed by Gettler-Ryan Inc. (G-R) at the referenced site. All field work was conducted in accordance with G-R Standard Operating Procedure - Groundwater Sampling (attached). Joint groundwater monitoring and sampling is performed with BP Station located at 1716 Webster Street, during the first and third quarters. Joint monitoring data is not reported.

Static groundwater levels were measured and the wells were checked for the presence of separate-phase hydrocarbons. Static water level data, groundwater elevations and separate-phase hydrocarbon thickness (if any) are presented in the attached Table 1. A Potentiometric Map is included as Figure 1.

Groundwater samples were collected from the monitoring wells and submitted to a state certified laboratory for analyses. The field data sheets for this event are attached. Analytical results are presented in the table(s) listed below. The chain of custody document and laboratory analytical report are also attached.

Please call if you have any questions or comments regarding this report. Thank you.

Sincerely,

Deanna L. Harding
Project Coordinator

Douglas J. Lee
Senior Geologist, P.G. No. 6882

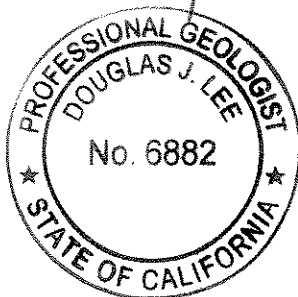
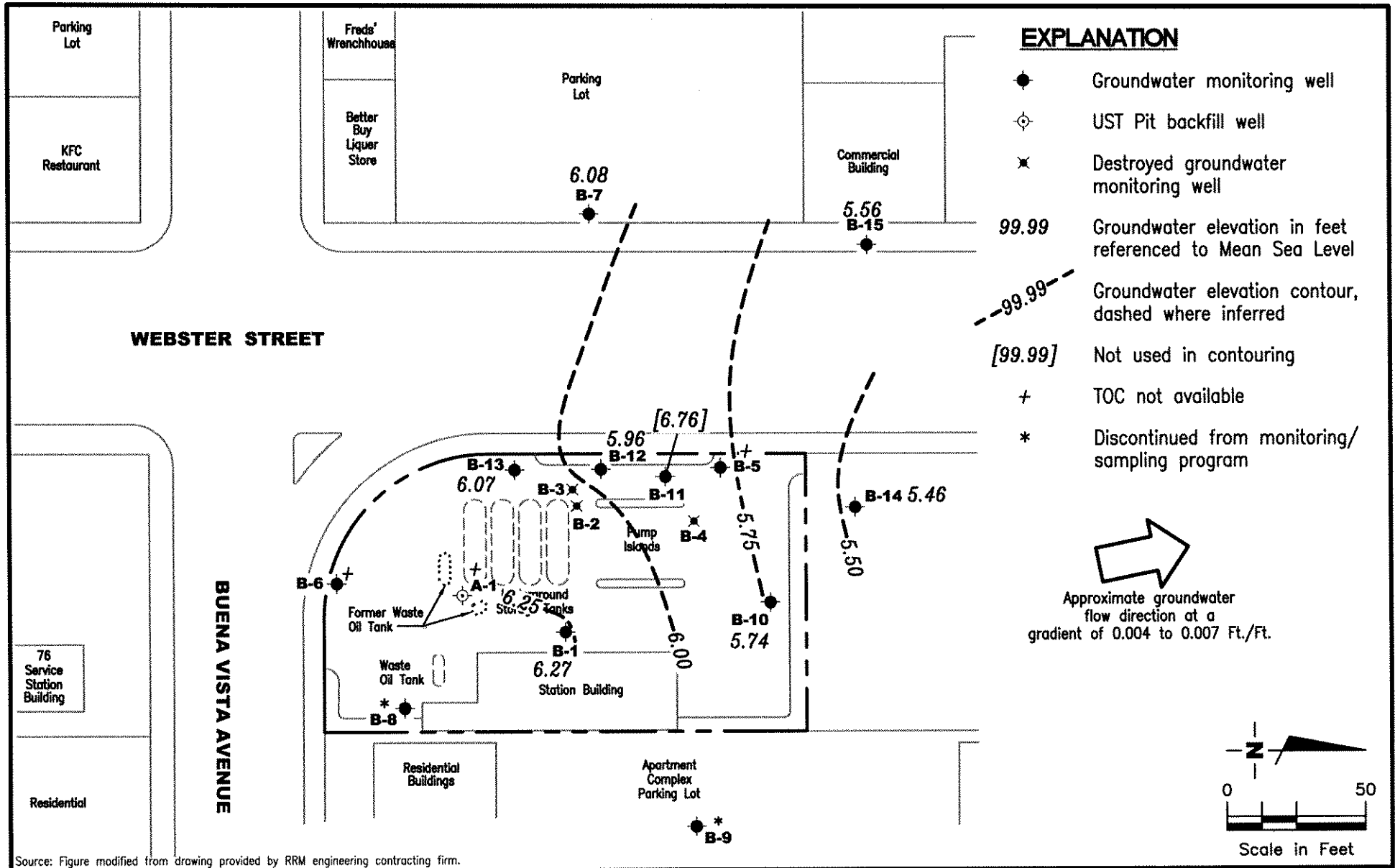

Figure 1: Potentiometric Map
Table 1: Groundwater Monitoring Data and Analytical Results
Table 2: Groundwater Analytical Results
Attachments: Standard Operating Procedure - Groundwater Sampling
Field Data Sheets
Chain of Custody Document and Laboratory Analytical Reports



Source: Figure modified from drawing provided by RRM engineering contracting firm.

GETTLER - RYAN INC.
 6747 Sierra Court, Suite J
 Dublin, CA 94568 (925) 551-7555

POTENTIOMETRIC MAP
 Chevron Service Station #9-0290
 1802 Webster Street
 Alameda, California

FIGURE
1

PROJECT NUMBER
 385280

REVIEWED BY

DATE
 May 14, 2008

REVISED DATE

Table 1
Groundwater Monitoring Data and Analytical Results
Chevron Service Station #9-0290
1802 Webster Street
Alameda, California

WELL ID/ DATE	TOC* (ft.)	GWE (msl)	DTW (ft.)	SPHT (ft.)	SPH								MTBE (ppb)	TOG (ppb)
					REMOVED (gallons)	TPH-D (ppb)	TPH-G (ppb)	B (ppb)	T (ppb)	E (ppb)	X (ppb)			
A-1														
09/20/91	8.13	0.48	9.23	1.58	--	--	--	--	--	--	--	--	--	--
10/09/91	8.13	1.46	6.67	0.00	--	--	--	--	--	--	--	--	--	--
10/17/91	8.13	1.43	7.28	0.58	--	--	--	--	--	--	--	--	--	--
10/23/91	8.13	1.36	7.42	0.65	--	--	--	--	--	--	--	--	--	--
11/01/91	8.13	1.49	7.14	0.50	--	--	--	--	--	--	--	--	--	--
11/07/91	8.13	1.50	7.14	0.51	--	--	--	--	--	--	--	--	--	--
11/15/91	8.13	1.47	7.19	0.53	--	--	--	--	--	--	--	--	--	--
11/21/91	8.13	1.28	7.28	0.54	--	--	--	--	--	--	--	--	--	--
12/12/91	8.13	1.29	7.33	0.49	--	--	--	--	--	--	--	--	--	--
12/30/91	8.13	1.73	6.76	0.36	--	--	--	--	--	--	--	--	--	--
01/13/92	8.13	2.21	6.29	0.37	--	--	--	--	--	--	--	--	--	--
01/22/92	8.13	2.15	6.43	0.45	--	--	--	--	--	--	--	--	--	--
02/12/92	8.13	2.21	6.30	0.38	--	--	--	--	--	--	--	--	--	--
03/09/92	8.13	3.14	5.30	0.31	--	--	--	--	--	--	--	--	--	--
04/10/92	8.13	2.83	5.37	0.07	--	--	--	--	--	--	--	--	--	--
05/18/92	8.13	2.39	6.14	0.40	--	--	--	--	--	--	--	--	--	--
01/06/93	8.13	--	--	--	--	--	--	--	--	--	--	--	--	--
02/03/93	8.13	--	--	--	--	--	--	--	--	--	--	--	--	--
04/23/93	11.56	6.19	5.85	0.60	--	--	--	--	--	--	--	--	--	--
06/11/93	11.56	--	--	--	2.00	--	--	--	--	--	--	--	--	--
06/15/93	11.56	--	--	--	0.13	--	--	--	--	--	--	--	--	--
06/18/93	11.56	--	--	--	0.13	--	--	--	--	--	--	--	--	--
06/22/93	11.56	--	--	--	0.50	--	--	--	--	--	--	--	--	--
06/29/93	11.56	--	--	--	--	--	--	--	--	--	--	--	--	--
07/09/93	11.56	--	--	--	--	--	--	--	--	--	--	--	--	--
07/15/93	11.56	--	--	--	--	--	--	--	--	--	--	--	--	--
07/19/93	11.56	5.54	6.23	0.26	2.00	--	--	--	--	--	--	--	--	--
07/20/93	11.56	--	--	--	--	--	--	--	--	--	--	--	--	--
07/27/93	11.56	--	--	--	--	--	--	--	--	--	--	--	--	--
08/06/93	11.56	--	--	--	--	--	--	--	--	--	--	--	--	--
08/10/93	11.56	--	--	--	--	--	--	--	--	--	--	--	--	--
08/16/93	11.56	--	--	--	--	--	--	--	--	--	--	--	--	--
09/16/93	11.56	--	--	--	--	--	--	--	--	--	--	--	--	--
09/24/93	11.56	--	--	--	--	--	--	--	--	--	--	--	--	--
10/01/93	11.56	--	--	--	--	--	--	--	--	--	--	--	--	--

Table 1
Groundwater Monitoring Data and Analytical Results
Chevron Service Station #9-0290
1802 Webster Street
Alameda, California

WELL ID/ DATE	TOC* (ft.)	GWE (mst)	DTW (ft.)	SPHT (ft.)	SPH REMOVED (gallons)	TPH-D (ppb)	TPH-G (ppb)	B (ppb)	T (ppb)	E (ppb)	X (ppb)	MTBE (ppb)	TOG (ppb)
A-1 (cont)													
10/07/93	11.56	--	--	--	--	--	--	--	--	--	--	--	--
10/13/93	11.56	--	--	--	--	--	--	--	--	--	--	--	--
10/19/93	11.56	--	--	0.10	--	--	--	--	--	--	--	--	--
10/20/93	11.56	--	--	--	--	--	--	--	--	--	--	--	--
10/28/93	11.56	--	--	--	--	--	--	--	--	--	--	--	--
11/12/93	11.56	--	--	--	--	--	--	--	--	--	--	--	--
11/19/93	11.56	--	--	--	--	--	--	--	--	--	--	--	--
11/30/93	11.56	--	--	--	--	--	--	--	--	--	--	--	--
12/10/93	11.56	--	--	--	--	--	--	--	--	--	--	--	--
12/16/93	11.56	--	--	--	--	--	--	--	--	--	--	--	--
12/23/93	11.56	--	--	--	--	--	--	--	--	--	--	--	--
12/29/93	11.56	--	--	--	--	--	--	--	--	--	--	--	--
01/03/94	11.56	--	--	--	--	--	--	--	--	--	--	--	--
01/17/94	11.56	--	--	--	--	--	--	--	--	--	--	--	--
01/26/94	11.56	--	--	--	--	--	--	--	--	--	--	--	--
02/07/94	11.56	--	--	--	--	--	--	--	--	--	--	--	--
02/11/94	11.56	--	--	--	--	--	--	--	--	--	--	--	--
02/18/94	11.56	--	--	--	--	--	--	--	--	--	--	--	--
02/25/94	11.56	--	--	--	--	--	--	--	--	--	--	--	--
03/04/94	11.56	--	--	--	--	--	--	--	--	--	--	--	--
03/11/94	11.56	--	--	--	--	--	--	--	--	--	--	--	--
03/16/94	11.56	--	--	--	--	--	--	--	--	--	--	--	--
03/25/94	11.56	--	--	--	--	--	--	--	--	--	--	--	--
04/01/94	11.56	--	--	--	--	--	--	--	--	--	--	--	--
08/18/94	11.56	--	--	--	--	--	--	--	--	--	--	--	--
11/30/94	11.56	--	--	--	2.00	--	--	--	--	--	--	--	--
02/15/95	11.56	--	4.79	--	--	--	--	--	--	--	--	--	--
05/01/95	11.56	--	--	--	--	--	--	--	--	--	--	--	--
08/04/95	11.56	--	--	--	--	--	--	--	--	--	--	--	--
11/29/95	11.56	5.24	6.38	0.08	0.03	--	--	--	--	--	--	--	--
02/08/96	11.56	7.03	4.57	0.05	--	--	--	--	--	--	--	--	--
05/08/96	11.56	6.29	5.49	0.28	--	--	--	--	--	--	--	--	--
08/23/96	11.56	5.31	6.43	0.22	--	--	--	--	--	--	--	--	--
12/12/96	11.56	6.37	5.53	0.42	0.05	--	--	--	--	--	--	--	--
02/10/97	11.56	7.25	4.45	0.17	0.08	--	--	--	--	--	--	--	--

Table 1
Groundwater Monitoring Data and Analytical Results
Chevron Service Station #9-0290
1802 Webster Street
Alameda, California

WELL ID/ DATE	TOC* (ft.)	GWE (msl)	DTW (ft.)	SPHT (ft.)	SPH								MTBE (ppb)	TOG (ppb)
					REMOVED (gallons)	TPH-D (ppb)	TPH-G (ppb)	B (ppb)	T (ppb)	E (ppb)	X (ppb)			
A-1 (cont)														
05/01/97	11.56	6.11	5.51	0.08	0.05	--	--	--	--	--	--	--	--	--
08/05/97	11.56	5.68	5.96	0.10	0.07	--	--	--	--	--	--	--	--	--
10/28/97	11.56	5.56	6.05	0.06	0.03	--	--	--	--	--	--	--	--	--
02/04/98	11.56	8.39	3.20	0.04	0.03	--	--	--	--	--	--	--	--	--
06/03/98	11.56	7.02	4.56	0.03	0.02	--	--	--	--	--	--	--	--	--
07/29/98	11.56	7.15	4.44	0.04	0.04	--	--	--	--	--	--	--	--	--
11/30/98	11.56	6.23	5.61	0.35	0.01	--	--	--	--	--	--	--	--	--
02/24/99	11.56	7.63	4.41	0.60	0.07	--	--	--	--	--	--	--	--	--
05/06/99	11.56	6.89	4.67	--	--	9,500 ³	580	13.4	<2.0	4.68	58	165	--	--
08/30/99	11.56	5.52	6.04	--	--	22,000 ³	615	12	3.45	3.8	44	95.5	--	--
11/17/99	11.56	5.70	5.89	0.04	0.08	--	--	--	--	--	--	--	--	--
02/21/00	11.56	7.39	4.23	0.08	0.01	--	--	--	--	--	--	--	--	--
05/08/00	11.56	6.55**	5.10	0.11	0.00	NOT SAMPLED DUE TO THE PRESENCE OF SPH				--	--	--	--	--
08/08/00	11.56	6.13**	5.53	0.13	0.26	NOT SAMPLED DUE TO THE PRESENCE OF SPH				--	--	--	--	--
11/01/00	11.56	5.99**	5.67	0.13	0.26	NOT SAMPLED DUE TO THE PRESENCE OF SPH				--	--	--	--	--
02/12/01	11.56	6.85	4.71	0.00	0.00	15,000 ¹²	290 ¹⁰	5.1	<2.0	<2.0	17	640	--	--
05/14/01 ¹⁷	11.56	6.26	5.30	0.00	0.00	3,100 ¹²	190 ¹⁰	4.8	1.2	0.92	22	100	--	--
08/13/01	11.56	5.69**	5.89	0.03	0.26	NOT SAMPLED DUE TO THE PRESENCE OF SPH				--	--	--	--	--
11/12/01	11.56	5.84**	5.78	0.08	0.05	NOT SAMPLED DUE TO THE PRESENCE OF SPH				--	--	--	--	--
02/04/02	11.56	6.77	4.79	0.00	0.00	23,000	380	3.3	1.4	0.69	14	1,800	--	--
05/06/02	11.56	6.56	5.00	0.00	0.00	12,000	280	2.7	1.9	1.1	20	130	--	--
08/29/02	11.56	5.86	5.70	0.00	0.00	13,000	380	4.1	3.3	2.1	31	42	--	--
11/25/02	11.56	5.74	5.82	0.00	0.00	19,000	290	3.0	1.3	0.81	12	340	--	--
02/05/03	11.56	6.75	4.81	0.00	0.00	12,000	290	3.1	1.1	<0.50	5.2	2,400 ²²	--	--
05/15/03	11.56	6.71	4.85	0.00	0.00	8,400	330	4.3	1.8	1	16	190	--	--
08/14/03 ²⁴	11.56	5.85	5.71	0.00	0.00	9,100 ²³	450	8	3	2	26	270	--	--
11/13/03 ²⁴	11.56	5.65	5.91	0.00	0.00	13,000	310	4	0.6	0.6	7	150	--	--
02/12/04 ²⁴	-- ²⁵	-- ²⁵	4.31	0.00	0.00	14,000	120	<0.5	<0.5	<0.5	3	84	--	--
05/13/04 ²⁴	-- ²⁵	-- ²⁵	4.53	0.00	0.00	3,900 ²³	310	3	1	0.9	13	9	--	--
08/12/04 ²⁴	-- ²⁵	-- ²⁵	5.13	0.00	0.00	4,600	240	1	<0.5	<0.5	5	16	--	--
11/11/04 ²⁴	-- ²⁵	-- ²⁵	5.67	0.00	0.00	9,500	<50	<0.5	<0.5	<0.5	<0.5	41	--	--
02/10/05 ²⁴	-- ²⁵	-- ²⁵	4.38	0.00	0.00	9,900	160	<0.5	<0.5	<0.5	1	43	--	--
05/12/05 ²⁴	-- ²⁵	-- ²⁵	4.19	0.00	0.00	3,100 ²⁶	180	0.7	0.5	<0.5	5	4	--	--
08/11/05 ²⁴	-- ²⁵	-- ²⁵	4.99	0.00	0.00	3,900 ²⁷	250	0.7	0.6	0.5	5	3	--	--
11/10/05 ²⁴	-- ²⁵	-- ²⁵	4.95	0.00	0.00	2,700 ²⁷	160	<0.5	<0.5	<0.5	2	37	--	--

Table 1
Groundwater Monitoring Data and Analytical Results
Chevron Service Station #9-0290
1802 Webster Street
Alameda, California

WELL ID/ DATE	TOC* (ft.)	GWE (msl)	DTW (ft.)	SPHT (ft.)	SPH REMOVED (gallons)	TPH-D (ppb)	TPH-G (ppb)	B (ppb)	T (ppb)	E (ppb)	X (ppb)	MTBE (ppb)	TOG (ppb)
A-1 (cont)													
02/09/06 ²⁴	-- ²⁵	-- ²⁵	4.02	0.00	0.00	4,700 ²⁷	83	<0.5	<0.5	<0.5	<0.5	28	--
05/11/06 ²⁴	-- ²⁵	-- ²⁵	4.06	0.00	0.00	4,000	71	<0.5	<0.5	<0.5	3	<0.5	--
08/10/06 ²⁴	-- ²⁵	-- ²⁵	5.05	0.00	0.00	4,500	180	0.8	0.7	0.6	6	1	--
11/09/06 ²⁴	-- ²⁵	-- ²⁵	5.38	0.00	0.00	3,300	160	<0.5	<0.5	<0.5	2	18	--
02/08/07 ²⁴	-- ²⁵	-- ²⁵	5.02	0.00	0.00	5,300	65	<0.5	<0.5	<0.5	<0.5	17	--
05/10/07 ²⁴	-- ²⁵	-- ²⁵	4.76	0.00	0.00	2,600	110	0.7	<0.5	<0.5	3	2	--
08/08/07 ²⁴	-- ²⁵	-- ²⁵	5.45	0.00	0.00	2,100	160	<0.5	<0.5	<0.5	5	7	--
11/07/07 ²⁴	-- ²⁵	-- ²⁵	5.60	0.00	0.00	6,900	78	<0.5	<0.5	<0.5	0.7	22	--
02/13/08 ²⁴	-- ²⁵	-- ²⁵	4.12	0.00	0.00	7,800	70	<0.5	<0.5	<0.5	<0.5	15	--
05/14/08 ²⁴	-- ²⁵	-- ²⁵	4.98	0.00	0.00	5,200	1,500	<0.5	<0.5	<0.5	3	2	--
B-1													
04/23/93	12.12	6.19	5.93	--	--	8,300	13,000	4,900	22	250	47	--	--
07/19/93	12.12	5.46	6.66	--	--	1,600	3,300	1,200	16	24	<30	--	--
10/19/93	12.12	5.04	7.08	--	--	550	2,300	730	18	14	31	--	--
01/17/94	12.12	5.39	6.73	--	--	<50	22,000	6,500	170	210	430	--	--
08/18/94	12.12	5.27	6.85	--	--	--	--	--	--	--	--	--	--
11/30/94	12.12	6.11	6.01	--	--	3,200 ¹	1,500	250	17	7.5	19	--	<5.0 ²
02/15/95	12.12	6.75	5.37	--	--	1,300 ¹	1,000	160	<2.0	4.6	2.6	--	--
05/01/95	12.12	7.00	5.12	--	--	2,600 ³	140	20	0.52	2.0	0.67	--	--
08/04/95	12.12	6.62	5.50	--	--	4,900 ³	6,700	1,400	<20	<20	<20	--	--
11/29/95	12.12	6.27	5.85	--	--	5,000 ³	9,200	2,200	<25	<25	25	8,300	--
02/08/96	12.12	8.12	4.00	--	--	1,300 ³	1,500	190	<5.0	<5.0	<5.0	2,300	--
05/08/96	12.12	7.32	4.80	--	--	2,900 ³	3,700	650	<10	24	16	2,300	--
08/23/96	12.12	6.58	5.54	--	--	2600	3,200	500	<20	<20	<20	4,900	--
12/12/96	12.12	7.22	4.90	--	--	3,400 ⁴	2,500	380	<25	<25	25	8,600	--
02/10/97	12.12	7.53	4.59	--	--	2,100 ³	2,200	270	11	8.8	13	3,400	--
05/01/97	12.12	6.46	5.66	--	--	1,300 ³	1,200	70	5.8	<5.0	7.2	2,000	--
08/05/97	12.12	5.68	6.44	--	--	1,500 ³	<1,000	86	<10	<10	<10	3,800	--
10/28/97	12.12	5.69	6.43	--	--	2,000 ³	1,400	73	6.5	6.8	9.0	2,900	--
02/04/98	12.12	9.11	3.01	--	--	1,200 ³	1,500	4.5	1.7	<0.5	2.2	1,900	--
02/12/98	12.12	8.33	3.79	--	--	--	--	--	--	--	--	--	--
06/03/98	12.12	7.23	4.89	--	--	970 ³	<50	<0.5	<0.5	<0.5	<0.5	1,400	--
07/29/98	12.12	6.37	5.75	--	--	1,100 ³	850	27	<0.5	4.0	2.9	770/1,200 ⁶	--

Table 1
Groundwater Monitoring Data and Analytical Results
Chevron Service Station #9-0290
1802 Webster Street
Alameda, California

WELL ID/ DATE	TOC* (ft.)	GWE (msl)	DTW (ft.)	SPHT (ft.)	SPH		TPH-D (ppb)	TPH-G (ppb)	B (ppb)	T (ppb)	E (ppb)	X (ppb)	MTBE (ppb)	TOG (ppb)
					REMOVED (gallons)									
B-1 (cont)														
11/30/98	12.12	6.44	5.68	--	--	1,490	543	<5.0	<5.0	<5.0	<5.0	2,220	--	
02/24/99	12.12	7.83	4.29	--	--	1,400 ³	390	1.6	0.57	2.8	2.5	2,600	--	
05/06/99	12.12	7.11	5.01	--	--	340 ³	239	4.02	<0.5	3.87	1.97	197	--	
08/30/99	12.12	5.91	6.21	--	--	1,570 ⁷	739	22.4	3.45	5.62	3.27	1,110	--	
11/17/99	12.12	5.98	6.14	--	--	1,730	907	66.4	3.82	4.39	4.75	2,480	--	
02/21/00	12.12	7.53	4.59	--	--	1,000 ³	679	10.5	<1.0	3.84	3.21	2,330	--	
05/08/00	12.12	6.66	5.46	0.00	0.00	870 ¹¹	1,000 ⁸	<5.0	<5.0	<5.0	<5.0	660	--	
08/08/00	12.12	6.22	5.90	0.00	0.00	520 ¹¹	<500	29	<5.0	<5.0	<5.0	1,900	--	
11/01/00	12.12	7.14	4.98	0.00	0.00	570 ¹⁴	860 ¹⁰	41	<5.0	8.3	13	2,500	--	
02/12/01	12.12	6.71	5.41	0.00	0.00	940 ¹⁴	790 ¹⁵	36	<5.0	<5.0	18	1,200	--	
05/14/01	12.12	6.38	5.74	0.00	0.00	690 ¹¹	<1,000	<10	<10	<10	<10	540	--	
11/12/01	12.12	5.59	6.53	0.00	0.00	2,300	1,100	12	2.5	3.4	8.8	1,100	--	
02/04/02	12.12	6.92	5.20	0.00	0.00	1,800	850	7.5	0.66	5.3	<5.0	220	--	
05/06/02	12.12	6.67	5.45	0.00	0.00	440	350	<0.50	<0.50	1.7	<1.5	83	--	
08/29/02	12.12	5.94	6.18	0.00	0.00	3,000	770	7.3	1.1	1.5	3.1	330	--	
11/25/02	12.12	5.87	6.25	0.00	0.00	3,400	510	7.7	<1.0	1.2	3.6	540	--	
02/05/03	12.12	6.87	5.25	0.00	0.00	1,400	560	4.8	0.55	2.4	1.9	200	--	
05/15/03	12.12	6.86	5.26	0.00	0.00	1,400	370	2.4	<0.5	1.9	2.0	130	--	
08/14/03 ²⁴	12.12	5.92	6.20	0.00	0.00	1,300 ²³	650	4	0.9	0.7	2	210	--	
11/13/03 ²⁴	12.12	5.73	6.39	0.00	0.00	720	210	0.7	<0.5	<0.5	0.9	200	--	
02/12/04 ²⁴	12.12	6.95	5.17	0.00	0.00	1,200	<50	<0.5	<0.5	<0.5	<0.5	53	--	
05/13/04 ²⁴	12.12	6.86	5.26	0.00	0.00	63 ²³	<50	<0.5	<0.5	<0.5	<0.5	10	--	
08/12/04 ²⁴	12.12	6.11	6.01	0.00	0.00	280	<50	<0.5	<0.5	<0.5	<0.5	26	--	
11/11/04 ²⁴	12.12	5.64	6.48	0.00	0.00	280	<50	<0.5	<0.5	<0.5	<0.5	23	--	
02/10/05 ²⁴	12.12	6.71	5.41	0.00	0.00	420	<50	<0.5	<0.5	<0.5	<0.5	41	--	
05/12/05 ²⁴	12.12	7.14	4.98	0.00	0.00	200	<50	<0.5	<0.5	<0.5	<0.5	9	--	
08/11/05 ²⁴	12.12	6.34	5.78	0.00	0.00	260 ²⁷	<50	<0.5	<0.5	<0.5	<0.5	17	--	
11/10/05 ²⁴	12.12	6.38	5.74	0.00	0.00	130 ²⁷	<50	<0.5	<0.5	<0.5	<0.5	56	--	
02/09/06 ²⁴	12.12	7.26	4.86	0.00	0.00	380 ³¹	<50	<0.5	<0.5	<0.5	<0.5	25	--	
05/11/06 ²⁴	12.12	7.20	4.92	0.00	0.00	580	<50	<0.5	<0.5	<0.5	<0.5	10	--	
08/10/06 ²⁴	12.12	6.32	5.80	0.00	0.00	550	<50	<0.5	<0.5	<0.5	<0.5	8	--	
11/09/06 ²⁴	12.12	5.97	6.15	0.00	0.00	300	<50	<0.5	<0.5	<0.5	<0.5	7	--	
02/08/07 ²⁴	12.12	6.32	5.80	0.00	0.00	240	<50	<0.5	<0.5	<0.5	<0.5	5	--	
05/10/07 ²⁴	12.12	6.62	5.50	0.00	0.00	140	<50	<0.5	<0.5	<0.5	<0.5	4	--	

Table 1
Groundwater Monitoring Data and Analytical Results
Chevron Service Station #9-0290
1802 Webster Street
Alameda, California

WELL ID/ DATE	TOC* (ft.)	GWE (msl)	DTW (ft.)	SPHT (ft.)	SPH		TPH-D (ppb)	TPH-G (ppb)	B (ppb)	T (ppb)	E (ppb)	X (ppb)	MTBE (ppb)	TOG (ppb)
					REMOVED (gallons)									
B-1 (cont)														
08/08/07 ²⁴	12.12	5.94	6.18	0.00	0.00	170	<50	<0.5	<0.5	<0.5	<0.5	<0.5	6	--
11/07/07 ²⁴	12.12	5.81	6.31	0.00	0.00	250	<50	<0.5	<0.5	<0.5	<0.5	<0.5	7	--
02/13/08 ²⁴	12.12	7.18	4.94	0.00	0.00	570	<50	<0.5	<0.5	<0.5	<0.5	<0.5	47	--
05/14/08 ²⁴	12.12	6.27	5.85	0.00	0.00	200	<50	<0.5	<0.5	<0.5	<0.5	<0.5	1	--
B-5														
09/20/91	7.73	2.20	5.53	--	--	<50	<50	<0.5	<0.5	<0.5	<0.5	<0.5	--	--
10/09/91	7.73	2.42	5.31	--	--	--	--	--	--	--	--	--	--	--
10/17/91	7.73	2.09	5.64	--	--	--	--	--	--	--	--	--	--	--
10/23/91	7.73	2.05	5.68	--	--	--	--	--	--	--	--	--	--	--
11/01/91	7.73	2.24	5.49	--	--	--	--	--	--	--	--	--	--	--
11/07/91	7.73	2.19	5.54	--	--	--	--	--	--	--	--	--	--	--
11/15/91	7.73	2.10	5.63	--	--	--	--	--	--	--	--	--	--	--
11/21/91	7.73	--	--	--	--	--	--	--	--	--	--	--	--	--
12/12/91	7.73	2.05	5.68	--	--	--	--	--	--	--	--	--	--	--
12/30/91	7.73	2.54	5.19	--	--	550	--	--	--	--	--	--	--	--
01/13/92	7.73	3.07	4.65	--	--	--	--	--	--	--	--	--	--	--
01/22/92	7.73	3.03	4.70	--	--	--	--	--	--	--	--	--	--	--
02/12/92	7.73	3.38	4.45	--	--	<50	<50	<0.5	<0.5	<0.5	<0.5	<0.5	--	--
03/09/92	7.73	3.68	4.05	--	--	--	--	--	--	--	--	--	--	--
04/10/92	7.73	3.30	4.43	--	--	--	--	--	--	--	--	--	--	--
05/18/92	7.73	3.94	3.79	--	--	--	390	39	1.9	11	24	--	<5,000	--
01/06/93	7.73	3.39	4.44	Sheen	--	<50	<50	<0.5	<0.5	<0.5	<0.5	<0.5	--	--
02/03/93	7.73	--	--	--	--	--	--	--	--	--	--	--	--	--
04/23/93	10.18	5.86	4.32	--	--	<50	<50	<0.5	<0.5	<0.5	<1.5	<1.5	--	--
07/19/93	10.18	5.15	5.03	--	--	<50	54	<0.5	0.7	<0.5	<1.5	<1.5	--	--
10/19/93	10.18	5.08	5.10	--	--	<50	<50	2.0	4.1	0.6	3.5	3.5	--	--
01/07/94	10.18	5.32	4.86	--	--	<50	<50	<0.5	<0.5	<0.5	<0.5	<0.5	--	--
08/18/94	10.18	5.04	5.14	--	--	<50	<50	<0.5	<0.5	<0.5	<0.5	<0.5	--	--
11/30/94	10.18	5.73	4.45	--	--	140 ¹	<50	<0.5	<0.5	<0.5	<0.5	<0.5	--	--
02/15/95	10.18	6.03	4.15	--	--	170 ¹	<50	<0.5	<0.5	<0.5	<0.5	<0.5	--	--
05/01/95	10.18	5.75	4.43	--	--	190 ³	<50	<0.5	<0.5	<0.5	<0.5	<0.5	--	--
08/04/95	10.18	5.22	4.96	--	--	250 ³	<50	<0.5	<0.5	<0.5	<0.5	<0.5	--	--
11/29/95	10.18	4.97	5.21	--	--	330 ³	140	1.5	<0.5	1.1	<0.5	<0.5	800	--

Table 1
Groundwater Monitoring Data and Analytical Results
Chevron Service Station #9-0290
1802 Webster Street
Alameda, California

WELL ID/ DATE	TOC* (ft.)	GWE (msl)	DTW (ft.)	SPHT (ft.)	SPH REMOVED (gallons)	TPH-D (ppb)	TPH-G (ppb)	B (ppb)	T (ppb)	E (ppb)	X (ppb)	MTBE (ppb)	TOG (ppb)
B-5 (cont)													
02/08/96	10.18	6.38	3.80	--	--	250 ³	<200	2.1	<2.0	<2.0	<2.0	1,100	--
05/08/96	10.18	5.78	4.40	--	--	350 ³	<500	<5.0	<5.0	<5.0	<5.0	1,400	--
08/23/96	10.18	5.19	4.99	--	--	990	250	6.4	2.1	2.1	4.3	9,300	--
12/12/96	10.18	5.90	4.28	--	--	430 ³	<1,000	<10	<10	<10	<10	6,700	--
02/10/97	10.18	6.55	3.63	--	--	340 ³	<500	<5.0	<5.0	<5.0	<5.0	930	--
05/01/97	10.18	5.87	4.31	--	--	290 ³	<500	<5.0	<5.0	<5.0	<5.0	1,900	--
08/05/97	10.18	5.29	4.89	--	--	710 ³	<1,000	<10	<10	<10	<10	6,800	--
10/28/97	10.18	5.18	5.00	--	--	880 ³	<500	<5.0	<5.0	<5.0	<5.0	7,000	--
02/04/98	10.18	7.65	2.53	--	--	290 ³	<50	0.51	<0.5	<0.5	<0.5	2,100	--
06/03/98	10.18	6.33	3.85	--	--	630 ³	220	2.0	15	2.8	20	450	--
07/29/98	10.18	5.63	4.55	--	--	1,100 ³	<50	1.6	<0.5	<0.5	1.6	4,600/6,200 ⁶	--
11/30/98	10.18	5.81	4.37	--	--	371	<50	<0.5	1.91	<0.5	1.09	202	--
02/24/99	10.18	6.79	3.39	--	--	512 ³	<50	<0.5	<0.5	0.69	3.1	25	--
05/06/99	10.18	6.16	4.02	--	--	790 ³	<50	2.27	<0.5	<0.5	<0.5	3,090	--
08/30/99	10.18	5.02	5.16	--	--	1,890 ⁷	<250	4.25	<2.5	<2.5	<2.5	10,400	--
11/17/99	10.18	5.28	4.90	--	--	1,180 ³	101	4.95	<0.5	<0.5	<0.5	8,510	--
02/21/00	10.18	6.67	3.51	--	--	240 ³	<100	<1.0	<1.0	<1.0	<1.0	555	--
05/08/00	10.18	5.88	4.30	0.00	0.00	1,200 ¹²	<50	<0.50	<0.50	<0.50	1.4	270	--
08/08/00	10.18	5.55	4.63	0.00	0.00	350 ¹¹	<1,000	<10	<10	<10	<10	8,600	--
11/01/00	10.18	5.53	4.65	0.00	0.00	470 ¹⁴	<500	<5.0	<5.0	<5.0	11	4,600	--
02/12/01	10.18	6.13	4.05	0.00	0.00	190 ¹²	<50	<0.50	<0.50	<0.50	1.3	420	--
05/14/01	10.18	5.59	4.59	0.00	0.00	<1,000	<500	<5.0	<5.0	<5.0	<5.0	6,800	--
08/13/01	10.18	5.14	5.04	0.00	0.00	2,800	<50	<0.50	<0.50	<0.50	<0.50	11,000	--
11/12/01	10.18	5.88	4.30	0.00	0.00	2,400	100	1.0	<0.50	<0.50	<1.5	2,300	--
02/04/02	10.18	6.03	4.15	0.00	0.00	1,800	99	<0.50	0.63	2.2	14	3,200	--
05/06/02	10.18	5.86	4.32	0.00	0.00	1,700	<50	<0.50	<0.50	<0.50	<1.5	830	--
08/29/02	10.18	5.20	4.98	0.00	0.00	12,000	<250	5.2	<1.0	<1.0	<3.0	18,000	--
11/25/02	10.18	5.26	4.92	0.00	0.00	5,100	100	1.2	<0.50	<0.50	<1.5	4,300	--
02/05/03	10.18	5.98	4.20	0.00	0.00	1,900	<50	<0.50	<0.50	<0.50	<1.5	4,100	--
05/15/03	10.18	5.95	4.23	0.00	0.00	2,600	53	0.8	0.7	<0.5	1.6	5,400	--
08/14/03 ²⁴	10.18	5.17	5.01	0.00	0.00	10,000 ²³	320	<10	<10	<10	<10	15,000	--
11/13/03 ²⁴	-- ²⁵	-- ²⁵	5.05	0.00	0.00	15,000	220	<3	<3	<3	<3	4,700	--
02/12/04 ²⁴	-- ²⁵	-- ²⁵	4.19	0.00	0.00	4,900	120	<5	<5	<5	<5	5,200	--
05/13/04 ²⁴	-- ²⁵	-- ²⁵	4.55	0.00	0.00	3,400 ²³	94	<1	<1	<1	<1	2,000	--
08/12/04 ²⁴	-- ²⁵	-- ²⁵	4.84	0.00	0.00	4,800	150	<0.5	<0.5	<0.5	<0.5	300	--

Table 1
Groundwater Monitoring Data and Analytical Results
Chevron Service Station #9-0290
1802 Webster Street
Alameda, California

WELL ID/ DATE	TOC* (ft.)	GWE (mst)	DTW (ft.)	SPHT (ft.)	SPH		TPH-D (ppb)	TPH-G (ppb)	B (ppb)	T (ppb)	E (ppb)	X (ppb)	MTBE (ppb)	TOG (ppb)
					REMOVED (gallons)									
B-5 (cont)														
11/11/04 ²⁴	-- ²⁵	-- ²⁵	5.35	0.00	0.00	12,000	150	<0.5	<0.5	<0.5	<0.5	<0.5	57	--
02/10/05 ²⁴	-- ²⁵	-- ²⁵	4.04	0.00	0.00	3,500	70	<0.5	<0.5	<0.5	<0.5	<0.5	44	--
05/12/05 ²⁴	-- ²⁵	-- ²⁵	4.11	0.00	0.00	2,900 ²⁶	69	<0.5	<0.5	<0.5	<0.5	<0.5	39	--
08/11/05 ²⁴	-- ²⁵	-- ²⁵	4.62	0.00	0.00	13,000 ²⁸	140	<0.5	<0.5	<0.5	<0.5	<0.5	83	--
11/10/05 ²⁴	-- ²⁵	-- ²⁵	4.71	0.00	0.00	9,500 ²⁷	<50	<0.5	<0.5	<0.5	<0.5	<0.5	16	--
02/09/06 ²⁴	-- ²⁵	-- ²⁵	3.90	0.00	0.00	1,400 ²⁷	61	<0.5	<0.5	<0.5	<0.5	<0.5	27	--
05/11/06 ²⁴	-- ²⁵	-- ²⁵	3.93	0.00	0.00	1,200	<50	<0.5	<0.5	<0.5	<0.5	<0.5	1	--
08/10/06 ²⁴	-- ²⁵	-- ²⁵	4.70	0.00	0.00	9,000	73	<0.5	<0.5	0.5	1	18	--	
11/09/06 ²⁴	-- ²⁵	-- ²⁵	4.83	0.00	0.00	9,200	50	<0.5	<0.5	0.5	<0.5	29	--	
02/08/07 ²⁴	-- ²⁵	-- ²⁵	4.58	0.00	0.00	6,600	56	<0.5	<0.5	<0.5	<0.5	650	--	
05/10/07 ²⁴	-- ²⁵	-- ²⁵	4.47	0.00	0.00	4,500	82	<0.5	<0.5	<0.5	<0.5	52	--	
08/08/07 ²⁴	-- ²⁵	-- ²⁵	4.93	0.00	0.00	13,000	54	<0.5	<0.5	<0.5	<0.5	32	--	
11/07/07 ²⁴	-- ²⁵	-- ²⁵	5.04	0.00	0.00	5,300	<50	<0.5	<0.5	<0.5	<0.5	9	--	
02/13/08 ²⁴	-- ²⁵	-- ²⁵	4.43	0.00	0.00	2,700	<50	<0.5	<0.5	<0.5	<0.5	8	--	
05/14/08²⁴	-- ²⁵	-- ²⁵	4.97	0.00	0.00	4,600	<50	<0.5	<0.5	<0.5	<0.5	<0.5	97	--
B-6														
09/20/91	8.55	1.70	6.85	--	--	<50	<50	<0.5	<0.5	<0.5	<0.5	--	--	--
10/09/91	8.55	1.72	6.83	--	--	--	--	--	--	--	--	--	--	--
10/17/91	8.55	1.65	6.90	--	--	--	--	--	--	--	--	--	--	--
10/23/91	8.55	1.62	6.93	--	--	--	--	--	--	--	--	--	--	--
11/01/91	8.55	1.77	6.78	--	--	--	--	--	--	--	--	--	--	--
11/07/91	8.55	1.74	6.81	--	--	--	--	--	--	--	--	--	--	--
11/15/91	8.55	1.67	6.88	--	--	--	--	--	--	--	--	--	--	--
11/21/91	8.55	1.60	6.95	--	--	--	--	--	--	--	--	--	--	--
12/12/91	8.55	1.41	7.14	--	--	--	--	--	--	--	--	--	--	--
12/30/91	8.55	2.05	6.50	--	--	--	--	--	--	--	--	--	--	--
01/13/92	8.55	2.36	6.19	--	--	--	--	--	--	--	--	--	--	--
01/22/92	8.55	2.28	6.27	--	--	--	--	--	--	--	--	--	--	--
02/12/92	8.55	2.43	6.12	--	--	<50	<50	<0.5	<0.5	<0.5	<0.5	--	--	--
03/09/92	8.55	3.27	5.28	--	--	--	--	--	--	--	--	--	--	--
04/10/92	8.55	3.07	5.48	--	--	--	--	--	--	--	--	--	--	--
05/18/92	8.55	2.65	5.90	--	--	<50	<50	<0.5	<0.5	<0.5	<0.5	--	--	<5,000
01/06/93	8.55	2.76	5.79	--	--	<50	<50	<0.5	<0.5	<0.5	<0.5	--	--	--

Table 1
Groundwater Monitoring Data and Analytical Results
Chevron Service Station #9-0290
1802 Webster Street
Alameda, California

WELL ID/ DATE	TOC* (ft.)	GWE (mst)	DTW (ft.)	SPHT (ft.)	SPH								MTBE (ppb)	TOG (ppb)
					REMOVED (gallons)	TPH-D (ppb)	TPH-G (ppb)	B (ppb)	T (ppb)	E (ppb)	X (ppb)			
B-6 (cont)														
02/03/93	8.55	--	--	--	--	--	--	--	--	--	--	--	--	--
04/23/93	11.97	6.70	5.27	--	--	<50	<50	<0.5	<0.5	<0.5	<1.5	--	--	--
07/19/93	11.97	5.06	6.91	--	--	<50	74	<0.5	<0.5	<0.5	<1.5	--	--	--
10/19/93	11.97	5.49	6.48	--	--	<50	<50	<0.5	0.5	<0.5	2.2	--	--	--
01/07/94	11.97	5.79	6.18	--	--	<50	<50	<0.5	<0.5	<0.5	<0.5	--	--	--
08/18/94	11.97	5.77	6.20	--	--	<50	<50	<0.5	<0.5	<0.5	<0.5	--	--	--
11/30/94	11.97	6.52	5.45	--	--	230 ¹	<50	<0.5	<0.5	<0.5	<0.5	--	--	--
02/15/95	11.97	7.27	4.70	--	--	130 ¹	<50	<0.5	<0.5	<0.5	<0.5	--	--	--
05/01/95	11.97	6.94	5.03	--	--	97 ³	<50	<0.5	<0.5	<0.5	<0.5	--	--	--
08/04/95	11.97	6.15	5.82	--	--	350 ³	<50	<0.5	<0.5	<0.5	<0.5	--	--	--
11/29/95	11.97	5.97	6.00	--	--	200 ³	--	--	--	--	--	--	--	--
02/08/96	11.97	7.27	4.70	--	--	210 ³	--	--	--	--	--	--	--	--
05/08/96	11.97	6.74	5.23	--	--	250 ³	--	--	--	--	--	--	--	--
08/23/96	11.97	5.92	6.05	--	--	310 ³	--	--	--	--	--	--	--	--
12/12/96	11.97	6.65	5.32	--	--	300 ³	--	--	--	--	--	--	--	--
02/10/97	11.97	7.60	4.37	--	--	130 ³	--	--	--	--	--	360	--	--
05/01/97	11.97	6.74	5.23	--	--	260 ³	--	--	--	--	--	2,200	--	--
08/05/97	11.97	6.22	5.75	--	--	260 ³	--	--	--	--	--	1,800	--	--
10/28/97	11.97	5.89	6.08	--	--	340 ³	--	--	--	--	--	1,900	--	--
02/04/98	11.97	9.26	2.71	--	--	280 ³	--	--	--	--	--	1,400	--	--
06/03/98	11.97	7.49	4.48	--	--	130 ³	--	--	--	--	--	1,200	--	--
07/29/98	11.97	6.69	5.28	--	--	340 ³	--	--	--	--	--	2,700/3,000 ⁶	--	--
11/30/98	11.97	6.48	5.49	--	--	2,740	655	<5.0	<5.0	<5.0	<5.0	2,160	--	--
02/24/99	11.97	7.79	4.18	--	--	225 ³	--	--	--	--	--	1,500	--	--
05/06/99	11.97	6.29	5.68	--	--	71 ³	--	--	--	--	--	1,010	--	--
08/30/99	11.97	6.06	5.91	--	--	356 ³	--	--	--	--	--	4,520	--	--
11/17/99	11.97	6.01	5.96	--	--	1,960 ³	--	--	--	--	--	5,160	--	--
02/21/00	11.97	7.51	4.46	--	--	180 ³	--	--	--	--	--	6,920	--	--
05/08/00	11.97	6.92	5.05	0.00	0.00	420 ¹¹	--	--	--	--	--	6,800	--	--
08/08/00	11.97	6.55	5.42	0.00	0.00	180 ¹¹	--	--	--	--	--	25,000	--	--
11/01/00	11.97	6.24	5.73	0.00	0.00	77 ¹⁴	--	--	--	--	--	25,000	--	--
02/12/01	11.97	6.65	5.32	0.00	0.00	62 ¹¹	--	--	--	--	--	16,000	--	--
05/14/01	11.97	6.62	5.35	0.00	0.00	55 ¹²	--	--	--	--	--	9,100	--	--
08/13/01	11.97	6.05	5.92	0.00	0.00	220	--	--	--	--	--	33,000	--	--
11/12/01	11.97	5.63	6.34	0.00	0.00	550	--	--	--	--	--	34,000 ¹⁹	--	--

Table 1
Groundwater Monitoring Data and Analytical Results
Chevron Service Station #9-0290
1802 Webster Street
Alameda, California

WELL ID/ DATE	TOC* (ft.)	GWE (msl)	DTW (ft.)	SPHT (ft.)	SPH							MTBE (ppb)	TOG (ppb)
					REMOVED (gallons)	TPH-D (ppb)	TPH-G (ppb)	B (ppb)	T (ppb)	E (ppb)	X (ppb)		
B-6 (cont)													
02/04/02	11.97	7.16	4.81	0.00	0.00	290	--	--	--	--	--	28,000	--
05/06/02	11.97	6.94	5.03	0.00	0.00	270	--	--	--	--	--	23,000	--
08/29/02	11.97	6.29	5.68	0.00	0.00	490	--	--	--	--	--	29,000	--
11/25/02	11.97	6.08	5.89	0.00	0.00	450	--	--	--	--	--	30,000	--
02/05/03	11.97	6.99	4.98	0.00	0.00	260	--	--	--	--	--	17,000	--
05/15/03	11.97	7.04	4.93	0.00	0.00	310	--	--	--	--	--	28,000	--
08/14/03	11.97	6.32	5.65	0.00	0.00	160 ²³	--	--	--	--	--	31,000	--
11/13/03	-- ²⁵	-- ²⁵	5.90	0.00	0.00	190	--	--	--	--	--	20,000	--
02/12/04	-- ²⁵	-- ²⁵	4.79	0.00	0.00	400	--	--	--	--	--	31,000	--
05/13/04	-- ²⁵	-- ²⁵	4.97	0.00	0.00	54 ²³	--	--	--	--	--	13,000	--
08/12/04	-- ²⁵	-- ²⁵	5.56	0.00	0.00	250	--	--	--	--	--	26,000	--
11/11/04	-- ²⁵	-- ²⁵	5.97	0.00	0.00	250	460	--	--	--	--	20,000	--
02/10/05	-- ²⁵	-- ²⁵	4.67	0.00	0.00	280	--	--	--	--	--	10,000	--
05/12/05 ²⁴	-- ²⁵	-- ²⁵	4.61	0.00	0.00	210 ²⁶	340	<10	<10	<10	<10	15,000	--
08/11/05	-- ²⁵	-- ²⁵	5.32	0.00	0.00	130 ²⁷	--	--	--	--	--	12,000 ²⁹	--
11/10/05	-- ²⁵	-- ²⁵	5.41	0.00	0.00	100 ²⁷	--	<0.5	<0.5	<0.5	<1.5	9,300	--
02/09/06	-- ²⁵	-- ²⁵	4.50	0.00	0.00	290 ³¹	--	--	--	--	--	2,200	--
05/11/06	-- ²⁵	-- ²⁵	4.70	0.00	0.00	<50	--	--	--	--	--	1,000	--
08/10/06	-- ²⁵	-- ²⁵	5.42	0.00	0.00	150	--	--	--	--	--	4,300	--
11/09/06 ²⁴	-- ²⁵	-- ²⁵	5.80	0.00	0.00	240	--	<2.0	<0.5	<0.5	<1.5	2,200	--
02/08/07	-- ²⁵	-- ²⁵	5.48	0.00	0.00	140	--	--	--	--	--	1,300	--
05/10/07	-- ²⁵	-- ²⁵	5.17	0.00	0.00	120	--	<0.5	<0.5	<0.5	<0.5	1,500	--
08/08/07	-- ²⁵	-- ²⁵	5.80	0.00	0.00	73	--	--	--	--	--	1,300	--
11/07/07	-- ²⁵	-- ²⁵	5.98	0.00	0.00	120	--	--	--	--	--	100 ³⁰	--
02/13/08	-- ²⁵	-- ²⁵	4.59	0.00	0.00	130	--	--	--	--	--	33	--
05/14/08	-- ²⁵	-- ²⁵	5.36	0.00	0.00	94	--	--	--	--	--	680	--
B-7													
04/23/93	10.54	6.02	4.52	--	--	--	<50	<0.5	<0.5	<0.5	<1.5	--	<50
07/19/93	10.54	5.50	5.04	--	--	--	<50	<0.5	<0.5	<0.5	<1.5	--	<50
10/19/93	10.54	5.14	5.40	--	--	--	<50	<50	3.1	0.5	<0.5	0.8	--
01/07/94	10.54	5.35	5.19	--	--	--	<50	<50	<0.5	<0.5	<0.5	<0.5	--
08/18/94	10.54	5.28	5.26	--	--	--	<50	<50	<0.5	<0.5	<0.5	1.1	--
11/30/94	10.54	5.96	4.58	--	--	--	<50	<50	<0.5	<0.5	<0.5	--	--

Table 1
Groundwater Monitoring Data and Analytical Results
Chevron Service Station #9-0290
1802 Webster Street
Alameda, California

WELL ID/ DATE	TOC* (ft.)	GWE (msl)	DTW (ft.)	SPH		TPH-D (ppb)	TPH-G (ppb)	B (ppb)	T (ppb)	E (ppb)	X (ppb)	MTBE (ppb)	TOG (ppb)
				SPHT (ft.)	REMOVED (gallons)								
B-7 (cont)													
02/15/95	10.54	6.32	4.22	--	--	<50	<50	<0.5	<0.5	<0.5	<0.5	--	--
05/01/95	10.54	6.04	4.50	--	--	53 ³	<50	<0.5	<0.5	<0.5	<0.5	--	--
08/04/95	10.54	5.56	4.98	--	--	<50	<50	<0.5	<0.5	<0.5	<0.5	--	--
02/12/98	10.54	7.49	3.05	--	--	<50	<50	<0.5	<0.5	<0.5	<0.5	--	--
06/03/98	10.54	6.59	3.95	--	--	SAMPLED SEMI-ANNUALLY		--	--	--	--	--	--
07/29/98	10.54	5.99	4.55	--	--	--	<50	<0.5	<0.5	<0.5	<0.5	<2.5	--
11/30/98	10.54	5.56	4.98	--	--	--	--	--	--	--	--	--	--
02/24/99	10.54	7.24	3.30	--	--	--	<50	<0.5	<0.5	<0.5	<0.5	<2.5	--
05/06/99	10.54	4.79	5.75	--	--	--	--	--	--	--	--	--	--
08/30/99	10.54	5.25	5.29	--	--	--	<50	<0.5	<0.5	<0.5	<0.5	<2.5	--
11/17/99	10.54	4.81	5.73	--	--	--	--	--	--	--	--	--	--
02/21/00	10.54	6.54	4.00	--	--	--	<50	<0.5	<0.5	<0.5	<0.5	<2.5	--
05/08/00	10.54	6.14	4.40	0.00	0.00	--	--	--	--	--	--	--	--
08/08/00	10.54	6.05	4.49	0.00	0.00	--	<50	<0.50	<0.50	<0.50	<0.50	<2.5	--
11/01/00	10.54	5.85	4.69	0.00	0.00	--	--	--	--	--	--	--	--
02/12/01	10.54	6.17	4.37	0.00	0.00	--	<50	<0.50	<0.50	<0.50	<0.50	<2.5	--
05/14/01	10.54	6.09	4.45	SAMPLED SEMI-ANNUALLY		--	--	--	--	--	--	--	--
08/13/01	10.54	5.61	4.93	0.00	0.00	--	<50	<0.50	<0.50	<0.50	<0.50	<2.5	--
11/12/01	10.54	5.27	5.27	0.00	0.00	SAMPLED SEMI-ANNUALLY		--	--	--	--	--	--
02/04/02	10.54	6.43	4.11	0.00	0.00	--	<50	<0.50	<0.50	<0.50	<1.5	<2.5	--
05/06/02	10.54	6.28	4.26	0.00	0.00	SAMPLED SEMI-ANNUALLY		--	--	--	--	--	--
08/29/02	10.54	5.76	4.78	0.00	0.00	--	<50	<0.50	<0.50	<0.50	1.8	<2.5	--
11/25/02	10.54	5.61	4.93	0.00	0.00	SAMPLED SEMI-ANNUALLY		--	--	--	--	--	--
02/05/03	10.54	6.43	4.11	0.00	0.00	--	<50	<0.50	<0.50	<0.50	<1.5	<2.5	--
05/15/03	10.54	6.45	4.09	0.00	0.00	SAMPLED SEMI-ANNUALLY		--	--	--	--	--	--
08/14/03 ²⁴	10.54	5.76	4.78	0.00	0.00	--	<50	<0.5	<0.5	<0.5	<0.5	<0.5	--
11/13/03	10.54	5.85	4.69	0.00	0.00	SAMPLED SEMI-ANNUALLY		--	--	--	--	--	--
02/12/04 ²⁴	10.54	6.39	4.15	0.00	0.00	--	<50	<0.5	<0.5	<0.5	<0.5	<0.5	--
05/13/04	10.54	6.24	4.30	0.00	0.00	<50 ²³	--	--	--	--	--	--	--
08/12/04 ²⁴	10.54	5.78	4.76	0.00	0.00	--	<50	<0.5	<0.5	<0.5	<0.5	<0.5	--
11/11/04	10.54	5.36	5.18	0.00	0.00	SAMPLED SEMI-ANNUALLY		--	--	--	--	--	--
02/10/05 ²⁴	10.54	6.58	3.96	0.00	0.00	--	<50	<0.5	<0.5	<0.5	<0.5	<0.5	--
05/12/05	10.54	6.67	3.87	0.00	0.00	SAMPLED SEMI-ANNUALLY		--	--	--	--	--	--
08/11/05 ²⁴	10.54	6.05	4.49	0.00	0.00	--	<50	<0.5	<0.5	<0.5	<0.5	<0.5	--
11/10/05	10.54	6.03	4.51	0.00	0.00	SAMPLED SEMI-ANNUALLY		--	--	--	--	--	--

Table 1
Groundwater Monitoring Data and Analytical Results
Chevron Service Station #9-0290
1802 Webster Street
Alameda, California

WELL ID/ DATE	TOC* (ft.)	GWE (mst)	DTW (ft.)	SPHT (ft.)	SPH		TPH-D (ppb)	TPH-G (ppb)	B (ppb)	T (ppb)	E (ppb)	X (ppb)	MTBE (ppb)	TOG (ppb)
					REMOVED (gallons)									
B-7 (cont)														
02/09/06 ²⁴	10.54	6.79	3.75	0.00	0.00	--	<50	<0.5	<0.5	<0.5	<0.5	<0.5	<0.5	--
05/11/06	10.54	6.82	3.72	0.00	0.00	SAMPLED SEMI-ANNUALLY		--	--	--	--	--	--	--
08/10/06 ²⁴	10.54	5.71	4.83	0.00	0.00	--	<50	<0.5	<0.5	<0.5	<0.5	<0.5	<0.5	--
11/09/06	10.54	5.42	5.12	0.00	0.00	SAMPLED SEMI-ANNUALLY		--	--	--	--	--	--	--
02/08/07 ²⁴	10.54	5.73	4.81	0.00	0.00	--	<50	<0.5	<0.5	<0.5	<0.5	<0.5	<0.5	--
05/10/07	10.54	5.89	4.65	0.00	0.00	SAMPLED SEMI-ANNUALLY		--	--	--	--	--	--	--
08/08/07 ²⁴	10.54	5.58	4.96	0.00	0.00	--	<50	<0.5	<0.5	<0.5	<0.5	<0.5	<0.5	--
11/07/07	10.54	5.33	5.21	0.00	0.00	SAMPLED SEMI-ANNUALLY		--	--	--	--	--	--	--
02/13/08 ²⁴	10.54	6.51	4.03	0.00	0.00	--	<50	<0.5	<0.5	<0.5	<0.5	<0.5	<0.5	--
05/14/08	10.54	6.08	4.46	0.00	0.00	SAMPLED SEMI-ANNUALLY		--	--	--	--	--	--	--
B-10														
11/29/95	11.42	4.91	6.51	--	--	900 ³	1,700	95	<2.5	69	170	22	--	--
02/08/96	11.42	6.87	4.55	--	--	650 ³	230	31	<0.5	7.2	6.2	10	--	--
05/08/96	11.42	5.87	5.55	--	--	570 ³	260	61	0.59	37	23	20	--	--
08/23/96	11.42	5.23	6.19	--	--	700 ³	320	34	<0.5	29	15	8.3	--	--
12/12/96	11.42	5.59	5.83	--	--	990 ³	1,600	94	<2.5	110	27	<12	--	--
02/10/97	11.42	6.84	4.58	--	--	530 ³	2,100	230	5.6	130	83	<12	--	--
05/01/97	11.42	5.85	5.57	--	--	770 ³	2,300	110	<2.5	140	49	<12	--	--
08/05/97	11.42	5.12	6.30	--	--	620 ³	650	33	1.1	70	16	3.2	--	--
10/28/97	11.42	5.24	6.18	--	--	310 ³	740	25	1.6	53	14	6.7	--	--
02/04/98	11.42	8.53	2.89	--	--	250 ³	950	23	4.5	<0.5	1.9	<2.5	--	--
06/03/98	11.42	6.62	4.80	--	--	490 ³	<50	<0.5	<0.5	<0.5	<0.5	<2.5	--	--
07/29/98	11.42	5.77	5.65	--	--	390 ³	290	3.9	<0.5	8.5	1.4	<2.5	--	--
11/30/98	11.42	5.80	5.62	--	--	437	<50	<0.5	<0.5	<0.5	<0.5	7.11	--	--
02/24/99	11.42	7.19	4.23	--	--	259 ³	160	35	0.55	0.64	0.64	9.2	--	--
05/06/99	11.42	6.31	5.11	--	--	190 ³	490	7.05	1.02	8.24	2.18	<5.0	--	--
08/30/99	11.42	5.06	6.36	--	--	330 ³	205	1.79	0.808	5.55	2.16	3.93	--	--
11/17/99	11.42	5.48	5.94	--	--	2,180 ³	108	1.2	<0.5	1.2	<0.5	<2.5	--	--
02/21/00	11.42	7.07	4.35	--	--	360 ³	587	17.6	2.92	10.1	4.61	5.08	--	--
05/08/00	11.42	5.99	5.43	0.00	0.00	320 ¹¹	380 ⁹	5.4	2.6	3.2	6.3	9.1	--	--
08/08/00	11.42	DRY	--	--	--	--	--	--	--	--	--	--	--	--
11/01/00	11.42	DRY	--	--	--	--	--	--	--	--	--	--	--	--
02/12/01 ¹⁶	NP	6.09	5.33	0.00	0.00	--	--	--	--	--	--	--	--	--

Table 1
Groundwater Monitoring Data and Analytical Results
Chevron Service Station #9-0290
1802 Webster Street
Alameda, California

WELL ID/ DATE	TOC* (ft.)	GWE (msl)	DTW (ft.)	SPHT (ft.)	SPH REMOVED (gallons)	TPH-D (ppb)	TPH-G (ppb)	B (ppb)	T (ppb)	E (ppb)	X (ppb)	MTBE (ppb)	TOG (ppb)
B-10 (cont)													
05/14/01 ¹⁶	11.42	OBSTRUCTION IN WELL			--	--	--	--	--	--	--	--	--
08/13/01 ¹⁶	11.42	OBSTRUCTION IN WELL			--	--	--	--	--	--	--	--	--
11/12/01 ¹⁶	11.42	OBSTRUCTION IN WELL			--	--	--	--	--	--	--	--	--
02/04/02 ²⁰	11.42	6.18	5.24	0.00	0.00	340	100	1.8	<0.50	0.57	<1.5	18	--
05/06/02	11.42	6.00	5.42	0.00	0.00	1,000	86	1.4	<0.50	<0.50	<1.5	17	--
08/29/02	11.42	4.79	6.63	0.00	0.00	650	120	<0.50	<0.50	<0.50	<1.5	38	--
11/25/02	11.42	5.32	6.10	0.00	0.00	1,200	77	<0.50	<0.50	<0.50	<1.5	40	--
02/05/03	11.42	6.19	5.23	0.00	0.00	650	190	<2.0	<0.50	<0.50	<1.5	30	--
05/15/03	11.42	6.16	5.26	0.00	0.00	750	150	1.2	<0.5	<0.5	<1.5	30	--
08/14/03 ²⁴	11.42	5.03	6.39	0.00	0.00	230 ²³	<50	<0.5	<0.5	<0.5	<0.5	38	--
11/13/03 ²⁴	11.42	5.17	6.25	0.00	0.00	1,000	<50	<0.5	<0.5	<0.5	<0.5	52	--
02/12/04 ²⁴	11.42	6.32	5.10	0.00	0.00	810	<50	<0.5	<0.5	<0.5	<0.5	30	--
05/13/04 ²⁴	11.42	5.75	5.67	0.00	0.00	71 ²³	<50	<0.5	<0.5	<0.5	<0.5	33	--
08/12/04 ²⁴	11.42	5.12	6.30	0.00	0.00	460	<50	<0.5	<0.5	<0.5	<0.5	30	--
11/11/04 ²⁴	11.42	4.65	6.77	0.00	0.00	350	<50	<0.5	<0.5	<0.5	<0.5	30	--
02/10/05 ²⁴	11.42	6.60	4.82	0.00	0.00	580	<50	<0.5	<0.5	<0.5	<0.5	27	--
05/12/05 ²⁴	11.42	6.38	5.04	0.00	0.00	160 ²⁶	<50	<0.5	<0.5	<0.5	<0.5	21	--
08/11/05 ²⁴	11.42	5.70	5.72	0.00	0.00	130 ²⁷	<50	<0.5	<0.5	<0.5	<0.5	18	--
11/10/05 ²⁴	11.42	5.90	5.52	0.00	0.00	89 ²⁷	<50	<0.5	<0.5	<0.5	<0.5	22	--
02/09/06 ²⁴	11.42	6.78	4.64	0.00	0.00	320 ²⁷	81	<0.5	<0.5	<0.5	<0.5	16	--
05/11/06 ²⁴	11.42	6.44	4.98	0.00	0.00	430	180	<0.5	<0.5	<0.5	0.5	19	--
08/10/06 ²⁴	11.42	5.64	5.78	0.00	0.00	210	<50	<0.5	<0.5	0.6	<0.5	12	--
11/09/06 ²⁴	11.42	5.33	6.09	0.00	0.00	980	<50	<0.5	<0.5	<0.5	<0.5	11	--
02/08/07 ²⁴	11.42	5.77	5.65	0.00	0.00	340	<50	<0.5	<0.5	<0.5	<0.5	13	--
05/10/07 ²⁴	11.42	5.91	5.51	0.00	0.00	90	<50	<0.5	<0.5	<0.5	<0.5	10	--
08/08/07 ²⁴	11.42	5.39	6.03	0.00	0.00	120	<50	<0.5	<0.5	<0.5	<0.5	7	--
11/07/07 ²⁴	11.42	5.12	6.30	0.00	0.00	250	<50	<0.5	<0.5	<0.5	<0.5	7	--
02/13/08 ²⁴	11.42	6.71	4.71	0.00	0.00	510	<50	<0.5	<0.5	<0.5	<0.5	4	--
05/14/08 ²⁴	11.42	5.74	5.68	0.00	0.00	140	<50	<0.5	<0.5	<0.5	<0.5	6	--
B-11													
11/29/95	11.98	6.08	5.90	--	--	1,400 ³	2,800	38	<10	26	48	21,000	--
02/08/96	11.98	7.54	4.44	--	--	1,100 ³	<5,000	<50	<50	<50	<50	38,000	--
05/08/96	11.98	6.98	5.00	--	--	1,300 ³	4,100	110	<10	31	25	17,000	--

Table 1
Groundwater Monitoring Data and Analytical Results
Chevron Service Station #9-0290
1802 Webster Street
Alameda, California

WELL ID/ DATE	TOC* (ft.)	GWE (mst)	DTW (ft.)	SPHT (ft.)	SPH		TPH-D (ppb)	TPH-G (ppb)	B (ppb)	T (ppb)	E (ppb)	X (ppb)	MTBE (ppb)	TOG (ppb)
					REMOVED (gallons)									
B-11 (cont)														
08/23/96	11.98	6.37	5.61	--	--		820 ³	3,400	160	12	41	13	4,000	--
12/12/96	11.98	6.85	5.13	--	--		1,300 ³	3,700	120	12	<5.0	30	2,200	--
02/10/97	11.98	7.91	4.07	--	--		810 ³	2,300	56	17	<5.0	20	4,700	--
05/01/97	11.98	6.95	5.03	--	--		820 ³	<5,000	<50	<50	<50	<50	21,000	--
08/05/97	11.98	6.38	5.60	--	--		900 ³	3,500	42	<10	<10	<10	4,100	--
10/28/97	11.98	6.30	5.68	--	--		1,300 ³	3,000	39	6.2	8.0	13	2,300	--
02/04/98	11.98	9.39	2.59	--	--		930 ³	1,300	3.2	1.4	<0.5	5.0	46,000	--
06/03/98	11.98	7.53	4.45	--	--		740 ³	860	3.7	1.4	0.84	3.0	34,000	--
07/29/98	11.98	6.80	5.18	--	--		1,400 ³	1,300	6.9	2.5	3.8	2.0	50,000/41,000 ⁶	--
11/30/98	11.98	6.91	5.07	--	--		1,020	<1,000	<10	<10	<10	<10	5,370	--
02/24/99	11.98	7.79	4.19	--	--		2,290 ³	690	4.7	<0.5	2.7	3.1	67,000	--
05/06/99	11.98	7.43	4.55	--	--		580 ³	423	4.66	0.662	<0.5	1.38	20,600	--
08/30/99	11.98	6.18	5.80	--	--		1,120 ³	1,220	31	8.6	<5.0	14	10,900	--
11/17/99	11.98	6.41	5.57	--	--		1,160 ³	2,800	36.6	10.6	8.41	11.6	12,000	--
02/21/00	11.98	7.77	4.21	--	--		730 ³	1,570	12.3	2.71	3.33	12.9	2,980	--
05/08/00	11.98	7.04	4.94	0.00	0.00		220 ¹³	<500	<5.0	<5.0	<5.0	<5.0	8,500	--
08/08/00	11.98	6.79	5.19	0.00	0.00		660 ¹³	2,900 ¹⁰	51	<25	<25	38	10,000	--
11/01/00	11.98	6.72	5.26	0.00	0.00		290 ¹¹	<5,000	<50	<50	<50	<50	29,000	--
02/12/01	11.98	7.24	4.74	0.00	0.00		660 ¹³	1,700 ¹⁰	38	11	11	22	7,800	--
05/14/01	11.98	6.84	5.14	0.00	0.00		430 ¹³	1,200 ¹⁰	29	11	<10	<10	35,000	--
08/13/01	11.98	6.33	5.65	0.00	0.00		910	<5,000	<50	<50	<50	<50	140,000 ¹⁸	--
11/12/01	11.98	6.32	5.66	0.00	0.00		1,400	3,100	14	6.1	8.7	23	6,100	--
02/04/02	11.98	7.25	4.73	0.00	0.00		650	1,400	5.6	1.8	2.5	9.3	7,800	--
05/06/02	11.98	7.10	4.88	0.00	0.00		880	480	1.2	0.64	1.3	1.9	1,400	--
08/29/02	11.98	6.44	5.54	0.00	0.00		3,500	1,500	5.4	1.9	2.2	5.8	96,000	--
11/25/02	11.98	6.44	5.54	0.00	0.00		3,700	1,200	2.7	1.0	1.4	7.0	45,000	--
02/05/03	11.98	7.18	4.80	0.00	0.00		2,100	910	2.7	<2.5	<2.5	<7.5	46,000	--
05/15/03	11.98	7.18	4.80	0.00	0.00		2,500	1,100	5.4	<2.5	4.5	11	78,000	--
08/14/03 ²⁴	11.98	6.45	5.53	0.00	0.00		3,600 ²³	840	<50	<50	<50	<50	88,000	--
11/13/03 ²⁴	11.98	6.37	5.61	0.00	0.00		2,300	570	<10	<10	<10	<10	14,000	--
02/12/04 ²⁴	11.98	7.28	4.70	0.00	0.00		4,400	310	<25	<25	<25	<25	29,000	--
05/13/04 ²⁴	11.98	6.95	5.03	0.00	0.00		410 ²³	480	<13	<13	<13	<13	100,000	--
08/12/04 ²⁴	11.98	6.56	5.42	0.00	0.00		3,600	850	<10	<10	<10	<10	83,000	--
11/11/04 ²⁴	11.98	6.05	5.93	0.00	0.00		3,100	570	<10	<10	<10	<10	20,000	--
02/10/05 ²⁴	11.98	7.42	4.56	0.00	0.00		12,000	320	<25	<25	<25	<25	49,000	--

Table 1
Groundwater Monitoring Data and Analytical Results
Chevron Service Station #9-0290
1802 Webster Street
Alameda, California

WELL ID/ DATE	TOC* (ft.)	GWE (mst)	DTW (ft.)	SPH									MTBE (ppb)	TOG (ppb)
				SPHT (ft.)	REMOVED (gallons)	TPH-D (ppb)	TPH-G (ppb)	B (ppb)	T (ppb)	E (ppb)	X (ppb)			
B-11 (cont)														
05/12/05 ²⁴	11.98	7.40	4.58	0.00	0.00	1,900 ²⁶	400	<25	<25	<25	<25	42,000	--	
08/11/05 ²⁴	11.98	6.82	5.16	0.00	0.00	12,000 ²⁸	320	<25	<25	<25	<25	36,000	--	
11/10/05 ²⁴	11.98	6.90	5.08	0.00	0.00	1,200 ²⁷	57	<0.5	<0.5	<0.5	<0.5	1,400	--	
02/09/06 ²⁴	11.98	7.62	4.36	0.00	0.00	310 ²⁷	70	<3	<3	<3	<3	10,000	--	
05/11/06 ²⁴	11.98	7.39	4.59	0.00	0.00	740	250	<5	<5	<5	<5	19,000	--	
08/10/06 ²⁴	11.98	5.89	6.09	0.00	0.00	6,600	2,000	<25	<25	<25	<25	94,000	--	
11/09/06 ²⁴	11.98	6.47	5.51	0.00	0.00	10,000	620	<3	<3	<3	<3	9,900	--	
02/08/07 ²⁴	11.98	6.76	5.22	0.00	0.00	5,100	1,000	<10	<10	<10	<10	47,000	--	
05/10/07 ²⁴	11.98	6.89	5.09	0.00	0.00	3,500	1,700	<5	<5	<5	<5	38,000	--	
08/08/07 ²⁴	11.98	6.43	5.55	0.00	0.00	9,800	730	<25	<25	<25	<25	50,000	--	
11/07/07 ²⁴	11.98	6.16	5.82	0.00	0.00	1,700	340	<0.5	<0.5	<0.5	1	680 ³⁰	--	
02/13/08 ²⁴	11.98	7.50	4.48	0.00	0.00	3,100	760	<3	<3	<3	<3	24,000	--	
05/14/08²⁴	11.98	6.76	5.22	0.00	0.00	10,000	750	<10	<10	<10	<10	38,000	--	
B-12														
11/29/95	11.16	5.15	6.01	--	--	1,800 ³	1,100	10	<10	<10	<10	37,000	--	
02/08/96	11.16	6.56	4.60	--	--	1,800 ³	<20,000	<200	<200	<200	<200	88,000	--	
05/08/96	11.16	6.08	5.08	--	--	1,800 ³	<25,000	<250	<250	<250	<250	88,000	--	
08/23/96	11.16	5.51	5.65	--	--	1,500 ³	630	16	<5.0	<5.0	<5.0	420	--	
12/12/96	11.16	6.05	5.11	--	--	1,200 ³	<25,000	<250	<250	<250	<250	54,000	--	
02/10/97	11.16	7.05	4.11	--	--	1,200 ³	<20,000	<200	<200	<200	<200	65,000	--	
02/10/97 ⁵	11.16	7.05	4.11	--	--	--	--	<500	<500	<500	<500	--	--	
05/01/97	11.16	6.17	4.99	--	--	1,100 ³	<12,500	<125	<125	<125	<125	64,000	--	
08/05/97	11.16	5.55	5.61	--	--	1,100 ³	<10,000	<100	<100	<100	<100	46,000	--	
10/28/97	11.16	5.40	5.76	--	--	1,100 ³	1,400	39	<5.0	7.2	6.0	29,000	--	
02/04/98	11.16	8.53	2.63	--	--	4,800 ³	920	6.9	1.1	<0.5	2.8	59,000	--	
06/03/98	11.16	6.71	4.45	--	--	2,000 ³	590	9.4	<0.5	0.93	<0.5	15,000	--	
07/29/98	11.16	5.91	5.25	--	--	2,200 ³	820	5.6	2.0	3.3	1.2	28,000/33,000 ⁶	--	
11/30/98	11.16	6.03	5.13	--	--	1,060	2,110	<10	<10	<10	<10	5,330	--	
02/24/99	11.16	7.16	4.00	--	--	2,680 ³	410	0.64	<0.5	2.2	2.3	15,000	--	
05/06/99	11.16	6.71	4.45	--	--	3,550 ³	<500	<5.0	<5.0	<5.0	<5.0	1370	<1,000	
08/30/99	11.16	5.32	5.84	--	--	1,310 ³	985	12.5	6.0	9.5	10.8	6600	--	
11/17/99	11.16	5.73	5.43	--	--	1,060 ³	1,700	14.4	5.99	5.98	<5.0	14,200	--	
02/21/00	11.16	6.85	4.31	--	--	430 ³	595	3.49	<0.5	<0.5	4.26	5,100	--	

Table 1
Groundwater Monitoring Data and Analytical Results
Chevron Service Station #9-0290
1802 Webster Street
Alameda, California

WELL ID/ DATE	TOC* (ft.)	GWE (msl)	DTW (ft.)	SPHT (ft.)	SPH REMOVED (gallons)	TPH-D (ppb)	TPH-G (ppb)	B (ppb)	T (ppb)	E (ppb)	X (ppb)	MTBE (ppb)	TOG (ppb)
B-12 (cont)													
05/08/00	11.16	6.21	4.95	0.00	0.00	340 ¹³	<500	<5.0	<5.0	<5.0	<5.0	2,100	--
08/08/00	11.16	6.01	5.15	0.00	0.00	260 ¹³	410 ¹⁰	3.9	1.5	1.8	4.8	2,000	--
11/01/00	11.16	5.85	5.31	0.00	0.00	130 ¹¹	660 ⁹	6.0	1.9	2.8	2.9	4,600	--
02/12/01	11.16	6.27	4.89	0.00	0.00	280 ¹¹	550 ¹⁰	14	<5.0	5.0	<5.0	2,000	--
05/14/01	11.16	6.05	5.11	0.00	0.00	280 ¹³	770 ¹⁰	7.6	5.0	0.80	4.8	1,400	--
08/13/01	11.16	5.52	5.64	0.00	0.00	500	730 ¹⁰	10	<5.0	6.1	<5.0	2,700	--
11/12/01	11.16	5.40	5.76	0.00	0.00	900	1,700	2.2	1.1	7.6	9.2	1,400	--
02/04/02	11.16	6.45	4.71	0.00	0.00	440	1,100	2.0	1.0	2.0	2.8	310	--
05/06/02	11.16	6.28	4.88	0.00	0.00	340	660	<1.0	<1.0	<1.0	<1.0	96	--
08/29/02	11.16	5.67	5.49	0.00	0.00	1,000	1,700	5.6	3.9	4.2	<15	530	--
11/25/02	11.16	5.58	5.58	0.00	0.00	890	2,300	<5.0	1.8	3.5	<10	320	--
02/05/03	11.16	6.40	4.76	0.00	0.00	770	1,600	<10	<2.5	<2.5	<7.5	270	--
05/15/03	11.16	6.40	4.76	0.00	0.00	1,500	1,800	<2.5	<2.5	2.6	<7.5	280	--
08/14/03 ²⁴	11.16	5.68	5.48	0.00	0.00	1,000 ²³	2,000	1	0.7	0.9	2	300	--
11/13/03 ²⁴	11.16	5.48	5.68	0.00	0.00	390	790	<0.5	<0.5	1	1	36	--
02/12/04 ²⁴	11.16	6.44	4.72	0.00	0.00	210	94	<0.5	<0.5	<0.5	<0.5	8	--
05/13/04 ²⁴	11.16	6.24	4.92	0.00	0.00	60 ²³	<50	<0.5	<0.5	<0.5	<0.5	2	--
08/12/04 ²⁴	11.16	5.75	5.41	0.00	0.00	130	290	<0.5	<0.5	<0.5	<0.5	61	--
11/11/04 ²⁴	11.16	5.26	5.90	0.00	0.00	160	180	<0.5	<0.5	<0.5	<0.5	5	--
02/10/05 ²⁴	11.16	6.62	4.54	0.00	0.00	130	<50	<0.5	<0.5	<0.5	<0.5	5	--
05/12/05 ²⁴	11.16	6.59	4.57	0.00	0.00	150	160	<0.5	<0.5	<0.5	<0.5	5	--
08/11/05 ²⁴	11.16	6.02	5.14	0.00	0.00	110	89	<0.5	<0.5	<0.5	<0.5	11	--
11/10/05 ²⁴	11.16	6.05	5.11	0.00	0.00	<50	<50	<0.5	<0.5	<0.5	<0.5	5	--
02/09/06 ²⁴	11.16	6.78	4.38	0.00	0.00	240 ²⁷	<50	<0.5	<0.5	<0.5	<0.5	2	--
05/11/06 ²⁴	11.16	6.59	4.57	0.00	0.00	100	250	<0.5	<0.5	<0.5	<0.5	3	--
08/10/06 ²⁴	11.16	5.84	5.32	0.00	0.00	1,300	470	<0.5	<0.5	<0.5	0.6	20	--
11/09/06 ²⁴	11.16	5.58	5.58	0.00	0.00	580	1,300	<0.5	<0.5	<0.5	0.5	17	--
02/08/07 ²⁴	11.16	5.86	5.30	0.00	0.00	97	<50	<0.5	<0.5	<0.5	<0.5	1	--
05/10/07 ²⁴	11.16	6.08	5.08	0.00	0.00	100	<50	<0.5	<0.5	<0.5	<0.5	1	--
08/08/07 ²⁴	11.16	5.56	5.60	0.00	0.00	480	1,300	0.9	<0.5	<0.5	0.9	45	--
11/07/07 ²⁴	11.16	5.45	5.71	0.00	0.00	150	180	<0.5	<0.5	<0.5	<0.5	4	--
02/13/08 ²⁴	11.16	6.71	4.45	0.00	0.00	290	59	<0.5	<0.5	<0.5	<0.5	2	--
05/14/08 ²⁴	11.16	5.96	5.20	0.00	0.00	100	140	<0.5	<0.5	<0.5	<0.5	2	--

Table 1
Groundwater Monitoring Data and Analytical Results
Chevron Service Station #9-0290
1802 Webster Street
Alameda, California

WELL ID/ DATE	TOC* (ft.)	GWE (msl)	DTW (ft.)	SPHT (ft.)	SPH REMOVED (gallons)	TPH-D (ppb)	TPH-G (ppb)	B (ppb)	T (ppb)	E (ppb)	X (ppb)	MTBE (ppb)	TOG (ppb)
B-13													
11/29/95	11.17	5.26	5.91	--	--	3,400 ³	1,800	19	<5.0	5.5	<5.0	7,400	--
02/08/96	11.17	6.72	4.45	--	--	450 ³	910	12	1.3	2.0	1.9	77	--
05/08/96	11.17	6.20	4.97	--	--	560 ³	140	1.9	<0.5	0.88	2.0	98	--
08/23/96	11.17	5.54	5.63	--	--	1,300 ³	1,300	<10	<10	<10	<10	450	--
12/12/96	11.17	5.91	5.26	--	--	1,300 ³	2,600	29	5.4	9.40	6.3	230	--
02/10/97	11.17	7.05	4.12	--	--	290 ³	670	<0.5	6.7	2.6	5.6	28	--
05/01/97	11.17	6.17	5.00	--	--	480 ³	920	8.5	4.6	2.1	6.1	530	--
08/05/97	11.17	5.52	5.65	--	--	1,300 ³	1,900	23	<5.0	<5.0	<5.0	860	--
10/28/97	11.17	5.49	5.68	--	--	2,200 ³	2,400	33	14	8.4	10	2100	--
02/04/98	11.17	8.48	2.69	--	--	260 ³	110	<0.5	<0.5	<0.5	<0.5	260	--
06/03/98	11.17	6.79	4.38	--	--	480 ³	<50	<0.5	<0.5	<0.5	<0.5	400	--
07/29/98	11.17	6.12	5.05	--	--	830 ³	350	5.0	<0.5	0.67	1.2	730/980 ⁶	--
11/30/98	11.17	6.16	5.01	--	--	741	168	0.797	<0.5	<0.5	<0.5	114	--
02/24/99	11.17	7.14	4.03	--	--	670 ³	69	<0.5	<0.5	<0.5	<0.5	530	--
05/06/99	11.17	6.72	4.45	--	--	540 ³	<500	<5.0	<5.0	<5.0	<5.0	454	--
08/30/99	11.17	5.43	5.74	--	--	927 ³	748	13.7	<2.5	4.53	10.6	377	--
11/17/99	11.17	5.58	5.59	--	--	1,310 ³	1,240	24.6	8.96	<5.0	20.2	1,900	--
02/21/00	11.17	6.93	4.24	--	--	200 ³	443	2.11	0.908	1.89	2.89	254	--
05/08/00	11.17	6.35	4.82	0.00	0.00	240 ¹¹	190 ¹⁰	<0.50	0.68	1.7	1.1	190	--
08/08/00	11.17	6.18	4.99	0.00	0.00	100 ¹³	150 ¹⁰	0.84	1.2	1.3	2.6	44	--
11/01/00	11.17	5.96	5.21	0.00	0.00	290 ¹⁴	560 ⁹	4.9	1.4	4.7	11	1,100	--
02/12/01	11.17	6.41	4.76	0.00	0.00	210 ¹³	160 ¹⁰	5.4	1.3	2.1	2.5	200	--
05/14/01	11.17	6.19	4.98	0.00	0.00	130 ¹¹	240 ¹⁰	3.7	2.2	0.92	3.2	66	--
08/13/01	11.17	5.62	5.55	0.00	0.00	750	560 ¹⁰	13	6.4	<5.0	<5.0	690	--
11/12/01	11.17	5.46	5.71	0.00	0.00	2,100	3,500	9.2	8.1	16	25	700	--
02/04/02	11.17	6.62	4.55	0.00	0.00	320	430	1.7	0.54	1.0	1.8	91	--
05/06/02	11.17	6.44	4.73	0.00	0.00	430	<50	<0.50	<0.50	<0.50	<0.50	22	--
08/29/02	11.17	5.82	5.35	0.00	0.00	1,600	660	<2.0	1.1	0.82	2.2	320	--
11/25/02	11.17	5.69	5.48	0.00	0.00	1,600	1,800	3.3	2.8	4.4	<10	520	--
02/05/03	11.17	6.56	4.61	0.00	0.00	550	410	1.1	0.60	<2.0	1.6	94	--
05/15/03	11.17	6.59	4.58	0.00	0.00	760	250	<2.0	<0.5	0.9	<1.5	41	--
08/14/03 ²⁴	11.17	5.84	5.33	0.00	0.00	1,200 ²³	610	1	0.9	1	2	300	--
11/13/03 ²⁴	11.17	5.61	5.56	0.00	0.00	1,500	810	0.6	0.5	1	1	63	--
02/12/04 ²⁴	11.17	6.58	4.59	0.00	0.00	180	<50	<0.5	<0.5	<0.5	<0.5	10	--

Table 1
Groundwater Monitoring Data and Analytical Results
Chevron Service Station #9-0290
1802 Webster Street
Alameda, California

WELL ID/ DATE	TOC* (ft.)	GWE (mst)	DTW (ft.)	SPHT (ft.)	SPH		TPH-D (ppb)	TPH-G (ppb)	B (ppb)	T (ppb)	E (ppb)	X (ppb)	MTBE (ppb)	TOG (ppb)
					REMOVED (gallons)									
B-13 (cont)														
05/13/04 ²⁴	11.17	6.42	4.75	0.00	0.00	<50 ²³	<50	<0.5	<0.5	<0.5	<0.5	<0.5	7	--
08/12/04 ²⁴	11.17	5.91	5.26	0.00	0.00	260	<50	<0.5	<0.5	<0.5	<0.5	<0.5	8	--
11/11/04 ²⁴	11.17	5.52	5.65	0.00	0.00	240	<50	<0.5	<0.5	<0.5	<0.5	<0.5	24	--
02/10/05 ²⁴	11.17	6.77	4.40	0.00	0.00	150	<50	<0.5	<0.5	<0.5	<0.5	<0.5	4	--
05/12/05 ²⁴	11.17	6.79	4.38	0.00	0.00	730 ²⁶	<50	<0.5	<0.5	<0.5	<0.5	<0.5	29	--
08/11/05 ²⁴	11.17	6.09	5.08	0.00	0.00	440 ²⁸	<50	<0.5	<0.5	<0.5	<0.5	<0.5	4	--
11/10/05 ²⁴	11.17	6.08	5.09	0.00	0.00	370 ²⁷	170	<0.5	<0.5	<0.5	<0.5	<0.5	27	--
02/09/06 ²⁴	11.17	6.77	4.40	0.00	0.00	200 ²⁷	<50	<0.5	<0.5	<0.5	<0.5	<0.5	0.7	--
05/11/06 ²⁴	11.17	6.67	4.50	0.00	0.00	120	<50	<0.5	<0.5	<0.5	<0.5	<0.5	<0.5	--
08/10/06 ²⁴	11.17	5.96	5.21	0.00	0.00	1,200	92	<0.5	<0.5	<0.5	<0.5	<0.5	5	--
11/09/06 ²⁴	11.17	5.68	5.49	0.00	0.00	1,500	530	<0.5	<0.5	0.6	0.8		14	--
02/08/07 ²⁴	11.17	5.98	5.19	0.00	0.00	790	68	<0.5	<0.5	<0.5	<0.5	<0.5	14	--
05/10/07 ²⁴	11.17	6.15	5.02	0.00	0.00	530	<50	<0.5	<0.5	<0.5	<0.5	<0.5	6	--
08/08/07 ²⁴	11.17	5.66	5.51	0.00	0.00	330	140	<0.5	<0.5	<0.5	<0.5	<0.5	4	--
11/07/07 ²⁴	11.17	5.44	5.73	0.00	0.00	400	250	<0.5	<0.5	<0.5	<0.5	<0.5	4	--
02/13/08 ²⁴	11.17	6.84	4.33	0.00	0.00	200	<50	<0.5	<0.5	<0.5	<0.5	<0.5	2	--
05/14/08²⁴	11.17	6.07	5.10	0.00	0.00	800	<50	<0.5	<0.5	<0.5	<0.5	<0.5	2	--
B-14														
08/29/02 ²¹	9.54	5.12	4.42	0.00	0.00	930	<50	<0.50	<0.50	<0.50	<1.5	<1.5	1,400	--
11/25/02	9.54	5.14	4.40	0.00	0.00	1,200	<50	<0.50	<0.50	<0.50	<1.5	<1.5	1,100	--
02/05/03	9.54	5.56	3.98	0.00	0.00	580	<50	<0.50	<0.50	<0.50	<1.5	<1.5	1,400	--
05/15/03	9.54	5.69	3.85	0.00	0.00	1,000	<50	<0.5	<0.5	<0.5	<1.5	<1.5	1,500	--
08/14/03 ²⁴	9.54	5.07	4.47	0.00	0.00	<250 ²³	<50	<0.5	<0.5	<0.5	<0.5	<0.5	1,100	--
11/13/03 ²⁴	9.54	5.04	4.50	0.00	0.00	1,800	<50	<0.5	<0.5	<0.5	<0.5	<0.5	530	--
02/12/04 ²⁴	9.54	5.56	3.98	0.00	0.00	2,000	59	<0.5	<0.5	<0.5	<0.5	<0.5	1,000	--
05/13/04 ²⁴	9.54	5.47	4.07	0.00	0.00	390 ²³	<50	<1	<1	<1	<1	<1	1,800	--
08/12/04 ²⁴	9.54	5.26	4.28	0.00	0.00	750	<50	<0.5	<0.5	<0.5	<0.5	<0.5	1,100	--
11/11/04 ²⁴	9.54	4.76	4.78	0.00	0.00	2,100	<50	<0.5	<0.5	<0.5	<0.5	<0.5	910	--
02/10/05 ²⁴	9.54	5.82	3.72	0.00	0.00	2,500	78	<1	<1	<1	<1	<1	1,600	--
05/12/05 ²⁴	9.54	5.74	3.80	0.00	0.00	700 ²⁶	72	<0.5	<0.5	<0.5	<0.5	<0.5	1,900	--
08/11/05 ²⁴	9.54	5.51	4.03	0.00	0.00	1,500 ²⁷	<50	<0.5	<0.5	<0.5	<0.5	<0.5	830	--
11/10/05 ²⁴	9.54	5.56	3.98	0.00	0.00	1,200 ²⁷	<50	<0.5	<0.5	<0.5	<0.5	<0.5	480	--
02/09/06 ²⁴	9.54	5.84	3.70	0.00	0.00	1,600 ²⁷	52	<0.5	<0.5	<0.5	<0.5	<0.5	230	--

Table 1
Groundwater Monitoring Data and Analytical Results
Chevron Service Station #9-0290
1802 Webster Street
Alameda, California

WELL ID/ DATE	TOC* (ft.)	GWE (msl)	DTW (ft.)	SPHT (ft.)	SPH		B (ppb)	T (ppb)	E (ppb)	X (ppb)	MTBE (ppb)	TOG (ppb)	
					REMOVED (gallons)	TPH-D (ppb)							
B-14 (cont)													
05/11/06 ²⁴	9.54	5.77	3.77	0.00	0.00	3,400	<50	<0.5	<0.5	<0.5	<0.5	190	--
08/10/06 ²⁴	9.54	5.27	4.27	0.00	0.00	1,700	53	<0.5	<0.5	<0.5	<0.5	440	--
11/09/06 ²⁴	9.54	5.34	4.20	0.00	0.00	1,400	<50	<0.5	<0.5	<0.5	<0.5	84	--
02/08/07 ²⁴	9.54	5.36	4.18	0.00	0.00	1,100	<50	<0.5	<0.5	<0.5	<0.5	7	--
05/10/07 ²⁴	9.54	5.45	4.09	0.00	0.00	910	<50	<0.5	<0.5	<0.5	<0.5	150	--
08/08/07 ²⁴	9.54	5.23	4.31	0.00	0.00	330	<50	<0.5	<0.5	<0.5	<0.5	94	--
11/07/07 ²⁴	9.54	5.14	4.40	0.00	0.00	240	<50	<0.5	<0.5	<0.5	<0.5	50	--
02/13/08 ²⁴	9.54	6.01	3.53	0.00	0.00	520	<50	<0.5	<0.5	<0.5	<0.5	2	--
05/14/08²⁴	9.54	5.46	4.08	0.00	0.00	280	<50	<0.5	<0.5	<0.5	<0.5	20	--
B-15													
08/29/02 ²¹	9.43	5.25	4.18	0.00	0.00	<130	<50	<0.50	<0.50	<0.50	<1.5	<2.5	--
11/25/02	9.43	5.22	4.21	0.00	0.00	<50	<50	<0.50	<0.50	<0.50	<1.5	<2.5	--
02/05/03	9.43	5.86	3.57	0.00	0.00	<50	<50	<0.50	<0.50	<0.50	<1.5	<2.5	--
05/15/03	9.43	5.88	3.55	0.00	0.00	<50	<50	<0.5	<0.5	<0.5	<1.5	<2.5	--
08/14/03 ²⁴	9.43	5.30	4.13	0.00	0.00	<50 ²³	<50	<0.5	<0.5	<0.5	<0.5	<0.5	--
11/13/03 ²⁴	9.43	5.14	4.29	0.00	0.00	<50	<50	<0.5	<0.5	<0.5	<0.5	0.8	--
02/12/04 ²⁴	9.43	5.84	3.59	0.00	0.00	<50	<50	<0.5	<0.5	<0.5	<0.5	<0.5	--
05/13/04 ²⁴	9.43	5.62	3.81	0.00	0.00	<50 ²³	<50	<0.5	<0.5	<0.5	<0.5	<0.5	--
08/12/04 ²⁴	9.43	5.22	4.21	0.00	0.00	<50	<50	<0.5	<0.5	<0.5	<0.5	<0.5	--
11/11/04 ²⁴	9.43	4.79	4.64	0.00	0.00	<50	<50	<0.5	<0.5	<0.5	<0.5	<0.5	--
02/10/05 ²⁴	9.43	6.02	3.41	0.00	0.00	<50	<50	<0.5	<0.5	<0.5	<0.5	<0.5	--
05/12/05 ²⁴	9.43	6.08	3.35	0.00	0.00	<50	<50	<0.5	<0.5	<0.5	<0.5	<0.5	--
08/11/05 ²⁴	9.43	5.56	3.87	0.00	0.00	<50	<50	<0.5	<0.5	<0.5	<0.5	<0.5	--
11/10/05 ²⁴	9.43	5.53	3.90	0.00	0.00	<50	<50	<0.5	<0.5	<0.5	<0.5	<0.5	--
02/09/06 ²⁴	9.43	5.91	3.52	0.00	0.00	150 ²⁷	<50	<0.5	<0.5	<0.5	<0.5	<0.5	--
05/11/06 ²⁴	9.43	5.96	3.47	0.00	0.00	<50	<50	<0.5	<0.5	<0.5	<0.5	<0.5	--
08/10/06 ²⁴	9.43	5.31	4.12	0.00	0.00	<50	<50	<0.5	<0.5	<0.5	<0.5	<0.5	--
11/09/06 ²⁴	9.43	5.26	4.17	0.00	0.00	<50	<50	<0.5	<0.5	<0.5	<0.5	<0.5	--
02/08/07 ²⁴	9.43	5.35	4.08	0.00	0.00	<50	<50	<0.5	<0.5	<0.5	<0.5	<0.5	--
05/10/07 ²⁴	9.43	5.42	4.01	0.00	0.00	<50	<50	<0.5	<0.5	<0.5	<0.5	<0.5	--
08/08/07 ²⁴	9.43	5.28	4.15	0.00	0.00	50	<50	<0.5	<0.5	<0.5	<0.5	<0.5	--

Table 1
Groundwater Monitoring Data and Analytical Results
Chevron Service Station #9-0290
1802 Webster Street
Alameda, California

WELL ID/ DATE	TOC* (ft.)	GWE (msl)	DTW (ft.)	SPHT (ft.)	SPH			B (ppb)	T (ppb)	E (ppb)	X (ppb)	MTBE (ppb)	TOG (ppb)
					REMOVED (gallons)	TPH-D (ppb)	TPH-G (ppb)						
B-15 (cont)													
11/07/07 ²⁴	9.43	5.10	4.33	0.00	0.00	250	<50	<0.5	<0.5	<0.5	<0.5	<0.5	--
02/13/08 ²⁴	9.43	5.92	3.51	0.00	0.00	67	<50	<0.5	<0.5	<0.5	<0.5	<0.5	--
05/14/08 ²⁴	9.43	5.56	3.87	0.00	0.00	110	<50	<0.5	<0.5	<0.5	<0.5	<0.5	--
A-2													
09/20/91	8.00	0.27	7.73	0.00	--	5,100	8,100	860	14	110	53	--	--
10/09/91	8.00	1.39	6.61	0.00	--	--	--	--	--	--	--	--	--
10/17/91	8.00	1.34	6.66	0.00	--	--	--	--	--	--	--	--	--
10/23/91	8.00	1.29	6.80	0.09	--	--	--	--	--	--	--	--	--
11/01/91	8.00	1.45	6.63	0.15	--	--	--	--	--	--	--	--	--
11/07/91	8.00	1.45	6.64	0.21	--	--	--	--	--	--	--	--	--
11/15/91	8.00	1.38	6.81	0.19	--	--	--	--	--	--	--	--	--
11/21/91	8.00	1.31	6.93	0.24	--	--	--	--	--	--	--	--	--
12/12/91	8.00	1.24	6.97	0.15	--	--	--	--	--	--	--	--	--
12/30/91	8.00	1.70	6.54	0.24	--	--	--	--	--	--	--	--	--
01/13/92	8.00	2.16	5.92	0.08	--	--	--	--	--	--	--	--	--
01/22/92	8.00	2.00	6.01	0.10	--	--	--	--	--	--	--	--	--
02/12/92	8.00	2.20	6.06	0.26	--	--	--	--	--	--	--	--	--
03/09/92	8.00	3.11	4.93	0.04	--	--	--	--	--	--	--	--	--
04/10/92	8.00	2.80	5.20	<0.01	--	--	--	--	--	--	--	--	--
05/18/92	8.00	2.36	5.66	0.02	--	--	--	--	--	--	--	--	--
01/06/93	8.00	--	--	--	--	--	--	--	--	--	--	--	--
02/03/93	8.00	3.20	4.98	0.22	--	--	--	--	--	--	--	--	--
04/23/93	11.46	6.24	5.36	0.18	--	--	--	--	--	--	--	--	--
06/11/93	11.46	--	--	--	0.13	--	--	--	--	--	--	--	--
06/15/93	11.46	--	--	--	0.13	--	--	--	--	--	--	--	--
06/18/93	11.46	--	--	--	0.26	--	--	--	--	--	--	--	--
06/22/93	11.46	--	--	--	0.50	--	--	--	--	--	--	--	--
06/29/93	11.46	--	--	--	--	--	--	--	--	--	--	--	--
07/09/93	11.46	--	--	--	--	--	--	--	--	--	--	--	--
07/15/93	11.46	--	--	--	--	--	--	--	--	--	--	--	--
07/19/93	11.46	5.53	6.79	1.07	--	--	--	--	--	--	--	--	--
07/20/93	11.46	--	--	--	--	--	--	--	--	--	--	--	--
07/27/93	11.46	--	--	--	--	--	--	--	--	--	--	--	--

Table 1
Groundwater Monitoring Data and Analytical Results
Chevron Service Station #9-0290
1802 Webster Street
Alameda, California

WELL ID/ DATE	TOC* (ft.)	GWE (mst)	DTW (ft.)	SPHT (ft.)	SPH REMOVED (gallons)	TPH-D (ppb)	TPH-G (ppb)	B (ppb)	T (ppb)	E (ppb)	X (ppb)	MTBE (ppb)	TOG (ppb)
A-2 (cont)													
08/06/93	11.46	--	--	--	--	--	--	--	--	--	--	--	--
08/10/93	11.46	--	--	--	--	--	--	--	--	--	--	--	--
08/16/93	11.46	--	--	--	--	--	--	--	--	--	--	--	--
09/16/93	11.46	--	--	--	--	--	--	--	--	--	--	--	--
09/24/93	11.46	--	--	--	--	--	--	--	--	--	--	--	--
10/01/93	11.46	--	--	--	--	--	--	--	--	--	--	--	--
10/07/93	11.46	--	--	--	--	--	--	--	--	--	--	--	--
10/13/93	11.46	--	--	--	--	--	--	--	--	--	--	--	--
10/19/93	11.46	6.23	6.36	1.41	--	--	--	--	--	--	--	--	--
10/20/93	11.46	--	--	--	--	--	--	--	--	--	--	--	--
10/28/93	11.46	--	--	--	--	--	--	--	--	--	--	--	--
11/12/93	11.46	--	--	--	--	--	--	--	--	--	--	--	--
11/19/93	11.46	--	--	--	--	--	--	--	--	--	--	--	--
11/30/93	11.46	--	--	--	--	--	--	--	--	--	--	--	--
12/10/93	11.46	--	--	--	--	--	--	--	--	--	--	--	--
12/16/93	11.46	--	--	--	--	--	--	--	--	--	--	--	--
12/23/93	11.46	--	--	--	--	--	--	--	--	--	--	--	--
12/29/93	11.46	--	--	--	--	--	--	--	--	--	--	--	--
01/03/94	11.46	--	--	--	--	--	--	--	--	--	--	--	--
01/17/94	11.46	--	--	--	--	--	--	--	--	--	--	--	--
01/26/94	11.46	--	--	--	--	--	--	--	--	--	--	--	--
02/07/94	11.46	--	--	--	--	--	--	--	--	--	--	--	--
02/11/94	11.46	--	--	--	--	--	--	--	--	--	--	--	--
02/18/94	11.46	--	--	--	--	--	--	--	--	--	--	--	--
02/25/94	11.46	--	--	--	--	--	--	--	--	--	--	--	--
03/04/94	11.46	--	--	--	--	--	--	--	--	--	--	--	--
03/11/94	11.46	--	--	--	--	--	--	--	--	--	--	--	--
03/16/94	11.46	--	--	--	--	--	--	--	--	--	--	--	--
03/25/94	11.46	--	--	--	--	--	--	--	--	--	--	--	--
DESTROYED													

Table 1
Groundwater Monitoring Data and Analytical Results
Chevron Service Station #9-0290
1802 Webster Street
Alameda, California

WELL ID/ DATE	TOC* (ft.)	GWE (mst)	DTW (ft.)	SPHT (ft.)	SPH			B (ppb)	T (ppb)	E (ppb)	X (ppb)	MTBE (ppb)	TOG (ppb)
					REMOVED (gallons)	TPH-D (ppb)	TPH-G (ppb)						
B-3													
09/20/91	8.01	1.08	6.94	0.01	--	--	--	--	--	--	--	--	--
10/09/91	8.01	1.66	6.35	--	--	--	--	--	--	--	--	--	--
10/17/91	8.01	1.57	6.44	--	--	--	--	--	--	--	--	--	--
11/01/91	8.01	1.70	6.31	--	--	--	--	--	--	--	--	--	--
11/07/91	8.01	1.69	6.32	--	--	--	--	--	--	--	--	--	--
11/15/91	8.01	1.62	6.39	--	--	--	--	--	--	--	--	--	--
11/21/91	8.01	1.57	6.44	--	--	--	--	--	--	--	--	--	--
12/12/91	8.01	1.19	6.82	<0.01	--	--	--	--	--	--	--	--	--
12/30/91	8.01	1.64	6.37	--	--	--	--	--	--	--	--	--	--
01/13/92	8.01	2.07	5.94	--	--	--	--	--	--	--	--	--	--
01/22/92	8.01	2.02	5.99	--	--	--	--	--	--	--	--	--	--
02/12/92	8.01	2.19	5.82	<0.01	--	--	--	--	--	--	--	--	--
03/09/92	8.01	2.91	5.10	--	--	--	--	--	--	--	--	--	--
04/10/92	8.01	2.65	5.36	--	--	--	--	--	--	--	--	--	--
05/18/92	8.01	2.29	5.72	--	--	250	6,200	550	58	13	51	--	<5,000
01/06/93	8.01	2.51	5.50	Sheen	--	10,000	5,400	490	54	51	82	--	--
02/03/93	8.01	--	--	--	--	--	--	--	--	--	--	--	--
04/23/93	11.42	6.10	5.32	--	--	6,400	18,000	540	69	47	120	--	--
07/29/93	11.42	5.48	5.94	--	--	4,000	40,000	780	69	49	150	--	--
10/19/93	11.42	5.10	6.32	--	--	1,500	20,000	520	37	43	100	--	--
01/17/94	11.42	4.47	6.95	--	--	<50	3,900	430	32	29	82	--	--

DESTROYED

B-4													
09/20/91	8.04	1.22	6.82	0.01	--	1,400	19,000	710	160	650	2,000	--	--
10/09/91	8.04	1.41	6.63	--	--	--	--	--	--	--	--	--	--
10/17/91	8.04	1.20	6.84	--	--	--	--	--	--	--	--	--	--
10/23/91	8.04	1.17	6.87	--	--	--	--	--	--	--	--	--	--
11/01/91	8.04	1.34	6.70	--	--	--	--	--	--	--	--	--	--
11/07/91	8.04	1.31	6.73	--	--	--	--	--	--	--	--	--	--
11/15/91	8.04	1.21	6.83	--	--	--	--	--	--	--	--	--	--
11/21/91	8.04	1.20	6.84	--	--	--	--	--	--	--	--	--	--
12/12/91	8.04	1.17	6.87	<0.01	--	--	--	--	--	--	--	--	--
12/30/91	8.04	1.58	6.46	--	--	--	--	--	--	--	--	--	--
01/13/92	8.04	2.13	5.91	--	--	--	--	--	--	--	--	--	--

Table 1
Groundwater Monitoring Data and Analytical Results
Chevron Service Station #9-0290
1802 Webster Street
Alameda, California

WELL ID/ DATE	TOC* (ft.)	GWE (mst)	DFW (ft.)	SPHT (ft.)	SPH			B (ppb)	T (ppb)	E (ppb)	X (ppb)	MTBE (ppb)	TOG (ppb)
					REMOVED (gallons)	TPH-D (ppb)	TPH-G (ppb)						
B-4 (cont)													
01/22/92	8.04	2.09	5.95	--	--	--	--	--	--	--	--	--	--
02/12/92	8.04	2.26	5.78	<0.01	--	860	15,000	920	75	520	940	--	--
03/09/92	8.04	2.95	5.09	--	--	--	--	--	--	--	--	--	--
04/10/92	8.04	2.65	5.39	--	--	--	--	--	--	--	--	--	--
05/18/92	8.04	2.45	5.59	--	--	<50	19,000	2,000	97	560	1,200	--	<5,000
01/06/93	8.04	2.54	5.50	Sheen	--	2,700	19,000	2,000	89	490	740	--	--
02/03/93	8.04	--	--	--	--	--	--	--	--	--	--	--	--
04/23/93	11.46	6.07	5.39	--	--	2,300	5,700	2,400	75	380	580	--	--
07/19/93	11.46	5.33	6.13	--	--	2,400	19,000	2,400	140	440	620	--	--
10/19/93	11.46	4.95	6.51	--	--	2,100	13,000	1,200	84	290	530	--	--
01/17/94	11.46	5.28	6.18	--	--	<50	11,000	1,900	63	170	290	--	--
DESTROYED													
B-8													
04/23/93	11.99	6.63	5.36	--	--	--	<50	<0.5	<0.5	<0.5	<1.5	--	<50
07/19/93	11.99	5.77	6.22	--	--	<50	<50	<0.5	<0.5	<0.5	<1.5	--	<50
10/19/93	11.99	DRY	--	--	--	--	--	--	--	--	--	--	--
01/07/94	11.99	5.69	6.30	--	--	<50	<50	<0.5	<0.5	<0.5	<0.5	--	--
08/18/94	11.99	5.56	6.43	--	--	<50	<50	<0.5	<0.5	<0.5	<0.5	--	--
11/30/94	11.99	6.53	5.46	--	--	120 ¹	<50	<0.5	<0.5	<0.5	<0.5	--	--
02/15/95	11.99	7.27	4.72	--	--	120 ¹	<50	<0.5	<0.5	<0.5	<0.5	--	--
05/01/95	11.99	6.99	5.00	--	--	51 ³	<50	<0.5	<0.5	<0.5	<0.5	--	--
08/04/95	11.99	6.07	5.92	--	--	<50	<50	<0.5	<0.5	<0.5	<0.5	--	--
11/30/98	11.99	6.45	5.54	--	--	--	--	--	--	--	--	--	--
NOT MONITORED/SAMPLED													
B-9													
04/23/93	10.70	6.14	4.56	--	--	--	<50	<0.5	<0.5	<0.5	<1.5	--	<50
07/19/93	10.70	5.25	5.45	--	--	<50	<50	<0.5	<0.5	<0.5	<1.5	--	<50
10/19/93	10.70	4.81	5.89	--	--	<50	<50	<0.5	<0.5	<0.5	<0.5	--	--
01/07/94	10.70	5.29	5.41	--	--	<50	<50	<0.5	<0.5	<0.5	<0.5	--	--
08/18/94	10.70	5.15	5.55	--	--	<50	<50	<0.5	<0.5	<0.5	<0.5	--	--
11/30/94	10.70	6.35	4.35	--	--	60 ¹	<50	<0.5	<0.5	<0.5	<0.5	--	--

Table 1
Groundwater Monitoring Data and Analytical Results
Chevron Service Station #9-0290
1802 Webster Street
Alameda, California

WELL ID/ DATE	TOC* (ft.)	GWE (msl)	DTW (ft.)	SPHT (ft.)	SPH REMOVED (gallons)	TPH-D (ppb)	TPH-G (ppb)	B (ppb)	T (ppb)	E (ppb)	X (ppb)	MTBE (ppb)	TOG (ppb)
B-9 (cont)													
02/15/95	10.70	7.05	3.65	--	--	<50	<50	<0.5	<0.5	<0.5	<0.5	--	--
05/01/95	10.70	6.41	4.29	--	--	<50	<50	<0.5	<0.5	<0.5	<0.5	--	--
08/04/95	10.70	5.50	5.20	--	--	<50	<50	<0.5	<0.5	<0.5	<0.5	--	--
NOT MONITORED/SAMPLED													
TRIP BLANK													
01/06/93	--	--	--	--	--	--	<50	<0.5	<0.5	<0.5	<0.5	--	--
04/23/93	--	--	--	--	--	--	--	--	--	--	--	--	--
07/19/93	--	--	--	--	--	--	--	--	--	--	--	--	--
10/19/93	--	--	--	--	--	--	<50	<0.5	0.5	<0.5	<0.5	--	--
01/17/94	--	--	--	--	--	--	<50	<0.5	<0.5	<0.5	<0.5	--	--
08/18/94	--	--	--	--	--	--	<50	<0.5	<0.5	<0.5	<0.5	--	--
11/30/94	--	--	--	--	--	--	<50	<0.5	<0.5	<0.5	<0.5	--	--
02/15/95	--	--	--	--	--	--	<50	<0.5	<0.5	<0.5	<0.5	--	--
05/01/95	--	--	--	--	--	--	<50	<0.5	<0.5	<0.5	<0.5	--	--
08/04/95	--	--	--	--	--	--	<50	<0.5	<0.5	<0.5	<0.5	--	--
11/29/95	--	--	--	--	--	--	<50	<0.5	<0.5	<0.5	<0.5	<2.5	--
02/08/96	--	--	--	--	--	--	<50	<0.5	<0.5	<0.5	<0.5	--	--
05/08/96	--	--	--	--	--	--	<50	<0.5	<0.5	<0.5	<0.5	<2.5	--
08/23/96	--	--	--	--	--	--	<50	<0.5	<0.5	<0.5	<0.5	--	--
12/12/96	--	--	--	--	--	--	<50	<0.5	<0.5	<0.5	<0.5	<2.5	--
02/10/97	--	--	--	--	--	--	<50	<0.5	<0.5	<0.5	<0.5	<2.5	--
05/01/97	--	--	--	--	--	--	<50	<0.5	<0.5	<0.5	<0.5	<2.5	--
08/05/97	--	--	--	--	--	--	<50	<0.5	<0.5	<0.5	<0.5	<2.5	--
10/28/97	--	--	--	--	--	--	<50	<0.5	<0.5	<0.5	<0.5	<2.5	--
02/04/98	--	--	--	--	--	--	<50	<0.5	<0.5	<0.5	<0.5	<2.5	--
02/12/98	--	--	--	--	--	--	<50	<0.5	<0.5	<0.5	<0.5	<2.5	--
06/03/98	--	--	--	--	--	--	<50	<0.5	<0.5	<0.5	<0.5	<2.5	--
07/29/98	--	--	--	--	--	--	<50	<0.5	<0.5	<0.5	<0.5	<2.5	--
11/30/98	--	--	--	--	--	--	<50	<0.5	<0.5	<0.5	<0.5	<2.0	--
02/24/99	--	--	--	--	--	--	<50	<0.5	<0.5	<0.5	<0.5	<2.5	--
05/06/99	--	--	--	--	--	--	<50	<0.5	<0.5	<0.5	<0.5	<5.0	--
08/30/99	--	--	--	--	--	--	<50	<0.5	<0.5	<0.5	<0.5	<2.5	--
11/17/99	--	--	--	--	--	--	<50	<0.5	<0.5	<0.5	<0.5	<2.5	--

Table 1
Groundwater Monitoring Data and Analytical Results
Chevron Service Station #9-0290
1802 Webster Street
Alameda, California

WELL ID/ DATE	TOC* (ft.)	GWE (msl)	DTW (ft.)	SPHT (ft.)	SPH REMOVED (gallons)	TPH-D (ppb)	TPH-G (ppb)	B (ppb)	T (ppb)	E (ppb)	X (ppb)	MTBE (ppb)	TOG (ppb)
TRIP BLANK (cont)													
02/21/00	--	--	--	--	--	--	<50	<0.5	<0.5	<0.5	<0.5	<2.5	--
05/08/00	--	--	--	--	--	--	<50	<0.50	<0.50	<0.50	<0.50	<2.5	--
08/08/00	--	--	--	--	--	--	<50	<0.50	<0.50	<0.50	<0.50	<2.5	--
11/01/00	--	--	--	--	--	--	<50	<0.50	<0.50	<0.50	<0.50	<2.5	--
02/12/01	--	--	--	--	--	--	<50	<0.50	<0.50	<0.50	<0.50	<2.5	--
05/14/01	--	--	--	--	--	--	<50	<0.50	<0.50	<0.50	<0.50	<2.5	--
08/13/01	--	--	--	--	--	--	<50	<0.50	<0.50	<0.50	<0.50	<2.5	--
QA													
11/12/01	--	--	--	--	--	--	<50	<0.50	<0.50	<0.50	<1.5	<2.5	--
02/04/02	--	--	--	--	--	--	<50	<0.50	<0.50	<0.50	<1.5	<2.5	--
05/06/02	--	--	--	--	--	--	<50	<0.50	<0.50	<0.50	<1.5	<2.5	--
08/29/02	--	--	--	--	--	--	<50	<0.50	<0.50	<0.50	<1.5	<2.5	--
11/25/02	--	--	--	--	--	--	<50	<0.50	<0.50	<0.50	<1.5	<2.5	--
02/05/03	--	--	--	--	--	--	<50	<0.50	<0.50	<0.50	<1.5	<2.5	--
05/15/03	--	--	--	--	--	--	<50	<0.5	<0.5	<0.5	<1.5	<2.5	--
08/14/03 ²⁴	--	--	--	--	--	--	<50	<0.5	<0.5	<0.5	<0.5	<0.5	--
11/13/03 ²⁴	--	--	--	--	--	--	<50	<0.5	<0.5	<0.5	<0.5	<0.5	--
02/12/04 ²⁴	--	--	--	--	--	--	<50	<0.5	<0.5	<0.5	<0.5	<0.5	--
05/13/04 ²⁴	--	--	--	--	--	--	<50	<0.5	<0.5	<0.5	<0.5	<0.5	--
08/12/04 ²⁴	--	--	--	--	--	--	<50	<0.5	<0.5	<0.5	<0.5	<0.5	--
11/11/04 ²⁴	--	--	--	--	--	--	<50	<0.5	<0.5	<0.5	<0.5	<0.5	--
02/10/05 ²⁴	--	--	--	--	--	--	<50	<0.5	<0.5	<0.5	<0.5	<0.5	--
05/12/05 ²⁴	--	--	--	--	--	--	<50	<0.5	<0.5	<0.5	<0.5	<0.5	--
08/11/05 ²⁴	--	--	--	--	--	--	<50	<0.5	<0.5	<0.5	<0.5	<0.5	--
11/10/05 ²⁴	--	--	--	--	--	--	<50	0.6 ³⁰	<0.5	<0.5	<0.5	<0.5	--
02/09/06 ²⁴	--	--	--	--	--	--	<50	<0.5	<0.5	<0.5	<0.5	<0.5	--
05/11/06 ²⁴	--	--	--	--	--	--	<50	<0.5	<0.5	<0.5	<0.5	<0.5	--
08/10/06 ²⁴	--	--	--	--	--	--	<50	<0.5	<0.5	<0.5	<0.5	<0.5	--
11/09/06 ²⁴	--	--	--	--	--	--	<50	<0.5	<0.5	<0.5	<0.5	<0.5	--
02/08/07 ²⁴	--	--	--	--	--	--	<50	<0.5	<0.5	<0.5	<0.5	<0.5	--
05/10/07 ²⁴	--	--	--	--	--	--	<50	<0.5	<0.5	<0.5	<0.5	<0.5	--
08/08/07 ²⁴	--	--	--	--	--	--	<50	<0.5	<0.5	<0.5	<0.5	<0.5	--

Table 1
Groundwater Monitoring Data and Analytical Results
Chevron Service Station #9-0290
1802 Webster Street
Alameda, California

WELL ID/ DATE	TOC* (ft.)	GWE (msl)	DTW (ft.)	SPHT (ft.)	SPH							MTBE (ppb)	TOG (ppb)
					REMOVED (gallons)	TPH-D (ppb)	TPH-G (ppb)	B (ppb)	T (ppb)	E (ppb)	X (ppb)		
QA (cont)													
11/07/07 ²⁴	--	--	--	--	--	--	<50	<0.5	<0.5	<0.5	<0.5	<0.5	--
02/13/08 ²⁴	--	--	--	--	--	--	<50	<0.5	<0.5	<0.5	<0.5	<0.5	--
05/14/08 ²⁴	--	--	--	--	--	--	<50	<0.5	<0.5	<0.5	<0.5	<0.5	--

Table 1
Groundwater Monitoring Data and Analytical Results
Chevron Service Station #9-0290
1802 Webster Street
Alameda, California

EXPLANATIONS:

Groundwater monitoring data and laboratory analytical results prior to May 8, 2000, were compiled from reports prepared by Blaine Tech Services, Inc.

TOC = Top of Casing	TPH-D = Total Petroleum Hydrocarbons as Diesel	MTBE = Methyl tertiary butyl ether
(ft.) = Feet	TPH-G = Total Petroleum Hydrocarbons as Gasoline	TOG = Total Oil and Grease
GWE = Groundwater Elevation	B = Benzene	(ppb) = Parts per billion
(msl) = Mean sea level	T = Toluene	-- = Not Measured/Not Analyzed
DTW = Depth to Water	E = Ethylbenzene	NP = No Purge
SPHT = Separate Phase Hydrocarbon Thickness	X = Xylenes	QA = Quality Assurance/Trip Blank

- * TOC elevations were surveyed on September 26, 2002, by Virgil Chavez Land Surveying. The benchmark for this survey was a brass disk in a monument well at the mid return of the northwest corner of Webster St. and Buena Vista Ave., (Benchmark Elevation = 11.09 feet NGVD 29).
- ** GWE has been corrected due to the presence of SPH; correction factor: [(TOC - DTW) + (SPHT x 0.80)].
- ¹ Chromatogram pattern indicates a non-diesel mix.
- ² Analytical values are in parts per million (ppm).
- ³ Chromatogram pattern indicates an unidentified hydrocarbon.
- ⁴ Chromatogram pattern indicates an unidentified hydrocarbon and weathered diesel.
- ⁵ EPA Method 8240.
- ⁶ Confirmation run.
- ⁷ Hydrocarbon pattern appears to be weathered.
- ⁸ Laboratory report indicates gasoline C6-C12 + unidentified hydrocarbons >C10.
- ⁹ Laboratory report indicates gasoline C6-C12 + unidentified hydrocarbons C6-C12.
- ¹⁰ Laboratory report indicates gasoline C6-C12.
- ¹¹ Laboratory report indicates unidentified hydrocarbons C9-C24.
- ¹² Laboratory report indicates unidentified hydrocarbons >C16.
- ¹³ Laboratory report indicates unidentified hydrocarbons <C16.
- ¹⁴ Laboratory report indicates unidentified hydrocarbons C9-C40.
- ¹⁵ Laboratory report indicates unidentified hydrocarbons C6-C12.
- ¹⁶ Well obstructed by roots.
- ¹⁷ Laboratory report indicates TPH-G, B, T, E, X and MTBE was originally analyzed within holding time. Re-analysis for confirmation or dilution was performed past the recommended holding time.
- ¹⁸ Laboratory report indicates sample was originally analyzed within holding time. Re-analysis for confirmation or dilution was performed past the recommended holding time.
- ¹⁹ Laboratory report indicates sample was run past holding time.
- ²⁰ Obstruction in well at 11.46 feet.
- ²¹ Well development performed.

Table 1
Groundwater Monitoring Data and Analytical Results
Chevron Service Station #9-0290
1802 Webster Street
Alameda, California

EXPLANATIONS: (cont)

- 22 Laboratory report indicates the analysis was performed from a previously opened vial and the results are therefore estimated.
- 23 TPH-D with silica gel cleanup.
- 24 BTEX and MTBE by EPA Method 8260.
- 25 TOC has been altered due to well repair. Unable to determine an accurate GWE.
- 26 Laboratory report indicates the observed sample pattern is not typical of diesel/#2 fuel oil.
- 27 Laboratory report indicates the observed sample pattern includes #2 fuel/diesel and an additional pattern which elutes later in the DRO range.
- 28 Laboratory report indicates the observed sample pattern is not typical of #2 fuel/diesel. It elutes in the DRO range later than #2 fuel.
- 29 Analysis by EPA Method 8260.
- 30 Laboratory confirmed analytical result.
- 31 Laboratory report indicates the observed sample pattern includes #2 fuel/diesel, an additional pattern which elutes later in the DRO range and individual peaks eluting in the DRO range.

Table 2
Groundwater Analytical Results
Chevron Service Station #9-0290
1802 Webster Street
Alameda, California

WELL ID/ DATE	Ethanol (ppb)	Alkalinity (ppb)	Ferrous Iron (ppb)	Nitrate as Nitrate (ppb)	Sulfate (ppb)	EPA 8010B (ppb)	EPA 8270B (ppb)	Cadmium (ppb)	Chromium (ppb)	Lead (ppb)	Nickel (ppb)	Zinc (ppb)	Motor Oil (ppb)
A-1													
08/30/99	--	--	--	--	--	--	--	--	--	--	--	--	68,400
08/14/03	<50	--	--	--	--	--	--	--	--	--	--	--	--
11/13/03	<50	--	--	--	--	--	--	--	--	--	--	--	--
02/12/04	<50	--	--	--	--	--	--	--	--	--	--	--	--
05/13/04	<50	--	--	--	--	--	--	--	--	--	--	--	--
08/12/04	<50	--	--	--	--	--	--	--	--	--	--	--	--
11/11/04	<50	--	--	--	--	--	--	--	--	--	--	--	--
02/10/05	<50	--	--	--	--	--	--	--	--	--	--	--	--
05/12/05	<50	--	--	--	--	--	--	--	--	--	--	--	--
08/11/05	<50	--	--	--	--	--	--	--	--	--	--	--	--
11/10/05	<50	--	--	--	--	--	--	--	--	--	--	--	--
02/09/06	<50	--	--	--	--	--	--	--	--	--	--	--	--
05/11/06	<50	--	--	--	--	--	--	--	--	--	--	--	--
08/10/06	<50	--	--	--	--	--	--	--	--	--	--	--	--
11/09/06	<50	--	--	--	--	--	--	--	--	--	--	--	--
02/08/07	<50	--	--	--	--	--	--	--	--	--	--	--	--
05/10/07	<50	--	--	--	--	--	--	--	--	--	--	--	--
08/08/07	<50	--	--	--	--	--	--	--	--	--	--	--	--
11/07/07	<50	--	--	--	--	--	--	--	--	--	--	--	--
02/13/08	<50	--	--	--	--	--	--	--	--	--	--	--	--
05/14/08	<50	--	--	--	--	--	--	--	--	--	--	--	--
B-1													
07/29/98	--	930,000	2,000	13,000	280,000	--	--	--	--	--	--	--	--
08/14/03	<50	--	--	--	--	--	--	--	--	--	--	--	--
11/13/03	<50	--	--	--	--	--	--	--	--	--	--	--	--
02/12/04	<50	--	--	--	--	--	--	--	--	--	--	--	--
05/13/04	<50	--	--	--	--	--	--	--	--	--	--	--	--
08/12/04	<50	--	--	--	--	--	--	--	--	--	--	--	--
11/11/04	<50	--	--	--	--	--	--	--	--	--	--	--	--
02/10/05	<50	--	--	--	--	--	--	--	--	--	--	--	--
05/12/05	<50	--	--	--	--	--	--	--	--	--	--	--	--
08/11/05	<50	--	--	--	--	--	--	--	--	--	--	--	--
11/10/05	<50	--	--	--	--	--	--	--	--	--	--	--	--

Table 2
Groundwater Analytical Results
Chevron Service Station #9-0290
1802 Webster Street
Alameda, California

WELL ID/ DATE	Ethanol (ppb)	Alkalinity (ppb)	Ferrous Iron (ppb)	Nitrate as Nitrate (ppb)	Sulfate (ppb)	EPA 8010B (ppb)	EPA 8270B (ppb)	Cadmium (ppb)	Chromium (ppb)	Lead (ppb)	Nickel (ppb)	Zinc (ppb)	Motor Oil (ppb)
B-1 (cont)													
02/09/06	<50	--	--	--	--	--	--	--	--	--	--	--	--
05/11/06	<50	--	--	--	--	--	--	--	--	--	--	--	--
08/10/06	<50	--	--	--	--	--	--	--	--	--	--	--	--
11/09/06	<50	--	--	--	--	--	--	--	--	--	--	--	--
02/08/07	<50	--	--	--	--	--	--	--	--	--	--	--	--
05/10/07	<50	--	--	--	--	--	--	--	--	--	--	--	--
08/08/07	<50	--	--	--	--	--	--	--	--	--	--	--	--
11/07/07	<50	--	--	--	--	--	--	--	--	--	--	--	--
02/13/08	<50	--	--	--	--	--	--	--	--	--	--	--	--
05/14/08	<50	--	--	--	--	--	--	--	--	--	--	--	--
B-5													
07/29/98	--	280,000	1,100	<1,000	7,000	--	--	--	--	--	--	--	--
08/14/03	<1,000	--	--	--	--	--	--	--	--	--	--	--	--
11/13/03	<250	--	--	--	--	--	--	--	--	--	--	--	--
02/12/04	<500	--	--	--	--	--	--	--	--	--	--	--	--
05/13/04	<100	--	--	--	--	--	--	--	--	--	--	--	--
08/12/04	<50	--	--	--	--	--	--	--	--	--	--	--	--
11/11/04	<50	--	--	--	--	--	--	--	--	--	--	--	--
02/10/05	<50	--	--	--	--	--	--	--	--	--	--	--	--
05/12/05	<50	--	--	--	--	--	--	--	--	--	--	--	--
08/11/05	<50	--	--	--	--	--	--	--	--	--	--	--	--
11/10/05	<50	--	--	--	--	--	--	--	--	--	--	--	--
02/09/06	<50	--	--	--	--	--	--	--	--	--	--	--	--
05/11/06	<50	--	--	--	--	--	--	--	--	--	--	--	--
08/10/06	<50	--	--	--	--	--	--	--	--	--	--	--	--
11/09/06	<50	--	--	--	--	--	--	--	--	--	--	--	--
02/08/07	<50	--	--	--	--	--	--	--	--	--	--	--	--
05/10/07	<50	--	--	--	--	--	--	--	--	--	--	--	--
08/08/07	<50	--	--	--	--	--	--	--	--	--	--	--	--
11/07/07	<50	--	--	--	--	--	--	--	--	--	--	--	--
02/13/08	<50	--	--	--	--	--	--	--	--	--	--	--	--
05/14/08	<50	--	--	--	--	--	--	--	--	--	--	--	--

Table 2
Groundwater Analytical Results
Chevron Service Station #9-0290
1802 Webster Street
Alameda, California

WELL ID/ DATE	Ethanol (ppb)	Alkalinity (ppb)	Ferrous Iron (ppb)	Nitrate as Nitrate (ppb)	Sulfate (ppb)	EPA 8010B (ppb)	EPA 8270B (ppb)	Cadmium (ppb)	Chromium (ppb)	Lead (ppb)	Nickel (ppb)	Zinc (ppb)	Motor Oil (ppb)
B-6													
08/14/03	<2,500	--	--	--	--	--	--	--	--	--	--	--	--
11/13/03	<1,000	--	--	--	--	--	--	--	--	--	--	--	--
02/12/04	<2,000	--	--	--	--	--	--	--	--	--	--	--	--
05/13/04	<250	--	--	--	--	--	--	--	--	--	--	--	--
08/12/04	<250	--	--	--	--	--	--	--	--	--	--	--	--
11/11/04	<1,000	--	--	--	--	--	--	--	--	--	--	--	--
02/10/05	<1,000	--	--	--	--	--	--	--	--	--	--	--	--
05/12/05	<1,000	--	--	--	--	--	--	--	--	--	--	--	--
08/11/05	<1,000	--	--	--	--	--	--	--	--	--	--	--	--
11/10/05	<500	--	--	--	--	--	--	--	--	--	--	--	--
02/09/06	<250	--	--	--	--	--	--	--	--	--	--	--	--
05/11/06	<50	--	--	--	--	--	--	--	--	--	--	--	--
08/10/06	<250	--	--	--	--	--	--	--	--	--	--	--	--
11/09/06	<50	--	--	--	--	--	--	--	--	--	--	--	--
02/08/07	<50	--	--	--	--	--	--	--	--	--	--	--	--
05/10/07	<50	--	--	--	--	--	--	--	--	--	--	--	--
08/08/07	<50	--	--	--	--	--	--	--	--	--	--	--	--
11/07/07	<50	--	--	--	--	--	--	--	--	--	--	--	--
02/13/08	<50	--	--	--	--	--	--	--	--	--	--	--	--
05/14/08	<50	--	--	--	--	--	--	--	--	--	--	--	--
B-7													
08/14/03	<50	--	--	--	--	--	--	--	--	--	--	--	--
11/13/03	SAMPLED SEMI-ANNUALLY												
02/12/04	<50	--	--	--	--	--	--	--	--	--	--	--	--
08/12/04	<50	--	--	--	--	--	--	--	--	--	--	--	--
02/10/05	<50	--	--	--	--	--	--	--	--	--	--	--	--
08/11/05	<50	--	--	--	--	--	--	--	--	--	--	--	--
02/09/06	<50	--	--	--	--	--	--	--	--	--	--	--	--
05/11/06	SAMPLED SEMI-ANNUALLY												
08/10/06	<50	--	--	--	--	--	--	--	--	--	--	--	--
02/08/07	<50	--	--	--	--	--	--	--	--	--	--	--	--

Table 2
Groundwater Analytical Results
Chevron Service Station #9-0290
1802 Webster Street
Alameda, California

WELL ID/ DATE	Ethanol (ppb)	Alkalinity (ppb)	Ferrous Iron (ppb)	Nitrate as Nitrate (ppb)	Sulfate (ppb)	EPA 8010B (ppb)	EPA 8270B (ppb)	Cadmium (ppb)	Chromium (ppb)	Lead (ppb)	Nickel (ppb)	Zinc (ppb)	Motor Oil (ppb)
B-7 (cont)													
05/10/07	<50	--	--	--	--	--	--	--	--	--	--	--	--
08/08/07	<50	--	--	--	--	--	--	--	--	--	--	--	--
02/13/08	<50	--	--	--	--	--	--	--	--	--	--	--	--
B-10													
07/29/98	--	630,000	740	34,000	16,000	--	--	--	--	--	--	--	--
08/14/03	<50	--	--	--	--	--	--	--	--	--	--	--	--
11/13/03	<50	--	--	--	--	--	--	--	--	--	--	--	--
02/12/04	<50	--	--	--	--	--	--	--	--	--	--	--	--
05/13/04	<50	--	--	--	--	--	--	--	--	--	--	--	--
08/12/04	<50	--	--	--	--	--	--	--	--	--	--	--	--
11/11/04	<50	--	--	--	--	--	--	--	--	--	--	--	--
02/10/05	<50	--	--	--	--	--	--	--	--	--	--	--	--
05/12/05	<50	--	--	--	--	--	--	--	--	--	--	--	--
08/11/05	<50	--	--	--	--	--	--	--	--	--	--	--	--
11/10/05	<50	--	--	--	--	--	--	--	--	--	--	--	--
02/09/06	<50	--	--	--	--	--	--	--	--	--	--	--	--
05/11/06	<50	--	--	--	--	--	--	--	--	--	--	--	--
08/10/06	<50	--	--	--	--	--	--	--	--	--	--	--	--
11/09/06	<50	--	--	--	--	--	--	--	--	--	--	--	--
02/08/07	<50	--	--	--	--	--	--	--	--	--	--	--	--
05/10/07	<50	--	--	--	--	--	--	--	--	--	--	--	--
08/08/07	<50	--	--	--	--	--	--	--	--	--	--	--	--
11/07/07	<50	--	--	--	--	--	--	--	--	--	--	--	--
02/13/08	<50	--	--	--	--	--	--	--	--	--	--	--	--
05/14/08	<50	--	--	--	--	--	--	--	--	--	--	--	--
B-11													
07/29/98	--	460,000	1,100	33,000	18,000	--	--	--	--	--	--	--	--
08/14/03	<5,000	--	--	--	--	--	--	--	--	--	--	--	--
11/13/03	<1,000	--	--	--	--	--	--	--	--	--	--	--	--
02/12/04	<2,500	--	--	--	--	--	--	--	--	--	--	--	--

Table 2
Groundwater Analytical Results
Chevron Service Station #9-0290
1802 Webster Street
Alameda, California

WELL ID/ DATE	Ethanol (ppb)	Alkalinity (ppb)	Ferrous Iron (ppb)	Nitrate as Nitrate (ppb)	Sulfate (ppb)	EPA 8010B (ppb)	EPA 8270B (ppb)	Cadmium (ppb)	Chromium (ppb)	Lead (ppb)	Nickel (ppb)	Zinc (ppb)	Motor Oil (ppb)
B-11 (cont)													
05/13/04	<1,300	--	--	--	--	--	--	--	--	--	--	--	--
08/12/04	<1,000	--	--	--	--	--	--	--	--	--	--	--	--
11/11/04	<1,000	--	--	--	--	--	--	--	--	--	--	--	--
02/10/05	<2,500	--	--	--	--	--	--	--	--	--	--	--	--
05/12/05	<2,500	--	--	--	--	--	--	--	--	--	--	--	--
08/11/05	<2,500	--	--	--	--	--	--	--	--	--	--	--	--
11/10/05	<50	--	--	--	--	--	--	--	--	--	--	--	--
02/09/06	<250	--	--	--	--	--	--	--	--	--	--	--	--
05/11/06	<500	--	--	--	--	--	--	--	--	--	--	--	--
08/10/06	<2,500	--	--	--	--	--	--	--	--	--	--	--	--
11/09/06	<250	--	--	--	--	--	--	--	--	--	--	--	--
02/08/07	<1,000	--	--	--	--	--	--	--	--	--	--	--	--
05/10/07	<500	--	--	--	--	--	--	--	--	--	--	--	--
08/08/07	<2,500	--	--	--	--	--	--	--	--	--	--	--	--
11/07/07	<50	--	--	--	--	--	--	--	--	--	--	--	--
02/13/08	<250	--	--	--	--	--	--	--	--	--	--	--	--
05/14/08	<1,000	--	--	--	--	--	--	--	--	--	--	--	--
B-12													
07/29/98	--	700,000	450	<1,000	27,000	--	--	--	--	--	--	--	--
05/06/99	--	--	--	--	--	<5.0-<10	<10-<50	<10	86.7	<75	143	185	--
08/14/03	<50	--	--	--	--	--	--	--	--	--	--	--	--
11/13/03	<50	--	--	--	--	--	--	--	--	--	--	--	--
02/12/04	<50	--	--	--	--	--	--	--	--	--	--	--	--
05/13/04	<50	--	--	--	--	--	--	--	--	--	--	--	--
08/12/04	<50	--	--	--	--	--	--	--	--	--	--	--	--
11/11/04	<50	--	--	--	--	--	--	--	--	--	--	--	--
02/10/05	<50	--	--	--	--	--	--	--	--	--	--	--	--
05/12/05	<50	--	--	--	--	--	--	--	--	--	--	--	--
08/11/05	<50	--	--	--	--	--	--	--	--	--	--	--	--
11/10/05	<50	--	--	--	--	--	--	--	--	--	--	--	--
02/09/06	<50	--	--	--	--	--	--	--	--	--	--	--	--
05/11/06	<50	--	--	--	--	--	--	--	--	--	--	--	--
08/10/06	<50	--	--	--	--	--	--	--	--	--	--	--	--

Table 2
Groundwater Analytical Results
Chevron Service Station #9-0290
1802 Webster Street
Alameda, California

WELL ID/ DATE	Ethanol (ppb)	Alkalinity (ppb)	Ferrous Iron (ppb)	Nitrate as Nitrate (ppb)	Sulfate (ppb)	EPA 8010B (ppb)	EPA 8270B (ppb)	Cadmium (ppb)	Chromium (ppb)	Lead (ppb)	Nickel (ppb)	Zinc (ppb)	Motor Oil (ppb)
B-12 (cont)													
11/09/06	<50	--	--	--	--	--	--	--	--	--	--	--	--
02/08/07	<50	--	--	--	--	--	--	--	--	--	--	--	--
05/10/07	<50	--	--	--	--	--	--	--	--	--	--	--	--
08/08/07	<50	--	--	--	--	--	--	--	--	--	--	--	--
11/07/07	<50	--	--	--	--	--	--	--	--	--	--	--	--
02/13/08	<50	--	--	--	--	--	--	--	--	--	--	--	--
05/14/08	<50	--	--	--	--	--	--	--	--	--	--	--	--
B-13													
07/29/98	--	290,000	240	5,600	17,000	--	--	--	--	--	--	--	--
08/14/03	<50	--	--	--	--	--	--	--	--	--	--	--	--
11/13/03	<50	--	--	--	--	--	--	--	--	--	--	--	--
02/12/04	<50	--	--	--	--	--	--	--	--	--	--	--	--
05/13/04	<50	--	--	--	--	--	--	--	--	--	--	--	--
08/12/04	<50	--	--	--	--	--	--	--	--	--	--	--	--
11/11/04	<50	--	--	--	--	--	--	--	--	--	--	--	--
02/10/05	<50	--	--	--	--	--	--	--	--	--	--	--	--
05/12/05	<50	--	--	--	--	--	--	--	--	--	--	--	--
08/11/05	<50	--	--	--	--	--	--	--	--	--	--	--	--
11/10/05	<50	--	--	--	--	--	--	--	--	--	--	--	--
02/09/06	<50	--	--	--	--	--	--	--	--	--	--	--	--
05/11/06	<50	--	--	--	--	--	--	--	--	--	--	--	--
08/10/06	<50	--	--	--	--	--	--	--	--	--	--	--	--
11/09/06	<50	--	--	--	--	--	--	--	--	--	--	--	--
02/08/07	<50	--	--	--	--	--	--	--	--	--	--	--	--
05/10/07	<50	--	--	--	--	--	--	--	--	--	--	--	--
08/08/07	<50	--	--	--	--	--	--	--	--	--	--	--	--
11/07/07	<50	--	--	--	--	--	--	--	--	--	--	--	--
02/13/08	<50	--	--	--	--	--	--	--	--	--	--	--	--
05/14/08	<50	--	--	--	--	--	--	--	--	--	--	--	--

Table 2
Groundwater Analytical Results
Chevron Service Station #9-0290
1802 Webster Street
Alameda, California

WELL ID/ DATE	Ethanol (ppb)	Alkalinity (ppb)	Ferrous Iron (ppb)	Nitrate as Nitrate (ppb)	Sulfate (ppb)	EPA 8010B (ppb)	EPA 8270B (ppb)	Cadmium (ppb)	Chromium (ppb)	Lead (ppb)	Nickel (ppb)	Zinc (ppb)	Motor Oil (ppb)
B-14													
05/13/04	<100	--	--	--	--	--	--	--	--	--	--	--	--
08/12/04	<50	--	--	--	--	--	--	--	--	--	--	--	--
11/11/04	<50	--	--	--	--	--	--	--	--	--	--	--	--
02/10/05	<100	--	--	--	--	--	--	--	--	--	--	--	--
05/12/05	<50	--	--	--	--	--	--	--	--	--	--	--	--
08/11/05	<50	--	--	--	--	--	--	--	--	--	--	--	--
11/10/05	<50	--	--	--	--	--	--	--	--	--	--	--	--
02/09/06	<50	--	--	--	--	--	--	--	--	--	--	--	--
05/11/06	<50	--	--	--	--	--	--	--	--	--	--	--	--
08/10/06	<50	--	--	--	--	--	--	--	--	--	--	--	--
11/09/06	<50	--	--	--	--	--	--	--	--	--	--	--	--
02/08/07	<50	--	--	--	--	--	--	--	--	--	--	--	--
05/10/07	<50	--	--	--	--	--	--	--	--	--	--	--	--
08/08/07	<50	--	--	--	--	--	--	--	--	--	--	--	--
11/07/07	<50	--	--	--	--	--	--	--	--	--	--	--	--
02/13/08	<50	--	--	--	--	--	--	--	--	--	--	--	--
05/14/08	<50	--	--	--	--	--	--	--	--	--	--	--	--
B-15													
05/13/04	<50	--	--	--	--	--	--	--	--	--	--	--	--
08/12/04	<50	--	--	--	--	--	--	--	--	--	--	--	--
11/11/04	<50	--	--	--	--	--	--	--	--	--	--	--	--
02/10/05	<50	--	--	--	--	--	--	--	--	--	--	--	--
05/12/05	<50	--	--	--	--	--	--	--	--	--	--	--	--
08/11/05	<50	--	--	--	--	--	--	--	--	--	--	--	--
11/10/05	<50	--	--	--	--	--	--	--	--	--	--	--	--
02/09/06	<50	--	--	--	--	--	--	--	--	--	--	--	--
05/11/06	<50	--	--	--	--	--	--	--	--	--	--	--	--
08/10/06	<50	--	--	--	--	--	--	--	--	--	--	--	--
11/09/06	<50	--	--	--	--	--	--	--	--	--	--	--	--
02/08/07	<50	--	--	--	--	--	--	--	--	--	--	--	--
05/10/07	<50	--	--	--	--	--	--	--	--	--	--	--	--

Table 2
Groundwater Analytical Results
Chevron Service Station #9-0290
1802 Webster Street
Alameda, California

WELL ID/ DATE	Ethanol (ppb)	Alkalinity (ppb)	Ferrous Iron (ppb)	Nitrate as Nitrate (ppb)	Sulfate (ppb)	EPA 8010B (ppb)	EPA 8270B (ppb)	Cadmium (ppb)	Chromium (ppb)	Lead (ppb)	Nickel (ppb)	Zinc (ppb)	Motor Oil (ppb)
B-15 (cont)													
08/08/07	<50	--	--	--	--	--	--	--	--	--	--	--	--
11/07/07	<50	--	--	--	--	--	--	--	--	--	--	--	--
02/13/08	<50	--	--	--	--	--	--	--	--	--	--	--	--
05/14/08	<50	--	--	--	--	--	--	--	--	--	--	--	--

Table 2
Groundwater Analytical Results
Chevron Service Station #9-0290
1802 Webster Street
Alameda, California

EXPLANATIONS:

Groundwater laboratory analytical results prior to August 14, 2003, were compiled from reports prepared by Blaine Tech Services, Inc.

(ppb) = Parts per billion

-- = Not Analyzed

STANDARD OPERATING PROCEDURE - GROUNDWATER SAMPLING

Gettler-Ryan Inc. field personnel adhere to the following procedures for the collection and handling of groundwater samples prior to analysis by the analytical laboratory. Prior to sample collection, the type of analysis to be performed is determined. Loss prevention of volatile compounds is controlled and sample preservation for subsequent analysis is maintained.

Prior to sampling, the presence or absence of free-phase hydrocarbons is determined using an interface probe. Product thickness, if present, is measured to the nearest 0.01 foot and is noted in the field notes. In addition, all depth to water level measurements are collected with a static water level indicator and are also recorded in the field notes, prior to purging and sampling any wells.

After water levels are collected and prior to sampling, if purging is to occur, each well is purged a minimum of three well casing volumes of water using pre-cleaned pumps (stack, suction, Grundfos), or disposable bailers. Temperature, pH and electrical conductivity are measured a minimum of three times during the purging. Purging continues until these parameters stabilize.

Groundwater samples are collected using disposable bailers. The water samples are transferred from the bailer into appropriate containers. Pre-preserved containers, supplied by analytical laboratories, are used when possible. When pre-preserved containers are not available, the laboratory is instructed to preserve the sample as appropriate. Duplicate samples are collected for the laboratory to use in maintaining quality assurance/quality control standards. The samples are labeled to include the job number, sample identification, collection date and time, analysis, preservation (if any), and the sample collector's initials. The water samples are placed in a cooler, maintained at 4°C for transport to the laboratory. Once collected in the field, all samples are maintained under chain of custody until delivered to the laboratory.

The chain of custody document includes the job number, type of preservation, if any, analysis requested, sample identification, date and time collected, and the sample collector's name. The chain of custody is signed and dated (including time of transfer) by each person who receives or surrenders the samples, beginning with the field personnel and ending with the laboratory personnel.

A laboratory supplied trip blank accompanies each sampling set. For sampling sets greater than 20 samples, 5% trip blanks are included. The trip blank is analyzed for some or all of the same compounds as the groundwater samples.

As requested by Chevron Environmental Management Company, the purge water and decontamination water generated during sampling activities is transported by IWM to Chemical Waste Management located in Kettleman Hills, California.



GETTLER - RYAN INC.

WELL MONITORING/SAMPLING FIELD DATA SHEET

Client/Facility#: Chevron #9-0290
 Site Address: 1802 Webster Street
 City: Alameda, CA

Job Number: 385280
 Event Date: 5-14-08 (inclusive)
 Sampler: Joc

Well ID: A-1
 Well Diameter: 6 in.
 Total Depth: 11.15 ft.
 Depth to Water: 4.98 ft.
6.17 x VF 1.52 = 9.25

Date Monitored: 5-14-08

Volume	3/4" = 0.02	1" = 0.04	2" = 0.17	3" = 0.38
Factor (VF)	4" = 0.66	5" = 1.02	6" = 1.50	12" = 5.80

Check if water column is less than 0.50 ft.

Depth to Water w/ 80% Recharge [(Height of Water Column x 0.20) + DTW]: 6.21 gal.
 x3 case volume = Estimated Purge Volume: 28 gal.

Purge Equipment:

Disposable Bailer _____
 Stainless Steel Bailer _____
 Stack Pump _____
 Suction Pump _____
 Grundfos _____
 Peristaltic Pump _____
 QED Bladder Pump _____
 Other: _____

Sampling Equipment:

Disposable Bailer _____
 Pressure Bailer _____
 Discrete Bailer _____
 Peristaltic Pump _____
 QED Bladder Pump _____
 Other: _____

Time Started: _____ (2400 hrs)
 Time Completed: _____ (2400 hrs)
 Depth to Product: _____ ft
 Depth to Water: _____ ft
 Hydrocarbon Thickness: 0 ft
 Visual Confirmation/Description: _____
 Skimmer / Absorbant Sock (circle one)
 Amt Removed from Skimmer: _____ gal
 Amt Removed from Well: _____ gal
 Water Removed: _____
 Product Transferred to: _____

Start Time (purge): 0638 Weather Conditions: clear
 Sample Time/Date: 0715 15-14-08 Water Color: clear Odor: DN
 Approx. Flow Rate: 1 gpm. Sediment Description: _____
 Did well de-water? yes If yes, Time: 0646 Volume: 10 gal. DTW @ Sampling: 6.04

Time (2400 hr.)	Volume (gal.)	pH	Conductivity (µmhos/cm - <u>NS</u>)	Temperature (°C / °F)	D.O. (mg/L)	ORP (mV)
<u>0645</u>	<u>9</u>	<u>6.67</u>	<u>751</u>	<u>15.9</u>		
<u>0646</u>	<u>10</u>					

LABORATORY INFORMATION

SAMPLE ID	(#) CONTAINER	REFRIG.	PRESERV. TYPE	LABORATORY	ANALYSES
A-1	<u>6</u> x vov vial	YES	HCL	LANCASTER	TPH-G(8015)/BTEX+MTBE(8260)/ETHANOL (8260)
	<u>2</u> x 500ml ambers	YES	NP	LANCASTER	TPH-D (8015)

COMMENTS:

Add/Replaced Lock: _____ Add/Replaced Plug: _____ Add/Replaced Bolt: _____



GETTLER-RYAN INC.

WELL MONITORING/SAMPLING FIELD DATA SHEET

Client/Facility#: Chevron #9-0290
 Site Address: 1802 Webster Street
 City: Alameda, CA

Job Number: 385280
 Event Date: 5-14-08 (inclusive)
 Sampler: Joe

Well ID: B-1
 Well Diameter: 2 in.
 Total Depth: 16.12 ft.
 Depth to Water: 5.85 ft.
10.25 x VF 0.17 = 1.74
 Depth to Water w/ 80% Recharge [(Height of Water Column x 0.20) + DTW]: 7.90

Date Monitored: 5-14-08

Volume	3/4"= 0.02	1"= 0.04	2"= 0.17	3"= 0.38
Factor (VF)	4"= 0.66	5"= 1.02	6"= 1.50	12"= 5.80

Check if water column is less than 0.50 ft.

x3 case volume = Estimated Purge Volume: 5.5 gal.

Purge Equipment:
 Disposable Bailer ✓
 Stainless Steel Bailer _____
 Stack Pump _____
 Suction Pump _____
 Grundfos _____
 Peristaltic Pump _____
 QED Bladder Pump _____
 Other: _____

Sampling Equipment:
 Disposable Bailer ✓
 Pressure Bailer _____
 Discrete Bailer _____
 Peristaltic Pump _____
 QED Bladder Pump _____
 Other: _____

Time Started: _____ (2400 hrs)
 Time Completed: _____ (2400 hrs)
 Depth to Product: _____ ft
 Depth to Water: _____ ft
 Hydrocarbon Thickness: 0 ft
 Visual Confirmation/Description: _____
 Skimmer / Absorbant Sock (circle one)
 Amt Removed from Skimmer: _____ gal
 Amt Removed from Well: _____ gal
 Water Removed: _____
 Product Transferred to: _____

Start Time (purge): 0730
 Sample Time/Date: 0805 5-14-08
 Approx. Flow Rate: _____ gpm.
 Did well de-water? _____ If yes, Time: _____

Weather Conditions: clear
 Water Color: clear Odor: ETN
 Sediment Description: _____
 Volume: _____ gal. DTW @ Sampling: 6.59

Time (2400 hr.)	Volume (gal.)	pH	Conductivity (µmhos/cm - (S))	Temperature (° F)	D.O. (mg/L)	ORP (mV)
<u>0742</u>	<u>1.5</u>	<u>6.91</u>	<u>877</u>	<u>15.2</u>	_____	_____
<u>0747</u>	<u>3</u>	<u>6.90</u>	<u>882</u>	<u>14.9</u>	_____	_____
<u>0753</u>	<u>5</u>	<u>6.93</u>	<u>887</u>	<u>14.8</u>	_____	_____

LABORATORY INFORMATION

SAMPLE ID	(#) CONTAINER	REFRIG.	PRESERV. TYPE	LABORATORY	ANALYSES
<u>B-1</u>	<u>6</u> x vva vial	<u>YES</u>	<u>HCL</u>	<u>LANCASTER</u>	<u>TPH-G(8015)/BTEX+MTBE(8260)/ETHANOL (8260)</u>
	<u>x vva vial</u>	<u>YES</u>	<u>HCL</u>	<u>LANCASTER</u>	<u>MTBE(8021)/ETHANOL(8260)</u>
	<u>2</u> x 500ml ambers	<u>YES</u>	<u>NP</u>	<u>LANCASTER</u>	<u>TPH-D (8015)</u>

COMMENTS: _____

Add/Replaced Lock: _____ Add/Replaced Plug: _____ Add/Replaced Bolt: _____



GETTLER-RYAN INC.

WELL MONITORING/SAMPLING FIELD DATA SHEET

Client/Facility#: Chevron #9-0290
 Site Address: 1802 Webster Street
 City: Alameda, CA

Job Number: 385280
 Event Date: 5-14-08 (inclusive)
 Sampler: Joe

Well ID: B-5
 Well Diameter: 2 in.
 Total Depth: 18.15 ft.
 Depth to Water: 4.97 ft.

Date Monitored: 5-14-08

Volume	3/4"= 0.02	1"= 0.04	2"= 0.17	3"= 0.38
Factor (VF)	4"= 0.66	5"= 1.02	6"= 1.50	12"= 5.80

Check if water column is less than 0.50 ft.
 $13.18 \times VF \ 0.17 = 2.24$ x3 case volume = Estimated Purge Volume: 7 gal.
 Depth to Water w/ 80% Recharge [(Height of Water Column x 0.20) + DTW]: 7.60

Purge Equipment:
 Disposable Bailer
 Stainless Steel Bailer _____
 Stack Pump _____
 Suction Pump _____
 Grundfos _____
 Peristaltic Pump _____
 QED Bladder Pump _____
 Other: _____

Sampling Equipment:
 Disposable Bailer
 Pressure Bailer _____
 Discrete Bailer _____
 Peristaltic Pump _____
 QED Bladder Pump _____
 Other: _____

Time Started: _____ (2400 hrs)
 Time Completed: _____ (2400 hrs)
 Depth to Product: _____ ft
 Depth to Water: _____ ft
 Hydrocarbon Thickness: 0 ft
 Visual Confirmation/Description: _____
 Skimmer / Absorbant Sock (circle one)
 Amt Removed from Skimmer: _____ gal
 Amt Removed from Well: _____ gal
 Water Removed: _____
 Product Transferred to: _____

Start Time (purge): 1415
 Sample Time/Date: 1445 15-14-08
 Approx. Flow Rate: 1 gpm.
 Did well de-water? _____ If yes, Time: _____
 Weather Conditions: clear
 Water Color: clear Odor: DN
 Sediment Description: _____
 Volume: _____ gal. DTW @ Sampling: 5.81

Time (2400 hr.)	Volume (gal.)	pH	Conductivity (µmhos/cm - <u>68</u>)	Temperature (°F)	D.O. (mg/L)	ORP (mV)
<u>1424</u>	<u>2.5</u>	<u>6.80</u>	<u>696</u>	<u>16.1</u>	_____	_____
<u>1430</u>	<u>5</u>	<u>6.75</u>	<u>715</u>	<u>15.8</u>	_____	_____
<u>1436</u>	<u>7</u>	<u>6.75</u>	<u>712</u>	<u>16.0</u>	_____	_____

LABORATORY INFORMATION

SAMPLE ID	(#) CONTAINER	REFRIG.	PRESERV. TYPE	LABORATORY	ANALYSES
B-5	6 x vov vial	YES	HCL	LANCASTER	TPH-G(8015)/BTEX+MTBE(8260)/ETHANOL (8260)
	x vov vial	YES	HCL	LANCASTER	MTBE(8021)/ETHANOL(8260)
	2 x 500ml ambers	YES	NP	LANCASTER	TPH-D (8015)

COMMENTS: _____

Add/Replaced Lock: _____ Add/Replaced Plug: _____ Add/Replaced Bolt: _____



GETTLER-RYAN INC.

WELL MONITORING/SAMPLING FIELD DATA SHEET

Client/Facility#: Chevron #9-0290
 Site Address: 1802 Webster Street
 City: Alameda, CA

Job Number: 385280
 Event Date: 5-14-08 (inclusive)
 Sampler: Joe

Well ID: B-6
 Well Diameter: 2 in.
 Total Depth: 18.25 ft.
 Depth to Water: 5.36 ft.
12.89 xVF 0.17 = 2.19

Date Monitored: 5-14-08

Volume	3/4"= 0.02	1"= 0.04	2"= 0.17	3"= 0.38
Factor (VF)	4"= 0.66	5"= 1.02	6"= 1.50	12"= 5.80

Check if water column is less than 0.50 ft.

Depth to Water w/ 80% Recharge [(Height of Water Column x 0.20) + DTW]: 7.793 gal.

Purge Equipment:

Disposable Bailer
 Stainless Steel Bailer _____
 Stack Pump _____
 Suction Pump _____
 Grundfos _____
 Peristaltic Pump _____
 QED Bladder Pump _____
 Other: _____

Sampling Equipment:

Disposable Bailer
 Pressure Bailer _____
 Discrete Bailer _____
 Peristaltic Pump _____
 QED Bladder Pump _____
 Other: _____

Time Started: _____ (2400 hrs)
 Time Completed: _____ (2400 hrs)
 Depth to Product: _____ ft
 Depth to Water: _____ ft
 Hydrocarbon Thickness: 0 ft
 Visual Confirmation/Description: _____
 Skimmer / Absorbant Sock (circle one)
 Amt Removed from Skimmer: _____ gal
 Amt Removed from Well: _____ gal
 Water Removed: _____
 Product Transferred to: _____

Start Time (purge): 1245 Weather Conditions: clear
 Sample Time/Date: 1315 15-14-08 Water Color: clear Odor: DN
 Approx. Flow Rate: _____ gpm. Sediment Description: _____
 Did well de-water? _____ If yes, Time: _____ Volume: _____ gal. DTW @ Sampling: 6.29

Time (2400 hr.)	Volume (gal.)	pH	Conductivity (µmhos/cm - 10°C)	Temperature (°F)	D.O. (mg/L)	ORP (mV)
<u>1254</u>	<u>2</u>	<u>6.57</u>	<u>691</u>	<u>16.6</u>	_____	_____
<u>1259</u>	<u>4</u>	<u>6.68</u>	<u>682</u>	<u>16.4</u>	_____	_____
<u>1305</u>	<u>6.5</u>	<u>6.70</u>	<u>685</u>	<u>16.2</u>	_____	_____

LABORATORY INFORMATION

SAMPLE ID	(#) CONTAINER	REFRIG.	PRESERV. TYPE	LABORATORY	ANALYSES
B-6	6 x vov vial	YES	HCL	LANCASTER	TPH-O(8015)/BTX(MTBE(8260)/ETHANOL(8260))
	6 x vov vial	YES	HCL	LANCASTER	MTBE(8021)/ETHANOL(8260)
	2 x 500ml ambers	YES	NP	LANCASTER	TPH-D (8015)

COMMENTS: _____

Add/Replaced Lock: _____ Add/Replaced Plug: _____ Add/Replaced Bolt: _____



GETTLER-RYAN INC.

WELL MONITORING/SAMPLING FIELD DATA SHEET

Client/Facility#: Chevron #9-0290
 Site Address: 1802 Webster Street
 City: Alameda, CA

Job Number: 385280
 Event Date: 5-14-08 (inclusive)
 Sampler: Joe

Well ID: B-7
 Well Diameter: 2 in.
 Total Depth: 13.25 ft.
 Depth to Water: 4.46 ft.

Date Monitored: 5-14-08

Volume	3/4"= 0.02	1"= 0.04	2"= 0.17	3"= 0.38
Factor (VF)	4"= 0.66	5"= 1.02	6"= 1.50	12"= 5.80

Check if water column is less than 0.50 ft.

Depth to Water w/ 80% Recharge [(Height of Water Column x 0.20) + DTW]: _____
 xVF _____ = _____ x3 case volume = Estimated Purge Volume: _____ gal.

Purge Equipment:
 Disposable Bailer _____
 Stainless Steel Bailer _____
 Stack Pump _____
 Suction Pump _____
 Grundfos _____
 Peristaltic Pump _____
 QED Bladder Pump _____
 Other: _____

Sampling Equipment:
 Disposable Bailer _____
 Pressure Bailer _____
 Discrete Bailer _____
 Peristaltic Pump _____
 QED Bladder Pump _____
 Other: _____

Time Started: _____ (2400 hrs)
 Time Completed: _____ (2400 hrs)
 Depth to Product: _____ ft
 Depth to Water: _____ ft
 Hydrocarbon Thickness: _____ ft
 Visual Confirmation/Description: _____
 Skimmer / Absorbant Sock (circle one)
 Amt Removed from Skimmer: _____ gal
 Amt Removed from Well: _____ gal
 Water Removed: _____
 Product Transferred to: _____

Start Time (purge): _____
 Sample Time/Date: 1
 Approx. Flow Rate: _____ gpm.
 Did well de-water? _____ If yes, Time: _____
 Weather Conditions: _____
 Water Color: _____ Odor: Y / N
 Sediment Description: _____
 Volume: _____ gal. DTW @ Sampling: _____

Time (2400 hr.)	Volume (gal.)	pH	Conductivity (µmhos/cm - µS)	Temperature (C / F)	D.O. (mg/L)	ORP (mV)

LABORATORY INFORMATION

SAMPLE ID	(#) CONTAINER	REFRIG.	PRESERV. TYPE	LABORATORY	ANALYSES
B-	x voa vial	YES	HCL	LANCASTER	TPH-G(8015)/BTEX+MTBE(8260)/ETHANOL (8260)
	x voa vial	YES	HCL	LANCASTER	MTBE(8021)/ETHANOL(8260)
	x 500ml ambers	YES	NP	LANCASTER	TPH-D (8015)

COMMENTS: M. only

Add/Replaced Lock: _____ Add/Replaced Plug: _____ Add/Replaced Bolt: _____



GETTLER-RYAN INC.

WELL MONITORING/SAMPLING FIELD DATA SHEET

Client/Facility#: Chevron #9-0290
 Site Address: 1802 Webster Street
 City: Alameda, CA

Job Number: 385280
 Event Date: 5-14-08 (inclusive)
 Sampler: Joe

Well ID: B-10
 Well Diameter: 2 in.
 Total Depth: 16.24 ft.
 Depth to Water: 5.68 ft.

Date Monitored: 5-14-08

Volume Factor (VF)	3/4"= 0.02	1"= 0.04	2"= 0.17	3"= 0.38
	4"= 0.66	5"= 1.02	6"= 1.50	12"= 5.80

Check if water column is less than 0.50 ft.

Depth to Water w/ 80% Recharge [(Height of Water Column x 0.20) + DTW]: 7.79
 $10.56 \times VF \ 0.17 = 1.79$ x3 case volume = Estimated Purge Volume: 5.5 gal.

Purge Equipment:
 Disposable Bailer
 Stainless Steel Bailer _____
 Stack Pump _____
 Suction Pump _____
 Grundfos _____
 Peristaltic Pump _____
 QED Bladder Pump _____
 Other: _____

Sampling Equipment:
 Disposable Bailer
 Pressure Bailer _____
 Discrete Bailer _____
 Peristaltic Pump _____
 QED Bladder Pump _____
 Other: _____

Time Started: _____ (2400 hrs)
 Time Completed: _____ (2400 hrs)
 Depth to Product: _____ ft
 Depth to Water: _____ ft
 Hydrocarbon Thickness: 0 ft
 Visual Confirmation/Description: _____
 Skimmer / Absorbant Sock (circle one)
 Amt Removed from Skimmer: _____ gal
 Amt Removed from Well: _____ gal
 Water Removed: _____ gal
 Product Transferred to: _____

Start Time (purge): 1105 Weather Conditions: clear
 Sample Time/Date: 1140 5-14-08 Water Color: clear Odor: (C) (D)
 Approx. Flow Rate: _____ gpm. Sediment Description: _____
 Did well de-water? _____ If yes, Time: _____ Volume: _____ gal. DTW @ Sampling: 7.04

Time (2400 hr.)	Volume (gal.)	pH	Conductivity (µmhos/cm - S)	Temperature (C / F)	D.O. (mg/L)	ORP (mV)
<u>1115</u>	<u>1.5</u>	<u>7.10</u>	<u>1212</u>	<u>16.2</u>	_____	_____
<u>1120</u>	<u>3</u>	<u>6.90</u>	<u>1215</u>	<u>16.5</u>	_____	_____
<u>1126</u>	<u>5.5</u>	<u>6.87</u>	<u>1220</u>	<u>16.3</u>	_____	_____

LABORATORY INFORMATION

SAMPLE ID	(#) CONTAINER	REFRIG.	PRESERV. TYPE	LABORATORY	ANALYSES
<u>B-10</u>	<u>6</u> x vva vial	<u>YES</u>	<u>HCL</u>	<u>LANCASTER</u>	<u>TPH-G(8015)/BTEX+MTBE(8260)/ETHANOL (8260)</u>
	<u>x vva vial</u>	<u>YES</u>	<u>HCL</u>	<u>LANCASTER</u>	<u>MTBE(8021)/ETHANOL(8260)</u>
	<u>2</u> x 500ml ambers	<u>YES</u>	<u>NP</u>	<u>LANCASTER</u>	<u>TPH-D (8015)</u>

COMMENTS: Removed roots from well

Add/Replaced Lock: _____ Add/Replaced Plug: _____ Add/Replaced Bolt: _____



GETTLER-RYAN INC.

WELL MONITORING/SAMPLING FIELD DATA SHEET

Client/Facility#: Chevron #9-0290
 Site Address: 1802 Webster Street
 City: Alameda, CA

Job Number: 385280
 Event Date: 5-14-08 (inclusive)
 Sampler: Joe

Well ID: B-11
 Well Diameter: 2 in.
 Total Depth: 15.00 ft.
 Depth to Water: 5.22 ft.
9.78 xVF = 1.66

Date Monitored: 5-14-08

Volume	3/4"= 0.02	1"= 0.04	2"= 0.17	3"= 0.38
Factor (VF)	4"= 0.66	5"= 1.02	6"= 1.50	12"= 5.80

Check if water column is less than 0.50 ft.

Depth to Water w/ 80% Recharge [(Height of Water Column x 0.20) + DTW]: 7.17
 Estimated Purge Volume: 5 gal.

Purge Equipment:
 Disposable Bailer
 Stainless Steel Bailer _____
 Stack Pump _____
 Suction Pump _____
 Grundfos _____
 Peristaltic Pump _____
 QED Bladder Pump _____
 Other: _____

Sampling Equipment:
 Disposable Bailer
 Pressure Bailer _____
 Discrete Bailer _____
 Peristaltic Pump _____
 QED Bladder Pump _____
 Other: _____

Time Started: _____ (2400 hrs)
 Time Completed: _____ (2400 hrs)
 Depth to Product: _____ ft
 Depth to Water: _____ ft
 Hydrocarbon Thickness: 0 ft
 Visual Confirmation/Description: _____
 Skimmer / Absorbant Sock (circle one)
 Amt Removed from Skimmer: _____ gal
 Amt Removed from Well: _____ gal
 Water Removed: _____
 Product Transferred to: _____

Start Time (purge): 1330 Weather Conditions: clear
 Sample Time/Date: 140215-1408 Water Color: clear Odor: 0 N
 Approx. Flow Rate: _____ gpm. Sediment Description: _____
 Did well de-water? If yes, Time: _____ Volume: _____ gal. DTW @ Sampling: 6.24

Time (2400 hr.)	Volume (gal.)	pH	Conductivity (µmhos/cm - µS)	Temperature (C / F)	D.O. (mg/L)	ORP (mV)
<u>1337</u>	<u>2.5</u>	<u>6.54</u>	<u>807</u>	<u>16.2</u>		
<u>1343</u>	<u>3</u>	<u>6.53</u>	<u>761</u>	<u>15.8</u>		
<u>1348</u>	<u>3</u>	<u>6.57</u>	<u>772</u>	<u>16.3</u>		

LABORATORY INFORMATION

SAMPLE ID	(#) CONTAINER	REFRIG.	PRESERV. TYPE	LABORATORY	ANALYSES
<u>B-11</u>	<u>6</u> x voa vial	YES	HCL	LANCASTER	TPH-G(8015)/BTEX+MTBE(8260)/ETHANOL (8260)
	<u>3</u> x voa vial	YES	HCL	LANCASTER	MTBE(8021)/ETHANOL(8260)
	<u>2</u> x 500ml ambers	YES	NP	LANCASTER	TPH-D (8015)

COMMENTS: _____

Add/Replaced Lock: _____ Add/Replaced Plug: _____ Add/Replaced Bolt: _____



GETTLER-RYAN INC.

WELL MONITORING/SAMPLING FIELD DATA SHEET

Client/Facility#: Chevron #9-0290
 Site Address: 1802 Webster Street
 City: Alameda, CA

Job Number: 385280
 Event Date: 5-14-08 (inclusive)
 Sampler: Joe

Well ID: B-12
 Well Diameter: 2 in.
 Total Depth: 15.02 ft.
 Depth to Water: 5.20 ft.

Date Monitored: 5-14-08

Volume	3/4"= 0.02	1"= 0.04	2"= 0.17	3"= 0.38
Factor (VF)	4"= 0.66	5"= 1.02	6"= 1.50	12"= 5.80

Check if water column is less than 0.50 ft.

Depth to Water w/ 80% Recharge [(Height of Water Column x 0.20) + DTW]: 7.16
 $9.82 \times VF 0.17 = 1.67$ x3 case volume = Estimated Purge Volume: 5 gal.

Purge Equipment:

Disposable Bailer
 Stainless Steel Bailer _____
 Stack Pump _____
 Suction Pump _____
 Grundfos _____
 Peristaltic Pump _____
 QED Bladder Pump _____
 Other: _____

Sampling Equipment:

Disposable Bailer
 Pressure Bailer _____
 Discrete Bailer _____
 Peristaltic Pump _____
 QED Bladder Pump _____
 Other: _____

Time Started: _____ (2400 hrs)
 Time Completed: _____ (2400 hrs)
 Depth to Product: _____ ft
 Depth to Water: _____ ft
 Hydrocarbon Thickness: 0 ft
 Visual Confirmation/Description: _____
 Skimmer / Absorbant Sock (circle one)
 Amt Removed from Skimmer: _____ gal
 Amt Removed from Well: _____ gal
 Water Removed: _____
 Product Transferred to: _____

Start Time (purge): 1200
 Sample Time/Date: 1230 5-14-08
 Approx. Flow Rate: _____ gpm.
 Did well de-water? _____ If yes, Time: _____

Weather Conditions: clear
 Water Color: clear Odor: Y/N
 Sediment Description: _____
 Volume: _____ gal. DTW @ Sampling: 5.95

Time (2400 hr.)	Volume (gal.)	pH	Conductivity (µmhos/cm - DS)	Temperature (°F)	D.O. (mg/L)	ORP (mV)
<u>1208</u>	<u>1.5</u>	<u>6.76</u>	<u>697</u>	<u>15.9</u>	_____	_____
<u>1216</u>	<u>3</u>	<u>6.72</u>	<u>710</u>	<u>15.7</u>	_____	_____
<u>1220</u>	<u>3</u>	<u>6.71</u>	<u>718</u>	<u>16.0</u>	_____	_____

LABORATORY INFORMATION

SAMPLE ID	(#) CONTAINER	REFRIG.	PRESERV. TYPE	LABORATORY	ANALYSES
<u>B-12</u>	<u>8</u> x voa vial	YES	HCL	LANCASTER	TPH-G(8015)/BTEX+MTBE(8260)/ETHANOL (8260)
	<u>x voa vial</u>	YES	HCL	LANCASTER	MTBE(8021)/ETHANOL(8260)
	<u>2</u> x 500ml ambers	YES	NP	LANCASTER	TPH-D (8015)

COMMENTS: _____

Add/Replaced Lock: _____ Add/Replaced Plug: _____ Add/Replaced Bolt: _____



GETTLER - RYAN INC.

WELL MONITORING/SAMPLING FIELD DATA SHEET

Client/Facility#: Chevron #9-0290
 Site Address: 1802 Webster Street
 City: Alameda, CA

Job Number: 385280
 Event Date: 5-14-08 (inclusive)
 Sampler: Joe

Well ID: B-13
 Well Diameter: 2 in.
 Total Depth: 13.85 ft.
 Depth to Water: 5.10 ft.
8.75 xVF = 0.17 = 1.49

Date Monitored: 5-14-08

Volume	3/4"= 0.02	1"= 0.04	2"= 0.17	3"= 0.38
Factor (VF)	4"= 0.66	5"= 1.02	6"= 1.50	12"= 5.80

Check if water column is less than 0.50 ft.

x3 case volume = Estimated Purge Volume: 4.5 gal.

Depth to Water w/ 80% Recharge [(Height of Water Column x 0.20) + DTW]: 6.85

Purge Equipment:

Disposable Bailer
 Stainless Steel Bailer _____
 Stack Pump _____
 Suction Pump _____
 Grundfos _____
 Peristaltic Pump _____
 QED Bladder Pump _____
 Other: _____

Sampling Equipment:

Disposable Bailer
 Pressure Bailer _____
 Discrete Bailer _____
 Peristaltic Pump _____
 QED Bladder Pump _____
 Other: _____

Time Started: _____ (2400 hrs)
 Time Completed: _____ (2400 hrs)
 Depth to Product: _____ ft
 Depth to Water: _____ ft
 Hydrocarbon Thickness: 0.5 ft
 Visual Confirmation/Description: _____
 Skimmer / Absorbant Sock (circle one)
 Amt Removed from Skimmer: _____ gal
 Amt Removed from Well: _____ gal
 Water Removed: _____
 Product Transferred to: _____

Start Time (purge): 0910 Weather Conditions: clear
 Sample Time/Date: 0942 5-14-08 Water Color: clear Odor: Y10
 Approx. Flow Rate: 1 gpm. Sediment Description: _____
 Did well de-water? _____ If yes, Time: _____ Volume: _____ gal. DTW @ Sampling: 5.78

Time (2400 hr.)	Volume (gal.)	pH	Conductivity (µmhos/cm - µS)	Temperature (°C / F)	D.O. (mg/L)	ORP (mV)
<u>0918</u>	<u>1.5</u>	<u>7.29</u>	<u>1216</u>	<u>14.8</u>	_____	_____
<u>0924</u>	<u>3</u>	<u>7.30</u>	<u>1221</u>	<u>15.1</u>	_____	_____
<u>0928</u>	<u>4.5</u>	<u>7.24</u>	<u>1197</u>	<u>15.4</u>	_____	_____

LABORATORY INFORMATION

SAMPLE ID	(#) CONTAINER	REFRIG.	PRESERV. TYPE	LABORATORY	ANALYSES
<u>B-13</u>	<u>6</u> x vva vial	YES	HCL	LANCASTER	TPH-G(8015)/BTEX+MTBE(8260)/ETHANOL (8260)
	x vva vial	YES	HCL	LANCASTER	MTBE(8021)/ETHANOL(8260)
	<u>2</u> x 500ml ambers	YES	NP	LANCASTER	TPH-D (8015)

COMMENTS: _____

Add/Replaced Lock: _____ Add/Replaced Plug: _____ Add/Replaced Bolt: _____



GETTLER-RYAN INC.

WELL MONITORING/SAMPLING FIELD DATA SHEET

Client/Facility#: Chevron #9-0290
 Site Address: 1802 Webster Street
 City: Alameda, CA

Job Number: 385280
 Event Date: 5-14-08 (inclusive)
 Sampler: Joe

Well ID: B-14
 Well Diameter: 2 in.
 Total Depth: 16.04 ft.
 Depth to Water: 4.08 ft.
11.96 xVF 0.17 = 2.03

Date Monitored: 5-14-08

Volume	3/4"= 0.02	1"= 0.04	2"= 0.17	3"= 0.38
Factor (VF)	4"= 0.66	5"= 1.02	6"= 1.50	12"= 5.80

Check if water column is less than 0.50 ft.

Depth to Water w/ 80% Recharge [(Height of Water Column x 0.20) + DTW]: 6.47 gal.

Purge Equipment:
 Disposable Bailer
 Stainless Steel Bailer _____
 Stack Pump _____
 Suction Pump _____
 Grundfos _____
 Peristaltic Pump _____
 QED Bladder Pump _____
 Other: _____

Sampling Equipment:
 Disposable Bailer
 Pressure Bailer _____
 Discrete Bailer _____
 Peristaltic Pump _____
 QED Bladder Pump _____
 Other: _____

Time Started: _____ (2400 hrs)
 Time Completed: _____ (2400 hrs)
 Depth to Product: _____ ft
 Depth to Water: _____ ft
 Hydrocarbon Thickness: 0 ft
 Visual Confirmation/Description: _____
 Skimmer / Absorbant Sock (circle one)
 Amt Removed from Skimmer: _____ gal
 Amt Removed from Well: _____ gal
 Water Removed: _____
 Product Transferred to: _____

Start Time (purge): 1005 Weather Conditions: clear
 Sample Time/Date: 1036 5-14-08 Water Color: clear Odor: (D) 1
 Approx. Flow Rate: _____ gpm. Sediment Description: _____
 Did well de-water? _____ If yes, Time: _____ Volume: _____ gal. DTW @ Sampling: 5.75

Time (2400 hr.)	Volume (gal.)	pH	Conductivity (µmhos/cm - <u>µS</u>)	Temperature (°F)	D.O. (mg/L)	ORP (mV)
<u>1014</u>	<u>2</u>	<u>6.90</u>	<u>841</u>	<u>15.7</u>	_____	_____
<u>1020</u>	<u>4</u>	<u>6.80</u>	<u>847</u>	<u>16.3</u>	_____	_____
<u>1025</u>	<u>6</u>	<u>6.82</u>	<u>855</u>	<u>16.0</u>	_____	_____

LABORATORY INFORMATION

SAMPLE ID	(#) CONTAINER	REFRIG.	PRESERV. TYPE	LABORATORY	ANALYSES
<u>B-14</u>	<u>6 x vva vial</u>	<u>YES</u>	<u>HCL</u>	<u>LANCASTER</u>	<u>TPH-G(8015)/BTEX+MTBE(8260)/ETHANOL (8260)</u>
	<u>x-vva vial</u>	<u>YES</u>	<u>HCL</u>	<u>LANCASTER</u>	<u>MTBE(8021)/ETHANOL(8260)</u>
	<u>2x 500ml ambers</u>	<u>YES</u>	<u>NP</u>	<u>LANCASTER</u>	<u>TPH-D (8015)</u>

COMMENTS: _____

Add/Replaced Lock: _____ Add/Replaced Plug: _____ Add/Replaced Bolt: _____



GETTLER-RYAN INC.

WELL MONITORING/SAMPLING FIELD DATA SHEET

Client/Facility#: Chevron #9-0290
 Site Address: 1802 Webster Street
 City: Alameda, CA

Job Number: 385280
 Event Date: 5-14-08 (inclusive)
 Sampler: Joe

Well ID: B-15
 Well Diameter: 2 in.
 Total Depth: 14.17 ft.
 Depth to Water: 3.87 ft.
10.30

Date Monitored: 5-14-08

Volume	3/4"= 0.02	1"= 0.04	2"= 0.17	3"= 0.38
Factor (VF)	4"= 0.66	5"= 1.02	6"= 1.50	12"= 5.80

Check if water column is less than 0.50 ft.
 xVF 0.17 = 1.75 x3 case volume = Estimated Purge Volume: 5.5 gal.

Depth to Water w/ 80% Recharge [(Height of Water Column x 0.20) + DTW]: 5.93

Purge Equipment:
 Disposable Bailer
 Stainless Steel Bailer _____
 Stack Pump _____
 Suction Pump _____
 Grundfos _____
 Peristaltic Pump _____
 QED Bladder Pump _____
 Other: _____

Sampling Equipment:
 Disposable Bailer
 Pressure Bailer _____
 Discrete Bailer _____
 Peristaltic Pump _____
 QED Bladder Pump _____
 Other: _____

Time Started: _____ (2400 hrs)
 Time Completed: _____ (2400 hrs)
 Depth to Product: _____ ft
 Depth to Water: _____ ft
 Hydrocarbon Thickness: 0 ft
 Visual Confirmation/Description: _____
 Skimmer / Absorbant Sock (circle one)
 Amt Removed from Skimmer: _____ gal
 Amt Removed from Well: _____ gal
 Water Removed: _____
 Product Transferred to: _____

Start Time (purge): 0820 Weather Conditions: clear
 Sample Time/Date: 0853/5-14-08 Water Color: clear Odor: Y10
 Approx. Flow Rate: _____ gpm. Sediment Description: _____
 Did well de-water? If yes, Time: _____ Volume: _____ gal. DTW @ Sampling: 5.02

Time (2400 hr.)	Volume (gal.)	pH	Conductivity (µmhos/cm - 15)	Temperature (°F)	D.O. (mg/L)	ORP (mV)
<u>0829</u>	<u>1.5</u>	<u>7.41</u>	<u>1066</u>	<u>15.3</u>	_____	_____
<u>0834</u>	<u>3</u>	<u>7.43</u>	<u>1061</u>	<u>15.7</u>	_____	_____
<u>0840</u>	<u>5.5</u>	<u>7.38</u>	<u>1056</u>	<u>15.1</u>	_____	_____

LABORATORY INFORMATION

SAMPLE ID	(#) CONTAINER	REFRIG.	PRESERV. TYPE	LABORATORY	ANALYSES
<u>B-15</u>	<u>6</u> x vva vial	YES	HCL	LANCASTER	TPH-G(8015)/BTEX+MTBE(8260)/ETHANOL (8260)
	x vva vial	YES	HCL	LANCASTER	MTBE(8021)/ETHANOL(8260)
	<u>2</u> x 500ml ambers	YES	NP	LANCASTER	TPH-D (8015)

COMMENTS: _____

Add/Replaced Lock: _____ Add/Replaced Plug: _____ Add/Replaced Bolt: _____

Chevron California Region Analysis Request/Chain of Custody



051408-07

For Lancaster Laboratories use only
 Acct. #: 10904 Sample # 5361568-78 Group #: 005128
1091392

Facility #: SS#9-0290 QML G-R#385280 Global ID# T0600100307
 Site Address: 1802 WEBSTER STREET, ALAMEDA, CA
 Chevron PM: OS Lead Consultant: CRACE
 Consultant/Office: G-R, Inc., 6747 Sierra Court, Suite J, Dublin, Ca. 94568
 Consultant Prj. Mgr.: Deanna L. Harding (deanna@grinc.com)
 Consultant Phone # 925-551-7555 Fax #: 925-551-7899
 Sampler: JOE AJEMIAN

Analyses Requested

Preservation Codes	
HT	HT
BTEX + MTBE 8260 <input type="checkbox"/> 8021 <input type="checkbox"/>	TPH 8015 MOD GRO <input type="checkbox"/>
TPH 8015 MOD DRO <input type="checkbox"/>	Silica Gel Cleanup <input type="checkbox"/>
8260 full scan	Oxygenates
Total Lead Method	Total Lead Method
Dissolved Lead Method	Dissolved Lead Method
<u>Ethanol (8260)</u>	<u>MTBE (8021)</u>

Preservative Codes

H = HCl T = Thiosulfate
 N = HNO₃ B = NaOH
 S = H₂SO₄ O = Other

J value reporting needed
 Must meet lowest detection limits possible for 8260 compounds

8021 MTBE Confirmation

Confirm highest hit by 8260
 Confirm all hits by 8260
 Run ___ oxy's on highest hit
 Run ___ oxy's on all hits

Sample Identification	Date Collected	Time Collected	Grab	Composite	Soil	Water	Oil <input type="checkbox"/> Air	Total Number of Containers	Analyses Requested				Oxygenates	Total Lead Method	Dissolved Lead Method
									BTEX + MTBE 8260	TPH 8015 MOD GRO	TPH 8015 MOD DRO	8260 full scan			
QA			<input checked="" type="checkbox"/>					2	<input checked="" type="checkbox"/>	<input checked="" type="checkbox"/>					
A-1	5-14-08	0715						8	<input checked="" type="checkbox"/>	<input checked="" type="checkbox"/>	<input checked="" type="checkbox"/>			<input checked="" type="checkbox"/>	
B-1		0805						8	<input checked="" type="checkbox"/>	<input checked="" type="checkbox"/>	<input checked="" type="checkbox"/>			<input checked="" type="checkbox"/>	
B-5		1445						8	<input checked="" type="checkbox"/>	<input checked="" type="checkbox"/>	<input checked="" type="checkbox"/>			<input checked="" type="checkbox"/>	
B-6		1315						8	<input checked="" type="checkbox"/>	<input checked="" type="checkbox"/>	<input checked="" type="checkbox"/>			<input checked="" type="checkbox"/>	<input checked="" type="checkbox"/>
B-10		1140						8	<input checked="" type="checkbox"/>	<input checked="" type="checkbox"/>	<input checked="" type="checkbox"/>			<input checked="" type="checkbox"/>	
B-11		1400						8	<input checked="" type="checkbox"/>	<input checked="" type="checkbox"/>	<input checked="" type="checkbox"/>			<input checked="" type="checkbox"/>	
B-12		1230						8	<input checked="" type="checkbox"/>	<input checked="" type="checkbox"/>	<input checked="" type="checkbox"/>			<input checked="" type="checkbox"/>	
B-13		0942						8	<input checked="" type="checkbox"/>	<input checked="" type="checkbox"/>	<input checked="" type="checkbox"/>			<input checked="" type="checkbox"/>	
B-14		1036						8	<input checked="" type="checkbox"/>	<input checked="" type="checkbox"/>	<input checked="" type="checkbox"/>			<input checked="" type="checkbox"/>	
B-15		0853	<input checked="" type="checkbox"/>					8	<input checked="" type="checkbox"/>	<input checked="" type="checkbox"/>	<input checked="" type="checkbox"/>			<input checked="" type="checkbox"/>	

Comments / Remarks

Turnaround Time Requested (TAT) (please circle) (STD. TAT) 72 hour 48 hour 24 hour 4 day 5 day	Relinquished by: <u>[Signature]</u>	Date	Time	Received by: <u>[Signature]</u>	Date	Time
	Relinquished by: <u>[Signature]</u>	Date	Time	Received by: <u>[Signature]</u>	Date	Time
	Relinquished by: _____	Date	Time	Received by: _____	Date	Time
Data Package Options (please circle if required) QC Summary Type I - Full Type VI (Raw Data) <input type="checkbox"/> Coeff Deliverable not needed EDF/EDD WIP (RWQCB) Disk	Relinquished by Commercial Carrier:	Date	Time	Received by: <u>[Signature]</u>	Date	Time
	UPS FedEx Other <u>[Signature]</u>				5/15/08	0930
	Temperature Upon Receipt <u>0-8-2-6</u> °C	Custody Seals Intact? Yes <input checked="" type="checkbox"/>				

ANALYTICAL RESULTS

Prepared for:

MAY 29 2008

Chevron
6001 Bollinger Canyon Rd L4310
San Ramon CA 94583GETTLER-RYAN INC.
GENERAL CONTRACTORS

925-842-8582

Prepared by:

Lancaster Laboratories
2425 New Holland Pike
Lancaster, PA 17605-2425SAMPLE GROUP

The sample group for this submittal is 1091392. Samples arrived at the laboratory on Thursday, May 15, 2008. The PO# for this group is 0015028049 and the release number is SKANCE.

<u>Client Description</u>	<u>Lancaster Labs Number</u>
QA-T-080514 NA Water	5361568
A-1-W-080514 Grab Water	5361569
B-1-W-080514 Grab Water	5361570
B-5-W-080514 Grab Water	5361571
B-6-W-080514 Grab Water	5361572
B-10-W-080514 Grab Water	5361573
B-11-W-080514 Grab Water	5361574
B-12-W-080514 Grab Water	5361575
B-13-W-080514 Grab Water	5361576
B-14-W-080514 Grab Water	5361577
B-15-W-080514 Grab Water	5361578

ELECTRONIC COPY TO CRA c/o Gettler-Ryan

Attn: Cheryl Hansen



Analysis Report

2425 New Holland Pike, PO Box 12425, Lancaster, PA 17605-2425 • 717-656-2300 Fax: 717-656-2681 • www.lancasterlabs.com

Questions? Contact your Client Services Representative
Angela M Miller at (717) 656-2300

Respectfully Submitted,

A handwritten signature in black ink that reads "Marla S. Lord".

Marla S. Lord
Senior Specialist



Analysis Report

2425 New Holland Pike, PO Box 12425, Lancaster, PA 17605-2425 • 717-656-2300 Fax: 717-656-2681 • www.lancasterlabs.com

Page 1 of 1

Lancaster Laboratories Sample No. WW5361568

Group No. 1091392

QA-T-080514 NA Water
Facility# 90290 Job# 385280 GRD
1802 Webster St-Alameda T0600100307 QA
Collected: 05/14/2008

Account Number: 10904

Submitted: 05/15/2008 09:50
Reported: 05/29/2008 at 13:58
Discard: 06/29/2008

Chevron
6001 Bollinger Canyon Rd L4310
San Ramon CA 94583

0290Q

CAT No.	Analysis Name	CAS Number	As Received Result	As Received		Units	Dilution Factor
				Method	Detection Limit		
01728	TPH-GRO - Waters	n.a.	N.D.		50.	ug/l	1
06054	BTEX+MTBE by 8260B						
02010	Methyl Tertiary Butyl Ether	1634-04-4	N.D.		0.5	ug/l	1
05401	Benzene	71-43-2	N.D.		0.5	ug/l	1
05407	Toluene	108-88-3	N.D.		0.5	ug/l	1
05415	Ethylbenzene	100-41-4	N.D.		0.5	ug/l	1
06310	Xylene (Total)	1330-20-7	N.D.		0.5	ug/l	1

State of California Lab Certification No. 2116

All QC is compliant unless otherwise noted. Please refer to the Quality Control Summary for overall QC performance data and associated samples.

Laboratory Chronicle

CAT No.	Analysis Name	Method	Trial#	Analysis		Analyst	Dilution Factor
				Date and Time			
01728	TPH-GRO - Waters	SW-846 8015B modified	1	05/23/2008	10:44	Steven A Skiles	1
06054	BTEX+MTBE by 8260B	SW-846 8260B	1	05/22/2008	06:04	Michael A Ziegler	1
01146	GC VOA Water Prep	SW-846 5030B	1	05/23/2008	10:44	Steven A Skiles	1
01163	GC/MS VOA Water Prep	SW-846 5030B	1	05/22/2008	06:04	Michael A Ziegler	1



Analysis Report

2425 New Holland Pike, PO Box 12425, Lancaster, PA 17605-2425 • 717-656-2300 Fax: 717-656-2681 • www.lancasterlabs.com

Lancaster Laboratories Sample No. WW5361569

Group No. 1091392

A-1-W-080514 Grab Water
 Facility# 90290 Job# 385280 GRD
 1802 Webster St-Alameda T0600100307 A-1
 Collected: 05/14/2008 07:15 by JA

Account Number: 10904

Submitted: 05/15/2008 09:50
 Reported: 05/29/2008 at 13:58
 Discard: 06/29/2008

Chevron
 6001 Bollinger Canyon Rd L4310
 San Ramon CA 94583

290A1

CAT No.	Analysis Name	CAS Number	As Received Result	As Received		Dilution Factor
				Method	Units	
01728	TPH-GRO - Waters	n.a.	1,500.	50.	ug/l	1
06609	TPH-DRO (Waters)	n.a.	5,200.	150.	ug/l	5
06067	BTEX, MTBE, ETOH					
01587	Ethanol	64-17-5	N.D.	50.	ug/l	1
02010	Methyl Tertiary Butyl Ether	1634-04-4	2.	0.5	ug/l	1
05401	Benzene	71-43-2	N.D.	0.5	ug/l	1
05407	Toluene	108-88-3	N.D.	0.5	ug/l	1
05415	Ethylbenzene	100-41-4	N.D.	0.5	ug/l	1
06310	Xylene (Total)	1330-20-7	3.	0.5	ug/l	1

State of California Lab Certification No. 2116

All QC is compliant unless otherwise noted. Please refer to the Quality Control Summary for overall QC performance data and associated samples.

Laboratory Chronicle

CAT No.	Analysis Name	Method	Analysis		Analyst	Dilution Factor
			Trial#	Date and Time		
01728	TPH-GRO - Waters	SW-846 8015B modified	1	05/23/2008 11:43	Steven A Skiles	1
06609	TPH-DRO (Waters)	SW-846 8015B	1	05/21/2008 03:34	Heather E Williams	5
06067	BTEX, MTBE, ETOH	SW-846 8260B	1	05/24/2008 00:52	Michael A Ziegler	1
01146	GC VOA Water Prep	SW-846 5030B	1	05/23/2008 11:43	Steven A Skiles	1
01163	GC/MS VOA Water Prep	SW-846 5030B	1	05/24/2008 00:52	Michael A Ziegler	1
02376	Extraction - Fuel/TPH (Waters)	SW-846 3510C	1	05/19/2008 01:45	Roman Kuropatkin	1

Lancaster Laboratories Sample No. WW5361570

Group No. 1091392

 B-1-W-080514 Grab Water
 Facility# 90290 Job# 385280 GRD
 1802 Webster St-Alameda T0600100307 B-1
 Collected: 05/14/2008 08:05 by JA

Account Number: 10904

 Submitted: 05/15/2008 09:50
 Reported: 05/29/2008 at 13:58
 Discard: 06/29/2008

 Chevron
 6001 Bollinger Canyon Rd L4310
 San Ramon CA 94583

290B1

CAT No.	Analysis Name	CAS Number	As Received	As Received	Units	Dilution Factor
			Result	Method		
01728	TPH-GRO - Waters	n.a.	N.D.	50.	ug/l	1
06609	TPH-DRO (Waters)	n.a.	200.	50.	ug/l	1
DRO was detected in the method blank at a concentration of 60 ug/l. Results from the reextraction are within the limits. The hold time had expired prior to the reextraction so all results are reported from the original extract. Similar results were obtained in both extracts.						
06067	BTEX, MTBE, ETOH					
01587	Ethanol	64-17-5	N.D.	50.	ug/l	1
02010	Methyl Tertiary Butyl Ether	1634-04-4	1.	0.5	ug/l	1
05401	Benzene	71-43-2	N.D.	0.5	ug/l	1
05407	Toluene	108-88-3	N.D.	0.5	ug/l	1
05415	Ethylbenzene	100-41-4	N.D.	0.5	ug/l	1
06310	Xylene (Total)	1330-20-7	N.D.	0.5	ug/l	1

State of California Lab Certification No. 2116

All QC is compliant unless otherwise noted. Please refer to the Quality Control Summary for overall QC performance data and associated samples.

Laboratory Chronicle

CAT No.	Analysis Name	Method	Trial#	Analysis		Analyst	Dilution Factor
				Date	Time		
01728	TPH-GRO - Waters	SW-846 8015B modified	1	05/23/2008	12:53	Steven A Skiles	1
06609	TPH-DRO (Waters)	SW-846 8015B	1	05/20/2008	23:13	Heather E Williams	1
06067	BTEX, MTBE, ETOH	SW-846 8260B	1	05/24/2008	01:16	Michael A Ziegler	1
01146	GC VOA Water Prep	SW-846 5030B	1	05/23/2008	12:53	Steven A Skiles	1
01163	GC/MS VOA Water Prep	SW-846 5030B	1	05/24/2008	01:16	Michael A Ziegler	1
02376	Extraction - Fuel/TPH (Waters)	SW-846 3510C	1	05/19/2008	01:45	Roman Kuropatkin	1



Analysis Report

2425 New Holland Pike, PO Box 12425, Lancaster, PA 17605-2425 • 717-656-2300 Fax: 717-656-2681 • www.lancasterlabs.com

Lancaster Laboratories Sample No. WW5361571

Group No. 1091392

B-5-W-080514 Grab Water
Facility# 90290 Job# 385280 GRD
1802 Webster St-Alameda T0600100307 B-5
Collected: 05/14/2008 14:45 by JA

Account Number: 10904

Submitted: 05/15/2008 09:50
Reported: 05/29/2008 at 13:58
Discard: 06/29/2008

Chevron
6001 Bollinger Canyon Rd L4310
San Ramon CA 94583

290B5

CAT No.	Analysis Name	CAS Number	As Received	As Received	Units	Dilution Factor
			Result	Method Detection Limit		
01728	TPH-GRO - Waters	n.a.	N.D.	50.	ug/l	1
06609	TPH-DRO (Waters)	n.a.	4,600.	140.	ug/l	5
06067	BTEX, MTBE, ETOH					
01587	Ethanol	64-17-5	N.D.	50.	ug/l	1
02010	Methyl Tertiary Butyl Ether	1634-04-4	97.	0.5	ug/l	1
05401	Benzene	71-43-2	N.D.	0.5	ug/l	1
05407	Toluene	108-88-3	N.D.	0.5	ug/l	1
05415	Ethylbenzene	100-41-4	N.D.	0.5	ug/l	1
06310	Xylene (Total)	1330-20-7	N.D.	0.5	ug/l	1

State of California Lab Certification No. 2116

All QC is compliant unless otherwise noted. Please refer to the Quality Control Summary for overall QC performance data and associated samples.

Laboratory Chronicle

CAT No.	Analysis Name	Method	Trial#	Analysis		Analyst	Dilution Factor
				Date	Time		
01728	TPH-GRO - Waters	SW-846 8015B modified	1	05/23/2008	13:22	Steven A Skiles	1
06609	TPH-DRO (Waters)	SW-846 8015B	1	05/21/2008	03:52	Heather E Williams	5
06067	BTEX, MTBE, ETOH	SW-846 8260B	1	05/24/2008	01:40	Michael A Ziegler	1
01146	GC VOA Water Prep	SW-846 5030B	1	05/23/2008	13:22	Steven A Skiles	1
01163	GC/MS VOA Water Prep	SW-846 5030B	1	05/24/2008	01:40	Michael A Ziegler	1
02376	Extraction - Fuel/TPH (Waters)	SW-846 3510C	1	05/19/2008	01:45	Roman Kuropatkin	1



Analysis Report

2425 New Holland Pike, PO Box 12425, Lancaster, PA 17605-2425 • 717-656-2300 Fax: 717-656-2681 • www.lancasterlabs.com

Page 1 of 1

Lancaster Laboratories Sample No. WW5361572

Group No. 1091392

B-6-W-080514 Grab Water
 Facility# 90290 Job# 385280 GRD
 1802 Webster St-Alameda T0600100307 B-6
 Collected: 05/14/2008 13:15 by JA

Account Number: 10904

Submitted: 05/15/2008 09:50
 Reported: 05/29/2008 at 13:58
 Discard: 06/29/2008

Chevron
 6001 Bollinger Canyon Rd L4310
 San Ramon CA 94583

290B6

CAT No.	Analysis Name	CAS Number	As Received Result	As Received Method Detection Limit	Units	Dilution Factor
06609	TPH-DRO (Waters) DRO was detected in the method blank at a concentration of 60 ug/l. Results from the reextraction are within the limits. The hold time had expired prior to the reextraction so all results are reported from the original extract. Similar results were obtained in both extracts.	n.a.	94.	50.	ug/l	1
02159	BTEX, MTBE					
02172	Methyl tert-Butyl Ether	1634-04-4	680.	2.5	ug/l	1
01594	BTEX+5 Oxygenates+EDC+EDB+ETOH					
01587	Ethanol	64-17-5	N.D.	50.	ug/l	1

State of California Lab Certification No. 2116

All QC is compliant unless otherwise noted. Please refer to the Quality Control Summary for overall QC performance data and associated samples.

Laboratory Chronicle

CAT No.	Analysis Name	Method	Trial#	Analysis Date and Time	Analyst	Dilution Factor
06609	TPH-DRO (Waters)	SW-846 8015B	1	05/20/2008 23:32	Heather E Williams	1
02159	BTEX, MTBE	SW-846 8021B	1	05/19/2008 21:25	Patrick N Evans	1
01594	BTEX+5 Oxygenates+EDC+EDB+ETOH	SW-846 8260B	1	05/25/2008 18:29	Michael A Ziegler	1
01146	GC VOA Water Prep	SW-846 5030B	1	05/19/2008 21:25	Patrick N Evans	1
01163	GC/MS VOA Water Prep	SW-846 5030B	1	05/25/2008 18:29	Michael A Ziegler	1
02376	Extraction - Fuel/TPH (Waters)	SW-846 3510C	1	05/19/2008 01:45	Roman Kurepatkin	1



Analysis Report

2425 New Holland Pike, PO Box 12425, Lancaster, PA 17605-2425 • 717-656-2300 Fax: 717-656-2681 • www.lancasterlabs.com

Page 1 of 1

Lancaster Laboratories Sample No. WW5361573

Group No. 1091392

B-10-W-080514 Grab Water
 Facility# 90290 Job# 385280 GRD
 1802 Webster St-Alameda T0600100307 B-10
 Collected: 05/14/2008 11:40 by JA

Account Number: 10904

Submitted: 05/15/2008 09:50
 Reported: 05/29/2008 at 13:58
 Discard: 06/29/2008

Chevron
 6001 Bollinger Canyon Rd L4310
 San Ramon CA 94583

90B10

CAT No.	Analysis Name	CAS Number	As Received	As Received	Units	Dilution Factor
			Result	Method		
01728	TPH-GRO - Waters	n.a.	N.D.	50.	ug/l	1
06609	TPH-DRO (Waters)	n.a.	140.	50.	ug/l	1
DRO was detected in the method blank at a concentration of 60 ug/l. Results from the reextraction are within the limits. The hold time had expired prior to the reextraction so all results are reported from the original extract. Similar results were obtained in both extracts.						
06067	BTEX, MTBE, ETOH					
01587	Ethanol	64-17-5	N.D.	50.	ug/l	1
02010	Methyl Tertiary Butyl Ether	1634-04-4	6.	0.5	ug/l	1
05401	Benzene	71-43-2	N.D.	0.5	ug/l	1
05407	Toluene	108-88-3	N.D.	0.5	ug/l	1
05415	Ethylbenzene	100-41-4	N.D.	0.5	ug/l	1
06310	Xylene (Total)	1330-20-7	N.D.	0.5	ug/l	1

State of California Lab Certification No. 2116

All QC is compliant unless otherwise noted. Please refer to the Quality Control Summary for overall QC performance data and associated samples.

Laboratory Chronicle

CAT No.	Analysis Name	Method	Trial#	Analysis		Analyst	Dilution Factor
				Date and Time			
01728	TPH-GRO - Waters	SW-846 8015B modified	1	05/23/2008 13:52		Steven A Skiles	1
06609	TPH-DRO (Waters)	SW-846 8015B	1	05/20/2008 23:51		Heather E Williams	1
06067	BTEX, MTBE, ETOH	SW-846 8260B	1	05/22/2008 22:12		Michael A Ziegler	1
01146	GC VOA Water Prep	SW-846 5030B	1	05/23/2008 13:52		Steven A Skiles	1
01163	GC/MS VOA Water Prep	SW-846 5030B	1	05/22/2008 22:12		Michael A Ziegler	1
02376	Extraction - Fuel/TPH (Waters)	SW-846 3510C	1	05/19/2008 01:45		Roman Kuropatkin	1



Analysis Report

2425 New Holland Pike, PO Box 12425, Lancaster, PA 17605-2425 • 717-656-2300 Fax: 717-656-2681 • www.lancasterlabs.com

Lancaster Laboratories Sample No. WW5361574

Group No. 1091392

B-11-W-080514 Grab Water
 Facility# 90290 Job# 385280 GRD
 1802 Webster St-Alameda T0600100307 B-11
 Collected: 05/14/2008 14:00 by JA

Account Number: 10904

Submitted: 05/15/2008 09:50
 Reported: 05/29/2008 at 13:58
 Discard: 06/29/2008

Chevron
 6001 Bollinger Canyon Rd L4310
 San Ramon CA 94583

90B11

CAT No.	Analysis Name	CAS Number	As Received Result	As Received		Dilution Factor
				Method	Units	
01728	TPH-GRO - Waters	n.a.	750.	Detection Limit 50.	ug/l	1
06609	TPH-DRO (Waters)	n.a.	10,000.	150.	ug/l	5
06067	BTEX, MTBE, ETOH					
01587	Ethanol	64-17-5	N.D.	1,000.	ug/l	20
02010	Methyl Tertiary Butyl Ether	1634-04-4	38,000.	100.	ug/l	200
05401	Benzene	71-43-2	N.D.	10.	ug/l	20
05407	Toluene	108-88-3	N.D.	10.	ug/l	20
05415	Ethylbenzene	100-41-4	N.D.	10.	ug/l	20
06310	Xylene (Total)	1330-20-7	N.D.	10.	ug/l	20

State of California Lab Certification No. 2116

All QC is compliant unless otherwise noted. Please refer to the Quality Control Summary for overall QC performance data and associated samples.

Laboratory Chronicle

CAT No.	Analysis Name	Method	Analysis		Analyst	Dilution Factor
			Trial#	Date and Time		
01728	TPH-GRO - Waters	SW-846 8015B modified	1	05/23/2008 14:21	Steven A Skiles	1
06609	TPH-DRO (Waters)	SW-846 8015B	1	05/21/2008 04:11	Heather E Williams	5
06067	BTEX, MTBE, ETOH	SW-846 8260B	1	05/22/2008 23:23	Michael A Ziegler	20
06067	BTEX, MTBE, ETOH	SW-846 8260B	1	05/22/2008 23:46	Michael A Ziegler	200
01146	GC VOA Water Prep	SW-846 5030B	1	05/23/2008 14:21	Steven A Skiles	1
01163	GC/MS VOA Water Prep	SW-846 5030B	1	05/22/2008 23:23	Michael A Ziegler	20
01163	GC/MS VOA Water Prep	SW-846 5030B	2	05/22/2008 23:46	Michael A Ziegler	200
02376	Extraction - Fuel/TPH (Waters)	SW-846 3510C	1	05/19/2008 01:45	Roman Kuropatkin	1

Lancaster Laboratories Sample No. WW5361575

Group No. 1091392

 B-12-W-080514 Grab Water
 Facility# 90290 Job# 385280 GRD
 1802 Webster St-Alameda T0600100307 B-12
 Collected: 05/14/2008 12:30 by JA

Account Number: 10904

 Submitted: 05/15/2008 09:50
 Reported: 05/29/2008 at 13:58
 Discard: 06/29/2008

 Chevron
 6001 Bollinger Canyon Rd L4310
 San Ramon CA 94583

90B12

CAT No.	Analysis Name	CAS Number	As Received Result	As Received		Units	Dilution Factor
				Method	Detection Limit		
01728	TPH-GRO - Waters	n.a.	140.	50.		ug/l	1
06609	TPH-DRO (Waters)	n.a.	100.	50.		ug/l	1
DRO was detected in the method blank at a concentration of 60 ug/l. Results from the reextraction are within the limits. The hold time had expired prior to the reextraction so all results are reported from the original extract. Similar results were obtained in both extracts.							
06067	BTEX, MTBE, ETOH						
01587	Ethanol	64-17-5	N.D.	50.		ug/l	1
02010	Methyl Tertiary Butyl Ether	1634-04-4	2.	0.5		ug/l	1
05401	Benzene	71-43-2	N.D.	0.5		ug/l	1
05407	Toluene	108-88-3	N.D.	0.5		ug/l	1
05415	Ethylbenzene	100-41-4	N.D.	0.5		ug/l	1
06310	Xylene (Total)	1330-20-7	N.D.	0.5		ug/l	1

State of California Lab Certification No. 2116

All QC is compliant unless otherwise noted. Please refer to the Quality Control Summary for overall QC performance data and associated samples.

Laboratory Chronicle

CAT No.	Analysis Name	Method	Trial#	Analysis		Analyst	Dilution Factor
				Date and Time			
01728	TPH-GRO - Waters	SW-846 8015B modified	1	05/23/2008 14:51		Steven A Skiles	1
06609	TPH-DRO (Waters)	SW-846 8015B	1	05/21/2008 00:10		Heather E Williams	1
06067	BTEX, MTBE, ETOH	SW-846 8260B	1	05/23/2008 00:09		Michael A Ziegler	1
01146	GC VOA Water Prep	SW-846 5030B	1	05/23/2008 14:51		Steven A Skiles	1
01163	GC/MS VOA Water Prep	SW-846 5030B	1	05/23/2008 00:09		Michael A Ziegler	1
02376	Extraction - Fuel/TPH (Waters)	SW-846 3510C	1	05/19/2008 01:45		Roman Kuropatkin	1



Analysis Report

2425 New Holland Pike, PO Box 12425, Lancaster, PA 17605-2425 • 717-656-2300 Fax: 717-656-2681 • www.lancasterlabs.com

Page 1 of 1

Lancaster Laboratories Sample No. WW5361576

Group No. 1091392

B-13-W-080514 Grab Water
Facility# 90290 Job# 385280 GRD
1802 Webster St-Alameda T0600100307 B-13
Collected: 05/14/2008 09:42 by JA

Account Number: 10904

Submitted: 05/15/2008 09:50
Reported: 05/29/2008 at 13:58
Discard: 06/29/2008

Chevron
6001 Bollinger Canyon Rd L4310
San Ramon CA 94583

90B13

CAT No.	Analysis Name	CAS Number	As Received Result	As Received		Dilution Factor
				Method	Units	
01728	TPH-GRO - Waters	n.a.	N.D.	Detection Limit 50.	ug/l	1
06609	TPH-DRO (Waters)	n.a.	800.	50.	ug/l	1
06067	BTEX, MTBE, ETOH					
01587	Ethanol	64-17-5	N.D.	50.	ug/l	1
02010	Methyl Tertiary Butyl Ether	1634-04-4	2.	0.5	ug/l	1
05401	Benzene	71-43-2	N.D.	0.5	ug/l	1
05407	Toluene	108-88-3	N.D.	0.5	ug/l	1
05415	Ethylbenzene	100-41-4	N.D.	0.5	ug/l	1
06310	Xylene (Total)	1330-20-7	N.D.	0.5	ug/l	1

State of California Lab Certification No. 2116

All QC is compliant unless otherwise noted. Please refer to the Quality Control Summary for overall QC performance data and associated samples.

Laboratory Chronicle

CAT No.	Analysis Name	Method	Analysis		Analyst	Dilution Factor
			Trial#	Date and Time		
01728	TPH-GRO - Waters	SW-846 8015B modified	1	05/23/2008 17:02	Steven A Skiles	1
06609	TPH-DRO (Waters)	SW-846 8015B	1	05/21/2008 00:29	Heather E Williams	1
06067	BTEX, MTBE, ETOH	SW-846 8260B	1	05/23/2008 00:33	Michael A Ziegler	1
01146	GC VOA Water Prep	SW-846 5030B	1	05/23/2008 17:02	Steven A Skiles	1
01163	GC/MS VOA Water Prep	SW-846 5030B	1	05/23/2008 00:33	Michael A Ziegler	1
02376	Extraction - Fuel/TPH (Waters)	SW-846 3510C	1	05/19/2008 01:45	Roman Kuropatkin	1



Analysis Report

2425 New Holland Pike, PO Box 12425, Lancaster, PA 17605-2425 • 717-656-2300 Fax: 717-656-2681 • www.lancasterlabs.com

Page 1 of 1

Lancaster Laboratories Sample No. WW5361577

Group No. 1091392

B-14-W-080514 Grab Water
 Facility# 90290 Job# 385280 GRD
 1802 Webster St-Alameda T0600100307 B-14
 Collected: 05/14/2008 10:36 by JA

Account Number: 10904

Submitted: 05/15/2008 09:50
 Reported: 05/29/2008 at 13:58
 Discard: 06/29/2008

Chevron
 6001 Bollinger Canyon Rd L4310
 San Ramon CA 94583

90B14

CAT No.	Analysis Name	CAS Number	As Received Result	As Received		Dilution Factor
				Method	Units	
01728	TPH-GRO - Waters	n.a.	N.D.	Detection Limit 50.	ug/l	1
06609	TPH-DRO (Waters)	n.a.	280.	50.	ug/l	1
DRO was detected in the method blank at a concentration of 45 ug/l. Results from the reextraction are within the limits. The hold time had expired prior to the reextraction so all results are reported from the original extract. Similar results were obtained in both extracts.						
06067	BTEX, MTBE, ETOH					
01587	Ethanol	64-17-5	N.D.	50.	ug/l	1
02010	Methyl Tertiary Butyl Ether	1634-04-4	20.	0.5	ug/l	1
05401	Benzene	71-43-2	N.D.	0.5	ug/l	1
05407	Toluene	108-88-3	N.D.	0.5	ug/l	1
05415	Ethylbenzene	100-41-4	N.D.	0.5	ug/l	1
06310	Xylene (Total)	1330-20-7	N.D.	0.5	ug/l	1

State of California Lab Certification No. 2116

All QC is compliant unless otherwise noted. Please refer to the Quality Control Summary for overall QC performance data and associated samples.

Laboratory Chronicle

CAT No.	Analysis Name	Method	Analysis			Dilution Factor
			Trial#	Date and Time	Analyst	
01728	TPH-GRO - Waters	SW-846 8015B modified	1	05/23/2008 17:31	Steven A Skiles	1
06609	TPH-DRO (Waters)	SW-846 8015B	1	05/21/2008 07:01	Heather E Williams	1
06067	BTEX, MTBE, ETOH	SW-846 8260B	1	05/23/2008 00:56	Michael A Ziegler	1
01146	GC VOA Water Prep	SW-846 5030B	1	05/23/2008 17:31	Steven A Skiles	1
01163	GC/MS VOA Water Prep	SW-846 5030B	1	05/23/2008 00:56	Michael A Ziegler	1
02376	Extraction - Fuel/TPH (Waters)	SW-846 3510C	1	05/19/2008 07:00	Tracy L Schickel	1



Analysis Report

2425 New Holland Pike, PO Box 12425, Lancaster, PA 17605-2425 • 717-656-2300 Fax: 717-656-2681 • www.lancasterlabs.com

Page 1 of 1

Lancaster Laboratories Sample No. WW5361578

Group No. 1091392

B-15-W-080514 Grab Water
Facility# 90290 Job# 385280 GRD
1802 Webster St-Alameda T0600100307 B-15
Collected: 05/14/2008 08:53 by JA

Account Number: 10904

Submitted: 05/15/2008 09:50
Reported: 05/29/2008 at 13:58
Discard: 06/29/2008

Chevron
6001 Bollinger Canyon Rd L4310
San Ramon CA 94583

90B15

CAT No.	Analysis Name	CAS Number	As Received	As Received	Units	Dilution Factor
			Result	Method		
01728	TPH-GRO - Waters	n.a.	N.D.	50. Limit	ug/l	1
06609	TPH-DRO (Waters)	n.a.	110.	50. Limit	ug/l	1
DRO was detected in the method blank at a concentration of 45 ug/l. Results from the reextraction are within the limits. The hold time had expired prior to the reextraction so all results are reported from the original extract. The DRO result for the reextraction is ND.						
06067	BTEX, MTBE, ETOH					
01587	Ethanol	64-17-5	N.D.	50.	ug/l	1
02010	Methyl Tertiary Butyl Ether	1634-04-4	N.D.	0.5	ug/l	1
05401	Benzene	71-43-2	N.D.	0.5	ug/l	1
05407	Toluene	108-88-3	N.D.	0.5	ug/l	1
05415	Ethylbenzene	100-41-4	N.D.	0.5	ug/l	1
06310	Xylene (Total)	1330-20-7	N.D.	0.5	ug/l	1

State of California Lab Certification No. 2116

All QC is compliant unless otherwise noted. Please refer to the Quality Control Summary for overall QC performance data and associated samples.

Laboratory Chronicle

CAT No.	Analysis Name	Method	Analysis		Analyst	Dilution Factor
			Trial#	Date and Time		
01728	TPH-GRO - Waters	SW-846 8015B modified	1	05/23/2008 18:01	Steven A Skiles	1
06609	TPH-DRO (Waters)	SW-846 8015B	1	05/21/2008 07:19	Heather E Williams	1
06067	BTEX, MTBE, ETOH	SW-846 8260B	1	05/23/2008 01:19	Michael A Ziegler	1
01146	GC VOA Water Prep	SW-846 5030B	1	05/23/2008 18:01	Steven A Skiles	1
01163	GC/MS VOA Water Prep	SW-846 5030B	1	05/23/2008 01:19	Michael A Ziegler	1
02376	Extraction - Fuel/TPH (Waters)	SW-846 3510C	1	05/19/2008 07:00	Tracy L Schickel	1

Quality Control Summary

 Client Name: Chevron
 Reported: 05/29/08 at 01:58 PM

Group Number: 1091392

Matrix QC may not be reported if site-specific QC samples were not submitted. In these situations, to demonstrate precision and accuracy at a batch level, a LCS/LCSD was performed, unless otherwise specified in the method.

Laboratory Compliance Quality Control

Analysis Name	Blank Result	Blank MDL	Report Units	LCS %REC	LCSD %REC	LCS/LCSD Limits	RPD	RPD Max
Batch number: 081380013A TPH-DRO (Waters)	Sample number(s): 5361569-5361576 60.	29.	ug/l	84	85	63-119	1	20
Batch number: 081380026A TPH-DRO (Waters)	Sample number(s): 5361577-5361578 45.	29.	ug/l	85	84	63-119	1	20
Batch number: 08140A54A Methyl tert-Butyl Ether	Sample number(s): 5361572 N.D.	2.5	ug/l	98	98	82-124	0	30
Batch number: 08143A08A TPH-GRO - Waters	Sample number(s): 5361568-5361571, 5361573-5361578 N.D.	50.	ug/l	91	91	75-135	0	30
Batch number: D081424AA Methyl Tertiary Butyl Ether	Sample number(s): 5361568 N.D.	0.5	ug/l	92		73-119		
Benzene	N.D.	0.5	ug/l	102		78-119		
Toluene	N.D.	0.5	ug/l	105		85-115		
Ethylbenzene	N.D.	0.5	ug/l	105		82-119		
Xylene (Total)	N.D.	0.5	ug/l	106		83-113		
Batch number: D081433AA Ethanol	Sample number(s): 5361573-5361578 N.D.	50.	ug/l	158		31-166		
Methyl Tertiary Butyl Ether	N.D.	0.5	ug/l	93		73-119		
Benzene	N.D.	0.5	ug/l	95		78-119		
Toluene	N.D.	0.5	ug/l	95		85-115		
Ethylbenzene	N.D.	0.5	ug/l	94		82-119		
Xylene (Total)	N.D.	0.5	ug/l	94		83-113		
Batch number: D081464AA Ethanol	Sample number(s): 5361572 N.D.	50.	ug/l	86		31-166		
Batch number: Z081443AA Ethanol	Sample number(s): 5361569-5361571 N.D.	50.	ug/l	100		31-166		
Methyl Tertiary Butyl Ether	N.D.	0.5	ug/l	89		73-119		
Benzene	N.D.	0.5	ug/l	102		78-119		
Toluene	N.D.	0.5	ug/l	105		85-115		
Ethylbenzene	N.D.	0.5	ug/l	101		82-119		
Xylene (Total)	N.D.	0.5	ug/l	100		83-113		

Sample Matrix Quality Control

Unspiked (UNSPK) = the sample used in conjunction with the matrix spike
 Background (BKG) = the sample used in conjunction with the duplicate

Analysis Name	MS %REC	MSD %REC	MS/MSD Limits	RPD	RPD MAX	BKG Conc	DUP Conc	DUP RPD	Dup RPD Max
---------------	---------	----------	---------------	-----	---------	----------	----------	---------	-------------

*- Outside of specification

- (1) The result for one or both determinations was less than five times the LOQ.
- (2) The unspiked result was more than four times the spike added.

Quality Control Summary

 Client Name: Chevron
 Reported: 05/29/08 at 01:58 PM

Group Number: 1091392

Sample Matrix Quality Control

 Unspiked (UNSPK) = the sample used in conjunction with the matrix spike
 Background (BKG) = the sample used in conjunction with the duplicate

Analysis Name	MS %REC	MSD %REC	MS/MSD Limits	RPD RPD	BKG MAX Conc	DUP Conc	DUP RPD	Dup RPD Max
Batch number: 08140A54A Methyl tert-Butyl Ether	84		70-134	UNSPK: P357415				
Batch number: 08143A08A TPH-GRO - Waters	91		63-154	UNSPK: 5361569				
Batch number: D081424AA Methyl Tertiary Butyl Ether	83	97	69-127	15	30			
Benzene	91	109	83-128	17	30			
Toluene	92	109	83-127	18	30			
Ethylbenzene	92	111	82-129	19	30			
Xylene (Total)	93	110	82-130	17	30			
Batch number: D081433AA Ethanol	165*	167*	32-164	1	30			
Methyl Tertiary Butyl Ether	97	91	69-127	5	30			
benzene	103	98	83-128	5	30			
Toluene	105	100	83-127	5	30			
Ethylbenzene	106	99	82-129	6	30			
Xylene (Total)	104	98	82-130	5	30			
Batch number: D081464AA Ethanol	146	136	32-164	7	30			
Batch number: Z081443AA Ethanol	103	104	32-164	1	30			
Methyl Tertiary Butyl Ether	90	87	69-127	3	30			
Benzene	111	107	83-128	4	30			
Toluene	112	107	83-127	4	30			
Ethylbenzene	107	102	82-129	4	30			
Xylene (Total)	104	100	82-130	4	30			

Surrogate Quality Control

Surrogate recoveries which are outside of the QC window are confirmed unless attributed to dilution or otherwise noted on the Analysis Report.

 Analysis Name: TPH-DRO (Waters)
 Batch number: 081380013A
 Orthoterphenyl

5361569	105
5361570	98
5361571	99
5361572	99
5361573	91
5361574	100
5361575	93
5361576	101
Blank	101

*- Outside of specification

- (1) The result for one or both determinations was less than five times the LOQ.
- (2) The unspiked result was more than four times the spike added.

Quality Control Summary

Client Name: Chevron
Reported: 05/29/08 at 01:58 PM

Group Number: 1091392

Surrogate Quality Control

LCS 115
LCSD 117

Limits: 59-131

Analysis Name: TPH-DRO (Waters)
Batch number: 081380026A
Orthoterphenyl

5361577 99
5361578 96
Blank 97
LCS 115
LCSD 112

Limits: 59-131

Analysis Name: BTEX, MTBE
Batch number: 08140A54A

Trifluorotoluene-F Trifluorotoluene-P

5361572	83
Blank	81
LCS	89
LCSD	90
MS	87

Limits: 63-135 69-129

Analysis Name: TPH-GRO - Waters
Batch number: 08143A08A
Trifluorotoluene-F

5361568 88
5361569 83
5361570 93
5361571 96
5361573 89
5361574 101
5361575 89
5361576 91
5361577 91
5361578 92
Blank 92
LCS 99
LCSD 102
MS 96

Limits: 63-135

Analysis Name: BTEX+MTBE by 8260B
Batch number: D081424AA

Dibromofluoromethane 1,2-Dichloroethane-d4 Toluene-d8 4-Bromofluorobenzene

5361568	93	101	104	109
Blank	92	99	103	108
LCS	93	101	101	105
MS	95	102	104	110

*- Outside of specification

- (1) The result for one or both determinations was less than five times the LOQ.
- (2) The unspiked result was more than four times the spike added.

Quality Control Summary

 Client Name: Chevron
 Reported: 05/29/08 at 01:58 PM

Group Number: 1091392

Surrogate Quality Control

MSD	97	103	106	113
Limits:	80-116	77-113	80-113	78-113
Analysis Name: BTEX, MTBE, ETOH Batch number: D081433AA				
	Dibromofluoromethane	1,2-Dichloroethane-d4	Toluene-d8	4-Bromofluorobenzene
5361573	88	95	97	107
5361574	93	101	102	111
5361575	90	98	100	111
5361576	89	94	99	109
5361577	89	96	97	108
5361578	91	98	102	111
Blank	93	100	102	111
LCS	91	99	99	110
MS	93	102	101	113
MSD	89	97	96	107
Limits:	80-116	77-113	80-113	78-113
Analysis Name: BTEX+5 Oxygenates+EDC+EDB+ETOH Batch number: D081464AA				
	Dibromofluoromethane	1,2-Dichloroethane-d4	Toluene-d8	4-Bromofluorobenzene
5361572	92	99	101	103
Blank	91	98	98	99
LCS	97	102	105	109
MS	94	101	101	105
MSD	92	100	100	104
Limits:	80-116	77-113	80-113	78-113
Analysis Name: BTEX, MTBE, ETOH Batch number: Z081443AA				
	Dibromofluoromethane	1,2-Dichloroethane-d4	Toluene-d8	4-Bromofluorobenzene
5361569	91	97	93	86
5361570	90	95	91	85
5361571	91	95	92	85
Blank	89	95	94	86
LCS	88	97	94	89
MS	88	97	93	87
MSD	88	99	93	87
Limits:	80-116	77-113	80-113	78-113

*- Outside of specification

- (1) The result for one or both determinations was less than five times the LOQ.
- (2) The unspiked result was more than four times the spike added.

Lancaster Laboratories Explanation of Symbols and Abbreviations

The following defines common symbols and abbreviations used in reporting technical data:

N.D.	none detected	BMQL	Below Minimum Quantitation Level
TNTC	Too Numerous To Count	MPN	Most Probable Number
IU	International Units	CP Units	cobalt-chloroplatinate units
umhos/cm	micromhos/cm	NTU	nephelometric turbidity units
C	degrees Celsius	F	degrees Fahrenheit
Cal	(diet) calories	lb.	pound(s)
meq	milliequivalents	kg	kilogram(s)
g	gram(s)	mg	milligram(s)
ug	microgram(s)	l	liter(s)
ml	milliliter(s)	ul	microliter(s)
m3	cubic meter(s)	fib >5 um/ml	fibers greater than 5 microns in length per ml
<	less than – The number following the sign is the <u>limit of quantitation</u> , the smallest amount of analyte which can be reliably determined using this specific test.		
>	greater than		
ppm	parts per million – One ppm is equivalent to one milligram per kilogram (mg/kg), or one gram per million grams. For aqueous liquids, ppm is usually taken to be equivalent to milligrams per liter (mg/l), because one liter of water has a weight very close to a kilogram. For gases or vapors, one ppm is equivalent to one microliter of gas per liter of gas.		
ppb	parts per billion		
Dry weight basis	Results printed under this heading have been adjusted for moisture content. This increases the analyte weight concentration to approximate the value present in a similar sample without moisture.		

U.S. EPA data qualifiers:

Organic Qualifiers

A	TIC is a possible aldol-condensation product
B	Analyte was also detected in the blank
C	Pesticide result confirmed by GC/MS
D	Compound quantitated on a diluted sample
E	Concentration exceeds the calibration range of the instrument
J	Estimated value
N	Presumptive evidence of a compound (TICs only)
P	Concentration difference between primary and confirmation columns >25%
U	Compound was not detected
X,Y,Z	Defined in case narrative

Inorganic Qualifiers

B	Value is <CRDL, but ≥IDL
E	Estimated due to interference
M	Duplicate injection precision not met
N	Spike amount not within control limits
S	Method of standard additions (MSA) used for calculation
U	Compound was not detected
W	Post digestion spike out of control limits
*	Duplicate analysis not within control limits
+	Correlation coefficient for MSA <0.995

Analytical test results for methods listed on the laboratories' accreditation scope meet all requirements of NELAC unless otherwise noted under the individual analysis.

Tests results relate only to the sample tested. Clients should be aware that a critical step in a chemical or microbiological analysis is the collection of the sample. Unless the sample analyzed is truly representative of the bulk of material involved, the test results will be meaningless. If you have questions regarding the proper techniques of collecting samples, please contact us. We cannot be held responsible for sample integrity, however, unless sampling has been performed by a member of our staff. This report shall not be reproduced except in full, without the written approval of the laboratory.

WARRANTY AND LIMITS OF LIABILITY – In accepting analytical work, we warrant the accuracy of test results for the sample as submitted. THE FOREGOING EXPRESS WARRANTY IS EXCLUSIVE AND IS GIVEN IN LIEU OF ALL OTHER WARRANTIES, EXPRESSED OR IMPLIED. WE DISCLAIM ANY OTHER WARRANTIES, EXPRESSED OR IMPLIED, INCLUDING A WARRANTY OF FITNESS FOR PARTICULAR PURPOSE AND WARRANTY OF MERCHANTABILITY. IN NO EVENT SHALL LANCASTER LABORATORIES BE LIABLE FOR INDIRECT, SPECIAL, CONSEQUENTIAL, OR INCIDENTAL DAMAGES INCLUDING, BUT NOT LIMITED TO, DAMAGES FOR LOSS OF PROFIT OR GOODWILL REGARDLESS OF (A) THE NEGLIGENCE (EITHER SOLE OR CONCURRENT) OF LANCASTER LABORATORIES AND (B) WHETHER LANCASTER LABORATORIES HAS BEEN INFORMED OF THE POSSIBILITY OF SUCH DAMAGES. We accept no legal responsibility for the purposes for which the client uses the test results. No purchase order or other order for work shall be accepted by Lancaster Laboratories which includes any conditions that vary from the Standard Terms and Conditions of Lancaster Laboratories and we hereby object to any conflicting terms contained in any acceptance or order submitted by client.