



**Chevron**

*A mw maybe required  
~60-80' north of B-7*

May 4, 1999

**Chevron Products Company**  
6001 Bollinger Canyon Road  
Building L, Room 1080  
PO Box 6004  
San Ramon, CA 94583-0904

Ms. Eva Chu  
Alameda County Health Care Services  
Department of Environmental Health  
1131 Harbor Bay Parkway, Suite 250  
Alameda, CA 94502-6577

**Philip R. Briggs**  
Project Manager  
Site Assessment & Remediation  
Phone 925 842-9136  
Fax 925 842-8370

**Re: Chevron Service Station #9-0290  
1802 Webster Street, Alameda, California**

Dear Ms. Chu:

Enclosed is the Fourth Quarter Groundwater Monitoring Report for 1998 that was prepared by our consultant Blaine Tech Services Inc. for the above noted site. Ground water samples were collected and analyzed for TPH-g, TPH-d, BTEX and MtBE constituents.

Monitoring wells A-1, B-1, B-5, B-6, B-7, B-10, B-11, B-12 and B-13 are analyzed for the presence of TPH-g, TPH-d, BTEX and MtBE constituents. Well B-7 is sampled semi-annually in the 1<sup>st</sup> and 3<sup>rd</sup> quarters.

Monitoring well B-7 was below method detection limits for all the constituents. The benzene constituent increased in wells B-6, B-11 and B-12 from the previous sampling event, while decreasing in wells B-1, B-5, B-10 and B-13. The MtBE constituent increased in wells B-1 and B-10, while decreasing in wells B-5, B-6, B-11, B-12 and B-13 from the previous sampling event. Separate phase hydrocarbon (SPH) was detected in monitoring well A-1 and approximately 0.012 gallons was bailed from the well. As noted on the well monitoring data sheet, the SPH was a very thick product.

The result of the TPH-d analysis in all of the wells does not show the presence of diesel constituents but varying presence's of an unidentified hydrocarbon, overlap from a heavy oil range product and overlap from a gasoline range product (refer to the footnotes).

Depth to ground water varied from 4.37 feet to 5.68 feet below grade with a direction of flow northwesterly.

99 MAY -7 AM 9:33

ENVIRONMENTAL  
PROTECTION

May 4, 1999  
Ms. Eva Chu  
Chevron Service Station #9-0290  
Page 2

Your letter of March 24, 1999, requested that a utility survey and risk assessment be conducted on this site. Chevron has authorized Cambria Environmental Technology, Inc. to perform this work. I would expect that the utility study would be completed within sixty days and the risk assessment within ninety days.

You also requested that monitoring well B-12 be sampled for TOG, HVOC's, SVOC's and metals (Cd, Cr, Pb, Ni and Zn) in the next sampling event. This sampling event will be conducted in the 2<sup>nd</sup> quarter.

Chevron will continue to monitor the wells in the sampling frequency as noted above. If you have any questions or comments, call me at (925) 842-9136.

Sincerely,  
**CHEVRON PRODUCTS COMPANY**



Philip R. Briggs  
Site Assessment and Remediation Project Manager

Enclosure

CC. Mr. Bill Scudder, Chevron

Mr. Arnold Cherry  
10 Kelsey Court  
Pleasant Hill, CA 94523

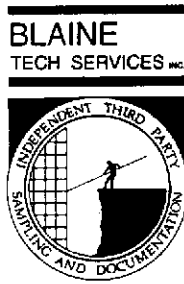

1680 ROGERS AVENUE  
SAN JOSE, CALIFORNIA 95112-1105  
(408) 573-7771 FAX  
(408) 573-0555 PHONE

April 23, 1999

Phil Briggs  
Chevron U.S.A. Products Company  
P.O. Box 6004  
San Ramon, CA 94583-0904

#### **4th Quarter 1998 Monitoring at 9-0290**

Fourth Quarter 1998 Groundwater Monitoring at  
Chevron Service Station Number 9-0290  
1802 Webster Street  
Alameda, CA

Monitoring Performed on November 30, 1998

---

#### **Groundwater Sampling Report 981130-Y-1**

This report covers the routine monitoring of groundwater wells at this Chevron facility. Blaine Tech Services, Inc.'s work at the site includes inspection, gauging, evacuation, purgewater containment, sample collection and sample handling in accordance with standard procedures that conform to Regional Water Quality Control Board requirements.

Routine field data collection includes depth to water, total well depth, thickness of any separate immiscible layer, water column volume, calculated volume of a three-case volume purge, elapsed evacuation time, total volume of water removed, and standard water parameter instrument readings. Sample material is collected, contained, stored, and transported to the laboratory in conformance with EPA standards. Purgewater is, likewise, collected and transported to McKittrick Waste Treatment Site for disposal.

Basic field information is presented alongside analytical values excerpted from the laboratory report in the cumulative table of **WELL DATA AND ANALYTICAL RESULTS**. The full analytical report for the most recent samples is located in the **Analytical Appendix**. The table also contains new groundwater elevation calculations taken from the computer plotted gradient map which is located in the **Professional Engineering Appendix**.

At a minimum, Blaine Tech Services, Inc. field personnel are certified upon completion of a forty-hour Hazardous Materials and Emergency Response training course per 29 CFR 1910.120. Field personnel are also enrolled in annual eight hour refresher courses.

Blaine Tech Services, Inc. conducts sampling and documentation assignments of this type as an independent third party. In order to avoid compromising the objectivity necessary for the proper and disinterested performance of this work, Blaine Tech Services, Inc. concentrates on objective data collection and does not participate in the interpretation of analytical results, the definition of geological or hydrological conditions, the formulation of recommendations, or the marketing of remedial systems.

Please call if you have any questions.

Yours truly,





Christine Lillie  
Project Coordinator

FPT/sb

attachments: Professional Engineering Appendix  
Cumulative Table of Well Data and Analytical Results  
Analytical Appendix  
Field Data Sheets

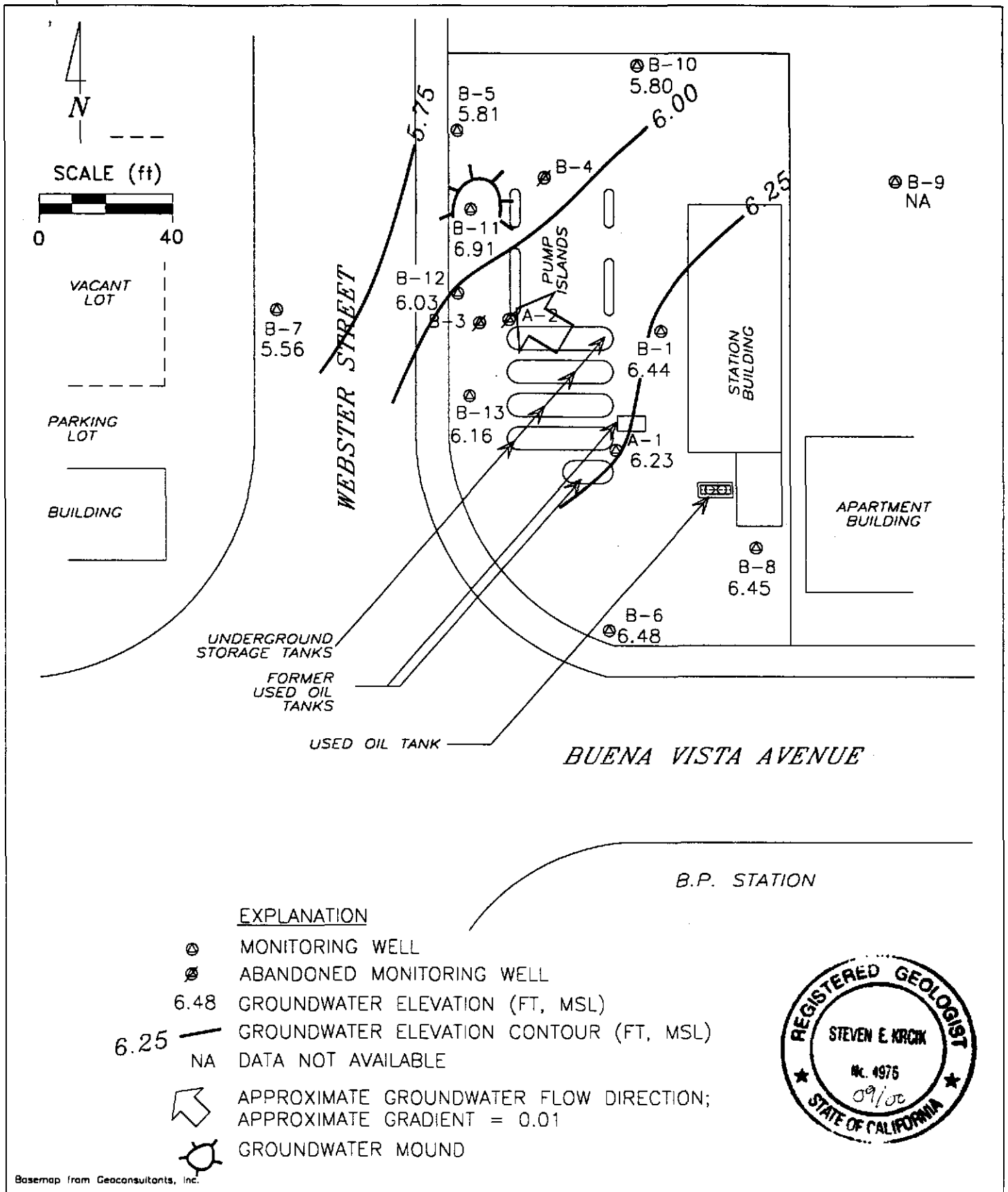
# **Professional Engineering Appendix**



PREPARED BY 	<b>Chevron Station 9-0290</b> 1802 Webster Street Alameda, California <b>GROUNDWATER ELEVATION CONTOUR MAP,</b> <b>NOVEMBER 30, 1998</b>	<b>FIGURE:</b> <b>1</b> <b>PROJECT:</b> <b>DAC04</b>
--	--	---

# **Table of Well Data and Analytical Results**

## Cumulative Table of Well Data and Analytical Results

Vertical Measurements are in feet.

Volumetric Measurements are in gallons.

Analytical results are in parts per billion (ppb)

DATE	Well Head Elev.	Ground Water Elev.	Depth To Water	SPH Thickness	SPH Removed	Total SPH Removed	Notes	TPH- Gasoline	Benzene	Toluene	Ethyl-Benzene	Xylene	TOG	TPH- Diesel	MTBE
<b>A-1</b>															
09/20/91	8.13	0.48	9.23	1.58	--	--	--	--	--	--	--	--	--	--	--
10/09/91	8.13	1.46	6.67	0.00	--	--	--	--	--	--	--	--	--	--	--
10/17/91	8.13	1.43	7.28	0.58	--	--	--	--	--	--	--	--	--	--	--
10/23/91	8.13	1.36	7.42	0.65	--	--	--	--	--	--	--	--	--	--	--
11/01/91	8.13	1.49	7.14	0.50	--	--	--	--	--	--	--	--	--	--	--
11/07/91	8.13	1.50	7.14	0.51	--	--	--	--	--	--	--	--	--	--	--
11/15/91	8.13	1.47	7.19	0.53	--	--	--	--	--	--	--	--	--	--	--
11/21/91	8.13	1.28	7.28	0.54	--	--	--	--	--	--	--	--	--	--	--
12/12/91	8.13	1.29	7.33	0.49	--	--	--	--	--	--	--	--	--	--	--
12/30/91	8.13	1.73	6.76	0.36	--	--	--	--	--	--	--	--	--	--	--
01/13/92	8.13	2.21	6.29	0.37	--	--	--	--	--	--	--	--	--	--	--
01/22/92	8.13	2.15	6.43	0.45	--	--	--	--	--	--	--	--	--	--	--
02/12/92	8.13	2.21	6.30	0.38	--	--	--	--	--	--	--	--	--	--	--
03/09/92	8.13	3.14	5.30	0.31	--	--	--	--	--	--	--	--	--	--	--
04/10/92	8.13	2.83	5.37	0.07	--	--	--	--	--	--	--	--	--	--	--
05/18/92	8.13	2.39	6.14	0.40	--	--	--	--	--	--	--	--	--	--	--
01/06/93	8.13	--	--	--	--	--	--	--	--	--	--	--	--	--	--
02/03/93	8.13	--	--	--	--	--	--	--	--	--	--	--	--	--	--
04/23/93	11.56	6.19	5.85	0.60	--	--	--	--	--	--	--	--	--	--	--
06/11/93	11.56	--	--	--	2.000	2.000	--	--	--	--	--	--	--	--	--
06/15/93	11.56	--	--	--	0.130	2.130	--	--	--	--	--	--	--	--	--
06/18/93	11.56	--	--	--	0.130	2.260	--	--	--	--	--	--	--	--	--
06/22/93	11.56	--	--	--	0.500	2.760	--	--	--	--	--	--	--	--	--
06/29/93	11.56	--	--	--	--	2.760	--	--	--	--	--	--	--	--	--
07/09/93	11.56	--	--	--	--	2.760	--	--	--	--	--	--	--	--	--
07/15/93	11.56	--	--	--	--	2.760	--	--	--	--	--	--	--	--	--
07/19/93	11.56	5.54	6.23	0.26	2.000	4.760	--	--	--	--	--	--	--	--	--
07/20/93	11.56	--	--	--	--	4.760	--	--	--	--	--	--	--	--	--
07/27/93	11.56	--	--	--	--	4.760	--	--	--	--	--	--	--	--	--
08/06/93	11.56	--	--	--	--	4.760	--	--	--	--	--	--	--	--	--
08/10/93	11.56	--	--	--	--	4.760	--	--	--	--	--	--	--	--	--
08/16/93	11.56	--	--	--	--	4.760	--	--	--	--	--	--	--	--	--

CONTINUED ON NEXT PAGE



## Cumulative Table of Well Data and Analytical Results

Vertical Measurements are in feet.

Volumetric Measurements are in gallons.

Analytical results are in parts per billion (ppb)

DATE	Well Head Elev.	Ground Water Elev.	Depth To Water	SPH Thickness	SPH Removed	Total SPH Removed	Notes	TPH- Gasoline	Benzene	Toluene	Ethyl- Benzene	Xylene	TOG	TPH- Diesel	MTBE
<b>A-1 (CONT'D)</b>															
09/16/93	11.56	--	--	--	--	4.760	--	--	--	--	--	--	--	--	--
09/24/93	11.56	--	--	--	--	4.760	--	--	--	--	--	--	--	--	--
10/01/93	11.56	--	--	--	--	4.760	--	--	--	--	--	--	--	--	--
10/07/93	11.56	--	--	--	--	4.760	--	--	--	--	--	--	--	--	--
10/13/93	11.56	--	--	--	--	4.760	--	--	--	--	--	--	--	--	--
10/19/93	11.56	--	--	0.10	--	4.760	--	--	--	--	--	--	--	--	--
10/20/93	11.56	--	--	--	--	4.760	--	--	--	--	--	--	--	--	--
10/28/93	11.56	--	--	--	--	4.760	--	--	--	--	--	--	--	--	--
11/12/93	11.56	--	--	--	--	4.760	--	--	--	--	--	--	--	--	--
11/19/93	11.56	--	--	--	--	4.760	--	--	--	--	--	--	--	--	--
11/30/93	11.56	--	--	--	--	4.760	--	--	--	--	--	--	--	--	--
12/10/93	11.56	--	--	--	--	4.760	--	--	--	--	--	--	--	--	--
12/16/93	11.56	--	--	--	--	4.760	--	--	--	--	--	--	--	--	--
12/23/93	11.56	--	--	--	--	4.760	--	--	--	--	--	--	--	--	--
12/29/93	11.56	--	--	--	--	4.760	--	--	--	--	--	--	--	--	--
01/03/94	11.56	--	--	--	--	4.760	--	--	--	--	--	--	--	--	--
01/17/94	11.56	--	--	--	--	4.760	--	--	--	--	--	--	--	--	--
01/26/94	11.56	--	--	--	--	4.760	--	--	--	--	--	--	--	--	--
02/07/94	11.56	--	--	--	--	4.760	--	--	--	--	--	--	--	--	--
02/11/94	11.56	--	--	--	--	4.760	--	--	--	--	--	--	--	--	--
02/18/94	11.56	--	--	--	--	4.760	--	--	--	--	--	--	--	--	--
02/25/94	11.56	--	--	--	--	4.760	--	--	--	--	--	--	--	--	--
03/04/94	11.56	--	--	--	--	4.760	--	--	--	--	--	--	--	--	--
03/11/94	11.56	--	--	--	--	4.760	--	--	--	--	--	--	--	--	--
03/16/94	11.56	--	--	--	--	4.760	--	--	--	--	--	--	--	--	--
03/25/94	11.56	--	--	--	--	4.760	--	--	--	--	--	--	--	--	--
04/01/94	11.56	--	--	--	--	4.760	--	--	--	--	--	--	--	--	--
08/18/94	11.56	--	--	--	--	4.760	--	--	--	--	--	--	--	--	--
11/30/94	11.56	--	--	--	2.000	6.760	--	--	--	--	--	--	--	--	--
02/15/95	11.56	--	4.79	--	--	6.760	--	--	--	--	--	--	--	--	--
05/01/95	11.56	--	--	--	--	6.760	--	--	--	--	--	--	--	--	--
08/04/95	11.56	--	--	--	--	6.760	--	--	--	--	--	--	--	--	--
11/29/95	11.56	5.24	6.38	0.08	0.026	6.786	--	--	--	--	--	--	--	--	--

CONTINUED ON NEXT PAGE

## Cumulative Table of Well Data and Analytical Results

Vertical Measurements are in feet.

Volumetric Measurements are in gallons.

Analytical results are in parts per billion (ppb)

DATE	Well Head Elev.	Ground Water Elev.	Depth To Water	SPH Thickness	SPH Removed	Total SPH Removed	Notes	TPH- Gasoline	Benzene	Toluene	Ethyl- Benzene	Xylene	TOG	TPH- Diesel	MTBE
<b>A-1 (CONT'D)</b>															
02/08/96	11.56	7.03	4.57	0.05	--	6.790	--	--	--	--	--	--	--	--	--
05/08/96	11.56	6.29	5.49	0.28	--	6.790	--	--	--	--	--	--	--	--	--
08/23/96	11.56	5.31	6.43	0.22	--	6.790	--	--	--	--	--	--	--	--	--
12/12/96	11.56	6.37	5.53	0.42	0.053	6.843	--	--	--	--	--	--	--	--	--
02/10/97	11.56	7.25	4.45	0.17	0.079	6.922	--	--	--	--	--	--	--	--	--
05/01/97	11.56	6.11	5.51	0.08	0.053	6.975	--	--	--	--	--	--	--	--	--
08/05/97	11.56	5.68	5.96	0.10	0.066	7.041	--	--	--	--	--	--	--	--	--
10/28/97	11.56	5.56	6.05	0.06	0.026	7.067	--	--	--	--	--	--	--	--	--
02/04/98	11.56	8.39	3.20	0.04	0.026	7.093	--	--	--	--	--	--	--	--	--
06/03/98	11.56	7.02	4.56	0.03	0.021	7.114	--	--	--	--	--	--	--	--	--
07/29/98	11.56	7.15	4.44	0.04	0.040	7.154	--	--	--	--	--	--	--	--	--
11/30/98	11.56	6.23	5.61	0.35	0.012	7.166	--	--	--	--	--	--	--	--	--

## Cumulative Table of Well Data and Analytical Results

Vertical Measurements are in feet.

Volumetric Measurements are in gallons.

Analytical results are in parts per billion (ppb)

DATE	Well Head Elev.	Ground Water Elev.	Depth To Water	SPH Thickness	SPH Removed	Total SPH Removed	Notes	TPH- Gasoline	Benzene	Toluene	Ethyl- Benzene	Xylene	TOG	TPH- Diesel	MTBE
<b>A-2</b>															
09/20/91	8.00	0.27	7.73	0.00	--	--	--	8100	860	14	110	53	--	5100	--
10/09/91	8.00	1.39	6.61	0.00	--	--	--	--	--	--	--	--	--	--	--
10/17/91	8.00	1.34	6.66	0.00	--	--	--	--	--	--	--	--	--	--	--
10/23/91	8.00	1.29	6.80	0.09	--	--	--	--	--	--	--	--	--	--	--
11/01/91	8.00	1.45	6.63	0.15	--	--	--	--	--	--	--	--	--	--	--
11/07/91	8.00	1.45	6.64	0.21	--	--	--	--	--	--	--	--	--	--	--
11/15/91	8.00	1.38	6.81	0.19	--	--	--	--	--	--	--	--	--	--	--
11/21/91	8.00	1.31	6.93	0.24	--	--	--	--	--	--	--	--	--	--	--
12/12/91	8.00	1.24	6.97	0.15	--	--	--	--	--	--	--	--	--	--	--
12/30/91	8.00	1.70	6.54	0.24	--	--	--	--	--	--	--	--	--	--	--
01/13/92	8.00	2.16	5.92	0.08	--	--	--	--	--	--	--	--	--	--	--
01/22/92	8.00	2.00	6.01	0.10	--	--	--	--	--	--	--	--	--	--	--
02/12/92	8.00	2.20	6.06	0.26	--	--	--	--	--	--	--	--	--	--	--
03/09/92	8.00	3.11	4.93	0.04	--	--	--	--	--	--	--	--	--	--	--
04/10/92	8.00	2.80	5.20	<0.01	--	--	--	--	--	--	--	--	--	--	--
05/18/92	8.00	2.36	5.66	0.02	--	--	--	--	--	--	--	--	--	--	--
01/06/93	8.00	--	--	--	--	--	--	--	--	--	--	--	--	--	--
02/03/93	8.00	3.20	4.98	0.22	--	--	--	--	--	--	--	--	--	--	--
04/23/93	11.46	6.24	5.36	0.18	--	--	--	--	--	--	--	--	--	--	--
06/11/93	11.46	--	--	--	0.13	1.000	--	--	--	--	--	--	--	--	--
06/15/93	11.46	--	--	--	0.13	1.130	--	--	--	--	--	--	--	--	--
06/18/93	11.46	--	--	--	0.26	1.390	--	--	--	--	--	--	--	--	--
06/22/93	11.46	--	--	--	0.50	1.890	--	--	--	--	--	--	--	--	--
06/29/93	11.46	--	--	--	--	1.890	--	--	--	--	--	--	--	--	--
07/09/93	11.46	--	--	--	--	1.890	--	--	--	--	--	--	--	--	--
07/15/93	11.46	--	--	--	--	1.890	--	--	--	--	--	--	--	--	--
07/19/93	11.46	5.53	6.79	1.07	--	1.890	--	--	--	--	--	--	--	--	--
07/20/93	11.46	--	--	--	--	1.890	--	--	--	--	--	--	--	--	--
07/27/93	11.46	--	--	--	--	1.890	--	--	--	--	--	--	--	--	--
08/06/93	11.46	--	--	--	--	1.890	--	--	--	--	--	--	--	--	--
08/10/93	11.46	--	--	--	--	1.890	--	--	--	--	--	--	--	--	--
08/16/93	11.46	--	--	--	--	1.890	--	--	--	--	--	--	--	--	--

CONTINUED ON NEXT PAGE

## Cumulative Table of Well Data and Analytical Results

Vertical Measurements are in feet.

Volumetric Measurements are in gallons.

Analytical results are in parts per billion (ppb)

DATE	Well Head Elev.	Ground Water Elev.	Depth To Water	SPH Thickness	SPH Removed	Total SPH Removed	Notes	TPH-Gasoline	Benzene	Toluene	Ethyl-Benzene	Xylene	TOG	TPH-Diesel	MTBE
<b>A-2 (CONT'D)</b>															
09/16/93	11.46	--	--		--	1.890	--	--	--	--	--	--	--	--	--
09/24/93	11.46	--	--		--	1.890	--	--	--	--	--	--	--	--	--
10/01/93	11.46	--	--		--	1.890	--	--	--	--	--	--	--	--	--
10/07/93	11.46	--	--		--	1.890	--	--	--	--	--	--	--	--	--
10/13/93	11.46	--	--		--	1.890	--	--	--	--	--	--	--	--	--
10/19/93	11.46	6.23	6.36	1.41	--	1.890	--	--	--	--	--	--	--	--	--
10/20/93	11.46	--	--		--	1.890	--	--	--	--	--	--	--	--	--
10/28/93	11.46	--	--		--	1.890	--	--	--	--	--	--	--	--	--
11/12/93	11.46	--	--		--	1.890	--	--	--	--	--	--	--	--	--
11/19/93	11.46	--	--		--	1.890	--	--	--	--	--	--	--	--	--
11/30/93	11.46	--	--		--	1.890	--	--	--	--	--	--	--	--	--
12/10/93	11.46	--	--		--	1.890	--	--	--	--	--	--	--	--	--
12/16/93	11.46	--	--		--	1.890	--	--	--	--	--	--	--	--	--
12/23/93	11.46	--	--		--	1.890	--	--	--	--	--	--	--	--	--
12/29/93	11.46	--	--		--	1.890	--	--	--	--	--	--	--	--	--
01/03/94	11.46	--	--		--	1.890	--	--	--	--	--	--	--	--	--
01/17/94	11.46	--	--		--	1.890	--	--	--	--	--	--	--	--	--
01/26/94	11.46	--	--		--	1.890	--	--	--	--	--	--	--	--	--
02/07/94	11.46	--	--		--	1.890	--	--	--	--	--	--	--	--	--
02/11/94	11.46	--	--		--	1.890	--	--	--	--	--	--	--	--	--
02/18/94	11.46	--	--		--	1.890	--	--	--	--	--	--	--	--	--
02/25/94	11.46	--	--		--	1.890	--	--	--	--	--	--	--	--	--
03/04/94	11.46	--	--		--	1.890	--	--	--	--	--	--	--	--	--
03/11/94	11.46	--	--		--	1.890	--	--	--	--	--	--	--	--	--
03/16/94	11.46	--	--		--	1.890	--	--	--	--	--	--	--	--	--
03/25/94	11.46	--	--		--	1.890	--	--	--	--	--	--	--	--	--
04/01/94	11.46	--	--		--	1.890	Destroyed	--	--	--	--	--	--	--	--

## Cumulative Table of Well Data and Analytical Results

Vertical Measurements are in feet.

Volumetric Measurements are in gallons.

Analytical results are in parts per billion (ppb)

DATE	Well Head Elev.	Ground Water Elev.	Depth To Water	SPH Thickness	SPH Removed	Total SPH Removed	Notes	TPH- Gasoline	Benzene	Toluene	Ethyl- Benzene	Xylene	TOG	TPH- Diesel	MTBE
<b>B-1</b>															
04/23/93	12.12	6.19	5.93	--	--	--	--	13,000	4900	22	250	47	--	8300	--
07/19/93	12.12	5.46	6.66	--	--	--	--	3300	1200	16	24	<30	--	1600	--
10/19/93	12.12	5.04	7.08	--	--	--	--	2300	730	18	14	31	--	550	--
01/17/94	12.12	5.39	6.73	--	--	--	--	22,000	6500	170	210	430	--	<50	--
08/18/94	12.12	5.27	6.85	--	--	--	Inaccessible	--	--	--	--	--	--	--	--
11/30/94	12.12	6.11	6.01	--	--	--	--	1500	250	17	7.5	19	<5.0*	3200**	--
02/15/95	12.12	6.75	5.37	--	--	--	--	1000	160	<2.0	4.6	2.6	--	1300**	--
05/01/95	12.12	7.00	5.12	--	--	--	--	140	20	0.52	2.0	0.67	--	2600***	--
08/04/95	12.12	6.62	5.50	--	--	--	--	6700	1400	<20	<20	<20	--	4900***	--
11/29/95	12.12	6.27	5.85	--	--	--	--	9200	2200	<25	<25	25	--	5000***	8300
02/08/96	12.12	8.12	4.00	--	--	--	--	1500	190	<5.0	<5.0	<5.0	--	1300***	2300
05/08/96	12.12	7.32	4.80	--	--	--	--	3700	650	<10	24	16	--	2900***	2300
08/23/96	12.12	6.58	5.54	--	--	--	--	3200	500	<20	<20	<20	--	2600	4900
12/12/96	12.12	7.22	4.90	--	--	--	--	2500	380	<25	<25	25	--	3400+	8600
02/10/97	12.12	7.53	4.59	--	--	--	--	2200	270	11	8.8	13	--	2100***	3400
05/01/97	12.12	6.46	5.66	--	--	--	--	1200	70	5.8	<5.0	7.2	--	1300***	2000
08/05/97	12.12	5.68	6.44	--	--	--	--	<1000	86	<10	<10	<10	--	1500***	3800
10/28/97	12.12	5.69	6.43	--	--	--	--	1400	73	6.5	6.8	9.0	--	2000***	2900
02/04/98	12.12	9.11	3.01	--	--	--	--	1500	4.5	1.7	<0.5	2.2	--	1200***	1900
02/12/98	12.12	8.33	3.79	--	--	--	--	--	--	--	--	--	--	--	--
06/03/98	12.12	7.23	4.89	--	--	--	--	<50	<0.5	<0.5	<0.5	<0.5	--	970***	1400
07/29/98	12.12	6.37	5.75	--	--	--	++	850	27	<0.5	4.0	2.9	--	1100***	770
07/29/98	12.12	6.37	5.75	--	--	--	Confirmation run	--	--	--	--	--	--	--	1200
11/30/98	12.12	6.44	5.68	--	--	--	--	543	<5.0	<5.0	<5.0	<5.0	--	1490	2220

\* Analytical values are in parts per million (ppm).

\*\* Chromatogram pattern indicates a non-diesel mix.

\*\*\* Chromatogram pattern indicates an unidentified hydrocarbon.

+ Chromatogram pattern indicates an unidentified hydrocarbon and weathered diesel.

++ See Table of Additional Analyses.

## Cumulative Table of Well Data and Analytical Results

Vertical Measurements are in feet.

Volumetric Measurements are in gallons.

Analytical results are in parts per billion (ppb)

DATE	Well Head Elev.	Ground Water Elev.	Depth To Water	SPH Thickness	SPH Removed	Total SPH Removed	Notes	TPH- Gasoline	Benzene	Toluene	Ethyl- Benzene	Xylene	TOG	TPH- Diesel	MTBE
<b>B-3</b>															
09/20/91	8.01	1.08	6.94	0.01	--	--	--	--	--	--	--	--	--	--	--
10/09/91	8.01	1.66	6.35	--	--	--	--	--	--	--	--	--	--	--	--
10/17/91	8.01	1.57	6.44	--	--	--	--	--	--	--	--	--	--	--	--
10/23/91	8.01	1.53	6.84	--	--	--	--	--	--	--	--	--	--	--	--
11/01/91	8.01	1.70	6.31	--	--	--	--	--	--	--	--	--	--	--	--
11/07/91	8.01	1.69	6.32	--	--	--	--	--	--	--	--	--	--	--	--
11/15/91	8.01	1.62	6.39	--	--	--	--	--	--	--	--	--	--	--	--
11/21/91	8.01	1.57	6.44	--	--	--	--	--	--	--	--	--	--	--	--
12/12/91	8.01	1.19	6.82	<0.01	--	--	--	--	--	--	--	--	--	--	--
12/30/91	8.01	1.64	6.37	--	--	--	--	--	--	--	--	--	--	--	--
01/13/92	8.01	2.07	5.94	--	--	--	--	--	--	--	--	--	--	--	--
01/22/92	8.01	2.02	5.99	--	--	--	--	--	--	--	--	--	--	--	--
02/12/92	8.01	2.19	5.82	<0.01	--	--	--	--	--	--	--	--	--	--	--
03/09/92	8.01	2.91	5.10	--	--	--	--	--	--	--	--	--	--	--	--
04/10/92	8.01	2.65	5.36	--	--	--	--	--	--	--	--	--	--	--	--
05/18/92	8.01	2.29	5.72	--	--	--	--	6200	550	58	13	51	<5000	250	--
01/06/93	8.01	2.51	5.50	--	--	--	Sheen	5400	490	54	51	82	--	10,000	--
02/03/93	8.01	--	--	--	--	--	--	--	--	--	--	--	--	--	--
04/23/93	11.42	6.10	5.32	--	--	--	--	18,000	540	69	47	120	--	6400	--
07/29/93	11.42	5.48	5.94	--	--	--	--	40,000	780	69	49	150	--	4000	--
10/19/93	11.42	5.10	6.32	--	--	--	--	20,000	520	37	43	100	--	1500	--
01/17/94	11.42	4.47	6.95	--	--	--	Destroyed	3900	430	32	29	82	--	<50	--

## Cumulative Table of Well Data and Analytical Results

Vertical Measurements are in feet.

Volumetric Measurements are in gallons.

Analytical results are in parts per billion (ppb)

DATE	Well Head Elev.	Ground Water Elev.	Depth To Water	SPH Thickness	SPH Removed	Total SPH Removed	Notes	TPH- Gasoline	Benzene	Toluene	Ethyl- Benzene	Xylene	TOG	TPH- Diesel	MTBE
<b>B-4</b>															
09/20/91	8.04	1.22	6.82	0.01	--	--	--	19,000	710	160	650	2000	--	1400	--
10/09/91	8.04	1.41	6.63	--	--	--	--	--	--	--	--	--	--	--	--
10/17/91	8.04	1.20	6.84	--	--	--	--	--	--	--	--	--	--	--	--
10/23/91	8.04	1.17	6.87	--	--	--	--	--	--	--	--	--	--	--	--
11/01/91	8.04	1.34	6.70	--	--	--	--	--	--	--	--	--	--	--	--
11/07/91	8.04	1.31	6.73	--	--	--	--	--	--	--	--	--	--	--	--
11/15/91	8.04	1.21	6.83	--	--	--	--	--	--	--	--	--	--	--	--
11/21/91	8.04	1.20	6.84	--	--	--	--	--	--	--	--	--	--	--	--
12/12/91	8.04	1.17	6.87	<0.01	--	--	--	--	--	--	--	--	--	--	--
12/30/91	8.04	1.58	6.46	--	--	--	--	--	--	--	--	--	--	--	--
01/13/92	8.04	2.13	5.91	--	--	--	--	--	--	--	--	--	--	--	--
01/22/92	8.04	2.09	5.95	--	--	--	--	--	--	--	--	--	--	--	--
02/12/92	8.04	2.26	5.78	<0.01	--	--	--	15,000	920	75	520	940	--	860	--
03/09/92	8.04	2.95	5.09	--	--	--	--	--	--	--	--	--	--	--	--
04/10/92	8.04	2.65	5.39	--	--	--	--	--	--	--	--	--	--	--	--
05/18/92	8.04	2.45	5.59	--	--	--	--	19,000	2000	97	560	1200	<5000	<50	--
01/06/93	8.04	2.54	5.50	--	--	--	Sheen	19,000	2000	89	490	740	--	2700	--
02/03/93	8.04	--	--	--	--	--	--	--	--	--	--	--	--	--	--
04/23/93	11.46	6.07	5.39	--	--	--	--	5700	2400	75	380	580	--	2300	--
07/19/93	11.46	5.33	6.13	--	--	--	--	19,000	2400	140	440	620	--	2400	--
10/19/93	11.46	4.95	6.51	--	--	--	--	13,000	1200	84	290	530	--	2100	--
01/17/94	11.46	5.28	6.18	--	--	--	Destroyed	11,000	1900	63	170	290	--	<50	--

## Cumulative Table of Well Data and Analytical Results

Vertical Measurements are in feet.

Volumetric Measurements are in gallons.

Analytical results are in parts per billion (ppb)

DATE	Well Head Elev.	Ground Water Elev.	Depth To Water	SPH Thickness	SPH Removed	Total SPH Removed	Notes	TPH- Gasoline	Benzene	Toluene	Ethyl- Benzene	Xylene	TOG	TPH- Diesel	MTBE
<b>B-5</b>															
09/20/91	7.73	2.20	5.53	--	--	--	--	<50	<0.5	<0.5	<0.5	<0.5	--	<50	--
10/09/91	7.73	2.42	5.31	--	--	--	--	--	--	--	--	--	--	--	--
10/17/91	7.73	2.09	5.64	--	--	--	--	--	--	--	--	--	--	--	--
10/23/91	7.73	2.05	5.68	--	--	--	--	--	--	--	--	--	--	--	--
11/01/91	7.73	2.24	5.49	--	--	--	--	--	--	--	--	--	--	--	--
11/07/91	7.73	2.19	5.54	--	--	--	--	--	--	--	--	--	--	--	--
11/15/91	7.73	2.10	5.63	--	--	--	--	--	--	--	--	--	--	--	--
11/21/91	7.73	--	--	--	--	--	--	--	--	--	--	--	--	--	--
12/12/91	7.73	2.05	5.68	--	--	--	--	--	--	--	--	--	--	--	--
12/30/91	7.73	2.54	5.19	--	--	--	--	--	--	--	--	--	--	--	--
01/13/92	7.73	3.07	4.65	--	--	--	--	--	--	--	--	--	--	--	--
01/22/92	7.73	3.03	4.70	--	--	--	--	--	--	--	--	--	--	--	--
02/12/92	7.73	3.38	4.45	--	--	--	--	<50	<0.5	<0.5	<0.5	<0.5	--	<50	--
03/09/92	7.73	3.68	4.05	--	--	--	--	--	--	--	--	--	--	--	--
04/10/92	7.73	3.30	4.43	--	--	--	--	--	--	--	--	--	--	--	--
05/18/92	7.73	3.94	3.79	--	--	--	--	390	39	1.9	11	24	<5000	--	--
01/06/93	7.73	3.39	4.44	--	--	--	Sheen	<50	<0.5	<0.5	<0.5	<0.5	--	<50	--
02/03/93	7.73	--	--	--	--	--	--	--	--	--	--	--	--	--	--
04/23/93	10.18	5.86	4.32	--	--	--	--	<50	<0.5	<0.5	<0.5	<1.5	--	<50	--
07/19/93	10.18	5.15	5.03	--	--	--	--	54	<0.5	0.7	<0.5	<1.5	--	<50	--
10/19/93	10.18	5.08	5.10	--	--	--	--	<50	2.0	4.1	0.6	3.5	--	<50	--
01/07/94	10.18	5.32	4.86	--	--	--	--	<50	<0.5	<0.5	<0.5	<0.5	--	<50	--
08/18/94	10.18	5.04	5.14	--	--	--	--	<50	<0.5	<0.5	<0.5	<0.5	--	<50	--
11/30/94	10.18	5.73	4.45	--	--	--	--	<50	<0.5	<0.5	<0.5	<0.5	--	140*	--
02/15/95	10.18	6.03	4.15	--	--	--	--	<50	<0.5	<0.5	<0.5	<0.5	--	170*	--
05/01/95	10.18	5.75	4.43	--	--	--	--	<50	<0.5	<0.5	<0.5	<0.5	--	190**	--
08/04/95	10.18	5.22	4.96	--	--	--	--	<50	<0.5	<0.5	<0.5	<0.5	--	250**	--
11/29/95	10.18	4.97	5.21	--	--	--	--	140	1.5	<0.5	1.1	<0.5	--	330**	800
02/08/96	10.18	6.38	3.80	--	--	--	--	<200	2.1	<2.0	<2.0	<2.0	--	250**	1100
05/08/96	10.18	5.78	4.40	--	--	--	--	<500	<5.0	<5.0	<5.0	<5.0	--	350**	1400

CONTINUED ON NEXT PAGE

\* Chromagram pattern indicates a non-diesel mix.

\*\* Chromatogram pattern indicates an unidentified hydrocarbon.



## Cumulative Table of Well Data and Analytical Results

Vertical Measurements are in feet.

Volumetric Measurements are in gallons.

Analytical results are in parts per billion (ppb)

DATE	Well Head Elev.	Ground Water Elev.	Depth To Water	SPH Thickness	SPH Removed	Total SPH Removed	Notes	TPH- Gasoline	Benzene	Toluene	Ethyl- Benzene	Xylene	TOG	TPH- Diesel	MTBE
<b>B-5 (CONT'D)</b>															
08/23/96	10.18	5.19	4.99	--	--	--	--	250	6.4	2.1	2.1	4.3	--	990	9300
12/12/96	10.18	5.90	4.28	--	--	--	--	<1000	<10	<10	<10	<10	--	430**	6700
02/10/97	10.18	6.55	3.63	--	--	--	--	<500	<5.0	<5.0	<5.0	<5.0	--	340**	930
05/01/97	10.18	5.87	4.31	--	--	--	--	<500	<5.0	<5.0	<5.0	<5.0	--	290**	1900
08/05/97	10.18	5.29	4.89	--	--	--	--	<1000	<10	<10	<10	<10	--	710**	6800
10/28/97	10.18	5.18	5.00	--	--	--	--	<500	<5.0	<5.0	<5.0	<5.0	--	880**	7000
02/04/98	10.18	7.65	2.53	--	--	--	--	<50	0.51	<0.5	<0.5	<0.5	--	290**	2100
06/03/98	10.18	6.33	3.85	--	--	--	--	220	2.0	15	2.8	20	--	630**	450
07/29/98	10.18	5.63	4.55	--	--	--	*	<50	1.6	<0.5	<0.5	1.6	--	1100**	4600
07/29/98	10.18	5.63	4.55	--	--	--	Confirmation run	--	--	--	--	--	--	--	6200
11/30/98	10.18	5.81	4.37	--	--	--	--	<50	<0.5	1.91	<0.5	1.09	--	371	202

\* See Table of Additional Analyses.

\*\* Chromatogram pattern indicates an unidentified hydrocarbon.

## Cumulative Table of Well Data and Analytical Results

Vertical Measurements are in feet.

Volumetric Measurements are in gallons.

Analytical results are in parts per billion (ppb)

DATE	Well Head Elev.	Ground Water Elev.	Depth To Water	SPH Thickness	SPH Removed	Total SPH Removed	Notes	TPH- Gasoline	Benzene	Toluene	Ethyl- Benzene	Xylene	TOG	TPH- Diesel	MTBE
<b>B-6</b>															
09/20/91	8.55	1.70	6.85	--	--	--	--	<50	<0.5	<0.5	<0.5	<0.5	--	<50	--
10/09/91	8.55	1.72	6.83	--	--	--	--	--	--	--	--	--	--	--	--
10/17/91	8.55	1.65	6.90	--	--	--	--	--	--	--	--	--	--	--	--
10/23/91	8.55	1.62	6.93	--	--	--	--	--	--	--	--	--	--	--	--
11/01/91	8.55	1.77	6.78	--	--	--	--	--	--	--	--	--	--	--	--
11/07/91	8.55	1.74	6.81	--	--	--	--	--	--	--	--	--	--	--	--
11/15/91	8.55	1.67	6.88	--	--	--	--	--	--	--	--	--	--	--	--
11/21/91	8.55	1.60	6.95	--	--	--	--	--	--	--	--	--	--	--	--
12/12/91	8.55	1.41	7.14	--	--	--	--	--	--	--	--	--	--	--	--
12/30/91	8.55	2.05	6.50	--	--	--	--	--	--	--	--	--	--	--	--
01/13/92	8.55	2.36	6.19	--	--	--	--	--	--	--	--	--	--	--	--
01/22/92	8.55	2.28	6.27	--	--	--	--	--	--	--	--	--	--	--	--
02/12/92	8.55	2.43	6.12	--	--	--	--	<50	<0.5	<0.5	<0.5	<0.5	--	<50	--
03/09/92	8.55	3.27	5.28	--	--	--	--	--	--	--	--	--	--	--	--
04/10/92	8.55	3.07	5.48	--	--	--	--	--	--	--	--	--	--	--	--
05/18/92	8.55	2.65	5.90	--	--	--	--	<50	<0.5	<0.5	<0.5	<0.5	<5000	<50	--
01/06/93	8.55	2.76	5.79	--	--	--	--	<50	<0.5	<0.5	<0.5	<0.5	--	<50	--
02/03/93	8.55	--	--	--	--	--	--	--	--	--	--	--	--	--	--
04/23/93	11.97	6.70	5.27	--	--	--	--	<50	<0.5	<0.5	<0.5	<1.5	--	<50	--
07/19/93	11.97	5.06	6.91	--	--	--	--	74	<0.5	<0.5	<0.5	<1.5	--	<50	--
10/19/93	11.97	5.49	6.48	--	--	--	--	<50	<0.5	0.5	<0.5	2.2	--	<50	--
01/07/94	11.97	5.79	6.18	--	--	--	--	<50	<0.5	<0.5	<0.5	<0.5	--	<50	--
08/18/94	11.97	5.77	6.20	--	--	--	--	<50	<0.5	<0.5	<0.5	<0.5	--	<50	--
11/30/94	11.97	6.52	5.45	--	--	--	--	<50	<0.5	<0.5	<0.5	<0.5	--	230*	--
02/15/95	11.97	7.27	4.70	--	--	--	--	<50	<0.5	<0.5	<0.5	<0.5	--	130*	--
05/01/95	11.97	6.94	5.03	--	--	--	--	<50	<0.5	<0.5	<0.5	<0.5	--	97**	--
08/04/95	11.97	6.15	5.82	--	--	--	--	<50	<0.5	<0.5	<0.5	<0.5	--	350**	--
11/29/95	11.97	5.97	6.00	--	--	--	--	--	--	--	--	--	--	200**	--
02/08/96	11.97	7.27	4.70	--	--	--	--	--	--	--	--	--	--	210**	--
05/08/96	11.97	6.74	5.23	--	--	--	--	--	--	--	--	--	--	250**	--

CONTINUED ON NEXT PAGE

\* Chromatogram pattern indicates a non-diesel mix.

\*\* Chromatogram pattern indicates an unidentified hydrocarbon.

## Cumulative Table of Well Data and Analytical Results

Vertical Measurements are in feet.

Volumetric Measurements are in gallons.

Analytical results are in parts per billion (ppb)

DATE	Well Head Elev.	Ground Water Elev.	Depth To Water	SPH Thickness	SPH Removed	Total SPH Removed	Notes	TPH- Gasoline	Benzene	Toluene	Ethyl- Benzene	Xylene	TOG	TPH- Diesel	MTBE
<b>B-6 (CONT'D)</b>															
08/23/96	11.97	5.92	6.05	--	--	--	--	--	--	--	--	--	--	310**	--
12/12/96	11.97	6.65	5.32	--	--	--	--	--	--	--	--	--	--	300**	--
02/10/97	11.97	7.60	4.37	--	--	--	--	--	--	--	--	--	--	130**	360
05/01/97	11.97	6.74	5.23	--	--	--	--	--	--	--	--	--	--	260**	2200
08/05/97	11.97	6.22	5.75	--	--	--	--	--	--	--	--	--	--	260**	1800
10/28/97	11.97	5.89	6.08	--	--	--	--	--	--	--	--	--	--	340**	1900
02/04/98	11.97	9.26	2.71	--	--	--	--	--	--	--	--	--	--	280**	1400
06/03/98	11.97	7.49	4.48	--	--	--	--	--	--	--	--	--	--	130**	1200
07/29/98	11.97	6.69	5.28	--	--	--	--	--	--	--	--	--	--	340**	2700
07/29/98	11.97	6.69	5.28	--	--	--	Confirmation run	--	--	--	--	--	--	--	3000
11/30/98	11.97	6.48	5.49	--	--	--	--	655	<5.0	<5.0	<5.0	<5.0	--	2740	2160

\*\* Chromatogram pattern indicates an unidentified hydrocarbon.

## Cumulative Table of Well Data and Analytical Results

Vertical Measurements are in feet.

Volumetric Measurements are in gallons.

Analytical results are in parts per billion (ppb)

DATE	Well Head Elev.	Ground Water Elev.	Depth To Water	SPH Thickness	SPH Removed	Total SPH Removed	Notes	TPH-Gasoline	Benzene	Toluene	Ethyl-Benzene	Xylene	TOG	TPH-Diesel	MTBE
<b>B-7</b>															
04/23/93	10.54	6.02	4.52	--	--	--	--	<50	<0.5	<0.5	<0.5	<1.5	<50	--	--
07/19/93	10.54	5.50	5.04	--	--	--	--	<50	<0.5	<0.5	<0.5	<1.5	<50	<50	--
10/19/93	10.54	5.14	5.40	--	--	--	--	<50	3.1	0.5	<0.5	0.8	--	<50	--
01/07/94	10.54	5.35	5.19	--	--	--	--	<50	<0.5	<0.5	<0.5	<0.5	--	<50	--
08/18/94	10.54	5.28	5.26	--	--	--	--	<50	<0.5	<0.5	<0.5	1.1	--	<50	--
11/30/94	10.54	5.96	4.58	--	--	--	--	<50	<0.5	<0.5	<0.5	<0.5	--	<50	--
02/15/95	10.54	6.32	4.22	--	--	--	--	<50	<0.5	<0.5	<0.5	<0.5	--	<50	--
05/01/95	10.54	6.04	4.50	--	--	--	--	<50	<0.5	<0.5	<0.5	<0.5	--	53**	--
08/04/95	10.54	5.56	4.98	--	--	--	--	<50	<0.5	<0.5	<0.5	<0.5	--	<50	--
02/12/98	10.54	7.49	3.05	--	--	--	--	<50	<0.5	<0.5	<0.5	<0.5	--	<50	--
06/03/98	10.54	6.59	3.95	--	--	--	Sampled biannually	--	--	--	--	--	--	--	--
07/29/98	10.54	5.99	4.55	--	--	--	--	<50	<0.5	<0.5	<0.5	<0.5	--	--	<2.5
11/30/98	10.54	5.56	4.98	--	--	--	--	--	--	--	--	--	--	--	--
<b>B-8</b>															
04/23/93	11.99	6.63	5.36	--	--	--	--	<50	<0.5	<0.5	<0.5	<1.5	<50	--	--
07/19/93	11.99	5.77	6.22	--	--	--	--	<50	<0.5	<0.5	<0.5	<1.5	<50	<50	--
10/19/93	11.99	--	--	--	--	--	Dry	--	--	--	--	--	--	--	--
01/07/94	11.99	5.69	6.30	--	--	--	--	<50	<0.5	<0.5	<0.5	<0.5	--	<50	--
08/18/94	11.99	5.56	6.43	--	--	--	--	<50	<0.5	<0.5	<0.5	<0.5	--	<50	--
11/30/94	11.99	6.53	5.46	--	--	--	--	<50	<0.5	<0.5	<0.5	<0.5	--	120*	--
02/15/95	11.99	7.27	4.72	--	--	--	--	<50	<0.5	<0.5	<0.5	<0.5	--	120*	--
05/01/95	11.99	6.99	5.00	--	--	--	--	<50	<0.5	<0.5	<0.5	<0.5	--	51**	--
08/04/95	11.99	6.07	5.92	--	--	--	--	<50	<0.5	<0.5	<0.5	<0.5	--	<50	--
11/30/98	11.99	6.45	5.54	--	--	--	--	--	--	--	--	--	--	--	--

\* Chromatogram pattern indicates a non-diesel mix.

\*\* Chromatogram pattern indicates an unidentified hydrocarbon.

## Cumulative Table of Well Data and Analytical Results

Vertical Measurements are in feet.				Volumetric Measurements are in gallons.				Analytical results are in parts per billion (ppb)							
DATE	Well Head Elev.	Ground Water Elev.	Depth To Water	SPH Thickness	SPH Removed	Total SPH Removed	Notes	TPH- Gasoline	Benzene	Toluene	Ethyl- Benzene	Xylene	TOG	TPH- Diesel	MTBE
<b>B-9</b>															
04/23/93	10.70	6.14	4.56	--	--	--	--	<50	<0.5	<0.5	<0.5	<1.5	<50	--	--
07/19/93	10.70	5.25	5.45	--	--	--	--	<50	<0.5	<0.5	<0.5	<1.5	<50	<50	--
10/19/93	10.70	4.81	5.89	--	--	--	--	<50	<0.5	<0.5	<0.5	<0.5	--	<50	--
01/07/94	10.70	5.29	5.41	--	--	--	--	<50	<0.5	<0.5	<0.5	<0.5	--	<50	--
08/18/94	10.70	5.15	5.55	--	--	--	--	<50	<0.5	<0.5	<0.5	<0.5	--	<50	--
11/30/94	10.70	6.35	4.35	--	--	--	--	<50	<0.5	<0.5	<0.5	<0.5	--	60*	--
02/15/95	10.70	7.05	3.65	--	--	--	--	<50	<0.5	<0.5	<0.5	<0.5	--	<50	--
05/01/95	10.70	6.41	4.29	--	--	--	--	<50	<0.5	<0.5	<0.5	<0.5	--	<50	--
08/04/95	10.70	5.50	5.20	--	--	--	--	<50	<0.5	<0.5	<0.5	<0.5	--	<50	--
NO LONGER MONITORED OR SAMPLED															
<b>B-10</b>															
11/29/95	11.42	4.91	6.51	--	--	--	--	1700	95	<2.5	69	170	--	900*	22
02/08/96	11.42	6.87	4.55	--	--	--	--	230	31	<0.5	7.2	6.2	--	650*	10
05/08/96	11.42	5.87	5.55	--	--	--	--	260	61	0.59	37	23	--	570*	20
08/23/96	11.42	5.23	6.19	--	--	--	--	320	34	<0.5	29	15	--	700*	8.3
12/12/96	11.42	5.59	5.83	--	--	--	--	1600	94	<2.5	110	27	--	990*	<12
02/10/97	11.42	6.84	4.58	--	--	--	--	2100	230	5.6	130	83	--	530*	<12
05/01/97	11.42	5.85	5.57	--	--	--	--	2300	110	<2.5	140	49	--	770*	<12
08/05/97	11.42	5.12	6.30	--	--	--	--	650	33	1.1	70	16	--	620*	3.2
10/28/97	11.42	5.24	6.18	--	--	--	--	740	25	1.6	53	14	--	310*	6.7
02/04/98	11.42	8.53	2.89	--	--	--	--	950	23	4.5	<0.5	1.9	--	250*	<2.5
06/03/98	11.42	6.62	4.80	--	--	--	--	<50	<0.5	<0.5	<0.5	<0.5	--	490*	<2.5
07/29/98	11.42	5.77	5.65	--	--	--	**	290	3.9	<0.5	8.5	1.4	--	390*	<2.5
11/30/98	11.42	5.80	5.62	--	--	--	--	<50	<0.5	<0.5	<0.5	<0.5	--	437	7.11

\* Chromatogram pattern indicates an unidentified hydrocarbon.

\*\* See Table of Additional Analyses.

## Cumulative Table of Well Data and Analytical Results

Vertical Measurements are in feet.				Volumetric Measurements are in gallons.			Analytical results are in parts per billion (ppb)								
DATE	Well Head Elev.	Ground Water Elev.	Depth To Water	SPH Thickness	SPH Removed	Total SPH Removed	Notes	TPH- Gasoline	Benzene	Toluene	Ethyl- Benzene	Xylene	TOG	TPH- Diesel	MTBE
<b>B-11</b>															
11/29/95	11.98	6.08	5.90	--	--	--	--	2800	38	<10	26	48	--	1400*	21,000
02/08/96	11.98	7.54	4.44	--	--	--	--	<5000	<50	<50	<50	<50	--	1100*	38,000
05/08/96	11.98	6.98	5.00	--	--	--	--	4100	110	<10	31	25	--	1300*	17,000
08/23/96	11.98	6.37	5.61	--	--	--	--	3400	160	12	41	13	--	820*	4000
12/12/96	11.98	6.85	5.13	--	--	--	--	3700	120	12	<5.0	30	--	1300*	2200
02/10/97	11.98	7.91	4.07	--	--	--	--	2300	56	17	<5.0	20	--	810*	4700
05/01/97	11.98	6.95	5.03	--	--	--	--	<5000	<50	<50	<50	<50	--	820*	21,000
08/05/97	11.98	6.38	5.60	--	--	--	--	3500	42	<10	<10	<10	--	900*	4100
10/28/97	11.98	6.30	5.68	--	--	--	--	3000	39	6.2	8.0	13	--	1300*	2300
02/04/98	11.98	9.39	2.59	--	--	--	--	1300	3.2	1.4	<0.5	5.0	--	930*	46,000
06/03/98	11.98	7.53	4.45	--	--	--	--	860	3.7	1.4	0.84	3.0	--	740*	34,000
07/29/98	11.98	6.80	5.18	--	--	--	*	1300	6.9	2.5	3.8	2.0	--	1400*	50,000
07/29/98	11.98	6.80	5.18	--	--	--	Confirmation run	--	--	--	--	--	--	--	41,000
11/30/98	11.98	6.91	5.07	--	--	--	--	<1000	<10	<10	<10	<10	--	1020	5370
<b>B-12</b>															
11/29/95	11.16	5.15	6.01	--	--	--	--	1100	10	<10	<10	<10	--	1800*	37,000
02/08/96	11.16	6.56	4.60	--	--	--	--	<20,000	<200	<200	<200	<200	--	1800*	88,000
05/08/96	11.16	6.08	5.08	--	--	--	--	<25,000	<250	<250	<250	<250	--	1800*	88,000
08/23/96	11.16	5.51	5.65	--	--	--	--	630	16	<5.0	<5.0	<5.0	--	1500*	420
12/12/96	11.16	6.05	5.11	--	--	--	--	<25,000	<250	<250	<250	<250	--	1200*	54,000
02/10/97	11.16	7.05	4.11	--	--	--	--	<20,000	<200	<200	<200	<200	--	1200*	65,000
02/10/97	11.16	7.05	4.11	--	--	--	EPA 8240	--	<500	<500	<500	<500	--	--	--
05/01/97	11.16	6.17	4.99	--	--	--	--	<12,500	<125	<125	<125	<125	--	1100*	64,000
08/05/97	11.16	5.55	5.61	--	--	--	--	<10,000	<100	<100	<100	<100	--	1100*	46,000
10/28/97	11.16	5.40	5.76	--	--	--	--	1400	39	<5.0	7.2	6.0	--	1100*	29,000
02/04/98	11.16	8.53	2.63	--	--	--	--	920	6.9	1.1	<0.5	2.8	--	4800*	59,000
06/03/98	11.16	6.71	4.45	--	--	--	--	590	9.4	<0.5	0.93	<0.5	--	2000*	15,000
07/29/98	11.16	5.91	5.25	--	--	--	*	820	5.6	2.0	3.3	1.2	--	2200*	28,000
07/29/98	11.16	5.91	5.25	--	--	--	Confirmation run	--	--	--	--	--	--	--	33,000
11/30/98	11.16	6.03	5.13	--	--	--	--	2110	<10	<10	<10	<10	--	1060	5330

\* See Table of Additional Analyses.

## Cumulative Table of Well Data and Analytical Results

Vertical Measurements are in feet.				Volumetric Measurements are in gallons.				Analytical results are in parts per billion (ppb)							
DATE	Well Head Elev.	Ground Water Elev.	Depth To Water	SPH Thickness	SPH Removed	Total SPH Removed	Notes	TPH- Gasoline	Benzene	Toluene	Ethyl- Benzene	Xylene	TOG	TPH- Diesel	MTBE
<b>B-13</b>															
11/29/95	11.17	5.26	5.91	--	--	--	--	1800	19	<5.0	5.5	<5.0	--	3400*	7400
02/08/96	11.17	6.72	4.45	--	--	--	--	910	12	1.3	2.0	1.9	--	450*	77
05/08/96	11.17	6.20	4.97	--	--	--	--	140	1.9	<0.5	0.88	2.0	--	560*	98
08/23/96	11.17	5.54	5.63	--	--	--	--	1300	<10	<10	<10	<10	--	1300*	450
12/12/96	11.17	5.91	5.26	--	--	--	--	2600	29	5.4	9.40	6.3	--	1300*	230
02/10/97	11.17	7.05	4.12	--	--	--	--	670	<0.5	6.7	2.6	5.6	--	290*	28
05/01/97	11.17	6.17	5.00	--	--	--	--	920	8.5	4.6	2.1	6.1	--	480*	530
08/05/97	11.17	5.52	5.65	--	--	--	--	1900	23	<5.0	<5.0	<5.0	--	1300*	860
10/28/97	11.17	5.49	5.68	--	--	--	--	2400	33	14	8.4	10	--	2200*	2100
02/04/98	11.17	8.48	2.69	--	--	--	--	110	<0.5	<0.5	<0.5	<0.5	--	260*	260
06/03/98	11.17	6.79	4.38	--	--	--	--	<50	<0.5	<0.5	<0.5	<0.5	--	480*	400
07/29/98	11.17	6.12	5.05	--	--	--	**	350	5.0	<0.5	0.67	1.2	--	830*	730
07/29/98	11.17	6.12	5.05	--	--	--	Confirmation run	--	--	--	--	--	--	--	980
11/30/98	11.17	6.16	5.01	--	--	--	--	168	0.797	<0.5	<0.5	<0.5	--	741	114

\* Chromatogram pattern indicates an unidentified hydrocarbon.

\*\* See Table of Additional Analyses.

## Cumulative Table of Well Data and Analytical Results

Vertical Measurements are in feet.

Volumetric Measurements are in gallons.

Analytical results are in parts per billion (ppb)

DATE	Well Head Elev.	Ground Water Elev.	Depth To Water	SPH Thickness	SPH Removed	Total SPH Removed	Notes	TPH- Gasoline	Benzene	Toluene	Ethyl- Benzene	Xylene	TOG	TPH- Diesel	MTBE
<b>TRIP BLANK</b>															
01/06/93	--	--	--	--	--	--	--	<50	<0.5	<0.5	<0.5	<0.5	--	--	--
04/23/93	--	--	--	--	--	--	--	--	--	--	--	--	--	--	--
07/19/93	--	--	--	--	--	--	--	--	--	--	--	--	--	--	--
10/19/93	--	--	--	--	--	--	--	<50	<0.5	0.5	<0.5	<0.5	--	--	--
01/17/94	--	--	--	--	--	--	--	<50	<0.5	<0.5	<0.5	<0.5	--	--	--
08/18/94	--	--	--	--	--	--	--	<50	<0.5	<0.5	<0.5	<0.5	--	--	--
11/30/94	--	--	--	--	--	--	--	<50	<0.5	<0.5	<0.5	<0.5	--	--	--
02/15/95	--	--	--	--	--	--	--	<50	<0.5	<0.5	<0.5	<0.5	--	--	--
05/01/95	--	--	--	--	--	--	--	<50	<0.5	<0.5	<0.5	<0.5	--	--	--
08/04/95	--	--	--	--	--	--	--	<50	<0.5	<0.5	<0.5	<0.5	--	--	--
11/29/95	--	--	--	--	--	--	--	<50	<0.5	<0.5	<0.5	<0.5	--	--	<2.5
02/08/96	--	--	--	--	--	--	--	<50	<0.5	<0.5	<0.5	<0.5	--	--	--
05/08/96	--	--	--	--	--	--	--	<50	<0.5	<0.5	<0.5	<0.5	--	--	<2.5
08/23/96	--	--	--	--	--	--	--	<50	<0.5	<0.5	<0.5	<0.5	--	--	--
12/12/96	--	--	--	--	--	--	--	<50	<0.5	<0.5	<0.5	<0.5	--	--	<2.5
02/10/97	--	--	--	--	--	--	--	<50	<0.5	<0.5	<0.5	<0.5	--	--	<2.5
05/01/97	--	--	--	--	--	--	--	<50	<0.5	<0.5	<0.5	<0.5	--	--	<2.5
08/05/97	--	--	--	--	--	--	--	<50	<0.5	<0.5	<0.5	<0.5	--	--	<2.5
10/28/97	--	--	--	--	--	--	--	<50	<0.5	<0.5	<0.5	<0.5	--	--	<2.5
02/04/98	--	--	--	--	--	--	--	<50	<0.5	<0.5	<0.5	<0.5	--	--	<2.5
02/12/98	--	--	--	--	--	--	--	<50	<0.5	<0.5	<0.5	<0.5	--	--	<2.5
06/03/98	--	--	--	--	--	--	--	<50	<0.5	<0.5	<0.5	<0.5	--	--	<2.5
07/29/98	--	--	--	--	--	--	--	<50	<0.5	<0.5	<0.5	<0.5	--	--	<2.5
11/30/98	--	--	--	--	--	--	--	<50	<0.5	<0.5	<0.5	<0.5	--	--	<2.0

\* See Table of Additional Analyses.



## Cumulative Table of Well Data and Analytical Results

### ADDITIONAL ANALYSES

Analytical values are in parts per billion (ppb)

DATE	Notes	Alkalinity	Ferrous Iron	Nitrate as Nitrate	Sulfate
<b>B-1</b>					
07/29/98	--	930,000	2000	13,000	280,000
<b>B-5</b>					
07/29/98	--	280,000	1100	<1000	7000
<b>B-10</b>					
07/29/98	--	630,000	740	34,000	16,000
<b>B-11</b>					
07/29/98	--	460,000	1100	33,000	18,000
<b>B-12</b>					
07/29/98	--	700,000	450	<1000	27,000
<b>B-13</b>					
07/29/98	--	290,000	240	5600	17,000

Note: Blaine Tech Services, Inc. began routine monitoring of the groundwater wells at this site on November 1, 1994.  
 Earlier field data and analytical results are drawn from the September 27, 1994 Groundwater Technology, Inc. report.

**ABBREVIATIONS:**

TPH = Total Petroleum Hydrocarbons  
 SPH = Separate-Phase Hydrocarbons  
 TOG = Total Oil and Grease  
 MTBE = Methyl t-Butyl Ether

# **Analytical Appendix**



**Sequoia  
Analytical**

1455 McDowell Blvd. North, Ste. D  
Petaluma, CA 94954  
(707) 792-1865  
FAX (707) 792-0342

May 4, 1999

Christine Lillie  
Blaine Tech/Chevron  
1680 Rogers Ave.  
San Jose, CA 95112

RE: Chevron/P812057

Dear Christine Lillie

Enclosed are the results of analyses for sample(s) received by the laboratory on December 2, 1998. If you have any questions concerning this report, please feel free to contact me.

Sincerely,

Matt Sakai  
Project Manager

CA ELAP Certificate Number 2245





Blaine Tech/Chevron 1680 Rogers Ave. San Jose, CA 95112	Project: Chevron Project Number: 9-0290/981130-Y1/Alameda Project Manager: Christine Lillie	Sampled: 11/30/98 Received: 12/2/98 Reported: 5/4/99
---	---	--

**ANALYTICAL REPORT FOR P812057**

Sample Description	Laboratory Sample Number	Sample Matrix	Date Sampled
B1	P812057-01	Water	11/30/98
B5	P812057-02	Water	11/30/98
B6	P812057-03	Water	11/30/98
B10	P812057-04	Water	11/30/98
B11	P812057-05	Water	11/30/98
B12	P812057-06	Water	11/30/98
B13	P812057-07	Water	11/30/98
TB	P812057-08	Water	11/30/98





Blaine Tech/Chevron 1680 Rogers Ave. San Jose, CA 95112	Project: Chevron Project Number: 9-0290/981130-Y1/Alameda Project Manager: Christine Lillie	Sampled: 11/30/98 Received: 12/2/98 Reported: 5/4/99
---	---	--

**Total Petroleum Hydrocarbons as Gasoline and BTEX by EPA 8015M/8020M  
 Sequoia Analytical - Petaluma**

Analyte	Batch Number	Date Prepared	Date Analyzed	Surrogate Limits	Reporting Limit	Result	Units	Notes*
				<b><u>P812057-01</u></b>				
<b>B1</b>								<b><u>Water</u></b>
Gasoline	8120213	12/9/98	12/9/98		500	543	ug/l	
Benzene	"	"	"		5.00	ND	"	
Toluene	"	"	"		5.00	ND	"	
Ethylbenzene	"	"	"		5.00	ND	"	
Xylenes (total)	"	"	"		5.00	ND	"	
Methyl tert-butyl ether	"	"	"		20.0	2220	"	
Surrogate: a,a,a-Trifluorotoluene	"	"	"	-		98.7	%	
Surrogate: 4-Bromofluorobenzene	"	"	"	-		101	"	
				<b><u>P812057-02</u></b>				
<b>B5</b>								<b><u>Water</u></b>
Gasoline	8120213	12/9/98	12/9/98		50.0	ND	ug/l	
Benzene	"	"	"		0.500	ND	"	
Toluene	"	"	"		0.500	1.91	"	
Ethylbenzene	"	"	"		0.500	ND	"	
Xylenes (total)	"	"	"		0.500	1.09	"	
Methyl tert-butyl ether	"	"	"		2.00	202	"	
Surrogate: a,a,a-Trifluorotoluene	"	"	"	-		101	%	
Surrogate: 4-Bromofluorobenzene	"	"	"	-		100	"	
				<b><u>P812057-03</u></b>				
<b>B6</b>								<b><u>Water</u></b>
Gasoline	8120213	12/9/98	12/9/98		500	655	ug/l	
Benzene	"	"	"		5.00	ND	"	
Toluene	"	"	"		5.00	ND	"	
Ethylbenzene	"	"	"		5.00	ND	"	
Xylenes (total)	"	"	"		5.00	ND	"	
Methyl tert-butyl ether	"	"	"		20.0	2160	"	
Surrogate: a,a,a-Trifluorotoluene	"	"	"	-		104	%	
Surrogate: 4-Bromofluorobenzene	"	"	"	-		105	"	
				<b><u>P812057-04</u></b>				
<b>B10</b>								<b><u>Water</u></b>
Gasoline	8120213	12/9/98	12/9/98		50.0	ND	ug/l	
Benzene	"	"	"		0.500	ND	"	
Toluene	"	"	"		0.500	ND	"	
Ethylbenzene	"	"	"		0.500	ND	"	
Xylenes (total)	"	"	"		0.500	ND	"	
Methyl tert-butyl ether	"	"	"		2.00	7.11	"	
Surrogate: a,a,a-Trifluorotoluene	"	"	"	-		101	%	
Surrogate: 4-Bromofluorobenzene	"	"	"	-		102	"	
				<b><u>P812057-05</u></b>				
<b>B11</b>								<b><u>Water</u></b>
Gasoline	8120213	12/9/98	12/9/98		1000	ND	ug/l	





Blaine Tech/Chevron 1680 Rogers Ave. San Jose, CA 95112	Project: Chevron Project Number: 9-0290/981130-Y1/Alameda Project Manager: Christine Lillie	Sampled: 11/30/98 Received: 12/2/98 Reported: 5/4/99
---	---	--

**Total Petroleum Hydrocarbons as Gasoline and BTEX by EPA 8015M/8020M  
Sequoia Analytical - Petaluma**

Analyte	Batch Number	Date Prepared	Date Analyzed	Surrogate Limits	Reporting Limit	Result	Units	Notes*
<b>B11 (continued)</b>				<b>P812057-05</b>			<b>Water</b>	
Benzene	8120213	12/9/98	12/9/98		10.0	ND	ug/l	
Toluene	"	"	"		10.0	ND	"	
Ethylbenzene	"	"	"		10.0	ND	"	
Xylenes (total)	"	"	"		10.0	ND	"	
Methyl tert-butyl ether	"	"	"		40.0	5370	"	
Surrogate: a,a,a-Trifluorotoluene	"	"	"	-		103	%	
Surrogate: 4-Bromofluorobenzene	"	"	"	-		102	"	
<b>B12</b>				<b>P812057-06</b>			<b>Water</b>	
Gasoline	8120213	12/9/98	12/9/98		1000	2110	ug/l	
Benzene	"	"	"		10.0	ND	"	
Toluene	"	"	"		10.0	ND	"	
Ethylbenzene	"	"	"		10.0	ND	"	
Xylenes (total)	"	"	"		10.0	ND	"	
Methyl tert-butyl ether	"	"	"		40.0	5330	"	
Surrogate: a,a,a-Trifluorotoluene	"	"	"	-		103	%	
Surrogate: 4-Bromofluorobenzene	"	"	"	-		102	"	
<b>B13</b>				<b>P812057-07</b>			<b>Water</b>	
Gasoline	8120213	12/9/98	12/9/98		50.0	168	ug/l	
Benzene	"	"	"		0.500	0.797	"	
Toluene	"	"	"		0.500	ND	"	
Ethylbenzene	"	"	"		0.500	ND	"	
Xylenes (total)	"	"	"		0.500	ND	"	
Methyl tert-butyl ether	"	"	"		2.00	114	"	
Surrogate: a,a,a-Trifluorotoluene	"	"	"	-		100	%	
Surrogate: 4-Bromofluorobenzene	"	"	"	-		101	"	
<b>TB</b>				<b>P812057-08</b>			<b>Water</b>	
Gasoline	8120213	12/9/98	12/9/98		50.0	ND	ug/l	
Benzene	"	"	"		0.500	ND	"	
Toluene	"	"	"		0.500	ND	"	
Ethylbenzene	"	"	"		0.500	ND	"	
Xylenes (total)	"	"	"		0.500	ND	"	
Methyl tert-butyl ether	"	"	"		2.00	ND	"	
Surrogate: a,a,a-Trifluorotoluene	"	"	"	-		107	%	
Surrogate: 4-Bromofluorobenzene	"	"	"	-		99.7	"	





Blaine Tech/Chevron 1680 Rogers Ave. San Jose, CA 95112	Project: Chevron Project Number: 9-0290/981130-Y1/Alameda Project Manager: Christine Lillie	Sampled: 11/30/98 Received: 12/2/98 Reported: 5/4/99
---	---	--

**Total Petroleum Hydrocarbons as Diesel & others by EPA 8015M  
Sequoia Analytical - Petaluma**

Analyte	Batch Number	Date Prepared	Date Analyzed	Surrogate Limits	Reporting Limit	Result	Units	Notes*
<b>B1</b>				<b>P812057-01</b>			<b>Water</b>	
Diesel	8120177	12/11/98	12/12/98	-	50.0	1490	ug/l	1
Surrogate: o-Terphenyl	"	"	"	-		75.7	%	
<b>B5</b>				<b>P812057-02</b>			<b>Water</b>	
Diesel	8120177	12/11/98	12/12/98	-	53.0	371	ug/l	2
Surrogate: o-Terphenyl	"	"	"	-		106	%	
<b>B6</b>				<b>P812057-03</b>			<b>Water</b>	
Diesel	8120177	12/11/98	12/12/98	-	630	2740	ug/l	2
Surrogate: o-Terphenyl	"	"	"	-		124	%	
<b>B10</b>				<b>P812057-04</b>			<b>Water</b>	
Diesel	8120177	12/11/98	12/12/98	-	53.0	437	ug/l	2
Surrogate: o-Terphenyl	"	"	"	-		89.2	%	
<b>B11</b>				<b>P812057-05</b>			<b>Water</b>	
Diesel	8120177	12/11/98	12/12/98	-	53.0	1020	ug/l	2,3
Surrogate: o-Terphenyl	"	"	"	-		91.4	%	
<b>B12</b>				<b>P812057-06</b>			<b>Water</b>	
Diesel	8120177	12/11/98	12/12/98	-	59.0	1060	ug/l	2,3
Surrogate: o-Terphenyl	"	"	"	-		89.8	%	
<b>B13</b>				<b>P812057-07</b>			<b>Water</b>	
Diesel	8120177	12/11/98	12/13/98	-	50.0	741	ug/l	1
Surrogate: o-Terphenyl	"	"	"	-		94.5	%	





Blaine Tech/Chevron 1680 Rogers Ave. San Jose, CA 95112	Project: Chevron Project Number: 9-0290/981130-Y1/Alameda Project Manager: Christine Lillie	Sampled: 11/30/98 Received: 12/2/98 Reported: 5/4/99
---	---	--

**Total Petroleum Hydrocarbons as Gasoline and BTEX by EPA 8015M/8020M/Quality Control  
Sequoia Analytical - Petaluma**

Analyte	Date Analyzed	Spike Level	Sample Result	QC Result	Units	Reporting Limit Recov. Limits	Recov. %	RPD Limit	RPD %	Notes*
<b>Batch: 8120213</b>		<b>Date Prepared: 12/9/98</b>			<b>Extraction Method: EPA 5030 waters</b>					
<b>Blank</b>		<b>8120213-BLK1</b>								
Gasoline	12/9/98			ND	ug/l	50.0				
Benzene	"			ND	"	0.500				
Toluene	"			ND	"	0.500				
Ethylbenzene	"			ND	"	0.500				
Xylenes (total)	"			ND	"	0.500				
Methyl tert-butyl ether	"			ND	"	2.00				
Surrogate: a,a,a-Trifluorotoluene	"	300		299	"		99.7			
Surrogate: 4-Bromofluorobenzene	"	300		294	"		98.0			
<b>LCS</b>		<b>8120213-BS1</b>								
Benzene	12/9/98	100		94.9	ug/l		94.9			
Toluene	"	100		94.5	"		94.5			
Ethylbenzene	"	100		90.7	"		90.7			
Xylenes (total)	"	300		282	"		94.0			
Surrogate: a,a,a-Trifluorotoluene	"	300		297	"		99.0			
<b>Matrix Spike</b>		<b>8120213-MS1</b>	<b>P812013-11</b>							
Benzene	12/9/98	100	ND	94.3	ug/l		94.3			
Toluene	"	100	ND	96.7	"		96.7			
Ethylbenzene	"	100	ND	91.2	"		91.2			
Xylenes (total)	"	300	ND	283	"		94.3			
Surrogate: a,a,a-Trifluorotoluene	"	300		328	"		109			
<b>Matrix Spike Dup</b>		<b>8120213-MSD1</b>	<b>P812013-11</b>							
Benzene	12/9/98	100	ND	95.6	ug/l		95.6			1.37
Toluene	"	100	ND	97.8	"		97.8			1.13
Ethylbenzene	"	100	ND	92.6	"		92.6			1.52
Xylenes (total)	"	300	ND	286	"		95.3			1.05
Surrogate: a,a,a-Trifluorotoluene	"	300		314	"		105			







Blaine Tech/Chevron 1680 Rogers Ave. San Jose, CA 95112	Project: Chevron Project Number: 9-0290/981130-Y1/Alameda Project Manager: Christine Lillie	Sampled: 11/30/98 Received: 12/2/98 Reported: 5/4/99
---	---	--

**Total Petroleum Hydrocarbons as Diesel & others by EPA 8015M/Quality Control  
Sequoia Analytical - Petaluma**

Analyte	Date Analyzed	Spike Level	Sample Result	QC Result	Units	Reporting Limit Recov. Limits	Recov. %	RPD Limit	RPD %	Notes*
<b>Batch: 8120177</b>		<b>Date Prepared: 12/11/98</b>			<b>Extraction Method: EPA 3520B</b>					
<b>Blank</b>		<b>8120177-BLK1</b>								
Diesel	12/12/98			ND	ug/l	50.0				
Surrogate: <i>o</i> -Terphenyl	"	100		105	"		105			
<b>LCS</b>		<b>8120177-BS1</b>								
Diesel	12/12/98	1000		803	ug/l	28.0-138	80.3			4
Surrogate: <i>o</i> -Terphenyl	"	100		85.4	"		85.4			





Blaine Tech/Chevron 1680 Rogers Ave. San Jose, CA 95112	Project: Chevron Project Number: 9-0290/981130-Y1/Alameda Project Manager: Christine Lillie	Sampled: 11/30/98 Received: 12/2/98 Reported: 5/4/99
---	---	--

**Notes and Definitions**

#	Note
---	------

- 1 Hydrocarbon pattern present in the requested fuel quantitation range but does not resemble the pattern of the requested fuel.
- 2 Results in the diesel organics range are primarily due to overlap from a heavy oil range product.
- 3 Results in the diesel organics range are primarily due to overlap from a gasoline range product.
- 4 BSD1 sample was lost, batch accepted on BS1 recovery
- DET Analyte DETECTED
- ND Analyte NOT DETECTED at or above the reporting limit
- NR Not Reported
- dry Sample results reported on a dry weight basis
- Recov. Recovery
- RPD Relative Percent Difference





# **Field Data Sheets**

## CHEVRON WELL MONITORING DATA SHEET

Project #: 981130 41	Station #: 9-0290
Sampler: B. TAYLOR	Date: 11/30/98
Well I.D.: B1	Well Diameter: (2) 3 4 6 8
Total Well Depth: 15.95	Depth to Water: 5.68
Depth to Free Product:	Thickness of Free Product (feet):
Referenced to: PVC Grade	D.O. Meter (if req'd): YSI HACH

Well Diameter	Multiplier	Well Diameter	Multiplier
2"	0.16	5"	1.02
3"	0.37	6"	1.47
4"	0.65	Other	radius <sup>2</sup> * 0.163

Purge Method: Bailer  
~~Disposable Bailer~~  
 Middleburg  
 Electric Submersible  
 Extraction Pump

Sampling Method: Bailer  
~~Disposable Bailer~~  
 Extraction Port  
 Other: \_\_\_\_\_

Other: \_\_\_\_\_

1.6	x	3	=	4.8	Gals.
1 Case Volume (Gals.)		Specified Volumes		Calculated Volume	

Time	Temp (°F)	pH	Cond.	Gals. Removed	Observations
7:24	69.7	7.2	1308	2	
7:33	65.8	7.1	1407	4	
7:42	65.7	7.4	1411	5	

Did well dewater? Yes  No  Gallons actually evacuated: 5

Sampling Time: 945 Sampling Date: 11/30/98

Sample I.D.: B1 Laboratory: Sequoia CORE N. Creek Assoc. Labs

Analyzed for: TPH-G BTEX MTBE TPH-D Other:

Duplicate I.D.: Analyzed for: TPH-G BTEX MTBE TPH-D Other:

D.O. (if req'd):	Pre-purge:	mg/L	Post-purge:	mg/L
------------------	------------	------	-------------	------

O.R.P. (if req'd):	Pre-purge:	mV	Post-purge:	mV
--------------------	------------	----	-------------	----

## CHEVRON WELL MONITORING DATA SHEET

Project #: 981130 41	Station #: 9-0290
Sampler: B. TAYLOR	Date: 11/30/98
Well I.D.: BS	Well Diameter: (2) 3 4 6 8
Total Well Depth: 18.20	Depth to Water: 4.37
Depth to Free Product:	Thickness of Free Product (feet):
Referenced to: (PVC) Grade	D.O. Meter (if req'd): YSI HACH

Well Diameter	Multiplier	Well Diameter	Multiplier
2"	0.16	5"	1.02
3"	0.37	6"	1.47
4"	0.65	Other	radius <sup>2</sup> * 0.163

Purge Method: Bailer  
~~Disposable Bailer~~  
 Middleburg  
 Electric Submersible  
 Extraction Pump  
 Other: \_\_\_\_\_

Sampling Method: Bailer  
~~Disposable Bailer~~  
 Extraction Port  
 Other: \_\_\_\_\_

2.2	x	3	=	6.6	Gals.
1 Case Volume (Gals.)		Specified Volumes		Calculated Volume	

Time	Temp (°F)	pH	Cond.	Gals. Removed	Observations
7:11	63.2	7.3	842	2	
9:19	64.8	7.4	737	4	
9:18	64.9	7.4	741	7	

Did well dewater? Yes  No  Gallons actually evacuated: 7

Sampling Time: 7:20 Sampling Date: 11/30/98

Sample I.D.: BS Laboratory: (Sequoia) CORE N. Creek Assoc. Labs

Analyzed for: (TPH-G BTEX MTBE TPH-D) Other: \_\_\_\_\_

Duplicate I.D.: Analyzed for: TPH-G BTEX MTBE TPH-D Other: \_\_\_\_\_

D.O. (if req'd):	Pre-purge: <span style="float: right;">mg/L</span>	Post-purge: <span style="float: right;">mg/L</span>
O.R.P. (if req'd):	Pre-purge: <span style="float: right;">mV</span>	Post-purge: <span style="float: right;">mV</span>

## CHEVRON WELL MONITORING DATA SHEET

Project #: 981130 41	Station #: 9-0290
Sampler: B. TAYLOR	Date: 11/30/98
Well I.D.: BE	Well Diameter: (2) 3 4 6 8
Total Well Depth: 18.37	Depth to Water: 5.47
Depth to Free Product:	Thickness of Free Product (feet):
Referenced to: PVC Grade	D.O. Meter (if req'd): YSI HACH

Well Diameter	Multiplier	Well Diameter	Multiplier
2"	0.16	5"	1.02
3"	0.37	6"	1.47
4"	0.65	Other	radius <sup>2</sup> * 0.163

Purge Method:

Bailer  
 Disposable Bailer  
 Middleburg  
 Electric Submersible  
 Extraction Pump

Sampling Method:

Bailer  
 Disposable Bailer  
 Extraction Port  
 Other: \_\_\_\_\_

Other: \_\_\_\_\_

<u>2</u>	x	<u>3</u>	=	<u>C</u>	Gals.
1 Case Volume (Gals.)		Specified Volumes		Calculated Volume	

Time	Temp (°F)	pH	Cond.	Gals. Removed	Observations
801	64.8	7.7	1108	2	
804	65.9	7.6	1223	4	
806	65.7	7.6	1191	C	

Did well dewater?	Yes	No	Gallons actually evacuated: C
Sampling Time: 810	Sampling Date: 11/30/98		
Sample I.D.: BE	Laboratory: Sequoia CORE N. Creek Assoc. Labs		
Analyzed for: TPH-G BTEX MTBE TPH-D	Other: _____		
Duplicate I.D.:	Analyzed for: TPH-G BTEX MTBE TPH-D Other: _____		
D.O. (if req'd):	Pre-purge:	mg/L	Post-purge: <span style="float: right;">mg/L</span>
O.R.P. (if req'd):	Pre-purge:	mV	Post-purge: <span style="float: right;">mV</span>

## CHEVRON WELL MONITORING DATA SHEET

Project #: <u>981130 41</u>	Station #: <u>9-0290</u>
Sampler: <u>B. TAYLOR</u>	Date: <u>11/30/98</u>
Well I.D.: <u>B10</u>	Well Diameter: <u>(2)</u> 3 4 6 8
Total Well Depth: <u>16.05</u>	Depth to Water: <u>5.62</u>
Depth to Free Product:	Thickness of Free Product (feet):
Referenced to: <u>PVC</u> Grade	D.O. Meter (if req'd): YSI HACH

Well Diameter	Multiplier	Well Diameter	Multiplier
2"	0.16	5"	1.02
3"	0.37	6"	1.47
4"	0.65	Other	radius <sup>2</sup> * 0.163

Purge Method: Bailer  
 Disposable Bailer  
 Middleburg  
 Electric Submersible  
 Extraction Pump  
 Other: \_\_\_\_\_

Sampling Method: Bailer  
 Disposable Bailer  
 Extraction Port  
 Other: \_\_\_\_\_

<u>1.7</u>	x	<u>3</u>	=	<u>5.1</u>	Gals.
1 Case Volume (Gals.)		Specified Volumes		Calculated Volume	

Time	Temp (°F)	pH	Cond.	Gals. Removed	Observations
823	63.7	7.2	982	2	
826	64.1	7.4	1031	4	
828	64.8	7.3	1043	5.1	

Did well dewater? Yes  No  Gallons actually evacuated: 5.1

Sampling Time: 8 31 Sampling Date: 11/30/98

Sample I.D.: B10 Laboratory: Sequoia CORE N. Creek Assoc. Labs

Analyzed for: TPH-G BTEX MTBE TPH-D Other: \_\_\_\_\_

Duplicate I.D.: \_\_\_\_\_ Analyzed for: TPH-G BTEX MTBE TPH-D Other: \_\_\_\_\_

D.O. (if req'd):	Pre-purge: _____ mg/L	Post-purge: _____ mg/L
O.R.P. (if req'd):	Pre-purge: _____ mV	Post-purge: _____ mV



## CHEVRON WELL MONITORING DATA SHEET

Project #: <u>981130 41</u>	Station #: <u>9-0290</u>
Sampler: <u>B. TAYLOR</u>	Date: <u>11/30/98</u>
Well I.D.: <u>B 11</u>	Well Diameter: <u>(2)</u> 3 4 6 8
Total Well Depth: <u>14.52</u>	Depth to Water: <u>8.07</u>
Depth to Free Product:	Thickness of Free Product (feet):
Referenced to: <u>(PVC)</u> Grade	D.O. Meter (if req'd): YSI HACH

Well Diameter	Multiplier	Well Diameter	Multiplier
2"	0.16	5"	1.02
3"	0.37	6"	1.47
4"	0.65	Other	radius <sup>2</sup> * 0.163

Purge Method:

Bailer  
 ~~Disposable Bailer~~  
 Middleburg  
 Electric Submersible  
 Extraction Pump

Sampling Method:

Bailer  
 ~~Disposable Bailer~~  
 Extraction Port

Other: \_\_\_\_\_

Other: \_\_\_\_\_

<u>1.5</u>	x	<u>3</u>	=	<u>4.5</u>	Gals.
1 Case Volume (Gals.)		Specified Volumes		Calculated Volume	

Time	Temp (°F)	pH	Cond.	Gals. Removed	Observations
<u>1002</u>	<u>65.4</u>	<u>7.4</u>	<u>1123</u>	<u>2</u>	
<u>1005</u>	<u>67.1</u>	<u>7.7</u>	<u>1108</u>	<u>4</u>	
<u>1008</u>	<u>67.2</u>	<u>7.9</u>	<u>1110</u>	<u>5</u>	

Did well dewater? Yes  No  Gallons actually evacuated: 5

Sampling Time: 10 15 Sampling Date: 11/30/98

Sample I.D.: B 11 Laboratory: (Sequoia) CORE N. Creek Assoc. Labs

Analyzed for: (TPH-G BTEX MTBE TPH-D) Other: \_\_\_\_\_

Duplicate I.D.: \_\_\_\_\_ Analyzed for: TPH-G BTEX MTBE TPH-D Other: \_\_\_\_\_

D.O. (if req'd):	Pre-purge: _____ mg/L	Post-purge: _____ mg/L
------------------	-----------------------	------------------------

O.R.P. (if req'd):	Pre-purge: _____ mV	Post-purge: _____ mV
--------------------	---------------------	----------------------

## CHEVRON WELL MONITORING DATA SHEET

Project #: 981130 Y1	Station #: 9-0290
Sampler: B. TAYLOR	Date: 11/30/98
Well I.D.: B12	Well Diameter: (2) 3 4 6 8
Total Well Depth: 15.25	Depth to Water: 5.13
Depth to Free Product:	Thickness of Free Product (feet):
Referenced to: (PVC) Grade	D.O. Meter (if req'd): YSI HACH

Well Diameter	Multiplier	Well Diameter	Multiplier
2"	0.16	5"	1.02
3"	0.37	6"	1.47
4"	0.65	Other	radius <sup>2</sup> * 0.165

Purge Method:  Bailer  Disposable Bailer  Middleburg  Electric Submersible Extraction Pump

Other: \_\_\_\_\_

Sampling Method:  Bailer  Disposable Bailer  Extraction Port

Other: \_\_\_\_\_

<u>1.6</u>	x	<u>3</u>	=	<u>4.8</u>	Gals.
1 Case Volume (Gals.)		Specified Volumes		Calculated Volume	

Time	Temp (°F)	pH	Cond.	Gals. Removed	Observations
1028	64.7	7.4	1109	2	
1031	65.1	7.4	1117	4	
1035	65.7	7.4	1121	5	

Did well dewater? Yes  No  Gallons actually evacuated: 5

Sampling Time: 1040 Sampling Date: 11/30/98

Sample I.D.: B12 Laboratory: (Sequoia) CORE N. Creek Assoc. Labs

Analyzed for: (TPH-G BTEX MTBE TPH-D) Other: \_\_\_\_\_

Duplicate I.D.: \_\_\_\_\_ Analyzed for: TPH-G BTEX MTBE TPH-D Other: \_\_\_\_\_

D.O. (if req'd):	Pre-purge:	mg/L	Post-purge:	mg/L
O.R.P. (if req'd):	Pre-purge:	mV	Post-purge:	mV

## CHEVRON WELL MONITORING DATA SHEET

Project #: <u>981130 Y1</u>	Station #: <u>9-0290</u>
Sampler: <u>B. TAYLOR</u>	Date: <u>11/30/98</u>
Well I.D.: <u>B13</u>	Well Diameter: <u>(2)</u> 3 4 6 8
Total Well Depth: <u>14.00</u>	Depth to Water: <u>5.01</u>
Depth to Free Product:	Thickness of Free Product (feet):
Referenced to: <u>(PVC)</u> Grade	D.O. Meter (if req'd): YSI HACH

Well Diameter	Multiplier	Well Diameter	Multiplier
2"	0.16	5"	1.02
3"	0.37	6"	1.47
4"	0.65	Other	radius <sup>2</sup> * 0.163

Purge Method: Bailer  
~~Disposable Bailer~~  
 Middleburg  
 Electric Submersible  
 Extraction Pump  
 Other: \_\_\_\_\_

Sampling Method: Bailer  
~~Disposable Bailer~~  
 Extraction Port  
 Other: \_\_\_\_\_

<u>1.5</u>	x	<u>3</u>	=	<u>4.5</u>	Gals.
1 Case Volume (Gals.)		Specified Volumes		Calculated Volume	

Time	Temp (°F)	pH	Cond.	Gals. Removed	Observations
<u>8:47</u>	<u>65.7</u>	<u>7.2</u>	<u>1007</u>	<u>2</u>	
<u>8:50</u>	<u>66.8</u>	<u>7.0</u>	<u>1012</u>	<u>4</u>	
<u>8:52</u>	<u>66.7</u>	<u>7.0</u>	<u>1018</u>	<u>5</u>	

Did well dewater? Yes  No  Gallons actually evacuated: 5

Sampling Time: 9:00 Sampling Date: 11/30/98

Sample I.D.: B13 Laboratory: Sequoia CORE N. Creek Assoc. Labs

Analyzed for: (TPH-G BTEX MTBE TPH-D) Other: \_\_\_\_\_

Duplicate I.D.: \_\_\_\_\_ Analyzed for: TPH-G BTEX MTBE TPH-D Other: \_\_\_\_\_

D.O. (if req'd):	Pre-purge: _____ mg/L	Post-purge: _____ mg/L
O.R.P. (if req'd):	Pre-purge: _____ mV	Post-purge: _____ mV