



**CONESTOGA-ROVERS
& ASSOCIATES**

5900 Hollis Street, Suite A
Emeryville, California 94608
Telephone: (510) 420-0700 Fax: (510) 420-9170
www.CRAworld.com

TRANSMITTAL

DATE: July 5, 2012 REFERENCE NO.: 240669

PROJECT NAME: 5251 Hopyard Road, Pleasanton

TO: Jerry Wickham
Alameda County Environmental Health
1131 Harbor Bay Parkway, Suite 250
Alameda, California 94502

RECEIVED
9:15 am, Jul 10, 2012
Alameda County
Environmental Health

Please find enclosed: Draft Final
 Originals Other
 Prints

Sent via: Mail Same Day Courier
 Overnight Courier Other GeoTracker and Alameda County FTP

QUANTITY	DESCRIPTION
1	Well Destruction Report

As Requested For Review and Comment
 For Your Use _____

COMMENTS:
If you have any questions regarding the content of this document, please contact Peter Schaefer at (510) 420-3319.

Copy to: Denis Brown, Shell Oil Products US (electronic copy)
Carl Cox, C and J Cox Corporation (property owner), 4431 Stoneridge Drive, Pleasanton, CA 94588

Completed by: Peter Schaefer Signed: *Peter Schaefer*

Filing: **Correspondence File**



Jerry Wickham
Alameda County Environmental Health
1131 Harbor Bay Parkway, Suite 250
Alameda, California 94502-6577

Denis L. Brown
Shell Oil Products US
HSE – Environmental Services
20945 S. Wilmington Ave.
Carson, CA 90810-1039
Tel (707) 865 0251
Fax (707) 865 2542
Email denis.l.brown@shell.com

Re: Shell-branded Service Station
5251 Hopyard Road
Pleasanton, California
SAP Code 135785
Incident No. 98995843
ACEH Case No. RO0000194

Dear Mr. Wickham:

The attached document is provided for your review and comment. Upon information and belief, I declare, under penalty of perjury, that the information contained in the attached document is true and correct.

If you have any questions or concerns, please call me at (707) 865-0251.

Sincerely,

A handwritten signature in black ink, appearing to read "Denis L. Brown", is written over a horizontal line.

Denis L. Brown
Senior Program Manager



WELL DESTRUCTION REPORT

**SHELL-BRANDED SERVICE STATION
5251 HOPYARD ROAD
PLEASANTON, CALIFORNIA**

**SAP CODE 135785
INCIDENT NO. 98995843
AGENCY NO. RO000194**

JULY 5, 2012

REF. NO. 240669 (4)

This report is printed on recycled paper.

**Prepared by:
Conestoga-Rovers
& Associates**

5900 Hollis Street, Suite A
Emeryville, California
U.S.A. 94608

Office: (510) 420-0700
Fax: (510) 420-9170

web: <http://www.CRAworld.com>

TABLE OF CONTENTS

	<u>Page</u>
1.0 INTRODUCTION.....	1
2.0 WELL DESTRUCTION.....	1
2.1 FIELD DATE.....	1
2.2 PERSONNEL PRESENT	1
2.3 DESTRUCTION METHOD	1
2.4 WASTE DISPOSAL.....	1

LIST OF FIGURES
(Following Text)

- FIGURE 1 VICINITY MAP
FIGURE 2 SITE PLAN

LIST OF APPENDICES

- APPENDIX A PERMITS

1.0 INTRODUCTION

Conestoga-Rovers & Associates (CRA) prepared this report on behalf of Equilon Enterprises LLC dba Shell Oil Products US (Shell) to document the recent well destructions at the referenced site.

The wells were properly destroyed as requested in Alameda County Environmental Health's (ACEH's) April 25, 2012 letter as a condition for case closure.

2.0 WELL DESTRUCTION

2.1 FIELD DATES

June 18 through 22, 2012.

2.2 PERSONNEL PRESENT

Geologist Bob Siegfried directed the well destructions under the supervision of California Professional Geologist Peter Schaefer.

2.3 DESTRUCTION METHOD

After removing the well boxes, wells S-1 through S-12, EW-1, and EW-2 were destroyed by pressure grouting. Copies of the Zone 7 Water Agency well destruction permit and City of Pleasanton encroachment permit are included in Appendix A.

2.4 WASTE DISPOSAL

No waste was generated during the well destructions.

Construction debris generated by the well destruction activities was transported by Vapor Tech Services of Berkeley, California to Commercial Waste and Recycling of Oakland, California for recycling.

All of Which is Respectfully Submitted,
CONESTOGA-ROVERS & ASSOCIATES



Peter Schaefer, CEG, CHG



 for:

Eric Syrstad, PG

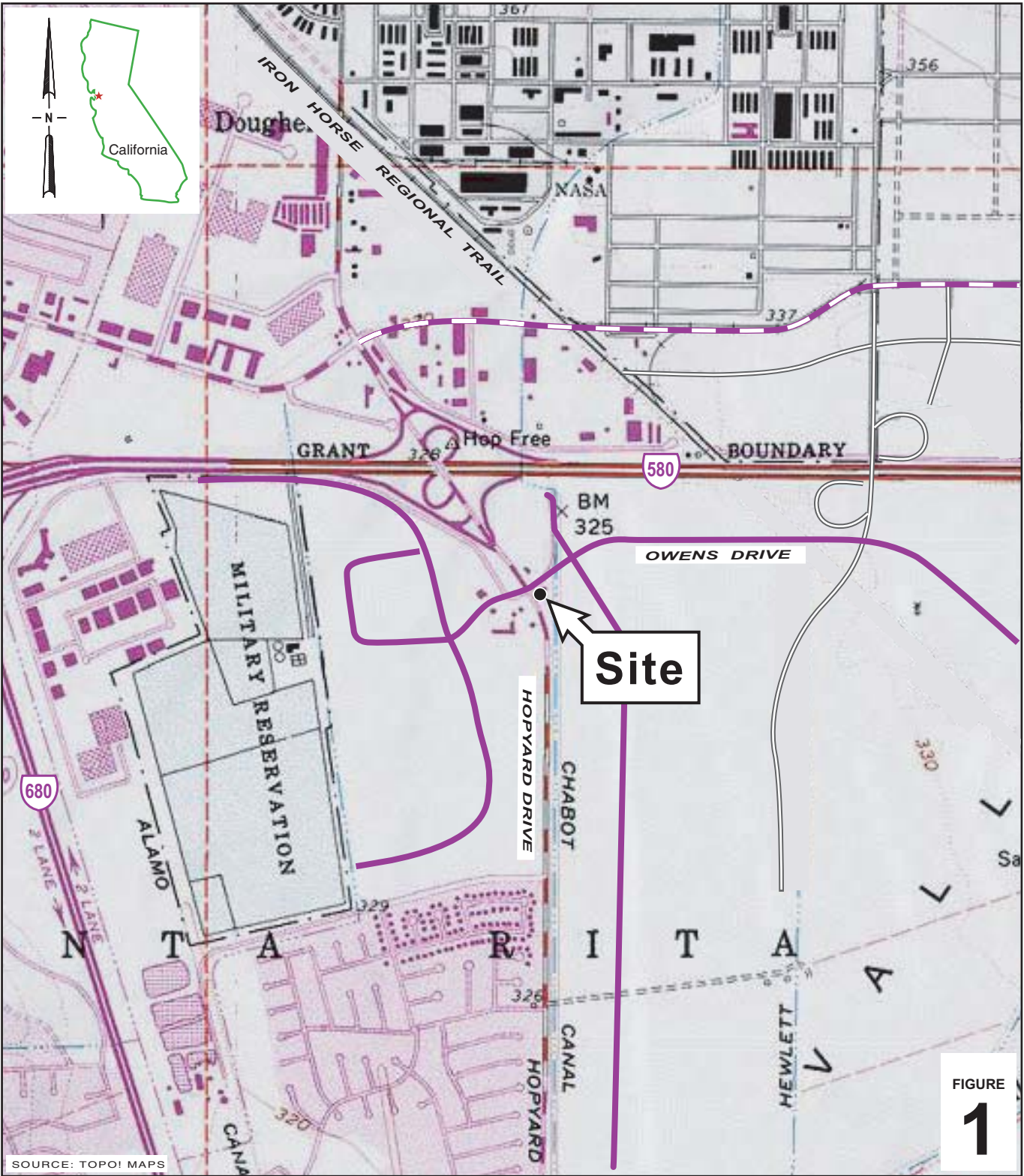
FIGURES



I:\Shell\6-chars\2406--\240669-Pleasanton 5251 Hopyard\240669-FIGURES\240669 VICINITY (F1).AI

Shell-branded Service Station

5251 Hopyard Road
Pleasanton, California



**CONESTOGA-ROVERS
& ASSOCIATES**

Vicinity Map

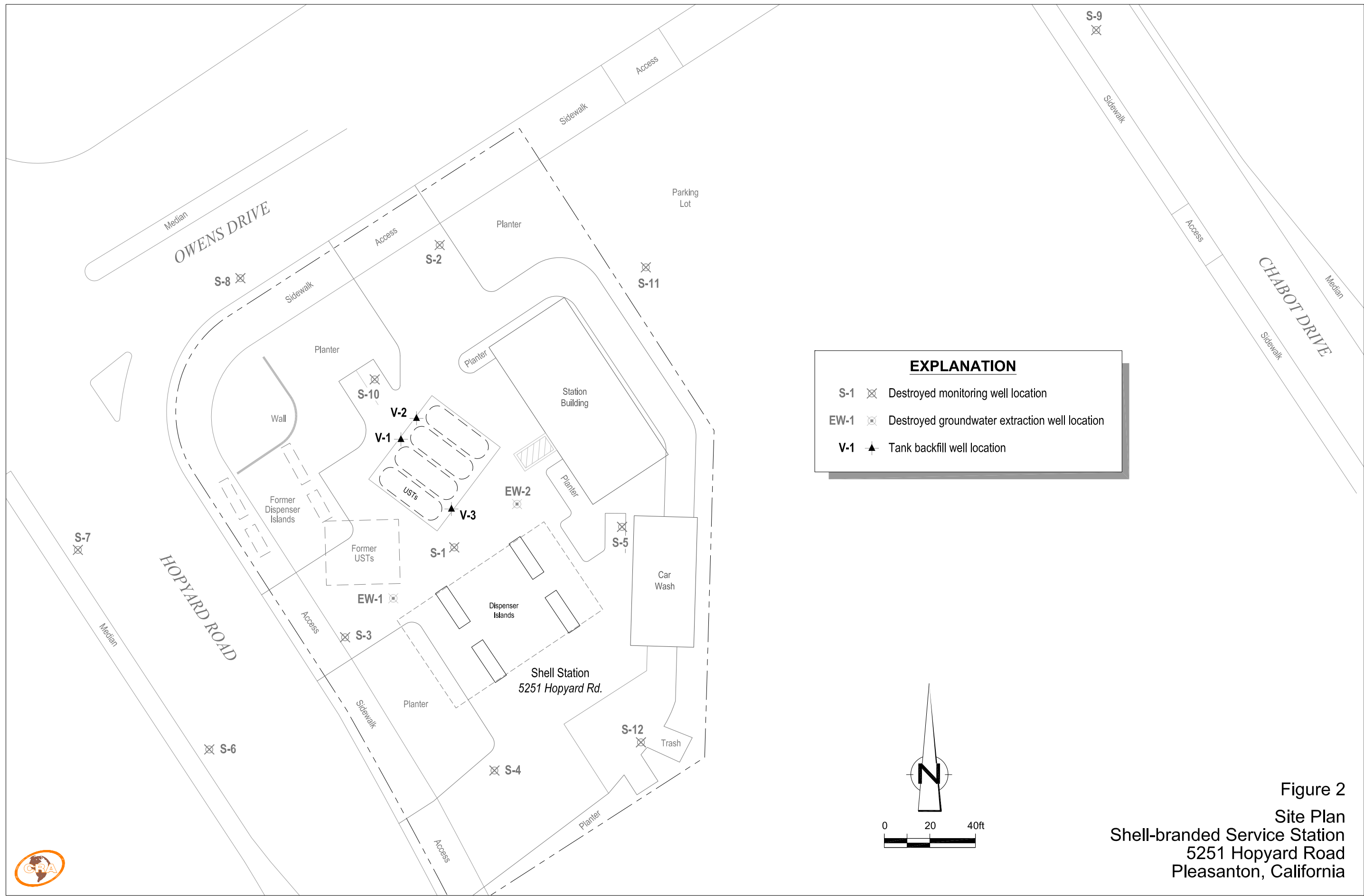

EXPLANATION

- S-1 ☒ Destroyed monitoring well location
- EW-1 ☒ Destroyed groundwater extraction well location
- V-1 ▲ Tank backfill well location

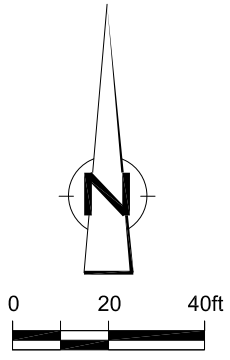

Figure 2
 Site Plan
 Shell-branded Service Station
 5251 Hopyard Road
 Pleasanton, California



APPENDIX A

PERMITS



ZONE 7 WATER AGENCY

100 NORTH CANYONS PARKWAY, LIVERMORE, CALIFORNIA 94551 VOICE (925) 454-5000 FAX (925) 245-9306
E-MAIL whong@zone7water.com

DRILLING PERMIT APPLICATION

FOR APPLICANT TO COMPLETE

FOR OFFICE USE

LOCATION OF PROJECT 5251 Hopyard Rd.
Pleasanton, CA

PERMIT NUMBER 2012059
WELL NUMBER S-1 to S-12, EW-1, EW-2, V+1 to V-
APN 941-2771-00

Coordinates Source Google Earth ft. Accuracy 1 ft.
LAT: 37° 41' 54.52" N ft. LONG: 121° 54' 12.73" W ft.
APN 941-2771-1

PERMIT CONDITIONS (Circled Permit Requirements Apply)

CLIENT
Name Shell Oil Products US
Address 20945 S. Wilmington Ave. Phone _____
City Carroll CA Zip 94588-8412

- A. GENERAL
 1. A permit application should be submitted so as to arrive at the Zone 7 office five days prior to your proposed starting date.
 2. Submit to Zone 7 within 60 days after completion of permitted work the original **Department of Water Resources Water Well Drillers Report (DWR Form 188), signed by the driller.**
 3. Permit is void if project not begun within 90 days of approval date.
 4. **Notify Zone 7 at least 24 hours before the start of work.**

APPLICANT
Name Bob Siegfried
Email bsiegfried@crossaid.com Fax (209) 983-6960
Address 202 Val Derwin Blvd Phone (209) 883-6810
City Stockton CA Zip 95206

- B. WATER SUPPLY WELLS
 1. Minimum surface seal diameter is four inches greater than the well casing diameter.
 2. Minimum seal depth is 50 feet for municipal and industrial wells or 20 feet for domestic and irrigation wells unless a lesser depth is specially approved.
 3. Grout placed by tremie.
 4. An access port at least 0.5 inches in diameter is required on the wellhead for water level measurements.
 5. A sample port is required on the discharge pipe near the wellhead.

TYPE OF PROJECT:
Well Construction Geotechnical Investigation
Well Destruction Contamination Investigation
Cathodic Protection Other

PROPOSED WELL USE:
Domestic Irrigation
Municipal Remediation
Industrial Groundwater Monitoring
Dewatering Other

DRILLING METHOD:
Mud Rotary Air Rotary Hollow Stem Auger
Cable Tool Direct Push Other

DRILLING COMPANY Vapor Tech Services
DRILLER'S LICENSE NO. 916083

- C. GROUNDWATER MONITORING WELLS INCLUDING PIEZOMETERS
 1. Minimum surface seal diameter is four inches greater than the well or piezometer casing diameter.
 2. Minimum seal depth for monitoring wells is the maximum depth practicable or 20 feet.
 3. Grout placed by tremie.

WELL SPECIFICATIONS:
Drill Hole Diameter 8 in. Maximum _____
Casing Diameter 3 in. Depth 26-9 ft.
Surface Seal Depth 8 ft. Number 17

- D. GEOTECHNICAL. Backfill bore hole with compacted cuttings or heavy bentonite and upper two feet with compacted material. In areas of known or suspected contamination, tremied cement grout shall be used in place of compacted cuttings.

SOIL BORINGS:
Number of Borings _____ Maximum _____
Hole Diameter _____ in. Depth _____ ft.

- E. CATHODIC. Fill hole above anode zone with concrete placed by tremie.

ESTIMATED STARTING DATE 6/1/12
ESTIMATED COMPLETION DATE 6/7/12

- F. WELL DESTRUCTION. See attached.

I hereby agree to comply with all requirements of this permit and Alameda County Ordinance No. 73-68.

- G. SPECIAL CONDITIONS. Submit to Zone 7 within 60 days after completion of permitted work the well installation report **including all soil and water laboratory analysis results.**

APPLICANT'S SIGNATURE [Signature] Date 5/4/2012

Approved [Signature] Date 6/8/12
Wyman Hong

ATTACH SITE PLAN OR SKETCH

June 12, 2012

Zone 7
Water Resources Engineering
Groundwater Protection Ordinance

Shell Oil Products U.S.
5251 Hopyard Road
Pleasanton

Wells 3S/1E-6K3 (S-1), 3S/1E-6K7 (S-2), 3S/1E-6K8 to 3S/1E-6K10 (S-3 to S-5),
3S/1E-6K15 to 3S/1E-6K17 (S-6 to S-8), 3S/1E-6K19 (S-9), 3S/1E-6K21 to 3S/1E-
6K23 (S-10 to S-12), 3S/1E-6K11 (EW-1), 3S/1E-6K20 (EW-2) & 3S/1E-6K4 to
3S/1E-6K6 (V-1 to V-3)
Permit 2012059

Destruction Requirements:

1. Remove from the well any pump, appurtenances, debris, or other materials.
2. Sound the well as deeply as practicable and record for your report.
3. Fill casing with neat cement or cement grout sealing material to two feet below the finished grade and pressurize to 25 psi and maintain for 5 minutes, forcing the sealing material through the existing perforations and into the surrounding formation.
4. Release the pressure and refill the empty portion of the casing with grouting material allowing it to spill over the top of the casing to form a cap.
5. Cut and remove any casing(s) to two feet below the finished grade or original ground, whichever is the lower elevation (optional).
6. After seal has set, backfill the remaining hole with compacted material.

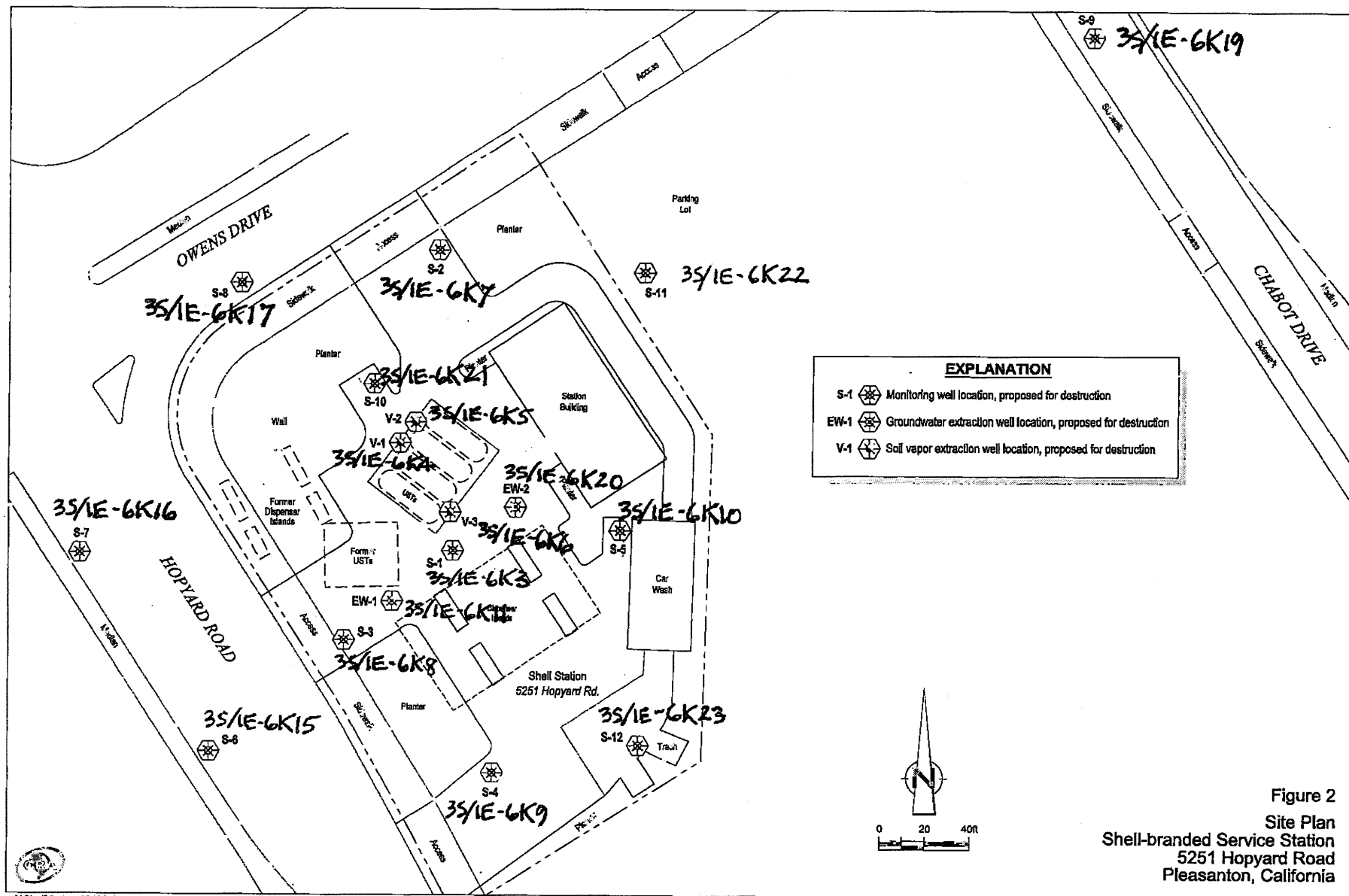



ENCROACHMENT PERMIT

PROJ. NO: 240669-95-2012.03
 ORIGINATOR: RS
 DATE: 5/22/12
 CORRESPONDENCE FILE
 ENGINEERING FEES FILE
 PERMIT OR FILE
 OUT-OF-OFFICE REPORTS FILE
 FIELD FILE
 Permits

-Inspections must be requested 24 Hours prior to Starting work-

Call (925) 931 - 5680

Project Address <u>5251 Hopyard Rd. Pleasanton CA</u>	Parcel # <u>941-2771-1</u> <u>941-2771-34</u>	Permit # E12-0239	Applicant <u>Bob Siegfried</u>
---	--	-----------------------------	-----------------------------------

Project: Vapor Tech Services

Owner <u>Shell Oil Products US</u>	Contractor VAPOR TECH SERVICES 1348 66TH STREET BERKELEY, CA 94702 License #: 916085	(415) 378-0415 Expires: 5/31/2012
------------------------------------	--	--------------------------------------

Scope of Work
Abandon monitoring well @ Hopyard Rd/Owens Dr and Chabot Dr

Issuance Comments

The City Engineer or his authorized representative will be the sole judge of the quality of work, the interpretation of these conditions, and the interpretations of City specifications and/or City Details applicable to the project.

The attached traffic control plan shall apply.
The attached list of conditions shall apply. 1,2,3,4,5,14,15,16, and 17.

Total Fees: \$271.22

Total Payments: \$271.22

All work to be performed to City of Pleasanton Standard Details and Specifications. This permit is issued pursuant to all provisions of the City of Pleasanton Municipal Code, Chapter 13.04, Encroachment.

Issued By: George Farrell [Signature] Date of Issue: 5/22/2012

Applicant/Agent: [Signature]

Building: (925) 931-5300 Planning: (925) 931-5600 Engineering: (925) 931-5650 Construction Insp.: (925) 931-5680

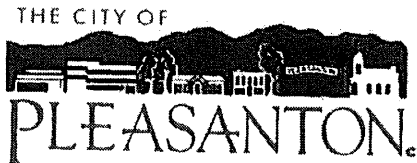

RECEIPT NUMBER: 4686
 RECEIPT DATE: 5/25/2012
 PROCESSED BY: GFARRELL

RECEIPT

RECORD: E12-0239

TYPE: Encroachment

Valuation: \$0.00

DESCRIPTION: Vapor Tech Services

SCOPE: Abandon monitoring well @ Hopyard Rd/Owens Dr and Chabot Dr

APN:

TRACT:

SITE:

OWNER:

PROF: VAPOR TECH SERVICES

CONTRACTOR NUM: 916085

1348 66TH STREET

BUS LIC NUMBER:

BERKELEY, CA 94702

PHONE NUMBER: (415) 378-0415

Fee Description	Fee Notes	Quantity	This Receipt
Misc Encroachment Permit Fee	1.	25.0000	\$25.00
Misc Inspection Fee	1.	246.2200	\$246.22
Total:			\$271.22

Method	Check #	Paid By	Comments	Date	Amount
CREDIT CARD		VAPOR TECH SERVICES		5/25/2012	\$271.22
Total:					\$271.22

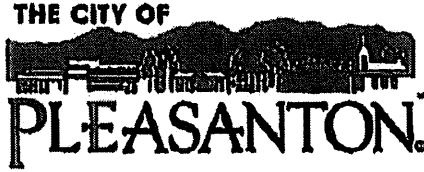

CONDITIONS FOR ENCROACHMENT PERMIT

1. Work area shall be clean at the end of each working day. No construction materials may be stored in street or sidewalk overnight. City of Pleasanton streets shall not be used for staging areas. If excessive debris accumulates to the dissatisfaction of the homeowners, business owners or the City due to construction activities, then the contractor shall be required to clean roadway and sidewalk areas during working hours. All cleaning methods used for construction shall conform to the Urban Runoff Program.
2. Work area shall be safe for vehicular, bicycle and pedestrian traffic. All driveways and other entrances to homes or businesses are to remain accessible at all times or other provisions for access must be made.
3. Landscaping damaged during the project shall be repaired to the owner's satisfaction. In the case of City owned and maintained landscaping, contact Parks Department at (925) 931-3365.
4. Traffic control shall conform to Caltrans standards.
5. Contractor to submit a traffic control plan for pothole work and bare work. (Traffic control plan must be received 48 hours prior to lane closure).
6. Concrete to be removed shall be removed to closest score mark outside work area. All replacement concrete must be doweled to existing concrete.
7. Removal of 6" of pavement required where gutter is to be removed. 6" slot shall be re-paved with AC deep lift after new gutter is in place.
8. Pipe or conduit that is installed in a trench over 3' in depth must be shored in accordance with applicable Cal-OSHA regulations.
9. When permission is granted for directional boring, existing utilities must be "potholed" to establish bore profile.
10. When permission is granted for directional boring in a landscaped area, the minimum bore depth shall be 42 inches, measured from the top of curb and not from the top of the landscape mound.
11. Structural trench backfill shall consist of:
 - A) Standard trenches: 3" min. AC on 10" of CTB (2 Sack mix) for minor streets.
 - B) Standard trenches: 3" min. AC on 15" of CTB (2-sack mix) for major streets.
 - C) Back wheel trenching: 2" of AC on flowable concrete trench backfill. (City approved mix)
 - D) Backfill in sidewalk and landscape areas shall conform to City Specifications.
12. Permits may be required from other agencies having jurisdiction in area.
13. Haul route per attached sheet.
14. Permittee to call utility locating service (USA) at 1-800-642-2444 48 hours prior to beginning of work.
15. Work hours are from 8:00 a.m. to 5:00 p.m. Monday through Friday. Weekends, holidays and after-hours only upon written permission 48 hours in advance. (All overtime is subject to reimbursement).
16. The City Engineer or his authorized representative will be the sole judge of the quality of work, the interpretation of these conditions, and the interpretations of City specifications and/or City Details applicable to the project.
17. Contractor is responsible for removal of all USA marking.

Rev 2/7/03
C:\data\m\methencou\Master Form for Conditions for Encroachment Permit.doc.sm

PUBLIC WORKS

P. O. Box 520, Pleasanton, CA 94566-0802

Administration	Engineering	Traffic	Inspection	Operation Service Center
200 Old Bernal Rd	200 Old Bernal Rd	200 Old Bernal Rd.	205-F Main St.	3333 Busch Road
(925) 931-3630	(925) 931-3630	(925) 931-5630	(925) 931-3680	(925) 931-3500
(925) 931-5479	(925) 931-5479	(925) 931-5479	(925) 931-5484	(925) 931-5595

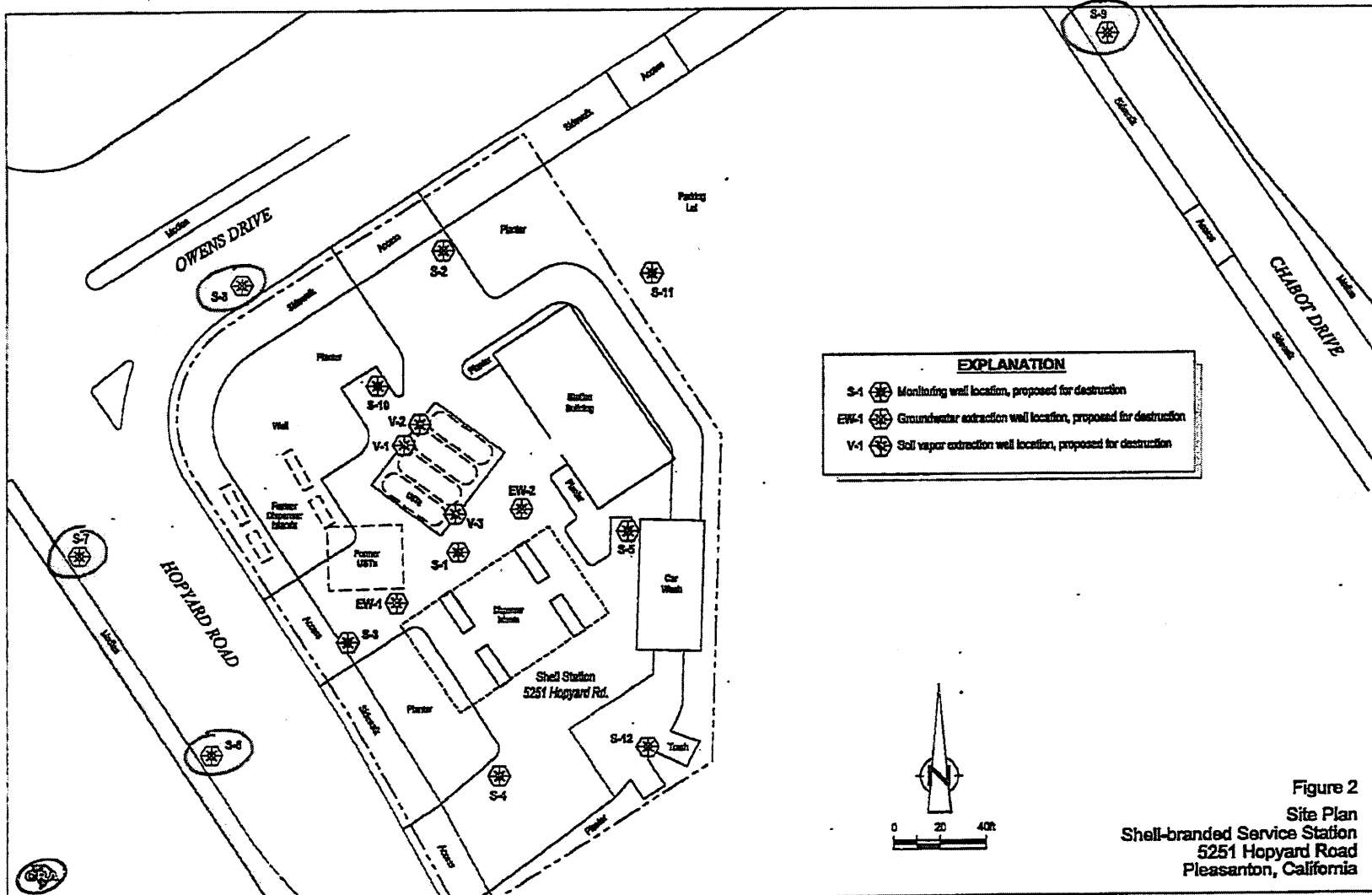

Figure 2
Site Plan
Shell-branded Service Station
5251 Hopyard Road
Pleasanton, California

AShell\G-cham\2406-1240668-Pleasanton 5251 Hopyard\240668-FIGURES\240668 SITE PLAN.DWG (04/19/2012)

E12-0237
144

TABLE						
Traffic Speed	Taper Length Each Lane		Cone Spacing		Sign	
	Merging	Shifting Shoulder	Taper	Tangent	Spacing	
25 MPH	125 FT	63 FT	42 FT	25 FT	50 FT	150 FT
30 MPH	180 FT	90 FT	60 FT	30 FT	60 FT	200 FT
35 MPH	245 FT	123 FT	82 FT	35 FT	70 FT	250 FT
40 MPH	320 FT	160 FT	107 FT	40 FT	80 FT	350 FT
45 MPH	540 FT	270 FT	180 FT	45 FT	90 FT	550 FT
50 MPH	600 FT	300 FT	200 FT	50 FT	100 FT	600 FT
65+ MPH	660 FT	330 FT	220 FT	50 FT	100 FT	1000 FT

Work Hours
8:00 am to 4:00 pm

24 Hour Contact
Mike Franceschi
(916) 606-7514

Staging Area
5251 Hopyard Road

LEGEND
W 20-1 Road Work Ahead
C20 Right lane Closed Ahead
C30 Lane Closed

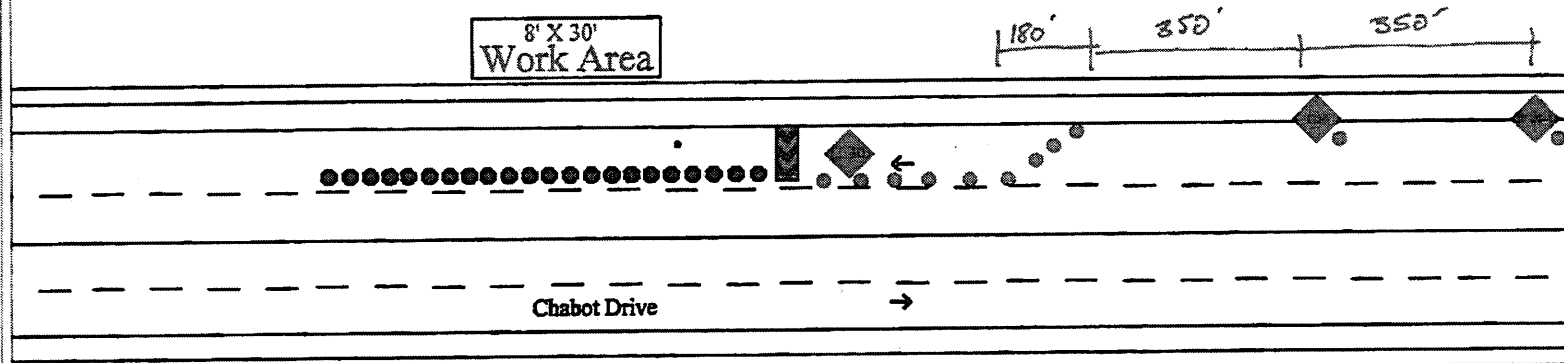

REVIEWED
CITY OF PLEASANTON
ENGINEERING DEPT.
By: EK
Date: 5-17-12

DIRECT TRAFFIC CONTROL
PO BOX 1822
DIAMOND SPRINGS C.A 95619
PHONE (530) 677-9239
FAX (530) 672-1185
MOBILE: (916) 606-7514
IDTC@SBCGLOBAL.NET

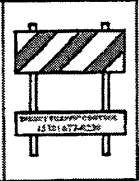

LEGEND

	24\"/>
	24\"/>
	48\"/>
	36\"/>
	48\"/>

Conestoga-Rovers & Associates
10969 Trade Center Drive Suite # 106
Rancho Cordova CA 95670

TRAFFIC CONTROL SITE MAP

DRAWN BY	DATE	PROJECT NUMBER
B. Franceschi	5/12/2012	

274

LEGEND
 W 20-I Road Work Ahead
 C20 Left Lane Closed Ahead
 C30 Lane Closed

9:00
 Work Hours
 9:00 am 3:00 pm
 24 Hour Contact
 Mike Franceschi
 (916) 606-7514

Staging Area
 5251 Hopyard Road

Notes
 * Work Hours 9:45 am to 4 pm

Traffic Speed MPH	Taper Length Each Lane			Cone Spacing		Sign
	Merging	Shifting	Shoulder	Taper	Tangent	
25 MPH	125 FT	63 FT	42 FT	25 FT	50 FT	150 FT
30 MPH	180 FT	90 FT	60 FT	30 FT	60 FT	200 FT
35 MPH	245 FT	123 FT	82 FT	35 FT	70 FT	250 FT
40 MPH	320 FT	160 FT	107 FT	40 FT	80 FT	350 FT
45 MPH	540 FT	270 FT	180 FT	45 FT	90 FT	550 FT
50 MPH	600 FT	300 FT	200 FT	50 FT	100 FT	600 FT
65 + MPH	660 FT	330 FT	220 FT	50 FT	100 FT	1000 FT

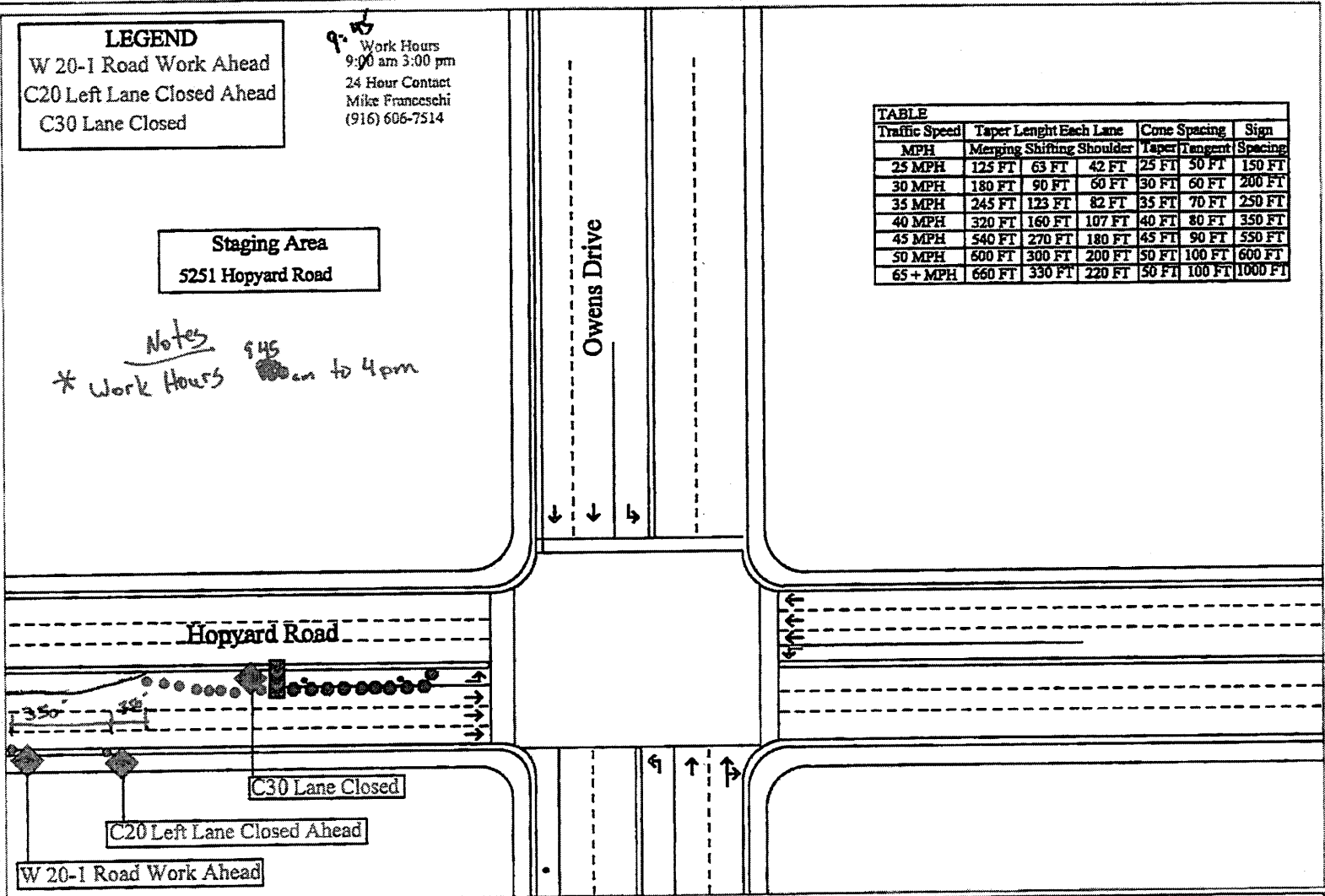

DIRECT TRAFFIC CONTROL
 PO BOX 1822
 DIAMOND SPRINGS C.A 95619
 PHONE (530) 677-9239
 FAX (530) 672-1185
 MOBILE: (916) 606-7514
 IDTC@SBCGLOBAL.NET

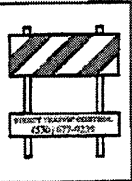

All drawings not to scale

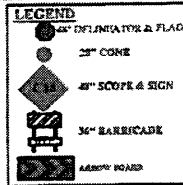

CONESTOGA ROVERS & ASSOCIATES
 10969 Trade Center Drive Suite # 106
 Rancho Cordova CA 95670

TRAFFIC CONTROL SITE MAP

DRAWN BY	DATE	PROJECT NUMBER
B. Franceschi	05/12/2012	

LEGEND
 W 20-1 Road Work Ahead
 C20 Left Lane Closed Ahead
 C30 Lane Closed

Work Hours
 9:00 am 3:00 pm
 24 Hour Contact
 Mike Franceschi
 (916) 606-7514

Staging Area
 5251 Hopyard Road

W 20-1 Road Work Ahead

Owens Drive

Traffic Speed MPH	Taper Length Each Lane			Cone Spacing		Sign Spacing
	Merging	Shifting	Shoulder	Taper	Tangent	
25 MPH	125 FT	63 FT	42 FT	25 FT	50 FT	150 FT
30 MPH	180 FT	90 FT	60 FT	30 FT	60 FT	200 FT
35 MPH	245 FT	123 FT	82 FT	35 FT	70 FT	250 FT
40 MPH	320 FT	160 FT	107 FT	40 FT	80 FT	350 FT
45 MPH	540 FT	270 FT	180 FT	45 FT	90 FT	550 FT
50 MPH	600 FT	300 FT	200 FT	50 FT	100 FT	600 FT
65+ MPH	660 FT	330 FT	220 FT	50 FT	100 FT	1000 FT

Hopyard Road
 350' 550'

C30 Lane Closed

C20 Left Lane Closed Ahead

W 20-1 Road Work Ahead

Notes
 * Work hours 9:45am to 4pm

DIRECT TRAFFIC CONTROL
 PO BOX 1822
 DIAMOND SPRINGS C.A 95619
 PHONE (530) 677-9239
 FAX (530) 672-1185
 MOBILE: (916) 606-7514
 DTC@SBCGLOBAL.NET

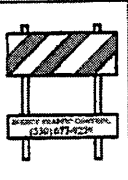

All drawings not to scale

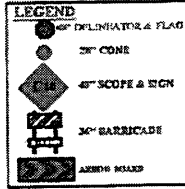

CONESTOGA ROVERS & ASSOCIATES
 10969 Trade Center Drive Suite # 106
 Rancho Cordova CA 95670
TRAFFIC CONTROL SITE MAP

DRAWN BY	DATE	PROJECT NUMBER
B. Franceschi	05/12/2012	

4 of 4



Application for Encroachment Permit

ENGINEERING DEPARTMENT
(925) 931-3650

Date of Application: 5/4/12
Date Work to Begin: 6/1/12
Date of Completion: 6/4/12

Work Location: Near 5251 Hayward Rd. & 5900 Owens Dr. Pleasanton CA APN# 941-2771-1 & 941-277-34

Owner/Developer: Shell Oil Products US Phone: ()

Address: 20945 S. Wilmington Ave., Carson, CA

Contractor: Vapor Tech Services Phone: (415) 328-0415

Address: 1348 66th St, Berkeley CA 94702

California Contractor's License # 916085 Type C-57 Exp. Date 5/31/14

Workers' Comp. Carrier: State Fund Policy # 0500032-2011 Exp. Date 7/17/2012

City of Pleasanton Business License # 110756 Exp. Date 12/31/2012

Description of proposed work: Abandon (4) monitoring wells by pressure sand (5-6, 7, 8 and 9) in City R-O-W and restore to original grade

3 copies of the Plans for proposed work are to be attached to this application.

The undersigned hereby certifies that all work proposed herein will be completed in a timely manner to the satisfaction of the City Engineer in accordance with the provisions of Ordinance 941 and City Standards.

By: M. O'Brien Date: 5/5/2012 Title: Owner - UTS

Application reviewed by: _____ Date: _____

Observations/Special Conditions: _____

Plan check/field review: _____ hrs. @ \$ _____	(1/2 hr. min.)	_____
Inspection Fee: (Select one method)		
1) Estimated _____ hrs. @ \$ _____	(1/2 hr. min.)	_____
2) Estimate of improvements _____	x 4%	_____
3) Trenching for Utilities _____	LF x \$.	_____

TOTAL PERMIT FEE _____

Bond Amount required: _____ Cash _____ Surety _____

Permit approved for issuance as noted above:

By: _____ Date: _____

Pl Complete this section

916085