

RECEIVED

2:42 pm, Jul 17, 2007

Alameda County
Environmental Health



Shell Oil Products US

July 15, 2007

Re: **Second Quarter 2007 Groundwater Monitoring Report**
Shell Service Station
5251 Hopyard Road
Pleasanton, California

Dear Mr. Jerry Wickham:

I declare, under penalty of perjury, that the information and/or recommendations contained in the attached document or report is true and correct to the best of my knowledge.

Sincerely,
Shell Oil Products US

A handwritten signature in black ink, appearing to read "Denis L. Brown", with a long horizontal flourish extending to the right.

Denis L. Brown
Sr. Environmental Engineer

July 15, 2007
DELTA Project SJ5251H1X
SAP: 135785

Mr. Jerry Wickham
Alameda County Health Care Services Agency
1131 Harbor Bay Parkway, Suite 250
Alameda, California 94502-6577

**Re: SECOND QUARTER 2007 GROUNDWATER MONITORING
REPORT
Shell-Branded Service Station
5251 Hopyard Road
Pleasanton, California**



Dear Mr. Wickham:

On behalf of Shell Oil Products (SHELL), Delta Consultants, Inc. (DELTA) has prepared this *Second Quarter 2007 Groundwater Monitoring Report* for the above referenced site.

This quarterly report represents DELTA's professional opinions based upon the currently available information and is arrived at in accordance with currently acceptable professional standards. This report is based upon a specific scope of work requested by the client. The Contract between DELTA and its client outlines the scope of work, and only those tasks specifically authorized by that contract or outlined in this report were performed. This report is intended only for the use of DELTA's Client and anyone else specifically listed on this report. DELTA will not and cannot be liable for unauthorized reliance by any other third party. Other than as contained in this paragraph, DELTA makes no express or implied warranty as to the contents of this report.

If you have any questions regarding this site, please contact Mr. Lee Dooley (DELTA) at (408) 826-1880 or Mr. Denis Brown (SHELL) at (707) 865-0251.

Sincerely,
Delta Consultants, Inc.

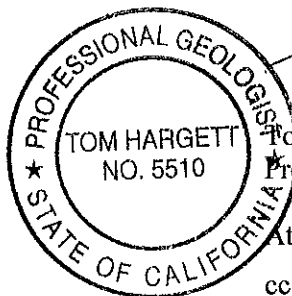

Tom Hargett
Tom Hargett, PG 5510
Project Geologist

Lee Dooley
-FOR- R. Lee Dooley, CHG 0183
Senior Hydrogeologist

Attachment: Second Quarter 2007 Groundwater Monitoring Report

cc: Denis Brown, Shell Oil Products US, Carson
Carl Cox, C and J Cox Corporation, Pleasanton
Colleen Winey, Zone 7 Water Agency, Livermore
Danielle Stefani, Livermore-Pleasanton Fire Department, Pleasanton

SHELL QUARTERLY STATUS REPORT

Station Address: 5251 Hopyard Road, Pleasanton, CA
DELTA Project No.: SJ5251H1X
SHELL Project Manager / Phone No.: Denis Brown / (707) 865-0251
DELTA Site Manager / Phone No.: Lee Dooley / (408) 826-1880
Primary Agency / Regulatory ID No.: Alameda County Environmental Health / Mr. Jerry Wickham, P.G., CHG
Other Agencies to Receive Copies: Zone 7 Water Agency, Livermore-Pleasanton Fire Department

WORK PERFORMED THIS QUARTER (SECOND - 2007):

1. Quarterly groundwater monitoring and sampling. Submitted quarterly report.
2. Submitted IRAP dated 5/29/07

WORK PROPOSED FOR NEXT QUARTER (THIRD - 2007):

1. Quarterly groundwater monitoring and sampling. Submit quarterly report.
2. Implementation of IRAP.

Current Phase of Project: Groundwater monitoring and interim remediation activities.
Frequency of Sampling: Quarterly
Frequency of Monitoring: Quarterly
Is Separate Phase Hydrocarbon Present <input type="checkbox"/> Yes <input checked="" type="checkbox"/> No On-site (Well #'s):
Cumulative SPH Recovered to Date: NA
SPH Recovered This Quarter : None
Sensitive Receptor(s) and Respective Direction(s): Chabot canal is located approximately 1133 feet north-east of the site and Hewlett Canal is located approximately 1156 feet east of the site. No municipal water supply wells were identified within a 1-mile radius of the site.
Current Remediation Techniques: Groundwater batch extraction
Permits for Discharge: None
Approximate Depth to Groundwater: 6.80 to 10.50 feet below top of well casing.
Groundwater Gradient Northwest at a gradient less than 0.01 ft/ft, consistent with previous data
Current Agency Correspondence: ACHCSA letter dated March 21, 2007 (Fuel Leak Case No. RO0000194, requesting work plan for interim remediation).
Summary of Unusual Activity: Significant decline in TBA concentration is downgradient well S-2. TBA concentration has declined from 10,000 ug/l in 8/23/06 to 1,500 ug/l in the 5/23/07 sample. Maximum MTBE concentration is 110 ug/l (well S-2).

Lee Dooley
Site Manager (DELTA)

ATTACHED:

- Figure 1 – Site Location Map
- Figure 2 – Groundwater Elevation Contour Map, May 23, 2007
- Figure 3 – Benzene, MTBE, and TBA Concentration Map, May 23, 2007
- Attachment A – Groundwater Monitoring and Sampling Report, June 21, 2007

FIGURES

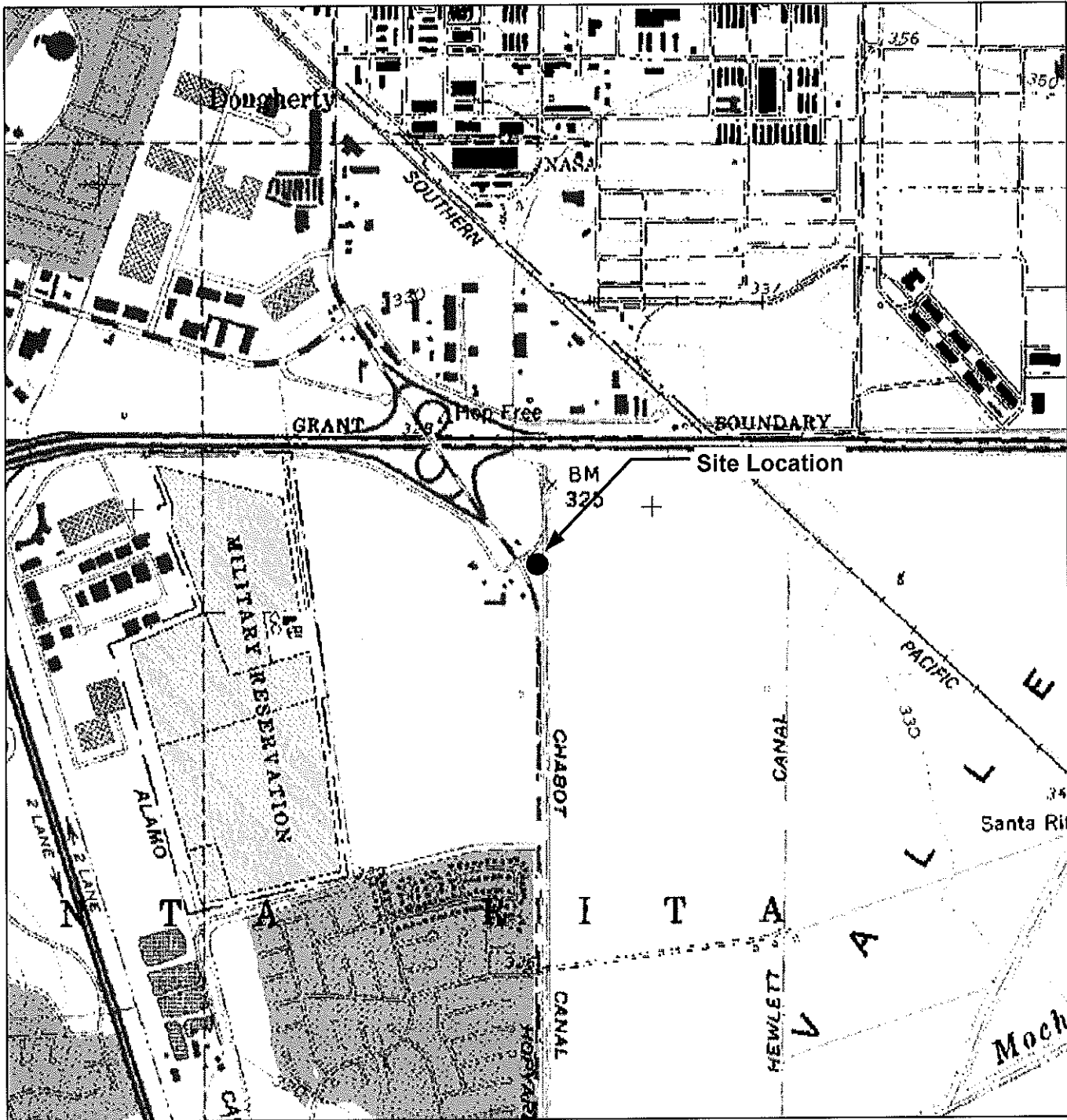

GENERAL NOTES:
 Base Map from: DeLorme Yarmouth, ME 04096
 Source Data: USGS



QUADRANGLE LOCATION

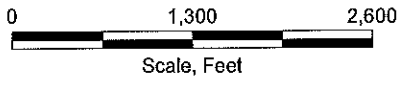

FIGURE 1
 SITE LOCATION MAP

SHELL-BRANDED SERVICE STATION
 5251 Hopyard Road
 Pleasanton, California

PROJECT NO. SJ52-51H-1.2005	DRAWN BY V. F. 3/31/05
FILE NO. SJ52-51H-1.2005	PREPARED BY VF
REVISION NO.	REVIEWED BY



ATTACHMENT A

GROUNDWATER MONITORING AND SAMPLING REPORT, JUNE 21, 2007

BLAINE
TECH SERVICES INC.

GROUNDWATER SAMPLING SPECIALISTS
SINCE 1985

June 21, 2007

Denis Brown
Shell Oil Products US
20945 South Wilmington Avenue
Carson, CA 90810

Second Quarter 2007 Groundwater Monitoring at
Shell-branded Service Station
5251 Hopyard Road
Pleasanton, CA

Monitoring performed on May 23, 2007

Groundwater Monitoring Report **070523-SL-1**

This report covers the routine monitoring of groundwater wells at this Shell-branded facility. In accordance with standard procedures that conform to Regional Water Quality Control Board requirements, routine field data collection includes depth to water, total well depth, thickness of any separate immiscible layer, water column volume, calculated purge volume (if applicable), elapsed evacuation time (if applicable), total volume of water removed (if applicable), and standard water parameter instrument readings. Sample material is collected, contained, stored, and transported to the laboratory in conformance with EPA standards. Purgewater (if applicable) is, likewise, collected and transported to the Martinez Refining Company.

Basic field information is presented alongside analytical values excerpted from the laboratory report in the cumulative table of **WELL CONCENTRATIONS**. The full analytical report for the most recent samples and the field data sheets are attached to this report.

At a minimum, Blaine Tech Services, Inc. field personnel are certified on completion of a forty-hour Hazardous Materials and Emergency Response training course per 29 CFR 1910.120. Field personnel are also enrolled in annual eight-hour refresher courses.

Blaine Tech Services, Inc. conducts sampling and documentation assignments of this type as an independent third party. Our activities at this site consisted of objective data and sample collection only. No interpretation of analytical results, defining of hydrological conditions or formulation of recommendations was performed.

Please call if you have any questions.

Yours truly,

Mike Ninokata
Project Manager

MN/ks

attachments: Cumulative Table of WELL CONCENTRATIONS
Certified Analytical Report
Field Data Sheets

cc: Lee Dooley
Delta Environmental
175 Bernal Rd., Suite 200
San Jose, CA 95119

WELL CONCENTRATIONS
Shell-branded Service Station
5251 Hopyard Road
Pleasanton, CA

Well ID	Date	TPPH (ug/L)	TEPH (ug/L)	B (ug/L)	T (ug/L)	E (ug/L)	X (ug/L)	MTBE 8020 (ug/L)	MTBE 8260 (ug/L)	DIPE (ug/L)	ETBE (ug/L)	TAME (ug/L)	TBA (ug/L)	TOC (MSL)	Depth to Water (ft.)	GW Elevation (MSL)	DO Reading (ppm)
S-1	01/25/1991	2,500	1,500	460	<25	130	36	NA	NA	NA	NA	NA	NA	326.73	NA	NA	NA
S-1	04/06/1991	6,700	2,600 a	2,600	14	580	250	NA	NA	NA	NA	NA	NA	326.73	NA	NA	NA
S-1	07/24/1991	8,800	3,800 a	2,300	30	640	220	NA	NA	NA	NA	NA	NA	326.73	NA	NA	NA
S-1	10/18/1991	12,000	3,300 a	3,600	380	990	580	NA	NA	NA	NA	NA	NA	326.73	8.85	317.88	NA
S-1	01/23/1992	1,600	890	450	3	120	17	NA	NA	NA	NA	NA	NA	326.73	NA	NA	NA
S-1	04/27/1992	1,100 g	500 a	610	<10	110	10	NA	NA	NA	NA	NA	NA	326.73	NA	NA	NA
S-1	07/21/1992	5,100	290 c	1,900	54	460	140	NA	NA	NA	NA	NA	NA	326.73	NA	NA	NA
S-1	10/16/1992	13,000	390 c	3,200	310	780	360	NA	NA	NA	NA	NA	NA	326.73	NA	NA	NA
S-1	01/23/1993	2,300	30 d	640	<5	110	13	NA	NA	NA	NA	NA	NA	326.73	7.96	318.77	NA
S-1	04/28/1993	4,600	390	780	<0.5	250	<0.5	NA	NA	NA	NA	NA	NA	326.73	9.07	317.66	NA
S-1	09/22/1993	3,000	610 a	660	28	160	17	NA	NA	NA	NA	NA	NA	326.73	8.68	318.05	NA
S-1	12/08/1993	520	280	210	<2.5	49	<2.5	NA	NA	NA	NA	NA	NA	326.73	8.23	318.50	NA
S-1	03/04/1994	640	NA	190	1.4	18	1.3	NA	NA	NA	NA	NA	NA	326.73	8.81	317.92	NA
S-1 (D)	03/04/1994	640	NA	180	1.7	17	1.3	NA	NA	NA	NA	NA	NA	326.73	8.81	317.92	NA
S-1	06/16/1994	2,500	NA	390	9.5	31	7.5	NA	NA	NA	NA	NA	NA	326.73	8.80	317.93	NA
S-1 (D)	06/16/1994	2,000	NA	410	7.8	120	20	NA	NA	NA	NA	NA	NA	326.73	8.80	317.93	NA
S-1	09/13/1994	1,400	NA	310	7.7	29	8.5	NA	NA	NA	NA	NA	NA	326.73	8.62	318.11	NA
S-1 (D)	09/13/1994	1,400	NA	240	7.9	44	6.3	NA	NA	NA	NA	NA	NA	326.73	8.62	318.11	NA
S-1	05/05/1995	800	NA	120	3.6	26	2.7	NA	NA	NA	NA	NA	NA	326.73	11.54	315.19	NA
S-1 (D)	05/05/1995	710	NA	110	3.4	19	2.7	NA	NA	NA	NA	NA	NA	326.73	11.54	315.19	NA
S-1	05/21/1996	1,500	NA	170	8.5	120	6.7	NA	NA	NA	NA	NA	NA	326.73	8.88	317.85	NA
S-1	05/12/1997	4,700	NA	200	15	210	20	2,300	NA	NA	NA	NA	NA	326.73	11.19	315.54	2.4
S-1 (D)	05/12/1997	4,800	NA	210	16	190	16	3,200	2,900	NA	NA	NA	NA	326.73	11.19	315.54	2.4
S-1	05/08/1998	500	NA	18	2.1	2.3	2	1,000	NA	NA	NA	NA	NA	326.73	8.38	318.35	2.1
S-1	06/27/1999	2,970	NA	117	32.0	69.1	17.5	374	NA	NA	NA	NA	NA	326.73	8.79	317.94	2.4
S-1	04/28/2000	1,920	NA	50.5	15.0	67.2	46.7	276	NA	NA	NA	NA	NA	326.73	8.50	318.23	2.8

WELL CONCENTRATIONS
Shell-branded Service Station
5251 Hopyard Road
Pleasanton, CA

Well ID	Date	TPPH (ug/L)	TEPH (ug/L)	B (ug/L)	T (ug/L)	E (ug/L)	X (ug/L)	MTBE 8020 (ug/L)	MTBE 8260 (ug/L)	DIPE (ug/L)	ETBE (ug/L)	TAME (ug/L)	TBA (ug/L)	TOC (MSL)	Depth to Water (ft.)	GW Elevation (MSL)	DO Reading (ppm)
---------	------	----------------	----------------	-------------	-------------	-------------	-------------	------------------------	------------------------	----------------	----------------	----------------	---------------	--------------	----------------------------	--------------------------	------------------------

S-1	05/30/2001	3,900	NA	27	12	140	28	NA	140	NA	NA	NA	NA	326.73	8.18	318.55	2.6
S-1	06/17/2002	2,700	NA	25	11	51	14	NA	140	NA	NA	NA	NA	326.73	8.39	318.34	3.2
S-1	05/30/2003	3,900	NA	12	8.2	47	12	NA	270	NA	NA	NA	NA	326.74	7.41	319.33	1.2
S-1	05/03/2004	3,700	NA	32	21	170	34	NA	410	NA	NA	NA	NA	326.74	11.18	315.56	2.4
S-1	01/14/2005	4,200	NA	22	34	380	33	NA	100	NA	NA	NA	NA	326.74	7.10	319.64	0.58
S-1	05/05/2005	5,000	NA	33	110	970	210	NA	190	<0.50	<0.50	0.95	630	326.74	11.32	315.42	NA
S-1	08/05/2005	4,600	NA	32	52	420	69	NA	110	<40	<40	<40	410	326.74	9.04	317.70	NA
S-1	09/16/2005	3,300	NA	14	28	280	43	NA	60	51	<10	<10	260	326.74	11.37	315.37	NA
S-1	11/08/2005	4,700	NA	19.2	47	416	84.0	NA	50.2	<0.500	<0.500	<0.500	<10.0	326.74	9.06	317.68	NA
S-1	01/31/2006	6,380	NA	21.0	33.1	280	31.0	NA	59.9	<0.500	<0.500	<0.500	306	326.74	8.12	318.62	NA
S-1	05/16/2006	9,080	NA	25.8	46.6	517	86.6 m	NA	69.5	<0.500	<0.500	<0.500	268	326.74	7.95	318.79	NA
S-1	08/23/2006	4,980	NA	19.0	22.7	74.7	38.7	NA	42.9	<0.500	<0.500	<0.500	252	326.74	7.95	318.79	NA
S-1	11/13/2006	7,900	NA	38	41	480	52	NA	44	<5.0	<5.0	<5.0	480	326.74	7.99	318.75	NA
S-1	02/01/2007	1,500	NA	18	15	110	17	NA	27	<10	<10	<10	640	326.74	8.19	318.55	NA
S-1	05/23/2007	5,300 n	NA	35	42	260	67.9	NA	<5.0	<10	<10	<10	720	326.74	10.50	316.24	NA

S-2	01/25/1991	<50	<50	<0.5	<0.5	<0.5	<0.5	NA	NA	NA	NA	NA	NA	326.59	NA	NA	NA
S-2	04/16/1991	<50	<50	<0.5	<0.5	<0.5	<0.5	NA	NA	NA	NA	NA	NA	326.59	NA	NA	NA
S-2	07/24/1991	<50	<50	<0.5	<0.5	<0.5	<0.5	NA	NA	NA	NA	NA	NA	326.59	NA	NA	NA
S-2	10/18/1991	<50	<50	<0.5	<0.5	<0.5	<0.5	NA	NA	NA	NA	NA	NA	326.59	8.83	317.76	NA
S-2	01/23/1992	<50	<50	<0.5	<0.5	<0.5	<0.5	NA	NA	NA	NA	NA	NA	326.59	NA	NA	NA
S-2	04/27/1992	<50	<50	<0.5	<0.5	<0.5	<0.5	NA	NA	NA	NA	NA	NA	326.59	NA	NA	NA
S-2	07/17/1992	<50	<50	<0.5	<0.5	<0.5	<0.5	NA	NA	NA	NA	NA	NA	326.59	NA	NA	NA
S-2	10/16/1992	<50	<50	<0.5	<0.5	<0.5	<0.5	NA	NA	NA	NA	NA	NA	326.59	NA	NA	NA
S-2	01/23/1993	<50	140 b	<0.5	<0.5	<0.5	<0.5	NA	NA	NA	NA	NA	NA	326.59	8.10	318.49	NA
S-2	04/28/1993	<50	<50	<0.5	<0.5	<0.5	<0.5	NA	NA	NA	NA	NA	NA	326.59	9.06	317.53	NA

WELL CONCENTRATIONS
Shell-branded Service Station
5251 Hopyard Road
Pleasanton, CA

Well ID	Date	TPPH (ug/L)	TEPH (ug/L)	B (ug/L)	T (ug/L)	E (ug/L)	X (ug/L)	MTBE 8020 (ug/L)	MTBE 8260 (ug/L)	DIPE (ug/L)	ETBE (ug/L)	TAME (ug/L)	TBA (ug/L)	TOC (MSL)	Depth to Water (ft.)	GW Elevation (MSL)	DO Reading (ppm)
S-2	09/22/1993	NA	NA	NA	NA	NA	NA	NA	NA	NA	NA	NA	NA	326.59	8.91	317.68	NA
S-2	12/08/1993	NA	NA	NA	NA	NA	NA	NA	NA	NA	NA	NA	NA	326.59	9.07	317.52	NA
S-2	03/04/1994	NA	NA	NA	NA	NA	NA	NA	NA	NA	NA	NA	NA	326.59	8.90	317.69	NA
S-2	06/16/1994	NA	NA	NA	NA	NA	NA	NA	NA	NA	NA	NA	NA	326.59	8.98	317.61	NA
S-2	09/13/1994	<50	NA	<0.5	2.5	<0.5	<0.5	NA	NA	NA	NA	NA	NA	326.59	8.78	317.81	NA
S-2	05/05/1995	<50	NA	<0.5	<0.5	<0.5	<0.5	NA	NA	NA	NA	NA	NA	326.59	8.60	317.99	NA
S-2	05/21/1996	<50	NA	<0.5	<0.5	<0.5	<0.5	NA	NA	NA	NA	NA	NA	326.59	8.75	317.84	NA
S-2	05/12/1997	<50	NA	<0.5	<0.5	<0.5	<0.5	<2.5	NA	NA	NA	NA	NA	326.59	8.72	317.87	3.4
S-2	05/08/1998	<50	NA	<0.50	<0.50	<0.50	<0.50	<2.5	NA	NA	NA	NA	NA	326.59	8.63	317.96	3.1
S-2	06/27/1999	<50.0	NA	<0.500	<0.500	<0.500	<0.500	<2.00	NA	NA	NA	NA	NA	326.59	8.79	317.80	2.6
S-2	04/28/2000	<50.0	NA	<0.500	<0.500	<0.500	<0.500	<2.50	NA	NA	NA	NA	NA	326.59	8.33	318.26	2.0
S-2	05/30/2001	<50	NA	<0.50	<0.50	<0.50	<0.50	NA	<0.50	NA	NA	NA	NA	326.59	8.56	318.03	1.8
S-2	06/17/2002	<50	NA	<0.50	<0.50	<0.50	<0.50	NA	<5.0	NA	NA	NA	NA	326.59	8.87	317.72	i
S-2	05/30/2003	<50	NA	<0.50	<0.50	<0.50	<1.0	NA	18	NA	NA	NA	NA	326.47	7.89	318.58	1.7
S-2	05/03/2004	<250	NA	<2.5	<2.5	<2.5	<5.0	NA	510	NA	NA	NA	NA	326.47	5.44	321.03	0.1
S-2	01/14/2005	<250	NA	<2.5	<2.5	<2.5	<5.0	NA	270	NA	NA	NA	NA	326.47	7.88	318.59	NA
S-2	05/05/2005	<50	NA	<0.50	<0.50	<0.50	<0.50	NA	280	<0.50	<0.50	0.55	8.9 j	326.47	8.14	318.33	NA
S-2	08/05/2005	<50	NA	<0.50	<0.50	<0.50	<1.0	NA	320	<2.0	<2.0	<2.0	510	326.47	8.24	318.23	NA
S-2	09/16/2005	<250	NA	<2.5	<2.5	<2.5	<5.0	NA	320	<10	<10	<10	1,800	326.47	8.06	318.41	NA
S-2	11/08/2005	<50.0	NA	<0.500	<0.500	<0.500	<0.500	NA	375	<0.500	<0.500	0.610	1,130	326.47	8.20	318.27	NA
S-2	01/31/2006	281	NA	<0.500	<0.500	<0.500	<0.500	NA	354	<0.500	<0.500	<0.500	3,090	326.47	8.18	318.29	NA
S-2	05/16/2006	785	NA	<0.500	<0.500	<0.500	<0.500	NA	282	<0.500	<0.500	<0.500	3,250	326.47	8.34	318.13	NA
S-2	08/23/2006	344	NA	<0.500	<0.500	<0.500	<0.500	NA	194	<0.500	<0.500	0.560	10,600	326.47	8.32	318.15	NA
S-2	11/13/2006	320	NA	<5.0 f	<5.0 f	<5.0 f	<5.0 f	NA	140 f	<5.0 f	<5.0 f	<5.0 f	6,000 f	326.50	8.37	318.13	NA
S-2	02/01/2007	160	NA	<0.50	<0.50	<0.50	<1.0	NA	130	<2.0	<2.0	<2.0	3,900	326.50	8.13	318.37	NA
S-2	05/23/2007	120 n	NA	<0.50	<1.0	<1.0	<1.0	NA	110	<2.0	<2.0	<2.0	1,500	326.50	8.55	317.95	NA

WELL CONCENTRATIONS
Shell-branded Service Station
5251 Hopyard Road
Pleasanton, CA

Well ID	Date	TPPH (ug/L)	TEPH (ug/L)	B (ug/L)	T (ug/L)	E (ug/L)	X (ug/L)	MTBE 8020 (ug/L)	MTBE 8260 (ug/L)	DIPE (ug/L)	ETBE (ug/L)	TAME (ug/L)	TBA (ug/L)	TOC (MSL)	Depth to Water (ft.)	GW Elevation (MSL)	DO Reading (ppm)
S-3	01/25/1991	870	330	230	<2.5	130	<2.5	NA	NA	NA	NA	NA	NA	327.38	NA	NA	NA
S-3	04/16/1991	190	140 a	12	0.8	6.2	1.5	NA	NA	NA	NA	NA	NA	327.38	NA	NA	NA
S-3	07/24/1991	1,700	1,200 a	450	4.4	150	2.9	NA	NA	NA	NA	NA	NA	327.38	NA	NA	NA
S-3	10/18/1991	1,900	500	370	3.1	120	220	NA	NA	NA	NA	NA	NA	327.38	9.64	317.74	NA
S-3	01/23/1992	2,000	650 a	580	3	200	<0.5	NA	NA	NA	NA	NA	NA	327.38	NA	NA	NA
S-3	04/27/1992	1,100	230 a	150	<3	76	14	NA	NA	NA	NA	NA	NA	327.38	NA	NA	NA
S-3	07/17/1992	810	58	200	<2.5	57	3.8	NA	NA	NA	NA	NA	NA	327.38	NA	NA	NA
S-3	10/16/1992	440	190 c	79	1.8	18	4.6	NA	NA	NA	NA	NA	NA	327.38	NA	NA	NA
S-3	01/23/1993	670	170 d	79	1.5	46	15	NA	NA	NA	NA	NA	NA	327.38	8.81	318.57	NA
S-3	04/28/1993	2,000	<50	300	3.4	210	38	NA	NA	NA	NA	NA	NA	327.38	9.87	317.51	NA
S-3	09/22/1993	4,800	670 a	2,000	34	150	51	NA	NA	NA	NA	NA	NA	327.38	9.65	317.73	NA
S-3	12/08/1993	1,200	11	440	<5.0	120	29	NA	NA	NA	NA	NA	NA	327.38	9.26	318.12	NA
S-3	03/04/1994	630	NA	130	<0.5	17	0.8	NA	NA	NA	NA	NA	NA	327.38	9.64	317.74	NA
S-3	06/16/1994	1,800	NA	430	19	35	21	NA	NA	NA	NA	NA	NA	327.38	9.78	317.60	NA
S-3	05/05/1995	160	NA	50	0.9	7.2	4.1	NA	NA	NA	NA	NA	NA	327.38	9.38	318.00	NA
S-3	05/21/1996	270	NA	45	<0.5	1.4	<0.5	NA	NA	NA	NA	NA	NA	327.38	9.41	317.97	NA
S-3 (D)	05/21/1996	210	NA	<0.5	<0.5	0.95	<0.5	NA	NA	NA	NA	NA	NA	327.38	9.41	317.97	NA
S-3	05/12/1997	420	NA	<1.0	<1.0	<1.0	<1.0	57	NA	NA	NA	NA	NA	327.38	9.30	318.08	2.5
S-3	05/08/1998	<50	NA	<0.50	<0.50	<0.50	<0.50	<2.5	NA	NA	NA	NA	NA	327.38	9.12	318.26	2.2
S-3	06/27/1999	106	NA	8.51	<0.500	<0.500	<0.500	31.0	NA	NA	NA	NA	NA	327.38	9.39	317.99	2.1
S-3	04/28/2000	139	NA	7.58	<0.500	<0.500	<0.500	42.6	NA	NA	NA	NA	NA	327.38	9.04	318.34	1.8
S-3	05/30/2001	2,200	NA	510	6.9	100	21	NA	33	NA	NA	NA	NA	327.38	9.19	318.19	2.0
S-3	06/17/2002	600	NA	150	2.1	30	11	NA	36	NA	NA	NA	NA	327.38	9.35	318.03	0.1
S-3	05/30/2003	<50	NA	<0.50	<0.50	<0.50	<1.0	NA	9.0	NA	NA	NA	NA	327.04	8.39	318.65	1.2
S-3	05/03/2004	61 k	NA	0.90	<0.50	<0.50	<1.0	NA	9.8	NA	NA	NA	NA	327.04	8.73	318.31	1.2

WELL CONCENTRATIONS
Shell-branded Service Station
5251 Hopyard Road
Pleasanton, CA

Well ID	Date	TPPH (ug/L)	TEPH (ug/L)	B (ug/L)	T (ug/L)	E (ug/L)	X (ug/L)	MTBE 8020 (ug/L)	MTBE 8260 (ug/L)	DIPE (ug/L)	ETBE (ug/L)	TAME (ug/L)	TBA (ug/L)	TOC (MSL)	Depth to Water (ft.)	GW Elevation (MSL)	DO Reading (ppm)
---------	------	----------------	----------------	-------------	-------------	-------------	-------------	------------------------	------------------------	----------------	----------------	----------------	---------------	--------------	----------------------------	--------------------------	------------------------

S-3	01/14/2005	94	NA	4.6	<0.50	3.1	1.0	NA	13	NA	NA	NA	NA	327.04	8.00	319.04	NA
S-3	05/05/2005	<50	NA	<0.50	<0.50	<0.50	<0.50	NA	5.7	<0.50	<0.50	<0.50	<5.0	327.04	8.31	318.73	NA
S-3	08/05/2005	<50	NA	0.51	<0.50	<0.50	<1.0	NA	6.0	<2.0	<2.0	<2.0	42	327.04	8.32	318.72	NA
S-3	09/16/2005	<50	NA	0.62	<0.50	<0.50	<1.0	NA	7.9	<2.0	<2.0	<2.0	<5.0	327.04	8.29	318.75	NA
S-3	11/08/2005	166	NA	63.0	1.32	7.20	2.99	NA	8.67	<0.500	<0.500	<0.500	<10.0	327.04	8.17	318.87	NA
S-3	01/31/2006	<50.0	NA	<0.500	<0.500	<0.500	<0.500	NA	7.05	<0.500	<0.500	<0.500	<10.0	327.04	8.05	318.99	NA
S-3	05/16/2006	<50.0	NA	3.23	<0.500	1.42	1.63 m	NA	3.92	<0.500	<0.500	<0.500	<10.0	327.04	8.62	318.42	NA
S-3	08/23/2006	<50.0	NA	18.9	<0.500	1.72	0.800	NA	7.65	<0.500	<0.500	<0.500	<10.0	327.04	8.54	318.50	NA
S-3	11/13/2006	530	NA	130 f	3.4 f	10 f	4.6 f	NA	17 f	<2.0 f	<2.0 f	<2.0 f	<80 f	327.01	8.65	318.36	NA
S-3	02/01/2007	430	NA	230	4.4	4.0	<5.0	NA	17	<10	<10	<10	<25	327.01	8.41	318.60	NA
S-3	05/23/2007	1,400 n	NA	370	11	17	11.58 o	NA	21	<2.0	<2.0	<2.0	12	327.01	8.37	318.64	NA

S-4	01/25/1991	<50	<50	<0.5	1.5	<0.5	2.8	NA	NA	NA	NA	NA	NA	327.38	NA	NA	NA
S-4	04/16/1991	<50	0.7	<0.5	<0.5	<0.5	<0.5	NA	NA	NA	NA	NA	NA	327.38	NA	NA	NA
S-4	07/24/1991	<50	<50	<0.5	<0.5	<0.5	<0.5	NA	NA	NA	NA	NA	NA	327.38	NA	NA	NA
S-4	10/18/1991	<50	<50	<0.5	<0.5	<0.5	<0.5	NA	NA	NA	NA	NA	NA	327.38	8.82	318.56	NA
S-4	01/23/1992	<50	<50	<0.5	<0.5	<0.5	<0.5	NA	NA	NA	NA	NA	NA	327.38	NA	NA	NA
S-4	04/27/1992	<50	<50	<0.5	<0.5	<0.5	<0.5	NA	NA	NA	NA	NA	NA	327.38	NA	NA	NA
S-4	07/17/1992	<500	74	<0.5	<0.5	<0.5	<0.5	NA	NA	NA	NA	NA	NA	327.38	NA	NA	NA
S-4	10/16/1992	<500	<50	<0.5	<0.5	<0.5	<0.5	NA	NA	NA	NA	NA	NA	327.38	NA	NA	NA
S-4	01/23/1993	<500	94 b	<0.5	<0.5	<0.5	<0.5	NA	NA	NA	NA	NA	NA	327.38	8.32	319.06	NA
S-4	04/28/1993	<50	<50	<0.5	<0.5	<0.5	<0.5	NA	NA	NA	NA	NA	NA	327.38	9.76	317.62	NA
S-4	09/22/1993	NA	NA	NA	NA	NA	NA	NA	NA	NA	NA	NA	NA	327.38	9.30	318.08	NA
S-4	12/08/1993	NA	NA	NA	NA	NA	NA	NA	NA	NA	NA	NA	NA	327.38	9.74	317.64	NA
S-4	03/04/1994	NA	NA	NA	NA	NA	NA	NA	NA	NA	NA	NA	NA	327.38	9.60	317.78	NA
S-4	06/16/1994	NA	NA	NA	NA	NA	NA	NA	NA	NA	NA	NA	NA	327.38	9.42	317.96	NA

WELL CONCENTRATIONS
Shell-branded Service Station
5251 Hopyard Road
Pleasanton, CA

Well ID	Date	TPPH (ug/L)	TEPH (ug/L)	B (ug/L)	T (ug/L)	E (ug/L)	X (ug/L)	MTBE 8020 (ug/L)	MTBE 8260 (ug/L)	DIPE (ug/L)	ETBE (ug/L)	TAME (ug/L)	TBA (ug/L)	TOC (MSL)	Depth to Water (ft.)	GW Elevation (MSL)	DO Reading (ppm)
S-4	05/05/1995	<50	NA	<0.5	<0.5	<0.5	<0.5	NA	NA	NA	NA	NA	NA	327.38	9.02	318.36	NA
S-4	05/21/1996	<50	NA	<0.5	<0.5	<0.5	<0.5	NA	NA	NA	NA	NA	NA	327.38	9.29	318.09	NA
S-4	05/12/1997	<50	NA	<0.50	<0.50	<0.50	<0.50	140	NA	NA	NA	NA	NA	327.38	7.95	319.43	2.5
S-4	05/08/1998	<50	NA	<0.50	<0.50	<0.50	<0.50	250	NA	NA	NA	NA	NA	327.38	8.96	318.42	2.0
S-4	06/27/1999	303	NA	35.8	24.8	12.4	69.8	106	NA	NA	NA	NA	NA	327.38	8.90	318.48	2.6
S-4	04/28/2000	<50.0	NA	<0.500	<0.500	<0.500	<0.500	40.2	NA	NA	NA	NA	NA	327.38	8.37	319.01	1.9
S-4	05/30/2001	<50	NA	<0.50	<0.50	<0.50	<0.50	NA	6.8	NA	NA	NA	NA	327.38	8.83	318.55	1.8
S-4	06/17/2002	<50	NA	<0.50	<0.50	<0.50	<0.50	NA	31	NA	NA	NA	NA	327.38	9.37	318.01	4.8
S-4	05/30/2003	<50	NA	<0.50	<0.50	<0.50	<1.0	NA	130	NA	NA	NA	NA	327.24	8.46	318.78	1.4
S-4	05/03/2004	<50	NA	<0.50	<0.50	<0.50	<1.0	NA	170	NA	NA	NA	NA	327.24	8.70	318.54	1.1
S-4	01/14/2005	<50	NA	<0.50	<0.50	<0.50	<1.0	NA	25	NA	NA	NA	NA	327.24	8.17	319.07	NA
S-4	05/05/2005	<50	NA	<0.50	<0.50	<0.50	<0.50	NA	15	<0.50	<0.50	<0.50	<5.0	327.24	8.25	318.99	NA
S-4	08/05/2005	<50	NA	<0.50	<0.50	<0.50	<1.0	NA	6.1	<2.0	<2.0	<2.0	<5.0	327.24	8.14	319.10	NA
S-4	11/08/2005	<50.0	NA	<0.500	<0.500	<0.500	<0.500	NA	1.01	<0.500	<0.500	<0.500	<10.0	327.24	8.33	318.91	NA
S-4	01/31/2006	<50.0	NA	<0.500	<0.500	<0.500	<0.500	NA	<0.500	<0.500	<0.500	<0.500	<10.0	327.24	8.29	318.95	NA
S-4	05/16/2006	<50.0	NA	<0.500	<0.500	<0.500	<0.500	NA	<0.500	<0.500	<0.500	<0.500	<10.0	327.24	8.46	318.78	NA
S-4	08/23/2006	<50.0	NA	<0.500	<0.500	<0.500	<0.500	NA	<0.500	<0.500	<0.500	<0.500	<10.0	327.24	8.34	318.90	NA
S-4	11/13/2006	<50	NA	<0.50	<0.50	<0.50	<0.50	NA	<0.50	<0.50	<0.50	<0.50	<20	327.24	8.23	319.01	NA
S-4	02/01/2007	<50	NA	<0.50	<0.50	<0.50	<1.0	NA	<0.50	<2.0	<2.0	<2.0	<5.0	327.24	8.56	318.68	NA
S-4	05/23/2007	<50 n	NA	<0.50	<1.0	<1.0	<1.0	NA	0.60 o	<2.0	<2.0	<2.0	<10	327.24	7.92	319.32	NA
S-5	01/25/1991	<50	<50	<0.5	<0.5	<0.5	0.7	NA	NA	NA	NA	NA	NA	327.76	NA	NA	NA
S-5	04/16/1991	<50	<50	<0.5	<0.5	<0.5	0.8	NA	NA	NA	NA	NA	NA	327.76	NA	NA	NA
S-5	07/24/1991	<50	<50	<0.5	<0.5	<0.5	<0.5	NA	NA	NA	NA	NA	NA	327.76	NA	NA	NA
S-5	10/18/1991	120 e	<50	4.3	<0.5	1	0.7	NA	NA	NA	NA	NA	NA	327.76	10.00	317.76	NA
S-5	01/23/1992	<50	<50	<0.5	<0.5	<0.5	<0.5	NA	NA	NA	NA	NA	NA	327.76	NA	NA	NA

WELL CONCENTRATIONS
Shell-branded Service Station
5251 Hopyard Road
Pleasanton, CA

Well ID	Date	TPPH (ug/L)	TEPH (ug/L)	B (ug/L)	T (ug/L)	E (ug/L)	X (ug/L)	MTBE 8020 (ug/L)	MTBE 8260 (ug/L)	DIPE (ug/L)	ETBE (ug/L)	TAME (ug/L)	TBA (ug/L)	TOC (MSL)	Depth to Water (ft.)	GW Elevation (MSL)	DO Reading (ppm)
S-5	04/27/1992	50	<50	<0.5	<0.5	<0.5	0.6	NA	NA	NA	NA	NA	NA	327.76	NA	NA	NA
S-5	07/17/1992	<50	70	<0.5	<0.5	<0.5	<0.5	NA	NA	NA	NA	NA	NA	327.76	NA	NA	NA
S-5	10/16/1992	230	57	13	<0.5	4.9	4.3	NA	NA	NA	NA	NA	NA	327.76	NA	NA	NA
S-5	01/23/1993	<50	150 b	<0.5	<0.5	<0.5	<0.5	NA	NA	NA	NA	NA	NA	327.76	8.88	318.88	NA
S-5	04/28/1993	<50	<50	<0.5	<0.5	<0.5	<0.5	NA	NA	NA	NA	NA	NA	327.76	10.20	317.56	NA
S-5	09/22/1993	<50	<50	<0.5	<0.5	<0.5	<0.5	NA	NA	NA	NA	NA	NA	327.76	9.92	317.84	NA
S-5	12/08/1993	<50	<50	<0.5	<0.5	<0.5	<0.5	NA	NA	NA	NA	NA	NA	327.76	10.19	317.57	NA
S-5	03/04/1994	<50	NA	<0.5	<0.5	<0.5	<0.5	NA	NA	NA	NA	NA	NA	327.76	9.95	317.81	NA
S-5	06/16/1994	<50	NA	0.9	<0.5	<0.5	<0.5	NA	NA	NA	NA	NA	NA	327.76	10.02	317.74	NA
S-5	05/05/1995	<50	NA	<0.5	<0.5	<0.5	<0.5	NA	NA	NA	NA	NA	NA	327.76	9.58	318.18	NA
S-5	05/21/1996	<50	NA	<0.5	<0.5	<0.5	<0.5	NA	NA	NA	NA	NA	NA	327.76	9.84	317.92	NA
S-5	05/12/1997	360	NA	3.3	<0.50	17	9.8	130	NA	NA	NA	NA	NA	327.76	9.16	318.60	4.2
S-5	05/08/1998	<50	NA	<0.50	<0.50	<0.50	<0.50	92	NA	NA	NA	NA	NA	327.76	9.25	318.51	3.8
S-5 (D)	05/08/1998	<50	NA	<0.50	<0.50	<0.50	<0.50	100	NA	NA	NA	NA	NA	327.76	9.25	318.51	3.8
S-5	06/27/1999	223	NA	13.7	12.9	8.20	45.8	106	NA	NA	NA	NA	NA	327.76	9.39	318.37	3.0
S-5	04/28/2000	<50.0	NA	<0.500	<0.500	<0.500	<0.500	255	NA	NA	NA	NA	NA	327.76	9.43	318.33	1.2
S-5	05/30/2001	<100	NA	<1.0	<1.0	<1.0	<1.0	NA	480	NA	NA	NA	NA	327.76	9.47	318.29	1.1
S-5	06/17/2002	<50	NA	<0.50	<0.50	<0.50	<0.50	NA	210	NA	NA	NA	NA	327.76	9.74	318.02	0.2
S-5	05/30/2003	<250	NA	<2.5	<2.5	<2.5	<5.0	NA	450	NA	NA	NA	NA	327.43	8.87	318.56	1.7
S-5	05/03/2004	<250	NA	<2.5	<2.5	<2.5	<5.0	NA	470	NA	NA	NA	NA	327.43	9.10	318.33	0.7
S-5	01/14/2005	<100	NA	<1.0	<1.0	<1.0	<2.0	NA	230	NA	NA	NA	NA	327.43	8.43	319.00	NA
S-5	05/05/2005	76	NA	16	<0.50	<0.50	<0.50	NA	120	<0.50	<0.50	<0.50	630	327.43	8.71	318.72	NA
S-5	08/05/2005	1,900	NA	57	7.5	22	17	NA	240	<4	<4	<4	480	327.43	8.90	318.53	NA
S-5	09/16/2005	1,400	NA	87	2.0	7.8	5.8	NA	75	<4.0	<4.0	<4.0	630	327.43	8.84	318.59	NA
S-5	11/08/2005	315	NA	35.8	<0.500	<0.500	1.07	NA	49.1	<0.500	<0.500	<0.500	<10.0	327.43	8.86	318.57	NA
S-5	01/31/2006	335	NA	7.74	<0.500	<0.500	<0.500	NA	48.2	<0.500	<0.500	<0.500	337	327.43	8.66	318.77	NA

WELL CONCENTRATIONS
Shell-branded Service Station
5251 Hopyard Road
Pleasanton, CA

Well ID	Date	TPPH (ug/L)	TEPH (ug/L)	B (ug/L)	T (ug/L)	E (ug/L)	X (ug/L)	MTBE 8020 (ug/L)	MTBE 8260 (ug/L)	DIPE (ug/L)	ETBE (ug/L)	TAME (ug/L)	TBA (ug/L)	TOC (MSL)	Depth to Water (ft.)	GW Elevation (MSL)	DO Reading (ppm)
S-5	05/16/2006	349	NA	3.54	<0.500	<0.500	<0.500	NA	24.7	<0.500	<0.500	<0.500	182	327.43	9.00	318.43	NA
S-5	08/23/2006	<50.0	NA	5.39	<0.500	<0.500	<0.500	NA	17.0	<0.500	<0.500	<0.500	91.0	327.43	8.97	318.46	NA
S-5	11/13/2006	420	NA	19	1.7	<0.50	1.7	NA	19	<0.50	<0.50	<0.50	80	327.43	8.77	318.66	NA
S-5	02/01/2007	280	NA	14	2.1	<0.50	1.4	NA	13	<2.0	<2.0	<2.0	42	327.43	9.30	318.13	NA
S-5	05/23/2007	590 n	NA	19	2.0	<1.0	0.92 o	NA	11	<2.0	<2.0	<2.0	24	327.43	8.73	318.70	NA
S-6	01/25/1991	<50	<50	<0.5	1.7	<0.5	2.8	NA	NA	NA	NA	NA	NA	326.56	NA	NA	NA
S-6	04/16/1991	<50	<50	<0.5	<0.5	<0.5	0.6	NA	NA	NA	NA	NA	NA	326.56	NA	NA	NA
S-6	07/24/1991	<50	<50	<0.5	<0.5	<0.5	0.5	NA	NA	NA	NA	NA	NA	326.56	NA	NA	NA
S-6	10/18/1991	<50	<50	<0.5	<0.5	<0.5	0.5	NA	NA	NA	NA	NA	NA	326.56	8.84	317.22	NA
S-6	01/23/1992	<50	<50	<0.5	<0.5	<0.5	0.5	NA	NA	NA	NA	NA	NA	326.56	NA	NA	NA
S-6	04/27/1992	<50	<50	<0.5	<0.5	<0.5	<0.5	NA	NA	NA	NA	NA	NA	326.56	NA	NA	NA
S-6	07/17/1992	400	130	<0.5	<0.5	<0.5	<0.5	NA	NA	NA	NA	NA	NA	326.56	NA	NA	NA
S-6	10/16/1992	<50	<50	<0.5	<0.5	<0.5	<0.5	NA	NA	NA	NA	NA	NA	326.56	NA	NA	NA
S-6	01/23/1993	<50	230 b	<0.5	<0.5	<0.5	<0.5	NA	NA	NA	NA	NA	NA	326.56	7.82	318.74	NA
S-6	04/28/1993	<50	<50	<0.5	<0.5	<0.5	<0.5	NA	NA	NA	NA	NA	NA	326.56	9.00	317.56	NA
S-6	09/22/1993	<50	<50	<0.5	<0.5	<0.5	<0.5	NA	NA	NA	NA	NA	NA	326.56	8.61	317.96	NA
S-6	12/08/1993	<50	<50	<0.5	<0.5	<0.5	<0.5	NA	NA	NA	NA	NA	NA	326.56	10.02	316.54	NA
S-6	03/04/1994	<50	NA	<0.5	<0.5	<0.5	<0.5	NA	NA	NA	NA	NA	NA	326.56	8.88	317.68	NA
S-6	06/16/1994	<50	NA	<0.5	<0.5	<0.5	<0.5	NA	NA	NA	NA	NA	NA	326.56	9.04	317.52	NA
S-6	05/05/1995	<50	NA	<0.5	<0.5	<0.5	<0.5	NA	NA	NA	NA	NA	NA	326.56	8.54	318.02	NA
S-6	05/21/1996	<50	NA	<0.5	<0.5	<0.5	<0.5	NA	NA	NA	NA	NA	NA	326.56	8.62	317.94	NA
S-6	05/12/1997	<50	NA	<0.50	<0.50	<0.50	<0.50	<2.5	NA	NA	NA	NA	NA	326.56	8.60	317.96	2.6
S-6	05/08/1998	<50	NA	<0.50	<0.50	<0.50	<0.50	<2.5	NA	NA	NA	NA	NA	326.56	7.90	318.66	2.2
S-6	06/27/1999	430	NA	50.1	30.5	15.2	83.5	8.05	NA	NA	NA	NA	NA	326.56	8.01	318.55	2.3
S-6	04/28/2000	<50.0	NA	<0.500	<0.500	<0.500	<0.500	<2.50	NA	NA	NA	NA	NA	326.56	8.84	317.72	2.0

WELL CONCENTRATIONS
Shell-branded Service Station
5251 Hopyard Road
Pleasanton, CA

Well ID	Date	TPPH (ug/L)	TEPH (ug/L)	B (ug/L)	T (ug/L)	E (ug/L)	X (ug/L)	MTBE 8020 (ug/L)	MTBE 8260 (ug/L)	DIPE (ug/L)	ETBE (ug/L)	TAME (ug/L)	TBA (ug/L)	TOC (MSL)	Depth to Water (ft.)	GW Elevation (MSL)	DO Reading (ppm)
S-6	05/30/2001	<50	NA	<0.50	<0.50	<0.50	<0.50	NA	<0.50	NA	NA	NA	NA	326.56	8.54	318.02	1.9
S-6	06/17/2002	<50	NA	<0.50	<0.50	<0.50	<0.50	NA	<5.0	NA	NA	NA	NA	326.56	8.48	318.08	1.3
S-6	05/30/2003	<50	NA	<0.50	<0.50	<0.50	<1.0	NA	8.7	NA	NA	NA	NA	326.35	7.36	318.99	1.0
S-6	05/03/2004	<50	NA	<0.50	<0.50	<0.50	<1.0	NA	<0.50	NA	NA	NA	NA	326.35	8.08	318.27	0.9
S-6	01/14/2005	<50	NA	<0.50	<0.50	<0.50	<1.0	NA	<0.50	NA	NA	NA	NA	326.35	7.38	318.97	NA
S-6	05/05/2005	<50	NA	<0.50	<0.50	<0.50	<0.50	NA	<0.50	<0.50	<0.50	<0.50	<5.0	326.35	7.55	318.80	NA
S-6	08/05/2005	<50	NA	<0.50	<0.50	<0.50	<1.0	NA	<0.50	<2.0	<2.0	<2.0	<5.0	326.35	7.61	318.74	NA
S-6	11/08/2005	<50.0	NA	<0.500	<0.500	<0.500	<0.500	NA	<0.500	<0.500	<0.500	<0.500	<10.0	326.35	7.64	318.71	NA
S-6	01/31/2006	<50.0	NA	<0.500	<0.500	<0.500	<0.500	NA	<0.500	<0.500	<0.500	<0.500	30.5	326.35	7.90	318.45	NA
S-6	05/16/2006	<50.0	NA	<0.500	<0.500	<0.500	<0.500	NA	<0.500	<0.500	<0.500	<0.500	<10.0	326.35	8.16	318.19	NA
S-6	08/23/2006	<50.0	NA	<0.500	<0.500	<0.500	<0.500	NA	<0.500	<0.500	<0.500	<0.500	10.9	326.35	7.77	318.58	NA
S-6	11/13/2006	<50	NA	<0.50	<0.50	<0.50	<0.50	NA	<0.50	<0.50	<0.50	<0.50	<20	326.35	8.15	318.20	NA
S-6	02/01/2007	<50	NA	<0.50	<0.50	<0.50	<1.0	NA	1.2	<2.0	<2.0	<2.0	<5.0	326.35	8.36	317.99	NA
S-6	05/23/2007	<50 n	NA	<0.50	<1.0	<1.0	<1.0	NA	<1.0	<2.0	<2.0	<2.0	<10	326.35	7.80	318.55	NA
S-7	01/25/1991	<50	<50	<0.5	<0.5	<0.5	<0.5	NA	NA	NA	NA	NA	NA	326.49	NA	NA	NA
S-7	04/16/1991	<50	<50	<0.5	<0.5	<0.5	<0.5	NA	NA	NA	NA	NA	NA	326.49	NA	NA	NA
S-7	07/24/1991	<50	<50	<0.5	<0.5	<0.5	<0.5	NA	NA	NA	NA	NA	NA	326.49	NA	NA	NA
S-7	10/18/1991	<50	140 f	<0.5	<0.5	<0.5	<0.5	NA	NA	NA	NA	NA	NA	326.49	8.92	317.57	NA
S-7	01/23/1992	<50	140 f	<0.5	<0.5	<0.5	<0.5	NA	NA	NA	NA	NA	NA	326.49	NA	NA	NA
S-7	04/27/1992	<50	<50	<0.5	<0.5	<0.5	<0.5	NA	NA	NA	NA	NA	NA	326.49	NA	NA	NA
S-7	07/17/1992	<50	<50	<0.5	1.8	0.6	4.1	NA	NA	NA	NA	NA	NA	326.49	NA	NA	NA
S-7	10/16/1992	<50	<50	<0.5	<0.5	<0.5	<0.5	NA	NA	NA	NA	NA	NA	326.49	NA	NA	NA
S-7	01/23/1993	<50	110 b	<0.5	<0.5	<0.5	<0.5	NA	NA	NA	NA	NA	NA	326.49	8.06	318.43	NA
S-7	04/28/1993	<50	<50	<0.5	<0.5	<0.5	<0.5	NA	NA	NA	NA	NA	NA	326.49	8.94	317.55	NA
S-7	09/22/1993	NA	NA	NA	NA	NA	NA	NA	NA	NA	NA	NA	NA	326.49	8.57	317.92	NA

WELL CONCENTRATIONS
Shell-branded Service Station
5251 Hopyard Road
Pleasanton, CA

Well ID	Date	TPPH (ug/L)	TEPH (ug/L)	B (ug/L)	T (ug/L)	E (ug/L)	X (ug/L)	MTBE 8020 (ug/L)	MTBE 8260 (ug/L)	DIPE (ug/L)	ETBE (ug/L)	TAME (ug/L)	TBA (ug/L)	TOC (MSL)	Depth to Water (ft.)	GW Elevation (MSL)	DO Reading (ppm)
---------	------	----------------	----------------	-------------	-------------	-------------	-------------	------------------------	------------------------	----------------	----------------	----------------	---------------	--------------	----------------------------	--------------------------	------------------------

S-7	12/08/1993	NA	NA	NA	NA	NA	NA	NA	NA	NA	NA	NA	NA	326.49	9.00	317.49	NA
S-7	03/04/1994	NA	NA	NA	NA	NA	NA	NA	NA	NA	NA	NA	NA	326.49	8.96	317.53	NA
S-7	06/16/1994	NA	NA	NA	NA	NA	NA	NA	NA	NA	NA	NA	NA	326.49	9.12	317.37	NA
S-7	05/05/1995	<50	NA	<0.5	<0.5	<0.5	<0.5	NA	NA	NA	NA	NA	NA	326.49	8.58	317.91	NA
S-7	05/21/1996	<50	NA	<0.5	<0.5	<0.5	<0.5	NA	NA	NA	NA	NA	NA	326.49	8.64	317.85	NA
S-7	05/12/1997	<50	NA	<0.50	<0.50	<0.50	<0.50	<2.5	NA	NA	NA	NA	NA	326.49	8.74	317.75	2.3
S-7	05/08/1998	<50	NA	<0.50	<0.50	<0.50	<0.50	<2.5	NA	NA	NA	NA	NA	326.49	8.00	318.49	2.5
S-7	06/27/1999	<50.0	NA	<0.500	<0.500	<0.500	<0.500	<2.00	NA	NA	NA	NA	NA	326.49	8.75	317.74	2.9
S-7	04/28/2000	<50.0	NA	<0.500	<0.500	<0.500	<0.500	<2.50	NA	NA	NA	NA	NA	326.49	8.96	317.53	2.2
S-7	05/30/2001	<50	NA	<0.50	<0.50	<0.50	<0.50	NA	<0.50	NA	NA	NA	NA	326.49	8.65	317.84	2.0
S-7	06/17/2002	<50	NA	<0.50	<0.50	<0.50	<0.50	NA	<5.0	NA	NA	NA	NA	326.49	8.55	317.94	2.3
S-7	05/30/2003	<50	NA	<0.50	<0.50	<0.50	<1.0	NA	12	NA	NA	NA	NA	326.36	7.88	318.48	1.8
S-7	05/03/2004	<50	NA	<0.50	<0.50	<0.50	<1.0	NA	100	NA	NA	NA	NA	326.36	8.30	318.06	1.2
S-7	01/14/2005	<50	NA	<0.50	<0.50	<0.50	<1.0	NA	41	NA	NA	NA	NA	326.36	7.70	318.66	NA
S-7	05/05/2005	<50	NA	<0.50	<0.50	<0.50	<0.50	NA	91	<0.50	<0.50	6.8	<5.0	326.36	7.60	318.76	NA
S-7	08/05/2005	<50	NA	<0.50	<0.50	<0.50	<1.0	NA	100	<2.0	<2.0	7.5	<5.0	326.36	8.42	317.94	NA
S-7	11/08/2005	<50.0	NA	<0.500	<0.500	<0.500	<0.500	NA	124	<0.500	<0.500	8.70	<10.0	326.36	7.61	318.75	NA
S-7	01/31/2006	<50.0	NA	<0.500	<0.500	<0.500	<0.500	NA	93.0	<0.500	<0.500	4.50	<10.0	326.36	7.85	318.51	NA
S-7	05/16/2006	<50.0	NA	<0.500	<0.500	<0.500	<0.500	NA	76.3	<0.500	<0.500	2.98	<10.0	326.36	8.08	318.28	NA
S-7	08/23/2006	<50.0	NA	<0.500	<0.500	<0.500	<0.500	NA	34.7	<0.500	<0.500	2.02	<10.0	326.36	7.93	318.43	NA
S-7	11/13/2006	<50	NA	<0.50	<0.50	<0.50	<0.50	NA	27	<0.50	<0.50	1.6	<20	326.36	8.15	318.21	NA
S-7	02/01/2007	<50	NA	<0.50	<0.50	<0.50	<1.0	NA	45	<2.0	<2.0	2.9	28	326.36	8.35	318.01	NA
S-7	05/23/2007	<50 n	NA	<0.50	<1.0	<1.0	<1.0	NA	1.7	<2.0	<2.0	<2.0	<10	326.36	8.11	318.25	NA

S-8	01/25/1991	<50	<50	<0.5	<0.5	<0.5	<0.5	NA	NA	NA	NA	NA	NA	325.32	NA	NA	NA
S-8	04/16/1991	<50	<50	<0.5	<0.5	<0.5	<0.5	NA	NA	NA	NA	NA	NA	325.32	NA	NA	NA

WELL CONCENTRATIONS
Shell-branded Service Station
5251 Hopyard Road
Pleasanton, CA

Well ID	Date	TPPH (ug/L)	TEPH (ug/L)	B (ug/L)	T (ug/L)	E (ug/L)	X (ug/L)	MTBE 8020 (ug/L)	MTBE 8260 (ug/L)	DIPE (ug/L)	ETBE (ug/L)	TAME (ug/L)	TBA (ug/L)	TOC (MSL)	Depth to Water (ft.)	GW Elevation (MSL)	DO Reading (ppm)
S-8	07/24/1991	<50	<50	<0.5	<0.5	<0.5	<0.5	NA	NA	NA	NA	NA	NA	325.32	NA	NA	NA
S-8	10/18/1991	<50	360 f	<0.5	<0.5	<0.5	<0.5	NA	NA	NA	NA	NA	NA	325.32	7.62	317.70	NA
S-8	01/23/1992	<50	90	<0.5	<0.5	<0.5	<0.5	NA	NA	NA	NA	NA	NA	325.32	NA	NA	NA
S-8	04/27/1992	<50	<50	<0.5	<0.5	<0.5	<0.5	NA	NA	NA	NA	NA	NA	325.32	NA	NA	NA
S-8	07/17/1992	53	<50	<0.5	1	<0.5	1.8	NA	NA	NA	NA	NA	NA	325.32	NA	NA	NA
S-8	10/16/1992	<50	<50	<0.5	<0.5	<0.5	<0.5	NA	NA	NA	NA	NA	NA	325.32	NA	NA	NA
S-8	01/23/1993	<50	<50	<0.5	<0.5	<0.5	<0.5	NA	NA	NA	NA	NA	NA	325.32	7.00	318.32	NA
S-8	04/28/1993	<50	<50	<0.5	<0.5	<0.5	<0.5	NA	NA	NA	NA	NA	NA	325.32	7.77	317.55	NA
S-8	09/22/1993	<50	160	<0.5	<0.5	<0.5	<0.5	NA	NA	NA	NA	NA	NA	325.32	7.67	317.65	NA
S-8	12/08/1993	<50	210	<0.5	<0.5	<0.5	<0.5	NA	NA	NA	NA	NA	NA	325.32	7.76	317.56	NA
S-8	03/04/1994	<50	NA	<0.5	<0.5	<0.5	<0.5	NA	NA	NA	NA	NA	NA	325.32	7.66	317.66	NA
S-8	06/16/1994	<50	NA	<0.5	<0.5	<0.5	<0.5	NA	NA	NA	NA	NA	NA	325.32	7.78	317.54	NA
S-8	05/05/1995	<50	NA	<0.5	<0.5	<0.5	<0.5	NA	NA	NA	NA	NA	NA	325.32	7.42	317.90	NA
S-8	05/21/1996	<50	NA	<0.5	<0.5	<0.5	<0.5	NA	NA	NA	NA	NA	NA	325.32	7.50	317.82	NA
S-8	05/12/1997	<50	NA	<0.50	<0.50	<0.50	<0.50	<2.5	NA	NA	NA	NA	NA	325.32	7.56	317.76	1.6
S-8	05/08/1998	<50	NA	<0.50	<0.50	<0.50	<0.50	<2.5	NA	NA	NA	NA	NA	325.32	7.64	317.68	2.0
S-8	06/27/1999	<50.0	NA	<0.500	<0.500	<0.500	<0.500	<2.00	NA	NA	NA	NA	NA	325.32	7.75	317.57	2.3
S-8	04/28/2000	<50.0	NA	<0.500	<0.500	<0.500	<0.500	<2.50	NA	NA	NA	NA	NA	325.32	8.02	317.30	1.8
S-8	05/30/2001	<50	NA	<0.50	<0.50	<0.50	<0.50	NA	<0.50	NA	NA	NA	NA	325.32	7.34	317.98	1.8
S-8	06/17/2002	<50	NA	<0.50	<0.50	<0.50	<0.50	NA	<5.0	NA	NA	NA	NA	325.32	7.45	317.87	1.8
S-8	05/30/2003	<50	NA	<0.50	<0.50	<0.50	<1.0	NA	14	NA	NA	NA	NA	325.03	7.39	317.64	3.0
S-8	05/03/2004	<50	NA	<0.50	<0.50	<0.50	<1.0	NA	<0.50	NA	NA	NA	NA	325.03	7.00	318.03	1.0
S-8	01/14/2005	<50	NA	<0.50	<0.50	<0.50	<1.0	NA	<0.50	NA	NA	NA	NA	325.03	8.65	316.39	NA
S-8	05/05/2005	<50	NA	<0.50	<0.50	<0.50	<0.50	NA	<0.50	<0.50	<0.50	<0.50	<5.0	325.03	6.73	318.30	NA
S-8	08/05/2005	<50	NA	<0.50	<0.50	<0.50	<1.0	NA	<0.50	<2.0	<2.0	<2.0	<5.0	325.03	6.93	318.10	NA
S-8	11/08/2005	<50.0	NA	<0.500	<0.500	<0.500	<0.500	NA	<0.500	<0.500	<0.500	<0.500	<10.0	325.03	6.95	318.08	NA

WELL CONCENTRATIONS
Shell-branded Service Station
5251 Hopyard Road
Pleasanton, CA

Well ID	Date	TPPH (ug/L)	TEPH (ug/L)	B (ug/L)	T (ug/L)	E (ug/L)	X (ug/L)	MTBE 8020 (ug/L)	MTBE 8260 (ug/L)	DIPE (ug/L)	ETBE (ug/L)	TAME (ug/L)	TBA (ug/L)	TOC (MSL)	Depth to Water (ft.)	GW Elevation (MSL)	DO Reading (ppm)
S-8	01/31/2006	<50.0	NA	<0.500	<0.500	<0.500	<0.500	NA	<0.500	<0.500	<0.500	<0.500	<10.0	325.03	6.91	318.12	NA
S-8	05/16/2006	<50.0	NA	<0.500	<0.500	<0.500	<0.500	NA	<0.500	<0.500	<0.500	<0.500	<10.0	325.03	7.02	318.01	NA
S-8	08/23/2006	<50.0	NA	<0.500	<0.500	<0.500	<0.500	NA	<0.500	<0.500	<0.500	<0.500	<10.0	325.03	6.98	318.05	NA
S-8	11/13/2006	<50	NA	<0.50	<0.50	<0.50	<0.50	NA	<0.50	<0.50	<0.50	<0.50	<20	325.03	7.09	317.94	NA
S-8	02/01/2007	<50	NA	<0.50	<0.50	<0.50	<1.0	NA	<0.50	<2.0	<2.0	<2.0	<5.0	325.03	7.27	317.76	NA
S-8	05/23/2007	<50 n	NA	<0.50	<1.0	<1.0	<1.0	NA	<1.0	<2.0	<2.0	<2.0	<10	325.03	6.80	318.23	NA
S-9	11/22/2006	NA	NA	NA	NA	NA	NA	NA	NA	NA	NA	NA	NA	325.89	7.61	318.28	NA
S-9	11/27/2006	<50	NA	<0.50	<0.50	<0.50	<1.0	NA	<0.50	<2.0	<2.0	<2.0	<5.0	325.89	7.77	318.12	NA
S-9	02/01/2007	<50	NA	<0.50	<0.50	<0.50	<1.0	NA	<0.50	<2.0	<2.0	<2.0	<5.0	325.89	8.14	317.75	NA
S-9	05/23/2007	<50 n	NA	<0.50	<1.0	<1.0	<1.0	NA	<1.0	<2.0	<2.0	<2.0	<10	325.89	7.85	318.04	NA

WELL CONCENTRATIONS
Shell-branded Service Station
5251 Hopyard Road
Pleasanton, CA

Well ID	Date	TPPH (ug/L)	TEPH (ug/L)	B (ug/L)	T (ug/L)	E (ug/L)	X (ug/L)	MTBE 8020 (ug/L)	MTBE 8260 (ug/L)	DIPE (ug/L)	ETBE (ug/L)	TAME (ug/L)	TBA (ug/L)	TOC (MSL)	Depth to Water (ft.)	GW Elevation (MSL)	DO Reading (ppm)
---------	------	----------------	----------------	-------------	-------------	-------------	-------------	------------------------	------------------------	----------------	----------------	----------------	---------------	--------------	----------------------------	--------------------------	------------------------

Abbreviations:

TPPH = Total petroleum hydrocarbons as gasoline by EPA Method 8260B; prior to May 30, 2001 analyzed by EPA Method 8015.

TEPH = Total petroleum hydrocarbons as diesel by modified EPA Method 8015.

BTEX = Benzene, toluene, ethylbenzene, xylenes by EPA Method 8260B; prior to May 30, 2001, analyzed by EPA Method 8020.

MTBE = Methyl tertiary butyl ether

DIPE = Di-isoproyl ether, analyzed by EPA Method 8260B

ETBE = Ethyl tertiary butyl ether, analyzed by EPA Method 8260B

TAME = Tertiary amyl methyl ether, analyzed by EPA Method 8260B

TBA = Tertiary butyl alcohol, analyzed by EPA Method 8260B

TOC = Top of Casing Elevation

TOB = Top of Wellbox Elevation

SPH = Separate-Phase Hydrocarbons

GW = Groundwater

DO = Dissolved Oxygen

ug/L = Parts per billion

ppm = Parts per million

MSL = Mean sea level

ft. = Feet

<n = Below detection limit

(D) = Duplicate sample

WELL CONCENTRATIONS
Shell-branded Service Station
5251 Hopyard Road
Pleasanton, CA

Well ID	Date	TPPH (ug/L)	TEPH (ug/L)	B (ug/L)	T (ug/L)	E (ug/L)	X (ug/L)	MTBE 8020 (ug/L)	MTBE 8260 (ug/L)	DIPE (ug/L)	ETBE (ug/L)	TAME (ug/L)	TBA (ug/L)	TOC (MSL)	Depth to Water (ft.)	GW Elevation (MSL)	DO Reading (ppm)
---------	------	----------------	----------------	-------------	-------------	-------------	-------------	------------------------	------------------------	----------------	----------------	----------------	---------------	--------------	----------------------------	--------------------------	------------------------

Notes:

- a = Compounds detected as TEPH appear to be the less volatile constituents of gasoline.
 - b = The concentration reported as TEPH primarily due to the presence of a heavier petroleum product.
 - c = The concentration reported as TEPH due to the presence of a lighter petroleum product.
 - d = Concentrations reported as diesel includes a heavier petroleum product.
 - e = Compounds detected within the chromatographic range of TEPH but not characteristic of the standard gasoline pattern.
 - f = There was insufficient preservative to reduce the sample pH to less than 2.
 - g = Compounds detected within the chromatographic range of TEPH but not characteristic of the standard diesel pattern.
 - h = The chromatographic pattern of the purgeable hydrocarbons found in the sample is similar to the pattern of weathered gasoline.
 - i = DO reading not taken.
 - j = The results may be biased slightly high.
 - k = The hydrocarbon reported in the gasoline range does not match the laboratory standard.
 - l = Extracted out of holding time.
 - m = Analyte was detected in the associated Method Blank.
 - n = Analyzed by EPA Method 8015B (M).
 - o = Analyte was detected at a concentration below the reporting limit and above the laboratory method detection limit. Reported value is estimated.
- Site surveyed April 16, 2002 by Virgil Chavez Land Surveying of Vallejo, CA.
Beginning May 30, 2003, depth to water referenced to Top of Casing elevation.
Wells S-2, S-3 and S-9 were surveyed on November 22, 2006 by Mid Coast Engineers.



DRAWN BY
J.F.F.

6/27/2007

CHECKED BY

APPROVED BY

PROJECT NUMBER
SJ5251H1X

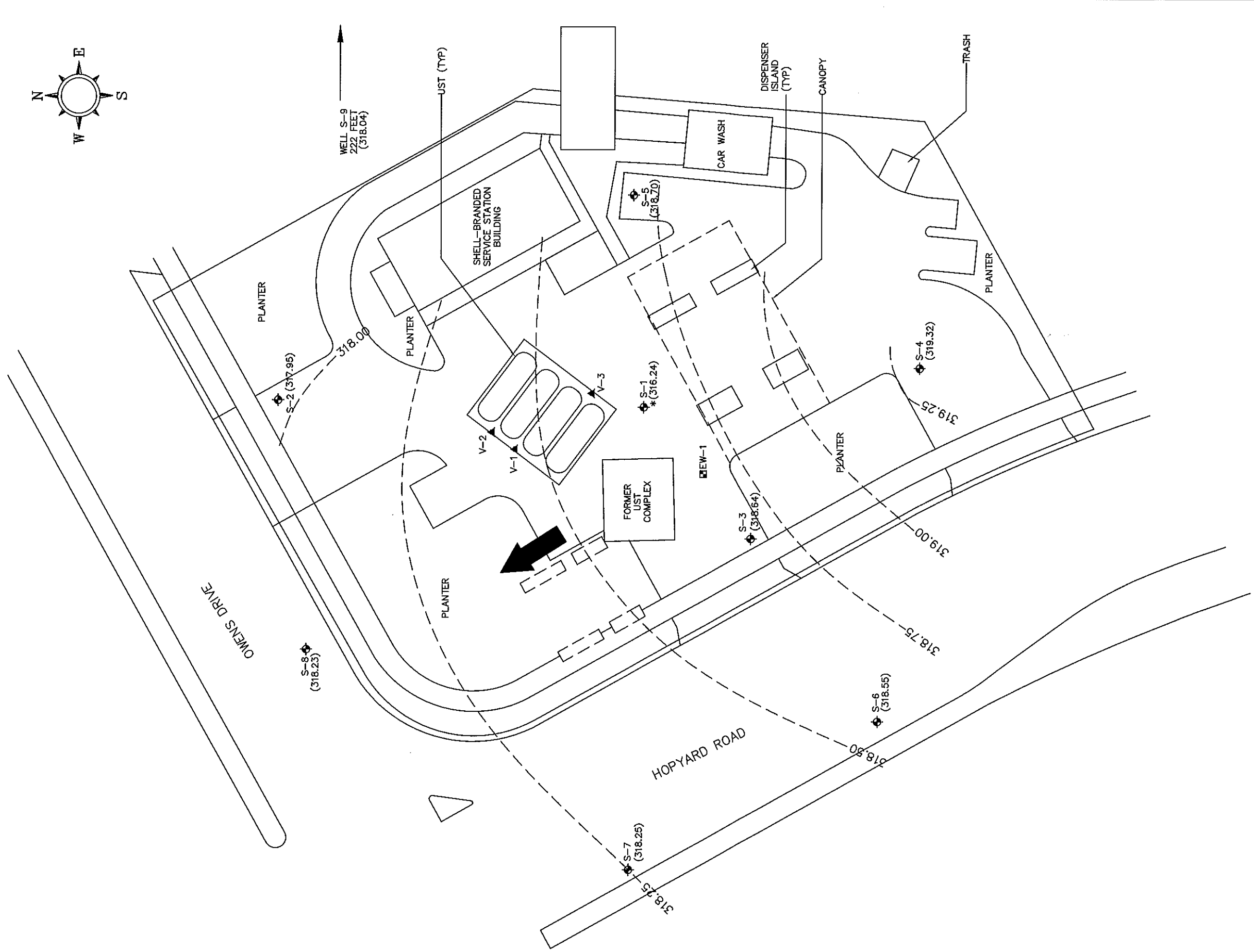
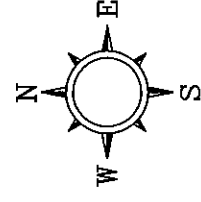

LEGEND

- S-1 GROUNDWATER MONITORING WELL LOCATION AND DESIGNATION (SHELL)
- EW-1 GROUNDWATER EXTRACTION WELL LOCATION AND DESIGNATION
- V-1 SOIL VAPOR EXTRACTION WELL LOCATION AND DESIGNATION
- (318.28) GROUNDWATER ELEVATION IN FEET ABOVE MEAN SEA LEVEL (FT/MSL)
- 318.25 GROUNDWATER CONTOUR IN FEET ABOVE MEAN SEA LEVEL (FT/MSL) CONTOUR INTERVAL=0.50 FEET
- APPROXIMATE GROUNDWATER GRADIENT DIRECTION (ft/ft)
- * NOT USED IN CONTOURING



DELTA CONSULTANTS

SHELL OIL PRODUCTS US
SHELL-BRANDED SERVICE STATION
PLEASANTON, CALIFORNIA

FIGURE 2
GROUNDWATER ELEVATION CONTOUR
MAP

5/23/2007
5251 HOPYARD ROAD
PLEASANTON, CALIFORNIA

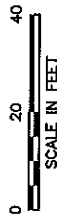

DRAWN BY
J.F.F.

6/27/2007

CHECKED BY

APPROVED BY

PROJECT NUMBER
SJ5251H1X

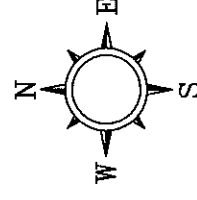

WELL S-9
222 FEET

S-2			
BENZENE ($\mu\text{g/L}$)	MTBE ($\mu\text{g/L}$)	TBA ($\mu\text{g/L}$)	
ND<0.50	110	1500	

S-8			
BENZENE ($\mu\text{g/L}$)	MTBE ($\mu\text{g/L}$)	TBA ($\mu\text{g/L}$)	
ND<0.50	ND<1.0	ND<10	

S-9			
BENZENE ($\mu\text{g/L}$)	MTBE ($\mu\text{g/L}$)	TBA ($\mu\text{g/L}$)	
ND<0.50	ND<1.0	ND<10	

S-1			
BENZENE ($\mu\text{g/L}$)	MTBE ($\mu\text{g/L}$)	TBA ($\mu\text{g/L}$)	
35	ND<5.0	720	

S-7			
BENZENE ($\mu\text{g/L}$)	MTBE ($\mu\text{g/L}$)	TBA ($\mu\text{g/L}$)	
ND<0.50	1.7	ND<10	

S-3			
BENZENE ($\mu\text{g/L}$)	MTBE ($\mu\text{g/L}$)	TBA ($\mu\text{g/L}$)	
370	21	12	

S-6			
BENZENE ($\mu\text{g/L}$)	MTBE ($\mu\text{g/L}$)	TBA ($\mu\text{g/L}$)	
ND<0.50	ND<1.0	ND<10	

S-5			
BENZENE ($\mu\text{g/L}$)	MTBE ($\mu\text{g/L}$)	TBA ($\mu\text{g/L}$)	
19	11	24	

S-4			
BENZENE ($\mu\text{g/L}$)	MTBE ($\mu\text{g/L}$)	TBA ($\mu\text{g/L}$)	
ND<0.50	0.60	ND<10	

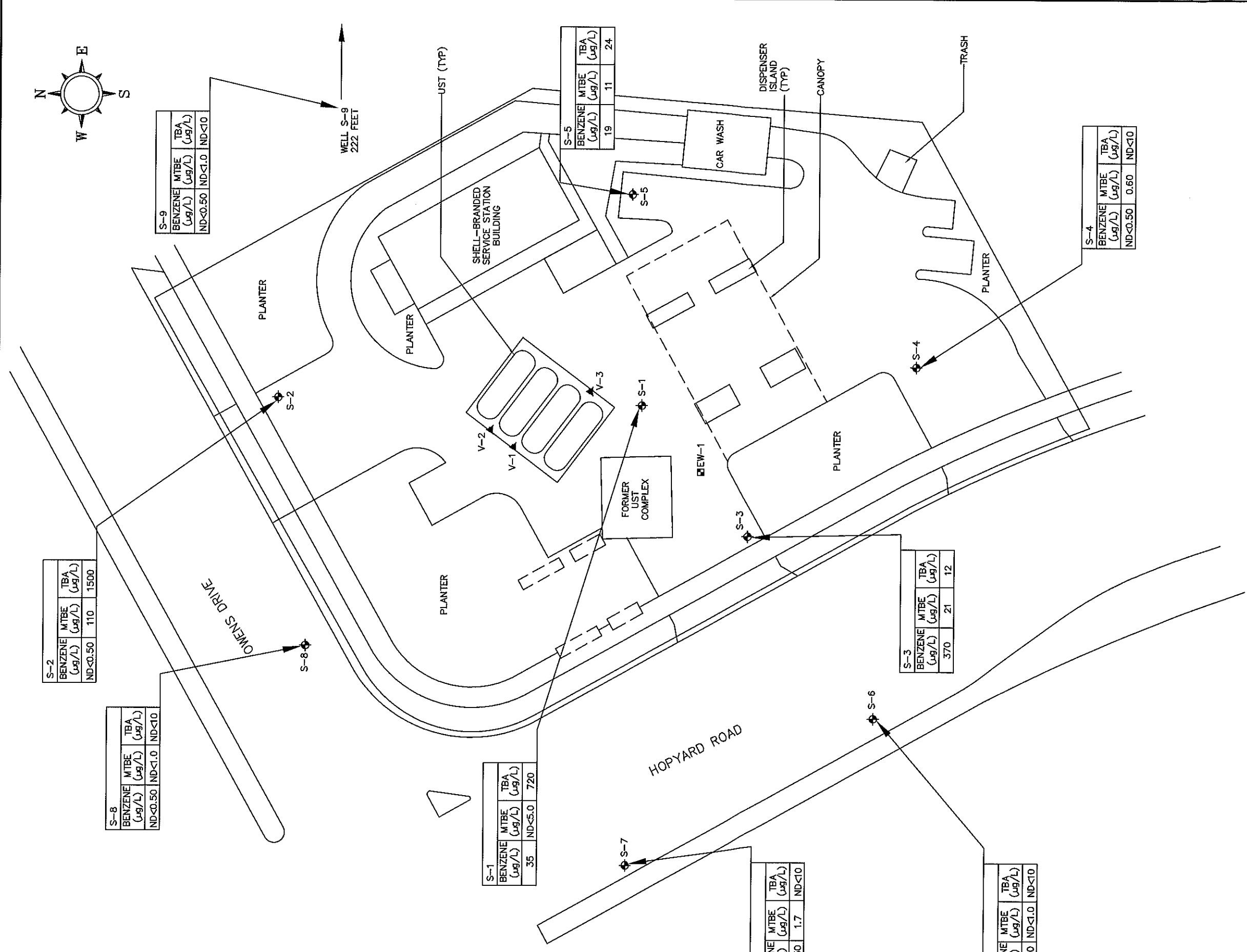

LEGEND

- S-1 GROUNDWATER MONITORING WELL LOCATION AND DESIGNATION (SHELL)
- EW-1 GROUNDWATER EXTRACTION WELL LOCATION AND DESIGNATION
- V-1 SOIL VAPOR EXTRACTION WELL LOCATION AND DESIGNATION
- MTBE METHYL TERT-BUTYL ETHER
- TBA TERT-BUTYL ALCOHOL
- ND< NOT DETECTED ABOVE LIMIT NOTED
- $\mu\text{g/L}$ MICROGRAMS PER LITER



DELTA CONSULTANTS

SHELL OIL PRODUCTS US
SHELL-BRANDED SERVICE STATION
PLEASANTON, CALIFORNIA

FIGURE 3

BENZENE, MTBE, AND TBA CONCENTRATION

MAP

5/23/2007

5251 HOPYARD ROAD
PLEASANTON, CALIFORNIA