

Atlantic Richfield Company

Shannon Couch
Operations Project Manager

PO Box 1257
San Ramon, CA 94583
Phone: (925) 275-3804
Fax: (925) 275-3815
E-Mail: shannon.couch@bp.com

April 15, 2013

RECEIVED

By Alameda County Environmental Health at 10:11 am, Apr 17, 2013

Re: First Quarter 2013 Status Report
Atlantic Richfield Company Station #2162
15135 Hesperian Boulevard, San Leandro, California
ACEH Case #RO0000190

I declare that to the best of my knowledge at the present time, that the information and/or recommendations contained in the attached document are true and correct.

Submitted by,

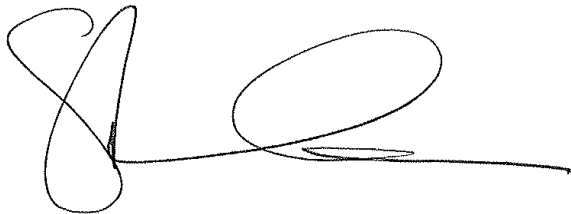

Shannon Couch
Operations Project Manager

Attachment



BROADBENT

875 Cotting Ln., Suite G, Vacaville, CA 95688

[T] 707-455-7290 [F] 707-455-7295

broadbentinc.com

CREATING SOLUTIONS. BUILDING TRUST.

April 15, 2013

Project No. 06-88-620

Atlantic Richfield Company
P.O. Box 1257
San Ramon, CA 94583
Submitted via ENFOS

Attn.: Ms. Shannon Couch

Re: First Quarter 2013 Status Report, Atlantic Richfield Company Station #2162,
15135 Hesperian Boulevard, San Leandro, California; ACEH Case #RO0000190

Dear Ms. Couch:

Attached is the First Quarter 2013 Status Report for Atlantic Richfield Company Station #2162 located at 15135 Hesperian Boulevard in San Leandro, California. Should you have questions regarding this submittal, please do not hesitate to contact us at (707)455-7290.

Sincerely,
BROADBENT & ASSOCIATES, INC.

Alexander J. Martinez
Senior Staff Geologist

Kristene Tidwell, P.G., CHG
Senior Geologist

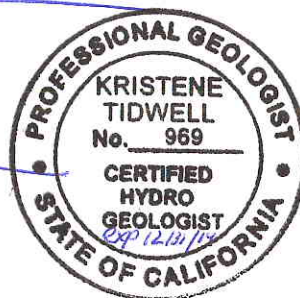

Enclosures

cc: Ms. Dilan Roe, P.E., Alameda County Environmental Health (submitted via ACEH ftp site)
Electronic copy uploaded to GeoTracker

**FIRST QUARTER 2013
STATUS REPORT
ARCO STATION #2162, SAN LEANDRO, CALIFORNIA**

Broadbent & Associates, Inc. (Broadbent) is pleased to present this *First Quarter 2013 Status Report* on behalf of Atlantic Richfield Company (a BP affiliated company) for ARCO Station #2162 located in San Leandro, Alameda County, California. Quarterly reporting is being submitted to the Alameda County Environmental Health Services Agency (ACEH) consistent with their requirements under the legal authority of the California Regional Water Quality Control Board as codified by California Code of Regulations Title 23, Section 2652(d). A summary description of current developments regarding the site is provided below.

Facility Name / Address:	ARCO Station #2162 / 15135 Hesperian Boulevard, San Leandro
Client Project Manager / Title:	Ms. Shannon Couch / Remediation Management Project Manager
Broadbent Contact:	Ms. Kristene Tidwell, PG, CHG / 707-455-7290
Broadbent Project No.:	06-88-620
Primary Regulatory Agency / ID No.:	ACEH, Case #RO0000190
Current phase of project:	Monitoring/Offsite Assessment
List of Acronyms / Abbreviations:	See end of report text for list of acronyms/abbreviations used in report.

WORK PERFORMED THIS QUARTER (First Quarter 2013):

1. Submitted *Fourth Quarter 2012 Groundwater Monitoring Report* on January 31, 2013.
2. No environmental field work was conducted at ARCO Station #2162 during the First Quarter 2012.

WORK SCHEDULED FOR NEXT QUARTER (Second Quarter 2013):

1. Submit *First Quarter 2013 Status Report* (contained herein).
2. Conduct groundwater monitoring for Second Quarter 2013.
3. Implement *Revised Work Plan for Offsite Groundwater Investigation* upon approval from ACEH.

DISCUSSION:

No groundwater monitoring and sampling work activities took place at ARCO Station #2162 during First Quarter 2013. Groundwater monitoring and sampling activities will be conducted during the Second Quarter 2013. In accordance with the Broadbent *Work Plan for Offsite Groundwater Investigation*, an offsite property access agreement has been secured for the adjacent parking lot of the neighboring KFC restaurant located at 15179 Hesperian Boulevard. To date, BP and Broadbent have not received an approval or comment letter from ACEH regarding their requested review of the proposed offsite groundwater investigation work plan. For reference, a Site Location Map is provided as Drawing 1, and a sketch showing proposed geoprobe boring locations is provided as Drawing 2.

ATTACHMENTS:

- Drawing 1: Site Location Map
Drawing 2: Proposed GeoProbe Boring Locations

LIST OF COMMONLY USED ACCRONYMS/ABBREVIATIONS:

ACEH:	Alameda County Environmental Health	ft/ft:	feet per foot
ACPWA:	Alameda County Public Works Agency	gal:	Gallons
BTEX:	Benzene, Toluene, Ethylbenzene, Total Xylenes	GRO:	Gasoline-Range Organics
1,2-DCA:	1,2-Dichloroethane	LNAPL:	Light Non-Aqueous Phase Liquid
DIPE:	Di-Isopropyl Ether	MTBE:	Methyl Tertiary Butyl Ether
DO:	Dissolved Oxygen	NO ₃ :	Nitrate as Nitrogen
DRO:	Diesel-Range Organics	ppb:	parts per billion
EDB:	1,2-Dibromomethane	SO ₄ :	Sulfate
Eh:	Oxidation Reduction Potential	TAME:	Tert-Amyl Methyl Ether
EPA:	Environmental Protection Agency	TBA:	Tertiary Butyl Ether
ETBE:	Ethyl Tertiary Butyl Ether	TOC:	Top of Casing
Fe ²⁺ :	Ferrous Iron	µg/L:	micrograms per liter

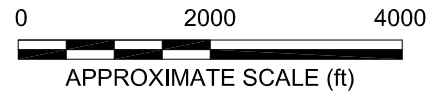
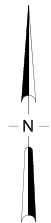
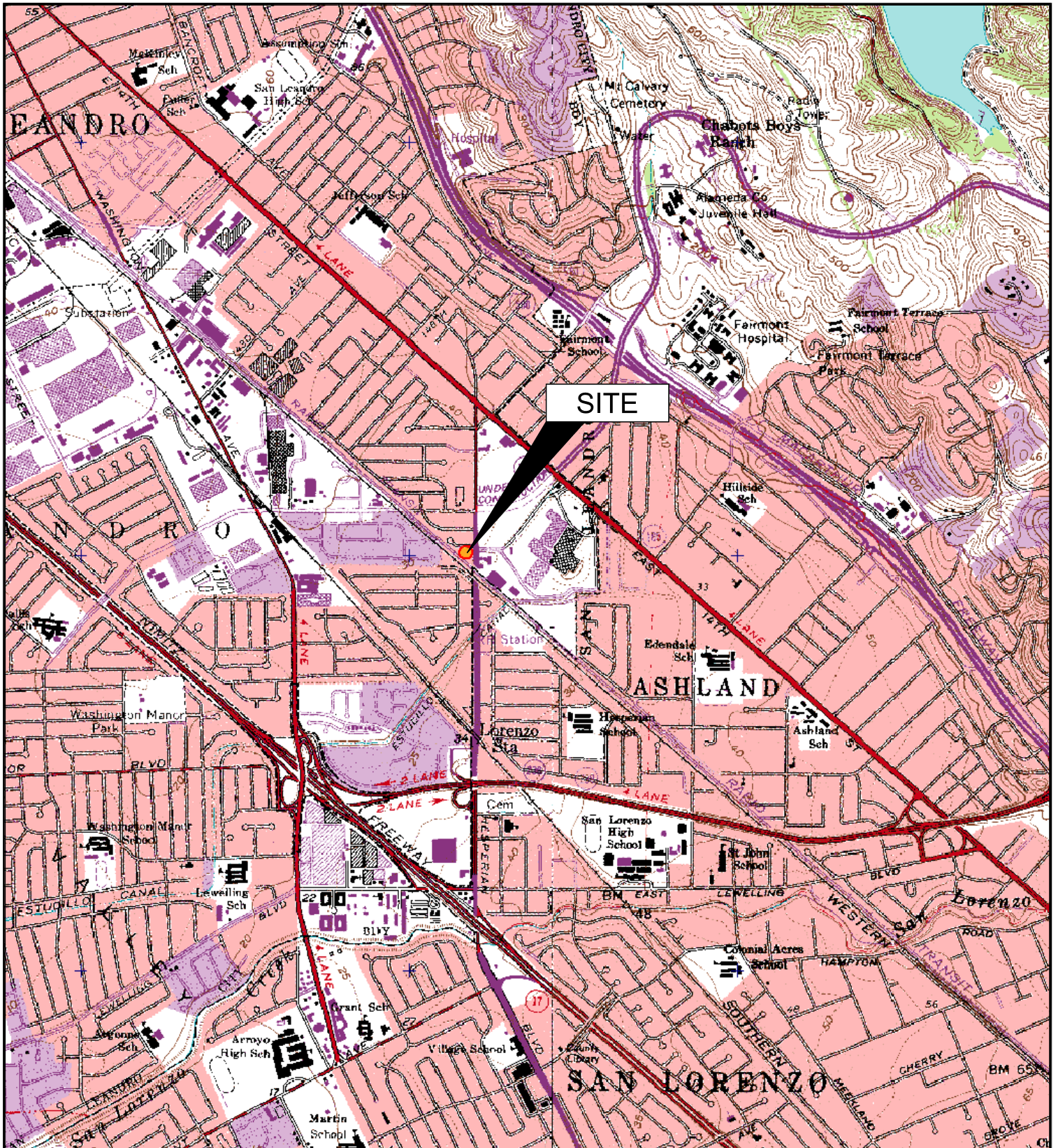

IMAGE SOURCE: USGS

BROADBENT & ASSOCIATES, INC
ENGINEERING, WATER RESOURCES & ENVIRONMENTAL
1324 Mangrove Ave, Suite 212, Chico, CA 95926
Project No.: 06-88-620 Date: 07/27/09

Station #2162
15135 Hesperian Boulevard
San Leandro, California

Site Location Map



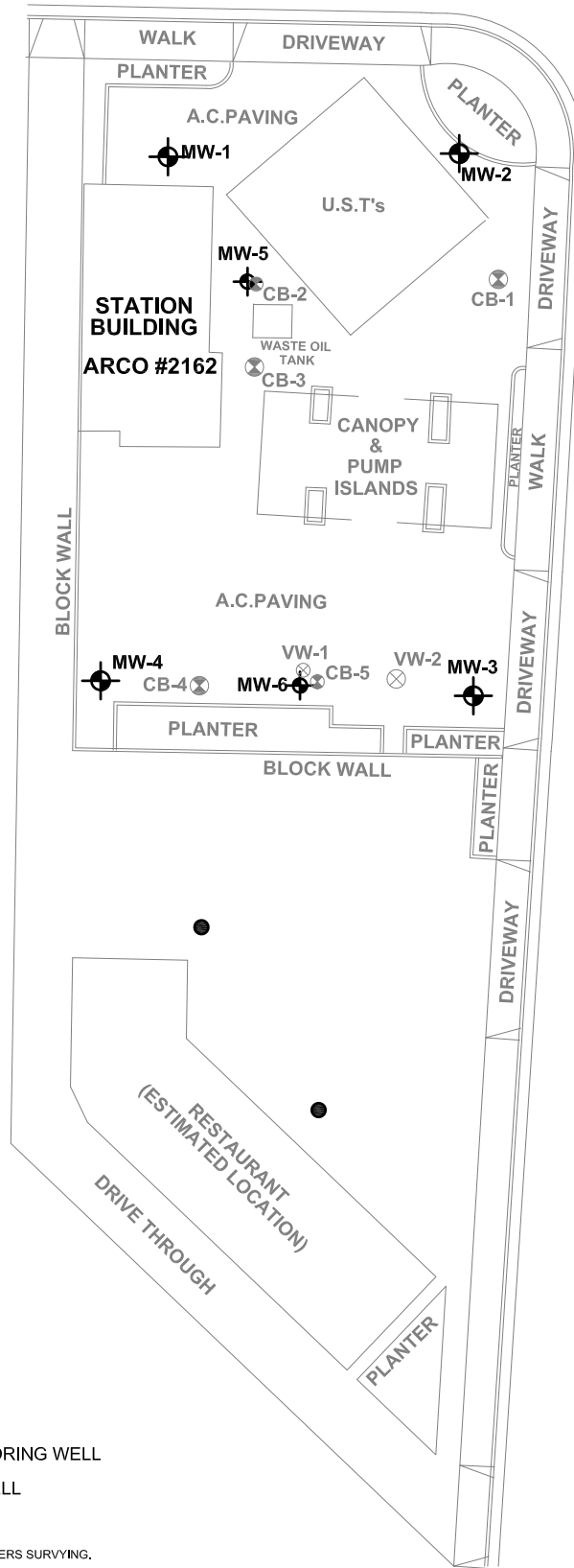

Drawing
1

RUTH COURT



HESPERIAN BLVD.

LEGEND

-  PROPOSED BORING
-  GROUNDWATER MONITORING WELL
-  VAPOR EXTRACTION WELL
-  SOIL BORING

NOTE: SITE MAP ADAPTED FROM WOOD RODGERS SURVYING.

