

Atlantic Richfield Company

Shannon Couch
Operations Project Manager

PO Box 1257
San Ramon, CA 94583
Phone: (925) 275-3804
Fax: (925) 275-3815
E-Mail: shannon.couch@bp.com

October 25, 2012

RECEIVED

11:43 am, Nov 01, 2012

Alameda County
Environmental Health

Re: Third Quarter 2012 Status Report
Atlantic Richfield Company Station #2162
15135 Hesperian Boulevard, San Leandro, California
ACEH Case #RO0000190

I declare that to the best of my knowledge at the present time, that the information and/or recommendations contained in the attached document are true and correct.

Submitted by,



Shannon Couch
Operations Project Manager

Attachment



BROADBENT

1324 Mangrove Ave., Suite 212, Chico, CA 95926

[T] 530-566-1400 [F] 530-566-1401

broadbentinc.com

Creating Solutions. Building Trust.

October 25, 2012

Project No. 06-88-620

Atlantic Richfield Company
P.O. Box 1257
San Ramon, CA 94583
Submitted via ENFOS

Attn.: Ms. Shannon Couch

Re: Third Quarter 2012 Status Report, Atlantic Richfield Company Station #2162,
15135 Hesperian Boulevard, San Leandro, California; ACEH Case #RO0000190

Dear Ms. Couch:

Attached is the Third Quarter 2012 Status Report for Atlantic Richfield Company Station #2162 located at 15135 Hesperian Boulevard in San Leandro, California. This report presents a summary of current developments at the Site through the Third Quarter of 2012.

Should you have questions regarding this submittal, please do not hesitate to contact us at (530) 566-1400.

Sincerely,
BROADBENT & ASSOCIATES, INC.

Thomas A. Venus, P.E.
Senior Engineer



Enclosures

cc: Ms. Dilan Roe, P.E., Alameda County Environmental Health (submitted via ACEH ftp site)
Electronic copy uploaded to GeoTracker

**THIRD QUARTER 2012
STATUS REPORT
ARCO STATION #2162, SAN LEANDRO, CALIFORNIA**

Broadbent & Associates, Inc. (Broadbent) is pleased to present this *Third Quarter 2012 Status Report* on behalf of Atlantic Richfield Company (a BP affiliated company) for ARCO Station #2162 located in San Leandro, Alameda County, California. Quarterly reporting is being submitted to the Alameda County Environmental Health Services Agency (ACEH) consistent with their requirements under the legal authority of the California Regional Water Quality Control Board as codified by California Code of Regulations Title 23, Section 2652(d). A summary description of current developments regarding the site is provided below.

Facility Name / Address:	<u>ARCO Station #2162 / 15135 Hesperian Boulevard, San Leandro</u>
Client Project Manager / Title:	<u>Ms. Shannon Couch / Remediation Management Project Manager</u>
Broadbent Contact:	<u>Mr. Tom Venus, PE / (530) 566-1400</u>
Broadbent Project No.:	<u>06-88-620</u>
Primary Regulatory Agency / ID No.:	<u>ACEH, Case #RO0000190</u>
Current phase of project:	<u>Monitoring/Offsite Assessment</u>
List of Acronyms / Abbreviations:	<u>See end of report text for list of acronyms/abbreviations used in report.</u>

WORK PERFORMED THIS QUARTER (Third Quarter 2012):

1. Submitted *Second Quarter 2012 Groundwater Monitoring Report* (Broadbent, 7/30/2012).
2. No environmental field work was conducted at ARCO Station #2162 during the Third Quarter 2012.

WORK SCHEDULED FOR NEXT QUARTER (Fourth Quarter 2012):

1. Submit *Third Quarter 2012 Status Report* (contained herein).
2. Conduct semi-annual groundwater monitoring/sampling for Fourth Quarter 2012.
3. Submit revised Work Plan for Off-Site Groundwater Investigation.

DISCUSSION:

No environmental field work was conducted at ARCO Station #2162 during the Third Quarter of 2012. Semi-annual groundwater monitoring and sampling is scheduled to be conducted at ARCO Station #2162 during the Fourth Quarter of 2012, consistent with the current monitoring program.

On January 5, 2012, Broadbent submitted a *Work Plan for Off-Site Groundwater Investigation*. Broadbent is in the process of revising this work plan and shall resubmit the revised work plan for ACEH approval during the Fourth Quarter of 2012. Broadbent has already secured the offsite property access agreement for the adjacent parking lot of the neighboring KFC Restaurant located at 15179 Hesperian Boulevard. Broadbent has also selected a C-57 licensed contractor for drilling the offsite GeoProbe borings to collect groundwater samples and has prepared soil-boring permits with the Alameda County Public Works Agency (ACPWA). For reference a Site Location Map is provided as Drawing 1, and a sketch showing Proposed GeoProbe Boring Locations is provided as Drawing 2.

ATTACHMENTS:

- Drawing 1: Site Location Map
Drawing 2: Proposed GeoProbe Boring Locations

LIST OF COMMONLY USED ACCRONYMS/ABBREVIATIONS:

ACEH:	Alameda County Environmental Health	ft/ft:	feet per foot
ACPWA:	Alameda County Public Works Agency	gal:	Gallons
BTEX:	Benzene, Toluene, Ethylbenzene, Total Xylenes	GRO:	Gasoline-Range Organics
1,2-DCA:	1,2-Dichloroethane	LNAPL:	Light Non-Aqueous Phase Liquid
DIPE:	Di-Isopropyl Ether	MTBE:	Methyl Tertiary Butyl Ether
DO:	Dissolved Oxygen	NO ₃ :	Nitrate as Nitrogen
DRO:	Diesel-Range Organics	ppb:	parts per billion
EDB:	1,2-Dibromomethane	SO ₄ :	Sulfate
Eh:	Oxidation Reduction Potential	TAME:	Tert-Amyl Methyl Ether
EPA:	Environmental Protection Agency	TBA:	Tertiary Butyl Ether
ETBE:	Ethyl Tertiary Butyl Ether	TOC:	Top of Casing
Fe ²⁺ :	Ferrous Iron	µg/L:	micrograms per liter

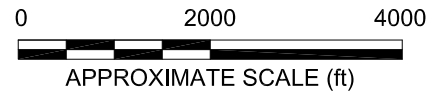
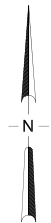
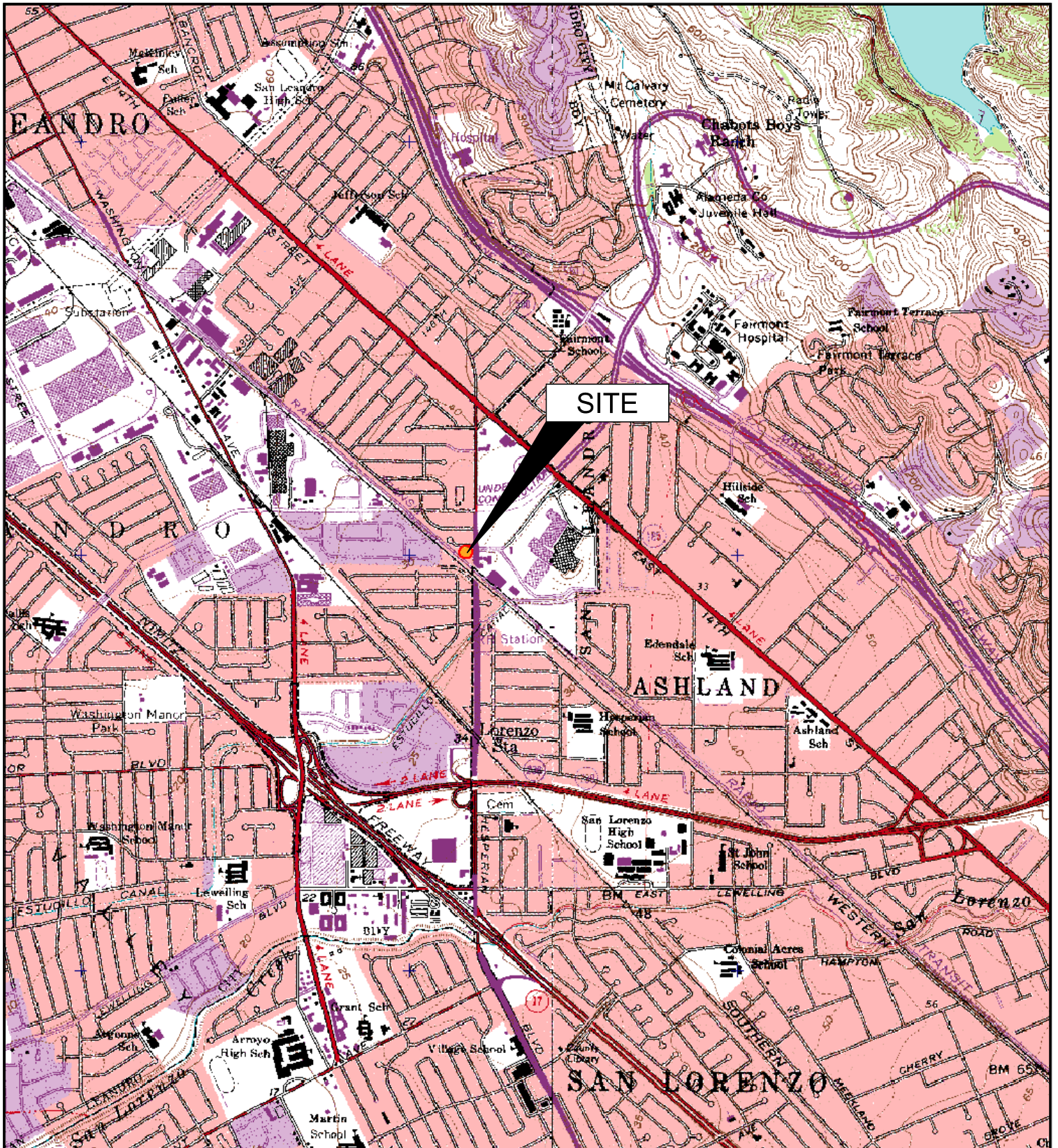

IMAGE SOURCE: USGS

BROADBENT & ASSOCIATES, INC
 ENGINEERING, WATER RESOURCES & ENVIRONMENTAL
 1324 Mangrove Ave. Suite 212, Chico, CA 95926
 Project No.: 06-88-620 Date: 07/27/09

Station #2162
 15135 Hesperian Boulevard
 San Leandro, California

Site Location Map



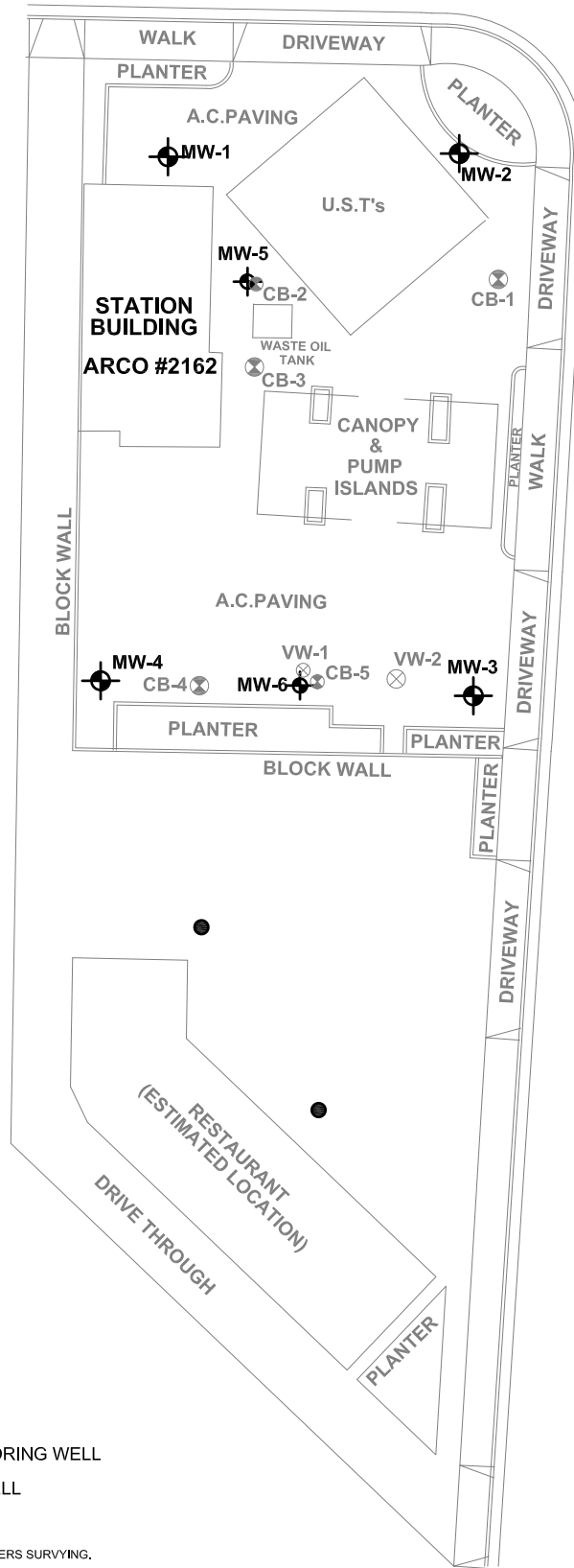

Drawing
1

RUTH COURT



HESPERIAN BLVD.

LEGEND

-  PROPOSED BORING
-  GROUNDWATER MONITORING WELL
-  VAPOR EXTRACTION WELL
-  SOIL BORING

NOTE: SITE MAP ADAPTED FROM WOOD RODGERS SURVYING.

