

Atlantic Richfield Company

Chuck Carmel
Environmental Business Manager

PO Box 1257
San Ramon, CA 94583
Phone: (925) 275-3803
Fax: (925) 275-3815
E-Mail: charles.carmel@bp.com

RECEIVED

8:52 am, Oct 06, 2010

Alameda County
Environmental Health

5 October 2010

Re: Third Quarter 2010 Status Report
Atlantic Richfield Company Station #2162
15135 Hesperian Boulevard, San Leandro, California
ACEH Case #RO0000190

"I declare, that to the best of my knowledge at the present time, that the information and/or recommendations contained in the attached document are true and correct.

Submitted by,



Chuck Carmel
Environmental Business Manager

Attachment

5 October 2010

Project No. 06-08-620

Atlantic Richfield Company
P.O. Box 1257
San Ramon, California 94583
Submitted via ENFOS

Attn.: Mr. Chuck Carmel

Re: Third Quarter 2010 Status Report, Atlantic Richfield Company Station #2162
15135 Hesperian Blvd, San Leandro, California; ACEH Case #RO0000190

Dear Mr. Carmel:

Provided herein is the *Third Quarter 2010 Status Report* for Atlantic Richfield Company (a BP affiliated company) Station #2162 located at 15135 Hesperian Blvd., San Leandro, Alameda County, California (Site). This report presents a summary of current developments regarding the Site through the Third Quarter 2010.

Should you have questions regarding this submission, please do not hesitate to contact me at (530) 566-1400.

Sincerely,

BROADBENT & ASSOCIATES, INC.



Thomas A. Venus, P.E.
Senior Engineer



Enclosures

cc: Mr. Paresh Khatri, ACEH (Submitted via ACEH ftp Site)
Mr. Karl Busche, City of San Leandro Environmental Services Division (Electronic copy uploaded to GeoTracker)

STATION #2162 QUARTERLY STATUS REPORT

Facility: #2162	Address:	15135 Hesperian Boulevard, San Leandro, California
Environmental Business Manager:		Mr. Chuck Carmel
Consulting Company/Contact Person:		Broadbent & Associates, Inc. (BAI)/Mr. Tom Venus, PE (530)566-1400
Primary Agency/Regulatory ID No.:		Alameda County Environmental Health (ACEH) ACEH Case #RO0000190
Consultant Project No.:		06-08-620

WORK PERFORMED THIS QUARTER (Third Quarter 2010):

1. Prepared and submitted the *Second Quarter 2010 Semi-Annual Ground-Water Monitoring Report* (BAI, 7/30/2010).
2. No environmental field work was conducted at the Site during the Third Quarter of 2010.

WORK PROPOSED FOR NEXT QUARTER (Fourth Quarter 2010):

1. Prepared and submitted this *Third Quarter 2010 Status Report* (contained herein).
2. Conduct semi-annual ground-water monitoring/sampling for Fourth Quarter 2010. Work to be performed by BAI.

DISCUSSION:

No ground-water monitoring and sampling work activities took place at the Site during Third Quarter 2010. For reference, a Site Location Map is provided as Drawing 1. Provided as Drawing 2 is the Ground-Water Elevation Contours and Analytical Summary Map from the *Second Quarter 2010 Ground-Water Monitoring Report* (BAI, 7/30/2010) for ground-water monitoring/sampling conducted on 4 June 2010.

ATTACHMENTS:

- Drawing 1 Site Location Map, Station #2162, 15135 Hesperian Boulevard, San Leandro, California
- Drawing 2. Ground-Water Elevation Contour and Analytical Summary Map, 4 June 2010,
Station #2162, 15135 Hesperian Boulevard, San Leandro, California

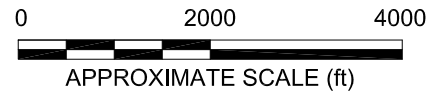
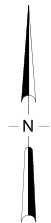
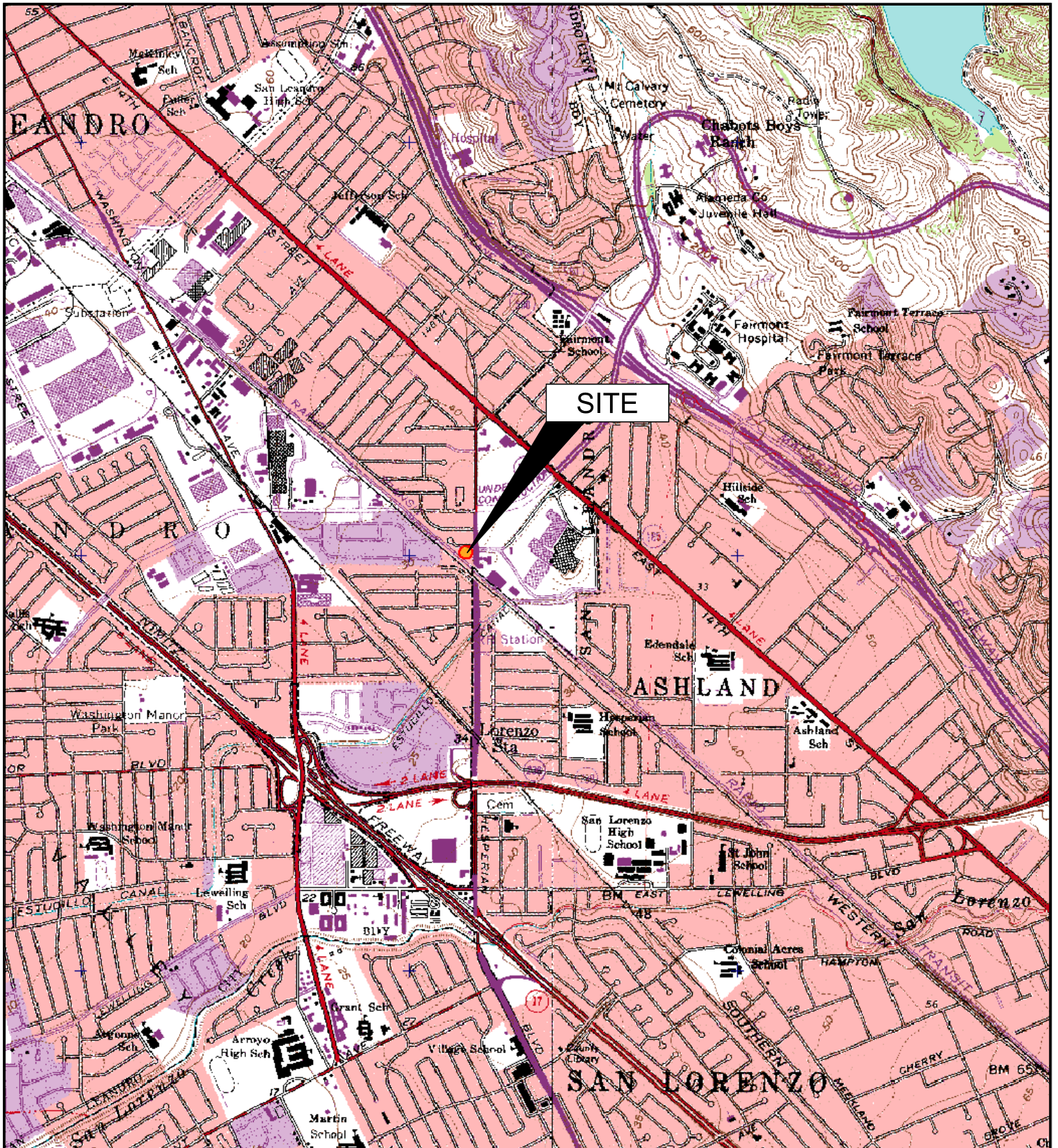

IMAGE SOURCE: USGS

BROADBENT & ASSOCIATES, INC
ENGINEERING, WATER RESOURCES & ENVIRONMENTAL
1324 Mangrove Ave. Suite 212, Chico, CA 95926
Project No.: 06-88-620 Date: 07/27/09

Station #2162
15135 Hesperian Boulevard
San Leandro, California

Site Location Map

Drawing
1

RUTH COURT

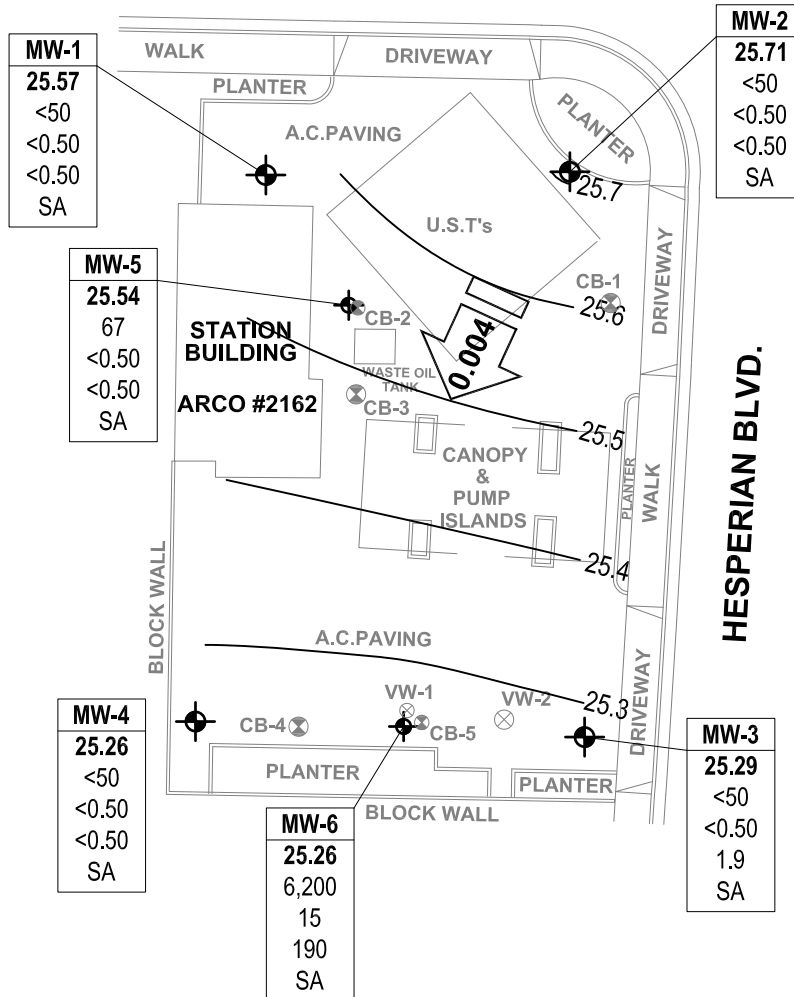

LEGEND

- GROUND-WATER MONITORING WELL
- VAPOR EXTRACTION WELL
- SOIL BORING
- 25.5 GROUND-WATER ELEVATION CONTOUR (FEET ABOVE DATUM)
- APPROXIMATE GROUND-WATER FLOW DIRECTION AND GRADIENT (FT/FT)

- Well WELL DESIGNATION
- ELEV GROUND-WATER ELEVATION (FEET)
- GRO GRO. BENZENE & MTBE CONCENTRATIONS (µg/L)
- Benzene
- MTBE
- A/Q/SA SAMPLING FREQUENCY
- < NOT DETECTED AT OR ABOVE LABORATORY REPORTING LIMITS
- * DATA NOT USED FOR CONTOURING
- SA SAMPLED SEMI-ANNUALLY

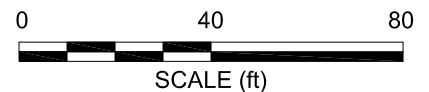

NOTE: SITE MAP ADAPTED FROM WOOD RODGERS SURVYING.