

Atlantic Richfield Company

Chuck Carmel
Environmental Business Manager

RECEIVED

8:52 am, Apr 01, 2010

Alameda County
Environmental Health

PO Box 1257
San Ramon, CA 94583
Phone: (925) 275-3803
Fax: (925) 275-3815
E-Mail: charles.carmel@bp.com

5 April 2010

Re: First Quarter 2010 Status Report
Atlantic Richfield Company Station #2162
15135 Hesperian Boulevard, San Leandro, California
ACEH Case #RO0000190

"I declare, that to the best of my knowledge at the present time, that the information and/or recommendations contained in the attached document are true and correct.

Submitted by,



Chuck Carmel
Environmental Business Manager

Attachment

5 April 2010

Project No. 06-08-620

Atlantic Richfield Company
P.O. Box 1257
San Ramon, California 94583
Submitted via ENFOS

Attn.: Mr. Chuck Carmel

Re: First Quarter 2010 Status Report, Atlantic Richfield Company Station #2162
15135 Hesperian Blvd, San Leandro, California; ACEH Case #RO0000190

Dear Mr. Carmel:

Provided herein is the *First Quarter 2010 Status Report* for Atlantic Richfield Company (a BP affiliated company) Station #2162 located at 15135 Hesperian Blvd., San Leandro, Alameda County, California (Site). This report presents a summary of current developments regarding the Site through the First Quarter 2010.

Should you have questions regarding this submission, please do not hesitate to contact me at (530) 566-1400.

Sincerely,

BROADBENT & ASSOCIATES, INC.

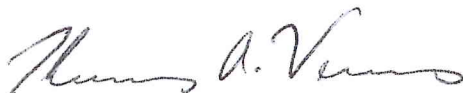

Thomas A. Venus, P.E.
Senior Engineer



Enclosures

cc: Mr. Paresh Khatri, ACEH (Submitted via ACEH ftp Site)
Mr. Karl Busche, City of San Leandro Environmental Services Division (Electronic copy uploaded to GeoTracker)

STATION #2162 QUARTERLY STATUS REPORT

Facility: #2162	Address:	15135 Hesperian Boulevard, San Leandro, California
Environmental Business Manager:		Mr. Chuck Carmel
Consulting Company/Contact Person:		Broadbent & Associates, Inc. (BAI)/Mr. Tom Venus, PE (530)566-1400
Primary Agency/Regulatory ID No.:		Alameda County Environmental Health (ACEH) ACEH Case #RO0000190
Consultant Project No.:		06-08-620

WORK PERFORMED THIS QUARTER (First Quarter 2010):

1. Prepared and submitted the *Fourth Quarter 2009 Ground-Water Monitoring Report* (BAI, 1/22/2010).
2. No environmental field work was conducted at the Site during the First Quarter of 2010.

WORK PROPOSED FOR NEXT QUARTER (Second Quarter 2010):

1. Prepared and submitted this *First Quarter 2010 Status Report* (contained herein).
2. Conduct semi-annual ground-water monitoring/sampling for Second Quarter 2010. Work to be performed by BAI.

DISCUSSION:

No ground-water monitoring and sampling work activities took place at the Site during First Quarter 2010. For reference, a Site Location Map is provided as Drawing 1. Provided as Drawing 2 is the Ground-Water Elevation Contours and Analytical Summary Map from the *Fourth Quarter 2009 Ground-Water Monitoring Report* (BAI, 1/22/2010) for ground-water monitoring/sampling conducted on 6 November 2009.

ATTACHMENTS:

- Drawing 1 Site Location Map, Station #2162, 15135 Hesperian Boulevard, San Leandro, California
- Drawing 2. Ground-Water Elevation Contour and Analytical Summary Map, 6 November 2009,
Station #2162, 15135 Hesperian Boulevard, San Leandro, California

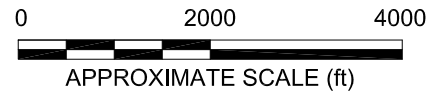
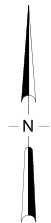
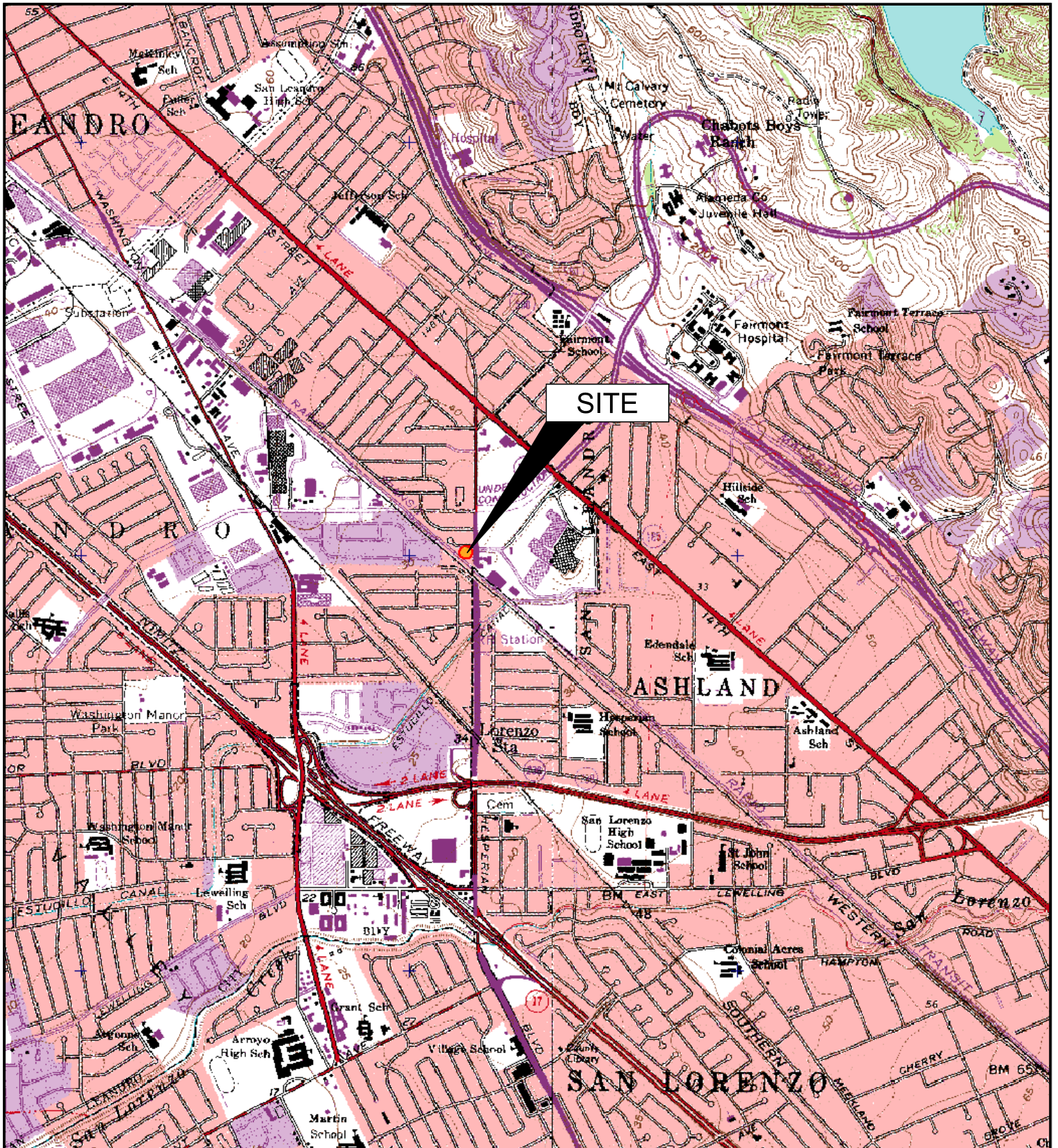

IMAGE SOURCE: USGS

BROADBENT & ASSOCIATES, INC
 ENGINEERING, WATER RESOURCES & ENVIRONMENTAL
 1324 Mangrove Ave, Suite 212, Chico, CA 95926
 Project No.: 06-88-620 Date: 07/27/09

Station #2162
 15135 Hesperian Boulevard
 San Leandro, California

Site Location Map

Drawing
1

RUTH COURT

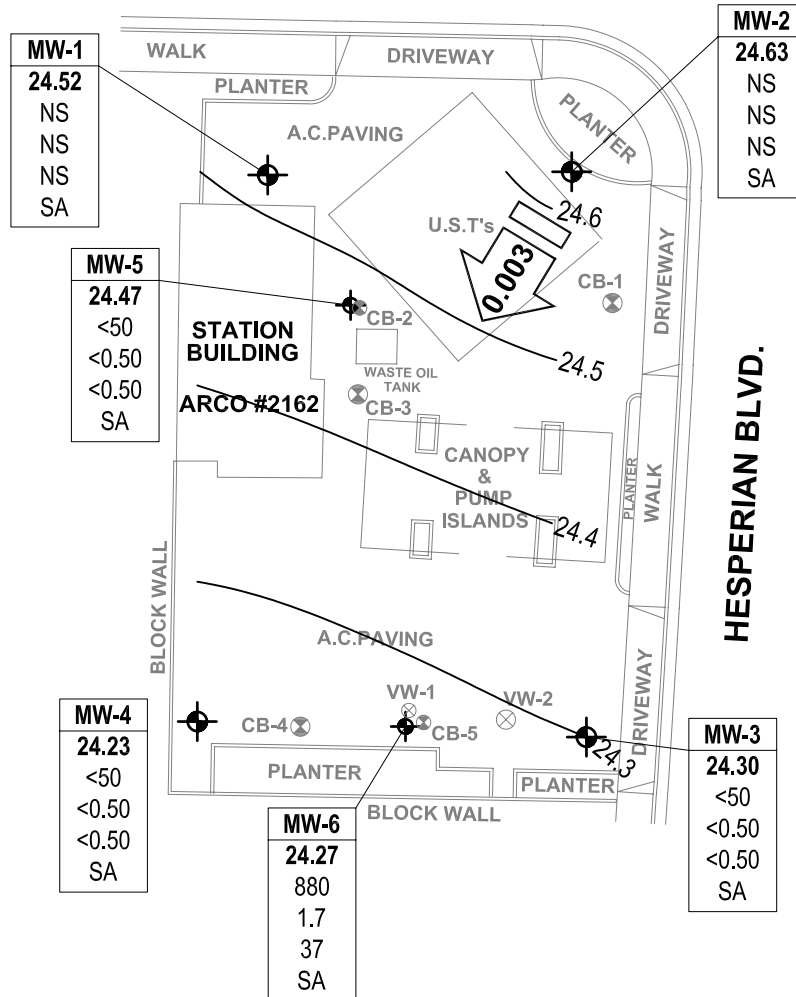

LEGEND

- GROUND-WATER MONITORING WELL
- VAPOR EXTRACTION WELL
- SOIL BORING
- 24.5 GROUND-WATER ELEVATION CONTOUR (FEET ABOVE DATUM)
- APPROXIMATE GROUND-WATER FLOW DIRECTION AND GRADIENT (FT/FT)

- | Well | WELL DESIGNATION |
|---------|---|
| ELEV | GROUND-WATER ELEVATION (FEET) |
| GRO | GRO. BENZENE & MTBE CONCENTRATIONS (µg/L) |
| Benzene | |
| MTBE | |
| A/Q/SA | SAMPLING FREQUENCY |
- < NOT DETECTED AT OR ABOVE LABORATORY REPORTING LIMITS
 - * DATA NOT USED FOR CONTOURING
 - SA SAMPLED SEMI-ANNUALLY

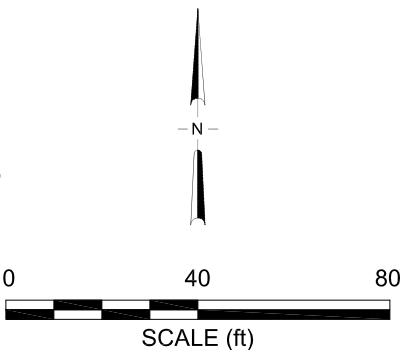

NOTE: SITE MAP ADAPTED FROM WOOD RODGERS SURVYING.