

Atlantic Richfield Company

Chuck Carmel
Environmental Business Manager

RECEIVED

10:29 am, Oct 19, 2009

Alameda County
Environmental Health

PO Box 1257
San Ramon, CA 94583
Phone: (925) 275-3803
Fax: (925) 275-3815
E-Mail: charles.carmel@bp.com

16 October 2009

Re: Third Quarter 2009 Status Report
Atlantic Richfield Company Station #2162
15135 Hesperian Boulevard, San Leandro, California
ACEH Case #RO0000190

"I declare, that to the best of my knowledge at the present time, that the information and/or recommendations contained in the attached document are true and correct.

Submitted by,



Chuck Carmel
Environmental Business Manager

Attachment

16 October 2009

Project No. 06-08-620

Atlantic Richfield Company
P.O. Box 1257
San Ramon, California 94583
Submitted via ENFOS

Attn.: Mr. Chuck Carmel

Re: Third Quarter 2009 Status Report, Atlantic Richfield Company Station #2162
15135 Hesperian Blvd, San Leandro, California; ACEH Case #RO0000190

Dear Mr. Carmel:

Provided herein is the *Third Quarter 2009 Status Report* for Atlantic Richfield Company (a BP affiliated company) Station #2162 located at 15135 Hesperian Blvd., San Leandro, Alameda County, California (Site). This report presents a summary of current developments regarding the Site through the Third Quarter 2009.

Should you have questions regarding this submission, please do not hesitate to contact me at (530) 566-1400.

Sincerely,

BROADBENT & ASSOCIATES, INC.



Thomas A. Venus, P.E.
Senior Engineer



Enclosures

cc: Mr. Paresh Khatri, ACEH (Submitted via ACEH ftp Site)
Mr. Karl Busche, City of San Leandro Environmental Services Division (Electronic copy uploaded to GeoTracker)

STATION #2162 QUARTERLY STATUS REPORT

Facility: #2162	Address:	15135 Hesperian Boulevard, San Leandro, California
Environmental Business Manager:		Mr. Chuck Carmel
Consulting Company/Contact Person:		Broadbent & Associates, Inc. (BAI)/Mr. Tom Venus, PE (530)566-1400
Primary Agency/Regulatory ID No.:		Alameda County Environmental Health (ACEH) ACEH Case #RO0000190
Consultant Project No.:		06-08-620

WORK PERFORMED THIS QUARTER (Third Quarter 2009):

1. Prepared and submitted the *Second Quarter 2009 Ground-Water Monitoring Report* (BAI, 7/30/2009).
2. No environmental field work was conducted at the Site during the Third Quarter of 2009.

WORK PROPOSED FOR NEXT QUARTER (Fourth Quarter 2009):

1. Prepared and submitted this *Third Quarter 2009 Status Report* (contained herein).
2. Conduct semi-annual ground-water monitoring/sampling for Fourth Quarter 2009. Work to be performed by BAI.

DISCUSSION:

In a letter dated 1 October 2008, ACEH requested further source area characterization and resumption of periodic ground-water monitoring. In April 2009, two new monitoring wells MW-5 and MW-6, were installed on the Site in the vicinity of boring CB-2 and near the middle of the southern property boundary, respectively. Results of the soil boring and monitoring well installation activities were summarized within the *On-Site Soil & Ground-Water Investigation Report* (BAI, 6/2/2009). For reference, a Site Location Map is provided as Drawing 1. Provided as Drawing 2 is the Ground-Water Elevation Contours and Analytical Summary Map from the *Second Quarter 2009 Ground-Water Monitoring Report* (BAI, 7/30/2009) for ground-water monitoring/sampling conducted on 12 June 2009.

ATTACHMENTS:

- Drawing 1 Site Location Map, Station #2162, 15135 Hesperian Boulevard, San Leandro, California
- Drawing 2. Ground-Water Elevation Contour and Analytical Summary Map, Station #2162, 15135 Hesperian Boulevard, San Leandro, California

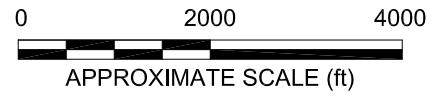
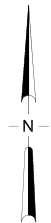
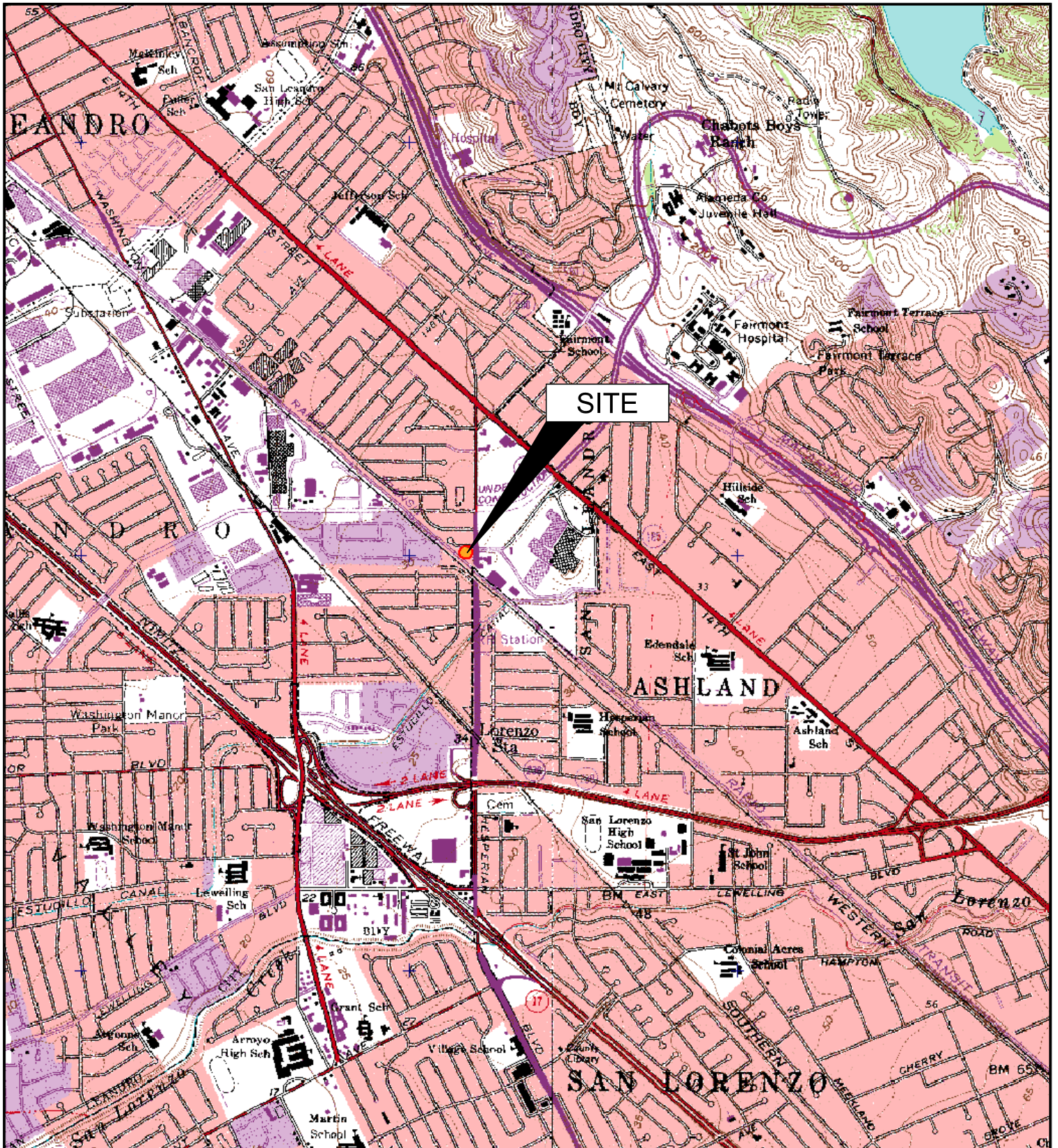

IMAGE SOURCE: USGS

BROADBENT & ASSOCIATES, INC
ENGINEERING, WATER RESOURCES & ENVIRONMENTAL
1324 Mangrove Ave. Suite 212, Chico, CA 95926
Project No.: 06-88-620 Date: 07/27/09

Station #2162
15135 Hesperian Boulevard
San Leandro, California

Site Location Map

Drawing
1

RUTH COURT

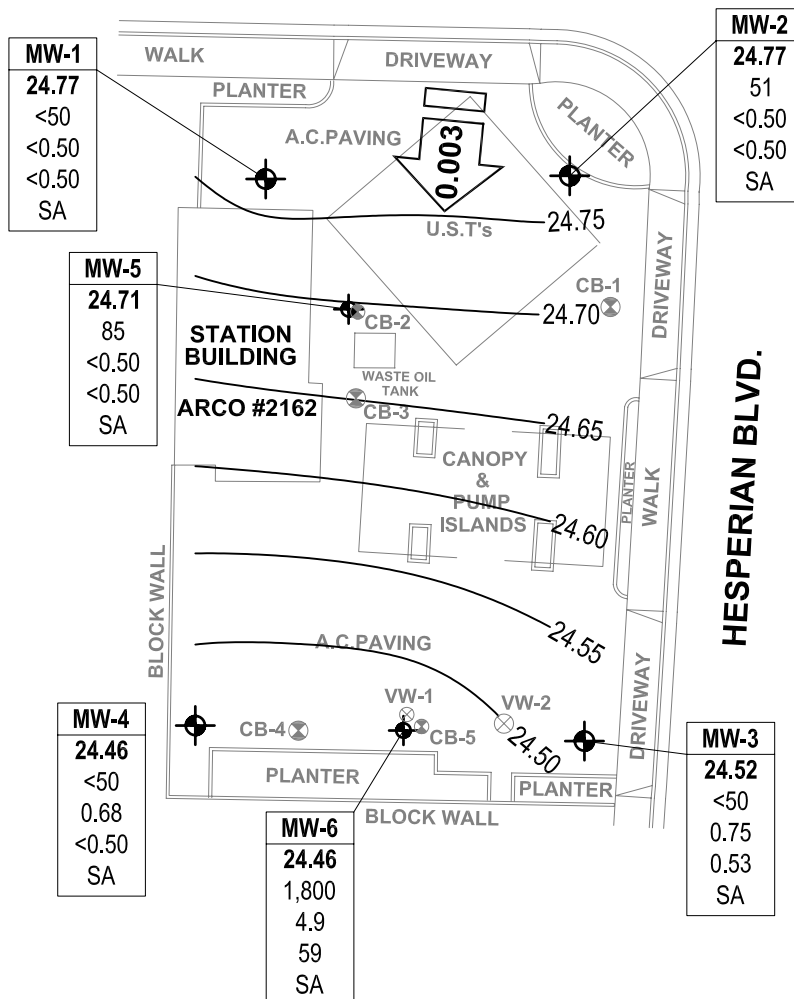

LEGEND

- GROUND-WATER MONITORING WELL
- VAPOR EXTRACTION WELL
- SOIL BORING
- 24.50 GROUND-WATER ELEVATION CONTOUR (FEET ABOVE MSL)
- APPROXIMATE GROUND-WATER FLOW DIRECTION AND GRADIENT (FT/FT)

- | Well | WELL DESIGNATION |
|---------|---|
| ELEV | GROUND-WATER ELEVATION (FEET ABOVE MSL) |
| GRO | GRO. BENZENE & MTBE CONCENTRATIONS (µg/L) |
| Benzene | |
| MTBE | |
| A/Q/SA | SAMPLING FREQUENCY |
- < NOT DETECTED AT OR ABOVE LABORATORY REPORTING LIMITS
 - * DATA NOT USED FOR CONTOURING
 - SA SAMPLED SEMI-ANNUALLY



NOTE: SITE MAP ADAPTED FROM WOOD RODGERS SURVYING.