

KAPREALIAN ENGINEERING
INCORPORATED

KEI-P95-0711.P1
December 5, 1995

Texaco Environmental Services
108 Cutting Boulevard
Richmond, CA 94804

Attention: Ms. Karen Petryna

RE: Work Plan/Proposal
Former Texaco Service Station
930 Springtown Blvd.
Livermore, California

Dear Ms. Petryna:

INTRODUCTION

Per your request, this work plan/proposal for the destruction of monitoring wells MW6 and MW7 at the subject site is presented for your review. The wells are proposed to be destroyed based upon authorization of the Alameda County Health Care Services (ACHCS) Agency (letter to Texaco dated November 8, 1995).

PROPOSED WELL DESTRUCTION

1. Kaprealian Engineering, Inc. (KEI) proposes the **destruction of monitoring wells MW6 and MW7** by fully drilling out the existing well seals, all filter pack sand materials, and the PVC well casings. Both wells extend to a depth of 25 feet below grade and are constructed with four-inch diameter PVC casings within a 10.5 inch diameter borehole. Ground water is anticipated at approximately 8 feet below grade (MW7) to 14 feet below grade (MW6), based on monitoring data collected in May 1995. Permits will be obtained from the ACHCS and the City of Livermore (encroachment permit - off-site well MW6) prior to beginning work.
2. The former wells will be fully sealed by the use of either neat cement grout or 11-sack cement/sand slurry, in accordance with the grout mixing guidelines presented in the California Well Standards, Bulletin 74-90, dated June 1991. All grout will be placed by the use of a tremie pipe. Grout will be placed from the bottom of the borings up to the surface in one continuous pour. The upper 1 to 2 feet of grout may contain a hardening agent to allow for reduced curing time.

KEI-P95-0711.P1
December 5, 1995
Page 2

3. All soil materials generated during well destruction operations will be stored on-site in DOT-approved, properly labeled, 55-gallon drums, or else covered by visqueen pending further analysis and disposal.
4. The results of the well destruction activities will be documented in a technical report. A copy of the report will be submitted to the ACHCS, and to the Regional Water Quality Control Board, San Francisco Bay Region.

If you have any questions regarding this work plan/proposal, please do not hesitate to call me at (510) 602-5100.

Sincerely,

Kaprealian Engineering, Inc.



Joel G. Greger, C.E.G.
Senior Engineering Geologist

License No. EG 1633
Exp. Date 8/31/96

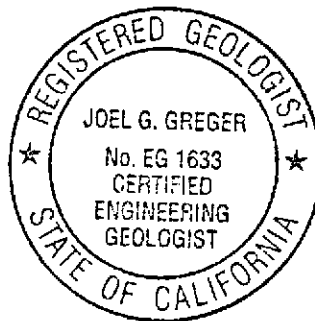

Timothy R. Ross
General Manager

/jad

Attachments: Location Map
Figure 1

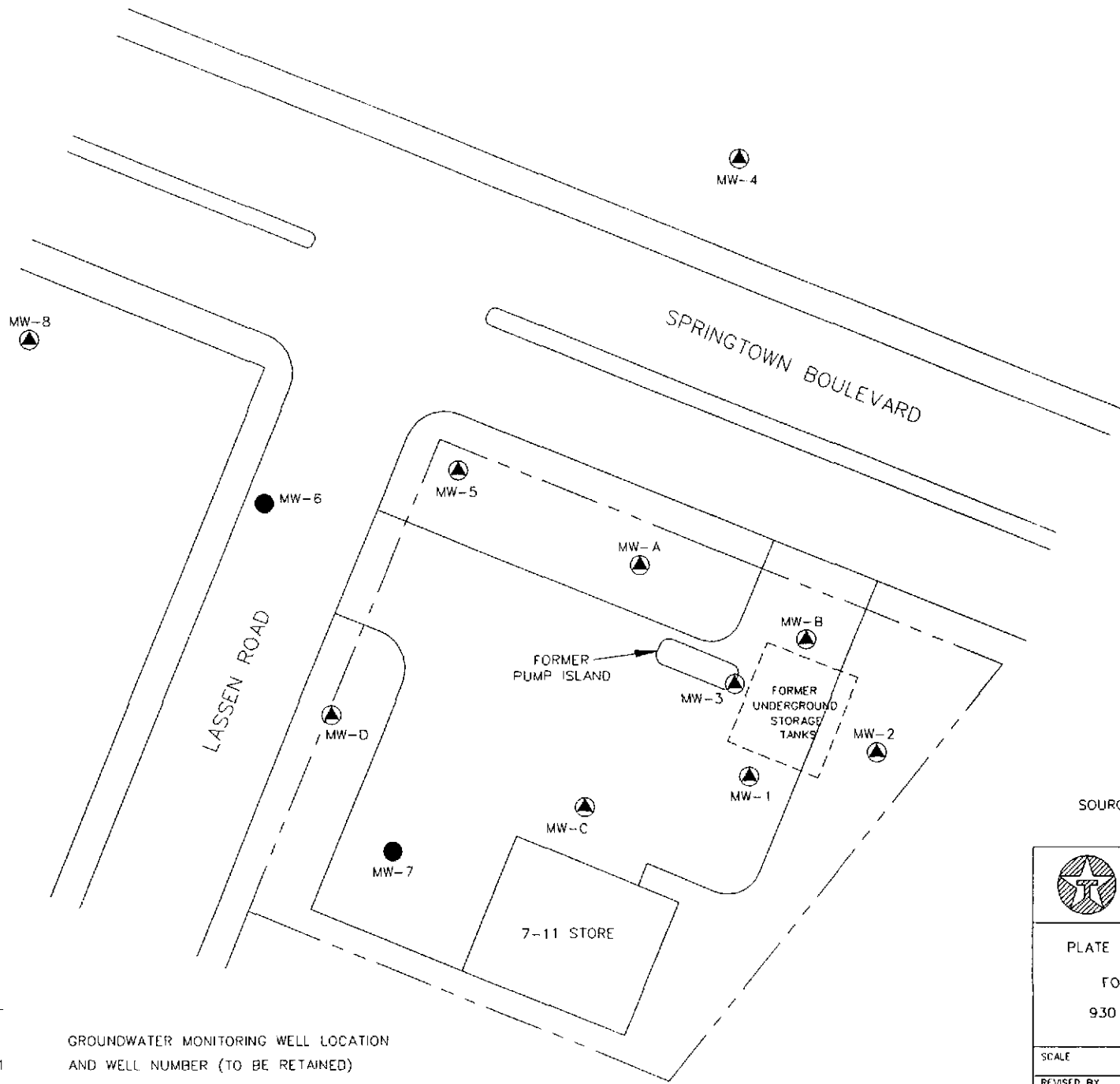
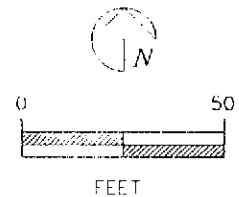

LEGEND :

- ▲ MW-1 GROUNDWATER MONITORING WELL LOCATION AND WELL NUMBER (TO BE RETAINED)
- MW-7 GROUNDWATER MONITORING WELL LOCATION AND WELL NUMBER (TO BE DESTROYED)

SOURCE : MATTESON ENGINEERING CONDUCTED SURVEY ON 08/04/1994



TEXACO

REFINING AND MARKETING INC.
TEXACO ENVIRONMENTAL SERVICES

PLATE 1 : MONITORING WELL LOCATION MAP

FORMER TEXACO SERVICE STATION

930 SPRINGTOWN BLVD. / LASSEN RD.,
LIVERMORE, CALIFORNIA

| | | | |
|------------|-----------|------------|-------------|
| SCALE | 1"=50'-0" | LOCATION # | 61-857-1050 |
| REVISED BY | AAB | DATE | 12/5/95 |
| CHECKED BY | | DATE | |

DRAWING NO. FIGURE 1