

RO-189



ENVIRONMENTAL MANAGEMENT, INC.

January 25, 2002  
Project No. C80-000930G1

Ms. Eva Chu  
Alameda County Health Services Agency  
1131 Harbor Bay Parkway, 2<sup>nd</sup> Floor  
Alameda, California 94502-6577

JAN 31 2002

**Re: Monitoring Report – First Quarter 2002  
Former Texaco Service Station  
930 Springtown Boulevard at Lassen Road  
Livermore, California  
Incident No. 91995053**

Dear Ms. Chu:

On behalf of Equiva Services LLC, Blaine Tech Services (Blaine) performed groundwater monitoring and sampling at the direction of KHM Environmental Management, Inc. (KHM) at the above-referenced site on January 1, 2002. Monitoring was performed during the first quarter of 2002 to provide additional data for a Notice of No Further Action being considered by the Alameda County Health Services Agency (ACHSA). Monitoring is typically performed on a semi-annual basis in the second and fourth quarters.

Depth to groundwater was measured in Wells MW-A, MW-B, MW-1 through MW-5, and MW-8. Groundwater elevation data and contours are presented on Figure 1.

Groundwater samples were collected from Wells MW-A, MW-B, MW-3, MW-5, and MW-8. Samples were submitted by Blaine to Kiff Analytical LLC in Davis, California for analysis for total purgeable petroleum hydrocarbons as gasoline (TPPH); benzene, toluene, ethylbenzene, total xylenes (BTEX compounds); and methyl tert-butyl ether (MTBE) using EPA Method 8260B. TPPH, benzene, and MTBE concentrations are presented on Figures 2 through 4, respectively.

Blaine's groundwater monitoring and sampling report, which includes historical and current groundwater elevation data, historical and current analytical results, and field data records for the current monitoring event, is included as Attachment A.

REDMOND, WASHINGTON  
PORTLAND, OREGON  
SAN JOSE, CALIFORNIA  
CROCKET, CALIFORNIA

• 18350 REDMOND WAY • 98052  
• 123 NE 3RD STREET, SUITE 300 • 97232  
• 6284 SAN IGNACIO AVENUE, SUITE E • 95119  
• 565 CLARK STREET • 94525

• PHONE: (425) 558-0134 • FAX: (425) 869-7494  
• PHONE: (503) 233-4068 • FAX: (503) 233-4917  
• PHONE: (408) 224-4724 • FAX: (408) 224-4518  
• PHONE: (510) 787-6756 • FAX: (510) 787-6756

January 25, 2002

## DISCUSSION

A small dissolved gasoline plume remains along the northern property boundary. The plume remains stable in size and shape. MTBE was not detected in Well MW-8 for the second time since an anomalous one-time detection in June 2001.

Groundwater monitoring data supports a Notice of No Further Action by the ACHSA.

Please call if you have any questions regarding the contents of this letter.

Sincerely,

**KHM Environmental Management, Inc.**



R. Lee Dooley  
Senior Hydrogeologist  
CHG 0183

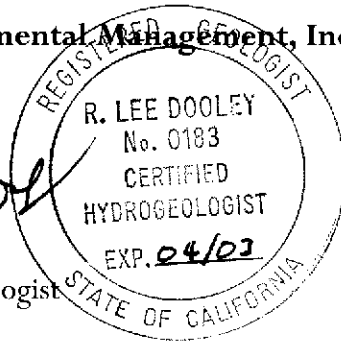

Attachments: Figure 1 – Groundwater Elevation Contour Map  
Figure 2 – TPH Concentration Map  
Figure 3 – Benzene Concentration Map  
Figure 4 – MTBE Concentration Map  
Attachment A – Groundwater Monitoring and Sampling Report

cc: Ms. Karen Petryna, P.E., Equiva Services LLC, P.O. Box 7869, Burbank, CA 91510-7869  
Attn: Environmental Manager, 7-eleven, Inc., 2711 North Haskell Avenue, Dallas, TX 75204-2906  
Attn: General Counsel, 7-eleven, Inc., 2711 North Haskell Avenue, Dallas, TX 75204-2906  
Mr. Bob DeNinno, 7-Eleven, Inc., 10220 S.W. Greenburg Road Suite 470, Portland, OR 97223

**BLAINE**  
TECH SERVICES, INC.

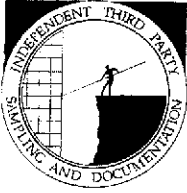

1680 ROGERS AVENUE  
SAN JOSE, CA 95112-1105  
(408) 573-7771 FAX  
(408) 573-0555 PHONE  
CONTRACTOR'S LICENSE #746684  
www.blainetech.com

January 23, 2002

Karen Petryna  
Equiva Services LLC  
P.O. Box 7869  
Burbank, CA 91510-7869

First Quarter 2002 Groundwater Monitoring at  
Former Texaco Service Station  
930 Springtown Blvd.  
Livermore, CA

Monitoring performed on January 4, 2002

---

Groundwater Monitoring Report **020104-DA-2**

This report covers the routine monitoring of groundwater wells at this Former Texaco facility. In accordance with standard procedures that conform to Regional Water Quality Control Board requirements, routine field data collection includes depth to water, total well depth, thickness of any separate immiscible layer, water column volume, calculated purge volume (if applicable), elapsed evacuation time (if applicable), total volume of water removed (if applicable), and standard water parameter instrument readings. Sample material is collected, contained, stored, and transported to the laboratory in conformance with EPA standards. Purgewater (if applicable) is, likewise, collected and transported to the Martinez Refining Company.

Basic field information is presented alongside analytical values excerpted from the laboratory report in the cumulative table of **WELL CONCENTRATIONS**. The full analytical report for the most recent samples and the field data sheets are attached to this report.

At a minimum, Blaine Tech Services, Inc. field personnel are certified on completion of a forty hour Hazardous Materials and Emergency Response training course per 29 CFR 1910.120. Field personnel are also enrolled in annual eight hour refresher courses.

Blaine Tech Services, Inc. conducts sampling and documentation assignments of this type as an independent third party. Our activities at this site consisted of objective data and sample collection only. No interpretation of analytical results, defining of hydrological conditions or formulation of recommendations was performed.

Please call if you have any questions.

Yours truly,

Leon Gearhart  
Project Coordinator

LG/jt

attachments: Cumulative Table of WELL CONCENTRATIONS  
Certified Analytical Report  
Field Data Sheets

cc: Janet Yantis  
KHM Environmental  
6234 San Ignacio Avenue, Suite E  
San Jose, CA 95119

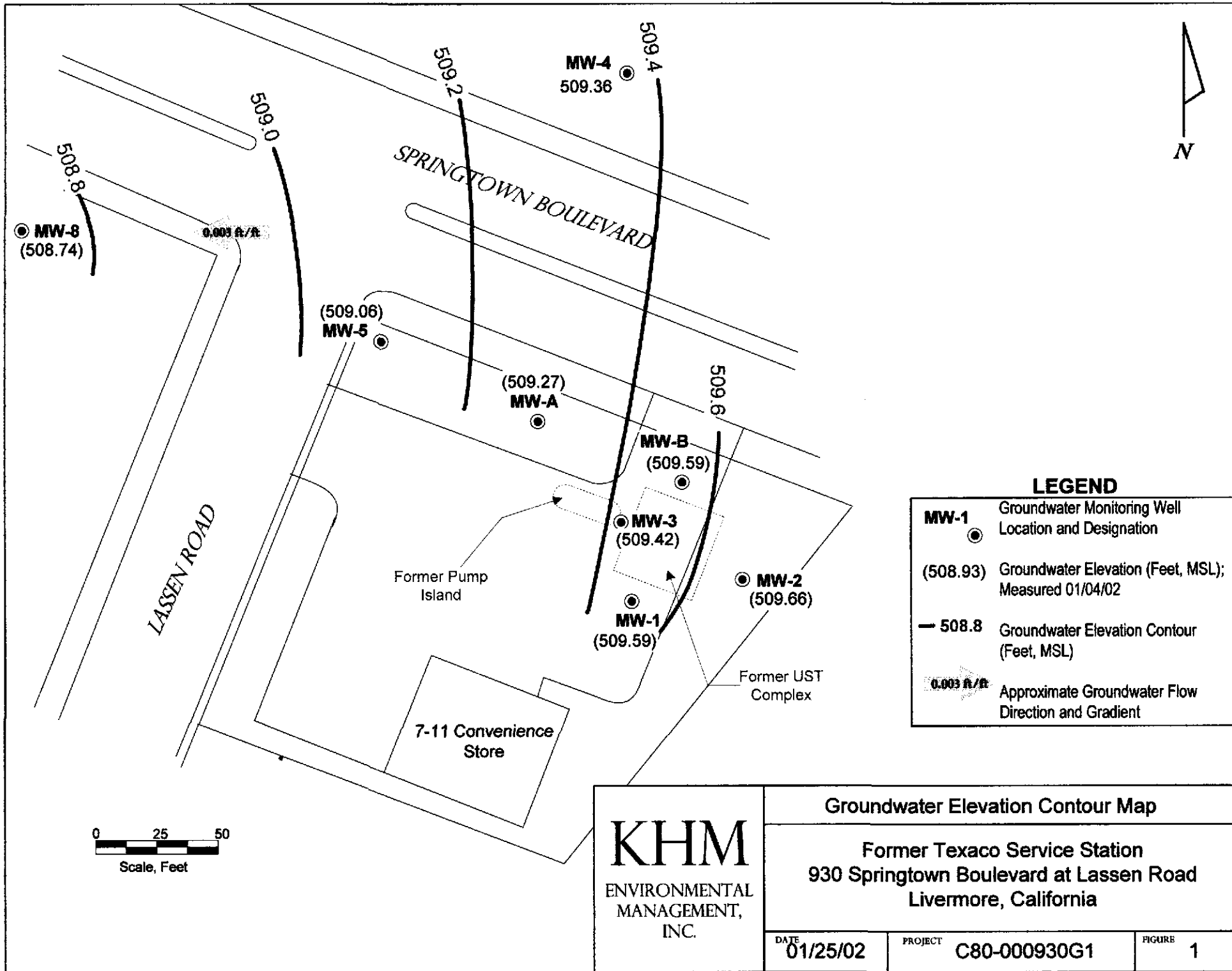

**LEGEND**

<b>MW-1</b>	Groundwater Monitoring Well Location and Designation
(508.93)	Groundwater Elevation (Feet, MSL); Measured 01/04/02
— 508.8	Groundwater Elevation Contour (Feet, MSL)
0.003 ft/ft	Approximate Groundwater Flow Direction and Gradient



<b>KHM</b> ENVIRONMENTAL MANAGEMENT, INC.	<b>Groundwater Elevation Contour Map</b>	
	<b>Former Texaco Service Station</b> <b>930 Springtown Boulevard at Lassen Road</b> <b>Livermore, California</b>	
	DATE 01/25/02	PROJECT C80-000930G1
	FIGURE 1	

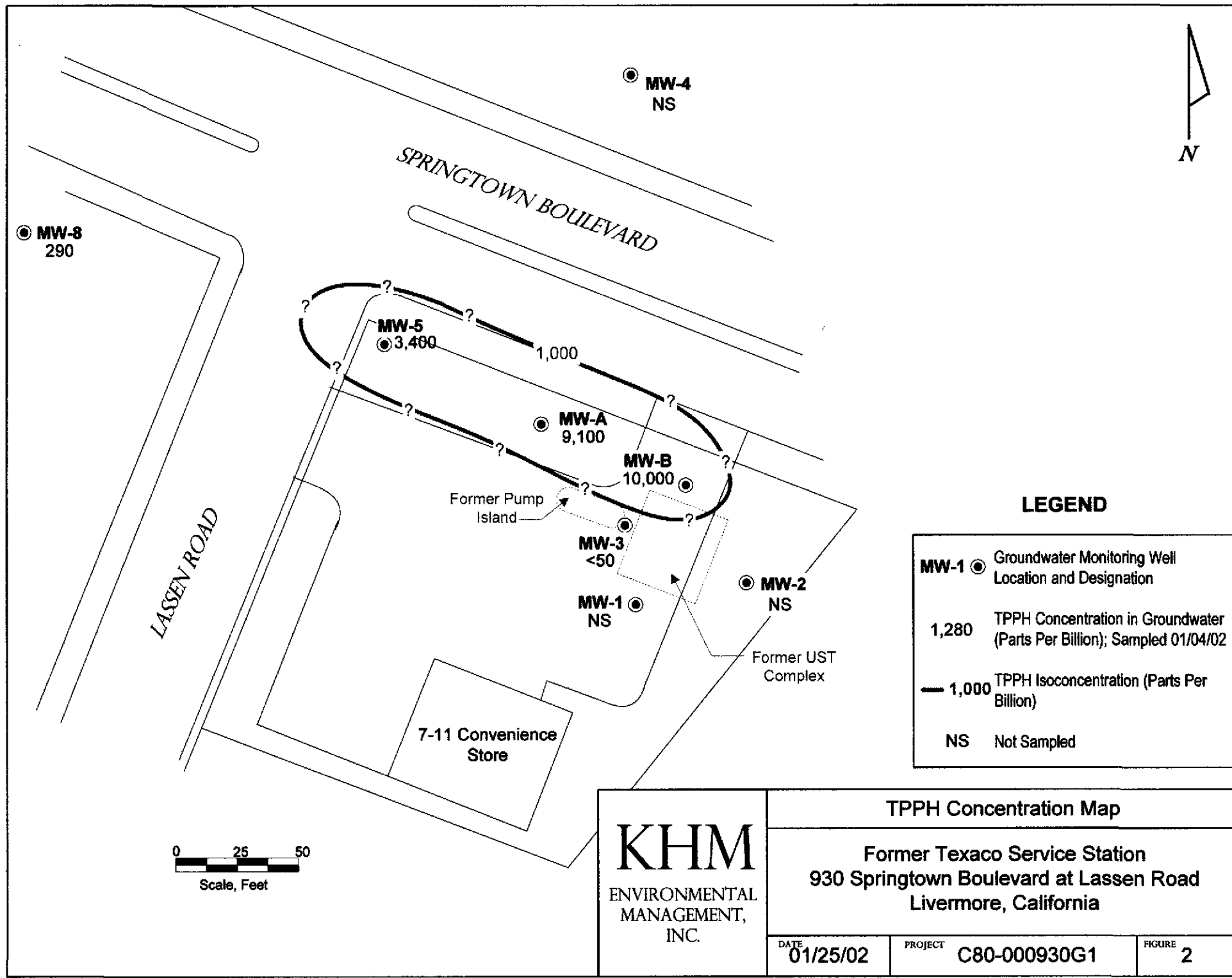

**LEGEND**

<b>MW-1</b>	●	Groundwater Monitoring Well Location and Designation
1,280		TPPH Concentration in Groundwater (Parts Per Billion); Sampled 01/04/02
— 1,000		TPPH Isoconcentration (Parts Per Billion)
NS		Not Sampled

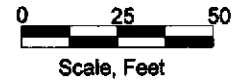

**KHM**  
 ENVIRONMENTAL  
 MANAGEMENT,  
 INC.

<b>TPPH Concentration Map</b>		
Former Texaco Service Station 930 Springtown Boulevard at Lassen Road Livermore, California		
DATE 01/25/02	PROJECT C80-000930G1	FIGURE 2

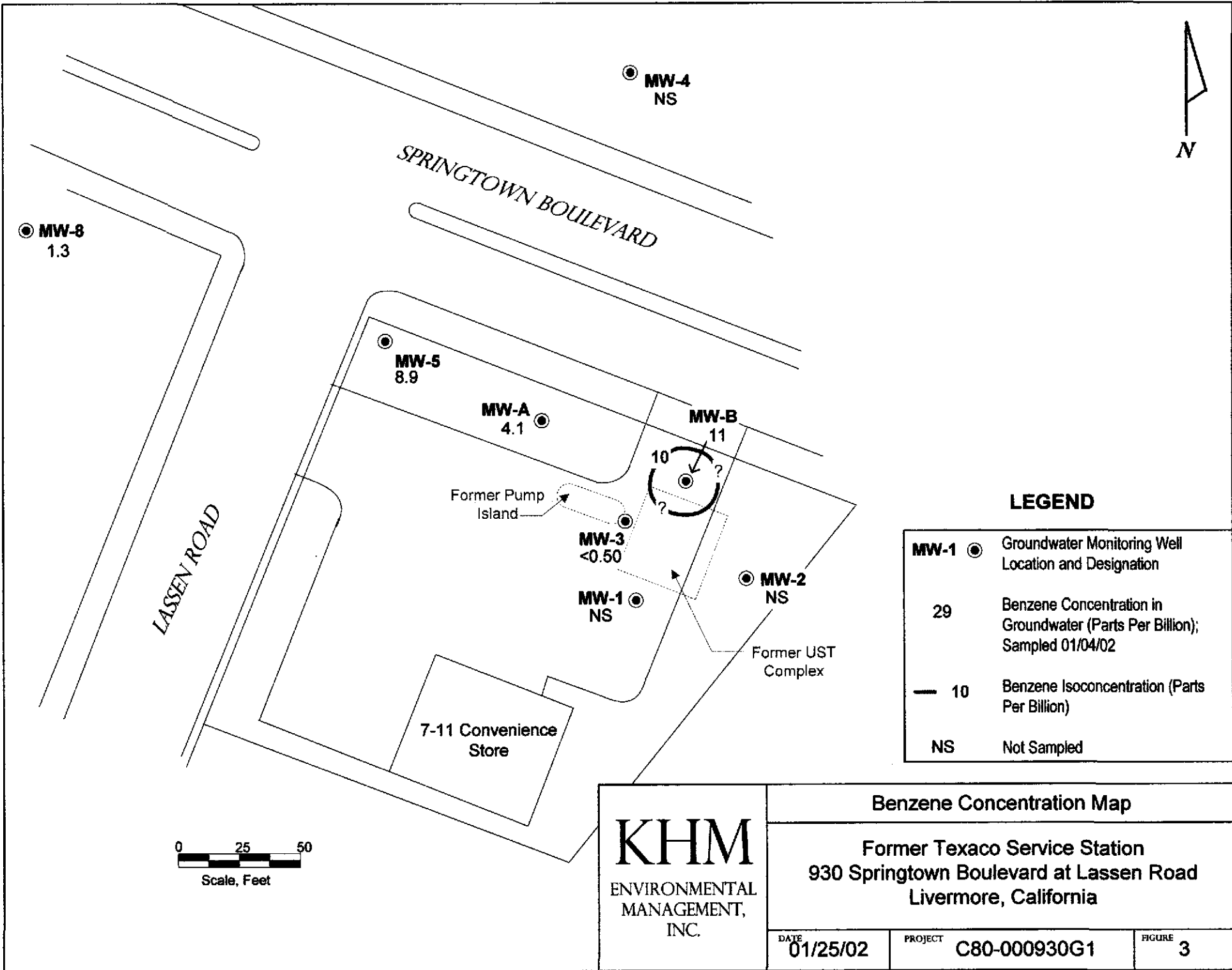

**LEGEND**

<b>MW-1</b>	●	Groundwater Monitoring Well Location and Designation
29		Benzene Concentration in Groundwater (Parts Per Billion); Sampled 01/04/02
— 10		Benzene Isoconcentration (Parts Per Billion)
NS		Not Sampled

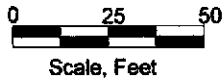

<p><b>KHM</b> ENVIRONMENTAL MANAGEMENT, INC.</p>	<b>Benzene Concentration Map</b>		
	<p><b>Former Texaco Service Station</b> 930 Springtown Boulevard at Lassen Road Livermore, California</p>		
	DATE 01/25/02	PROJECT C80-000930G1	FIGURE 3



● MW-4  
NA

SPRINGTOWN BOULEVARD

● MW-8  
<5.0

● MW-5  
<5.0

● MW-A  
<20

● MW-B  
<20

Former Pump  
Island

● MW-3  
<5.0

● NS  
MW-2

● MW-1  
NS

Former UST  
Complex

LASSEN ROAD

7-11 Convenience  
Store

### LEGEND

- MW-1 Groundwater Monitoring Well Location and Designation
- 26.5 MTBE Concentration in Groundwater (Parts Per Billion); Sampled 01/04/02
- NS Not Sampled

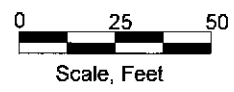

**KHM**  
ENVIRONMENTAL  
MANAGEMENT,  
INC.

### MTBE Concentration Map

Former Texaco Service Station  
930 Springtown Boulevard at Lassen Road  
Livermore, California

DATE 01/25/02

PROJECT C80-000930G1

FIGURE 4



**ATTACHMENT A**

---

**GROUNDWATER MONITORING AND SAMPLING REPORT**

**WELL CONCENTRATIONS**  
**Former Texaco Service Station**  
**930 Springtown Boulevard**  
**Livermore, CA**

Well ID	Date	TPPH (ug/L)	B (ug/L)	T (ug/L)	E (ug/L)	X (ug/L)	MTBE 8020 (ug/L)	MTBE 8260 (ug/L)	TOC (MSL)	Depth to Water (ft.)	GW Elevation (MSL)
MW-A	01/02/1992	NA	NA	NA	NA	NA	NA	NA	520.10	13.61	506.49
MW-A	04/02/1992	27000	1200	570	1700	2300	NA	NA	520.10	12.44	507.66
MW-A	07/21/1992	57000	1500	1800	2700	7100	NA	NA	520.10	13.35	506.75
MW-A	10/09/1992	56000	2900	2600	4600	12000	NA	NA	520.10	12.92	507.18
MW-A	01/11/1993	NA	NA	NA	NA	NA	NA	NA	520.10	11.78	508.32
MW-A	05/05/1993	NA	NA	NA	NA	NA	NA	NA	520.10	11.39	508.71
MW-A	08/09/1993	NA	NA	NA	NA	NA	NA	NA	520.10	12.80	507.30
MW-A	10/14/1993	NA	NA	NA	NA	NA	NA	NA	520.10	13.48	506.62
MW-A	01/24/1994	1400000	6900	2100	15000	38000	NA	NA	520.10	12.74	507.36
MW-A	05/31/1994	48000	1200	900	1900	4200	NA	NA	520.10	12.28	507.82
MW-A	08/31/1994	24000	140	120	830	1500	NA	NA	520.10	13.20	506.90
MW-A	11/02/1994	15000	230	360	1100	1800	NA	NA	520.10	13.15	506.95
MW-A	02/20/1995	12000	290	330	570	1300	NA	NA	520.10	11.71	508.39
MW-A	05/09/1995	1200	6.1	5.9	12	15	NA	NA	520.10	12.37	507.73
MW-A	08/21/1995	9600	85	140	250	860	160	NA	520.10	11.37	508.73
MW-A	10/20/1995	360	5.2	7.9	15	43	NA	NA	520.10	12.04	508.06
MW-A	02/07/1996	6100	130	180	320	840	NA	NA	520.10	10.11	509.99
MW-A	04/30/1996	410	1.2	0.67	1.2	1.5	NA	NA	520.10	10.28	509.82
MW-A	08/14/1996	3000	65	75	170	460	57	NA	520.10	10.82	509.28
MW-A	11/22/1996	6300	100	170	310	710	64	NA	520.10	10.97	509.13
MW-A	02/14/1997	8100	140	180	700	1600	<300	NA	520.10	10.00	510.10
MW-A	05/23/1997	24000	340	520	1600	3800	<2000	NA	520.10	11.36	508.74
MW-A	07/25/1997	440	<0.5	<0.5	<0.5	<0.5	<30	NA	520.10	11.66	508.44
MW-A	10/31/1997	3700	21	48	200	430	35	NA	520.10	11.56	508.54
MW-A	02/06/1998	1500	2.1	4.4	55	77	<30	NA	520.10	9.00	511.10
MW-A	05/19/1998	32000	310	380	1800	3700	1300	NA	520.10	9.85	510.25

**WELL CONCENTRATIONS**  
**Former Texaco Service Station**  
**930 Springtown Boulevard**  
**Livermore, CA**

Well ID	Date	TPPH (ug/L)	B (ug/L)	T (ug/L)	E (ug/L)	X (ug/L)	MTBE 8020 (ug/L)	MTBE 8260 (ug/L)	TOC (MSL)	Depth to Water (ft.)	GW Elevation (MSL)
---------	------	----------------	-------------	-------------	-------------	-------------	------------------------	------------------------	--------------	----------------------------	--------------------------

MW-A	07/31/1998	<50	<0.5	<0.5	<0.5	<0.5	<2.5	NA	520.10	10.04	510.06
MW-A	11/04/1998	15000	86	180	960	1800	<50	<50	520.10	11.09	509.01
MW-A	11/11/1999	1010	4.72	<2.50	26.1	59.9	87.6	<0.500	520.10	11.39	508.71
MW-A	04/03/2000	12800	23.8	54.9	704	1070	242	NA	520.10	10.41	509.69
MW-A	10/16/2000	4810	51.6	<20.0	251	434	108	<10.0	520.10	11.59	508.51
MW-A	06/28/2001	1100	1.2	2.4	51	64	NA	<0.50	520.10	12.13	507.97
MW-A	10/22/2001	15000	24	38	1000	980	NA	<5.0	520.10	12.74	507.36
<b>MW-A</b>	<b>01/04/2002</b>	<b>9100</b>	<b>4.1</b>	<b>6.5</b>	<b>450</b>	<b>360</b>	<b>NA</b>	<b>&lt;20</b>	<b>520.10</b>	<b>10.83</b>	<b>509.27</b>

MW-B	01/02/1992	NA	NA	NA	NA	NA	NA	NA	518.05	11.27	506.78
MW-B	04/02/1992	1900	ND	39	24	35	NA	NA	518.05	10.18	507.87
MW-B	07/21/1992	16000	180	1600	270	1100	NA	NA	518.05	11.27	506.78
MW-B	10/09/1992	38000	490	8300	1400	5100	NA	NA	518.05	11.64	506.41
MW-B	01/11/1993	NA	NA	NA	NA	NA	NA	NA	518.05	9.65	508.40
MW-B	05/05/1993	NA	NA	NA	NA	NA	NA	NA	518.05	9.28	508.77
MW-B	08/09/1993	NA	NA	NA	NA	NA	NA	NA	518.05	11.02	507.03
MW-B	10/14/1993	NA	NA	NA	NA	NA	NA	NA	518.05	11.34	506.71
MW-B	01/24/1994	23000	110	1700	600	1900	NA	NA	518.05	10.54	507.51
MW-B	05/31/1994	13000	780	310	370	1400	NA	NA	518.05	10.19	507.86
MW-B	08/31/1994	35000	160	2800	1000	4500	NA	NA	518.05	10.98	507.07
MW-B	11/02/1994	2500	170	3200	1100	4700	NA	NA	518.05	10.90	507.15
MW-B	02/20/1995	10000	46	1400	330	1200	NA	NA	518.05	9.47	508.58
MW-B	05/09/1995	4100	9.1	47	26	30	NA	NA	518.05	10.58	507.47
MW-B	08/21/1995	4000	9.6	110	120	270	98	NA	518.05	9.34	508.71
MW-B	10/20/1995	9300	35	1300	370	1300	NA	NA	518.05	9.83	508.22
MW-B	02/07/1996	8900	33	700	110	360	NA	NA	518.05	7.85	510.20
MW-B	04/30/1996	5500	17	460	120	400	NA	NA	518.05	8.02	510.03

**WELL CONCENTRATIONS**  
**Former Texaco Service Station**  
**930 Springtown Boulevard**  
**Livermore, CA**

Well ID	Date	TPPH (ug/L)	B (ug/L)	T (ug/L)	E (ug/L)	X (ug/L)	MTBE 8020 (ug/L)	MTBE 8260 (ug/L)	TOC (MSL)	Depth to Water (ft.)	GW Elevation (MSL)
---------	------	----------------	-------------	-------------	-------------	-------------	------------------------	------------------------	--------------	----------------------------	--------------------------

MW-B	08/14/1996	9000	<5	260	120	320	<300	NA	518.05	8.66	509.39
MW-B	11/22/1996	560000	56	2400	1600	5500	<3000	NA	518.05	8.70	509.35
MW-B	02/14/1997	4600	5.2	110	72	210	<300	NA	518.05	7.75	510.30
MW-B	05/23/1997	34000	75	1700	590	2100	1800	NA	518.05	9.05	509.00
MW-B	07/25/1997	39000	250	5200	1600	5900	<800	NA	518.05	9.37	508.68
MW-B	10/31/1997	36000	130	2600	1200	4800	<800	NA	518.05	9.29	508.76
MW-B	02/06/1998	4800	10	120	72	200	<80	NA	518.05	6.68	511.37
MW-B	05/19/1998	25000	200	900	410	1600	570	NA	518.05	7.57	510.48
MW-B	07/31/1998	580	<0.5	<0.5	<0.5	<0.5	14	NA	518.05	8.03	510.02
MW-B	11/04/1998	24000	150	1400	850	2400	<50	<66	518.05	8.85	509.20
MW-B	11/11/1999	685	7.22	14.7	6.10	17.8	<12.5	NA	518.05	9.03	509.02
MW-B	04/03/2000	9250	106	477	346	1320	231	<1.00a	518.05	8.14	509.91
MW-B	10/16/2000	1280	14.5	13.8	13.3	38.8	26.5	NA	518.05	9.42	508.63
MW-B	06/28/2001	16000	29	550	470	1700	NA	<2.5	518.05	9.81	508.24
MW-B	10/22/2001	7000	20	400	330	1100	NA	<20	518.05	10.44	507.61
<b>MW-B</b>	<b>01/04/2002</b>	<b>10000</b>	<b>11</b>	<b>240</b>	<b>280</b>	<b>1100</b>	<b>NA</b>	<b>&lt;20</b>	<b>518.05</b>	<b>8.46</b>	<b>509.59</b>

MW-1	01/02/1992	16	6	ND	ND	ND	NA	NA	520.61	14.11	506.50
MW-1	04/02/1992	ND	ND	ND	ND	ND	NA	NA	520.61	12.98	507.63
MW-1	07/21/1992	<50	3.2	<0.5	<0.5	<0.5	NA	NA	520.61	13.92	506.69
MW-1	10/09/1992	<50	8.5	<0.5	<0.5	<0.5	NA	NA	520.61	14.25	506.36
MW-1	01/11/1993	<50	<0.5	<0.5	<0.5	<0.5	NA	NA	520.61	12.30	508.31
MW-1	05/05/1993	<50	<0.5	<0.5	<0.5	<0.5	NA	NA	520.61	11.88	508.73
MW-1	08/09/1993	<50	<0.5	<0.5	<0.5	<0.5	NA	NA	520.61	13.63	506.98
MW-1	10/14/1993	440	16	2.9	2.9	11	NA	NA	520.61	13.91	506.70
MW-1	01/24/1993	NA	NA	NA	NA	NA	NA	NA	520.61	13.12	507.49
MW-1	05/31/1994	<50	<0.5	<0.5	<0.5	<0.5	NA	NA	520.61	12.74	507.87

**WELL CONCENTRATIONS**  
**Former Texaco Service Station**  
**930 Springtown Boulevard**  
**Livermore, CA**

Well ID	Date	TPPH (ug/L)	B (ug/L)	T (ug/L)	E (ug/L)	X (ug/L)	MTBE 8020 (ug/L)	MTBE 8260 (ug/L)	TOC (MSL)	Depth to Water (ft.)	GW Elevation (MSL)
MW-1	08/31/1994	<50	<0.5	<0.5	<0.5	<0.5	NA	NA	520.61	13.68	506.93
MW-1	11/02/1994	<50	<0.5	<0.5	<0.5	<0.5	NA	NA	520.61	13.48	507.13
MW-1	02/20/1995	<50	<0.5	<0.5	<0.5	<0.5	NA	NA	520.61	12.02	508.59
MW-1	05/09/1995	450	22	25	23	100	NA	NA	520.61	12.83	507.78
MW-1	08/21/1995	58	<0.5	1.5	1.8	4.5	<10	NA	520.61	11.93	508.68
MW-1	10/20/1995	<50	<0.5	<0.5	<0.5	<0.5	NA	NA	520.61	12.40	508.21
MW-1	02/07/1996	<50	<0.5	<0.5	<0.5	<0.5	NA	NA	520.61	10.42	510.19
MW-1	04/30/1996	NA	NA	NA	NA	NA	NA	NA	520.61	10.48	510.13
MW-1	08/14/1996	<50	<0.5	<0.5	<0.5	<0.5	<30	NA	520.61	11.18	509.43
MW-1	11/22/1996	NA	NA	NA	NA	NA	NA	NA	520.61	11.10	509.51
MW-1	02/14/1997	<50	<0.5	<0.5	<0.5	<0.5	<30	NA	520.61	10.25	510.36
MW-1	05/23/1997	NA	NA	NA	NA	NA	NA	NA	520.61	11.48	509.13
MW-1	07/25/1997	<50	<0.5	<0.5	<0.5	<0.5	<30	NA	520.61	11.99	508.62
MW-1	10/31/1997	NA	NA	NA	NA	NA	NA	NA	520.61	11.74	508.87
MW-1	02/06/1998	<50	<0.5	<0.5	<0.5	<0.5	<30	NA	520.61	9.27	511.34
MW-1	05/19/1998	NA	NA	NA	NA	NA	NA	NA	520.61	10.51	510.10
MW-1	07/31/1998	<50	<0.5	<0.5	<0.5	<0.5	<2.5	NA	520.61	10.41	510.20
MW-1	11/04/1998	<50	<0.50	<0.50	<0.50	<0.50	<2.5	NA	520.61	11.32	509.29
MW-1	11/11/1999	82.5	6.35	7.08	4.76	10.9	3.13	1.08	520.61	11.54	509.07
MW-1	04/03/2000	<50.0	<0.500	<0.500	<0.500	<0.500	<2.50	NA	520.61	10.65	509.96
MW-1	10/16/2000	<50.0	<0.500	<0.500	<0.500	<0.500	<2.50	NA	520.61	11.91	508.70
MW-1	06/28/2001	<50	<0.50	<0.50	<0.50	<0.50	NA	0.65	520.61	12.37	508.24
MW-1	10/22/2001	<50	<0.50	<0.50	<0.50	0.55	NA	<5.0	520.61	12.90	507.71
<b>MW-1</b>	<b>01/04/2002</b>	<b>NA</b>	<b>NA</b>	<b>NA</b>	<b>NA</b>	<b>NA</b>	<b>NA</b>	<b>NA</b>	<b>520.61</b>	<b>11.02</b>	<b>509.59</b>
MW-2	01/02/1992	ND	ND	ND	ND	ND	NA	NA	518.29	11.96	506.33
MW-2	04/02/1992	ND	ND	ND	ND	ND	NA	NA	518.29	10.89	507.40

**WELL CONCENTRATIONS**  
**Former Texaco Service Station**  
**930 Springtown Boulevard**  
**Livermore, CA**

Well ID	Date	TPPH (ug/L)	B (ug/L)	T (ug/L)	E (ug/L)	X (ug/L)	MTBE 8020 (ug/L)	MTBE 8260 (ug/L)	TOC (MSL)	Depth to Water (ft.)	GW Elevation (MSL)
MW-2	07/21/1992	NA	NA	NA	NA	NA	NA	NA	518.29	11.55	506.74
MW-2	05/31/1994	NA	NA	NA	NA	NA	NA	NA	518.29	10.37	507.92
MW-2	08/31/1994	<50	<0.5	<0.5	<0.5	<0.5	NA	NA	518.29	11.16	507.13
MW-2	11/02/1994	NA	NA	NA	NA	NA	NA	NA	518.29	11.07	507.22
MW-2	02/20/1995	<50	<0.5	<0.5	<0.5	<0.5	NA	NA	518.29	9.66	508.63
MW-2	05/09/1995	NA	NA	NA	NA	NA	NA	NA	518.29	10.14	508.15
MW-2	08/21/1995	<50	<0.5	<0.5	<0.5	<0.5	<10	NA	518.29	9.58	508.71
MW-2	10/20/1995	NA	NA	NA	NA	NA	NA	NA	518.29	9.91	508.38
MW-2	02/07/1996	<50	<0.5	<0.5	<0.5	<0.5	NA	NA	518.29	8.00	510.29
MW-2	04/30/1996	NA	NA	NA	NA	NA	NA	NA	518.29	8.21	510.08
MW-2	08/14/1996	<50	<0.5	<0.5	<0.5	<0.5	<30	NA	518.29	8.88	509.41
MW-2	11/22/1996	NA	NA	NA	NA	NA	NA	NA	518.29	8.88	509.41
MW-2	02/14/1997	<50	<0.5	<0.5	<0.5	<0.5	<30	NA	518.29	7.92	510.37
MW-2	05/23/1997	NA	NA	NA	NA	NA	NA	NA	518.29	9.25	509.04
MW-2	07/25/1997	<50	<0.5	<0.5	<0.5	<0.5	<30	NA	518.29	9.51	508.78
MW-2	10/31/1997	NA	NA	NA	NA	NA	NA	NA	518.29	9.30	508.99
MW-2	02/06/1998	<50	<0.5	<0.5	<0.5	1.4	<30	NA	518.29	6.88	511.41
MW-2	05/19/1998	NA	NA	NA	NA	NA	NA	NA	518.29	8.35	509.94
MW-2	07/31/1998	<50	<0.5	<0.5	<0.5	<0.5	<2.5	NA	518.29	8.14	510.15
MW-2	11/04/1998	<50	<0.50	<0.50	<0.50	<0.50	<2.5	NA	518.29	9.00	509.29
MW-2	11/11/1999	65.8	6.34	7.04	4.71	10.8	3.21	1.04	518.29	9.19	509.10
MW-2	04/03/2000	<50.0	<0.500	<0.500	<0.500	<0.500	<2.50	NA	518.29	8.31	509.98
MW-2	10/16/2000	<50.0	<0.500	<0.500	<0.500	<0.500	<2.50	NA	518.29	9.36	508.93
MW-2	06/28/2001	<50	<0.50	<0.50	<0.50	<0.50	NA	<0.50	518.29	9.88	508.41
MW-2	10/22/2001	<50	<0.50	<0.50	<0.50	<0.50	NA	<5.0	518.29	10.54	507.75
MW-2	01/04/2002	NA	NA	NA	NA	NA	NA	NA	518.29	8.63	509.66

**WELL CONCENTRATIONS**  
**Former Texaco Service Station**  
**930 Springtown Boulevard**  
**Livermore, CA**

Well ID	Date	TPPH (ug/L)	B (ug/L)	T (ug/L)	E (ug/L)	X (ug/L)	MTBE 8020 (ug/L)	MTBE 8260 (ug/L)	TOC (MSL)	Depth to Water (ft.)	GW Elevation (MSL)
MW-3	01/02/1992	340	0.4	ND	ND	ND	NA	NA	519.60	12.87	506.73
MW-3	04/02/1992	160	5	ND	0.3	0.5	NA	NA	519.60	11.97	507.63
MW-3	07/21/1992	260	1.7	<0.5	<0.5	<0.5	NA	NA	519.60	12.60	507.00
MW-3	10/09/1992	88	<0.5	<0.5	<0.5	<0.5	NA	NA	519.60	12.93	506.67
MW-3	01/11/1993	130	<0.5	<0.5	<0.5	<0.5	NA	NA	519.60	11.16	508.44
MW-3	05/05/1993	340	1.8	<0.5	1.3	<0.5	NA	NA	519.60	10.72	508.88
MW-3	08/09/1993	610	18	<0.5	2.4	0.9	NA	NA	519.60	12.34	507.26
MW-3	10/14/1993	<50	<0.5	<0.5	<0.5	<0.5	NA	NA	519.60	12.71	506.89
MW-3	01/24/1994	320	3.5	<0.5	<0.5	<0.5	NA	NA	519.60	12.03	507.57
MW-3	05/31/1994	830	11	12	5.0	1.2	NA	NA	519.60	11.54	508.06
MW-3	08/31/1994	660	2	<0.5	1	<0.5	NA	NA	519.60	12.60	507.00
MW-3	11/02/1994	1500	260	36	34	76	NA	NA	519.60	12.16	507.44
MW-3	02/20/1995	410	1.2	1.9	1.4	2.2	NA	NA	519.60	11.05	508.55
MW-3	05/09/1995	730	23	43	21	95	NA	NA	519.60	11.97	507.63
MW-3	08/21/1995	<50	<0.5	<0.5	<0.5	<0.5	<10	NA	519.60	7.60	512.00
MW-3	10/20/1995	<50	<0.5	<0.5	<0.5	<0.5	NA	NA	519.60	11.46	508.14
MW-3	02/07/1996	<50	<0.5	<0.5	<0.5	<0.5	NA	NA	519.60	9.42	510.18
MW-3	04/30/1996	NA	NA	NA	NA	NA	NA	NA	519.60	9.60	510.00
MW-3	08/14/1996	<50	<0.5	0.60	<0.5	<0.5	<30	NA	519.60	10.24	509.36
MW-3	11/22/1996	NA	NA	NA	NA	NA	NA	NA	519.60	10.34	509.26
MW-3	02/14/1997	<50	<0.5	<0.5	<0.5	<0.5	<30	NA	519.60	9.38	510.22
MW-3	05/23/1997	NA	NA	NA	NA	NA	NA	NA	519.60	10.67	508.93
MW-3	07/25/1997	<50	<0.5	<0.5	<0.5	<0.5	<30	NA	519.60	11.11	508.49
MW-3	10/31/1997	NA	NA	NA	NA	NA	NA	NA	519.60	10.86	508.74
MW-3	02/06/1998	63	1.5	2.8	0.77	8.6	<30	NA	519.60	8.41	511.19
MW-3	05/19/1998	NA	NA	NA	NA	NA	NA	NA	519.60	9.40	510.20
MW-3	07/31/1998	<50	<0.5	<0.5	<0.5	<0.5	<2.5	NA	519.60	9.04	510.56

**WELL CONCENTRATIONS**  
**Former Texaco Service Station**  
**930 Springtown Boulevard**  
**Livermore, CA**

Well ID	Date	TPPH (ug/L)	B (ug/L)	T (ug/L)	E (ug/L)	X (ug/L)	MTBE 8020 (ug/L)	MTBE 8260 (ug/L)	TOC (MSL)	Depth to Water (ft.)	GW Elevation (MSL)
---------	------	----------------	-------------	-------------	-------------	-------------	------------------------	------------------------	--------------	----------------------------	--------------------------

MW-3	11/04/1998	230	11	7.2	7.6	33	18	14	519.60	10.45	509.15
MW-3	11/11/1999	569	103	47.1	14.1	29.6	521	604	519.60	10.73	508.87
MW-3	04/03/2000	<50.0	<0.500	<0.500	<0.500	<0.500	<2.50	NA	519.60	9.78	509.82
MW-3	10/16/2000	<50.0	<0.500	<0.500	<0.500	<0.500	<2.50	NA	519.60	10.97	508.63
MW-3	06/28/2001	110	<0.50	<0.50	0.56	1.8	NA	1.8	519.60	11.49	508.11
MW-3	10/22/2001	190	1.4	1.3	1.2	7.7	NA	<5.0	519.60	12.08	507.52
<b>MW-3</b>	<b>01/04/2002</b>	<b>&lt;50</b>	<b>&lt;0.50</b>	<b>&lt;0.50</b>	<b>&lt;0.50</b>	<b>&lt;0.50</b>	<b>NA</b>	<b>&lt;5.0</b>	<b>519.60</b>	<b>10.18</b>	<b>509.42</b>

MW-4	01/02/1992	ND	ND	ND	ND	ND	NA	NA	518.79	12.22	506.57
MW-4	04/02/1992	ND	ND	ND	ND	ND	NA	NA	518.79	11.03	507.76
MW-4	07/21/1992	<50	<0.5	<0.5	<0.5	<0.5	NA	NA	518.79	12.36	506.43
MW-4	10/09/1992	<50	<0.5	<0.5	<0.5	<0.5	NA	NA	518.79	12.40	506.39
MW-4	01/11/1993	<50	<0.5	<0.5	<0.5	<0.5	NA	NA	518.79	10.72	508.07
MW-4	05/05/1993	<50	<0.5	<0.5	<0.5	<0.5	NA	NA	518.79	10.21	508.58
MW-4	08/09/1993	<50	<0.5	<0.5	<0.5	<0.5	NA	NA	518.79	12.25	506.54
MW-4	10/14/1993	<50	<0.5	<0.5	<0.5	<0.5	NA	NA	518.79	12.58	506.21
MW-4	01/24/1994	<50	<0.5	<0.5	<0.5	<0.5	NA	NA	518.79	11.72	507.07
MW-4	05/31/1994	NA	NA	NA	NA	NA	NA	NA	518.79	11.29	507.50
MW-4	08/31/1994	<50	<0.5	<0.5	<0.5	<0.5	NA	NA	518.79	12.00	506.79
MW-4	11/02/1994	NA	NA	NA	NA	NA	NA	NA	518.79	11.96	506.83
MW-4	02/20/1995	<50	<0.5	<0.5	<0.5	<0.5	NA	NA	518.79	10.42	508.37
MW-4	05/09/1995	NA	NA	NA	NA	NA	NA	NA	518.79	11.22	507.57
MW-4	08/21/1995	<50	<0.5	<0.5	<0.5	<0.5	<10	NA	518.79	10.51	508.28
MW-4	10/20/1995	<50	<0.5	<0.5	<0.5	<0.5	NA	NA	518.79	10.86	507.93
MW-4	02/07/1996	<50	<0.5	<0.5	<0.5	<0.5	NA	NA	518.79	8.93	509.86
MW-4	04/30/1996	NA	NA	NA	NA	NA	NA	NA	518.79	9.03	509.76
MW-4	08/14/1996	<50	<0.5	<0.5	<0.5	<0.5	<30	NA	518.79	9.84	508.95



**WELL CONCENTRATIONS**  
**Former Texaco Service Station**  
**930 Springtown Boulevard**  
**Livermore, CA**

Well ID	Date	TPPH (ug/L)	B (ug/L)	T (ug/L)	E (ug/L)	X (ug/L)	MTBE 8020 (ug/L)	MTBE 8260 (ug/L)	TOC (MSL)	Depth to Water (ft.)	GW Elevation (MSL)
---------	------	----------------	-------------	-------------	-------------	-------------	------------------------	------------------------	--------------	----------------------------	--------------------------

MW-4	11/22/1996	NA	NA	NA	NA	NA	NA	NA	518.79	9.73	509.06
MW-4	02/14/1997	<50	<0.5	<0.5	<0.5	<0.5	<30	NA	518.79	8.85	509.94
MW-4	05/23/1997	NA	NA	NA	NA	NA	NA	NA	518.79	10.15	508.64
MW-4	07/25/1997	<50	<0.5	<0.5	<0.5	<0.5	<30	NA	518.79	10.61	508.18
MW-4	10/31/1997	NA	NA	NA	NA	NA	NA	NA	518.79	10.36	508.43
MW-4	02/06/1998	<50	<0.5	<0.5	<0.5	<0.5	<30	NA	518.79	7.46	511.33
MW-4	05/19/1998	NA	NA	NA	NA	NA	NA	NA	518.79	8.91	509.88
MW-4	07/31/1998	<50	<0.5	<0.5	<0.5	<0.5	<2.5	NA	518.79	8.99	509.80
MW-4	11/04/1998	<50	<0.50	<0.50	<0.50	<0.50	<2.5	NA	518.79	10.08	508.71
MW-4	11/11/1999	83.6	6.50	7.52	4.31	9.59	<2.50	NA	518.79	9.81	508.98
MW-4	04/03/2000	<50.0	<0.500	<0.500	<0.500	<0.500	<2.50	NA	518.79	9.24	509.55
MW-4	10/16/2000	<50.0	<0.500	<0.500	<0.500	<0.500	<2.50	NA	518.79	10.49	508.30
MW-4	06/28/2001	<50	<0.50	<0.50	<0.50	<0.50	NA	<0.50	518.79	10.82	507.97
MW-4	10/22/2001	<50	<0.50	<0.50	<0.50	<0.50	NA	<5.0	518.79	11.45	507.34
<b>MW-4</b>	<b>01/04/2002</b>	<b>NA</b>	<b>NA</b>	<b>NA</b>	<b>NA</b>	<b>NA</b>	<b>NA</b>	<b>NA</b>	<b>518.79</b>	<b>9.43</b>	<b>509.36</b>

MW-5	01/02/1992	1800	74	41	84	94	NA	NA	521.19	14.56	506.63
MW-5	04/02/1992	ND	ND	ND	ND	ND	NA	NA	521.19	13.58	507.61
MW-5	07/21/1992	1000	69	16	40	31	NA	NA	521.19	13.77	507.42
MW-5	10/09/1992	3400	890	51	110	110	NA	NA	521.19	14.09	507.10
MW-5	01/11/1993	15000	460	110	900	370	NA	NA	521.19	12.24	508.95
MW-5	05/05/1993	4500	160	19	280	110	NA	NA	521.19	11.90	509.29
MW-5	08/09/1993	2300	180	19	130	80	NA	NA	521.19	13.35	507.84
MW-5	10/14/1993	2200	160	27	90	64	NA	NA	521.19	13.89	507.30
MW-5	01/24/1994	2600	69	11	65	25	NA	NA	521.19	13.32	507.87
MW-5	05/31/1994	3100	130	64	140	120	NA	NA	521.19	12.75	508.44
MW-5	08/31/1994	600	20	2.9	14	7.1	NA	NA	521.19	14.34	506.85

**WELL CONCENTRATIONS**  
**Former Texaco Service Station**  
**930 Springtown Boulevard**  
**Livermore, CA**

Well ID	Date	TPPH (ug/L)	B (ug/L)	T (ug/L)	E (ug/L)	X (ug/L)	MTBE 8020 (ug/L)	MTBE 8260 (ug/L)	TOC (MSL)	Depth to Water (ft.)	GW Elevation (MSL)
---------	------	----------------	-------------	-------------	-------------	-------------	------------------------	------------------------	--------------	----------------------------	--------------------------

MW-5	11/02/1994	2300	68	18	52	54	NA	NA	521.19	14.22	506.97
MW-5	02/20/1995	12000	130	<30	240	138	NA	NA	521.19	12.78	508.41
MW-5	05/09/1995	2500	57	60	54	37	NA	NA	521.19	13.41	507.78
MW-5	08/21/1995	11000	91	28	140	120	<100	<100	521.19	12.32	508.87
MW-5	10/20/1995	2300	38	3.8	28	19	NA	NA	521.19	13.28	507.91
MW-5	02/07/1996	1800	35	8.1	37	20	NA	NA	521.19	11.31	509.88
MW-5	04/30/1996	NA	NA	NA	NA	NA	NA	NA	521.19	11.52	509.67
MW-5	08/14/1996	3500	130	22	170	47	71	NA	521.19	12.03	509.16
MW-5	11/22/1996	3500	160	15	190	28	<200	NA	521.19	12.22	508.97
MW-5	02/14/1997	2900	150	54	330	68	<300	NA	521.19	11.20	509.99
MW-5	05/23/1997	10000	170	98	380	68	<200	NA	521.19	12.55	508.64
MW-5	07/25/1997	2700	110	<0.5	33	<0.5	<30	NA	521.19	12.93	508.26
MW-5	10/31/1997	NA	NA	NA	NA	NA	NA	NA	521.19	12.78	508.41
MW-5	02/06/1998	67	<0.5	<0.5	<0.5	<0.5	<30	NA	521.19	10.26	510.93
MW-5	05/19/1998	4200	120	25	360	76	510	NA	521.19	11.12	510.07
MW-5	07/31/1998	270	<0.5	<0.5	<0.5	<0.5	<2.5	NA	521.19	11.79	509.40
MW-5	11/04/1998	2800	120	14	590	140	<25	<10	521.19	12.33	508.86
MW-5	11/11/1999	1220	40.5	22.8	16.4	6.22	<12.5	NA	521.19	12.64	508.55
MW-5	04/03/2000	5060	130	20.8	281	30.6	74.1	NA	521.19	11.64	509.55
MW-5	10/16/2000	2070	35.4	33.6	114	57.6	50.1	NA	521.19	12.82	508.37
MW-5	06/28/2001	1500	15	2.5	74	5.5	NA	<0.50	521.19	13.40	507.79
MW-5	10/22/2001	2400	37	2.9	75	7.3	NA	<5.0	521.19	13.99	507.20
<b>MW-5</b>	<b>01/04/2002</b>	<b>3400</b>	<b>8.9</b>	<b>1.2</b>	<b>22</b>	<b>13</b>	<b>NA</b>	<b>&lt;5.0</b>	<b>521.19</b>	<b>12.13</b>	<b>509.06</b>

MW-6	01/02/1992	23	ND	0.3	0.6	3	NA	NA	522.18	16.64	505.54
MW-6	04/02/1991	ND	ND	ND	ND	ND	NA	NA	522.18	15.61	506.57
MW-6	07/21/1992	<50	<0.5	<0.5	<0.5	<0.5	NA	NA	522.18	15.53	506.65

**WELL CONCENTRATIONS**  
**Former Texaco Service Station**  
**930 Springtown Boulevard**  
**Livermore, CA**

Well ID	Date	TPPH (ug/L)	B (ug/L)	T (ug/L)	E (ug/L)	X (ug/L)	MTBE 8020 (ug/L)	MTBE 8260 (ug/L)	TOC (MSL)	Depth to Water (ft.)	GW Elevation (MSL)
MW-6	10/09/1992	<50	<0.5	<0.5	<0.5	<0.5	NA	NA	522.18	15.69	506.49
MW-6	08/09/1993	<50	<0.5	<0.5	<0.5	<0.5	NA	NA	522.18	14.50	507.68
MW-6	10/14/1993	NA	NA	NA	NA	NA	NA	NA	522.18	NA	NA
MW-6	01/24/1994	<50	<0.5	<0.5	<0.5	<0.5	NA	NA	522.18	15.09	507.09
MW-6	05/31/1994	NA	NA	NA	NA	NA	NA	NA	522.18	14.64	507.54
MW-6	08/31/1994	<50	<0.5	<0.5	<0.5	<0.5	NA	NA	522.18	15.32	506.86
MW-6	11/02/1994	NA	NA	NA	NA	NA	NA	NA	522.18	15.32	506.86
MW-6	02/20/1995	<50	<0.5	<0.5	<0.5	<0.5	NA	NA	522.18	14.07	508.11
MW-6	05/09/1995	NA	NA	NA	NA	NA	NA	NA	522.18	14.30	507.88
MW-6	10/20/1995	NA	NA	NA	NA	NA	NA	NA	522.18	14.31	NA
MW-6	07/25/1997	NA	NA	NA	NA	NA	NA	NA	522.18	NA	NA
MW-7	01/02/1992	NA	NA	NA	NA	NA	NA	NA	522.19	11.17	511.02
MW-7	04/02/1992	ND	ND	ND	ND	ND	NA	NA	522.19	10.34	511.85
MW-7	07/21/1992	NA	NA	NA	NA	NA	NA	NA	522.19	9.02	513.17
MW-7	05/31/1994	NA	NA	NA	NA	NA	NA	NA	522.19	9.42	512.77
MW-7	08/31/1994	NA	NA	NA	NA	NA	NA	NA	522.19	6.84	515.35
MW-7	11/02/1994	NA	NA	NA	NA	NA	NA	NA	522.19	6.48	515.71
MW-7	02/20/1995	NA	NA	NA	NA	NA	NA	NA	522.19	7.71	514.48
MW-7	05/09/1995	NA	NA	NA	NA	NA	NA	NA	522.19	7.65	514.54
MW-7	08/21/1995	NA	NA	NA	NA	NA	NA	NA	522.19	7.83	514.36
MW-7	10/20/1995	NA	NA	NA	NA	NA	NA	NA	522.19	8.61	513.58
MW-7	07/25/1997	NA	NA	NA	NA	NA	NA	NA	522.19	NA	NA
MW-8	01/02/1992	12000	32	980	200	760	NA	NA	524.03	18.42	505.61
MW-8	04/02/1992	ND	ND	ND	ND	ND	NA	NA	524.03	17.39	506.64
MW-8	07/21/1992	NA	NA	NA	NA	NA	NA	NA	524.03	14.02	510.01

**WELL CONCENTRATIONS**  
**Former Texaco Service Station**  
**930 Springtown Boulevard**  
**Livermore, CA**

Well ID	Date	TPPH (ug/L)	B (ug/L)	T (ug/L)	E (ug/L)	X (ug/L)	MTBE 8020 (ug/L)	MTBE 8260 (ug/L)	TOC (MSL)	Depth to Water (ft.)	GW Elevation (MSL)
MW-8	05/31/1994	NA	NA	NA	NA	NA	NA	NA	524.03	19.65	504.38
MW-8	08/31/1994	<50	<0.5	<0.5	<0.5	<0.5	NA	NA	524.03	17.40	506.63
MW-8	11/02/1994	NA	NA	NA	NA	NA	NA	NA	524.03	17.38	506.65
MW-8	02/20/1995	<50	<0.5	<0.5	<0.5	<0.5	NA	NA	524.03	15.99	508.04
MW-8	05/09/1995	NA	NA	NA	NA	NA	NA	NA	524.03	16.54	507.49
MW-8	08/21/1995	<50	<0.5	<0.5	0.67	0.62	<10	NA	524.03	15.77	508.26
MW-8	10/20/1995	NA	NA	NA	NA	NA	NA	NA	524.03	16.24	507.79
MW-8	02/07/1996	<50	7.0	<0.5	<0.5	<0.5	NA	NA	524.03	14.42	509.61
MW-8	04/30/1996	61	9.6	<0.5	<0.5	<0.5	NA	NA	524.03	14.65	509.38
MW-8	08/14/1996	<50	0.73	<0.5	<0.5	<0.5	<30	NA	524.03	15.08	508.95
MW-8	11/22/1996	120	5.9	2.2	2.4	8.3	<30	NA	524.03	15.35	508.68
MW-8	02/14/1997	<50	<0.5	<0.5	<0.5	<0.5	<30	NA	524.03	14.32	509.71
MW-8	05/23/1997	<50	<0.5	<0.5	<0.5	<0.5	<30	NA	524.03	13.35	510.68
MW-8	07/25/1997	<50	<0.5	<0.5	<0.5	<0.5	<30	NA	524.03	16.05	507.98
MW-8	10/31/1997	<50	<0.5	<0.5	<0.5	<0.5	<30	NA	524.03	15.86	508.17
MW-8	02/06/1998	180	17	<0.5	<0.5	6.0	<30	NA	524.03	13.62	510.41
MW-8	05/19/1998	<50	4.9	<0.5	<0.5	<0.5	<2.5	NA	524.03	14.23	509.80
MW-8	07/31/1998	140	<0.5	<0.5	<0.5	<0.5	<2.5	NA	524.03	14.95	509.08
MW-8	11/04/1998	<50	1.2	100	1.9	7.8	<2.5	NA	524.03	15.42	508.61
MW-8	11/11/1999	<50.0	<0.500	<0.500	<0.500	<0.500	3.70	<0.500	524.03	15.74	508.29
MW-8	04/03/2000	87.7	10.8	<0.500	<0.500	<0.500	<2.50	NA	524.03	14.76	509.27
MW-8	10/16/2000	237	11.3	<0.500	<0.500	0.544	7.93	NA	524.03	15.91	508.12
MW-8	06/28/2001	<50	<0.50	<0.50	<0.50	<0.50	NA	29	524.03	16.49	507.54
MW-8	10/22/2001	<50	<0.50	<0.50	<0.50	2.0	NA	<5.0	524.03	16.98	507.05
<b>MW-8</b>	<b>01/04/2002</b>	<b>290</b>	<b>1.3</b>	<b>&lt;0.50</b>	<b>&lt;0.50</b>	<b>&lt;0.50</b>	<b>NA</b>	<b>&lt;5.0</b>	<b>524.03</b>	<b>15.29</b>	<b>508.74</b>

**WELL CONCENTRATIONS**  
**Former Texaco Service Station**  
**930 Springtown Boulevard**  
**Livermore, CA**

Well ID	Date	TPPH (ug/L)	B (ug/L)	T (ug/L)	E (ug/L)	X (ug/L)	MTBE		TOC (MSL)	Depth to Water (ft.)	GW Elevation (MSL)
							8020 (ug/L)	8260 (ug/L)			

Abbreviations:

TPPH = Total petroleum hydrocarbons as gasoline by EPA Method 8260B; prior to June 28, 2001, analyzed by EPA Method 8015.

BTEX = benzene, toluene, ethylbenzene, xylenes by EPA Method 8260B; prior to June 28, 2001, analyzed by EPA Method 8020.

MTBE = Methyl-tertiary-butyl ether

TOC = Top of Casing Elevation

GW = Groundwater

ug/L = Parts per billion

msl = Mean sea level

ft = Feet

<n = Below detection limit

(D) = Duplicate sample

NA = Not applicable

ND = Not detected at or above the minimum quantitation limits.

Notes:

a = Sample analyzed outside of EPA recommended holding time.

For the event on April 3, 2000, the lab confirmed MTBE by 8260 for well MW-B instead of well MW-A.



Report Number : 24208

Date : 1/14/2002

Nick Sudano  
Blaine Tech Services  
1680 Rogers Avenue  
San Jose, CA 95112-1105

Subject : 5 Water Samples  
Project Name : 930 Springtown Boulevard, Livermore  
Project Number : 020104-DA2  
P.O. Number : 91995053

Dear Mr. Sudano,

Chemical analysis of the samples referenced above has been completed. Summaries of the data are contained on the following pages. Sample(s) were received under documented chain-of-custody. US EPA protocols for sample storage and preservation were followed.

Kiff Analytical is certified by the State of California (# 2236). If you have any questions regarding procedures or results, please call me at 530-297-4800.

Sincerely,

A handwritten signature in black ink that reads "Joel Kiff". The signature is written in a cursive style with a large initial "J".

Joel Kiff



Report Number : 24208

Date : 1/14/2002

Project Name : 930 Springtown Boulevard, Livermore

Project Number : 020104-DA2

Sample : MW-A

Matrix : Water

Lab Number : 24208-01

Sample Date :1/4/2002

Parameter	Measured Value	Method Reporting Limit	Units	Analysis Method	Date Analyzed
Benzene	4.1	2.0	ug/L	EPA 8260B	1/9/2002
Toluene	6.5	2.0	ug/L	EPA 8260B	1/9/2002
Ethylbenzene	450	2.0	ug/L	EPA 8260B	1/9/2002
Total Xylenes	360	2.0	ug/L	EPA 8260B	1/9/2002
Methyl-t-butyl ether (MTBE)	< 20	20	ug/L	EPA 8260B	1/9/2002
TPH as Gasoline	9100	200	ug/L	EPA 8260B	1/9/2002
Toluene - d8 (Surr)	102		% Recovery	EPA 8260B	1/9/2002
4-Bromofluorobenzene (Surr)	107		% Recovery	EPA 8260B	1/9/2002

Sample : MW-B

Matrix : Water

Lab Number : 24208-02

Sample Date :1/4/2002

Parameter	Measured Value	Method Reporting Limit	Units	Analysis Method	Date Analyzed
Benzene	11	2.0	ug/L	EPA 8260B	1/9/2002
Toluene	240	2.0	ug/L	EPA 8260B	1/9/2002
Ethylbenzene	280	2.0	ug/L	EPA 8260B	1/9/2002
Total Xylenes	1100	2.0	ug/L	EPA 8260B	1/9/2002
Methyl-t-butyl ether (MTBE)	< 20	20	ug/L	EPA 8260B	1/9/2002
TPH as Gasoline	10000	200	ug/L	EPA 8260B	1/9/2002
Toluene - d8 (Surr)	101		% Recovery	EPA 8260B	1/9/2002
4-Bromofluorobenzene (Surr)	110		% Recovery	EPA 8260B	1/9/2002

Approved By: Joel Kiff



Report Number : 24208

Date : 1/14/2002

Project Name : 930 Springtown Boulevard, Livermore

Project Number : 020104-DA2

Sample : MW-3

Matrix : Water

Lab Number : 24208-03

Sample Date :1/4/2002

Parameter	Measured Value	Method Reporting Limit	Units	Analysis Method	Date Analyzed
<b>Benzene</b>	< 0.50	0.50	ug/L	EPA 8260B	1/9/2002
<b>Toluene</b>	< 0.50	0.50	ug/L	EPA 8260B	1/9/2002
<b>Ethylbenzene</b>	< 0.50	0.50	ug/L	EPA 8260B	1/9/2002
<b>Total Xylenes</b>	< 0.50	0.50	ug/L	EPA 8260B	1/9/2002
<b>Methyl-t-butyl ether (MTBE)</b>	< 5.0	5.0	ug/L	EPA 8260B	1/9/2002
<b>TPH as Gasoline</b>	< 50	50	ug/L	EPA 8260B	1/9/2002
Toluene - d8 (Surr)	99.6		% Recovery	EPA 8260B	1/9/2002
4-Bromofluorobenzene (Surr)	102		% Recovery	EPA 8260B	1/9/2002

Sample : MW-5

Matrix : Water

Lab Number : 24208-04

Sample Date :1/4/2002

Parameter	Measured Value	Method Reporting Limit	Units	Analysis Method	Date Analyzed
<b>Benzene</b>	8.9	0.50	ug/L	EPA 8260B	1/9/2002
<b>Toluene</b>	1.2	0.50	ug/L	EPA 8260B	1/9/2002
<b>Ethylbenzene</b>	22	0.50	ug/L	EPA 8260B	1/9/2002
<b>Total Xylenes</b>	13	0.50	ug/L	EPA 8260B	1/9/2002
<b>Methyl-t-butyl ether (MTBE)</b>	< 5.0	5.0	ug/L	EPA 8260B	1/9/2002
<b>TPH as Gasoline</b>	3400	250	ug/L	EPA 8260B	1/10/2002
Toluene - d8 (Surr)	96.5		% Recovery	EPA 8260B	1/9/2002
4-Bromofluorobenzene (Surr)	101		% Recovery	EPA 8260B	1/9/2002

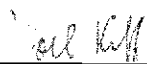
Approved By:  Joel Kiff





Report Number : 24208

Date : 1/14/2002

Project Name : 930 Springtown Boulevard, Livermore

Project Number : 020104-DA2

Sample : MW-8

Matrix : Water

Lab Number : 24208-05

Sample Date : 1/4/2002

Parameter	Measured Value	Method Reporting Limit	Units	Analysis Method	Date Analyzed
<b>Benzene</b>	<b>1.3</b>	0.50	ug/L	EPA 8260B	1/9/2002
<b>Toluene</b>	<b>&lt; 0.50</b>	0.50	ug/L	EPA 8260B	1/9/2002
<b>Ethylbenzene</b>	<b>&lt; 0.50</b>	0.50	ug/L	EPA 8260B	1/9/2002
<b>Total Xylenes</b>	<b>&lt; 0.50</b>	0.50	ug/L	EPA 8260B	1/9/2002
<b>Methyl-t-butyl ether (MTBE)</b>	<b>&lt; 5.0</b>	5.0	ug/L	EPA 8260B	1/9/2002
<b>TPH as Gasoline</b>	<b>290</b>	50	ug/L	EPA 8260B	1/10/2002
Toluene - d8 (Surr)	101		% Recovery	EPA 8260B	1/9/2002
4-Bromofluorobenzene (Surr)	99.9		% Recovery	EPA 8260B	1/9/2002

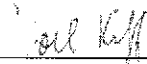
  
Approved By: Joel Kiff

Report Number : 24208

Date : 1/14/2002

**QC Report : Method Blank Data**

Project Name : **930 Springtown Boulevard, Livermore**

Project Number : **020104-DA2**

<u>Parameter</u>	<u>Measured Value</u>	<u>Method Reporting Limit</u>	<u>Units</u>	<u>Analysis Method</u>	<u>Date Analyzed</u>
Benzene	< 0.50	0.50	ug/L	EPA 8260B	1/9/2002
Toluene	< 0.50	0.50	ug/L	EPA 8260B	1/9/2002
Ethylbenzene	< 0.50	0.50	ug/L	EPA 8260B	1/9/2002
Total Xylenes	< 0.50	0.50	ug/L	EPA 8260B	1/9/2002
Methyl-t-butyl ether (MTBE)	< 5.0	5.0	ug/L	EPA 8260B	1/9/2002
TPH as Gasoline	< 50	50	ug/L	EPA 8260B	1/9/2002
Toluene - d8 (Surr)	103		%	EPA 8260B	1/9/2002
4-Bromofluorobenzene (Surr)	114		%	EPA 8260B	1/9/2002

<u>Parameter</u>	<u>Measured Value</u>	<u>Method Reporting Limit</u>	<u>Units</u>	<u>Analysis Method</u>	<u>Date Analyzed</u>
------------------	-----------------------	-------------------------------	--------------	------------------------	----------------------

KIFF ANALYTICAL, LLC

720 Olive Drive, Suite D Davis, CA 95616 530-297-4800

Approved By:  \_\_\_\_\_  
Joel Kiff

Report Number : 24208

Date : 1/14/2002

QC Report : Matrix Spike/ Matrix Spike Duplicate

Project Name : 930 Springtown

Project Number : 020104-DA2

Parameter	Spiked Sample	Sample Value	Spike Level	Spike Dup. Level	Spiked Sample Value	Duplicate Spiked Sample Value	Units	Analysis Method	Date Analyzed	Spiked Sample Percent Recov.	Duplicate Spiked Sample Percent Recov.	Relative Percent Diff.	Spiked Sample Recov. Limit	Relative Percent Diff. Limit
Benzene	24206-03	<0.50	18.5	19.5	18.6	19.4	ug/L	EPA 8260B	1/9/2002	101	99.4	1.20	70-130	25
Toluene	24206-03	<0.50	18.5	19.5	18.1	19.1	ug/L	EPA 8260B	1/9/2002	97.8	98.0	0.281	70-130	25
Tert-Butanol	24206-03	<5.0	92.5	97.4	84.2	92.3	ug/L	EPA 8260B	1/9/2002	91.0	94.8	4.06	70-130	25
Methyl-t-Butyl Ether	24206-03	1.4	18.5	19.5	18.4	16.1	ug/L	EPA 8260B	1/9/2002	92.1	75.5	19.7	70-130	25

KIFF ANALYTICAL, LLC

720 Olive Drive, Suite D Davis, CA 95616 530-297-4800

Approved By:  Joel Kiff

Report Number : 24208

Date : 1/14/2002

QC Report : Laboratory Control Sample (LCS)

Project Name : 930 Springtown

Project Number : 020104-DA2

Parameter	Spike Level	Units	Analysis Method	Date Analyzed	LCS Percent Recov.	LCS Percent Recov. Limit
Benzene	19.1	ug/L	EPA 8260B	1/8/2002	100	70-130
Toluene	19.1	ug/L	EPA 8260B	1/8/2002	99.4	70-130
Tert-Butanol	95.6	ug/L	EPA 8260B	1/8/2002	91.6	70-130
Methyl-t-Butyl Ether	19.1	ug/L	EPA 8260B	1/8/2002	85.9	70-130

KIFF ANALYTICAL, LLC

720 Olive Drive, Suite D Davis, CA 95616 530-297-4800

Approved By:   
Joel Kiff



## WELL GAUGING DATA

Project # 020104-DA2 Date 1/4/02 Client Equiva

Site 930 Springtown Blvd. Livermore

Well ID	Well Size (in.)	Sheen / Odor	Depth to Immiscible Liquid (ft.)	Thickness of Immiscible Liquid (ft.)	Volume of Immiscibles Removed (ml)	Depth to water (ft.)	Depth to well bottom (ft.)	Survey Point: TOB or <del>TOC</del>	
* MW-A	2					10.83 <del>11.02</del>	16.35		G/S
MW-B	2					8.46	22.20		S
MW-1	4					11.02	25.40		G
MW-2	4					8.63	22.48		G
MW-3	3/4					10.18	24.52 <del>24.85</del>		S
MW-4	3					9.43	24.85		G
MW-5	2					12.13	22.00		S
MW-8	4					15.29	24.20	↓	S
* Bent casing, used disposable bailer									

## EQUIVA WELL MONITORING DATA SHEET

BTS #: 020104-DA2	Site: 930 Springtown Blvd. Livermore
Sampler: DA	Date: 1/4/02
Well I.D.: MW-A	Well Diameter: <input checked="" type="radio"/> 2 3 4 6 8
Total Well Depth: 16.35	Depth to Water: 10.83
Depth to Free Product:	Thickness of Free Product (feet):
Referenced to: <input checked="" type="radio"/> PVC Grade	D.O. Meter (if req'd): YSI HACH

Purge Method:

- |  |  |
|--|--|
| <input checked="" type="radio"/> Bailer<br>Disposable Bailer<br>Middleburg<br>Electric Submersible | Waterra<br>Peristaltic<br>Extraction Pump<br>Other _____ |
|--|--|

Sampling Method:

- Bailer
- Disposable Bailer  
 Extraction Port  
 Dedicated Tubing

Other: \_\_\_\_\_

0.9 (Gals.) X 3	=	2.7 Gals.
1 Case Volume	Specified Volumes	Calculated Volume

Well Diameter	Multiplier	Well Diameter	Multiplier
1"	0.04	4"	0.65
<input checked="" type="radio"/> 2"	0.16	6"	1.47
3"	0.37	Other	radius <sup>2</sup> * 0.163

Time	Temp (°F)	pH	Cond.	Turbidity	Gals. Removed	Observations
1434	64.1	7.2	1920	196	0.9	cloudy, tan, light sheen, odor
1438	64.1	7.1	1824	>200	1.8	"
1442	64.8	7.1	1737	>200	2.7	"

Did well dewater? Yes  No Gallons actually evacuated: 2.7

Sampling Time: 1445 Sampling Date: 1/4/02

Sample I.D.: MW-A Laboratory: Sequoia Columbia Other Kiff

Analyzed for: ~~TPH-G BTEX MTBE~~ TPH-D Other:

EB I.D. (if applicable): @ Time Duplicate I.D. (if applicable):

Analyzed for: TPH-G BTEX MTBE TPH-D Other:

D.O. (if req'd):	Pre-purge:	mg/L	Post-purge:	mg/L
O.R.P. (if req'd):	Pre-purge:	mV	Post-purge:	mV

## EQUIVA WELL MONITORING DATA SHEET

BTS #: 020104-DA2	Site: 930 Springtown Blvd. Livermore
Sampler: DA	Date: 1/4/07
Well I.D.: MW-B	Well Diameter: ② 3 4 6 8
Total Well Depth: 22.20	Depth to Water: 8.46
Depth to Free Product:	Thickness of Free Product (feet):
Referenced to: <u>PVC</u> Grade	D.O. Meter (if req'd): YSI HACH

Purge Method: Bailer  
 Disposable Bailer  
 Middleburg  
 Electric Submersible

Watertra  
 Peristaltic  
 Extraction Pump  
 Other \_\_\_\_\_

Sampling Method: Bailer  
 Disposable Bailer  
 Extraction Port  
 Dedicated Tubing

Other: \_\_\_\_\_

$2.2 \text{ (Gals.)} \times 3 = 6.6 \text{ Gals.}$   
 1 Case Volume      Specified Volumes      Calculated Volume

Well Diameter	Multiplier	Well Diameter	Multiplier
1"	0.04	4"	0.65
② 2"	0.16	6"	1.47
3"	0.37	Other	radius <sup>2</sup> * 0.163

Time	Temp (°F)	pH	Cond.	Turbidity	Gals. Removed	Observations
1404	63.4	7.5	1733	135	2.2	light sheen
1409	63.2	7.5	1750	157	4.4	cloudy, turning green
1412	63.7	7.6	1760	192	6.6	"

Did well dewater? Yes  No  Gallons actually evacuated: 6.6

Sampling Time: 1415      Sampling Date: 1/4/07

Sample I.D.: MW-B      Laboratory: KIT Sequoia Other \_\_\_\_\_

Analyzed for: TPH-G BTEX MTBE TPH-D Other: \_\_\_\_\_

EB I.D. (if applicable): @ \_\_\_\_\_ Time Duplicate I.D. (if applicable): \_\_\_\_\_

Analyzed for: TPH-G BTEX MTBE TPH-D Other: \_\_\_\_\_

D.O. (if req'd):	Pre-purge:	mg/L	Post-purge:	mg/L
O.R.P. (if req'd):	Pre-purge:	mV	Post-purge:	mV



# EQUIVA WELL MONITORING DATA SHEET

5  
80

BTS #: 020104-DA2	Site: 930 Springtown Blvd. Livermore
Sampler: DA	Date: 1/4/02
Well I.D.: <del>MW-2</del> MW-3	Well Diameter: 2 3 <u>4</u> 6 8
Total Well Depth: <del>25.40</del> <sup>24.52</sup> <del>22.48</del>	Depth to Water: <del>11.02</del> 10.18
Depth to Free Product:	Thickness of Free Product (feet):
Referenced to: <u>PVC</u> Grade	D.O. Meter (if req'd): YSI HACH

Purge Method:

- Bailer
- Disposable Bailer
- Middleburg
- Electric Submersible
- Waterra
- Peristaltic
- Extraction Pump
- Other \_\_\_\_\_

Sampling Method:

- Bailer
- Disposable Bailer
- Extraction Port
- Dedicated Tubing

Other: \_\_\_\_\_

9.3 (Gals.) X	3	= 27.9 Gals.
I Case Volume	Specified Volumes	Calculated Volume

Well Diameter	Multiplier	Well Diameter	Multiplier
1"	0.04	4"	0.65
2"	0.16	6"	1.47
3"	0.37	Other	radius <sup>2</sup> * 0.163

Time	Temp (°F)	pH	Cond.	Turbidity	Gals. Removed	Observations
1310	62.7	7.3	1851	146	9.3	cloudy
dewatered after 9.3g. dtw = 22.45						
1455	Returned. Recharged 80%.				18.6 ↓	dtw = 10.47
1501	60.9	7.4	2004	100	27.9 ↓	
1505	61.9	7.4	1933	62		

Did well dewater? <u>Yes</u> No	Gallons actually evacuated: 27.9	
Sampling Time: 1508	Sampling Date: 1/4/02	
Sample I.D.: MW-3	Laboratory: Sequoia Columbia Other <u>Kiff</u>	
Analyzed for: <del>TPH-G BTEX MTBE</del> TPH-D Other:		
EB I.D. (if applicable): @ Time	Duplicate I.D. (if applicable):	
Analyzed for: TPH-G BTEX MTBE TPH-D Other:		
D.O. (if req'd):	Pre-purge: mg/L	Post-purge: mg/L
O.R.P. (if req'd):	Pre-purge: mV	Post-purge: mV

EQUIVA WELL MONITORING DATA SHEET

BTS #: 020104-DA2	Site: 930 Springtown Blvd. Livermore
Sampler: DA	Date: 1/4/02
Well I.D.: MW-5	Well Diameter: <input checked="" type="radio"/> 3   4   6   8
Total Well Depth: 22.00	Depth to Water: 12.13
Depth to Free Product:	Thickness of Free Product (feet):
Referenced to: <input checked="" type="radio"/> PVC   Grade	D.O. Meter (if req'd):   YSI   HACH

Purge Method:      Sampling Method:

<input checked="" type="radio"/> Bailer	Waterra	<input checked="" type="radio"/> Bailer
Disposable Bailer	Peristaltic	Disposable Bailer
Middleburg	Extraction Pump	Extraction Port
Electric Submersible	Other _____	Dedicated Tubing
		Other: _____

$\frac{9.16}{9.16}$  (Gals.) X 3 =  $\frac{4.8}{29.7}$  Gals.  
 1 Case Volume      Specified Volumes      Calculated Volume

Well Diameter	Multiplier	Well Diameter	Multiplier
1"	0.04	4"	0.65
<input checked="" type="radio"/> 2"	0.16	6"	1.47
3"	0.37	Other	radius <sup>2</sup> * 0.163

Time	Temp (°F)	pH	Cond.	Turbidity	Gals. Removed	Observations
1332	65.2	7.1	1286	7200	1.6	light grey
1336	65.8	7.1	1352	7200	3.2	darker grey
1340	66.6	7.2	1481	7200	4.8	

Did well dewater? Yes  No      Gallons actually evacuated: 4.8

Sampling Time: 1343      Sampling Date: 1/4/02

Sample I.D.: MW-5      Laboratory: Sequoia   Columbia   Other Kiff

Analyzed for: ~~TPH-G~~ ~~BTEX~~ ~~MTBE~~   TPH-D   Other:

EB I.D. (if applicable): @      Duplicate I.D. (if applicable):

Analyzed for: TPH-G   BTEX   MTBE   TPH-D   Other:

D.O. (if req'd):      Pre-purge:      mg/L      Post-purge:      mg/L

O.R.P. (if req'd):      Pre-purge:      mV      Post-purge:      mV