



FIDELITY ROOF COMPANY

RECEIVED

9:52 am, Jan 27, 2010

Alameda County
Environmental Health

January 22, 2010

Alameda County Department of
Environmental Health
1131 Harbor Bay Parkway, 2nd Floor
Alameda, CA 94502

Attention: Steven Plunkett

Subject: Fourth Quarter 2009 Groundwater Monitoring Report
1075 40th Street, Oakland, CA 94608
ACDEH Site No. RO000186

Ladies and Gentlemen:

Attached please find a copy of the *Fourth Quarter 2009 Groundwater Monitoring Report, 1075 40th Street, Oakland, CA 94608*, prepared by Gribi Associates. I declare, under penalty of perjury, that the information and/or recommendations contained in the attached document or report is true and correct to the best of my knowledge.

Very truly yours,

Monte M. Upshaw
Chairman
Fidelity Roof Company



January 22, 2010

Alameda County Department of
Environmental Health
1131 Harbor Bay Parkway, 2nd Floor
Alameda, CA 94502

Attention: Steven Plunkett

Subject: Fourth Quarter 2009 Groundwater Monitoring Report
1075 40th Street, Oakland, CA 94608
ACDEH Site No. RO000186

Ladies and Gentlemen:

Gribi Associates is pleased to submit this Fourth Quarter 2009 Groundwater Monitoring Report on behalf of Fidelity Roof Company for the underground storage tank (UST) site located at 1075 40th Street in Oakland, California (see Figure 1 and Figure 2). This letter report documents the monitoring and sampling of seven site wells on November 18, 2009.

DESCRIPTION OF SAMPLING ACTIVITIES

1. Gribi Associates personnel conducted groundwater monitoring and sampling activities for seven site wells (MW-1, MW-2, MW-4, MW-5, MW-6, DP-1, and DP-2) on November 18, 2009.
2. Groundwater monitoring and sampling was conducted in accordance with California LUFT Field Manual, including the following:
 - a. measuring static water levels;
 - b. checking for presence of free-product;
 - c. and purging of approximately three well volumes while recording of temperature, pH, conductivity, and clarity.
3. Collected groundwater samples were placed in an ice-chilled cooler and submitted to a state-certified laboratory for analyses.
4. Copies of groundwater sampling field data sheets are provided as Attachment A.

RESULTS OF GROUNDWATER MONITORING

Hydrologic Conditions

1. Groundwater depths ranged from approximately 8.20 feet (MW-4) to 10.45 feet (MW-5).
2. Groundwater elevations ranged from 40.23 feet above means sea level (msl) (MW-6) to 41.44 feet msl (MW-1).
3. Groundwater flow direction is variable, generally trending to the northwest.
4. Groundwater elevations and groundwater contours are shown on Figure 3.

Laboratory Analytical Results

1. Groundwater samples from the seven sampled wells were analyzed for the following parameters with standard method turn around time on results:
 - a. USEPA 8015C Total Petroleum Hydrocarbons as Diesel (TPH-D)
 - b. USEPA 8015C Total Petroleum Hydrocarbons as Gasoline (TPH-G)
 - c. USEPA 8260B Benzene, Toluene, Ethylbenzene, Xylenes (BTEX)
 - d. USEPA 8260B Oxygenates (TBA, MTBE, DIPE, ETBE, and TAME)
2. Groundwater hydrocarbon results for this monitoring event are summarized in Table 1.
3. Groundwater hydrocarbon results for this monitoring event are summarized on Figure 4.
4. The laboratory analytical data report and chain-of custody are provided as Attachment B.
5. A hydrocarbon concentration versus time trend graph for MW-2 is included in Attachment C.

CONCLUSIONS

1. Results of this and previous monitoring events seem to indicate a relatively small groundwater hydrocarbon plume extending 30 to 40 feet northwest from the former UST area.
2. With the exception of MW-2, groundwater samples from this monitoring event show no significant concentrations of benzene or oxygenates, indicating that the residual hydrocarbons beneath the site do not pose a significant environmental or human health risk. Based upon the relatively close proximity of site wells, the groundwater impacts observed in the vicinity of MW-2 appear to be limited in lateral extent.

PLANNED ACTIVITIES

1. Gribi Associates will perform Second Quarter 2010 groundwater monitoring at the site.

Alameda County Department of
Environmental Health
January 22, 2010
Page 3

We appreciate this opportunity to provide this report for your review. Please contact us if there are questions or if additional information is required.

Very truly yours,



Matthew A. Rosman
Project Engineer



James E. Gribi
Professional Geologist
California No. 5843



Enclosure

cc: Mr. Monte Upshaw, Fidelity Roof Co.

M:\Projects\Active Projects\Fidelity Roofing\Groundwater Monitoring\2009\4Q 2009\Fidelity Roof_4q 2009 GWM_Rpt.wpd

FIGURES

TOPO! map printed on 04/03/07 from "California.tpo" and "Untitled.tpg"
 122°18.000' W 122°17.000' W WGS84 122°16.000' W

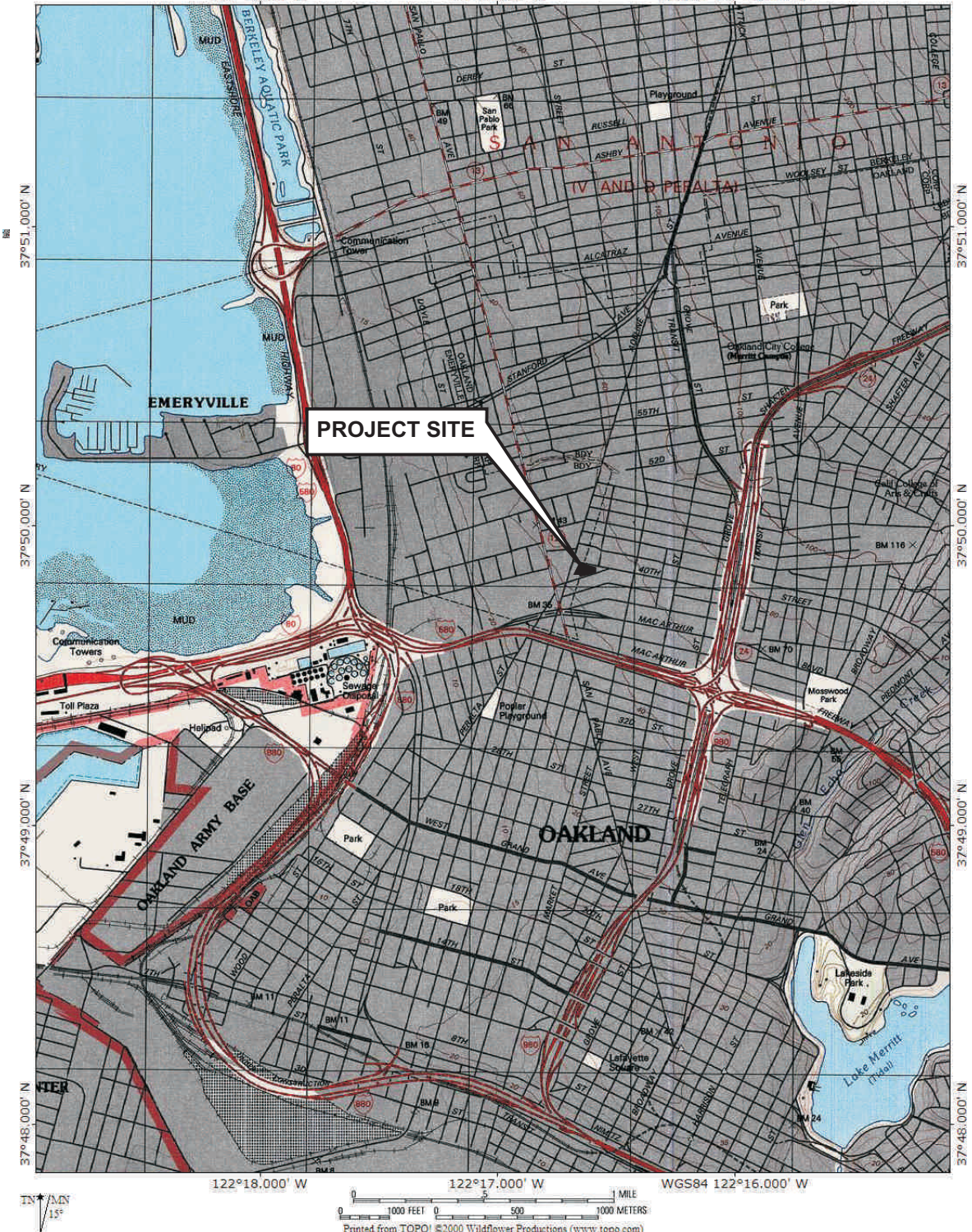

DESIGNED BY:	CHECKED BY:
DRAWN BY: JG	SCALE:
PROJECT NO:	

SITE VICINITY MAP

1075 40TH STREET
 OAKLAND, CALIFORNIA

DATE: 01/21/2010	FIGURE: 1

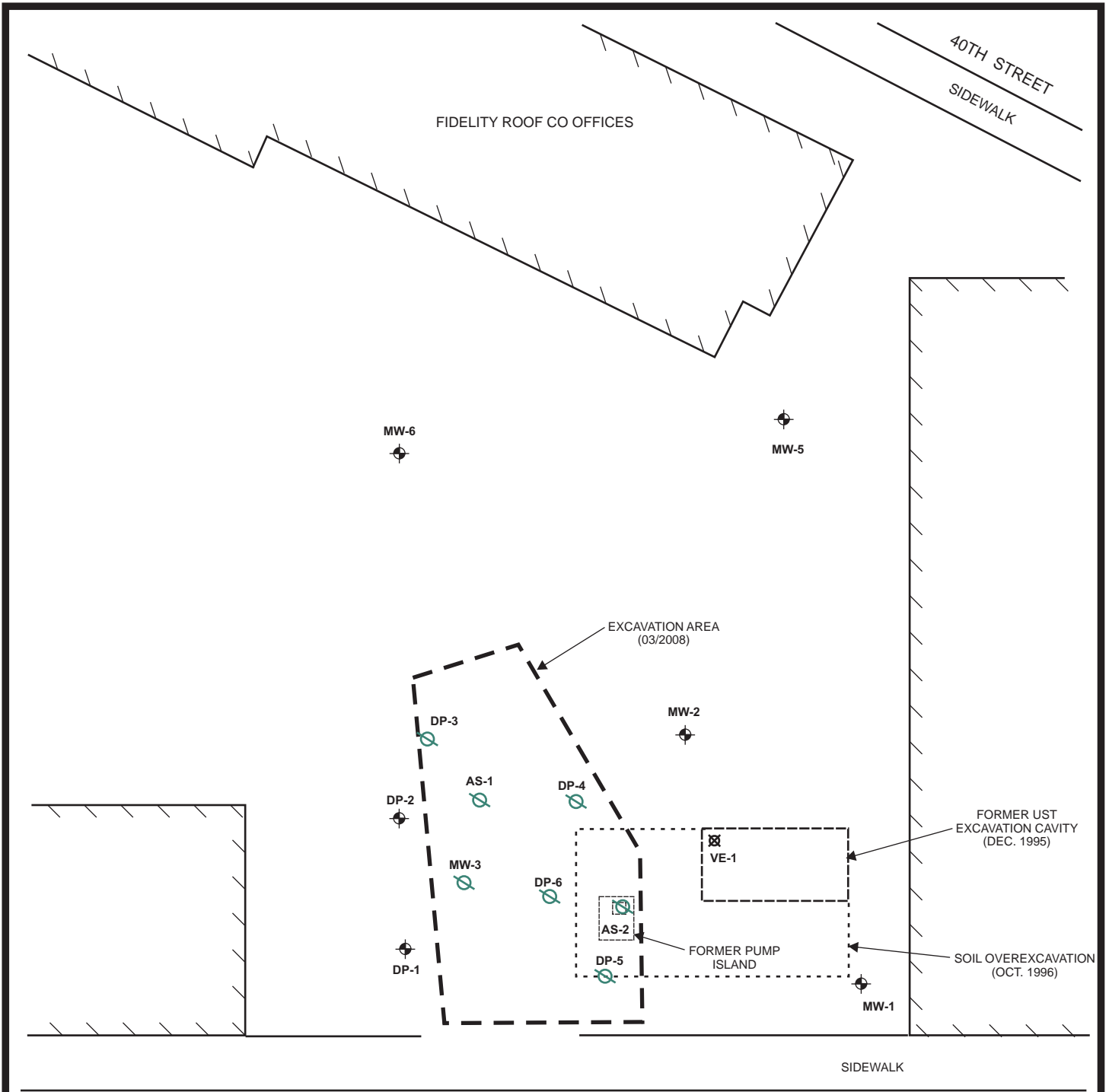

LEGEND

- ABANDONED WELL
- REMEDIATION WELL
- GROUNDWATER MONITORING WELL

MW-4

YERBA BUENA AVENUE

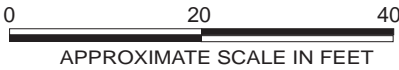

DESIGNED BY:	CHECKED BY:
DRAWN BY: JG	SCALE:
PROJECT NO:	

SITE PLAN

1075 40TH STREET
 OAKLAND, CALIFORNIA

DATE: 01/21/2010	FIGURE: 2

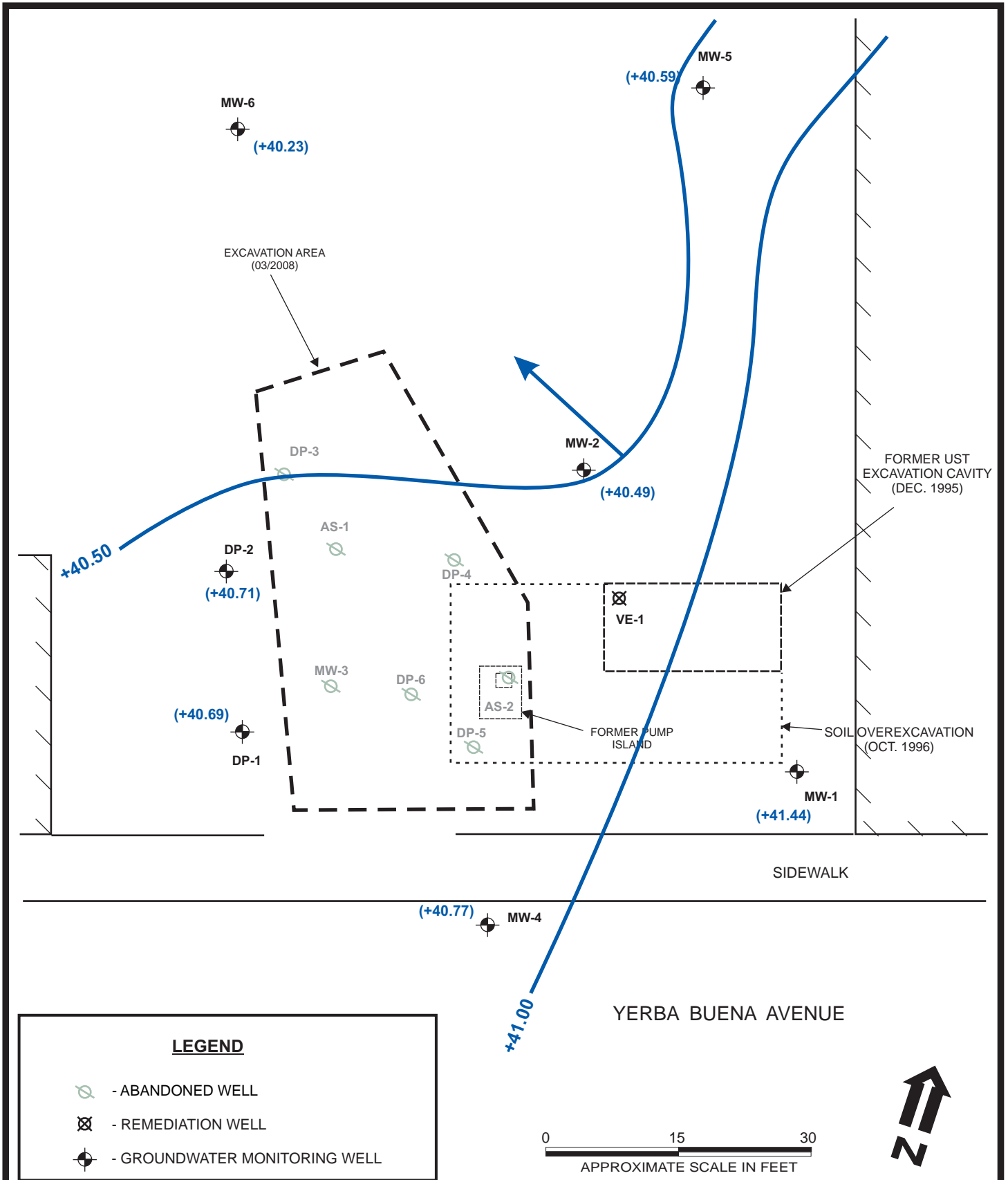

LEGEND

- ABANDONED WELL
- REMEDIATION WELL
- GROUNDWATER MONITORING WELL



DESIGNED BY:	CHECKED BY:	GROUNDWATER ELEVATIONS AND CONTOURS - 11/18/2009 1075 40TH STREET OAKLAND, CALIFORNIA	DATE: 01/21/2010	FIGURE: 3	
DRAWN BY: JG	SCALE:				
PROJECT NO:					

TPH-G:	<50
B:	<0.50
T:	<0.50
E:	<0.50
X:	<1.0
MTBE:	62
DIPE:	<2.0
ETBE:	<2.0
TAME:	<2.0
TBA:	<10
TPH-D:	<500

TPH-G:	<50
B:	<0.5
T:	<0.5
E:	<0.5
X:	<1.0
MTBE:	<1.0
DIPE:	<2.0
ETBE:	<2.0
TAME:	<2.0
TBA:	<10
TPH-D:	<50

TPH-G:	1,600
B:	2.3
T:	<0.5
E:	15
X:	<1.0
MTBE:	160
DIPE:	<2.0
ETBE:	<2.0
TAME:	<2.0
TBA:	2,700
TPH-D:	960

TPH-G:	85
B:	<0.5
T:	<0.5
E:	<0.5
X:	<1.0
MTBE:	<1.0
DIPE:	<2.0
ETBE:	<2.0
TAME:	<2.0
TBA:	<10
TPH-D:	<50

TPH-G:	<50
B:	<0.5
T:	<0.5
E:	<0.5
X:	<1.0
MTBE:	<1.0
DIPE:	<2.0
ETBE:	<2.0
TAME:	<2.0
TBA:	<10
TPH-D:	<50

TPH-G:	150
B:	<0.5
T:	<0.5
E:	<0.5
X:	<1.0
MTBE:	4.0
DIPE:	<2.0
ETBE:	<2.0
TAME:	<2.0
TBA:	<10
TPH-D:	180

TPH-G:	<50
B:	<0.5
T:	<0.5
E:	<0.5
X:	0.10
MTBE:	13
DIPE:	<2.0
ETBE:	<2.0
TAME:	<2.0
TBA:	<10
TPH-D:	<50

GROUNDWATER
TPH-G = 1,000 UG/L

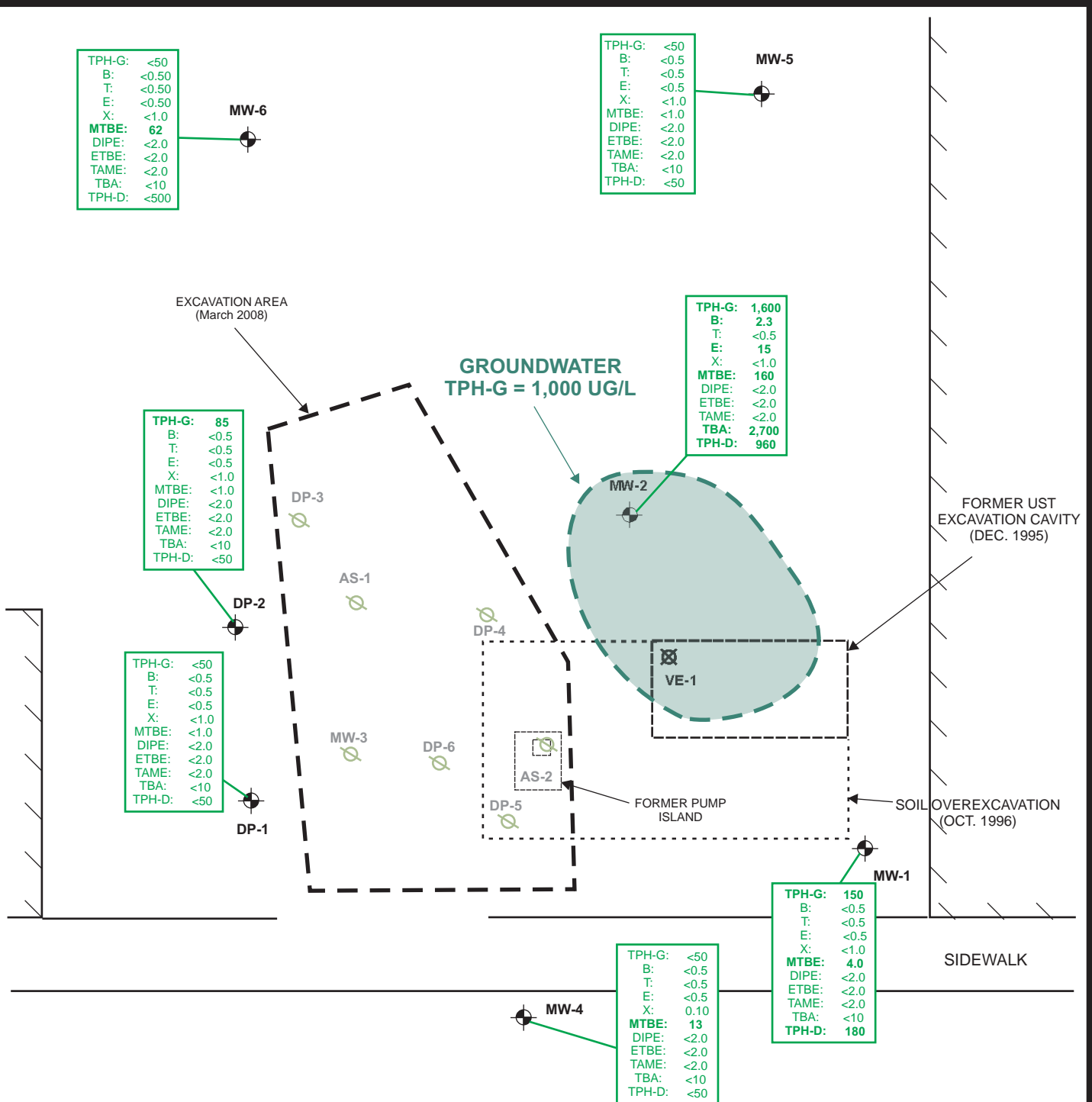

LEGEND

- ABANDONED WELL
- REMEDIATION WELL
- GROUNDWATER MONITORING WELL

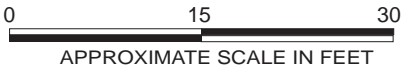

DESIGNED BY:	CHECKED BY:
DRAWN BY: JG	SCALE:
PROJECT NO:	

**GROUNDWATER HYDROCARBON
RESULTS - 11/18/2009**

1075 40TH STREET
OAKLAND, CALIFORNIA

DATE: 01/21/2010	FIGURE: 4
------------------	-----------



TABLE

Table 1
Groundwater Laboratory Analytical Results
 Fidelity Roof Co. UST Site

Well ID	Date	GW Depth	GW Elev.	Concentration, micrograms per liter (ug/l)							
				TPH-D	TPH-G	B	T	E	X	MTBE	Oxy
MW-1	3/19/1997	8.25	42.74	<50	<50	<0.5	<0.5	<0.5	<0.5	23	--
<50.99>	6/23/1997	9.1	41.89	420	1,300	150	2.1	12	19	14	--
	10/8/1997	9.95	41.04	66	56	2.8	<0.5	<0.5	<0.5	5.8	--
	1/16/1998	7.57	43.42	910	1,500	95	0.72	69	8.4	<33	--
	8/5/1999	10.16	40.83	63	160	1.6	<0.5	0.56	1.1	<15	--
	11/18/1999	8.52	42.47	<50	79	<0.5	<0.5	<0.5	<0.5	<5.0	--
	2/24/2000	7.65	43.34	160	300	14	0.82	3.5	1.6	<5.0	--
	5/24/2000	8.47	42.52	480	1,300	93	<0.5	17	1.6	<10	--
	8/29/2000	10.28	40.71	<0.5	120	0.93	<0.5	<0.5	<0.5	<5.0	--
	1/12/2001	8.5	42.49	170	360	16	<0.5	9.3	0.69	<5.0	--
	4/18/2001	8.77	42.22	410	1,100	63	<0.5	34	0.73	2,800	--
	7/27/2001	10.5	40.49	66	130	1.6	<0.5	<0.5	<0.5	<5.0	--
	11/6/2001	10.28	40.71	<50	<50	<0.5	<0.5	<0.5	<0.5	<5.0	--
	2/13/2002	8.47	42.52	270	430	17	0.51	11	0.64	<5.0	--
	5/14/2002	9.5	41.49	170	340	21	<0.5	5.3	0.67	<5.0	--
	8/15/2002	10.39	40.60	53	96	0.66	<0.5	<0.5	<0.5	<5.0	--
	11/14/2002	9.08	41.91	<50	<50	<0.5	<0.5	<0.5	<0.5	<5.0	--
	2/12/2003	8.36	42.63	120	710	28	4.3	32	130	<5.0	--
	5/16/2003	8.49	42.50	340	1,100	54	4.1	40	100	<15	--
	8/29/2003	9.91	41.08	280	1,200	46	5.1	55	230	<5.0	--
	12/2/2003	8.88	42.11	<50	<50	<0.5	<0.5	<0.5	<0.5	<5.0	--
	3/8/2004	7.66	43.33	240	120	2.9	<0.5	<0.5	0.71	<5.0	--
	6/8/2004	9.39	41.60	782	<50	<0.5	<0.5	<0.5	<0.5	<5.0	ND
	9/10/2004	9.95	41.04	<50	<50	<0.5	<0.5	<0.5	<0.5	<5.0	ND
	12/13/2004	6.94	44.05	150	240	11	<0.5	5.6	<0.5	<5.0	--
	3/11/2005	7.35	43.64	420	1,100	43	0.60	12	0.80	<40	--
	6/15/2005	7.35	43.64	220	440	26	<0.5	0.60	<0.5	<15	--
	9/8/2005	9.57	41.42	76	120	2.0	<0.5	<0.5	<0.5	<5.0	--
	12/1/2005	7.66	43.33	<50	<50	1.3	<0.5	0.74	<0.5	<5.0	--
	3/7/2006	7.32	43.67	150	590	29	0.89	4.4	1.1	<5.0	--
	6/5/2006	8.46	42.53	120	74	1.2	<0.5	<0.5	<0.5	<5.0	--
	9/18/2006	9.36	41.63	99	<50	<0.5	<0.5	<0.5	<0.5	<5.0	--
	1/3/2007	7.99	43.00	<50	78	1.4	<0.5	0.66	<0.5	<5.0	--
	06/12/2007	9.21	41.78	<500	88	9.2	<0.5	0.64	<1.0	3.8	ND
	09/12/2007	10.02	40.97	<500	410	5.1	<0.5	<0.5	<1.0	2.7	ND
	12/5/2007	8.68	42.31	1,100	2,300	96	<0.5	20	<1.0	6.2	ND
	03/04/2008	7.87	43.12	920	200	2.8	<0.5	<0.5	<1.0	3.2	ND
	05/22/2008	9.62	41.37	590	150	18	<0.5	<0.5	<1.0	<1.0	ND

Table 1
Groundwater Laboratory Analytical Results
 Fidelity Roof Co. UST Site

Well ID	Date	GW Depth	GW Elev.	Concentration, micrograms per liter (ug/l)							
				TPH-D	TPH-G	B	T	E	X	MTBE	Oxy
	09/10/2008	10.57	40.42	<50	110	<0.5	<0.5	<0.5	<1.0	<1.0	ND
	11/25/2008	9.77	41.22	63	<50	2.6	<0.5	<0.5	<1.0	<1.0	ND
	02/26/2009	7.06	43.93	<50	79	6.9	<0.5	0.95	<1.0	3.5	ND
	05/26/2009	9.03	41.96	72	220	10	<0.5	0.85	<1.0	6.4	ND
	11/18/2009	9.55	41.44	180	150	<0.5	<0.5	<0.5	<1.0	4.0	ND
MW-2	3/19/1997	8.4	42.09	<50	<50	<0.5	<0.5	<0.5	<0.5	65	--
<50.49>	6/23/1997	8.85	41.64	<50	<50	3.4	<0.5	<0.5	<0.5	70	--
	10/8/1997	9.8	40.69	<50	<50	<0.5	<0.5	<0.5	<0.5	90	--
	1/16/1998	5.28	45.21	<50	<50	<0.5	<0.5	<0.5	<0.5	65	--
	8/5/1999	9.32	41.17	<50	<50	<0.5	<0.5	<0.5	<0.5	600	--
	11/18/1999	10.2	40.29	<50	<50	<0.5	<0.5	<0.5	<0.5	370	--
	2/24/2000	7.03	43.46	<50	<50	<0.5	<0.5	<0.5	<0.5	880	--
	5/24/2000	8.01	42.48	62	<250	<0.5	<0.5	<0.5	<0.5	2,200	--
	8/29/2000	11.07	39.42	<50	<200	<0.5	<0.5	<0.5	<0.5	1,900	--
	1/12/2001	8.6	41.89	70	470	8.7	3.1	16	73	2,000	--
	4/18/2001	8.8	41.69	<50	<50	<0.5	<0.5	<0.5	<0.5	2,800	--
	7/27/2001	11.1	39.39	<50	<100	<0.5	<0.5	<0.5	<0.5	3,300	--
	11/6/2001	12.21	38.28	<50	<100	<0.5	<0.5	<0.5	<0.5	3,000	--
	2/13/2002	7.98	42.51	<50	54	<0.5	<0.5	<0.5	<0.5	3,200	--
	5/14/2002	10.48	40.01	<50	<150	4.8	<1.0	<1.0	<1.0	3,800	--
	8/15/2002	10.64	39.85	<50	<50	<0.5	<0.5	<0.5	<0.5	2,900	--
	11/14/2002	11.69	38.80	<50	<120	<1.0	<1.0	<1.0	<1.0	3,800	--
	2/12/2003	9.07	41.42	120	1,100	57	7.0	55	210	3,200	--
	5/16/2003	11.25	39.24	85	530	35	3.6	22	79	6,000	--
	8/29/2003	12.19	38.30	1200	2,400	39	5.8	77	320	4,800	--
	12/2/2003	10.96	39.53	<50	<100	<1.0	<1.0	<1.0	<1.0	3,300	--
	3/8/2004	8.41	42.08	<50	<250	<2.5	<2.5	<2.5	<2.5	4,300	ND
	6/8/2004	10.19	40.30	<50	<120	<1.2	<1.2	<1.2	<1.2	2,800	ND
	9/10/2004	10.84	39.65	<250	<250	<2.5	<2.5	<2.5	<2.5	4,100	--
	12/13/2004	8.41	42.08	<50	77	<0.5	0.83	<0.5	1.9	4,200	--
	3/11/2005	7.81	42.68	<50	120	14	<0.5	0.56	<0.5	4,900	--
	6/15/2005	7.81	42.68	<50	1,200	85	<5.0	<5.0	<5.0	12,000	--
	9/8/2005	11.58	38.91	<50	<500	<5.0	<5.0	<5.0	<5.0	8,600	--
	12/1/2005	9.03	41.46	<50	<500	<5.0	<5.0	<5.0	<5.0	12,000	--
	3/7/2006	7.78	42.71	<50	<500	44	<5.0	<5.0	<5.0	10,000	--
	6/5/2006	9.28	41.21	1,000	890	110	<5.0	<5.0	31	19,000	--
	9/18/2006	10.39	40.10	4,100	2,000,	<5.0	<5.0	<5.0	<5.0	8,900	--
	1/3/2007	8.79	41.70	600	1,500	150	<5.0	51	59	7,500	--

Table 1
Groundwater Laboratory Analytical Results
 Fidelity Roof Co. UST Site

Well ID	Date	GW Depth	GW Elev.	Concentration, micrograms per liter (ug/l)							
				TPH-D	TPH-G	B	T	E	X	MTBE	Oxy
	06/12/2007	9.90	40.59	1,700	2,600	230	1.3	110	37.8	8,100	6,900=TBA
	09/12/2007	10.75	39.74	740	2,600	9.1	<0.5	73	42.1	1,900	3,900=TBA
	12/5/2007	--	--	870	2,000	1.1	<0.5	34	15.66	660	2,700=TBA
	03/04/2008	8.01	42.48	700	1,400	150	<0.5	30	11	1,800	3,100=TBA
	05/22/2008	10.30	40.19	1,200	960	120	0.60	26	6.3	1,100	4,700=TBA
	09/10/2008	10.99	39.50	610	1,300	4.5	<0.5	23	7.0	240	3,100=TBA
	11/25/2008	10.49	40.00	750	4,200	<0.50	<0.5	23	5.88	<1.0	ND
	02/26/2009	6.47	44.02	420	1,000	<0.50	4.5	33	24.2	210	4,300=TBA
	05/26/2009	9.35	41.14	310	1,800	350	1.2	41	5.28	3,400	4,400=TBA
	11/18/2009	10.00	40.49	960	1,600	2.3	<0.5	15	<1.0	160	2,700=TBA
MW-3	3/19/1997	7.59	42.34	5,000	26,000	3,000	530	340	2,300	230	--
<49.93>	6/23/1997	9.98	39.95	7,000	25,000	4,400	120	540	1,500	270	--
	10/8/1997	8.36	41.57	5,100	17,000	4,400	47	280	410	<280	--
	1/16/1998	9.18	40.75	7,300	29,000	5,600	740	950	3,500	<360	--
	8/5/1999	10.56	39.37	5,100	31,000	5,400	150	1100	2,300	<200	--
	11/18/1999	10.92	39.01	49,000	74,000	8,100	5,000	2,100	8,100	<1,000	--
	2/24/2000	8.49	41.44	6,300	110,000	12,000	1,400	2,900	14,000	<200	--
	5/24/2000	8.42	41.51	26,000	87,000	13,000	1,900	2,900	14,000	<200	--
	8/29/2000	12	37.93	9,400	49,000	7,400	800	1,800	7,400	<200	--
	1/12/2001	10.5	39.43	21,000	69,000	8,600	980	2,600	11,000	<300	--
	4/18/2001	9.5	40.43	13,000	75,000	9,200	1,200	2,500	12,000	<500	--
	7/27/2001	11.61	38.32	85,000	75,000	8,700	1,100	2,600	12,000	<650	--
	11/6/2001	11.73	38.20	86,000	89,000	7,900	910	2,800	12,000	<200	--
	2/13/2002	9.36	40.57	13,000	85,000	8,500	830	2,600	11,000	<2,000	--
	5/14/2002	9	40.93	35,000	94,000	9,700	1,100	3,400	15,000	<1,000	--
	8/15/2002	11.72	38.21	9,700	37,000	5,200	430	1,800	5,900	<1,200	--
	11/14/2002	11.28	38.65	23,000	66,000	8,300	860	3,000	11,000	<1,200	--
	2/12/2003	10.17	39.76	8,400	61,000	6,800	500	2,400	9,800	<500	--
	5/16/2003	11.47	38.46	17,000	59,000	6,200	320	2,000	6,500	<500	--
	8/29/2003	11.92	38.01	100,000	78,000	6,800	440	2,900	11,000	<1,200	--
	12/2/2003	11.32	38.61	46,000	68,000	7,600	450	2,900	10,000	<1,000	--
	3/8/2004	10.49	39.44	160,000	79,000	7,700	570	300	13,000	<250	--
	6/8/2004	9.89	40.04	26,000	90,000	6,700	580	2,500	13,000	99	ND
	9/10/2004	11.54	38.39	Free Product		7,600*	540*	3,500*	14,000	<100	ND
	12/13/2004	8.91	41.02	Free Product = 0.05 ft, Not Sampled							
	3/11/2005	6.94	42.99	Free Product = 0.05 ft, Not Sampled							
	6/15/2005	6.99	42.94	Free Product = 0.12 ft, Not Sampled							

Table 1
Groundwater Laboratory Analytical Results
 Fidelity Roof Co. UST Site

Well ID	Date	GW Depth	GW Elev.	Concentration, micrograms per liter (ug/l)							
				TPH-D	TPH-G	B	T	E	X	MTBE	Oxy
	9/8/2005	10.61	39.32	Free Product = 0.64 ft, Not Sampled							
	12/1/2005	--	49.93	Free Product, Not Sampled							
	3/7/2006	5.26	44.67	Free Product = 0.95 ft, Not Sampled							
	6/5/2006	8.09	41.84	690,000	37,000	110	10	960	4,400	<100	--
	6/13/2006	8.99	40.94	28,000	41,000	350	24	1,100	4,600	<170	--
	9/18/2006	10.56	39.37	Free Product = 0.04 ft, Not Sampled							
	1/3/2007	8.84	41.09	Free Product = 0.28 ft, Not Sampled							
	06/12/2007	9.71	40.22	Free Product = 0.55 ft, Not Sampled							
	09/12/2007	10.82	39.11	Free Product = 0.73 ft, Not Sampled							
	12/5/2007			Well Abandoned November 27 2007							
MW-4	8/5/1999	8.79	40.18	<50	<50	<0.5	<0.5	<0.5	<0.5	37	--
<48.97>	11/18/1999	8.11	40.86	<50	<50	<0.5	<0.5	<0.5	<0.5	20	--
	2/24/2000	5.19	43.78	<50	<50	<0.5	<0.5	<0.5	<0.5	20	--
	5/24/2000	7.23	41.74	140	120	1.3	<0.5	<0.5	<0.5	31	--
	8/29/2000	9.04	39.93	<50	<50	<0.5	<0.5	<0.5	<0.5	22	--
	1/12/2001	6.4	42.57	81	<50	<0.5	<0.5	<0.5	<0.5	25	--
	4/18/2001	7.3	41.67	170	30	2.4	1.1	0.66	4.2	35	--
	7/27/2001	9.16	39.81	110	87	1.8	<0.5	2.0	10	26	--
	11/6/2001	9.03	39.94	59	200	4.5	1.0	5.2	24	21	--
	2/13/2002	6.6	42.37	91	<50	<0.5	<0.5	<0.5	<0.5	15	--
	5/14/2002	7.19	41.78	140	260	12	2.7	11	49	26	--
	8/15/2002	8.97	40.00	<50	<50	<0.5	<0.5	<0.5	<0.5	12	--
	11/14/2002	7.52	41.45	<50	<50	<0.5	<0.5	<0.5	<0.5	11	--
	2/12/2003	6.37	42.60	130	170	3.1	0.66	6.4	27	16	--
	5/16/2003	6.81	42.16	60	<50	<0.5	<0.5	<0.5	<0.5	23	--
	8/29/2003	8.56	40.41	120	610	16	2.7	30	130	10	--
	12/2/2003	6.02	42.95	<50	<50	<0.5	<0.5	<0.5	<0.5	7.7	--
	3/8/2004	5.75	43.22	<50	<50	<0.5	<0.5	<0.5	<0.5	10	--
	6/8/2004	8.19	40.78	<50	<50	<0.5	<0.5	<0.5	<0.5	11	--
	9/10/2004	8.84	40.13	<50	<50	<0.5	<0.5	<0.5	<0.5	10	--
	12/13/2004	5.75	43.22	<50	<50	<0.5	<0.5	<0.5	<0.5	16	--
	3/11/2005	5.26	43.71	<50	<50	<0.5	<0.5	<0.5	<0.5	16	--
	6/15/2005	5.26	43.71	<50	<50	<0.5	<0.5	<0.5	<0.5	15	ND
	9/8/2005	8.2	40.77	54	<50	<0.5	<0.5	<0.5	<0.5	8.2	ND
	12/1/2005	6.93	42.04	<50	<50	<0.5	<0.5	<0.5	<0.5	13	--
	3/7/2006	4.17	44.80	<50	<50	<0.5	<0.5	<0.5	<0.5	11	--
	6/5/2006	6.88	42.09	<50	<50	<0.5	<0.5	<0.5	<0.5	11	--
	9/18/2006	8.33	40.64	110	<50	<0.5	<0.5	<0.5	<0.5	10	--
	1/3/2007	6.57	42.40	<50	<50	<0.5	<0.5	<0.5	<0.5	7.9	--
	06/12/2007	8.01	40.96	<500	<50	<0.5	<0.5	<0.5	<0.5	8.3	ND

Table 1
Groundwater Laboratory Analytical Results
 Fidelity Roof Co. UST Site

Well ID	Date	GW Depth	GW Elev.	Concentration, micrograms per liter (ug/l)							
				TPH-D	TPH-G	B	T	E	X	MTBE	Oxy
AS-1	12/01/2005	8.11	42.24	--	<50	<0.5	0.81	<0.5	1.5	<5.0	--
<50.35>	01/03/2007	9.2	41.15	130	<50	<0.5	<0.5	<0.5	<0.5	98	--
	06/12/2007	--	--	--	--	--	--	--	--	--	--
	09/12/2007	--	--	--	--	--	--	--	--	--	--
	12/05/2007	--	--	--	--	--	--	--	--	--	--
Well Abandoned November 27 2007											
AS-2	12/01/2005	9.64	40.87	--	<50	<0.5	<0.5	<0.5	<0.5	<5.0	--
<50.51>	01/03/2007	10.8	39.71	910	<50	<0.5	<0.5	<0.5	<0.5	<5.0	--
	06/12/2007	--	--	--	--	--	--	--	--	--	--
	09/12/2007	--	--	--	--	--	--	--	--	--	--
	12/05/2007	--	--	--	--	--	--	--	--	--	--
Well Abandoned November 27 2007											
DP-1	12/01/2005	7.22	42.74	--	220	<0.5	2.8	<0.5	0.94	<5.0	--
<49.96>	03/07/2006	4.4	45.56	--	<50	<0.5	0.71	<0.5	1.1	<5.0	--
	06/13/2006	7.99	41.97	67	<50	<0.5	<0.5	<0.5	<0.5	<5.0	--
	01/03/2007	7.12	42.84	93	<50	<0.5	<0.5	<0.5	<0.5	<5.0	--
	06/13/2007	8.92	41.04	<500	<50	<0.5	<0.5	<0.5	<1.0	<1.0	ND
	09/12/2007	9.95	40.01	<50	100	<0.5	<0.5	<0.5	<1.0	<1.0	ND
	12/5/2007	9.98	39.98	<50	<50	<0.5	<0.5	<0.5	<1.0	<1.0	ND
	03/04/2008	6.49	43.47	<50	<50	<0.5	<0.5	<0.5	<1.0	<1.0	ND
	05/22/2008	9.73	40.23	<50	<50	<0.5	<0.5	<0.5	<1.0	<1.0	ND
	09/10/2008	10.51	39.45	<50	75	<0.5	<0.5	<0.5	<1.0	2.1	ND
	11/25/2008	9.83	40.13	<50	<50	<0.5	<0.5	<0.5	<1.0	<1.0	ND
	02/26/2009	5.66	44.30	<50	<50	<0.5	0.99	1.3	4.7	<1.0	ND
	05/29/2009	8.49	41.47	<50	<50	<0.5	<0.5	<0.5	<1.0	<1.0	ND
	11/18/2009	9.27	40.69	<50	<50	<0.5	<0.5	<0.5	<1.0	<1.0	ND
DP-2	12/01/2005	6.83	43.34	--	<50	<0.5	<0.5	<0.5	<0.5	59	--
<50.17>	03/07/2006	6.09	44.08	--	230	1.2	2.6	<0.5	1.2	<10	--
	06/13/2006	7.98	42.19	110	280	<0.5	1.2	<0.5	0.67	<5.0	--
	01/03/2007	7.45	42.72	77	170	<0.5	<0.5	<0.5	<0.5	<5.0	--
	06/13/2007	8.39	41.78	<500	75	<0.5	<0.5	<0.5	<1.0	<1.0	ND
	09/12/2007	9.84	40.33	<50	<50	<0.5	<0.5	<0.5	<1.0	<1.0	ND
	12/5/2007	9.57	40.60	<50	76	<0.5	<0.5	<0.5	<1.0	<1.0	ND
	03/04/2008	7.03	43.14	<50	60	<0.5	<0.5	<0.5	<1.0	<1.0	ND
	05/22/2008	10.27	39.90	<50	<50	<0.5	<0.5	<0.5	<1.0	<1.0	ND
	09/10/2008	10.52	39.65	<50	96	<0.5	<0.5	<0.5	<1.0	<1.0	ND
	11/25/2008	9.58	40.59	59	<50	<0.5	<0.5	<0.5	<1.0	<1.0	ND
	02/26/2009	6.18	43.99	<50	<50	<0.5	1.0	1.3	5.0	<1.0	ND
	05/26/2009	8.46	41.71	<50	<50	<0.5	<0.5	<0.5	<1.0	<1.0	ND
	11/18/2009	9.46	40.71	<50	85	<0.5	<0.5	<0.5	<1.0	<1.0	ND

Table 1
Groundwater Laboratory Analytical Results
 Fidelity Roof Co. UST Site

Well ID	Date	GW Depth	GW Elev.	Concentration, micrograms per liter (ug/l)							
				TPH-D	TPH-G	B	T	E	X	MTBE	Oxy
DP-3	12/01/2005	7.14	43.31	--	120	2.1	0.96	<0.5	0.78	140	--
<50.45>	03/07/2006	6.62	43.83	--	<50	<0.5	<0.5	<0.5	<0.5	260	--
	06/13/2006	9.34	41.11	88	220	0.57	0.83	<0.5	<0.5	67	--
	06/13/2006	10.53	39.92	110	78	<0.5	1.1	<0.5	0.98	45	--
	01/03/2007	8.92	41.53	150	<50	0.60	<0.5	<0.5	<0.5	<5.0	--
	06/13/2007	10.10	40.35	<500	<50	<0.5	<0.5	<0.5	<1.0	22	ND
	09/12/2007	10.87	39.58	<50	<50	<0.5	<0.5	<0.5	<1.0	36	ND
Well Abandoned November 27 2007											
DP-4	12/01/2005	8.43	42.42	ns	ns	ns	ns	ns	ns	ns	--
<50.85>	03/07/2006	7.19	43.66	--	2,400	570	3.2	38	0.94	310	--
	06/13/2006	8.71	42.14	250	1,100	210	2.0	9.2	1.2	330	--
	06/13/2006	9.56	41.29	210	810	190	1.4	11	0.98	190	--
	01/03/2007	8.33	42.52	260	1,500	210	4.1	11	0.54	200	--
	06/13/2007	9.39	41.46	<500	370	10	<0.5	2.2	<1.0	85	13=TBA
	09/12/2007	10.21	40.64	<500	660	33	<0.5	0.58	<1.0	62	14=TBA
Well Abandoned November 27 2007											
DP-5	12/01/2005	4.69	45.92	na	<50	<0.5	<0.5	<0.5	<0.5	<5.0	--
<50.61>	03/07/2006	2.33	48.28	na	<50	<0.5	<0.5	<0.5	<0.5	<5.0	--
	06/13/2006	5.03	45.58	140	<50	<0.5	<0.5	<0.5	<0.5	5.4	--
	01/03/2007	4.98	45.63	240	<50	<0.5	<0.5	<0.5	<0.5	5.5	--
	06/13/2007	4.33	46.28	<500	<50	<0.5	<0.5	<0.5	<1.0	<1.0	ND
	09/12/2007	4.96	45.65	<500	<50	<0.5	<0.5	<0.5	<1.0	<1.0	ND
Well Abandoned November 27 2007											
DP-6	12/01/2005	5.91	44.77	--	7,000	1000	7.8	860	230	<120	--
<50.68>	03/07/2006	7.11	43.57	--	6,500	850	5.9	650	350	<160	--
	06/13/2006	8.73	41.95	1,500	3,100	250	1.2	270	120	28	--
	09/18/2006	9.69	40.99	570	840	70	1.3	77	4.5	<10	--
	01/03/2007	7.98	42.70	1,700	2,400	270	3.9	160	30	21	--
	06/13/2007	8.43	42.25	1,100	1,900	310	0.51	200	26.9	15	ND
	09/12/2007	10.14	40.54	1,300	2,800	500	1.3	380	60	20	ND
Well Abandoned November 27 2007											

Notes:

ug/l= micrograms per liter

GW Elev = Groundwater mean sea level elevation.

TPH-D = Total Petroleum Hydrocarbons as diesel

TPH-G = Total Petroleum Hydrocarbons as gasoline

B = Benzene

T = Toluene

E = Ethylbenzene

X = Xylenes MTBE = Methyl Tertiary Butyl Ether

Oxy = Oxygenates (except MTBE), including Ter-Butanol (TBA), Di-isopropyl Ether (DIPE), Ethyl-t-butyl Ether (ETBE), and Tert-amyl Methyl Ether (TAME)

ND = Not detected above the expressed value

<50.99> = Top of casing mean sea level elevation (Morrow Surveying, 01/22/2007).

ATTACHMENT A
GROUNDWATER MONITORING FIELD DATA RECORDS

Ground Water Monitoring Field Sheet

Site Fidelity Roof

Project Number _____

Sampling Personnel ADG

Date 11/18/09

Weather Conditions SUN

Well ID MW-1

Casing Diameter (inches) 2"

Depth to Water (ft) 9.55'

Total Depth (ft) 21'

Water Column (ft) 11.45

One Well Volume (gal) _____

3X Well Volume (gal) 7

Notes:

One Well Volume is determined by multiplying "Water Column" by:

* 0.059 for 3/4 inch well, 0.17 for 2 inch well, 0.38 for 3 inch well, 0.66 for 4 inch well, 1.50 for 6 inch well

Field Methods (check appropriate box)

Activity	Bailer	Pump	Comments
<u>PURGE</u>		<u>X</u>	<u>12 V pump</u>

Field Parameters

Time	Volume Purged	Temp (Celsius)	E.C. (mS/cm)	D.O. (mg/L)	pH	ORP (mv)	Comments
<u>11:20</u>	<u>2</u>	<u>19.66</u>	<u>1811</u>	<u>14.25</u>	<u>6.57</u>	<u>178.5</u>	
<u>11:25</u>	<u>2</u>	<u>20.25</u>	<u>989</u>	<u>2.32</u>	<u>6.29</u>	<u>172.6</u>	
<u>11:30</u>	<u>3</u>	<u>20.19</u>	<u>1044</u>	<u>1.51</u>	<u>6.27</u>	<u>163.6</u>	

Sample Observations

Characteristic	None	Slight	Moderate	Strong	Comments
Color	<input checked="" type="checkbox"/>				
Odor	<input checked="" type="checkbox"/>				
Turbidity	<input checked="" type="checkbox"/>				
Sheen	<input checked="" type="checkbox"/>				
Floating Particles					
Precipitate					

Sample Time 11:30

Sampler's Signature 

Ground Water Monitoring Field Sheet

Site Fidelity Roof

Project Number _____

Sampling Personnel APK

Date 11/18/09

Weather Conditions SUN

Well ID MW-2

Casing Diameter (inches) 2"

Depth to Water (ft) 18.00

Total Depth (ft) 21'

Water Column (ft) 11.00

One Well Volume (gal) _____

3X Well Volume (gal) 7

Notes:

One Well Volume is determined by multiplying "Water Column" by:

* 0.059 for 1/4 inch well, 0.17 for 2 inch well, 0.38 for 3 inch well, 0.66 for 4 inch well, 1.50 for 6 inch well

Field Methods (check appropriate box)

Activity	Bailer	Pump	Comments
<u>PURGE</u>		<u>X</u>	<u>12 v pump</u>

Field Parameters

Time	Volume Purged	Temp (Celsius)	E.C. (mS/cm)	D.O. (mg/L)	pH	ORP (mv)	Comments
<u>2:20</u>	<u>1</u>	<u>21.32</u>	<u>1731</u>	<u>7.07</u>	<u>6.32</u>	<u>165.0</u>	
<u>2:25</u>	<u>2</u>	<u>21.05</u>	<u>1701</u>	<u>1.39</u>	<u>6.36</u>	<u>153.2</u>	
<u>2:30</u>	<u>3</u>	<u>21.47</u>	<u>1751</u>	<u>1.18</u>	<u>6.36</u>	<u>128.1</u>	

Sample Observations

Characteristic	None	Slight	Moderate	Strong	Comments
Color	<input checked="" type="checkbox"/>				
Odor			<input checked="" type="checkbox"/>	<input checked="" type="checkbox"/>	
Turbidity	<input checked="" type="checkbox"/>				
Sheen	<input checked="" type="checkbox"/>				
Floating Particles					
Precipitate					

Sample Time 2:30

Sampler's Signature APK

Ground Water Monitoring Field Sheet

Site Froelich Reef

Project Number _____

Sampling Personnel AJK

Date 11/18/09

Weather Conditions SUN

Well ID MW-4

Casing Diameter (inches) 2"

Depth to Water (ft) 8.20

Total Depth (ft) 21'

Water Column (ft) 12.80

One Well Volume (gal) _____

3X Well Volume (gal) 7

Notes:

One Well Volume is determined by multiplying "Water Column" by:

* 0.059 for 3/4 inch well, 0.17 for 2 inch well, 0.38 for 3 inch well, 0.66 for 4 inch well, 1.50 for 6 inch well

Field Methods (check appropriate box)

Activity	Bailer	Pump	Comments
<u>Probe</u>		<u>X</u>	<u>12 V pump</u>

Field Parameters

Time	Volume Purged	Temp (Celsius)	E.C. (mS/cm)	D.O. (mg/L)	pH	ORP (mv)	Comments
<u>12:50</u>	<u>2</u>	<u>21.25</u>	<u>1133</u>	<u>9.14</u>	<u>6.59</u>	<u>168.5</u>	
<u>11:55</u>	<u>2</u>	<u>22.33</u>	<u>881</u>	<u>3.62</u>	<u>6.38</u>	<u>149.6</u>	
<u>1:00</u>	<u>3</u>	<u>22.47</u>	<u>1828</u>	<u>2.36</u>	<u>6.30</u>	<u>146.5</u>	

Sample Observations

Characteristic	None	Slight	Moderate	Strong	Comments
Color	/				
Odor	/				
Turbidity	/				
Sheen	/				
Floating Particles					
Precipitate					

Sample Time 1:00

Sampler's Signature AJK

Ground Water Monitoring Field Sheet

Site Finding Roof

Project Number _____

Sampling Personnel ASH

Date 11/18/89

Weather Conditions SUN

Well ID MW-5

Casing Diameter (inches) 2"

Depth to Water (ft) 12.45'

Total Depth (ft) 21'

Water Column (ft) 12.55'

One Well Volume (gal) _____

3X Well Volume (gal) 6

Notes:

One Well Volume is determined by multiplying "Water Column" by:

* 0.059 for 3/4 inch well, 0.17 for 2 inch well, 0.38 for 3 inch well, 0.66 for 4 inch well, 1.50 for 6 inch well

Field Methods (check appropriate box)

Activity	Bailer	Pump	Comments
<u>Purge</u>		<u>x</u>	<u>12 V pump</u>

Field Parameters

Time	Volume Purged	Temp (Celsius)	E.C. (mS/cm)	D.O. (mg/L)	pH	ORP (mv)	Comments
<u>9:52</u>	<u>2</u>	<u>21.15</u>	<u>1321</u>	<u>13.24</u>	<u>6.56</u>	<u>168.7</u>	
<u>9:55</u>	<u>2</u>	<u>22.23</u>	<u>1327</u>	<u>5.27</u>	<u>6.49</u>	<u>165.2</u>	
<u>10:00</u>	<u>2</u>	<u>21.21</u>	<u>1323</u>	<u>4.60</u>	<u>6.53</u>	<u>165.4</u>	

Sample Observations

Characteristic	None	Slight	Moderate	Strong	Comments
Color	<u>/</u>				
Odor	<u>/</u>				
Turbidity	<u>/</u>				
Sheen	<u>/</u>				
Floating Particles					
Precipitate					

Sample Time 10:00

Sampler's Signature ASH

Ground Water Monitoring Field Sheet

Site Fidelity Roof

Project Number _____

Sampling Personnel AKS

Date 11/18/09

Weather Conditions SW

Well ID MW-6

Casing Diameter (inches) 2"

Depth to Water (ft) 12.11

Total Depth (ft) 20'5"

Water Column (ft) 12.39

One Well Volume (gal) _____

3X Well Volume (gal) 6

Notes:

One Well Volume is determined by multiplying "Water Column" by:

* 0.059 for ¾ inch well, 0.17 for 2 inch well, 0.38 for 3 inch well, 0.66 for 4 inch well, 1.50 for 6 inch well

Field Methods (check appropriate box)

Activity	Bailer	Pump	Comments
<u>PURNE</u>		<u>X</u>	<u>12' v pump</u>

Field Parameters

Time	Volume Purged	Temp (Celsius)	E.C. (mS/cm)	D.O. (mg/L)	pH	ORP (mv)	Comments
<u>8:52</u>	<u>2</u>	<u>21.76</u>	<u>1132</u> 1133	<u>4.81</u>	<u>5.84</u>	<u>183.5</u>	
<u>8:55</u>	<u>2</u>	<u>22.94</u>	<u>1132</u>	<u>2.42</u>	<u>5.96</u>	<u>178.6</u>	
<u>9:00</u>	<u>2</u>	<u>22.63</u>	<u>1122</u>	<u>6.01</u> <u>1.94</u>	<u>6.04</u>	<u>173.6</u>	

Sample Observations

Characteristic	None	Slight	Moderate	Strong	Comments
Color	<u>/</u>				
Odor	<u>/</u>				
Turbidity	<u>/</u>				
Sheen	<u>/</u>				
Floating Particles					
Precipitate					

Sample Time 9:00

Sampler's Signature [Signature]

Ground Water Monitoring Field Sheet

Site Frosting Road

Project Number _____

Sampling Personnel AJH

Date 11/18/04

Weather Conditions SUN

Well ID OP-1

Casing Diameter (inches) 3/4"

Depth to Water (ft) 9.22

Total Depth (ft) 16'

Water Column (ft) 6.73

One Well Volume (gal) _____

3X Well Volume (gal) _____

Notes:

One Well Volume is determined by multiplying "Water Column" by:

* 0.059 for 3/4 inch well, 0.17 for 2 inch well, 0.38 for 3 inch well, 0.66 for 4 inch well, 1.50 for 6 inch well

Field Methods (check appropriate box)

Activity	Bailer	Pump	Comments
<u>SAMPLE</u>	<u>x</u>		

Field Parameters

Time	Volume Purged	Temp (Celsius)	E.C. (mS/cm)	D.O. (mg/L)	pH	ORP (mv)	Comments

Sample Observations

Characteristic	None	Slight	Moderate	Strong	Comments
Color	<u>/</u>				
Odor	<u>/</u>				
Turbidity	<u>/</u>				
Sheen	<u>/</u>				
Floating Particles					
Precipitate					

Sample Time 3:30

Sampler's Signature AJH

Ground Water Monitoring Field Sheet

Site Fidelity Roof

Project Number _____

Sampling Personnel ADK

Date 11/18/05

Weather Conditions SW

Well ID DP-2

Casing Diameter (inches) 3/4"

Depth to Water (ft) 9.46

Total Depth (ft) 16'

Water Column (ft) 6.54

One Well Volume (gal) _____

3X Well Volume (gal) _____

Notes:
One Well Volume is determined by multiplying "Water Column" by:
* 0.059 for 3/4 inch well, 0.17 for 2 inch well, 0.38 for 3 inch well, 0.66 for 4 inch well, 1.50 for 6 inch well

Field Methods (check appropriate box)

Activity	Bailer	Pump	Comments
<u>SAMPLE</u>	<u>X</u>		

Field Parameters

Time	Volume Purged	Temp (Celsius)	E.C. (mS/cm)	D.O. (mg/L)	pH	ORP (mv)	Comments

Sample Observations

Characteristic	None	Slight	Moderate	Strong	Comments
Color	<u>/</u>				
Odor	<u>/</u>				
Turbidity	<u>/</u>				
Sheen	<u>/</u>				
Floating Particles					
Precipitate					

Sample Time 4:30

Sampler's Signature ADK

ATTACHMENT B
LABORATORY DATA REPORTS AND
CHAIN-OF-CUSTODY RECORDS



25712 Commercentre Drive
Lake Forest, California 92630
949.297.5020 Phone
949.297.5027 Fax

30 November 2009

Jim Gribi
Gribi Associates
1090 Adam Street, Suite K
Benicia, CA 94510
RE: Fidelity Roof

Enclosed are the results of analyses for samples received by the laboratory on 11/21/09 09:36. If you have any questions concerning this report, please feel free to contact me.

Sincerely,

John Shepler
Laboratory Director

SunStar Laboratories, Inc.
 3002 Dow Ave, Suite 212
 Tustin, CA 92780
 1-800-781-6777

Chain of Custody Record

Client: GRIBI ASSOCIATES
 Address: 1090 ADAMS STREET, SUITE K
 Phone: (707) 748-7743 Fax: (707) 748-7763
 Project Manager: JAMES GRIBI

Date: 11/19/09 Page: Of
 Project Name: ~~4-BENT #1~~ Fixability Roof
 Collector: AARON GARCIA Client Project #:
 Batch #: T901112 Proposal #:

Sample ID	Date Sampled	Time	Sample Type	Container Type	BTEX/TPH Gas/MTBE (8021B/M8015)	TPH as Gas (M8015)	TPH as Diesel (M8015)	TPH as Motor Oil (M8015)	TPH Gas/BTEX/MTBE (8260B)	5 Oxygenates/TPH Gas/BTEX (8260B)	7 Oxygenates/TPH Gas/BTEX (8260B)	5 Oxygenates (8260B)	Lead Scav (1,2 DCA & 1,2 EDB (8260B)	EPA 8260 (Full List)	Halogenated VOCs (8260B)	Laboratory ID #	Preservative	Comments	Total # of containers
	<u>11/19/09</u>		<u>Water</u>	<u>VDA</u>														STD. TAT <u>11-21-09</u>	<u>BC</u>
<u>MW-1</u>		<u>11:30</u>			<u>X</u>	<u>X</u>			<u>X</u>							<u>01</u>			<u>1</u>
<u>MW-2</u>		<u>7:30</u>			<u>X</u>	<u>X</u>			<u>X</u>							<u>02</u>			<u>1</u>
<u>MW-4</u>		<u>1:00</u>			<u>X</u>	<u>X</u>			<u>X</u>							<u>03</u>			<u>1</u>
<u>MW-5</u>		<u>12:00</u>			<u>X</u>	<u>X</u>			<u>X</u>							<u>04</u>			<u>1</u>
<u>MW-6</u>		<u>9:00</u>			<u>X</u>	<u>X</u>			<u>X</u>							<u>05</u>			<u>1</u>
<u>DP-1</u>		<u>3:30</u>			<u>X</u>	<u>X</u>			<u>X</u>							<u>06</u>			<u>1</u>
<u>DP-2</u>	<u>X</u>	<u>4:30</u>			<u>X</u>	<u>X</u>			<u>X</u>							<u>07</u>			<u>1</u>

Relinquished by: (signature) <u>[Signature]</u>	Date / Time <u>11/19/09 9:50</u>	Received by: (signature) <u>[Signature]</u>	Date / Time <u>11/20 11:15</u>	Total # of containers <u>28</u> Chain of Custody seals Y/N/NA <u>Y</u> Seals intact? Y/N/NA <u>Y</u> Received good condition/cold <u>1.8</u>	Notes <u>NEED FOR FILE</u>
Relinquished by: (signature) _____	Date / Time _____	Received by: (signature) _____	Date / Time _____		
Relinquished by: (signature) <u>GSC</u>	Date / Time <u>11-21-09 936</u>	Received by: (signature) <u>[Signature]</u>	Date / Time <u>11-21-09 936</u>		

Sample disposal Instructions: Disposal @ \$2.00 each _____ Return to client _____ Pickup _____

Turn around time: _____



25712 Commercentre Drive
Lake Forest, California 92630
949.297.5020 Phone
949.297.5027 Fax

Gribi Associates
1090 Adam Street, Suite K
Benicia CA, 94510

Project: Fidelity Roof
Project Number: 224-01-03
Project Manager: Jim Gribi

Reported:
11/30/09 14:44

ANALYTICAL REPORT FOR SAMPLES

Sample ID	Laboratory ID	Matrix	Date Sampled	Date Received
MW-1	T901112-01	Water	11/18/09 11:30	11/21/09 09:36
MW-2	T901112-02	Water	11/18/09 14:30	11/21/09 09:36
MW-4	T901112-03	Water	11/18/09 13:00	11/21/09 09:36
MW-5	T901112-04	Water	11/18/09 10:00	11/21/09 09:36
MW-6	T901112-05	Water	11/18/09 09:00	11/21/09 09:36
DP-1	T901112-06	Water	11/18/09 15:30	11/21/09 09:36
DP-2	T901112-07	Water	11/18/09 16:30	11/21/09 09:36

SunStar Laboratories, Inc.

The results in this report apply to the samples analyzed in accordance with the chain of custody document. This analytical report must be reproduced in its entirety.

John Shepler, Laboratory Director



25712 Commercentre Drive
 Lake Forest, California 92630
 949.297.5020 Phone
 949.297.5027 Fax

Gribi Associates 1090 Adam Street, Suite K Benicia CA, 94510	Project: Fidelity Roof Project Number: 224-01-03 Project Manager: Jim Gribi	Reported: 11/30/09 14:44
--	---	------------------------------------

MW-1
T901112-01 (Water)

Analyte	Result	Reporting Limit	Units	Dilution	Batch	Prepared	Analyzed	Method	Notes
---------	--------	-----------------	-------	----------	-------	----------	----------	--------	-------

SunStar Laboratories, Inc.

Purgeable Petroleum Hydrocarbons by EPA 8015C

C6-C12 (GRO)	150	50	ug/l	1	9112306	11/23/09	11/23/09	EPA 8015C	
<i>Surrogate: 4-Bromofluorobenzene</i>		98.9 %	72.6-146		"	"	"	"	

Extractable Petroleum Hydrocarbons by 8015C

Diesel Range Hydrocarbons	0.18	0.050	mg/l	1	9112307	11/23/09	11/23/09	EPA 8015C	
<i>Surrogate: p-Terphenyl</i>		91.6 %	65-135		"	"	"	"	

Volatile Organic Compounds by EPA Method 8260B

Benzene	ND	0.50	ug/l	1	9112304	11/23/09	11/23/09	EPA 8260B	
Toluene	ND	0.50	"	"	"	"	"	"	
Ethylbenzene	ND	0.50	"	"	"	"	"	"	
m,p-Xylene	ND	1.0	"	"	"	"	"	"	
o-Xylene	ND	0.50	"	"	"	"	"	"	
Tert-amyl methyl ether	ND	2.0	"	"	"	"	"	"	
Tert-butyl alcohol	ND	10	"	"	"	"	"	"	
Di-isopropyl ether	ND	2.0	"	"	"	"	"	"	
Ethyl tert-butyl ether	ND	2.0	"	"	"	"	"	"	
Methyl tert-butyl ether	4.0	1.0	"	"	"	"	"	"	
C6-C12 (GRO)	130	50	"	"	"	"	"	"	
<i>Surrogate: 4-Bromofluorobenzene</i>		98.0 %	77.1-110		"	"	"	"	
<i>Surrogate: Dibromofluoromethane</i>		108 %	66.3-111		"	"	"	"	
<i>Surrogate: Toluene-d8</i>		98.5 %	84.7-109		"	"	"	"	

SunStar Laboratories, Inc.

The results in this report apply to the samples analyzed in accordance with the chain of custody document. This analytical report must be reproduced in its entirety.

John Shepler, Laboratory Director

Gribi Associates 1090 Adam Street, Suite K Benicia CA, 94510	Project: Fidelity Roof Project Number: 224-01-03 Project Manager: Jim Gribi	Reported: 11/30/09 14:44
--	---	------------------------------------

**MW-2
T901112-02 (Water)**

Analyte	Result	Reporting Limit	Units	Dilution	Batch	Prepared	Analyzed	Method	Notes
---------	--------	-----------------	-------	----------	-------	----------	----------	--------	-------

SunStar Laboratories, Inc.

Purgeable Petroleum Hydrocarbons by EPA 8015C

C6-C12 (GRO)	1600	50	ug/l	1	9112306	11/23/09	11/23/09	EPA 8015C	
<i>Surrogate: 4-Bromofluorobenzene</i>		118 %	72.6-146		"	"	"	"	

Extractable Petroleum Hydrocarbons by 8015C

Diesel Range Hydrocarbons	0.96	0.050	mg/l	1	9112307	11/23/09	11/23/09	EPA 8015C	D-08
<i>Surrogate: p-Terphenyl</i>		105 %	65-135		"	"	"	"	

Volatile Organic Compounds by EPA Method 8260B

Benzene	2.3	0.50	ug/l	1	9112304	11/23/09	11/23/09	EPA 8260B	
Toluene	ND	0.50	"	"	"	"	"	"	
Ethylbenzene	15	0.50	"	"	"	"	"	"	
m,p-Xylene	ND	1.0	"	"	"	"	"	"	
o-Xylene	ND	0.50	"	"	"	"	"	"	
Tert-amyl methyl ether	ND	2.0	"	"	"	"	"	"	
Tert-butyl alcohol	2700	250	"	25	"	"	11/24/09	"	
Di-isopropyl ether	ND	2.0	"	1	"	"	11/23/09	"	
Ethyl tert-butyl ether	ND	2.0	"	"	"	"	"	"	
Methyl tert-butyl ether	160	25	"	25	"	"	11/24/09	"	
C6-C12 (GRO)	1100	50	"	1	"	"	11/23/09	"	
<i>Surrogate: 4-Bromofluorobenzene</i>		100 %	77.1-110		"	"	"	"	
<i>Surrogate: Dibromofluoromethane</i>		124 %	66.3-111		"	"	"	"	S-GC
<i>Surrogate: Toluene-d8</i>		103 %	84.7-109		"	"	"	"	

SunStar Laboratories, Inc.

The results in this report apply to the samples analyzed in accordance with the chain of custody document. This analytical report must be reproduced in its entirety.



John Shepler, Laboratory Director



25712 Commercentre Drive
 Lake Forest, California 92630
 949.297.5020 Phone
 949.297.5027 Fax

Gribi Associates 1090 Adam Street, Suite K Benicia CA, 94510	Project: Fidelity Roof Project Number: 224-01-03 Project Manager: Jim Gribi	Reported: 11/30/09 14:44
--	---	-----------------------------

MW-4
T901112-03 (Water)

Analyte	Result	Reporting Limit	Units	Dilution	Batch	Prepared	Analyzed	Method	Notes
---------	--------	-----------------	-------	----------	-------	----------	----------	--------	-------

SunStar Laboratories, Inc.

Purgeable Petroleum Hydrocarbons by EPA 8015C

C6-C12 (GRO)	ND	50	ug/l	1	9112306	11/23/09	11/23/09	EPA 8015C	
<i>Surrogate: 4-Bromofluorobenzene</i>		107 %	72.6-146		"	"	"	"	

Extractable Petroleum Hydrocarbons by 8015C

Diesel Range Hydrocarbons	0.31	0.050	mg/l	1	9112307	11/23/09	11/23/09	EPA 8015C	
<i>Surrogate: p-Terphenyl</i>		106 %	65-135		"	"	"	"	

Volatile Organic Compounds by EPA Method 8260B

Benzene	ND	0.50	ug/l	1	9112304	11/23/09	11/23/09	EPA 8260B	
Toluene	ND	0.50	"	"	"	"	"	"	
Ethylbenzene	ND	0.50	"	"	"	"	"	"	
m,p-Xylene	ND	1.0	"	"	"	"	"	"	
o-Xylene	ND	0.50	"	"	"	"	"	"	
Tert-amyl methyl ether	ND	2.0	"	"	"	"	"	"	
Tert-butyl alcohol	ND	10	"	"	"	"	"	"	
Di-isopropyl ether	ND	2.0	"	"	"	"	"	"	
Ethyl tert-butyl ether	ND	2.0	"	"	"	"	"	"	
Methyl tert-butyl ether	13	1.0	"	"	"	"	"	"	
C6-C12 (GRO)	ND	50	"	"	"	"	"	"	
<i>Surrogate: 4-Bromofluorobenzene</i>		95.6 %	77.1-110		"	"	"	"	
<i>Surrogate: Dibromofluoromethane</i>		122 %	66.3-111		"	"	"	"	S-GC
<i>Surrogate: Toluene-d8</i>		101 %	84.7-109		"	"	"	"	

SunStar Laboratories, Inc.

The results in this report apply to the samples analyzed in accordance with the chain of custody document. This analytical report must be reproduced in its entirety.

John Shepler, Laboratory Director



25712 Commercentre Drive
 Lake Forest, California 92630
 949.297.5020 Phone
 949.297.5027 Fax

Gribi Associates 1090 Adam Street, Suite K Benicia CA, 94510	Project: Fidelity Roof Project Number: 224-01-03 Project Manager: Jim Gribi	Reported: 11/30/09 14:44
--	---	-----------------------------

MW-5
T901112-04 (Water)

Analyte	Result	Reporting Limit	Units	Dilution	Batch	Prepared	Analyzed	Method	Notes
---------	--------	-----------------	-------	----------	-------	----------	----------	--------	-------

SunStar Laboratories, Inc.

Purgeable Petroleum Hydrocarbons by EPA 8015C

C6-C12 (GRO)	ND	50	ug/l	1	9112306	11/23/09	11/23/09	EPA 8015C	
<i>Surrogate: 4-Bromofluorobenzene</i>		<i>111 %</i>	<i>72.6-146</i>		<i>"</i>	<i>"</i>	<i>"</i>	<i>"</i>	

Extractable Petroleum Hydrocarbons by 8015C

Diesel Range Hydrocarbons	ND	0.050	mg/l	1	9112307	11/23/09	11/23/09	EPA 8015C	
<i>Surrogate: p-Terphenyl</i>		<i>84.9 %</i>	<i>65-135</i>		<i>"</i>	<i>"</i>	<i>"</i>	<i>"</i>	

Volatile Organic Compounds by EPA Method 8260B

Benzene	ND	0.50	ug/l	1	9112304	11/23/09	11/23/09	EPA 8260B	
Toluene	ND	0.50	"	"	"	"	"	"	
Ethylbenzene	ND	0.50	"	"	"	"	"	"	
m,p-Xylene	ND	1.0	"	"	"	"	"	"	
o-Xylene	ND	0.50	"	"	"	"	"	"	
Tert-amyl methyl ether	ND	2.0	"	"	"	"	"	"	
Tert-butyl alcohol	ND	10	"	"	"	"	"	"	
Di-isopropyl ether	ND	2.0	"	"	"	"	"	"	
Ethyl tert-butyl ether	ND	2.0	"	"	"	"	"	"	
Methyl tert-butyl ether	ND	1.0	"	"	"	"	"	"	
C6-C12 (GRO)	ND	50	"	"	"	"	"	"	
<i>Surrogate: 4-Bromofluorobenzene</i>		<i>98.4 %</i>	<i>77.1-110</i>		<i>"</i>	<i>"</i>	<i>"</i>	<i>"</i>	
<i>Surrogate: Dibromofluoromethane</i>		<i>126 %</i>	<i>66.3-111</i>		<i>"</i>	<i>"</i>	<i>"</i>	<i>"</i>	<i>S-GC</i>
<i>Surrogate: Toluene-d8</i>		<i>100 %</i>	<i>84.7-109</i>		<i>"</i>	<i>"</i>	<i>"</i>	<i>"</i>	

SunStar Laboratories, Inc.

The results in this report apply to the samples analyzed in accordance with the chain of custody document. This analytical report must be reproduced in its entirety.

John Shepler, Laboratory Director



25712 Commercentre Drive
 Lake Forest, California 92630
 949.297.5020 Phone
 949.297.5027 Fax

Gribi Associates 1090 Adam Street, Suite K Benicia CA, 94510	Project: Fidelity Roof Project Number: 224-01-03 Project Manager: Jim Gribi	Reported: 11/30/09 14:44
--	---	-----------------------------

MW-6
T901112-05 (Water)

Analyte	Result	Reporting Limit	Units	Dilution	Batch	Prepared	Analyzed	Method	Notes
---------	--------	-----------------	-------	----------	-------	----------	----------	--------	-------

SunStar Laboratories, Inc.

Purgeable Petroleum Hydrocarbons by EPA 8015C

C6-C12 (GRO)	ND	50	ug/l	1	9112306	11/23/09	11/23/09	EPA 8015C	
<i>Surrogate: 4-Bromofluorobenzene</i>		116 %	72.6-146		"	"	"	"	

Extractable Petroleum Hydrocarbons by 8015C

Diesel Range Hydrocarbons	ND	0.050	mg/l	1	9112307	11/23/09	11/23/09	EPA 8015C	
<i>Surrogate: p-Terphenyl</i>		110 %	65-135		"	"	"	"	

Volatile Organic Compounds by EPA Method 8260B

Benzene	ND	0.50	ug/l	1	9112304	11/23/09	11/23/09	EPA 8260B	
Toluene	ND	0.50	"	"	"	"	"	"	
Ethylbenzene	ND	0.50	"	"	"	"	"	"	
m,p-Xylene	ND	1.0	"	"	"	"	"	"	
o-Xylene	ND	0.50	"	"	"	"	"	"	
Tert-amyl methyl ether	ND	2.0	"	"	"	"	"	"	
Tert-butyl alcohol	ND	10	"	"	"	"	"	"	
Di-isopropyl ether	ND	2.0	"	"	"	"	"	"	
Ethyl tert-butyl ether	ND	2.0	"	"	"	"	"	"	
Methyl tert-butyl ether	62	1.0	"	"	"	"	"	"	
C6-C12 (GRO)	ND	50	"	"	"	"	"	"	
<i>Surrogate: 4-Bromofluorobenzene</i>		97.2 %	77.1-110		"	"	"	"	
<i>Surrogate: Dibromofluoromethane</i>		119 %	66.3-111		"	"	"	"	S-GC
<i>Surrogate: Toluene-d8</i>		100 %	84.7-109		"	"	"	"	

SunStar Laboratories, Inc.

The results in this report apply to the samples analyzed in accordance with the chain of custody document. This analytical report must be reproduced in its entirety.

John Shepler, Laboratory Director



25712 Commercentre Drive
 Lake Forest, California 92630
 949.297.5020 Phone
 949.297.5027 Fax

Gribi Associates 1090 Adam Street, Suite K Benicia CA, 94510	Project: Fidelity Roof Project Number: 224-01-03 Project Manager: Jim Gribi	Reported: 11/30/09 14:44
--	---	------------------------------------

DP-1
T901112-06 (Water)

Analyte	Result	Reporting Limit	Units	Dilution	Batch	Prepared	Analyzed	Method	Notes
---------	--------	-----------------	-------	----------	-------	----------	----------	--------	-------

SunStar Laboratories, Inc.

Purgeable Petroleum Hydrocarbons by EPA 8015C

C6-C12 (GRO)	ND	50	ug/l	1	9112306	11/23/09	11/23/09	EPA 8015C	
<i>Surrogate: 4-Bromofluorobenzene</i>		105 %	72.6-146		"	"	"	"	

Extractable Petroleum Hydrocarbons by 8015C

Diesel Range Hydrocarbons	ND	0.050	mg/l	1	9112307	11/23/09	11/23/09	EPA 8015C	
<i>Surrogate: p-Terphenyl</i>		98.8 %	65-135		"	"	"	"	

Volatile Organic Compounds by EPA Method 8260B

Benzene	ND	0.50	ug/l	1	9112304	11/23/09	11/23/09	EPA 8260B	
Toluene	ND	0.50	"	"	"	"	"	"	
Ethylbenzene	ND	0.50	"	"	"	"	"	"	
m,p-Xylene	ND	1.0	"	"	"	"	"	"	
o-Xylene	ND	0.50	"	"	"	"	"	"	
Tert-amyl methyl ether	ND	2.0	"	"	"	"	"	"	
Tert-butyl alcohol	ND	10	"	"	"	"	"	"	
Di-isopropyl ether	ND	2.0	"	"	"	"	"	"	
Ethyl tert-butyl ether	ND	2.0	"	"	"	"	"	"	
Methyl tert-butyl ether	ND	1.0	"	"	"	"	"	"	
C6-C12 (GRO)	ND	50	"	"	"	"	"	"	
<i>Surrogate: 4-Bromofluorobenzene</i>		97.5 %	77.1-110		"	"	"	"	
<i>Surrogate: Dibromofluoromethane</i>		127 %	66.3-111		"	"	"	"	S-GC
<i>Surrogate: Toluene-d8</i>		101 %	84.7-109		"	"	"	"	

SunStar Laboratories, Inc.

The results in this report apply to the samples analyzed in accordance with the chain of custody document. This analytical report must be reproduced in its entirety.

John Shepler, Laboratory Director

Gribi Associates 1090 Adam Street, Suite K Benicia CA, 94510	Project: Fidelity Roof Project Number: 224-01-03 Project Manager: Jim Gribi	Reported: 11/30/09 14:44
--	---	------------------------------------

**DP-2
T901112-07 (Water)**

Analyte	Result	Reporting Limit	Units	Dilution	Batch	Prepared	Analyzed	Method	Notes
---------	--------	-----------------	-------	----------	-------	----------	----------	--------	-------

SunStar Laboratories, Inc.

Purgeable Petroleum Hydrocarbons by EPA 8015C

C6-C12 (GRO)	85	50	ug/l	1	9112306	11/23/09	11/23/09	EPA 8015C	
<i>Surrogate: 4-Bromofluorobenzene</i>		108 %	72.6-146		"	"	"	"	

Extractable Petroleum Hydrocarbons by 8015C

Diesel Range Hydrocarbons	ND	0.050	mg/l	1	9112307	11/23/09	11/23/09	EPA 8015C	
<i>Surrogate: p-Terphenyl</i>		103 %	65-135		"	"	"	"	

Volatile Organic Compounds by EPA Method 8260B

Benzene	ND	0.50	ug/l	1	9112304	11/23/09	11/23/09	EPA 8260B	
Toluene	ND	0.50	"	"	"	"	"	"	
Ethylbenzene	ND	0.50	"	"	"	"	"	"	
m,p-Xylene	ND	1.0	"	"	"	"	"	"	
o-Xylene	ND	0.50	"	"	"	"	"	"	
Tert-amyl methyl ether	ND	2.0	"	"	"	"	"	"	
Tert-butyl alcohol	ND	10	"	"	"	"	"	"	
Di-isopropyl ether	ND	2.0	"	"	"	"	"	"	
Ethyl tert-butyl ether	ND	2.0	"	"	"	"	"	"	
Methyl tert-butyl ether	ND	1.0	"	"	"	"	"	"	
C6-C12 (GRO)	ND	50	"	"	"	"	"	"	
<i>Surrogate: 4-Bromofluorobenzene</i>		101 %	77.1-110		"	"	"	"	
<i>Surrogate: Dibromofluoromethane</i>		130 %	66.3-111		"	"	"	"	S-GC
<i>Surrogate: Toluene-d8</i>		99.2 %	84.7-109		"	"	"	"	

SunStar Laboratories, Inc.

The results in this report apply to the samples analyzed in accordance with the chain of custody document. This analytical report must be reproduced in its entirety.



John Shepler, Laboratory Director

Gribi Associates
1090 Adam Street, Suite K
Benicia CA, 94510

Project: Fidelity Roof
Project Number: 224-01-03
Project Manager: Jim Gribi

Reported:
11/30/09 14:44

Purgeable Petroleum Hydrocarbons by EPA 8015C - Quality Control
SunStar Laboratories, Inc.

Analyte	Result	Reporting Limit	Units	Spike Level	Source Result	%REC	%REC Limits	RPD	RPD Limit	Notes
---------	--------	-----------------	-------	-------------	---------------	------	-------------	-----	-----------	-------

Batch 9112306 - EPA 5030 GC

Blank (9112306-BLK1)

Prepared & Analyzed: 11/23/09

C6-C12 (GRO)	ND	50	ug/l							
<i>Surrogate: 4-Bromofluorobenzene</i>	204		"	200		102	72.6-146			

LCS (9112306-BS1)

Prepared & Analyzed: 11/23/09

C6-C12 (GRO)	6110	50	ug/l	5500		111	75-125			
<i>Surrogate: 4-Bromofluorobenzene</i>	221		"	200		111	72.6-146			

LCS Dup (9112306-BSD1)

Prepared & Analyzed: 11/23/09

C6-C12 (GRO)	6060	50	ug/l	5500		110	75-125	0.916	20	
<i>Surrogate: 4-Bromofluorobenzene</i>	198		"	200		98.8	72.6-146			

SunStar Laboratories, Inc.

The results in this report apply to the samples analyzed in accordance with the chain of custody document. This analytical report must be reproduced in its entirety.



John Shepler, Laboratory Director

Gribi Associates
1090 Adam Street, Suite K
Benicia CA, 94510

Project: Fidelity Roof
Project Number: 224-01-03
Project Manager: Jim Gribi

Reported:
11/30/09 14:44

Extractable Petroleum Hydrocarbons by 8015C - Quality Control

SunStar Laboratories, Inc.

Analyte	Result	Reporting Limit	Units	Spike Level	Source Result	%REC	%REC Limits	RPD	RPD Limit	Notes
---------	--------	-----------------	-------	-------------	---------------	------	-------------	-----	-----------	-------

Batch 9112307 - EPA 3510C GC

Blank (9112307-BLK1)

Prepared & Analyzed: 11/23/09

Diesel Range Hydrocarbons	ND	0.050	mg/l							
Surrogate: <i>p</i> -Terphenyl	3.51		"	4.00		87.7	65-135			

LCS (9112307-BS1)

Prepared & Analyzed: 11/23/09

Diesel Range Hydrocarbons	15.8	0.050	mg/l	20.0		79.0	75-125			
Surrogate: <i>p</i> -Terphenyl	3.18		"	4.00		79.5	65-135			

LCS Dup (9112307-BSD1)

Prepared & Analyzed: 11/23/09

Diesel Range Hydrocarbons	15.8	0.050	mg/l	20.0		79.1	75-125	0.0675	20	
Surrogate: <i>p</i> -Terphenyl	3.41		"	4.00		85.2	65-135			

SunStar Laboratories, Inc.

The results in this report apply to the samples analyzed in accordance with the chain of custody document. This analytical report must be reproduced in its entirety.



John Shepler, Laboratory Director



25712 Commercentre Drive
 Lake Forest, California 92630
 949.297.5020 Phone
 949.297.5027 Fax

Gribi Associates
 1090 Adam Street, Suite K
 Benicia CA, 94510

Project: Fidelity Roof
 Project Number: 224-01-03
 Project Manager: Jim Gribi

Reported:
 11/30/09 14:44

Volatile Organic Compounds by EPA Method 8260B - Quality Control

SunStar Laboratories, Inc.

Analyte	Result	Reporting Limit	Units	Spike Level	Source Result	%REC	%REC Limits	RPD	RPD Limit	Notes
---------	--------	-----------------	-------	-------------	---------------	------	-------------	-----	-----------	-------

Batch 9112304 - EPA 5030 GCMS

Blank (9112304-BLK1)

Prepared & Analyzed: 11/23/09

Benzene	ND	0.50	ug/l							
Toluene	ND	0.50	"							
Ethylbenzene	ND	0.50	"							
m,p-Xylene	ND	1.0	"							
o-Xylene	ND	0.50	"							
Tert-amyl methyl ether	ND	2.0	"							
Tert-butyl alcohol	ND	10	"							
Di-isopropyl ether	ND	2.0	"							
Ethyl tert-butyl ether	ND	2.0	"							
Methyl tert-butyl ether	ND	1.0	"							
C6-C12 (GRO)	ND	50	"							
Surrogate: 4-Bromofluorobenzene	7.72		"	8.00		96.5	77.1-110			
Surrogate: Dibromofluoromethane	8.80		"	8.00		110	66.3-111			
Surrogate: Toluene-d8	7.83		"	8.00		97.9	84.7-109			

LCS (9112304-BS1)

Prepared & Analyzed: 11/23/09

Benzene	21.3	0.50	ug/l	20.0		106	75-125			
Toluene	19.8	0.50	"	20.0		99.2	75-125			
Surrogate: 4-Bromofluorobenzene	7.34		"	8.00		91.8	77.1-110			
Surrogate: Dibromofluoromethane	8.12		"	8.00		102	66.3-111			
Surrogate: Toluene-d8	7.92		"	8.00		99.0	84.7-109			

LCS Dup (9112304-BSD1)

Prepared & Analyzed: 11/23/09

Benzene	22.2	0.50	ug/l	20.0		111	75-125	4.42	20	
Toluene	20.9	0.50	"	20.0		104	75-125	5.16	20	
Surrogate: 4-Bromofluorobenzene	8.28		"	8.00		104	77.1-110			
Surrogate: Dibromofluoromethane	8.61		"	8.00		108	66.3-111			
Surrogate: Toluene-d8	8.03		"	8.00		100	84.7-109			

SunStar Laboratories, Inc.

The results in this report apply to the samples analyzed in accordance with the chain of custody document. This analytical report must be reproduced in its entirety.

John Shepler, Laboratory Director

Gribi Associates
1090 Adam Street, Suite K
Benicia CA, 94510

Project: Fidelity Roof
Project Number: 224-01-03
Project Manager: Jim Gribi

Reported:
11/30/09 14:44

Notes and Definitions

S-GC Surrogate recovery outside of established control limits. The data was accepted based on valid recovery of the remaining surrogate(s).

D-08 Results in the diesel organics range are primarily due to overlap from a gasoline range product.

DET Analyte DETECTED

ND Analyte NOT DETECTED at or above the reporting limit

NR Not Reported

dry Sample results reported on a dry weight basis

RPD Relative Percent Difference

SunStar Laboratories, Inc.

The results in this report apply to the samples analyzed in accordance with the chain of custody document. This analytical report must be reproduced in its entirety.



John Shepler, Laboratory Director

ATTACHMENT C
HYDROCARBON TREND GRAPH FOR MW-2

MW-2 - TPH-G, Benzene & MTBE Concentrations versus Time

