



**RECEIVED**

1:56 pm, Nov 13, 2007

Alameda County  
Environmental Health

November 9, 2007

Alameda County Department of  
Environmental Health  
1131 Harbor Bay Parkway, 2<sup>nd</sup> Floor  
Alameda, CA 94502

Attention: Donna Drogos

Subject: Third Quarter 2007 Groundwater Monitoring Report  
1075 40<sup>th</sup> Street, Oakland, CA 94608  
ACDEH Site No. RO000186

Ladies and Gentlemen:

Gribi Associates is pleased to submit this Third Quarter 2007 Groundwater Monitoring Report on behalf of Fidelity Roof Company for the underground storage tank (UST) site located at 1075 40<sup>th</sup> Street in Oakland, California (see Figure 1 and Figure 2). This letter report documents the monitoring and sampling of 11 site wells on September 12, 2007.

#### **DESCRIPTION OF SAMPLING ACTIVITIES**

1. Gribi Associates personnel conducted groundwater monitoring and sampling activities for 11 of site wells (MW-1, MW-2, MW-4, MW-5, and MW-6; and DP-1 through DP-6) on September 12, 2007.
  - a. Free product thickness was also measured in well MW-3; groundwater was not sampled in this well.
  - b. Well VE-1 had insufficient water in the well to sample.
  - c. Wells AS-1 and AS-2 were not sampled.
2. Groundwater monitoring and sampling was conducted in accordance with California LUFT Field Manual, including the following:
  - a. measuring static water levels;
  - b. checking for presence of free-product;
  - c. and purging of approximately three well volumes while recording of temperature, pH, conductivity, and clarity.
3. Collected groundwater samples were placed in an ice-chilled cooler and submitted to a state-certified laboratory for analyses.
4. Copies of groundwater sampling field data sheets are provided as Attachment A.

## **RESULTS OF GROUNDWATER MONITORING**

### **Hydrologic Conditions**

1. Groundwater depths ranged from approximately 4.96 feet (DP-5) to 10.97 feet (DP-3).
2. Groundwater elevations ranged from 39.51 feet above means sea level (msl) (MW-6) to 45.65 feet msl (DP-5).
3. Groundwater flow direction is variable, generally trends to the northwest.
4. Groundwater elevations and groundwater contours are shown on Figure 3.

### **Laboratory Analytical Results**

1. Groundwater samples from the seven sampled wells were analyzed for the following parameters with standard method turn around time on results:
  - a. USEPA 8015M Total Petroleum Hydrocarbons as Gasoline (TPH-G) and Total Petroleum Hydrocarbons as Diesel (TPH-D)
  - b. USEPA 8021B Benzene, Toluene, Ethylbenzene, Xylenes (BTEX)
  - c. USEPA 8260B Oxygenates (TBA, MTBE, DIPE, ETBE, and TAME)
  - d. USEPA 6010 Total Lead
2. Groundwater hydrocarbon results for this monitoring event are summarized in Table 1.
3. Groundwater hydrocarbon results for this monitoring event are summarized on Figure 4.
4. The laboratory analytical data report and chain-of custody are provided as Attachment B.

## **CONCLUSIONS**

1. Results of this and previous monitoring events seem to indicate two distinct groundwater hydrocarbon plumes.
  - a. One is a primarily a groundwater MTBE plume that extends downgradient (northwest) from the former UST tank area
  - b. The second plume is primarily a non-MTBE, gasolines-range dissolved and free product groundwater hydrocarbon plume extending downgradient from the former fuel dispenser area.

## **PLANNED ACTIVITIES**

1. Gribi Associates plans to conduct: (1) a soil boring investigation in the former UST source area; and (2) Conduct source area excavation activities.
2. Gribi Associates will perform Fourth Quarter 2007 groundwater monitoring and sampling at the site.

Alameda County Department of  
Environmental Health  
November 9, 2007  
Page 3

We appreciate this opportunity to provide this report for your review. Please contact us if there are questions or if additional information is required.

Very truly yours,



Aaron J. Garcia  
Environmental Scientist

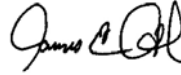

James E. Gribi  
Professional Geologist  
California No. 5843



Enclosure

cc: Mr. Monte Upshaw, Fidelity Roof Co.

M:\Projects\Active Projects\Fidelity Roofing\GWM\3rd Qtr 2007\Fidelity Roof 2nd Qtr 2007 Rpt.wpd

## FIGURES

TOPO! map printed on 04/03/07 from "California.tpo" and "Untitled.tpg"  
 122°18.000' W 122°17.000' W WGS84 122°16.000' W

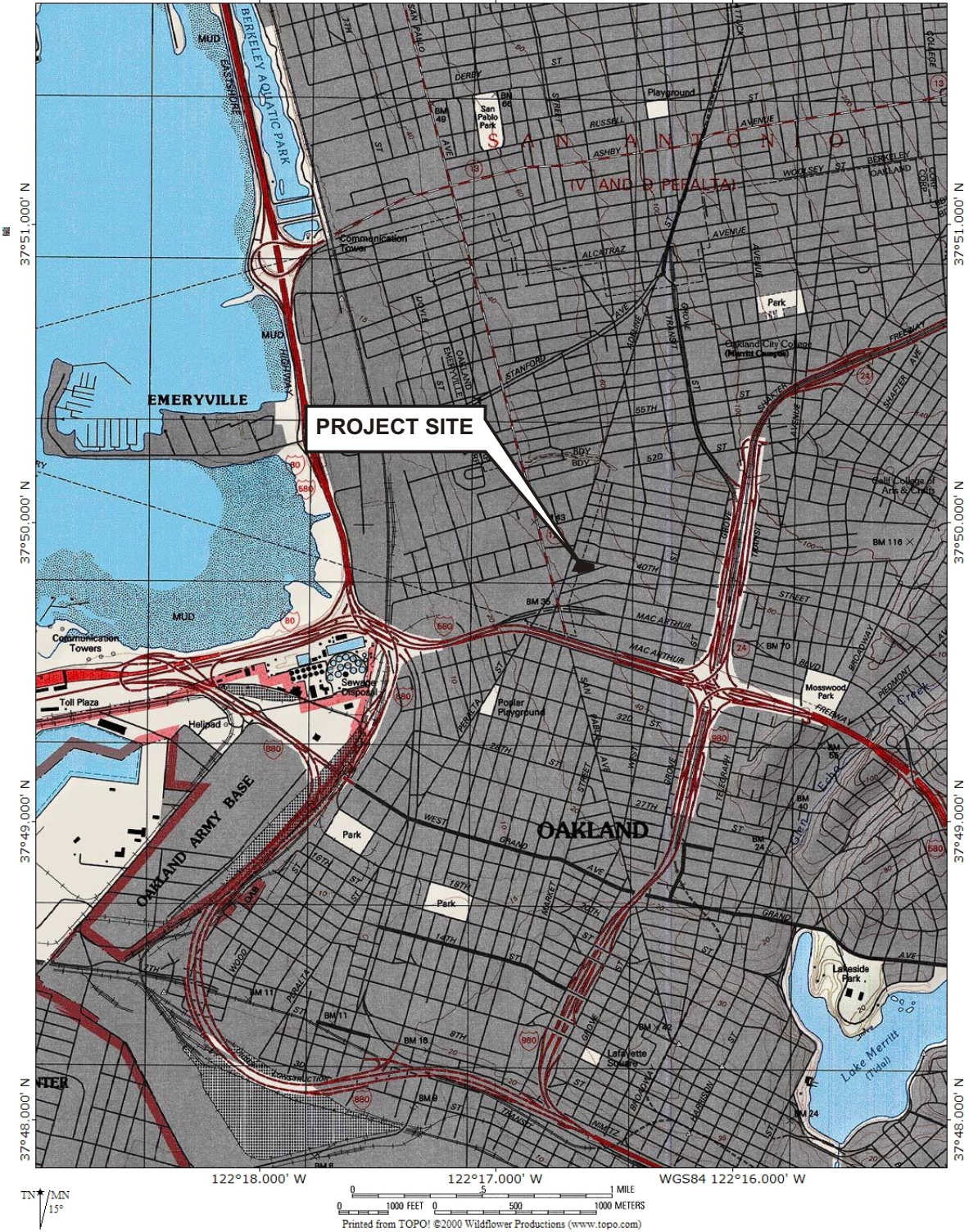

DESIGNED BY:	CHECKED BY:
DRAWN BY: JG	SCALE:
PROJECT NO: 330-01-01	

**SITE VICINITY MAP**

1075 40TH STREET  
OAKLAND, CALIFORNIA

DATE: 11/09/2007	FIGURE: 1
------------------	-----------



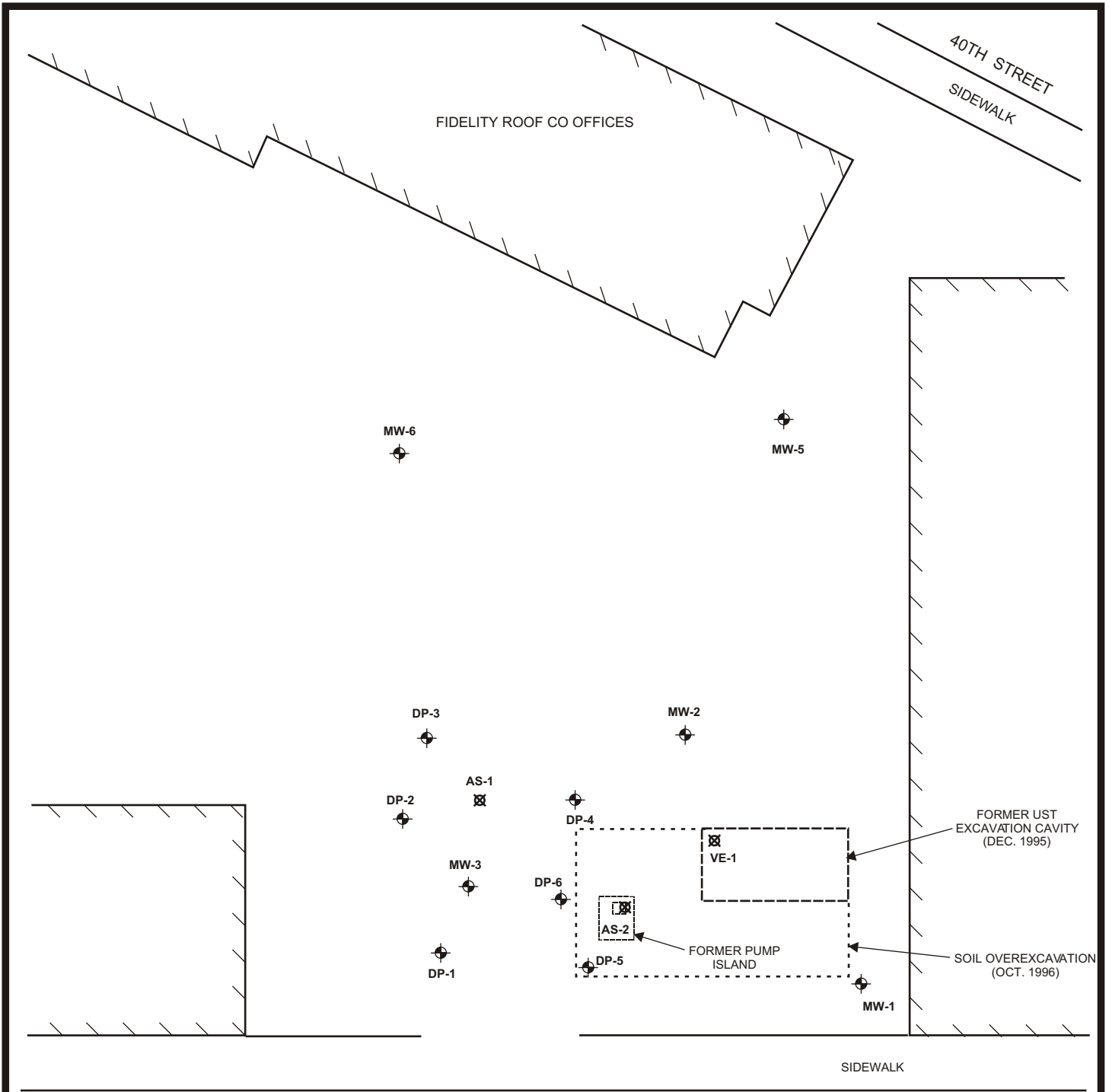

**LEGEND**

- REMEDIATION WELL  
 - GROUNDWATER MONITORING WELL

MW-4

YERBA BUENA AVENUE

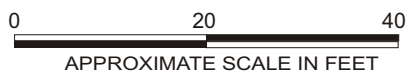

DESIGNED BY:	CHECKED BY:
DRAWN BY: JG	SCALE:
PROJECT NO: 330-01-01	

**SITE PLAN**

1075 40TH STREET  
OAKLAND, CALIFORNIA

DATE: 11/09/2007	FIGURE: <b>2</b>

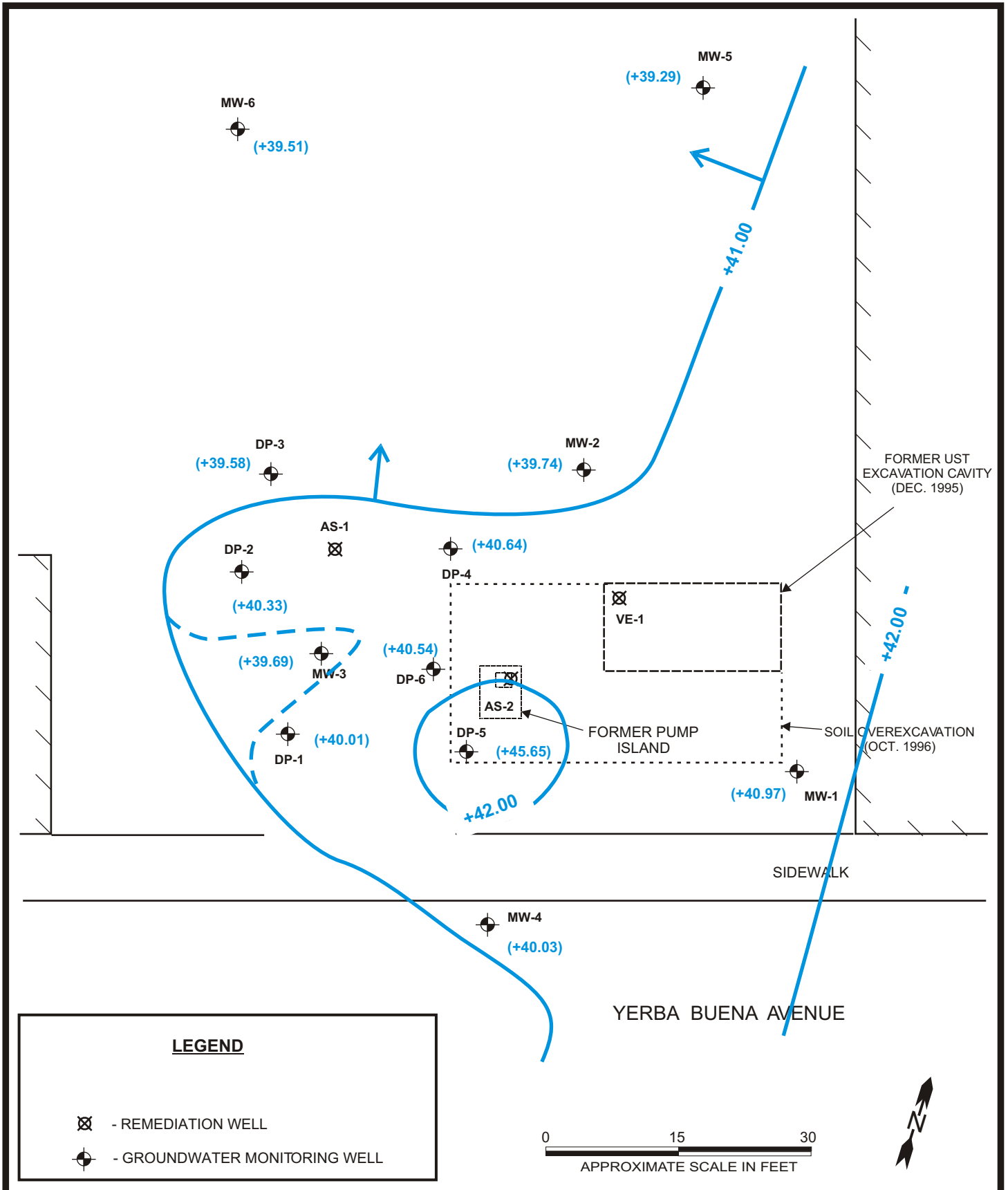

DESIGNED BY:	CHECKED BY:	<b>GROUNDWATER ELEVATIONS</b> 09/12/2007	DATE: 11/09/2007	FIGURE: 3
DRAWN BY: JG	SCALE:		<b>GRIBI</b>	
PROJECT NO: 330-01-01				

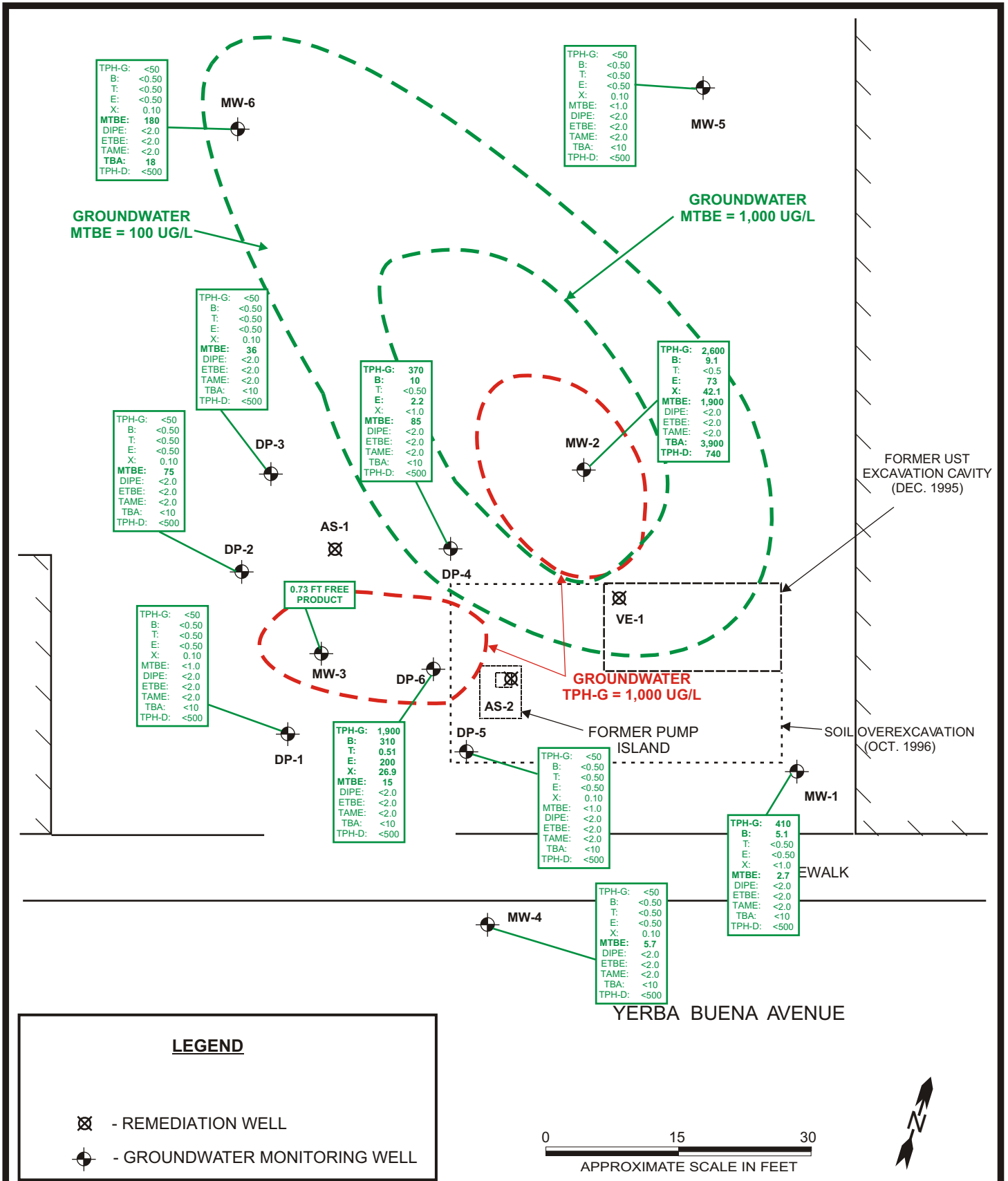

DESIGNED BY:	CHECKED BY:	<b>GROUNDWATER HYDROCARBON RESULTS - 09/12/2007</b>	DATE: 11/09/2007	FIGURE: 4
DRAWN BY: JG	SCALE:			
PROJECT NO: 330-01-01				



## TABLE

**Table 1**  
**Groundwater Laboratory Analytical Results**  
 Fidelity Roof Co. UST Site

Well ID	Date	GW Depth	GW Elev.	Concentration, micrograms per liter (ug/l)							
				TPH-D	TPH-G	B	T	E	X	MTBE	Oxy
MW-1	3/19/1997	8.25	42.74	<50	<50	<0.5	<0.5	<0.5	<0.5	23	--
<50.99>	6/23/1997	9.1	41.89	420	1,300	150	2.1	12	19	14	--
	10/8/1997	9.95	41.04	66	56	2.8	<0.5	<0.5	<0.5	5.8	--
	1/16/1998	7.57	43.42	910	1,500	95	0.72	69	8.4	<33	--
	8/5/1999	10.16	40.83	63	160	1.6	<0.5	0.56	1.1	<15	--
	11/18/1999	8.52	42.47	<50	79	<0.5	<0.5	<0.5	<0.5	<5.0	--
	2/24/2000	7.65	43.34	160	300	14	0.82	3.5	1.6	<5.0	--
	5/24/2000	8.47	42.52	480	1,300	93	<0.5	17	1.6	<10	--
	8/29/2000	10.28	40.71	<0.5	120	0.93	<0.5	<0.5	<0.5	<5.0	--
	1/12/2001	8.5	42.49	170	360	16	<0.5	9.3	0.69	<5.0	--
	4/18/2001	8.77	42.22	410	1,100	63	<0.5	34	0.73	2,800	--
	7/27/2001	10.5	40.49	66	130	1.6	<0.5	<0.5	<0.5	<5.0	--
	11/6/2001	10.28	40.71	<50	<50	<0.5	<0.5	<0.5	<0.5	<5.0	--
	2/13/2002	8.47	42.52	270	430	17	0.51	11	0.64	<5.0	--
	5/14/2002	9.5	41.49	170	340	21	<0.5	5.3	0.67	<5.0	--
	8/15/2002	10.39	40.60	53	96	0.66	<0.5	<0.5	<0.5	<5.0	--
	11/14/2002	9.08	41.91	<50	<50	<0.5	<0.5	<0.5	<0.5	<5.0	--
	2/12/2003	8.36	42.63	120	710	28	4.3	32	130	<5.0	--
	5/16/2003	8.49	42.50	340	1,100	54	4.1	40	100	<15	--
	8/29/2003	9.91	41.08	280	1,200	46	5.1	55	230	<5.0	--
	12/2/2003	8.88	42.11	<50	<50	<0.5	<0.5	<0.5	<0.5	<5.0	--
	3/8/2004	7.66	43.33	240	120	2.9	<0.5	<0.5	0.71	<5.0	--
	6/8/2004	9.39	41.60	782	<50	<0.5	<0.5	<0.5	<0.5	<5.0	ND
	9/10/2004	9.95	41.04	<50	<50	<0.5	<0.5	<0.5	<0.5	<5.0	ND
	12/13/2004	6.94	44.05	150	240	11	<0.5	5.6	<0.5	<5.0	--
	3/11/2005	7.35	43.64	420	1,100	43	0.60	12	0.80	<40	--
	6/15/2005	7.35	43.64	220	440	26	<0.5	0.60	<0.5	<15	--
	9/8/2005	9.57	41.42	76	120	2.0	<0.5	<0.5	<0.5	<5.0	--
	12/1/2005	7.66	43.33	<50	<50	1.3	<0.5	0.74	<0.5	<5.0	--
	3/7/2006	7.32	43.67	150	590	29	0.89	4.4	1.1	<5.0	--
	6/5/2006	8.46	42.53	120	74	1.2	<0.5	<0.5	<0.5	<5.0	--
	9/18/2006	9.36	41.63	99	<50	<0.5	<0.5	<0.5	<0.5	<5.0	--
	1/3/2007	7.99	43.00	<50	78	1.4	<0.5	0.66	<0.5	<5.0	--
	06/12/2007	9.21	41.78	<500	88	9.2	<0.5	0.64	<1.0	3.8	ND
	09/12/2007	10.02	40.97	<500	410	5.1	<0.5	<0.5	<1.0	2.7	ND

**Table 1**  
**Groundwater Laboratory Analytical Results**  
 Fidelity Roof Co. UST Site

Well ID	Date	GW Depth	GW Elev.	Concentration, micrograms per liter (ug/l)							
				TPH-D	TPH-G	B	T	E	X	MTBE	Oxy
MW-2	3/19/1997	8.4	42.09	<50	<50	<0.5	<0.5	<0.5	<0.5	65	--
<50.49>	6/23/1997	8.85	41.64	<50	<50	3.4	<0.5	<0.5	<0.5	70	--
	10/8/1997	9.8	40.69	<50	<50	<0.5	<0.5	<0.5	<0.5	90	--
	1/16/1998	5.28	45.21	<50	<50	<0.5	<0.5	<0.5	<0.5	65	--
	8/5/1999	9.32	41.17	<50	<50	<0.5	<0.5	<0.5	<0.5	600	--
	11/18/1999	10.2	40.29	<50	<50	<0.5	<0.5	<0.5	<0.5	370	--
	2/24/2000	7.03	43.46	<50	<50	<0.5	<0.5	<0.5	<0.5	880	--
	5/24/2000	8.01	42.48	62	<250	<0.5	<0.5	<0.5	<0.5	2,200	--
	8/29/2000	11.07	39.42	<50	<200	<0.5	<0.5	<0.5	<0.5	1,900	--
	1/12/2001	8.6	41.89	70	470	8.7	3.1	16	73	2,000	--
	4/18/2001	8.8	41.69	<50	<50	<0.5	<0.5	<0.5	<0.5	2,800	--
	7/27/2001	11.1	39.39	<50	<100	<0.5	<0.5	<0.5	<0.5	3,300	--
	11/6/2001	12.21	38.28	<50	<100	<0.5	<0.5	<0.5	<0.5	3,000	--
	2/13/2002	7.98	42.51	<50	54	<0.5	<0.5	<0.5	<0.5	3,200	--
	5/14/2002	10.48	40.01	<50	<150	4.8	<1.0	<1.0	<1.0	3,800	--
	8/15/2002	10.64	39.85	<50	<50	<0.5	<0.5	<0.5	<0.5	2,900	--
	11/14/2002	11.69	38.80	<50	<120	<1.0	<1.0	<1.0	<1.0	3,800	--
	2/12/2003	9.07	41.42	120	1,100	57	7.0	55	210	3,200	--
	5/16/2003	11.25	39.24	85	530	35	3.6	22	79	6,000	--
	8/29/2003	12.19	38.30	1200	2,400	39	5.8	77	320	4,800	--
	12/2/2003	10.96	39.53	<50	<100	<1.0	<1.0	<1.0	<1.0	3,300	--
	3/8/2004	8.41	42.08	<50	<250	<2.5	<2.5	<2.5	<2.5	4,300	ND
	6/8/2004	10.19	40.30	<50	<120	<1.2	<1.2	<1.2	<1.2	2,800	ND
	9/10/2004	10.84	39.65	<250	<250	<2.5	<2.5	<2.5	<2.5	4,100	--
	12/13/2004	8.41	42.08	<50	77	<0.5	0.83	<0.5	1.9	4,200	--
	3/11/2005	7.81	42.68	<50	120	14	<0.5	0.56	<0.5	4,900	--
	6/15/2005	7.81	42.68	<50	1,200	85	<5.0	<5.0	<5.0	12,000	--
	9/8/2005	11.58	38.91	<50	<500	<5.0	<5.0	<5.0	<5.0	8,600	--
	12/1/2005	9.03	41.46	<50	<500	<5.0	<5.0	<5.0	<5.0	12,000	--
	3/7/2006	7.78	42.71	<50	<500	44	<5.0	<5.0	<5.0	10,000	--
	6/5/2006	9.28	41.21	1,000	890	110	<5.0	<5.0	31	19,000	--
	9/18/2006	10.39	40.10	4,100	2,000,	<5.0	<5.0	<5.0	<5.0	8,900	--
	1/3/2007	8.79	41.70	600	1,500	150	<5.0	51	59	7,500	--
	06/12/2007	9.90	40.59	1,700	2,600	230	1.3	110	37.8	8,100	6,900=TBA
	09/12/2007	10.75	39.74	740	2,600	9.1	<0.5	73	42.1	1,900	3,900=TBA

**Table 1**  
**Groundwater Laboratory Analytical Results**  
 Fidelity Roof Co. UST Site

Well ID	Date	GW Depth	GW Elev.	Concentration, micrograms per liter (ug/l)								
				TPH-D	TPH-G	B	T	E	X	MTBE	Oxy	
MW-3	3/19/1997	7.59	42.34	5,000	26,000	3,000	530	340	2,300	230	--	
<49.93>	6/23/1997	9.98	39.95	7,000	25,000	4,400	120	540	1,500	270	--	
	10/8/1997	8.36	41.57	5,100	17,000	4,400	47	280	410	<280	--	
	1/16/1998	9.18	40.75	7,300	29,000	5,600	740	950	3,500	<360	--	
	8/5/1999	10.56	39.37	5,100	31,000	5,400	150	1100	2,300	<200	--	
	11/18/1999	10.92	39.01	49,000	74,000	8,100	5,000	2,100	8,100	<1,000	--	
	2/24/2000	8.49	41.44	6,300	110,000	12,000	1,400	2,900	14,000	<200	--	
	5/24/2000	8.42	41.51	26,000	87,000	13,000	1,900	2,900	14,000	<200	--	
	8/29/2000	12	37.93	9,400	49,000	7,400	800	1,800	7,400	<200	--	
	1/12/2001	10.5	39.43	21,000	69,000	8,600	980	2,600	11,000	<300	--	
	4/18/2001	9.5	40.43	13,000	75,000	9,200	1,200	2,500	12,000	<500	--	
	7/27/2001	11.61	38.32	85,000	75,000	8,700	1,100	2,600	12,000	<650	--	
	11/6/2001	11.73	38.20	86,000	89,000	7,900	910	2,800	12,000	<200	--	
	2/13/2002	9.36	40.57	13,000	85,000	8,500	830	2,600	11,000	<2,000	--	
	5/14/2002	9	40.93	35,000	94,000	9,700	1,100	3,400	15,000	<1,000	--	
	8/15/2002	11.72	38.21	9,700	37,000	5,200	430	1,800	5,900	<1,200	--	
	11/14/2002	11.28	38.65	23,000	66,000	8,300	860	3,000	11,000	<1,200	--	
	2/12/2003	10.17	39.76	8,400	61,000	6,800	500	2,400	9,800	<500	--	
	5/16/2003	11.47	38.46	17,000	59,000	6,200	320	2,000	6,500	<500	--	
	8/29/2003	11.92	38.01	100,000	78,000	6,800	440	2,900	11,000	<1,200	--	
	12/2/2003	11.32	38.61	46,000	68,000	7,600	450	2,900	10,000	<1,000	--	
	3/8/2004	10.49	39.44	160,000	79,000	7,700	570	300	13,000	<250	--	
	6/8/2004	9.89	40.04	26,000	90,000	6,700	580	2,500	13,000	99	ND	
	9/10/2004	11.54	38.39	Free Product		7,600*	540*	3,500*	14,000	<100	ND	
	12/13/2004	8.91	41.02	Free Product = 0.05 ft, Not Sampled								
	3/11/2005	6.94	42.99	Free Product = 0.05 ft, Not Sampled								
	6/15/2005	6.99	42.94	Free Product = 0.12 ft, Not Sampled								
	9/8/2005	10.61	39.32	Free Product = 0.64 ft, Not Sampled								
	12/1/2005	--	49.93	Free Product, Not Sampled								
3/7/2006	5.26	44.67	Free Product = 0.95 ft, Not Sampled									
6/5/2006	8.09	41.84	690,000	37,000	110	10	960	4,400	<100	--		
6/13/2006	8.99	40.94	28,000	41,000	350	24	1,100	4,600	<170	--		
9/18/2006	10.56	39.37	Free Product = 0.04 ft, Not Sampled									
1/3/2007	8.84	41.09	Free Product = 0.28 ft, Not Sampled									
06/12/2007	9.71	40.22	Free Product = 0.55 ft, Not Sampled									
09/12/2007	10.82	39.64 <sup>A</sup>	Free Product = 0.73 ft, Not Sampled									

**Table 1**  
**Groundwater Laboratory Analytical Results**  
 Fidelity Roof Co. UST Site

Well ID	Date	GW Depth	GW Elev.	Concentration, micrograms per liter (ug/l)							
				TPH-D	TPH-G	B	T	E	X	MTBE	Oxy
MW-4 <48.97>	8/5/1999	8.79	40.18	<50	<50	<0.5	<0.5	<0.5	<0.5	37	--
	11/18/1999	8.11	40.86	<50	<50	<0.5	<0.5	<0.5	<0.5	20	--
	2/24/2000	5.19	43.78	<50	<50	<0.5	<0.5	<0.5	<0.5	20	--
	5/24/2000	7.23	41.74	140	120	1.3	<0.5	<0.5	<0.5	31	--
	8/29/2000	9.04	39.93	<50	<50	<0.5	<0.5	<0.5	<0.5	22	--
	1/12/2001	6.4	42.57	81	<50	<0.5	<0.5	<0.5	<0.5	25	--
	4/18/2001	7.3	41.67	170	30	2.4	1.1	0.66	4.2	35	--
	7/27/2001	9.16	39.81	110	87	1.8	<0.5	2.0	10	26	--
	11/6/2001	9.03	39.94	59	200	4.5	1.0	5.2	24	21	--
	2/13/2002	6.6	42.37	91	<50	<0.5	<0.5	<0.5	<0.5	15	--
	5/14/2002	7.19	41.78	140	260	12	2.7	11	49	26	--
	8/15/2002	8.97	40.00	<50	<50	<0.5	<0.5	<0.5	<0.5	12	--
	11/14/2002	7.52	41.45	<50	<50	<0.5	<0.5	<0.5	<0.5	11	--
	2/12/2003	6.37	42.60	130	170	3.1	0.66	6.4	27	16	--
	5/16/2003	6.81	42.16	60	<50	<0.5	<0.5	<0.5	<0.5	23	--
	8/29/2003	8.56	40.41	120	610	16	2.7	30	130	10	--
	12/2/2003	6.02	42.95	<50	<50	<0.5	<0.5	<0.5	<0.5	7.7	--
	3/8/2004	5.75	43.22	<50	<50	<0.5	<0.5	<0.5	<0.5	10	--
	6/8/2004	8.19	40.78	<50	<50	<0.5	<0.5	<0.5	<0.5	11	--
	9/10/2004	8.84	40.13	<50	<50	<0.5	<0.5	<0.5	<0.5	10	--
	12/13/2004	5.75	43.22	<50	<50	<0.5	<0.5	<0.5	<0.5	16	--
	3/11/2005	5.26	43.71	<50	<50	<0.5	<0.5	<0.5	<0.5	16	--
	6/15/2005	5.26	43.71	<50	<50	<0.5	<0.5	<0.5	<0.5	15	ND
	9/8/2005	8.2	40.77	54	<50	<0.5	<0.5	<0.5	<0.5	8.2	ND
12/1/2005	6.93	42.04	<50	<50	<0.5	<0.5	<0.5	<0.5	13	--	
3/7/2006	4.17	44.80	<50	<50	<0.5	<0.5	<0.5	<0.5	11	--	
6/5/2006	6.88	42.09	<50	<50	<0.5	<0.5	<0.5	<0.5	11	--	
9/18/2006	8.33	40.64	110	<50	<0.5	<0.5	<0.5	<0.5	10	--	
1/3/2007	6.57	42.40	<50	<50	<0.5	<0.5	<0.5	<0.5	7.9	--	
06/12/2007	8.01	40.96	<500	<50	<0.5	<0.5	<0.5	<0.5	8.3	ND	
09/12/2007	8.94	40.03	<500	<50	<0.5	<0.5	<0.5	<0.5	5.7	ND	
MW-5 <51.04>	01/03/2007	16.47	34.57	<50	<50	<0.5	<0.5	<0.5	<1.0	<1.0	--
	06/12/2007	10.12	40.92	<500	<50	<0.5	<0.5	<0.5	<1.0	<1.0	ND
	09/12/2007	11.75	39.29	<500	<50	<0.5	<0.5	<0.5	<1.0	<1.0	ND
MW-6 <50.34>	01/03/07	8.93	41.41	63	<50	<0.5	<0.5	<0.5	<1.0	<5.0	--
	06/12/2007	10.05	40.29	<500	<50	<0.5	<0.5	<0.5	<1.0	72	ND
	09/12/2007	10.83	39.51	<500	<50	<0.5	<0.5	<0.5	<1.0	180	18=TBA

**Table 1**  
**Groundwater Laboratory Analytical Results**  
 Fidelity Roof Co. UST Site

Well ID	Date	GW Depth	GW Elev.	Concentration, micrograms per liter (ug/l)							
				TPH-D	TPH-G	B	T	E	X	MTBE	Oxy
VE-1 <50.75>	12/01/05	5.19	45.56	540	140	26	13	4.5	15	250	--
	03/07/06	2.81	47.94	--	55	5.2	1.4	2.3	4.5	230	--
	06/05/06	5.37	45.38	490	180	30	4.6	5.8	8.2	410	--
	01/03/07	4.92	45.83	250	82	8.4	1.5	1.7	2.6	320	--
	06/12/07	--	--	--	--	--	--	--	--	--	--
	09/12/07	--	--	--	--	--	--	--	--	--	--
AS-1 <50.35>	12/01/05	8.11	42.24	--	<50	<0.5	0.81	<0.5	1.5	<5.0	--
	01/03/07	9.2	41.15	130	<50	<0.5	<0.5	<0.5	<0.5	98	--
	06/12/07	--	--	--	--	--	--	--	--	--	--
	09/12/07	--	--	--	--	--	--	--	--	--	--
AS-2 <50.51>	12/01/05	9.64	40.87	--	<50	<0.5	<0.5	<0.5	<0.5	<5.0	--
	01/03/07	10.8	39.71	910	<50	<0.5	<0.5	<0.5	<0.5	<5.0	--
	06/12/07	--	--	--	--	--	--	--	--	--	--
	09/12/07	--	--	--	--	--	--	--	--	--	--
DP-1 <49.96>	12/01/05	7.22	42.74	--	220	<0.5	2.8	<0.5	0.94	<5.0	--
	03/07/06	4.4	45.56	--	<50	<0.5	0.71	<0.5	1.1	<5.0	--
	06/13/06	7.99	41.97	67	<50	<0.5	<0.5	<0.5	<0.5	<5.0	--
	01/03/07	7.12	42.84	93	<50	<0.5	<0.5	<0.5	<0.5	<5.0	--
	06/13/07	8.92	41.04	<500	<50	<0.5	<0.5	<0.5	<1.0	<1.0	ND
	09/12/07	9.95	40.01	<50	100	<0.5	<0.5	<0.5	<1.0	<1.0	ND
DP-2 <50.17>	12/01/05	6.83	43.34	--	<50	<0.5	<0.5	<0.5	<0.5	59	--
	03/07/06	6.09	44.08	--	230	1.2	2.6	<0.5	1.2	<10	--
	06/13/06	7.98	42.19	110	280	<0.5	1.2	<0.5	0.67	<5.0	--
	01/03/07	7.45	42.72	77	170	<0.5	<0.5	<0.5	<0.5	<5.0	--
	06/13/07	8.39	41.78	<500	75	<0.5	<0.5	<0.5	<1.0	<1.0	ND
	09/12/07	9.84	40.33	<50	<50	<0.5	<0.5	<0.5	<1.0	<1.0	ND
DP-3 <50.45>	12/01/05	7.14	43.31	--	120	2.1	0.96	<0.5	0.78	140	--
	03/07/06	6.62	43.83	--	<50	<0.5	<0.5	<0.5	<0.5	260	--
	06/13/06	9.34	41.11	88	220	0.57	0.83	<0.5	<0.5	67	--
	09/18/06	10.53	39.92	110	78	<0.5	1.1	<0.5	0.98	45	--
	01/03/07	8.92	41.53	150	<50	0.60	<0.5	<0.5	<0.5	<5.0	--
	06/13/07	10.10	40.35	<500	<50	<0.5	<0.5	<0.5	<1.0	22	ND
	09/12/07	10.87	39.58	<50	<50	<0.5	<0.5	<0.5	<1.0	36	ND
DP-4 <50.85>	12/01/05	8.43	42.42	ns	ns	ns	ns	ns	ns	ns	--
	03/07/06	7.19	43.66	--	2,400	570	3.2	38	0.94	310	--
	06/13/06	8.71	42.14	250	1,100	210	2.0	9.2	1.2	330	--
	06/13/06	9.56	41.29	210	810	190	1.4	11	0.98	190	--
	01/03/07	8.33	42.52	260	1,500	210	4.1	11	0.54	200	--
	06/13/07	9.39	41.46	<500	370	10	<0.5	2.2	<1.0	85	13=TBA
	09/12/07	10.21	40.64	<500	660	33	<0.5	0.58	<1.0	62	14=TBA

**Table 1**  
**Groundwater Laboratory Analytical Results**  
 Fidelity Roof Co. UST Site

Well ID	Date	GW Depth	GW Elev.	Concentration, micrograms per liter (ug/l)								
				TPH-D	TPH-G	B	T	E	X	MTBE	Oxy	
DP-5 <50.61>	12/01/05	4.69	45.92	na	<50	<0.5	<0.5	<0.5	<0.5	<0.5	<5.0	--
	03/07/06	2.33	48.28	na	<50	<0.5	<0.5	<0.5	<0.5	<0.5	<5.0	--
	06/13/06	5.03	45.58	<b>140</b>	<50	<0.5	<0.5	<0.5	<0.5	<0.5	<b>5.4</b>	--
	01/03/07	4.98	45.63	<b>240</b>	<50	<0.5	<0.5	<0.5	<0.5	<0.5	<b>5.5</b>	--
	06/13/07	4.33	46.28	<500	<50	<0.5	<0.5	<0.5	<0.5	<1.0	<1.0	ND
	09/12/07	4.96	45.65	<500	<50	<0.5	<0.5	<0.5	<0.5	<1.0	<1.0	ND
DP-6 <50.68>	12/01/05	5.91	44.77	--	<b>7,000</b>	<b>1000</b>	<b>7.8</b>	<b>860</b>	<b>230</b>	<120	--	--
	03/07/06	7.11	43.57	--	<b>6,500</b>	<b>850</b>	<b>5.9</b>	<b>650</b>	<b>350</b>	<160	--	--
	06/13/06	8.73	41.95	<b>1,500</b>	<b>3,100</b>	<b>250</b>	<b>1.2</b>	<b>270</b>	<b>120</b>	<b>28</b>	--	--
	09/18/06	9.69	40.99	<b>570</b>	<b>840</b>	<b>70</b>	<b>1.3</b>	<b>77</b>	<b>4.5</b>	<10	--	--
	01/03/07	7.98	42.70	<b>1,700</b>	<b>2,400</b>	<b>270</b>	<b>3.9</b>	<b>160</b>	<b>30</b>	<b>21</b>	--	--
	06/13/07	8.43	42.25	<b>1,100</b>	<b>1,900</b>	<b>310</b>	<b>0.51</b>	<b>200</b>	<b>26.9</b>	<b>15</b>	ND	ND
	09/12/07	10.14	40.54	<b>1,300</b>	<b>2,800</b>	<b>500</b>	<b>1.3</b>	<b>380</b>	<b>60</b>	<b>20</b>	ND	ND

**Notes:**

ug/l= micrograms per liter

GW Elev = Groundwater mean sea level elevation.

TPH-D = Total Petroleum Hydrocarbons as diesel

TPH-G = Total Petroleum Hydrocarbons as gasoline

B = Benzene

T = Toluene

E = Ethylbenzene

X = Xylenes

MTBE = Methyl Tertiary Butyl Ether

Oxy = Oxygenates (except MTBE), including Ter-Butanol (TBA), Di-isopropyl Ether (DIPE), Ethyl-t-butyl Ether (ETBE), and Tert-amyl Methyl Ether (TAME)

ND = Not detected above the expressed value

<50.99> = Top of casing mean sea level elevation (Morrow Surveying, 01/22/2007).

A = Groundwater elevation corrected for free product, using product density of 0.80.

**ATTACHMENT A**  
**GROUNDWATER MONITORING FIELD DATA RECORDS**



Ground Water Monitoring Field Sheet

Site Frostling Roof

Project Number \_\_\_\_\_

Sampling Personnel ASZ

Date 9/21/07

Weather Conditions Overcast

Well ID MW-1

Casing Diameter (inches) 2"

Depth to Water (ft) 10.02

Total Depth (ft) 21

Water Column (ft) 10.98

One Well Volume (gal) \_\_\_\_\_

3X Well Volume (gal) \_\_\_\_\_

Notes:

One Well Volume is determined by multiplying "Water Column" by:

\* 0.059 for 3/4 inch well, 0.17 for 2 inch well, 0.38 for 3 inch well, 0.66 for 4 inch well, 1.50 for 6 inch well

Field Methods (check appropriate box)

Activity	Bailer	Pump	Comments
<u>GRAB SAMPLE</u>	<u>X</u>		<u>LITTLE TO NO ACCESS</u>

Field Parameters DID NOT RECORD

Time	Volume Purged	Temp (Celsius)	E.C. (mS/cm)	D.O. (mg/L)	pH	ORP (mv)	Comments
<del> </del>							
<del> </del>							
<del> </del>							
<del> </del>							

Sample Observations

Characteristic	None	Slight	Moderate	Strong	Comments
Color	<u>/</u>				
Odor			<u>/</u>		
Turbidity	<u>/</u>				
Sheen		<u>/</u>			
Floating Particles					
Precipitate					

Sample Time 10:05

Sampler's Signature ASZ

Ground Water Monitoring Field Sheet

Site Freezing Roof

Project Number \_\_\_\_\_

Sampling Personnel RJZ

Date 9/22/07

Weather Conditions overcast

Well ID DP-1

Casing Diameter (inches) 3/4"

Depth to Water (ft) 9.95

Total Depth (ft) 16

Water Column (ft) 6.05

One Well Volume (gal) \_\_\_\_\_

3X Well Volume (gal) \_\_\_\_\_

Notes:

One Well Volume is determined by multiplying "Water Column" by:

\* 0.059 for 3/4 inch well, 0.17 for 2 inch well, 0.38 for 3 inch well, 0.66 for 4 inch well, 1.50 for 6 inch well

Field Methods (check appropriate box)

Activity	Bailer	Pump	Comments
<u>Purge</u>		<u>X</u>	<u>Perist. Pump</u>

Field Parameters Did NOT Record

Time	Volume Purged	Temp (Celsius)	E.C. (mS/cm)	D.O. (mg/L)	pH	ORP (mv)	Comments

Sample Observations

Characteristic	None	Slight	Moderate	Strong	Comments
Color					
Odor					
Turbidity					
Sheen					
Floating Particles					
Precipitate					

Sample Time 1:00

Sampler's Signature Angie

Ground Water Monitoring Field Sheet

Site Fidelity Roof

Project Number \_\_\_\_\_

Sampling Personnel AJH

Date 5/10/07

Weather Conditions overcast

Well ID MW-2

Casing Diameter (inches) 2"

Depth to Water (ft) 10.75

Total Depth (ft) 21

Water Column (ft) 10.25

One Well Volume (gal) \_\_\_\_\_

3X Well Volume (gal) 6

Notes:

One Well Volume is determined by multiplying "Water Column" by:

\* 0.059 for 3/4 inch well, 0.17 for 2 inch well, 0.38 for 3 inch well, 0.66 for 4 inch well, 1.50 for 6 inch well

Field Methods (check appropriate box)

Activity	Bailer	Pump	Comments
<u>8 mls</u>		<u>X</u>	<u>12 v pump</u>

Field Parameters

Time	Volume Purged	Temp (Celsius)	E.C. (mS/cm)	D.O. (mg/L)	pH	ORP (mv)	Comments
<u>10:20</u>	<u>3</u>	<u>21.90</u>	<u>1.511</u>	<u>2.84</u>	<u>6.87</u>	<u>-158.5</u>	
<u>10:30</u>	<u>3</u>	<u>20.90</u>	<u>1.571</u>	<u>0.75</u>	<u>6.84</u>	<u>-155.4</u>	

Sample Observations

Characteristic	None	Slight	Moderate	Strong	Comments
Color	<input checked="" type="checkbox"/>				
Odor				<input checked="" type="checkbox"/>	
Turbidity	<input checked="" type="checkbox"/>				
Sheen		<input checked="" type="checkbox"/>			
Floating Particles					
Precipitate					

Sample Time 10:30

Sampler's Signature AJH

Ground Water Monitoring Field Sheet

Site Fidelity Roof

Project Number \_\_\_\_\_

Sampling Personnel NSZ

Date 5/12/07

Weather Conditions Overcast

Well ID DR-2

Casing Diameter (inches) 3/4"

Depth to Water (ft) 9.84

Total Depth (ft) 14

Water Column (ft) 6.16

One Well Volume (gal) \_\_\_\_\_

3X Well Volume (gal) \_\_\_\_\_

Notes:

One Well Volume is determined by multiplying "Water Column" by:

\* 0.059 for 3/4 inch well, 0.17 for 2 inch well, 0.38 for 3 inch well, 0.66 for 4 inch well, 1.50 for 6 inch well

Field Methods (check appropriate box)

Activity	Bailer	Pump	Comments
<u>Probe</u>		<u>X</u>	<u>Pass. Pump</u>

Field Parameters

Time	Volume Purged	Temp (Celsius)	E.C. (mS/cm)	D.O. (mg/L)	pH	ORP (mv)	Comments
<u>12:15</u>	<u>1</u>	<u>22.14</u>	<u>1.402</u>	<u>6.68</u>	<u>6.77</u>	<u>-55.7</u>	
			<u>-Water Only -</u>				

Sample Observations

Characteristic	None	Slight	Moderate	Strong	Comments
Color	<u>/</u>				
Odor	<u>/</u>				
Turbidity	<u>/</u>				
Sheen	<u>/</u>				
Floating Particles					
Precipitate					

Sample Time 12:15

Sampler's Signature [Signature]

Ground Water Monitoring Field Sheet

Site Fossilium Reef

Project Number \_\_\_\_\_

Sampling Personnel ASH

Date 9/12/07

Weather Conditions overcast

Well ID QR-3

Casing Diameter (inches) 3/4"

Depth to Water (ft) 12.87

Total Depth (ft) 16'

Water Column (ft) 5.13

One Well Volume (gal) \_\_\_\_\_

3X Well Volume (gal) 1

Notes:

One Well Volume is determined by multiplying "Water Column" by:

\* 0.059 for 3/4 inch well, 0.17 for 2 inch well, 0.38 for 3 inch well, 0.66 for 4 inch well, 1.50 for 6 inch well

Field Methods (check appropriate box)

Activity	Bailer	Pump	Comments
<u>Pushing</u>		<u>X</u>	<u>PARASS. QND</u>

Field Parameters DID NOT RECORD

Time	Volume Purged	Temp (Celsius)	E.C. (mS/cm)	D.O. (mg/L)	pH	ORP (mv)	Comments
							<u>NOT ENOUGH WATER TO RUN.</u>

Sample Observations

Characteristic	None	Slight	Moderate	Strong	Comments
Color	//				
Odor	//				
Turbidity	//				
Sheen	//				
Floating Particles					
Precipitate					

Sample Time 11:30

Sampler's Signature ASH

Ground Water Monitoring Field Sheet

Site Foxhollow Road

Project Number \_\_\_\_\_

Sampling Personnel ATK

Date 9/12/07

Weather Conditions Overcast

Well ID MW-4

Casing Diameter (inches) 2"

Depth to Water (ft) 8.94'

Total Depth (ft) 21'

Water Column (ft) 12.26'

One Well Volume (gal) \_\_\_\_\_

3X Well Volume (gal) 7

Notes:

One Well Volume is determined by multiplying "Water Column" by:

\* 0.059 for 1/4 inch well, 0.17 for 2 inch well, 0.38 for 3 inch well, 0.66 for 4 inch well, 1.50 for 6 inch well

Field Methods (check appropriate box)

Activity	Bailer	Pump	Comments
<u>PURGE</u>		<u>X</u>	<u>12 V pump</u>

Field Parameters

Time	Volume Purged	Temp (Celsius)	E.C. (mS/cm)	D.O. (mg/L)	pH	ORP (mv)	Comments
<u>4:55</u>	<u>4</u>	<u>22.52</u>	<u>0.895</u>	<u>3.41</u>	<u>6.82</u>	<u>543.3</u>	
<u>4:40</u>	<u>3</u>	<u>21.74</u>	<u>1.032</u>	<u>2.58</u>	<u>6.78</u>	<u>212.6</u>	

Sample Observations

Characteristic	None	Slight	Moderate	Strong	Comments
Color	<u>/</u>				
Odor	<u>/</u>				
Turbidity	<u>/</u>				
Sheen	<u>/</u>				
Floating Particles					
Precipitate					

Sample Time 4:40

Sampler's Signature [Signature]

10.09  
10.02

Ground Water Monitoring Field Sheet

Site Fireman Roof

Project Number \_\_\_\_\_

Sampling Personnel AS

Date 9/12/07

Weather Conditions overcast

Well ID MP-5

Casing Diameter (inches) 3/4"

Depth to Water (ft) 4.96

Total Depth (ft) 16

Water Column (ft) 11.04

One Well Volume (gal) \_\_\_\_\_

3X Well Volume (gal) 1

Notes:

One Well Volume is determined by multiplying "Water Column" by:

\* 0.059 for 3/4 inch well, 0.17 for 2 inch well, 0.38 for 3 inch well, 0.66 for 4 inch well, 1.50 for 6 inch well

Field Methods (check appropriate box)

Activity	Bailer	Pump	Comments
<u>probe</u>		<u>X</u>	<u>12 v mp</u>

Field Parameters

Time	Volume Purged	Temp (Celsius)	E.C. (mS/cm)	D.O. (mg/L)	pH	ORP (mv)	Comments
<u>1:48</u>	<u>2</u>	<u>24.61</u>	<u>0.577</u>	<u>3.49</u>	<u>7.25</u>	<u>-0.8</u>	
<u>1:50</u>	<u>2</u>	<u>24.84</u>	<u>0.581</u>	<u>0.44</u>	<u>7.4</u>	<u>23.2</u>	

Sample Observations

Characteristic	None	Slight	Moderate	Strong	Comments
Color	<u>/</u>				
Odor	<u>/</u>				
Turbidity	<u>/</u>				
Sheen	<u>/</u>				
Floating Particles					
Precipitate					

Sample Time 1:50

Sampler's Signature [Signature]

Ground Water Monitoring Field Sheet

Site Fidelity Roof

Project Number \_\_\_\_\_

Sampling Personnel DJH

Date 9/12/07

Weather Conditions overcast

Well ID MV-5

Casing Diameter (inches) 2"

Depth to Water (ft) 11.75

Total Depth (ft) 20

Water Column (ft) 8.25

One Well Volume (gal) \_\_\_\_\_

3X Well Volume (gal) 5

Notes:

One Well Volume is determined by multiplying "Water Column" by:

\* 0.059 for 3/4 inch well, 0.17 for 2 inch well, 0.38 for 3 inch well, 0.66 for 4 inch well, 1.50 for 6 inch well

Field Methods (check appropriate box)

Activity	Bailer	Pump	Comments
<u>Pump</u>		<u>X</u>	<u>12 rpm</u>

Field Parameters

Time	Volume Purged	Temp (Celsius)	E.C. (mS/cm)	D.O. (mg/L)	pH	ORP (mv)	Comments
<u>9:35</u>	<u>2.5</u>	<u>21.5</u>	<u>1.248</u>	<u>5.23</u>	<u>7.12</u>	<u>225.4</u>	
<u>9:42</u>	<u>2.5</u>	<u>w/imp</u>	<u>imp</u>				

Sample Observations

Characteristic	None	Slight	Moderate	Strong	Comments
Color	<u>/</u>				
Odor	<u>/</u>				
Turbidity	<u>/</u>				
Sheen	<u>/</u>				
Floating Particles					
Precipitate					

Sample Time 9:42

Sampler's Signature AJH



Ground Water Monitoring Field Sheet

Site Fidelity Roof

Project Number \_\_\_\_\_

Sampling Personnel RJK

Date 9/12/87

Weather Conditions overcast

Well ID MW-6

Casing Diameter (inches) 2"

Depth to Water (ft) 12.83

Total Depth (ft) 22.5

Water Column (ft) 9.67

One Well Volume (gal) \_\_\_\_\_

3X Well Volume (gal) 6

Notes:

One Well Volume is determined by multiplying "Water Column" by:  
 \* 0.059 for 3/4 inch well, 0.17 for 2 inch well, 0.38 for 3 inch well, 0.66 for 4 inch well, 1.50 for 6 inch well

Field Methods (check appropriate box)

Activity	Bailer	Pump	Comments
<u>Probe</u>		<u>X</u>	<u>12 v pmp</u>

Field Parameters

Time	Volume Purged	Temp (Celsius)	E.C. (mS/cm)	D.O. (mg/L)	pH	ORP (mv)	Comments
<u>8:45</u>	<u>3</u>	<u>23.52</u>	<u>0.955</u>	<u>0.92</u>	<u>6.86</u>	<u>250.1</u>	
<u>8:50</u>	<u>7</u>	<u>21.82</u>	<u>0.964</u>	<u>0.33</u>	<u>6.88</u>	<u>241.4</u>	

Sample Observations

Characteristic	None	Slight	Moderate	Strong	Comments
Color	<u>/</u>				
Odor	<u>/</u>				
Turbidity	<u>/</u>				
Sheen	<u>/</u>				
Floating Particles					
Precipitate					

Sample Time 8:50

Sampler's Signature [Signature]

Ground Water Monitoring Field Sheet

Site Fidelity Roof

Project Number \_\_\_\_\_

Sampling Personnel DSL

Date 9/12/07

Weather Conditions overcast

Well ID DR-6

Casing Diameter (inches) 3/4"

Depth to Water (ft) 10.14

Total Depth (ft) 16

Water Column (ft) 5.84

One Well Volume (gal) \_\_\_\_\_

3X Well Volume (gal) \_\_\_\_\_

Notes:

One Well Volume is determined by multiplying "Water Column" by:

\* 0.059 for 1/4 inch well, 0.17 for 2 inch well, 0.38 for 3 inch well, 0.66 for 4 inch well, 1.50 for 6 inch well

Field Methods (check appropriate box)

Activity	Bailer	Pump	Comments
<u>probe</u>		<u>X</u>	<u>PARAST. Pump</u>

Field Parameters NO NOT RECORDED

Time	Volume Purged	Temp (Celsius)	E.C. (mS/cm)	D.O. (mg/L)	pH	ORP (mv)	Comments

Sample Observations

Characteristic	None	Slight	Moderate	Strong	Comments
Color	<u>/</u>				
Odor	<u>/</u>				
Turbidity	<u>/</u>				
Sheen					
Floating Particles					
Precipitate					

Sample Time 2:45

Sampler's Signature [Signature]

Ground Water Monitoring Field Sheet

Site F. Oakley Roof

Project Number \_\_\_\_\_

Sampling Personnel ADH

Date 9/12/07

Weather Conditions Overcast

Well ID OP-4

Casing Diameter (inches) 3/4"

Depth to Water (ft) 10.21

Total Depth (ft) \_\_\_\_\_

Water Column (ft) \_\_\_\_\_

One Well Volume (gal) \_\_\_\_\_

3X Well Volume (gal) \_\_\_\_\_

Notes:

One Well Volume is determined by multiplying "Water Column" by:

\* 0.059 for 3/4 inch well, 0.17 for 2 inch well, 0.38 for 3 inch well, 0.66 for 4 inch well, 1.50 for 6 inch well

Field Methods (check appropriate box)

Activity	Bailer	Pump	Comments

Field Parameters

Time	Volume Purged	Temp (Celsius)	E.C. (mS/cm)	D.O. (mg/L)	pH	ORP (mv)	Comments

Sample Observations

Characteristic	None	Slight	Moderate	Strong	Comments
Color					
Odor					
Turbidity					
Sheen					
Floating Particles					
Precipitate					

Sample Time \_\_\_\_\_

Sampler's Signature \_\_\_\_\_

**ATTACHMENT B**

**LABORATORY DATA REPORTS AND  
CHAIN-OF-CUSTODY RECORDS**

21 September 2007

Jim Gribi  
Gribi Associates  
1090 Adam Street, Suite K  
Benicia, CA 94510  
RE: Fidelity Roof

Enclosed are the results of analyses for samples received by the laboratory on 09/14/07 09:00. If you have any questions concerning this report, please feel free to contact me.

Sincerely,

A handwritten signature in cursive script that reads "Albert Vargas".

Albert Vargas For John Shepler  
Laboratory Director

SunStar Laboratories, Inc.  
 3002 Dow Ave, Suite 212  
 Tustin, CA 92780  
 1-800-781-6777

### Chain of Custody Record

Client: **GRI BI ASSOCIATES**  
 Address: **1090 ADAMS STREET, SUITE K**  
 Phone: **(707) 748-7743** Fax: **(707) 748-7763**  
 Project Manager: **JAMES GRIBI**

Date: **9/13/07** Page: **1** Of **1**  
 Project Name: **Fueling Roof**  
 Collector: **AARON GABRIA** Client Project #: **224-01-03**  
 Batch #: **T701185** Proposal #:

Sample ID	Date Sampled	Time	Sample Type	Container Type	BTEX (8021B)	BTEX/TPH Gas/MTBE (8021B/M8015)	TPH as Diesel (M8015)	TPH as Motor Oil (M8015)	TPH Gas/BTEX/MTBE (8260B)	5 Oxygenates/TPH Gas/BTEX (8260B)	7 Oxygenates/TPH Gas/BTEX (8260B)	5 Oxygenates (8260B)	Lead Scav. (1,2 DCA & 1,2 EDB (8260B)	EPA 8260 (Full List)	Halogenated VOCs (8260B)	Total Volatile Hydrocarbons	Laboratory ID # FILE:SYLC	Preservative	Comments	Total # of containers
MW-1	9/12/07		WATER	VDA		X	X										01			5
MW-2						X	X										02			5
MW-3						X	X										03			5
MW-4						X	X										04			5
MW-5						X	X										05			5
MW-6						X	X										06			5
DP-1						X	X										07			5
DP-2						X	X										08			5
DP-3						X	X										09			5
DP-4						X	X										10			5
DP-5						X	X										11			5
DP-6						X	X													5
Relinquished by: (signature) <i>[Signature]</i> Date / Time 9/13/07 3:15					Received by: (signature) <i>[Signature]</i> Date / Time 9/13/07 3:15 pm					Total # of containers 44					Notes					
Relinquished by: (signature) GSO Date / Time 9/14/07 09:00					Received by: (signature) <i>[Signature]</i> Date / Time 9/14/07 09:00					Chain of Custody seals N/A					NEED - EOP					
Relinquished by: (signature) Date / Time					Received by: (signature) Date / Time					Seals intact? N/A					FILE					
Relinquished by: (signature) Date / Time					Received by: (signature) Date / Time					Received good condition/cold 2.0										
Turn around time:																				

Sample disposal Instructions: Disposal @ \$2.00 each \_\_\_\_\_ Return to client \_\_\_\_\_ Pickup \_\_\_\_\_

Gribi Associates  
1090 Adam Street, Suite K  
Benicia CA, 94510

Project: Fidelity Roof  
Project Number: 224-01-03  
Project Manager: Jim Gribi

**Reported:**  
09/21/07 14:40

**ANALYTICAL REPORT FOR SAMPLES**

Sample ID	Laboratory ID	Matrix	Date Sampled	Date Received
MW-1	T701185-01	Water	09/12/07 00:00	09/14/07 09:00
MW-2	T701185-02	Water	09/12/07 00:00	09/14/07 09:00
MW-4	T701185-03	Water	09/12/07 00:00	09/14/07 09:00
MW-5	T701185-04	Water	09/12/07 00:00	09/14/07 09:00
MW-6	T701185-05	Water	09/12/07 00:00	09/14/07 09:00
DP-1	T701185-06	Water	09/12/07 00:00	09/14/07 09:00
DP-2	T701185-07	Water	09/12/07 00:00	09/14/07 09:00
DP-3	T701185-08	Water	09/12/07 00:00	09/14/07 09:00
DP-4	T701185-09	Water	09/12/07 00:00	09/14/07 09:00
DP-5	T701185-10	Water	09/12/07 00:00	09/14/07 09:00
DP-6	T701185-11	Water	09/12/07 00:00	09/14/07 09:00

SunStar Laboratories, Inc.

*The results in this report apply to the samples analyzed in accordance with the chain of custody document. This analytical report must be reproduced in its entirety.*



Albert Vargas For John Shepler, Laboratory Director

Gribi Associates  
 1090 Adam Street, Suite K  
 Benicia CA, 94510

Project: Fidelity Roof  
 Project Number: 224-01-03  
 Project Manager: Jim Gribi

**Reported:**  
 09/21/07 14:40

**MW-1**  
**T701185-01 (Water)**

Analyte	Result	Reporting Limit	Units	Dilution	Batch	Prepared	Analyzed	Method	Notes
<b>SunStar Laboratories, Inc.</b>									
<b>Purgeable Petroleum Hydrocarbons by EPA 8015m</b>									
<b>C6-C12 (GRO)</b>	<b>410</b>	50	ug/l	1	7091701	09/17/07	09/17/07	EPA 8015m	
<i>Surrogate: 4-Bromofluorobenzene</i>		93.3 %	65-135		"	"	"	"	
<b>Extractable Petroleum Hydrocarbons by 8015m</b>									
Diesel Range Hydrocarbons	ND	0.50	mg/l	1	7091703	09/17/07	09/18/07	EPA 8015m	
<i>Surrogate: p-Terphenyl</i>		113 %	65-135		"	"	"	"	
<b>Metals by EPA 6010B</b>									
Lead	ND	50	ug/l	1	7091705	09/17/07	09/21/07	EPA 6010B	
<b>Metals (Dissolved) by EPA 6000/7000 Series Methods</b>									
Lead	ND	50	ug/l	1	7091704	09/17/07	09/18/07	EPA 6010B	
<b>Volatile Organic Compounds by EPA Method 8260B</b>									
<b>Benzene</b>	<b>5.1</b>	0.50	ug/l	1	7091702	09/17/07	09/17/07	EPA 8260B	
Toluene	ND	0.50	"	"	"	"	"	"	
Ethylbenzene	ND	0.50	"	"	"	"	"	"	
m,p-Xylene	ND	1.0	"	"	"	"	"	"	
o-Xylene	ND	0.50	"	"	"	"	"	"	
Tert-amyl methyl ether	ND	2.0	"	"	"	"	"	"	
Tert-butyl alcohol	ND	10	"	"	"	"	"	"	
Di-isopropyl ether	ND	2.0	"	"	"	"	"	"	
Ethyl tert-butyl ether	ND	2.0	"	"	"	"	"	"	
<b>Methyl tert-butyl ether</b>	<b>2.7</b>	1.0	"	"	"	"	"	"	
<b>C6-C12 (GRO)</b>	<b>190</b>	50	"	"	"	"	"	"	
<i>Surrogate: 4-Bromofluorobenzene</i>		92.8 %	84-118		"	"	"	"	
<i>Surrogate: Dibromofluoromethane</i>		83.8 %	66-124		"	"	"	"	
<i>Surrogate: Toluene-d8</i>		102 %	85-115		"	"	"	"	

SunStar Laboratories, Inc.

*The results in this report apply to the samples analyzed in accordance with the chain of custody document. This analytical report must be reproduced in its entirety.*



Albert Vargas For John Shepler, Laboratory Director



Gribi Associates  
 1090 Adam Street, Suite K  
 Benicia CA, 94510

Project: Fidelity Roof  
 Project Number: 224-01-03  
 Project Manager: Jim Gribi

**Reported:**  
 09/21/07 14:40

**MW-2**  
**T701185-02 (Water)**

Analyte	Result	Reporting Limit	Units	Dilution	Batch	Prepared	Analyzed	Method	Notes
---------	--------	-----------------	-------	----------	-------	----------	----------	--------	-------

**SunStar Laboratories, Inc.**

**Purgeable Petroleum Hydrocarbons by EPA 8015m**

<b>C6-C12 (GRO)</b>	<b>2600</b>	50	ug/l	1	7091701	09/17/07	09/17/07	EPA 8015m	
<i>Surrogate: 4-Bromofluorobenzene</i>		102 %	65-135		"	"	"	"	

**Extractable Petroleum Hydrocarbons by 8015m**

<b>Diesel Range Hydrocarbons</b>	<b>0.74</b>	0.50	mg/l	1	7091703	09/17/07	09/18/07	EPA 8015m	D-02
<i>Surrogate: p-Terphenyl</i>		101 %	65-135		"	"	"	"	

**Metals by EPA 6010B**

Lead	ND	50	ug/l	1	7091705	09/17/07	09/21/07	EPA 6010B	
------	----	----	------	---	---------	----------	----------	-----------	--

**Metals (Dissolved) by EPA 6000/7000 Series Methods**

Lead	ND	50	ug/l	1	7091704	09/17/07	09/18/07	EPA 6010B	
------	----	----	------	---	---------	----------	----------	-----------	--

**Volatile Organic Compounds by EPA Method 8260B**

<b>Benzene</b>	<b>9.1</b>	0.50	ug/l	1	7091702	09/17/07	09/17/07	EPA 8260B	
Toluene	ND	0.50	"	"	"	"	"	"	
<b>Ethylbenzene</b>	<b>73</b>	0.50	"	"	"	"	"	"	
<b>m,p-Xylene</b>	<b>40</b>	1.0	"	"	"	"	"	"	
<b>o-Xylene</b>	<b>2.1</b>	0.50	"	"	"	"	"	"	
Tert-amyl methyl ether	ND	2.0	"	"	"	"	"	"	
<b>Tert-butyl alcohol</b>	<b>3900</b>	250	"	25	"	"	09/18/07	"	
Di-isopropyl ether	ND	2.0	"	1	"	"	09/17/07	"	
Ethyl tert-butyl ether	ND	2.0	"	"	"	"	"	"	
<b>Methyl tert-butyl ether</b>	<b>1900</b>	25	"	25	"	"	09/18/07	"	
<b>C6-C12 (GRO)</b>	<b>2300</b>	50	"	1	"	"	09/17/07	"	
<i>Surrogate: 4-Bromofluorobenzene</i>		105 %	84-118		"	"	"	"	
<i>Surrogate: Dibromofluoromethane</i>		80.6 %	66-124		"	"	"	"	
<i>Surrogate: Toluene-d8</i>		111 %	85-115		"	"	"	"	

SunStar Laboratories, Inc.

*The results in this report apply to the samples analyzed in accordance with the chain of custody document. This analytical report must be reproduced in its entirety.*



Albert Vargas For John Shepler, Laboratory Director

Gribi Associates  
 1090 Adam Street, Suite K  
 Benicia CA, 94510

Project: Fidelity Roof  
 Project Number: 224-01-03  
 Project Manager: Jim Gribi

**Reported:**  
 09/21/07 14:40

**MW-4**  
**T701185-03 (Water)**

Analyte	Result	Reporting Limit	Units	Dilution	Batch	Prepared	Analyzed	Method	Notes
---------	--------	-----------------	-------	----------	-------	----------	----------	--------	-------

**SunStar Laboratories, Inc.**

**Purgeable Petroleum Hydrocarbons by EPA 8015m**

C6-C12 (GRO)	ND	50	ug/l	1	7091701	09/17/07	09/17/07	EPA 8015m	
<i>Surrogate: 4-Bromofluorobenzene</i>		76.9 %	65-135		"	"	"	"	

**Extractable Petroleum Hydrocarbons by 8015m**

Diesel Range Hydrocarbons	ND	0.50	mg/l	1	7091703	09/17/07	09/18/07	EPA 8015m	
<i>Surrogate: p-Terphenyl</i>		106 %	65-135		"	"	"	"	

**Metals by EPA 6010B**

Lead	ND	50	ug/l	1	7091705	09/17/07	09/21/07	EPA 6010B	
------	----	----	------	---	---------	----------	----------	-----------	--

**Metals (Dissolved) by EPA 6000/7000 Series Methods**

Lead	ND	50	ug/l	1	7091704	09/17/07	09/18/07	EPA 6010B	
------	----	----	------	---	---------	----------	----------	-----------	--

**Volatile Organic Compounds by EPA Method 8260B**

Benzene	ND	0.50	ug/l	1	7091702	09/17/07	09/17/07	EPA 8260B	
Toluene	ND	0.50	"	"	"	"	"	"	
Ethylbenzene	ND	0.50	"	"	"	"	"	"	
m,p-Xylene	ND	1.0	"	"	"	"	"	"	
o-Xylene	ND	0.50	"	"	"	"	"	"	
Tert-amyl methyl ether	ND	2.0	"	"	"	"	"	"	
Tert-butyl alcohol	ND	10	"	"	"	"	"	"	
Di-isopropyl ether	ND	2.0	"	"	"	"	"	"	
Ethyl tert-butyl ether	ND	2.0	"	"	"	"	"	"	
<b>Methyl tert-butyl ether</b>	<b>5.7</b>	1.0	"	"	"	"	"	"	
C6-C12 (GRO)	ND	50	"	"	"	"	"	"	
<i>Surrogate: 4-Bromofluorobenzene</i>		90.5 %	84-118		"	"	"	"	
<i>Surrogate: Dibromofluoromethane</i>		81.4 %	66-124		"	"	"	"	
<i>Surrogate: Toluene-d8</i>		97.1 %	85-115		"	"	"	"	

SunStar Laboratories, Inc.

*The results in this report apply to the samples analyzed in accordance with the chain of custody document. This analytical report must be reproduced in its entirety.*



Albert Vargas For John Shepler, Laboratory Director

Gribi Associates  
 1090 Adam Street, Suite K  
 Benicia CA, 94510

Project: Fidelity Roof  
 Project Number: 224-01-03  
 Project Manager: Jim Gribi

**Reported:**  
 09/21/07 14:40

**MW-5**  
**T701185-04 (Water)**

Analyte	Result	Reporting Limit	Units	Dilution	Batch	Prepared	Analyzed	Method	Notes
---------	--------	-----------------	-------	----------	-------	----------	----------	--------	-------

**SunStar Laboratories, Inc.**

**Purgeable Petroleum Hydrocarbons by EPA 8015m**

C6-C12 (GRO)	ND	50	ug/l	1	7091701	09/17/07	09/17/07	EPA 8015m	
<i>Surrogate: 4-Bromofluorobenzene</i>		79.4 %	65-135		"	"	"	"	

**Extractable Petroleum Hydrocarbons by 8015m**

Diesel Range Hydrocarbons	ND	0.50	mg/l	1	7091703	09/17/07	09/18/07	EPA 8015m	
<i>Surrogate: p-Terphenyl</i>		105 %	65-135		"	"	"	"	

**Metals by EPA 6010B**

Lead	ND	50	ug/l	1	7091705	09/17/07	09/21/07	EPA 6010B	
------	----	----	------	---	---------	----------	----------	-----------	--

**Metals (Dissolved) by EPA 6000/7000 Series Methods**

Lead	ND	50	ug/l	1	7091704	09/17/07	09/18/07	EPA 6010B	
------	----	----	------	---	---------	----------	----------	-----------	--

**Volatile Organic Compounds by EPA Method 8260B**

Benzene	ND	0.50	ug/l	1	7091702	09/17/07	09/17/07	EPA 8260B	
Toluene	ND	0.50	"	"	"	"	"	"	
Ethylbenzene	ND	0.50	"	"	"	"	"	"	
m,p-Xylene	ND	1.0	"	"	"	"	"	"	
o-Xylene	ND	0.50	"	"	"	"	"	"	
Tert-amyl methyl ether	ND	2.0	"	"	"	"	"	"	
Tert-butyl alcohol	ND	10	"	"	"	"	"	"	
Di-isopropyl ether	ND	2.0	"	"	"	"	"	"	
Ethyl tert-butyl ether	ND	2.0	"	"	"	"	"	"	
Methyl tert-butyl ether	ND	1.0	"	"	"	"	"	"	
C6-C12 (GRO)	ND	50	"	"	"	"	"	"	
<i>Surrogate: 4-Bromofluorobenzene</i>		91.4 %	84-118		"	"	"	"	
<i>Surrogate: Dibromofluoromethane</i>		83.0 %	66-124		"	"	"	"	
<i>Surrogate: Toluene-d8</i>		97.1 %	85-115		"	"	"	"	

SunStar Laboratories, Inc.

*The results in this report apply to the samples analyzed in accordance with the chain of custody document. This analytical report must be reproduced in its entirety.*



Albert Vargas For John Shepler, Laboratory Director

Gribi Associates  
 1090 Adam Street, Suite K  
 Benicia CA, 94510

Project: Fidelity Roof  
 Project Number: 224-01-03  
 Project Manager: Jim Gribi

**Reported:**  
 09/21/07 14:40

**MW-6**  
**T701185-05 (Water)**

Analyte	Result	Reporting Limit	Units	Dilution	Batch	Prepared	Analyzed	Method	Notes
---------	--------	-----------------	-------	----------	-------	----------	----------	--------	-------

**SunStar Laboratories, Inc.**

**Purgeable Petroleum Hydrocarbons by EPA 8015m**

C6-C12 (GRO)	ND	50	ug/l	1	7091701	09/17/07	09/17/07	EPA 8015m	
<i>Surrogate: 4-Bromofluorobenzene</i>		77.3 %	65-135		"	"	"	"	

**Extractable Petroleum Hydrocarbons by 8015m**

Diesel Range Hydrocarbons	ND	0.50	mg/l	1	7091703	09/17/07	09/18/07	EPA 8015m	
<i>Surrogate: p-Terphenyl</i>		104 %	65-135		"	"	"	"	

**Metals by EPA 6010B**

<b>Lead</b>	<b>68</b>	50	ug/l	1	7091705	09/17/07	09/21/07	EPA 6010B	
-------------	-----------	----	------	---	---------	----------	----------	-----------	--

**Metals (Dissolved) by EPA 6000/7000 Series Methods**

Lead	ND	50	ug/l	1	7091704	09/17/07	09/18/07	EPA 6010B	
------	----	----	------	---	---------	----------	----------	-----------	--

**Volatile Organic Compounds by EPA Method 8260B**

Benzene	ND	0.50	ug/l	1	7091702	09/17/07	09/17/07	EPA 8260B	
Toluene	ND	0.50	"	"	"	"	"	"	
Ethylbenzene	ND	0.50	"	"	"	"	"	"	
m,p-Xylene	ND	1.0	"	"	"	"	"	"	
o-Xylene	ND	0.50	"	"	"	"	"	"	
Tert-amyl methyl ether	ND	2.0	"	"	"	"	"	"	
<b>Tert-butyl alcohol</b>	<b>18</b>	10	"	"	"	"	"	"	
Di-isopropyl ether	ND	2.0	"	"	"	"	"	"	
Ethyl tert-butyl ether	ND	2.0	"	"	"	"	"	"	
<b>Methyl tert-butyl ether</b>	<b>180</b>	25	"	25	"	"	09/18/07	"	
C6-C12 (GRO)	ND	50	"	1	"	"	09/17/07	"	
<i>Surrogate: 4-Bromofluorobenzene</i>		92.1 %	84-118		"	"	"	"	
<i>Surrogate: Dibromofluoromethane</i>		85.6 %	66-124		"	"	"	"	
<i>Surrogate: Toluene-d8</i>		97.9 %	85-115		"	"	"	"	

SunStar Laboratories, Inc.

*The results in this report apply to the samples analyzed in accordance with the chain of custody document. This analytical report must be reproduced in its entirety.*



Albert Vargas For John Shepler, Laboratory Director

Gribi Associates  
 1090 Adam Street, Suite K  
 Benicia CA, 94510

Project: Fidelity Roof  
 Project Number: 224-01-03  
 Project Manager: Jim Gribi

**Reported:**  
 09/21/07 14:40

**DP-1**  
**T701185-06 (Water)**

Analyte	Result	Reporting Limit	Units	Dilution	Batch	Prepared	Analyzed	Method	Notes
---------	--------	-----------------	-------	----------	-------	----------	----------	--------	-------

**SunStar Laboratories, Inc.**

**Purgeable Petroleum Hydrocarbons by EPA 8015m**

<b>C6-C12 (GRO)</b>	<b>100</b>	50	ug/l	1	7091701	09/17/07	09/17/07	EPA 8015m	
<i>Surrogate: 4-Bromofluorobenzene</i>		90.8 %	65-135		"	"	"	"	

**Extractable Petroleum Hydrocarbons by 8015m**

Diesel Range Hydrocarbons	ND	0.50	mg/l	1	7091703	09/17/07	09/18/07	EPA 8015m	
<i>Surrogate: p-Terphenyl</i>		109 %	65-135		"	"	"	"	

**Metals by EPA 6010B**

Lead	ND	50	ug/l	1	7091705	09/17/07	09/21/07	EPA 6010B	
------	----	----	------	---	---------	----------	----------	-----------	--

**Metals (Dissolved) by EPA 6000/7000 Series Methods**

Lead	ND	50	ug/l	1	7091704	09/17/07	09/18/07	EPA 6010B	
------	----	----	------	---	---------	----------	----------	-----------	--

**Volatile Organic Compounds by EPA Method 8260B**

Benzene	ND	0.50	ug/l	1	7091702	09/17/07	09/17/07	EPA 8260B	
Toluene	ND	0.50	"	"	"	"	"	"	
Ethylbenzene	ND	0.50	"	"	"	"	"	"	
m,p-Xylene	ND	1.0	"	"	"	"	"	"	
o-Xylene	ND	0.50	"	"	"	"	"	"	
Tert-amyl methyl ether	ND	2.0	"	"	"	"	"	"	
Tert-butyl alcohol	ND	10	"	"	"	"	"	"	
Di-isopropyl ether	ND	2.0	"	"	"	"	"	"	
Ethyl tert-butyl ether	ND	2.0	"	"	"	"	"	"	
Methyl tert-butyl ether	ND	1.0	"	"	"	"	"	"	
<b>C6-C12 (GRO)</b>	<b>ND</b>	<b>50</b>	<b>"</b>	<b>"</b>	<b>"</b>	<b>"</b>	<b>"</b>	<b>"</b>	
<i>Surrogate: 4-Bromofluorobenzene</i>		96.9 %	84-118		"	"	"	"	
<i>Surrogate: Dibromofluoromethane</i>		81.0 %	66-124		"	"	"	"	
<i>Surrogate: Toluene-d8</i>		97.9 %	85-115		"	"	"	"	

SunStar Laboratories, Inc.

*The results in this report apply to the samples analyzed in accordance with the chain of custody document. This analytical report must be reproduced in its entirety.*



Albert Vargas For John Shepler, Laboratory Director

Gribi Associates  
 1090 Adam Street, Suite K  
 Benicia CA, 94510

Project: Fidelity Roof  
 Project Number: 224-01-03  
 Project Manager: Jim Gribi

**Reported:**  
 09/21/07 14:40

**DP-2**  
**T701185-07 (Water)**

Analyte	Result	Reporting Limit	Units	Dilution	Batch	Prepared	Analyzed	Method	Notes
---------	--------	-----------------	-------	----------	-------	----------	----------	--------	-------

**SunStar Laboratories, Inc.**

**Purgeable Petroleum Hydrocarbons by EPA 8015m**

C6-C12 (GRO)	ND	50	ug/l	1	7091701	09/17/07	09/17/07	EPA 8015m	
<i>Surrogate: 4-Bromofluorobenzene</i>		81.8 %	65-135		"	"	"	"	

**Extractable Petroleum Hydrocarbons by 8015m**

Diesel Range Hydrocarbons	ND	0.50	mg/l	1	7091703	09/17/07	09/18/07	EPA 8015m	
<i>Surrogate: p-Terphenyl</i>		106 %	65-135		"	"	"	"	

**Metals by EPA 6010B**

Lead	ND	50	ug/l	1	7091705	09/17/07	09/21/07	EPA 6010B	
------	----	----	------	---	---------	----------	----------	-----------	--

**Metals (Dissolved) by EPA 6000/7000 Series Methods**

Lead	ND	50	ug/l	1	7091704	09/17/07	09/18/07	EPA 6010B	
------	----	----	------	---	---------	----------	----------	-----------	--

**Volatile Organic Compounds by EPA Method 8260B**

Benzene	ND	0.50	ug/l	1	7091702	09/17/07	09/17/07	EPA 8260B	
Toluene	ND	0.50	"	"	"	"	"	"	
Ethylbenzene	ND	0.50	"	"	"	"	"	"	
m,p-Xylene	ND	1.0	"	"	"	"	"	"	
o-Xylene	ND	0.50	"	"	"	"	"	"	
Tert-amyl methyl ether	ND	2.0	"	"	"	"	"	"	
Tert-butyl alcohol	ND	10	"	"	"	"	"	"	
Di-isopropyl ether	ND	2.0	"	"	"	"	"	"	
Ethyl tert-butyl ether	ND	2.0	"	"	"	"	"	"	
Methyl tert-butyl ether	ND	1.0	"	"	"	"	"	"	
C6-C12 (GRO)	ND	50	"	"	"	"	"	"	
<i>Surrogate: 4-Bromofluorobenzene</i>		90.0 %	84-118		"	"	"	"	
<i>Surrogate: Dibromofluoromethane</i>		86.6 %	66-124		"	"	"	"	
<i>Surrogate: Toluene-d8</i>		98.9 %	85-115		"	"	"	"	

SunStar Laboratories, Inc.

*The results in this report apply to the samples analyzed in accordance with the chain of custody document. This analytical report must be reproduced in its entirety.*



Albert Vargas For John Shepler, Laboratory Director

Gribi Associates  
 1090 Adam Street, Suite K  
 Benicia CA, 94510

Project: Fidelity Roof  
 Project Number: 224-01-03  
 Project Manager: Jim Gribi

**Reported:**  
 09/21/07 14:40

**DP-3**  
**T701185-08 (Water)**

Analyte	Result	Reporting Limit	Units	Dilution	Batch	Prepared	Analyzed	Method	Notes
---------	--------	-----------------	-------	----------	-------	----------	----------	--------	-------

**SunStar Laboratories, Inc.**

**Purgeable Petroleum Hydrocarbons by EPA 8015m**

C6-C12 (GRO)	ND	50	ug/l	1	7091701	09/17/07	09/17/07	EPA 8015m	
<i>Surrogate: 4-Bromofluorobenzene</i>		84.0 %	65-135		"	"	"	"	

**Extractable Petroleum Hydrocarbons by 8015m**

Diesel Range Hydrocarbons	ND	0.50	mg/l	1	7091703	09/17/07	09/18/07	EPA 8015m	
<i>Surrogate: p-Terphenyl</i>		104 %	65-135		"	"	"	"	

**Metals by EPA 6010B**

Lead	ND	50	ug/l	1	7091705	09/17/07	09/21/07	EPA 6010B	
------	----	----	------	---	---------	----------	----------	-----------	--

**Metals (Dissolved) by EPA 6000/7000 Series Methods**

Lead	ND	50	ug/l	1	7091704	09/17/07	09/18/07	EPA 6010B	
------	----	----	------	---	---------	----------	----------	-----------	--

**Volatile Organic Compounds by EPA Method 8260B**

Benzene	ND	0.50	ug/l	1	7091702	09/17/07	09/17/07	EPA 8260B	
Toluene	ND	0.50	"	"	"	"	"	"	
Ethylbenzene	ND	0.50	"	"	"	"	"	"	
m,p-Xylene	ND	1.0	"	"	"	"	"	"	
o-Xylene	ND	0.50	"	"	"	"	"	"	
Tert-amyl methyl ether	ND	2.0	"	"	"	"	"	"	
Tert-butyl alcohol	ND	10	"	"	"	"	"	"	
Di-isopropyl ether	ND	2.0	"	"	"	"	"	"	
Ethyl tert-butyl ether	ND	2.0	"	"	"	"	"	"	
<b>Methyl tert-butyl ether</b>	<b>36</b>	1.0	"	"	"	"	"	"	
C6-C12 (GRO)	ND	50	"	"	"	"	"	"	
<i>Surrogate: 4-Bromofluorobenzene</i>		93.5 %	84-118		"	"	"	"	
<i>Surrogate: Dibromofluoromethane</i>		80.8 %	66-124		"	"	"	"	
<i>Surrogate: Toluene-d8</i>		98.5 %	85-115		"	"	"	"	

SunStar Laboratories, Inc.

*The results in this report apply to the samples analyzed in accordance with the chain of custody document. This analytical report must be reproduced in its entirety.*



Albert Vargas For John Shepler, Laboratory Director

Gribi Associates  
 1090 Adam Street, Suite K  
 Benicia CA, 94510

Project: Fidelity Roof  
 Project Number: 224-01-03  
 Project Manager: Jim Gribi

**Reported:**  
 09/21/07 14:40

**DP-4**  
**T701185-09 (Water)**

Analyte	Result	Reporting Limit	Units	Dilution	Batch	Prepared	Analyzed	Method	Notes
---------	--------	-----------------	-------	----------	-------	----------	----------	--------	-------

**SunStar Laboratories, Inc.**

**Purgeable Petroleum Hydrocarbons by EPA 8015m**

<b>C6-C12 (GRO)</b>	<b>660</b>	50	ug/l	1	7091701	09/17/07	09/17/07	EPA 8015m	
<i>Surrogate: 4-Bromofluorobenzene</i>		95.5 %	65-135		"	"	"	"	

**Extractable Petroleum Hydrocarbons by 8015m**

Diesel Range Hydrocarbons	ND	0.50	mg/l	1	7091703	09/17/07	09/18/07	EPA 8015m	
<i>Surrogate: p-Terphenyl</i>		114 %	65-135		"	"	"	"	

**Metals by EPA 6010B**

Lead	ND	50	ug/l	1	7091705	09/17/07	09/21/07	EPA 6010B	
------	----	----	------	---	---------	----------	----------	-----------	--

**Metals (Dissolved) by EPA 6000/7000 Series Methods**

Lead	ND	50	ug/l	1	7091704	09/17/07	09/18/07	EPA 6010B	
------	----	----	------	---	---------	----------	----------	-----------	--

**Volatile Organic Compounds by EPA Method 8260B**

<b>Benzene</b>	<b>33</b>	0.50	ug/l	1	7091702	09/17/07	09/17/07	EPA 8260B	
Toluene	ND	0.50	"	"	"	"	"	"	
<b>Ethylbenzene</b>	<b>0.58</b>	0.50	"	"	"	"	"	"	
m,p-Xylene	ND	1.0	"	"	"	"	"	"	
o-Xylene	ND	0.50	"	"	"	"	"	"	
Tert-amyl methyl ether	ND	2.0	"	"	"	"	"	"	
<b>Tert-butyl alcohol</b>	<b>14</b>	10	"	"	"	"	"	"	
Di-isopropyl ether	ND	2.0	"	"	"	"	"	"	
Ethyl tert-butyl ether	ND	2.0	"	"	"	"	"	"	
<b>Methyl tert-butyl ether</b>	<b>62</b>	1.0	"	"	"	"	"	"	
<b>C6-C12 (GRO)</b>	<b>280</b>	50	"	"	"	"	"	"	
<i>Surrogate: 4-Bromofluorobenzene</i>		102 %	84-118		"	"	"	"	
<i>Surrogate: Dibromofluoromethane</i>		82.2 %	66-124		"	"	"	"	
<i>Surrogate: Toluene-d8</i>		101 %	85-115		"	"	"	"	

SunStar Laboratories, Inc.

*The results in this report apply to the samples analyzed in accordance with the chain of custody document. This analytical report must be reproduced in its entirety.*



Albert Vargas For John Shepler, Laboratory Director



Gribi Associates  
 1090 Adam Street, Suite K  
 Benicia CA, 94510

Project: Fidelity Roof  
 Project Number: 224-01-03  
 Project Manager: Jim Gribi

**Reported:**  
 09/21/07 14:40

**DP-5**  
**T701185-10 (Water)**

Analyte	Result	Reporting Limit	Units	Dilution	Batch	Prepared	Analyzed	Method	Notes
---------	--------	-----------------	-------	----------	-------	----------	----------	--------	-------

**SunStar Laboratories, Inc.**

**Purgeable Petroleum Hydrocarbons by EPA 8015m**

C6-C12 (GRO)	ND	50	ug/l	1	7091701	09/17/07	09/17/07	EPA 8015m	
<i>Surrogate: 4-Bromofluorobenzene</i>		76.6 %	65-135		"	"	"	"	

**Extractable Petroleum Hydrocarbons by 8015m**

Diesel Range Hydrocarbons	ND	0.50	mg/l	1	7091703	09/17/07	09/18/07	EPA 8015m	
<i>Surrogate: p-Terphenyl</i>		105 %	65-135		"	"	"	"	

**Metals by EPA 6010B**

Lead	ND	50	ug/l	1	7091705	09/17/07	09/21/07	EPA 6010B	
------	----	----	------	---	---------	----------	----------	-----------	--

**Metals (Dissolved) by EPA 6000/7000 Series Methods**

Lead	ND	50	ug/l	1	7091704	09/17/07	09/18/07	EPA 6010B	
------	----	----	------	---	---------	----------	----------	-----------	--

**Volatile Organic Compounds by EPA Method 8260B**

Benzene	ND	0.50	ug/l	1	7091702	09/17/07	09/17/07	EPA 8260B	
Toluene	ND	0.50	"	"	"	"	"	"	
Ethylbenzene	ND	0.50	"	"	"	"	"	"	
m,p-Xylene	ND	1.0	"	"	"	"	"	"	
o-Xylene	ND	0.50	"	"	"	"	"	"	
Tert-amyl methyl ether	ND	2.0	"	"	"	"	"	"	
Tert-butyl alcohol	ND	10	"	"	"	"	"	"	
Di-isopropyl ether	ND	2.0	"	"	"	"	"	"	
Ethyl tert-butyl ether	ND	2.0	"	"	"	"	"	"	
Methyl tert-butyl ether	ND	1.0	"	"	"	"	"	"	
C6-C12 (GRO)	ND	50	"	"	"	"	"	"	
<i>Surrogate: 4-Bromofluorobenzene</i>		90.9 %	84-118		"	"	"	"	
<i>Surrogate: Dibromofluoromethane</i>		89.8 %	66-124		"	"	"	"	
<i>Surrogate: Toluene-d8</i>		97.0 %	85-115		"	"	"	"	

SunStar Laboratories, Inc.

*The results in this report apply to the samples analyzed in accordance with the chain of custody document. This analytical report must be reproduced in its entirety.*



Albert Vargas For John Shepler, Laboratory Director

Gribi Associates  
 1090 Adam Street, Suite K  
 Benicia CA, 94510

Project: Fidelity Roof  
 Project Number: 224-01-03  
 Project Manager: Jim Gribi

**Reported:**  
 09/21/07 14:40

**DP-6**  
**T701185-11 (Water)**

Analyte	Result	Reporting Limit	Units	Dilution	Batch	Prepared	Analyzed	Method	Notes
---------	--------	-----------------	-------	----------	-------	----------	----------	--------	-------

**SunStar Laboratories, Inc.**

**Purgeable Petroleum Hydrocarbons by EPA 8015m**

<b>C6-C12 (GRO)</b>	<b>2800</b>	50	ug/l	1	7091701	09/17/07	09/17/07	EPA 8015m	
<i>Surrogate: 4-Bromofluorobenzene</i>		105 %	65-135		"	"	"	"	

**Extractable Petroleum Hydrocarbons by 8015m**

<b>Diesel Range Hydrocarbons</b>	<b>1.3</b>	0.50	mg/l	1	7091703	09/17/07	09/18/07	EPA 8015m	D-02
<i>Surrogate: p-Terphenyl</i>		107 %	65-135		"	"	"	"	

**Metals by EPA 6010B**

Lead	ND	50	ug/l	1	7091705	09/17/07	09/21/07	EPA 6010B	
------	----	----	------	---	---------	----------	----------	-----------	--

**Metals (Dissolved) by EPA 6000/7000 Series Methods**

Lead	ND	50	ug/l	1	7091704	09/17/07	09/18/07	EPA 6010B	
------	----	----	------	---	---------	----------	----------	-----------	--

**Volatile Organic Compounds by EPA Method 8260B**

<b>Benzene</b>	<b>500</b>	12	ug/l	25	7091702	09/17/07	09/18/07	EPA 8260B	
<b>Toluene</b>	<b>1.3</b>	0.50	"	1	"	"	09/17/07	"	
<b>Ethylbenzene</b>	<b>380</b>	12	"	25	"	"	09/18/07	"	
<b>m,p-Xylene</b>	<b>42</b>	1.0	"	1	"	"	09/17/07	"	
<b>o-Xylene</b>	<b>18</b>	0.50	"	"	"	"	"	"	
Tert-amyl methyl ether	ND	2.0	"	"	"	"	"	"	
Tert-butyl alcohol	ND	10	"	"	"	"	"	"	
Di-isopropyl ether	ND	2.0	"	"	"	"	"	"	
Ethyl tert-butyl ether	ND	2.0	"	"	"	"	"	"	
<b>Methyl tert-butyl ether</b>	<b>20</b>	1.0	"	"	"	"	"	"	
<b>C6-C12 (GRO)</b>	<b>2000</b>	50	"	"	"	"	"	"	
<i>Surrogate: 4-Bromofluorobenzene</i>		102 %	84-118		"	"	"	"	
<i>Surrogate: Dibromofluoromethane</i>		83.9 %	66-124		"	"	"	"	
<i>Surrogate: Toluene-d8</i>		104 %	85-115		"	"	"	"	

SunStar Laboratories, Inc.

*The results in this report apply to the samples analyzed in accordance with the chain of custody document. This analytical report must be reproduced in its entirety.*



Albert Vargas For John Shepler, Laboratory Director

Gribi Associates  
1090 Adam Street, Suite K  
Benicia CA, 94510

Project: Fidelity Roof  
Project Number: 224-01-03  
Project Manager: Jim Gribi

**Reported:**  
09/21/07 14:40

**Purgeable Petroleum Hydrocarbons by EPA 8015m - Quality Control**  
**SunStar Laboratories, Inc.**

Analyte	Result	Reporting Limit	Units	Spike Level	Source Result	%REC	%REC Limits	RPD	RPD Limit	Notes
---------	--------	-----------------	-------	-------------	---------------	------	-------------	-----	-----------	-------

**Batch 7091701 - EPA 5030 GC**

**Blank (7091701-BLK1)**

Prepared & Analyzed: 09/17/07

Surrogate: 4-Bromofluorobenzene	151		ug/l	200		75.5	65-135			
C6-C12 (GRO)	ND	50	"							

**LCS (7091701-BS1)**

Prepared & Analyzed: 09/17/07

Surrogate: 4-Bromofluorobenzene	247		ug/l	200		123	65-135			
C6-C12 (GRO)	5490	50	"	5500		99.9	75-125			

**LCS Dup (7091701-BSD1)**

Prepared & Analyzed: 09/17/07

Surrogate: 4-Bromofluorobenzene	233		ug/l	200		117	65-135			
C6-C12 (GRO)	5500	50	"	5500		100	75-125	0.192	20	

SunStar Laboratories, Inc.

*The results in this report apply to the samples analyzed in accordance with the chain of custody document. This analytical report must be reproduced in its entirety.*

Albert Vargas For John Shepler, Laboratory Director

Gribi Associates  
 1090 Adam Street, Suite K  
 Benicia CA, 94510

Project: Fidelity Roof  
 Project Number: 224-01-03  
 Project Manager: Jim Gribi

**Reported:**  
 09/21/07 14:40

**Extractable Petroleum Hydrocarbons by 8015m - Quality Control**  
**SunStar Laboratories, Inc.**

Analyte	Result	Reporting Limit	Units	Spike Level	Source Result	%REC	%REC Limits	RPD	RPD Limit	Notes
---------	--------	-----------------	-------	-------------	---------------	------	-------------	-----	-----------	-------

**Batch 7091703 - EPA 3510C GC**

**Blank (7091703-BLK1)**

Prepared: 09/17/07 Analyzed: 09/18/07

Surrogate: <i>p</i> -Terphenyl	4.21		mg/l	4.00		105	65-135			
Diesel Range Hydrocarbons	ND	0.50	"							

**LCS (7091703-BS1)**

Prepared: 09/17/07 Analyzed: 09/18/07

Surrogate: <i>p</i> -Terphenyl	3.81		mg/l	4.00		95.3	65-135			
Diesel Range Hydrocarbons	17.8	0.50	"	20.0		88.9	75-125			

**LCS Dup (7091703-BSD1)**

Prepared: 09/17/07 Analyzed: 09/18/07

Surrogate: <i>p</i> -Terphenyl	4.04		mg/l	4.00		101	65-135			
Diesel Range Hydrocarbons	17.1	0.50	"	20.0		85.4	75-125	3.93	20	

SunStar Laboratories, Inc.

*The results in this report apply to the samples analyzed in accordance with the chain of custody document. This analytical report must be reproduced in its entirety.*



Albert Vargas For John Shepler, Laboratory Director

Gribi Associates  
1090 Adam Street, Suite K  
Benicia CA, 94510

Project: Fidelity Roof  
Project Number: 224-01-03  
Project Manager: Jim Gribi

**Reported:**  
09/21/07 14:40

**Metals by EPA 6010B - Quality Control**  
**SunStar Laboratories, Inc.**

Analyte	Result	Reporting Limit	Units	Spike Level	Source Result	%REC	%REC Limits	RPD	RPD Limit	Notes
---------	--------	--------------------	-------	----------------	------------------	------	----------------	-----	--------------	-------

**Batch 7091705 - EPA 3010A**

**Blank (7091705-BLK1)**

Prepared: 09/17/07 Analyzed: 09/21/07

Lead ND 50 ug/l

**LCS (7091705-BS1)**

Prepared: 09/17/07 Analyzed: 09/21/07

Lead 407 50 ug/l 500 81.5 75-125

**LCS Dup (7091705-BSD1)**

Prepared: 09/17/07 Analyzed: 09/20/07

Lead 408 50 ug/l 500 81.6 75-125 0.171 20

SunStar Laboratories, Inc.

*The results in this report apply to the samples analyzed in accordance with the chain of custody document. This analytical report must be reproduced in its entirety.*

Albert Vargas For John Shepler, Laboratory Director

Gribi Associates  
1090 Adam Street, Suite K  
Benicia CA, 94510

Project: Fidelity Roof  
Project Number: 224-01-03  
Project Manager: Jim Gribi

**Reported:**  
09/21/07 14:40

**Metals (Dissolved) by EPA 6000/7000 Series Methods - Quality Control**  
**SunStar Laboratories, Inc.**

Analyte	Result	Reporting Limit	Units	Spike Level	Source Result	%REC	%REC Limits	RPD	RPD Limit	Notes
---------	--------	-----------------	-------	-------------	---------------	------	-------------	-----	-----------	-------

**Batch 7091704 - EPA 3010A**

**Blank (7091704-BLK1)**

Prepared: 09/17/07 Analyzed: 09/18/07

Lead ND 50 ug/l

**LCS (7091704-BS1)**

Prepared: 09/17/07 Analyzed: 09/18/07

Lead 901 50 ug/l 1050 85.6 75-125

**LCS Dup (7091704-BSD1)**

Prepared: 09/17/07 Analyzed: 09/18/07

Lead 916 50 ug/l 1050 87.0 75-125 1.69 20

SunStar Laboratories, Inc.

*The results in this report apply to the samples analyzed in accordance with the chain of custody document. This analytical report must be reproduced in its entirety.*

Albert Vargas For John Shepler, Laboratory Director

Gribi Associates  
 1090 Adam Street, Suite K  
 Benicia CA, 94510

Project: Fidelity Roof  
 Project Number: 224-01-03  
 Project Manager: Jim Gribi

Reported:  
 09/21/07 14:40

**Volatile Organic Compounds by EPA Method 8260B - Quality Control**  
**SunStar Laboratories, Inc.**

Analyte	Result	Reporting Limit	Units	Spike Level	Source Result	%REC	%REC Limits	RPD	RPD Limit	Notes
---------	--------	-----------------	-------	-------------	---------------	------	-------------	-----	-----------	-------

**Batch 7091702 - EPA 5030 GCMS**

**Blank (7091702-BLK1)**

Prepared & Analyzed: 09/17/07

Surrogate: 4-Bromofluorobenzene	7.31		ug/l	8.00		91.4	84-118			
Surrogate: Dibromofluoromethane	6.01		"	8.00		75.1	66-124			
Surrogate: Toluene-d8	7.73		"	8.00		96.6	85-115			
Benzene	ND	0.50	"							
Toluene	ND	0.50	"							
Ethylbenzene	ND	0.50	"							
m,p-Xylene	ND	1.0	"							
o-Xylene	ND	0.50	"							
Tert-amyl methyl ether	ND	2.0	"							
Tert-butyl alcohol	ND	10	"							
Di-isopropyl ether	ND	2.0	"							
Ethyl tert-butyl ether	ND	2.0	"							
Methyl tert-butyl ether	ND	1.0	"							
C6-C12 (GRO)	ND	50	"							

**LCS (7091702-BS1)**

Prepared & Analyzed: 09/17/07

Surrogate: 4-Bromofluorobenzene	7.54		ug/l	8.00		94.2	84-118			
Surrogate: Dibromofluoromethane	6.39		"	8.00		79.9	66-124			
Surrogate: Toluene-d8	7.90		"	8.00		98.8	85-115			
Benzene	17.9	0.50	"	20.0		89.6	75-125			
Toluene	18.0	0.50	"	20.0		89.8	75-125			

**LCS Dup (7091702-BSD1)**

Prepared & Analyzed: 09/17/07

Surrogate: 4-Bromofluorobenzene	7.55		ug/l	8.00		94.4	84-118			
Surrogate: Dibromofluoromethane	6.41		"	8.00		80.1	66-124			
Surrogate: Toluene-d8	8.03		"	8.00		100	85-115			
Benzene	19.4	0.50	"	20.0		97.0	75-125	7.93	20	
Toluene	19.7	0.50	"	20.0		98.4	75-125	9.03	20	

SunStar Laboratories, Inc.

*The results in this report apply to the samples analyzed in accordance with the chain of custody document. This analytical report must be reproduced in its entirety.*



Albert Vargas For John Shepler, Laboratory Director

Gribi Associates  
1090 Adam Street, Suite K  
Benicia CA, 94510

Project: Fidelity Roof  
Project Number: 224-01-03  
Project Manager: Jim Gribi

**Reported:**  
09/21/07 14:40

### Notes and Definitions

D-02 Hydrocarbon pattern present in the requested fuel quantitation range but does not resemble the pattern of the requested fuel.

DET Analyte DETECTED

ND Analyte NOT DETECTED at or above the reporting limit

NR Not Reported

dry Sample results reported on a dry weight basis

RPD Relative Percent Difference

---

SunStar Laboratories, Inc.

*The results in this report apply to the samples analyzed in accordance with the chain of custody document. This analytical report must be reproduced in its entirety.*



---

Albert Vargas For John Shepler, Laboratory Director