

C A M B R I A

Alameda County

JUN 04 2003

June 2, 2003

Environmental Health

Mr. Scott Seery
Alameda County Health Care Services Agency
Environmental Health Services
1131 Harbor Bay Parkway
Alameda, CA 94502

Re: **Proposed Changes to Scope of Work
For Groundwater Monitoring & Sampling**
Former Chevron Station 9-7127
I-580 & Grantline Road
Tracy, California
Cambria Project No. 31D-1656



Mr. Seery:

Cambria Environmental Technology, Inc. (Cambria), on behalf of Chevron Products Company (Chevron) presents this recommendation for modification to the existing scope of work regarding groundwater monitoring and sampling at the site referenced above. The proposed changes and justifications for change are described below. Though sampling frequency changes are proposed, groundwater elevations will continue to be measured in each well to calculate groundwater flow direction and gradient.

WELL

RECOMMENDATION & JUSTIFICATION FOR CHANGE

MW-2

Cease current annual sampling frequency. Last detections (single-digit BTEX) were 5/01 and appear anomalous. Prior detections were in 11/94. Well is consistently cross-gradient of axis of plume. Recommendation is to sample this well bi-annually.

MW-5

Cease current annual sampling frequency. MW-5 has historically ND with minor single-digit BTEX results. Well is located cross-gradient of the plume. Recommendation is to sample this well bi-annually.

MW-6

Cease current semi-annual sampling frequency. Although in an apparent direct down-gradient location with the axis of the dissolved plume, this well has been essentially ND for BTEX constituents, with intermittent minor TPHg concentrations. Due

**Cambria
Environmental
Technology, Inc.**

5900 Hollis Street
Suite A
Emeryville, CA 94608
Tel (510) 420-0700
Fax (510) 420-9170

MW-6 Cease current semi-annual sampling frequency. Although in an apparent direct down-gradient location with the axis of the dissolved plume, this well has been essentially ND for BTEX constituents, with intermittent minor TPHg concentrations. Due to its location in relation to the plume, our recommendation is to sample this well annually.

MW-7 Cease current annual sampling frequency. MW-7 has always been ND since first sampled in February 1996. It has had one anomalous single-digit detection of toluene and xylenes and is located 130 feet perpendicular to the source area. Our recommendation is to cease sampling of this well altogether.

MW-8 Cease current annual sampling frequency. MW-8 has shown one anomalous single-digit detection of BTEX. The well is located 120 feet perpendicular to the source area and is slightly up-gradient of the source area, as well. As with MW-7, our recommendation is to cease sampling of this well altogether.

Current monitoring and sampling frequencies for remaining wells MW-1, MW-3 and MW-4 appear appropriate. No change in scope for these wells is proposed at this time.

CLOSING

Please review the proposed changes to the current scope of work for monitoring and sampling of former Chevron SS #9-7127. The next semi-annual monitoring and sampling event will occur in November 2003. We anticipate hearing back from you regarding this proposal prior to that event. In the event that we do not receive a response from your office on this matter, it is our intention to implement the proposed changes to the scope of work. If you have any questions or comments regarding the proposal, please contact me at (510) 420-3348.

C A M B R I A

Mr. Scott Seery
June 2, 2003

Sincerely,

Cambria Environmental Technology, Inc

Robert C. Foss

Robert C. Foss, R.G.
Senior Project Geologist

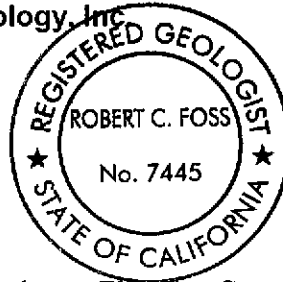

Attachment: A – Figure 8 – Groundwater Elevation Contour Map, 11/8/02
(From Delta Environmental Consultants)



cc: Karen Streich, ChevronTexaco, P.O. Box 6012, San Ramon, CA 94583

i:\9-7127 Tracy\SFR request 5-03.doc

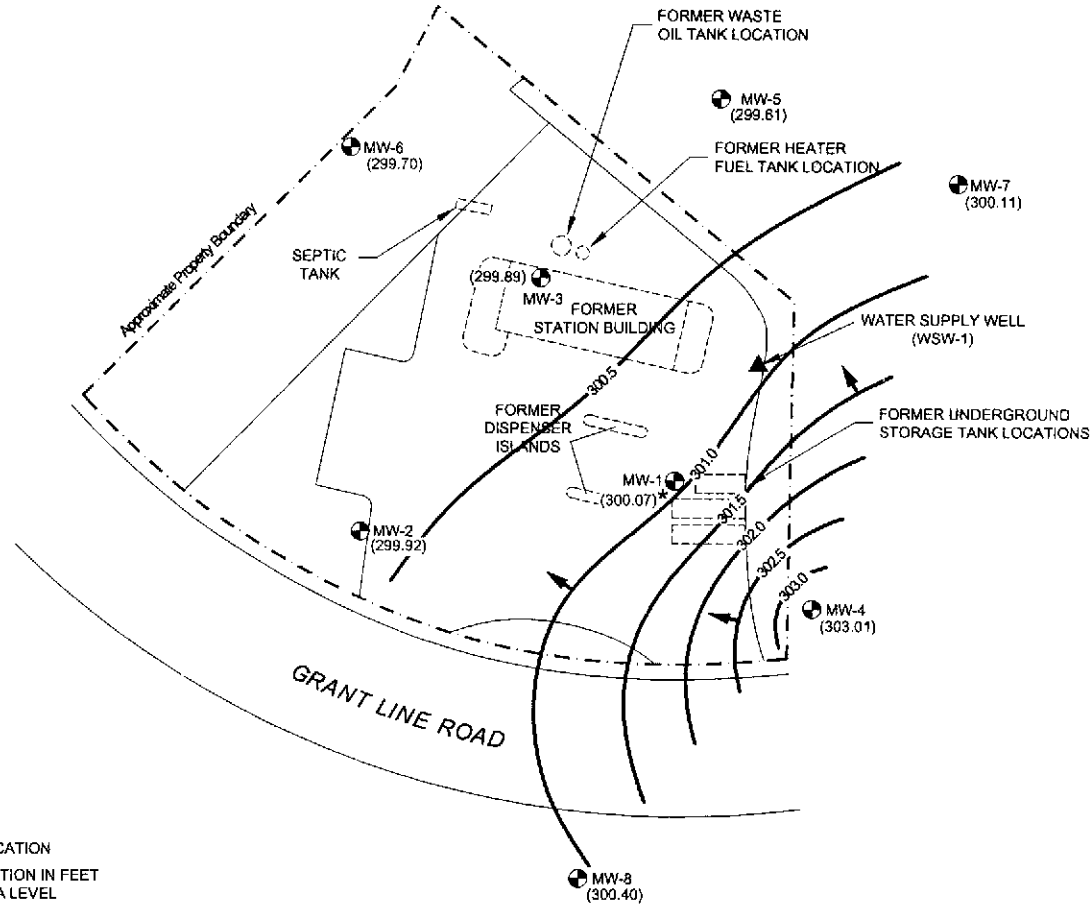
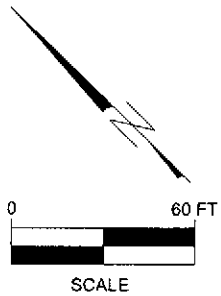

LEGEND:

- MW-1 MONITORING WELL LOCATION
- (300.07) GROUNDWATER ELEVATION IN FEET RELATIVE TO MEAN SEA LEVEL
- 301.5— WATER TABLE CONTOUR IN FEET RELATIVE TO MEAN SEA LEVEL
- ➔ GROUNDWATER FLOW DIRECTION
- * GROUND WATER ELEVATION CORRECTED FOR PRESENCE OF SINGLE PHASE HYDROCARBONS

FIGURE 8
GROUNDWATER ELEVATION CONTOUR MAP
11/8/02

FORMER CHEVRON SERVICE STATION NO. 9-7127
GRANT LINE ROAD AT INTERSTATE 580
TRACY, CALIFORNIA

PROJECT NO. DG97-127	DRAWN BY M.L. 4/1/03
FILE NO. DG97127B	PREPARED BY BIH
REVISION NO. 3	REVIEWED BY

