

Detterman, Mark, Env. Health

From: Russi, Tonya [Tonya.Russi@arcadis-us.com]
Sent: Thursday, May 30, 2013 1:27 PM
To: Detterman, Mark, Env. Health; Espino Devine, Catalina (espino@chevron.com)
Subject: Chevron site 97127 (Tracy, CA): revised locations
Attachments: 97127 revised locations.pdf

Please find attached for our discussion the proposed revised boring/well locations.

Tonya Russi | Senior Scientist | tonya.russi@arcadis-us.com

ARCADIS U.S., Inc. | 950 Glenn Drive, Suite 125 | Folsom, California 95630
T: 916 985 2079 ext. 15
www.arcadis-us.com

ARCADIS, Imagine the result
Please consider the environment before printing this email.



NOTICE: This e-mail and any files transmitted with it are the property of ARCADIS U.S., Inc. and its affiliates. All rights, including without limitation copyright, are reserved. The proprietary information contained in this e-mail message, and any files transmitted with it, is intended for the use of the recipient(s) named above. If the reader of this e-mail is not the intended recipient, you are hereby notified that you have received this e-mail in error and that any review, distribution or copying of this e-mail or any files transmitted with it is strictly prohibited. If you have received this e-mail in error, please notify the sender immediately and delete the original message and any files transmitted. The unauthorized use of this e-mail or any files transmitted with it is prohibited and disclaimed by ARCADIS U.S., Inc. and its affiliates. Nothing herein is intended to constitute the offering or performance of services where otherwise restricted by law.

CITY: PETALUMA, CA DIV/GRP: ENV DB: J. HARRIS
 G:\ENVCAD\Roseville-CA\RETURNS-FO\PetAluma-CA\B0047959\000\001\001\DWG\47959001.dwg LAYOUT: 2 SAVED: 8/29/2012 2:26 PM ACADVER: 18.1S (LMS TECH) PAGESETUP: SETUP1 PLOTSTYLE/TABLE: ARCADIS.CTB PLOTTED: 8/29/2012 2:27 PM BY: ROBITALLE, BEVERLY
 XREFS: IMAGES: PROJECTNAME: 47959X01 B0047959.0000.001\001\google 2790x.jpg

GRANT LINE ROAD

INTERSTATE 580 ON RAMP

JESS RANCH ROAD

- LEGEND
- PROPERTY BOUNDARY
 - x - x - FENCE
 - MW-1 [Symbol] MONITORING WELL LOCATION
 - WSW-1 [Symbol] WATER SUPPLY WELL (LIVESTOCK)
 - [Symbol] PROPOSED BORING

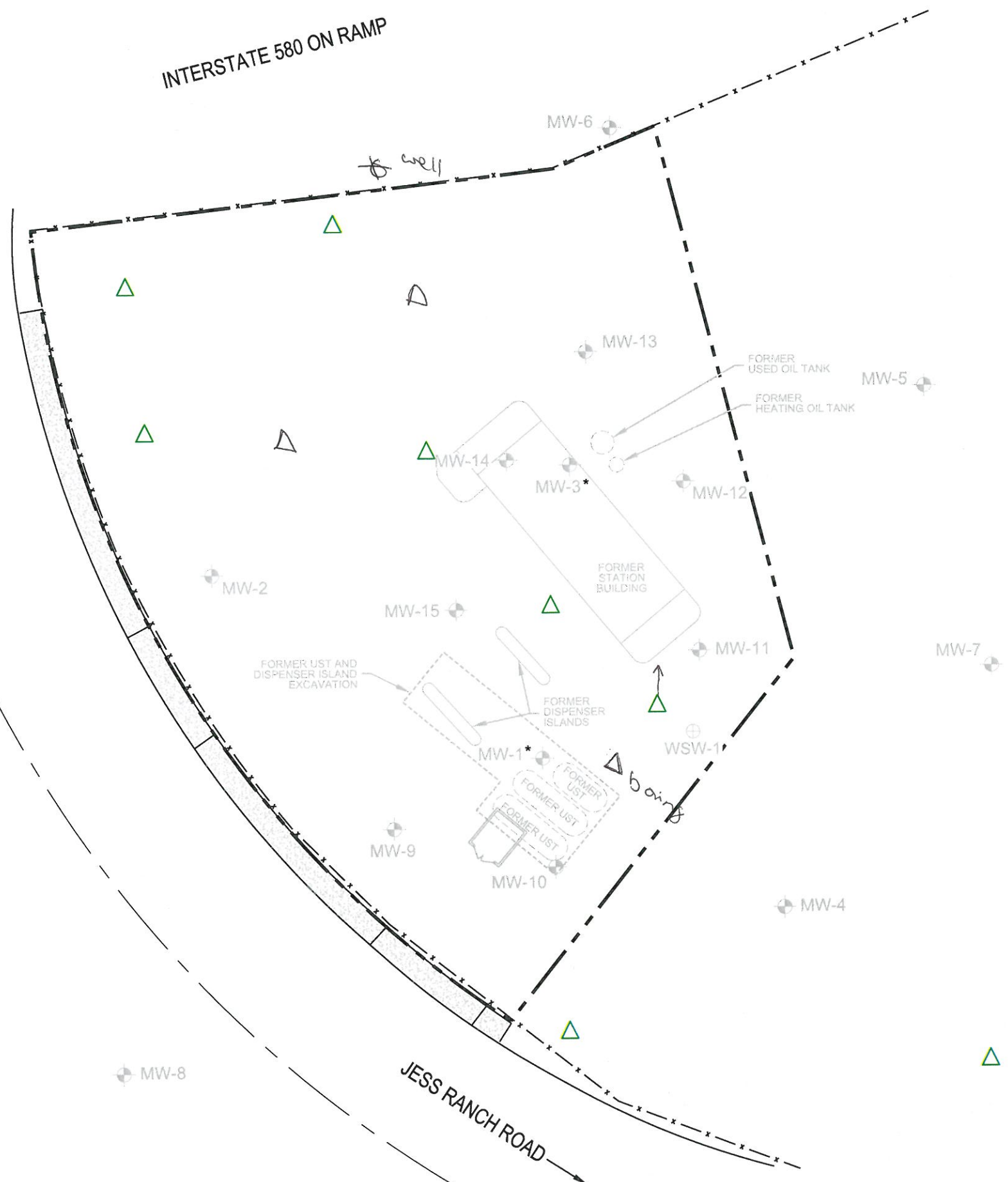

NOTES:

1. MONITORING WELL LOCATIONS BASED ON SURVEY DATA PROVIDED BY VIRGIL CHAVEZ LAND SURVEYING (SEPTEMBER 2011) DRAWING FILE 305620cad.dwg. MW-6 LOCATION WAS NOT SURVEYED AND IS APPROXIMATE.
2. MAP MODIFIED FROM CONESTOGA-ROVERS & ASSOCIATES (CRA) FIGURE ENTITLED "FIGURE 2 CONCENTRATION MAP" DATED FEBRUARY 21, 2012, DRAWING FILE xsite.dwg. ALL SITE FEATURES AND LOCATIONS ARE APPROXIMATE.
3. MONITORING WELL MW-8 DISCONTINUED FROM MONITORING AND SAMPLING PROGRAM.

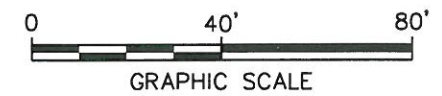

CHEVRON SITE ID 97127 GRANT LINE ROAD AND INTERSTATE 580 TRACY, CALIFORNIA ADDITIONAL SITE ASSESSMENT WORK PLAN	
SITE PLAN WITH PROPOSED BORING LOCATIONS	
	FIGURE 2