

Broadbent & Associates, Inc.
1324 Mangrove Ave., Suite 212
Chico, CA 95926
Voice (530) 566-1400
Fax (530) 566-1401

RECEIVED

2:26 pm, Jan 31, 2008

Alameda County
Environmental Health



January 21, 2008

Project No. 06-02-628

Atlantic Richfield Company
P.O. Box 1257
San Ramon, CA 94583
Submitted via ENFOS

Attn.: Mr. Paul Supple

Re: Fourth Quarter, 2007 Status Report, Former Atlantic Richfield Company (a BP affiliated company) Station #5387, 20200 Hesperian Boulevard, Hayward, California. ACEH Case No. RO0000174.

Dear Mr. Supple:

Attached is the *Fourth Quarter, 2007 Status Report* for Former Atlantic Richfield Company Station #5387 (herein referred to as Station #5387) located at 20200 Hesperian Boulevard, Hayward, California (Property).

Should you have questions please do not hesitate to contact us at (530) 566-1400.

Sincerely,

BROADBENT & ASSOCIATES, INC.

A handwritten signature in black ink, appearing to read 'M. G. Herrick', written over a horizontal line.

Matthew G. Herrick, P.G.
Project Hydrogeologist

A handwritten signature in black ink, appearing to read 'Robert H. Miller', written over a horizontal line.

Robert H. Miller, P.G., C.H.G.
Principal Hydrogeologist

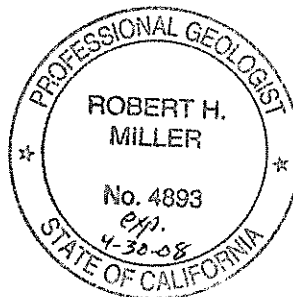

Enclosures

cc: Mr. Steven Plunkett, Alameda County Environmental Health, 1131 Harbor Bay Parkway, Suite 250, Alameda, CA, 94502 (Submitted via ACEH ftp Site)
Mr. Chris Panaitescu, Thrifty Oil Co., 13116 Imperial Hwy, Santa Fe Springs, CA 90760
Mr. Jack Oman, Atlantic Richfield Company (Submitted via ENFOS)
GeoTracker

STATION #5387 QUARTERLY STATUS REPORT

Facility: #5387	Address: 20200 Hesperian Boulevard, Hayward, California
Station #5387 Environmental	
Business Manager:	Mr. Paul Supple
Consulting Co./Contact Persons:	Broadbent & Associates, Inc. (BAI) / Rob Miller & Matt Herrick
Primary Agency/Regulatory ID No.:	Alameda County Environmental Health (ACEH) / ACEH Case No. RO0000174
Consultant Project No.:	06-02-628
Facility Permits/Permitting Agency.:	NA

WORK PERFORMED THIS QUARTER (Fourth Quarter, 2007):

1. Submit the Third Quarter, 2007 Semi-Annual Ground-Water Monitoring Report. Report completed by BAI.
2. No environmental work was completed on the Property during the Fourth Quarter, 2007.

WORK PROPOSED FOR NEXT QUARTER (First Quarter, 2008):

1. Submit Fourth Quarter, 2007 Status Report (contained herein).
2. Conduct ground-water monitoring/sampling for First Quarter, 2008.

QUARTERLY RESULTS SUMMARY:

Current phase of project:	<u>Ground-water monitoring/sampling</u>
Frequency of ground-water sampling:	<u>A-7, AR-1, AR-2 = Annual (3Q)</u>
	<u>MW-1 and MW-2 = Semi-Annual (1Q and 3Q)</u>
Frequency of ground-water monitoring:	<u>All wells = Semi-annual (1Q and 3Q)</u>
Is free product (FP) present on-site:	<u>No</u>
Current remediation techniques:	<u>NA</u>
Depth to ground water (below TOC):	<u>NA</u>
General ground-water flow direction:	<u>NA</u>
Approximate hydraulic gradient:	<u>NA</u>

DISCUSSION:

No environmental activities took place at Station #5387 during the Fourth Quarter, 2007. The attached Drawing 1 depicts the site and monitor well locations. The most recent quarterly ground-water monitoring data can be referenced in the Third Quarter, 2007 Semi-Annual Ground-Water Monitoring Report.

A Soil Gas Investigation Report and Closure Request was submitted to the ACEH on August 2, 2007. A response from the ACEH regarding the closure request has not been received.

ATTACHMENTS:

Drawing 1: Site Map, Station #5387, Hayward, California

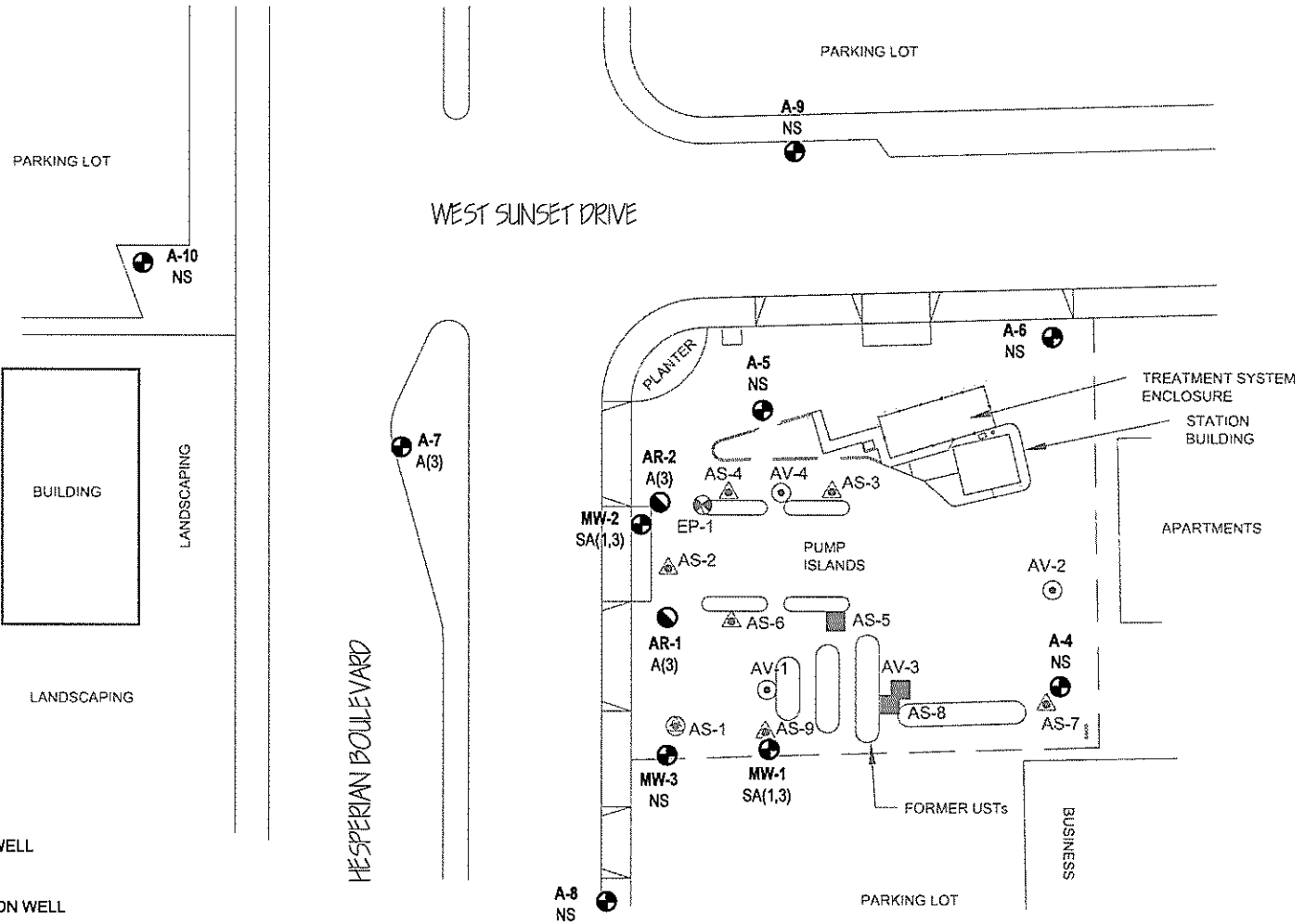

LEGEND

- ABANDONED MONITORING WELL
- MONITORING WELL
- GROUND-WATER EXTRACTION WELL
- AIR SPARGE WELL
- DUAL AIR SPARGE/SOIL VAPOR EXTRACTION WELL
- EXTRACTION POINT
- Well — WELL DESIGNATION
- A,SA — SAMPLING FREQUENCY
- A(3) — SAMPLED ANNUALLY 3rd QUARTER
- SA(1,3) — SAMPLED SEMI-ANNUALLY 1st & 3rd QUARTER
- NS — NOT SAMPLED

NOTE: SITE MAP ADAPTED FROM IT CORPORATION FIGURES.
SITE DIMENSIONS AND FACILITY LOCATIONS NOT VERIFIED.

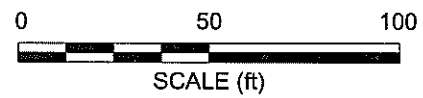
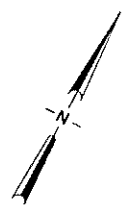

BROADBENT & ASSOCIATES, INC.
ENGINEERING, WATER RESOURCES & ENVIRONMENTAL
1324 Mangrove Ave. Suite 212, Chico, California, 95926
Project No.: 06-02-628 Date: 7/4/07

Former Station #5387
20200 Hesperian Boulevard
Hayward, California

Site Map