



**CONESTOGA-ROVERS
& ASSOCIATES**

5900 Hollis Street, Suite A
Emeryville, California 94608
Telephone: (510) 420-0700 Fax: (510) 420-9170
www.CRAworld.com

TRANSMITTAL

DATE: February 19, 2010 REFERENCE NO.: 240733
PROJECT NAME: 2120 Montana Street, Oakland
TO: Jerry Wickham
Alameda County Environmental Health
1131 Harbor Bay Parkway, Suite 250
Alameda, California 94502-6577

RECEIVED
8:58 am, Feb 22, 2010
Alameda County
Environmental Health

Please find enclosed: Draft Final
 Originals Other
 Prints
Sent via: Mail Same Day Courier
 Overnight Courier Other GeoTracker and Alameda County FTP

QUANTITY	DESCRIPTION
1	Groundwater Monitoring Report - Fourth Quarter 2009

As Requested For Review and Comment
 For Your Use _____

COMMENTS:
If you have any questions regarding the content of this document, please contact Peter Schaefer at (510) 420-3319.

Copy to: Denis Brown, Shell Oil Products US, 20945 S. Wilmington Avenue, Carson, CA 90810
SF Data Room (electronic copy)
Completed by: Peter Schaefer Signed: *Peter Schaefer*
Filing: Correspondence File



Jerry Wickham
Alameda County Environmental Health
1131 Harbor Bay Parkway, Suite 250
Alameda, California 94502-6577

Denis L. Brown
Shell Oil Products US
HSE - Environmental Services
20945 S. Wilmington Ave.
Carson, CA 90810-1039
Tel (707) 865 0251
Fax (707) 865 2542
Email denis.l.brown@shell.com

Re: Shell-branded Service Station
2120 Montana Street
Oakland, California
SAP Code 135675
Incident No. 98995740
ACEH Case No. RO0000173

Dear Mr. Wickham:

The attached document is provided for your review and comment. Upon information and belief, I declare, under penalty of perjury, that the information contained in the attached document is true and correct.

If you have any questions or concerns, please call me at (707) 865-0251.

Sincerely,

A handwritten signature in black ink, appearing to read "Denis L. Brown", is written over a horizontal line.

Denis L. Brown
Project Manager



GROUNDWATER MONITORING REPORT - FOURTH QUARTER 2009

**SHELL-BRANDED SERVICE STATION
2120 MONTANA STREET
OAKLAND, CALIFORNIA**

**SAP CODE 135675
INCIDENT NO. 98995740
AGENCY NO. RO0000173**

**FEBRUARY 19, 2010
REF. NO. 240733 (10)**

This report is printed on recycled paper.

**Prepared by:
Conestoga-Rovers
& Associates**

5900 Hollis Street, Suite A
Emeryville, California
U.S.A. 94608

Office: (510) 420-0700
Fax: (510) 420-9170

web: <http://www.CRAworld.com>

TABLE OF CONTENTS

	<u>Page</u>
1.0 INTRODUCTION.....	1
1.1 SITE INFORMATION	1
2.0 SITE ACTIVITIES, FINDINGS, AND DISCUSSION.....	1
2.1 CURRENT QUARTER'S ACTIVITIES.....	1
2.2 CURRENT QUARTER'S FINDINGS	2
2.3 PROPOSED ACTIVITIES.....	2

LIST OF FIGURES
(Following Text)

FIGURE 1 VICINITY MAP

FIGURE 2 GROUNDWATER CONTOUR AND CHEMICAL CONCENTRATION MAP

LIST OF APPENDICES

APPENDIX A BLAINE TECH SERVICES, INC. - GROUNDWATER MONITORING
REPORT

1.0 INTRODUCTION

Conestoga-Rovers & Associates (CRA) prepared this report on behalf of Equilon Enterprises LLC dba Shell Oil Products US (Shell).

1.1 SITE INFORMATION

Site Address	2120 Montana Street, Oakland
Site Use	Shell-branded Service Station
Shell Project Manager	Denis Brown
CRA Project Manager	Peter Schaefer
Lead Agency and Contact	ACEH, Jerry Wickham
Agency Case No.	RO0000173
Shell SAP Code	135675
Shell Incident No.	98995740

Date of most recent agency correspondence was July 24, 2009.

2.0 SITE ACTIVITIES, FINDINGS, AND DISCUSSION

2.1 CURRENT QUARTER'S ACTIVITIES

Blaine Tech Services, Inc. (Blaine) gauged and sampled the wells according to the established monitoring program for this site.

CRA prepared a vicinity map (Figure 1) and a groundwater contour and chemical concentration map (Figure 2). Blaine's report, presenting the analytical data, is included in Appendix A.

CRA's June 8, 2009 *Self-Monitoring Report - First Semi-Annual 2009* to the East Bay Municipal Utilities District (EBMUD) requested cancellation of the discharge permit for the groundwater extraction and treatment system. EBMUD's November 9, 2009 electronic correspondence confirmed cancellation of the permit. In November 2009, CRA demolished the groundwater treatment system.

2.2 CURRENT QUARTER'S FINDINGS

Groundwater Flow Direction	Generally southwesterly
Hydraulic Gradient	0.03
Depth to Water	9.85 to 13.35 feet below top of well casing

2.3 PROPOSED ACTIVITIES

Blaine will gauge and sample wells according to the established monitoring program for this site. This site is monitored semiannually during the second and fourth quarters, and CRA will issue groundwater monitoring reports semiannually following the sampling events.

All of Which is Respectfully Submitted,
CONESTOGA-ROVERS & ASSOCIATES



Peter Schaefer, CHG, CEG



Aubrey K. Cool, PG

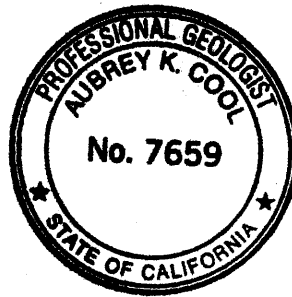

FIGURES

I:\Shell\6-chars\2407--\240733-Oakland 2120 Montana\240733-FIGURES\240733 VICINITY.A1

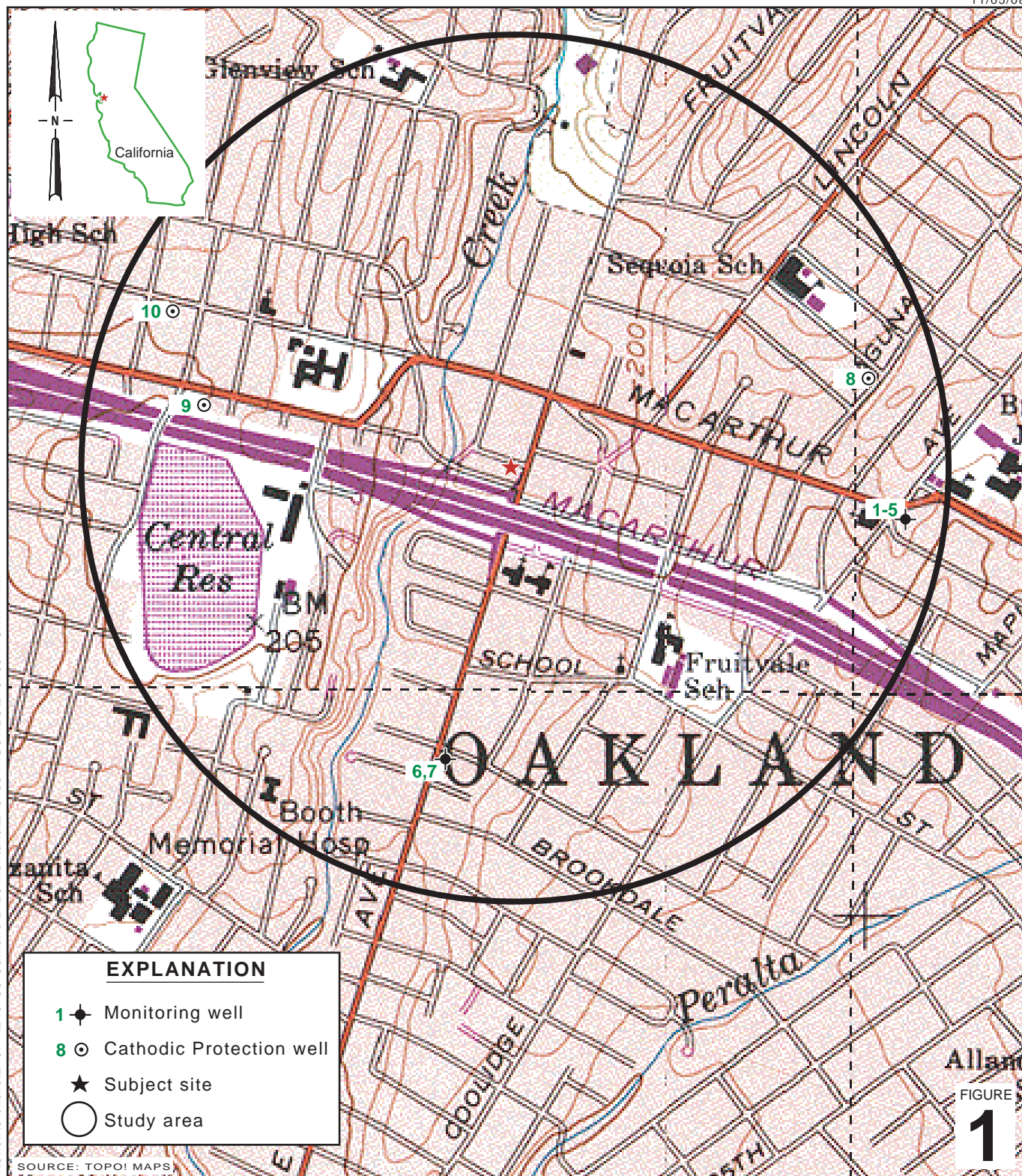

FIGURE 1

Shell-branded Service Station
2120 Montana Street
Oakland, California



**CONESTOGA-ROVERS
& ASSOCIATES**

Vicinity Map

EXPLANATION

- EW-1** Extraction well location
- MW-1** Well formerly used for groundwater extraction
- MW-2** Monitoring well location
- TBW-N** Tank backfill well location
- SV-D** Soil vapor sampling location (06/14-16/05)
- SV-A** Attempted soil vapor sampling location (6/14/05)
- INF** GWE system sampling location

- Remediation piping (R)
- Discharge line (D)
- Electrical line (E)
- Overhead electric line (OE)
- Sanitary sewer (SS)
- Water line (W)
- Telecommunications line (T)

- Product dispenser number
- Groundwater flow direction and gradient
- Groundwater elevation contour, in feet above mean sea level (msl)

- Well** Well designation
- ELEV** Groundwater elevation, in feet above msl
- Benzene** Benzene and MTBE concentrations are in micrograms per liter
- MTBE**

Notes:
ND = Not detected

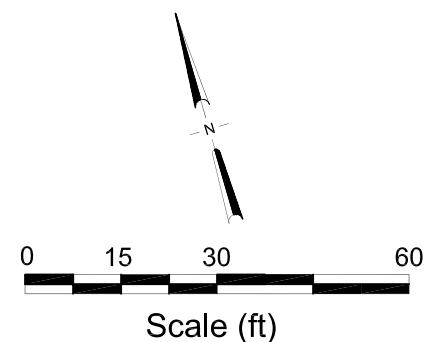
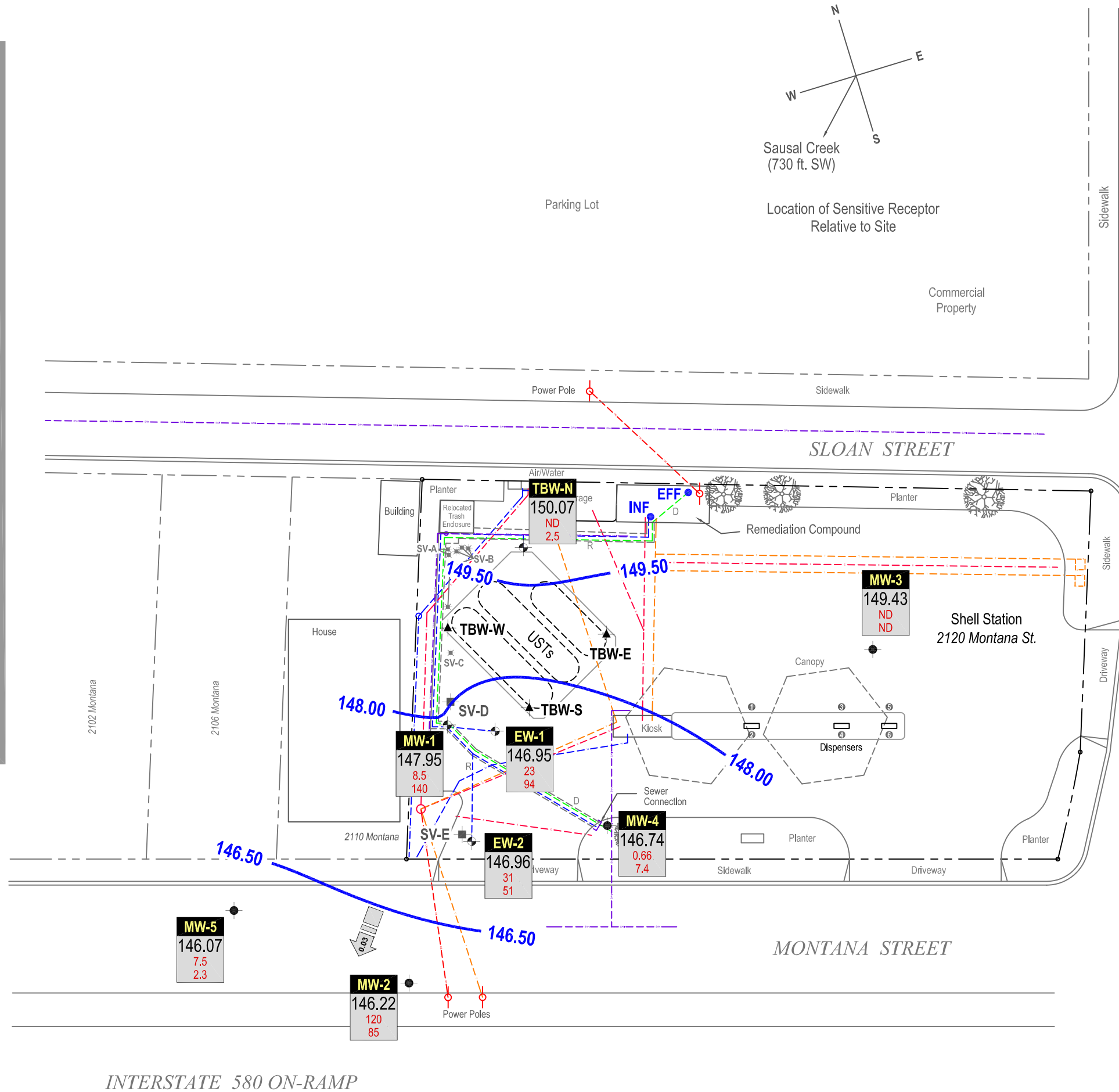
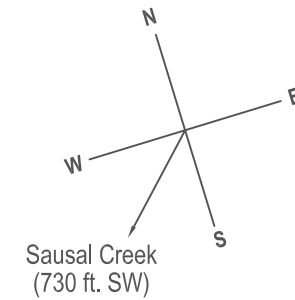

FIGURE

2



CONESTOGA-ROVERS & ASSOCIATES

I:\Shell16-chars\2407--\240733-Oakland 2120 Montana\240733-REPORTS\240733-RPT10-Q09\240733-QM09-GW.DWG

APPENDIX A

BLAINE TECH SERVICES, INC. -
GROUNDWATER MONITORING REPORT

BLAINE
TECH SERVICES INC.

GROUNDWATER SAMPLING SPECIALISTS
SINCE 1985

January 14, 2010

Denis Brown
Shell Oil Products US
20945 South Wilmington Avenue
Carson, CA 90810

Fourth Quarter 2009 Groundwater Monitoring at
Shell-branded Service Station
2120 Montana Street
Oakland, CA

Monitoring performed on December 28, 2009

Groundwater Monitoring Report **091228-FS-1**

This report covers the routine monitoring of groundwater wells at this Shell-branded facility. In accordance with standard procedures that conform to Regional Water Quality Control Board requirements, routine field data collection includes depth to water, total well depth, thickness of any separate immiscible layer, water column volume, calculated purge volume (if applicable), elapsed evacuation time (if applicable), total volume of water removed (if applicable), and standard water parameter instrument readings. Sample material is collected, contained, stored, and transported to the laboratory in conformance with EPA standards. Purgewater (if applicable) is, likewise, collected and transported to the Martinez Refining Company.

Basic field information is presented alongside analytical values excerpted from the laboratory report in the cumulative table of **WELL CONCENTRATIONS**. The full analytical report for the most recent samples and the field data sheets are attached to this report.

At a minimum, Blaine Tech Services, Inc. field personnel are certified on completion of a forty-hour Hazardous Materials and Emergency Response training course per 29 CFR 1910.120. Field personnel are also enrolled in annual eight-hour refresher courses.

Blaine Tech Services, Inc. conducts sampling and documentation assignments of this type as an independent third party. Our activities at this site consisted of objective data and sample collection only. No interpretation of analytical results, defining of hydrological conditions or formulation of recommendations was performed.

Please call if you have any questions.

Yours truly,



Mike Ninokata
Project Manager

MN/np

attachments: Cumulative Table of WELL CONCENTRATIONS
Certified Analytical Report
Field Data Sheets

cc: Anni Kreml
Conestoga-Rovers & Associates
5900 Hollis Street, Suite A
Emeryville, CA 94608

WELL CONCENTRATIONS
Shell-branded Service Station
2120 Montana Street
Oakland, CA

Well ID	Date	TPPH (ug/L)	B (ug/L)	T (ug/L)	E (ug/L)	X (ug/L)	MTBE 8020 (ug/L)	MTBE 8260 (ug/L)	DIPE (ug/L)	ETBE (ug/L)	TAME (ug/L)	TBA (ug/L)	TOC (MSL)	Depth to Water (ft.)	GW Elevation (MSL)	SPH Thickness (ft.)
MW-1	03/19/2001	NA	NA	NA	NA	NA	NA	NA	NA	NA	NA	NA	159.59	12.14	147.45	ND
MW-1	03/23/2001	16,600	753	1,720	407	2,330	NA	27,500	NA	NA	NA	NA	159.59	12.25	147.34	ND
MW-1	05/31/2001	<20,000 d	1,000 d	920 d	490 d	2,000 d	NA	54,000 d	NA	NA	NA	NA	161.13	12.22	148.91	ND
MW-1	06/27/2001	NA	NA	NA	NA	NA	NA	NA	NA	NA	NA	NA	159.59	13.00b	NA	ND
MW-1	07/09/2001	NA	NA	NA	NA	NA	NA	NA	NA	NA	NA	NA	159.59	13.17	146.67	0.31
MW-1	09/25/2001	NA	NA	NA	NA	NA	NA	NA	NA	NA	NA	NA	159.59	14.27	145.66	0.43
MW-1	11/20/2001	NA	NA	NA	NA	NA	NA	NA	NA	NA	NA	NA	159.59	13.49	146.14	0.05
MW-1	12/05/2001	NA	NA	NA	NA	NA	NA	NA	NA	NA	NA	NA	159.59	11.32	148.31	0.05
MW-1	03/01/2002	NA	NA	NA	NA	NA	NA	NA	NA	NA	NA	NA	159.59	13.22	146.56	0.24
MW-1	06/06/2002	NA	NA	NA	NA	NA	NA	NA	NA	NA	NA	NA	159.59	12.99	147.00	0.50
MW-1	07/16/2002	NA	NA	NA	NA	NA	NA	NA	NA	NA	NA	NA	159.59	13.37	146.22	ND
MW-1	09/06/2002	NA	NA	NA	NA	NA	NA	NA	NA	NA	NA	NA	159.57	13.30	146.70	0.54
MW-1	12/12/2002	NA	NA	NA	NA	NA	NA	NA	NA	NA	NA	NA	159.57	13.78	146.61	1.03
MW-1	03/31/2003	NA	NA	NA	NA	NA	NA	NA	NA	NA	NA	NA	159.57	11.21	148.38	0.03
MW-1	06/30/2003	7,800	<25	37	<25	380	NA	2,000	NA	NA	NA	NA	159.57	12.20	147.37	ND
MW-1	09/09/2003	NA	NA	NA	NA	NA	NA	NA	NA	NA	NA	NA	159.08	15.70	145.28	2.38
MW-1	12/29/2003	NA	NA	NA	NA	NA	NA	NA	NA	NA	NA	NA	159.08	11.25	147.89	0.07
MW-1	03/17/2004	NA	NA	NA	NA	NA	NA	NA	NA	NA	NA	NA	159.08	11.80	147.40	0.15
MW-1	05/24/2004	NA	NA	NA	NA	NA	NA	NA	NA	NA	NA	NA	159.08	12.42	146.71	0.06
MW-1	09/17/2004	8,000	530	380	330	960	NA	1,100	<20	<20	<20	4,100	159.08	15.95	143.13	ND
MW-1	12/06/2004	2,800	150	<5.0	120	120	NA	300	NA	NA	NA	NA	159.08	13.15	145.93	ND
MW-1	03/02/2005	13,000	490	710	360	2,200	NA	5,000	NA	NA	NA	NA	159.08	12.14	146.94	ND
MW-1	06/10/2005	5,600	210	120	120	910	NA	3,100	NA	NA	NA	NA	159.08	NA	NA	<0.01
MW-1	09/01/2005	<1,300	73	<13	30	42	NA	2,400	<50	<50	<50	13,000	159.08	11.71	147.37	ND
MW-1	11/16/2005	4,150	62.7	10.9	45.2	98.9	NA	845	NA	NA	NA	NA	159.08	11.71	147.37	ND
MW-1 i	03/03/2006	<50.0	<0.500	<0.500	<0.500	<0.500	NA	0.790	NA	NA	NA	<10.0	159.08	13.37	145.71	ND
MW-1	05/12/2006	3,430	80.0	0.530	26.8	71.9	NA	154	NA	NA	NA	1,040	159.08	17.41	141.67	ND

WELL CONCENTRATIONS
Shell-branded Service Station
2120 Montana Street
Oakland, CA

Well ID	Date	TPPH (ug/L)	B (ug/L)	T (ug/L)	E (ug/L)	X (ug/L)	MTBE 8020 (ug/L)	MTBE 8260 (ug/L)	DIPE (ug/L)	ETBE (ug/L)	TAME (ug/L)	TBA (ug/L)	TOC (MSL)	Depth to Water (ft.)	GW Elevation (MSL)	SPH Thickness (ft.)
MW-1	09/05/2006	5,390	24.8	2.44	6.69	22.2	NA	106	<0.500	<0.500	<0.500	4,860	159.08	12.12	146.96	ND
MW-1	12/18/2006	6,800	120	28	110	840	NA	1,100	NA	NA	NA	5,400	159.08	10.74	148.34	ND
MW-1	03/21/2007	Well inaccessible		NA	NA	NA	NA	NA	NA	NA	NA	NA	159.08	NA	NA	ND
MW-1	06/14/2007	6,200	18	<5.0	11	4.6 k	NA	68	NA	NA	NA	1,800	159.08	19.82	139.26	ND
MW-1	08/27/2007	2,700 l	13	<5.0	3.9 k	5.6 k	NA	54	<10	<10	<10	1,200	159.08	12.20	146.88	ND
MW-1	11/29/2007	2,600 l	20	1.9 k	8.3	29.4	NA	350	NA	NA	NA	4,100	159.08	11.68	147.40	ND
MW-1	03/21/2008	4,600	42	<5.0	120	94	NA	300	NA	NA	NA	3,200	159.08	11.59	147.49	ND
MW-1	05/29/2008	1,800	11	<5.0	<5.0	<5.0	NA	150	NA	NA	NA	3,900	159.08	11.87	147.21	ND
MW-1	08/29/2008	2,400	42	<5.0	23	<5.0	NA	320	<10	<10	<10	4,700	159.08	12.33	146.75	ND
MW-1	12/29/2008	2,700	30	<5.0	28	45	NA	460	NA	NA	NA	3,300	159.08	11.21	147.87	ND
MW-1	03/05/2009	2,000	15	<5.0	<5.0	66	NA	83	NA	NA	NA	980	159.08	8.98	150.10	ND
MW-1	05/27/2009	2,100	25	<1.0	69	52	NA	220	NA	NA	NA	2,500	159.08	11.71	147.37	ND
MW-1	12/28/2009	1,500	8.5	<2.0	8.8	7.4	NA	140	<4.0	<4.0	<4.0	1,800	159.08	11.13	147.95	ND
MW-2	03/19/3001	NA	NA	NA	NA	NA	NA	NA	NA	NA	NA	NA	158.03	11.60	146.43	ND
MW-2	03/23/2001	4,450	280	41.0	62.1	63.0	NA	16,600	NA	NA	NA	NA	158.03	11.76	146.27	ND
MW-2	05/31/2001	<20,000 a	820 a	<200 a	<200 a	<200 a	NA	63,000 a	NA	NA	NA	NA	158.03	11.40	146.63	ND
MW-2	06/27/2001	<50,000	610	4.0	13	9.2	NA	47,000	NA	NA	NA	NA	158.03	12.65	145.38	ND
MW-2	09/25/2001	<2,000	41	<20	<20	<20	NA	6,400	NA	NA	NA	NA	158.03	12.89	145.14	ND
MW-2	12/05/2001	<2,000	74	<20	<20	<20	NA	8,400	NA	NA	NA	NA	158.03	10.40	147.63	ND
MW-2	03/01/2002	<1,000	<10	<10	<10	<10	NA	2,900	NA	NA	NA	NA	158.03	11.52	146.51	ND
MW-2	06/06/2002	<5,000	210	<50	<50	<50	NA	23,000	NA	NA	NA	NA	158.03	12.15	145.88	ND
MW-2	07/16/2002	NA	NA	NA	NA	NA	NA	NA	NA	NA	NA	NA	158.03	12.25	145.78	ND
MW-2	09/06/2002	<2,000	56	<20	<20	<20	NA	11,000	NA	NA	NA	NA	158.01	12.44	145.57	ND
MW-2	12/12/2002	<2,500	80	<25	<25	<25	NA	13,000	NA	NA	NA	NA	158.01	12.53	145.48	ND
MW-2	03/31/2003	<5,000	230	1,200	95	150	NA	13,000	NA	NA	NA	NA	158.01	11.98	146.03	ND
MW-2	06/30/2003	<12,000	780	<120	170	250	NA	9,000	NA	NA	NA	NA	158.01	12.10	145.91	ND
MW-2	09/09/2003	140,000	4,600	40,000	4,800	32,000	NA	11,000	NA	NA	NA	NA	158.01	12.94	145.07	ND

WELL CONCENTRATIONS
Shell-branded Service Station
2120 Montana Street
Oakland, CA

Well ID	Date	TPPH (ug/L)	B (ug/L)	T (ug/L)	E (ug/L)	X (ug/L)	MTBE 8020 (ug/L)	MTBE 8260 (ug/L)	DIPE (ug/L)	ETBE (ug/L)	TAME (ug/L)	TBA (ug/L)	TOC (MSL)	Depth to Water (ft.)	GW Elevation (MSL)	SPH Thickness (ft.)
MW-2	12/29/2003	220,000	240	4,800	2,900	19,000	NA	1,000	NA	NA	NA	NA	158.01	11.20	146.81	ND
MW-2	03/17/2004	25,000	170	390	280	1,400	NA	1,500	NA	NA	NA	NA	158.01	11.40	146.61	ND
MW-2	05/24/2004	140,000	<25	220	1,200	6,800	NA	320	NA	NA	NA	NA	158.01	12.28	145.73	ND
MW-2	09/17/2004	64,000	2,900	230	2,300	9,700	NA	6,300	<100	<100	<100	4,100	158.01	12.90	145.11	ND
MW-2	12/06/2004	47,000	1,200	46	1,300	6,000	NA	3,900	NA	NA	NA	NA	158.01	13.02	144.99	ND
MW-2	03/02/2005	85,000	1,600	81	1,900	6,900	NA	2,500	NA	NA	NA	NA	158.01	11.06	146.95	ND
MW-2	06/10/2005	100,000	450	<25	440	800	NA	300	NA	NA	NA	NA	158.01	11.71	146.30	ND
MW-2	09/01/2005	140,000 g	490	<25	550	850	NA	110	<100	<100	<100	1,900	158.01	12.11	145.90	ND
MW-2	11/16/2005	473,000 h	776	18.7	1,300	2,730	NA	374	NA	NA	NA	NA	158.01	12.15	145.86	ND
MW-2 i	03/03/2006	4,830	6.25	2.29	14.6	5.45	NA	106	NA	NA	NA	228	158.01	11.40	146.61	ND
MW-2	05/12/2006	7,610	1,200	27.9	858	396	NA	688	NA	NA	NA	681	158.01	14.22	143.79	ND
MW-2	09/05/2006	84,000	683	10.2	314	300	NA	96.7	<0.500	<0.500	<0.500	1,250	158.01	12.20	145.81	ND
MW-2	12/18/2006	19,000	230	6.2	130	64	NA	94	NA	NA	NA	1,600	158.01	11.03	146.98	ND
MW-2	03/21/2007	30,000	380	31	460	290	NA	95	NA	NA	NA	1,700	158.01	11.75	146.26	ND
MW-2	06/14/2007	Well inaccessible		NA	NA	NA	NA	NA	NA	NA	NA	NA	158.01	NA	NA	ND
MW-2	08/27/2007	83,000 l	220	8.7 k	99	24.5k	NA	<10	<20	<20	<20	980	158.01	12.54	145.47	ND
MW-2	11/29/2007	23,000 l	28	<10	20	<10	NA	<10	NA	NA	NA	1,200	158.01	11.77	146.24	ND
MW-2	03/21/2008	Well inaccessible		NA	NA	NA	NA	NA	NA	NA	NA	NA	158.01	NA	NA	ND
MW-2	05/29/2008	14,000	130	14	78	6.8	NA	130	NA	NA	NA	1,000	158.01	12.11	145.90	ND
MW-2	08/29/2008	14,000	120	10	23	6.6	NA	60	<10	<10	<10	810	158.01	12.32	145.69	ND
MW-2	12/29/2008	33,000	110	<10	15	<10	NA	58	NA	NA	NA	890	158.01	11.61	146.40	ND
MW-2	03/05/2009	22,000	250	55	130	60	NA	130	NA	NA	NA	1,200	158.01	9.60	148.41	ND
MW-2	05/27/2009	11,000	150	20	110	49	NA	110	NA	NA	NA	740	158.01	12.08	145.93	ND
MW-2	12/28/2009	20,000	120	9.5	16	11	NA	85	<10	<10	<10	720	158.01	11.79	146.22	ND
MW-3	03/19/3001	NA	NA	NA	NA	NA	NA	NA	NA	NA	NA	NA	161.13	11.42	149.71	ND
MW-3	03/23/2001	<50.0	<0.500	<0.500	<0.500	<0.500	NA	1.26	NA	NA	NA	NA	161.13	11.42	149.71	ND
MW-3	05/31/2001	<50 e	<0.50 e	<0.50 e	<0.50 e	<0.50 e	NA	<5.0 e	NA	NA	NA	NA	159.59	13.00	146.59	ND

WELL CONCENTRATIONS
Shell-branded Service Station
2120 Montana Street
Oakland, CA

Well ID	Date	TPPH (ug/L)	B (ug/L)	T (ug/L)	E (ug/L)	X (ug/L)	MTBE 8020 (ug/L)	MTBE 8260 (ug/L)	DIPE (ug/L)	ETBE (ug/L)	TAME (ug/L)	TBA (ug/L)	TOC (MSL)	Depth to Water (ft.)	GW Elevation (MSL)	SPH Thickness (ft.)
MW-3	9/25/2001	<50	<0.50	<0.50	<0.50	<0.50	NA	<0.50	NA	NA	NA	NA	161.13	12.50	148.63	ND
MW-3	12/5/2001	<50	<0.50	<0.50	<0.50	<0.50	NA	<5.0	NA	NA	NA	NA	161.13	10.13	151.00	ND
MW-3	3/1/2002	<50	<0.50	<0.50	<0.50	0.73	NA	<5.0	NA	NA	NA	NA	161.13	11.63	149.50	ND
MW-3	6/6/2002	<50	<0.50	<0.50	<0.50	<0.50	NA	<5.0	NA	NA	NA	NA	161.13	11.55	149.58	ND
MW-3	7/16/2002	NA	NA	NA	NA	NA	NA	NA	NA	NA	NA	NA	161.13	11.72	149.41	ND
MW-3	9/6/2002	<50	<0.50	<0.50	<0.50	<0.50	NA	<5.0	NA	NA	NA	NA	161.11	12.24	148.87	ND
MW-3	12/12/2002	<50	<0.50	<0.50	<0.50	<0.50	NA	<5.0	NA	NA	NA	NA	161.11	12.18	148.93	ND
MW-3	3/31/2003	<50	<0.50	<0.50	<0.50	<1.0	NA	0.78	NA	NA	NA	NA	161.11	11.94	149.17	ND
MW-3	6/30/2003	<50	<0.50	<0.50	<0.50	<1.0	NA	<0.50	NA	NA	NA	NA	161.11	12.50	148.61	ND
MW-3	9/9/2003	<50	<0.50	<0.50	<0.50	<1.0	NA	<0.50	NA	NA	NA	NA	161.11	12.55	148.56	ND
MW-3	12/29/2003	<50	<0.50	<0.50	<0.50	<1.0	NA	0.70	NA	NA	NA	NA	161.11	10.90	150.21	ND
MW-3	3/17/2004	<50	<0.50	<0.50	<0.50	<1.0	NA	2.1	NA	NA	NA	NA	161.11	11.63	149.48	ND
MW-3	5/24/2004	<50	<0.50	<0.50	<0.50	1.0	NA	0.96	NA	NA	NA	NA	161.11	11.32	149.79	ND
MW-3	9/17/2004	<50	<0.50	<0.50	<0.50	1.0	NA	2.6	<2.0	<2.0	<2.0	<5.0	161.11	12.13	148.98	ND
MW-3	12/6/2004	<50	<0.50	<0.50	<0.50	<1.0	NA	6.1	NA	NA	NA	NA	161.11	12.28	148.83	ND
MW-3	3/2/2005	<50 f	<0.50	<0.50	<0.50	<1.0	NA	2.4	NA	NA	NA	NA	161.11	10.42	150.69	ND
MW-3	6/10/2005	<50 f	<0.50	<0.50	<0.50	<1.0	NA	1.6	NA	NA	NA	NA	161.11	11.15	149.96	ND
MW-3	9/1/2005	<50	<0.50	<0.50	<0.50	<1.0	NA	0.54	<2.0	<2.0	<2.0	<5.0	161.11	12.55	148.56	ND
MW-3	11/16/2005	<50.0	<0.500	<0.500	<0.500	<0.500	NA	0.570	NA	NA	NA	NA	161.11	12.04	149.07	ND
MW-3 i	3/3/2006	16,000 j	191	107 j	127	997 j	NA	1090 j	NA	NA	NA	NA	161.11	10.36	150.75	ND
MW-3	5/12/2006	<50.0	<0.500	<0.500	<0.500	<0.500	NA	1.45	NA	NA	NA	NA	161.11	12.24	148.87	ND
MW-3	9/5/2006	<50.0	<0.500	<0.500	<0.500	<0.500	NA	1.62	<0.500	<0.500	<0.500	<10.0	161.11	12.52	148.59	ND
MW-3	12/18/2006	<50	<0.50	<0.50	<0.50	<1.0	NA	0.88	NA	NA	NA	NA	161.11	11.00	150.11	ND
MW-3	3/21/2007	<50	<0.50	<0.50	<0.50	<1.0	NA	<1.0	NA	NA	NA	NA	161.11	12.10	149.01	ND
MW-3	6/14/2007	100	<0.50	<1.0	<1.0	<1.0	NA	2.4	NA	NA	NA	NA	161.11	12.08	149.03	ND
MW-3	8/27/2007	<50 l	<0.50	<1.0	<1.0	<1.0	NA	1.3	<2.0	<2.0	<2.0	<10	161.11	12.54	148.57	ND
MW-3	11/29/2007	<50 l	<0.50	<1.0	<1.0	<1.0	NA	0.52 k	NA	NA	NA	NA	161.11	12.09	149.02	ND
MW-3	3/21/2008	<50	<0.50	<1.0	<1.0	<1.0	NA	<1.0	NA	NA	NA	NA	161.11	12.20	148.91	ND

WELL CONCENTRATIONS
Shell-branded Service Station
2120 Montana Street
Oakland, CA

Well ID	Date	TPPH (ug/L)	B (ug/L)	T (ug/L)	E (ug/L)	X (ug/L)	MTBE 8020 (ug/L)	MTBE 8260 (ug/L)	DIPE (ug/L)	ETBE (ug/L)	TAME (ug/L)	TBA (ug/L)	TOC (MSL)	Depth to Water (ft.)	GW Elevation (MSL)	SPH Thickness (ft.)
MW-3	03/21/2008	<50	<0.50	<1.0	<1.0	<1.0	NA	<1.0	NA	NA	NA	NA	161.11	12.20	148.91	ND
MW-3	05/29/2008	<50	<0.50	<1.0	<1.0	<1.0	NA	<1.0	NA	NA	NA	NA	161.11	12.12	148.99	ND
MW-3	08/29/2008	<50	<0.50	<1.0	<1.0	<1.0	NA	<1.0	<2.0	<2.0	<2.0	<10	161.11	12.49	148.62	ND
MW-3	12/29/2008	<50	<0.50	<1.0	<1.0	<1.0	NA	<1.0	NA	NA	NA	NA	161.11	11.40	149.71	ND
MW-3	03/05/2009	<50	<0.50	<1.0	<1.0	<1.0	NA	<1.0	NA	NA	NA	NA	161.11	9.50	151.61	ND
MW-3	05/27/2009	<50	<0.50	<1.0	<1.0	<1.0	NA	<1.0	NA	NA	NA	NA	161.11	11.83	149.28	ND
MW-3	12/28/2009	<50	<0.50	<1.0	<1.0	<1.0	NA	<1.0	<2.0	<2.0	<2.0	<10	161.11	11.68	149.43	ND

MW-4	07/10/2002	NA	NA	NA	NA	NA	NA	NA	NA	NA	NA	NA	NM	13.19	NA	ND
MW-4	07/16/2002	800	1.1	1.1	2.6	2.4	NA	450	NA	NA	NA	NA	NM	13.56	NA	ND
MW-4	09/06/2002	1,100	3.0	1.8	8.0	4.6	NA	110	NA	NA	NA	NA	160.09	13.67	146.42	ND
MW-4	12/12/2002	130	<0.50	<0.50	<0.50	<0.50	NA	940	NA	NA	NA	NA	160.09	14.06	146.03	ND
MW-4	03/31/2003	<250	<2.5	<2.5	<2.5	<5.0	NA	500	NA	NA	NA	NA	160.09	13.69	146.40	ND
MW-4	06/30/2003	3,100	5.3	<5.0	7.1	<10	NA	420	NA	NA	NA	NA	160.09	14.12	145.97	ND
MW-4	09/09/2003	1,400	2.4	2.0	2.6	3.2	NA	140	NA	NA	NA	NA	160.09	14.92	145.17	ND
MW-4	12/29/2003	2,700	10	6.2	20	11	NA	420	NA	NA	NA	NA	160.09	12.71	147.38	ND
MW-4	03/17/2004	1,900	6.9	3.0	33	22	NA	290	NA	NA	NA	NA	160.09	13.24	146.85	ND
MW-4	05/24/2004	1,800	<2.5	<2.5	<2.5	11	NA	44	NA	NA	NA	NA	160.09	14.03	146.06	ND
MW-4	09/17/2004	3,300	57	10	47	32	NA	310	<10	<10	<10	700	160.09	13.58	146.51	ND
MW-4	12/06/2004	4,700	9.4	3.8	34	12	NA	150	NA	NA	NA	NA	160.09	14.65	145.44	ND
MW-4	03/02/2005	<1,300	<13	<13	<13	<25	NA	150	NA	NA	NA	NA	160.09	12.67	147.42	ND
MW-4	06/10/2005	2,600	4.1	1.9	25	5.6	NA	61	NA	NA	NA	NA	160.09	13.11	146.98	ND
MW-4	09/01/2005	4,000 g	<13	<13	22	<25	NA	36	<50	<50	<50	<130	160.09	14.00	146.09	ND
MW-4	11/16/2005	4,740	3.23	1.75	12.8	6.06	NA	12.2	NA	NA	NA	NA	160.09	13.87	146.22	ND
MW-4 i	03/03/2006	79,300 j	649 j	37.2	470 j	326	NA	577 j	NA	NA	NA	NA	160.09	12.80	147.29	ND
MW-4	05/12/2006	2,750	8.03	<0.500	<0.500	<0.500	NA	244	NA	NA	NA	NA	160.09	16.26	143.83	ND
MW-4	09/05/2006	2,230	2.04	1.24	<0.500	1.50	NA	95.9	<0.500	<0.500	<0.500	239	160.09	13.92	146.17	ND
MW-4	12/18/2006	1,400	4.3	1.7	7.3	2.8	NA	140	NA	NA	NA	NA	160.09	12.71	147.38	ND

WELL CONCENTRATIONS
Shell-branded Service Station
2120 Montana Street
Oakland, CA

Well ID	Date	TPPH (ug/L)	B (ug/L)	T (ug/L)	E (ug/L)	X (ug/L)	MTBE 8020 (ug/L)	MTBE 8260 (ug/L)	DIPE (ug/L)	ETBE (ug/L)	TAME (ug/L)	TBA (ug/L)	TOC (MSL)	Depth to Water (ft.)	GW Elevation (MSL)	SPH Thickness (ft.)
MW-4	03/21/2007	540	0.68	0.51	4.0	<1.0	NA	140	NA	NA	NA	NA	160.09	13.35	146.74	ND
MW-4	06/14/2007	NA	NA	NA	NA	NA	NA	NA	NA	NA	NA	NA	160.09	19.02	141.07	ND
MW-4	08/27/2007	880 l,m	0.38 k	<1.0	<1.0	<1.0	NA	8.5	<2.0	<2.0	<2.0	98	160.09	13.92	146.17	ND
MW-4	11/29/2007	3,200 l	1.9	1.2	1.9	2.55 k	NA	<1.0	NA	NA	NA	NA	160.09	13.50	146.59	ND
MW-4	03/21/2008	350	<0.50	<1.0	<1.0	<1.0	NA	8.2	NA	NA	NA	NA	160.09	13.45	146.64	ND
MW-4	05/29/2008	1,800	1.6	<1.0	1.8	1.5	NA	13	NA	NA	NA	NA	160.09	13.73	146.36	ND
MW-4	08/29/2008	1,300	1.5	<1.0	1.2	1.3	NA	13	<2.0	<2.0	<2.0	54	160.09	14.08	146.01	ND
MW-4	12/29/2008	1,700	1.8	1.4	2.3	1.6	NA	8.9	NA	NA	NA	NA	160.09	13.13	146.96	ND
MW-4	03/05/2009	1,800	1.6	<1.0	<1.0	<1.0	NA	16	NA	NA	NA	NA	160.09	11.12	148.97	ND
MW-4	05/27/2009	2,000	4.6	1.8	3.5	2.2	NA	28	NA	NA	NA	NA	160.09	13.35	146.74	ND
MW-4	12/28/2009	1,100	0.66	<1.0	<1.0	<1.0	NA	7.4	<2.0	<2.0	<2.0	72	160.09	13.35	146.74	ND
MW-5	07/10/2002	NA	NA	NA	NA	NA	NA	NA	NA	NA	NA	NA	NM	12.22	NA	ND
MW-5	07/16/2002	6,100	65	7.2	100	130	NA	410	NA	NA	NA	NA	NM	12.50	NA	ND
MW-5	09/06/2002	5,900	100	8.1	41	32	NA	230	NA	NA	NA	NA	158.25	12.77	145.48	ND
MW-5	12/12/2002	4,900	70	5.7	25	17	NA	280	NA	NA	NA	NA	158.25	12.71	145.54	ND
MW-5	03/31/2003	6,400	61	4.9	23	13	NA	330	NA	NA	NA	NA	158.25	11.93	146.32	ND
MW-5	06/30/2003	3,400	18	<2.5	17	5.5	NA	47	NA	NA	NA	NA	158.25	11.97	146.28	ND
MW-5	09/09/2003	6,800	46	23	39	42	NA	67	NA	NA	NA	NA	158.25	12.44	145.81	ND
MW-5	12/29/2003	8,400	44	6.2	36	16	NA	60	NA	NA	NA	NA	158.25	11.38	146.87	ND
MW-5	03/17/2004	7,100	120	22	42	27	NA	300	NA	NA	NA	NA	158.25	11.68	146.57	ND
MW-5	05/24/2004	6,100	72	17	34	23	NA	110	NA	NA	NA	NA	158.25	12.30	145.95	ND
MW-5	09/17/2004	5,700	27	5.3	35	<10	NA	28	<20	<20	<20	<50	158.25	12.15	146.10	ND
MW-5	12/06/2004	4,500	11	<5.0	22	<10	NA	7.5	NA	NA	NA	NA	158.25	12.85	145.40	ND
MW-5	03/02/2005	6,500	14	<2.5	18	<5.0	NA	6.0	NA	NA	NA	NA	158.25	10.83	147.42	ND
MW-5	06/10/2005	5,300	19	2.4	17	4.3	NA	7.2	NA	NA	NA	NA	158.25	12.00	146.25	ND
MW-5	09/01/2005	1,900 g	5.3	<2.5	6.9	<5.0	NA	<2.5	<10	<10	<10	<25	158.25	12.30	145.95	ND
MW-5	11/16/2005	3,590	4.66	0.580	7.69	1.45	NA	1.13	NA	NA	NA	NA	158.25	12.58	145.67	ND

WELL CONCENTRATIONS
Shell-branded Service Station
2120 Montana Street
Oakland, CA

Well ID	Date	TPPH (ug/L)	B (ug/L)	T (ug/L)	E (ug/L)	X (ug/L)	MTBE 8020 (ug/L)	MTBE 8260 (ug/L)	DIPE (ug/L)	ETBE (ug/L)	TAME (ug/L)	TBA (ug/L)	TOC (MSL)	Depth to Water (ft.)	GW Elevation (MSL)	SPH Thickness (ft.)
MW-5	03/03/2006	5,760	7.08	0.960	8.46	2.18	NA	2.65	NA	NA	NA	NA	158.25	11.15	147.10	ND
MW-5	05/12/2006	1,960	3.66	<0.500	1.03	<0.500	NA	1.45	NA	NA	NA	NA	158.25	12.55	145.70	ND
MW-5	09/05/2006	3,730	4.23	0.780	3.19	0.790	NA	1.77	<0.500	<0.500	<0.500	32.9	158.25	12.70	145.55	ND
MW-5	12/18/2006	1,600	5.1	0.66	6.0	3.3	NA	<0.50	NA	NA	NA	NA	158.25	11.40	146.85	ND
MW-5	03/21/2007	210	1.7	<0.50	<0.50	<1.0	NA	<1.0	NA	NA	NA	NA	158.25	12.17	146.08	ND
MW-5	06/14/2007	2,300	1.5	<1.0	0.43 k	<1.0	NA	<1.0	NA	NA	NA	NA	158.25	13.50	144.75	ND
MW-5	08/27/2007	2,500 l,m	3.2	0.41 k	2.8	2.48 k	NA	<1.0	<2.0	<2.0	<2.0	6.8 k	158.25	12.55	145.70	ND
MW-5	11/29/2007	2,300 l	7.8	0.45 k	0.75 k	0.60 k	NA	<1.0	NA	NA	NA	NA	158.25	11.97	146.28	ND
MW-5	03/21/2008	1,400	24	5.5	1.8	2.2	NA	6.6	NA	NA	NA	NA	158.25	11.70	146.55	ND
MW-5	05/29/2008	1,400	33	2.9	<1.0	3.2	NA	6.9	NA	NA	NA	NA	158.25	12.27	145.98	ND
MW-5	08/29/2008	960	14	<1.0	<1.0	1.4	NA	4.3	<2.0	<2.0	<2.0	<10	158.25	12.46	145.79	ND
MW-5	12/29/2008	1,200	12	<1.0	<1.0	<1.0	NA	<1.0	NA	NA	NA	NA	158.25	11.80	146.45	ND
MW-5	03/05/2009	1,900	24	2.9	3.7	7.9	NA	<1.0	NA	NA	NA	NA	158.25	9.82	148.43	ND
MW-5	05/27/2009	1,400	23	1.7	2.0	4.9	NA	4.4	NA	NA	NA	NA	158.25	12.34	145.91	ND
MW-5	12/28/2009	980	7.5	<1.0	<1.0	<1.0	NA	2.3	<2.0	<2.0	<2.0	<10	158.25	12.18	146.07	ND
TBW-N	09/25/2001 c	120,000	3,200	2,800	4,000	18,000	NA	31,000	NA	NA	NA	NA	NM	12.25	NM	ND
TBW-N	11/20/2001	72,000	2,200	3,600	2,600	14,000	NA	35,000	NA	NA	NA	NA	NM	12.13	NM	ND
TBW-N	12/05/2001	76,000	1,600	3,200	2,900	15,000	NA	30,000	NA	NA	NA	NA	NM	11.51	NM	ND
TBW-N	03/01/2002	91,000	1,200	4,200	2,800	14,000	NA	29,000	NA	NA	NA	NA	NM	11.88	NM	ND
TBW-N	06/06/2002	100,000	2,100	8,200	3,400	17,000	NA	18,000	NA	NA	NA	NA	NM	12.48	NM	ND
TBW-N	07/16/2002	NA	NA	NA	NA	NA	NA	NA	NA	NA	NA	NA	NM	12.39	NM	ND
TBW-N	09/06/2002	69,000	870	4,800	2,300	11,000	NA	17,000	NA	NA	NA	NA	161.26	12.36	148.90	ND
TBW-N	12/12/2002	Well inaccessible		NA	NA	NA	NA	NA	NA	NA	NA	NA	161.26	NA	NA	NA
TBW-N	12/19/2002	110,000	1,900	13,000	3,100	18,000	NA	19,000	NA	NA	NA	NA	161.26	10.82	150.44	ND
TBW-N	03/31/2003	62,000	1,600	6,500	2,200	11,000	NA	11,000	NA	NA	NA	NA	161.26	10.63	150.63	ND
TBW-N	06/30/2003	260,000	7,700	<120	5,800	40,000	NA	8,400	NA	NA	NA	NA	161.26	11.51	149.75	ND
TBW-N	09/09/2003	NA	NA	NA	NA	NA	NA	NA	NA	NA	NA	NA	159.92	11.37	148.64	0.11

WELL CONCENTRATIONS
Shell-branded Service Station
2120 Montana Street
Oakland, CA

Well ID	Date	TPPH (ug/L)	B (ug/L)	T (ug/L)	E (ug/L)	X (ug/L)	MTBE 8020 (ug/L)	MTBE 8260 (ug/L)	DIPE (ug/L)	ETBE (ug/L)	TAME (ug/L)	TBA (ug/L)	TOC (MSL)	Depth to Water (ft.)	GW Elevation (MSL)	SPH Thickness (ft.)
TBW-N	12/29/2003	130,000	840	8,200	2,400	18,000	NA	5,400	NA	NA	NA	NA	159.92	10.40	149.52	ND
TBW-N	03/17/2004	32,000	440	1,500	580	4,500	NA	3,700	NA	NA	NA	NA	159.92	10.49	149.44	0.01
TBW-N	05/24/2004	110,000	380	2,600	1,600	11,000	NA	3,100	NA	NA	NA	NA	159.92	10.72	149.20	ND
TBW-N	09/17/2004	25,000	120	490	570	3,900	NA	490	<200	<200	<200	4,500	159.92	10.80	149.12	ND
TBW-N	12/06/2004	15,000	33	11	410	1,500	NA	200	NA	NA	NA	NA	159.92	11.00	148.92	ND
TBW-N	03/02/2005	7,900	15	<10	120	610	NA	460	NA	NA	NA	NA	159.92	10.58	149.34	ND
TBW-N	06/10/2005	1,200	<5.0	<5.0	13	25	NA	93	NA	NA	NA	NA	159.92	10.68	149.24	ND
TBW-N	09/01/2005	3,500 g	<10	<10	86	330	NA	47	<40	<40	<40	1,700	159.92	11.05	148.87	ND
TBW-N	11/16/2005	8,830	1.53	1.59	86.6	404	NA	35.0	NA	NA	NA	NA	159.92	10.95	148.97	ND
TBW-N	03/03/2006	955	<0.500	<0.500	1.25	<0.500	NA	70.4	NA	NA	NA	4,930	159.92	10.31	149.61	ND
TBW-N	05/12/2006	706	<0.500	<0.500	5.81	<0.500	NA	14.5	NA	NA	NA	488	159.92	10.73	149.19	ND
TBW-N	09/05/2006	1,230	<0.500	<0.500	6.05	2.68	NA	15.3	<0.500	<0.500	<0.500	265	159.92	11.46	148.46	ND
TBW-N	12/18/2006	290	0.68	<0.50	<0.50	<1.0	NA	37	NA	NA	NA	3,400	159.92	10.12	149.80	ND
TBW-N	03/21/2007	300	<0.50	<0.50	<0.50	<1.0	NA	15	NA	NA	NA	820	159.92	10.67	149.25	ND
TBW-N	06/14/2007	530	<0.50	<1.0	<1.0	<1.0	NA	7.7	NA	NA	NA	240	159.92	11.22	148.70	ND
TBW-N	08/27/2007	100 l	0.52	<1.0	<1.0	<1.0	NA	18	<2.0	<2.0	<2.0	40	159.92	11.44	148.48	ND
TBW-N	11/29/2007	130 l	0.19 k	<1.0	<1.0	<1.0	NA	7.8	NA	NA	NA	490	159.92	10.58	149.34	ND
TBW-N	03/21/2008	56	<0.50	<1.0	<1.0	<1.0	NA	9.3	NA	NA	NA	300	159.92	10.50	149.42	ND
TBW-N	05/29/2008	<50	<0.50	<1.0	<1.0	<1.0	NA	4.1	NA	NA	NA	140	159.92	10.66	149.26	ND
TBW-N	08/29/2008	54	<0.50	<1.0	<1.0	<1.0	NA	4.3	<2.0	<2.0	<2.0	89	159.92	10.88	149.04	ND
TBW-N	12/29/2008	93	<0.50	<1.0	<1.0	<1.0	NA	4.4	NA	NA	NA	740	159.92	10.17	149.75	ND
TBW-N	03/05/2009	93	<0.50	<1.0	<1.0	<1.0	NA	6.7	NA	NA	NA	1,900	159.92	8.62	151.30	ND
TBW-N	05/27/2009	<250	<2.5	<5.0	<5.0	<5.0	NA	<5.0	NA	NA	NA	160	159.92	10.44	149.48	ND
TBW-N	12/28/2009	<50	<0.50	<1.0	<1.0	<1.0	NA	2.5	<2.0	<2.0	<2.0	170	159.92	9.85	150.07	ND
EW-1	05/05/2006	NA	NA	NA	NA	NA	NA	NA	NA	NA	NA	NA	NA	15.42	NA	ND
EW-1	05/12/2006	5,550	52.9	30.2	86.9	249	NA	939	<0.500	<0.500	<0.500	3,900	NA	17.33	NA	ND
EW-1	09/05/2006	2,700	28.3	1.64	11.8	7.98	NA	325	<0.500	<0.500	<0.500	1,900	158.63	12.44	146.19	ND

WELL CONCENTRATIONS
Shell-branded Service Station
2120 Montana Street
Oakland, CA

Well ID	Date	TPPH (ug/L)	B (ug/L)	T (ug/L)	E (ug/L)	X (ug/L)	MTBE 8020 (ug/L)	MTBE 8260 (ug/L)	DIPE (ug/L)	ETBE (ug/L)	TAME (ug/L)	TBA (ug/L)	TOC (MSL)	Depth to Water (ft.)	GW Elevation (MSL)	SPH Thickness (ft.)
EW-1	12/18/2006	4,900	140	63	170	790	NA	640	NA	NA	NA	NA	158.63	11.00	147.63	ND
EW-1	03/21/2007	1,000	32	<2.5	14	48	NA	420	NA	NA	NA	NA	158.63	14.61	144.02	ND
EW-1	06/14/2007	2,100	14	1.1	5.0	9.3	NA	46	NA	NA	NA	NA	158.63	21.00	137.63	ND
EW-1	08/27/2007	97 l	<0.50	<1.0	<1.0	0.19 k	NA	3.6	<2.0	<2.0	<2.0	32	158.63	12.80	145.83	ND
EW-1	11/29/2007	7,600 l	110	36	190	1,390	NA	470	NA	NA	NA	NA	158.63	11.87	146.76	ND
EW-1	03/21/2008	7,300	160	14	400	630	NA	640	NA	NA	NA	NA	158.63	12.10	146.53	ND
EW-1	05/29/2008	3,600	93	6.0	190	124	NA	340	NA	NA	NA	NA	158.63	12.09	146.54	ND
EW-1	08/29/2008	1,100	15	1.5	78	36	NA	48	<2.0	<2.0	<2.0	190	158.63	12.65	145.98	ND
EW-1	12/29/2008	3,200	48	4.2	100	240	NA	180	NA	NA	NA	NA	158.63	11.45	147.18	ND
EW-1	03/05/2009	2,900	58	2.4	130	220	NA	280	NA	NA	NA	NA	158.63	8.48	150.15	ND
EW-1	05/27/2009	2,300	74	2.1	59	96	NA	160	NA	NA	NA	NA	158.63	11.90	146.73	ND
EW-1	12/28/2009	2,100	23	<1.0	93	96	NA	94	<2.0	<2.0	<2.0	400	158.63	11.68	146.95	ND

EW-2	05/05/2006	NA	NA	NA	NA	NA	NA	NA	NA	NA	NA	NA	NA	16.83	NA	ND
EW-2	05/12/2006	11,400	377	135	335	313	NA	401	<0.500	<0.500	<0.500	1,220	NA	15.91	NA	ND
EW-2	09/05/2006	1,810	41.1	4.52	17.2	74.0	NA	87.8	<0.500	<0.500	<0.500	606	157.51	11.21	146.30	ND
EW-2	12/18/2006	3,200	75	33	90	470	NA	130	NA	NA	NA	NA	157.51	9.93	147.58	ND
EW-2	03/21/2007	61	<0.50	<0.50	<0.50	1.5	NA	18	NA	NA	NA	NA	157.51	10.55	146.96	ND
EW-2	06/14/2007	570	3.8	<1.0	<1.0	<1.0	NA	10	NA	NA	NA	NA	157.51	12.82	144.69	ND
EW-2	08/27/2007	320 l	2.6	0.36 k	1.4	6.31 k	NA	10	<2.0	<2.0	<2.0	230	157.51	10.34	147.17	ND
EW-2	11/29/2007	72 l	0.83	0.53 k	0.49 k	1.41 k	NA	12	NA	NA	NA	NA	157.51	10.80	146.71	ND
EW-2	03/21/2008	250	3.5	<1.0	2.7	15.3	NA	62	NA	NA	NA	NA	157.51	10.80	146.71	ND
EW-2	05/29/2008	280	8.7	1.5	7.8	29.3	NA	46	NA	NA	NA	NA	157.51	10.86	146.65	ND
EW-2	08/29/2008	<50	<0.50	<1.0	<1.0	<1.0	NA	<1.0	<2.0	<2.0	<2.0	<10	157.51	9.81	147.70	ND
EW-2	12/29/2008	760	21	1.4	17	64	NA	37	NA	NA	NA	NA	157.51	10.37	147.14	ND
EW-2	03/05/2009	260	5.8	<1.0	8.4	30	NA	38	NA	NA	NA	NA	157.51	8.35	149.16	ND
EW-2	05/27/2009	580	27	2.4	25	79	NA	71	NA	NA	NA	NA	157.51	10.83	146.68	ND
EW-2	12/28/2009	780	31	1.6	31	67	NA	51	<2.0	<2.0	<2.0	270	157.51	10.55	146.96	ND

WELL CONCENTRATIONS
Shell-branded Service Station
2120 Montana Street
Oakland, CA

Well ID	Date	TPPH (ug/L)	B (ug/L)	T (ug/L)	E (ug/L)	X (ug/L)	MTBE 8020 (ug/L)	MTBE 8260 (ug/L)	DIPE (ug/L)	ETBE (ug/L)	TAME (ug/L)	TBA (ug/L)	TOC (MSL)	Depth to Water (ft.)	GW Elevation (MSL)	SPH Thickness (ft.)
---------	------	----------------	-------------	-------------	-------------	-------------	------------------------	------------------------	----------------	----------------	----------------	---------------	--------------	----------------------------	--------------------------	---------------------------

Abbreviations:

TPPH = Total petroleum hydrocarbons as gasoline by EPA Method 8260B; prior to May 31, 2001, analyzed by EPA Method 8015.

BTEX = Benzene, toluene, ethylbenzene, xylenes by EPA Method 8260B; prior to May 31, 2001, analyzed by EPA Method 8020.

MTBE = Methyl tertiary butyl ether

DIPE = Di-isopropyl ether, analyzed by EPA Method 8260B

ETBE = Ethyl tertiary butyl ether, analyzed by EPA Method 8260B

TAME = Tertiary amyl methyl ether, analyzed by EPA Method 8260B

TBA = Tertiary butyl alcohol, analyzed by EPA Method 8260B

TOC = Top of Casing Elevation

GW = Groundwater

TBW-N = tank backfill well-North

NA = Not analyzed

ND = Not detected

NM = Not measured

ug/L = parts per billion

MSL = Mean sea level

ft. = Feet

<n = Below detection limit

WELL CONCENTRATIONS
Shell-branded Service Station
2120 Montana Street
Oakland, CA

Well ID	Date	TPPH (ug/L)	B (ug/L)	T (ug/L)	E (ug/L)	X (ug/L)	MTBE 8020 (ug/L)	MTBE 8260 (ug/L)	DIPE (ug/L)	ETBE (ug/L)	TAME (ug/L)	TBA (ug/L)	TOC (MSL)	Depth to Water (ft.)	GW Elevation (MSL)	SPH Thickness (ft.)
---------	------	----------------	-------------	-------------	-------------	-------------	------------------------	------------------------	----------------	----------------	----------------	---------------	--------------	----------------------------	--------------------------	---------------------------

Notes:

a = Resampled on June 27, 2001 due to possible mislabeling.

b = Separate phase hydrocarbons encountered during purge; groundwater elevation may not be accurate.

c = Sample TBW-N was analyzed once within hold time, but the analyte concentrations all exceeded the instrument working ranges. The sample was diluted and re-analyzed out of hold time. The diluted analysis is reported because it more accurately reflects the concentrations present.

d = These results are listed as MW-3 on analytical report due to possible mislabeling in field or laboratory. Resampled on June 27, 2001, to confirm mislabeling.

e = These results are listed as MW-1 on analytical report due to possible mislabeling in field or laboratory. Resampled on June 27, 2001, to confirm mislabeling.

f = The concentration reported reflect(s) individual or discrete unidentified peaks not matching a typical fuel pattern.

g = Quantity of unknown hydrocarbon(s) in sample based on gasoline.

h = Concentration estimated. Analyte exceeded calibration range. Reanalysis not performed due to holding time requirements.

i = Several of the results were above the instrument calibration range and should be considered estimated values. The results from the different VOA vials were not consistent; therefore the highest results were reported.

j = Concentration exceeds the calibration range and therefore result is semi-quantitative.

k = Analyte was detected at a concentration below the reporting limit and above the laboratory method detection limit. Reported value is estimated.

l = Analyzed by EPA Method 8015B (M).

m = The sample chromatographic pattern for TPH does not match the chromatographic pattern of the specified standard. Quantitation of the unknown hydrocarbon(s) in the sample was based on Survey data provided by Cambria Environmental Technology, May 2001.

Site surveyed February 12, 2002 and June 26, 2002 by Virgil Chavez Land Surveying of Vallejo, CA.

Wells MW-1 and TBW-N surveyed September 23, 2003 by Virgil Chavez Land Surveying of Vallejo, CA.

When separate phase hydrocarbons are present, ground water elevation is adjusted using the relation:

Corrected groundwater elevation = Top-of-casing elevation - Depth to water + (0.8 x Hydrocarbon thickness).

Wells EW-1 and EW-2 surveyed July 7, 2006 by Virgil Chavez Land Surveying of Vallejo, CA.

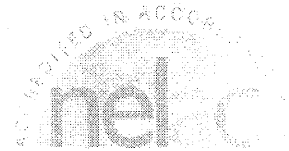
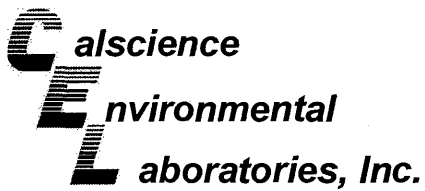

January 11, 2010

Michael Ninokata
Blaine Tech Services, Inc.
1680 Rogers Avenue
San Jose, CA 95112-1105

Subject: **Calscience Work Order No.:** 09-12-2290
Client Reference: 2120 Montana St., Oakland, CA

Dear Client:

Enclosed is an analytical report for the above-referenced project. The samples included in this report were received 12/30/2009 and analyzed in accordance with the attached chain-of-custody.

Unless otherwise noted, all analytical testing was accomplished in accordance with the guidelines established in our Quality Systems Manual, applicable standard operating procedures, and other related documentation. The original report of subcontracted analysis, if any, is provided herein, and follows the standard Calscience data package. The results in this analytical report are limited to the samples tested and any reproduction thereof must be made in its entirety.

If you have any questions regarding this report, please do not hesitate to contact the undersigned.

Sincerely,

A handwritten signature in cursive script that reads 'Philip Samelle for'.

Calscience Environmental
Laboratories, Inc.
Xuan H. Dang
Project Manager

Analytical Report



Blaine Tech Services, Inc.
 1680 Rogers Avenue
 San Jose, CA 95112-1105

Date Received: 12/30/09
 Work Order No: 09-12-2290
 Preparation: EPA 5030B
 Method: LUFT GC/MS / EPA 8260B
 Units: ug/L

Project: 2120 Montana St., Oakland, CA

Page 1 of 3

Client Sample Number	Lab Sample Number	Date/Time Collected	Matrix	Instrument	Date Prepared	Date/Time Analyzed	QC Batch ID
MW-1	09-12-2290-1-B	12/28/09 13:30	Aqueous	GC/MS U	01/04/10	01/05/10 01:49	100104L02

Parameter	Result	RL	DF	Qual	Parameter	Result	RL	DF	Qual
Benzene	8.5	1.0	2		Tert-Butyl Alcohol (TBA)	1800	20	2	
Ethylbenzene	8.8	2.0	2		Diisopropyl Ether (DIPE)	ND	4.0	2	
Toluene	ND	2.0	2		Ethyl-t-Butyl Ether (ETBE)	ND	4.0	2	
Xylenes (total)	7.4	2.0	2		Tert-Amyl-Methyl Ether (TAME)	ND	4.0	2	
Methyl-t-Butyl Ether (MTBE)	140	2.0	2		TPPH	1500	100	2	
Surrogates:	REC (%)	Control Limits	Qual		Surrogates:	REC (%)	Control Limits	Qual	
Dibromofluoromethane	95	80-132			1,2-Dichloroethane-d4	104	80-141		
Toluene-d8	104	80-120			Toluene-d8-TPPH	104	88-112		
1,4-Bromofluorobenzene	98	76-120							

Client Sample Number	Lab Sample Number	Date/Time Collected	Matrix	Instrument	Date Prepared	Date/Time Analyzed	QC Batch ID
MW-2	09-12-2290-2-B	12/28/09 10:30	Aqueous	GC/MS U	01/04/10	01/05/10 02:19	100104L02

Parameter	Result	RL	DF	Qual	Parameter	Result	RL	DF	Qual
Benzene	120	2.5	5		Tert-Butyl Alcohol (TBA)	720	50	5	
Ethylbenzene	16	5.0	5		Diisopropyl Ether (DIPE)	ND	10	5	
Toluene	9.5	5.0	5		Ethyl-t-Butyl Ether (ETBE)	ND	10	5	
Xylenes (total)	11	5.0	5		Tert-Amyl-Methyl Ether (TAME)	ND	10	5	
Methyl-t-Butyl Ether (MTBE)	85	5.0	5		TPPH	20000	250	5	
Surrogates:	REC (%)	Control Limits	Qual		Surrogates:	REC (%)	Control Limits	Qual	
Dibromofluoromethane	87	80-132			1,2-Dichloroethane-d4	92	80-141		
Toluene-d8	109	80-120			Toluene-d8-TPPH	109	88-112		
1,4-Bromofluorobenzene	104	76-120							

Client Sample Number	Lab Sample Number	Date/Time Collected	Matrix	Instrument	Date Prepared	Date/Time Analyzed	QC Batch ID
MW-3	09-12-2290-3-B	12/28/09 11:10	Aqueous	GC/MS U	01/04/10	01/05/10 02:50	100104L02

Parameter	Result	RL	DF	Qual	Parameter	Result	RL	DF	Qual
Benzene	ND	0.50	1		Tert-Butyl Alcohol (TBA)	ND	10	1	
Ethylbenzene	ND	1.0	1		Diisopropyl Ether (DIPE)	ND	2.0	1	
Toluene	ND	1.0	1		Ethyl-t-Butyl Ether (ETBE)	ND	2.0	1	
Xylenes (total)	ND	1.0	1		Tert-Amyl-Methyl Ether (TAME)	ND	2.0	1	
Methyl-t-Butyl Ether (MTBE)	ND	1.0	1		TPPH	ND	50	1	
Surrogates:	REC (%)	Control Limits	Qual		Surrogates:	REC (%)	Control Limits	Qual	
Dibromofluoromethane	97	80-132			1,2-Dichloroethane-d4	107	80-141		
Toluene-d8	98	80-120			Toluene-d8-TPPH	98	88-112		
1,4-Bromofluorobenzene	92	76-120							

RL - Reporting Limit , DF - Dilution Factor , Qual - Qualifiers

Analytical Report

Blaine Tech Services, Inc.
1680 Rogers Avenue
San Jose, CA 95112-1105

Date Received: 12/30/09
Work Order No: 09-12-2290
Preparation: EPA 5030B
Method: LUFT GC/MS / EPA 8260B
Units: ug/L

Project: 2120 Montana St., Oakland, CA

Page 2 of 3

Client Sample Number	Lab Sample Number	Date/Time Collected	Matrix	Instrument	Date Prepared	Date/Time Analyzed	QC Batch ID
MW-4	09-12-2290-4-B	12/28/09 13:55	Aqueous	GC/MS-U	01/04/10	01/05/10 04:22	100104L02

Parameter	Result	RL	DF	Qual	Parameter	Result	RL	DF	Qual
Benzene	0.66	0.50	1		Tert-Butyl Alcohol (TBA)	72	10	1	
Ethylbenzene	ND	1.0	1		Diisopropyl Ether (DIPE)	ND	2.0	1	
Toluene	ND	1.0	1		Ethyl-t-Butyl Ether (ETBE)	ND	2.0	1	
Xylenes (total)	ND	1.0	1		Tert-Amyl-Methyl Ether (TAME)	ND	2.0	1	
Methyl-t-Butyl Ether (MTBE)	7.4	1.0	1		TPPH	1100	50	1	
<u>Surrogates:</u>	<u>REC (%)</u>	<u>Control Limits</u>	<u>Qual</u>		<u>Surrogates:</u>	<u>REC (%)</u>	<u>Control Limits</u>	<u>Qual</u>	
Dibromofluoromethane	94	80-132			1,2-Dichloroethane-d4	100	80-141		
Toluene-d8	103	80-120			Toluene-d8-TPPH	103	88-112		
1,4-Bromofluorobenzene	97	76-120							

Client Sample Number	Lab Sample Number	Date/Time Collected	Matrix	Instrument	Date Prepared	Date/Time Analyzed	QC Batch ID
MW-5	09-12-2290-5-B	12/28/09 10:05	Aqueous	GC/MS-U	01/04/10	01/05/10 04:53	100104L02

Parameter	Result	RL	DF	Qual	Parameter	Result	RL	DF	Qual
Benzene	7.5	0.50	1		Tert-Butyl Alcohol (TBA)	ND	10	1	
Ethylbenzene	ND	1.0	1		Diisopropyl Ether (DIPE)	ND	2.0	1	
Toluene	ND	1.0	1		Ethyl-t-Butyl Ether (ETBE)	ND	2.0	1	
Xylenes (total)	ND	1.0	1		Tert-Amyl-Methyl Ether (TAME)	ND	2.0	1	
Methyl-t-Butyl Ether (MTBE)	2.3	1.0	1		TPPH	980	50	1	
<u>Surrogates:</u>	<u>REC (%)</u>	<u>Control Limits</u>	<u>Qual</u>		<u>Surrogates:</u>	<u>REC (%)</u>	<u>Control Limits</u>	<u>Qual</u>	
Dibromofluoromethane	91	80-132			1,2-Dichloroethane-d4	99	80-141		
Toluene-d8	106	80-120			Toluene-d8-TPPH	106	88-112		
1,4-Bromofluorobenzene	99	76-120							

Client Sample Number	Lab Sample Number	Date/Time Collected	Matrix	Instrument	Date Prepared	Date/Time Analyzed	QC Batch ID
TBW-N	09-12-2290-6-B	12/28/09 11:45	Aqueous	GC/MS-U	01/04/10	01/05/10 05:24	100104L02

Parameter	Result	RL	DF	Qual	Parameter	Result	RL	DF	Qual
Benzene	ND	0.50	1		Tert-Butyl Alcohol (TBA)	170	10	1	
Ethylbenzene	ND	1.0	1		Diisopropyl Ether (DIPE)	ND	2.0	1	
Toluene	ND	1.0	1		Ethyl-t-Butyl Ether (ETBE)	ND	2.0	1	
Xylenes (total)	ND	1.0	1		Tert-Amyl-Methyl Ether (TAME)	ND	2.0	1	
Methyl-t-Butyl Ether (MTBE)	2.5	1.0	1		TPPH	ND	50	1	
<u>Surrogates:</u>	<u>REC (%)</u>	<u>Control Limits</u>	<u>Qual</u>		<u>Surrogates:</u>	<u>REC (%)</u>	<u>Control Limits</u>	<u>Qual</u>	
Dibromofluoromethane	96	80-132			1,2-Dichloroethane-d4	107	80-141		
Toluene-d8	98	80-120			Toluene-d8-TPPH	99	88-112		
1,4-Bromofluorobenzene	93	76-120							

RL - Reporting Limit , DF - Dilution Factor , Qual - Qualifiers

Analytical Report

Blaine Tech Services, Inc.
1680 Rogers Avenue
San Jose, CA 95112-1105

Date Received: 12/30/09
Work Order No: 09-12-2290
Preparation: EPA 5030B
Method: LUFT GC/MS / EPA 8260B
Units: ug/L

Project: 2120 Montana St., Oakland, CA

Page 3 of 3

Client Sample Number	Lab Sample Number	Date/Time Collected	Matrix	Instrument	Date Prepared	Date/Time Analyzed	QC Batch ID
EW-1	09-12-2290-7-B	12/28/09 13:50	Aqueous	GC/MS-U	01/04/10	01/05/10 05:55	100104L02

Parameter	Result	RL	DF	Qual	Parameter	Result	RL	DF	Qual
Benzene	23	0.50	1		Tert-Butyl Alcohol (TBA)	400	10	1	
Ethylbenzene	93	1.0	1		Diisopropyl Ether (DIPE)	ND	2.0	1	
Toluene	ND	1.0	1		Ethyl-t-Butyl Ether (ETBE)	ND	2.0	1	
Xylenes (total)	96	1.0	1		Tert-Amyl-Methyl Ether (TAME)	ND	2.0	1	
Methyl-t-Butyl Ether (MTBE)	94	1.0	1		TPPH	2100	50	1	
<u>Surrogates:</u>	<u>REC (%)</u>	<u>Control Limits</u>	<u>Qual</u>		<u>Surrogates:</u>	<u>REC (%)</u>	<u>Control Limits</u>	<u>Qual</u>	
Dibromofluoromethane	87	80-132			1,2-Dichloroethane-d4	99	80-141		
Toluene-d8	103	80-120			Toluene-d8-TPPH	103	88-112		
1,4-Bromofluorobenzene	100	76-120							

Client Sample Number	Lab Sample Number	Date/Time Collected	Matrix	Instrument	Date Prepared	Date/Time Analyzed	QC Batch ID
EW-2	09-12-2290-8-B	12/28/09 12:35	Aqueous	GC/MS-U	01/04/10	01/05/10 06:25	100104L02

Parameter	Result	RL	DF	Qual	Parameter	Result	RL	DF	Qual
Benzene	31	0.50	1		Tert-Butyl Alcohol (TBA)	270	10	1	
Ethylbenzene	31	1.0	1		Diisopropyl Ether (DIPE)	ND	2.0	1	
Toluene	1.6	1.0	1		Ethyl-t-Butyl Ether (ETBE)	ND	2.0	1	
Xylenes (total)	67	1.0	1		Tert-Amyl-Methyl Ether (TAME)	ND	2.0	1	
Methyl-t-Butyl Ether (MTBE)	51	1.0	1		TPPH	780	50	1	
<u>Surrogates:</u>	<u>REC (%)</u>	<u>Control Limits</u>	<u>Qual</u>		<u>Surrogates:</u>	<u>REC (%)</u>	<u>Control Limits</u>	<u>Qual</u>	
Dibromofluoromethane	90	80-132			1,2-Dichloroethane-d4	102	80-141		
Toluene-d8	98	80-120			Toluene-d8-TPPH	99	88-112		
1,4-Bromofluorobenzene	100	76-120							

Client Sample Number	Lab Sample Number	Date/Time Collected	Matrix	Instrument	Date Prepared	Date/Time Analyzed	QC Batch ID
Method Blank	099-12-767-3-100	N/A	Aqueous	GC/MS-U	01/04/10	01/05/10 01:18	100104L02

Parameter	Result	RL	DF	Qual	Parameter	Result	RL	DF	Qual
Benzene	ND	0.50	1		Tert-Butyl Alcohol (TBA)	ND	10	1	
Ethylbenzene	ND	1.0	1		Diisopropyl Ether (DIPE)	ND	2.0	1	
Toluene	ND	1.0	1		Ethyl-t-Butyl Ether (ETBE)	ND	2.0	1	
Xylenes (total)	ND	1.0	1		Tert-Amyl-Methyl Ether (TAME)	ND	2.0	1	
Methyl-t-Butyl Ether (MTBE)	ND	1.0	1		TPPH	ND	50	1	
<u>Surrogates:</u>	<u>REC (%)</u>	<u>Control Limits</u>	<u>Qual</u>		<u>Surrogates:</u>	<u>REC (%)</u>	<u>Control Limits</u>	<u>Qual</u>	
Dibromofluoromethane	97	80-132			1,2-Dichloroethane-d4	108	80-141		
Toluene-d8	99	80-120			Toluene-d8-TPPH	100	88-112		
1,4-Bromofluorobenzene	93	76-120							

RL - Reporting Limit , DF - Dilution Factor , Qual - Qualifiers

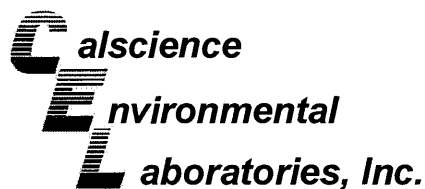

Quality Control - Spike/Spike Duplicate



Blaine Tech Services, Inc.
1680 Rogers Avenue
San Jose, CA 95112-1105

Date Received: 12/30/09
Work Order No: 09-12-2290
Preparation: EPA 5030B
Method: LUFT GC/MS / EPA
8260B

Project 2120 Montana St., Oakland, CA

Quality Control Sample ID	Matrix	Instrument	Date Prepared	Date Analyzed	MS/MSD Batch Number
MW-3	Aqueous	GC/MS U	01/04/10	01/05/10	100104S02

Parameter	MS %REC	MSD %REC	%REC CL	RPD	RPD CL	Qualifiers
Benzene	95	98	72-120	4	0-20	
Carbon Tetrachloride	97	102	63-135	5	0-20	
Chlorobenzene	95	99	80-120	4	0-20	
1,2-Dibromoethane	92	98	80-120	7	0-20	
1,2-Dichlorobenzene	95	100	80-120	5	0-20	
1,1-Dichloroethene	87	89	60-132	3	0-24	
Ethylbenzene	104	108	78-120	4	0-20	
Toluene	93	97	74-122	4	0-20	
Trichloroethene	97	99	69-120	2	0-20	
Vinyl Chloride	90	95	58-130	6	0-20	
Methyl-t-Butyl Ether (MTBE)	103	109	72-126	6	0-21	
Tert-Butyl Alcohol (TBA)	104	108	72-126	4	0-20	
Diisopropyl Ether (DIPE)	100	105	71-137	5	0-23	
Ethyl-t-Butyl Ether (ETBE)	105	110	74-128	5	0-20	
Tert-Amyl-Methyl Ether (TAME)	102	108	76-124	5	0-20	
Ethanol	92	95	35-167	4	0-48	

RPD - Relative Percent Difference, CL - Control Limit

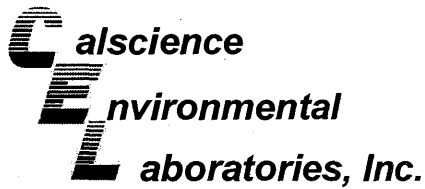

Quality Control - LCS/LCS Duplicate

Blaine Tech Services, Inc.
1680 Rogers Avenue
San Jose, CA 95112-1105

Date Received: N/A
Work Order No: 09-12-2290
Preparation: EPA 5030B
Method: LUFT GC/MS / EPA 8260B

Project: 2120 Montana St., Oakland, CA

Quality Control Sample ID	Matrix	Instrument	Date Prepared	Date Analyzed	LCS/LCSD Batch Number		
099-12-767-3/100	Aqueous	GC/MS-U	01/04/10	01/05/10	100104L02		
Parameter	LCS %REC	LCSD %REC	%REC CL	ME CL	RPD	RPD CL	Qualifiers
Benzene	99	92	80-122	73-129	7	0-20	
Carbon Tetrachloride	100	100	68-140	56-152	0	0-20	
Chlorobenzene	97	94	80-120	73-127	3	0-20	
1,2-Dibromoethane	97	97	80-121	73-128	0	0-20	
1,2-Dichlorobenzene	97	95	80-120	73-127	2	0-20	
1,1-Dichloroethene	90	84	72-132	62-142	6	0-25	
Ethylbenzene	106	102	80-126	72-134	3	0-20	
Toluene	97	92	80-121	73-128	5	0-20	
Trichloroethene	100	94	80-123	73-130	6	0-20	
Vinyl Chloride	94	96	67-133	56-144	2	0-20	
Methyl-t-Butyl Ether (MTBE)	107	101	75-123	67-131	6	0-20	
Tert-Butyl Alcohol (TBA)	104	87	75-123	67-131	18	0-20	
Diisopropyl Ether (DIPE)	104	99	71-131	61-141	5	0-20	
Ethyl-t-Butyl Ether (ETBE)	109	104	76-124	68-132	4	0-20	
Tert-Amyl-Methyl Ether (TAME)	108	103	80-123	73-130	5	0-20	
Ethanol	98	73	61-139	48-152	29	0-27	X
TPPH	99	100	65-135	53-147	1	0-30	

Total number of LCS compounds : 17

Total number of ME compounds : 0

Total number of ME compounds allowed : 1

LCS ME CL validation result : Pass

RPD - Relative Percent Difference , CL - Control Limit

Glossary of Terms and Qualifiers



Work Order Number: 09-12-2290

<u>Qualifier</u>	<u>Definition</u>
*	See applicable analysis comment.
1	Surrogate compound recovery was out of control due to a required sample dilution, therefore, the sample data was reported without further clarification.
2	Surrogate compound recovery was out of control due to matrix interference. The associated method blank surrogate spike compound was in control and, therefore, the sample data was reported without further clarification.
3	Recovery of the Matrix Spike (MS) or Matrix Spike Duplicate (MSD) compound was out of control due to matrix interference. The associated LCS and/or LCSD was in control and, therefore, the sample data was reported without further clarification.
4	The MS/MSD RPD was out of control due to matrix interference. The LCS/LCSD RPD was in control and, therefore, the sample data was reported without further clarification.
5	The PDS/PDSD associated with this batch of samples was out of control due to a matrix interference effect. The associated batch LCS/LCSD was in control and, hence, the associated sample data was reported with no further corrective action required.
A	Result is the average of all dilutions, as defined by the method.
B	Analyte was present in the associated method blank.
C	Analyte presence was not confirmed on primary column.
E	Concentration exceeds the calibration range.
J	Analyte was detected at a concentration below the reporting limit and above the laboratory method detection limit. Reported value is estimated.
ME	LCS Recovery Percentage is within LCS ME Control Limit range.
N	Nontarget Analyte.
ND	Parameter not detected at the indicated reporting limit.
Q	Spike recovery and RPD control limits do not apply resulting from the parameter concentration in the sample exceeding the spike concentration by a factor of four or greater.
U	Undetected at the laboratory method detection limit.
X	% Recovery and/or RPD out-of-range.
Z	Analyte presence was not confirmed by second column or GC/MS analysis.
	Solid - Unless otherwise indicated, solid sample data is reported on a wet weight basis, not corrected for % moisture.

LAB (LOCATION)



Shell Oil Products Chain Of Custody Record

- CALSCIENCE ()
- SPL ()
- XENCO ()
- TEST AMERICA ()
- OTHER ()

Please Check Appropriate Box:

<input type="checkbox"/> ENV. SERVICES	<input type="checkbox"/> MOTIVA RETAIL	<input type="checkbox"/> SHELL RETAIL
<input type="checkbox"/> MOTIVA SD&CM	<input checked="" type="checkbox"/> CONSULTANT	<input type="checkbox"/> LUBES
<input type="checkbox"/> SHELL PIPELINE	<input type="checkbox"/> OTHER _____	

Print Bill To Contact Name: Peter Schaefer 240733

INCIDENT # (ENV SERVICES): 9 8 9 9 5 7 4 0

PO # _____ SAP # _____

DATE: 12-28-09

PAGE: 1 of 1

SAMPLING COMPANY: Blaine Tech Services

LOG CODE: BTSS

SITE ADDRESS: Street and City: 2120 Montana St., Oakland

State: CA

GLOBAL ID NO: T0600101805

ADDRESS: 1680 Rogers Ave, San Jose, CA 95112

EDF DELIVERABLE TO (Name, Company, Office Location): Anni Kremi, CRA, Emeryville

PHONE NO: (510) 420-3335

E-MAIL: Shelledf@craworld.com

CONSULTANT PROJECT NO: 091228-FS1

BTS #: _____

PROJECT CONTACT (Hardcopy or PDF Report to): Michael Ninokata - Copy to Shell.Lab.Billing@craworld.com

SAMPLER NAME(S) (P#M): F. SRIVONGTONG, B. PANELL

LAB USE ONLY: 12-2290

TELEPHONE: (408)573-0555

FAX: (408)573-7771

E-MAIL: mninokata@blainetech.com

TURNAROUND TIME (CALENDAR DAYS):

STANDARD (14 DAY) 5 DAYS 3 DAYS 2 DAYS 24 HOURS

RESULTS NEEDED ON WEEKEND

REQUESTED ANALYSIS

LA - RWQCB REPORT FORMAT UST AGENCY:

SPECIAL INSTRUCTIONS OR NOTES:

Run TPH-d w/Silica Gel Clean Up

SHELL CONTRACT RATE APPLIES

STATE REIMBURSEMENT RATE APPLIES

EDD NOT NEEDED

RECEIPT VERIFICATION REQUESTED

TPH - Purgeable (8260B)	TPH - Extractable (8015M)	BTEX (8260B)	5 Oxygenates (8260B)	MTBE (8260B)	TBA (8260B)	DIPE (8260B)	TAME (8260B)	ETBE (8260B)	1,2 DCA (8260B)	EDB (8260B)	Ethanol (8260B)	Methanol (8015M)	TEMPERATURE ON RECEIPT °C
-------------------------	---------------------------	--------------	----------------------	--------------	-------------	--------------	--------------	--------------	-----------------	-------------	-----------------	------------------	---------------------------

LAB USE ONLY	Field Sample Identification	SAMPLING		MATRIX	PRESERVATIVE					NO. OF CONT.	REQUESTED ANALYSIS													Container PID Readings or Laboratory Notes	
		DATE	TIME		HCL	HNO3	H2SO4	NONE	OTHER		TPH - Purgeable (8260B)	TPH - Extractable (8015M)	BTEX (8260B)	5 Oxygenates (8260B)	MTBE (8260B)	TBA (8260B)	DIPE (8260B)	TAME (8260B)	ETBE (8260B)	1,2 DCA (8260B)	EDB (8260B)	Ethanol (8260B)	Methanol (8015M)		
		1	MW-1		12/29/09	1330							X	X	X	X	X								
2	MW-2		1030						X	X	X	X	X												
3	MW-3		1110						X	X	X	X	X												
4	MW-4		1355						X	X	X	X	X												
5	MW-5		1005						X	X	X	X	X												
6	TBW-N		1145						X	X	X	X	X												
7	EW-1		1350						X	X	X	X	X												
8	EW-2		1235						X	X	X	X	X												

Relinquished by: (Signature) _____ Received by: (Signature) _____ (SAMPLE CUSTODIAN) Date: 12-28-09 Time: 1530

Relinquished by: (Signature) _____ Received by: (Signature) Tom O'Reilly CER Date: 12/29/09 Time: 0950

Relinquished by: (Signature) _____ Date: 12-29-09 Time: 1730

Relinquished by: (Signature) _____ Date: 12/30/09 Time: 1000



WebShip >>>>
800-322-5555 www.gso.com

2290

- 12/29/09

Ship From:
ALAN KEMP
CAL SCIENCE- CONCORD
5063 COMMERCIAL CIRCLE #H
CONCORD, CA 94520

Ship To:
SAMPLE RECEIVING
CEL
7440 LINCOLN WAY
GARDEN GROVE, CA 92841

COD:
\$0.00

Reference:
ERI, BTS

Delivery Instructions:

Signature Type:
SIGNATURE REQUIRED

Tracking #: 513288474



NPS

ORC

D

GARDEN GROVE

D92843A

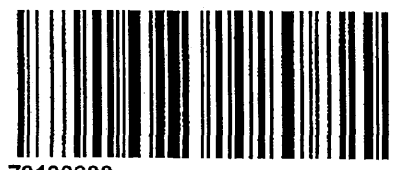

78190688

Print Date : 12/29/09 13:58 PM

Package 1 of 1

Print All

LABEL INSTRUCTIONS:

- Do not copy or reprint this label for additional shipments - each package must have a unique barcode.
- STEP 1 - Use the "Send Label to Printer" button on this page to print the shipping label on a laser or inkjet printer.
- STEP 2 - Fold this page in half.
- STEP 3 - Securely attach this label to your package, do not cover the barcode.
- STEP 4 - Request an on-call pickup for your package, if you do not have scheduled daily pickup service or Drop-off your package at the nearest GSO drop box. Locate nearest GSO dropbox locations using this link.

ADDITIONAL OPTIONS:

TERMS AND CONDITIONS:

By giving us your shipment to deliver, you agree to all the service terms and conditions described in this section. Our liability for loss or damage to any package is limited to your actual damages or \$100 whichever is less, unless you pay for and declare a higher authorized value. If you declare a higher value and pay the additional charge, our liability will be the lesser of your declared value or the actual value of your loss or damage. In any event, we will not be liable for any damage, whether direct, incidental, special or consequential, in excess of the declared value of a shipment whether or not we had knowledge that such damage might be incurred including but not limited to loss of income or profit. We will not be liable for your acts or omissions, including but not limited to improper or insufficient packaging, securing, marking or addressing. Also, we will not be liable if you or the recipient violates any of the terms of our agreement. We will not be liable for loss, damage or delay caused by events we cannot control, including but not limited to acts of God, perils of the air, weather conditions, act of public enemies, war, strikes, or civil commotion. The highest declared value for our GSO Priority Letter or GSO Priority Package is \$500. For other shipments the highest declared value is \$10,000 unless your package contains items of "extraordinary value", in which case the highest declared value we allow is \$500. Items of "extraordinary value" include, but or not limited to, artwork, jewelry, furs, precious metals, tickets, negotiable instruments and other items with intrinsic value.

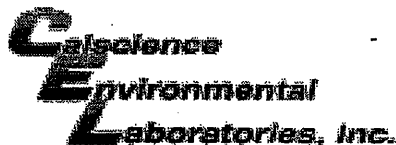

WORK ORDER #: 09-12-2290

SAMPLE RECEIPT FORM

Cooler 1 of 1

CLIENT: Blaine Tech

DATE: 12/30/09

TEMPERATURE: Thermometer ID: SC1 (Criteria: 0.0°C – 6.0°C, not frozen)

Temperature 2.4 °C + 0.5°C (CF) = 2.9 °C Blank Sample

Sample(s) outside temperature criteria (PM/APM contacted by: _____).

Sample(s) outside temperature criteria but received on ice/chilled on same day of sampling.

Received at ambient temperature, placed on ice for transport by Courier.

Ambient Temperature: Air Filter Metals Only PCBs Only Initial: JF

CUSTODY SEALS INTACT:

Cooler _____ No (Not Intact) Not Present N/A Initial: JF

Sample _____ No (Not Intact) Not Present Initial: WB

SAMPLE CONDITION:

	Yes	No	N/A
Chain-Of-Custody (COC) document(s) received with samples.....	<input checked="" type="checkbox"/>	<input type="checkbox"/>	<input type="checkbox"/>
COC document(s) received complete.....	<input checked="" type="checkbox"/>	<input checked="" type="checkbox"/>	<input type="checkbox"/>
<input type="checkbox"/> Collection date/time, (matrix) and/or # of containers logged in based on sample labels.			
<input type="checkbox"/> No analysis requested. <input type="checkbox"/> Not relinquished. <input type="checkbox"/> No date/time relinquished.			
Sampler's name indicated on COC.....	<input checked="" type="checkbox"/>	<input type="checkbox"/>	<input type="checkbox"/>
Sample container label(s) consistent with COC.....	<input checked="" type="checkbox"/>	<input type="checkbox"/>	<input type="checkbox"/>
Sample container(s) intact and good condition.....	<input checked="" type="checkbox"/>	<input type="checkbox"/>	<input type="checkbox"/>
Correct containers and volume for analyses requested.....	<input checked="" type="checkbox"/>	<input type="checkbox"/>	<input type="checkbox"/>
Analyses received within holding time.....	<input checked="" type="checkbox"/>	<input type="checkbox"/>	<input type="checkbox"/>
Proper preservation noted on COC or sample container.....	<input checked="" type="checkbox"/>	<input type="checkbox"/>	<input type="checkbox"/>
<input type="checkbox"/> Unpreserved vials received for Volatiles analysis			
Volatile analysis container(s) free of headspace.....	<input checked="" type="checkbox"/>	<input type="checkbox"/>	<input type="checkbox"/>
Tedlar bag(s) free of condensation.....	<input type="checkbox"/>	<input type="checkbox"/>	<input checked="" type="checkbox"/>

CONTAINER TYPE:

Solid: 4ozCGJ 8ozCGJ 16ozCGJ Sleeve EnCores® TerraCores® _____

Water: VOA VOAh VOAna₂ 125AGB 125AGBh 125AGBp 1AGB 1AGBna₂ 1AGBs

500AGB 500AGJ 500AGJs 250AGB 250CGB 250CGBs 1PB 500PB 500PBna

250PB 250PBn 125PB 125PBz_{nna} 100PJ 100PJna₂ _____ _____ _____

Air: Tedlar® Summa® **Other:** _____ **Trip Blank Lot#:** _____ **Checked by:** WB

Container: C: Clear A: Amber P: Plastic G: Glass J: Jar B: Bottle Z: Ziploc/Resealable Bag E: Envelope **Reviewed by:** WJC

Preservative: h: HCL n: HNO₃ na₂:Na₂S₂O₃ Na: NaOH p: H₃PO₄ s: H₂SO₄ z_{nna}: ZnAc₂+NaOH f: Field-filtered **Scanned by:** WB

WELL GAUGING DATA

Project # 091228-FS1 Date 12-28-09 Client SHELL

Site 2120 MONTANA ST. OAKLAND, CA

Well ID	Time	Well Size (in.)	Sheen / Odor	Depth to Immiscible Liquid (ft.)	Thickness of Immiscible Liquid (ft.)	Volume of Immiscibles Removed (ml)	Depth to water (ft.)	Depth to well bottom (ft.)	Survey Point: TOB or TOC	Notes
MW-1	845	2					11.13	26.90	TOC	
MW-2	845 1015	2					11.79	19.96		
MW-3	933	2					11.68	19.90		
MW-4	915	4					13.35	19.89		
MW-5	945	2					12.18	19.40		
TBW-N	922	4					13.32 9.85	12.62		
EW-1	855	4					11.68	25.63		
EW-2	905	4					10.55	26.34	↓	

SHELL WELL MONITORING DATA SHEET

BTS #: 091228-FS1	Site: 2120 MONTANA ST. OAKLAND, CA
Sampler: FS	Date: 12-28-09
Well I.D.: MW-1	Well Diameter: (2) 3 4 6 8 _____
Total Well Depth (TD): 26.90	Depth to Water (DTW): 11.13 15.77
Depth to Free Product:	Thickness of Free Product (feet):
Referenced to: (PVC) Grade	D.O. Meter (if req'd): YSI HACH
DTW with 80% Recharge [(Height of Water Column x 0.20) + DTW]: 14.28	

Purge Method: Bailer Waterra Sampling Method: Bailer
 Disposable Bailer Peristaltic Disposable Bailer
 Positive Air Displacement Extraction Pump Extraction Port
 Electric Submersible Other _____ Dedicated Tubing

$2.6 \text{ (Gals.)} \times 3 = 7.8 \text{ Gals.}$ 1 Case Volume Specified Volumes Calculated Volume	<table border="1" style="width: 100%; border-collapse: collapse; text-align: center;"> <thead> <tr> <th>Well Diameter</th> <th>Multiplier</th> <th>Well Diameter</th> <th>Multiplier</th> </tr> </thead> <tbody> <tr> <td>1"</td> <td>0.04</td> <td>4"</td> <td>0.65</td> </tr> <tr> <td>2"</td> <td>0.16</td> <td>6"</td> <td>1.47</td> </tr> <tr> <td>3"</td> <td>0.37</td> <td>Other</td> <td>radius² * 0.163</td> </tr> </tbody> </table>	Well Diameter	Multiplier	Well Diameter	Multiplier	1"	0.04	4"	0.65	2"	0.16	6"	1.47	3"	0.37	Other	radius ² * 0.163
Well Diameter	Multiplier	Well Diameter	Multiplier														
1"	0.04	4"	0.65														
2"	0.16	6"	1.47														
3"	0.37	Other	radius ² * 0.163														

Time	Temp (°F)	pH	Cond. (mS or μS)	Turbidity (NTUs)	Gals. Removed	Observations
1307	63.8	6.9	1014	45	2.6	
1316	63.9	6.8	931	18	5.2	
1326	64.7	6.7	978	112	7.8	

Did well dewater? Yes No Gallons actually evacuated: **7.8**

Sampling Date: **12-28-09** Sampling Time: **1330** Depth to Water: **11.70**

Sample I.D.: **MW-1** Laboratory: **(CalScience)** Columbia Other _____

Analyzed for: **(TPH-G)** **(BTEX)** MTBE TPH-D **(Oxygenates (5))** Other:

EB I.D. (if applicable): _____ @ _____ Time Duplicate I.D. (if applicable): _____

Analyzed for: TPH-G BTEX MTBE TPH-D Oxygenates (5) Other:

D.O. (if req'd):	Pre-purge:	mg/L	Post-purge:	mg/L
O.R.P. (if req'd):	Pre-purge:	mV	Post-purge:	mV

SHELL WELL MONITORING DATA SHEET

BTS #: 091228-FS1	Site: 2120 MONTANA ST. OAKLAND, CA
Sampler: FS	Date: 12-28-09
Well I.D.: MW-2	Well Diameter: (2) 3 4 6 8
Total Well Depth (TD): 19.96	Depth to Water (DTW): 11.71
Depth to Free Product:	Thickness of Free Product (feet):
Referenced to: (PVC) Grade	D.O. Meter (if req'd): YSI HACH
DTW with 80% Recharge [(Height of Water Column x 0.20) + DTW]: 13.42	

Purge Method: Bailer <input checked="" type="radio"/> Disposable Bailer <input type="radio"/> Positive Air Displacement <input type="radio"/> Electric Submersible	Waterra <input type="radio"/> Peristaltic <input type="radio"/> Extraction Pump Other _____	Sampling Method: Bailer <input checked="" type="radio"/> Disposable Bailer <input type="radio"/> Extraction Port <input type="radio"/> Dedicated Tubing Other: _____
---	--	--

1.4 (Gals.) X 3 = 4.2 Gals. 1 Case Volume Specified Volumes Calculated Volume	<table border="1" style="width: 100%; border-collapse: collapse; font-size: small;"> <thead> <tr> <th>Well Diameter</th> <th>Multiplier</th> <th>Well Diameter</th> <th>Multiplier</th> </tr> </thead> <tbody> <tr> <td>1"</td> <td>0.04</td> <td>4"</td> <td>0.65</td> </tr> <tr> <td>2"</td> <td>0.16</td> <td>6"</td> <td>1.47</td> </tr> <tr> <td>3"</td> <td>0.37</td> <td>Other</td> <td>radius² * 0.163</td> </tr> </tbody> </table>	Well Diameter	Multiplier	Well Diameter	Multiplier	1"	0.04	4"	0.65	2"	0.16	6"	1.47	3"	0.37	Other	radius ² * 0.163
Well Diameter	Multiplier	Well Diameter	Multiplier														
1"	0.04	4"	0.65														
2"	0.16	6"	1.47														
3"	0.37	Other	radius ² * 0.163														

Time	Temp (°F)	pH	Cond. (mS or μS)	Turbidity (NTUs)	Gals. Removed	Observations
1021	61.4	6.6	846	79	1.4	ODOR
1023	63.4	6.5	875	58	2.8	"
1025	63.6	6.5	890	91	4.2	

Did well dewater? Yes No Gallons actually evacuated: 4.2

Sampling Date: 12-28-09 Sampling Time: 1030 Depth to Water: 13.04

Sample I.D.: MW-2 Laboratory: (CalScience) Columbia Other _____

Analyzed for: (TPH-G) (BTEX) MTBE TPH-D (Oxygenates (5)) (Other) TBA

EB I.D. (if applicable): @ Time Duplicate I.D. (if applicable):

Analyzed for: TPH-G BTEX MTBE TPH-D Oxygenates (5) Other:

D.O. (if req'd):	Pre-purge:	mg/L	Post-purge:	mg/L
------------------	------------	------	-------------	------

O.R.P. (if req'd):	Pre-purge:	mV	Post-purge:	mV
--------------------	------------	----	-------------	----

SHELL WELL MONITORING DATA SHEET

BTS #: 091228-FS1	Site: 2120 MONTANA ST. OAKLAND, CA
Sampler: FS	Date: 12-28-09
Well I.D.: MW-3	Well Diameter: <u>2</u> 3 4 6 8
Total Well Depth (TD): 1990	Depth to Water (DTW): 11.68
Depth to Free Product:	Thickness of Free Product (feet):
Referenced to: <u>PVC</u> Grade	D.O. Meter (if req'd): YSI HACH
DTW with 80% Recharge [(Height of Water Column x 0.20) + DTW]: 13.32	

Purge Method: <u>Bailer</u>	Waters: _____	Sampling Method: <u>Bailer</u>
Disposable Bailer	Peristaltic	Disposable Bailer
Positive Air Displacement	Extraction Pump	Extraction Port
Electric Submersible	Other _____	Dedicated Tubing

$1.4 \text{ (Gals.)} \times 3 = 4.2 \text{ Gals.}$ 1 Case Volume Specified Volumes Calculated Volume	<table style="width: 100%; border-collapse: collapse;"> <thead> <tr> <th style="text-align: left;">Well Diameter</th> <th style="text-align: left;">Multiplier</th> <th style="text-align: left;">Well Diameter</th> <th style="text-align: left;">Multiplier</th> </tr> </thead> <tbody> <tr> <td>1"</td> <td>0.04</td> <td>4"</td> <td>0.65</td> </tr> <tr> <td>2"</td> <td>0.16</td> <td>6"</td> <td>1.47</td> </tr> <tr> <td>3"</td> <td>0.37</td> <td>Other</td> <td>radius² * 0.163</td> </tr> </tbody> </table>	Well Diameter	Multiplier	Well Diameter	Multiplier	1"	0.04	4"	0.65	2"	0.16	6"	1.47	3"	0.37	Other	radius ² * 0.163
Well Diameter	Multiplier	Well Diameter	Multiplier														
1"	0.04	4"	0.65														
2"	0.16	6"	1.47														
3"	0.37	Other	radius ² * 0.163														

Time	Temp (°F)	pH	Cond. (mS or <u>µS</u>)	Turbidity (NTUs)	Gals. Removed	Observations
1048	65.3	6.7 7.14	579.0	196	1.4	
1053	66.5	7.08	574.2	>1000	2.8	
1058	67.8	7.06	573.0	>1000	4.2	

Did well dewater? Yes No Gallons actually evacuated: 4.2

Sampling Date: 12-28-09 Sampling Time: 1110 Depth to Water: 13.10

Sample I.D.: MW-3 Laboratory: CalScience Columbia Other _____

Analyzed for: TPH-G BTEX MTBE TPH-D Oxygenates (5) Other: _____

EB I.D. (if applicable): _____ @ _____ Time Duplicate I.D. (if applicable): _____

Analyzed for: TPH-G BTEX MTBE TPH-D Oxygenates (5) Other: _____

D.O. (if req'd):	Pre-purge:	mg/L	Post-purge:	mg/L
O.R.P. (if req'd):	Pre-purge:	mV	Post-purge:	mV

SHELL WELL MONITORING DATA SHEET

BTS #: 091228-FS1	Site: 2120 MONTANA ST. OAKLAND, CA
Sampler: FS	Date: 12-28-09
Well I.D.: MW-4	Well Diameter: 2 3 <u>4</u> 6 8
Total Well Depth (TD): 19.89	Depth to Water (DTW): 13.35
Depth to Free Product:	Thickness of Free Product (feet):
Referenced to: <u>PVC</u> Grade	D.O. Meter (if req'd): YSI HACH
DTW with 80% Recharge [(Height of Water Column x 0.20) + DTW]: 14.65	

Purge Method: Bailer Waterra Sampling Method: Bailer
 Disposable Bailer Peristaltic Disposable Bailer
 Positive Air Displacement Extraction Pump Extraction Port
Electric Submersible Other _____ Dedicated Tubing
 Other: _____

$\frac{4.3 \text{ (Gals.)} \times 3}{1 \text{ Case Volume Specified Volumes}} = \frac{12.9 \text{ Gals.}}{\text{Calculated Volume}}$	<table border="1" style="width: 100%; border-collapse: collapse; font-size: small;"> <thead> <tr> <th>Well Diameter</th> <th>Multiplier</th> <th>Well Diameter</th> <th>Multiplier</th> </tr> </thead> <tbody> <tr> <td>1"</td> <td>0.04</td> <td>4"</td> <td>0.65</td> </tr> <tr> <td>2"</td> <td>0.16</td> <td>6"</td> <td>1.47</td> </tr> <tr> <td>3"</td> <td>0.37</td> <td>Other</td> <td>radius² * 0.163</td> </tr> </tbody> </table>	Well Diameter	Multiplier	Well Diameter	Multiplier	1"	0.04	4"	0.65	2"	0.16	6"	1.47	3"	0.37	Other	radius ² * 0.163
Well Diameter	Multiplier	Well Diameter	Multiplier														
1"	0.04	4"	0.65														
2"	0.16	6"	1.47														
3"	0.37	Other	radius ² * 0.163														

Time	Temp (°F)	pH	Cond. (mS or <u>µS</u>)	Turbidity (NTUs)	Gals. Removed	Observations
1243	64.5	7.01	671	17	4.3	
— WELL		DEWATERED @		6	GALS	DTW 16.94
1355	62.4	7.00	635	18	—	

Did well dewater? Yes No Gallons actually evacuated: 6

Sampling Date: 12-28-09 Sampling Time: 1355 Depth to Water: 14.05

Sample I.D.: MW-4 Laboratory: CalScience Columbia Other _____

Analyzed for: TPH-G BTEX MTBE TPH-D Oxygenates (5) Other: _____

EB I.D. (if applicable): @ Time Duplicate I.D. (if applicable):

Analyzed for: TPH-G BTEX MTBE TPH-D Oxygenates (5) Other: _____

D.O. (if req'd):	Pre-purge:	mg/L	Post-purge:	mg/L
O.R.P. (if req'd):	Pre-purge:	mV	Post-purge:	mV

SHELL WELL MONITORING DATA SHEET

BTS #: 091228-FS1	Site: 2120 MONTANA ST. OAKLAND, CA
Sampler: FS	Date: 12-28-09
Well I.D.: MW-5	Well Diameter: (2) 3 4 6 8 _____
Total Well Depth (TD): 19.40	Depth to Water (DTW): 12.18 7.22
Depth to Free Product:	Thickness of Free Product (feet):
Referenced to: (PVC) Grade	D.O. Meter (if req'd): YSI HACH
DTW with 80% Recharge [(Height of Water Column x 0.20) + DTW]: 13.62	

Purge Method: Bailer Watera Sampling Method: Bailer
 Disposable Bailer Peristaltic Disposable Bailer
 Positive Air Displacement Extraction Pump Extraction Port
 Electric Submersible Other _____ Dedicated Tubing

1.2 (Gals.) X 3 = 3.6 Gals. 1 Case Volume Specified Volumes Calculated Volume	<table border="1" style="width: 100%; border-collapse: collapse;"> <thead> <tr> <th>Well Diameter</th> <th>Multiplier</th> <th>Well Diameter</th> <th>Multiplier</th> </tr> </thead> <tbody> <tr> <td>1"</td> <td>0.04</td> <td>4"</td> <td>0.65</td> </tr> <tr> <td>2"</td> <td>0.16</td> <td>6"</td> <td>1.47</td> </tr> <tr> <td>3"</td> <td>0.37</td> <td>Other</td> <td>radius² * 0.163</td> </tr> </tbody> </table>	Well Diameter	Multiplier	Well Diameter	Multiplier	1"	0.04	4"	0.65	2"	0.16	6"	1.47	3"	0.37	Other	radius ² * 0.163
Well Diameter	Multiplier	Well Diameter	Multiplier														
1"	0.04	4"	0.65														
2"	0.16	6"	1.47														
3"	0.37	Other	radius ² * 0.163														

Time	Temp (°F)	pH	Cond. (mS or μ S)	Turbidity (NTUs)	Gals. Removed	Observations
9:55	59.9	5.8	670	>1000	1.2	
9:57	62.3	6.2	670	>1000	2.4	
9:59	63.0	6.3	670	>1000	3.6	

Did well dewater? Yes No Gallons actually evacuated: 3.6

Sampling Date: 12-28-09 Sampling Time: 1005 Depth to Water: 12.18

Sample I.D.: MW-5 Laboratory: (CalScience) Columbia Other _____

Analyzed for: (TPH-G) (BTEX) MTBE TPH-D (Oxygenates (5)) Other:

EB I.D. (if applicable): @ Time Duplicate I.D. (if applicable):

Analyzed for: TPH-G BTEX MTBE TPH-D Oxygenates (5) Other:

D.O. (if req'd): Pre-purge: _____ mg/L Post-purge: _____ mg/L

O.R.P. (if req'd): Pre-purge: _____ mV Post-purge: _____ mV

SHELL WELL MONITORING DATA SHEET

BTS #: 091228-FS1	Site: 2120 MONTANA ST. OAKLAND, CA
Sampler: FS	Date: 12-28-09
Well I.D.: TBN-N	Well Diameter: 2 3 <u>4</u> 6 8
Total Well Depth (TD): 12.62	Depth to Water (DTW): 9.85
Depth to Free Product:	Thickness of Free Product (feet):
Referenced to: <u>PVC</u> Grade	D.O. Meter (if req'd): YSI HACH
DTW with 80% Recharge [(Height of Water Column x 0.20) + DTW]: 10.40	

Purge Method: Bailer Waterra Sampling Method: Bailer
 Disposable Bailer Peristaltic Disposable Bailer
 Positive Air Displacement Extraction Pump Extraction Port
 Electric Submersible Other _____ Dedicated Tubing

Other: _____

$\frac{1.9 \text{ (Gals.)} \times 3}{\text{I Case Volume Specified Volumes}} = \frac{5.7 \text{ Gals.}}{\text{Calculated Volume}}$	<table border="1" style="width: 100%; border-collapse: collapse;"> <thead> <tr> <th>Well Diameter</th> <th>Multiplier</th> <th>Well Diameter</th> <th>Multiplier</th> </tr> </thead> <tbody> <tr> <td>1"</td> <td>0.04</td> <td>4"</td> <td>0.65</td> </tr> <tr> <td>2"</td> <td>0.16</td> <td>6"</td> <td>1.47</td> </tr> <tr> <td>3"</td> <td>0.37</td> <td>Other</td> <td>radius² * 0.163</td> </tr> </tbody> </table>	Well Diameter	Multiplier	Well Diameter	Multiplier	1"	0.04	4"	0.65	2"	0.16	6"	1.47	3"	0.37	Other	radius ² * 0.163
Well Diameter	Multiplier	Well Diameter	Multiplier														
1"	0.04	4"	0.65														
2"	0.16	6"	1.47														
3"	0.37	Other	radius ² * 0.163														

Time	Temp (°F)	pH	Cond. (mS or <u>µS</u>)	Turbidity (NTUs)	Gals. Removed	Observations
1130	64.5	6.78	976	71000	1.9	
1134	64.5	6.71	970	71000	3.8	
1138	64.1	6.72	968	71000	5.7	

Did well dewater? Yes No Gallons actually evacuated: 5.7

Sampling Date: 12-28-09 Sampling Time: 1145 Depth to Water: 9.85

Sample I.D.: TBN-N Laboratory: CalScience Columbia Other _____

Analyzed for: TPH-G BTEX MTBE TPH-D Oxygenates (5) Other: TBN

EB I.D. (if applicable): @ _____ Duplicate I.D. (if applicable): _____

Analyzed for: TPH-G BTEX MTBE TPH-D Oxygenates (5) Other: _____

D.O. (if req'd):	Pre-purge:	mg/L	Post-purge:	mg/L
O.R.P. (if req'd):	Pre-purge:	mV	Post-purge:	mV

SHELL WELL MONITORING DATA SHEET

BTS #: 091228-FS1	Site: 2120 MONTANA ST. OAKLAND, CA
Sampler: FS	Date: 12-28-09
Well I.D.: EW-1	Well Diameter: 2 3 4 6 8
Total Well Depth (TD): 25.63	Depth to Water (DTW): 11.68
Depth to Free Product:	Thickness of Free Product (feet):
Referenced to: PVC Grade	D.O. Meter (if req'd): YSI HACH
DTW with 80% Recharge [(Height of Water Column x 0.20) + DTW]: 14.47	

Purge Method: Bailer Waterra Sampling Method: **Bailer**
 Disposable Bailer Peristaltic Disposable Bailer
 Positive Air Displacement Extraction Pump Extraction Port
Electric Submersible Other _____ Dedicated Tubing

$9.1 \text{ (Gals.)} \times 3 = 27.3 \text{ Gals.}$ 1 Case Volume Specified Volumes Calculated Volume	<table border="1" style="width: 100%; border-collapse: collapse; font-size: small;"> <thead> <tr> <th>Well Diameter</th> <th>Multiplier</th> <th>Well Diameter</th> <th>Multiplier</th> </tr> </thead> <tbody> <tr> <td>1"</td> <td>0.04</td> <td>4"</td> <td>0.65</td> </tr> <tr> <td>2"</td> <td>0.16</td> <td>6"</td> <td>1.47</td> </tr> <tr> <td>3"</td> <td>0.37</td> <td>Other</td> <td>radius² * 0.163</td> </tr> </tbody> </table>	Well Diameter	Multiplier	Well Diameter	Multiplier	1"	0.04	4"	0.65	2"	0.16	6"	1.47	3"	0.37	Other	radius ² * 0.163
Well Diameter	Multiplier	Well Diameter	Multiplier														
1"	0.04	4"	0.65														
2"	0.16	6"	1.47														
3"	0.37	Other	radius ² * 0.163														

Time	Temp (°F)	pH	Cond. (mS or µS)	Turbidity (NTUs)	Gals. Removed	Observations
1342	65.3	7.0	868	101	9.1	ODOR
1343	67.3	6.8	833	39	18.2	
1344	67.7	6.8	840	32	27.3	

Did well dewater? Yes **No** Gallons actually evacuated: 27.3

Sampling Date: 12-28-09 Sampling Time: 1350 Depth to Water: 14.38

Sample I.D.: EW-1 Laboratory: **CalScience** Columbia Other _____

Analyzed for: **TPH-G** **BTEX** MTBE TPH-D **Oxygenates (5)** Other: _____

EB I.D. (if applicable): _____ @ _____ Time Duplicate I.D. (if applicable): _____

Analyzed for: TPH-G BTEX MTBE TPH-D Oxygenates (5) Other: _____

D.O. (if req'd):	Pre-purge:	mg/L	Post-purge:	mg/L
------------------	------------	------	-------------	------

O.R.P. (if req'd):	Pre-purge:	mV	Post-purge:	mV
--------------------	------------	----	-------------	----

SHELL WELL MONITORING DATA SHEET

BTS #: 091228-FS1	Site: 2120 MONTANA ST. OAKLAND, CA
Sampler: FS	Date: 12-28-09
Well I.D.: EW-2	Well Diameter: 2 3 4 6 8 _____
Total Well Depth (TD): 26.34	Depth to Water (DTW): 10.55 15.79
Depth to Free Product:	Thickness of Free Product (feet):
Referenced to: <u>PVC</u> Grade	D.O. Meter (if req'd): YSI HACH
DTW with 80% Recharge [(Height of Water Column x 0.20) + DTW]: 23.18 13.70	

Purge Method: Bailer	Waterra	Sampling Method: <input checked="" type="checkbox"/> Bailer
Disposable Bailer	Peristaltic	Disposable Bailer
Positive Air Displacement	Extraction Pump	Extraction Port
<input checked="" type="checkbox"/> Electric Submersible	Other _____	Dedicated Tubing
Other: _____		

$\underline{10.3} \text{ (Gals.)} \times \underline{3} = \underline{30.9} \text{ Gals.}$ 1 Case Volume Specified Volumes Calculated Volume	<table border="1" style="width: 100%; border-collapse: collapse; font-size: small;"> <thead> <tr> <th>Well Diameter</th> <th>Multiplier</th> <th>Well Diameter</th> <th>Multiplier</th> </tr> </thead> <tbody> <tr> <td>1"</td> <td>0.04</td> <td>4"</td> <td>0.65</td> </tr> <tr> <td>2"</td> <td>0.16</td> <td>6"</td> <td>1.47</td> </tr> <tr> <td>3"</td> <td>0.37</td> <td>Other</td> <td>radius² * 0.163</td> </tr> </tbody> </table>	Well Diameter	Multiplier	Well Diameter	Multiplier	1"	0.04	4"	0.65	2"	0.16	6"	1.47	3"	0.37	Other	radius ² * 0.163
Well Diameter	Multiplier	Well Diameter	Multiplier														
1"	0.04	4"	0.65														
2"	0.16	6"	1.47														
3"	0.37	Other	radius ² * 0.163														

Time	Temp (°F)	pH	Cond. (mS or <u>µS</u>)	Turbidity (NTUs)	Gals. Removed	Observations
1224	63.4	7.29	726.1	80	10.3	
1227	65.5	7.13	712.1	35	20.6	
1229	66.2	7.05	719.5	10	30.9	

Did well dewater? Yes No Gallons actually evacuated: 30.9

Sampling Date: 12-28-09 Sampling Time: 12 35 Depth to Water: 12.55

Sample I.D.: EW-2 Laboratory: CalScience Columbia Other _____

Analyzed for: TPH-G BTEX MTBE TPH-D Oxygenates (5) Other: _____

EB I.D. (if applicable): @ Time Duplicate I.D. (if applicable):

Analyzed for: TPH-G BTEX MTBE TPH-D Oxygenates (5) Other: _____

D.O. (if req'd):	Pre-purge:	mg/L	Post-purge:	mg/L
------------------	------------	------	-------------	------

O.R.P. (if req'd):	Pre-purge:	mV	Post-purge:	mV
--------------------	------------	----	-------------	----