

Wickham, Jerry, Env. Health

From: Schaefer, Peter [pschaefer@croworld.com]
Sent: Monday, November 19, 2012 9:26 AM
To: Matthews, Keith
Cc: paradiso@pminc.net; pete.pugnale@shell.com; denis.l.brown@shell.com; Cool, Aubrey;
Project Email Hold; Wickham, Jerry, Env. Health
Subject: 135675-2120 Montana Ave., Oakland - UST Removal sampling results & request to back fill
UST excavation ~COR-240733~
Attachments: 240733 site plan (F2).pdf; 240733-Master historical soil.xls; 240733-Master GW Data.xls

Keith,

Here is a map showing the locations where soil samples were collected on 11/13/12 and tables presenting the soil and grab groundwater analytical results. Only total petroleum hydrocarbons as gasoline (TPHg; 1,300 milligrams per kilogram [mg/kg]) and total xylenes (13 mg/kg) in one dispenser soil sample (D-2) and TPHg (210 micrograms per liter [$\mu\text{g/L}$]) in a grab water sample from the underground storage tank excavation exceed San Francisco Bay Regional Water Quality Control Board (RWQCB) environmental screening levels (ESLs) . Please note noted that the RWQCB advises that ESLs must be used in conjunction with ESLs for related chemicals (e.g. BTEX, polynuclear aromatic hydrocarbons, oxidizers, etc.)” In this case, benzene, toluene, ethylbenzene, total xylenes, methyl tertiary-butyl ether, and tertiary-butyl alcohol are the appropriate related chemicals. Since the detection of total xylenes only slightly exceeds the ESL (9.3 mg/kg) and all other analytical results were below ESLs, on behalf of Shell Oil Products US, I request your permission to backfill the excavation.

I should be getting analytical result for the composite samples collected from the stockpiles of soil and pea gravel this afternoon. If we decide we would like to reuse the pea gravel based on the results, I will request your permission to reuse the material.

Regards,

Peter Schaefer, CEG, CHG
Conestoga-Rovers & Associates
5900 Hollis Avenue, Suite A
Emeryville, California 94608-2008
Telephone: (510) 420-3319
Fax: (510) 420-9170
pschaefer@croworld.com
Think before you print 
Perform every task the safe way, the right way, every time!

EXPLANATION

- DP-1** ▲ Soil sample location (CRA, 2012)
- TW** ▲ Grab groundwater sample location (CRA, 2012)
- EW-1** ⚙ Extraction well location
- MW-1** ⚙ Monitoring well formerly used for groundwater extraction
- MW-2** ● Monitoring well location
- TBW-N** ▲ Tank backfill well location
- SB-4** ○ Soil boring location (Cambria, 2005)
- SB-7** ⊠ Attempted soil boring location (Cambria, 2005)
- SV-D** ■ Soil vapor sampling location (Cambria, 2005)
- SV-A** ✕ Attempted soil vapor sampling location (Cambria, 2005)
- D-1-4.0** ◆ Soil sample location (Cambria, 2004)
- SB-1** ○ Soil boring location (Cambria, 1999)
- D-1** ● Soil sample location (Cambria, 1997)
- INF** ● GWE system sampling location

- Remediation piping (R)
- Discharge line (D)
- Electrical line (E)
- Overhead electric line (OE)
- Sanitary sewer (SS)
- Water line (W)
- Telecommunications line (T)

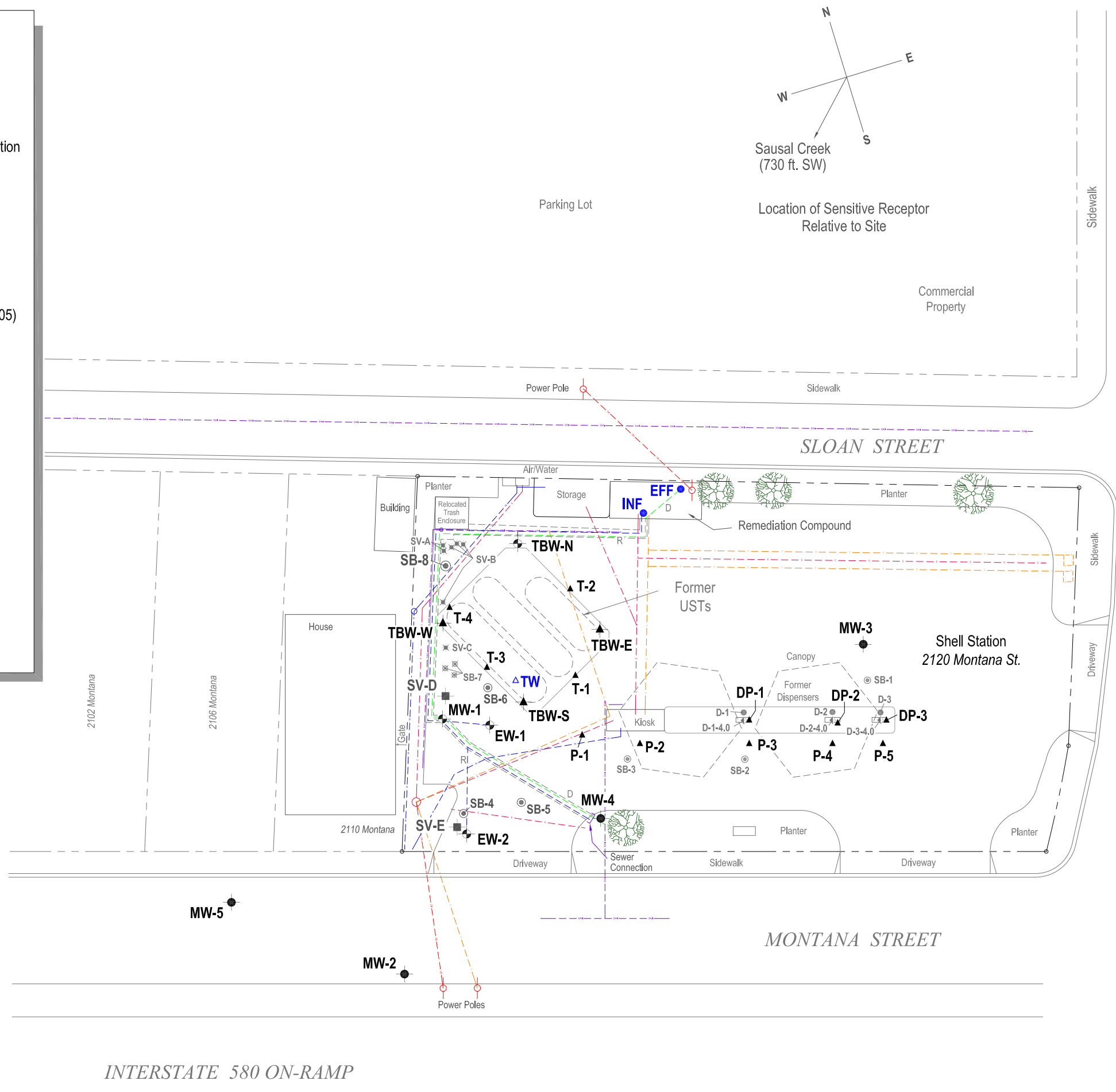

FIGURE
2

I:\Shell\6-chars\2407--\240733-Oakland 2120 Montana\240733-FIGURES\240733 SITE PLAN.DWG

TABLE 1

**HISTORICAL SOIL ANALYTICAL DATA
SHELL-BRANDED SERVICE STATION
2120 MONTANA STREET, OAKLAND, CALIFORNIA**

<i>Sample ID</i>	<i>Date</i>	<i>Depth (fbg)</i>	<i>TPHg (mg/kg)</i>	<i>B (mg/kg)</i>	<i>T (mg/kg)</i>	<i>E (mg/kg)</i>	<i>X (mg/kg)</i>	<i>MTBE (mg/kg)</i>	<i>TBA (mg/kg)</i>	<i>DIPE (mg/kg)</i>	<i>ETBE (mg/kg)</i>	<i>TAME (mg/kg)</i>	<i>1,2-DCA (mg/kg)</i>	<i>EDB (mg/kg)</i>	<i>Lead (mg/kg)</i>
D-1	11/11/1997	5	1.8	<0.0050	<0.0050	<0.0050	0.0059	0.16	---	---	---	---	---	---	9.2 a
D-2	11/11/1997	5	9.5	0.024	0.016	<0.0050	0.088	0.37	---	---	---	---	---	---	9.2 a
D-3	11/11/1997	5	59	0.76	0.14	<0.050	0.095	1.1	---	---	---	---	---	---	9.2 a
SB-1-5	10/27/1999	5	54	<0.050	<0.050	0.091	0.099	<0.50	---	---	---	---	---	---	---
SB-1-10	10/27/1999	10	12	<0.0050	<0.0050	0.0093	0.030	<0.05	---	---	---	---	---	---	---
SB-2-5	10/27/1999	5	<1.0	<0.0050	<0.0050	<0.0050	<0.0050	<0.05	---	---	---	---	---	---	---
SB-2-10	10/27/1999	10	2.0	0.0050	0.0063	<0.0050	<0.0050	0.27/0.24 b	---	---	---	---	---	---	---
SB-2-15	10/27/1999	15	14	0.019	0.032	0.064	0.072	<0.05	---	---	---	---	---	---	---
SB-2-20	10/27/1999	20	<1.0	<0.0050	<0.0050	<0.0050	<0.0050	<0.05	---	---	---	---	---	---	---
SB-3-5	10/27/1999	5	<1.0	<0.0050	<0.0050	<0.0050	<0.0050	<0.05	---	---	---	---	---	---	---
SB-3-10	10/27/1999	10	<1.0	<0.0050	<0.0050	<0.0050	<0.0050	0.11	---	---	---	---	---	---	---
SB-3-15	10/27/1999	15	17	0.013	0.018	0.054	0.16	0.19	---	---	---	---	---	---	---
MW-1-5.5	2/20/2001	5.5	<1.0	<0.0050	<0.0050	<0.0050	<0.0050	0.12	---	---	---	---	---	---	---
MW-1-10.0	2/20/2001	10	4.7	0.066	<0.0050	0.12	0.14	2.4	---	---	---	---	---	---	---
MW-1-15.5	2/20/2001	15.5	1.0	0.014	0.041	0.024	0.098	5.0	---	---	---	---	---	---	---
MW-1-20.5	2/20/2001	20.5	1.5	0.023	0.16	0.037	0.17	2.0	---	---	---	---	---	---	---
MW-1-24.0	2/20/2001	24	4.4	0.024	0.14	0.050	0.27	0.51	---	---	---	---	---	---	---
MW-2-5.5	2/21/2001	5.5	<1.0	<0.0050	<0.0050	<0.0050	<0.0050	<0.0050	---	---	---	---	---	---	---
MW-2-10.5	2/21/2001	10.5	<1.0	<0.0050	<0.0050	<0.0050	<0.0050	<0.0050	---	---	---	---	---	---	---
MW-2-15.5	2/21/2001	15.5	<1.0	<0.0050	<0.0050	<0.0050	<0.0050	5.2	---	---	---	---	---	---	---
MW-2-21.0	2/21/2001	21	10	0.028	0.012	0.080	0.021	1.3	---	---	---	---	---	---	---
MW-3-5.5	2/21/2001	5.5	<1.0	<0.0050	<0.0050	<0.0050	<0.0050	<0.0050	---	---	---	---	---	---	---
MW-3-10.5	2/21/2001	10.5	<1.0	<0.0050	<0.0050	<0.0050	<0.0050	<0.0050	---	---	---	---	---	---	---
MW-3-15.5	2/21/2001	15.5	<1.0	<0.0050	<0.0050	<0.0050	<0.0050	<0.0050	---	---	---	---	---	---	---
MW-3-20.5	2/21/2001	20.5	<1.0	<0.0050	<0.0050	<0.0050	<0.0050	<0.0050	---	---	---	---	---	---	---
MW-4-5.5	6/21/2002	5.5	<1.0	<0.005	<0.005	<0.005	<0.005	<0.5	---	---	---	---	---	---	---

TABLE 1

**HISTORICAL SOIL ANALYTICAL DATA
SHELL-BRANDED SERVICE STATION
2120 MONTANA STREET, OAKLAND, CALIFORNIA**

<i>Sample ID</i>	<i>Date</i>	<i>Depth (fbg)</i>	<i>TPHg (mg/kg)</i>	<i>B (mg/kg)</i>	<i>T (mg/kg)</i>	<i>E (mg/kg)</i>	<i>X (mg/kg)</i>	<i>MTBE (mg/kg)</i>	<i>TBA (mg/kg)</i>	<i>DIPE (mg/kg)</i>	<i>ETBE (mg/kg)</i>	<i>TAME (mg/kg)</i>	<i>1,2-DCA (mg/kg)</i>	<i>EDB (mg/kg)</i>	<i>Lead (mg/kg)</i>
MW-4-9.0	6/21/2002	9	<1.0	<0.005	<0.005	<0.005	<0.005	<0.5	---	---	---	---	---	---	---
MW-4-13.5	6/21/2002	13.5	<1.0	<0.005	<0.005	<0.005	<0.005	<0.5	---	---	---	---	---	---	---
MW-5-5.5	6/21/2002	5.5	<1.0	<0.005	<0.005	<0.005	<0.005	<0.5	---	---	---	---	---	---	---
MW-5-9.0	6/21/2002	9	1.3	0.0083	<0.005	<0.005	<0.005	<0.5	---	---	---	---	---	---	---
MW-5-19.0	6/21/2002	19	18	0.0071	<0.005	0.014	0.019	<0.5	---	---	---	---	---	---	---
D-1-4.0	5/6/2004	4	<4.8	<0.024	<0.024	<0.024	0.17	0.77	---	---	---	---	---	---	7.5
D-2-4.0	5/6/2004	4	1,900	1.7	<1.0	21	57	5.80	---	---	---	---	---	---	7.3
D-3-4.0	5/6/2004	4	110	<0.50	<0.50	3.1	<0.50	0.65	---	---	---	---	---	---	8.7
SB-4-5	6/15/2005	5	<1.0	0.0072	<0.0050	<0.0050	<0.0050	0.13	0.53	<0.010	<0.0050	<0.0050	---	---	---
SB-4-10	6/15/2005	10	2.0	<0.0050	<0.0050	<0.0050	<0.0050	<0.0050	0.020	<0.010	<0.0050	<0.0050	---	---	---
SB-4-15	6/15/2005	15	<1.0	<0.0050	<0.0050	<0.0050	<0.0050	<0.0050	<0.010	<0.010	<0.0050	<0.0050	---	---	---
SB-4-20	6/15/2005	20	23	<0.025	<0.025	0.056	0.10	0.061	0.25	<0.050	<0.025	<0.025	---	---	---
SB-5-5	6/15/2005	5	<5.0	<0.025	<0.025	<0.025	<0.025	<0.025	2.3	<0.050	<0.025	<0.025	---	---	---
SB-5-10	6/15/2005	10	<4.9	<0.024	<0.024	<0.024	<0.024	<0.024	3.3	<0.049	<0.024	<0.024	---	---	---
SB-5-13	6/15/2005	13	9.3	<0.024	<0.024	0.030	0.040	<0.024	0.14	<0.049	<0.024	<0.024	---	---	---
SB-5-15	6/15/2005	15	8.6	<0.0050	<0.0050	0.20	<0.0050	0.065	0.50	<0.010	<0.0050	<0.0050	---	---	---
SB-6-5	6/15/2005	5	<1.0	<0.0050	<0.0050	<0.0050	<0.0050	0.030	0.13	<0.010	<0.0050	<0.0050	---	---	---
SB-6-10	6/15/2005	10	<1.0	<0.0050	<0.0050	<0.0050	0.0064	0.0068	0.49	<0.010	<0.0050	<0.0050	---	---	---
SB-6-15	6/15/2005	15	<4.8	<0.024	<0.024	<0.024	<0.024	0.13	9.3	<0.048	<0.024	<0.024	---	---	---
SB-6-17	6/15/2005	17	<4.9	<0.025	<0.025	<0.025	<0.025	<0.025	3.1	<0.049	<0.025	<0.025	---	---	---
SB-8-5	6/16/2005	5	<1.0	<0.0050	<0.0050	<0.0050	<0.0050	0.0050	0.011	<0.010	<0.0050	<0.0050	---	---	---
SB-8-10	6/16/2005	10	<1.0	<0.0050	<0.0050	<0.0050	<0.0050	<0.0050	1.6	<0.010	<0.0050	<0.0050	---	---	---
SB-8-12	6/16/2005	12	<1.0	<0.0050	<0.0050	<0.0050	<0.0050	0.014	0.30	<0.010	<0.0050	<0.0050	---	---	---
SB-8-15	6/16/2005	15	<1.0	<0.0050	<0.0050	<0.0050	<0.0050	0.23	0.38	<0.010	<0.0050	<0.0050	---	---	---
EW-1-5	4/5/2006	5	0.232	<0.00200	<0.00200	<0.00200	<0.00500	0.0497	0.848	<0.00200	<0.00500	<0.00200	---	---	---
EW-1-10	4/5/2006	10	0.803	0.00603	<0.00200	0.00581	<0.00500	0.320	0.376	<0.00200	<0.00500	<0.00200	---	---	---

**HISTORICAL SOIL ANALYTICAL DATA
SHELL-BRANDED SERVICE STATION
2120 MONTANA STREET, OAKLAND, CALIFORNIA**

<i>Sample ID</i>	<i>Date</i>	<i>Depth (fbg)</i>	<i>TPHg (mg/kg)</i>	<i>B (mg/kg)</i>	<i>T (mg/kg)</i>	<i>E (mg/kg)</i>	<i>X (mg/kg)</i>	<i>MTBE (mg/kg)</i>	<i>TBA (mg/kg)</i>	<i>DIPE (mg/kg)</i>	<i>ETBE (mg/kg)</i>	<i>TAME (mg/kg)</i>	<i>1,2-DCA (mg/kg)</i>	<i>EDB (mg/kg)</i>	<i>Lead (mg/kg)</i>
EW-1-12	4/5/2006	12	0.920	0.00496	<0.00200	0.00637	0.0270	0.172	0.502	<0.00200	<0.00500	<0.00200	---	---	---
EW-2-5	4/6/2006	5	0.158	<0.00200	<0.00200	<0.00200	<0.00500	<0.00200	<0.0500	<0.00200	<0.00500	<0.00200	---	---	---
EW-2-10	4/6/2006	10	0.488	<0.00200	<0.00200	<0.00200	<0.00500	<0.00200	<0.0500	<0.00200	<0.00500	<0.00200	---	---	---
EW-2-12	4/6/2006	12	0.715	0.00532	<0.00240	<0.00200	<0.00500	<0.00300	<0.0500	<0.00200	<0.00500	<0.00200	---	---	---
T-1	11/13/2012	12	<0.098	<0.0020	<0.0020	<0.0020	<0.0039	<0.0049	1.2	---	---	---	<0.0020	<0.0020	---
T-2	11/13/2012	12	<0.10	<0.0020	<0.0020	<0.0020	<0.0040	<0.0050	0.16	---	---	---	<0.0020	<0.0020	---
T-3	11/13/2012	12	<0.099	<0.0020	<0.0020	<0.0020	<0.0040	<0.0050	<0.099	---	---	---	<0.0020	<0.0020	---
T-4	11/13/2012	12	<0.096	<0.0019	<0.0019	<0.0019	<0.0038	<0.0048	<0.096	---	---	---	<0.0019	<0.0019	---
DP-1	11/13/2012	4.5	1,300	<2.0	<2.0	<2.0	13	<5.0	<100	---	---	---	<2.0	<2.0	---
DP-2	11/13/2012	4	0.89	0.020	<0.0085	0.10	0.053	0.42	<0.43	---	---	---	<0.0085	<0.0085	---
DP-3	11/13/2012	4.5	0.27	<0.0020	<0.0020	<0.0020	<0.0040	0.032	<0.099	---	---	---	<0.0020	<0.0020	---
P-1	11/13/2012	4	<0.099	<0.0020	<0.0020	<0.0020	<0.0040	<0.0050	<0.099	---	---	---	<0.0020	<0.0020	---
P-2	11/13/2012	4	<0.096	<0.0019	<0.0019	<0.0019	<0.0039	<0.0048	<0.096	---	---	---	<0.0019	<0.0019	---
P-3	11/13/2012	4.5	<0.10	<0.0020	<0.0020	<0.0020	<0.0040	<0.0050	<0.10	---	---	---	<0.0020	<0.0020	---
P-4	11/13/2012	4.5	0.47	<0.0020	<0.0020	0.0025	<0.0039	0.032	0.18	---	---	---	<0.0020	<0.0020	---
P-5	11/13/2012	4	0.33	<0.0020	<0.0020	<0.0020	<0.0040	0.10	<0.10	---	---	---	<0.0020	<0.0020	---
<i>Shallow Soil (≤10 fbg) ^c:</i>			180	0.27	9.3	4.7	11	8.4	110	NA	NA	NA	NA	NA	320 d
<i>Deep Soil (>10 fbg) ESL ^c:</i>			180	2.0	9.3	4.7	11	8.4	110	NA	NA	NA	NA	NA	320 d

Notes:

TPHg = Total petroleum hydrocarbons as gasoline analyzed by EPA Method 8260B; before February 20, 2001, analyzed by EPA Method 8015.

BTEX = Benzene, toluene, ethylbenzene, and total xylenes analyzed by EPA Method 8260B; before February 20, 2001, analyzed by EPA Method 8020.

MTBE = Methyl tertiary-butyl ether analyzed by EPA Method 8260B; before February 20, 2001, analyzed by EPA Method 8020 unless otherwise noted.

TBA = Tertiary-butyl alcohol analyzed by EPA Method 8260B

DIPE = Di-isopropyl ether analyzed by EPA Method 8260B

ETBE = Ethyl tertiary-butyl ether analyzed by EPA Method 8260B

TAME = Tertiary-amyl methyl ether analyzed by EPA Method 8260B

1,2-DCA = 1,2-Dichloroethane analyzed by EPA Method 8260B

EDB = 1,2-Dibromoethane analyzed by EPA Method 8260B

Lead analyzed by EPA Method 6010B; before May 6, 2004 analyzed according to Title 22

**HISTORICAL SOIL ANALYTICAL DATA
SHELL-BRANDED SERVICE STATION
2120 MONTANA STREET, OAKLAND, CALIFORNIA**

<i>Sample ID</i>	<i>Date</i>	<i>Depth</i> (fbg)	<i>TPHg</i> (mg/kg)	<i>B</i> (mg/kg)	<i>T</i> (mg/kg)	<i>E</i> (mg/kg)	<i>X</i> (mg/kg)	<i>MTBE</i> (mg/kg)	<i>TBA</i> (mg/kg)	<i>DIPE</i> (mg/kg)	<i>ETBE</i> (mg/kg)	<i>TAME</i> (mg/kg)	<i>1,2-DCA</i> (mg/kg)	<i>EDB</i> (mg/kg)	<i>Lead</i> (mg/kg)
------------------	-------------	-----------------------	------------------------	---------------------	---------------------	---------------------	---------------------	------------------------	-----------------------	------------------------	------------------------	------------------------	---------------------------	-----------------------	------------------------

fbg = Feet below grade

mg/kg = Milligrams per kilogram

--- = Not analyzed

<x = Not detected at reporting limit x

ESL = Environmental screening level

NA = No applicable ESL

CHHSL = California human health screening level

Results in bold exceed ESL

a = Lead results reported are based on a composite sample of D-1, D-2, and D-3

b = Analyzed by EPA Method 8260B

c = San Francisco Bay Regional Water Quality Control Board commercial/industrial ESL for soil where groundwater is not a current or potential source of drinking water. Commercial land use. Ref: Tables B and D of *Screening for Environmental Concerns at Sites With Contaminated Soil and Groundwater*, Interim Final - November 2007 (Revised May 2008).

d = Updated CHHSL for total exposure (inhalation, ingestion, and dermal absorption) developed by the California Office of Environmental Health Hazard Assessment (September 23, 2010) for lead in soil with commercial land use.

TABLE 1

**GROUNDWATER DATA
SHELL-BRANDED SERVICE STATION
2120 MONTANA STREET, OAKLAND, CALIFORNIA**

<i>Well ID</i>	<i>Date</i>	<i>TPHg (µg/L)</i>	<i>B (µg/L)</i>	<i>T (µg/L)</i>	<i>E (µg/L)</i>	<i>X (µg/L)</i>	<i>MTBE (µg/L)</i>	<i>TBA (µg/L)</i>	<i>DIPE (µg/L)</i>	<i>ETBE (µg/L)</i>	<i>TAME (µg/L)</i>	<i>TOC (ft MSL)</i>	<i>Depth to Water (ft TOC)</i>	<i>GW Elevation (ft MSL)</i>	<i>SPH Thickness (ft)</i>
MW-1	03/19/2001	---	---	---	---	---	---	---	---	---	---	159.59	12.14	147.45	---
MW-1	03/23/2001	16,600	753	1,720	407	2,330	27,500	---	---	---	---	159.59	12.25	147.34	---
MW-1	05/31/2001	<20,000	1,000	920	490	2,000	54,000	---	---	---	---	159.59	12.22	147.37	---
MW-1	06/27/2001	---	---	---	---	---	---	---	---	---	---	159.59	13.00 a	---	---
MW-1	07/09/2001	---	---	---	---	---	---	---	---	---	---	159.59	13.17	146.67	0.31
MW-1	09/25/2001	---	---	---	---	---	---	---	---	---	---	159.59	14.27	145.66	0.43
MW-1	11/20/2001	---	---	---	---	---	---	---	---	---	---	159.59	13.49	146.14	0.05
MW-1	12/05/2001	---	---	---	---	---	---	---	---	---	---	159.59	11.32	148.31	0.05
MW-1	03/01/2002	---	---	---	---	---	---	---	---	---	---	159.59	13.22	146.56	0.24
MW-1	06/06/2002	---	---	---	---	---	---	---	---	---	---	159.59	12.99	147.00	0.50
MW-1	07/16/2002	---	---	---	---	---	---	---	---	---	---	159.59	13.37	146.22	---
MW-1	09/06/2002	---	---	---	---	---	---	---	---	---	---	159.57	13.30	146.70	0.54
MW-1	12/12/2002	---	---	---	---	---	---	---	---	---	---	159.57	13.78	146.61	1.03
MW-1	03/31/2003	---	---	---	---	---	---	---	---	---	---	159.57	11.21	148.38	0.03
MW-1	06/30/2003	7,800	<25	37	<25	380	2,000	---	---	---	---	159.57	12.20	147.37	---
MW-1	09/09/2003	---	---	---	---	---	---	---	---	---	---	159.08	15.70	145.28	2.38
MW-1	12/29/2003	---	---	---	---	---	---	---	---	---	---	159.08	11.25	147.89	0.07
MW-1	03/17/2004	---	---	---	---	---	---	---	---	---	---	159.08	11.80	147.40	0.15
MW-1	05/24/2004	---	---	---	---	---	---	---	---	---	---	159.08	12.42	146.71	0.06
MW-1	09/17/2004	8,000	530	380	330	960	1,100	4,100	<20	<20	<20	159.08	15.95	143.13	---
MW-1	12/06/2004	2,800	150	<5.0	120	120	300	---	---	---	---	159.08	13.15	145.93	---
MW-1	03/02/2005	13,000	490	710	360	2,200	5,000	---	---	---	---	159.08	12.14	146.94	---
MW-1	06/10/2005	5,600	210	120	120	910	3,100	---	---	---	---	159.08	---	---	<0.01
MW-1	09/01/2005	<1,300	73	<13	30	42	2,400	13,000	<50	<50	<50	159.08	11.71	147.37	---
MW-1	11/16/2005	4,150	62.7	10.9	45.2	98.9	845	---	---	---	---	159.08	11.71	147.37	---
MW-1 c	03/03/2006	<50.0	<0.500	<0.500	<0.500	<0.500	0.790	<10.0	---	---	---	159.08	13.37	145.71	---
MW-1	05/12/2006	3,430	80.0	0.530	26.8	71.9	154	1,040	---	---	---	159.08	17.41	141.67	---
MW-1	09/05/2006	5,390	24.8	2.44	6.69	22.2	106	4,860	<0.500	<0.500	<0.500	159.08	12.12	146.96	---
MW-1	12/18/2006	6,800	120	28	110	840	1,100	5,400	---	---	---	159.08	10.74	148.34	---
MW-1	03/21/2007	Well inaccessible		---	---	---	---	---	---	---	---	159.08	---	---	---

TABLE 1

**GROUNDWATER DATA
SHELL-BRANDED SERVICE STATION
2120 MONTANA STREET, OAKLAND, CALIFORNIA**

<i>Well ID</i>	<i>Date</i>	<i>TPHg (µg/L)</i>	<i>B (µg/L)</i>	<i>T (µg/L)</i>	<i>E (µg/L)</i>	<i>X (µg/L)</i>	<i>MTBE (µg/L)</i>	<i>TBA (µg/L)</i>	<i>DIPE (µg/L)</i>	<i>ETBE (µg/L)</i>	<i>TAME (µg/L)</i>	<i>TOC (ft MSL)</i>	<i>Depth to Water (ft TOC)</i>	<i>GW Elevation (ft MSL)</i>	<i>SPH Thickness (ft)</i>
MW-1	06/14/2007	6,200	18	<5.0	11	4.6 e	68	1,800	---	---	---	159.08	19.82	139.26	---
MW-1	08/27/2007	2,700 f	13	<5.0	3.9 e	5.6 e	54	1,200	<10	<10	<10	159.08	12.20	146.88	---
MW-1	11/29/2007	2,600 f	20	1.9 e	8.3	29.4	350	4,100	---	---	---	159.08	11.68	147.40	---
MW-1	03/21/2008	4,600	42	<5.0	120	94	300	3,200	---	---	---	159.08	11.59	147.49	---
MW-1	05/29/2008	1,800	11	<5.0	<5.0	<5.0	150	3,900	---	---	---	159.08	11.87	147.21	---
MW-1	08/29/2008	2,400	42	<5.0	23	<5.0	320	4,700	<10	<10	<10	159.08	12.33	146.75	---
MW-1	12/29/2008	2,700	30	<5.0	28	45	460	3,300	---	---	---	159.08	11.21	147.87	---
MW-1	03/05/2009	2,000	15	<5.0	<5.0	66	83	980	---	---	---	159.08	8.98	150.10	---
MW-1	05/27/2009	2,100	25	<1.0	69	52	220	2,500	---	---	---	159.08	11.71	147.37	---
MW-1	12/28/2009	1,500	8.5	<2.0	8.8	7.4	140	1,800	<4.0	<4.0	<4.0	159.08	11.13	147.95	---
MW-1	06/02/2010	2,100	22	<2.0	73	51	140	2,600	---	---	---	159.08	11.10	147.98	---
MW-1	12/28/2010	3,700	26	<2.0	69	260	100	1,400	<4.0	<4.0	<4.0	159.08	9.95	149.13	---
MW-1	06/20/2011	2,000	11	<0.50	93	120	64	1,400	---	---	---	159.08	11.40	147.68	---
MW-1	12/13/2011	1,100	1.14	<0.500	2.55	3.58	36.0	530	<0.500	<0.500	<0.500	159.08	12.17	146.91	---
MW-1	05/30/2012	870	1.8	<1.0	9.9	5.7	25	810	---	---	---	159.08	11.56	147.52	---
MW-2	03/19/2001	---	---	---	---	---	---	---	---	---	---	158.03	11.60	146.43	---
MW-2	03/23/2001	4,450	280	41.0	62.1	63.0	16,600	---	---	---	---	158.03	11.76	146.27	---
MW-2	05/31/2001	<20,000	820	<200	<200	<200	63,000	---	---	---	---	158.03	11.40	146.63	---
MW-2	06/27/2001	<50,000	610	4.0	13	9.2	47,000	---	---	---	---	158.03	12.65	145.38	---
MW-2	09/25/2001	<2,000	41	<20	<20	<20	6,400	---	---	---	---	158.03	12.89	145.14	---
MW-2	12/05/2001	<2,000	74	<20	<20	<20	8,400	---	---	---	---	158.03	10.40	147.63	---
MW-2	03/01/2002	<1,000	<10	<10	<10	<10	2,900	---	---	---	---	158.03	11.52	146.51	---
MW-2	06/06/2002	<5,000	210	<50	<50	<50	23,000	---	---	---	---	158.03	12.15	145.88	---
MW-2	07/16/2002	---	---	---	---	---	---	---	---	---	---	158.03	12.25	145.78	---
MW-2	09/06/2002	<2,000	56	<20	<20	<20	11,000	---	---	---	---	158.01	12.44	145.57	---
MW-2	12/12/2002	<2,500	80	<25	<25	<25	13,000	---	---	---	---	158.01	12.53	145.48	---
MW-2	03/31/2003	<5,000	230	1,200	95	150	13,000	---	---	---	---	158.01	11.98	146.03	---
MW-2	06/30/2003	<12,000	780	<120	170	250	9,000	---	---	---	---	158.01	12.10	145.91	---
MW-2	09/09/2003	140,000	4,600	40,000	4,800	32,000	11,000	---	---	---	---	158.01	12.94	145.07	---

TABLE 1

**GROUNDWATER DATA
SHELL-BRANDED SERVICE STATION
2120 MONTANA STREET, OAKLAND, CALIFORNIA**

<i>Well ID</i>	<i>Date</i>	<i>TPHg (µg/L)</i>	<i>B (µg/L)</i>	<i>T (µg/L)</i>	<i>E (µg/L)</i>	<i>X (µg/L)</i>	<i>MTBE (µg/L)</i>	<i>TBA (µg/L)</i>	<i>DIPE (µg/L)</i>	<i>ETBE (µg/L)</i>	<i>TAME (µg/L)</i>	<i>TOC (ft MSL)</i>	<i>Depth to Water (ft TOC)</i>	<i>GW Elevation (ft MSL)</i>	<i>SPH Thickness (ft)</i>
MW-2	12/29/2003	220,000	240	4,800	2,900	19,000	1,000	---	---	---	---	158.01	11.20	146.81	---
MW-2	03/17/2004	25,000	170	390	280	1,400	1,500	---	---	---	---	158.01	11.40	146.61	---
MW-2	05/24/2004	140,000	<25	220	1,200	6,800	320	---	---	---	---	158.01	12.28	145.73	---
MW-2	09/17/2004	64,000	2,900	230	2,300	9,700	6,300	4,100	<100	<100	<100	158.01	12.90	145.11	---
MW-2	12/06/2004	47,000	1,200	46	1,300	6,000	3,900	---	---	---	---	158.01	13.02	144.99	---
MW-2	03/02/2005	85,000	1,600	81	1,900	6,900	2,500	---	---	---	---	158.01	11.06	146.95	---
MW-2	06/10/2005	100,000	450	<25	440	800	300	---	---	---	---	158.01	11.71	146.30	---
MW-2	09/01/2005	140,000 g	490	<25	550	850	110	1,900	<100	<100	<100	158.01	12.11	145.90	---
MW-2	11/16/2005	473,000 d	776	18.7	1,300	2,730	374	---	---	---	---	158.01	12.15	145.86	---
MW-2 c	03/03/2006	4,830	6.25	2.29	14.6	5.45	106	228	---	---	---	158.01	11.40	146.61	---
MW-2	05/12/2006	7,610	1,200	27.9	858	396	688	681	---	---	---	158.01	14.22	143.79	---
MW-2	09/05/2006	84,000	683	10.2	314	300	96.7	1,250	<0.500	<0.500	<0.500	158.01	12.20	145.81	---
MW-2	12/18/2006	19,000	230	6.2	130	64	94	1,600	---	---	---	158.01	11.03	146.98	---
MW-2	03/21/2007	30,000	380	31	460	290	95	1,700	---	---	---	158.01	11.75	146.26	---
MW-2	06/14/2007	Well inaccessible	---	---	---	---	---	---	---	---	---	158.01	---	---	---
MW-2	08/27/2007	83,000 f	220	8.7 e	99	24.5 e	<10	980	<20	<20	<20	158.01	12.54	145.47	---
MW-2	11/29/2007	23,000 f	28	<10	20	<10	<10	1,200	---	---	---	158.01	11.77	146.24	---
MW-2	03/21/2008	Well inaccessible	---	---	---	---	---	---	---	---	---	158.01	---	---	---
MW-2	05/29/2008	14,000	130	14	78	6.8	130	1,000	---	---	---	158.01	12.11	145.90	---
MW-2	08/29/2008	14,000	120	10	23	6.6	60	810	<10	<10	<10	158.01	12.32	145.69	---
MW-2	12/29/2008	33,000	110	<10	15	<10	58	890	---	---	---	158.01	11.61	146.40	---
MW-2	03/05/2009	22,000	250	55	130	60	130	1,200	---	---	---	158.01	9.60	148.41	---
MW-2	05/27/2009	11,000	150	20	110	49	110	740	---	---	---	158.01	12.08	145.93	---
MW-2	12/28/2009	20,000	120	9.5	16	11	85	720	<10	<10	<10	158.01	11.79	146.22	---
MW-2	06/02/2010	59,000	100	<20	36	<20	75	600	---	---	---	158.01	11.92	146.09	---
MW-2	12/28/2010	9,100	120	8.9	52	26	50	700	<10	<10	<10	158.01	10.84	147.17	---
MW-2	06/20/2011	12,000	36	8.8	28	21	68	570	---	---	---	158.01	12.34	145.67	---
MW-2	12/13/2011	6,000	21.9	2.15	2.98	4.19	27.6	307	<0.500	<0.500	<0.500	158.01	12.88	145.13	---
MW-2	05/30/2012	6,100	40	13	14	29	<5.0	550	---	---	---	158.01	12.71	145.30	---

TABLE 1

**GROUNDWATER DATA
SHELL-BRANDED SERVICE STATION
2120 MONTANA STREET, OAKLAND, CALIFORNIA**

<i>Well ID</i>	<i>Date</i>	<i>TPHg (µg/L)</i>	<i>B (µg/L)</i>	<i>T (µg/L)</i>	<i>E (µg/L)</i>	<i>X (µg/L)</i>	<i>MTBE (µg/L)</i>	<i>TBA (µg/L)</i>	<i>DIPE (µg/L)</i>	<i>ETBE (µg/L)</i>	<i>TAME (µg/L)</i>	<i>TOC (ft MSL)</i>	<i>Depth to Water (ft TOC)</i>	<i>GW Elevation (ft MSL)</i>	<i>SPH Thickness (ft)</i>
MW-3	03/19/2001	---	---	---	---	---	---	---	---	---	---	161.13	11.42	149.71	---
MW-3	03/23/2001	<50.0	<0.500	<0.500	<0.500	<0.500	1.26	---	---	---	---	161.13	11.42	149.71	---
MW-3	05/31/2001	<50	<0.50	<0.50	<0.50	<0.50	<5.0	---	---	---	---	161.13	13.00	148.13	---
MW-3	06/27/2001	<50	<0.50	<0.50	<0.50	<0.50	<0.50	---	---	---	---	161.13	12.32	148.81	---
MW-3	09/25/2001	<50	<0.50	<0.50	<0.50	<0.50	<0.50	---	---	---	---	161.13	12.50	148.63	---
MW-3	12/05/2001	<50	<0.50	<0.50	<0.50	<0.50	<5.0	---	---	---	---	161.13	10.13	151.00	---
MW-3	03/01/2002	<50	<0.50	<0.50	<0.50	0.73	<5.0	---	---	---	---	161.13	11.63	149.50	---
MW-3	06/06/2002	<50	<0.50	<0.50	<0.50	<0.50	<5.0	---	---	---	---	161.13	11.55	149.58	---
MW-3	07/16/2002	---	---	---	---	---	---	---	---	---	---	161.13	11.72	149.41	---
MW-3	09/06/2002	<50	<0.50	<0.50	<0.50	<0.50	<5.0	---	---	---	---	161.11	12.24	148.87	---
MW-3	12/12/2002	<50	<0.50	<0.50	<0.50	<0.50	<5.0	---	---	---	---	161.11	12.18	148.93	---
MW-3	03/31/2003	<50	<0.50	<0.50	<0.50	<1.0	0.78	---	---	---	---	161.11	11.94	149.17	---
MW-3	06/30/2003	<50	<0.50	<0.50	<0.50	<1.0	<0.50	---	---	---	---	161.11	12.50	148.61	---
MW-3	09/09/2003	<50	<0.50	<0.50	<0.50	<1.0	<0.50	---	---	---	---	161.11	12.55	148.56	---
MW-3	12/29/2003	<50	<0.50	<0.50	<0.50	<1.0	0.70	---	---	---	---	161.11	10.90	150.21	---
MW-3	03/17/2004	<50	<0.50	<0.50	<0.50	<1.0	2.1	---	---	---	---	161.11	11.63	149.48	---
MW-3	05/24/2004	<50	<0.50	<0.50	<0.50	1.0	0.96	---	---	---	---	161.11	11.32	149.79	---
MW-3	09/17/2004	<50	<0.50	<0.50	<0.50	1.0	2.6	<5.0	<2.0	<2.0	<2.0	161.11	12.13	148.98	---
MW-3	12/06/2004	<50	<0.50	<0.50	<0.50	<1.0	6.1	---	---	---	---	161.11	12.28	148.83	---
MW-3	03/02/2005	<50	<0.50	<0.50	<0.50	<1.0	2.4	---	---	---	---	161.11	10.42	150.69	---
MW-3	06/10/2005	<50	<0.50	<0.50	<0.50	<1.0	1.6	---	---	---	---	161.11	11.15	149.96	---
MW-3	09/01/2005	<50	<0.50	<0.50	<0.50	<1.0	0.54	<5.0	<2.0	<2.0	<2.0	161.11	12.55	148.56	---
MW-3	11/16/2005	<50.0	<0.500	<0.500	<0.500	<0.500	0.570	---	---	---	---	161.11	12.04	149.07	---
MW-3 c	03/03/2006	16,000 d	191	107 d	127	997 d	1,090 d	---	---	---	---	161.11	10.36	150.75	---
MW-3	05/12/2006	<50.0	<0.500	<0.500	<0.500	<0.500	1.45	---	---	---	---	161.11	12.24	148.87	---
MW-3	09/05/2006	<50.0	<0.500	<0.500	<0.500	<0.500	1.62	<10.0	<0.500	<0.500	<0.500	161.11	12.52	148.59	---
MW-3	12/18/2006	<50	<0.50	<0.50	<0.50	<1.0	0.88	---	---	---	---	161.11	11.00	150.11	---
MW-3	03/21/2007	<50	<0.50	<0.50	<0.50	<1.0	<1.0	---	---	---	---	161.11	12.10	149.01	---
MW-3	06/14/2007	100	<0.50	<1.0	<1.0	<1.0	2.4	---	---	---	---	161.11	12.08	149.03	---
MW-3	08/27/2007	<50 f	<0.50	<1.0	<1.0	<1.0	1.3	<10	<2.0	<2.0	<2.0	161.11	12.54	148.57	---

TABLE 1

**GROUNDWATER DATA
SHELL-BRANDED SERVICE STATION
2120 MONTANA STREET, OAKLAND, CALIFORNIA**

<i>Well ID</i>	<i>Date</i>	<i>TPHg (µg/L)</i>	<i>B (µg/L)</i>	<i>T (µg/L)</i>	<i>E (µg/L)</i>	<i>X (µg/L)</i>	<i>MTBE (µg/L)</i>	<i>TBA (µg/L)</i>	<i>DIPE (µg/L)</i>	<i>ETBE (µg/L)</i>	<i>TAME (µg/L)</i>	<i>TOC (ft MSL)</i>	<i>Depth to Water (ft TOC)</i>	<i>GW Elevation (ft MSL)</i>	<i>SPH Thickness (ft)</i>
MW-3	11/29/2007	<50 f	<0.50	<1.0	<1.0	<1.0	0.52 e	---	---	---	---	161.11	12.09	149.02	---
MW-3	03/21/2008	<50	<0.50	<1.0	<1.0	<1.0	<1.0	---	---	---	---	161.11	12.20	148.91	---
MW-3	05/29/2008	<50	<0.50	<1.0	<1.0	<1.0	<1.0	---	---	---	---	161.11	12.12	148.99	---
MW-3	08/29/2008	<50	<0.50	<1.0	<1.0	<1.0	<1.0	<10	<2.0	<2.0	<2.0	161.11	12.49	148.62	---
MW-3	12/29/2008	<50	<0.50	<1.0	<1.0	<1.0	<1.0	---	---	---	---	161.11	11.40	149.71	---
MW-3	03/05/2009	<50	<0.50	<1.0	<1.0	<1.0	<1.0	---	---	---	---	161.11	9.50	151.61	---
MW-3	05/27/2009	<50	<0.50	<1.0	<1.0	<1.0	<1.0	---	---	---	---	161.11	11.83	149.28	---
MW-3	12/28/2009	<50	<0.50	<1.0	<1.0	<1.0	<1.0	<10	<2.0	<2.0	<2.0	161.11	11.68	149.43	---
MW-3	06/02/2010	<50	<0.50	<1.0	<1.0	<1.0	<1.0	---	---	---	---	161.11	11.71	149.40	---
MW-3	12/28/2010	<50	<0.50	<1.0	<1.0	<1.0	<1.0	<10	<2.0	<2.0	<2.0	161.11	10.80	150.31	---
MW-3	06/20/2011	<50	<0.50	<0.50	<0.50	<1.0	<1.0	---	---	---	---	161.11	11.95	149.16	---
MW-3	12/13/2011	<50	<0.500	<0.500	<0.500	<0.500	<0.500	<10.0	<0.500	<0.500	<0.500	161.11	12.00	149.11	---
MW-3	05/30/2012	<50	<0.50	<0.50	<0.50	<1.0	<0.50	---	---	---	---	161.11	12.22	148.89	---
MW-4	07/10/2002	---	---	---	---	---	---	---	---	---	---	---	13.19	---	---
MW-4	07/16/2002	800	1.1	1.1	2.6	2.4	450	---	---	---	---	---	13.56	---	---
MW-4	09/06/2002	1,100	3.0	1.8	8.0	4.6	110	---	---	---	---	160.09	13.67	146.42	---
MW-4	12/12/2002	130	<0.50	<0.50	<0.50	<0.50	940	---	---	---	---	160.09	14.06	146.03	---
MW-4	03/31/2003	<250	<2.5	<2.5	<2.5	<5.0	500	---	---	---	---	160.09	13.69	146.40	---
MW-4	06/30/2003	3,100	5.3	<5.0	7.1	<10	420	---	---	---	---	160.09	14.12	145.97	---
MW-4	09/09/2003	1,400	2.4	2.0	2.6	3.2	140	---	---	---	---	160.09	14.92	145.17	---
MW-4	12/29/2003	2,700	10	6.2	20	11	420	---	---	---	---	160.09	12.71	147.38	---
MW-4	03/17/2004	1,900	6.9	3.0	33	22	290	---	---	---	---	160.09	13.24	146.85	---
MW-4	05/24/2004	1,800	<2.5	<2.5	<2.5	11	44	---	---	---	---	160.09	14.03	146.06	---
MW-4	09/17/2004	3,300	57	10	47	32	310	700	<10	<10	<10	160.09	13.58	146.51	---
MW-4	12/06/2004	4,700	9.4	3.8	34	12	150	---	---	---	---	160.09	14.65	145.44	---
MW-4	03/02/2005	<1,300	<13	<13	<13	<25	150	---	---	---	---	160.09	12.67	147.42	---
MW-4	06/10/2005	2,600	4.1	1.9	25	5.6	61	---	---	---	---	160.09	13.11	146.98	---
MW-4	09/01/2005	4,000 g	<13	<13	22	<25	36	<130	<50	<50	<50	160.09	14.00	146.09	---
MW-4	11/16/2005	4,740	3.23	1.75	12.8	6.06	12.2	---	---	---	---	160.09	13.87	146.22	---

TABLE 1

**GROUNDWATER DATA
SHELL-BRANDED SERVICE STATION
2120 MONTANA STREET, OAKLAND, CALIFORNIA**

<i>Well ID</i>	<i>Date</i>	<i>TPHg (µg/L)</i>	<i>B (µg/L)</i>	<i>T (µg/L)</i>	<i>E (µg/L)</i>	<i>X (µg/L)</i>	<i>MTBE (µg/L)</i>	<i>TBA (µg/L)</i>	<i>DIPE (µg/L)</i>	<i>ETBE (µg/L)</i>	<i>TAME (µg/L)</i>	<i>TOC (ft MSL)</i>	<i>Depth to Water (ft TOC)</i>	<i>GW Elevation (ft MSL)</i>	<i>SPH Thickness (ft)</i>
MW-4 c	03/03/2006	79,300 d	649 d	37.2	470 d	326	577 d	---	---	---	---	160.09	12.80	147.29	---
MW-4	05/12/2006	2,750	8.03	<0.500	<0.500	<0.500	244	---	---	---	---	160.09	16.26	143.83	---
MW-4	09/05/2006	2,230	2.04	1.24	<0.500	1.50	95.9	239	<0.500	<0.500	<0.500	160.09	13.92	146.17	---
MW-4	12/18/2006	1,400	4.3	1.7	7.3	2.8	140	---	---	---	---	160.09	12.71	147.38	---
MW-4	03/21/2007	540	0.68	0.51	4.0	<1.0	140	---	---	---	---	160.09	13.35	146.74	---
MW-4	06/14/2007	---	---	---	---	---	---	---	---	---	---	160.09	19.02	141.07	---
MW-4	08/27/2007	880 f,g	0.38 e	<1.0	<1.0	<1.0	8.5	98	<2.0	<2.0	<2.0	160.09	13.92	146.17	---
MW-4	11/29/2007	3,200 f	1.9	1.2	1.9	2.55 e	<1.0	---	---	---	---	160.09	13.50	146.59	---
MW-4	03/21/2008	350	<0.50	<1.0	<1.0	<1.0	8.2	---	---	---	---	160.09	13.45	146.64	---
MW-4	05/29/2008	1,800	1.6	<1.0	1.8	1.5	13	---	---	---	---	160.09	13.73	146.36	---
MW-4	08/29/2008	1,300	1.5	<1.0	1.2	1.3	13	54	<2.0	<2.0	<2.0	160.09	14.08	146.01	---
MW-4	12/29/2008	1,700	1.8	1.4	2.3	1.6	8.9	---	---	---	---	160.09	13.13	146.96	---
MW-4	03/05/2009	1,800	1.6	<1.0	<1.0	<1.0	16	---	---	---	---	160.09	11.12	148.97	---
MW-4	05/27/2009	2,000	4.6	1.8	3.5	2.2	28	---	---	---	---	160.09	13.35	146.74	---
MW-4	12/28/2009	1,100	0.66	<1.0	<1.0	<1.0	7.4	72	<2.0	<2.0	<2.0	160.09	13.35	146.74	---
MW-4	06/02/2010	1,400	1.5	<1.0	1.8	1.0	8.6	---	---	---	---	160.09	13.33	146.76	---
MW-4	12/28/2010	1,100	<0.50	<1.0	<1.0	<1.0	5.8	50	<2.0	<2.0	<2.0	160.09	12.38	147.71	---
MW-4	06/20/2011	90	<0.50	<0.50	<0.50	<1.0	2.8	---	---	---	---	160.09	13.87	146.22	---
MW-4	12/13/2011	290	<0.500	<0.500	<0.500	<0.500	<0.500	<10.0	<0.500	<0.500	<0.500	160.09	14.04	146.05	---
MW-4	05/30/2012	110	<0.50	<0.50	<0.50	<1.0	5.0	---	---	---	---	160.09	12.77	147.32	---
MW-5	07/10/2002	---	---	---	---	---	---	---	---	---	---	---	12.22	---	---
MW-5	07/16/2002	6,100	65	7.2	100	130	410	---	---	---	---	---	12.50	---	---
MW-5	09/06/2002	5,900	100	8.1	41	32	230	---	---	---	---	158.25	12.77	145.48	---
MW-5	12/12/2002	4,900	70	5.7	25	17	280	---	---	---	---	158.25	12.71	145.54	---
MW-5	03/31/2003	6,400	61	4.9	23	13	330	---	---	---	---	158.25	11.93	146.32	---
MW-5	06/30/2003	3,400	18	<2.5	17	5.5	47	---	---	---	---	158.25	11.97	146.28	---
MW-5	09/09/2003	6,800	46	23	39	42	67	---	---	---	---	158.25	12.44	145.81	---
MW-5	12/29/2003	8,400	44	6.2	36	16	60	---	---	---	---	158.25	11.38	146.87	---
MW-5	03/17/2004	7,100	120	22	42	27	300	---	---	---	---	158.25	11.68	146.57	---

TABLE 1

**GROUNDWATER DATA
SHELL-BRANDED SERVICE STATION
2120 MONTANA STREET, OAKLAND, CALIFORNIA**

<i>Well ID</i>	<i>Date</i>	<i>TPHg (µg/L)</i>	<i>B (µg/L)</i>	<i>T (µg/L)</i>	<i>E (µg/L)</i>	<i>X (µg/L)</i>	<i>MTBE (µg/L)</i>	<i>TBA (µg/L)</i>	<i>DIPE (µg/L)</i>	<i>ETBE (µg/L)</i>	<i>TAME (µg/L)</i>	<i>TOC (ft MSL)</i>	<i>Depth to Water (ft TOC)</i>	<i>GW Elevation (ft MSL)</i>	<i>SPH Thickness (ft)</i>
MW-5	05/24/2004	6,100	72	17	34	23	110	---	---	---	---	158.25	12.30	145.95	---
MW-5	09/17/2004	5,700	27	5.3	35	<10	28	<50	<20	<20	<20	158.25	12.15	146.10	---
MW-5	12/06/2004	4,500	11	<5.0	22	<10	7.5	---	---	---	---	158.25	12.85	145.40	---
MW-5	03/02/2005	6,500	14	<2.5	18	<5.0	6.0	---	---	---	---	158.25	10.83	147.42	---
MW-5	06/10/2005	5,300	19	2.4	17	4.3	7.2	---	---	---	---	158.25	12.00	146.25	---
MW-5	09/01/2005	1,900 g	5.3	<2.5	6.9	<5.0	<2.5	<25	<10	<10	<10	158.25	12.30	145.95	---
MW-5	11/16/2005	3,590	4.66	0.580	7.69	1.45	1.13	---	---	---	---	158.25	12.58	145.67	---
MW-5	03/03/2006	5,760	7.08	0.960	8.46	2.18	2.65	---	---	---	---	158.25	11.15	147.10	---
MW-5	05/12/2006	1,960	3.66	<0.500	1.03	<0.500	1.45	---	---	---	---	158.25	12.55	145.70	---
MW-5	09/05/2006	3,730	4.23	0.780	3.19	0.790	1.77	32.9	<0.500	<0.500	<0.500	158.25	12.70	145.55	---
MW-5	12/18/2006	1,600	5.1	0.66	6.0	3.3	<0.50	---	---	---	---	158.25	11.40	146.85	---
MW-5	03/21/2007	210	1.7	<0.50	<0.50	<1.0	<1.0	---	---	---	---	158.25	12.17	146.08	---
MW-5	06/14/2007	2,300	1.5	<1.0	0.43 e	<1.0	<1.0	---	---	---	---	158.25	13.50	144.75	---
MW-5	08/27/2007	2,500 f,g	3.2	0.41 e	2.8	2.48 e	<1.0	6.8 e	<2.0	<2.0	<2.0	158.25	12.55	145.70	---
MW-5	11/29/2007	2,300 f	7.8	0.45 e	0.75 e	0.60 e	<1.0	---	---	---	---	158.25	11.97	146.28	---
MW-5	03/21/2008	1,400	24	5.5	1.8	2.2	6.6	---	---	---	---	158.25	11.70	146.55	---
MW-5	05/29/2008	1,400	33	2.9	<1.0	3.2	6.9	---	---	---	---	158.25	12.27	145.98	---
MW-5	08/29/2008	960	14	<1.0	<1.0	1.4	4.3	<10	<2.0	<2.0	<2.0	158.25	12.46	145.79	---
MW-5	12/29/2008	1,200	12	<1.0	<1.0	<1.0	<1.0	---	---	---	---	158.25	11.80	146.45	---
MW-5	03/05/2009	1,900	24	2.9	3.7	7.9	<1.0	---	---	---	---	158.25	9.82	148.43	---
MW-5	05/27/2009	1,400	23	1.7	2.0	4.9	4.4	---	---	---	---	158.25	12.34	145.91	---
MW-5	12/28/2009	980	7.5	<1.0	<1.0	<1.0	2.3	<10	<2.0	<2.0	<2.0	158.25	12.18	146.07	---
MW-5	06/02/2010	1,200	12	<1.0	<1.0	3.1	<1.0	---	---	---	---	158.25	12.04	146.21	---
MW-5	12/28/2010	970	5.5	<1.0	<1.0	<1.0	1.3	<10	<2.0	<2.0	<2.0	158.25	11.11	147.14	---
MW-5	06/20/2011	1,400	9.4	0.90	0.99	3.6	2.6	---	---	---	---	158.25	12.54	145.71	---
MW-5	12/13/2011	1,500	6.41	0.640	0.610	1.76	2.53	<10.0	<0.500	<0.500	<0.500	158.25	13.00	145.25	---
MW-5	05/30/2012	1,000	3.5	0.66	0.82	<1.0	2.0	---	---	---	---	158.25	12.74	145.51	---
TBW-N	09/25/2001 b	120,000	3,200	2,800	4,000	18,000	31,000	---	---	---	---	---	12.25	---	---
TBW-N	11/20/2001	72,000	2,200	3,600	2,600	14,000	35,000	---	---	---	---	---	12.13	---	---

TABLE 1

**GROUNDWATER DATA
SHELL-BRANDED SERVICE STATION
2120 MONTANA STREET, OAKLAND, CALIFORNIA**

<i>Well ID</i>	<i>Date</i>	<i>TPHg (µg/L)</i>	<i>B (µg/L)</i>	<i>T (µg/L)</i>	<i>E (µg/L)</i>	<i>X (µg/L)</i>	<i>MTBE (µg/L)</i>	<i>TBA (µg/L)</i>	<i>DIPE (µg/L)</i>	<i>ETBE (µg/L)</i>	<i>TAME (µg/L)</i>	<i>TOC (ft MSL)</i>	<i>Depth to Water (ft TOC)</i>	<i>GW Elevation (ft MSL)</i>	<i>SPH Thickness (ft)</i>
TBW-N	12/05/2001	76,000	1,600	3,200	2,900	15,000	30,000	---	---	---	---	---	11.51	---	---
TBW-N	03/01/2002	91,000	1,200	4,200	2,800	14,000	29,000	---	---	---	---	---	11.88	---	---
TBW-N	06/06/2002	100,000	2,100	8,200	3,400	17,000	18,000	---	---	---	---	---	12.48	---	---
TBW-N	07/16/2002	---	---	---	---	---	---	---	---	---	---	---	12.39	---	---
TBW-N	09/06/2002	69,000	870	4,800	2,300	11,000	17,000	---	---	---	---	161.26	12.36	148.90	---
TBW-N	12/12/2002	Well inaccessible		---	---	---	---	---	---	---	---	161.26	---	---	---
TBW-N	12/19/2002	110,000	1,900	13,000	3,100	18,000	19,000	---	---	---	---	161.26	10.82	150.44	---
TBW-N	03/31/2003	62,000	1,600	6,500	2,200	11,000	11,000	---	---	---	---	161.26	10.63	150.63	---
TBW-N	06/30/2003	260,000	7,700	<120	5,800	40,000	8,400	---	---	---	---	161.26	11.51	149.75	---
TBW-N	09/09/2003	---	---	---	---	---	---	---	---	---	---	159.92	11.37	148.64	0.11
TBW-N	12/29/2003	130,000	840	8,200	2,400	18,000	5,400	---	---	---	---	159.92	10.40	149.52	---
TBW-N	03/17/2004	32,000	440	1,500	580	4,500	3,700	---	---	---	---	159.92	10.49	149.44	0.01
TBW-N	05/24/2004	110,000	380	2,600	1,600	11,000	3,100	---	---	---	---	159.92	10.72	149.20	---
TBW-N	09/17/2004	25,000	120	490	570	3,900	490	4,500	<200	<200	<200	159.92	10.80	149.12	---
TBW-N	12/06/2004	15,000	33	11	410	1,500	200	---	---	---	---	159.92	11.00	148.92	---
TBW-N	03/02/2005	7,900	15	<10	120	610	460	---	---	---	---	159.92	10.58	149.34	---
TBW-N	06/10/2005	1,200	<5.0	<5.0	13	25	93	---	---	---	---	159.92	10.68	149.24	---
TBW-N	09/01/2005	3,500 g	<10	<10	86	330	47	1,700	<40	<40	<40	159.92	11.05	148.87	---
TBW-N	11/16/2005	8,830	1.53	1.59	86.6	404	35.0	---	---	---	---	159.92	10.95	148.97	---
TBW-N	03/03/2006	955	<0.500	<0.500	1.25	<0.500	70.4	4,930	---	---	---	159.92	10.31	149.61	---
TBW-N	05/12/2006	706	<0.500	<0.500	5.81	<0.500	14.5	488	---	---	---	159.92	10.73	149.19	---
TBW-N	09/05/2006	1,230	<0.500	<0.500	6.05	2.68	15.3	265	<0.500	<0.500	<0.500	159.92	11.46	148.46	---
TBW-N	12/18/2006	290	0.68	<0.50	<0.50	<1.0	37	3,400	---	---	---	159.92	10.12	149.80	---
TBW-N	03/21/2007	300	<0.50	<0.50	<0.50	<1.0	15	820	---	---	---	159.92	10.67	149.25	---
TBW-N	06/14/2007	530	<0.50	<1.0	<1.0	<1.0	7.7	240	---	---	---	159.92	11.22	148.70	---
TBW-N	08/27/2007	100 f	0.52	<1.0	<1.0	<1.0	18	40	<2.0	<2.0	<2.0	159.92	11.44	148.48	---
TBW-N	11/29/2007	130 f	0.19 e	<1.0	<1.0	<1.0	7.8	490	---	---	---	159.92	10.58	149.34	---
TBW-N	03/21/2008	56	<0.50	<1.0	<1.0	<1.0	9.3	300	---	---	---	159.92	10.50	149.42	---
TBW-N	05/29/2008	<50	<0.50	<1.0	<1.0	<1.0	4.1	140	---	---	---	159.92	10.66	149.26	---
TBW-N	08/29/2008	54	<0.50	<1.0	<1.0	<1.0	4.3	89	<2.0	<2.0	<2.0	159.92	10.88	149.04	---

TABLE 1

**GROUNDWATER DATA
SHELL-BRANDED SERVICE STATION
2120 MONTANA STREET, OAKLAND, CALIFORNIA**

<i>Well ID</i>	<i>Date</i>	<i>TPHg (µg/L)</i>	<i>B (µg/L)</i>	<i>T (µg/L)</i>	<i>E (µg/L)</i>	<i>X (µg/L)</i>	<i>MTBE (µg/L)</i>	<i>TBA (µg/L)</i>	<i>DIPE (µg/L)</i>	<i>ETBE (µg/L)</i>	<i>TAME (µg/L)</i>	<i>TOC (ft MSL)</i>	<i>Depth to Water (ft TOC)</i>	<i>GW Elevation (ft MSL)</i>	<i>SPH Thickness (ft)</i>
TBW-N	12/29/2008	93	<0.50	<1.0	<1.0	<1.0	4.4	740	---	---	---	159.92	10.17	149.75	---
TBW-N	03/05/2009	93	<0.50	<1.0	<1.0	<1.0	6.7	1,900	---	---	---	159.92	8.62	151.30	---
TBW-N	05/27/2009	<250	<2.5	<5.0	<5.0	<5.0	<5.0	160	---	---	---	159.92	10.44	149.48	---
TBW-N	12/28/2009	<50	<0.50	<1.0	<1.0	<1.0	2.5	170	<2.0	<2.0	<2.0	159.92	9.85	150.07	---
TBW-N	06/02/2010	<50	<0.50	<1.0	<1.0	<1.0	2.5	91	---	---	---	159.92	9.76	150.16	---
TBW-N	12/28/2010	63	<0.50	<1.0	<1.0	<1.0	2.6	720	<2.0	<2.0	<2.0	159.92	9.06	150.86	---
TBW-N	06/20/2011	<50	<0.50	<0.50	<0.50	<1.0	1.7	17	---	---	---	159.92	10.00	149.92	---
TBW-N	12/13/2011	<50	<0.500	<0.500	<0.500	<0.500	2.20	<10.0	<0.500	<0.500	<0.500	159.92	9.93	149.99	---
TBW-N	05/30/2012	56	1.1	<0.50	<0.50	1.1	23	18	---	---	---	159.92	10.46	149.46	---
EW-1	05/05/2006	---	---	---	---	---	---	---	---	---	---	---	15.42	---	---
EW-1	05/12/2006	5,550	52.9	30.2	86.9	249	939	3,900	<0.500	<0.500	<0.500	---	17.33	---	---
EW-1	09/05/2006	2,700	28.3	1.64	11.8	7.98	325	1,900	<0.500	<0.500	<0.500	158.63	12.44	146.19	---
EW-1	12/18/2006	4,900	140	63	170	790	640	---	---	---	---	158.63	11.00	147.63	---
EW-1	03/21/2007	1,000	32	<2.5	14	48	420	---	---	---	---	158.63	14.61	144.02	---
EW-1	06/14/2007	2,100	14	1.1	5.0	9.3	46	---	---	---	---	158.63	21.00	137.63	---
EW-1	08/27/2007	97 f	<0.50	<1.0	<1.0	0.19 e	3.6	32	<2.0	<2.0	<2.0	158.63	12.80	145.83	---
EW-1	11/29/2007	7,600 f	110	36	190	1,390	470	---	---	---	---	158.63	11.87	146.76	---
EW-1	03/21/2008	7,300	160	14	400	630	640	---	---	---	---	158.63	12.10	146.53	---
EW-1	05/29/2008	3,600	93	6.0	190	124	340	---	---	---	---	158.63	12.09	146.54	---
EW-1	08/29/2008	1,100	15	1.5	78	36	48	190	<2.0	<2.0	<2.0	158.63	12.65	145.98	---
EW-1	12/29/2008	3,200	48	4.2	100	240	180	---	---	---	---	158.63	11.45	147.18	---
EW-1	03/05/2009	2,900	58	2.4	130	220	280	---	---	---	---	158.63	8.48	150.15	---
EW-1	05/27/2009	2,300	74	2.1	59	96	160	---	---	---	---	158.63	11.90	146.73	---
EW-1	12/28/2009	2,100	23	<1.0	93	96	94	400	<2.0	<2.0	<2.0	158.63	11.68	146.95	---
EW-1	06/02/2010	1,700	13	<1.0	59	66	51	---	---	---	---	158.63	11.70	146.93	---
EW-1	12/28/2010	2,100	20	<1.0	110	170	45	340	<2.0	<2.0	<2.0	158.63	10.65	147.98	---
EW-1	06/20/2011	890	7.5	<0.50	23	24	31	---	---	---	---	158.63	12.08	146.55	---
EW-1	12/13/2011	850	3.25	<0.500	15.4	9.67	22.4	27.8	<0.500	<0.500	<0.500	158.63	12.62	146.01	---
EW-1	05/30/2012	1,100	4.4	<0.50	13	12	22	---	---	---	---	158.63	12.19	146.44	---

**GROUNDWATER DATA
SHELL-BRANDED SERVICE STATION
2120 MONTANA STREET, OAKLAND, CALIFORNIA**

<i>Well ID</i>	<i>Date</i>	<i>TPHg (µg/L)</i>	<i>B (µg/L)</i>	<i>T (µg/L)</i>	<i>E (µg/L)</i>	<i>X (µg/L)</i>	<i>MTBE (µg/L)</i>	<i>TBA (µg/L)</i>	<i>DIPE (µg/L)</i>	<i>ETBE (µg/L)</i>	<i>TAME (µg/L)</i>	<i>TOC (ft MSL)</i>	<i>Depth to Water (ft TOC)</i>	<i>GW Elevation (ft MSL)</i>	<i>SPH Thickness (ft)</i>
EW-2	05/05/2006	---	---	---	---	---	---	---	---	---	---	---	16.83	---	---
EW-2	05/12/2006	11,400	377	135	335	313	401	1,220	<0.500	<0.500	<0.500	---	15.91	---	---
EW-2	09/05/2006	1,810	41.1	4.52	17.2	74.0	87.8	606	<0.500	<0.500	<0.500	157.51	11.21	146.30	---
EW-2	12/18/2006	3,200	75	33	90	470	130	---	---	---	---	157.51	9.93	147.58	---
EW-2	03/21/2007	61	<0.50	<0.50	<0.50	1.5	18	---	---	---	---	157.51	10.55	146.96	---
EW-2	06/14/2007	570	3.8	<1.0	<1.0	<1.0	10	---	---	---	---	157.51	12.82	144.69	---
EW-2	08/27/2007	320 f	2.6	0.36 e	1.4	6.31 e	10	230	<2.0	<2.0	<2.0	157.51	10.34	147.17	---
EW-2	11/29/2007	72 f	0.83	0.53 e	0.49 e	1.41 e	12	---	---	---	---	157.51	10.80	146.71	---
EW-2	03/21/2008	250	3.5	<1.0	2.7	15.3	62	---	---	---	---	157.51	10.80	146.71	---
EW-2	05/29/2008	280	8.7	1.5	7.8	29.3	46	---	---	---	---	157.51	10.86	146.65	---
EW-2	08/29/2008	<50	<0.50	<1.0	<1.0	<1.0	<1.0	<10	<2.0	<2.0	<2.0	157.51	9.81	147.70	---
EW-2	12/29/2008	760	21	1.4	17	64	37	---	---	---	---	157.51	10.37	147.14	---
EW-2	03/05/2009	260	5.8	<1.0	8.4	30	38	---	---	---	---	157.51	8.35	149.16	---
EW-2	05/27/2009	580	27	2.4	25	79	71	---	---	---	---	157.51	10.83	146.68	---
EW-2	12/28/2009	780	31	1.6	31	67	51	270	<2.0	<2.0	<2.0	157.51	10.55	146.96	---
EW-2	06/02/2010	1,400	45	3.0	110	160	53	---	---	---	---	157.51	10.63	146.88	---
EW-2	12/28/2010	770	29	1.3	58	82	48	310	<2.0	<2.0	<2.0	157.51	9.57	147.94	---
EW-2	06/20/2011	180	12	<0.50	15	8.3	14	---	---	---	---	157.51	10.98	146.53	---
EW-2	12/13/2011	260	17.4	<0.500	16.3	10.8	12.1	63.3	<0.500	<0.500	<0.500	157.51	11.21	146.30	---
EW-2	05/30/2012	200	8.5	<0.50	9.2	2.3	13	---	---	---	---	157.51	11.23	146.28	---

Notes:

TPHg = Total petroleum hydrocarbons as gasoline analyzed by EPA Method 8260B; prior to May 31, 2001, analyzed by EPA Method 8015 unless otherwise noted.

BTEX = Benzene, toluene, ethylbenzene, and total xylenes analyzed by EPA Method 8260B; prior to May 31, 2001, analyzed by EPA Method 8020.

MTBE = Methyl tertiary-butyl ether analyzed by EPA Method 8260B

TBA = Tertiary-butyl alcohol analyzed by EPA Method 8260B

DIPE = Di-isopropyl ether analyzed by EPA Method 8260B

ETBE = Ethyl tertiary-butyl ether analyzed by EPA Method 8260B

**GROUNDWATER DATA
SHELL-BRANDED SERVICE STATION
2120 MONTANA STREET, OAKLAND, CALIFORNIA**

<i>Well ID</i>	<i>Date</i>	<i>TPHg</i> ($\mu\text{g/L}$)	<i>B</i> ($\mu\text{g/L}$)	<i>T</i> ($\mu\text{g/L}$)	<i>E</i> ($\mu\text{g/L}$)	<i>X</i> ($\mu\text{g/L}$)	<i>MTBE</i> ($\mu\text{g/L}$)	<i>TBA</i> ($\mu\text{g/L}$)	<i>DIPE</i> ($\mu\text{g/L}$)	<i>ETBE</i> ($\mu\text{g/L}$)	<i>TAME</i> ($\mu\text{g/L}$)	<i>TOC</i> (ft MSL)	<i>Depth to</i> <i>Water</i> (ft TOC)	<i>GW</i> <i>Elevation</i> (ft MSL)	<i>SPH</i> <i>Thickness</i> (ft)
----------------	-------------	------------------------------------	---------------------------------	---------------------------------	---------------------------------	---------------------------------	------------------------------------	-----------------------------------	------------------------------------	------------------------------------	------------------------------------	------------------------	---	---	--

TAME = Tertiary-amyl methyl ether analyzed by EPA Method 8260B

TOC = Top of casing elevation, in feet relative to mean sea level

GW = Groundwater

SPH = Separate-phase hydrocarbon

$\mu\text{g/L}$ = Micrograms per liter

ft = Feet

MSL = Mean sea level

<x = Not detected at reporting limit x

--- = Not analyzed or available

a = SPHs encountered during purge

b = Sample analyzed once within hold time, but the analyte concentrations all exceeded the instrument working ranges. The sample was diluted and re-analyzed out of hold time. The diluted analysis is reported because it more accurately reflects the concentrations present.

c = Several results were above the instrument calibration range and should be considered estimated values. Results from the different VOA vials were not consistent; therefore the highest results were reported.

d = Concentration exceeds the calibration range and therefore result is semi-quantitative.

e = Analyte was detected at a concentration below the reporting limit and above the laboratory method detection limit. Reported value is estimated.

f = Analyzed by EPA Method 8015B (M).

g = The sample chromatographic pattern for TPH does not match the chromatographic pattern of the specified standard. Quantitation of the unknown hydrocarbon(s) in the sample was based upon the specified standard.

When SPHs are present, GW elevation is adjusted using the relation:

Corrected GW elevation = TOC - Depth to water + (0.8 x SPH thickness).

Site wells surveyed February 12, 2002 and June 26, 2002 by Virgil Chavez Land Surveying of Vallejo, CA.

Wells MW-1 and TBW-N surveyed September 23, 2003 by Virgil Chavez Land Surveying of Vallejo, CA.

Wells EW-1 and EW-2 surveyed July 7, 2006 by Virgil Chavez Land Surveying of Vallejo, CA.