



Atlantic Richfield Company  
(a BP affiliated company)

P.O. Box 6549  
Moraga, California 94570  
Phone: (925) 299-8891  
Fax: (925) 299-8872

October 10, 2005



Alameda County  
OCT 17 2005  
Environmental Health

Re: Third Quarter 2005 Groundwater Monitoring Report  
Former ARCO Service Station #6002  
6235 Seminary Avenue  
Oakland, California  
ACEH Case #3942

I declare, that to the best of my knowledge at the present time, that the information and/or recommendations contained in the attached document are true and correct.

Submitted by:

Paul Supple  
Environmental Business Manager

|



October 10, 2005

Ms. Donna Drogos  
Alameda County Environmental Health (ACEH)  
1131 Harbor Bay Parkway, Suite 250  
Alameda, California 94502-6577

Alameda County  
OCT 17 2005  
Environmental Health

**Re: Third Quarter 2005 Groundwater Monitoring Report  
Former ARCO Service Station #6002  
6235 Seminary Avenue  
Oakland, California  
ACEH Case #3942**

Dear Ms. Drogos:

On behalf of Atlantic Richfield Company, a BP affiliated company, URS Corporation (URS) is submitting the *Third Quarter 2005 Groundwater Monitoring Report* for the Former ARCO Service Station #6002, located at 6235 Seminary Avenue, Oakland, California.

If you have any questions regarding this submission, please call (510) 874-3280.

Sincerely,

**URS CORPORATION**



Scott Robinson, P.G.  
Project Manager

Enclosure: Third Quarter 2005 Groundwater Monitoring Report

cc: Mr. Paul Supple, Atlantic Richfield Company (RM), electronic copy uploaded to ENFOS.

**R E P O R T**

**THIRD QUARTER 2005  
GROUNDWATER MONITORING  
REPORT**

FORMER ARCO SERVICE STATION #6002  
6235 SEMINARY AVENUE  
OAKLAND, CALIFORNIA

*Prepared for*  
RM

October 10, 2005

**URS**

URS Corporation  
1333 Broadway, Suite 800  
Oakland, California 94612

,Date: October 10, 2005  
Quarter: 3Q05

### THIRD QUARTER 2005 GROUNDWATER MONITORING REPORT

Former Facility No.: 6002 Address: 6235 Seminary Avenue, Oakland, California  
RM Environmental Business Manager: Paul Supple  
Consulting Co./Contact Person: URS Corporation / Scott Robinson  
Primary Agency Alameda County Environmental Health (ACEH)  
ACEH Case #: 3942

#### WORK PERFORMED THIS QUARTER (Third – 2005):

1. Performed third quarter 2005 groundwater monitoring event on August 11, 2005.
2. Prepared and submitted this Third Quarter 2005 Groundwater Monitoring Report.
3. Well repairs performed on wells MW-5, MW-6, and VW-1 on June 8, 2005 (Attachment D).

#### WORK PROPOSED FOR NEXT QUARTER (Fourth – 2005):

1. Perform fourth quarter 2005 groundwater monitoring event.
2. Prepare and submit Fourth Quarter 2005 Groundwater Monitoring Report.

#### SITE SUMMARY:

Current Phase of Project: GW monitoring/sampling  
Frequency of Groundwater Sampling: Quarterly: MW-5, VW-1, and VW-4  
Annually (3<sup>rd</sup> quarter): MW-3, MW-4, MW-6, MW-7, and MW-8  
Frequency of Groundwater Monitoring: Quarterly  
Is Free Product (FP) Present On-Site: None  
Bulk Soil Removed to Date: Approximately 370 cubic yards of TPH impacted soil  
Current Remediation Techniques: None  
Approximate Depth to Groundwater: 7.89 (VW-1) to 12.77 (MW-5) feet  
Groundwater Gradient (direction): West  
Groundwater Gradient (magnitude): 0.07 feet per foot

#### DISCUSSION:

Gasoline range organics (GRO) were detected at or above the laboratory reporting limit in two of the seven wells sampled this quarter at concentrations of 74 micrograms per liter ( $\mu\text{g/L}$ ) (VW-4) and 5,700  $\mu\text{g/L}$  (MW-5). Ethylbenzene was detected at or above its respective laboratory reporting limits in one well (MW-5) at a concentration of 13  $\mu\text{g/L}$ . Methyl tert-butyl ether (MTBE) was detected at or above the laboratory reporting limit in four of the seven wells sampled at concentrations ranging from 0.73  $\mu\text{g/L}$  (MW-3) to 51  $\mu\text{g/L}$  (MW-5). Tert-butyl alcohol (TBA) and ethyl tert-butyl ether (ETBE) were detected at or above the respective laboratory reporting limits in one well (VW-4) at concentrations of 2,000  $\mu\text{g/L}$  and 1.8  $\mu\text{g/L}$ , respectively. No other fuel components were detected at or above their respective laboratory reporting limits in any wells sampled this quarter. Well MW-8 was not sampled due to a vehicle parked over it. Prior to sampling, well MW-4 de-watered after 7 gallons were purged.

**ATTACHMENTS:**

- Figure 1 – Groundwater Elevation Contour and Analytical Summary Map – August 11, 2005
- Table 1 – Groundwater Elevation and Analytical Data
- Table 2 – Fuel Additives Analytical Data
- Table 3 – Groundwater Gradient Data
- Attachment A – Field Procedures and Field Data Sheets
- Attachment B – Laboratory Procedures, Certified Analytical Reports, and Chain-of-Custody Records
- Attachment C – Error Check Reports and EDF/Geowell Submittal Confirmations
- Attachment D – Well Repair Data Sheets

Oct 06, 2005 - 2:13pm  
 X:\c\_env\waste\BP-GEM\Sites\Scout\_Robinson\Paul\_Supple\6002\Monitoring\2005 Q3\Drawings\6002-3005-GW.dwg

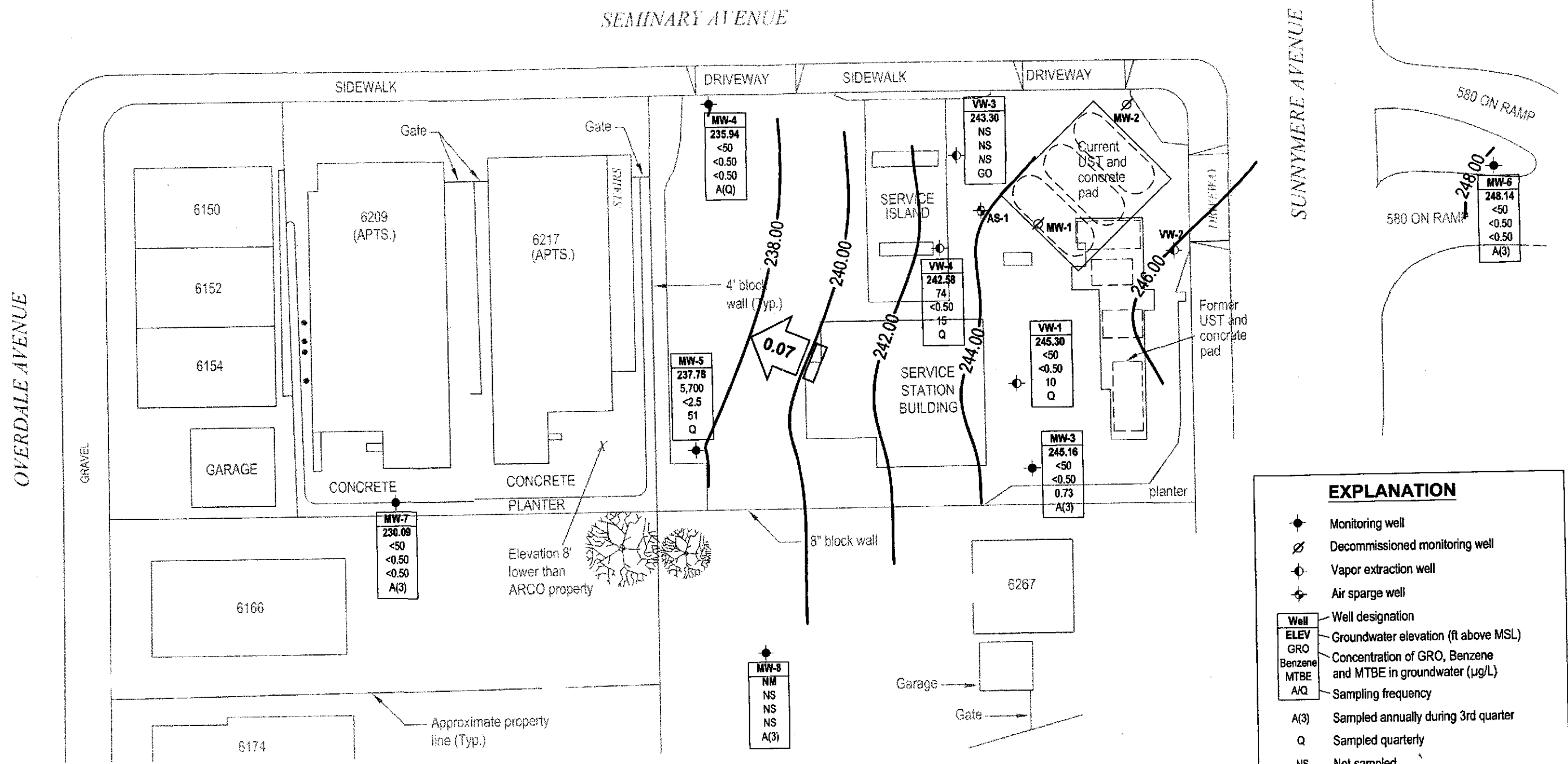

EXPLANATION	
	Monitoring well
	Decommissioned monitoring well
	Vapor extraction well
	Air sparge well
<b>Well</b>	Well designation
<b>ELEV</b>	Groundwater elevation (ft above MSL)
<b>GRO</b>	Concentration of GRO, Benzene and MTBE in groundwater (µg/L)
<b>Benzene</b>	
<b>MTBE</b>	
<b>A/Q</b>	Sampling frequency
A(3)	Sampled annually during 3rd quarter
Q	Sampled quarterly
NS	Not sampled
<	Not detected at or above laboratory reporting limits
*	Not used in contouring due to screen interval
— 244.00	Groundwater elevation contour (ft/MSL)
	Approximate groundwater flow direction and gradient (ft/ft)

NOTE: SITE MAP ADAPTED FROM CAMBRIA ENVIRONMENTAL FIGURES. SITE DIMENSIONS AND FACILITY LOCATIONS NOT VERIFIED.

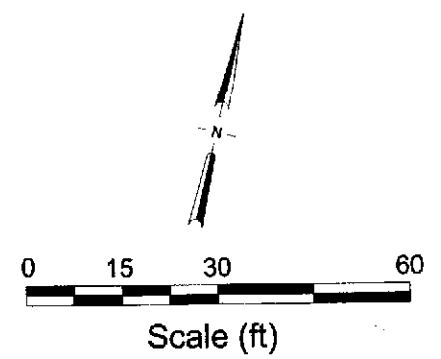

<b>URS</b>	Project No. 38487187	<b>GROUNDWATER ELEVATION CONTOUR AND ANALYTICAL SUMMARY MAP Third Quarter 2005 (August 11, 2005)</b>	FIGURE <b>1</b>
	Former ARCO Service Station #6002 6235 Seminary Avenue Oakland, California		

Table 1

## Groundwater Elevation and Analytical Data

Former ARCO Service Station #6002

6235 Seminary Ave., Oakland, CA

Well No.	Date	P/ NP	Notes	TOC (ft MSL)	Top of Screen (ft bgs)	Bottom of Screen (ft bgs)	DTW (ft bgs)	Product Thickness (feet)	GWE (ft MSL)	GRO/ TPH-g (µg/L)	Benzene (µg/L)	Toluene (µg/L)	Ethyl-benzene (µg/L)	Total Xylenes (µg/L)	MTBE (µg/L)	DO (mg/L)	pH
AS-1	6/29/1995	--		--	20.00	22.00	9.20	--	--	<50	1.6	<0.5	0.9	0.9	--	--	--
MW-1	3/15/1995	--		247.06	4.50	24.50	7.37	--	239.69	13,000	1,200	44	770	1,100	--	--	--
	5/30/1995	--		247.06	4.50	24.50	8.48	--	238.58	19,000	1,600	30	890	1,400	--	--	--
	9/1/1995	--		247.06	4.50	24.50	9.47	--	237.59	14,000	1,300	28	480	780	24,000	--	--
	11/13/1995	--	a, b	247.06	4.50	24.50	8.78	0.01	238.29	11,000	570	17	260	410	25,000	--	--
	2/23/1996	--	d	247.06	4.50	24.50	--	--	--	--	--	--	--	--	--	--	--
MW-2	3/15/1995	--		249.3	5.00	17.50	8.25	--	241.05	<50	<0.5	<0.5	<0.5	<0.5	--	--	--
	5/30/1995	--		249.3	5.00	17.50	9.93	--	239.37	<50	<0.5	<0.5	<0.5	<0.5	--	--	--
	9/1/1995	--		249.3	5.00	17.50	10.69	--	238.61	<50	<0.5	<0.5	<0.5	<0.5	<3	--	--
	11/13/1995	--		249.3	5.00	17.50	10.32	--	238.98	<50	<0.5	<0.5	<0.5	<0.5	--	--	--
	2/23/1996	--	d	249.3	5.00	17.50	--	--	--	--	--	--	--	--	--	--	--
MW-3	3/15/1995	--		248.35	5.00	24.50	6.76	--	241.59	<50	<0.5	<0.5	<0.5	<0.5	--	--	--
	5/30/1995	--		248.35	5.00	24.50	7.81	--	240.54	<50	<0.5	<0.5	<0.5	<0.5	--	--	--
	9/1/1995	--		248.35	5.00	24.50	8.65	--	239.70	<50	<0.5	<0.5	<0.5	<0.5	<3	--	--
	11/13/1995	--		248.35	5.00	24.50	8.25	--	240.10	120	45	0.7	<0.5	6.2	--	--	--
	2/23/1996	--		248.35	5.00	24.50	6.64	--	241.71	<50	<0.5	<0.5	0.6	1.9	<3	--	--
	5/10/1996	--		248.35	5.00	24.50	7.95	--	240.40	--	--	--	--	--	--	--	--
	8/9/1996	--		248.35	5.00	24.50	8.06	--	240.29	--	--	--	--	--	--	--	--
	11/8/1996	--	e	248.35	5.00	24.50	--	--	--	--	--	--	--	--	--	--	--
	3/21/1997	--		248.35	5.00	24.50	8.21	--	240.14	<50	<0.5	<0.5	<0.5	<0.5	<3	--	--
	5/27/1997	--		248.35	5.00	24.50	8.25	--	240.10	--	--	--	--	--	--	--	--
	8/5/1997	--		248.35	5.00	24.50	8.29	--	240.06	--	--	--	--	--	--	--	--
	10/29/1997	--		248.35	5.00	24.50	8.58	--	239.77	<50	<0.5	<0.5	<0.5	<0.5	<3	--	--
	2/25/1998	--		248.35	5.00	24.50	7.69	--	240.66	<50	<0.5	<0.5	<0.5	<0.5	<3	--	--
	5/12/1998	--		248.35	5.00	24.50	8.20	--	240.15	--	--	--	--	--	--	--	--
	7/28/1998	--		248.35	5.00	24.50	8.55	--	239.80	--	--	--	--	--	--	--	--
	10/27/1998	--		248.35	5.00	24.50	8.30	--	240.05	--	--	--	--	--	--	--	--
	2/8/1999	--		248.35	5.00	24.50	7.90	--	240.45	<50	<0.5	<0.5	<0.5	<0.5	<3	--	--
	6/1/1999	--		248.35	5.00	24.50	8.40	--	239.95	--	--	--	--	--	--	--	--
	8/25/1999	--		248.35	5.00	24.50	8.49	--	239.86	--	--	--	--	--	--	1.67	--
	10/29/1999	--		248.35	5.00	24.50	8.52	--	239.83	--	--	--	--	--	--	6.9	--
	2/16/2000	NP		248.35	5.00	24.50	8.03	--	240.32	<50	<0.5	0.8	<0.5	<1	<3	8.51	--

Table 1

## Groundwater Elevation and Analytical Data

Former ARCO Service Station #6002

6235 Seminary Ave., Oakland, CA

Well No.	Date	P/ NP	Notes	TOC (ft MSL)	Top of Screen (ft bgs)	Bottom of Screen (ft bgs)	DTW (ft bgs)	Product Thickness (feet)	GWE (ft MSL)	GRO/ TPH-g (µg/L)	Benzene (µg/L)	Toluene (µg/L)	Ethyl-benzene (µg/L)	Total Xylenes (µg/L)	MTBE (µg/L)	DO (mg/L)	pH
MW-3	6/23/2000	--		248.35	5.00	24.50	7.55	--	240.80	--	--	--	--	--	--	2.1	--
	8/17/2000	--		248.35	5.00	24.50	8.65	--	239.70	--	--	--	--	--	--	1.1	--
	11/10/2000	--		248.35	5.00	24.50	7.19	--	241.16	--	--	--	--	--	--	--	--
	2/12/2001	NP		248.35	5.00	24.50	8.60	--	239.75	<50	<0.50	<0.50	<0.50	<0.50	<2.5	0.81	--
	4/13/2001	--		248.35	5.00	24.50	6.13	--	242.22	--	--	--	--	--	--	--	--
	7/18/2001	--		248.35	5.00	24.50	6.47	--	241.88	--	--	--	--	--	--	--	--
	10/1/2001	--		248.35	5.00	24.50	6.99	--	241.36	--	--	--	--	--	--	--	--
	1/14/2002	NP		248.35	5.00	24.50	5.47	--	242.88	<50	<0.50	<0.50	<0.50	<0.50	<5.0	--	--
	4/3/2002	--		248.35	5.00	24.50	6.95	--	241.40	--	--	--	--	--	--	--	--
	8/8/2002	--		248.35	5.00	24.50	8.78	--	239.57	--	--	--	--	--	--	--	--
	11/27/2002	--		248.35	5.00	24.50	8.52	--	239.83	--	--	--	--	--	--	--	--
	2/10/2003	NP		248.35	5.00	24.50	8.40	--	239.95	<50	<0.50	<0.50	<0.50	<0.50	<0.50	0.7	6.4
	6/3/2003	--		248.35	5.00	24.50	8.40	--	239.95	--	--	--	--	--	--	--	--
	8/14/2003	--		248.35	5.00	24.50	8.60	--	239.75	--	--	--	--	--	--	--	--
	11/13/2003	--		248.35	5.00	24.50	8.41	--	239.94	--	--	--	--	--	--	--	--
	02/13/2004	--		253.88	5.00	24.50	8.40	--	245.48	--	--	--	--	--	--	--	--
	05/05/2004	--		253.88	5.00	24.50	8.28	--	245.60	--	--	--	--	--	--	--	--
	08/30/2004	NP		253.88	5.00	24.50	10.32	--	243.56	<50	<0.50	<0.50	<0.50	<0.50	0.72	1.40	6.4
	11/08/2004	--		253.88	5.00	24.50	8.12	--	245.76	--	--	--	--	--	--	--	--
	02/07/2005	--		253.88	5.00	24.50	8.20	--	245.68	--	--	--	--	--	--	--	--
	05/09/2005	--		253.88	5.00	24.50	8.23	--	245.65	--	--	--	--	--	--	--	--
	08/11/2005	NP		253.88	5.00	24.50	8.72	--	245.16	<50	<0.50	<0.50	<0.50	<0.50	0.73	1.60	6.1
MW-4	3/15/1995	--		242.91	4.50	24.50	9.37	--	233.54	<50	<0.5	<0.5	<0.5	<0.5	--	--	--
	5/30/1995	--		242.91	4.50	24.50	11.47	--	231.44	<50	<0.5	<0.5	<0.5	<0.5	--	--	--
	9/1/1995	--		242.91	4.50	24.50	12.28	--	230.63	78	<0.5	0.7	<0.5	<0.5	<3	--	--
	11/13/1995	--		242.91	4.50	24.50	11.75	--	231.16	<50	<0.5	<0.5	<0.5	<0.5	--	--	--
	2/23/1996	--		242.91	4.50	24.50	8.51	--	234.40	59	1.2	7.4	1.6	9.3	3	--	--
	5/10/1996	--		242.91	4.50	24.50	11.35	--	231.56	<50	<0.5	<0.5	<0.5	<0.5	<3	--	--
	8/9/1996	--		242.91	4.50	24.50	9.70	--	233.21	<50	<0.5	<0.5	<0.5	<0.5	<3	--	--
	11/8/1996	--		242.91	4.50	24.50	11.79	--	231.12	<50	<0.5	<0.5	<0.5	<0.5	<3	--	--
	3/21/1997	--		242.91	4.50	24.50	10.94	--	231.97	<50	<0.5	<0.5	<0.5	<0.5	81	--	--
	5/27/1997	--		242.91	4.50	24.50	11.51	--	231.40	<50	<0.5	<0.5	<0.5	<0.5	<3	--	--
	8/5/1997	--		242.91	4.50	24.50	11.90	--	231.01	<50	<0.5	<0.5	<0.5	<0.5	<3	--	--



Table 1

## Groundwater Elevation and Analytical Data

Former ARCO Service Station #6002

6235 Seminary Ave., Oakland, CA

Well No.	Date	P/ NP	Notes	TOC (ft MSL)	Top of Screen (ft bgs)	Bottom of Screen (ft bgs)	DTW (ft bgs)	Product Thickness (feet)	GWE (ft MSL)	GRO/ TPH-g (µg/L)	Benzene (µg/L)	Toluene (µg/L)	Ethyl-benzene (µg/L)	Total Xylenes (µg/L)	MTBE (µg/L)	DO (mg/L)	pH
MW-4	10/29/1997	--		242.91	4.50	24.50	12.00	--	230.91	<50	<0.5	<0.5	<0.5	<0.5	<3	--	--
	2/25/1998	--		242.91	4.50	24.50	8.34	--	234.57	<50	<0.5	0.9	<0.5	0.9	4	--	--
	5/12/1998	--		242.91	4.50	24.50	10.93	--	231.98	<50	<0.5	<0.5	<0.5	<0.5	<3	--	--
	7/28/1998	--		242.91	4.50	24.50	12.08	--	230.83	<50	<0.5	<0.5	<0.5	<0.5	<3	--	--
	10/27/1998	--		242.91	4.50	24.50	11.40	--	231.51	<5,000	<50	<50	160	64	6,400	--	--
	2/8/1999	--		242.91	4.50	24.50	8.40	--	234.51	<50	<0.5	<0.5	<0.5	<0.5	<3	--	--
	6/1/1999	NP		242.91	4.50	24.50	11.93	--	230.98	<50	<0.5	<0.5	<0.5	<0.5	<3	4	6.26
	8/25/1999	NP		242.91	4.50	24.50	12.21	--	230.70	<50	<0.5	<0.5	<0.5	<0.5	<3	1.29	6.34
	10/29/1999	NP		242.91	4.50	24.50	12.37	--	230.54	<50	<0.5	<0.5	<0.5	<1	<3	1.5	5.60
	2/16/2000	NP		242.91	4.50	24.50	7.45	--	235.46	<50	<0.5	<0.5	<0.5	<1	<3	2.38	--
	6/23/2000	NP		242.91	4.50	24.50	12.31	--	230.60	<50	<0.50	<0.50	<0.50	<0.50	<2.50	2.8	--
	8/17/2000	--	f	242.91	4.50	24.50	--	--	--	<50	<0.50	<0.50	<0.50	<0.50	<2.50	--	--
	8/17/2000	NP		242.91	4.50	24.50	11.92	--	230.99	<50	<0.50	<0.50	<0.50	<0.50	<2.50	2.38	--
	11/10/2000	NP		242.91	4.50	24.50	10.80	--	232.11	<50	<0.50	<0.50	<0.50	<0.50	<2.50	1.55	--
	2/12/2001	NP		242.91	4.50	24.50	11.65	--	231.26	<50	<0.50	<0.50	<0.50	<0.50	<2.50	1.12	--
	4/13/2001	--	f	242.91	4.50	24.50	--	--	--	<50	<0.50	<0.50	<0.50	<0.50	<2.50	--	--
	4/13/2001	NP		242.91	4.50	24.50	8.17	--	234.74	<50	<0.50	<0.50	<0.50	<0.50	<2.50	--	--
	7/18/2001	NP		242.91	4.50	24.50	8.51	--	234.40	<50	<0.50	<0.50	<0.50	<0.50	<2.5	--	--
	10/1/2001	NP		242.91	4.50	24.50	8.71	--	234.20	<50	<0.50	<0.50	<0.50	<0.50	<2.5	--	--
	1/14/2002	--	f	242.91	4.50	24.50	--	--	--	<50	<0.50	<0.50	<0.50	<0.50	<5.0	--	--
	1/14/2002	NP		242.91	4.50	24.50	7.13	--	235.78	<50	<0.50	<0.50	<0.50	<0.50	<5.0	--	--
	4/3/2002	NP		242.91	4.50	24.50	10.10	--	232.81	<50	<0.50	<0.50	<0.50	<0.50	<2.5	--	--
	8/8/2002	NP		242.91	4.50	24.50	12.64	--	230.27	<50	<0.50	<0.50	<0.50	<0.50	<2.5	2.4	8.1
	11/27/2002	NP		242.91	4.50	24.50	12.01	--	230.90	<50	<0.50	<0.50	<0.50	<0.50	4.7	2.5	6.5
	2/10/2003	NP		242.91	4.50	24.50	11.22	--	231.69	<50	<0.50	<0.50	<0.50	<0.50	<0.50	0.8	6.6
	6/3/2003	--		242.91	4.50	24.50	11.54	--	231.37	<50	<0.50	<0.50	<0.50	<0.50	<0.50	3.9	6
	8/14/2003	--		242.91	4.50	24.50	12.41	--	230.50	<50	<0.50	<0.50	<0.50	<0.50	<0.50	1.8	6.3
	11/13/2003	--		242.91	4.50	24.50	11.64	--	231.27	--	--	--	--	--	--	--	--
	02/13/2004	--		248.62	4.50	24.50	10.28	--	238.34	--	--	--	--	--	--	--	--
	05/05/2004	--		248.62	4.50	24.50	12.04	--	236.58	--	--	--	--	--	--	--	--
	08/30/2004	NP		248.62	4.50	24.50	12.98	--	235.64	<50	<0.50	<0.50	<0.50	<0.50	<0.50	1.60	5.8
	11/08/2004	--		248.62	4.50	24.50	11.29	--	237.33	--	--	--	--	--	--	--	--
	02/07/2005	--		248.62	4.50	24.50	10.03	--	238.59	--	--	--	--	--	--	--	--
	05/09/2005	--		248.62	4.50	24.50	10.65	--	237.97	--	--	--	--	--	--	--	--

Table 1

**Groundwater Elevation and Analytical Data**  
Former ARCO Service Station #6002  
6235 Seminary Ave., Oakland, CA

Well No.	Date	P/ NP	Notes	TOC (ft MSL)	Top of Screen (ft bgs)	Bottom of Screen (ft bgs)	DTW (ft bgs)	Product Thickness (feet)	GWE (ft MSL)	GRO/ TPH-g (µg/L)	Benzene (µg/L)	Toluene (µg/L)	Ethyl-benzene (µg/L)	Total Xylenes (µg/L)	MTBE (µg/L)	DO (mg/L)	pH
MW-4	08/11/2005	NP		248.62	4.50	24.50	12.68	--	235.94	<50	<0.50	<0.50	<0.50	<0.50	<0.50	1.90	6.5
MW-5	3/15/1995	--		244.82	5.00	24.50	11.99	--	232.83	21,000	870	22	1,600	1,900	--	--	--
	5/30/1995	--		244.82	5.00	24.50	12.97	--	231.85	17,000	2,100	250	1,000	520	--	--	--
	9/1/1995	--		244.82	5.00	24.50	14.03	--	230.79	19,000	1,500	25	1,600	880	8,300	--	--
	11/13/1995	--		244.82	5.00	24.50	13.65	--	231.17	21,000	1,300	22	1,400	630	--	--	--
	2/23/1996	--		244.82	5.00	24.50	11.93	--	232.89	27,000	1,300	<50	1,600	1,500	730	--	--
	5/10/1996	--		244.82	5.00	24.50	13.05	--	231.77	17,000	460	21	760	480	1,000	--	--
	8/9/1996	--		244.82	5.00	24.50	13.22	--	231.60	16,000	420	14	870	390	1,500	--	--
	11/8/1996	--	e	244.82	5.00	24.50	--	--	--	--	--	--	--	--	--	--	--
	3/21/1997	--		244.82	5.00	24.50	13.24	--	231.58	18,000	110	<50	730	1,500	1,800	--	--
	5/27/1997	--		244.82	5.00	24.50	13.10	--	231.72	21,000	86	<20	810	610	1,700	--	--
	8/5/1997	--		244.82	5.00	24.50	13.14	--	231.68	340	2.2	<0.5	15	8.8	39	--	--
	10/29/1997	--		244.82	5.00	24.50	13.03	--	231.79	19,000	130	<20	1,400	620	1,700	--	--
	2/25/1998	--		244.82	5.00	24.50	11.33	--	233.49	8,500	19	13	190	100	170	--	--
	5/12/1998	--		244.82	5.00	24.50	12.81	--	232.01	10,000	34	<10	390	220	610	--	--
	7/28/1998	--		244.82	5.00	24.50	13.12	--	231.70	15,000	68	<10	690	620	1,000	--	--
	10/27/1998	--		244.82	5.00	24.50	12.90	--	231.92	15,000	60	<10	770	400	890	--	--
	2/8/1999	--		244.82	5.00	24.50	11.08	--	233.74	8,200	23	<10	290	120	<60	--	--
	6/1/1999	NP		244.82	5.00	24.50	12.95	--	231.87	11,000	33	3.3	340	180	580	1	6.49
	8/25/1999	NP		244.82	5.00	24.50	12.99	--	231.83	9,200	26	14	420	270	1,100	0.37	7.78
	10/29/1999	NP		244.82	5.00	24.50	13.10	--	231.72	11,000	19	9.8	260	150	590	1.27	6.2
	2/16/2000	NP		244.82	5.00	24.50	8.21	--	236.61	12,000	8.1	10	340	160	130	1.42	--
	6/23/2000	NP		244.82	5.00	24.50	12.90	--	231.92	9,680	38	<20.0	212	114	930	1.4	--
	8/17/2000	NP		244.82	5.00	24.50	13.00	--	231.82	10,500	15	7.98	223	118	430	0.68	--
	11/10/2000	NP		244.82	5.00	24.50	12.50	--	232.32	7,030	19.7	<10.0	190	43.6	445	1.27	--
	2/12/2001	NP		244.82	5.00	24.50	12.81	--	232.01	8,840	33.9	<10.0	186	56.4	352	0.4	--
	4/13/2001	NP		244.82	5.00	24.50	11.31	--	233.51	9,020	54.2	43.3	137	96	297	--	--
	7/18/2001	NP		244.82	5.00	24.50	11.59	--	233.23	13,000	19	10	110	49	230	--	--
	10/1/2001	NP		244.82	5.00	24.50	11.84	--	232.98	8,500	6.9	<1.0	87	27	220	--	--
	1/14/2002	NP		244.82	5.00	24.50	10.75	--	234.07	9,500	<20	<20	140	22	<200	--	--
	4/3/2002	NP	f	244.82	5.00	24.50	--	--	--	2,700	24	5.1	92	8.5	130	--	--
	4/3/2002	NP		244.82	5.00	24.50	12.50	--	232.32	2,400	21	<5.0	91	8.5	130	--	--
	8/8/2002	NP		244.82	5.00	24.50	12.83	--	231.99	2,000	<20	<20	48	<20	520	0.8	6.9

Table 1

## Groundwater Elevation and Analytical Data

Former ARCO Service Station #6002

6235 Seminary Ave., Oakland, CA

Well No.	Date	P/ NP	Notes	TOC (ft MSL)	Top of Screen (ft bgs)	Bottom of Screen (ft bgs)	DTW (ft bgs)	Product Thickness (feet)	GWE (ft MSL)	GRO/ TPH-g (µg/L)	Benzene (µg/L)	Toluene (µg/L)	Ethyl-benzene (µg/L)	Total Xylenes (µg/L)	MTBE (µg/L)	DO (mg/L)	pH
MW-5	11/27/2002	NP		244.82	5.00	24.50	12.79	--	232.03	2,200	<10	<10	33	<10	150	0.8	6.4
	2/10/2003	NP		244.82	5.00	24.50	12.62	--	232.20	2,600	<2.5	<2.5	47	4.2	100	0.7	6.6
	6/3/2003	--		244.82	5.00	24.50	12.41	--	232.41	2,400	<5.0	<5.0	26	<5.0	160	1.8	6.3
	8/14/2003	--	e	244.82	5.00	24.50	--	--	--	--	--	--	--	--	--	--	--
	11/13/2003	NP		244.82	5.00	24.50	12.49	--	232.33	1,900	<5.0	<5.0	13	<5.0	90	0.90	6.4
	02/13/2004	NP		250.55	5.00	24.50	12.38	--	238.17	1,400	1.4	1.9	23	3.6	90	1.10	62.8
	05/05/2004	NP		250.55	5.00	24.50	12.68	--	237.87	5,800	<2.5	<2.5	13	<2.5	130	1.10	6.3
	08/30/2004	P		250.55	5.00	24.50	12.96	--	237.59	4,100	<2.5	<2.5	<2.5	<2.5	85	--	6.4
	11/08/2004	NP		250.55	5.00	24.50	12.10	--	238.45	3,300	14	1.9	17	6.1	69	1.05	6.0
	02/07/2005	NP		250.55	5.00	24.50	12.02	--	238.53	3,500	<1.0	1.1	16	2.6	15	0.95	6.5
	05/09/2005	NP	j	250.55	5.00	24.50	11.94	--	238.61	3,400	<1.0	1.7	12	2.2	19	2.20	6.7
	08/11/2005	NP		250.55	5.00	24.50	12.77	--	237.78	5,700	<2.5	<2.5	13	<2.5	51	0.70	6.0
MW-6	6/29/1995	--		--	17.00	31.50	6.63	--	--	<50	<0.5	<0.5	<0.5	<0.5	--	--	--
	9/1/1995	--		--	17.00	31.50	--	--	--	--	--	--	--	--	--	--	--
	11/13/1995	--		--	17.00	31.50	7.70	--	--	<50	<0.5	<0.5	<0.5	<0.5	<3	--	--
	2/23/1996	--		--	17.00	31.50	9.82	--	--	<50	<0.5	0.8	<0.5	0.6	<3	--	--
	5/10/1996	--		--	17.00	31.50	15.25	--	--	--	--	--	--	--	--	--	--
	8/9/1996	--		252.2	17.00	31.50	11.11	--	241.09	--	--	--	--	--	--	--	--
	11/8/1996	--		252.2	17.00	31.50	9.31	--	242.89	--	--	--	--	--	--	--	--
	3/21/1997	--		252.2	17.00	31.50	9.40	--	242.80	<50	<0.5	<0.5	<0.5	<0.5	<3	--	--
	5/27/1997	--		252.2	17.00	31.50	7.08	--	245.12	--	--	--	--	--	--	--	--
	8/5/1997	--		252.2	17.00	31.50	7.12	--	245.08	--	--	--	--	--	--	--	--
	10/29/1997	--		252.2	17.00	31.50	7.42	--	244.78	<50	<0.5	<0.5	<0.5	<0.5	<3	--	--
	2/25/1998	--		252.2	17.00	31.50	10.35	--	241.85	<50	<0.5	<0.5	<0.5	<0.5	<3	--	--
	5/12/1998	--		252.2	17.00	31.50	15.83	--	236.37	--	--	--	--	--	--	--	--
	7/28/1998	--		252.2	17.00	31.50	11.84	--	240.36	--	--	--	--	--	--	--	--
	10/27/1998	--		252.2	17.00	31.50	9.73	--	242.47	--	--	--	--	--	--	--	--
	2/8/1999	--		252.2	17.00	31.50	8.10	--	244.10	<50	<0.5	<0.5	<0.5	<0.5	<3	--	--
	6/1/1999	--		252.2	17.00	31.50	17.84	--	234.36	--	--	--	--	--	--	--	--
	8/25/1999	--		252.2	17.00	31.50	11.00	--	241.20	--	--	--	--	--	--	0.77	--
	10/29/1999	--		252.2	17.00	31.50	9.03	--	243.17	--	--	--	--	--	--	3.42	--
	2/16/2000	P		252.2	17.00	31.50	7.71	--	244.49	<50	<0.5	<0.5	<0.5	<1	<3	2.42	--
	6/23/2000	--		252.2	17.00	31.50	6.69	--	245.51	--	--	--	--	--	--	2.3	--

Table 1

## Groundwater Elevation and Analytical Data

Former ARCO Service Station #6002

6235 Seminary Ave., Oakland, CA

Well No.	Date	P/ NP	Notes	TOC (ft MSL)	Top of Screen (ft bgs)	Bottom of Screen (ft bgs)	DTW (ft bgs)	Product Thickness (feet)	GWE (ft MSL)	GRO/ TPH-g (µg/L)	Benzene (µg/L)	Toluene (µg/L)	Ethyl-benzene (µg/L)	Total Xylenes (µg/L)	MTBE (µg/L)	DO (mg/L)	pH
MW-6	8/17/2000	--		252.2	17.00	31.50	6.95	--	245.25	--	--	--	--	--	--	2.51	--
	11/10/2000	--		252.2	17.00	31.50	11.79	--	240.41	--	--	--	--	--	--	--	--
		--	f	--	--	--	--	--	--	--	--	--	--	--	--	--	--
	2/12/2001	P		252.2	17.00	31.50	7.35	--	244.85	<50	<0.50	<0.50	<0.50	<0.50	<2.5	1.66	7.77
	4/13/2001	--		252.2	17.00	31.50	10.52	--	241.68	--	--	--	--	--	--	--	--
	7/18/2001	--		252.2	17.00	31.50	11.03	--	241.17	--	--	--	--	--	--	--	--
	10/1/2001	--		252.2	17.00	31.50	11.31	--	240.89	--	--	--	--	--	--	--	--
	1/14/2002	P		252.2	17.00	31.50	9.87	--	242.33	<50	<0.50	<0.50	<0.50	<0.50	<5.0	--	--
	4/3/2002	--		252.2	17.00	31.50	12.19	--	240.01	--	--	--	--	--	--	--	--
	8/8/2002	--		252.2	17.00	31.50	7.04	--	245.16	--	--	--	--	--	--	--	--
	11/27/2002	--		252.2	17.00	31.50	6.85	--	245.35	--	--	--	--	--	--	--	--
	2/10/2003	NP		252.2	17.00	31.50	6.74	--	245.46	<50	<0.50	<0.50	<0.50	<0.50	<0.50	1.1	7.4
	6/3/2003	--		252.2	17.00	31.50	14.35	--	237.85	--	--	--	--	--	--	--	--
	8/14/2003	--		252.2	17.00	31.50	10.74	--	241.46	--	--	--	--	--	--	--	--
	11/13/2003	--		252.20	17.00	31.50	10.68	--	241.52	--	--	--	--	--	--	--	--
	02/13/2004	--		257.94	17.00	31.50	7.38	--	250.56	--	--	--	--	--	--	--	--
	05/05/2004	--		257.94	17.00	31.50	7.43	--	250.51	--	--	--	--	--	--	--	--
	08/30/2004	P		257.94	17.00	31.50	7.39	--	250.55	<50	<0.50	<0.50	<0.50	<0.50	<0.50	2.50	7.0
	11/08/2004	--		257.94	17.00	31.50	15.57	--	242.37	--	--	--	--	--	--	--	--
	02/07/2005	--		257.94	17.00	31.50	15.26	--	242.68	--	--	--	--	--	--	--	--
	05/09/2005	--		257.94	17.00	31.50	11.31	--	246.63	--	--	--	--	--	--	--	--
	08/11/2005	P		257.94	17.00	31.50	9.80	--	248.14	<50	<0.50	<0.50	<0.50	<0.50	<0.50	2.40	7.1
MW-7	8/9/1996	--	g	235.95	8.50	13.50	--	--	--	--	--	--	--	--	--	--	--
	11/8/1996	--	g	235.95	8.50	13.50	--	--	--	--	--	--	--	--	--	--	--
	1/27/1997	--		235.95	8.50	13.50	--	--	--	2,900	29	<5	<5	580	220	--	--
	3/21/1997	--		235.95	8.50	13.50	7.13	--	228.82	590	3.5	<0.5	<0.5	1.3	90	--	--
	5/27/1997	--		235.95	8.50	13.50	9.02	--	226.93	<50	<0.5	<0.5	<0.5	<0.5	<3	--	--
	8/5/1997	--		235.95	8.50	13.50	12.33	--	223.62	110	0.5	<0.5	<0.5	0.8	81	--	--
	10/29/1997	--	g	235.95	8.50	13.50	--	--	--	--	--	--	--	--	--	--	--
	2/25/1998	--		235.95	8.50	13.50	8.04	--	227.91	<50	<0.5	0.6	<0.5	0.7	<3	--	--
	5/12/1998	--		235.95	8.50	13.50	8.88	--	227.07	<50	<0.5	<0.5	<0.5	<0.5	<3	--	--
	7/28/1998	--		235.95	8.50	13.50	10.50	--	225.45	<50	<0.5	<0.5	<0.5	<0.5	<3	--	--
	10/27/1998	--		235.95	8.50	13.50	8.75	--	227.20	<50	<0.5	<0.5	<0.5	<0.5	<3	--	--

Table 1

## Groundwater Elevation and Analytical Data

Former ARCO Service Station #6002

6235 Seminary Ave., Oakland, CA

Well No.	Date	P/ NP	Notes	TOC (ft MSL)	Top of Screen (ft bgs)	Bottom of Screen (ft bgs)	DTW (ft bgs)	Product Thickness (feet)	GWE (ft MSL)	GRO/ TPH-g (µg/L)	Benzene (µg/L)	Toluene (µg/L)	Ethyl-benzene (µg/L)	Total Xylenes (µg/L)	MTBE (µg/L)	DO (mg/L)	pH
MW-7	2/8/1999	--		235.95	8.50	13.50	9.35	--	226.60	<50	<0.5	<0.5	<0.5	<0.5	<3	--	--
	6/1/1999	NP		235.95	8.50	13.50	9.85	--	226.10	250	<0.5	0.6	<0.5	1.6	18	1	6.43
	8/25/1999	NP		235.95	8.50	13.50	11.31	--	224.64	119	<0.5	5.7	<0.5	<0.5	11	0.41	8.28
	10/29/1999	NP		235.95	8.50	13.50	9.08	--	226.87	<50	<0.5	<0.5	<0.5	<1	<3	1.29	5.82
	2/25/2000	NP		235.95	8.50	13.50	8.02	--	227.93	<50	<0.5	<0.5	<0.5	<1	38	2.1	--
	6/23/2000	NP		235.95	8.50	13.50	10.68	--	225.27	<50	<0.50	<0.50	<0.50	<0.50	14.4	1.6	--
	8/17/2000	NP		235.95	8.50	13.50	11.85	--	224.10	70	<0.500	0.678	<0.500	1.07	14.2	1.59	--
	11/10/2000	NP		235.95	8.50	13.50	9.62	--	226.33	<50	<0.50	<0.50	<0.50	<0.50	<2.5	1.09	--
	2/12/2001	NP		235.95	8.50	13.50	12.10	--	223.85	<50	<0.50	<0.50	<0.50	<0.50	<2.5	0.84	--
	4/13/2001	P		235.95	8.50	13.50	7.95	--	228.00	<50	<0.50	<0.50	<0.50	<0.50	<2.5	--	--
	7/18/2001	P		235.95	8.50	13.50	8.20	--	227.75	<50	<0.50	<0.50	<0.50	<0.50	<2.5	--	--
	10/1/2001	NP		235.95	8.50	13.50	8.59	--	227.36	<50	<0.50	<0.50	<0.50	<0.50	<2.5	--	--
	1/14/2002	P		235.95	8.50	13.50	6.93	--	229.02	<50	<0.50	<0.50	<0.50	<0.50	<5.0	--	--
	4/3/2002	P		235.95	8.50	13.50	8.31	--	227.64	<50	<0.50	<0.50	<0.50	<0.50	<2.5	--	--
	8/8/2002	P	h	235.95	8.50	13.50	12.11	--	223.84	--	--	--	--	--	--	--	--
	11/27/2002	NP	h	235.95	8.50	13.50	13.01	--	222.94	--	--	--	--	--	--	--	--
	2/10/2003	NP		235.95	8.50	13.50	10.02	--	225.93	<50	<0.50	<0.50	<0.50	<0.50	<0.50	1.5	6.7
	6/3/2003	NP		235.95	8.50	13.50	6.82	--	229.13	<50	<0.50	<0.50	<0.50	<0.50	<0.50	8.1	6.8
	8/14/2003	P		235.95	8.50	13.50	8.16	--	227.79	<50	<0.50	<0.50	<0.50	<0.50	<0.50	2.8	6.7
	11/13/2003	--		235.95	8.50	13.50	8.07	--	227.88	--	--	--	--	--	--	--	--
	02/13/2004	--		241.64	8.50	13.50	7.62	--	234.02	--	--	--	--	--	--	--	--
	05/05/2004	--		241.64	8.50	13.50	11.01	--	230.63	--	--	--	--	--	--	--	--
	08/30/2004	--	h	241.64	8.50	13.50	13.27	--	228.37	--	--	--	--	--	--	--	--
	11/08/2004	--		241.64	8.50	13.50	13.22	--	228.42	--	--	--	--	--	--	--	--
	02/07/2005	--		241.64	8.50	13.50	13.07	--	228.57	--	--	--	--	--	--	--	--
	05/09/2005	--		241.64	8.50	13.50	7.57	--	234.07	--	--	--	--	--	--	--	--
	08/11/2005	NP		241.64	8.50	13.50	11.55	--	230.09	<50	<0.50	<0.50	<0.50	<0.50	<0.50	1.10	6.7
MW-8	8/9/1996	--		240.37	5.50	14.00	9.41	--	230.96	<50	<0.5	<0.5	<0.5	<0.5	<3	--	--
	11/8/1996	--		240.37	5.50	14.00	9.19	--	231.18	<50	<0.5	<0.5	<0.5	<0.5	<3	--	--
	3/21/1997	--		240.37	5.50	14.00	8.55	--	231.82	<50	<0.5	<0.5	<0.5	<0.5	<3	--	--
	5/27/1997	--		240.37	5.50	14.00	11.06	--	229.31	91	0.6	<0.5	<0.5	0.6	66	--	--
	8/5/1997	--		240.37	5.50	14.00	9.32	--	231.05	<50	<0.5	<0.5	<0.5	<0.5	<3	--	--
	10/29/1997	--		240.37	5.50	14.00	9.35	--	231.02	<50	<0.5	<0.5	<0.5	<0.5	<3	--	--

Table 1

## Groundwater Elevation and Analytical Data

Former ARCO Service Station #6002

6235 Seminary Ave., Oakland, CA

Well No.	Date	P/ NP	Notes	TOC (ft MSL)	Top of Screen (ft bgs)	Bottom of Screen (ft bgs)	DTW (ft bgs)	Product Thickness (feet)	GWE (ft MSL)	GRO/ TPH-g (µg/L)	Benzene (µg/L)	Toluene (µg/L)	Ethyl-benzene (µg/L)	Total Xylenes (µg/L)	MTBE (µg/L)	DO (mg/L)	pH
MW-8	2/25/1998	--		240.37	5.50	14.00	7.08	--	233.29	<50	<0.5	<0.5	<0.5	<0.5	<3	--	--
	5/12/1998	--		240.37	5.50	14.00	8.61	--	231.76	<50	<0.5	<0.5	<0.5	<0.5	<3	--	--
	7/28/1998	--		240.37	5.50	14.00	9.63	--	230.74	<50	<0.5	<0.5	<0.5	<0.5	4	--	--
	10/27/1998	--		240.37	5.50	14.00	9.30	--	231.07	<50	<0.5	<0.5	<0.5	<0.5	<3	--	--
	2/8/1999	--		240.37	5.50	14.00	5.56	--	234.81	<50	<0.5	<0.5	<0.5	<0.5	<3	--	--
	6/1/1999	--	e	240.37	5.50	14.00	--	--	--	--	--	--	--	--	--	--	--
	8/25/1999	--	e	240.37	5.50	14.00	--	--	--	--	--	--	--	--	--	--	--
	10/29/1999	--	e	240.37	5.50	14.00	--	--	--	--	--	--	--	--	--	--	--
	2/16/2000	--	e	240.37	5.50	14.00	--	--	--	--	--	--	--	--	--	--	--
	6/23/2000	NP		240.37	5.50	14.00	9.45	--	230.92	<50	<0.50	<0.50	<0.500	<0.50	<2.5	1.9	--
	8/17/2000	NP		240.37	5.50	14.00	6.40	--	233.97	<50	<0.50	<0.50	<0.50	<0.50	<2.5	2.56	--
	11/10/2000	--	f	240.37	5.50	14.00	--	--	--	<50	<0.50	<0.50	<0.50	<0.50	<2.5	--	--
	11/10/2000	NP		240.37	5.50	14.00	6.25	--	234.12	<50	<0.50	<0.50	<0.50	<0.50	<2.5	1.93	--
	2/12/2001	NP		240.37	5.50	14.00	8.11	--	232.26	<50	<0.50	<0.50	<0.50	<0.50	<2.5	1.65	--
	4/13/2001	P		240.37	5.50	14.00	5.19	--	235.18	<50	<0.50	<0.50	<0.50	<0.50	<2.5	--	--
	7/18/2001	NP		240.37	5.50	14.00	5.55	--	234.82	<50	<0.50	<0.50	<0.50	<0.50	<2.5	--	--
	10/1/2001	NP		240.37	5.50	14.00	6.41	--	233.96	<50	<0.50	<0.50	<0.50	<0.50	<2.5	--	--
	1/14/2002	P		240.37	5.50	14.00	5.07	--	235.30	<50	<0.50	<0.50	<0.50	<0.50	<5.0	--	--
	4/3/2002	P		240.37	5.50	14.00	8.60	--	231.77	<50	<0.50	<0.50	<0.50	<0.50	<2.5	--	--
	8/8/2002	P		240.37	5.50	14.00	9.58	--	230.79	<50	<0.50	<0.50	<0.50	<0.50	<2.5	1.7	7
	11/27/2002	P		240.37	5.50	14.00	9.15	--	231.22	<50	<0.50	<0.50	<0.50	<0.50	<0.50	3.1	6.7
	2/10/2003	P		240.37	5.50	14.00	8.55	--	231.82	<50	<0.50	<0.50	<0.50	<0.50	<0.50	1.3	6.6
	6/3/2003	--		240.37	5.50	14.00	8.72	--	231.65	<50	<0.50	<0.50	<0.50	<0.50	<0.50	9.1	6.3
	8/14/2003	--		240.37	5.50	14.00	9.52	--	230.85	<50	<0.50	<0.50	<0.50	<0.50	<0.50	5.5	6.4
	11/13/2003	--		240.37	5.50	14.00	9.45	--	230.92	--	--	--	--	--	--	--	--
	02/13/2004	--		246.09	5.50	14.00	8.38	--	237.71	--	--	--	--	--	--	--	--
	05/05/2004	--		246.09	5.50	14.00	9.30	--	236.79	--	--	--	--	--	--	--	--
	08/30/2004	P		246.09	5.50	14.00	9.69	--	236.40	<50	<0.50	<0.50	<0.50	0.75	<0.50	5.10	6.5
	11/08/2004	--		246.09	5.50	14.00	8.34	--	237.75	--	--	--	--	--	--	--	--
	02/07/2005	--		246.09	5.50	14.00	8.23	--	237.86	--	--	--	--	--	--	--	--
	05/09/2005	--		246.09	5.50	14.00	7.07	--	239.02	--	--	--	--	--	--	--	--
	08/11/2005	--	e	246.09	5.50	14.00	--	--	--	--	--	--	--	--	--	--	--
VW-1	2/23/1996	--		--	6.00	14.00	5.29	--	--	21,000	490	57	520	1,500	240	--	--

Table 1

**Groundwater Elevation and Analytical Data**  
Former ARCO Service Station #6002  
6235 Seminary Ave., Oakland, CA

Well No.	Date	P/ NP	Notes	TOC (ft MSL)	Top of Screen (ft bgs)	Bottom of Screen (ft bgs)	DTW (ft bgs)	Product Thickness (feet)	GWE (ft MSL)	GRO/TPH-g (µg/L)	Benzene (µg/L)	Toluene (µg/L)	Ethylbenzene (µg/L)	Total Xylenes (µg/L)	MTBE (µg/L)	DO (mg/L)	pH
VW-1	5/10/1996	--		--	6.00	14.00	6.80	--	--	3,700	61	<5	100	50	200	--	--
	8/9/1996	--		--	6.00	14.00	7.03	--	--	970	2.7	<2.5	2.7	3.7	180	--	--
	11/8/1996	--	e	--	6.00	14.00	--	--	--	--	--	--	--	--	--	--	--
	3/21/1997	--		--	6.00	14.00	7.51	--	--	640	<4	<1	1	3	194	--	--
	5/27/1997	--		--	6.00	14.00	7.51	--	--	--	--	--	--	--	--	--	--
	8/5/1997	--		--	6.00	14.00	7.51	--	--	630	<1	<1	3	2	120	--	--
	10/29/1997	--		--	6.00	14.00	7.53	--	--	600	<0.5	<0.5	<0.5	1.6	84	--	--
	2/25/1998	--		--	6.00	14.00	6.77	--	--	230	<4	<0.7	1.2	0.5	27	--	--
	5/12/1998	--		--	6.00	14.00	7.43	--	--	340	<0.5	0.5	2.3	0.8	29	--	--
	7/28/1998	--		--	6.00	14.00	7.00	--	--	240	<0.5	<0.5	<0.5	1.1	54	--	--
	10/27/1998	--		--	6.00	14.00	7.52	--	--	230	<0.5	<0.5	<0.5	<0.5	65	--	--
	2/8/1999	--	c	--	6.00	14.00	7.05	--	--	<50	<0.5	<0.5	<0.5	<0.5	<3/36	--	--
	6/1/1999	NP		--	6.00	14.00	7.55	--	--	180	<0.5	<0.5	<0.5	<0.5	23	1	6.36
	8/25/1999	NP		--	6.00	14.00	7.66	--	--	130	<0.5	5.6	<0.5	<0.5	40	0.39	7.5
	10/29/1999	NP		--	6.00	14.00	7.59	--	--	200	1	<0.5	0.6	1.6	36	0.89	5.65
	2/16/2000	NP		--	6.00	14.00	7.03	--	--	210	<0.5	0.9	2.2	1.9	11	1.41	--
	6/23/2000	NP		--	6.00	14.00	7.71	--	--	175	1.04	<0.500	<0.500	<0.500	14.4	1.9	--
	8/17/2000	NP		--	6.00	14.00	7.75	--	--	180	<0.500	<0.500	0.622	0.76	23.7	0.63	--
	11/10/2000	NP		--	6.00	14.00	6.83	--	--	157	0.955	<0.500	0.973	<0.500	32.5	1.03	--
	2/12/2001	NP		--	6.00	14.00	7.85	--	--	273	0.627	<0.500	<0.500	0.507	9.19	0.47	--
	4/13/2001	P		--	6.00	14.00	5.11	--	--	213	<0.500	<0.500	<0.500	<0.500	6.36	--	--
	7/18/2001	P		--	6.00	14.00	5.39	--	--	270	<0.50	<0.50	<0.50	<0.50	20	--	--
	10/1/2001	NP		--	6.00	14.00	6.50	--	--	200	<0.50	<0.50	<0.50	0.81	14	--	--
	1/14/2002	P		--	6.00	14.00	5.04	--	--	110	<0.50	<0.50	<0.50	<0.50	6.4	--	--
	4/3/2002	P		--	6.00	14.00	7.51	--	--	91	0.72	<0.50	<0.50	<0.50	12	--	--
	8/8/2002	P		--	6.00	14.00	9.58	--	--	<50	<0.50	<0.50	<0.50	<0.50	33	0.6	6.3
	11/27/2002	P		--	6.00	14.00	7.42	--	--	52	0.72	0.78	<0.50	<0.50	21	1	6.1
	2/10/2003	NP		--	6.00	14.00	7.38	--	--	52	<0.50	<0.50	<0.50	<0.50	11	1.7	6.5
	6/3/2003	--		--	6.00	14.00	7.30	--	--	71	<0.50	<0.50	<0.50	<0.50	13	3.3	6.3
	8/14/2003	--		--	6.00	14.00	7.59	--	--	<50	<0.50	<0.50	<0.50	<0.50	18	0.3	6.1
	11/13/2003	P		--	6.00	14.00	7.43	--	--	<50	<0.50	<0.50	<0.50	<0.50	13	0.60	6.1
	02/13/2004	P		253.19	6.00	14.00	7.35	--	245.84	59	<0.50	<0.50	<0.50	0.56	8.0	1.0	6.0
	05/05/2004	P		253.19	6.00	14.00	7.30	--	245.89	<50	0.71	<0.50	<0.50	0.60	11	0.10	6.4
	08/30/2004	P		253.19	6.00	14.00	8.50	--	244.69	<50	<0.50	<0.50	<0.50	<0.50	24	0.20	6.2

Table 1

## Groundwater Elevation and Analytical Data

Former ARCO Service Station #6002

6235 Seminary Ave., Oakland, CA

Well No.	Date	P/ NP	Notes	TOC (ft MSL)	Top of Screen (ft bgs)	Bottom of Screen (ft bgs)	DTW (ft bgs)	Product Thickness (feet)	GWE (ft MSL)	GRO/ TPH-g (µg/L)	Benzene (µg/L)	Toluene (µg/L)	Ethyl-benzene (µg/L)	Total Xylenes (µg/L)	MTBE (µg/L)	DO (mg/L)	pH
VW-1	11/08/2004	P		253.19	6.00	14.00	7.22	--	245.97	230	<0.50	<0.50	<0.50	0.75	27	0.65	5.1
	02/07/2005	P		253.19	6.00	14.00	7.25	--	245.94	<50	<0.50	<0.50	<0.50	<0.50	5.1	1.57	5.9
	05/09/2005	P		253.19	6.00	14.00	7.10	--	246.09	64	<0.50	<0.50	<0.50	<0.50	6.9	3.50	--
	08/11/2005	P		253.19	6.00	14.00	7.89	--	245.30	<50	<0.50	<0.50	<0.50	<0.50	10	0.04	6.3
VW-2	2/23/1996	--	i	--	--	--	6.92	--	--	--	--	--	--	--	--	--	--
	8/8/2002	--	i	--	--	--	10.51	--	--	--	--	--	--	--	--	--	--
VW-3	8/8/2002	--		--	5.50	14.50	8.85	--	--	<50	<0.50	<0.50	<0.50	<0.50	2.5	0.7	6.1
	11/27/2002	--	i	--	5.50	14.50	8.80	--	--	--	--	--	--	--	--	--	--
	2/10/2003	--	i	--	5.50	14.50	8.41	--	--	--	--	--	--	--	--	--	--
	6/3/2003	--	i	--	5.50	14.50	8.71	--	--	--	--	--	--	--	--	--	--
	8/14/2003	--	i	--	5.50	14.50	8.81	--	--	--	--	--	--	--	--	--	--
	11/13/2003	--		--	5.50	14.50	8.75	--	--	--	--	--	--	--	--	--	--
	02/13/2004	--		252.26	5.50	14.50	8.48	--	243.78	--	--	--	--	--	--	--	--
	05/05/2004	--		252.26	5.50	14.50	8.85	--	243.41	--	--	--	--	--	--	--	--
	08/30/2004	--		252.26	5.50	14.50	9.07	--	243.19	--	--	--	--	--	--	--	--
	11/08/2004	--		252.26	5.50	14.50	8.32	--	243.94	--	--	--	--	--	--	--	--
	02/07/2005	--		252.26	5.50	14.50	8.28	--	243.98	--	--	--	--	--	--	--	--
	05/09/2005	--		252.26	5.50	14.50	8.44	--	243.82	--	--	--	--	--	--	--	--
	08/11/2005	--		252.26	5.50	14.50	8.96	--	243.30	--	--	--	--	--	--	--	--
	VW-4	5/10/1996	--		--	5.50	14.50	8.58	--	--	13,000	2,500	41	420	660	43,000	--
8/9/1996		--		--	5.50	14.50	11.70	--	--	<50	<0.5	<0.5	<0.5	<0.5	6,200	--	--
11/8/1996		--		--	5.50	14.50	9.38	--	--	7,800	510	7	180	370	21,000	--	--
3/21/1997		--		--	5.50	14.50	9.11	--	--	10,000	290	10	270	230	8,900	--	--
5/27/1997		--		--	5.50	14.50	9.34	--	--	--	--	--	--	--	--	--	--
8/5/1997		--		--	5.50	14.50	9.47	--	--	<10,000	180	<100	<100	110	12,000	--	--
10/29/1997		--		--	5.50	14.50	9.35	--	--	9,800	200	69	260	360	4,900	--	--
2/25/1998		--		--	5.50	14.50	7.08	--	--	<50	2.5	<0.5	<0.5	0.7	<3	--	--
5/12/1998		--		--	5.50	14.50	9.17	--	--	3,200	<20	22	29	52	2,100	--	--
7/28/1998		--		--	5.50	14.50	9.55	--	--	<10,000	<100	<100	<100	<100	5,100	--	--
10/27/1998		--		--	5.50	14.50	9.92	--	--	<50	<0.5	<0.5	<0.5	<0.5	<3	--	--
2/8/1999		--	c	--	5.50	14.50	7.50	--	--	<2,500	<25	<25	28	<25	2,400/3,100	--	--
6/1/1999		NP		--	5.50	14.50	9.87	--	--	2,100	2.5	1.1	2.5	15	3,300	2	6.69



Table 1

## Groundwater Elevation and Analytical Data

Former ARCO Service Station #6002

6235 Seminary Ave., Oakland, CA

Well No.	Date	P/ NP	Notes	TOC (ft MSL)	Top of Screen (ft bgs)	Bottom of Screen (ft bgs)	DTW (ft bgs)	Product Thickness (feet)	GWE (ft MSL)	GRO/ TPH-g (µg/L)	Benzene (µg/L)	Toluene (µg/L)	Ethyl-benzene (µg/L)	Total Xylenes (µg/L)	MTBE (µg/L)	DO (mg/L)	pH
VW-4	8/25/1999	NP		--	5.50	14.50	9.78	--	--	1,300	4.4	4.9	1.7	2.9	4,600	0.36	7.94
	10/29/1999	NP		--	5.50	14.50	9.93	--	--	1,400	<0.5	1.8	1.6	3	4,200	1.18	6.64
	2/16/2000	NP		--	5.50	14.50	7.45	--	--	1,800	<0.5	2.9	15	10	3,400	1.01	--
	6/23/2000	--	f	--	5.50	14.50	--	--	--	1,260	<2.00	<2.00	<2.00	2.73	2,720	--	--
	6/23/2000	NP		--	5.50	14.50	9.74	--	--	1,360	<2.00	2.26	<2.00	2.25	4,900	1.5	--
	8/17/2000	NP		--	5.50	14.50	9.95	--	--	2,230	<10.0	<10.0	<10.0	<10.0	5,310	1.13	--
	11/10/2000	NP		--	5.50	14.50	9.22	--	--	1,390	18.5	<5.00	<5.00	<5.00	8,840	1.25	--
	2/12/2001	NP		--	5.50	14.50	8.99	--	--	1,400	9.42	<2.00	17.8	16.1	3,570	0.91	--
	4/13/2001	NP		--	5.50	14.50	7.80	--	--	556	3.82	<1.25	<1.25	<1.25	2,450	--	--
	7/18/2001	--	f	--	5.50	14.50	--	--	--	2,000	8.7	2.2	<2.0	<2.0	3,400	--	--
	7/18/2001	NP		--	5.50	14.50	7.73	--	--	2,100	9.2	<2.0	<2.0	<2.0	3,700	--	--
	10/1/2001	--	f	--	5.50	14.50	--	--	--	1,800	<10	<10	<10	<10	5,800	--	--
	10/1/2001	NP		--	5.50	14.50	6.69	--	--	2,000	<10	<10	<10	13	5,900	--	--
	1/14/2002	P		--	5.50	14.50	5.93	--	--	580	<2.0	<2.0	<2.0	<2.0	2,700	--	--
	4/3/2002	NP		--	5.50	14.50	9.60	--	--	1,400	5.2	16	<5.0	9.6	2,200	--	--
	8/8/2002	--	i	--	5.50	14.50	10.01	--	--	--	--	--	--	--	--	--	--
	11/27/2002	P		--	5.50	14.50	10.30	--	--	<10,000	<100	<100	<100	<100	3,800	1.7	6.7
	2/10/2003	NP		--	5.50	14.50	10.06	--	--	<5,000	<50	<50	<50	<50	2,500	1	6.8
	6/3/2003	--		--	5.50	14.50	10.04	--	--	<1,000	<10	<10	<10	<10	440	1.9	6.6
	8/14/2003	--		--	5.50	14.50	9.66	--	--	<500	<5.0	<5.0	<5.0	<5.0	170	0.8	6.7
	11/13/2003	P		--	5.50	14.50	10.01	--	--	<500	<5.0	<5.0	<5.0	<5.0	130	1.70	6.4
	02/13/2004	P		252.69	5.50	14.50	9.34	--	243.35	330	<2.5	<2.5	<2.5	3.0	210	2.0	6.6
	05/05/2004	P		252.69	5.50	14.50	10.07	--	242.62	130	<1.0	<1.0	<1.0	<1.0	66	1.20	6.8
	08/30/2004	P		252.69	5.50	14.50	10.32	--	242.37	<500	<5.0	<5.0	<5.0	<5.0	220	1.10	6.6
	11/08/2004	P		252.69	5.50	14.50	9.35	--	243.34	480	<2.5	<2.5	<2.5	<2.5	140	1.10	6.0
	02/07/2005	P		252.69	5.50	14.50	9.22	--	243.47	180	<0.50	<0.50	<0.50	<0.50	47	1.83	6.5
	05/09/2005	P		252.69	5.50	14.50	9.78	--	242.91	120	0.63	<0.50	<0.50	<0.50	37	--	--
	08/11/2005	P		252.69	5.50	14.50	10.11	--	242.58	74	<0.50	<0.50	<0.50	<0.50	15	0.70	6.7

**Table 1**

**Groundwater Elevation and Analytical Data**

Former ARCO Service Station #6002

6235 Seminary Ave., Oakland, CA

**SYMBOLS AND ABBREVIATIONS:**

-- = Not analyzed/applicable/measured/available  
< = Not detected at or above laboratory reporting limit  
DO = Dissolved oxygen  
DTW = Depth to water in ft bgs  
ft bgs = feet below ground surface  
ft MSL = feet above mean sea level  
GRO = Gasoline Range Organics, range C4-C12  
GWE = Groundwater elevation measured in ft MSL  
mg/L = Milligrams per liter  
MTBE = Methyl tert butyl ether  
NP = Well not purged prior to sampling  
P = Well purged prior to sampling  
TOC = Top of casing measured in feet above mean sea level  
TPH-g = Total petroleum hydrocarbons as gasoline  
ug/L = Micrograms per liter

**FOOTNOTES:**

a = SPH detected and GWE corrected; corrected elevation (Z') =  $Z + (h * 0.73)$  where: Z: measured elevation, h: floating product thickness, 0.73: density ratio of oil to water.  
b = MTBE analyzed by EPA method 8240  
c = MTBE, sample also analyzed for fuel oxygenates  
d = Well was decommissioned on 2/12/1996.  
e = Well inaccessible.  
f = Duplicate  
g = Well is dry.  
h = Insufficient water to sample.  
i = Well is not part of the sampling program and therefore was not sampled.  
j = Sheen in well.

**NOTES:**

Wells surveyed to NAVD'88 datum on 1/27/2004.

Beginning on the first quarter 2003 sampling event (2/10/2003), TPH-g, BTEX and MTBE analyzed by EPA method 8260. Prior to 2/10/2003, BTEX (Benzene, toluene, ethylbenzene, xylenes) by EPA method 8021B from 10/29/99 to 2/10/03, and 8020 prior to 10/29/99.

Beginning in the fourth quarter 2003, the laboratory modified the reported analyte list. TPH-g has been changed to GRO. The resulting data may be impacted by the potential of non-TPHg analytes within the requested fuel range resulting in a higher concentration being reported.

Beginning in the second quarter 2004, the carbon range for GRO was changed from C6-C10 to C4-C12

Values for DO and pH were obtained through field measurements.

The data within this table collected prior to August 2002 was provided to URS by RM and their previous consultants. URS has not verified the accuracy of this information.

Table 2

**Fuel Additives Analytical Data**  
Former ARCO Service Station #6002  
6235 Seminary Ave., Oakland, CA

Well Number	Date Sampled	Ethanol (µg/L)	TBA (µg/L)	MTBE (µg/L)	DIPE (µg/L)	ETBE (µg/L)	TAME (µg/L)	1,2-DCA (µg/L)	EDB (µg/L)	Footnotes/ Comments
MW-3	2/10/2003	<40	<20	<0.50	<0.50	<0.50	<0.50	--	--	
	08/30/2004	<100	<20	0.72	<0.50	<0.50	<0.50	<0.50	<0.50	
	08/11/2005	<100	<20	0.73	<0.50	<0.50	<0.50	<0.50	<0.50	
MW-4	2/10/2003	<40	<20	<0.50	<0.50	<0.50	<0.50	--	--	
	6/3/2003	<100	<20	<0.50	<0.50	<0.50	<0.50	--	--	
	8/14/2003	<100	<20	<0.50	<0.50	<0.50	<0.50	<0.50	<0.50	
	08/30/2004	<100	<20	<0.50	<0.50	<0.50	<0.50	<0.50	<0.50	
	08/11/2005	<100	<20	<0.50	<0.50	<0.50	<0.50	<0.50	<0.50	
MW-5	2/10/2003	<200	<100	100	<0.50	<0.50	<0.50	--	--	
	6/3/2003	<1,000	<200	160	<5.0	<5.0	<5.0	--	--	
	11/13/2003	<1,000	<200	90	<5.0	<5.0	<5.0	--	--	
	02/13/2004	<200	41	90	<1.0	<1.0	<1.0	<1.0	<1.0	
	05/05/2004	<500	<100	130	<2.5	<2.5	<2.5	<2.5	<2.5	
	08/30/2004	<500	100	85	<2.5	<2.5	<2.5	<2.5	<2.5	
	11/08/2004	<200	43	69	<1.0	<1.0	<1.0	<1.0	<1.0	
	02/07/2005	<200	<40	15	<1.0	<1.0	<1.0	<1.0	<1.0	
	05/09/2005	<200	<40	19	<1.0	<1.0	<1.0	<1.0	<1.0	a
	08/11/2005	<500	<100	51	<2.5	<2.5	<2.5	<2.5	<2.5	
MW-6	2/10/2003	<40	<20	<0.50	<0.50	<0.50	<0.50	--	--	
	08/30/2004	<100	<20	<0.50	<0.50	<0.50	<0.50	<0.50	<0.50	
	08/11/2005	<100	<20	<0.50	<0.50	<0.50	<0.50	<0.50	<0.50	
MW-7	2/10/2003	<40	<20	<0.50	<0.50	<0.50	<0.50	--	--	
	6/3/2003	<100	<20	<0.50	<0.50	<0.50	<0.50	--	--	
	8/14/2003	<100	<20	<0.50	<0.50	<0.50	<0.50	<0.50	<0.50	
	08/11/2005	<100	<20	<0.50	<0.50	<0.50	<0.50	<0.50	<0.50	
MW-8	2/10/2003	<40	<20	<0.50	<0.50	<0.50	<0.50	--	--	
	6/3/2003	<100	<20	<0.50	<0.50	<0.50	<0.50	--	--	
	8/14/2003	<100	<20	<0.50	<0.50	<0.50	<0.50	<0.50	<0.50	
	08/30/2004	<100	<20	<0.50	<0.50	<0.50	<0.50	<0.50	<0.50	
VW-1	2/10/2003	<40	<20	11	<0.50	<0.50	<0.50	--	--	
	6/3/2003	<100	<20	13	<0.50	<0.50	<0.50	--	--	
	8/14/2003	<100	<20	18	<0.50	<0.50	<0.50	<0.50	<0.50	

**Table 2**

**Fuel Additives Analytical Data**  
 Former ARCO Service Station #6002  
 6235 Seminary Ave., Oakland, CA

Well Number	Date Sampled	Ethanol (µg/L)	TBA (µg/L)	MTBE (µg/L)	DIPE (µg/L)	ETBE (µg/L)	TAME (µg/L)	1,2-DCA (µg/L)	EDB (µg/L)	Footnotes/ Comments
VW-1	11/13/2003	<100	<20	13	<0.50	<0.50	<0.50	--	--	
	02/13/2004	<100	<20	8.0	<0.50	<0.50	<0.50	<0.50	<0.50	
	05/05/2004	<100	<20	11	<0.50	<0.50	<0.50	<0.50	<0.50	
	08/30/2004	<100	<20	24	<0.50	<0.50	<0.50	<0.50	<0.50	
	11/08/2004	<100	<20	27	<0.50	<0.50	<0.50	<0.50	<0.50	
	02/07/2005	<100	<20	5.1	<0.50	<0.50	<0.50	<0.50	<0.50	
	05/09/2005	<100	<20	6.9	<0.50	<0.50	<0.50	<0.50	<0.50	
	08/11/2005	<100	<20	10	<0.50	<0.50	<0.50	<0.50	<0.50	
VW-4	2/10/2003	<4,000	<2,000	2500	<0.50	<0.50	<0.50	--	--	
	6/3/2003	<2,000	4,100	440	<10	<10	<10	--	--	
	8/14/2003	<1,000	3,200	170	<5.0	<5.0	<5.0	<5.0	<5.0	
	11/13/2003	<1,000	3,300	130	<5.0	<5.0	<5.0	--	--	
	02/13/2004	<500	1,300	210	<2.5	<2.5	<2.5	<2.5	<2.5	
	05/05/2004	<200	1,500	66	<1.0	1.3	<1.0	<1.0	<1.0	
	08/30/2004	<1,000	5,400	220	<5.0	5.4	<5.0	<5.0	<5.0	
	11/08/2004	<500	2,700	140	<2.5	<2.5	<2.5	<2.5	<2.5	
	02/07/2005	<100	1,000	47	<0.50	0.89	<0.50	<0.50	<0.50	
	05/09/2005	<100	1,200	37	<0.50	0.92	<0.50	<0.50	<0.50	
08/11/2005	<100	2,000	15	<0.50	1.8	<0.50	<0.50	<0.50	b	

## Table 2

### Fuel Additives Analytical Data

Former ARCO Service Station #6002

6235 Seminary Ave., Oakland, CA

#### SYMBOLS AND ABBREVIATIONS:

-- = Not analyzed/applicable/measured/available

< = Not detected at or above the laboratory reporting limit.

1,2-DCA = 1,2-Dichloroethane

DIPE = Di-isopropyl ether

EDB = 1,2-Dibromoethane

ETBE = Ethyl tert-butyl ether

MTBE = Methyl tert-butyl ether

TAME = tert-Amyl methyl ether

TBA = tert-Butyl alcohol

ug/L = Micrograms per Liter

#### FOOTNOTES:

a = Calibration verification for ethanol was within the method limits but outside the contract limits.

b = The initial analysis for TBA was within holding time but required dilution.

#### NOTES:

All volatile organic compounds (Ethanol, TBA, MTBE, DIPE, ETBE, and TAME) analyzed using EPA Method 8260B.

The data within this table collected prior to August 2002 was provided to URS by RM and their previous consultants. URS has not verified the accuracy of this information.

Table 3

**Groundwater Gradient Data**  
 Former ARCO Service Station #6002  
 6235 Seminary Ave., Oakland, CA

Date Sampled	Approximate Flow Direction	Approximate Hydraulic Gradient
3/15/1995	West-Southwest	0.08
5/30/1995	West-Southwest	0.08
9/1/1995	West-Southwest	0.09
11/13/1995	West-Southwest	0.08
2/23/1996	West-Southwest	0.08
5/10/1996	West-Southwest	0.08
8/9/1996	Southwest	0.08
11/8/1996	Southwest	0.06
3/21/1997	West-Southwest	0.05
5/27/1997	West-Southwest	0.07
8/5/1997	West	0.08
10/29/1997	West-Southwest	0.04
2/25/1998	West-Southwest	0.05
5/12/1998	West	0.07
7/28/1998	West	0.07
10/27/1998	West-Southwest	0.06
2/8/1999	West-Southwest	0.07
6/1/1999	West-Northwest	0.07
8/25/1999	West-Southwest	0.07
10/29/1999	West	0.07
2/16/2000	Southwest	0.05
6/23/2000	West	0.04
8/17/2000	West	0.09
11/10/2000	West-Southwest	0.08
2/12/2001	West-Southwest	0.07
4/13/2001	West	0.09
7/18/2001	West	0.08
10/1/2001	West-Southwest	0.08
1/14/2002	West-Southwest	0.07
4/3/2002	West-Southwest	0.08
8/8/2002	West-Southwest	0.09
11/27/2002	West-Southwest	0.08
2/10/2003	Southwest	0.06
6/3/2003	West	0.07
8/14/2003	West-Southwest	0.07
11/13/2003	West-Southwest	0.07
2/13/2004	Southwest	0.05
5/4/2004	Southwest	0.06
8/30/2004	Southwest	0.07
11/8/2004	Southwest	0.10

**Table 3**

**Groundwater Gradient Data**  
Former ARCO Service Station #6002  
6235 Seminary Ave., Oakland, CA

<b>Date Sampled</b>	<b>Approximate Flow Direction</b>	<b>Approximate Hydraulic Gradient</b>
2/7/2005	Southwest	0.1
5/9/2005	Southwest	0.07
8/11/2005	West	0.07

Source : The data within this table collected prior to August 2002 was provided to URS by RM and their previous consultants. URS has not verified the accuracy of this information.

**ATTACHMENT A**  
**FIELD PROCEDURES AND FIELD DATA SHEETS**



## FIELD PROCEDURES

---

### Sampling Procedures

The sampling procedure for each well consists first of measuring the water level and depth to bottom, and checking for the presence of free phase petroleum product (free product), using either an electronic indicator and a clear Teflon™ bailer or an oil-water interface probe. Wells not containing free product are purged approximately three casing volumes of water (or until dewatered) using a centrifugal pump, gas displacement pump, or bailer. Equipment and purging method used for the current sampling event is noted on the attached field data sheets. During purging, temperature, pH, and electrical conductivity are monitored to document that these parameters are stable prior to collecting samples. After purging, water levels are allowed to partially (approximately 80%) recover. Groundwater samples (both purge and no purge) are collected using a Teflon bailer, placed into appropriate Environmental Protection Agency- (EPA) approved containers, labeled, logged onto chain-of-custody records, and transported on ice to a California State-certified laboratory. Wells with free product are not sampled and free product is removed according to California Code of Regulation, Title 23, Div. 3, Chap. 16, Section 2655, UST Regulations.

## WELL GAUGING DATA

Project # 050811-PC1

Date 8/11/05

Client Arlo 6002

Site 6255 Seminary Ave., Oakland

Well ID	Well Size (in.)	Sheen / Odor	Depth to Immiscible Liquid (ft.)	Thickness of Immiscible Liquid (ft.)	Volume of Immiscibles Removed (ml)	Depth to water (ft.)	Depth to well bottom (ft.)	Survey Point: TOB or TOC	
MW-3	4					8.72	24.52	TOC	NP 5'
MW-4	4					12.68	24.18		4.5'
MW-5	4					12.77	24.50		5'
MW-6	2					9.80	32.05		
MW-7	2					11.55	13.32		10'
MW-8	2		Well Parked over			-	-		
VW-1	4					7.89	14.00		
VW-3	4					8.96	14.32		GD.
VW-4	4					10.11	14.98		

## ARCO / BP WELL MONITORING DATA SHEET

BTS #: <u>050611-PC1</u>	Station # <u>Arco10002</u>
Sampler: <u>PC</u>	Date: <u>8/11/05</u>
Well I.D.: <u>MW-3</u>	Well Diameter: 2 3 <u>4</u> 6 8 <u>   </u>
Total Well Depth: <u>24.52</u>	Depth to Water: <u>2.72</u>
Depth to Free Product:	Thickness of Free Product (feet):
Referenced to: <u>PVC</u> Grade	D.O. Meter (if req'd): <u>YSI</u> HACH

Well Diameter	Multiplier	Well Diameter	Multiplier
1"	0.04	4"	0.65
2"	0.16	6"	1.47
3"	0.37	Other	radius <sup>2</sup> * 0.163

Purge Method: Bailer      Sampling Method: Bailer  
    Disposable Bailer      Disposable Bailer  
    Positive Air Displacement      Extraction Port  
    Electric Submersible      Other: \_\_\_\_\_  
    Extraction Pump  
 Other: \_\_\_\_\_

Top of Screen: 5'      If well is listed as a no-purge, confirm that water level is below the top of screen. Otherwise, the well must be purged.

$\frac{\text{1 Case Volume (Gals.)}}{\text{Specified Volumes}} \times \text{no Purge} = \text{Calculated Volume Gals.}$
---

Time	Temp (°F)	pH	Conductivity (mS or <u>µS</u> )	Gals. Removed	Observations
<u>8:30</u>	<u>76.80</u>	<u>6.1</u>	<u>436</u>	—	

Did well dewater? Yes  No       Gallons actually evacuated:    

Sampling Time: 8:30      Sampling Date: 8/11/05

Sample I.D.: MW-3      Laboratory: Pace Sequoia Other \_\_\_\_\_

Analyzed for: GRO BTEX MTBE DRO Other: acetone

D.O. (if req'd):	Pre-purge:	mg/L	Post-purge:	1.6	mg/L
O.R.P. (if req'd):	Pre-purge:	mV	Post-purge:		mV

## ARCO / BP WELL MONITORING DATA SHEET

BTS #: <u>050B11-PC1</u>	Station # <u>Arco602</u>
Sampler: <u>PC</u>	Date: <u>8/11/05</u>
Well I.D.: <u>MW-4</u>	Well Diameter: 2 3 <u>(4)</u> 6 8
Total Well Depth: <u>24.10</u>	Depth to Water: <u>12.60</u>
Depth to Free Product:	Thickness of Free Product (feet):
Referenced to: <u>eye</u> Grade	D.O. Meter (if req'd): <u>VSI</u> HACH

Well Diameter	Multiplier	Well Diameter	Multiplier
1"	0.04	4"	0.65
2"	0.16	6"	1.47
3"	0.37	Other	radius <sup>2</sup> * 0.163

Purge Method:  Bailer      Sampling Method:  Bailer

Disposable Bailer       Disposable Bailer

Positive Air Displacement       Extraction Port

Electric Submersible

Extraction Pump

Other: \_\_\_\_\_

Top of Screen: 4.5'      If well is listed as a no-purge, confirm that water level is below the top of screen. Otherwise, the well must be purged.

1 Case Volume (Gals.)	x <u>No Purge</u>	=	_____ Gals.
	Specified Volumes		Calculated Volume

Time	Temp (°F)	pH	Conductivity (mS or <u>µS</u> )	Gals. Removed	Observations
945	73.1	6.5	369	-	

Did well dewater? Yes   No      Gallons actually evacuated: \_\_\_\_\_

Sampling Time: 945      Sampling Date: 8/11/05

Sample I.D.: MW-4      Laboratory: Pace Sequoya Other \_\_\_\_\_

Analyzed for: GRO BTEX MTBE DRO Other:  

D.O. (if req'd):	Pre-purge: _____ mg/L	Post-purge: <u>1.9</u> mg/L
O.R.P. (if req'd):	Pre-purge: _____ mV	Post-purge: _____ mV

## ARCO / BP WELL MONITORING DATA SHEET

BTS #: <u>050811-PC</u>	Station # <u>Arco 6002</u>
Sampler: <u>PC</u>	Date: <u>8/1/05</u>
Well I.D.: <u>MW-5</u>	Well Diameter: 2 3 <u>4</u> 6 8
Total Well Depth: <u>24.50</u>	Depth to Water: <u>12.77</u>
Depth to Free Product:	Thickness of Free Product (feet):
Referenced to: <u>EGC</u> Grade	D.O. Meter (if req'd): <u>YSI</u> HACH

Well Diameter	Multiplier	Well Diameter	Multiplier
1"	0.04	4"	0.65
2"	0.16	6"	1.47
3"	0.37	Other	radius <sup>2</sup> * 0.163

Purge Method:  Bailer  
 Disposable Bailer  
 Positive Air Displacement  
 Electric Submersible Extraction Pump  
 Other: \_\_\_\_\_

Sampling Method:  Bailer  
 Disposable Bailer  
 Extraction Port  
 Other: \_\_\_\_\_

Top of Screen: 5' If well is listed as a no-purge, confirm that water level is below the top of screen. Otherwise, the well must be purged.

_____	x	<u>No Purge</u>	=	_____ Gals.
1 Case Volume (Gals.)		Specified Volumes		Calculated Volume

Time	Temp (°F)	pH	Conductivity (mS or $\mu$ S)	Gals. Removed	Observations
<u>905</u>	<u>60.2</u>	<u>6.0</u>	<u>588</u>	-	

Did well dewater? Yes  No  Gallons actually evacuated: 0

Sampling Time: 905 Sampling Date: 8/1/05

Sample I.D.: MW-5 Laboratory: Pace Sequoia Other \_\_\_\_\_

Analyzed for: GRO BTEX MTBE DRO Other: seco

D.O. (if req'd):	Pre-purge:	mg/L	Post-purge:	mg/L
	O.R.P. (if req'd):	Pre-purge:	mV	Post-purge:

## ARCO / BP WELL MONITORING DATA SHEET

BTS #: <u>050811-PC1</u>	Station # <u>Arco 6002</u>
Sampler: <u>P2</u>	Date: <u>6/11/05</u>
Well I.D.: <u>MU-6</u>	Well Diameter: <u>0</u> 3 4 6 8 <u>    </u>
Total Well Depth: <u>3205</u>	Depth to Water: <u>9.80</u>
Depth to Free Product:	Thickness of Free Product (feet):
Referenced to: <u>(EVO)</u> Grade	D.O. Meter (if req'd): <u>(YS)</u> HACH

Well Diameter	Multiplier	Well Diameter	Multiplier
1"	0.04	4"	0.65
2"	0.16	6"	1.47
3"	0.37	Other	radius <sup>2</sup> * 0.163

Purge Method: <input type="checkbox"/> Bailer <input checked="" type="checkbox"/> Disposable Bailer <input type="checkbox"/> Positive Air Displacement <input type="checkbox"/> Electric Submersible <input type="checkbox"/> Extraction Pump Other: _____	Sampling Method: <input type="checkbox"/> Bailer <input checked="" type="checkbox"/> Disposable Bailer <input type="checkbox"/> Extraction Port Other: _____
---	---

Top of Screen: \_\_\_\_\_ If well is listed as a no-purge, confirm that water level is below the top of screen. Otherwise, the well must be purged.

<u>3.6</u>	x	<u>3</u>	=	<u>10.8</u>	Gals.
1 Case Volume (Gals.)		Specified Volumes		Calculated Volume	

Time	Temp (°F)	pH	Conductivity (mS or $\mu$ S)	Gals. Removed	Observations
1010	69.0	7.2	412	3.6	
1016	67.9	7.1	415	7.2	
1022	67.2	7.1	412	10.8	

Did well dewater? Yes <input type="checkbox"/> <input checked="" type="checkbox"/> No	Gallons actually evacuated: <u>10.8</u>	
Sampling Time: <u>1030</u>	Sampling Date: <u>6/11/05</u>	
Sample I.D.: <u>MU-6</u>	Laboratory: Pace <u>Sequoia</u> Other _____	
Analyzed for: GRO BTEX MTBE DRO Other: _____		
D.O. (if req'd):	Pre-purge: _____ mg/L	Post-purge: <u>2.4</u> mg/L
O.R.P. (if req'd):	Pre-purge: _____ mV	Post-purge: _____ mV

## ARCO / BP WELL MONITORING DATA SHEET

BTS #: <u>050811-PC1</u>	Station # <u>Arco 6002</u>
Sampler: <u>PC</u>	Date: <u>6/11/05</u>
Well I.D.: <u>MW-7</u>	Well Diameter: <u>(2)</u> 3 4 6 8 _____
Total Well Depth: <u>332</u>	Depth to Water: <u>11.55</u>
Depth to Free Product:	Thickness of Free Product (feet):
Referenced to: <u>(EVE)</u> Grade	D.O. Meter (if req'd): <u>(YS)</u> HACH

Well Diameter	Multiplier	Well Diameter	Multiplier
1"	0.04	4"	0.65
2"	0.16	6"	1.47
3"	0.37	Other	radius <sup>2</sup> * 0.163

Purge Method: Bailer      Sampling Method: Bailer

Disposable Bailer       Disposable Bailer  
 Positive Air Displacement       Extraction Port  
 Electric Submersible  
 Extraction Pump  
 Other: \_\_\_\_\_

Top of Screen: 10'      If well is listed as a no-purge, confirm that water level is below the top of screen. Otherwise, the well must be purged.

1 Case Volume (Gals.)	x	$\frac{\text{No Purge}}{\text{Specified Volumes}}$	=	$\frac{\text{Gals.}}{\text{Calculated Volume}}$
-----------------------	---	--	---	---

Time	Temp (°F)	pH	Conductivity (mS or <u>(S)</u> )	Gals. Removed	Observations
938	68.7	6.7	432	✓	

Did well dewater? Yes  No       Gallons actually evacuated: 0

Sampling Time: 938      Sampling Date: 6/11/05

Sample I.D.: MW-7      Laboratory: Pace Sequoia Other \_\_\_\_\_

Analyzed for: GRO BTEX MTBE DRO Other: \_\_\_\_\_

D.O. (if req'd):	Pre-purge:	mg/L	Post-purge:	mg/L
			<u>1.1</u>	
O.R.P. (if req'd):	Pre-purge:	mV	Post-purge:	mV

## ARCO / BP WELL MONITORING DATA SHEET

BTS #: <u>050811-PCL</u>	Station # <u>Arco 6002</u>
Sampler: <u>PC</u>	Date: <u>8/1/06</u>
Well I.D.: <u>MU-B</u>	Well Diameter: 2 3 4 6 8 <u>    </u>
Total Well Depth:	Depth to Water:
Depth to Free Product:	Thickness of Free Product (feet):
Referenced to: PVC                  Grade	D.O. Meter (if req'd): YSI                  HACH

Well Diameter	Multiplier	Well Diameter	Multiplier
1"	0.04	4"	0.65
2"	0.16	6"	1.47
3"	0.37	Other	radius <sup>2</sup> * 0.163

Purge Method: <u>Bailer</u> <del>Disposable Bailer</del> <del>Positive Air Displacement</del> <del>Electric Submersible</del> <del>Extraction Pump</del> Other: _____	Sampling Method: <u>Bailer</u> <del>Disposable Bailer</del> <del>Extraction Port</del> Other: _____
--	--

Top of Screen: \_\_\_\_\_ If well is listed as a no-purge, confirm that water level is below the top of screen. Otherwise, the well must be purged.

_____	X	_____	=	_____ Gals.
1 Case Volume (Gals.)		Specified Volumes		Calculated Volume

Time	Temp (°F)	pH	Conductivity (mS or µS)	Gals. Removed	Observations

Well Parked over  
In Backyard of Residence  
Tenants not available

Did well dewater? Yes          No	Gallons actually evacuated: _____
Sampling Time: _____	Sampling Date: _____
Sample I.D.: <u>MW-B</u>	Laboratory: <u>Pace</u> Sequoia    Other _____
Analyzed for: GRO    BTEX    MTBE    DRO    Other: _____	
D.O. (if req'd):	Pre-purge: _____ mg/L          Post-purge: _____ mg/L
O.R.P. (if req'd):	Pre-purge: _____ mV          Post-purge: _____ mV



## ARCO / BP WELL MONITORING DATA SHEET

BTS #: <u>050811-PCL</u>	Station # <u>Arco 6002</u>
Sampler: <u>Pc</u>	Date: <u>8/11/05</u>
Well I.D.: <u>VW-1</u>	Well Diameter: 2 3 <u>4</u> 6 8 <u>    </u>
Total Well Depth: <u>14.00</u>	Depth to Water: <u>7.89</u>
Depth to Free Product:	Thickness of Free Product (feet):
Referenced to: <u>PVC</u> Grade	D.O. Meter (if req'd): <u>YS</u> HACH

Well Diameter	Multiplier	Well Diameter	Multiplier
1"	0.04	4"	0.65
2"	0.16	6"	1.47
3"	0.37	Other	radius <sup>3</sup> * 0.163

Purge Method:  Bailer      Sampling Method:  Bailer  
 Disposable Bailer       Disposable Bailer  
 Positive Air Displacement       Extraction Port  
 Electric Submersible      Other: \_\_\_\_\_  
 Extraction Pump

Top of Screen: \_\_\_\_\_ If well is listed as a no-purge, confirm that water level is below the top of screen. Otherwise, the well must be purged.

<u>4</u>	x	<u>3</u>	=	<u>12</u>	Gals.
1 Case Volume (Gals.)		Specified Volumes		Calculated Volume	

Time	Temp (°F)	pH	Conductivity (mS or $\mu$ S)	Gals. Removed	Observations
1040	68.9	6.7	485	4	
1042	70.1	6.4	468	8	
1043	69.8	6.3	482	12	

Did well dewater? Yes   No      Gallons actually evacuated: 12

Sampling Time: 1050      Sampling Date: 8/11/05

Sample I.D.: VW-1      Laboratory: Pace Sequim Other \_\_\_\_\_

Analyzed for: GRO BTEX MTBE DRO Other: \_\_\_\_\_

D.O. (if req'd):	Pre-purge:	$\text{mg/L}$	Post-purge:	<u>0.04</u> $\text{mg/L}$
O.R.P. (if req'd):	Pre-purge:	mV	Post-purge:	mV

## ARCO / BP WELL MONITORING DATA SHEET

BTS #: <u>050811-PC1</u>	Station # <u>Arco 6002</u>
Sampler: <u>PC</u>	Date: <u>6/11/05</u>
Well I.D.: <u>1.75-4</u>	Well Diameter: 2 3 <u>4</u> 6 8
Total Well Depth: <u>14.98</u>	Depth to Water: <u>10.11</u>
Depth to Free Product:	Thickness of Free Product (feet):
Referenced to: <u>PVD</u> Grade	D.O. Meter (if req'd): <u>YS</u> HACH

Well Diameter	Multiplier	Well Diameter	Multiplier
1"	0.04	4"	0.65
2"	0.16	6"	1.47
3"	0.37	Other	radius <sup>2</sup> * 0.163

Purge Method: <input type="checkbox"/> Bailer <input type="checkbox"/> Disposable Bailer <input type="checkbox"/> Positive Air Displacement <input checked="" type="checkbox"/> Electric Submersible <input type="checkbox"/> Extraction Pump Other: _____	Sampling Method: <input type="checkbox"/> Bailer <input checked="" type="checkbox"/> Disposable Bailer <input type="checkbox"/> Extraction Port Other: _____
---	---

Top of Screen: \_\_\_\_\_ If well is listed as a no-purge, confirm that water level is below the top of screen. Otherwise, the well must be purged.

<u>3.2</u>	X	<u>3</u>	=	<u>9.6</u>	Gals.
1 Case Volume (Gals.)		Specified Volumes		Calculated Volume	

Time	Temp (°F)	pH	Conductivity (mS or <del>µS</del> )	Gals. Removed	Observations
1100	68.8	6.6	642	3.2	
1101	69.4	6.6	681	6.6	
	well dewatered				
1112	71.6	6.7	699	DTW-1386	

Did well dewater?  Yes  No      Gallons actually evacuated: 7

Sampling Time: 1112 Site departure      Sampling Date: 6/11/05

Sample I.D.: VW-4      Laboratory: Pace Sequoia Other \_\_\_\_\_

Analyzed for: GRO BTEX MTBE DRO Other: \_\_\_\_\_

D.O. (if req'd):	Pre-purge:	mg/L	Post-purge:	mg/L
			<u>0.7</u>	
O.R.P. (if req'd):	Pre-purge:	mV	Post-purge:	mV

**BP GEM OIL COMPANY TYPE A BILL OF LADING**

SOURCE RECORD BILL OF LADING FOR NON-HAZARDOUS PURGEWATER RECOVERED FROM GROUNDWATER WELLS AT BP GEM OIL COMPANY FACILITIES IN THE STATE OF CALIFORNIA. THE NON-HAZARDOUS PURGE- WATER WHICH HAS BEEN RECOVERED FROM GROUND- WATER WELLS IS COLLECTED BY THE CONTRACTOR, MADE UP INTO LOADS OF APPROPRIATE SIZE AND HAULED BY DILLARD ENVIRONMENTAL TO THE ALTAMONT LANDFILL AND RESOURCE RECOVERY FACILITY IN LIVERMORE, CALIFORNIA.

The contractor performing this work is PLAINE TECH SERVICES, INC. (BTS), 1680 Rogers Avenue, San Jose, CA 95112 (phone [408] 573-0555). Blaine Tech Services, Inc. is authorized by BP GEM OIL COMPANY to recover, collect, apportion into loads the Non-Hazardous Well Purgewater that is drawn from wells at the BP GEM Oil Company facility indicated below and deliver that purgewater to BTS. Transport routing of the Non-Hazardous Well Purgewater may be direct from one BP GEM facility to the designated destination point; from one BP GEM facility to the designated destination point via another BP GEM facility; from a BP GEM facility to the designated destination point via the contractor's facility, or any combination thereof. The Non-Hazardous Well Purgewater is and remains the property of BP GEM Oil Company.

This Source Record BILL OF LADING was initiated to cover the recovery of Non-Hazardous Well Purgewater from wells at the BP GEM Oil Company facility described below:

Arco 6002

Station #

62355 Seminary Ave, Oakland

Station Address

Total Gallons Collected From Groundwater Monitoring Wells:

30

added equip. \_\_\_\_\_ any other adjustments \_\_\_\_\_

rinse water B

TOTAL GALS. RECOVERED 30

loaded onto BTS vehicle # 5B

BTS event # \_\_\_\_\_ time \_\_\_\_\_ date \_\_\_\_\_

050811-PC1 1100 8/11/05

signature PAINE

\*\*\*\*\*

REC'D AT \_\_\_\_\_ time \_\_\_\_\_ date \_\_\_\_\_

BTS 1600 8/11/05

unloaded by \_\_\_\_\_

signature \_\_\_\_\_

**ATTACHMENT B**  
**LABORATORY PROCEDURES,**  
**CERTIFIED ANALYTICAL REPORTS,**  
**AND CHAIN-OF-CUSTODY RECORDS**

## **LABORATORY PROCEDURES**

---

### **Laboratory Procedures**

The groundwater samples were analyzed for the presence of the chemicals mentioned in the chain of custody using standard EPA methods. The methods of analysis for the groundwater samples are documented in the certified analytical report. The certified analytical reports and chain-of-custody record are presented in this attachment. The analytical data provided by the laboratory approved by RM have been reviewed and verified by that laboratory.



**Sequoia  
Analytical**

885 Jarvis Drive  
Morgan Hill, CA 95037  
(408) 776-9600  
FAX (408) 782-6308  
www.sequoialabs.com

---

6 September, 2005

Scott Robinson  
URS Corporation [Arco]  
1333 Broadway, Suite 800  
Oakland, CA 94612

RE: ARCO #6002, Oakland, CA  
Work Order: MOH0676

Enclosed are the results of analyses for samples received by the laboratory on 08/12/05 15:05. If you have any questions concerning this report, please feel free to contact me.

Sincerely,

Lisa Race For Jamshid Kekobad  
Project Manager

CA ELAP Certificate #1210



URS Corporation [Arco]  
1333 Broadway, Suite 800  
Oakland CA, 94612

Project: ARCO #6002, Oakland, CA  
Project Number: G0C8K-0004  
Project Manager: Scott Robinson

MOH0676  
Reported:  
09/06/05 17:18

**ANALYTICAL REPORT FOR SAMPLES**

Sample ID	Laboratory ID	Matrix	Date Sampled	Date Received
MW-3	MOH0676-01	Water	08/11/05 08:30	08/12/05 15:05
MW-4	MOH0676-02	Water	08/11/05 09:45	08/12/05 15:05
MW-5	MOH0676-03	Water	08/11/05 09:05	08/12/05 15:05
MW-6	MOH0676-04	Water	08/11/05 10:30	08/12/05 15:05
MW-7	MOH0676-05	Water	08/11/05 09:38	08/12/05 15:05
VW-1	MOH0676-06	Water	08/11/05 10:50	08/12/05 15:05
VW-4	MOH0676-07	Water	08/11/05 11:12	08/12/05 15:05
TB-600208112005	MOH0676-08	Water	08/11/05 00:00	08/12/05 15:05

The carbon range for the TPH-GRO has been changed from C6-C10 to C4-C12. The carbon range for TPH-DRO has been changed from C10-C28 to C10-C36. EPA 8015B has been modified to better meet the requirements of California regulatory agencies.

These samples were received with no custody seals.

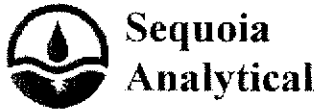

1885 Jarvis Drive  
Morgan Hill, CA 95037  
(408) 776-9600  
FAX (408) 782-6308  
www.sequoialabs.com

URS Corporation [Arco]  
1333 Broadway, Suite 800  
Oakland CA, 94612

Project: ARCO #6002, Oakland, CA  
Project Number: G0C8K-0004  
Project Manager: Scott Robinson

MOH0676  
Reported:  
09/06/05 17:18

**Volatile Organic Compounds by EPA Method 8260B**  
**Sequoia Analytical - Morgan Hill**

Analyte	Result	Reporting Limit	Units	Dilution	Batch	Prepared	Analyzed	Method	Notes
<b>MW-3 (MOH0676-01) Water    Sampled: 08/11/05 08:30    Received: 08/12/05 15:05</b>									
tert-Amyl methyl ether	ND	0.50	ug/l	1	5H23007	08/23/05	08/23/05	EPA 8260B	
Benzene	ND	0.50	"	"	"	"	"	"	
tert-Butyl alcohol	ND	20	"	"	"	"	"	"	
Di-isopropyl ether	ND	0.50	"	"	"	"	"	"	
1,2-Dibromoethane (EDB)	ND	0.50	"	"	"	"	"	"	
1,2-Dichloroethane	ND	0.50	"	"	"	"	"	"	
Ethanol	ND	100	"	"	"	"	"	"	
Ethyl tert-butyl ether	ND	0.50	"	"	"	"	"	"	
Ethylbenzene	ND	0.50	"	"	"	"	"	"	
<b>Methyl tert-butyl ether</b>	<b>0.73</b>	0.50	"	"	"	"	"	"	
Toluene	ND	0.50	"	"	"	"	"	"	
Xylenes (total)	ND	0.50	"	"	"	"	"	"	
Gasoline Range Organics (C4-C12)	ND	50	"	"	"	"	"	"	
<i>Surrogate: 1,2-Dichloroethane-d4</i>		112 %	60-135	"	"	"	"	"	
<b>MW-4 (MOH0676-02) Water    Sampled: 08/11/05 09:45    Received: 08/12/05 15:05</b>									
tert-Amyl methyl ether	ND	0.50	ug/l	1	5H23007	08/23/05	08/23/05	EPA 8260B	
Benzene	ND	0.50	"	"	"	"	"	"	
tert-Butyl alcohol	ND	20	"	"	"	"	"	"	
Di-isopropyl ether	ND	0.50	"	"	"	"	"	"	
1,2-Dibromoethane (EDB)	ND	0.50	"	"	"	"	"	"	
1,2-Dichloroethane	ND	0.50	"	"	"	"	"	"	
Ethanol	ND	100	"	"	"	"	"	"	
Ethyl tert-butyl ether	ND	0.50	"	"	"	"	"	"	
Ethylbenzene	ND	0.50	"	"	"	"	"	"	
Methyl tert-butyl ether	ND	0.50	"	"	"	"	"	"	
Toluene	ND	0.50	"	"	"	"	"	"	
Xylenes (total)	ND	0.50	"	"	"	"	"	"	
Gasoline Range Organics (C4-C12)	ND	50	"	"	"	"	"	"	
<i>Surrogate: 1,2-Dichloroethane-d4</i>		112 %	60-135	"	"	"	"	"	

Sequoia Analytical - Morgan Hill

*The results in this report apply to the samples analyzed in accordance with the chain of custody document. Unless otherwise stated, results are reported on a wet weight basis. This analytical report must be reproduced in its entirety.*





**Sequoia  
Analytical**

1885 Jarvis Drive  
Morgan Hill, CA 95037  
(408) 776-9600  
FAX (408) 782-6308  
www.sequoialabs.com

URS Corporation [Arco]  
1333 Broadway, Suite 800  
Oakland CA, 94612

Project: ARCO #6002, Oakland, CA  
Project Number: G0C8K-0004  
Project Manager: Scott Robinson

MOH0676  
Reported:  
09/06/05 17:18

**Volatile Organic Compounds by EPA Method 8260B  
Sequoia Analytical - Morgan Hill**

Analyte	Result	Reporting Limit	Units	Dilution	Batch	Prepared	Analyzed	Method	Notes
<b>MW-5 (MOH0676-03) Water Sampled: 08/11/05 09:05 Received: 08/12/05 15:05</b>									
tert-Amyl methyl ether	ND	2.5	ug/l	5	5H25008	08/25/05	08/25/05	EPA 8260B	
Benzene	ND	2.5	"	"	"	"	"	"	
tert-Butyl alcohol	ND	100	"	"	"	"	"	"	
Di-isopropyl ether	ND	2.5	"	"	"	"	"	"	
1,2-Dibromoethane (EDB)	ND	2.5	"	"	"	"	"	"	
1,2-Dichloroethane	ND	2.5	"	"	"	"	"	"	
Ethanol	ND	500	"	"	"	"	"	"	
Ethyl tert-butyl ether	ND	2.5	"	"	"	"	"	"	
<b>Ethylbenzene</b>	<b>13</b>	2.5	"	"	"	"	"	"	
<b>Methyl tert-butyl ether</b>	<b>51</b>	2.5	"	"	"	"	"	"	
Toluene	ND	2.5	"	"	"	"	"	"	
Xylenes (total)	ND	2.5	"	"	"	"	"	"	
<b>Gasoline Range Organics (C4-C12)</b>	<b>5700</b>	250	"	"	"	"	"	"	
<i>Surrogate: 1,2-Dichloroethane-d4</i>		87 %	60-135	"	"	"	"	"	
<b>MW-6 (MOH0676-04) Water Sampled: 08/11/05 10:30 Received: 08/12/05 15:05</b>									
tert-Amyl methyl ether	ND	0.50	ug/l	1	5H25008	08/25/05	08/25/05	EPA 8260B	
Benzene	ND	0.50	"	"	"	"	"	"	
tert-Butyl alcohol	ND	20	"	"	"	"	"	"	
Di-isopropyl ether	ND	0.50	"	"	"	"	"	"	
1,2-Dibromoethane (EDB)	ND	0.50	"	"	"	"	"	"	
1,2-Dichloroethane	ND	0.50	"	"	"	"	"	"	
Ethanol	ND	100	"	"	"	"	"	"	
Ethyl tert-butyl ether	ND	0.50	"	"	"	"	"	"	
Ethylbenzene	ND	0.50	"	"	"	"	"	"	
Methyl tert-butyl ether	ND	0.50	"	"	"	"	"	"	
Toluene	ND	0.50	"	"	"	"	"	"	
Xylenes (total)	ND	0.50	"	"	"	"	"	"	
<b>Gasoline Range Organics (C4-C12)</b>	<b>ND</b>	50	"	"	"	"	"	"	
<i>Surrogate: 1,2-Dichloroethane-d4</i>		86 %	60-135	"	"	"	"	"	

Sequoia Analytical - Morgan Hill

*The results in this report apply to the samples analyzed in accordance with the chain of custody document. Unless otherwise stated, results are reported on a wet weight basis. This analytical report must be reproduced in its entirety.*



1885 Jarvis Drive  
 Morgan Hill, CA 95037  
 (408) 776-9600  
 FAX (408) 782-6308  
 www.sequoialabs.com

URS Corporation [Arco] 1333 Broadway, Suite 800 Oakland CA, 94612	Project: ARCO #6002, Oakland, CA Project Number: G0C8K-0004 Project Manager: Scott Robinson	MOH0676 Reported: 09/06/05 17:18
---	---	--

**Volatile Organic Compounds by EPA Method 8260B**  
**Sequoia Analytical - Morgan Hill**

Analyte	Result	Reporting Limit	Units	Dilution	Batch	Prepared	Analyzed	Method	Notes
---------	--------	-----------------	-------	----------	-------	----------	----------	--------	-------

**MW-7 (MOH0676-05) Water** Sampled: 08/11/05 09:38 Received: 08/12/05 15:05

tert-Amyl methyl ether	ND	0.50	ug/l	1	5H23007	08/23/05	08/23/05	EPA 8260B	
Benzene	ND	0.50	"	"	"	"	"	"	
tert-Butyl alcohol	ND	20	"	"	"	"	"	"	
Di-isopropyl ether	ND	0.50	"	"	"	"	"	"	
1,2-Dibromoethane (EDB)	ND	0.50	"	"	"	"	"	"	
1,2-Dichloroethane	ND	0.50	"	"	"	"	"	"	
Ethanol	ND	100	"	"	"	"	"	"	
Ethyl tert-butyl ether	ND	0.50	"	"	"	"	"	"	
Ethylbenzene	ND	0.50	"	"	"	"	"	"	
Methyl tert-butyl ether	ND	0.50	"	"	"	"	"	"	
Toluene	ND	0.50	"	"	"	"	"	"	
Xylenes (total)	ND	0.50	"	"	"	"	"	"	
Gasoline Range Organics (C4-C12)	ND	50	"	"	"	"	"	"	
<i>Surrogate: 1,2-Dichloroethane-d4</i>		103 %	60-135	"	"	"	"	"	

**VW-1 (MOH0676-06) Water** Sampled: 08/11/05 10:50 Received: 08/12/05 15:05

tert-Amyl methyl ether	ND	0.50	ug/l	1	5H23007	08/23/05	08/23/05	EPA 8260B	
Benzene	ND	0.50	"	"	"	"	"	"	
tert-Butyl alcohol	ND	20	"	"	"	"	"	"	
Di-isopropyl ether	ND	0.50	"	"	"	"	"	"	
1,2-Dibromoethane (EDB)	ND	0.50	"	"	"	"	"	"	
1,2-Dichloroethane	ND	0.50	"	"	"	"	"	"	
Ethanol	ND	100	"	"	"	"	"	"	
Ethyl tert-butyl ether	ND	0.50	"	"	"	"	"	"	
Ethylbenzene	ND	0.50	"	"	"	"	"	"	
<b>Methyl tert-butyl ether</b>	<b>10</b>	0.50	"	"	"	"	"	"	
Toluene	ND	0.50	"	"	"	"	"	"	
Xylenes (total)	ND	0.50	"	"	"	"	"	"	
Gasoline Range Organics (C4-C12)	ND	50	"	"	"	"	"	"	
<i>Surrogate: 1,2-Dichloroethane-d4</i>		104 %	60-135	"	"	"	"	"	

URS Corporation [Arco]  
 1333 Broadway, Suite 800  
 Oakland CA, 94612

 Project: ARCO #6002, Oakland, CA  
 Project Number: G0C8K-0004  
 Project Manager: Scott Robinson

 MOH0676  
 Reported:  
 09/06/05 17:18

**Volatile Organic Compounds by EPA Method 8260B**  
**Sequoia Analytical - Morgan Hill**

Analyte	Result	Reporting Limit	Units	Dilution	Batch	Prepared	Analyzed	Method	Notes
<b>VW-4 (MOH0676-07) Water    Sampled: 08/11/05 11:12    Received: 08/12/05 15:05</b>									
tert-Amyl methyl ether	ND	0.50	ug/l	1	5H23007	08/23/05	08/23/05	EPA 8260B	
Benzene	ND	0.50	"	"	"	"	"	"	
Di-isopropyl ether	ND	0.50	"	"	"	"	"	"	
1,2-Dibromoethane (EDB)	ND	0.50	"	"	"	"	"	"	
1,2-Dichloroethane	ND	0.50	"	"	"	"	"	"	
Ethanol	ND	100	"	"	"	"	"	"	
<b>Ethyl tert-butyl ether</b>	<b>1.8</b>	<b>0.50</b>	"	"	"	"	"	"	
Ethylbenzene	ND	0.50	"	"	"	"	"	"	
<b>Methyl tert-butyl ether</b>	<b>15</b>	<b>0.50</b>	"	"	"	"	"	"	
Toluene	ND	0.50	"	"	"	"	"	"	
Xylenes (total)	ND	0.50	"	"	"	"	"	"	
<b>Gasoline Range Organics (C4-C12)</b>	<b>74</b>	<b>50</b>	"	"	"	"	"	"	
<i>Surrogate: 1,2-Dichloroethane-d4</i>		92 %		60-135	"	"	"	"	
<b>VW-4 (MOH0676-07RE1) Water    Sampled: 08/11/05 11:12    Received: 08/12/05 15:05</b>									
<b>tert-Butyl alcohol</b>	<b>2000</b>	<b>200</b>	ug/l	10	5H28002	08/28/05	08/28/05	EPA 8260B	<b>CL</b>
<i>Surrogate: 1,2-Dichloroethane-d4</i>		88 %		60-135	"	"	"	"	



1885 Jarvis Drive  
 Morgan Hill, CA 95037  
 (408) 776-9600  
 FAX (408) 782-6308  
 www.sequoialahs.com

URS Corporation [Arco]  
 1333 Broadway, Suite 800  
 Oakland CA, 94612

Project: ARCO #6002, Oakland, CA  
 Project Number: G0C8K-0004  
 Project Manager: Scott Robinson

MOH0676  
 Reported:  
 09/06/05 17:18

**Volatile Organic Compounds by EPA Method 8260B - Quality Control**  
**Sequoia Analytical - Morgan Hill**

Analyte	Result	Reporting Limit	Units	Spike Level	Source Result	%REC	%REC Limits	RPD	RPD Limit	Notes
---------	--------	-----------------	-------	-------------	---------------	------	-------------	-----	-----------	-------

**Batch 5H23007 - EPA 5030B Modified / EPA 8260B**

**Blank (5H23007-BLK1)**

Prepared & Analyzed: 08/23/05

tert-Amyl methyl ether	ND	0.50	ug/l							
Benzene	ND	0.50	"							
tert-Butyl alcohol	ND	20	"							
Di-isopropyl ether	ND	0.50	"							
1,2-Dibromoethane (EDB)	ND	0.50	"							
1,2-Dichloroethane	ND	0.50	"							
Ethanol	ND	100	"							
Ethyl tert-butyl ether	ND	0.50	"							
Ethylbenzene	ND	0.50	"							
Methyl tert-butyl ether	ND	0.50	"							
Toluene	ND	0.50	"							
Xylenes (total)	ND	0.50	"							
Gasoline Range Organics (C4-C12)	ND	50	"							
<i>Surrogate: 1,2-Dichloroethane-d4</i>	2.63		"	2.50		105	60-135			

**Laboratory Control Sample (5H23007-BS1)**

Prepared & Analyzed: 08/23/05

tert-Amyl methyl ether	15.8	0.50	ug/l	15.0		105	80-115			
Benzene	5.35	0.50	"	5.16		104	65-115			
tert-Butyl alcohol	190	20	"	143		133	75-150			
Di-isopropyl ether	15.9	0.50	"	15.1		105	75-125			
1,2-Dibromoethane (EDB)	16.3	0.50	"	14.8		110	85-120			
1,2-Dichloroethane	16.7	0.50	"	14.7		114	85-130			
Ethanol	164	100	"	141		116	70-135			
Ethyl tert-butyl ether	15.6	0.50	"	15.0		104	75-130			
Ethylbenzene	7.41	0.50	"	7.54		98	75-135			
Methyl tert-butyl ether	7.10	0.50	"	7.02		101	65-125			
Toluene	37.8	0.50	"	37.2		102	85-120			
Xylenes (total)	43.3	0.50	"	41.4		105	85-125			
Gasoline Range Organics (C4-C12)	488	50	"	440		111	70-124			
<i>Surrogate: 1,2-Dichloroethane-d4</i>	2.50		"	2.50		100	60-135			

Sequoia Analytical - Morgan Hill

*The results in this report apply to the samples analyzed in accordance with the chain of custody document. Unless otherwise stated, results are reported on a wet weight basis. This analytical report must be reproduced in its entirety.*

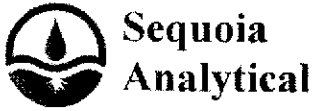

URS Corporation [Arco]  
1333 Broadway, Suite 800  
Oakland CA, 94612

Project: ARCO #6002, Oakland, CA  
Project Number: G0C8K-0004  
Project Manager: Scott Robinson

MOH0676  
Reported:  
09/06/05 17:18

**Volatile Organic Compounds by EPA Method 8260B - Quality Control**  
**Sequoia Analytical - Morgan Hill**

Analyte	Result	Reporting Limit	Units	Spike Level	Source Result	%REC	%REC Limits	RPD	RPD Limit	Notes
---------	--------	-----------------	-------	-------------	---------------	------	-------------	-----	-----------	-------

**Batch 5H23007 - EPA 5030B Modified / EPA 8260B**

<b>Matrix Spike (5H23007-MS1)</b>		<b>Source: MOH0685-02</b>			<b>Prepared &amp; Analyzed: 08/23/05</b>					
tert-Amyl methyl ether	810	25	ug/l	752	ND	108	80-115			
Benzene	277	25	"	258	10	103	65-115			
tert-Butyl alcohol	8330	1000	"	7150	ND	117	75-120			
Di-isopropyl ether	814	25	"	757	ND	108	75-125			
1,2-Dibromoethane (EDB)	847	25	"	742	ND	114	85-120			
1,2-Dichloroethane	851	25	"	736	ND	116	85-130			
Ethanol	9120	5000	"	7070	ND	129	70-135			
Ethyl tert-butyl ether	794	25	"	751	ND	106	75-130			
Ethylbenzene	424	25	"	377	49	99	75-135			
Methyl tert-butyl ether	368	25	"	351	20	99	65-125			
Toluene	1920	25	"	1860	ND	103	85-120			
Xylenes (total)	2230	25	"	2070	72	104	85-125			
Gasoline Range Organics (C4-C12)	32300	2500	"	22000	6100	119	70-124			
<i>Surrogate: 1,2-Dichloroethane-d4</i>	2.71		"	2.50		108	60-135			

<b>Matrix Spike Dup (5H23007-MSD1)</b>		<b>Source: MOH0685-02</b>			<b>Prepared &amp; Analyzed: 08/23/05</b>					
tert-Amyl methyl ether	775	25	ug/l	752	ND	103	80-115	4	15	
Benzene	260	25	"	258	10	97	65-115	6	20	
tert-Butyl alcohol	11200	1000	"	7150	ND	157	75-120	29	25	LM, BA
Di-isopropyl ether	784	25	"	757	ND	104	75-125	4	15	
1,2-Dibromoethane (EDB)	824	25	"	742	ND	111	85-120	3	15	
1,2-Dichloroethane	812	25	"	736	ND	110	85-130	5	20	
Ethanol	21500	5000	"	7070	ND	304	70-135	81	35	LM, BA
Ethyl tert-butyl ether	766	25	"	751	ND	102	75-130	4	25	
Ethylbenzene	406	25	"	377	49	95	75-135	4	15	
Methyl tert-butyl ether	349	25	"	351	20	94	65-125	5	20	
Toluene	1800	25	"	1860	ND	97	85-120	6	20	
Xylenes (total)	2110	25	"	2070	72	98	85-125	6	20	
Gasoline Range Organics (C4-C12)	31300	2500	"	22000	6100	115	70-124	3	20	
<i>Surrogate: 1,2-Dichloroethane-d4</i>	2.66		"	2.50		106	60-135			

Sequoia Analytical - Morgan Hill

*The results in this report apply to the samples analyzed in accordance with the chain of custody document. Unless otherwise stated, results are reported on a wet weight basis. This analytical report must be reproduced in its entirety.*



1885 Jarvis Drive  
 Morgan Hill, CA 95037  
 (408) 776-9600  
 FAX (408) 782-6308  
 www.sequoialabs.com

URS Corporation [Arco]  
 1333 Broadway, Suite 800  
 Oakland CA, 94612

Project: ARCO #6002, Oakland, CA  
 Project Number: G0C8K-0004  
 Project Manager: Scott Robinson

MOH0676  
 Reported:  
 09/06/05 17:18

**Volatile Organic Compounds by EPA Method 8260B - Quality Control**  
**Sequoia Analytical - Morgan Hill**

Analyte	Result	Reporting Limit	Units	Spike Level	Source Result	%REC	%REC Limits	RPD	RPD Limit	Notes
---------	--------	-----------------	-------	-------------	---------------	------	-------------	-----	-----------	-------

**Batch 5H25008 - EPA 5030B P/T / EPA 8260B**

**Blank (5H25008-BLK1)**

Prepared & Analyzed: 08/25/05

tert-Amyl methyl ether	ND	0.50	ug/l							
Benzene	ND	0.50	"							
tert-Butyl alcohol	ND	20	"							
Di-isopropyl ether	ND	0.50	"							
1,2-Dibromoethane (EDB)	ND	0.50	"							
1,2-Dichloroethane	ND	0.50	"							
Ethanol	ND	100	"							
Ethyl tert-butyl ether	ND	0.50	"							
Ethylbenzene	ND	0.50	"							
Methyl tert-butyl ether	ND	0.50	"							
Toluene	ND	0.50	"							
Xylenes (total)	ND	0.50	"							
Gasoline Range Organics (C4-C12)	ND	50	"							
<i>Surrogate: 1,2-Dichloroethane-d4</i>	<i>2.04</i>		<i>"</i>	<i>2.50</i>		<i>82</i>	<i>60-135</i>			

**Blank (5H25008-BLK2)**

Prepared & Analyzed: 08/25/05

tert-Amyl methyl ether	ND	0.50	ug/l							
Benzene	ND	0.50	"							
tert-Butyl alcohol	ND	20	"							
Di-isopropyl ether	ND	0.50	"							
1,2-Dibromoethane (EDB)	ND	0.50	"							
1,2-Dichloroethane	ND	0.50	"							
Ethanol	ND	100	"							
Ethyl tert-butyl ether	ND	0.50	"							
Ethylbenzene	ND	0.50	"							
Methyl tert-butyl ether	ND	0.50	"							
Toluene	ND	0.50	"							
Xylenes (total)	ND	0.50	"							
Gasoline Range Organics (C4-C12)	ND	50	"							
<i>Surrogate: 1,2-Dichloroethane-d4</i>	<i>2.01</i>		<i>"</i>	<i>2.50</i>		<i>80</i>	<i>60-135</i>			

Sequoia Analytical - Morgan Hill

*The results in this report apply to the samples analyzed in accordance with the chain of custody document. Unless otherwise stated, results are reported on a wet weight basis. This analytical report must be reproduced in its entirety.*



1885 Jarvis Drive  
 Morgan Hill, CA 95037  
 (408) 776-9600  
 FAX (408) 782-6308  
 www.sequoialabs.com

URS Corporation [Arco]  
 1333 Broadway, Suite 800  
 Oakland CA, 94612

Project: ARCO #6002, Oakland, CA  
 Project Number: G0C8K-0004  
 Project Manager: Scott Robinson

MOH0676  
 Reported:  
 09/06/05 17:18

**Volatile Organic Compounds by EPA Method 8260B - Quality Control**  
**Sequoia Analytical - Morgan Hill**

Analyte	Result	Reporting Limit	Units	Spike Level	Source Result	%REC	%REC Limits	RPD	RPD Limit	Notes
---------	--------	-----------------	-------	-------------	---------------	------	-------------	-----	-----------	-------

**Batch 5H25008 - EPA 5030B P/T / EPA 8260B**

**Laboratory Control Sample (5H25008-BS1)**

Prepared & Analyzed: 08/25/05

tert-Amyl methyl ether	8.20	0.50	ug/l	7.52		109	80-115			
Benzene	2.77	0.50	"	2.58		107	65-115			
tert-Butyl alcohol	70.1	20	"	71.5		98	75-150			
Di-isopropyl ether	8.23	0.50	"	7.57		109	75-125			
1,2-Dibromoethane (EDB)	8.78	0.50	"	7.42		118	85-120			
1,2-Dichloroethane	8.26	0.50	"	7.36		112	85-130			
Ethanol	70.2	100	"	70.7		99	70-135			
Ethyl tert-butyl ether	8.21	0.50	"	7.51		109	75-130			
Ethylbenzene	4.06	0.50	"	3.77		108	75-135			
Methyl tert-butyl ether	3.85	0.50	"	3.51		110	65-125			
Toluene	19.5	0.50	"	18.6		105	85-120			
Xylenes (total)	22.6	0.50	"	20.7		109	85-125			
Gasoline Range Organics (C4-C12)	261	50	"	220		119	70-124			
<i>Surrogate: 1,2-Dichloroethane-d4</i>	<i>2.10</i>		<i>"</i>	<i>2.50</i>		<i>84</i>	<i>60-135</i>			

**Laboratory Control Sample (5H25008-BS2)**

Prepared & Analyzed: 08/25/05

tert-Amyl methyl ether	8.04	0.50	ug/l	7.52		107	80-115			
Benzene	2.68	0.50	"	2.58		104	65-115			
tert-Butyl alcohol	74.1	20	"	71.5		104	75-150			
Di-isopropyl ether	7.86	0.50	"	7.57		104	75-125			
1,2-Dibromoethane (EDB)	8.55	0.50	"	7.42		115	85-120			
1,2-Dichloroethane	7.84	0.50	"	7.36		107	85-130			
Ethanol	102	100	"	70.7		144	70-135			HL
Ethyl tert-butyl ether	8.02	0.50	"	7.51		107	75-130			
Ethylbenzene	3.83	0.50	"	3.77		102	75-135			
Methyl tert-butyl ether	3.76	0.50	"	3.51		107	65-125			
Toluene	19.0	0.50	"	18.6		102	85-120			
Xylenes (total)	22.6	0.50	"	20.7		109	85-125			
Gasoline Range Organics (C4-C12)	247	50	"	220		112	70-124			
<i>Surrogate: 1,2-Dichloroethane-d4</i>	<i>2.06</i>		<i>"</i>	<i>2.50</i>		<i>82</i>	<i>60-135</i>			

Sequoia Analytical - Morgan Hill

*The results in this report apply to the samples analyzed in accordance with the chain of custody document. Unless otherwise stated, results are reported on a wet weight basis. This analytical report must be reproduced in its entirety.*

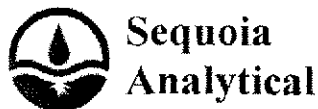

1885 Jarvis Drive  
Morgan Hill, CA 95037  
(408) 776-9600  
FAX (408) 782-6308  
www.sequoialabs.com

URS Corporation [Arco]  
1333 Broadway, Suite 800  
Oakland CA, 94612

Project: ARCO #6002, Oakland, CA  
Project Number: G0C8K-0004  
Project Manager: Scott Robinson

MOH0676  
Reported:  
09/06/05 17:18

**Volatile Organic Compounds by EPA Method 8260B - Quality Control**  
**Sequoia Analytical - Morgan Hill**

Analyte	Result	Reporting Limit	Units	Spike Level	Source Result	%REC	%REC Limits	RPD	RPD Limit	Notes
---------	--------	-----------------	-------	-------------	---------------	------	-------------	-----	-----------	-------

**Batch 5H25008 - EPA 5030B P/T / EPA 8260B**

<b>Matrix Spike (5H25008-MS1)</b>		<b>Source: MOH0687-02</b>			<b>Prepared &amp; Analyzed: 08/25/05</b>					
tert-Amyl methyl ether	84.7	5.0	ug/l	75.2	ND	113	80-115			
Benzene	34.7	5.0	"	25.8	16	72	65-115			
tert-Butyl alcohol	761	200	"	715	ND	106	75-120			
Di-isopropyl ether	81.0	5.0	"	75.7	ND	107	75-125			
1,2-Dibromoethane (EDB)	90.1	5.0	"	74.2	ND	121	85-120			LM
1,2-Dichloroethane	82.3	5.0	"	73.6	ND	112	85-130			
Ethanol	1280	1000	"	707	ND	181	70-135			HL
Ethyl tert-butyl ether	84.7	5.0	"	75.1	ND	113	75-130			
Ethylbenzene	198	5.0	"	37.7	170	74	75-135			LN
Methyl tert-butyl ether	65.7	5.0	"	35.1	27	110	65-125			
Toluene	201	5.0	"	186	7.9	104	85-120			
Xylenes (total)	234	5.0	"	207	14	106	85-125			
Gasoline Range Organics (C4-C12)	6380	500	"	2200	4100	104	70-124			
<i>Surrogate: 1,2-Dichloroethane-d4</i>	<i>2.12</i>		<i>"</i>	<i>2.50</i>		<i>85</i>	<i>60-135</i>			

<b>Matrix Spike Dup (5H25008-MSD1)</b>		<b>Source: MOH0687-02</b>			<b>Prepared &amp; Analyzed: 08/25/05</b>					
tert-Amyl methyl ether	85.3	5.0	ug/l	75.2	ND	113	80-115	0.7	15	
Benzene	34.7	5.0	"	25.8	16	72	65-115	0	20	
tert-Butyl alcohol	785	200	"	715	ND	110	75-120	3	25	
Di-isopropyl ether	82.6	5.0	"	75.7	ND	109	75-125	2	15	
1,2-Dibromoethane (EDB)	87.8	5.0	"	74.2	ND	118	85-120	3	15	
1,2-Dichloroethane	83.7	5.0	"	73.6	ND	114	85-130	2	20	
Ethanol	1250	1000	"	707	ND	177	70-135	2	35	HL
Ethyl tert-butyl ether	84.4	5.0	"	75.1	ND	112	75-130	0.4	25	
Ethylbenzene	199	5.0	"	37.7	170	77	75-135	0.5	15	
Methyl tert-butyl ether	65.3	5.0	"	35.1	27	109	65-125	0.6	20	
Toluene	205	5.0	"	186	7.9	106	85-120	2	20	
Xylenes (total)	235	5.0	"	207	14	107	85-125	0.4	20	
Gasoline Range Organics (C4-C12)	6450	500	"	2200	4100	107	70-124	1	20	
<i>Surrogate: 1,2-Dichloroethane-d4</i>	<i>2.14</i>		<i>"</i>	<i>2.50</i>		<i>86</i>	<i>60-135</i>			

Sequoia Analytical - Morgan Hill

*The results in this report apply to the samples analyzed in accordance with the chain of custody document. Unless otherwise stated, results are reported on a wet weight basis. This analytical report must be reproduced in its entirety.*



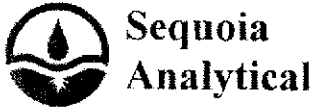

1885 Jarvis Drive  
 Morgan Hill, CA 95037  
 (408) 776-9600  
 FAX (408) 782-6308  
 www.sequoialabs.com

URS Corporation [Arco]  
 1333 Broadway, Suite 800  
 Oakland CA, 94612

Project: ARCO #6002, Oakland, CA  
 Project Number: GOC8K-0004  
 Project Manager: Scott Robinson

MOH0676  
 Reported:  
 09/06/05 17:18

**Volatile Organic Compounds by EPA Method 8260B - Quality Control**  
**Sequoia Analytical - Morgan Hill**

Analyte	Result	Reporting Limit	Units	Spike Level	Source Result	%REC	%REC Limits	RPD	RPD Limit	Notes
---------	--------	-----------------	-------	-------------	---------------	------	-------------	-----	-----------	-------

**Batch 5H28002 - EPA 5030B P/T / EPA 8260B**

**Blank (5H28002-BLK1)**

Prepared & Analyzed: 08/28/05

tert-Amyl methyl ether	ND	0.50	ug/l							
Benzene	ND	0.50	"							
tert-Butyl alcohol	ND	20	"							
Di-isopropyl ether	ND	0.50	"							
1,2-Dibromoethane (EDB)	ND	0.50	"							
1,2-Dichloroethane	ND	0.50	"							
Ethanol	ND	100	"							
Ethyl tert-butyl ether	ND	0.50	"							
Ethylbenzene	ND	0.50	"							
Methyl tert-butyl ether	ND	0.50	"							
Toluene	ND	0.50	"							
Xylenes (total)	ND	0.50	"							
Gasoline Range Organics (C4-C12)	ND	50	"							
<i>Surrogate: 1,2-Dichloroethane-d4</i>	2.29		"	2.50		92	60-135			

**Blank (5H28002-BLK2)**

Prepared: 08/28/05 Analyzed: 08/29/05

tert-Amyl methyl ether	ND	0.50	ug/l							
Benzene	ND	0.50	"							
tert-Butyl alcohol	ND	20	"							
Di-isopropyl ether	ND	0.50	"							
1,2-Dibromoethane (EDB)	ND	0.50	"							
1,2-Dichloroethane	ND	0.50	"							
Ethanol	ND	100	"							
Ethyl tert-butyl ether	ND	0.50	"							
Ethylbenzene	ND	0.50	"							
Methyl tert-butyl ether	ND	0.50	"							
Toluene	ND	0.50	"							
Xylenes (total)	ND	0.50	"							
Gasoline Range Organics (C4-C12)	ND	50	"							
<i>Surrogate: 1,2-Dichloroethane-d4</i>	2.30		"	2.50		92	60-135			

Sequoia Analytical - Morgan Hill

*The results in this report apply to the samples analyzed in accordance with the chain of custody document. Unless otherwise stated, results are reported on a wet weight basis. This analytical report must be reproduced in its entirety.*



**Sequoia  
Analytical**

1885 Jarvis Drive  
Morgan Hill, CA 95037  
(408) 776-9600  
FAX (408) 782-6308  
www.sequoialabs.com

URS Corporation [Arco]  
1333 Broadway, Suite 800  
Oakland CA, 94612

Project: ARCO #6002, Oakland, CA  
Project Number: G0C8K-0004  
Project Manager: Scott Robinson

MOH0676  
Reported:  
09/06/05 17:18

**Volatile Organic Compounds by EPA Method 8260B - Quality Control  
Sequoia Analytical - Morgan Hill**

Analyte	Result	Reporting Limit	Units	Spike Level	Source Result	%REC	%REC Limits	RPD	RPD Limit	Notes
---------	--------	-----------------	-------	-------------	---------------	------	-------------	-----	-----------	-------

**Batch 5H28002 - EPA 5030B P/T / EPA 8260B**

**Laboratory Control Sample (5H28002-BS1)**

Prepared & Analyzed: 08/28/05

tert-Amyl methyl ether	17.0	0.50	ug/l	15.0		113	80-115			
Benzene	5.29	0.50	"	5.16		103	65-115			
tert-Butyl alcohol	162	20	"	143		113	75-150			
Di-isopropyl ether	17.0	0.50	"	15.1		113	75-125			
1,2-Dibromoethane (EDB)	17.5	0.50	"	14.8		118	85-120			
1,2-Dichloroethane	15.6	0.50	"	14.7		106	85-130			
Ethanol	171	100	"	141		121	70-135			
Ethyl tert-butyl ether	17.2	0.50	"	15.0		115	75-130			
Ethylbenzene	7.77	0.50	"	7.54		103	75-135			
Methyl tert-butyl ether	6.33	0.50	"	7.02		90	65-125			
Toluene	35.5	0.50	"	37.2		95	85-120			
Xylenes (total)	44.1	0.50	"	41.4		107	85-125			
Gasoline Range Organics (C4-C12)	521	50	"	440		118	70-124			
<i>Surrogate: 1,2-Dichloroethane-d4</i>	<i>2.15</i>		<i>"</i>	<i>2.50</i>		<i>86</i>	<i>60-135</i>			

**Laboratory Control Sample (5H28002-BS2)**

Prepared: 08/28/05 Analyzed: 08/29/05

tert-Amyl methyl ether	17.2	0.50	ug/l	15.0		115	80-115			
Benzene	5.40	0.50	"	5.16		105	65-115			
tert-Butyl alcohol	155	20	"	143		108	75-150			
Di-isopropyl ether	17.2	0.50	"	15.1		114	75-125			
1,2-Dibromoethane (EDB)	17.6	0.50	"	14.8		119	85-120			
1,2-Dichloroethane	15.9	0.50	"	14.7		108	85-130			
Ethanol	170	100	"	141		121	70-135			
Ethyl tert-butyl ether	17.4	0.50	"	15.0		116	75-130			
Ethylbenzene	8.03	0.50	"	7.54		106	75-135			
Methyl tert-butyl ether	6.47	0.50	"	7.02		92	65-125			
Toluene	36.5	0.50	"	37.2		98	85-120			
Xylenes (total)	45.6	0.50	"	41.4		110	85-125			
Gasoline Range Organics (C4-C12)	529	50	"	440		120	70-124			
<i>Surrogate: 1,2-Dichloroethane-d4</i>	<i>2.18</i>		<i>"</i>	<i>2.50</i>		<i>87</i>	<i>60-135</i>			

Sequoia Analytical - Morgan Hill

*The results in this report apply to the samples analyzed in accordance with the chain of custody document. Unless otherwise stated, results are reported on a wet weight basis. This analytical report must be reproduced in its entirety.*

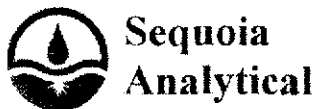

1885 Jarvis Drive  
Morgan Hill, CA 95037  
(408) 776-9600  
FAX (408) 782-6308  
www.sequoialabs.com

URS Corporation [Arco]  
1333 Broadway, Suite 800  
Oakland CA, 94612

Project: ARCO #6002, Oakland, CA  
Project Number: G0C8K-0004  
Project Manager: Scott Robinson

MOH0676  
Reported:  
09/06/05 17:18

**Volatile Organic Compounds by EPA Method 8260B - Quality Control**  
**Sequoia Analytical - Morgan Hill**

Analyte	Result	Reporting Limit	Units	Spike Level	Source Result	%REC	%REC Limits	RPD	RPD Limit	Notes
---------	--------	-----------------	-------	-------------	---------------	------	-------------	-----	-----------	-------

**Batch 5H28002 - EPA 5030B P/T / EPA 8260B**

<b>Matrix Spike (5H28002-MS1)</b>	<b>Source: MOH1017-03</b>			<b>Prepared: 08/28/05</b>		<b>Analyzed: 08/29/05</b>				
tert-Amyl methyl ether	161	5.0	ug/l	150	ND	107	80-115			
Benzene	48.1	5.0	"	51.6	ND	93	65-115			
tert-Butyl alcohol	1740	200	"	1430	350	97	75-120			
Di-isopropyl ether	160	5.0	"	151	ND	106	75-125			
1,2-Dibromoethane (EDB)	168	5.0	"	148	ND	114	85-120			
1,2-Dichloroethane	149	5.0	"	147	ND	101	85-130			
Ethanol	1420	1000	"	1410	ND	101	70-135			
Ethyl tert-butyl ether	161	5.0	"	150	ND	107	75-130			
Ethylbenzene	69.2	5.0	"	75.4	ND	92	75-135			
Methyl tert-butyl ether	227	5.0	"	70.2	170	81	65-125			
Toluene	319	5.0	"	372	ND	86	85-120			
Xylenes (total)	402	5.0	"	414	ND	97	85-125			
Gasoline Range Organics (C4-C12)	4520	500	"	4400	180	99	70-124			
<i>Surrogate: 1,2-Dichloroethane-d4</i>	<i>2.10</i>		<i>"</i>	<i>2.50</i>		<i>84</i>	<i>60-135</i>			

<b>Matrix Spike Dup (5H28002-MSD1)</b>	<b>Source: MOH1017-03</b>			<b>Prepared: 08/28/05</b>		<b>Analyzed: 08/29/05</b>				
tert-Amyl methyl ether	161	5.0	ug/l	150	ND	107	80-115	0	15	
Benzene	45.8	5.0	"	51.6	ND	89	65-115	5	20	
tert-Butyl alcohol	2230	200	"	1430	350	131	75-120	25	25	LM
Di-isopropyl ether	157	5.0	"	151	ND	104	75-125	2	15	
1,2-Dibromoethane (EDB)	166	5.0	"	148	ND	112	85-120	1	15	
1,2-Dichloroethane	147	5.0	"	147	ND	100	85-130	1	20	
Ethanol	1580	1000	"	1410	ND	112	70-135	11	35	
Ethyl tert-butyl ether	161	5.0	"	150	ND	107	75-130	0	25	
Ethylbenzene	67.4	5.0	"	75.4	ND	89	75-135	3	15	
Methyl tert-butyl ether	236	5.0	"	70.2	170	94	65-125	4	20	
Toluene	308	5.0	"	372	ND	83	85-120	4	20	LN
Xylenes (total)	395	5.0	"	414	ND	95	85-125	2	20	
Gasoline Range Organics (C4-C12)	4410	500	"	4400	180	96	70-124	2	20	
<i>Surrogate: 1,2-Dichloroethane-d4</i>	<i>2.05</i>		<i>"</i>	<i>2.50</i>		<i>82</i>	<i>60-135</i>			

Sequoia Analytical - Morgan Hill

*The results in this report apply to the samples analyzed in accordance with the chain of custody document. Unless otherwise stated, results are reported on a wet weight basis. This analytical report must be reproduced in its entirety.*



URS Corporation [Arco]  
1333 Broadway, Suite 800  
Oakland CA, 94612

Project: ARCO #6002, Oakland, CA  
Project Number: G0C8K-0004  
Project Manager: Scott Robinson

MOH0676  
Reported:  
09/06/05 17:18

**Notes and Definitions**

LN MS and/or MSD below acceptance limits. See Blank Spike(LCS).  
LM MS and/or MSD above acceptance limits. See Blank Spike(LCS).  
HL Analyte recovery above established limit  
CL Initial analysis within holding time but required dilution  
BA Relative percent difference out of control  
DET Analyte DETECTED  
ND Analyte NOT DETECTED at or above the reporting limit or MDL, if MDL is specified  
NR Not Reported  
dry Sample results reported on a dry weight basis  
RPD Relative Percent Difference



# Chain of Custody Record

Project Name: Analytical for QMR sampling  
 BP BU/AR Region/Enfos Segment: BP > Americas > West Coast > Retail > WCBU > CA > Central > 6002 > Historical/BL  
 State or Lead Regulatory Agency: California Regional Water Quality Control Board - San Francisco  
 Requested Due Date (mm/dd/yy): 10 Day TAT

On-site Time: 7:40 Temp: 70°F  
 Off-site Time: 11:30 Temp: 75°  
 Sky Conditions: clear  
 Meteorological Events: none  
 Wind Speed: \_\_\_\_\_ Direction: \_\_\_\_\_

Lab Name: Sequoia	BP/AR Facility No.: 6002	Consultant/Contractor: URS
Address: 885 Jarvis Drive Morgan Hill, CA 95037	BP/AR Facility Address: 6235 Seminary Ave., Oakland, CA 94605	Address: 1333 Broadway, Suite 800 Oakland, CA 94612
Lab PM: Lisa Race / Jamshid Kekobad	California Global ID No.: T0600100105	Consultant/Contractor Project No.: 38487035
Tele/Fax: 408.782.8156 / 408.782.6308	Enfos Project No.: GOC8K-0004	Consultant/Contractor PM: Scott Robinson
BP/AR PM Contact: Paul Supple	Provision or RCOP: Provision	Tele/Fax: 510.874.3280 / 510.874.3268
Address: P.O. Box 6549 Moraga, CA 94570	Phase/WBS: 04 - Mon/Remed by Natural Attenuation	Report Type & QC Level: Level 1 with EDF
Tele/Fax: 925.299.8891 / 925.299.8872	Sub Phase/Task: 03 - Analytical	E-mail BDD To: Donna.Cosper@urscorp.com
	Cost Element: 05 - Subcontracted Costs	Invoice to: Atlantic Richfield Company

Item No.	Sample Description	Time	Date	Matrix			Laboratory No.	No. of Containers	Preservative					Requested Analysis					Sample Point Lat/Long and Comments
				Soil/Solid	Water/Liquid	Air			Unpreserved	H <sub>2</sub> SO <sub>4</sub>	HNO <sub>3</sub>	HCl	Methanol	GRO/BTEX (8260)	MIBE, TAME, BTBE (8260)	DIPE, TBA (8260)	EDB, 1,2-DCA (8260)	Ethanol (8260)	
1	MW-3	830	8/11/05	X			01	3						X	X	X	1	<p style="text-align: center; border: 1px solid black; border-radius: 50%; padding: 5px;">MOMBL7C</p> <p>Sample Point Lat/Long and Comments</p> <p style="text-align: right;">on hold</p>	
2	MW-4	945					02	3						X	X	X	4		
3	MW-5	905		X			03	3						X	X	X	4		
4	MW-6	1080		X			04	3						X	X	X	4		
5	MW-7	938		X			05	3						X	X	X	4		
6	<del>MW-1</del>	1090					04	3						X	X	X	4		
7	VU-4	1112		X			02	3						X	X	X	4		
8	TB-600208112005			X			08	2						X	X	X	4		
9																			
10																			

Sampler's Name: <u>P. Iovish</u>	Relinquished By / Affiliation	Date	Time	Accepted By / Affiliation	Date	Time
Sampler's Company: <u>BTS</u>	<u>[Signature]</u>	<u>8/11/05</u>	<u>1539</u>	<u>[Signature]</u>	<u>8/11/05</u>	<u>1539</u>
Shipment Date:	<u>[Signature]</u>	<u>8/12</u>	<u>904</u>	<u>[Signature]</u>	<u>8/12/05</u>	<u>904</u>
Shipment Method:	<u>[Signature]</u>	<u>8/11/05</u>	<u>1505</u>	<u>[Signature]</u>	<u>8/11/05</u>	<u>1505</u>
Shipment Tracking No:						

Special Instructions:

Seals In Place Yes  No  Temp Blank Yes  No  Cooler Temperature on Receipt 60°F Trip Blank Yes  No

## SEQUOIA ANALYTICAL SAMPLE RECEIPT LOG

**CLIENT NAME:** BP  
**REC. BY (PRINT):** E. Fallin  
**WORKORDER:** M04 6676

**DATE REC'D AT LAB:** 8/12/05  
**TIME REC'D AT LAB:** 1505  
**DATE LOGGED IN:** 8-13-05

For Regulatory Purposes? Y  
**DRINKING WATER YES/NO**  
**WASTE WATER YES/NO**

CIRCLE THE APPROPRIATE RESPONSE	LAB SAMPLE #	DASH #	CLIENT ID	CONTAINER DESCRIPTION	PRESERVATIVE	pH	SAMPLE MATRIX	DATE SAMPLED	REMARKS: CONDITION (ETC.)
1. Custody Seal(s) Present / Absent Intact / Broken*	01	AL	MW-3	waal v09(3)	HCL	-	L	8/12/05	
2. Chain-of-Custody Present / Absent*	02		MW-4						
3. Traffic Reports or Packing List: Present / Absent	03		MW-5						
	04		MW-6						
	05		MW-7						
4. Airbill: Airbill / Sticker Present / Absent	06		VW-1						
	07		VW-4						
5. Airbill #: Present / Absent	08	A-B	TB 602 08112005	v09(2)					
6. Sample Labels: Present / Absent									
7. Sample IDs: Listed / Not Listed on Chain-of-Custody									
8. Sample Condition: Intact / Broken* / Leaking*									
9. Does information on chain-of-custody, traffic reports and sample labels agree? Yes / No*									
10. Sample received within hold time? Yes / No*									
11. Adequate sample volume received? Yes / No*									
12. Proper preservatives used? Yes / No*									
13. Trip Blank / Temp Blank Received? (circle which, if yes) Yes / No*									
14. Read Temp: <u>16.0°C</u> Corrected Temp: <u>16.0°C</u> Is corrected temp 4 +/- 2°C? Yes / No**									

EBF 8/12/05

\*IF CIRCLED, CONTACT PROJECT MANAGER AND ATTACH RECORD OF RESOLUTION.

**ATTACHMENT C**

**ERROR CHECK REPORTS AND EDF/GEOWELL SUBMITTAL  
CONFIRMATIONS**

## Electronic Submittal Information

[Main Menu](#) | 
 [View/Add Facilities](#) | 
 [Upload EDD](#) | 
 [Check EDD](#)

### SUCCESSFUL EDF CHECK - NO ERRORS

<u>ORGANIZATION NAME:</u>	URS Corporation-Oakland Office
<u>USER NAME:</u>	URSCORP-OAKLAND
<u>DATE CHECKED:</u>	9/14/2005 9:23:15 AM
<u>GLOBAL ID:</u>	T0600100105
<u>FILE UPLOADED:</u>	ARCO#6002-EDF-MOH0676.zip

No errors were found in your EDF upload file.

**If you want to submit this file to the SWRCB, choose the "Upload EDD" option in the above menu and follow the instructions.**

When you complete the submittal process, you will be given a confirmation number for your submittal.

Click [here](#) to view the detections report for this upload.

<b>ARCO # 06002</b> 6235 SEMINARY AVE OAKLAND, CA 94605	<b><u>Regional Board - Case #: 01-0113</u></b> SAN FRANCISCO BAY RWQCB (REGION 2) - (BG) <b><u>Local Agency (lead agency) - Case #: 3942</u></b> ALAMEDA COUNTY LOP - (AG)
---	---

#### **SAMPLE DETECTIONS REPORT**

# FIELD POINTS SAMPLED	7
# FIELD POINTS WITH DETECTIONS	4
# FIELD POINTS WITH WATER SAMPLE DETECTIONS ABOVE MCL	2
SAMPLE MATRIX TYPES	WATER

#### **METHOD QA/QC REPORT**

METHODS USED	8260FA
TESTED FOR REQUIRED ANALYTES?	N
MISSING PARAMETERS NOT TESTED:	
- 8260FA REQUIRES DBFM TO BE TESTED	
- 8260FA REQUIRES BR4FBZ TO BE TESTED	
- 8260FA REQUIRES BZMED8 TO BE TESTED	
LAB NOTE DATA QUALIFIERS	Y

#### **QA/QC FOR 8021/8260 SERIES SAMPLES**

TECHNICAL HOLDING TIME VIOLATIONS	2
METHOD HOLDING TIME VIOLATIONS	2
LAB BLANK DETECTIONS ABOVE REPORTING DETECTION LIMIT	0
LAB BLANK DETECTIONS	0
DO ALL BATCHES WITH THE 8021/8260 SERIES INCLUDE THE FOLLOWING?	
- LAB METHOD BLANK	Y
- MATRIX SPIKE	Y
- MATRIX SPIKE DUPLICATE	Y



- BLANK SPIKE Y
- SURROGATE SPIKE Y

**WATER SAMPLES FOR 8021/8260 SERIES**

- MATRIX SPIKE / MATRIX SPIKE DUPLICATE(S) % RECOVERY BETWEEN 65-135% N
- MATRIX SPIKE / MATRIX SPIKE DUPLICATE(S) RPD LESS THAN 30% Y
- SURROGATE SPIKES % RECOVERY BETWEEN 85-115% Y
- BLANK SPIKE / BLANK SPIKE DUPLICATES % RECOVERY BETWEEN 70-130% N

**SOIL SAMPLES FOR 8021/8260 SERIES**

- MATRIX SPIKE / MATRIX SPIKE DUPLICATE(S) % RECOVERY BETWEEN 65-135% n/a
- MATRIX SPIKE / MATRIX SPIKE DUPLICATE(S) RPD LESS THAN 30% n/a
- SURROGATE SPIKES % RECOVERY BETWEEN 70-125% n/a
- BLANK SPIKE / BLANK SPIKE DUPLICATES % RECOVERY BETWEEN 70-130% n/a

**FIELD QC SAMPLES**

<u>SAMPLE</u>	<u>COLLECTED</u>	<u>DETECTIONS &gt; REPD</u>
QCTB SAMPLES	N	0
QCEB SAMPLES	N	0
QCAB SAMPLES	N	0

Logged in as URSCORP-OAKLAND (CONTRACTOR)

CONTACT SITE ADMINISTRATOR.

## Electronic Submittal Information

[Main Menu](#) | [View/Add Facilities](#) | [Upload EDD](#) | [Check EDD](#)

Your EDF file has been successfully uploaded!

**Confirmation Number:** 5900702178  
**Date/Time of Submittal:** 9/14/2005 9:26:08 AM  
**Facility Global ID:** T0600100105  
**Facility Name:** ARCO # 06002  
**Submittal Title:** 3Q 05 QMR EDF BP/ARCO 6002  
**Submittal Type:** GW Monitoring Report

Click [here](#) to view the detections report for this upload.

<b>ARCO # 06002</b> 6235 SEMINARY AVE OAKLAND, CA 94605	<b>Regional Board - Case #: 01-0113</b> SAN FRANCISCO BAY RWQCB (REGION 2) - (BG) <b>Local Agency (lead agency) - Case #: 3942</b> ALAMEDA COUNTY LOP - (AG)
---	---

CONF #	TITLE	QUARTER
5900702178	3Q 05 QMR EDF BP/ARCO 6002	Q3 2005
SUBMITTED BY	SUBMIT DATE	STATUS
Srijesh Thapa	9/14/2005	PENDING REVIEW

### SAMPLE DETECTIONS REPORT

# FIELD POINTS SAMPLED	7
# FIELD POINTS WITH DETECTIONS	4
# FIELD POINTS WITH WATER SAMPLE DETECTIONS ABOVE MCL	2
SAMPLE MATRIX TYPES	WATER

### METHOD QA/QC REPORT

METHODS USED	8260FA
TESTED FOR REQUIRED ANALYTES?	N
MISSING PARAMETERS NOT TESTED:	
- 8260FA REQUIRES DBFM TO BE TESTED	
- 8260FA REQUIRES BR4FBZ TO BE TESTED	
- 8260FA REQUIRES BZMED8 TO BE TESTED	
LAB NOTE DATA QUALIFIERS	Y

### QA/QC FOR 8021/8260 SERIES SAMPLES

TECHNICAL HOLDING TIME VIOLATIONS	2
METHOD HOLDING TIME VIOLATIONS	2
LAB BLANK DETECTIONS ABOVE REPORTING DETECTION LIMIT	0
LAB BLANK DETECTIONS	0
DO ALL BATCHES WITH THE 8021/8260 SERIES INCLUDE THE FOLLOWING?	
- LAB METHOD BLANK	Y
- MATRIX SPIKE	Y
- MATRIX SPIKE DUPLICATE	Y
- BLANK SPIKE	Y
- SURROGATE SPIKE	Y

### WATER SAMPLES FOR 8021/8260 SERIES

MATRIX SPIKE / MATRIX SPIKE DUPLICATE(S) % RECOVERY BETWEEN 65-135%	N
---	---

MATRIX SPIKE / MATRIX SPIKE DUPLICATE(S) RPD LESS THAN 30%	Y
SURROGATE SPIKES % RECOVERY BETWEEN 85-115%	Y
BLANK SPIKE / BLANK SPIKE DUPLICATES % RECOVERY BETWEEN 70-130%	N

**SOIL SAMPLES FOR 8021/8260 SERIES**

MATRIX SPIKE / MATRIX SPIKE DUPLICATE(S) % RECOVERY BETWEEN 65-135%	n/a
MATRIX SPIKE / MATRIX SPIKE DUPLICATE(S) RPD LESS THAN 30%	n/a
SURROGATE SPIKES % RECOVERY BETWEEN 70-125%	n/a
BLANK SPIKE / BLANK SPIKE DUPLICATES % RECOVERY BETWEEN 70-130%	n/a

**FIELD QC SAMPLES**

<u>SAMPLE</u>	<u>COLLECTED</u>	<u>DETECTIONS &gt; REPD</u>
QCTB SAMPLES	N	0
QCEB SAMPLES	N	0
QCAB SAMPLES	N	0

Logged in as URSCORP-OAKLAND (CONTRACTOR)

CONTACT SITE ADMINISTRATOR.

## Electronic Submittal Information

[Main Menu](#) | [View/Add Facilities](#) | [Upload EDD](#) | [Check EDD](#)

### SUCCESSFUL GEO\_WELL CHECK - NO ERRORS

<u>ORGANIZATION NAME:</u>	URS Corporation-Oakland Office
<u>USER NAME:</u>	URSCORP-OAKLAND
<u>DATE CHECKED:</u>	10/4/2005 3:15:58 PM

**Processing is complete. No errors were found!**  
**You may now proceed to the [upload](#) page.**

**[Back to Main Menu](#)**

Logged in as URSCORP-OAKLAND (CONTRACTOR)

CONTACT SITE [ADMINISTRATOR](#).

## Electronic Submittal Information

[Main Menu](#) | [View/Add Facilities](#) | [Upload EDD](#) | [Check EDD](#)

### UPLOADING A GEO\_WELL FILE

**Processing is complete. No errors were found!  
Your file has been successfully submitted!**

**Submittal Title:** 3Q 2005 QMR GeoWell BP/ARCO  
6002

**Submittal Date/Time:** 10/4/2005 3:17:13 PM

**Confirmation**  
**Number:** 1201644718

**[Back to Main Menu](#)**

Logged in as URSCORP-OAKLAND  
(CONTRACTOR)

[CONTACT SITE ADMINISTRATOR.](#)

			geo_well			
T0600100105 N	MW-8	NOACC	8/11/2005			UNK
T0600100105 N	MW-4	ACT	8/11/2005	12.68	24.18	UNK
T0600100105 N	MW-5	ACT	8/11/2005	12.77	24.58	UNK
T0600100105 N	MW-3	ACT	8/11/2005	8.72	24.52	UNK
T0600100105 N	VW-3	ACT	8/11/2005	8.96	14.32	UNK
T0600100105 N	VW-1	ACT	8/11/2005	7.89	14	UNK
T0600100105 N	MW-6	ACT	8/11/2005	9.8	32.05	UNK
T0600100105 N	MW-7	ACT	8/11/2005	11.55	13.32	UNK
T0600100105 N	VW-4	ACT	8/11/2005	10.11	14.98	UNK

**ATTACHMENT D**  
**WELL REPAIR DATA SHEETS**

# Repair Data Sheet

Client Arco 6002 Date 6-7-05  
 Site Address 6235 Seminary Ave., Oakland  
 Job Number 050607AA1 Technician Andrew Adinolfi

Inspection Point (Well ID or description of location)	Well Inspected, Cleaned, Labeled - No Further Corrective Action Required	Replaced Cap	Replaced Lock	Replaced Lid Seal	Check Indicates deficiency							Lid Not Securable By Design (List Type)	Well Not Inspected (explain in notes)	Deficiency Logged on Repair Order	Deficiency Remains Uncorrected/Logged on Site Inspection Checklist	Partial Repair Completed/Outstanding Deficiency Logged on Repair Order	All Repairs Completed
					Casing	Annular Seal	Tabs / Bolts	Box Structure	Apron	Trip Hazard	Below Grade						
MW-5							X	X									X
Notes: 1 of 2 tabs broken - New Box																	
MW-6							X	X									X
Notes: 1 of 2 tabs stripped - Retap																	
VW-1											X						X
Notes: Well rim cracked missing 1" section New box																	
Notes:																	
Notes:																	