

131

Rancho San Lorenzo (Guillermo Castro)
(Pat. Bk. A Pg. 142)
Map of the Anita L. Stanton Tract (Bk. 23, Pg. 41)
Map of Block B, Castro Valley Tract (Bk. 25, Pg. 64)
TR. 3680 (Bk. 92 Pg. 12)

Scale: 1" = 100'

Jan. 24, 1957, R.W.
6-1-12-11-15
Rev. 11-10-76 U.P.
8-20-91 CSL
4-3-01 UT

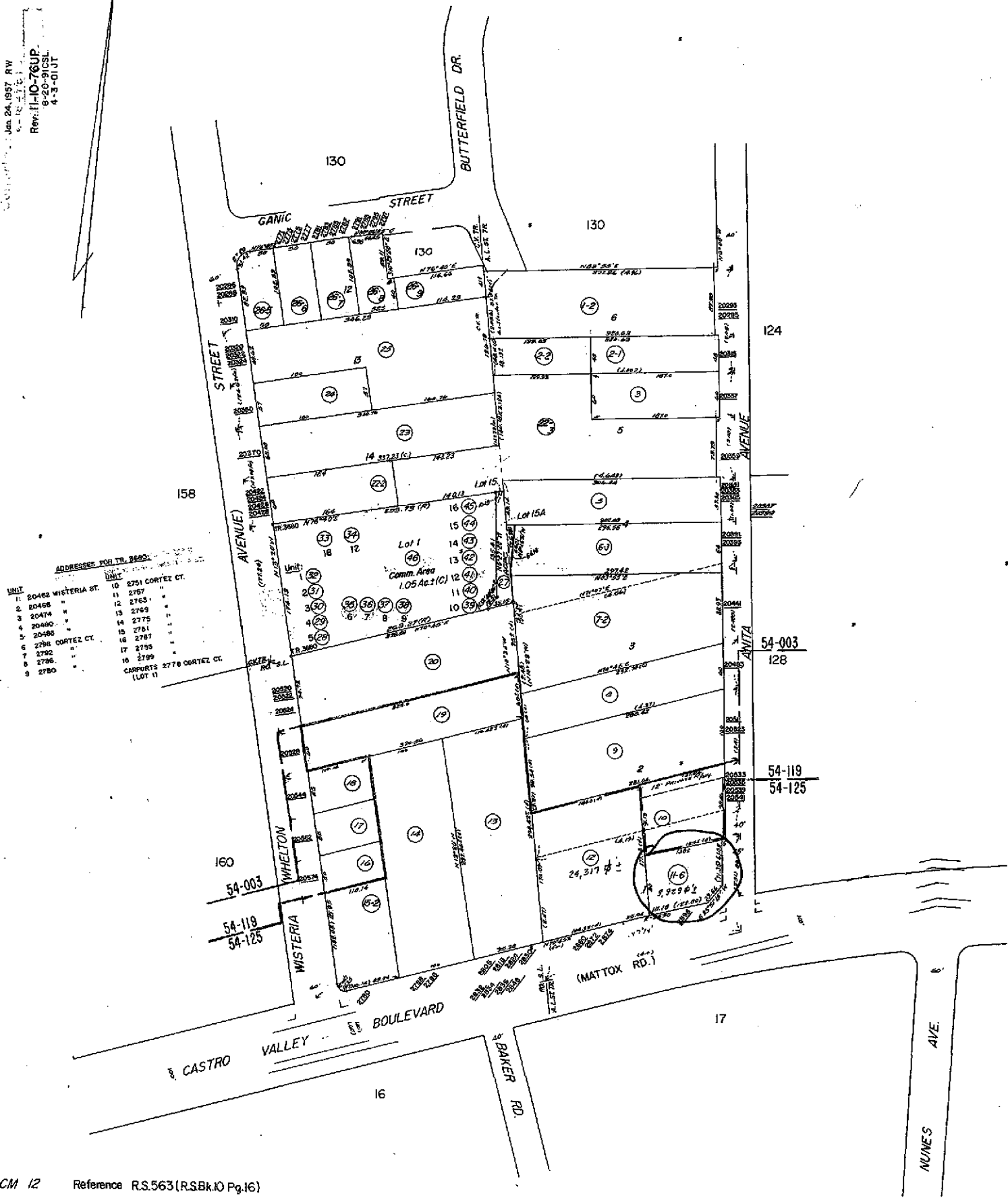

ADDRESS FOR TR. 3680:

UNIT	ADDRESS	UNIT	ADDRESS
1	20462 WISTERIA ST.	10	2751 CORTEZ CT.
2	20466 "	11	2767 "
3	20474 "	12	2763 "
4	20480 "	13	2769 "
5	20488 "	14	2775 "
6	2798 CORTEZ CT.	15	2781 "
7	2792 "	16	2787 "
8	2796 "	17	2793 "
9	2780 "	18	2799 "
		19	CARPORTS 2778 CORTEZ CT. (LOT 11)

Fmly. Bkks. 144 & 148

Property Detail**Alameda, CA Ron Thomsen, Assessor**

Parcel # (APN): 084A-0131-011-06

Use Description:

Parcel Status:

Owner Name: JIANG JAMES & WONG HILDA

Mailing Address: PO BOX 2945, CASTRO VALLEY CA 94546-0945

Situs Address: 2896 CASTRO VALLEY BL, CASTRO VALLEY CA 94546

Legal
Description:**ASSESSMENT**

Total Value: \$204,663

Use Code: 810

Zoning:

Land Value: \$149,518

Tax Rate Area: 54125

Impr Value: \$55,145

Year Assd: 2002

Improve Type:

Other Value:

Property Tax:

Price/SqFt: \$180.00

% Improved: 27%

Delinquent Yr:

Exempt Amt:

Exempt Codes:

SALES HISTORYSale 1Sale 2Sale 3Transfer

Recording Date: 03/10/1995

04/19/1994

03/10/1995

Recorded Doc #: 95 053987

94 151382

95 053987

Recorded Doc Type:

Transfer Amount: \$180,000

Sale 1 Seller (Grantor):

1st Trst Dd Amt:

Code1:

2nd Trst Dd Amt:

Code2:

PROPERTY CHARACTERISTICS

Lot Acres: 0.230A

Year Built: 1961

Fireplace:

Lot SqFt: 9,929

Effective Yr: 1962

A/C:

Bldg/Liv Area: 1,000

Heating:

Units: 1

Total Rooms:

Pool:

Buildings: 1

Bedrooms:

Flooring:

Stories: 1.00

Baths (Full): 2

Park Type: GARAGE

Style:

Baths (Half):

Spaces: 10

Construct:

Bsmt SqFt:

Site Inflnce:

Quality: 4.0

Garage SqFt:

Timber Preserve:

Building Class: S

Ag Preserve:

Condition: AVERAGE

Other:

Other Rooms:

R0158

[Help](#)[New Query](#)

COUNTY OF ALAMEDA
Assessor's Office
Property Value System

[History](#)[Value](#)[Transfer](#)[Map](#)[Glossary](#)

Parcel Number: **84A-131-11-6** Inactive: **N** Lien Date: **01/01/2007** Owner: **JIANG JAMES & WONG HILDA**
 Property Address: **2896 CASTRO VALLEY BLVD, CASTRO VALLEY, CA 94546-5506**
 Current Mailing Address as of 12/15/2006: **JIANG JAMES & WONG HILDA, P O BOX 2682 , FREMONT, CA 94536-0682**

[Parcel History](#)

Mailing Name		Historical Mailing Address	Document Date	Document Number	Value From Trans	Parcel Count	Use Tax
JIANG JAMES & WONG HILDA	List Owners	PO BOX 2945 , CASTRO VALLEY, CA 94546-0945	03/10/1995	1995-53987	\$180,000	1	8100
LINCOLN TRUST CO TR ETAL	List Owners	PO BOX 5831 , DENVER, CO 80217	03/10/1995	1995-53986		1	8100
CALIFORNIA CENTRAL TRUST BANK TR ETAL	List Owners	PO BOX 31051 , LAGUNA HILLS, CA 92654-1051	11/18/1994	1994-364199		1	8100
CALIFORNIA CENTRAL TRUST BANK TR ETAL c/o DIVERSIFIED LOAN SVC	List Owners	257 E CAMPBELL AVE , CAMPBELL, CA 95008-2057	04/19/1994	1994-151382		1	8100
FROST ROBERT M c/o LAKESHORE FINANCIAL	List Owners	21060 REDWOOD RD , CASTRO VALLEY, CA 94546-5931	06/29/1989	1989-174184		2	8100

All information on this site is to be assumed accurate for property assessment purposes only, and is based upon the Assessor's knowledge of each property. Caution is advised for use other than its intended purpose.

The Alameda County Intranet site is best viewed in Internet Explorer Version 5.5 or later.
 Click [here](#) for more information regarding supported browsers.

Copyright © 2001 Alameda County