

**Shell Oil Products US**

January 16, 2004

eva chu
Alameda County Health Care Services Agency
1131 Harbor Bay Parkway, Suite 250
Alameda, California 94502-6577

Subject: **Shell-branded Service Station**
1285 Bancroft Avenue
San Leandro, California

Alameda County
JAN 22 2004
ELECTRONIC MAIL

Dear Ms. chu:

Attached for your review and comment is a copy of the *Fourth Quarter 2003 Monitoring Report* for the above referenced site. Upon information and belief, I declare, under penalty of perjury, that the information contained in the attached document is true and correct.

As always, please feel free to contact me directly at (559) 645-9306 with any questions or concerns.

Sincerely,

Shell Oil Products US

A handwritten signature in cursive script that reads "Karen Petryna".

Karen Petryna
Sr. Environmental Engineer

January 16, 2004

eva chu
Alameda County Health Care Services Agency
1131 Harbor Bay Parkway, Suite 250
Alameda, California 94502-6577

Re: **Fourth Quarter 2003 Monitoring Report**
Shell-branded Service Station
1285 Bancroft Avenue
San Leandro, California
Incident #98996067
Cambria Project #246-0504-002

Alameda County
JAN 22 2004
Environmental Services



Dear Ms. chu:

On behalf of Equilon Enterprises LLC dba Shell Oil Products US, Cambria Environmental Technology, Inc. (Cambria) is submitting this groundwater monitoring report in accordance with the reporting requirements of 23 CCR 2652d.

REMEDIATION SUMMARY

Dual-phase vapor extraction (DVE) is the process of applying high vacuum through an airtight well seal to simultaneously extract soil vapors from the vadose zone and to enhance groundwater extraction from the saturated zone. In November 2000, Cambria initiated monthly mobile DVE on wells MW-5 and MW-6 to facilitate hydrocarbon and oxygenate removal from groundwater and the vadose zones. To date, approximately 12.4 pounds of liquid-phase total petroleum hydrocarbons as gasoline (TPHg), 0.62 pounds of liquid-phase methyl tertiary butyl ether (MTBE), 108.0 pounds of vapor-phase TPHg and 1.14 pounds of vapor-phase MTBE have been removed from the subsurface.

FOURTH QUARTER 2003 ACTIVITIES

Groundwater Monitoring: Blaine Tech Services, Inc. (Blaine) of San Jose, California gauged and sampled all wells, calculated groundwater elevations, measured dissolved oxygen (DO) concentrations in all wells, and compiled the analytical data. Cambria prepared a vicinity map

**Cambria
Environmental
Technology, Inc.**

5900 Hollis Street
Suite A
Emeryville, CA 94608
Tel (510) 420-0700
Fax (510) 420-9170

which includes previously submitted well survey information (Figure 1) and a groundwater elevation contour map (Figure 2). Blaine's report, presenting the laboratory report and supporting field documents, is included as Attachment A.

DVE: During the fourth quarter of 2003, PSC Industrial Services of Benicia, California performed monthly mobile DVE using wells MW-5 and MW-6. Cambria tabulated the groundwater and vapor-extraction mass removal data (Tables 1 and 2) and prepared graphs depicting groundwater monitoring and extraction data for the target wells (Figures 3 and 4).

Subsurface Investigation Report, Work Plan, and Site Conceptual Model: Cambria's November 3, 2003, *Subsurface Investigation Report, Work Plan, and Site Conceptual Model* presented the results of the August 2003 installation of two on-site and 3 off-site soil borings. This document also included a site conceptual model and a work plan in which Cambria recommended the installation of four additional monitoring wells and four additional soil borings.



ANTICIPATED FIRST QUARTER 2004 ACTIVITIES

Groundwater Monitoring: Blaine will gauge and sample all wells, measure DO concentrations in all wells, and tabulate the data. Cambria will prepare a monitoring report.

Mobile DVE: Mobile DVE will be performed monthly in the first quarter using wells MW-5 and MW-6.

Additional Subsurface Investigation: A November 7, 2003 letter from Alameda County Health Care Services Agency (ACHCSA) concurred with Cambria's recommendation for additional investigation, with additional conditions. Per an extension granted by the ACHCSA, Cambria will install four additional monitoring wells and four additional soil borings by February 17, 2004. Cambria will also examine the irrigation well located to the west of the site with a video camera in an attempt to determine the well's construction details.

CLOSING

We appreciate the opportunity to work with you on this project. Please call Caryl Weekley at (510) 420-3324 if you have any questions or comments.

Sincerely,
Cambria Environmental Technology, Inc



Caryl A. Weekley
Caryl A. Weekley, R.G.
Senior Project Geologist

Matthew W. Derby
Matthew W. Derby, P.E.
Senior Project Engineer

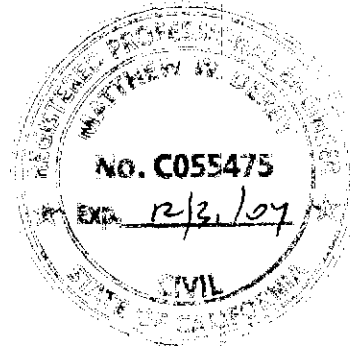

- Figures: 1 - Vicinity/Area Well Survey Map
 2 - Groundwater Elevation Contour Map
 3 - VacOps/DVE Effect on MTBE Concentration – MW-5
 4 - VacOps/DVE Effect on MTBE Concentration – MW-6

- Tables: 1 - Groundwater Extraction - Mass Removal Data
 2 - Vapor Extraction - Mass Removal Data

Attachment: A - Blaine Groundwater Monitoring Report and Field Notes

cc: Karen Petryna, Shell Oil Products US, 20945 S. Wilmington Ave., Carson, CA 90810
 Mike Bakaldin, City of San Leandro, 835 East 14th Street, San Leandro, CA 94577

G:\San Leandro 1285 Bancroft\QM\4q03\4q03qm.doc

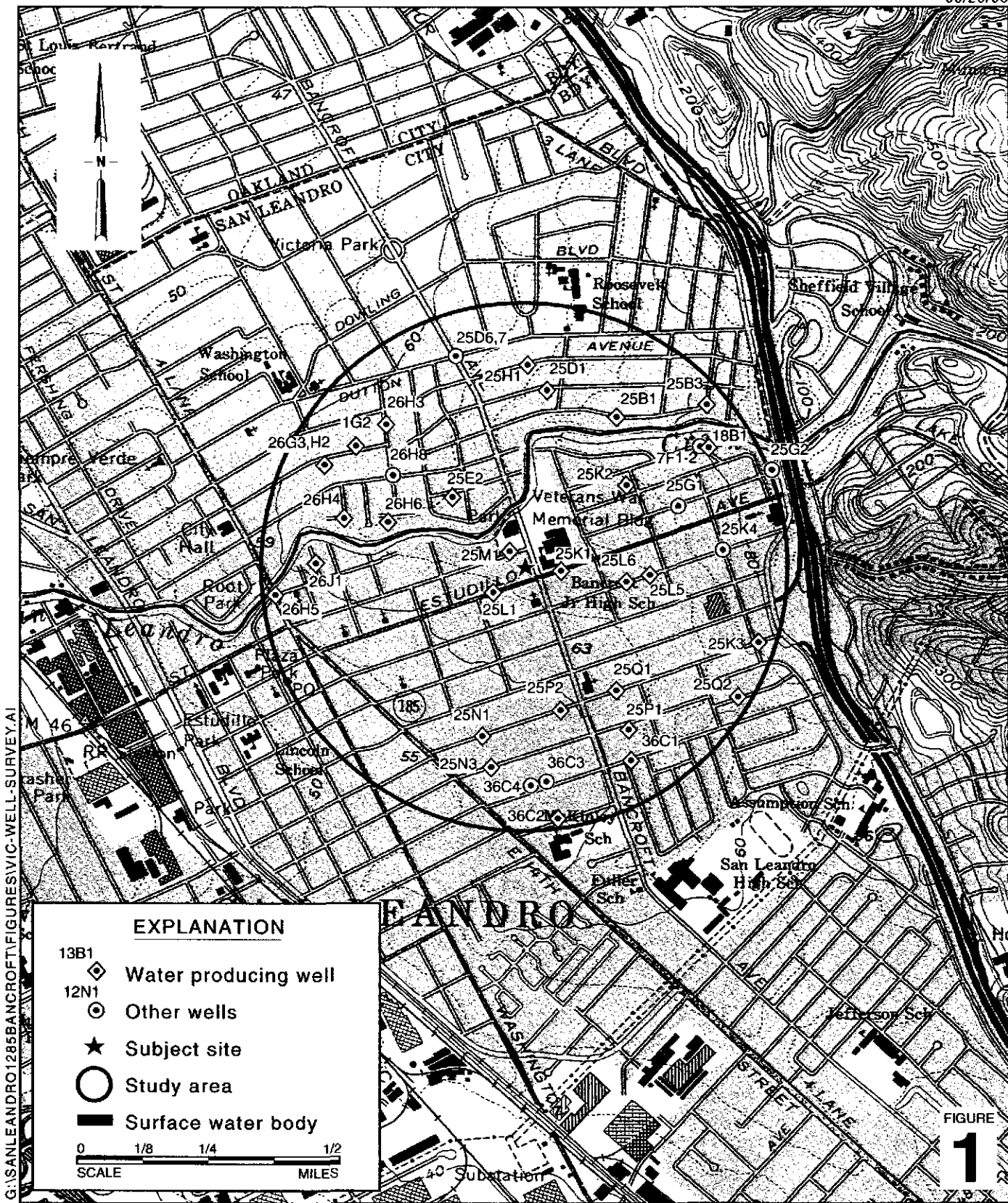

G:\SANLEANDRO\1285BANCROFT\FIGURES\VIC-WELL-SURVEY.A1

Shell-branded Service Station
 1285 Bancroft Avenue
 San Leandro, California
 Incident #98996067



**Vicinity / Area Well
 Survey Map**
 (1/2-Mile Radius)

EXPLANATION

- MW-9 Proposed monitoring well location
- SB-9 Proposed soil boring location
- MW-1 Monitoring well location
- Irr. Well Irrigation well location
- SB-4 Soil boring location
- SB-5 Attempted soil boring location
- B-1 Soil vapor survey location (6/00)
- BH-D Soil boring location (WA, 1994)
- NS Not surveyed
- * Data anomalous, not used for contouring
- Groundwater flow direction
- XX.XX Groundwater elevation contour, in feet above mean sea level (msl), approximately located, dashed where inferred

Well	ELEV	Benzene	MTBE
MW-4	27.56	<0.50	87
MW-5	27.63	290	300
MW-6	27.53	720	3,500
MW-7	27.47	<0.50	<0.50
MW-8	27.50	<1.0	240
MW-9	27.70*	<0.50	<0.50
MW-10			
MW-11			
MW-12			
NS	1.1		19

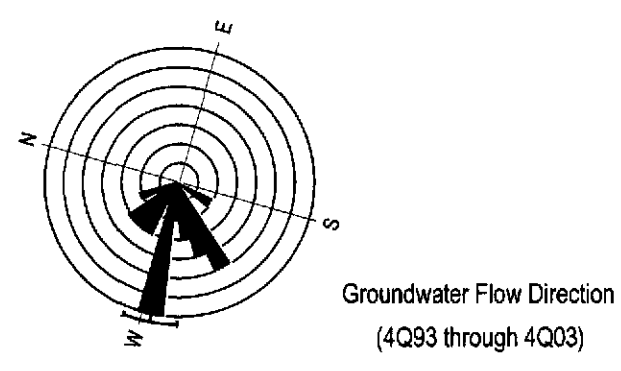
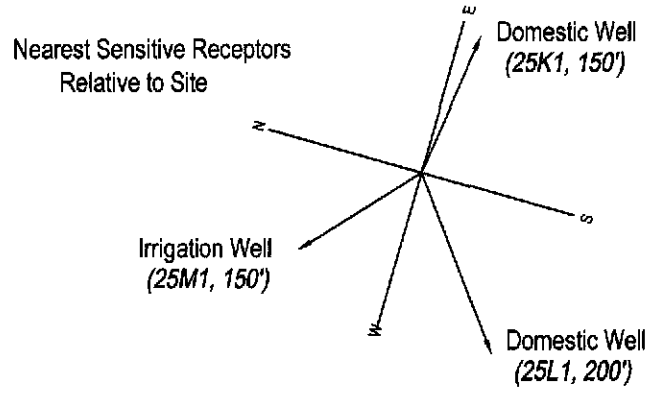

G:\SAN LEANDRO\1285BANCROFT\FIGURES\MOM03.DWG

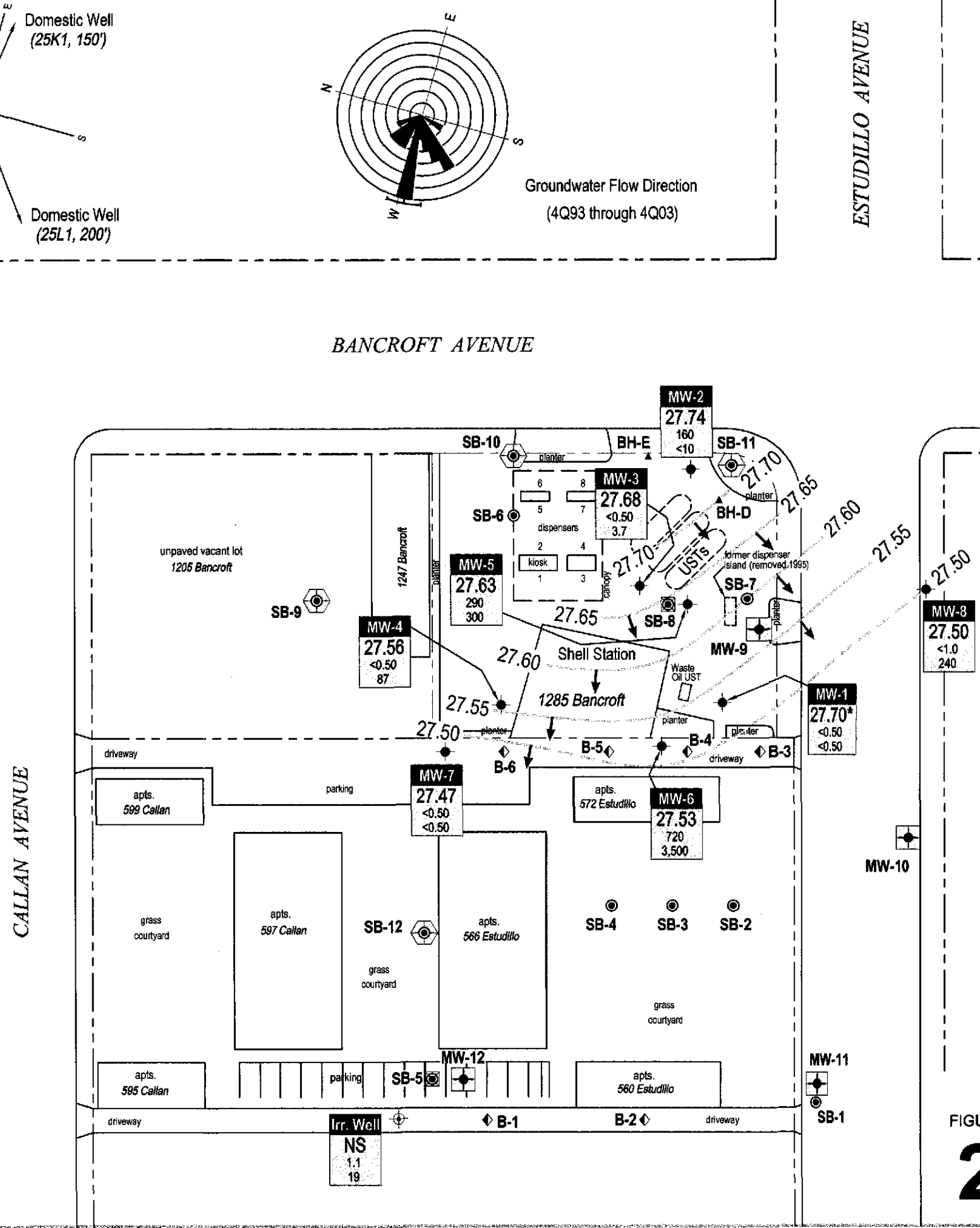
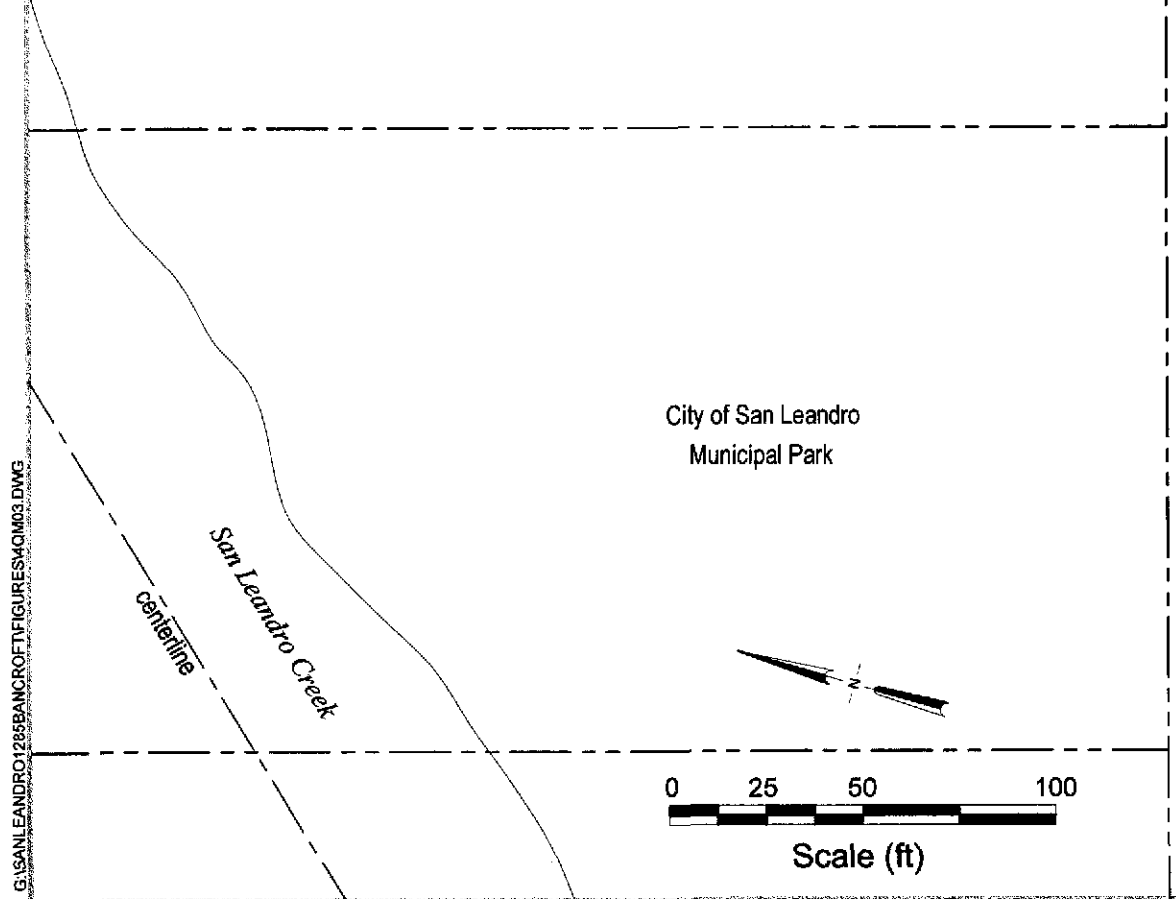

FIGURE 2

VacOps/DVE effect on MTBE concentration
1285 Bancroft, San Leandro - MW-5

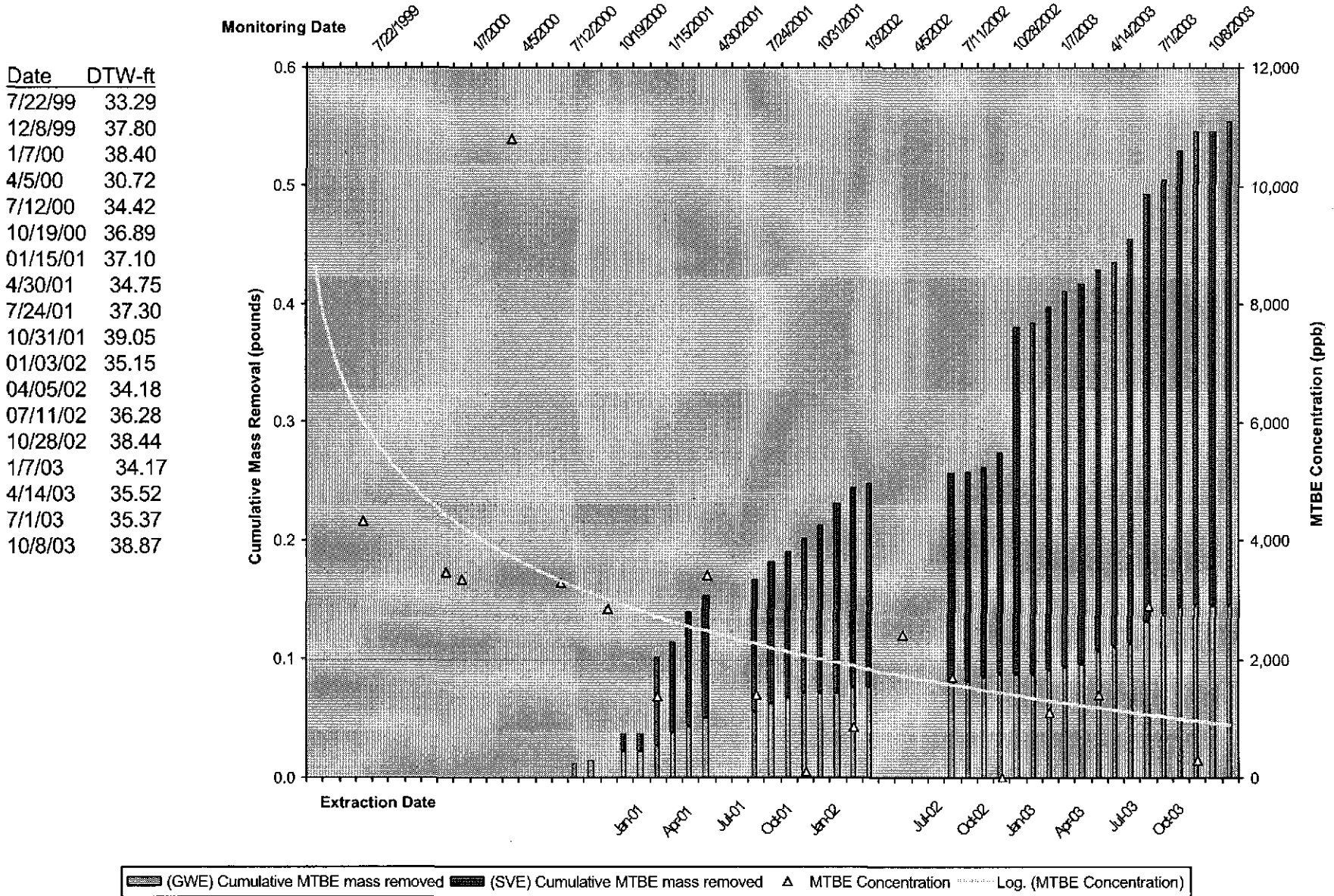

Figure 3

VacOps/DVE effect on MTBE concentration
1285 Bancroft, San Leandro - MW-6

Date	DTW-ft
6/4/99	32.13
7/22/99	32.09
12/8/99	36.62
1/7/00	37.03
4/5/00	29.37
7/12/00	33.04
10/19/00	35.62
1/15/01	35.91
4/30/01	33.70
7/2/01	35.98
10/31/01	37.55
01/03/02	33.34
04/05/02	34.18
07/11/02	35.02
10/28/02	37.78
1/10/03	32.75
4/14/03	34.95
7/1/03	34.77
10/8/03	37.57

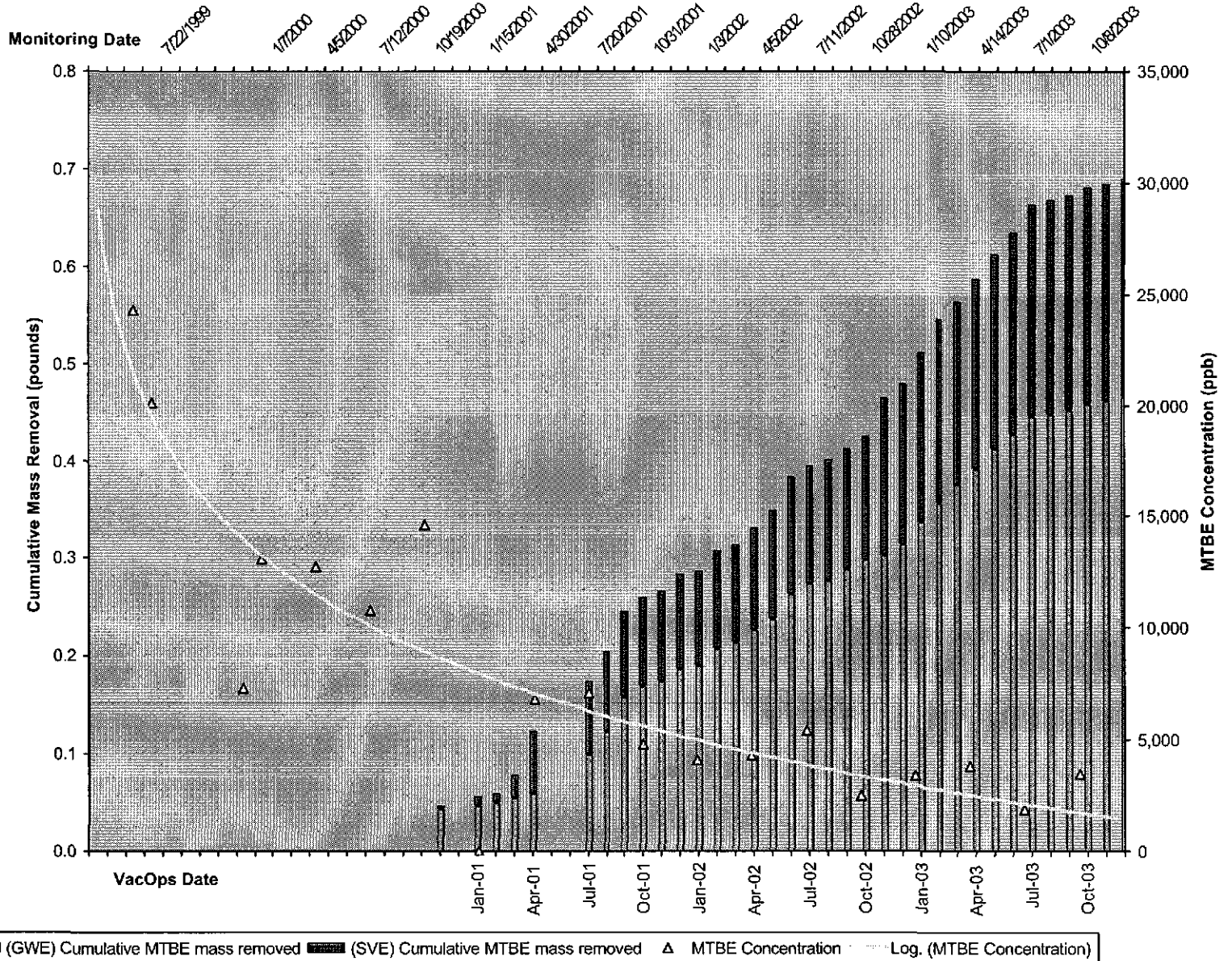

Figure 4

Table 1: Groundwater Extraction - Mass Removal Data - Shell-branded Service Station, Incident #98996067, 1285 Bancroft Avenue, San Leandro, California

Date Purged	Well ID	Volume Pumped (gal)	Cumulative Volume Pumped (gal)	Date Sampled	TPPH			Benzene			MTBE		
					TPPH Concentration (ppb)	TPPH Removed (pounds)	TPPH Removed To Date (pounds)	Benzene Concentration (ppb)	Benzene Removed (pounds)	Benzene Removed To Date (pounds)	MTBE Concentration (ppb)	MTBE Removed (pounds)	MTBE Removed To Date (pounds)
09/02/98	MW-1	130	130	07/15/98	<50	0.00003	0.00003	2.5	0.00000	0.00000	12	0.00001	0.00001
07/30/99	MW-1	0	130	07/22/99	<50	0.00000	0.00003	<0.500	0.00000	0.00000	2.17	0.00000	0.00001
08/05/99	MW-1	0	130	07/22/99	<50	0.00000	0.00003	<0.500	0.00000	0.00000	2.17	0.00000	0.00001
08/11/99	MW-1	0	130	07/22/99	<50	0.00000	0.00003	<0.500	0.00000	0.00000	2.17	0.00000	0.00001
08/12/99	MW-1	0	130	07/22/99	<50	0.00000	0.00003	<0.500	0.00000	0.00000	2.17	0.00000	0.00001
08/13/99	MW-1	400	530	07/22/99	<50	0.00008	0.00011	<0.500	0.00000	0.00000	2.17	0.00001	0.00002
08/19/99	MW-1	278	808	07/22/99	<50	0.00006	0.00017	<0.500	0.00000	0.00000	2.17	0.00001	0.00003
08/30/99	MW-1	240	1048	07/22/99	<50	0.00005	0.00022	<0.500	0.00000	0.00000	2.17	0.00000	0.00003
09/09/99	MW-1	247	1295	07/22/99	<50	0.00005	0.00027	<0.500	0.00000	0.00001	2.17	0.00000	0.00003
09/02/98	MW-3	240	240	07/18/98	31,000	0.06208	0.06208	1,100	0.00220	0.00220	3,700	0.00741	0.00741
07/30/99	MW-3	0	130	07/22/99	1,970	0.00000	0.06208	51.2	0.00000	0.00220	109	0.00000	0.00741
08/05/99	MW-3	0	130	07/22/99	1,970	0.00000	0.06208	51.2	0.00000	0.00220	109	0.00000	0.00741
08/11/99	MW-3	0	530	07/22/99	1,970	0.00000	0.06208	51.2	0.00000	0.00220	109	0.00000	0.00741
08/12/99	MW-3	100	908	07/22/99	1,970	0.00164	0.06373	51.2	0.00004	0.00225	109	0.00009	0.00750
08/13/99	MW-3	450	1,358	07/22/99	1,970	0.00740	0.07112	51.2	0.00019	0.00244	109	0.00041	0.00791
08/19/99	MW-3	269	1,627	07/22/99	1,970	0.00442	0.07555	51.2	0.00011	0.00255	109	0.00024	0.00815
08/30/99	MW-3	204	1,831	07/22/99	1,970	0.00335	0.07890	51.2	0.00009	0.00264	109	0.00019	0.00834
09/09/99	MW-3	232	2,063	07/22/99	1,970	0.00381	0.08271	51.2	0.00010	0.00274	109	0.00021	0.00855
09/02/98	MW-5	147	147	NA	NA	0.00000	0.00000	NA	0.00000	0.00000	NA	0.00000	0.00000
07/30/99	MW-5	0	147	07/22/99	97,200	0.00000	0.00000	4,580	0.00000	0.00000	4,330	0.00000	0.00000
08/05/99	MW-5	0	147	07/22/99	97,200	0.00000	0.00000	4,580	0.00000	0.00000	4,330	0.00000	0.00000
08/11/99	MW-5	0	147	07/22/99	97,200	0.00000	0.00000	4,580	0.00000	0.00000	4,330	0.00000	0.00000
08/12/99	MW-5	0	147	07/22/99	97,200	0.00000	0.00000	4,580	0.00000	0.00000	4,330	0.00000	0.00000
08/13/99	MW-5	100	247	07/22/99	97,200	0.08111	0.08111	4,580	0.00382	0.00382	4,330	0.00361	0.00361
08/19/99	MW-5	247	494	07/22/99	97,200	0.20033	0.28144	4,580	0.00944	0.01326	4,330	0.00892	0.01254
08/30/99	MW-5	0	494	07/22/99	97,200	0.00000	0.28144	4,580	0.00000	0.01326	4,330	0.00000	0.01254
09/09/99	MW-5	65	559	07/22/99	97,200	0.05272	0.33416	4,580	0.00248	0.01575	4,330	0.00235	0.01489

Table 1: Groundwater Extraction - Mass Removal Data - Shell-branded Service Station, Incident #98996067, 1285 Bancroft Avenue, San Leandro, California

Date Purged	Well ID	Volume Pumped (gal)	Cumulative Volume Pumped (gal)	Date Sampled	<u>TPPH</u>			<u>Benzene</u>			<u>MTBE</u>		
					TPPH Concentration (ppb)	TPPH Removed (pounds)	TPPH Removed To Date (pounds)	Benzene Concentration (ppb)	Benzene Removed (pounds)	Benzene Removed To Date (pounds)	MTBE Concentration (ppb)	MTBE Removed (pounds)	MTBE Removed To Date (pounds)
11/28/00	MW-5	324	883	10/19/00	72,400	0.19574	0.52990	3,010	0.00814	0.02388	2,840	0.00768	0.02256
01/23/01	MW-5	375	1,258	01/15/01	78,300	0.24501	0.77491	2,220	0.00695	0.03083	1,370	0.00429	0.02685
02/16/01	MW-5	950	2,208	01/15/01	78,300	0.62069	1.39561	2,220	0.01760	0.04843	1,370	0.01086	0.03771
03/22/01	MW-5	500	2,708	01/15/01	78,300	0.32668	1.72229	2,220	0.00926	0.05769	1,370	0.00572	0.04343
04/23/01	MW-5	600	3,308	01/15/01	78,300	0.39202	2.11431	2,220	0.01111	0.06881	1,370	0.00686	0.05029
07/16/01	MW-5	165	3,473	04/30/01	83,000	0.11428	2.22858	1,400	0.00193	0.07073	3,400	0.00468	0.05497
08/23/01	MW-5	650	4,123	07/24/01	160,000	0.86781	3.09639	2,400	0.01302	0.08375	1,400	0.00759	0.06256
09/10/01	MW-5	450	4,573	07/24/01	160,000	0.60079	3.69719	2,400	0.00901	0.09276	1,400	0.00526	0.06782
10/30/01	MW-5	250	4,823	07/24/01	160,000	0.33377	4.03096	2,400	0.00501	0.09777	1,400	0.00292	0.07074
11/26/01	MW-5	260	5,083	10/31/01	14,000	0.03037	4.06134	150	0.00033	0.09809	110	0.00024	0.07098
12/17/01	MW-5	300	5,383	10/31/01	14,000	0.03505	4.09638	150	0.00038	0.09847	110	0.00028	0.07125
01/29/02	MW-5	725	6,108	01/03/02	62,000	0.37508	4.47146	660	0.00399	0.10246	860	0.00520	0.07645
07/24/02	MW-5	250	6,358	07/11/02	140,000	0.29205	4.76351	1,900	0.00396	0.10643	1,700	0.00355	0.08000
08/30/02	MW-5	95	6,453	07/11/02	140,000	0.11098	4.87449	1,900	0.00151	0.10793	1,700	0.00135	0.08135
09/26/02	MW-5	250	6,703	07/11/02	140,000	0.29205	5.16655	1,900	0.00396	0.11190	1,700	0.00355	0.08490
10/24/02	MW-5	150	6,853	07/11/02	140,000	0.17523	5.34178	1,900	0.00238	0.11427	1,700	0.00213	0.08702
11/19/02	MW-5	150	7,003	10/28/02	30,000	0.03755	5.37933	340	0.00043	0.11470	<200	0.00013	0.08715
12/26/02	MW-5	525	7,528	10/28/02	30,000	0.13142	5.51075	340	0.00149	0.11619	<200	0.00044	0.08759
01/15/03	MW-5	300	7,828	01/07/03	72,000	0.18024	5.69099	720	0.00180	0.11799	1,100	0.00275	0.09034
02/24/03	MW-5	300	8,128	01/07/03	72,000	0.18024	5.87123	720	0.00180	0.11979	1,100	0.00275	0.09309
03/24/03	MW-5	350	8,478	01/07/03	72,000	0.21028	6.08150	720	0.00210	0.12190	1,100	0.00321	0.09631
04/21/03	MW-5	850	9,328	04/14/03	110,000	0.78020	6.86170	900	0.00638	0.12828	1,400	0.00993	0.10624
05/21/03	MW-5	310	9,638	04/14/03	110,000	0.28454	7.14624	900	0.00233	0.13061	1,400	0.00362	0.10986
06/26/03	MW-5	300	9,938	04/14/03	110,000	0.27536	7.42161	900	0.00225	0.13286	1,400	0.00350	0.11336
07/24/03	MW-5	750	10,688	07/01/03	94,000	0.58828	8.00989	970	0.00607	0.13893	2,900	0.01815	0.13151
08/22/03	MW-5	250	10,938	07/01/03	94,000	0.19609	8.20598	970	0.00202	0.14095	2,900	0.00605	0.13756
09/25/03	MW-5	251	11,189	07/01/03	94,000	0.19688	8.40285	970	0.00203	0.14299	2,900	0.00607	0.14363
10/28/03	MW-5	236	11,425	10/08/03	26,000	0.05120	8.45406	290	0.00057	0.14356	300	0.00059	0.14423
11/26/03	MW-5	127	11,552	10/08/03	26,000	0.02755	8.48161	290	0.00031	0.14386	300	0.00032	0.14454

Table 1: Groundwater Extraction - Mass Removal Data - Shell-branded Service Station, Incident #98996067, 1285 Bancroft Avenue, San Leandro, California

Date Purged	Well ID	Volume Pumped (gal)	Cumulative Volume Pumped (gal)	Date Sampled	<u>TPPH</u>			<u>Benzene</u>			<u>MTBE</u>		
					TPPH Concentration (ppb)	TPPH Removed (pounds)	TPPH Removed To Date (pounds)	Benzene Concentration (ppb)	Benzene Removed (pounds)	Benzene Removed To Date (pounds)	MTBE Concentration (ppb)	MTBE Removed (pounds)	MTBE Removed To Date (pounds)
12/11/03	MW-5	200	11,752	10/08/03	26,000	0.04339	8.52500	290	0.00048	0.14435	300	0.00050	0.14504
11/28/00	MW-6	365	365	10/19/00	39,600	0.12061	0.12061	4,050	0.01234	0.01234	14,200	0.04325	0.04325
01/23/01	MW-6	482	847	01/15/01	64,800	0.26062	0.26062	2,090	0.00841	0.00841	<1,250	0.00251	0.04576
02/16/01	MW-6	650	1,497	01/15/01	64,800	0.35146	0.35146	2,090	0.01134	0.01134	<1,250	0.00339	0.04915
03/22/01	MW-6	980	2,477	01/15/01	64,800	0.52990	0.52990	2,090	0.01709	0.01709	<1,250	0.00511	0.05426
04/23/01	MW-6	900	3,377	01/15/01	64,800	0.48664	0.48664	2,090	0.01570	0.01570	<1,250	0.00469	0.05896
07/16/01	MW-6	700	4,077	04/30/01	27,000	0.15771	0.15771	2,300	0.01343	0.01343	6,800	0.03972	0.09868
08/23/01	MW-6	400	4,477	07/20/01	29,000	0.09679	0.09679	2,100	0.00701	0.00701	7,100	0.02370	0.12237
09/10/01	MW-6	600	5,077	07/20/01	29,000	0.14519	0.14519	2,100	0.01051	0.01051	7,100	0.03555	0.15792
10/30/01	MW-6	250	5,327	10/24/01	38,000	0.07927	0.07927	1,400	0.00292	0.00292	4,800	0.01001	0.16793
11/26/01	MW-6	150	5,477	10/24/01	38,000	0.04756	0.04756	1,400	0.00175	0.00175	4,800	0.00601	0.17394
12/17/01	MW-6	300	5,777	10/24/01	38,000	0.09513	0.09513	1,400	0.00350	0.00350	4,800	0.01202	0.18596
01/29/02	MW-6	100	5,877	01/03/02	10,000	0.00834	0.00834	810	0.00068	0.00068	4,100	0.00342	0.18938
02/19/02	MW-6	500	6,377	01/03/02	10,000	0.04172	0.04172	810	0.00338	0.00338	4,100	0.01711	0.20649
03/19/02	MW-6	200	6,577	01/03/02	10,000	0.01669	0.01669	810	0.00135	0.00135	4,100	0.00684	0.21333
04/24/02	MW-6	350	6,927	04/05/02	19,000	0.05549	0.05549	1,100	0.00321	0.00321	4,300	0.01256	0.22589
05/29/02	MW-6	300	7,227	04/05/02	19,000	0.04756	0.04756	1,100	0.00275	0.00275	4,300	0.01076	0.23665
06/26/02	MW-6	700	7,927	04/05/02	19,000	0.11098	0.11098	1,100	0.00643	0.00643	4,300	0.02512	0.26177
07/24/02	MW-6	250	8,177	07/11/02	26,000	0.05424	0.05424	1,100	0.00229	0.00229	5,400	0.01126	0.27303
08/30/02	MW-6	95	8,272	07/11/02	26,000	0.02061	0.02061	1,100	0.00087	0.00087	5,400	0.00428	0.27731
09/26/02	MW-6	250	8,522	07/11/02	26,000	0.05424	0.05424	1,100	0.00229	0.00229	5,400	0.01126	0.28858
10/24/02	MW-6	200	8,722	07/11/02	26,000	0.04339	0.04339	1,100	0.00184	0.00184	5,400	0.00901	0.29759
11/19/02	MW-6	200	8,922	10/28/02	11,000	0.01836	0.01836	230	0.00038	0.00038	2,500	0.00417	0.30176
12/26/02	MW-6	525	9,447	10/28/02	11,000	0.04819	0.04819	230	0.00101	0.00101	2,500	0.01095	0.31271
01/15/03	MW-6	830	10,277	01/10/03	17,000	0.11774	0.11774	840	0.00582	0.00582	3,400	0.02355	0.33626
02/24/03	MW-6	700	10,977	01/10/03	17,000	0.09930	0.09930	840	0.00491	0.00491	3,400	0.01986	0.35612
03/24/03	MW-6	650	11,627	01/10/03	17,000	0.09221	0.09221	840	0.00456	0.00456	3,400	0.01844	0.37456
04/21/03	MW-6	550	12,177	04/14/03	31,000	0.14227	0.14227	810	0.00372	0.00372	3,800	0.01744	0.39200

Table 1: Groundwater Extraction - Mass Removal Data - Shell-branded Service Station, Incident #98996067, 1285 Bancroft Avenue, San Leandro, California

Date Purged	Well ID	Volume Pumped (gal)	Cumulative Volume Pumped (gal)	Date Sampled	TPPH			Benzene			MTBE		
					TPPH Concentration (ppb)	TPPH Removed (pounds)	TPPH Removed To Date (pounds)	Benzene Concentration (ppb)	Benzene Removed (pounds)	Benzene Removed To Date (pounds)	MTBE Concentration (ppb)	MTBE Removed (pounds)	MTBE Removed To Date (pounds)
05/21/03	MW-6	612	12,789	04/14/03	31,000	0.15831	0.15831	810	0.00414	0.00414	3,800	0.01941	0.41141
06/26/03	MW-6	450	13,239	04/14/03	31,000	0.11640	0.11640	810	0.00304	0.00304	3,800	0.01427	0.42568
07/24/03	MW-6	1,200	14,439	07/01/03	1,400	0.01402	0.01402	88	0.00088	0.00088	1,900	0.01903	0.44470
08/22/03	MW-6	150	14,589	07/01/03	1,400	0.00175	0.00175	88	0.00011	0.00011	1,900	0.00238	0.44708
09/25/03	MW-6	251	14,840	07/01/03	1,400	0.00293	0.00293	88	0.00018	0.00018	1,900	0.00398	0.45106
10/28/03	MW-6	236	15,076	10/08/03	26,000	0.05120	0.05120	720	0.00142	0.00142	3,500	0.00689	0.45795
11/26/03	MW-6	127	15,203	10/08/03	26,000	0.02755	0.02755	720	0.00076	0.00076	3,500	0.00371	0.46166
12/11/03	MW-6	150	15,353	10/08/03	26,000	0.03254	0.03254	720	0.00090	0.00090	3,500	0.00438	0.46604
Total Gallons Extracted:		29,895			Total Pounds Removed:		12.35491			0.30801			0.61967
					Total Gallons Removed:		2.02540			0.04219			0.09995

Abbreviations & Notes:

TPPH = Total purgeable hydrocarbons as gasoline

MtBE = Methyl tert-butyl ether

ppb = Parts per billion

gal = Gallon

Mass removed based on the formula: volume extracted (gal) x Concentration (µg/L) x (g/10⁶µg) x (pound/453.6g) x (3.785 L/gal)

Volume removal data based on the formula: density (in gms/cc) x 9.339 (ccxlbs/gmsxgals)

TPPH, benzene and MTBE analyzed by EPA Method 8260

If concentration is less than the laboratory detection limit, one half of the detection limit concentration is used in the mass removal calculation.

Groundwater extracted by vacuum trucks provided by ECI. Water disposed of at a Martinez Refinery.

Table 2: Vapor Extraction - Mass Removal Data - Shell-branded Service Station, Incident #98996067, 1285 Bancroft Avenue, San Leandro, California

Date	Well ID	Interval Hours of Operation (hours)	System Flow Rate (CFM)	Hydrocarbon Concentrations			TPHg		Benzene		MTBE				
				TPHg	Benzene	MTBE	TPHg Removal Rate (#/hour)	Cumulative TPHg Removed (#)	Benzene Removal Rate (#/hour)	Cumulative Benzene Removed (#)	MTBE Removal Rate (#/hour)	Cumulative MTBE Removed (#)			
													(Concentrations in ppmv)		
11/28/00	MW-5	4.00	6.8	2,060	57.4	38.0	0.187	0.749	0.005	0.019	0.004	0.014			
12/19/00	MW-5	2.00	3.8	<2.84	<0.0314	<0.111	0.000	0.749	0.000	0.019	0.000	0.014			
01/23/01	MW-5	4.00	9.5	6,060	11.3	118	0.770	3.828	0.001	0.024	0.015	0.075			
02/16/01	MW-5	4.00	5.0	141	5.0	3.8	0.009	3.865	0.000	0.025	0.000	0.077			
03/22/01	MW-5	4.00	20.7	292	9.1	18.1	0.081	4.189	0.002	0.035	0.005	0.097			
04/23/01	MW-5	4.00	4.1	330	4.4	28.0	0.018	4.261	0.000	0.035	0.002	0.103			
07/16/01	MW-5	4.00	10.8	2,400	3.4	14	0.346	5.647	0.000	0.037	0.002	0.112			
08/23/01	MW-5	4.00	6.9	4,100	8.3	19	0.378	7.160	0.001	0.040	0.002	0.119			
09/10/01	MW-5	4.00	7.2	3,000	5.7	9.4	0.289	8.315	0.000	0.042	0.001	0.122			
10/30/01	MW-5	4.00	10.8	4,300	7.5	13	0.621	10.798	0.001	0.046	0.002	0.130			
11/26/01	MW-5	3.67	9.4	6,800	11	22	0.854	13.934	0.001	0.050	0.003	0.141			
12/17/01	MW-5	4.00	7.6	8,300	15	45	0.843	17.307	0.001	0.056	0.005	0.159			
01/29/02	MW-5	3.00	5.0	710	6.2	41	0.047	17.450	0.000	0.057	0.003	0.168			
02/19/02	MW-5	3.00	6.8	450	2.9	17	0.041	17.572	0.000	0.058	0.002	0.172			
07/24/02	MW-5	3.00	8.2	3,200	5.4	11	0.351	18.625	0.001	0.059	0.001	0.176			
08/30/02	MW-5	3.00	5.0	17	0.14	1.0	0.001	18.628	0.000	0.059	0.000	0.176			
09/26/02	MW-5	3.00	17.7	NA	NA	NA	0.000	18.628	0.000	0.059	0.000	0.176			
10/24/02	MW-5	3.00	9.9	13,000	9.1	26	1.720	23.789	0.001	0.063	0.004	0.187			
11/19/02	MW-5	3.00	9.3	17,000	21	280	2.113	30.130	0.002	0.070	0.036	0.294			
12/26/02	MW-5	3.00	5.4	1,300	3.3	15	0.094	30.411	0.000	0.070	0.001	0.297			
01/15/03	MW-5	3.00	9.2	760	5.8	27	0.093	30.692	0.001	0.072	0.003	0.307			
02/24/03	MW-5	4.00	7.5	1,100	4.9	27	0.110	31.133	0.000	0.074	0.003	0.318			
03/24/03	MW-5	3.00	2.6	586.05	2.92	18.27	0.020	31.194	0.000	0.074	0.001	0.320			
04/21/03	MW-5	2.50	3.7	145.13	8.61	21.82	0.007	31.212	0.000	0.075	0.001	0.323			
05/21/03*	MW-5	3.00	3.5	NA	NA	NA	0.007	31.232	0.000	0.077	0.001	0.326			
06/26/03	MW-5	3.00	7.7	3,906.98	6.15	49.09	0.402	32.439	0.001	0.078	0.005	0.342			

Table 2: Vapor Extraction - Mass Removal Data - Shell-branded Service Station, Incident #98996067, 1285 Bancroft Avenue, San Leandro, California

Date	Well ID	Interval Hours of Operation (hours)	System Flow Rate (CFM)	Hydrocarbon Concentrations (Concentrations in ppmv)			TPHg		Benzene		MTBE	
				TPHg	Benzene	MTBE	TPHg Removal Rate (#/hour)	Cumulative TPHg Removed (#)	Benzene Removal Rate (#/hour)	Cumulative Benzene Removed (#)	MTBE Removal Rate (#/hour)	Cumulative MTBE Removed (#)
07/24/03**	MW-5	2.75	11.2	NA	NA	NA	0.585	34.047	0.001	0.081	0.008	0.362
08/22/03	MW-5	2.75	6.0	6,000	1.6	27	0.481	35.371	0.000	0.081	0.002	0.368
09/25/03	MW-5	3.00	12.8	9,300	6.2	33	1.591	40.145	0.001	0.084	0.006	0.386
10/28/03	MW-5	3.25	11.5	2,000	1.7	31	0.307	41.144	0.000	0.085	0.005	0.402
11/26/03	MW-5	2.00	14.6	75,000	<3.1	640	14.638	70.420	0.000	0.085	0.128	0.657
12/11/03	MW-5	3.00	4.8	8,400	<6.2	43	0.539	72.037	0.000	0.086	0.003	0.666
11/28/00	MW-6	2.00	5.6	278	7.13	18.0	0.021	0.042	0.000	0.001	0.001	0.003
12/19/00	MW-6	4.00	5.1	2.84	0.0314	0.111	0.000	0.042	0.000	0.001	0.000	0.003
01/23/01	MW-6	4.00	7.1	581	13.1	19.0	0.055	0.263	0.001	0.005	0.002	0.010
02/16/01	MW-6	4.00	3.1	3.1	<0.031	<0.28	0.000	0.263	0.000	0.005	0.000	0.010
03/22/01	MW-6	4.00	13.8	647	47	17.8	0.120	0.742	0.008	0.037	0.003	0.024
04/23/01	MW-6	4.00	15.4	130	14	47	0.027	0.849	0.003	0.047	0.010	0.063
07/16/01	MW-6	4.00	12.3	310	8.1	16	0.051	1.053	0.001	0.052	0.003	0.074
08/23/01	MW-6	4.00	9.0	650	8.8	16	0.078	1.366	0.001	0.056	0.002	0.082
09/10/01	MW-6	4.00	8.3	320	3.8	9.8	0.036	1.508	0.000	0.058	0.001	0.086
10/30/01	MW-6	4.00	13.0	520	5.1	6.4	0.090	1.869	0.001	0.061	0.001	0.091
11/26/01	MW-6	4.00	4.1	690	4.8	5.5	0.038	2.020	0.000	0.062	0.000	0.092
12/17/01	MW-6	4.00	12.6	590	4.1	7.2	0.099	2.418	0.001	0.064	0.001	0.097
01/29/02	MW-6	3.00	5.4	51	0.082	0.88	0.004	2.429	0.000	0.064	0.000	0.097
02/19/02	MW-6	3.00	5.9	130	5.1	11	0.010	2.460	0.000	0.065	0.001	0.100
03/19/02	MW-6	6.00	6.3	5.6	<0.050	0.14	0.000	2.463	0.000	0.065	0.000	0.100
04/24/02	MW-6	6.00	7.3	76	3.9	9.3	0.007	2.507	0.000	0.068	0.001	0.106
05/29/02	MW-6	10.50	6.1	67	2.9	7.0	0.005	2.564	0.000	0.070	0.001	0.112
06/26/02	MW-6	7.00	9.8	190	4.4	10	0.025	2.739	0.001	0.073	0.001	0.121
07/24/02	MW-6	3.00	9.2	11	0.10	<0.10	0.001	2.743	0.000	0.073	0.000	0.121

Table 2: Vapor Extraction - Mass Removal Data - Shell-branded Service Station, Incident #98996067, 1285 Bancroft Avenue, San Leandro, California

Date	Well ID	Interval Hours of Operation (hours)	System Flow Rate (CFM)	Hydrocarbon Concentrations			TPHg		Benzene		MTBE	
				TPHg	Benzene	MTBE	TPHg Removal Rate (#/hour)	Cumulative TPHg Removed (#)	Benzene Removal Rate (#/hour)	Cumulative Benzene Removed (#)	MTBE Removal Rate (#/hour)	Cumulative MTBE Removed (#)
				(Concentrations in ppmv)								
08/30/02	MW-6	3.00	10.1	280	3.1	5.5	0.038	2.856	0.000	0.075	0.001	0.123
09/26/02	MW-6	3.00	17.7	NA	NA	NA	0.000	2.856	0.000	0.075	0.000	0.123
10/24/02	MW-6	5.00	12.9	1,000	3.3	4.7	0.172	3.718	0.001	0.077	0.001	0.128
11/19/02	MW-6	3.00	8.8	3,300	6.6	98	0.388	4.883	0.001	0.079	0.012	0.163
12/26/02	MW-6	3.00	6.8	160	5.0	10	0.015	4.927	0.000	0.081	0.001	0.166
01/15/03	MW-6	3.25	9.3	170	10	19	0.021	4.995	0.001	0.084	0.002	0.174
02/24/03	MW-6	3.50	15.8	210	8.1	20	0.044	5.151	0.002	0.090	0.004	0.189
03/24/03	MW-6	3.00	6.6	NA	NA	NA	0.000	5.151	0.000	0.090	0.000	0.189
04/21/03	MW-6	3.00	4.0	1,535	7	41	0.082	5.397	0.000	0.091	0.002	0.195
05/21/03*	MW-6	3.00	3.5	NA	NA	NA	0.072	5.612	0.000	0.092	0.002	0.201
06/26/03	MW-6	3.00	8.4	256.74	5.23	21.55	0.029	5.699	0.001	0.093	0.002	0.209
07/24/03**	MW-6	2.50	13.8	NA	NA	NA	0.047	5.817	0.001	0.095	0.004	0.219
08/22/03	MW-6	3.33	8.3	460	2.3	4.7	0.051	5.987	0.000	0.096	0.001	0.221
09/25/03	MW-6	3.00	12.7	480	1.8	3.0	0.081	6.232	0.000	0.097	0.001	0.222
10/28/03	MW-6	3.00	14.3	990	1.9	1.0	0.189	6.799	0.000	0.098	0.000	0.223
11/26/03	MW-6	2.00	14.3	8,800	41	66	14.337	35.473	0.001	0.099	0.125	0.473
12/11/03	MW-6	3.00	12.0	1,100	2.6	3.8	0.176	36.003	0.000	0.100	0.001	0.475
Total Pounds Removed:							TPHg =	108.039	Benzene =	0.186	MTBE =	1.141

Abbreviations and Notes:

CFM = Cubic feet per minute

TPHg = Total petroleum hydrocarbons as gasoline (C6-C12) by modified EPA Method 8015 in 1 liter tedlar bag samples

ppmv = Parts per million by volume

= Pounds

TPHG, Benzene, and MTBE analyzed by EPA Method 8260 in 1 liter tedlar bag samples

Table 2: Vapor Extraction - Mass Removal Data - Shell-branded Service Station, Incident #98996067, 1285 Bancroft Avenue, San Leandro, California

Date	Well ID	Interval Operation (hours)	System Flow Rate (CFM)	Hydrocarbon Concentrations			TPHg		Benzene		MTBE	
				TPHg	Benzene	MTBE	TPHg Removal Rate (#/hour)	Cumulative TPHg Removed (#)	Benzene Removal Rate (#/hour)	Cumulative Benzene Removed (#)	MTBE Removal Rate (#/hour)	Cumulative MTBE Removed (#)

TPHg / Benzene / MTBE removal rate = Rate based on Bay Area Air Quality Management District's Manual of Procedures for Soil Vapor Extraction dated July 17, 1991.

(Rate = Concentration (ppmv) x system flow rate (cfm) x (1lb-mole/386ft3) x molecular weight (86 lb/lb-mole for TPHg, 78 lb/lb-mole for benzene, 88 lb/lb-mole for MTBE) x 60 min/hour x 1/1,000,000)

Cumulative TPHg / Benzene / MTBE removal = Previous removal rate multiplied by the hour-interval of operation plus the previous total

If concentration is less than the laboratory detection limit, one half of the detection limit concentration is used in the mass removal calculation.

* = Calculated mass removal is estimated from 04/21/03 lab data.

** = Calculated mass removal is estimated from 06/26/03 lab data.

ATTACHMENT A
Blaine Groundwater Monitoring Report
and Field Notes

BLAINE
TECH SERVICES, INC.



1680 ROGERS AVENUE
SAN JOSE, CA 95112-1105
(408) 573-7771 FAX
(408) 573-0555 PHONE
CONTRACTOR'S LICENSE #746684
www.blainetech.com

November 12, 2003

Karen Petryna
Shell Oil Products US
P.O. Box 7869
Burbank, CA 91510-7869

Fourth Quarter 2003 Groundwater Monitoring at
Shell-branded Service Station
1285 Bancroft Avenue
San Leandro, CA

Monitoring performed on October 8, 2003

Groundwater Monitoring Report **031008-BA-1**

This report covers the routine monitoring of groundwater wells at this Shell-branded facility. In accordance with standard procedures that conform to Regional Water Quality Control Board requirements, routine field data collection includes depth to water, total well depth, thickness of any separate immiscible layer, water column volume, calculated purge volume (if applicable), elapsed evacuation time (if applicable), total volume of water removed (if applicable), and standard water parameter instrument readings. Sample material is collected, contained, stored, and transported to the laboratory in conformance with EPA standards. Purgewater (if applicable) is, likewise, collected and transported to the Martinez Refining Company.

Basic field information is presented alongside analytical values excerpted from the laboratory report in the cumulative table of **WELL CONCENTRATIONS**. The full analytical report for the most recent samples and the field data sheets are attached to this report.

At a minimum, Blaine Tech Services, Inc. field personnel are certified on completion of a forty-hour Hazardous Materials and Emergency Response training course per 29 CFR 1910.120. Field personnel are also enrolled in annual eight-hour refresher courses.

Blaine Tech Services, Inc. conducts sampling and documentation assignments of this type as an independent third party. Our activities at this site consisted of objective data and sample collection only. No interpretation of analytical results, defining of hydrological conditions or formulation of recommendations was performed.

Please call if you have any questions.

Yours truly,

Leon Gearhart
Project Coordinator

LG/jt

attachments: Cumulative Table of WELL CONCENTRATIONS
Certified Analytical Report
Field Data Sheets

cc: Anni Kreml
Cambria Environmental Technology, Inc.
5900 Hollis Street, Suite A
Oakland, CA 94608

WELL CONCENTRATIONS
Shell-branded Service Station
1285 Bancroft Avenue
San Leandro, CA

Well ID	Date	TPPH (ug/L)	TEPH (ug/L)	B (ug/L)	T (ug/L)	E (ug/L)	X (ug/L)	MTBE 8020 (ug/L)	MTBE 8260 (ug/L)	TOC (MSL)	Depth to Water (ft)	GW Elevation (MSL)	DO Reading (ppm)
MW-1	03/13/1990	NA	NA	NA	NA	NA	NA	NA	NA	66.29	42.65	23.64	NA
MW-1	06/12/1990	NA	NA	NA	NA	NA	NA	NA	NA	66.29	43.14	23.15	NA
MW-1	09/13/1990	NA	NA	NA	NA	NA	NA	NA	NA	66.29	44.71	21.58	NA
MW-1	12/18/1990	NA	NA	NA	NA	NA	NA	NA	NA	66.29	45.23	21.06	NA
MW-1	03/07/1991	NA	NA	NA	NA	NA	NA	NA	NA	66.29	43.32	22.97	NA
MW-1	06/07/1991	NA	NA	NA	NA	NA	NA	NA	NA	66.29	42.18	24.11	NA
MW-1	09/17/1991	50a	160a	<0.5	<0.5	<0.5	<0.5	NA	NA	66.29	44.85	21.44	NA
MW-1	03/01/1992	<50	<50	<0.5	<0.5	<0.5	<0.5	NA	NA	66.29	41.56	24.73	NA
MW-1	06/03/1992	<50	NA	0.8	<0.5	0.9	<0.5	NA	NA	66.29	40.74	25.55	NA
MW-1	09/01/1992	<50	NA	<0.5	5.8	5.3	7.2	NA	NA	66.29	43.05	23.24	NA
MW-1	12/07/1992	68	NA	<0.5	0.8	<0.5	1.2	NA	NA	66.29	44.19	22.10	NA
MW-1	03/01/1993	<50	NA	<0.5	<0.5	<0.5	<0.5	NA	NA	66.29	34.96	31.33	NA
MW-1 (D)	03/01/1993	<50	NA	<0.5	<0.5	<0.5	<0.5	NA	NA	66.29	34.96	31.33	NA
MW-1	06/22/1993	<50	NA	<0.5	<0.5	<0.5	<0.5	NA	NA	66.29	36.75	29.54	NA
MW-1	09/09/1993	200a	NA	16	5.2	2	<0.5	NA	NA	66.29	39.36	26.93	NA
MW-1	12/13/1993	89a	NA	3.4	<0.5	<0.5	<0.5	NA	NA	66.29	40.74	25.55	NA
MW-1	03/03/1994	65a	NA	2.6	<0.5	<0.5	<0.5	NA	NA	66.29	38.40	27.89	NA
MW-1	07/27/1994	180	NA	30	1.8	2.6	5	NA	NA	66.90	40.49	26.41	NA
MW-1 (D)	07/27/1994	240	NA	25	2.2	2.2	4	NA	NA	66.90	40.49	26.41	NA
MW-1	08/09/1994	NA	NA	NA	NA	NA	NA	NA	NA	66.90	40.84	26.06	NA
MW-1	10/05/1994	<50	NA	<0.3	<0.3	<0.3	<0.6	NA	NA	66.90	41.98	24.92	NA
MW-1	11/11/1994	NA	NA	NA	NA	NA	NA	NA	NA	66.90	41.34	25.56	NA
MW-1	12/29/1994	NA	NA	NA	NA	NA	NA	NA	NA	66.90	42.06	24.84	NA
MW-1	01/04/1995	<50	NA	2.4	<0.5	<0.5	<0.5	NA	NA	66.90	39.90	27.00	NA
MW-1 (D)	01/04/1995	<50	NA	2.5	<0.5	<0.5	<0.5	NA	NA	66.90	39.90	27.00	NA
MW-1	04/14/1995	<50	NA	<0.5	0.5	<0.5	<0.5	NA	NA	66.90	31.02	35.88	NA
MW-1 (D)	04/14/1995	<50	NA	<0.5	<0.5	<0.5	<0.5	NA	NA	66.90	31.02	35.88	NA

WELL CONCENTRATIONS
Shell-branded Service Station
1285 Bancroft Avenue
San Leandro, CA

Well ID	Date	TPPH (ug/L)	TEPH (ug/L)	B (ug/L)	T (ug/L)	E (ug/L)	X (ug/L)	MTBE 8020 (ug/L)	MTBE 8260 (ug/L)	TOC (MSL)	Depth to Water (ft)	GW Elevation (MSL)	DO Reading (ppm)
MW-1	07/12/1995	<50	NA	1.2	0.8	<0.5	<0.5	NA	NA	66.90	34.61	32.29	NA
MW-1	12/14/1995	380	NA	230	9	1.1	49	NA	NA	66.90	39.24	27.66	NA
MW-1	01/10/1996	60	NA	3.5	<0.5	<0.5	0.5	NA	NA	66.90	38.34	28.56	NA
MW-1	04/25/1996	<50	NA	3.3	2.4	1.2	5.4	NA	NA	66.90	31.95	34.95	NA
MW-1	07/09/1996	810	NA	29	7.3	<5.0	11	1,800	NA	66.90	34.45	32.45	NA
MW-1	10/02/1996	<125	NA	3.1	<1.2	<1.2	<1.2	960	NA	66.90	37.72	29.18	NA
MW-1	01/09/1997	<250	NA	<2.5	<2.5	<2.5	<2.5	510	NA	66.90	32.25	34.65	NA
MW-1	04/09/1997	<50	NA	<0.5	<0.5	<0.5	<0.5	130	NA	66.90	32.90	34.00	NA
MW-1	07/02/1997	<250	NA	60	7.6	4.2	18	1,300	NA	66.90	36.65	30.25	NA
MW-1	10/24/1997	<500	NA	140	<5.0	12	40	2,600	NA	66.90	39.75	27.15	4.5
MW-1	01/08/1998	<50	NA	<0.50	<0.50	<0.50	<0.50	170	NA	66.90	36.31	30.59	4.0
MW-1	04/14/1998 b	72	NA	0.82	4.9	1.8	13	2.7	NA	66.90	26.37	40.53	2.2
MW-1	07/15/1998	<50	NA	2.5	1.5	<0.50	<0.50	12	NA	66.90	31.23	35.67	2.4
MW-1	10/13/1998	<50	NA	3.2	0.69	<0.50	1.1	29	NA	66.90	35.69	31.21	1.3
MW-1	01/22/1999	567	NA	79.7	120	21.4	99.9	193	190	66.90	35.32	31.58	1.2
MW-1	04/16/1999	<50	NA	0.69	1.1	1.2	<0.50	8.2	NA	66.90	31.76	35.14	1.0
MW-1	07/22/1999	<50	NA	<0.500	<0.500	<0.500	<0.500	<5.00	2.17	66.90	23.21	43.69	2.1/2.0
MW-1	12/08/1999	<50.0	NA	<0.500	<0.500	<0.500	<0.500	<5.00	NA	66.90	33.27	33.63	2.2/2.1
MW-1	01/07/2000	<50.0	NA	0.631	0.577	<0.500	1.25	14.1	NA	66.90	38.17	28.73	d
MW-1	04/05/2000	153	NA	12.4	21.2	6.65	28.3	50.1	NA	66.90	30.45	36.45	2.0/2.3
MW-1	07/12/2000	<50.0	NA	<0.500	<0.500	<0.500	<0.500	<2.50	NA	66.90	34.29	32.61	4.4/3.8
MW-1	10/19/2000	129	NA	7.76	19.6	7.84	33.3	31.3	NA	66.90	36.87	30.03	3.9/4.7
MW-1	01/15/2001	201	NA	7.58	29.9	9.64	42.9	24.9	NA	66.90	36.99	29.91	2.7/3.0
MW-1	04/30/2001	<50	NA	<0.50	<0.50	<0.50	0.54	NA	<5.0	66.90	34.62	32.28	3.1/2.4
MW-1	07/20/2001	180	NA	8.0	16	9.5	39	NA	140	66.90	37.25	29.65	3.9/3.8
MW-1	10/24/2001	94	NA	7.0	0.90	3.4	8.4	NA	34	66.90	38.82	28.08	3.6/3.9
MW-1	01/03/2002	<50	NA	<0.50	0.78	<0.50	1.5	NA	<5.0	66.90	34.97	31.93	3.1/3.3
MW-1	04/05/2002	<50	NA	<0.50	<0.50	<0.50	<0.50	NA	<5.0	66.90	34.04	32.86	1.6/1.8

WELL CONCENTRATIONS
Shell-branded Service Station
1285 Bancroft Avenue
San Leandro, CA

Well ID	Date	TPPH (ug/L)	TEPH (ug/L)	B (ug/L)	T (ug/L)	E (ug/L)	X (ug/L)	MTBE 8020 (ug/L)	MTBE 8260 (ug/L)	TOC (MSL)	Depth to Water (ft)	GW Elevation (MSL)	DO Reading (ppm)
---------	------	----------------	----------------	-------------	-------------	-------------	-------------	------------------------	------------------------	--------------	---------------------------	--------------------------	------------------------

MW-1	07/11/2002	61	NA	2.2	2.6	3.9	14	NA	28	66.90	36.15	30.75	0.6/3.8
MW-1	10/28/2002	270	NA	7.9	3.6	17	51	NA	72	66.33	38.35	27.98	1.0/1.2
MW-1	01/07/2003	<50	NA	<0.50	<0.50	<0.50	0.53	NA	<5.0	66.33	34.13	32.20	3.8/3.9
MW-1	04/14/2003	<50	NA	0.51	0.52	1.0	2.9	NA	21	66.33	35.40	30.93	3.4/3.5
MW-1	07/01/2003	<50	NA	<0.50	<0.50	1.1	2.5	NA	4.1	66.33	35.19	31.14	0.4/0.7
MW-1	10/08/2003	<50	NA	<0.50	<0.50	<0.50	<1.0	NA	<0.50	66.33	38.63	27.70	2.9/2.9

MW-2	03/01/1992	910	<50	11	5.2	50	140	NA	NA	66.91	41.57	25.34	NA
MW-2	06/03/1992	1,400	NA	33	16	150	240	NA	NA	66.91	40.56	26.35	NA
MW-2	09/01/1992	230	NA	5.2	4.1	15	19	NA	NA	66.91	42.94	23.97	NA
MW-2 (D)	09/01/1992	320	NA	5.6	5	18	220	NA	NA	66.91	42.94	23.97	NA
MW-2	12/07/1992	240	NA	1.5	1.3	9.5	9.9	NA	NA	66.91	44.13	22.78	NA
MW-2 (D)	12/07/1992	<50	NA	1.7	1	13	12	NA	NA	66.91	44.13	22.78	NA
MW-2	03/01/1993	230	NA	260	310	27	66	NA	NA	66.91	34.82	32.09	NA
MW-2	06/22/1993	220	NA	18	3.4	3.6	5.2	NA	NA	66.91	36.64	30.27	NA
MW-2 (D)	06/22/1993	320	NA	29	4.8	4.2	6.1	NA	NA	66.91	36.64	30.27	NA
MW-2	09/09/1993	260	NA	18	4.6	16	12	NA	NA	66.91	39.24	27.67	NA
MW-2 (D)	09/09/1993	210	NA	16	3.9	14	9.1	NA	NA	66.91	39.24	27.67	NA
MW-2	12/13/1993	1,300a	NA	82	34	73	15	NA	NA	66.91	40.64	26.27	NA
MW-2 (D)	12/13/1993	1,400a	NA	110	45	72	19	NA	NA	66.91	40.64	26.27	NA
MW-2	03/03/1994	9,600	NA	1,200	600	390	710	NA	NA	66.91	38.98	27.93	NA
MW-2 (D)	03/03/1994	10,000	NA	930	500	330	590	NA	NA	66.91	38.98	27.93	NA
MW-2	07/27/1994	190	NA	<0.5	1	<0.5	<0.5	NA	NA	66.91	40.40	26.51	NA
MW-2	08/09/1994	1,500	NA	53.5	12.4	46.2	44	NA	NA	66.91	40.71	26.20	NA
MW-2	10/05/1994	<485	NA	<0.3	<0.3	<0.3	<0.6	NA	NA	66.91	41.89	25.02	NA
MW-2	11/11/1994	NA	NA	NA	NA	NA	NA	NA	NA	66.91	41.22	25.69	NA
MW-2	12/29/1994	NA	NA	NA	NA	NA	NA	NA	NA	66.91	41.99	24.92	NA

WELL CONCENTRATIONS
Shell-branded Service Station
1285 Bancroft Avenue
San Leandro, CA

Well ID	Date	TPPH (ug/L)	TEPH (ug/L)	B (ug/L)	T (ug/L)	E (ug/L)	X (ug/L)	MTBE 8020 (ug/L)	MTBE 8260 (ug/L)	TOC (MSL)	Depth to Water (ft)	GW Elevation (MSL)	DO Reading (ppm)
MW-2	01/04/1995	1,300	NA	150	35	23	51	NA	NA	66.91	39.81	27.10	NA
MW-2	04/14/1995	5,000	NA	1,000	340	400	810	NA	NA	66.91	30.83	36.08	NA
MW-2	07/12/1995	4,500	NA	440	170	170	290	NA	NA	66.91	34.50	32.41	NA
MW-2 (D)	07/12/1995	4,300	NA	430	160	160	280	NA	NA	66.91	34.50	32.41	NA
MW-2	12/14/1995	37,000	NA	1,800	7,600	1,000	6,700	NA	NA	66.91	39.22	27.69	NA
MW-2 (D)	12/14/1995	34,000	NA	1,800	6,600	1,000	6,500	NA	NA	66.91	39.22	27.69	NA
MW-2	01/10/1996	69,000	NA	1,000	3,200	510	3,300	NA	NA	66.91	38.22	28.69	NA
MW-2 (D)	01/10/1996	78,000	NA	1,100	3,500	560	3,600	NA	NA	66.91	38.22	28.69	NA
MW-2	04/25/1996	11,000	NA	820	880	210	1,400	NA	NA	66.91	31.78	35.13	NA
MW-2 (D)	04/25/1996	9,300	NA	690	710	160	1,200	NA	NA	66.91	31.78	35.13	NA
MW-2	07/09/1996	100,000	NA	15,000	24,000	1,700	9,900	70,000	NA	66.91	34.35	32.56	NA
MW-2 (D)	07/09/1996	86,000	NA	12,000	19,000	1,400	7,500	32,000	NA	66.91	34.35	32.56	NA
MW-2	10/02/1996	82,000	NA	20,000	32,000	1,800	9,100	40,000	NA	66.91	37.56	29.35	NA
MW-2 (D)	10/02/1996	89,000	NA	19,000	31,000	1,700	8,900	42,000	NA	66.91	37.56	29.35	NA
MW-2	01/09/1997	17,000	NA	710	2,300	350	2,200	4,000	NA	66.91	32.07	34.84	NA
MW-2 (D)	01/09/1997	12,000	NA	490	1,300	260	1,800	2,800	NA	66.91	32.07	34.84	NA
MW-2	04/09/1997	20,000	NA	970	3,500	330	2,000	3,200	NA	66.91	32.78	34.13	NA
MW-2	07/02/1997	28,000	NA	1,700	8,700	550	3,000	5,500	NA	66.91	36.56	30.35	NA
MW-2 (D)	07/02/1997	32,000	NA	2,000	11,000	680	3,800	6,400	NA	66.91	36.56	30.35	NA
MW-2	10/24/1997	14,000	NA	460	1,000	300	2,000	3,000	NA	66.91	39.74	27.17	3.2
MW-2 (D)	10/24/1997	14,000	NA	420	980	270	2,000	2,800	NA	66.91	39.74	27.17	3.2
MW-2	01/08/1998	180	NA	2.8	1.6	<0.50	<0.50	7.6	NA	66.91	36.13	30.78	3.6
MW-2	04/14/1998 b	12,000	NA	92	1,500	260	1,900	110	NA	66.91	26.15	40.76	4.6
MW-2	07/15/1998	36,000	NA	250	5,600	830	6,000	6,800	NA	66.91	31.14	35.77	4.8
MW-2 (D)	07/15/1998	35,000	NA	230	5,600	860	600	570	NA	66.91	31.14	35.77	4.8
MW-2	10/13/1998	100	NA	7	12	3.7	10	5.8	NA	66.91	36.14	30.77	0.8
MW-2	01/22/1999	21,000	NA	701	3,330	960	5,420	772	620	66.91	35.97	30.94	1.0

WELL CONCENTRATIONS
Shell-branded Service Station
1285 Bancroft Avenue
San Leandro, CA

Well ID	Date	TPPH (ug/L)	TEPH (ug/L)	B (ug/L)	T (ug/L)	E (ug/L)	X (ug/L)	MTBE 8020 (ug/L)	MTBE 8260 (ug/L)	TOC (MSL)	Depth to Water (ft)	GW Elevation (MSL)	DO Reading (ppm)
---------	------	----------------	----------------	-------------	-------------	-------------	-------------	------------------------	------------------------	--------------	---------------------------	--------------------------	------------------------

MW-2	04/16/1999	14,000	NA	200	1,600	560	3,300	330	NA	66.91	31.52	35.39	1.0
MW-2	07/22/1999	1,410	NA	28.3	91.2	50.4	256	35.3	15.2	66.91	26.14	40.77	2.1/2.5
MW-2	12/08/1999	<50.0	NA	1.45	1.34	1.15	5.31	5.08	NA	66.91	37.72	29.19	2.1/2.5
MW-2	01/07/2000	743	NA	18.6	47.0	3.06	166	30.3	NA	66.91	38.14	28.77	1.4/1.8
MW-2	04/05/2000	2,320	NA	60.9	101	115	606	62.5	NA	66.91	30.46	36.45	1.7/1.9
MW-2	07/12/2000	12,100	NA	325	555	793	3,610	260	NA	66.91	34.13	32.78	4.1/4.6
MW-2	10/19/2000	4,840	NA	188	267	318	1,370	84.4	NA	66.91	36.50	30.41	4.8/2.6
MW-2	01/15/2001	654	NA	52.3	9.10	37.8	93.6	10.9	NA	66.91	36.73	30.18	4.2/3.5
MW-2	04/30/2001	<50	NA	<0.50	<0.50	<0.50	<0.50	NA	<5.0	66.91	35.25	31.66	2.4/2.0
MW-2	07/20/2001	5,400	NA	320	110	340	1,100	NA	33	66.91	37.00	29.91	3.4/2.4
MW-2	10/24/2001 g	NA	NA	NA	NA	NA	NA	NA	NA	66.91	38.63	28.28	NA
MW-2	10/31/2001	1,400	NA	81	16	76	180	NA	29	66.91	38.71	28.20	3.8/2.9
MW-2	01/03/2002	1,800	NA	88	62	130	520	NA	17	66.91	34.71	32.20	3.0/2.1
MW-2	04/05/2002	9,400	NA	190	120	410	1,800	NA	<50	66.91	33.86	33.05	1.3/1.8
MW-2	07/11/2002	6,700	NA	220	73	360	1,100	NA	<20	66.91	35.99	30.92	3.4/2.1
MW-2	10/28/2002	4,600	NA	190	25	210	370	NA	21	66.33	38.05	28.28	0.7/0.9
MW-2	01/07/2003	1,700	NA	9.3	14	83	380	NA	<5.0	66.33	34.22	32.11	3.9/3.6
MW-2	04/14/2003	5,900	NA	86	53	360	1,500	NA	<50	66.33	35.28	31.05	3.0/2.9
MW-2	07/01/2003	2,200	NA	34	24	130	510	NA	3.3	66.33	35.13	31.20	0.9/1.1
MW-2	10/08/2003	4,000	NA	160	28	220	530	NA	<10	66.33	38.59	27.74	2.9/0.5

MW-3	03/01/1992	<50	<50	<0.5	<0.5	<0.5	<0.5	NA	NA	66.31	42.00	24.31	NA
MW-3	06/03/1992	<50	NA	<0.5	<0.5	<0.5	<0.5	NA	NA	66.31	44.30	22.01	NA
MW-3	09/01/1992	<50	NA	<0.5	<0.5	1.1	3.2	NA	NA	66.31	43.62	22.69	NA
MW-3	12/07/1992	52	NA	<0.5	<0.5	<0.5	0.5	NA	NA	66.31	44.77	21.54	NA
MW-3	03/01/1993	<50	NA	<0.5	<0.5	<0.5	<0.5	NA	NA	66.31	35.50	30.81	NA
MW-3	06/22/1993	<50	NA	<0.5	<0.5	<0.5	<0.5	NA	NA	66.31	37.30	29.01	NA

WELL CONCENTRATIONS
Shell-branded Service Station
1285 Bancroft Avenue
San Leandro, CA

Well ID	Date	TPPH (ug/L)	TEPH (ug/L)	B (ug/L)	T (ug/L)	E (ug/L)	X (ug/L)	MTBE 8020 (ug/L)	MTBE 8260 (ug/L)	TOC (MSL)	Depth to Water (ft.)	GW Elevation (MSL)	DO Reading (ppm)
MW-3	09/09/1993	50a	NA	5	<0.5	<0.5	<0.5	NA	NA	66.31	39.90	26.41	NA
MW-3	12/13/1993	120a	NA	7.5	<0.5	1.6	6.3	NA	NA	66.31	41.30	25.01	NA
MW-3	03/03/1994	<50	NA	0.81	<0.5	<0.5	<0.5	NA	NA	66.31	38.32	27.99	NA
MW-3	07/27/1994	<50	NA	3.5	<0.5	<0.5	<0.5	NA	NA	67.52	41.07	26.45	NA
MW-3	08/09/1994	NA	NA	NA	NA	NA	NA	NA	NA	67.52	41.37	26.15	NA
MW-3	10/05/1994	<57	NA	<0.3	<0.3	<0.3	<0.6	NA	NA	67.52	42.55	24.97	NA
MW-3	11/11/1994	NA	NA	NA	NA	NA	NA	NA	NA	67.52	41.86	25.66	NA
MW-3	12/29/1994	NA	NA	NA	NA	NA	NA	NA	NA	67.52	42.59	24.93	NA
MW-3	01/04/1995	<50	NA	6	<0.5	<0.5	<0.5	NA	NA	67.52	40.54	26.98	NA
MW-3	04/14/1995	<50	NA	<0.5	<0.5	<0.5	<0.5	NA	NA	67.52	31.50	36.02	NA
MW-3	07/12/1995	90	NA	16	<0.5	<0.5	<0.5	NA	NA	67.52	35.14	32.38	NA
MW-3	12/14/1995	4,600	NA	460	390	34	1,000	NA	NA	67.52	39.86	27.66	NA
MW-3	01/10/1996	11,000	NA	470	460	68	670	NA	NA	67.52	39.98	27.54	NA
MW-3	04/25/1996	5,500	NA	830	910	<50	460	NA	NA	67.52	32.38	35.14	NA
MW-3	07/09/1996	72,000	NA	7,600	14,000	970	5,900	59,000	NA	67.52	34.93	32.59	NA
MW-3	10/02/1996	77,000	NA	15,000	24,000	2,000	9,600	94,000	71,000	67.52	38.20	29.32	NA
MW-3	01/09/1997	130	NA	15	16	2	9.7	80	NA	67.52	32.81	34.71	NA
MW-3	04/09/1997	24,000	NA	2,900	5,300	420	2,200	4,100	NA	67.52	33.42	34.10	NA
MW-3 (D)	04/09/1997	24,000	NA	3,000	5,600	450	2,300	4,700	NA	67.52	33.42	34.10	NA
MW-3	07/02/1997	68,000	NA	7,400	18,000	1,600	8,700	16,000	NA	67.52	37.22	30.30	NA
MW-3	10/24/1997	93,000	NA	1,800	8,500	2,300	14,000	3,100	NA	67.52	40.75	26.77	1.8
MW-3	01/08/1998	16,000	NA	140	870	22	5,000	120	NA	67.52	36.90	30.62	2.1
MW-3 (D)	01/08/1998	24,000	NA	100	840	26	5,600	<100	NA	67.52	36.90	30.62	2.1
MW-3	04/14/1998 b	100,000	NA	270	5,000	2,100	17,000	890	NA	67.52	26.92	40.60	1.8
MW-3 (D)	04/14/1998 b	49,000	NA	230	3,200	1,200	8,900	790	NA	67.52	26.92	40.60	1.8
MW-3	07/15/1998	31,000	NA	1,100	3,300	300	2,800	3,700	NA	67.52	31.74	35.78	2
MW-3	10/13/1998	51,000	NA	3,100	12,000	7,630	6,800	6,200	NA	67.52	35.61	31.91	2.1

WELL CONCENTRATIONS
Shell-branded Service Station
1285 Bancroft Avenue
San Leandro, CA

Well ID	Date	TPPH (ug/L)	TEPH (ug/L)	B (ug/L)	T (ug/L)	E (ug/L)	X (ug/L)	MTBE 8020 (ug/L)	MTBE 8260 (ug/L)	TOC (MSL)	Depth to Water (ft.)	GW Elevation (MSL)	DO Reading (ppm)
MW-3 (D)	10/13/1998	88,000	NA	5,800	21,000	1,400	12,000	9200	NA	67.52	35.61	31.91	2.1
MW-3	01/22/1999	25,100	NA	855	4,400	786	5,260	1,850	1,500	67.52	35.29	32.23	0.8
MW-3	04/16/1999	7,800	NA	150	550	160	1,100	370	NA	67.52	32.29	35.23	1.0
MW-3	07/22/1999	1,970	NA	51.2	160	43.1	286	179	109	67.52	26.67	40.85	3.1/3.0
MW-3	12/08/1999	12,500	NA	171	537	141	1,260	717	NA	67.52	38.34	29.18	3.1/2.9
MW-3	01/07/2000	6,020	NA	<10.0	929	177	1,170	217	NA	67.52	38.87	28.65	3.2/2.6
MW-3	04/05/2000	3,890	NA	120	351	67.8	576	231	NA	67.52	31.08	36.44	3.4/3.8
MW-3	07/12/2000	23,300	NA	592	4,690	672	4,620	1,340	NA	67.52	34.80	32.72	0.4/3.7
MW-3	10/19/2000	6,280	NA	124	1,280	229	1,510	311	NA	67.52	37.34	30.18	2.1/2.9
MW-3	01/15/2001	4,800	NA	7.04	70.0	70.9	380	54.7	NA	67.52	37.65	29.87	2.7/2.5
MW-3	04/30/2001	<50	NA	<0.50	<0.50	<0.50	1.8	NA	<5.0	67.52	35.25	32.27	1.8/1.6
MW-3	07/20/2001	2,900	NA	11	100	120	520	NA	48	67.52	37.71	29.81	1.2/3.4
MW-3	10/24/2001 g	NA	NA	NA	NA	NA	NA	NA	NA	67.52	39.35	28.17	0.5
MW-3	10/31/2001	1,700	NA	4.5	43	43	230	NA	17	67.52	39.30	28.22	0.8/3.0
MW-3	01/03/2002	12,000	NA	26	410	490	2,800	NA	99	67.52	35.51	32.01	1.4/1.2
MW-3	04/05/2002	22,000	NA	76	930	710	4,500	NA	390	67.52	34.56	32.96	1.7/1.9
MW-3	07/11/2002	13,000	NA	23	340	320	1,800	NA	120	67.52	36.65	30.87	1.0/2.2
MW-3	10/28/2002	1,500	NA	<0.50	2.6	13	83	NA	45	66.93	38.85	28.08	1.2/1.1
MW-3	01/07/2003	5,500	NA	8.3	150	130	1,000	NA	130	66.93	34.64	32.29	3.2/3.1
MW-3	04/14/2003	14,000	NA	23	250	470	3,200	NA	330	66.93	35.90	31.03	1.6/2.1
MW-3	07/01/2003	12,000	NA	19	100	440	2,700	NA	250	66.93	35.70	31.23	0.9/1.0
MW-3	10/08/2003	300	NA	<0.50	0.84	3.0	16	NA	3.7	66.93	39.25	27.68	0.4/2.6
MW-4	07/27/1994	120	NA	3.4	3.9	0.6	4.9	NA	NA	68.08	41.78	26.30	NA
MW-4	08/09/1994	NA	NA	NA	NA	NA	NA	NA	NA	68.08	42.09	25.99	NA
MW-4	10/05/1994	<50	NA	<0.3	<0.3	<0.3	<0.6	NA	NA	68.08	43.25	24.83	NA
MW-4 (D)	10/05/1994	<50	NA	<0.3	<0.3	<0.3	<0.6	NA	NA	68.08	43.25	24.83	NA

WELL CONCENTRATIONS
Shell-branded Service Station
1285 Bancroft Avenue
San Leandro, CA

Well ID	Date	TPPH (ug/L)	TEPH (ug/L)	B (ug/L)	T (ug/L)	E (ug/L)	X (ug/L)	MTBE 8020 (ug/L)	MTBE 8260 (ug/L)	TOC (MSL)	Depth to Water (ft)	GW Elevation (MSL)	DO Reading (ppm)
MW-4	11/11/1994	NA	NA	NA	NA	NA	NA	NA	NA	68.08	42.54	25.54	NA
MW-4	12/29/1994	NA	NA	NA	NA	NA	NA	NA	NA	68.08	43.34	24.74	NA
MW-4	01/04/1995	<50	NA	1.4	<0.5	<0.5	<0.5	NA	NA	68.08	41.57	26.51	NA
MW-4	04/14/1995	<50	NA	<0.5	<0.5	<0.5	<0.5	NA	NA	68.08	32.24	35.84	NA
MW-4	07/12/1995	<50	NA	<0.5	<0.5	<0.5	<0.5	NA	NA	68.08	35.88	32.20	NA
MW-4	12/14/1995	70	NA	0.6	<0.5	<0.5	<0.5	NA	NA	68.08	40.54	27.54	NA
MW-4	01/10/1996	280	NA	3.7	1	<0.5	0.8	NA	NA	68.08	39.59	28.49	NA
MW-4	04/25/1996	<500	NA	63	<5.0	<5.0	<5.0	NA	NA	68.08	33.22	34.86	NA
MW-4	07/09/1996	<2,000	NA	160	<20	<20	<20	5,300	NA	68.08	35.70	32.38	NA
MW-4	10/02/1996	<5,000	NA	480	<50	<50	<50	19,000	NA	68.08	38.95	29.13	NA
MW-4	01/09/1997	<2,000	NA	43	<20	<20	<20	7,000	NA	68.08	33.04	35.04	NA
MW-4	04/09/1997	<2,500	NA	120	<25	<25	<25	8,100	NA	68.08	34.15	33.93	NA
MW-4	07/02/1997	<2,000	NA	81	<20	<20	<20	6,600	NA	68.08	37.92	30.16	NA
MW-4	10/24/1997	<500	NA	90	<5.0	11	6.3	3,200	NA	68.08	41.00	27.08	2.1
MW-4	01/08/1998	<50	NA	3.9	<0.50	<0.50	<0.50	1,800	NA	68.08	37.54	30.54	2.2
MW-4	04/14/1998 b	920	NA	<0.50	<0.50	<0.50	<0.50	27	NA	68.08	27.75	40.33	1.2
MW-4	07/15/1998	2,100	NA	160	76	120	190	2,600	NA	68.08	32.47	35.61	1.8
MW-4	10/13/1998	<50	NA	<0.50	<0.50	<0.50	<0.50	17	NA	68.08	36.75	31.33	1.1
MW-4	01/22/1999	<50.0	NA	<0.500	<0.500	<0.500	<0.500	7	13	68.08	36.41	31.67	1.6
MW-4	04/16/1999	1,800	NA	92	35	110	200	1,800	2,750	68.08	33.00	35.08	1.2
MW-4	07/22/1999	Well Inaccessible		NA	NA	NA	NA	NA	NA	68.08	27.59	40.49	NA
MW-4	12/08/1999	<50.0	NA	<0.500	<0.500	<0.500	<0.500	22.6	NA	68.08	39.04	29.04	2.5/2.6
MW-4	01/07/2000	871	NA	39.4	69.0	71.6	99.6	1,030	NA	68.08	39.35	28.73	1.2/1.2
MW-4	04/05/2000	475	NA	26.9	5.24	19.8	41.5	681	NA	68.08	31.28	36.80	1.6/1.8
MW-4	07/12/2000	1,040	NA	35.7	6.95	125	104	1,040	NA	68.08	35.52	32.56	0.5/4.9
MW-4	10/19/2000	944	NA	23.9	6.57	122	109	372	NA	68.08	38.08	30.00	2.3/1.4
MW-4	01/15/2001	1,170	NA	21.6	1.51	123	52.8	592	NA	68.08	38.31	29.77	1.7/1.9

WELL CONCENTRATIONS
Shell-branded Service Station
1285 Bancroft Avenue
San Leandro, CA

Well ID	Date	TPPH (ug/L)	TEPH (ug/L)	B (ug/L)	T (ug/L)	E (ug/L)	X (ug/L)	MTBE 8020 (ug/L)	MTBE 8260 (ug/L)	TOC (MSL)	Depth to Water (ft)	GW Elevation (MSL)	DO Reading (ppm)
---------	------	----------------	----------------	-------------	-------------	-------------	-------------	------------------------	------------------------	--------------	---------------------------	--------------------------	------------------------

MW-4	04/30/2001	<50	NA	<0.50	<0.50	<0.50	<0.50	NA	26	68.08	35.80	32.28	1.3/1.0
MW-4	07/20/2001	2,000	NA	16	5.8	230	270	NA	520	68.08	38.46	29.62	1.6/1.8
MW-4	10/24/2001	1,000	NA	6.9	<1.0	96	44	NA	270	68.08	40.02	28.06	0.7/0.9
MW-4	01/03/2002	390	NA	3.0	<0.50	19	5.9	NA	230	68.08	35.71	32.37	1.2/1.9
MW-4	04/05/2002	150	NA	0.57	<0.50	3.8	<0.50	NA	250	68.08	35.25	32.83	1.6/1.6
MW-4	07/11/2002	530	NA	2.6	<0.50	46	4.6	NA	280	68.08	37.39	30.69	0.8/1.9
MW-4	10/28/2002	110	NA	<0.50	<0.50	1.8	<0.50	NA	180	67.52	39.55	27.97	1.1/0.9
MW-4	01/07/2003	210	NA	0.72	<0.50	12	1.5	NA	140	67.52	35.24	32.28	2.1/2.2
MW-4	04/14/2003	220	NA	0.77	<0.50	9.8	1.2	NA	160	67.52	36.62	30.90	1.9/1.5
MW-4	07/01/2003	61	NA	<0.50	<0.50	<0.50	<1.0	NA	84	67.52	36.49	31.03	0.6/0.7
MW-4	10/08/2003	120	NA	<0.50	<0.50	4.4	<1.0	NA	87	67.52	39.96	27.56	2.6/1.5

MW-5*	06/04/1999	159,000	NA	7,190	39,300	2,450	16,700	<5,000	NA	66.50	33.48	33.02	1.7
MW-5	06/04/1999	80,400	NA	4,400	26,000	1,480	11,000	3,660	NA	66.50	33.48	33.02	1.9
MW-5	07/22/1999	97,200	NA	4,580	25,600	1,580	10,100	<5,000	4,330	66.50	33.29	33.21	1.7/1.8
MW-5	12/08/1999	72,000	NA	3,360	16,600	1,560	8,320	3,460	NA	66.50	37.80	28.70	1.7/1.9
MW-5	01/07/2000	104,000	NA	5,370	30,400	2,500	13,900	3,330	NA	66.50	38.40	28.10	1.6/1.2
MW-5	04/05/2000	99,700	NA	5,710	37,000	2,410	14,200	10,800	NA	66.50	30.72	35.78	1.7/1.5
MW-5	07/12/2000	106,000	NA	3,840	38,200	2,980	18,100	3,280	NA	66.50	34.42	32.08	0.2/1.8
MW-5	10/19/2000	72,400	NA	3,010	32,200	2,440	15,400	2,840	NA	66.50	36.89	29.61	1.0/2.7
MW-5	01/15/2001	78,300	NA	2,220	21,400	1,960	12,200	3,420	1,370	66.50	37.10	29.40	1.2/1.0
MW-5	04/30/2001	83,000	NA	1,400	23,000	2,300	14,000	NA	3,400	66.50	34.75	31.75	0.6/0.8
MW-5	07/20/2001 f	NA	NA	NA	NA	NA	NA	NA	NA	66.50	37.40	29.10	0.5
MW-5	07/24/2001	160,000	NA	2,400	37,000	3,800	24,000	NA	1,400	66.50	37.30	29.20	0.7/0.8
MW-5	10/24/2001 g	NA	NA	NA	NA	NA	NA	NA	NA	66.50	39.00	27.50	NA
MW-5	10/31/2001	14,000	NA	150	2,700	450	2,300	NA	110	66.50	39.05	27.45	0.4/0.8
MW-5	01/03/2002	62,000	NA	660	12,000	1,700	11,000	NA	860	66.50	35.15	31.35	0.4/0.3

WELL CONCENTRATIONS
Shell-branded Service Station
1285 Bancroft Avenue
San Leandro, CA

Well ID	Date	TPPH (ug/L)	TEPH (ug/L)	B (ug/L)	T (ug/L)	E (ug/L)	X (ug/L)	MTBE 8020 (ug/L)	MTBE 8260 (ug/L)	TOC (MSL)	Depth to Water (ft)	GW Elevation (MSL)	DO Reading (ppm)
---------	------	----------------	----------------	-------------	-------------	-------------	-------------	------------------------	------------------------	--------------	---------------------------	--------------------------	------------------------

MW-5	04/05/2002	81,000	NA	1,500	19,000	2,400	13,000	NA	2,400	66.50	34.18	32.32	1.7/1.4
MW-5	07/11/2002	140,000	NA	1,900	26,000	3,400	20,000	NA	1,700	66.50	36.28	30.22	0.5/0.6
MW-5	10/28/2002	30,000	NA	340	4,900	830	5,200	NA	<200	66.50	38.44	28.06	0.6/0.9
MW-5	01/07/2003	72,000	NA	720	13,000	1,900	10,000	NA	1,100	66.50	34.17	32.33	1.4/1.1
MW-5	04/14/2003	110,000	NA	900	19,000	3,000	20,000	NA	1,400	66.50	35.52	30.98	0.8/0.6
MW-5	07/01/2003	94,000	NA	970	22,000	3,300	20,000	NA	2,900	66.50	35.37	31.13	1.1/1.0
MW-5	10/08/2003	26,000	NA	290	3,000	960	5,000	NA	300	66.50	38.87	27.63	0.4/0.4

MW-6*	06/04/1999	36,000	NA	4,240	1,680	1,100	4,160	11,300	17,500	64.98	32.13	32.85	1.3
MW-6	06/04/1999	56,900	NA	6,830	6,050	1,970	9,060	17,000	24,300	64.98	32.13	32.85	1.3
MW-6	07/22/1999	42,800	NA	4,660	740	1,210	4,980	15,600	20,100	64.98	32.09	32.89	2.9/2.1
MW-6	12/08/1999	9,520	NA	1,760	58.0	142	384	9,320	7,310c	64.98	36.62	28.36	2.9/2.2
MW-6	01/07/2000	20,000	NA	3,650	367	949	1,700	13,600	13,100	64.98	37.03	27.95	1.2/1.4
MW-6	04/05/2000	20,500e	NA	4,190e	1,250e	1,200e	2,750e	18,600e	12,700c	64.98	29.37	35.61	1.2/1.2
MW-6	07/12/2000	27,300	NA	4,000	3,170	1,470	4,570	12,900	10,800c	64.98	33.04	31.94	0.8/0.4
MW-6	10/19/2000	39,600	NA	4,050	6,250	1,920	7,800	14,200	14,600c	64.98	35.62	29.36	1.4/1.7
MW-6	01/15/2001	64,800	NA	2,090	20,400	1,860	11,100	<1,250	NA	64.98	35.91	29.07	1.2/1.5
MW-6	04/30/2001	27,000	NA	2,300	3,200	1,100	4,600	NA	6,800	64.98	33.70	31.28	1.6/1.2
MW-6	07/20/2001	29,000	NA	2,100	1,900	1,100	5,600	NA	7,100	64.98	35.98	29.00	1.0/0.7
MW-6	10/24/2001	38,000	NA	1,400	690	1,400	5,700	NA	4,800	64.98	37.55	27.43	1.0/0.6
MW-6	01/03/2002	10,000	NA	810	120	260	1,100	NA	4,100	64.98	33.34	31.64	0.8/0.6
MW-6	04/05/2002	19,000	NA	1,100	1,100	510	3,000	NA	4,300	64.98	34.60	30.38	1.1/1.5
MW-6	07/11/2002	26,000	NA	1,100	550	1,200	4,400	NA	5,400	64.98	35.02	29.96	0.1/0.7
MW-6	10/28/2002	11,000	NA	230	56	140	540	NA	2,500	65.10	37.78	27.32	0.7/1.1
MW-6	01/07/2003	Unable to sample		NA	NA	NA	NA	NA	NA	65.10	32.95	32.15	NA
MW-6	01/10/2003	17,000	NA	840	1,200	1,100	2,700	NA	3,400	65.10	32.75	32.35	0.4/0.3
MW-6	04/14/2003	31,000	NA	810	420	1,300	4,000	NA	3,800	65.10	34.95	30.15	3.6/1.0

WELL CONCENTRATIONS
Shell-branded Service Station
1285 Bancroft Avenue
San Leandro, CA

Well ID	Date	TPPH (ug/L)	TEPH (ug/L)	B (ug/L)	T (ug/L)	E (ug/L)	X (ug/L)	MTBE 8020 (ug/L)	MTBE 8260 (ug/L)	TOC (MSL)	Depth to Water (ft.)	GW Elevation (MSL)	DO Reading (ppm)
MW-6	07/01/2003	1,400	NA	88	44	<10	160	NA	1,900	65.10	34.77	30.33	1.2/1.5
MW-6	10/08/2003	26,000	NA	720	92	1,100	1,800	NA	3,500	65.10	37.57	27.53	0.5/0.6
MW-7*	06/04/1999	<50.0	NA	<0.500	<0.500	<0.500	<0.500	<5.00	NA	65.83	33.03	32.80	1.4
MW-7	06/04/1999	<50.0	NA	0.663	<0.500	0.677	<0.500	11.7	NA	65.83	33.03	32.80	1.4
MW-7	07/22/1999	<50.0	NA	<0.500	<0.500	<0.500	<0.500	<5.00	<2.00	65.83	33.09	32.74	2.7/2.4
MW-7	12/08/1999	<50.0	NA	<0.500	<0.500	<0.500	<0.500	<5.00	NA	65.83	37.68	28.15	2.7/2.4
MW-7	01/07/2000	<50.0	NA	<0.500	<0.500	<0.500	<0.500	<2.50	NA	65.83	37.87	27.96	2.8/2.6
MW-7	04/05/2000	<50.0	NA	<0.500	<0.500	<0.500	<0.500	<2.50	NA	65.83	30.30	35.53	2.8/3.1
MW-7	07/12/2000	<50.0	NA	<0.500	<0.500	<0.500	<0.500	<2.50	NA	65.83	33.92	31.91	0.9/0.7
MW-7	10/19/2000	<50.0	NA	<0.500	<0.500	<0.500	<0.500	<2.50	NA	65.83	36.51	29.32	1.5/1.8
MW-7	01/15/2001	<50.0	NA	<0.500	<0.500	<0.500	<0.500	<2.50	NA	65.83	36.73	29.10	4.7/4.3
MW-7	04/30/2001	<50	NA	<0.50	<0.50	<0.50	<0.50	NA	<5.0	65.83	34.25	31.58	4.2/2.2
MW-7	07/20/2001	<50	NA	<0.50	<0.50	<0.50	<0.50	NA	<5.0	65.83	36.88	28.95	1.8/1.7
MW-7	10/24/2001	<50	NA	<0.50	<0.50	<0.50	<0.50	NA	<5.0	65.83	38.45	27.38	1.4/1.5
MW-7	01/03/2002	<50	NA	<0.50	<0.50	<0.50	<0.50	NA	<5.0	65.83	34.52	31.31	1.2/1.8
MW-7	04/05/2002	<50	NA	<0.50	<0.50	<0.50	<0.50	NA	<5.0	65.83	34.51	31.32	1.7/1.4
MW-7	07/11/2002	<50	NA	<0.50	<0.50	<0.50	<0.50	NA	<5.0	65.83	35.77	30.06	4.5/2.5
MW-7	10/28/2002	<50	NA	<0.50	<0.50	<0.50	<0.50	NA	<5.0	65.84	37.70	28.14	0.4/0.8
MW-7	01/07/2003	<50	NA	<0.50	<0.50	<0.50	<0.50	NA	<5.0	65.84	33.76	32.08	2.24/1.9
MW-7	04/14/2003	80	NA	2.2	1.1	3.0	9.0	NA	21	65.84	34.99	30.85	2.7/1.9
MW-7	07/01/2003	<50	NA	<0.50	0.75	<0.50	1.1	NA	0.77	65.84	34.79	31.05	0.7/0.9
MW-7	10/08/2003	<50	NA	<0.50	<0.50	<0.50	<1.0	NA	<0.50	65.84	38.37	27.47	1.7/1.8
MW-8*	06/04/1999	<50	NA	<0.500	<0.500	<0.500	<0.500	452	NA	65.07	32.19	32.88	2.1
MW-8	06/04/1999	<50.0	NA	<0.500	<0.500	<0.500	<0.500	186	NA	65.07	32.19	32.88	1.8
MW-8	07/22/1999	<50.0	NA	<0.500	<0.500	<0.500	<0.500	286	443	65.07	32.14	32.93	2.9/2.7

WELL CONCENTRATIONS
Shell-branded Service Station
1285 Bancroft Avenue
San Leandro, CA

Well ID	Date	TPPH (ug/L)	TEPH (ug/L)	B (ug/L)	T (ug/L)	E (ug/L)	X (ug/L)	MTBE 8020 (ug/L)	MTBE 8260 (ug/L)	TOC (MSL)	Depth to Water (ft)	GW Elevation (MSL)	DO Reading (ppm)
MW-8	12/08/1999	<50.0	NA	<0.500	<0.500	<0.500	<0.500	<5.00	NA	65.07	36.75	28.32	2.9/2.7
MW-8	01/07/2000	<50.0	NA	<0.500	<0.500	<0.500	<0.500	255	NA	65.07	37.15	27.92	1.8/2.0
MW-8	04/05/2000	<50.0e	NA	<0.500e	<0.500e	<0.500e	<0.500e	247e	NA	65.07	29.45	35.62	2.1/2.5
MW-8	07/12/2000	<50.0	NA	<0.500	<0.500	<0.500	<0.500	123	NA	65.07	33.13	31.94	0.5/0.5
MW-8	10/19/2000	<50.0	NA	<0.500	<0.500	<0.500	<0.500	123	NA	65.07	35.72	29.35	1.2/1.8
MW-8	01/15/2001	<50.0	NA	<0.500	<0.500	<0.500	<0.500	173	NA	65.07	36.00	29.07	0.5/1.0
MW-8	04/30/2001	<50	NA	<0.50	<0.50	<0.50	<0.50	NA	120	65.07	33.48	31.59	1.4/1.0
MW-8	07/20/2001	<50	NA	<0.50	<0.50	<0.50	<0.50	NA	210	65.07	36.12	28.95	1.0/1.2
MW-8	10/24/2001	<100	NA	<1.0	<1.0	<1.0	<1.0	NA	360	65.07	37.73	27.34	1.4/0.5
MW-8	01/03/2002	290	NA	<0.50	<0.50	<0.50	<0.50	NA	18	65.07	35.37	29.70	1.2/1.1
MW-8	04/05/2002	<50	NA	<0.50	<0.50	<0.50	<0.50	NA	100	65.07	35.40	29.67	1.2/1.3
MW-8	07/11/2002	<50	NA	<0.50	<0.50	<0.50	<0.50	NA	230	65.07	35.05	30.02	0.3/0.4
MW-8	10/28/2002	<50	NA	<0.50	<0.50	<0.50	<0.50	NA	210	65.08	37.25	27.83	1.1/1.2
MW-8	01/07/2003	<50	NA	<0.50	<0.50	<0.50	<0.50	NA	97	65.08	33.01	32.07	1.4/1.7
MW-8	04/14/2003	<50	NA	<0.50	<0.50	<0.50	1.1	NA	130	65.08	34.29	30.79	2.5/0.9
MW-8	07/01/2003	<250	NA	<2.5	<2.5	<2.5	<5.0	NA	430	65.08	34.04	31.04	0.6/0.8
MW-8	10/08/2003	<100	NA	<1.0	<1.0	<1.0	<2.0	NA	240	65.08	37.58	27.50	0.6/0.7

Irrigation Well	06/04/1999	<50.0	NA	<0.500	<0.500	<0.500	<0.500	<5.00	<2.00	NA	NA	NA	NA
Irrigation Well	07/22/1999	<50.0	NA	<0.500	<0.500	<0.500	<0.500	<5.00	<2.00	NA	NA	NA	NA
Irrigation Well	12/08/1999	<50.0	NA	<0.500	<0.500	<0.500	<0.500	<5.00	NA	NA	NA	NA	NA
Irrigation Well	01/07/2000	<50.0	NA	<0.500	<0.500	<0.500	<0.500	<2.50	NA	NA	NA	NA	NA
Irrigation Well	04/05/2000	<50.0	NA	<0.500	<0.500	<0.500	<0.500	<2.50	NA	NA	27.85	NA	NA
Irrigation Well	07/12/2000	<50.0	NA	<0.500	<0.500	<0.500	<0.500	<2.50	NA	NA	NA	NA	NA
Irrigation Well	10/19/2000	<50.0	NA	<0.500	<0.500	<0.500	<0.500	<2.50	NA	NA	NA	NA	1.7/1.8
Irrigation Well	01/15/2001	<50.0	NA	<0.500	<0.500	<0.500	<0.500	<2.50	NA	NA	34.35	NA	1.0/1.2
Irrigation Well	04/30/2001	<50	NA	<0.50	<0.50	<0.50	<0.50	NA	<5.0	NA	31.74	NA	1.4/3.8

WELL CONCENTRATIONS
Shell-branded Service Station
1285 Bancroft Avenue
San Leandro, CA

Well ID	Date	TPPH (ug/L)	TEPH (ug/L)	B (ug/L)	T (ug/L)	E (ug/L)	X (ug/L)	MTBE 8020 (ug/L)	MTBE 8260 (ug/L)	TOC (MSL)	Depth to Water (ft.)	GW Elevation (MSL)	DO Reading (ppm)
Irrigation Well	07/20/2001	<50	NA	<0.50	<0.50	<0.50	<0.50	NA	<5.0	NA	34.38	NA	3.0/4.0
Irrigation Well	10/24/2001	<50	NA	<0.50	<0.50	<0.50	<0.50	NA	<5.0	NA	36.28	NA	5.8/7.0
Irrigation Well	01/03/2002	<50	NA	<0.50	<0.50	<0.50	<0.50	NA	<5.0	NA	31.96	NA	3.1/3.1
Irrigation Well	04/05/2002	<50	NA	<0.50	<0.50	<0.50	<0.50	NA	<5.0	NA	32.00	NA	2.8/2.9
Irrigation Well	07/11/2002	<50	NA	<0.50	<0.50	<0.50	<0.50	NA	<5.0	NA	33.22	NA	4.6/4.6
Irrigation Well	10/28/2002	<50	NA	<0.50	<0.50	<0.50	<0.50	NA	<5.0	NA	35.55	NA	1.7/1.9
Irrigation Well	01/07/2003	<50	NA	<0.50	<0.50	<0.50	<0.50	NA	<5.0	NA	31.20 h	NA	1.4/1.0
Irrigation Well	04/14/2003	<50	NA	<0.50	<0.50	<0.50	<1.0	NA	<5.0	NA	32.35	NA	3.9/4.3
Irrigation Well	07/01/2003	<50	NA	<0.50	<0.50	<0.50	<1.0	NA	0.64	NA	33.03	NA	3.7/4.9
Irrigation Well	10/08/2003	<50	NA	1.1	<0.50	3.5	5.7	NA	19	NA	35.75	NA	3.8/4.8

WELL CONCENTRATIONS
Shell-branded Service Station
1285 Bancroft Avenue
San Leandro, CA

Well ID	Date	TPPH (ug/L)	TEPH (ug/L)	B (ug/L)	T (ug/L)	E (ug/L)	X (ug/L)	MTBE 8020 (ug/L)	MTBE 8260 (ug/L)	TOC (MSL)	Depth to Water (ft)	GW Elevation (MSL)	DO Reading (ppm)
---------	------	----------------	----------------	-------------	-------------	-------------	-------------	------------------------	------------------------	--------------	---------------------------	--------------------------	------------------------

Abbreviations:

TPPH = Total petroleum hydrocarbons as gasoline by EPA Method 8260B; prior to April 30, 2001, analyzed by EPA Method 8015.

TEPH = Total petroleum hydrocarbons as diesel by modified EPA Method 8015.

BTEX = Benzene, toluene, ethylbenzene, xylenes by EPA Method 8260B; prior to April 30, 2001, analyzed by EPA Method 8020.

MTBE = Methyl-tertiary-butyl ether

TOC = Top of Casing Elevation

SPH = Separate-Phase Hydrocarbons

GW = Groundwater

DO = Dissolved Oxygen

ug/L = Parts per billion

ppm = Parts per million

MSL = Mean sea level

ft = Feet

<n = Below detection limit

D = Duplicate sample

n/n = Pre-purge/post-purge DO reading.

NA = Not applicable

WELL CONCENTRATIONS
Shell-branded Service Station
1285 Bancroft Avenue
San Leandro, CA

Well ID	Date	TPPH (ug/L)	TEPH (ug/L)	B (ug/L)	T (ug/L)	E (ug/L)	X (ug/L)	MTBE 8020 (ug/L)	MTBE 8260 (ug/L)	TOC (MSL)	Depth to Water (ft)	GW Elevation (MSL)	DO Reading (ppm)
---------	------	----------------	----------------	-------------	-------------	-------------	-------------	------------------------	------------------------	--------------	---------------------------	--------------------------	------------------------

Notes:

a = Chromatogram pattern indicated an unidentified hydrocarbon.

b = Equipment blank contained 80 ug/L TPH-G, 1.2 ug/L benzene, 17 ug/L toluene, 3.2 ug/L ethylbenzene, 16 ug/L xylenes, and 15 ug/L MTBE

c = Sample was analyzed outside the EPA recommended holding time.

d = DO Reading not taken.

e = Result was generated out of hold time.

f = Stinger broke off in well; removed on subsequent return trip.

g = Unable to complete sample due to equipment failure.

h = Depth to water at five minutes purge time.

* Pre-purge samples

TOC elevation of wells MW-1, MW-2, and MW-3 resurveyed March 29, 1994

Site surveyed on June 21, 1999 by Virgil Chavez land surveying, Vallejo, CA

Site surveyed on March 14, 2002 by Virgil Chavez land surveying, Vallejo, CA

Blaine Tech Services, Inc.

October 23, 2003

1680 Rogers Avenue
San Jose, CA 95112-1105

Attn.: Leon Gearhart

Project#: 031008-BA1

Project: 98996067

Site: 1285 Bancroft Avenue, San Leandro

Dear Mr. Gearhart,

Attached is our report for your samples received on 10/09/2003 14:12

This report has been reviewed and approved for release. Reproduction of this report is permitted only in its entirety.

Please note that any unused portion of the samples will be discarded after 11/23/2003 unless you have requested otherwise.

We appreciate the opportunity to be of service to you. If you have any questions, please call me at (925) 484-1919.

You can also contact me via email. My email address is: vvancil@stl-inc.com

Sincerely,

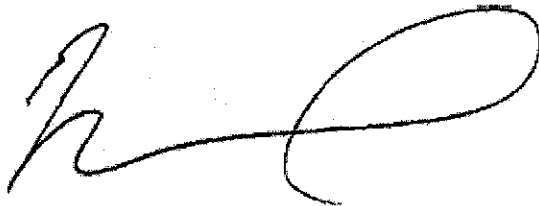

Vincent Vancil
Project Manager

Gas/BTEX/MTBE by 8260B (C6-C12)

Blaine Tech Services, Inc.

Attn.: Leon Gearhart

1680 Rogers Avenue

San Jose, CA 95112-1105

Phone: (408) 573-0555 Fax: (408) 573-7771

Project: 031008-BA1
98996067

Received: 10/09/2003 14:12

Site: 1285 Bancroft Avenue, San Leandro

Samples Reported

Sample Name	Date Sampled	Matrix	Lab #
MW-1	10/08/2003 12:00	Water	1
MW-2	10/08/2003 12:55	Water	2
MW-3	10/08/2003 13:25	Water	3
MW-4	10/08/2003 12:30	Water	4
MW-5	10/08/2003 13:55	Water	5
MW-6	10/08/2003 11:25	Water	6
MW-7	10/08/2003 10:50	Water	7
MW-8	10/08/2003 10:15	Water	8
IW-1	10/08/2003 09:40	Water	9

Gas/BTEX/MTBE by 8260B (C6-C12)

Blaine Tech Services, Inc.

Attn.: Leon Gearhart

1680 Rogers Avenue

San Jose, CA 95112-1105

Phone: (408) 573-0555 Fax: (408) 573-7771

Project: 031008-BA1
98996067

Received: 10/09/2003 14:12

Site: 1285 Bancroft Avenue, San Leandro

Prep(s):	5030B	Test(s):	8260FAB
Sample ID:	MW-1	Lab ID:	2003-10-0369 - 1
Sampled:	10/08/2003 12:00	Extracted:	10/20/2003 23:48
Matrix:	Water	QC Batch#:	2003/10/20-1B.64

Compound	Conc.	RL	Unit	Dilution	Analyzed	Flag
Gasoline	ND	50	ug/L	1.00	10/20/2003 23:48	
Benzene	ND	0.50	ug/L	1.00	10/20/2003 23:48	
Toluene	ND	0.50	ug/L	1.00	10/20/2003 23:48	
Ethylbenzene	ND	0.50	ug/L	1.00	10/20/2003 23:48	
Total xylenes	ND	1.0	ug/L	1.00	10/20/2003 23:48	
Methyl tert-butyl ether (MTBE)	ND	0.50	ug/L	1.00	10/20/2003 23:48	
Surrogate(s)						
1,2-Dichloroethane-d4	101.9	76-130	%	1.00	10/20/2003 23:48	
Toluene-d8	96.0	78-115	%	1.00	10/20/2003 23:48	

Gas/BTEX/MTBE by 8260B (C6-C12)

Blaine Tech Services, Inc.

Attn.: Leon Gearhart

1680 Rogers Avenue

San Jose, CA 95112-1105

Phone: (408) 573-0555 Fax: (408) 573-7771

Project: 031008-BA1
98996067

Received: 10/09/2003 14:12

Site: 1285 Bancroft Avenue, San Leandro

Prep(s):	5030B	Test(s):	8260FAB
Sample ID:	MW-2	Lab ID:	2003-10-0369 - 2
Sampled:	10/08/2003 12:55	Extracted:	10/21/2003 00:10
Matrix:	Water	QC Batch#:	2003/10/20-1B.64
Analysis Flag: o (See Legend and Note Section)			

Compound	Conc.	RL	Unit	Dilution	Analyzed	Flag
Gasoline	4000	1000	ug/L	20.00	10/21/2003 00:10	
Benzene	160	10	ug/L	20.00	10/21/2003 00:10	
Toluene	28	10	ug/L	20.00	10/21/2003 00:10	
Ethylbenzene	220	10	ug/L	20.00	10/21/2003 00:10	
Total xylenes	530	20	ug/L	20.00	10/21/2003 00:10	
Methyl tert-butyl ether (MTBE)	ND	10	ug/L	20.00	10/21/2003 00:10	
Surrogate(s)						
1,2-Dichloroethane-d4	103.4	76-130	%	20.00	10/21/2003 00:10	
Toluene-d8	99.9	78-115	%	20.00	10/21/2003 00:10	

Gas/BTEX/MTBE by 8260B (C6-C12)

Blaine Tech Services, Inc.

Attn.: Leon Gearhart

1680 Rogers Avenue

San Jose, CA 95112-1105

Phone: (408) 573-0555 Fax: (408) 573-7771

Project: 031008-BA1
98996067

Received: 10/09/2003 14:12

Site: 1285 Bancroft Avenue, San Leandro

Prep(s):	5030B	Test(s):	8260FAB
Sample ID:	MW-3	Lab ID:	2003-10-0369-3
Sampled:	10/08/2003 13:25	Extracted:	10/21/2003 00:32
Matrix:	Water	QC Batch#:	2003/10/20-1B.64

Compound	Conc.	RL	Unit	Dilution	Analyzed	Flag
Gasoline	300	50	ug/L	1.00	10/21/2003 00:32	
Benzene	ND	0.50	ug/L	1.00	10/21/2003 00:32	
Toluene	0.84	0.50	ug/L	1.00	10/21/2003 00:32	
Ethylbenzene	3.0	0.50	ug/L	1.00	10/21/2003 00:32	
Total xylenes	16	1.0	ug/L	1.00	10/21/2003 00:32	
Methyl tert-butyl ether (MTBE)	3.7	0.50	ug/L	1.00	10/21/2003 00:32	
Surrogate(s)						
1,2-Dichloroethane-d4	98.7	76-130	%	1.00	10/21/2003 00:32	
Toluene-d8	96.4	78-115	%	1.00	10/21/2003 00:32	

Gas/BTEX/MTBE by 8260B (C6-C12)

Blaine Tech Services, Inc.

Attn.: Leon Gearhart

1680 Rogers Avenue
San Jose, CA 95112-1105
Phone: (408) 573-0555 Fax: (408) 573-7771

Project: 031008-BA1
98996067

Received: 10/09/2003 14:12

Site: 1285 Bancroft Avenue, San Leandro

Prep(s):	5030B	Test(s):	8260FAB
Sample ID:	MW-4	Lab ID:	2003-10-0369 - 4
Sampled:	10/08/2003 12:30	Extracted:	10/21/2003 01:39
Matrix:	Water	QC Batch#:	2003/10/20-1B 64

Compound	Conc.	RL	Unit	Dilution	Analyzed	Flag
Gasoline	120	50	ug/L	1.00	10/21/2003 01:39	
Benzene	ND	0.50	ug/L	1.00	10/21/2003 01:39	
Toluene	ND	0.50	ug/L	1.00	10/21/2003 01:39	
Ethylbenzene	4.4	0.50	ug/L	1.00	10/21/2003 01:39	
Total xylenes	ND	1.0	ug/L	1.00	10/21/2003 01:39	
Methyl tert-butyl ether (MTBE)	87	0.50	ug/L	1.00	10/21/2003 01:39	
Surrogate(s)						
1,2-Dichloroethane-d4	101.9	76-130	%	1.00	10/21/2003 01:39	
Toluene-d8	91.9	78-115	%	1.00	10/21/2003 01:39	

Gas/BTEX/MTBE by 8260B (C6-C12)

Blaine Tech Services, Inc.

Attn.: Leon Gearhart

1680 Rogers Avenue

San Jose, CA 95112-1105

Phone: (408) 573-0555 Fax: (408) 573-7771

Project: 031008-BA1

98996067

Received: 10/09/2003 14:12

Site: 1285 Bancroft Avenue, San Leandro

Prep(s):	5030B	Test(s):	8260FAB
Sample ID:	MW-5	Lab ID:	2003-10-0369 - 5
Sampled:	10/08/2003 13:55	Extracted:	10/21/2003 02:01
Matrix:	Water	QC Batch#:	2003/10/20-1B.64
Analysis Flag: 0 (See Legend and Note Section)			

Compound	Conc.	RL	Unit	Dilution	Analyzed	Flag
Gasoline	26000	10000	ug/L	200.00	10/21/2003 02:01	
Benzene	290	100	ug/L	200.00	10/21/2003 02:01	
Toluene	3000	100	ug/L	200.00	10/21/2003 02:01	
Ethylbenzene	960	100	ug/L	200.00	10/21/2003 02:01	
Total xylenes	5000	200	ug/L	200.00	10/21/2003 02:01	
Methyl tert-butyl ether (MTBE)	300	100	ug/L	200.00	10/21/2003 02:01	
Surrogate(s)						
1,2-Dichloroethane-d4	101.5	76-130	%	200.00	10/21/2003 02:01	
Toluene-d8	100.4	78-115	%	200.00	10/21/2003 02:01	

Gas/BTEX/MTBE by 8260B (C6-C12)

Blaine Tech Services, Inc.

Attn.: Leon Gearhart

1680 Rogers Avenue
San Jose, CA 95112-1105
Phone: (408) 573-0555 Fax: (408) 573-7771

Project: 031008-BA1
98996067

Received: 10/09/2003 14:12

Site: 1285 Bancroft Avenue, San Leandro

Prep(s):	5030B	Test(s):	8260FAB
Sample ID:	MW-6	Lab ID:	2003-10-0369 - 6
Sampled:	10/08/2003 11:25	Extracted:	10/21/2003 02:23
Matrix:	Water	QC Batch#:	2003/10/20-1B.64
Analysis Flag: o (See Legend and Note Section)			

Compound	Conc.	RL	Unit	Dilution	Analyzed	Flag
Gasoline	26000	2500	ug/L	50.00	10/21/2003 02:23	
Benzene	720	25	ug/L	50.00	10/21/2003 02:23	
Toluene	92	25	ug/L	50.00	10/21/2003 02:23	
Ethylbenzene	1100	25	ug/L	50.00	10/21/2003 02:23	
Total xylenes	1800	50	ug/L	50.00	10/21/2003 02:23	
Methyl tert-butyl ether (MTBE)	3500	25	ug/L	50.00	10/21/2003 02:23	
Surrogate(s)						
1,2-Dichloroethane-d4	100.0	76-130	%	50.00	10/21/2003 02:23	
Toluene-d8	95.3	78-115	%	50.00	10/21/2003 02:23	

Gas/BTEX/MTBE by 8260B (C6-C12)

Blaine Tech Services, Inc.

Attn.: Leon Gearhart

1680 Rogers Avenue

San Jose, CA 95112-1105

Phone: (408) 573-0555 Fax: (408) 573-7771

Project: 031008-BA1
98996067

Received: 10/09/2003 14:12

Site: 1285 Bancroft Avenue, San Leandro

Prep(s):	5030B	Test(s):	8260FAB
Sample ID:	MW-7	Lab ID:	2003-10-0369-7
Sampled:	10/08/2003 10:50	Extracted:	10/21/2003 02:45
Matrix:	Water	QC Batch#:	2003/10/20-1B.64

Compound	Conc.	RL	Unit	Dilution	Analyzed	Flag
Gasoline	ND	50	ug/L	1.00	10/21/2003 02:45	
Benzene	ND	0.50	ug/L	1.00	10/21/2003 02:45	
Toluene	ND	0.50	ug/L	1.00	10/21/2003 02:45	
Ethylbenzene	ND	0.50	ug/L	1.00	10/21/2003 02:45	
Total xylenes	ND	1.0	ug/L	1.00	10/21/2003 02:45	
Methyl tert-butyl ether (MTBE)	ND	0.50	ug/L	1.00	10/21/2003 02:45	
Surrogate(s)						
1,2-Dichloroethane-d4	107.1	76-130	%	1.00	10/21/2003 02:45	
Toluene-d8	99.7	78-115	%	1.00	10/21/2003 02:45	

Gas/BTEX/MTBE by 8260B (C6-C12)

Blaine Tech Services, Inc.

Attn.: Leon Gearhart

1680 Rogers Avenue
San Jose, CA 95112-1105
Phone: (408) 573-0555 Fax: (408) 573-7771

Project: 031008-BA1
98996067

Received: 10/09/2003 14:12

Site: 1285 Bancroft Avenue, San Leandro

Prep(s):	5030B	Test(s):	8260FAB
Sample ID:	MW-8	Lab ID:	2003-10-0369 - 8
Sampled:	10/08/2003 10:15	Extracted:	10/21/2003 03:07
Matrix:	Water	QC Batch#:	2003/10/20-1B.64
Analysis Flag: o (See Legend and Note Section)			

Compound	Conc.	RL	Unit	Dilution	Analyzed	Flag
Gasoline	ND	100	ug/L	2.00	10/21/2003 03:07	
Benzene	ND	1.0	ug/L	2.00	10/21/2003 03:07	
Toluene	ND	1.0	ug/L	2.00	10/21/2003 03:07	
Ethylbenzene	ND	1.0	ug/L	2.00	10/21/2003 03:07	
Total xylenes	ND	2.0	ug/L	2.00	10/21/2003 03:07	
Methyl tert-butyl ether (MTBE)	240	1.0	ug/L	2.00	10/21/2003 03:07	
Surrogate(s)						
1,2-Dichloroethane-d4	108.4	76-130	%	2.00	10/21/2003 03:07	
Toluene-d8	102.0	78-115	%	2.00	10/21/2003 03:07	

Gas/BTEX/MTBE by 8260B (C6-C12)

Blaine Tech Services, Inc.

Attn.: Leon Gearhart

1680 Rogers Avenue

San Jose, CA 95112-1105

Phone: (408) 573-0555 Fax: (408) 573-7771

Project: 031008-BA1
98996067

Received: 10/09/2003 14:12

Site: 1285 Bancroft Avenue, San Leandro

Prep(s):	5030B	Test(s):	8260FAB
Sample ID:	IW-1	Lab ID:	2003-10-0369 - 9
Sampled:	10/08/2003 09:40	Extracted:	10/21/2003 03:29
Matrix:	Water	QC Batch#:	2003/10/20-1B.64

Compound	Conc.	RL	Unit	Dilution	Analyzed	Flag
Gasoline	ND	50	ug/L	1.00	10/21/2003 03:29	
Benzene	1.1	0.50	ug/L	1.00	10/21/2003 03:29	
Toluene	ND	0.50	ug/L	1.00	10/21/2003 03:29	
Ethylbenzene	3.5	0.50	ug/L	1.00	10/21/2003 03:29	
Total xylenes	5.7	1.0	ug/L	1.00	10/21/2003 03:29	
Methyl tert-butyl ether (MTBE)	19	0.50	ug/L	1.00	10/21/2003 03:29	
Surrogate(s)						
1,2-Dichloroethane-d4	103.9	76-130	%	1.00	10/21/2003 03:29	
Toluene-d8	99.0	78-115	%	1.00	10/21/2003 03:29	

Gas/BTEX/MTBE by 8260B (C6-C12)

Blaine Tech Services, Inc.

Attn.: Leon Gearhart

1680 Rogers Avenue

San Jose, CA 95112-1105

Phone: (408) 573-0555 Fax: (408) 573-7771

Project: 031008-BA1

98996067

Received: 10/09/2003 14:12

Site: 1285 Bancroft Avenue, San Leandro

Batch QC Report		
Prep(s): 5030B		Test(s): 8260FAB
Method Blank	Water	QC Batch # 2003/10/20-1B.64
MB: 2003/10/20-1B.64-023		Date Extracted: 10/20/2003 19:23

Compound	Conc.	RL	Unit	Analyzed	Flag
Gasoline	ND	50	ug/L	10/20/2003 19:23	
Benzene	ND	0.5	ug/L	10/20/2003 19:23	
Toluene	ND	0.5	ug/L	10/20/2003 19:23	
Ethylbenzene	ND	0.5	ug/L	10/20/2003 19:23	
Total xylenes	ND	1.0	ug/L	10/20/2003 19:23	
Methyl tert-butyl ether (MTBE)	ND	0.5	ug/L	10/20/2003 19:23	
Surrogates(s)					
1,2-Dichloroethane-d4	96.4	76-130	%	10/20/2003 19:23	
Toluene-d8	100.4	78-115	%	10/20/2003 19:23	

Gas/BTEX/MTBE by 8260B (C6-C12)

Blaine Tech Services, Inc.

Attn.: Leon Gearhart

1680 Rogers Avenue
San Jose, CA 95112-1105
Phone: (408) 573-0555 Fax: (408) 573-7771

Project: 031008-BA1
98996067

Received: 10/09/2003 14:12

Site: 1285 Bancroft Avenue, San Leandro

Batch QC Report									
Prep(s): 5030B					Test(s): 8260FAB				
Laboratory Control Spike			Water			QC Batch # 2003/10/20-1B.64			
LCS	2003/10/20-1B.64-039		Extracted: 10/20/2003			Analyzed: 10/20/2003 18:39			
LCSD	2003/10/20-1B.64-001		Extracted: 10/20/2003			Analyzed: 10/20/2003 19:01			

Compound	Conc. ug/L		Exp.Conc.	Recovery %		RPD	Ctrl.Limits %		Flags	
	LCS	LCSD		LCS	LCSD		%	Rec.	RPD	LCS
Benzene	19.4	20.0	25	77.6	80.0	3.0	69-129	20		
Toluene	21.8	23.3	25	87.2	93.2	6.7	70-130	20		
Methyl tert-butyl ether (MTBE)	18.3	18.3	25	73.2	73.2	0.0	65-165	20		
Surrogates(s)										
1,2-Dichloroethane-d4	490	505	500	98.0	101.0		76-130			
Toluene-d8	498	506	500	99.6	101.2		78-115			

Gas/BTEX/MTBE by 8260B (C6-C12)

Blaine Tech Services, Inc.

Attn.: Leon Gearhart

1680 Rogers Avenue
San Jose, CA 95112-1105
Phone: (408) 573-0555 Fax: (408) 573-7771

Project: 031008-BA1
98996067

Received: 10/09/2003 14:12

Site: 1285 Bancroft Avenue, San Leandro

Batch QC Report			
Prep(s):	5030B	Test(s):	8260FAB
Matrix Spike (MS / MSD)		Water	QC Batch # 2003/10/20-1B:64
MW-3 >> MS		Lab ID:	2003-10-0369 - 003
MS: 2003/10/20-1B:64-054	Extracted: 10/21/2003	Analyzed:	10/21/2003 00:54
		Dilution:	1.00
MSD: 2003/10/20-1B:64-016	Extracted: 10/21/2003	Analyzed:	10/21/2003 01:16
		Dilution:	1.00

Compound	Conc. ug/L			Spk.Level ug/L	Recovery %			Limits %		Flags	
	MS	MSD	Sample		MS	MSD	RPD	Rec.	RPD	MS	MSD
Benzene	23.1	23.9	ND	25	92.4	95.6	3.4	69-129	20		
Toluene	27.0	28.3	0.836	25	104.7	109.9	4.8	70-130	20		
Methyl tert-butyl ether	27.5	26.8	3.66	25	95.4	92.6	3.0	65-165	20		
Surrogate(s)											
1,2-Dichloroethane-d4	543	537		500	108.6	107.4		76-130			
Toluene-d8	529	523		500	105.8	104.7		78-115			

Gas/BTEX/MTBE by 8260B (C6-C12)

Blaine Tech Services, Inc.

Attn.: Leon Gearhart

1680 Rogers Avenue

San Jose, CA 95112-1105

Phone: (408) 573-0555 Fax: (408) 573-7771

Project: 031008-BA1
98996067

Received: 10/09/2003 14:12

Site: 1285 Bancroft Avenue, San Leandro

Legend and Notes

Analysis Flag

o

Reporting limits were raised due to high level of analyte present in the sample.

Lab Identification (if necessary):

Address:

City, State, Zip:

Shell Project Manager to be invoiced:

- SCIENCE & ENGINEERING
- TECHNICAL SERVICES
- CRMT HOUSTON

Karen Petryna

2003-10-0369

INCIDENT NUMBER (S&E ONLY)

9 8 9 9 6 0 6 7

DATE: 10/8/03

SAP or CRMT NUMBER (S/CRMT)

PAGE: 1 of 1

LABORATORY COMPANY

LAB USE ONLY

SITE ADDRESS (Street and City)

STOCK ID NO.

Blaine Tech Services

BTSS

1285 Bancroft Avenue, San Leandro

T0600101224

ADDRESS

1680 Rogers Avenue, San Jose, CA 95112

EDF DELIVERABLE TO (Responsible Party or Designee)

PHONE NO.

E-MAIL

CONTACT PERSONNEL

Ann Kroml

510-420-3335

ShellOaklandEDF@cambria-env.com

031008-34

Leon Gearhart

TELEPHONE

408-573-0555

FAX

408-573-7771

E-MAIL

lgearhart@blainetech.com

SAMPLER NAME(S) (PRINT)

Beau Acoen

LAB USE ONLY

TURNAROUND TIME (BUSINESS DAYS)

16 DAYS 5 DAYS 72 HOURS 48 HOURS 24 HOURS LESS THAN 24 HOURS

REQUESTED ANALYSIS

LA - KWQCB REPORT FORMAT UST AGENCY

GC/MS/MTBE CONFIRMATION: HIGHEST HIGHEST per BORING ALL

SPECIAL INSTRUCTIONS OR NOTES: CHECK BOX IF EDD IS NOT NEEDED

FIELD NOTES:

Container/Preservative or PID Readings or Laboratory Notes



2.9°C

TEMPERATURE ON RECEIPT °C

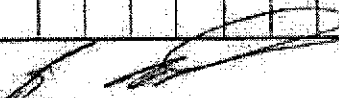
LAB USE ONLY	Field Sample Identification	SAMPLING		MATRIX	NO. OF CONT.	TPH - Gas, Purgeable	BTEX	MTBE (802 B - 5ppb RL)	MTBE (8260B - 0.5ppb RL)	Oxygenates (S) by (8260B)	Ethanol (8260B)	Methanol	1,2-DCA (8260B)	EDG (8260B)	TPH - Diesel, Extractable (8015m)
		DATE	TIME												
	MW-1	10/8	1200	W	3	X	X	X							
	MW-2		1255			X	X	X							
	MW-3		1325			X	X	X							
	MW-4		1230			X	X	X							
	MW-5		1355			X	X	X							
	MW-6		1125			X	X	X							
	MW-7		1050			X	X	X							
	MW-8		1015			X	X	X							
	TK-1	10/8	0940	W	3	X	X	X							

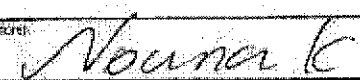
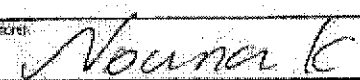
Requested by (Signature): 
 Received by (Signature): 
 Date: 10/9/03
 Time: 1810

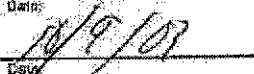
Requested by (Signature): 
 Received by (Signature): 
 Date: 10/9/03
 Time: 1810

Requested by (Signature): 
 Received by (Signature): 
 Date: 10/9/03
 Time: 1810

WELL GAUGING DATA

Project # 031008-BA1 Date 10/8/03 Client Shell

Site 1285 Bancroft Ave, San Leandro

Well ID	Well Size (in.)	Sheen / Odor	Depth to Immiscible Liquid (ft.)	Thickness of Immiscible Liquid (ft.)	Volume of Immiscibles Removed (ml)	Depth to water (ft.)	Depth to well bottom (ft.)	Survey Point: TOB or TOC	
MW-1	4					38.63	59.19	ToC	
MW-2	4					38.59	59.04		
MW-3	4					39.25	57.65		
MW-4	4					39.96	54.73		
MW-5	4	Odor				38.87*	49.95		
MW-6	2					37.57*	49.94		
MW-7	2					38.37	50.10		
MW-8	2					37.58	50.09		
IW-1	8					35.75	-		>
* gauged w/ stinger in well									

SHELL WELL MONITORING DATA SHEET

BTS #: <u>031008-BA1</u>	Site: <u>1285 Bancroft Ave, San Leandro</u>
Sampler: <u>Brian Alcom</u>	Date: <u>10/8/03</u>
Well I.D.: <u>MW-1</u>	Well Diameter: 2 3 <u>(4)</u> 6 8 _____
Total Well Depth (TD): <u>39.19</u>	Depth to Water (DTW): <u>38.63</u>
Depth to Free Product: 35	Thickness of Free Product (feet):
Referenced to: <u>(PVC)</u> Grade	D.O. Meter (if req'd): <u>(YSI)</u> HACH
DTW with 80% Recharge [(Height of Water Column x 0.20) + DTW]: <u>42.74</u>	

Purge Method: <u>Bailer</u> Disposable Bailer Positive Air Displacement <u>Electric Submersible</u>	Water: <u>Peristaltic</u> Extraction Pump Other: _____	Sampling Method: <u>(Bailer)</u> Disposable Bailer Extraction Port Dedicated Tubing Other: _____
--	--	--

$\frac{13.5 \text{ (Gals.)} \times 3}{\text{Specified Volumes}} = \frac{40.5}{\text{Calculated Volume}} \text{ Gals.}$	<table border="1" style="width: 100%; border-collapse: collapse;"> <tr> <th>Well Diameter</th> <th>Multiplier</th> <th>Well Diameter</th> <th>Multiplier</th> </tr> <tr> <td>1"</td> <td>0.04</td> <td>4"</td> <td>0.65</td> </tr> <tr> <td>2"</td> <td>0.16</td> <td>6"</td> <td>1.47</td> </tr> <tr> <td>3"</td> <td>0.37</td> <td>Other</td> <td>radius² * 0.163</td> </tr> </table>	Well Diameter	Multiplier	Well Diameter	Multiplier	1"	0.04	4"	0.65	2"	0.16	6"	1.47	3"	0.37	Other	radius ² * 0.163
Well Diameter	Multiplier	Well Diameter	Multiplier														
1"	0.04	4"	0.65														
2"	0.16	6"	1.47														
3"	0.37	Other	radius ² * 0.163														

Time	Temp (°F)	pH	Cond. (mS or (S))	Turbidity (NTUs)	Gals. Removed	Observations
1151	65.4	6.7	566	77	13.5	clear
1154	65.3	6.7	559	63	27.0	"
1157	65.4	6.7	559	51	40.5	" DTW 38.75

Did well dewater? Yes <u>(No)</u>	Gallons actually evacuated: <u>40.5</u>	
Sampling Date: <u>10/8/03</u>	Sampling Time: <u>1200</u>	Depth to Water: <u>38.75</u>
Sample I.D.: <u>MW-1</u>	Laboratory: <u>(STL)</u> Other: _____	
Analyzed for: <u>(TPH-G BTEX MTBE)</u> TPH-D Other: _____		
EB I.D. (if applicable): _____ @ _____ Time	Duplicate I.D. (if applicable): _____	
Analyzed for: TPH-G BTEX MTBE TPH-D Other: _____		
D.O. (if req'd): <u>(Pre-purge:)</u> <u>2.9</u> mg/L	<u>(Post-purge:)</u> <u>2.9</u> mg/L	
O.R.P. (if req'd): <u>Pre-purge:</u> _____ mV	<u>Post-purge:</u> _____ mV	

SHELL WELL MONITORING DATA SHEET

BTS #: <u>031008-BA1</u>	Site: <u>1285 Bancroft Ave, San Leandro</u>
Sampler: <u>Brian Alcorn</u>	Date: <u>10/8/03</u>
Well I.D.: <u>MW-2</u>	Well Diameter: 2 3 <u>(4)</u> 6 8
Total Well Depth (TD): <u>59.04</u>	Depth to Water (DTW): <u>38.59</u>
Depth to Free Product:	Thickness of Free Product (feet):
Referenced to: <u>(PVC)</u> Grade	D.O. Meter (if req'd): <u>(YSI)</u> HACH
DTW with 80% Recharge [(Height of Water Column x 0.20) + DTW]: <u>42.68</u>	

Purge Method: <u>Bailer</u> Disposable Bailer Positive Air Displacement <u>Electric Submersible</u>	Waterra Peristaltic Extraction Pump Other _____	Sampling Method: <u>Bailer</u> Disposable Bailer Extraction Port Dedicated Tubing Other: _____
--	--	--

$\underline{13.5} \text{ (Gals.)} \times \underline{3} = \underline{40.5} \text{ Gals.}$ I Case Volume Specified Volumes Calculated Volume	<table border="1" style="width: 100%; border-collapse: collapse; font-size: small;"> <tr> <th>Well Diameter</th> <th>Multiplier</th> <th>Well Diameter</th> <th>Multiplier</th> </tr> <tr> <td>1"</td> <td>0.04</td> <td>4"</td> <td>0.65</td> </tr> <tr> <td>2"</td> <td>0.16</td> <td>6"</td> <td>1.47</td> </tr> <tr> <td>3"</td> <td>0.37</td> <td>Other</td> <td>radius² * 0.163</td> </tr> </table>	Well Diameter	Multiplier	Well Diameter	Multiplier	1"	0.04	4"	0.65	2"	0.16	6"	1.47	3"	0.37	Other	radius ² * 0.163
Well Diameter	Multiplier	Well Diameter	Multiplier														
1"	0.04	4"	0.65														
2"	0.16	6"	1.47														
3"	0.37	Other	radius ² * 0.163														

Time	Temp (°F)	pH	Cond. (mS or μ S)	Turbidity (NTUs)	Gals. Removed	Observations
1246	64.8	6.7	564	97	13.5	clear
1249	64.7	6.7	562	58	27.0	"
1252	64.5	6.7	562	51	40.5	" ^{DTW} 39.08

Did well dewater? Yes <u>(No)</u>	Gallons actually evacuated: <u>40.5</u>	
Sampling Date: <u>10/8/03</u>	Sampling Time: <u>1255</u>	Depth to Water: <u>39.08</u>
Sample I.D.: <u>MW-2</u>	Laboratory: <u>(STL)</u> Other _____	
Analyzed for: <u>(TPH-G BTEX MTBE)</u> TPH-D Other:		
EB I.D. (if applicable): _____ @ _____ Time	Duplicate I.D. (if applicable): _____	
Analyzed for: TPH-G BTEX MTBE TPH-D Other:		
D.O. (if req'd): <u>(Pre-purge: 2.9)</u> mg/L	<u>(Post-purge: 0.5)</u> mg/L	
O.R.P. (if req'd): Pre-purge: _____ mV	Post-purge: _____ mV	

SHELL WELL MONITORING DATA SHEET

BTS #: 031008-BA1	Site: 1285 Bancroft Ave, San Leandro
Sampler: Brian Alcorn	Date: 10/8/03
Well I.D.: MW-4	Well Diameter: 2 3 (4) 6 8
Total Well Depth (TD): 54.73	Depth to Water (DTW): 39.96
Depth to Free Product:	Thickness of Free Product (feet):
Referenced to: (PVC) Grade	D.O. Meter (if req'd): (YSI) HACH
DTW with 80% Recharge [(Height of Water Column x 0.20) + DTW]: 54.73 42.91	

Purge Method: Bailer Waterra Sampling Method: Bailer
 Disposable Bailer Peristaltic Disposable Bailer
 Positive Air Displacement Extraction Pump Extraction Port
 Electric Submersible Other _____ Dedicated Tubing

$10.0 \text{ (Gals.)} \times 3 = 30.0 \text{ Gals.}$ 1 Case Volume Specified Volumes Calculated Volume	<table border="1" style="width: 100%; border-collapse: collapse;"> <tr> <th>Well Diameter</th> <th>Multiplier</th> <th>Well Diameter</th> <th>Multiplier</th> </tr> <tr> <td>1"</td> <td>0.04</td> <td>4"</td> <td>0.65</td> </tr> <tr> <td>2"</td> <td>0.16</td> <td>6"</td> <td>1.47</td> </tr> <tr> <td>3"</td> <td>0.37</td> <td>Other</td> <td>radius² * 0.163</td> </tr> </table>	Well Diameter	Multiplier	Well Diameter	Multiplier	1"	0.04	4"	0.65	2"	0.16	6"	1.47	3"	0.37	Other	radius ² * 0.163
Well Diameter	Multiplier	Well Diameter	Multiplier														
1"	0.04	4"	0.65														
2"	0.16	6"	1.47														
3"	0.37	Other	radius ² * 0.163														

Time	Temp (°F)	pH	Cond. (mS or (µS))	Turbidity (NTUs)	Gals. Removed	Observations
12:21	65.7	6.7	544	51	10.0	clear
12:24	65.4	6.5	579	78	20.0	"
12:27	65.1	6.5	606	84	30.0	" DTW 41.13 41.13

Did well dewater? Yes No Gallons actually evacuated: 30.0

Sampling Date: 10/8/03 Sampling Time: 1230 Depth to Water: 41.13

Sample I.D.: MW-4 Laboratory: (STL) Other _____

Analyzed for: (TPH-G BTEX MTBE) TPH-D Other:

EB I.D. (if applicable): @ _____ time Duplicate I.D. (if applicable):

Analyzed for: TPH-G BTEX MTBE TPH-D Other:

D.O. (if req'd): (Pre-purge): 2.6 mg/L	(Post-purge): 1.5 mg/L
O.R.P. (if req'd): Pre-purge: _____ mV	Post-purge: _____ mV

Blaine Tech Services, Inc. 1680 Rogers Ave., San Jose, CA 95112 (800) 545-7558

SHELL WELL MONITORING DATA SHEET

BTS #: <u>031008-BA1</u>	Site: <u>1285 Bancroft Ave, San Leandro</u>
Sampler: <u>Brian Alcorn</u>	Date: <u>10/8/03</u>
Well I.D.: <u>MW-5</u>	Well Diameter: 2 3 <u>(4)</u> 6 8
Total Well Depth (TD): <u>49.95</u>	Depth to Water (DTW): <u>38.87</u>
Depth to Free Product:	Thickness of Free Product (feet):
Referenced to: <u>(PVC)</u> Grade	D.O. Meter (if req'd): <u>(YSI)</u> HACH
DTW with 80% Recharge [(Height of Water Column x 0.20) + DTW]: <u>41.08</u>	

Purge Method: Bailer Water: Peristaltic Sampling Method: (Bailer)
 Disposable Bailer Extraction Pump Disposable Bailer
 Positive Air Displacement Other: _____ Extraction Port
(Electric Submersible) _____ Dedicated Tubing

<u>7.5</u> (Gals.) X <u>3</u> = <u>22.5</u> Gals.	Well Diameter	Multiplier	Well Diameter	Multiplier
1 Case Volume Specified Volumes Calculated Volume	1"	0.04	4"	0.65
	2"	0.16	6"	1.47
	3"	0.37	Other	radius ² * 0.163

Time	Temp (°F)	pH	Cond. (mS or (uS))	Turbidity (NTUs)	Gals. Removed	Observations
<u>1341</u>	<u>69.1</u>	<u>6.5</u>	<u>605</u>	<u>74</u>	<u>7.5</u>	<u>clear, odor</u>
<u>1343</u>	<u>67.5</u>	<u>6.5</u>	<u>602</u>	<u>132</u>	<u>15.0</u>	<u>cloudy gray, odor</u>
<u>1345</u>	<u>67.2</u>	<u>6.6</u>	<u>610</u>	<u>89</u>	<u>22.5</u>	<u>clear, odor</u>

DTW
43.1

Did well dewater? Yes (No) Gallons actually evacuated: 22.5

Sampling Date: 10/8/03 Sampling Time: 1355 Depth to Water: 38.91

Sample I.D.: MW-5 Laboratory: (STL) Other: _____

Analyzed for: (TPH-G BTEX MTBE) YPH-D Other: _____

EB I.D. (if applicable): _____ @ _____ Time Duplicate I.D. (if applicable): _____

Analyzed for: TPH-G BTEX MTBE TPH-D Other: _____

D.O. (if req'd):	<u>(Pre-purge:)</u> <u>0.4</u> mg/L	<u>(Post-purge:)</u> <u>0.4</u> mg/L
O.R.P. (if req'd):	Pre-purge: _____ mV	Post-purge: _____ mV

SHELL WELL MONITORING DATA SHEET

BTS #: <u>031008-BA1</u>	Site: <u>1285 Bancroft Ave, San Leandro</u>
Sampler: <u>Brian Alcorn</u>	Date: <u>10/8/03</u>
Well I.D.: <u>MW-6</u>	Well Diameter: <u>(2)</u> 3 4 6 8 _____
Total Well Depth (TD): <u>49.94</u>	Depth to Water (DTW): <u>37.57</u>
Depth to Free Product:	Thickness of Free Product (feet):
Referenced to: <u>(PVC)</u> Grade	D.O. Meter (if req'd): <u>(YSI)</u> HACH
DTW with 80% Recharge [(Height of Water Column x 0.20) + DTW]: <u>40.04</u>	

Purge Method: <u>(Bailer)</u> Disposable Bailer Positive Air Displacement Electric Submersible	Waterra Peristaltic Extraction Pump Other _____	Sampling Method: <u>(Bailer)</u> Disposable Bailer Extraction Port Dedicated Tubing Other: _____
---	--	--

<u>2.0</u> (Gals.) X	<u>3</u>	= <u>6.0</u> Gals.
1 Case Volume	Specified Volumes	Calculated Volume

Well Diameter	Multiplier	Well Diameter	Multiplier
1"	0.04	4"	0.65
2"	0.16	6"	1.47
3"	0.37	Other	radius ² * 0.163

Time	Temp (°F)	pH	Cond (mS or <u>(µS)</u>)	Turbidity (NTUs)	Gals. Removed	Observations
1116	64.3	6.4	736	>1,000	2.0	cloudy, gray, odor
1119	64.6	6.4	778	>1,000	4.0	"
1122	64.7	6.4	801	>1,000	6.0	"

Did well dewater? Yes <u>(No)</u>	Gallons actually evacuated: <u>6.0</u>	
Sampling Date: <u>10/8/03</u>	Sampling Time: <u>1125</u>	Depth to Water: <u>38.00</u>
Sample I.D.: <u>MW-6</u>	Laboratory: <u>(STL)</u> Other _____	
Analyzed for: <u>(TPH-G BTEX MTBE)</u> TPH-D Other:		
EB I.D. (if applicable): _____ @ _____ Time	Duplicate I.D. (if applicable):	
Analyzed for: TPH-G BTEX MTBE TPH-D Other:		
D.O. (if req'd): <u>(Pre-purge:)</u> <u>0.5</u> mg/L	<u>(Post-purge:)</u> <u>0.6</u> mg/L	
O.R.P. (if req'd): Pre-purge: _____ mV	Post-purge: _____ mV	

SHELL WELL MONITORING DATA SHEET

BTS #: 031008-BA1	Site: 1285 Bancroft Ave, San Leandro
Sampler: Brian Alcorn	Date: 10/8/03
Well I.D.: MW-7	Well Diameter: (2) 3 4 6 8
Total Well Depth (TD): 50.10	Depth to Water (DTW): 38.37
Depth to Free Product:	Thickness of Free Product (feet):
Referenced to: (PVC) Grade	D.O. Meter (if req'd): (YSI) HACH
DTW with 80% Recharge [(Height of Water Column x 0.20) + DTW]: 40.72	

Purge Method: (Bailer) Water: Sampling Method: (Bailer)

Disposable Bailer Peristaltic Disposable Bailer

Positive Air Displacement Extraction Pump Extraction Port

Electric Submersible Other _____ Dedicated Tubing

Other: _____

$2.0 \text{ (Gals.)} \times 3 = 6.0 \text{ Gals.}$	<table border="1" style="width: 100%; border-collapse: collapse;"> <thead> <tr> <th>Well Diameter</th> <th>Multiplier</th> <th>Well Diameter</th> <th>Multiplier</th> </tr> </thead> <tbody> <tr> <td>1"</td> <td>0.04</td> <td>4"</td> <td>0.65</td> </tr> <tr> <td>2"</td> <td>0.16</td> <td>6"</td> <td>1.47</td> </tr> <tr> <td>3"</td> <td>0.37</td> <td>Other</td> <td>radius² * 0.163</td> </tr> </tbody> </table>	Well Diameter	Multiplier	Well Diameter	Multiplier	1"	0.04	4"	0.65	2"	0.16	6"	1.47	3"	0.37	Other	radius ² * 0.163
Well Diameter	Multiplier	Well Diameter	Multiplier														
1"	0.04	4"	0.65														
2"	0.16	6"	1.47														
3"	0.37	Other	radius ² * 0.163														
I Case Volume Specified Volumes Calculated Volume																	

Time	Temp (°F)	pH	Cond. (mS or (µS))	Turbidity (NTUs)	Gals. Removed	Observations
1043	64.4	6.5	580	>1,000	2.0	cloudy brown
1045	64.8	6.4	583	>1,000	4.0	"
1047	65.2	6.4	581	>1,000	6.0	"

Did well dewater? Yes (No) Gallons actually evacuated: 6.0

Sampling Date: 10/8/03 Sampling Time: 1050 Depth to Water: 38.36

Sample I.D.: MW-7 Laboratory: (STL) Other _____

Analyzed for: (TPH-G BTEX MTBE) TPH-D Other: _____

EB I.D. (if applicable): _____ @ _____ Time Duplicate I.D. (if applicable): _____

Analyzed for: TPH-G BTEX MTBE TPH-D Other: _____

D.O. (if req'd): (Pre-purge: 1.7) ^{mg/L}	(Post-purge: 1.8) ^{mg/L}
O.R.P. (if req'd): Pre-purge: _____ mV	Post-purge: _____ mV

SHELL WELL MONITORING DATA SHEET

BTS #: <u>031008-BA1</u>	Site: <u>1285 Bancroft Ave, San Leandro</u>
Sampler: <u>Brian Alcorn</u>	Date: <u>10/8/03</u>
Well I.D.: <u>MW-8</u>	Well Diameter: (2) <u>3</u> 4 6 8 _____
Total Well Depth (TD): <u>50.09</u>	Depth to Water (DTW): <u>37.58</u>
Depth to Free Product:	Thickness of Free Product (feet):
Referenced to: <u>(PVC)</u> Grade	D.O. Meter (if req'd): <u>(YSI)</u> HACH
DTW with 80% Recharge [(Height of Water Column x 0.20) + DTW]: <u>40.08</u>	

Purge Method: <u>(Bailer)</u> Disposable Bailer Positive Air Displacement Electric Submersible	Water: _____ Peristaltic Extraction Pump Other _____	Sampling Method: <u>(Bailer)</u> Disposable Bailer Extraction Port Dedicated Tubing Other: _____
---	---	--

Well Diameter	Multiplier	Well Diameter	Multiplier
1"	0.04	4"	0.65
2"	0.16	6"	1.47
3"	0.37	Other	radius ² * 0.163

<u>2.0</u> (Gals.) X	<u>3</u>	=	<u>6.0</u> Gals.
I Case Volume	Specified Volumes		Calculated Volume

Time	Temp (°F)	pH	Cond. (mS or (µS)	Turbidity (NTUs)	Gals. Removed	Observations
<u>1005</u>	<u>64.1</u>	<u>6.3</u>	<u>550</u>	<u>>1,000</u>	<u>2.0</u>	<u>cloudy brown</u>
<u>1009</u>	<u>64.4</u>	<u>6.3</u>	<u>549</u>	<u>>1,000</u>	<u>4.0</u>	<u>"</u>
<u>1013</u>	<u>64.3</u>	<u>6.4</u>	<u>548</u>	<u>>1,000</u>	<u>6.0</u>	<u>"</u> <u>STW</u> <u>37.72</u>

Did well dewater? Yes (No) Gallons actually evacuated: 6.0

Sampling Date: 10/8/03 Sampling Time: 1015 Depth to Water: 37.72 TRAFFIC WELL

Sample I.D.: MW-8 Laboratory: (STL) Other _____

Analyzed for: (TPH-G BTEX MTBE) TPH-D Other: _____

EB I.D. (if applicable): _____ @ _____ Time Duplicate I.D. (if applicable): _____

Analyzed for: TPH-G BTEX MTBE TPH-D Other: _____

D.O. (if req'd): (Pre-purge:) 0.6 mg/L (Post-purge:) 0.7 mg/L

O.R.P. (if req'd): Pre-purge: _____ mV Post-purge: _____ mV

SHELL WELL MONITORING DATA SHEET

BTS #: 031008-BA1	Site: 1285 Bancroft Ave, San Leandro
Sampler: Brian Alcorn	Date: 10/8/03
Well I.D.: IW-1	Well Diameter: 2 3 4 6 (8)
Total Well Depth (TD): —	Depth to Water (DTW): 35.75
Depth to Free Product:	Thickness of Free Product (feet):
Referenced to: (PVC) Grade	D.O. Meter (if req'd): (YSI) HACH
DTW with 80% Recharge [(Height of Water Column x 0.20) + DTW]:	

Purge Method: Bailer Waterra Sampling Method: (Bailer)
 Disposable Bailer Peristaltic Disposable Bailer
 Positive Air Displacement (Extraction Pump) Extraction Port
 Electric Submersible Other: Spicket + Garden Hose in Shed Dedicated Tubing
 Other: Spicket in Shed

15 Minute Purge

(Gals.) X _____ = _____ Gals.	<table border="1" style="width: 100%; border-collapse: collapse;"> <tr> <th>Well Diameter</th> <th>Multiplier</th> <th>Well Diameter</th> <th>Multiplier</th> </tr> <tr> <td>1"</td> <td>0.04</td> <td>4"</td> <td>0.65</td> </tr> <tr> <td>2"</td> <td>0.16</td> <td>6"</td> <td>1.47</td> </tr> <tr> <td>3"</td> <td>0.37</td> <td>Other</td> <td>radius² * 0.163</td> </tr> </table>	Well Diameter	Multiplier	Well Diameter	Multiplier	1"	0.04	4"	0.65	2"	0.16	6"	1.47	3"	0.37	Other	radius ² * 0.163
Well Diameter	Multiplier	Well Diameter	Multiplier														
1"	0.04	4"	0.65														
2"	0.16	6"	1.47														
3"	0.37	Other	radius ² * 0.163														
1 Case Volume Specified Volumes Calculated Volume																	

Time	Temp (°F)	pH	Cond. (mS or μS)	Turbidity (NTUs)	Gals. Removed	Observations
0925					5 minutes	DTW = 36.08
0930					10 minutes	36.05
0935					15 minutes	36.11
0940	63.5	6.2	579	52	—	clear

Did well dewater? Yes (No) Gallons actually evacuated: N/A

Sampling Date: 10/8/03 Sampling Time: 0940 Depth to Water: 36.11

Sample I.D.: IW-1 Laboratory: (STL) Other _____

Analyzed for: (TPH-G) BTEX MTBE TPH-D Other:

EB I.D. (if applicable): @ _____ Time Duplicate I.D. (if applicable):

Analyzed for: TPH-G BTEX MTBE TPH-D Other:

D.O. (if req'd): Pre-purge: (3.8) mg/L Post-purge: (4.8) mg/L

O.R.P. (if req'd): Pre-purge: _____ mV Post-purge: _____ mV