

# Campus Map

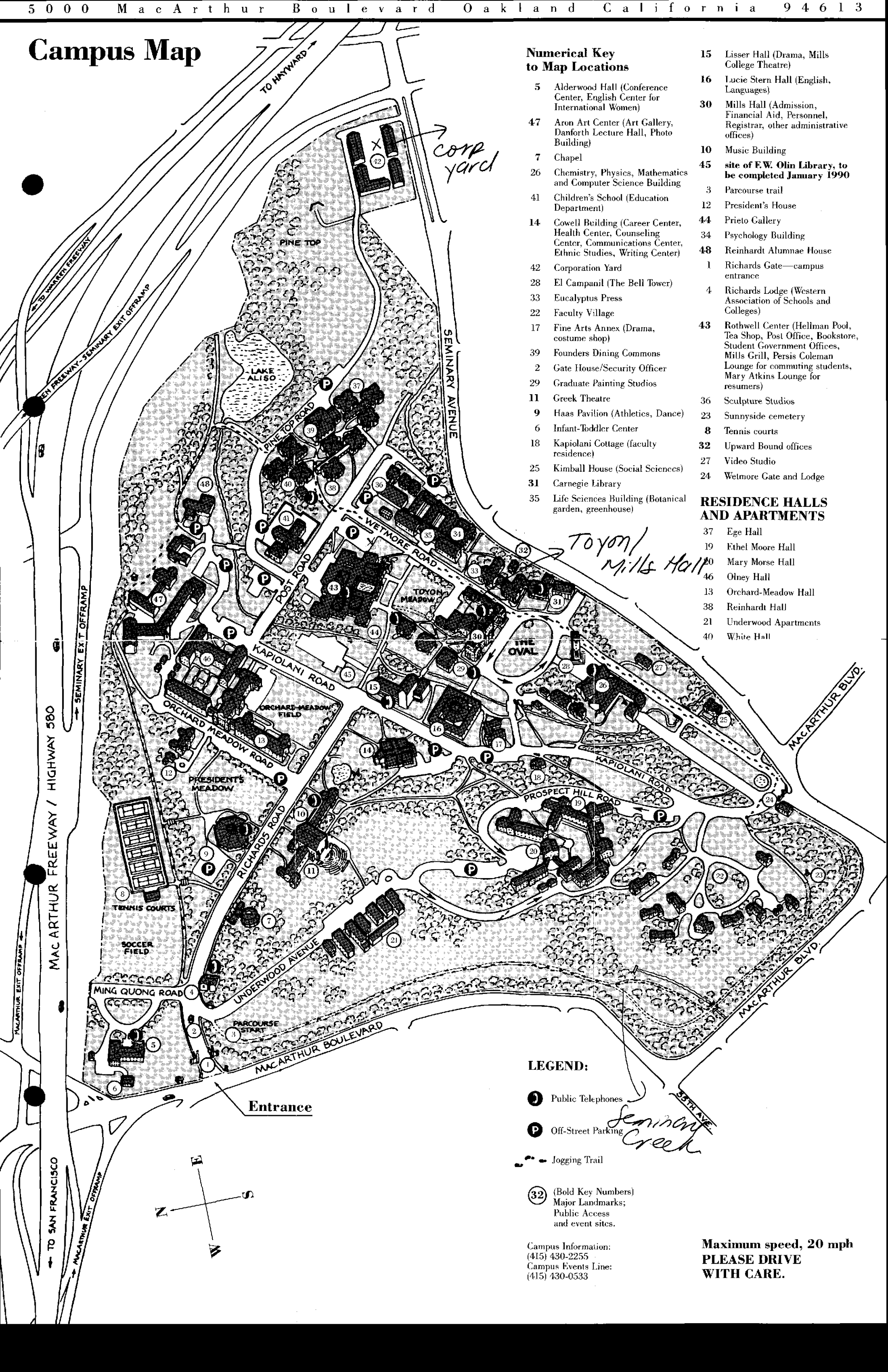

## Numerical Key to Map Locations

- 5 Alderwood Hall (Conference Center, English Center for International Women)
- 47 Aron Art Center (Art Gallery, Danforth Lecture Hall, Photo Building)
- 7 Chapel
- 26 Chemistry, Physics, Mathematics and Computer Science Building
- 41 Children's School (Education Department)
- 14 Cowell Building (Career Center, Health Center, Counseling Center, Communications Center, Ethnic Studies, Writing Center)
- 42 Corporation Yard
- 28 El Campanil (The Bell Tower)
- 33 Eucalyptus Press
- 22 Faculty Village
- 17 Fine Arts Annex (Drama, costume shop)
- 39 Founders Dining Commons
- 2 Gate House/Security Officer
- 29 Graduate Painting Studios
- 11 Greek Theatre
- 9 Haas Pavilion (Athletics, Dance)
- 6 Infant-Toddler Center
- 18 Kapiolani Cottage (faculty residence)
- 25 Kimball House (Social Sciences)
- 31 Carnegie Library
- 35 Life Sciences Building (Botanical garden, greenhouse)

- 15 Lisser Hall (Drama, Mills College Theatre)
- 16 Lucie Stern Hall (English, Languages)
- 30 Mills Hall (Admission, Financial Aid, Personnel, Registrar, other administrative offices)
- 10 Music Building
- 45 **site of F.W. Olin Library, to be completed January 1990**
- 3 Parcourse trail
- 12 President's House
- 44 Prieto Gallery
- 34 Psychology Building
- 48 Reinhardt Alumnae House
- 1 Richards Gate—campus entrance
- 4 Richards Lodge (Western Association of Schools and Colleges)
- 43 Rothwell Center (Hellman Pool, Tea Shop, Post Office, Bookstore, Student Government Offices, Mills Grill, Persis Coleman Lounge for commuting students, Mary Atkins Lounge for resurers)
- 36 Sculpture Studios
- 23 Sunnyside cemetery
- 8 Tennis courts
- 32 Upward Bound offices
- 27 Video Studio
- 24 Wetmore Gate and Lodge

## RESIDENCE HALLS AND APARTMENTS

- 37 Ege Hall
- 19 Ethel Moore Hall
- 20 Mary Morse Hall
- 46 Olney Hall
- 13 Orchard-Meadow Hall
- 38 Reinhardt Hall
- 21 Underwood Apartments
- 40 White Hall

## LEGEND:

- (J)** Public Telephones
- (P)** Off-Street Parking
- (- - -)** Jogging Trail

**(32)** (Bold Key Numbers) Major Landmarks; Public Access and event sites.

Campus Information: (415) 430-2255  
 Campus Events Line: (415) 430-0533

**Maximum speed, 20 mph  
 PLEASE DRIVE WITH CARE.**

**Entrance**

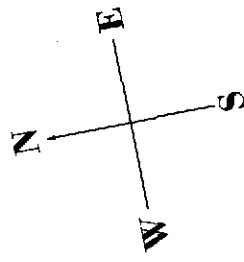



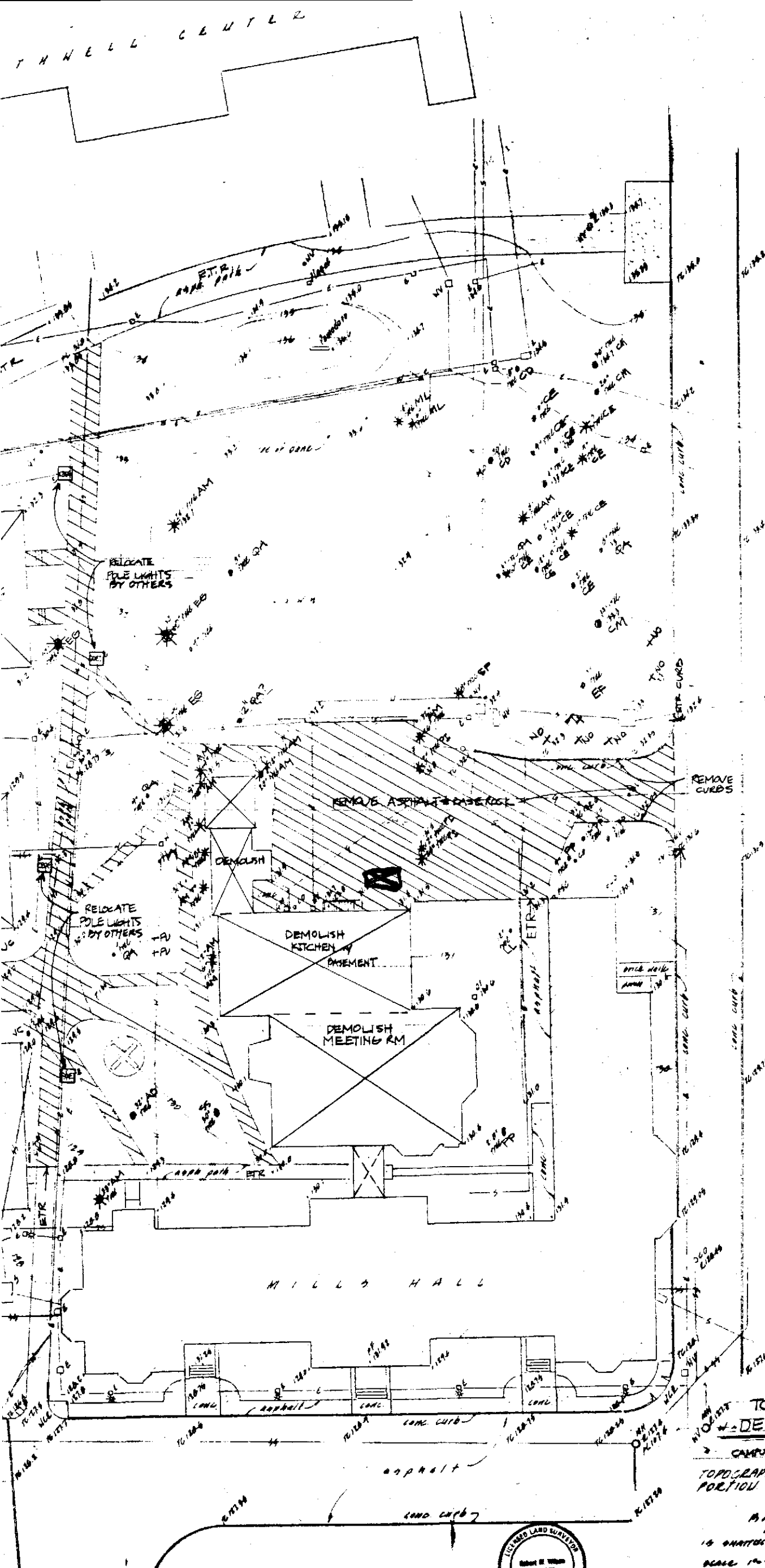

☒ = TANK

NOTES

1. ETR - EXISTING TO REMAIN
2. \* TREES - REMOVE w/ TOPPER GRIND OUT STUMP
3. ☒ TREES - CUT TO GROUND LEAVE STUMP

TOYON MEADOW  
DEMOLITION PLAN

CAMPUS FACILITIES - 20 MAR 88 REV 01/20  
 TOPOGRAPHIC SURVEY OF  
 PORTION OF MILLS COLLEGE, OAKLAND

MATEL AND MAILEY  
 LAND SURVEYORS  
 15 SHATTUCK SQUARE BERKELEY CA 94704  
 SCALE 1"=50' JAN 1988 JOB NO 17000  
 SHEET 1 OF 1



EXISTING PLANT LIST

AA	AILANTHUS ALTISSIMA
AB	ARALGARIA ARALICANA
AM	ACER MACROPHYLLUM
AMK	ACACIA MELANOCYDON
AR	ALNUS RUBRA
ARU	ARBUTUS UNDOO
CD	CEDEUS DEODARA
CB	CASURINA EQUISETIFOLIA
CM	CUPRESSUS MACROCARPA
EP	EUCALYPTUS PICIFOLIA
EG	E. GLOBULUS
JC	JUNIPERUS CALIFORNICA
LE	LEPTOSPERMUM LABURNATUM
LE	MELALEUCA LINARIFOLIA
NO	NERIUM OLEANDER
PC	PHOENIX CANARIENSIS
PE	PITOSPORUM EUGENIODES
PI	POPULUS ITALICA NIGRA
PP	PRUNUS PISSARDII
PT	PITOSPORUM TODARA
Q	QUERCUS UNDULATUM
QA	QUERCUS ADRIPOLIA
SP	SYZYGIUM PANGULATUM
SS	SEQUOIA SEMPERVIRENS

Campus Map is attached to show property line.

Scale: 1" = 80'

RAPIDOLI ROAD

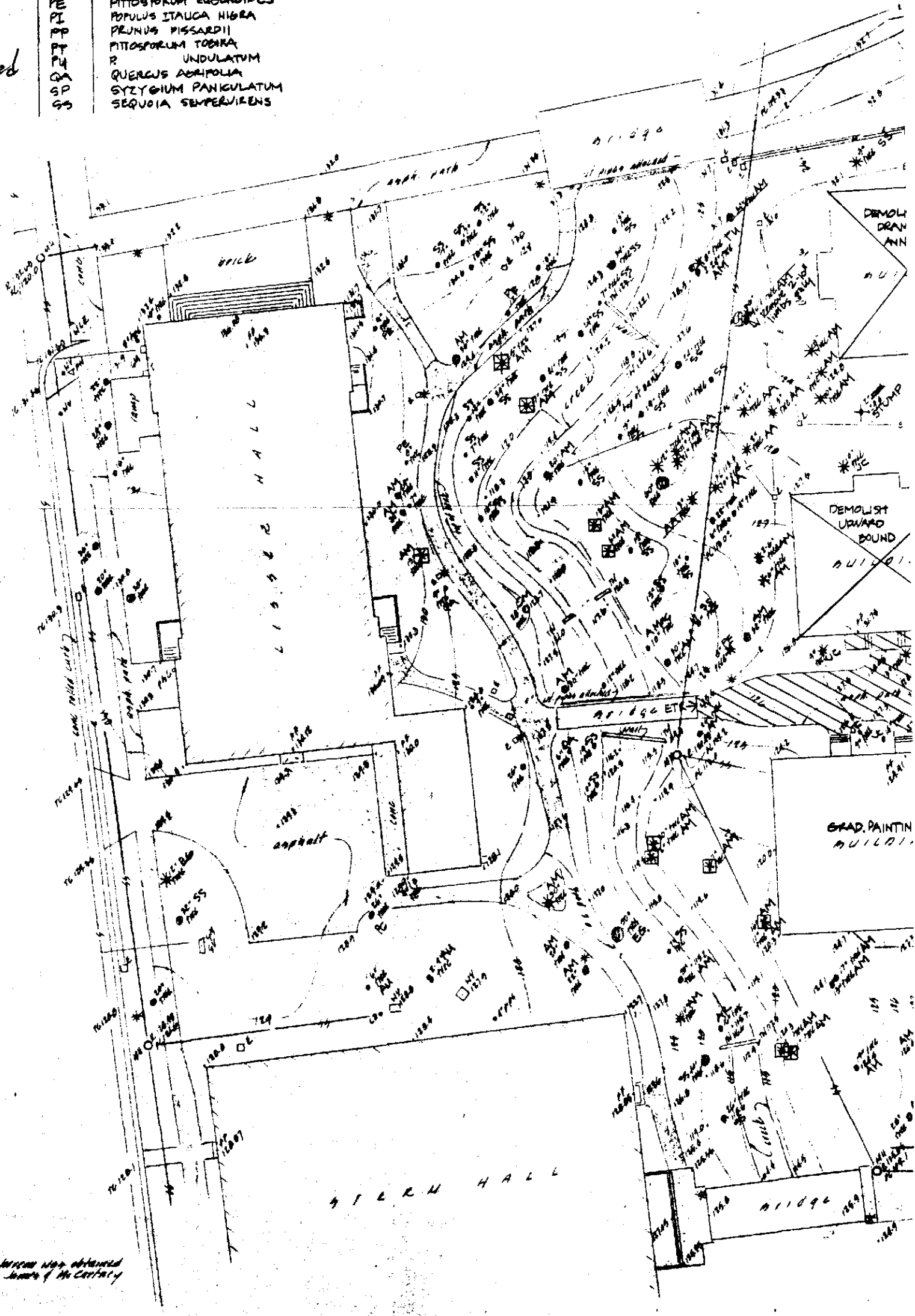

NOTE  
Location of utility lines shown herein was obtained from information furnished by James H. McCarty Engineering, Inc.