

20154

ASSESSOR'S MAP 30

Code Area Nos. 17-001

FREMONT TRACT (Bk. 26 Pg. 14) LOCKE TRACT (Bk. 24 Pg. 77) KEY ROUTE HEIGHTS (Bk. 25 Pg. 17)
POTTERS ADDITION TO VALLEY VIEW (Bk. 25 Pg. 20) SUTER TRACT (Bk. 13 Pg. 51)
QUIGLEY-SUBDIVISION OF PORTION (Bk. 4 Pg. 36) P.M. 3407 125/47

1981

Scale 1" = 100'

Dimensions: 3-20-70 H.N. Method: 2-28-2018
6-15-2017 ICR
8-1-2017
9-31-2017
11-30-2017

Permitted: Ch. 30 - Bks. 1916, 1919 B. Bk. 31 - Bks. 1959, 1964, 1965, 1996, 1997, 1999, 2000, 2006
(Am.)

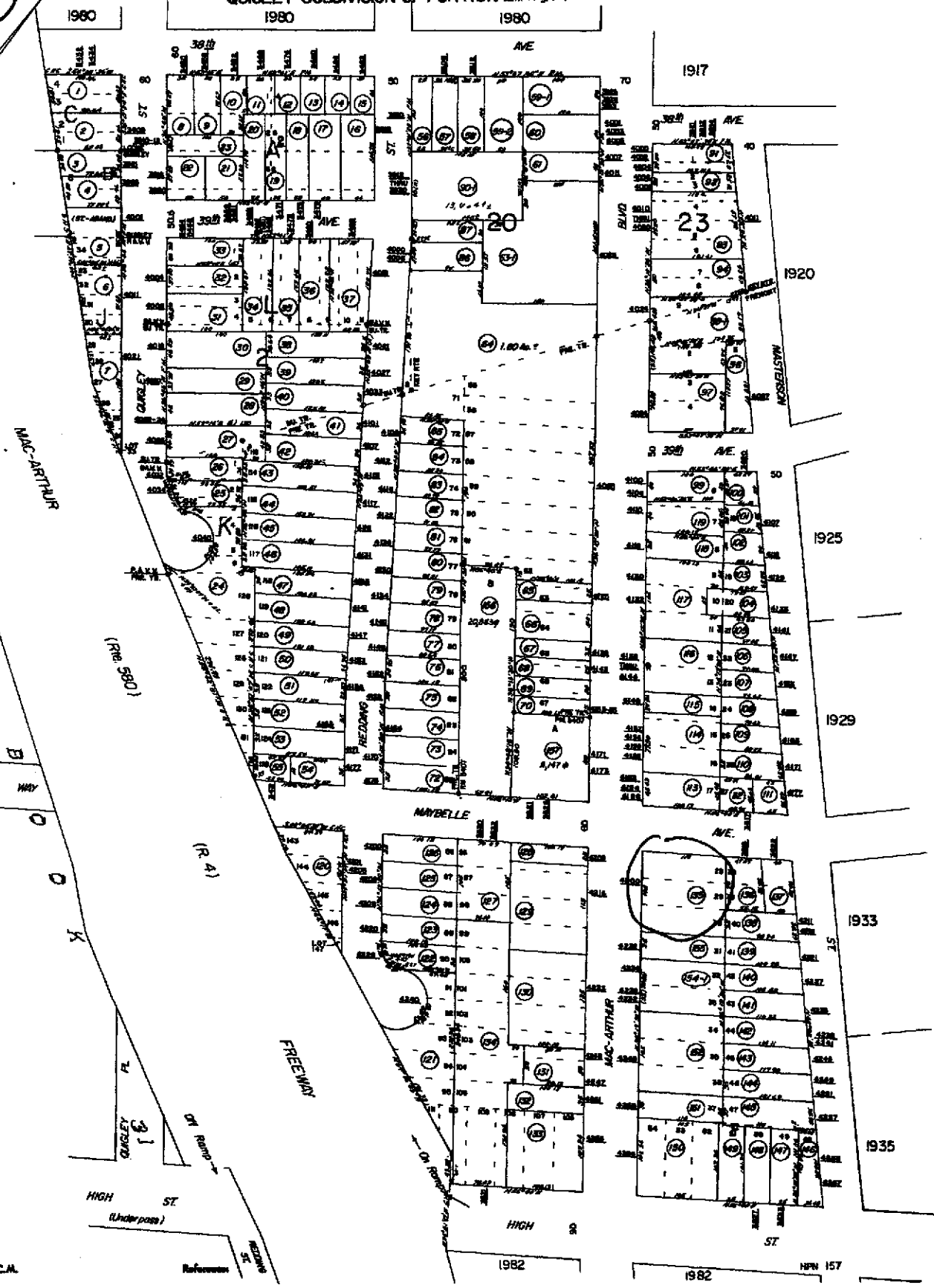

ACA

Reference

HPN 157

RO 154.



COUNTY OF ALAMEDA
Assessor's Office

Property Value System

History

Value

Transfer

[New Query](#)

Parcel Number: 30-1981-135 Lien Date: 01/01/2005 Owner: NICOLA RONALD S & NANCY R TRS & NICK S JR

Property Address: 4200 MACARTHUR BLVD , OAKLAND, CA 94619-1908

Economic Unit

Mailing Name	Mailing Address	Document Date	Document Number	Value From Trans Tax	Parcel Count	Use
NICOLA RONALD S & NANCY R TRS & NICK S JR c/o CSK AUTO INC	645 E MISSOURI AVE # 400, PHOENIX, AZ 85012	03/01/1991	1991-56784		3	3100
NICOLA RONALD S & NANCY R & NICK S JR	2020 BLACKWOOD DR , WALNUT CREEK, CA 94596-5709	02/05/1991	1991-33180		3	3100
NICOLA NICK S JR & RONALD S c/o NO AUTOMOTIVE CORP	PO BOX 6030 , PHOENIX, AZ 85005	06/26/1987	1987-181166		3	3100
NICOLA NICK S JR & RONALD S	347 14TH ST , OAKLAND, CA 94612-3906	05/01/1987	TRAN-232483		1	3100
NICOLA NICK S JR & RONALD S	347 14TH ST , OAKLAND, CA 94612-3906	01/19/1978	1978-11397	\$68,000	1	3100
NICOLA HELEN E	4200 MACARTHUR BLVD , OAKLAND, CA 94619-1908	01/14/1975	1975-4680		4	3100
LYON SAM	4200 MACARTHUR BLVD , OAKLAND, CA 94619-1908	03/25/1960	AR-34530		3	3100

All information on this site is to be assumed accurate for property assessment purposes only, and is based upon the Assessor's knowledge of each property. Caution is advised for use other than its intended purpose.

The Alameda County Intranet site is best viewed in Internet Explorer Version 5.5 or later.
 Click [here](#) for more information regarding supported browsers.

Copyright © 2001 Alameda County

Property Detail**Alameda, CA RON THOMSEN, ASSESSOR**

Parcel # (APN): 030 -1981-135-00 Use Description:

Parcel Status:

Owner Name: NICOLA RONALD S & NICK S JR

Mailing Address: 645 E MISSOURI AV #400 PHOENIX AZ 85012-5709

Situs Address: 4200 MACARTHUR BL OAKLAND CA 94619

Legal

Description:

ASSESSMENT

Total Value: \$490,031	Use Code: 311	Zoning:
Land Value: \$256,804	Tax Rate Area: 17001	
Impr Value: \$233,227	Year Assd: 2003	Improve Type:
Other Value:	Property Tax:	Price/SqFt:
% Improved 48%	Delinquent Yr	
Exempt Amt:	HO Exempt?: N	

SALES HISTORY

	<u>Sale 1</u>	<u>Sale 2</u>	<u>Sale 3</u>	<u>Transfer</u>
Recording Date:	05/01/1987	01/19/1978		03/01/1991
Recorded Doc #:	87 999999	78 011397		91 056784
Recorded Doc Type:				
Transfer Amount:		\$68,000		
Sale 1 Seller (Grantor):				
1st Trst Dd Amt:	Code1:	2nd Trst Dd Amt:	Code2:	

PROPERTY CHARACTERISTICS

Lot Acres: 0.270	Year Built:	Fireplace:
Lot SqFt: 11,550	Effective Yr: 1990	A/C:
Bldg/Liv Area: 5,225		Heating:
Units: 1	Total Rooms:	Pool:
Buildings: 1	Bedrooms:	
Stories: 1.0	Baths (Full):	Park Type:
Style:	Baths (Half):	Spaces:
Construct:		Site Infince:
Quality: 6.0	Garage SqFt:	
Building Class: S		Timber Preserve:
Condition:		Ag Preserve:
Other Rooms:		