

795

PAGE 4.

MAP OF VERNON TERRACE TRACT. (Bk. 29 Pg. 67)

Scale: 1" = 40'

795  
Page 3.

REV. 9-14-57 L.S.

Revised 9-14-57 L.S.

798

HARRISON STREET

VERNON TERRACE

769

VERNON STREET

27-1  
2.18 Ac ±

769

BAY PLACE  
768

BOOK 8  
570

HARRISON STREET

HPN 129

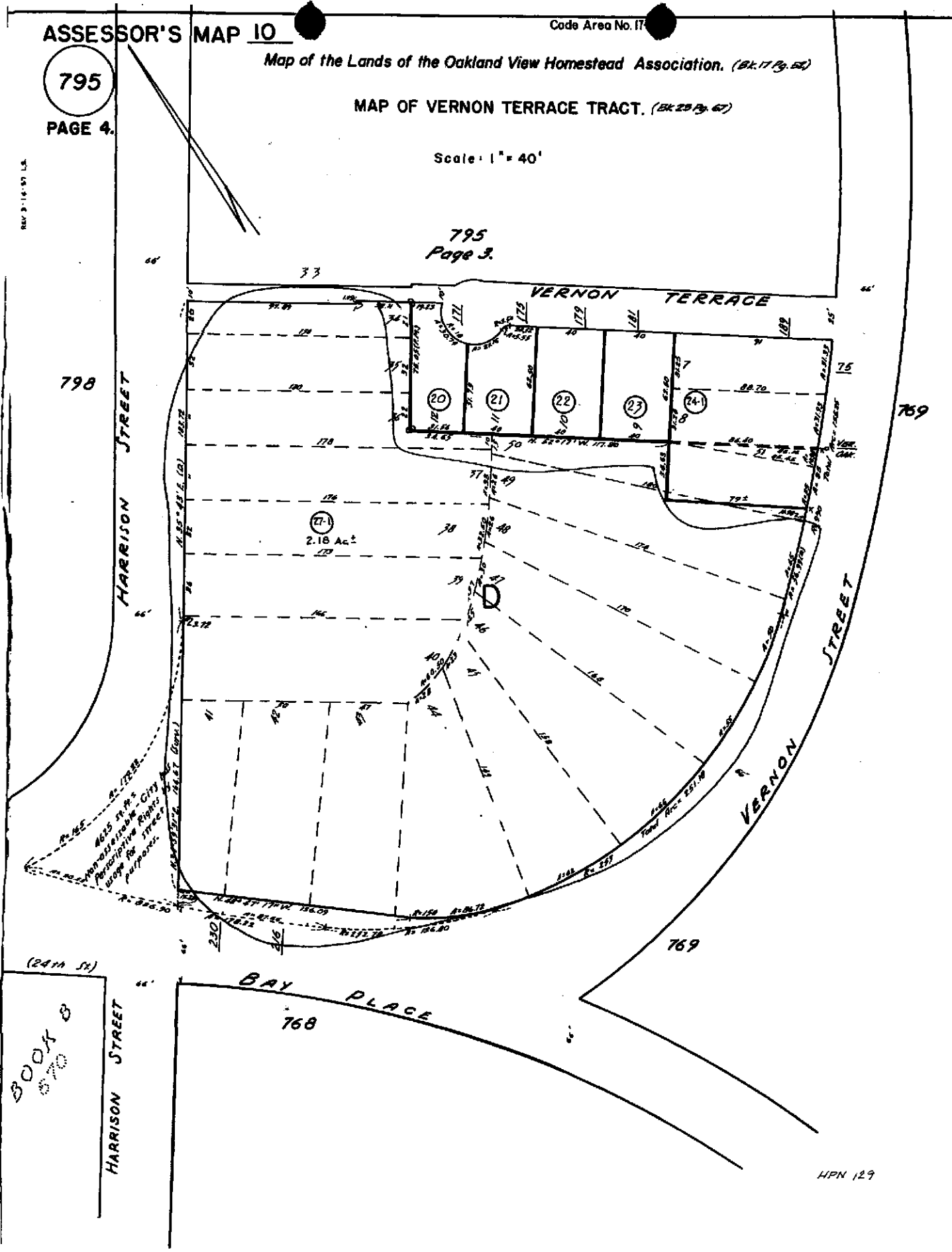

**Property Detail**

**Alameda, CA RON THOMSEN, ASSESSOR**

Parcel # (APN): 010 -0795-027-01 Use Description:

Parcel Status:

Owner Name: BOND CC OAKLAND LLC

Mailing Address: 3579 VALLEY CENTRE DR SAN DIEGO CA 92130-3302

Situs Address: 230 BAY PL OAKLAND CA 94612

Legal

Description:

**ASSESSMENT**

Total Value: \$2,601,000	Use Code: 820	Zoning:
Land Value: \$1,580,680	Tax Rate Area: 17001	
Impr Value: \$1,020,320	Year Assd: 2003	Improve Type:
Other Value:	Property Tax:	Price/SqFt:
% Improved 39%	Delinquent Yr	
Exempt Amt:	HO Exempt?: N	

**SALES HISTORY**

	<u>Sale 1</u>	<u>Sale 2</u>	<u>Sale 3</u>	<u>Transfer</u>
Recording Date:	10/08/2003	08/22/2000	04/22/1998	10/08/2003
Recorded Doc #:	03 597341	00 253099	98 134697	03 597341
Recorded Doc Type:				
Transfer Amount:				
Sale 1 Seller (Grantor):				
1st Trst Dd Amt:	Code1:	2nd Trst Dd Amt:	Code2:	

**PROPERTY CHARACTERISTICS**

Lot Acres: 2.180	Year Built: 1915	Fireplace:
Lot SqFt: 94,961	Effective Yr: 1928	A/C:
Bldg/Liv Area: 45,309		Heating:
Units:	Total Rooms:	Pool:
Buildings: 1	Bedrooms:	
Stories: 1.0	Baths (Full):	Park Type:
Style:	Baths (Half):	Spaces:
Construct:		Site Inflnce:
Quality: 6.5	Garage SqFt:	
Building Class: C		Timber Preserve:
Condition:		Ag Preserve:
Other Rooms:		

\*\*\* The information provided here is deemed reliable, but is not guaranteed.

Ro 148



COUNTY OF ALAMEDA  
**Assessor's Office**

**Property Value System**

**History**

**Value**

**Transfer**

New Query

Parcel Number: **10-795-27-1** Lien Date: **01/01/2005** Owner: **BOND CC OAKLAND LLC**

Property Address: **230 BAY PL , OAKLAND, CA 94612-3805**

Mailing Address as of 12/20/2004: **BOND CC OAKLAND LLC, c/o BOND CC OAKLAND, LLC, Attn: BOND COMPANIES, 350 W HUBBARD STE 450, CHICAGO, IL 60610**

Mailing Name	Mailing Address	Document Date	Document Number	Value From Trans	Parcel Count	Use Tax
BOND CC OAKLAND LLC c/o GRANT PULEO ESQ	3579 VALLEY CENTRE DR , SAN DIEGO, CA 92130-3302	10/08/2003	2003-597341		1	<u>8200</u>
KESTREL PARTNERS LLC c/o ARNOLD E BROWN	4457 WILLOW RD STE 102, PLEASANTON, CA 94588-8554	10/08/2003	2003-597340		1	<u>8200</u>
230 BAY PLACE LP c/o TAX DEPT	2900 EISENHOWER AVE # 3, ALEXANDRIA, VA 22314	08/22/2000	2000-253099		1	<u>8200</u>
GREATER BAY TRUST COMPANY TR ETAL	PO BOX 1740 , PALO ALTO, CA 94302-1740	06/01/1999	1999-205903		2	<u>8200</u>
WELLS FARGO BANK NA TR c/o GREATER BAY TRUST	PO BOX 1740 , PALO ALTO, CA 94302-1740	04/22/1998	1998-134697		1	<u>8200</u>
WELLS FARGO BANK NA TR c/o H W SHEPHARD	PO BOX 63700 , SAN FRANCISCO, CA 94163- 0001	05/19/1997	1997-124483		1	<u>8200</u>
SHEPARD H W JR & WELLS FARGO BANK N A TRS c/o WELLS FARGO AU #5108	PO BOX 63700 , SAN FRANCISCO, CA 94163- 0001	12/30/1974	1974-162487		1	<u>8200</u>
SHEPARD H W INC	230 BAY PL , OAKLAND, CA 94612-3805	07/31/1973	1973-102997		1	<u>8200</u>
SHEPARD CADILLAC PONTIAC CO	230 BAY PL , OAKLAND, CA 94612-3805	03/01/1969	TRAN-8525		1	<u>8200</u>

All information on this site is to be assumed accurate for property assessment purposes only, and is based upon the Assessor's knowledge of each property. Caution is advised for use other than its intended purpose.

The Alameda County Intranet site is best viewed in Internet Explorer Version 5.5 or later.  
 Click [here](#) for more information regarding supported browsers.

Copyright © 2001 Alameda County