



Alexis Coulter
Project Manager
Marketing Business Unit

**Chevron Environmental
Management Company**
6101 Bollinger Canyon Road
San Ramon, CA 94583
Tel (925) 790-6441
acoulter@chevron.com

RECEIVED

By Alameda County Environmental Health at 9:43 am, Dec 31, 2014

Alameda County Health Care Services
1131 Harbor Bay Parkway, Suite 250
Alameda, CA 94502-6577

Re: Former Chevron Service Station No. 90200
1633 Harrison Street
Oakland, California

I have reviewed the attached report titled *Well Destruction Report*

I agree with the conclusions and recommendations presented in the referenced report. The information in this report is accurate to the best of my knowledge and all local Agency/Regional Board guidelines have been followed. This report was prepared by Conestoga-Rovers & Associates, upon whose assistance and advice I have relied.

This letter is submitted pursuant to the requirements of California Water Code Section 13267(b)(1) and the regulating implementation entitled Appendix A pertaining thereto.

I declare under penalty of perjury that the foregoing is true and correct to the best of my knowledge.

Sincerely,

A handwritten signature in blue ink that reads "Alex Coulter".

Alexis Coulter
Project Manager

Attachment: *Well Destruction Report*



**CONESTOGA-ROVERS
& ASSOCIATES**

5900 Hollis Street, Suite A
Emeryville, California 94608
Telephone: (510) 420-0700 Fax: (510) 420-9170
<http://www.craworld.com>

December 29, 2014

Reference No. 311956

Mr. Mark Detterman, P.G., C.E.G.
Alameda County Environmental Health
1131 Harbor Bay Parkway, Suite 250
Alameda, California 94502-6577

Re: **Well Destruction Report**
Former Chevron Service Station 90020
1633 Harrison Street
Oakland, California
Case No. RO0000143

Dear Mr. Detterman:

Conestoga-Rovers & Associates (CRA) is submitting this *Well Destruction Report* for the site referenced above (Figure 1) on behalf of Chevron Environmental Management Company (EMC). As the final step for case closure, in accordance with the Alameda County Environmental Health (ACEH) correspondences dated May 23, 2014, August 4, 2014 and September 22, 2014 (Attachment A), remaining monitoring wells MW-9, MW-13, MW-15, MW-16, and MW-17 were destroyed as described below.

1.0 Well Destruction Activities

Permits

Well destruction was performed in general accordance with Alameda County Public Works Agency (ACPWA) water resources well permits W2014-0789 through MW2014-0793, dated August 26, 2014; and City of Oakland traffic control plan permit TSD-14-0168, obstruction permits OB1400815 and OB1400816, and excavation permits X1402411, X1402413, and X1402414. Copies of all permits are included as Attachment B.

Equal
Employment Opportunity
Employer



December 29, 2014

Reference No. 311956

- 2 -

Site Health and Safety Plan

CRA prepared a site specific health and safety plan (HASP) to protect site workers and visitors during the well destruction activities. The HASP was kept onsite, and reviewed, signed, and followed by site workers and visitors.

Underground Utility Location

CRA marked the site for Underground Service Alert (USA) clearance and notified USA prior to beginning work. On October 29 and 30, 2014, private underground utility locator, NORCAL Geophysical Consultants Inc., of Cotati, California, was contracted to identify subsurface utilities and obstructions near the wells and to confirm markings by USA.

Well Destruction

On October 29 and 30, 2014, CRA staff observed Vapor Tech Services (C-57 License No. 916085) destroy wells MW-9, MW-13, MW-15, MW-16, and MW-17 (Figure 2). As permitted by ACPWA, the wells were destroyed by pressure grouting. Pressure grouting was completed by injecting neat Portland Type II/V cement through a tremie pipe to the wells total depth. A pressure of at least 25 pounds per square inch was then applied to the well casing for at least 5 minutes. Due to the City of Oakland moratorium of work on city right-of-way from November 1, 2014 through January 1, 2015, the well boxes were not removed. The well boxes will be removed and backfilled with asphalt and roadbase to match existing surface grade once the moratorium has lifted. CRA's *Standard Field Procedures for Monitoring Well Destruction* is presented as Attachment C.

Well Completion Reports

On November 12, 2014, CRA submitted the Well Completion Reports to the Department of Water Resources (DWR) and ACPWA under a separate cover. The DWR Well Completion Reports are confidential documents and are not included in this report. Copies are maintained in our files and can be provided upon written request.

Waste Removal

No waste was generated during well destruction activities. Construction debris expected during well box removal will be transported to an appropriate disposal facility.



**CONESTOGA-ROVERS
& ASSOCIATES**

December 29, 2014

Reference No. 311956

- 3 -

2.0 Closing

All monitoring wells at the site have been destroyed which completes the case closure activities approved by ACEH (Attachment A). On behalf of EMC, CRA requests a final no further action approval letter.

Please contact Mr. Nathan Lee at (925) 849-1003 if you have any questions or need any additional information.

Regards,
CONESTOGA-ROVERS & ASSOCIATES



Nathan Lee

Nathan Lee, P.G.

OY/mws/24

Encl.



**CONESTOGA-ROVERS
& ASSOCIATES**

December 29, 2014

Reference No. 311956

- 4 -

Figure 1 Vicinity Map

Figure 2 Site Plan

Attachment A ACEH Correspondence

Attachment B Permits

Attachment C CRA's Standard Field Procedures for Well Destructutions

cc: Ms. Alexis Coulter, Chevron (*electronic copy only*)
Housing Authority of the City of Oakland

FIGURES

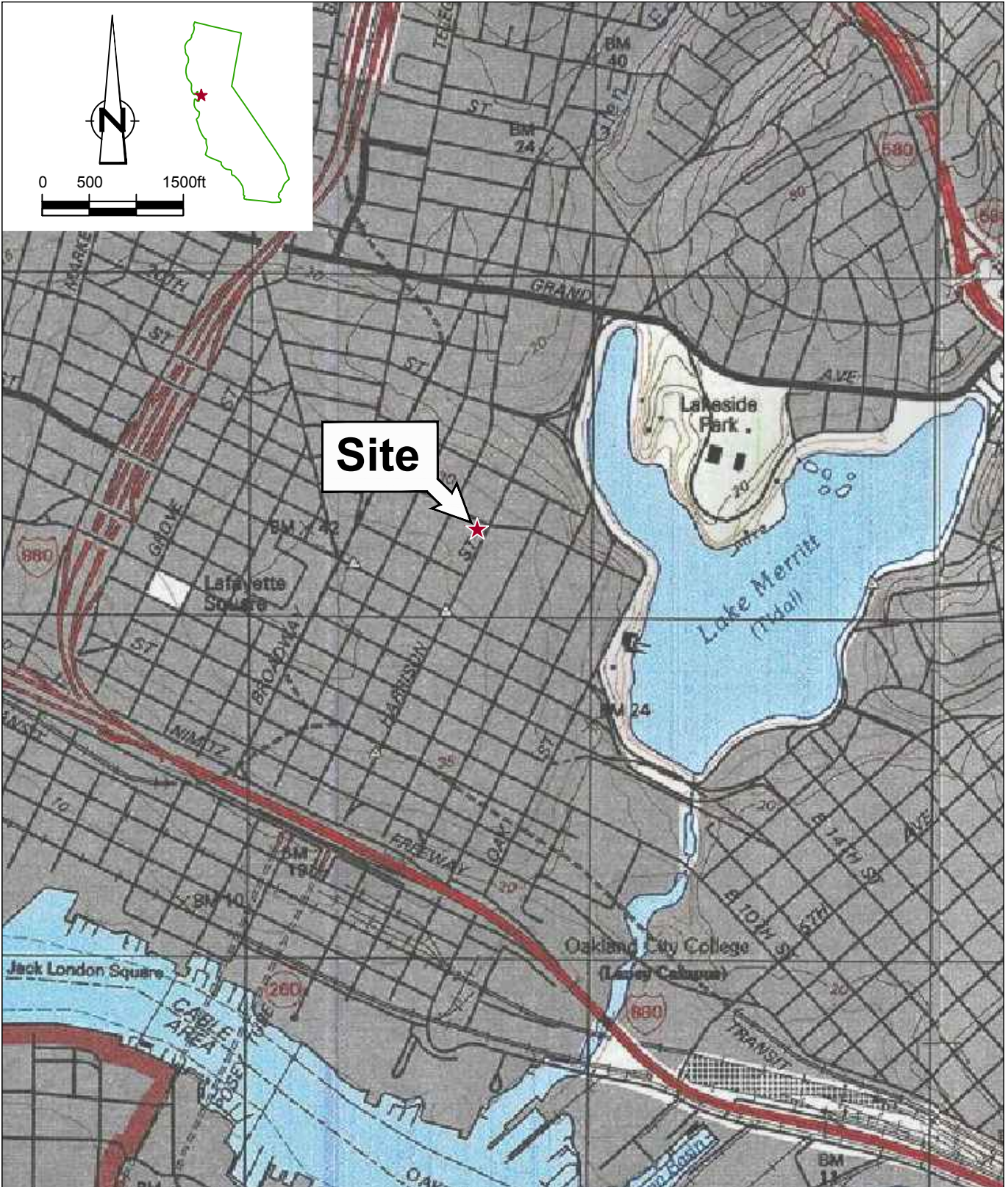

Site

Figure 1

VICINITY MAP
 FORMER CHEVRON SERVICE STATION 90020
 1633 HARRISON STREET
Oakland, California



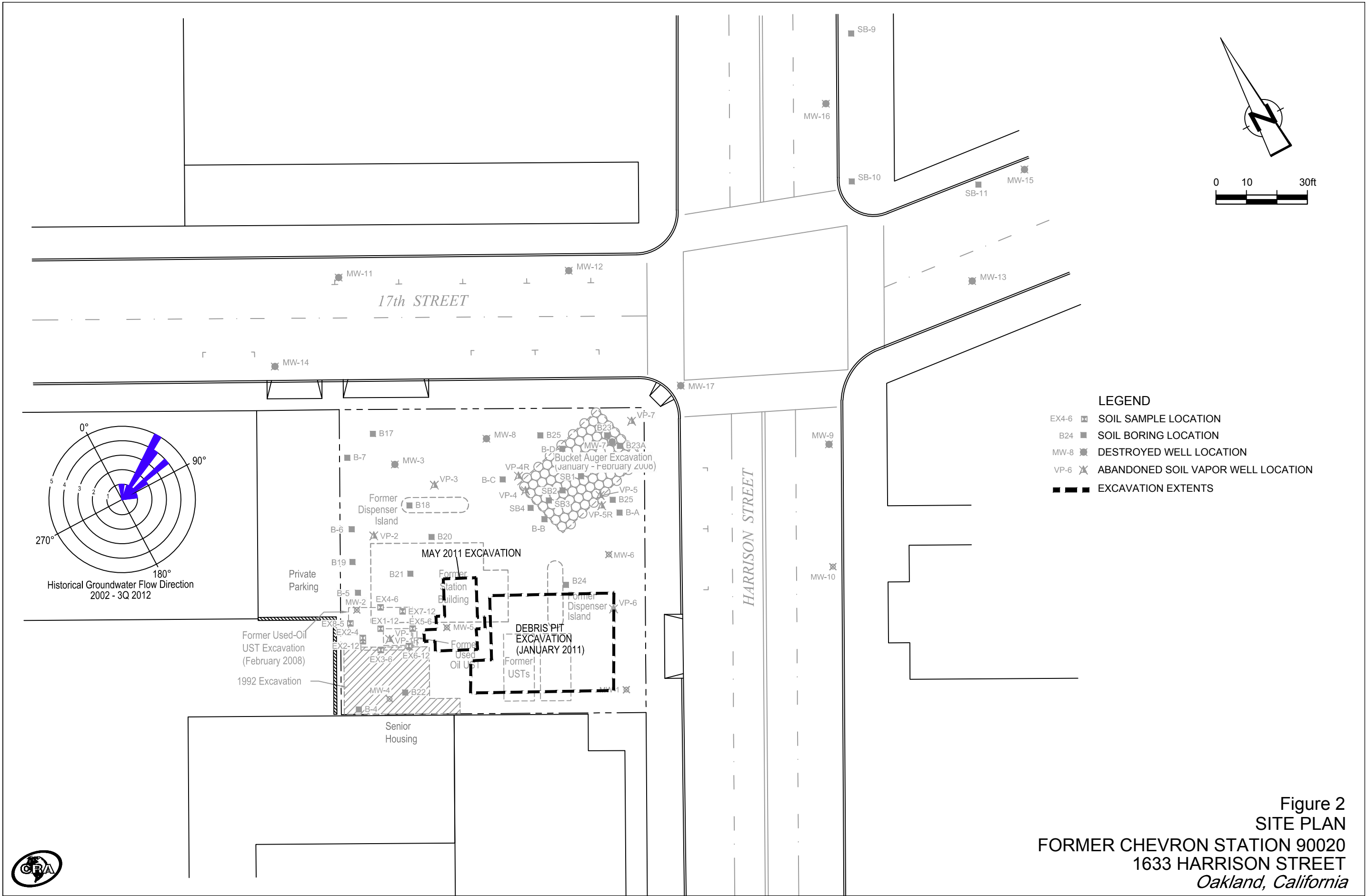

Figure 2
 SITE PLAN
 FORMER CHEVRON STATION 90020
 1633 HARRISON STREET
 Oakland, California



ATTACHMENT A
ACEH CORRESPONDENCE



ENVIRONMENTAL HEALTH SERVICES
ENVIRONMENTAL PROTECTION
1131 Harbor Bay Parkway, Suite 250
Alameda, CA 94502-6577
(510) 567-6700
FAX (510) 337-9335

May 23, 2014

Ms. Alexis Fischer
Chevron Environmental Management
6101 Bollinger Canyon Road
San Ramon, CA 94583
(Sent via electronic mail to: afischer@chevron.com)

Mr. Shadrick Small
Oakland Housing Authority
1805 Harrison Street
Oakland, CA 94612
(Sent via electronic mail to: ssmall@oakha.org)

Subject: Landowner and Public Participation Notification for Case Closure Consideration, Fuel Leak Case No. RO0000143 (Global ID # T0600100304), Chevron #9-0020, 1633 Harrison Street, Oakland, CA 94612

Dear Ms. Fischer and Mr. Small:

Alameda County Environmental Health (ACEH) staff has reviewed the case file including the *Site Conceptual Model and Low-Threat Closure Request*, dated March 28, 2014. The report was generated and submitted on your behalf by Conestoga-Rovers & Associates (CRA). Thank you for submitting the report. As you are aware, numerous site investigations and groundwater monitoring events for underground storage tank leaks have been performed at the subject property to which you are named as the primary or active responsible party. ACEH is in general agreement that the subject fuel case is suitable for potential case closure under the State Water Resource Control (SWRCB) Board Low-Threat Closure Policy.

List of Landowners Form

Pursuant to Section 25297.15 (a), Alameda County Environmental Health (ACEH), the local agency, shall not consider cleanup or site closure proposals from the primary or active responsible party, issue a closure letter, or make a determination that no further action is required with respect to a site upon which there was an unauthorized release of hazardous substances from an underground storage tank subject to this chapter unless all current record owners of fee title to the site of the proposed action have been notified of the proposed action by the primary or active responsible party. ACEH is required to notify the primary or active responsible party of their requirement to certify in writing to the local agency that the notification requirement in the above-mentioned regulation has been satisfied and to provide the local agency with a complete mailing list of all record fee title owners.

To satisfy this requirement, please complete the enclosed *List of Landowners Form*, and mail or e-mail it back to ACEH by the date identified below. Also your comments, if any, must be considered prior to the proposed closure. Please respond within 30 days from the date of this letter for your comments to be considered.

Public Participation

Public participation is a requirement for the case closure process. In order to notify potentially affected members of the public of the potential fuel leak case closure, ACEH will distribute the attached *Notification of Potential Case Closure* to addresses in the immediate vicinity. The *Invitation to Comment - Potential Case Closure* requests that landowners or residents submit any comments or questions to

ACEH regarding the potential case closure by August 1, 2014. ACEH will consider all comments from the public prior to potential case closure. ACEH will provide written notification if any comments are received.

Request for Monitoring Well Destruction Scheduling and Waste Removal

Local Oversight Programs are required by the State's Low Threat Closure Policy (LTCP) to issue a uniform closure letter within 30 days from the end of the public comment period and completion of associated tasks (report of monitoring well destruction and waste removal) for case closures. After written ACEH concurrence (e-mail or other) that there have been no comments, and provided ACEH receives the required List of Landowners Form as is described above, you would be free to proceed with well decommissioning and waste removal activities.

In order to meet this timeline ACEH requests that wells be scheduled for destruction, wastes (as defined by the LTCP) be removed from the site, and a Well Decommissioning Report and appropriate disposal documentation submitted as soon as possible after the end date of the public comment period. Please contact the Alameda County Public Works Agency at 510-567-6791 or online, to obtain the required well destruction permits. Please provide notification to ACEH of the date of planned well destruction and waste removal activities.

TECHNICAL REPORT REQUEST

Please submit the following documents to Alameda County Environmental Health (Attention: Karel Detterman), according to the following schedule:

- **June 1, 2014** – Public Comment Period Begins
- **July 7, 2014** - Return *List of Landowner Form*
File to be named: RO143_LNDOWNR_F_yyyy-mm-dd
- **August 1, 2014** – Public Comment Period Ends
- **October 3, 2014** – Complete Well Decommissioning and Waste Removal. (Please notify ACEH at least 48-hours in advance with an e-mail message to mark.detterman@acgov.org.)
- **December 1, 2014** – Well Decommissioning Report (with waste disposal documentation)
File to be named: RO143_WELL_DCM_R_yyyy-mm-dd
- **4 Weeks After Completion of All Required Submittal Tasks** – Uniform Closure Letter Issued
(Provided all required documents have been submitted)

Online case files are available for review at the following website: <http://www.acgov.org/aceh/index.htm>. Should you have any questions, please contact me at (510) 567-6876 or send me an e-mail message at mark.detterman@acgov.org.

Sincerely,



Digitally signed by Mark E. Detterman
DN: cn=Mark E. Detterman, o, ou,
email, c=US
Date: 2014.05.23 09:41:43 -07'00'

Mark Detterman, PG, CEG
Senior Hazardous Materials Specialist

Ms. Fischer and Mr. Small
RO0000143
May 23, 2014, Page 3

Enclosures: Attachment 1 – Responsible Party (ies) Legal Requirements/Obligations and
Electronic Report Upload (ftp) Instructions

Attachment 2 - *List of Landowners Form*

Attachment 3 – *Invitation to Comment - Potential Case Closure* and Mailing List

cc: Kiersten Hoey, Conestoga-Rovers & Assoc., 5900 Hollis Street, Suite A, Emeryville, CA 94608;
(sent via electronic mail to khoey@croworld.com)

Derek Wilken, Conestoga-Rovers & Assoc., 5900 Hollis Street, Suite A, Emeryville, CA 94608
(sent via electronic mail to dwilken@croworld.com)

Nathan Lee, Conestoga-Rovers & Assoc., 5900 Hollis Street, Suite A, Emeryville, CA 94608
(sent via electronic mail to nlee@croworld.com)

Dilan Roe, ACEH, (sent via e-mail to dilan.roe@acgov.org)

Mark Detterman, ACEH, (sent via e-mail mark.detterman@acgov.org)
Geotracker, Electronic File

Attachment 1

Responsible Party(ies) Legal Requirements / Obligations

REPORT REQUESTS

These reports are being requested pursuant to California Health and Safety Code Section 25296.10. 23 CCR Sections 2652 through 2654, and 2721 through 2728 outline the responsibilities of a responsible party in response to an unauthorized release from a petroleum UST system, and require your compliance with this request.

ELECTRONIC SUBMITTAL OF REPORTS

ACEH's Environmental Cleanup Oversight Programs (LOP and SLIC) require submission of reports in electronic form. The electronic copy replaces paper copies and is expected to be used for all public information requests, regulatory review, and compliance/enforcement activities. Instructions for submission of electronic documents to the Alameda County Environmental Cleanup Oversight Program FTP site are provided on the attached "Electronic Report Upload Instructions." Submission of reports to the Alameda County FTP site is an addition to existing requirements for electronic submittal of information to the State Water Resources Control Board (SWRCB) GeoTracker website. In September 2004, the SWRCB adopted regulations that require electronic submittal of information for all groundwater cleanup programs. For several years, responsible parties for cleanup of leaks from underground storage tanks (USTs) have been required to submit groundwater analytical data, surveyed locations of monitoring wells, and other data to the GeoTracker database over the Internet. Beginning July 1, 2005, these same reporting requirements were added to Spills, Leaks, Investigations, and Cleanup (SLIC) sites. Beginning July 1, 2005, electronic submittal of a complete copy of all reports for all sites is required in GeoTracker (in PDF format). Please visit the SWRCB website for more information on these requirements (http://www.waterboards.ca.gov/water_issues/programs/ust/electronic_submittal/).

PERJURY STATEMENT

All work plans, technical reports, or technical documents submitted to ACEH must be accompanied by a cover letter from the responsible party that states, at a minimum, the following: "I declare, under penalty of perjury, that the information and/or recommendations contained in the attached document or report is true and correct to the best of my knowledge." This letter must be signed by an officer or legally authorized representative of your company. Please include a cover letter satisfying these requirements with all future reports and technical documents submitted for this fuel leak case.

PROFESSIONAL CERTIFICATION & CONCLUSIONS/RECOMMENDATIONS

The California Business and Professions Code (Sections 6735, 6835, and 7835.1) requires that work plans and technical or implementation reports containing geologic or engineering evaluations and/or judgments be performed under the direction of an appropriately registered or certified professional. For your submittal to be considered a valid technical report, you are to present site specific data, data interpretations, and recommendations prepared by an appropriately licensed professional and include the professional registration stamp, signature, and statement of professional certification. Please ensure all that all technical reports submitted for this fuel leak case meet this requirement.

UNDERGROUND STORAGE TANK CLEANUP FUND

Please note that delays in investigation, later reports, or enforcement actions may result in your becoming ineligible to receive grant money from the state's Underground Storage Tank Cleanup Fund (Senate Bill 2004) to reimburse you for the cost of cleanup.

AGENCY OVERSIGHT

If it appears as though significant delays are occurring or reports are not submitted as requested, we will consider referring your case to the Regional Board or other appropriate agency, including the County District Attorney, for possible enforcement actions. California Health and Safety Code, Section 25299.76 authorizes enforcement including administrative action or monetary penalties of up to \$10,000 per day for each day of violation.

Alameda County Environmental Cleanup Oversight Programs (LOP and SLIC)	REVISION DATE: May 15, 2014
	ISSUE DATE: July 5, 2005
	PREVIOUS REVISIONS: October 31, 2005; December 16, 2005; March 27, 2009; July 8, 2010, July 25, 2010
SECTION: Miscellaneous Administrative Topics & Procedures	SUBJECT: Electronic Report Upload (ftp) Instructions

The Alameda County Environmental Cleanup Oversight Programs (LOP and SLIC) require submission of all reports in electronic form to the county's ftp site. Paper copies of reports will no longer be accepted. The electronic copy replaces the paper copy and will be used for all public information requests, regulatory review, and compliance/enforcement activities.

REQUIREMENTS

- Please **do not** submit reports as attachments to electronic mail.
- Entire report including cover letter must be submitted to the ftp site as a **single portable document format (PDF) with no password protection**.
- It is **preferable** that reports be converted to PDF format from their original format, (e.g., Microsoft Word) rather than scanned.
- **Signature pages and perjury statements must be included and have either original or electronic signature.**
- **Do not password protect the document.** Once indexed and inserted into the correct electronic case file, the document will be secured in compliance with the County's current security standards and a password. **Documents with password protection will not be accepted.**
- Each page in the PDF document should be rotated in the direction that will make it easiest to read on a computer monitor.
- Reports must be named and saved using the following naming convention:

RO#_Report Name_Year-Month-Date (e.g., RO#5555_WorkPlan_2005-06-14)

Submission Instructions

- 1) Obtain User Name and Password
 - a) Contact the Alameda County Environmental Health Department to obtain a User Name and Password to upload files to the ftp site.
 - i) Send an e-mail to deh.loptoxic@acgov.org
 - b) In the subject line of your request, be sure to include "**ftp PASSWORD REQUEST**" and in the body of your request, include the **Contact Information, Site Addresses, and the Case Numbers (RO# available in Geotracker) you will be posting for.**
- 2) Upload Files to the ftp Site
 - a) Using Internet Explorer (IE4+), go to <ftp://alcoftp1.acgov.org>
 - (i) Note: Netscape, Safari, and Firefox browsers will not open the FTP site as they are NOT being supported at this time.
 - b) Click on Page located on the Command bar on upper right side of window, and then scroll down to Open FTP Site in Windows Explorer.
 - c) Enter your User Name and Password. (Note: Both are Case Sensitive.)
 - d) Open "My Computer" on your computer and navigate to the file(s) you wish to upload to the ftp site.
 - e) With both "My Computer" and the ftp site open in separate windows, drag and drop the file(s) from "My Computer" to the ftp window.
- 3) Send E-mail Notifications to the Environmental Cleanup Oversight Programs
 - a) Send email to deh.loptoxic@acgov.org notify us that you have placed a report on our ftp site.
 - b) Copy your Caseworker on the e-mail. Your Caseworker's e-mail address is the entire first name then a period and entire last name @acgov.org. (e.g., firstname.lastname@acgov.org)
 - c) The subject line of the e-mail must start with the RO# followed by **Report Upload**. (e.g., Subject: RO1234 Report Upload) If site is a new case without an RO#, use the street address instead.
 - d) If your document meets the above requirements and you follow the submission instructions, you will receive a notification by email indicating that your document was successfully uploaded to the ftp site.

LIST OF LANDOWNERS FORM

County of Alameda
Environmental Health Services
Environmental Protection
1131 Harbor Bay Parkway, Suite 250
Alameda, CA 94502-6577

CERTIFIED LIST OF RECORD FEE TITLE OWNERS FOR:

Site Name: Chevron #9-0020
Address: 1633 Harrison Street
City, State, Zip: Oakland, CA 94612
Record ID #: RO0000143

Please fill out item 1 if there are multiple site landowners (attach an extra sheet if necessary). If you are the sole site landowner, skip item 1 and fill out item 2.

1. In accordance with Section 25297.15(a) of Chapter 6.7 of the California Health & Safety Code, I, (name of primary responsible party), certify that the following is a complete list of current record fee title owners and their mailing addresses for the above site:

Name:
Address:
City, State, Zip:
E-mail Address:
Name:
Address:
City, State, Zip:
E-mail Address:
Name:
Address:
City, State, Zip:
E-mail Address:

2. In accordance with Section 25297.15(a) of Chapter 6.7 of the California Health & Safety Code, I, certify that I am the sole landowner for the above site.

Sincerely,

Signature of Primary Responsible Party Printed Name Date E-mail Address



ENVIRONMENTAL HEALTH SERVICES
ENVIRONMENTAL PROTECTION
1131 Harbor Bay Parkway, Suite 250
Alameda, CA 94502-6577
(510) 567-6700
FAX (510) 337-9335

INVITATION TO COMMENT – POTENTIAL CASE CLOSURE

**CHEVRON #9-0020
1633 HARRISON STREET, OAKLAND, CA
FUEL LEAK CASE RO0000143
GEOTRACKER GLOBAL ID T0600100304**

May 23, 2014

The above referenced site is a fuel leak case that is under the regulatory oversight of the Alameda County Environmental Health (ACEH) Local Oversight Program for the investigation and cleanup of a release of petroleum hydrocarbons from an underground storage tank system. Site investigation and cleanup activities have been completed and the site has been evaluated in accordance with the State Water Resources Control Board Low-Threat Closure Policy. The site appears to meet all of the criteria in the Low-Threat Closure Policy. Therefore, ACEH is considering closure of the fuel leak case.

This notice is being sent to the current landowner in compliance with Health and Safety Code Section 25295.40. It is also being sent to the current occupants and landowners of adjacent properties and known interested parties for this site.

The public is invited to review and comment on the potential closure of the fuel leak case. The entire case file can be viewed over the Internet on the ACEH website (<http://www.acgov.org/aceh/lop/ust.htm>) or the State of California Water Resources Control Board GeoTracker website (<http://geotracker.waterboards.ca.gov>). Please send written comments to Jerry Wickham at the address below; all comments will be forwarded to the responsible parties. **Comments received by August 1, 2014** will be considered and responded to prior to a final determination on the proposed case closure.

If you have comments or questions regarding this site, please contact the ACEH caseworker, Mark Detterman at 510-567-6876 or by email at mark.detterman@acgov.org. Please refer to ACEH case RO0000143 in any correspondence.

1800 HARRISON FOUNDATION
Parcel #: 8-626-1-1
1800 HARRISON ST #6TH
OAKLAND CA 94612-3470

1811 1817 HARRISON ST PARTNERSHIP
Parcel #: 8-625-5
5 3RD ST #1000
SAN FRANCISCO CA 94103-3221

AMERICAN CANCER SOCIETY CALIFORNIA DIVI
Parcel #: 8-625-14-1
PO BOX 2061
OAKLAND CA 94604-2061

BLACKSETH KIM R & AUDREY J TRS & DUNCKE
Parcel #: 8-625-9
2321 MIDDLEFIELD RD
PALO ALTO CA 94301-4027

CITY OAKLAND HOUSING
Parcel #: 8-625-7
1805 HARRISON ST
OAKLAND CA 94612-3403

HICKEY CHRISTOPHER M & MARIETTA
Parcel #: 8-626-7
1971 HOOVER AVE
OAKLAND CA 94602-1921

HOUSING AUTHORITY OF THE CITY OF OAKLAND
Parcel #: 8-625-23
1619 HARRISON ST
OAKLAND CA 94612-3307

HOUSING AUTHORITY OF THE CITY OF OAKLAND
Parcel #: 8-625-6
1619 HARRISON ST
OAKLAND CA 94612-3307

HOUSING AUTHORITY OF THE CITY OF OAKLAND
Parcel #: 8-625-8
1619 HARRISON ST
OAKLAND CA 94612-3307

HOUSING AUTHORITY OF THE CITY OF OAKLAND
Parcel #: 8-625-22-1
1619 HARRISON ST
OAKLAND CA 94612-3307

HOWDEN BUILDING INVESTORS ETAL
Parcel #: 8-625-19
388 17TH ST #200
OAKLAND CA 94612-3362

MURPHY MATTHEW & MARGARET ETAL
Parcel #: 8-626-33
325 DWIGHT ST
SAN FRANCISCO CA 94134-1913

OCCUPANT
Parcel #: 8-626-34
285 17TH ST
OAKLAND CA 94612

OCCUPANT
Parcel #: 8-625-5
1811 HARRISON ST
OAKLAND CA 94612

OCCUPANT
Parcel #: 8-625-23
1621 HARRISON ST
OAKLAND CA 94612

OCCUPANT
Parcel #: 8-625-14-1
1700 WEBSTER ST
OAKLAND CA 94612

OCCUPANT
Parcel #: 8-625-19
333 17TH ST
OAKLAND CA 94612

OCCUPANT
Parcel #: 8-626-7
278 17TH ST
OAKLAND CA 94612

OCCUPANT
Parcel #: 8-625-9
300 17TH ST
OAKLAND CA 94612

OCCUPANT
Parcel #: 8-625-6
1805 HARRISON ST
OAKLAND CA 94612

OCCUPANT
Parcel #: 8-625-8
1711 HARRISON ST
OAKLAND CA 94612

OCCUPANT
Parcel #: 8-626-33
1622 HARRISON ST
OAKLAND CA 94612

OCCUPANT
Parcel #: 8-625-7
1801 HARRISON ST
OAKLAND CA 94612

OCCUPANT
Parcel #: 8-625-22-1
1633 HARRISON ST
OAKLAND CA 94612

TKW LLC
Parcel #: 8-626-34
360 17TH ST #204
OAKLAND CA 94612-3340

Hoey, Kiersten

From: Detterman, Mark, Env. Health [Mark.Detterman@acgov.org]
Sent: Monday, August 04, 2014 4:49 PM
To: 'Fischer, Alexis N'
Cc: Lee, Nathan; Hoey, Kiersten; Roe, Dilan, Env. Health
Subject: Chevron 90020 (RO143) Well Destruction

Alexis,

As you are likely aware, the public comment period for the subject site ended on Friday August 1, 2014. I have had a chance to review my emails and phone messages that I received while on vacation, and no written or verbal comments were received by Alameda County Environmental Health (ACEH). Therefore, Chevron is free to proceed with the destruction of all wells associated with the site (groundwater, vapor, etc), as requested in the May 23, 2014 letter from ACEH. The timelines established in that letter should be adequate to complete the tasks; however, if additional time is required, please let me know.

Regards,

Mark Detterman
Senior Hazardous Materials Specialist, PG, CEG
Alameda County Environmental Health
1131 Harbor Bay Parkway
Alameda, CA 94502
Direct: 510.567.6876
Fax: 510.337.9335
Email: mark.detterman@acgov.org

PDF copies of case files can be downloaded at:

<http://www.acgov.org/aceh/lop/ust.htm>

Weir, Carissa

From: Lee, Nathan
Sent: Wednesday, September 24, 2014 7:56 AM
To: Weir, Carissa
Subject: FW: Former Chevron 90020 (RO 143) -1633 Harrison Street, Oakland - Well Destruction Extension Request

Please upload to STRATA

Nathan Lee, P.G.
Conestoga-Rovers & Associates (CRA)
2300 Clayton Road, Suite 920
Concord, CA 94520

Phone: 925.849.1003
Fax: 510.420.9170
Cell: 510.385.2499
Email: nlee@CRAworld.com

From: Detterman, Mark, Env. Health [<mailto:Mark.Detterman@acgov.org>]
Sent: Monday, September 22, 2014 10:50 AM
To: Lee, Nathan
Cc: Roe, Dilan, Env. Health; Fischer, Alexis N
Subject: RE: Former Chevron 90020 (RO 143) -1633 Harrison Street, Oakland - Well Destruction Extension Request

Nate,
Thanks for the update on well destruction at this site. ACEH is in agreement that an extension until January 16, 2014 is appropriate for the site. I will update Geotracker shortly.

Mark Detterman
Senior Hazardous Materials Specialist, PG, CEG
Alameda County Environmental Health
1131 Harbor Bay Parkway
Alameda, CA 94502
Direct: 510.567.6876
Fax: 510.337.9335
Email: mark.detterman@acgov.org

PDF copies of case files can be downloaded at:

<http://www.acgov.org/aceh/lop/ust.htm>

From: Lee, Nathan [<mailto:nlee@craworld.com>]
Sent: Monday, September 22, 2014 9:10 AM
To: Detterman, Mark, Env. Health
Cc: Roe, Dilan, Env. Health; Fischer, Alexis N
Subject: Former Chevron 90020 (RO 143) -1633 Harrison Street, Oakland - Well Destruction Extension Request

Mark,

Conestoga-Rovers and Associates (CRA) on behalf of Chevron Environmental Management Company (EMC) would like to request an extension for the October 3, 2014 date that Alameda County Environmental Health's (ACEH) requested for the Monitoring Well Decommissioning and Waste Removal in ACEH letter dated May 23, 2014 and email dated August 4, 2014. The reason for the extension, as discussed over the phone on September 19, 2014, is that the City of Oakland has no record of an encroachment permit for monitoring wells MW-9 and MW-13. The City of Oakland is requiring that a new encroachment permit be obtained for monitoring wells MW-9 and MW-13 before the wells can be destroyed. Based on recent experiences with the City of Oakland, the encroachment permit can take anywhere from 3 to over 6 months to obtain. Also the City of Oakland has a moratorium for any work in the area from November 1, 2014 to January 2, 2015. Therefore an extension of **January 16, 2014** for the Monitoring Well Decommissioning and Waste Removal is requested. Based on this new extension date, the Well Decommissioning Report would be submitted 60 days after the wells have been destroyed. As discussed, this extension date is depend on when the City issues an encroachment permit.

Thanks,

Nathan Lee, P.G.
Conestoga-Rovers & Associates (CRA)
2300 Clayton Road, Suite 920
Concord, CA 94520

Phone: 925.849.1003
Fax: 510.420.9170
Cell: 510.385.2499
Email: nlee@CRAworld.com

CRA and GHD have merged! To learn more, visit www.CRAworld.com/ghd

CRA and GHD have merged! To learn more, visit www.CRAworld.com/ghd

ATTACHMENT B

PERMITS

Alameda County Public Works Agency - Water Resources Well Permit

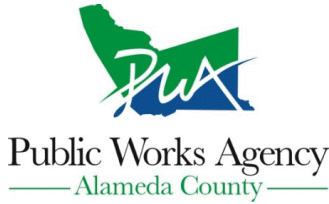

399 Elmhurst Street
Hayward, CA 94544-1395
Telephone: (510)670-6633 Fax:(510)782-1939

Application Approved on: 08/26/2014 By jamesy

Permit Numbers: W2014-0789 to W2014-0793
Permits Valid from 10/01/2014 to 12/31/2014

Application Id: 1408635898629
Site Location: 1633 Harrison Street (cross street 17th Street)
Project Start Date: 10/01/2014
Assigned Inspector: Contact Steve Miller at (510) 670-5517 or stevem@acpwa.org

City of Project Site:Oakland

Completion Date:12/31/2014

Applicant: Conestoga-Rovers & Associates - Kiersten Hoey
5900 Hollis Street, Suite A, Emeryville, CA 94608
Property Owner: Oakland Housing Authority
1801 Harrison Street, 2nd Floor, Oakland, CA 94612
Client: Chevron EMC
6101 Bollinger Canyon Road, San Ramon, CA 94583

Phone: 510-420-3347

Phone: 510-587-2144

Phone: 925-790-6441

Total Due: \$1985.00
Total Amount Paid: \$1985.00
Receipt Number: WR2014-0356 **Payer Name : Conestoga Rovers & Associates** **PAID IN FULL**
Paid By: CHECK

Works Requesting Permits:

Well Destruction-Monitoring - 5 Wells

Driller: Vapor Tech Services - Lic #: 916085 - Method: press

Work Total: \$1985.00

Specifications

Permit #	Issued Date	Expire Date	Owner Well Id	Hole Diam.	Casing Diam.	Seal Depth	Max. Depth	State Well #	Orig. Permit #	DWR #
W2014-0789	08/26/2014	12/30/2014	MW-13	8.00 in.	2.00 in.	16.00 ft	28.00 ft	1S/4W34A	No Records	No Records
W2014-0790	08/26/2014	12/30/2014	MW-15	8.00 in.	2.00 in.	9.00 ft	28.00 ft	1S/4W34A1 5	No Records	No Records
W2014-0791	08/26/2014	12/30/2014	MW-16	8.00 in.	2.00 in.	11.00 ft	30.00 ft	1S/4W34A1 9	No Records	No Records
W2014-0792	08/26/2014	12/30/2014	MW-17	3.50 in.	1.00 in.	13.00 ft	24.00 ft	1S/4W34A	W2010-0004	e0120556
W2014-0793	08/26/2014	12/30/2014	MW-9	8.00 in.	2.00 in.	17.00 ft	25.00 ft	1S/4W34A	No Records	No Records

Specific Work Permit Conditions

1. Drilling Permit(s) can be voided/ cancelled only in writing. It is the applicant's responsibility to notify Alameda County Public Works Agency, Water Resources Section in writing for an extension or to cancel the drilling permit application. No drilling permit application(s) shall be extended beyond ninety (90) days from the original start date. Applicants may not cancel a drilling permit application after the completion date of the permit issued has passed.

2. Prior to any drilling activities, it shall be the applicant's responsibility to contact and coordinate an Underground Service Alert (USA), obtain encroachment permit(s), excavation permit(s) or any other permits or agreements required for that Federal, State, County or City, and follow all City or County Ordinances. No work shall begin until all the permits and requirements have been approved or obtained. It shall also be the applicants responsibilities to provide to the Cities or to Alameda County an Traffic Safety Plan for any lane closures or detours planned. No work shall begin until all the permits and requirements have been approved or obtained.

3. Compliance with the well-sealing specifications shall not exempt the well-sealing contractor from complying with appropriate State reporting-requirements related to well construction or destruction (Sections 13750 through 13755

Alameda County Public Works Agency - Water Resources Well Permit

(Division 7, Chapter 10, Article 3) of the California Water Code). Contractor must complete State DWR Form 188 and mail original to the Alameda County Public Works Agency, Water Resources Section, within 60 days. Include permit number and site map.

4. Applicant shall submit the copies of the approved encroachment permit to this office within 60 days.
 5. Permittee shall assume entire responsibility for all activities and uses under this permit and shall indemnify, defend and save the Alameda County Public Works Agency, its officers, agents, and employees free and harmless from any and all expense, cost and liability in connection with or resulting from the exercise of this Permit including, but not limited to, property damage, personal injury and wrongful death.
 6. Applicant shall contact assigned inspector listed on the top of the permit at least five (5) working days prior to starting, once the permit has been approved. Confirm the scheduled date(s) at least 24 hours prior to drilling.
 7. Remove the Christy box or similar structure. Destroy wells by overdrilling the upper 5ft. bgs & Tremie Grouting with Cement. After the seal has set, backfill the remaining hole with concrete or compacted material to match existing.
 8. Permittee, permittee's contractors, consultants or agents shall be responsible to assure that all material or waters generated during drilling, boring destruction, and/or other activities associated with this Permit will be safely handled, properly managed, and disposed of according to all applicable federal, state, and local statutes regulating such. In no case shall these materials and/or waters be allowed to enter, or potentially enter, on or off-site storm sewers, dry wells, or waterways or be allowed to move off the property where work is being completed.
 9. Copy of approved drilling permit must be on site at all times. Failure to present or show proof of the approved permit application on site shall result in a fine of \$500.00.
-

APPLICATION FOR TRAFFIC CONTROL PLAN

Transportation Services Fee: \$123/hour
(Check or Money Order Only)



City of Oakland

Public Works Agency
Transportation Services Division

- Check the box that apply:
- New Application (Utility, Excavation)
 - Renewal Application
 - New Development w/ Mgmt Plan
 - City of Oakland Project

Please Read the Following Statements Below:

1. Processing time for a Traffic Control Application is a **minimum of 10 business days**.
2. Traffic Control review is scheduled **only on Tuesdays and Thursdays from 8:30am thru 11:30am by appointment only**.
3. A scheduled **appointment** by phone or email with a TSD staff member is necessary to discuss any and all traffic control application and plans.
4. Please **call ahead** to confirm that the traffic control application is ready for pickup @ 510-238-3467.
5. Businesses and residences adjacent to the work area must be provided **72 hour advance notice**.
6. A **completed** traffic control application may be faxed to (510) 238-7415.
7. **Incomplete** traffic control applications will not be processed and returned to applicant immediately.
8. The initial approval for a traffic control plan is 1 month, the renewal submittal may be approved up to 3 months.
9. The traffic control provision dates cannot be changed or extended if work has already commenced.
10. After receiving TSD approval of the traffic control application, contractor shall proceed to the Permit Center to "Obstruction obtain an obstruction permit."

Contact Person: Kiersten Hoey Phone: 510 420 3347
 Name of Company: Conestoga-Rovos + Associates Fax: 510 420 9170
 Address of Company: 5900 Hillis St., Emeryville
 Describe type of work to be performed: Destroy (remove) wells MW-9, MW-13, MW-15 MW-16, MW-17

Location of work: 5 locations near intersection of Harrison St. And* 17th St
 Work date (s): October (2 days) total Mon-Fri Sat-Sun Work Hours: 8 to 5

Please Follow these Steps in Order to Complete a Traffic Control Plan:

- A. **Drawing Area:** The full width of all streets adjacent to the site **MUST** be included in the drawing. Include the entire block in which your work is located for every street that is adjacent to your site.
- B. Include **Street Names, Direction of Traffic on the Street, and North Arrow**
- C. Show **Existing Number of Lanes in all Directions** (with any pavement arrows)
- D. Check the Box(s) that Apply: All checked items **MUST** be shown on the drawing

<input checked="" type="checkbox"/> Lane Closure	<input type="checkbox"/> Use of Median	<input type="checkbox"/> Sidewalk Closure
<input type="checkbox"/> Street Closures (must provide detour plan)	<input checked="" type="checkbox"/> Use Parking Lane	(must provide pedestrian walk way)
- E. Show **All Dimensions** of street widths (curb to curb), lane widths, sidewalk widths, and work area dimension.
(Note: Traffic Control Application / Plans missing the above information will not be accepted or processed.)
- F. Show the **Name and Locations** of all advanced warning devices, flaggers, delineators, warning and construction signs to be used.

RENEWAL PROCESS: Resubmit a completed Traffic Control Application with the old approved plan (with the necessary modifications / changes to the plans).

FOR HELP in preparing a traffic control plan, see Temporary Traffic Control Pocket Reference Guide 2007, Work Area Traffic Control Handbook 2006, or the California Manual on Uniform Traffic Control (MUTCD) 2003, Chapter 6.
http://www.dot.ca.gov/hq/traffops/signtech/mutcdsupp/ca_mutcd.htm
 For City website: <http://www.oaklandpw.com/Page548.aspx>

* Name the streets that are the boundaries of your work area.

SPECIAL PROVISION 7-10.1 TRAFFIC REQUIREMENTS

Project Name: _____
 Project Number: TSD-14-0168
 Reviewed By: JWatson *[Signature]*
 Date: 9/23/2014
 Permit good from 9/23/2014
 to 10/23/2014

ADD NEW SUBSECTION TO READ:
SP 7-10.1.4 Vehicular Traffic

Attention is directed to Section 7-10. Public Convenience and Safety, of the City of Oakland Standard Specification for Public Works Construction, 2006 Edition (Include this paragraph for p-jobs, excavation permits or obstruction permits).

The Contractor shall conduct its work in such a manner as to provide public convenience and safety and according to the provisions in this subsection. The provisions shall not be modified or altered without written approval from the Engineer.

Standard traffic control devices shall be placed at the construction zone according to the latest edition of the Work Area Traffic Control Handbook or Manual on Uniform Traffic Control Devices (MUTCD), Chapter 6 – "Traffic Controls for Construction and Maintenance Work Zone," or as directed by the Engineer.

All trenches and excavations in any public street or roadway shall be back filled and opened to traffic, or covered with suitable steel plates securely placed and opened to traffic at all times except during actual construction operations unless otherwise permitted by the Engineer.

Each section of work shall be completed or temporarily paved and open to traffic in not more than 5 days after commencing work unless otherwise permitted in writing by the Engineer.

Where construction encroaches into the sidewalk area, a minimum of 5 ½ feet of unobstructed sidewalk shall be maintained at all times for pedestrian use. Pedestrian barricades, shelter, and detour signs per Caltrans standards may be required.

The contractor shall conduct its operation in such a manner as to leave the following traffic lanes unobstructed and in a condition satisfactory for vehicular travel during the Obstruction Period. At all times traffic lanes will be restricted and reopened to travel. Emergency access shall be provided at all times.

Street Name Limits	Obstruction Period	North Bound	South Bound	East Bound	West Bound
Harrison Street between 19 th Street and 15 th Street	Mon. – Fri. 9am – 3pm	1 – 12' lane open minimum	1 – 12' lane open minimum	1 – 12' lane open minimum	N/A

The Contractor Shall Also include all check item:

1. Design a construction traffic control plan and submit (2) copies to the Engineer for approval prior to starting any work.
2. Replace all signs, pavement markings, and traffic detector loops damaged or removed due to construction within 3 days of completion of work or the final pavement lift.
3. Provide advance notice to Oakland Police at (510) 777-3333 (24-hrs) and Oakland Fire at (510) 238-3331 (2-rhs) when a single lane of traffic or less is provided on any street.
4. Provide 72-hour advance notice to AC Transit at (510) 891-4909 when affecting a bus stop.
5. For Caltrans roadways, ramps, or maintained facilities, the Contractor shall obtain appropriate permits and notify the Traffic Management Center 24 hours in advance of any work.
6. Flagger control is required. Certified Flagger is required.
7. Pedestrian walkway by K-rail, Canopy or Plywood is required. (See detour plan)
8. Pedestrian traffic shall be maintained and guided through the project at all times.
9. Provide advance notice to Business and Residence within 72-hours.
10. Allow all traffic movement at intersection.

Nothing specified herein shall prohibit emergency work and/or repair necessary to ensure public health and safety.

Day 1

APPROVED: *De Watson 7/23/14*
 Transportation Services Division
 CITY OF OAKLAND

LEGEND
 W 20-1 Road Work Ahead
 C20 Right lane Closed Ahead
 C30 Lane Closed

TABLE

Traffic Speed	Taper Length Each Lane			Cone Spacing		Sign Spacing
	Merging	Shifting	Shoulder	Taper	Tangent	
25 MPH	125 FT	63 FT	42 FT	25 FT	50 FT	150 FT
30 MPH	180 FT	90 FT	60 FT	30 FT	60 FT	200 FT
35 MPH	245 FT	123 FT	82 FT	35 FT	70 FT	250 FT
40 MPH	320 FT	160 FT	107 FT	40 FT	80 FT	350 FT
45 MPH	540 FT	270 FT	180 FT	45 FT	90 FT	550 FT
50 MPH	600 FT	300 FT	200 FT	50 FT	100 FT	600 FT
65 + MPH	660 FT	330 FT	220 FT	50 FT	100 FT	1000 FT

Staging Area
 1633 Harrison Street

Work Hours
 9:00 am to 3:00 pm
 24 Hour Contact
 Mike Franceschi
 (916) 606-7514

lane width 20'

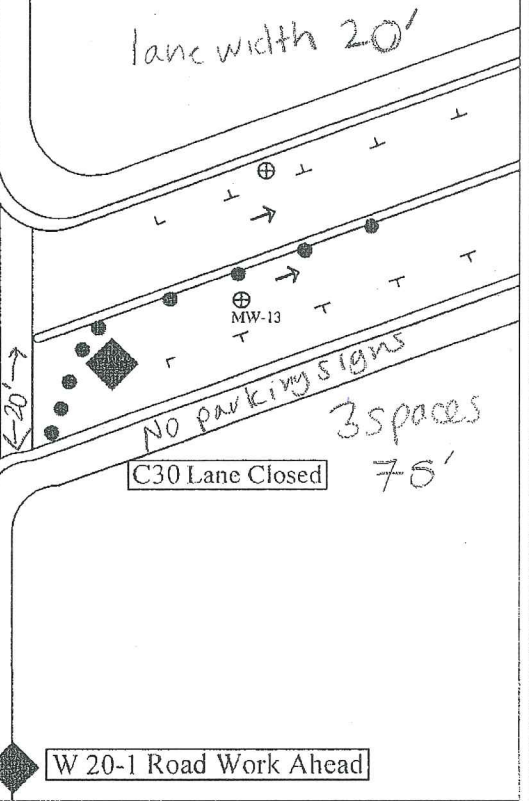
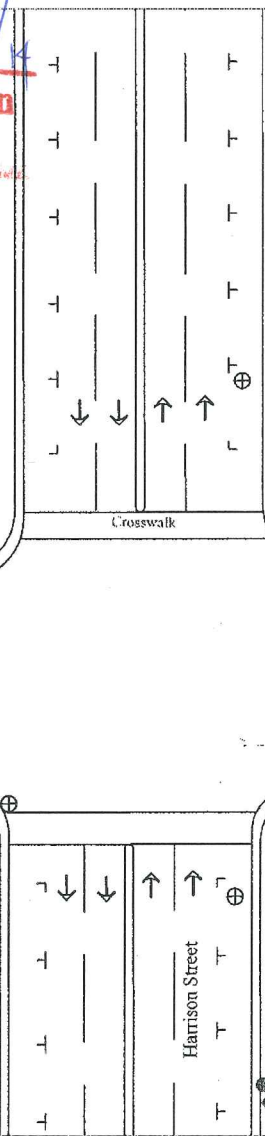
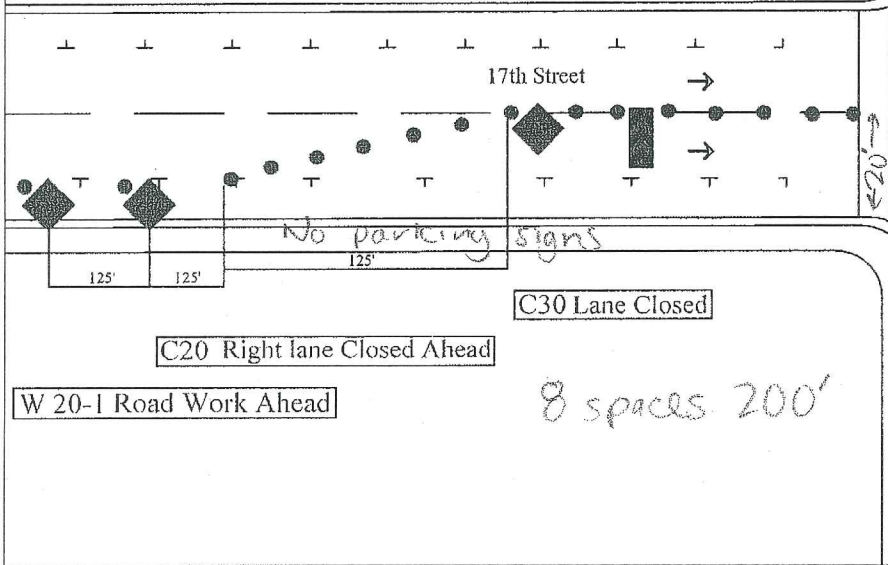

DIRECT TRAFFIC CONTROL
 PO BOX 1822
 DIAMOND SPRINGS C.A 95619
 PHONE (530) 677-9239
 FAX (530) 672-1185
 MOBILE: (916) 606-7514
 IDTC@SBCGLOBAL.NET

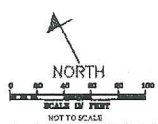

LEGEND

- 31" DISENATOR (FLAY)
- 24" CYLIND
- ◆ 48" SQUARE SIGN
- ⊕ 40" BARRICADE
- ARREST BARRI
- ⊕ Traffic Signal

CONESTOGA ROVERS & ASSOCIATES
 5900 Hollis Street Suite A
 Emeryville CA 94608

TRAFFIC CONTROL SITE MAP

MPH 25	TL 125'	S.S 125'	B.S 158'
DRAWN BY	DATE	PROJECT NUMBER	
B FRANCESCHI	08/24/14	311956	

Day 1

LEGEND
 W 20-1 Road Work Ahead
 C20 Right lane Closed Ahead
 C30 Lane Closed

Traffic Speed	Taper Length Each Lane		Cone Spacing		Sign Spacing
	Merging	Shifting Shoulder	Taper	Tangent	
25 MPH	125 FT	63 FT	42 FT	25 FT	50 FT
30 MPH	180 FT	90 FT	60 FT	30 FT	60 FT
35 MPH	245 FT	123 FT	82 FT	35 FT	70 FT
40 MPH	320 FT	160 FT	107 FT	40 FT	80 FT
45 MPH	540 FT	270 FT	180 FT	45 FT	90 FT
50 MPH	600 FT	300 FT	200 FT	50 FT	100 FT
65 + MPH	660 FT	330 FT	220 FT	50 FT	1000 FT

APPROVED: *Jan White 9/23/14*
 Transportation Services Division
 CITY OF OAKLAND

Staging Area
 1633 Harrison Street

Work Hours
 9:00 am to 3:00 pm
 24 Hour Contact
 Mike Franceschi
 (916) 606-7514

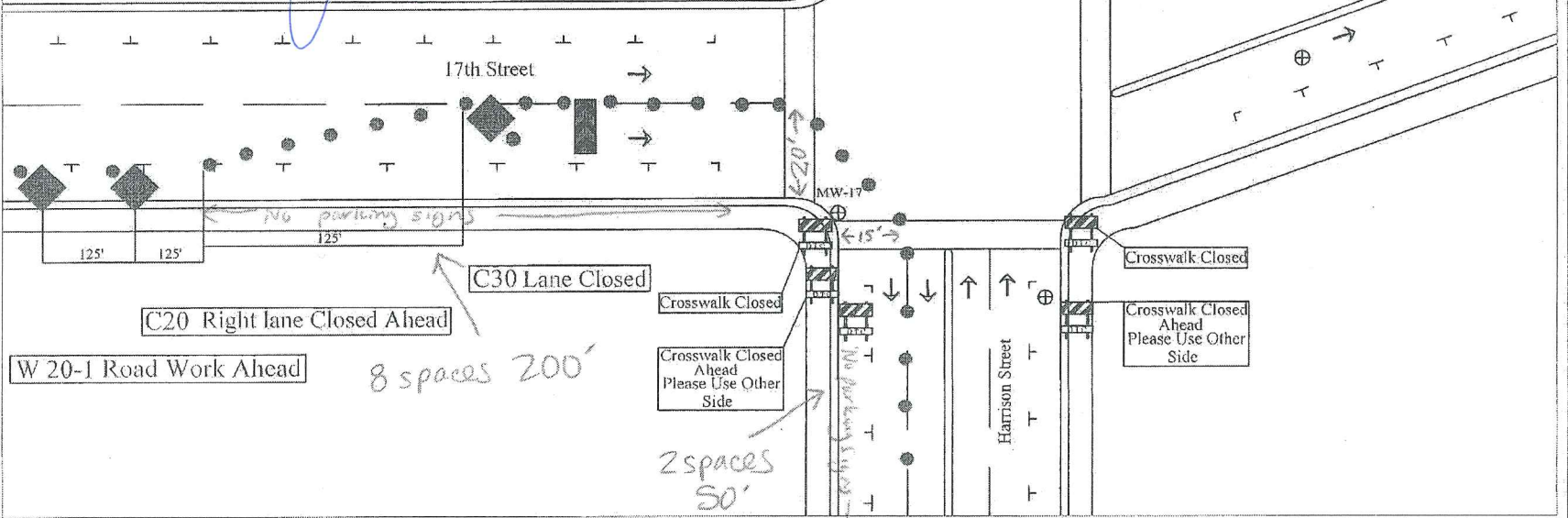

DIRECT TRAFFIC CONTROL
 PO BOX 1822
 DIAMOND SPRINGS C.A 95619
 PHONE (530) 677-9239
 FAX (530) 672-1185
 MOBILE: (916) 606-7514
 IDTC@SBCGLOBAL.NET

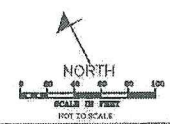

LEGEND

- 18" OPERATOR REFLECTOR
- 24" CONE
- ◆ 48" SIGN/PLA SIGN
- ▭ 36" BARRICADE
- ▨ ANCHOR SPACING
- ⊕ Traffic Signal

CONESTOGA ROVERS & ASSOCIATES
 5900 Hollis Street Suite A
 Emeryville CA 94608

TRAFFIC CONTROL SITE MAP

MPH 25	TL 125'	S.S 125'	B.S 158'
DRAWN BY	DATE	PROJECT NUMBER	
B FRANCESCHI	08/24/14	311956	

Day 2

LEGEND
 C24 Shoulder Work Ahead
 C30A Shoulder Closed

TABLE

Traffic Speed	Taper Length Each Lane			Cone Spacing		Sign Spacing
	Merging	Shifting	Shoulder	Taper	Tangent	
25 MPH	125 FT	63 FT	42 FT	25 FT	50 FT	150 FT
30 MPH	180 FT	90 FT	60 FT	30 FT	60 FT	200 FT
35 MPH	245 FT	123 FT	82 FT	35 FT	70 FT	250 FT
40 MPH	320 FT	160 FT	107 FT	40 FT	80 FT	350 FT
45 MPH	540 FT	270 FT	180 FT	45 FT	90 FT	550 FT
50 MPH	600 FT	300 FT	200 FT	50 FT	100 FT	600 FT
65 + MPH	660 FT	330 FT	220 FT	50 FT	100 FT	1000 FT

Staging Area
 1633 Harrison Street

Work Hours
 9:00 am to 3:00 pm

24 Hour Contact
 Mike Franceschi
 (916) 606-7514

no parking signs

2 spaces 50'

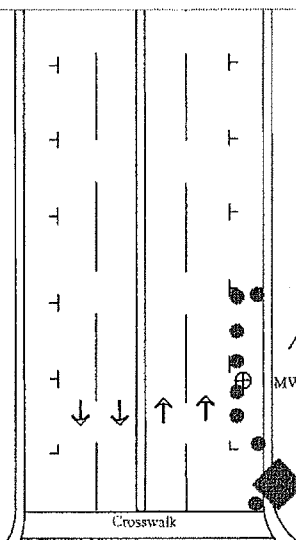
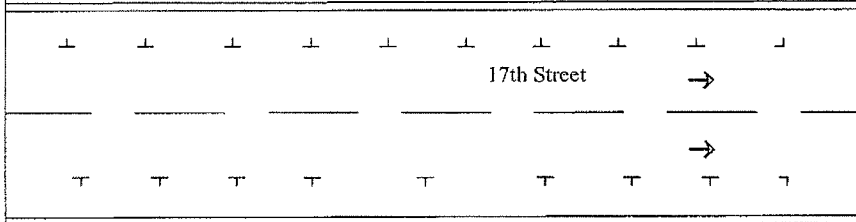

C30A Shoulder Closed

C24 Shoulder Work Ahead

DIRECT TRAFFIC CONTROL
 PO BOX 1822
 DIAMOND SPRINGS CA 95619
 PHONE: (530) 677-9239
 FAX (530) 672-1185
 MOBILE: (916) 606-7514
 IDTC@SBCGLOBAL.NET

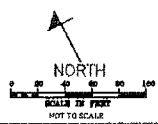

LEGEND

- 30" DIA BARRIER OR FLAG
- 24" CONE
- ◆ 48" TRIANGLE SIGN
- ⊕ 36" RADIUS SIGN
- ⊕ ADVISORY BOARD
- ⊕ Traffic Sign

CONESTOGA ROVERS & ASSOCIATES
 5900 Hollis Street Suite A
 Emeryville CA 94608

TRAFFIC CONTROL SITE MAP

MPH 25	TL 125'	S.S 125'	B.S 158'
DRAWN BY	DATE	PROJECT NUMBER	
B FRANCESCHI	08/24/14	311956	

Day 2

LEGEND
 C24 Shoulder Work Ahead
 C30A Shoulder Closed

TABLE

Traffic Speed MPH	Taper Length Each Lane			Cone Spacing		Sign Spacing
	Merging	Shifting	Shoulder	Taper	Tangent	
25 MPH	125 FT	63 FT	42 FT	25 FT	50 FT	150 FT
30 MPH	180 FT	90 FT	60 FT	30 FT	60 FT	200 FT
35 MPH	245 FT	123 FT	82 FT	35 FT	70 FT	250 FT
40 MPH	320 FT	160 FT	107 FT	40 FT	80 FT	350 FT
45 MPH	540 FT	270 FT	180 FT	45 FT	90 FT	550 FT
50 MPH	600 FT	300 FT	200 FT	50 FT	100 FT	600 FT
65 + MPH	660 FT	330 FT	220 FT	50 FT	100 FT	1000 FT

Staging Area
 1633 Harrison Street

Work Hours
 9:00 am to 3:00 pm

24 Hour Contact
 Mike Franceschi
 (916) 606-7514

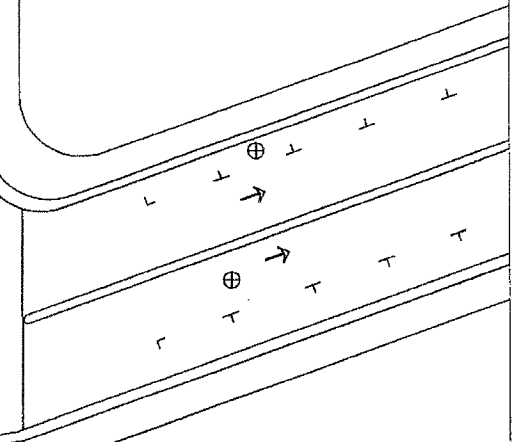
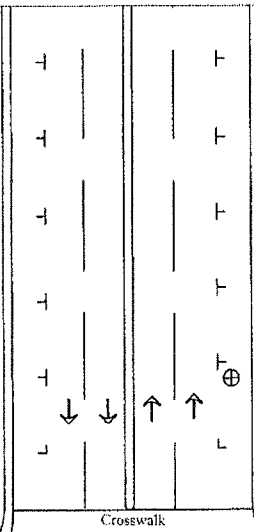
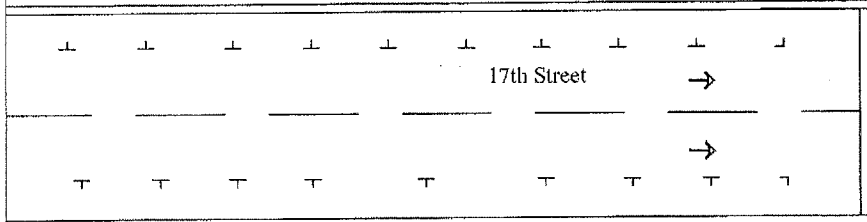

C30A Shoulder Closed

C24 Shoulder Work Ahead

DIRECT TRAFFIC CONTROL
 PO BOX 1822
 DIAMOND SPRINGS C.A 95619
 PHONE (530) 677-9239
 FAX (530) 672-1185
 MOBILE: (916) 606-7514
 1DTC@SBCGLOBAL.NET

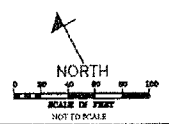

LEGEND

- 30" CONE/SHOULDER AHEAD
- 30" CONE
- ◆ 30" SIGN/STATION
- ⊕ 30" TARDIC AHEAD
- ⊕ 30" TARDIC AHEAD
- ⊕ Traffic Signal

CONESTOGA ROVERS & ASSOCIATES
 5900 Hollis Street Suite A
 Emeryville CA 94608

TRAFFIC CONTROL SITE MAP

MPH 25	TL 125'	S.S 125'	B.S 158'
DRAWN BY	DATE	PROJECT NUMBER	
B FRANCESCO	08/24/14	311956	

Permits for which no major inspection has been approved within 180 days shall expire by limitation. No refund more than 180 days after expiration or final.

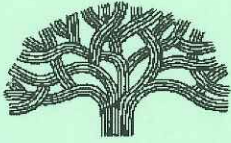

CITY OF OAKLAND

250 FRANK H. OGAWA PLAZA ▪ 2ND FLOOR ▪ OAKLAND, CA 94612

Planning and Building Department
www.oaklandnet.com

PH: 510-238-3891
FAX: 510-238-2263
TDD: 510-238-3254

Permit No: OB1400816 **Obstruction** **Filed Date:** 9/25/2014

Job Site: 1633 HARRISON ST **Schedule Inspection by calling:** 510-238-3444

Parcel No: 008 062502200

District:

Project Description: RESERVE 4 METERED SPACES & 50' ON HARRISON & 17TH ST. BLOCK PORTION OF TRAFFIC LANE ON 17TH ST & HARRISON FOR DRILLING.
Abandon two monitoring wells MW-09 & mw-13 on Harrison St & 17th St.
Alameda County documentation provided. Call PWA INSPECTION prior to start: 510-238-3651.
4th FLOOR. TSD#14-0168

Encroach into public right of way of Harrison and 17th St with two monitoring wells. Recorded 3/8/93. MW-15; MW-16. RESCISSION NEEDED TO FINAL PERMIT.

Related Permits: OB1400815

	<u>Name</u>	<u>Applicant</u>	<u>Address</u>	<u>Phone</u>	<u>License #</u>
Owner:	CHEVRON USA INC			1111111	
Contractor:	VAPOR TECH SERVICES	X	2316 TRIPALDI WAY HAYWARD, CA	(415) 378-0415	916085

PERMIT DETAILS: Building/Public Use/Activity/Obstructions

Work Information

Start Date: 10/28/2014	Obstruction Permit Type:	Short Term (Max 14 Days)
End Date: 10/28/2014	Number of Meters (Metered Area):	4
	Length Of Obstruction (Unmetered Area):	50

Traffic Control Plan (TCP) to be approved every 30 days by PWA Transportation Services or whenever there is any deviation from previously approved TCP.

TOTAL FEES TO BE PAID AT FILING: \$279.41

Application Fee	\$71.00	Records Management Fee	\$23.13	Short Term Meter	\$69.00
Short Term Permits	\$103.50	Technology Enhancement Fee	\$12.78		

Plans Checked By _____ Date _____ Permit Issued By _____ Date _____

Finalized By _____ Date _____

APPLICANT COPY

Permits for which no major inspection has been approved within 180 days shall expire by limitation. No refund more than 180 days after expiration or final.

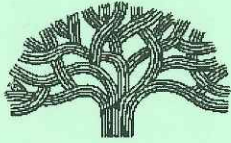

CITY OF OAKLAND

250 FRANK H. OGAWA PLAZA ▪ 2ND FLOOR ▪ OAKLAND, CA 94612

Planning and Building Department
www.oaklandnet.com

PH: 510-238-3891
FAX: 510-238-2263
TDD: 510-238-3254

Permit No: X1402413 Excavation **Filed Date:** 9/25/2014

Job Site: 1633 HARRISON ST **Schedule Inspection by calling:** 510-238-3444

Parcel No: 008 062502200

District:

Project Description: Abandon MW-17 monitoring wells Harrison Off 17th.
AlamedaCounty documentation provided. Call PWA INSPECTION prior to start: 510-238-3651.
4th FLOOR.

Permit to place monitoring well in public right of way; MW-17. Rescission needed to final permit.

Related Permits: ENMI09221

	<u>Name</u>	<u>Applicant</u>	<u>Address</u>	<u>Phone</u>	<u>License #</u>
Owner:	HOUSING AUTHORITY OF THE CITY			0	
Contractor:	VAPOR TECH SERVICES	X	2316 TRIPALDI WAY HAYWARD, CA	(415) 378-0415	916085

PERMIT DETAILS: Building/Public Infrastructure/Excavation/NA

General Information

Excavation Type: Private Party	Special Paving Detail Required:	Tree Removal Involved:
Date Street Last Resurfaced:		Holiday Restriction (Nov 1 - Jan 1);
Worker's Compensation Company Name:		Limited Operation Area (7AM-9AM) And (4PM-6PM);
Worker's Compensation Policy #:		

Key Dates

Approximate Start Date: _____

Approximate End Date: _____

TOTAL FEES TO BE PAID AT FILING: \$436.05

Application Fee	\$71.00	Excavation - Private Party Type	\$309.00	Records Management Fee	\$36.10
Technology Enhancement Fee	\$19.95				

Plans Checked By _____ Date _____

Permit Issued By _____ Date _____

Finalized By _____ Date _____

APPLICANT COPY

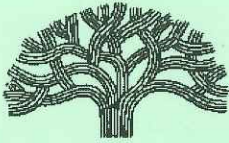

Permit No: X1402413

Parcel No: 008 062502200

Job Site: 1633 HARRISON ST

Page 2 of 2

LICENSED CONTRACTOR'S DECLARATION

I hereby affirm under penalty of perjury that I am licensed under provisions of Chapter 9 (commencing with Section 7000) of Division 3 of the Business and Professions Code, and my license is in full force and effect.

CONSTRUCTION LENDING AGENCY DECLARATION

I hereby affirm under penalty of perjury that there is a construction lending agency for the performance of the work for which this permit is issued (Section 8172, Civil Code).

Lender's Name _____

Branch Designation _____

Lender's Address _____

WORKERS' COMPENSATION DECLARATION

WARNING: FAILURE TO SECURE WORKERS' COMPENSATION COVERAGE IS UNLAWFUL, AND SHALL SUBJECT AN EMPLOYER TO CRIMINAL PENALTIES AND CIVIL FINES UP TO ONE HUNDRED THOUSAND DOLLARS (\$100,000), IN ADDITION TO THE COST OF COMPENSATION, DAMAGES AS PROVIDED FOR IN SECTION 3706 OF THE LABOR CODE, INTEREST, AND ATTORNEY'S FEES.

I hereby affirm under penalty of perjury one of the following declarations:

I have and will maintain a certificate of consent to self-insure for workers' compensation, issued by the Director of Industrial Relations as provided for by Section 3700 of the Labor Code, for the performance of the work for which this permit is issued.

I have and will maintain workers' compensation insurance, as required by Section 3700 of the Labor Code, for the performance of the work for which this permit is issued.

I certify that, in the performance of the work for which this permit is issued, I shall not employ any person in any manner so as to become subject to the workers' compensation laws of California, and agree that, if I should become subject to the workers' compensation provisions of Section 3700 of the Labor Code, I shall forthwith comply with those provisions.

HAZARDOUS MATERIALS DECLARATION

I hereby affirm that the intended occupancy WILL WILL NOT use, handle or store any hazardous, or acutely hazardous, materials. (Checking "WILL" acknowledges that Sections 25505, 25533, and 25534 of the Health and Safety Code, as well as filing instructions were made available to you).

I HEREBY CERTIFY THE FOLLOWING: That I have read this document; that the above information is correct; and that I have truthfully affirmed all applicable declarations contained in this document. I agree to comply with all city and county ordinances and state laws relating to building construction, and hereby authorize representatives of this city to enter upon the above-mentioned property for inspection purposes.

I hereby agree to save, defend, indemnify and keep harmless the City of Oakland and its officials, officers, employees, representatives, agents, and volunteers from all actions, claims, demands, litigation, or proceedings, including those for attorneys' fees, against the City in consequence of the granting of this permit or from the use or occupancy of the public right-of-way, public easement, or any sidewalk, street or sub-sidewalk or otherwise by virtue thereof, and will in all things strictly comply with the conditions under which this permit is granted I further certify that I am the owner of the property involved in this permit or that I am fully authorized by the owner to access the property and perform the work authorized by this permit.

Name _____

Signature _____

Contractor, or Contractor's Agent Date _____

NOTICE: No activities related to the approved work, including storage/use of materials, is allowed within the public right-of-way without an encroachment permit. Dust control measures shall be used throughout all phases of construction.

Permits for which no major inspection has been approved within 180 days shall expire by limitation. No refund more than 180 days after expiration or final.

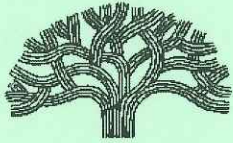

CITY OF OAKLAND

250 FRANK H. OGAWA PLAZA ▪ 2ND FLOOR ▪ OAKLAND, CA 94612

Planning and Building Department
www.oaklandnet.com

PH: 510-238-3891
FAX: 510-238-2263
TDD: 510-238-3254

Permit No: OB1400815 **Obstruction** **Filed Date:** 9/25/2014
Job Site: 1633 HARRISON ST **Schedule Inspection by calling:** 510-238-3444
Parcel No: 008 062502200

District:

Project Description: RESERVE 16 SPACES ON 17TH ST OFF HARRISON FOR DRILLING.
Abandon two monitoring wells MW-09 & mw-13 on Harrison St & 17th St.
Alameda County documentation provided. Call PWA INSPECTION prior to start: 510-238-3651.
4th FLOOR.

Encroach into public right of way of Harrison and 17th St with two monitoring wells. Recorded 3/8/93. MW-15; MW-16. RESCISSION NEEDED TO FINAL PERMIT.

Related Permits: X1402414 OB1400816

	<u>Name</u>	<u>Applicant</u>	<u>Address</u>	<u>Phone</u>	<u>License #</u>
Owner:	CHEVRON USA INC			1111111	
Contractor:	VAPOR TECH SERVICES	X	2316 TRIPALDI WAY HAYWARD, CA	(415) 378-0415	916085

PERMIT DETAILS: Building/Public Use/Activity/Obstructions			
Work Information			
Start Date: 10/27/2014	Obstruction Permit Type:	Short Term (Max 14 Days)	
End Date: 10/27/2014	Number of Meters (Metered Area):	16	
	Length Of Obstruction (Unmetered Area):		

TOTAL FEES TO BE PAID AT FILING: \$714.90			
Application Fee	\$71.00	Records Management Fee	\$59.19
Short Term Permits	\$276.00	Technology Enhancement Fee	\$32.71
		Short Term Meter	\$276.00

Plans Checked By _____ Date _____ Permit Issued By _____ Date _____
Finalized By _____ Date _____

APPLICANT
COPY

Permits for which no major inspection has been approved within 180 days shall expire by limitation. No refund more than 180 days after expiration or final.

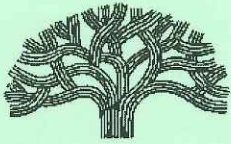

CITY OF OAKLAND

250 FRANK H. OGAWA PLAZA ▪ 2ND FLOOR ▪ OAKLAND, CA 94612

Planning and Building Department
www.oaklandnet.com

PH: 510-238-3891
FAX: 510-238-2263
TDD: 510-238-3254

Permit No: X1402411 Excavation

Filed Date: 9/25/2014

Job Site: 1633 HARRISON ST

Schedule Inspection by calling: 510-238-3444

Parcel No: 008 062502200

District:

Project Description: Abandon two monitoring wells MW-15 & mw-16 on Harrison St & 17th St.
Alameda County documentation provided. Call PWA INSPECTION prior to start: 510-238-3651.
4th FLOOR.

Encroach into public right of way of Harrison and 17th St with two monitoring wells. Recorded
3/8/93. MW-15; MW-16. RESCISSION NEEDED TO FINAL PERMIT.

Related Permits: ENMI96017 X1402414

	<u>Name</u>	<u>Applicant</u>	<u>Address</u>	<u>Phone</u>	<u>License #</u>
Owner:	CHEVRON USA INC			1111111	
Contractor:	VAPOR TECH SERVICES	X	2316 TRIPALDI WAY HAYWARD, CA	(415) 378-0415	916085

PERMIT DETAILS: Building/Public Infrastructure/Excavation/NA

General Information

Excavation Type: Private Party	Special Paving Detail Required:	Tree Removal Involved:
Date Street Last Resurfaced:		Holiday Restriction (Nov 1 - Jan 1):
Worker's Compensation Company Name:		Limited Operation Area (7AM-9AM) And (4PM-6PM):
Worker's Compensation Policy #:		

Key Dates

Approximate Start Date:
Approximate End Date:

TOTAL FEES TO BE PAID AT FILING: \$436.05

Application Fee	\$71.00	Excavation - Private Party Type	\$309.00	Records Management Fee	\$36.10
Technology Enhancement Fee	\$19.95				

Plans Checked By _____ Date _____ Permit Issued By _____ Date _____

Finalized By _____ Date _____

APPLICANT
COPY

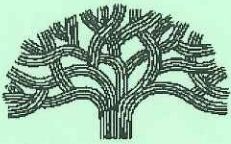

Permit No: X1402411

Parcel No: 008 062502200

Job Site: 1633 HARRISON ST

Page 2 of 2

LICENSED CONTRACTOR'S DECLARATION

I hereby affirm under penalty of perjury that I am licensed under provisions of Chapter 9 (commencing with Section 7000) of Division 3 of the Business and Professions Code, and my license is in full force and effect.

CONSTRUCTION LENDING AGENCY DECLARATION

I hereby affirm under penalty of perjury that there is a construction lending agency for the performance of the work for which this permit is issued (Section 8172, Civil Code).

Lender's Name _____

Branch Designation _____

Lender's Address _____

WORKERS' COMPENSATION DECLARATION

WARNING: FAILURE TO SECURE WORKERS' COMPENSATION COVERAGE IS UNLAWFUL, AND SHALL SUBJECT AN EMPLOYER TO CRIMINAL PENALTIES AND CIVIL FINES UP TO ONE HUNDRED THOUSAND DOLLARS (\$100,000), IN ADDITION TO THE COST OF COMPENSATION, DAMAGES AS PROVIDED FOR IN SECTION 3706 OF THE LABOR CODE, INTEREST, AND ATTORNEY'S FEES.

I hereby affirm under penalty of perjury one of the following declarations:

I have and will maintain a certificate of consent to self-insure for workers' compensation, issued by the Director of Industrial Relations as provided for by Section 3700 of the Labor Code, for the performance of the work for which this permit is issued.

I have and will maintain workers' compensation insurance, as required by Section 3700 of the Labor Code, for the performance of the work for which this permit is issued.

I certify that, in the performance of the work for which this permit is issued, I shall not employ any person in any manner so as to become subject to the workers' compensation laws of California, and agree that, if I should become subject to the workers' compensation provisions of Section 3700 of the Labor Code, I shall forthwith comply with those provisions.

HAZARDOUS MATERIALS DECLARATION

I hereby affirm that the intended occupancy WILL WILL NOT use, handle or store any hazardous, or acutely hazardous, materials. (Checking "WILL" acknowledges that Sections 25505, 25533, and 25534 of the Health and Safety Code, as well as filing instructions were made available to you).

I HEREBY CERTIFY THE FOLLOWING: That I have read this document; that the above information is correct; and that I have truthfully affirmed all applicable declarations contained in this document. I agree to comply with all city and county ordinances and state laws relating to building construction, and hereby authorize representatives of this city to enter upon the above-mentioned property for inspection purposes.

I hereby agree to save, defend, indemnify and keep harmless the City of Oakland and its officials, officers, employees, representatives, agents, and volunteers from all actions, claims, demands, litigation, or proceedings, including those for attorneys' fees, against the City in consequence of the granting of this permit or from the use or occupancy of the public right-of-way, public easement, or any sidewalk, street or sub-sidewalk or otherwise by virtue thereof, and will in all things strictly comply with the conditions under which this permit is granted I further certify that I am the owner of the property involved in this permit or that I am fully authorized by the owner to access the property and perform the work authorized by this permit.

Name _____

Signature _____

Contractor, or Contractor's Agent

Date

NOTICE: No activities related to the approved work, including storage/use of materials, is allowed within the public right-of-way without an encroachment permit. Dust control measures shall be used throughout all phases of construction.

Permits for which no major inspection has been approved within 180 days shall expire by limitation. No refund more than 180 days after expiration or final.

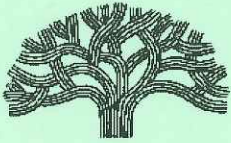

CITY OF OAKLAND

250 FRANK H. OGAWA PLAZA ■ 2ND FLOOR ■ OAKLAND, CA 94612

Planning and Building Department
www.oaklandnet.com

PH: 510-238-3891
FAX: 510-238-2263
TDD: 510-238-3254

Permit No: X1402414 Excavation **Filed Date:** 9/25/2014

Job Site: 1633 HARRISON ST **Schedule Inspection by calling:** 510-238-3444

Parcel No: 008 062502200

District:

Project Description: Abandon two monitoring wells MW-09 & mw-13 on Harrison St & 17th St.
Alameda County documentation provided. Call PWA INSPECTION prior to start: 510-238-3651.
4th FLOOR.

Encroach into public right of way of Harrison and 17th St with two monitoring wells. Recorded 3/8/93. MW-15; MW-16. RESCISSION NEEDED TO FINAL PERMIT.

Related Permits: X1402411 OB1400815

	<u>Name</u>	<u>Applicant</u>	<u>Address</u>	<u>Phone</u>	<u>License #</u>
Owner:	CHEVRON USA INC			1111111	
Contractor:	VAPOR TECH SERVICES	X	2316 TRIPALDI WAY HAYWARD, CA	(415) 378-0415	916085

PERMIT DETAILS: Building/Public Infrastructure/Excavation/NA

General Information

Excavation Type: Private Party	Special Paving Detail Required:	Tree Removal Involved:
Date Street Last Resurfaced:		Holiday Restriction (Nov 1 - Jan 1):
Worker's Compensation Company Name:		Limited Operation Area (7AM-9AM) And (4PM-6PM):
Worker's Compensation Policy #:		

Key Dates

Approximate Start Date:
Approximate End Date:

TOTAL FEES TO BE PAID AT FILING: \$436.05

Application Fee	\$71.00	Excavation - Private Party Type	\$309.00	Records Management Fee	\$36.10
Technology Enhancement Fee	\$19.95				

Plans Checked By _____ Date _____ Permit Issued By _____ Date _____

Finalized By _____ Date _____

APPLICANT COPY

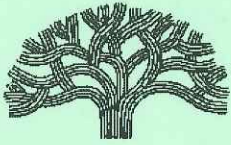

Permit No: X1402414

Parcel No: 008 062502200

Job Site: 1633 HARRISON ST

Page 2 of 2

LICENSED CONTRACTOR'S DECLARATION

I hereby affirm under penalty of perjury that I am licensed under provisions of Chapter 9 (commencing with Section 7000) of Division 3 of the Business and Professions Code, and my license is in full force and effect.

CONSTRUCTION LENDING AGENCY DECLARATION

I hereby affirm under penalty of perjury that there is a construction lending agency for the performance of the work for which this permit is issued (Section 8172, Civil Code).

Lender's Name _____

Branch Designation _____

Lender's Address _____

WORKERS' COMPENSATION DECLARATION

WARNING: FAILURE TO SECURE WORKERS' COMPENSATION COVERAGE IS UNLAWFUL, AND SHALL SUBJECT AN EMPLOYER TO CRIMINAL PENALTIES AND CIVIL FINES UP TO ONE HUNDRED THOUSAND DOLLARS (\$100,000), IN ADDITION TO THE COST OF COMPENSATION, DAMAGES AS PROVIDED FOR IN SECTION 3706 OF THE LABOR CODE, INTEREST, AND ATTORNEY'S FEES.

I hereby affirm under penalty of perjury one of the following declarations:

I have and will maintain a certificate of consent to self-insure for workers' compensation, issued by the Director of Industrial Relations as provided for by Section 3700 of the Labor Code, for the performance of the work for which this permit is issued.

I have and will maintain workers' compensation insurance, as required by Section 3700 of the Labor Code, for the performance of the work for which this permit is issued.

I certify that, in the performance of the work for which this permit is issued, I shall not employ any person in any manner so as to become subject to the workers' compensation laws of California, and agree that, if I should become subject to the workers' compensation provisions of Section 3700 of the Labor Code, I shall forthwith comply with those provisions.

HAZARDOUS MATERIALS DECLARATION

I hereby affirm that the intended occupancy WILL WILL NOT use, handle or store any hazardous, or acutely hazardous, materials. (Checking "WILL" acknowledges that Sections 25505, 25533, and 25534 of the Health and Safety Code, as well as filing instructions were made available to you).

I HEREBY CERTIFY THE FOLLOWING: That I have read this document; that the above information is correct; and that I have truthfully affirmed all applicable declarations contained in this document. I agree to comply with all city and county ordinances and state laws relating to building construction, and hereby authorize representatives of this city to enter upon the above-mentioned property for inspection purposes.

I hereby agree to save, defend, indemnify and keep harmless the City of Oakland and its officials, officers, employees, representatives, agents, and volunteers from all actions, claims, demands, litigation, or proceedings, including those for attorneys' fees, against the City in consequence of the granting of this permit or from the use or occupancy of the public right-of-way, public easement, or any sidewalk, street or sub-sidewalk or otherwise by virtue thereof, and will in all things strictly comply with the conditions under which this permit is granted I further certify that I am the owner of the property involved in this permit or that I am fully authorized by the owner to access the property and perform the work authorized by this permit.

Name _____

Signature _____

Contractor, or Contractor's Agent

Date

NOTICE: No activities related to the approved work, including storage/use of materials, is allowed within the public right-of-way without an encroachment permit. Dust control measures shall be used throughout all phases of construction.

ATTACHMENT C

CRA'S STANDARD FIELD PROCEDURES FOR WELL DESTRUCTIONS

STANDARD FIELD PROCEDURES FOR MONITORING WELL DESTRUCTION

This document presents standard field procedures for properly destroying groundwater monitoring wells. The objective of well destruction is to destroy wells in a manner that is protective of potential water resources. The two procedures most commonly used are pressure grouting and drilling out the well. These procedures are designed to comply with Federal, State and local regulatory guidelines. Specific field procedures are summarized below.

Pressure Grouting

Pressure grouting consists of injecting neat Portland cement through a tremie pipe under pressure to the bottom of the well. The cement is composed of about five gallons of water to a 94 pound sack of Portland II/V Cement. Once the well casing is full of grout, it is pressurized for five minutes by applying a pressure of 25 pounds per square inch (psi) with a grout pump. The well casing can also be pressurized by extending the well casing to the appropriate height and filling it with grout. In either case, the additional pressure allows the grout to be forced into the sand pack. After grouting the sand pack and casing, the well vault is removed and the area resurfaced or backfilled as required.

Well Drill Out

When well drill out is required, the well location is cleared for subsurface utilities and a hollow-stem auger (or other appropriate) drilling rig is used to drill out the well casing and filter pack materials. First, drill rods are placed down the well and used to guide the augers as they drill out the well. A guide auger is used in place of the drill rods if feasible. Once the well is drilled out, the boring is filled with Portland cement injected through the augers or a tremmie pipe under pressure to the bottom of the boring. The well vault is removed and the area resurfaced or backfilled as required.

Waste Handling and Disposal

Soil cuttings from drilling activities are usually stockpiled onsite and covered by plastic sheeting. At least three individual soil samples are collected from the stockpiles and composited at the analytic laboratory. The composite sample is analyzed for the same constituents analyzed in the borehole samples in addition to any analytes required by the receiving disposal facility. Soil cuttings are transported by licensed waste haulers and disposed in secure, licensed facilities based on the composite analytic results.