

**BLAINE**  
TECH SERVICES INC



1680 ROGERS AVENUE  
SAN JOSE, CALIFORNIA 95112  
(408) 573-7771 FAX  
(408) 573-0555 PHONE

January 20, 1997

Phil Briggs  
Chevron U.S.A. Products Company  
P.O. Box 6004  
San Ramon, CA 94583-0904

#### **4th Quarter 1996 Monitoring at 9-0020**

Fourth Quarter 1996 Groundwater Monitoring at  
Chevron Service Station Number 9-0020  
1633 Harrison Street  
Oakland, CA

Monitoring Performed on December 16, 1996

---

#### **Groundwater Sampling Report 961216-F-1**

This report covers the routine quarterly monitoring of groundwater wells at this Chevron facility. Blaine Tech Services, Inc.'s work at the site includes inspection, gauging, evacuation, purgewater containment, sample collection and sample handling in accordance with standard procedures that conform to Regional Water Quality Control Board requirements.

Routine field data collection includes depth to water, total well depth, thickness of any separate immiscible layer, water column volume, calculated volume of a three-case volume purge, elapsed evacuation time, total volume of water removed, and standard water parameter instrument readings. Sample material is collected, contained, stored, and transported to the laboratory in conformance with EPA standards. Purgewater is, likewise, collected and transported to McKittrick Waste Treatment Site for disposal.

Basic field information is presented alongside analytical values excerpted from the laboratory report in the cumulative table of **WELL DATA AND ANALYTICAL RESULTS**. The full analytical report for the most recent samples is located in the **Analytical Appendix**. The table

also contains new groundwater elevation calculations taken from the computer plotted gradient map which is located in the **Professional Engineering Appendix**.

At a minimum, Blaine Tech Services, Inc. field personnel are certified upon completion of a forty-hour Hazardous Materials and Emergency Response training course per 29 CFR 1910.120. Field personnel are also enrolled in annual eight hour refresher courses.

Blaine Tech Services, Inc. conducts sampling and documentation assignments of this type as an independent third party. In order to avoid compromising the objectivity necessary for the proper and disinterested performance of this work, Blaine Tech Services, Inc. concentrates on objective data collection and does not participate in the interpretation of analytical results, the definition of geological or hydrological conditions, the formulation of recommendations, or the marketing of remedial systems.

Please call if you have any questions.

Yours truly,

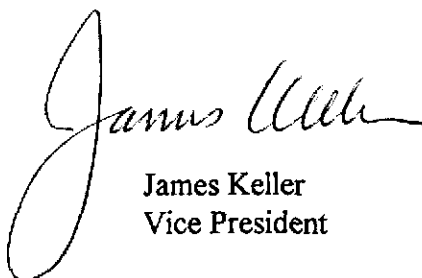
A handwritten signature in cursive script that reads "James Keller". The signature is written in black ink and is positioned above the printed name and title.

James Keller  
Vice President

JPK/cg

attachments: Professional Engineering Appendix  
Cumulative Table of Well Data and Analytical Results  
Analytical Appendix  
Field Data Sheets

# **Professional Engineering Appendix**

**EXPLANATION**

- MW-16 MONITORING WELL LOCATION AND WELL NUMBER
- 7.53 GROUND-WATER ELEVATION IN FEET ABOVE MEAN SEA LEVEL
- NM NOT MEASURED
- GROUND-WATER ELEVATION CONTOUR IN FEET ABOVE MEAN SEA LEVEL
- 0.01 → APPROXIMATE DIRECTION OF GROUND-WATER FLOW. GRADIENT INDICATED IN FEET / FEET

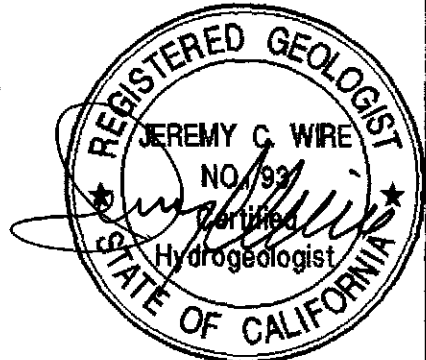
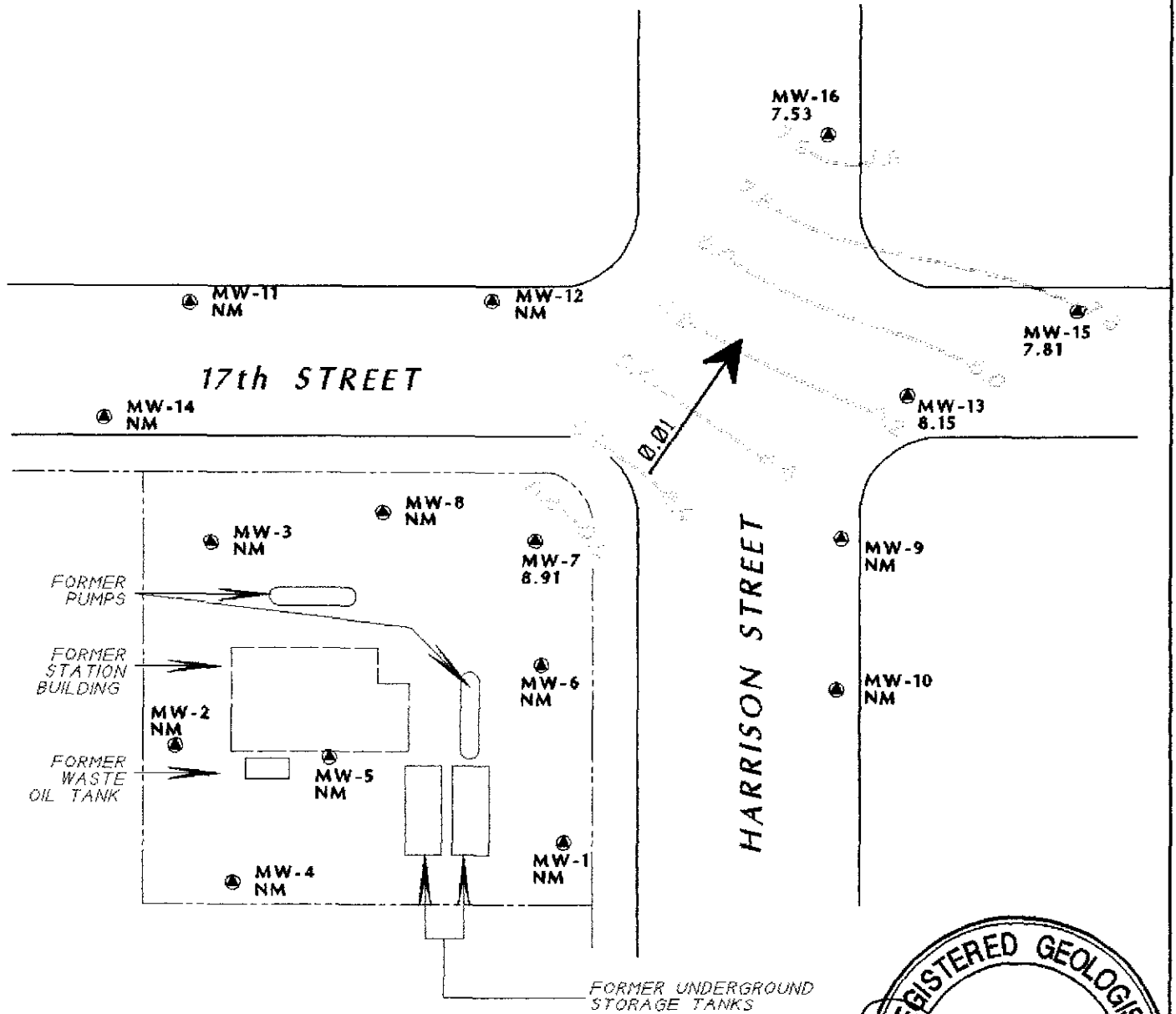

TITLE : GROUND-WATER ELEVATION CONTOUR MAP -  
DECEMBER 16, 1996

LOCATION : CHEVRON SERVICE STATION 9-0020  
1633 HARRISON STREET, OAKLAND, CALIFORNIA

SOURCE : CAMBRIA ENVIROMENTAL TECHNOLOGY, INC.



**GEOCONSULTANTS, INC**  
SAN JOSE, CALIFORNIA  
Project No. G758-09  
DRAWN BY: CHEVRON/ALAMEDA/BASE

# **Table of Well Data and Analytical Results**

## Cumulative Table of Well Data and Analytical Results

Vertical Measurements are in feet.

Analytical results are in parts per billion (ppb)

DATE	Well Head Elev.	Ground Water Elev.	Depth To Water	Notes	TPH- Gasoline	Benzene	Toluene	Ethyl- Benzene	Xylene	MTBE	TOG
<b>MW-1</b>											
11/03/88	29.82	9.42	20.40	--	<1000	<1.0	<1.0	<1.0	<1.0	--	--
02/02/89	29.82	9.11	20.71	--	--	--	--	--	--	--	--
02/10/89	29.82	--	--	--	<100	<0.2	<0.2	<0.2	<0.4	--	--
04/23/89	29.82	9.48	20.34	--	--	--	--	--	--	--	--
04/24/89	29.82	--	--	--	<50	<0.5	<1.0	<1.0	<1.0	--	<3000
07/28/89	29.82	9.24	20.58	--	<50	<0.1	<0.5	<0.2	<0.5	--	<3000
10/30/89	29.82	9.30	20.52	--	<500	<0.3	<0.3	<0.3	<0.6	--	--
01/09/90	29.82	9.05	20.77	--	<50	<0.3	<0.3	<0.3	<0.6	--	--
04/18/90	29.82	8.87	20.95	--	<50	<0.3	<0.3	<0.3	<0.6	--	--
06/22/90	29.82	8.82	21.00	--	--	--	--	--	--	--	--
08/09/90	29.82	8.88	20.94	--	<50	<0.3	<0.3	<0.3	<0.6	--	--
11/13/90	29.82	8.84	20.98	--	<50	<0.5	<0.5	<0.5	<0.5	--	--
05/15/91	29.82	9.18	20.64	--	<50	<0.5	<0.5	<0.5	<0.5	--	--
08/27/91	29.82	9.03	20.79	--	110	<0.5	<0.5	<0.5	<0.5	--	--
11/15/91	29.82	9.07	20.75	--	<50	<0.5	<0.5	<0.5	<0.5	--	--
02/20/92	29.82	8.92	20.90	--	<50	0.5	0.6	<0.5	0.9	--	--
06/15/92	29.82	9.18	20.64	--	<50	<0.5	<0.5	<0.5	<0.5	--	--
12/16/92	29.82	8.98	20.84	--	<50	<0.5	<0.5	<0.5	<0.5	--	--
04/07/93	29.82	9.91	19.91	--	<50	<0.5	<0.5	<0.5	<1.5	--	--
06/09/93	29.82	9.97	19.85	--	--	--	--	--	--	--	--
09/10/93	29.82	--	--	--	--	--	--	--	--	--	--
09/27/93	29.82	9.47	20.35	--	<50	<0.5	<0.5	<0.5	<0.5	--	--
12/17/93	29.82	9.14	20.68	--	<50	<0.5	<0.5	<0.5	<0.5	--	--
03/10/94	29.82	9.25	20.57	--	<50	<0.5	<0.5	<0.5	<0.5	--	--
06/16/94	29.82	9.27	20.55	--	<50	<0.5	<0.5	<0.5	<0.5	--	--
09/07/94	29.82	9.13	20.69	--	<50	<0.5	<0.5	<0.5	<0.5	--	--
11/30/94	29.82	9.59	20.23	--	<50	<0.5	<0.5	<0.5	<0.5	--	--
03/22/95	29.82	10.37	19.45	--	<50	<0.5	<0.5	<0.5	<0.5	--	--

NO LONGER MONITORED OR SAMPLED

## Cumulative Table of Well Data and Analytical Results

Vertical Measurements are in feet.

Analytical results are in parts per billion (ppb)

DATE	Well Head Elev.	Ground Water Elev.	Depth To Water	Notes	TPH-Gasoline	Benzene	Toluene	Ethyl-Benzene	Xylene	MTBE	TOG
<b>MW-2</b>											
11/03/88	30.59	9.70	20.89	--	<1000	<1.0	<1.0	<1.0	<1.0	--	--
02/02/89	30.59	9.38	21.21	--	--	--	--	--	--	--	--
02/10/89	30.59	--	--	--	<100	<0.2	<0.2	<0.2	<0.4	--	--
04/23/89	30.59	9.77	20.82	--	--	--	--	--	--	--	--
04/24/89	30.59	--	--	--	<50	<0.5	<1.0	<1.0	<1.0	--	<3000
07/28/89	30.59	9.57	21.02	--	<100	<0.2	<1.0	<0.2	<0.5	--	<3000
10/30/89	30.59	9.63	20.96	--	<500	<0.3	<0.3	<0.3	<0.6	--	--
01/09/90	30.59	9.34	21.25	--	<50	<0.3	<0.3	<0.3	<0.6	--	--
04/18/90	30.59	9.06	21.53	--	<50	<0.3	<0.3	<0.3	<0.6	--	--
06/22/90	30.59	9.02	21.57	--	--	--	--	--	--	--	--
08/09/90	30.59	9.04	21.55	--	<50	<0.3	<0.3	<0.3	<0.6	--	--
11/13/90	30.59	9.05	21.54	--	<50	<0.5	0.8	<0.5	0.9	--	--
05/15/91	30.59	9.44	21.15	--	83	<0.5	<0.5	<0.5	<0.5	--	--
08/27/91	30.59	9.32	21.27	--	97	<0.5	<0.5	<0.5	<0.5	--	--
11/15/91	30.59	9.29	21.30	--	<50	0.5	1.5	0.8	3.6	--	--
02/20/92	30.59	9.13	21.43	--	<50	<0.5	<0.5	<0.5	<0.5	--	--
06/15/92	30.59	9.41	21.18	--	<50	<0.5	<0.5	<0.5	<0.5	--	--
12/16/92	30.56	9.09	21.47	--	<50	<0.5	<0.5	<0.5	<0.5	--	--
04/07/93	30.56	10.03	20.53	--	66	<0.5	<0.5	<0.5	<1.5	--	--
06/09/93	30.56	10.11	20.45	--	<50	<0.5	<0.5	<0.5	<0.5	--	--
09/10/93	30.56	--	--	--	--	--	--	--	--	--	--
09/27/93	30.56	9.59	20.97	--	--	--	--	--	--	--	--
12/17/93	30.56	9.25	21.31	--	<50	<0.5	<0.5	<0.5	<0.5	--	--
03/10/94	30.56	9.33	21.23	--	<50	<0.5	<0.5	<0.5	<0.5	--	--
06/16/94	30.56	9.35	21.21	--	<50	<0.5	<0.5	<0.5	<0.5	--	--
09/07/94	30.56	9.22	21.34	--	<50	<0.5	<0.5	<0.5	<0.5	--	--
11/30/94	30.56	9.66	20.90	--	<50	<0.5	<0.5	<0.5	<0.5	--	--
03/22/95	30.56	10.22	20.34	--	<50	<0.5	<0.5	<0.5	<0.5	--	--

NO LONGER MONITORED OR SAMPLED

## Cumulative Table of Well Data and Analytical Results

Vertical Measurements are in feet.

Analytical results are in parts per billion (ppb)

DATE	Well Head Elev.	Ground Water Elev.	Depth To Water	Notes	TPH-Gasoline	Benzene	Toluene	Ethyl-Benzene	Xylene	MTBE	TOG
<b>MW-3</b>											
11/03/88	30.09	9.55	20.54	--	<1000	<1.0	<1.0	<1.0	<1.0	--	--
02/02/89	30.09	9.24	20.85	--	--	--	--	--	--	--	--
02/10/89	30.09	--	--	--	<100	<0.2	<0.2	<0.2	<0.4	--	--
04/23/89	30.09	9.66	20.43	--	--	--	--	--	--	--	--
04/24/89	30.09	--	--	--	<50	<0.5	<1.0	<1.0	<1.0	--	<3000
07/28/89	30.09	9.45	20.64	--	<100	<0.2	<1.0	<0.2	<0.4	--	<3000
10/30/89	30.09	9.48	20.61	--	<500	<0.3	<0.3	<0.3	<0.6	--	--
01/09/90	30.09	9.21	20.88	--	<50	<0.3	<0.3	<0.3	<0.6	--	--
04/18/90	30.09	8.94	21.15	--	<50	<0.3	<0.3	<0.3	<0.6	--	--
06/22/90	30.09	8.89	21.20	--	--	--	--	--	--	--	--
08/09/90	30.09	8.91	21.18	--	<50	<0.3	<0.3	<0.3	<0.6	--	--
11/13/90	30.09	8.94	21.15	--	51	<0.5	<0.5	<0.5	<0.5	--	--
05/15/91	30.09	9.18	20.91	--	85	<0.5	<0.5	<0.5	<0.5	--	--
08/27/91	30.09	9.20	20.89	*	91	<0.5	<0.5	<0.5	<0.5	--	--
11/15/91	30.09	9.07	21.02	--	<50	<0.5	0.7	<0.5	1.3	--	--
02/20/92	30.09	9.02	21.07	--	<50	<0.5	<0.5	<0.5	0.9	--	--
06/15/92	30.09	9.27	20.82	--	50	<0.5	<0.5	<0.5	<0.5	--	--
12/16/92	30.08	9.07	21.07	--	<50	<0.5	<0.5	<0.5	<0.5	--	--
04/07/93	30.08	9.95	20.13	--	<50	<0.5	<0.5	<0.5	<1.5	--	--
06/09/93	30.08	10.03	20.05	--	<50	<0.5	<0.5	<0.5	<0.5	--	--
09/10/93	30.08	--	--	--	<50	<0.5	<0.5	<0.5	<0.5	--	--
09/27/93	30.08	9.50	20.58	--	--	--	--	--	--	--	--
12/17/93	30.08	9.07	21.01	--	<50	<0.5	<0.5	<0.5	<0.5	--	--
03/10/94	30.08	9.22	20.86	--	<50	<0.5	<0.5	<0.5	1.1	--	--
06/16/94	30.08	9.21	20.87	--	<50	<0.5	<0.5	<0.5	<0.5	--	--
09/07/94	30.08	9.11	20.97	--	<50	<0.5	<0.5	<0.5	<0.5	--	--
11/30/94	30.08	10.45	19.63	--	<50	<0.5	<0.5	<0.5	<0.5	--	--
03/22/95	30.08	10.27	19.81	--	<50	<0.5	<0.5	<0.5	<0.5	--	--

NO LONGER MONITORED OR SAMPLED

\* See Table 2 of Additional Analyses.



## Cumulative Table of Well Data and Analytical Results

Vertical Measurements are in feet.

Analytical results are in parts per billion (ppb)

DATE	Well Head Elev.	Ground Water Elev.	Depth To Water	Notes	TPH-Gasoline	Benzene	Toluene	Ethyl-Benzene	Xylene	MTBE	TOG
<b>MW-4</b>											
04/23/89	31.17	9.84	21.33	--	--	--	--	--	--	--	--
04/24/89	31.17	--	--	--	<50	<0.5	<1.0	<1.0	<1.0	--	<3000
07/28/89	31.17	9.59	21.58	--	<50	<0.1	<0.5	<0.1	<0.2	--	<3000
10/30/89	31.17	9.63	21.54	--	<500	<0.3	<0.3	<0.3	<0.6	--	--
01/09/90	31.17	9.35	21.82	--	<50	<0.3	<0.3	<0.3	<0.6	--	--
04/18/90	31.17	9.08	22.09	--	<50	<0.3	<0.3	<0.3	<0.6	--	--
06/22/90	31.17	9.05	22.12	--	--	--	--	--	--	--	--
08/09/90	31.17	9.06	22.11	--	<50	<0.3	<0.3	<0.3	<0.6	--	--
11/13/90	31.17	9.07	22.10	--	<50	<0.5	1.0	0.5	1.0	--	--
05/15/91	31.17	9.46	21.71	--	<50	<0.5	<0.5	<0.5	<0.5	--	--
08/27/91	31.17	9.30	21.87	--	<50	<0.5	<0.5	<0.5	<0.5	--	--
11/15/91	31.17	9.37	21.80	--	97	<0.5	0.9	<0.5	1.9	--	--
02/20/92	31.17	9.18	21.99	--	<50	<0.5	<0.5	<0.5	<0.5	--	--
06/15/92	31.17	9.43	21.74	--	<50	<0.5	<0.5	<0.5	<0.5	--	--
12/16/92	31.17	9.12	22.05	--	<50	0.7	0.5	0.5	1.3	--	--
04/07/93	31.17	10.06	21.11	--	<50	<0.5	<0.5	<0.5	<1.5	--	--
06/09/93	31.17	--	--	--	--	--	--	--	--	--	--
09/10/93	31.17	--	--	--	--	--	--	--	--	--	--
09/27/93	31.17	9.63	21.54	--	<50	<0.5	<0.5	<0.5	<0.5	--	--
12/17/93	31.17	9.28	21.89	--	<50	<0.5	<0.5	<0.5	<0.5	--	--
03/10/94	31.17	--	--	--	--	--	--	--	--	--	--
06/16/94	31.17	10.63	20.54	--	--	--	--	--	--	--	--
09/07/94	31.17	9.27	21.90	--	<50	<0.5	<0.5	<0.5	<0.5	--	--
11/30/94	31.17	9.83	21.34	--	<50	<0.5	<0.5	<0.5	<0.5	--	--
03/21/95	31.17	10.55	20.62	--	<50	<0.5	<0.5	<0.5	<0.5	--	--

NO LONGER MONITORED OR SAMPLED

## Cumulative Table of Well Data and Analytical Results

Vertical Measurements are in feet.

Analytical results are in parts per billion (ppb)

DATE	Well Head Elev.	Ground Water Elev.	Depth To Water	Notes	TPH-Gasoline	Benzene	Toluene	Ethyl-Benzene	Xylene	MTBE	TOG
<b>MW-5</b>											
04/23/89	30.28	9.66	20.62	--	--	--	--	--	--	--	--
04/24/89	30.28	--	--	--	<50	<0.5	<1.0	<1.0	<1.0	--	<3000
07/28/89	30.28	9.42	20.86	--	<100	<0.2	<1.0	<0.2	<0.4	--	<3000
10/30/89	30.28	9.46	20.82	--	<500	<0.3	<0.3	<0.3	<0.6	--	--
01/09/90	30.28	9.21	21.07	--	<50	<0.3	<0.3	<0.3	<0.6	--	--
04/18/90	30.28	8.93	21.35	--	<50	<0.3	<0.3	<0.3	<0.6	--	--
06/22/90	30.28	8.90	21.38	--	--	--	--	--	--	--	--
08/09/90	30.28	8.92	21.36	--	<50	<0.3	<0.3	<0.3	<0.6	--	--
11/13/90	30.28	8.93	21.35	--	<50	<0.5	1.0	<0.5	1.0	--	--
05/15/91	30.28	8.99	21.29	--	<50	<0.5	<0.5	<0.5	<0.5	--	--
08/27/91	30.28	9.17	21.11	--	94	3.0	5.0	1.5	5.5	--	--
11/15/91	30.28	9.10	21.18	--	<50	0.9	1.7	<0.5	2.2	--	--
02/20/92	30.28	9.03	21.25	--	<50	<0.5	<0.5	<0.5	<0.5	--	--
06/15/92	30.28	9.28	21.00	--	<50	<0.5	<0.5	<0.5	<0.5	--	--
12/16/92	30.28	9.05	21.23	--	<50	<0.5	<0.5	<0.5	<0.5	--	--
04/07/93	30.28	9.97	20.31	--	<50	<0.5	<0.5	<0.5	<1.5	--	--
06/09/93	30.28	--	--	--	--	--	--	--	--	--	--
09/10/93	30.28	--	--	--	--	--	--	--	--	--	--
09/27/93	30.28	9.52	20.76	--	--	--	--	--	--	--	--

NO LONGER MONITORED OR SAMPLED

## Cumulative Table of Well Data and Analytical Results

Vertical Measurements are in feet.

Analytical results are in parts per billion (ppb)

DATE	Well Head Elev.	Ground Water Elev.	Depth To Water	Notes	TPH-Gasoline	Benzene	Toluene	Ethyl-Benzene	Xylene	MTBE	TOG
<b>MW-6</b>											
04/23/89	29.46	9.41	20.05	--	--	--	--	--	--	--	--
04/24/89	29.46	--	--	--	<50	<0.5	<1.0	<1.0	<1.0	--	<3.0
07/28/89	29.46	9.16	20.30	--	<100	<0.2	<1.0	<0.2	<0.4	--	<3.0
10/30/89	29.46	9.14	20.32	--	<500	<0.3	<0.3	<0.3	<0.6	--	--
01/09/90	29.46	8.95	20.51	--	<50	<0.3	<0.3	<0.3	<0.6	--	--
04/18/90	29.46	8.74	20.72	--	<50	<0.3	<0.3	<0.3	<0.6	--	--
06/22/90	29.46	8.69	20.77	--	--	--	--	--	--	--	--
08/09/90	29.46	8.72	20.74	--	<50	<0.3	<0.3	<0.3	<0.6	--	--
11/13/90	29.46	8.71	20.75	--	<50	3.0	5.0	0.5	2.0	--	--
05/15/91	29.46	8.85	20.61	--	<50	<0.5	<0.5	<0.5	<0.5	--	--
08/27/91	29.46	8.93	20.53	--	180	6.1	12	3.8	14	--	--
11/15/91	29.46	8.93	20.53	--	<50	<0.5	0.6	<0.5	<0.5	--	--
02/20/92	29.46	8.77	20.69	--	<50	0.9	1.1	<0.5	1.4	--	--
06/15/92	29.46	9.08	20.38	--	<50	<0.5	<0.5	<0.5	<0.5	--	--
12/16/92	29.45	8.88	20.57	--	<50	<0.5	<0.5	<0.5	<0.5	--	--
04/07/93	29.45	9.86	19.59	--	<50	<0.5	<0.5	<0.5	<1.5	--	--
06/09/93	29.45	9.95	19.50	--	<50	<0.5	<0.5	<0.5	<0.5	--	--
09/10/93	29.45	--	--	--	--	--	--	--	--	--	--
09/27/93	29.45	9.38	20.07	--	--	--	--	--	--	--	--

NO LONGER MONITORED OR SAMPLED

## Cumulative Table of Well Data and Analytical Results

Vertical Measurements are in feet.

Analytical results are in parts per billion (ppb)

DATE	Well Head Elev.	Ground Water Elev.	Depth To Water	Notes	TPH-Gasoline	Benzene	Toluene	Ethyl-Benzene	Xylene	MTBE	TOG
<b>MW-7</b>											
04/23/89	29.01	10.02	18.99	--	--	--	--	--	--	--	--
04/24/89	29.01	--	--	See Table 2	8400	100	260	160	1300	--	<3.0
07/28/89	29.01	9.07	19.94	--	7000	230	90	70	440	--	<3000
07/28/89	29.01	--	--	Duplicate	6000	280	180	58	430	--	--
10/30/89	29.01	9.04	19.97	--	10,000	570	55	160	400	--	--
10/30/89	29.01	--	--	Duplicate	9900	520	82	180	410	--	--
01/09/90	29.01	8.86	20.15	--	3400	290	72	9.0	200	--	--
04/18/90	29.01	8.64	20.37	--	6800	350	140	110	400	--	--
06/22/90	29.01	8.61	20.40	--	--	--	--	--	--	--	--
08/09/90	29.01	8.63	20.38	--	11,000	360	130	14	660	--	--
11/13/90	29.01	8.60	20.41	--	6500	230	110	97	460	--	--
05/15/91	29.01	8.54	20.47	--	4600	180	55	46	300	--	--
08/27/91	29.01	8.87	20.14	--	7000	220	53	63	340	--	--
11/15/91	29.01	8.79	20.22	--	3300	150	19	4.9	200	--	--
02/20/92	29.01	8.69	20.32	--	5200	520	150	100	380	--	--
06/15/92	29.01	9.03	19.98	--	10,000	760	430	320	1100	--	--
12/16/92	29.01	8.87	20.14	--	11,000	810	350	280	1100	--	--
04/07/93	29.01	9.87	19.14	--	150	1.4	0.9	0.9	4.5	--	--
06/09/93	29.01	9.96	19.05	--	180	4.0	1.0	1.0	3.0	--	--
09/10/93	29.01	--	--	--	--	--	--	--	--	--	--
09/27/93	29.01	--	--	--	--	--	--	--	--	--	--
12/17/93	29.01	--	--	--	--	--	--	--	--	--	--
03/10/94	29.01	--	--	--	--	--	--	--	--	--	--
06/16/94	29.01	--	--	--	--	--	--	--	--	--	--
09/07/94	29.01	--	--	--	--	--	--	--	--	--	--
11/30/94	29.01	--	--	Inaccessible	--	--	--	--	--	--	--
01/17/95	29.01	17.39	11.62	--	2700	140	65	44	200	--	--
03/22/95	29.01	11.33	17.68	--	160	3.4	<0.5	1.1	0.77	--	--
06/27/95	29.01	9.75	19.26	--	<50	<0.5	<0.5	<0.5	<0.5	--	--
09/28/95	29.01	9.67	19.34	--	1500	84	24	26	130	--	--
12/30/95	29.01	9.85	19.16	--	200	1.6	<0.5	1.3	5.9	5.5	--
02/28/96	29.01	10.57	18.44	--	650	14	1.3	4.2	16	34	--
06/27/96	29.01	10.29	18.72	--	640	140	10	9.8	14	55	--
09/13/96	29.01	9.61	19.40	--	1400	100	30	24	66	130	--
12/16/96	29.01	8.91	20.10	--	2600	140	72	51	180	<50	--

## Cumulative Table of Well Data and Analytical Results

Vertical Measurements are in feet.

Analytical results are in parts per billion (ppb)

DATE	Well Head Elev.	Ground Water Elev.	Depth To Water	Notes	TPH-Gasoline	Benzene	Toluene	Ethyl-Benzene	Xylene	MTBE	TOG
<b>MW-8</b>											
04/23/89	29.57	9.43	20.14	--	--	--	--	--	--	--	--
04/24/89	29.57	--	--	--	<50	<0.5	<1.0	<1.0	<1.0	--	3000
04/24/89	29.57	--	--	Duplicate	<50	<0.5	<1.0	<1.0	<1.0	--	--
07/28/89	29.57	9.20	20.37	--	<100	<0.2	<1.0	<0.2	<0.4	--	<3000
10/30/89	29.57	9.25	20.32	--	<500	<0.3	<0.3	<0.3	<0.6	--	--
01/09/90	29.57	8.97	20.60	--	<50	<0.3	<0.3	<0.3	<0.6	--	--
04/18/90	29.57	8.70	20.87	--	<50	<0.3	<0.3	<0.3	<0.6	--	--
06/22/90	29.57	9.23	20.34	--	--	--	--	--	--	--	--
08/09/90	29.57	8.68	20.89	--	<50	<0.3	<0.3	<0.3	<0.6	--	--
11/13/90	29.57	8.71	20.86	--	<50	<0.5	0.8	<0.5	2.0	--	--
05/15/91	29.57	9.08	20.49	--	<50	<0.5	<0.5	<0.5	<0.5	--	--
08/27/91	29.57	8.97	20.60	--	73	<0.5	<0.5	<0.5	<0.5	--	--
11/15/91	29.57	8.95	20.62	--	<50	<0.5	0.7	<0.5	2.1	--	--
02/20/92	29.57	8.77	20.80	--	<50	<0.5	<0.5	<0.5	<0.5	--	--
06/15/92	29.57	9.09	20.48	--	<50	<0.5	<0.5	<0.5	<0.5	--	--
12/16/92	29.57	8.89	20.68	--	<50	<0.5	<0.5	<0.5	<0.5	--	--
04/07/93	29.57	9.87	19.70	--	<50	<0.5	<0.5	<0.5	<1.5	--	--
06/09/93	29.57	9.97	19.60	--	<50	<0.5	<0.5	<0.5	<0.5	--	--
09/10/93	29.57	--	--	--	--	--	--	--	--	--	--
09/27/93	29.57	9.35	20.22	--	--	--	--	--	--	--	--

NO LONGER MONITORED OR SAMPLED

## Cumulative Table of Well Data and Analytical Results

Vertical Measurements are in feet.

Analytical results are in parts per billion (ppb)

DATE	Well	Ground	Depth	Notes	TPH- Gasoline	Benzene	Toluene	Ethyl- Benzene	Xylene	MTBE	TOG
	Head Elev.	Water Elev.	To Water								
<b>MW-9</b>											
06/22/90	28.67	7.87	20.80	--	5700	47	31	280	530	--	<1000
08/09/90	28.67	7.93	20.74	--	8000	<0.3	17	210	480	--	--
11/13/90	28.67	7.89	20.78	--	6400	<3.0	20	240	450	--	--
05/15/91	28.67	8.19	20.48	--	5700	2.0	16	190	390	--	--
08/27/91	28.67	8.12	20.55	--	6700	<3.0	31	180	350	--	--
11/15/91	28.67	8.10	20.57	--	4000	8.8	26	150	280	--	--
02/20/92	28.67	6.90	21.77	--	3400	13	30	230	460	--	--
06/15/92	28.67	8.30	20.37	--	4500	19	72	280	560	--	--
12/16/92	28.68	8.39	20.29	--	9900	380	220	380	1300	--	--
04/07/93	28.68	9.36	19.32	--	8700	51	150	360	1000	--	--
06/09/93	28.68	9.52	19.16	--	8900	170	160	350	1100	--	--
09/10/93	28.68	--	--	--	4600	110	63	190	350	--	--
09/27/93	28.68	8.74	19.94	--	--	--	--	--	--	--	--
12/17/93	28.68	8.37	20.31	--	4600	92	85	180	300	--	--
03/10/94	28.68	8.38	20.30	--	3300	8.0	29	120	170	--	--
06/16/94	28.68	8.42	20.26	--	2900	4.8	16	85	64	--	--
09/07/94	28.68	8.27	20.41	--	2900	<0.5	9.9	70	75	--	--
11/30/94	28.68	8.70	19.98	--	2100	<5.0	<5.0	53	51	--	--
03/22/95	28.68	9.27	19.41	--	2200	<5.0	5.3	26	69	--	--
06/27/95	28.68	9.28	19.40	--	2900	7.4	10	68	99	--	--
09/28/95	28.68	9.13	19.55	--	4000	32	<10	36	44	--	--
12/30/95	28.68	8.88	19.80	--	3800	<5.0	13	<5.0	120	120	--
02/28/96	28.68	8.93	19.75	--	2000	9.9	<5.0	46	30	<25	--
06/27/96	28.68	9.13	19.55	--	2400	36	7.1	65	72	<50	--
09/13/96	28.68	8.86	19.82	--	2500	26	8.4	53	39	36	--
12/16/96	28.68	7.91	20.77	--	1200	3.5	2.4	12	14	<10	--

## Cumulative Table of Well Data and Analytical Results

Vertical Measurements are in feet.

Analytical results are in parts per billion (ppb)

DATE	Well Head Elev.	Ground Water Elev.	Depth To Water	Notes	TPH-Gasoline	Benzene	Toluene	Ethyl-Benzene	Xylene	MTBE	TOG
<b>MW-10</b>											
06/22/90	28.60	8.12	20.48	--	<50	<0.5	<0.5	<0.5	<0.5	--	<1000
08/09/90	28.60	8.15	20.45	--	<50	<0.3	<0.3	<0.3	<0.6	--	--
11/13/90	28.60	8.13	20.47	--	<50	<0.5	2.0	0.5	2.0	--	--
05/15/91	28.60	8.45	20.15	--	<50	<0.5	<0.5	<0.5	<0.5	--	--
08/27/91	28.60	8.33	20.27	--	<50	<0.5	<0.5	<0.5	<0.5	--	--
11/15/91	28.60	8.27	20.33	--	<50	<0.5	<0.5	<0.5	<0.5	--	--
02/20/92	28.60	7.15	21.45	--	<50	2.0	2.2	<0.5	2.1	--	--
06/15/92	28.60	7.30	21.30	--	<50	<0.5	<0.5	<0.5	<0.5	--	--
12/16/92	28.62	8.45	20.17	--	<50	<0.5	<0.5	<0.5	<0.5	--	--
04/07/93	28.62	9.41	19.26	--	<50	<0.5	<0.5	<0.5	<1.5	--	--
06/09/93	28.62	9.55	19.07	--	<50	<0.5	<0.5	<0.5	<0.5	--	--
09/10/93	28.62	--	--	--	<50	<0.5	<0.5	<0.5	<0.5	--	--
09/24/93	28.62	8.90	19.72	--	--	--	--	--	--	--	--
12/17/93	28.62	8.55	20.07	--	<50	<0.5	<0.5	<0.5	<0.5	--	--
03/10/94	28.62	8.65	19.97	--	<50	<0.5	<0.5	<0.5	<0.5	--	--
06/16/94	28.62	8.64	19.98	--	<50	<0.5	<0.5	<0.5	<0.5	--	--
09/07/94	28.62	8.50	20.12	--	<50	<0.5	<0.5	<0.5	<0.5	--	--
11/30/94	28.62	8.92	19.70	--	<50	<0.5	<0.5	<0.5	<0.5	--	--
03/22/95	28.62	9.70	18.92	--	<50	<0.5	<0.5	<0.5	<0.5	--	--

NO LONGER MONITORED OR SAMPLED

## Cumulative Table of Well Data and Analytical Results

Vertical Measurements are in feet.

Analytical results are in parts per billion (ppb)

DATE	Well Head Elev.	Ground Water Elev.	Depth To Water	Notes	TPH-Gasoline	Benzene	Toluene	Ethyl-Benzene	Xylene	MTBE	TOG
<b>MW-11</b>											
06/22/90	29.37	8.34	21.03	--	<50	<0.5	<0.5	<0.5	<0.5	---	<1000
08/09/90	29.37	8.35	21.02	--	<50	<0.3	<0.3	<0.3	<0.6	--	--
11/13/90	29.37	8.44	20.93	--	76	0.6	1.0	0.9	4.0	--	--
05/15/91	29.37	8.76	20.61	--	78	<0.5	<0.5	<0.5	<0.5	--	--
08/27/91	29.37	8.67	20.70	--	110	<0.5	<0.5	<0.5	<0.5	--	--
11/15/91	29.37	8.69	20.68	--	<50	<0.5	<0.5	<0.5	<0.5	--	--
02/20/92	29.37	7.46	21.91	--	<50	1.9	2.1	1.0	4.4	--	--
06/15/92	29.37	8.81	20.56	--	--	--	--	--	--	--	--
12/16/92	29.39	8.64	20.75	--	<50	<0.5	<0.5	<0.5	<0.5	--	--
04/07/93	29.39	9.56	19.83	--	<50	<0.5	<0.5	<0.5	<1.5	--	--
06/09/93	29.39	9.72	19.67	--	<50	<0.5	<0.5	<0.5	<0.5	--	--
09/10/93	29.39	--	--	--	--	--	--	--	--	--	--
09/27/93	29.39	9.06	20.33	--	<50	<0.5	<0.5	<0.5	<0.5	--	--
12/17/93	29.39	8.66	20.73	--	<50	<0.5	<0.5	<0.5	<0.5	--	--
03/10/94	29.39	8.70	20.69	--	--	--	--	--	--	--	--
06/16/94	29.39	8.83	20.56	--	<50	<0.5	<0.5	<0.5	<0.5	--	--

NO LONGER MONITORED OR SAMPLED

### MW-12

06/22/90	28.43	7.98	20.45	--	<50	<0.5	<0.5	<0.5	<0.5	--	<1000
08/09/90	28.43	8.00	20.43	--	<50	<0.3	<0.3	<0.3	<0.6	--	--
11/13/90	28.43	7.98	20.45	--	<50	<0.5	<0.5	<0.5	<0.5	--	--
05/15/91	28.43	8.36	20.07	--	<50	<0.5	<0.5	<0.5	<0.5	--	--
08/27/91	28.43	8.28	20.15	--	56	<0.5	<0.5	<0.5	<0.5	--	--
11/15/91	28.43	8.18	20.25	--	<50	<0.5	<0.5	<0.5	<0.5	--	--
02/20/92	28.43	7.06	21.37	--	<50	2.5	3.1	0.7	3.0	--	--
06/15/92	28.43	8.53	19.90	--	<50	<0.5	<0.5	<0.5	<0.5	--	--
12/16/92	28.43	8.63	19.80	--	<50	<0.5	<0.5	<0.5	<0.5	--	--
04/07/93	28.43	9.68	18.75	--	<50	<0.5	<0.5	<0.5	<1.5	--	--
06/09/93	28.43	--	--	--	--	--	--	--	--	--	--
09/10/93	28.43	--	--	--	--	--	--	--	--	--	--
09/27/93	28.43	8.80	19.63	--	--	--	--	--	--	--	--

NO LONGER MONITORED OR SAMPLED



## Cumulative Table of Well Data and Analytical Results

Vertical Measurements are in feet.

Analytical results are in parts per billion (ppb)

DATE	Well	Ground	Depth	Notes	TPH- Gasoline	Benzene	Toluene	Ethyl- Benzene	Xylene	MTBE	TOG	
	Head Elev.	Water Elev.	To Water									
<b>MW-13</b>												
11/15/91	28.63	7.56	21.07	*	3100	68	40	110	270	--	--	
02/20/92	28.63	6.46	22.17	--	3100	120	50	240	400	--	--	
06/15/92	28.63	7.96	20.67	--	3200	35	33	210	300	--	--	
12/16/92	28.62	8.28	20.34	--	87,000	1400	540	2400	11,000	--	--	
04/07/93	28.62	9.21	19.41	--	1500	72	12	70	160	--	--	
06/09/93	28.62	9.42	19.20	--	210	6.0	2.0	7.0	16	--	--	
09/10/93	28.62	--	--	--	73	3.0	<0.5	2.0	3.0	--	--	
09/27/93	28.62	8.27	20.35	--	--	--	--	--	--	--	--	
12/17/93	28.62	7.86	20.76	--	640	43	12	12	37	--	--	
03/10/94	28.62	7.93	20.69	--	540	44	22	10	69	--	--	
06/16/94	28.62	7.95	20.67	--	1800	63	12	18	64	--	--	
09/07/94	28.62	7.79	20.83	--	1400	59	12	22	50	--	--	
11/30/94	28.62	8.21	20.41	--	700	36	4.4	18	31	--	--	
03/22/95	28.62	8.80	19.82	--	190	1.4	1.4	<0.5	<0.5	--	--	
06/27/95	28.62	8.86	19.76	--	220	1.8	<0.5	<0.5	0.84	--	--	
09/28/95	28.62	8.58	20.04	--	160	3.2	<0.5	0.97	2.2	--	--	
12/30/95	28.62	8.32	20.30	--	190	0.94	<0.5	0.74	1.1	<2.5	--	
02/28/96	28.62	8.73	19.89	--	130	<0.5	<0.5	<0.5	<0.5	<2.5	--	
06/27/96	28.62	8.64	19.98	--	280	<0.5	1.4	<0.5	3.8	9.4	--	
09/13/96	28.62	8.34	20.28	--	170	<0.5	<0.5	<0.5	0.89	2.7	--	
12/16/96	28.62	8.15	20.47	--	170	<0.5	0.51	0.60	3.0	<2.5	--	
<b>MW-14</b>												
11/15/91	29.46	9.13	20.33	--	<50	<0.5	<0.5	<0.5	<0.5	--	--	
02/20/92	29.46	8.05	21.41	--	<50	1.3	1.8	1.1	5.2	--	--	
06/15/92	29.46	--	--	--	--	--	--	--	--	--	--	
12/16/92	29.45	8.79	20.66	--	<50	<0.5	<0.5	<0.5	<0.5	--	--	
04/07/93	29.45	--	--	--	--	--	--	--	--	--	--	
06/09/93	29.45	--	--	--	--	--	--	--	--	--	--	
09/10/93	29.45	--	--	--	--	--	--	--	--	--	--	
09/27/93	29.45	9.19	20.26	--	--	--	--	--	--	--	--	

NO LONGER MONITORED OR SAMPLED

\* See Table 2 of Additional Analyses.

## Cumulative Table of Well Data and Analytical Results

Vertical Measurements are in feet.

Analytical results are in parts per billion (ppb)

DATE	Well Head Elev.	Ground Water Elev.	Depth To Water	Notes	TPH-Gasoline	Benzene	Toluene	Ethyl-Benzene	Xylene	MTBE	TOG
<b>MW-15</b>											
12/16/92	28.04	8.30	19.74	--	<50	<0.5	<0.5	<0.5	<0.5	--	--
04/07/93	28.04	9.24	18.80	--	<50	1.3	<0.5	<0.5	<1.5	--	--
06/09/93	28.04	9.44	18.60	--	<50	<0.5	<0.5	<0.5	<0.5	--	--
09/10/93	28.04	--	--	--	--	--	--	--	--	--	--
09/27/93	28.04	8.11	19.93	--	<50	2.0	<0.5	<0.5	<0.5	--	--
12/17/93	28.04	7.72	20.32	--	<50	<0.5	<0.5	<0.5	<0.5	--	--
03/10/94	28.04	7.75	20.29	--	<50	<0.5	<0.5	<0.5	<0.5	--	--
06/16/94	28.04	7.73	20.31	--	<50	<0.5	<0.5	<0.5	<0.5	--	--
09/07/94	28.04	7.61	20.43	--	<50	<0.5	<0.5	<0.5	<0.5	--	--
11/30/94	28.04	8.03	20.01	--	<50	<0.5	<0.5	<0.5	<0.5	--	--
03/22/95	28.04	8.57	19.47	--	69	4.9	<0.5	<0.5	<0.5	--	--
06/27/95	28.04	8.70	19.34	--	<50	3.9	<0.5	1.4	<0.5	--	--
09/28/95	28.04	8.38	19.66	--	<50	0.82	<0.5	<0.5	<0.5	--	--
12/30/95	28.04	8.10	19.94	--	160	7.0	1.4	<0.5	1.8	14	--
02/28/96	28.04	8.41	19.63	--	81	1.7	<0.5	<0.5	<0.5	<2.5	--
06/27/96	28.04	8.44	19.60	--	<50	<0.5	<0.5	<0.5	<0.5	<5.0	--
09/13/96	28.04	8.14	19.90	--	<50	<0.5	<0.5	<0.5	<0.5	<2.5	--
12/16/96	28.04	7.81	20.23	--	<50	<0.5	<0.5	<0.5	<0.5	<2.5	--

## Cumulative Table of Well Data and Analytical Results

Vertical Measurements are in feet.

Analytical results are in parts per billion (ppb)

DATE	Well	Ground	Depth	Notes	TPH- Gasoline	Benzene	Toluene	Ethyl- Benzene	Xylene	MTBE	TOG	
	Head Elev.	Water Elev.	To Water									
<b>MW-16</b>												
12/16/92	28.32	8.74	19.58	--	--	--	--	--	--	--	--	
12/21/92	28.32	--	--	--	<50	<0.5	<0.5	<0.5	<0.5	--	--	
04/07/93	28.32	9.91	18.41	--	<50	<0.5	6.8	<0.5	<0.5	--	--	
06/09/93	28.32	10.07	18.25	--	<50	<0.5	<0.5	<0.5	<0.5	--	--	
09/10/93	28.32	--	--	--	<50	<0.5	<0.5	<0.5	<0.5	--	--	
09/27/93	28.32	8.16	20.16	--	--	--	--	--	--	--	--	
12/17/93	28.32	--	--	--	--	--	--	--	--	--	--	
03/10/94	28.32	7.77	20.55	--	<50	<0.5	<0.5	<0.5	<0.5	--	--	
06/16/94	28.32	7.67	20.65	--	<50	0.9	0.7	<0.5	<0.5	--	--	
09/07/94	28.32	7.59	20.73	--	150	1.3	0.8	1.2	3.6	--	--	
11/30/94	28.32	8.04	20.28	--	4200	300	<5.0	34	350	--	--	
03/22/95	28.32	8.65	19.67	--	2900	180	5.7	21	91	--	--	
06/27/95	28.32	8.72	19.60	--	2000	330	10	27	48	--	--	
09/28/95	28.32	--	--	Inaccessible	--	--	--	--	--	--	--	
12/30/95	28.32	8.06	20.26	--	3100	770	39	30	80	<12	--	
02/28/96	28.32	8.48	19.84	--	1600	320	15	11	21	<25	--	
06/27/96	28.32	8.45	19.87	--	2900	670	48	54	86	280	--	
09/13/96	28.32	8.17	20.15	--	1400	18	4.0	8.6	16	<10	--	
12/16/96	28.32	7.53	20.79	--	3100	500	25	23	52	<25	--	

## Cumulative Table of Well Data and Analytical Results

Vertical Measurements are in feet.

Analytical results are in parts per billion (ppb)

DATE	Well Head Elev.	Ground Water Elev.	Depth To Water	Notes	TPH-Gasoline	Benzene	Toluene	Ethyl-Benzene	Xylene	MTBE	TOG
<b>TRIP BLANK</b>											
11/03/88	--	--	--	--	--	<1.0	<1.0	<1.0	<1.0	--	--
02/10/89	--	--	--	--	<50	<0.1	<0.1	<0.1	<0.2	--	--
04/24/89	--	--	--	--	<50	<0.5	<0.5	<1.0	<1.0	--	--
07/28/89	--	--	--	--	<50	<0.1	<0.1	<0.1	<0.2	--	--
10/30/89	--	--	--	--	<500	<0.3	<0.3	<0.3	<0.6	--	--
01/09/90	--	--	--	--	<50	<0.3	<0.3	<0.3	<0.6	--	--
04/18/90	--	--	--	--	<50	<0.3	<0.3	<0.3	<0.6	--	--
06/22/90	--	--	--	--	<50	<0.5	<0.5	<0.5	<0.5	--	--
08/09/90	--	--	--	--	<50	<0.3	<0.3	<0.3	<0.6	--	--
11/13/90	--	--	--	--	<50	<0.5	<0.5	<0.5	<0.5	--	--
05/15/91	--	--	--	--	<50	<0.5	<0.5	<0.5	<0.5	--	--
08/27/91	--	--	--	--	<50	<0.5	<0.5	<0.5	<0.5	--	--
11/15/91	--	--	--	--	<50	<0.5	<0.5	<0.5	<0.5	--	--
02/20/92	--	--	--	--	<50	<0.5	<0.5	<0.5	<0.5	--	--
06/15/92	--	--	--	--	<50	<0.5	<0.5	<0.5	<0.5	--	--
12/16/92	--	--	--	--	<50	<0.5	<0.5	<0.5	<0.5	--	--
04/07/93	--	--	--	--	<50	<0.5	<0.5	<0.5	<1.5	--	--
06/09/93	--	--	--	--	<50	<0.5	<0.5	<0.5	<0.5	--	--
09/10/93	--	--	--	--	<50	<0.5	<0.5	<0.5	<0.5	--	--
09/27/93	--	--	--	--	<50	<0.5	<0.5	<0.5	<0.5	--	--
12/17/93	--	--	--	--	<50	<0.5	<0.5	<0.5	<0.5	--	--
03/10/94	--	--	--	--	<50	<0.5	0.6	<0.5	0.6	--	--
06/16/94	--	--	--	--	<50	<0.5	<0.5	<0.5	<0.5	--	--
09/07/94	--	--	--	--	<50	<0.5	<0.5	<0.5	<0.5	--	--
11/30/94	--	--	--	--	<50	<0.5	<0.5	<0.5	<0.5	--	--
01/17/95	--	--	--	--	<50	<0.5	<0.5	<0.5	<0.5	--	--
03/22/95	--	--	--	--	<50	<0.5	<0.5	<0.5	<0.5	--	--
06/27/95	--	--	--	--	<50	<0.5	<0.5	<0.5	<0.5	--	--
09/28/95	--	--	--	--	<50	<0.5	<0.5	<0.5	<0.5	--	--
12/30/95	--	--	--	--	<50	<0.5	<0.5	<0.5	<0.5	--	--
02/28/96	--	--	--	--	<50	<0.5	<0.5	<0.5	<0.5	<2.5	--
06/27/96	--	--	--	--	<50	<0.5	<0.5	<0.5	<0.5	<5.0	--
09/13/96	--	--	--	--	<50	<0.5	<0.5	<0.5	<0.5	--	--
12/16/96	--	--	--	--	<50	<0.5	<0.5	<0.5	<0.5	<2.5	--

## Cumulative Table of Well Data and Analytical Results

### TABLE OF ADDITIONAL ANALYSES

Vertical Measurements are in feet.

Analytical values are in parts per billion (ppb)

DATE	Carbon Tet	Chloro-form	PCE	TCE	1, 2,-DCE	t-1, 2-DCE	c-1, 2-DCE	1, 1, 1-TCA	1,2-DCA	1, 2-DCP	1, 2-DCP
<b>MW-1</b>											
11/03/88	18	7.0	<1.0	<1.0	--	<1.0	--	<1.0	<1.0	--	--
02/10/89	17	6.0	<0.2	<0.2	--	<0.2	<0.2	<0.2	<0.2	--	--
04/24/89	16	6.0	<1.0	<1.0	<1.0	--	--	<1.0	<1.0	--	--
07/28/89	20	6.4	<0.1	<0.1	--	<0.1	<0.1	0.3	<0.1	--	--
10/30/89	11	4.9	<0.5	<0.5	<0.5	--	--	<0.5	<0.5	--	--
01/09/90	24	7.2	<0.5	<0.5	<0.5	--	--	<0.5	<0.5	--	--
04/18/90	23	5.5	<0.5	<0.5	<0.5	--	--	1.4	<0.5	<0.5	<0.5
08/09/90	32	11	0.7	<0.5	<0.5	--	--	<0.5	<0.5	<0.5	<0.5
11/13/90	24	7.0	60.7	<0.5	--	<0.5	<0.5	<0.5	<0.5	<0.5	<0.5
05/15/91	15	5.0	<0.5	<0.5	--	<0.5	<0.5	<0.5	<0.5	<0.5	<0.5
08/27/91	18	4.2	<0.5	<0.5	--	--	<0.5	<0.5	<0.5	<0.5	<0.5
11/15/91	21	7.9	<0.5	<0.5	--	<0.5	<0.5	<0.5	<0.5	<0.5	<0.5
02/20/92	24	7.5	<0.5	<0.5	--	<0.5	<0.5	<0.5	<0.5	<0.5	<0.5
06/15/92	10	3.2	<0.5	<0.5	--	<0.5	<0.5	<0.5	<0.5	<0.5	<0.5
<b>MW-2</b>											
11/03/88	3.0	2.0	34	3.0	--	10	--	<1.0	<1.0	--	--
02/10/89	1.4	1.0	17.2	<0.2	--	<0.2	6.3	<0.2	<0.2	--	--
04/24/89	2.0	2.0	38	3.0	9.0	--	--	<1.0	<1.0	--	--
07/28/89	3.7	2.0	46	2.6	--	<0.2	<0.2	<0.2	<0.2	--	--
10/30/89	1.4	2.6	53	1.1	14	--	--	<0.5	<0.5	--	--
01/09/90	3.6	3.9	78	5.3	16	--	--	<0.5	<0.5	--	--
04/18/90	1.5	2.7	130	3.9	19	--	--	<0.5	<0.5	<0.5	<0.5
08/09/90	2.1	2.1	74	6.1	15	--	--	<0.5	<0.5	<0.5	<0.5
11/13/90	<0.5	2.0	40	4.0	--	<0.5	10	<0.5	<0.5	<0.5	<0.5
05/15/91	2.0	2.0	56	6.0	--	<0.5	15	<0.5	<0.5	<0.5	<0.5
08/27/91	1.1	0.9	46	3.9	--	--	8.0	<0.5	<0.5	<0.5	<0.5
11/15/91	0.6	1.1	58	3.1	--	<0.5	6.3	<0.5	<0.5	<0.5	<0.5
02/20/92	11	<2.5	62	3.1	--	<2.5	4.3	<2.5	<2.5	<2.5	<2.5
06/15/92	<0.5	1.2	45	3.1	--	<0.5	4.8	<0.5	<0.5	<0.5	<0.5

## Cumulative Table of Well Data and Analytical Results

Vertical Measurements are in feet.

Analytical values are in parts per billion (ppb)

DATE	Carbon Tet	Chloro-form	PCE	TCE	1, 2,-DCE	t-1, 2-DCE	c-1, 2-DCE	1, 1, 1-TCA	1,2-DCA	1, 2-DCP	1, 2-DCP
<b>MW-3</b>											
11/03/88	8.0	6.0	84	3.0	--	5.0	--	<1.0	<1.0	--	--
02/10/89	5.8	4.0	53	1.9	--	<0.2	9.0	<0.2	<0.2	--	--
04/24/89	7.0	6.0	110	3.0	11	--	--	<1.0	<1.0	--	--
07/28/89	8.6	5.0	49	2.1	--	<0.2	11	<0.2	<0.1	--	--
10/30/89	5.6	5.3	62	0.7	8.2	--	--	<0.5	<0.5	--	--
01/09/90	8.6	6.1	81	73.8	8.7	--	--	<0.5	<0.5	--	--
04/18/90	7.6	5.8	120	2.4	11	--	--	<0.5	<0.5	<0.5	<0.5
08/09/90	11	6.7	81	5.1	11	--	--	<0.5	<0.5	<0.5	<0.5
11/13/90	7.0	5.0	43	4.0	--	<0.5	9.0	<0.5	<0.5	<0.5	<0.5
05/15/91	6.0	4.0	46	3.0	--	<0.5	8.0	<0.5	<0.5	<0.5	<0.5
08/27/91	5.5	3.8	43	2.6	--	--	8.1	<0.5	<0.5	<0.5	<0.5
11/15/91	6.3	5.0	67	3.4	--	0.8	7.4	0.9	<0.5	<0.5	<0.5
02/20/92	2.8	4.0	96	3.0	--	<2.5	6.1	<2.5	<2.5	<2.5	<2.5
06/15/92	5.0	3.9	86	2.9	--	<0.5	7.5	<0.5	<0.5	<0.5	<0.5
<b>MW-4</b>											
04/24/89	35	11	<1.0	<1.0	<1.0	--	--	<1.0	<1.0	--	--
07/28/89	32	9.3	<0.1	<0.1	--	<0.1	<0.1	<0.1	<0.1	--	--
10/30/89	32	8.5	<0.5	<0.5	<0.5	--	--	<0.5	<0.5	--	--
01/09/90	36	9.8	<0.5	<0.5	<0.5	--	--	<0.5	<0.5	--	--
04/18/90	41	9.5	<0.5	<0.5	<0.5	--	--	<0.5	<0.5	<0.5	<0.5
08/09/90	38	11	<0.5	<0.5	<0.5	--	--	<0.5	<0.5	<0.5	<0.5
11/13/90	40	11	<0.5	<0.5	--	<0.5	<0.5	<0.5	<0.5	<0.5	<0.5
05/15/91	35	10	<0.5	<0.5	--	<0.5	<0.5	<0.5	<0.5	<0.5	<0.5
08/27/91	28	6.1	<0.5	<0.5	--	--	<0.5	<0.5	<0.5	<0.5	<0.5
11/15/91	23	9.1	<0.5	<0.5	--	<0.5	<0.5	<0.5	<0.5	<0.5	<0.5
02/20/92	400	140	<0.5	<0.5	--	<0.5	<0.5	<0.5	<0.5	<0.5	<0.5
06/15/92	38	11	<0.5	<0.5	--	<0.5	<0.5	<0.5	<0.5	<0.5	<0.5

## Cumulative Table of Well Data and Analytical Results

Vertical Measurements are in feet.

Analytical values are in parts per billion (ppb)

DATE	Carbon Tet	Chloro-form	PCE	TCE	1, 2,-DCE	t-1, 2-DCE	c-1, 2-DCE	1, 1, 1-TCA	1,2-DCA	1, 2-DCP	1, 2-DCP
<b>MW-5</b>											
04/24/89	4.0	5.0	4.0	<1.0	2.0	--	--	<1.0	<1.0	--	--
07/28/89	5.6	4.0	5.3	0.3	--	<0.2	2.3	0.5	<0.2	--	--
10/30/89	2.9	2.0	2.7	<0.5	0.86	--	--	<0.5	<0.5	--	--
01/09/90	8.2	4.6	7.8	0.6	3.1	--	--	<0.5	<0.5	--	--
04/18/90	6.3	2.8	2.6	<0.5	1.7	--	--	<0.5	<0.5	<0.5	<0.5
08/09/90	11	4.8	6.0	<0.5	2.3	--	--	<0.5	<0.5	<0.5	<0.5
11/13/90	7.0	3.0	5.0	<0.5	--	<0.5	1	<0.5	<0.5	<0.5	<0.5
05/15/91	4.0	2.0	3.0	<0.5	--	<0.5	0.8	<0.5	<0.5	<0.5	<0.5
08/27/91	3.3	1.1	2.3	<0.5	--	--	<0.5	<0.5	<0.5	<0.5	<0.5
11/15/91	5.7	2.8	5.5	<0.5	--	<0.5	1.7	<0.5	<0.5	<0.5	<0.5
02/20/92	4.0	2.0	3.9	<0.5	--	<0.5	0.7	<0.5	<0.5	<0.5	<0.5
06/15/92	4.0	2.0	5.0	<0.5	--	<0.5	1.4	<0.5	<0.5	<0.5	<0.5
<b>MW-6</b>											
04/24/89	13	7.0	<1.0	<1.0	<1.0	--	--	<1.0	<1.0	--	--
07/28/89	9.6	4.0	<0.2	<0.2	--	<0.2	<0.2	0.5	0.6	--	--
10/30/89	8.2	3.6	<0.5	<0.5	<0.5	--	--	<0.5	<0.5	--	--
01/09/90	10	4.2	<0.5	<0.5	<0.5	--	--	<0.5	1.8	--	--
04/18/90	11	3.8	<0.5	<0.5	<0.5	--	--	<0.5	<0.5	<0.5	<0.5
08/09/90	20	6.6	<0.5	<0.5	<0.5	--	--	<0.5	<0.5	<0.5	<0.5
11/13/90	15	5.0	<0.5	<0.5	--	<0.5	<0.5	<0.5	<0.5	<0.5	<0.5
05/15/91	11	4.0	<0.5	<0.5	--	<0.5	<0.5	<0.5	<0.5	<0.5	<0.5
08/27/91	8.0	2.2	2.4	<0.5	--	--	<0.5	<0.5	<0.5	<0.5	<0.5
11/15/91	13	5.4	<0.5	<0.5	--	<0.5	<0.5	<0.5	0.8	<0.5	<0.5
02/20/92	11	4.0	<0.5	<0.5	--	<0.5	<0.5	<0.5	<0.5	<0.5	<0.5
06/15/92	9.6	4.2	<0.5	<0.5	--	<0.5	<0.5	<0.5	<0.5	<0.5	<0.5

## Cumulative Table of Well Data and Analytical Results

Vertical Measurements are in feet.

Analytical values are in parts per billion (ppb)

DATE	Carbon Tet	Chloro-form	PCE	TCE	1, 2-DCE	1-1, 2-DCE	c-1, 2-DCE	1, 1, 1-TCA	1,2-DCA	1, 2-DCP	1, 2-DCP
<b>MW-7</b>											
04/24/89	3.0	9.0	<1.0	<1.0	<1.0	--	--	<1.0	<1.0	--	--
07/28/89	<2.0	<10	<2.0	<2.0	--	<2.0	<2.0	<1.0	6.0	--	--
07/28/89	<5.0	<20	<5.0	<5.0	--	<5.0	<0.5	<5.0	<5.0	--	--
10/30/89	<1.0	3.9	<1.0	<1.0	<1.0	--	--	<1.0	6.4	--	--
10/30/89	<1.0	3.1	<1.0	<1.0	<1.0	--	--	<1.0	6.2	--	--
01/09/90	<0.5	3.0	<0.5	<0.5	<0.5	--	--	<0.5	8.4	--	--
04/18/90	<0.5	3.2	<0.5	<0.5	<0.5	--	--	<0.5	7.7	0.6	0.6
08/09/90	3.3	7.7	<0.5	<0.5	<0.5	--	--	<0.5	8.4	<0.5	<0.5
11/13/90	0.6	3.0	<0.5	<0.5	--	<0.5	<0.5	<0.5	4.0	<0.5	<0.5
05/15/91	2.0	2.0	<0.5	<0.5	--	<0.5	<0.5	<0.5	3.0	<0.5	<0.5
08/27/91	0.7	2.8	<0.5	<0.5	--	--	<0.5	<0.5	2.7	<0.5	<0.5
11/15/91	0.8	2.7	<0.5	<0.5	--	<0.5	<0.5	<0.5	3.1	<0.5	<0.5
02/20/92	2.2	1.9	<0.5	<0.5	--	<0.5	<0.5	<0.5	3.3	<0.5	<0.5
06/15/92	1.1	1.8	<0.5	<0.5	--	<0.5	<0.5	<0.5	4.5	<0.5	<0.5
<b>MW-8</b>											
04/24/89	2.0	3.0	6.0	<1.0	4.0	--	--	<1.0	<1.0	--	--
04/24/89	2.0	2.0	6.0	<1.0	3.0	--	--	<1.0	<1.0	--	--
07/28/89	2.3	2.0	5.6	<0.2	--	<0.2	3.8	<0.2	<0.2	--	--
10/30/89	2.5	2.6	8.0	<0.5	5.5	--	--	<0.5	<0.5	--	--
01/09/90	4.9	3.9	19	0.9	6.6	--	--	<0.5	<0.5	--	--
04/18/90	3.8	2.8	17	0.6	5.7	--	--	<0.5	<0.5	<0.5	<0.5
08/09/90	5.3	4.4	27	1.2	9.2	--	--	<0.5	<0.5	<0.5	<0.5
11/13/90	3.0	2.0	21	0.7	--	<0.5	6.0	<0.5	<0.5	<0.5	<0.5
05/15/91	2.0	2.0	30	0.9	--	<0.5	6.0	<0.5	<0.5	<0.5	<0.5
08/27/91	1.4	1.1	32	1.0	--	--	4.7	<0.5	<0.5	<0.5	<0.5
11/15/91	1.5	1.9	50	<0.5	--	<0.5	5.8	<0.5	<0.5	2.0	2.0
02/20/92	1.3	2.3	68	2.4	--	<0.5	7.6	<0.5	<0.5	<0.5	<0.5
06/15/92	0.7	1.9	46	1.6	--	<0.5	5.6	<0.5	--	<0.5	<0.5



## Cumulative Table of Well Data and Analytical Results

Vertical Measurements are in feet.

Analytical values are in parts per billion (ppb)

DATE	Carbon Tet	Chloro-form	PCE	TCE	1, 2,-DCE	t-1, 2-DCE	c-1, 2-DCE	1, 1, 1-TCA	1,2-DCA	1, 2-DCP	1, 2-DCP
<b>MW-9</b>											
06/22/90	<0.5	<0.5	<0.5	<0.5	--	<0.5	--	<0.5	<0.5	<0.5	<0.5
08/09/90	<0.5	<0.5	<0.5	<0.5	<0.5	--	--	<0.5	0.71	<0.5	<0.5
11/13/90	<0.5	<0.5	<0.5	<0.5	--	<0.5	<0.5	<0.5	1.0	<0.5	<0.5
05/15/91	<0.5	<0.5	<0.5	<0.5	--	<0.5	<0.5	<0.5	0.5	<0.5	<0.5
08/27/91	<0.5	<0.5	<0.5	<0.5	--	--	<0.5	<0.5	<0.5	<0.5	<0.5
11/15/91	<0.5	<0.5	<0.5	<0.5	--	<0.5	<0.5	<0.5	0.6	<0.5	<0.5
02/20/92	<0.5	<0.5	<0.5	<0.5	--	<0.5	<0.5	<0.5	<0.5	<0.5	<0.5
06/15/92	<0.5	<0.5	<0.5	<0.5	--	<0.5	<0.5	<0.5	<0.5	<0.5	<0.5
<b>MW-10</b>											
06/22/90	9.6	8.9	<0.5	<0.5	--	<0.5	--	<0.5	<0.5	<0.5	<0.5
08/09/90	11	7.8	<0.5	<0.5	<0.5	--	--	<0.5	<0.5	<0.5	<0.5
11/13/90	5.0	4.0	<0.5	<0.5	--	<0.5	<0.5	<0.5	<0.5	<0.5	<0.5
05/15/91	5.0	4.0	<0.5	<0.5	--	<0.5	<0.5	<0.5	<0.5	<0.5	<0.5
08/27/91	6.9	3.4	<0.5	<0.5	--	--	<0.5	<0.5	<0.5	<0.5	<0.5
11/15/91	2.7	3.3	<0.5	<0.5	--	<0.5	<0.5	<0.5	<0.5	<0.5	<0.5
02/20/92	3.3	3.4	3.0	<0.5	--	<0.5	<0.5	<0.5	<0.5	<0.5	<0.5
06/15/92	4.5	2.9	<0.5	<0.5	--	<0.5	<0.5	<0.5	<0.5	<0.5	<0.5
<b>MW-11</b>											
06/22/90	4.6	6.5	73	1.3	--	<0.5	8.9	<0.5	<0.5	<0.5	<0.5
08/09/90	8.1	6.8	84	2.0	4.6	--	--	<0.5	<0.5	<0.5	<0.5
11/13/90	<0.5	<0.5	39	<0.5	--	<0.5	2.0	5	<0.5	<0.5	<0.5
05/15/91	1.0	3.0	7	0.5	--	<0.5	2.0	<0.5	<0.5	<0.5	<0.5
08/27/91	4.1	3.3	73	1.0	--	--	2.4	<0.5	<0.5	<0.5	<0.5
11/15/91	3.3	3.6	64	0.9	--	<0.5	2.3	<0.5	<0.5	<0.5	<0.5
02/20/92	<2.5	<2.5	62	<2.5	--	<2.5	<2.5	<2.5	<2.5	<2.5	<2.5
06/15/92	--	---	---	--	--	--	--	--	--	--	--

## Cumulative Table of Well Data and Analytical Results

Vertical Measurements are in feet.

Analytical values are in parts per billion (ppb)

DATE	Carbon Tet	Chloro-form	PCE	TCE	1, 2,-DCE	t-1, 2-DCE	c-1, 2-DCE	1, 1, 1-TCA	1,2-DCA	1, 2-DCP	1, 2-DCP
<b>MW-12</b>											
06/22/90	6.0	7.3	7.4	<0.5	--	<0.5	13	<0.5	<0.5	<0.5	<0.5
08/09/90	8.0	7.0	6.7	<0.5	5.8	--	--	<0.5	<0.5	<0.5	<0.5
11/13/90	<0.5	<0.5	9.0	<0.5	--	<0.5	3.0	3.0	<0.5	<0.5	<0.5
05/15/91	4.0	4.0	10	<0.5	--	<0.5	3.0	<0.5	<0.5	<0.5	<0.5
08/27/91	3.1	2.6	10	<0.5	--	--	2.3	<0.5	<0.5	<0.5	<0.5
11/15/91	1.9	3.5	8.9	<0.5	--	<0.5	5.9	<0.5	<0.5	<0.5	<0.5
02/20/92	3.3	3.4	3.7	<0.5	--	<0.5	<0.5	<0.5	<0.5	<0.5	<0.5
06/15/92	2.2	3.7	13	<0.5	--	<0.5	4.5	<0.5	<0.5	<0.5	<0.5
<b>MW-13</b>											
11/15/91	<0.5	<0.5	<0.5	--	<0.5	<0.5	<0.5	<0.5	<0.5	<0.5	<0.5
02/20/92	<0.5	<0.5	<0.5	--	<0.5	<0.5	<0.5	<0.5	<0.5	<0.5	<0.5
06/15/92	<0.5	<0.5	<0.5	--	--	<0.5	<0.5	<0.5	<0.5	<0.5	<0.5
<b>MW-14</b>											
11/15/91	<0.5	5.5	33	<0.5	--	<0.5	<0.5	<0.5	<0.5	<0.5	<0.5
02/20/92	<0.5	4.3	38	<0.5	--	<0.5	<0.5	<0.5	<0.5	<0.5	<0.5
06/15/92	--	---	---	--	--	--	--	--	--	--	--

## Cumulative Table of Well Data and Analytical Results

Vertical Measurements are in feet.

Analytical values are in parts per billion (ppb)

DATE	Carbon Tet	Chloro-form	PCE	TCE	1, 2-DCE	t-1, 2-DCE	c-1, 2-DCE	1, 1, 1-TCA	1,2-DCA	1, 2-DCP	1, 2-DCP
<b>TRIP BLANK</b>											
11/03/88	<1.0	<1.0	<1.0	<1.0	--	<1.0	--	<1.0	<1.0	--	--
02/10/89	<0.1	<0.5	<0.1	<0.1	--	<0.1	<0.1	<0.1	<0.1	--	--
04/24/89	<1.0	<1.0	<1.0	<1.0	<1.0	--	--	<1.0	<1.0	--	--
07/28/89	<0.1	<0.5	<0.1	<0.5	<0.1	--	<0.1	<0.1	<0.1	--	--
10/30/89	<0.5	<0.5	<0.5	<0.5	<0.5	--	--	<0.5	<0.5	--	--
01/09/90	<0.5	<0.5	<0.5	<0.5	<0.5	--	--	<0.5	<0.5	--	--
04/18/90	<0.5	<0.5	<0.5	<0.5	<0.5	--	--	<0.5	<0.5	<0.5	<0.5
06/22/90	<0.5	<0.5	<0.5	<0.5	--	<0.5	--	<0.5	<0.5	<0.5	<0.5
08/09/90	<0.5	<0.5	<0.5	<0.5	<0.5	--	--	<0.5	<0.5	<0.5	<0.5
11/13/90	<0.5	0.5	<0.5	<0.5	--	<0.5	<0.5	<0.5	<0.5	<0.5	<0.5
05/15/91	--	--	--	--	--	--	--	--	--	--	--
08/27/91	--	--	--	--	--	--	--	--	--	--	--
11/15/91	<0.5	<0.5	<0.5	<0.5	--	<0.5	<0.5	<0.5	<0.5	<0.5	<0.5
02/20/92	<0.5	<0.5	<0.5	<0.5	--	<0.5	<0.5	<0.5	<0.5	<0.5	<0.5
06/15/92	<0.5	<0.5	<0.5	<0.5	--	<0.5	<0.5	<0.5	<0.5	<0.5	<0.5

## Cumulative Table of Well Data and Analytical Results

**TABLE 2 OF ADDITIONAL ANALYSES**

Vertical Measurements are in feet.

Analytical values are in parts per billion (ppb)

DATE	2-butanone	Acetone	1, 1-DCE	1, 1-DCA	Chloro-benzene	Chloro-benzene
<b>MW-3</b> 08/27/91	--	--	1.3	0.5	0.7	0.7
<b>MW-7</b> 04/24/89	160	5.0	--	--	--	--
<b>MW-13</b> 11/15/91	--	--	--	0.6	--	--

Note: Blaine Tech Services, Inc. began routine monitoring of the groundwater wells at this site on November 1, 1994.

Earlier field data and analytical results are drawn from the September 27, 1994 Groundwater Technology, Inc. report.

**ABBREVIATIONS:**

TPH = Total Petroleum Hydrocarbons

TOG = Total Oil and Grease

Carbon Tet = Carbon Tetrachloride

PCE = Tetrachloroethene

TCE = Trichloroethene

1,2-DCE = 1,2-Dichloroethene

t-1,2-DCE = trans-1,2-Dichloroethene

c-1,2-DCE = cis-1,2-Dichloroethene

1,1,1-TCA = 1,1,1-Trichloroethane

1,2-DCA = 1,2-Dichloroethane

1,2-DCP = 1,2-Dichloropropane

1,1-DCE = 1,1-Dichloroethene

MC = Methylene chloride



Blaine Technical Services  
1680 Rogers Avenue  
San Jose, CA 95112

Attention: Jim Keller

Client Proj. ID: Chevron 9-0020/961216-F1  
Sample Descript: MW-7  
Matrix: LIQUID  
Analysis Method: 8015Mod/8020  
Lab Number: 9612A36-01

Sampled: 12/16/96  
Received: 12/17/96  
Analyzed: 12/19/96  
Reported: 12/30/96

QC Batch Number: GC121896BTEX02A  
Instrument ID: GCHP2

**Total Purgeable Petroleum Hydrocarbons (TPPH) with BTEX and MTBE**

Analyte	Detection Limit ug/L	Sample Results ug/L
TPPH as Gas	1000	2600
Methyl t-Butyl Ether	50	N.D.
Benzene	10	140
Toluene	10	72
Ethyl Benzene	10	51
Xylenes (Total)	10	180
Chromatogram Pattern:		Gas
<b>Surrogates</b>	<b>Control Limits %</b>	<b>% Recovery</b>
Trifluorotoluene	70 130	88

Analytes reported as N.D. were not present above the stated limit of detection.

**SEQUOIA ANALYTICAL - ELAP #1210**

Peggy Permer  
Project Manager





Blaine Technical Services  
1680 Rogers Avenue  
San Jose, CA 95112

Client Proj. ID: Chevron 9-0020/961216-F1  
Sample Descript: MW-9  
Matrix: LIQUID  
Analysis Method: 8015Mod/8020  
Lab Number: 9612A36-02

Sampled: 12/16/96  
Received: 12/17/96  
Analyzed: 12/20/96  
Reported: 12/30/96

Attention: Jim Keller

QC Batch Number: GC121996BTEX02A  
Instrument ID: GCHP2

**Total Purgeable Petroleum Hydrocarbons (TPPH) with BTEX and MTBE**

Analyte	Detection Limit ug/L	Sample Results ug/L
TPPH as Gas	200	1200
Methyl t-Butyl Ether	10	N.D.
Benzene	2.0	3.5
Toluene	2.0	2.4
Ethyl Benzene	2.0	12
Xylenes (Total)	2.0	14
Chromatogram Pattern: Weathered Gas		C6-C12
<b>Surrogates</b>	<b>Control Limits %</b>	<b>% Recovery</b>
Trifluorotoluene	70 130	96

Analytes reported as N.D. were not present above the stated limit of detection.

**SEQUOIA ANALYTICAL - ELAP #1210**

  
Peggy Renner  
Project Manager





Blaine Technical Services  
1680 Rogers Avenue  
San Jose, CA 95112

Attention: Jim Keller

Client Proj. ID: Chevron 9-0020/961216-F1  
Sample Descript: MW-13  
Matrix: LIQUID  
Analysis Method: 8015Mod/8020  
Lab Number: 9612A36-03

Sampled: 12/16/96  
Received: 12/17/96  
Analyzed: 12/19/96  
Reported: 12/30/96

QC Batch Number: GC121896BTEX02A  
Instrument ID: GCHP2

**Total Purgeable Petroleum Hydrocarbons (TPPH) with BTEX and MTBE**

Analyte	Detection Limit ug/L	Sample Results ug/L
TPPH as Gas	50	170
Methyl t-Butyl Ether	2.5	N.D.
Benzene	0.50	N.D.
Toluene	0.50	0.51
Ethyl Benzene	0.50	0.60
Xylenes (Total)	0.50	3.0
Chromatogram Pattern: Unidentified HC		C6-C12
<b>Surrogates</b>	<b>Control Limits %</b>	<b>% Recovery</b>
Trifluorotoluene	70 130	78

Analytes reported as N.D. were not present above the stated limit of detection.

**SEQUOIA ANALYTICAL - ELAP #1210**

  
Peggy Penner  
Project Manager





Blaine Technical Services  
1680 Rogers Avenue  
San Jose, CA 95112

Client Proj. ID: Chevron 9-0020/961216-F1  
Sample Descript: MW-15  
Matrix: LIQUID  
Analysis Method: 8015Mod/8020  
Lab Number: 9612A36-04

Sampled: 12/16/96  
Received: 12/17/96  
Analyzed: 12/19/96  
Reported: 12/30/96

Attention: Jim Keller

QC Batch Number: GC121896BTEX02A  
Instrument ID: GCHP2

**Total Purgeable Petroleum Hydrocarbons (TPPH) with BTEX and MTBE**

Analyte	Detection Limit ug/L	Sample Results ug/L
TPPH as Gas	50	N.D.
Methyl t-Butyl Ether	2.5	N.D.
Benzene	0.50	N.D.
Toluene	0.50	N.D.
Ethyl Benzene	0.50	N.D.
Xylenes (Total)	0.50	N.D.
Chromatogram Pattern:		
<b>Surrogates</b>	<b>Control Limits %</b>	<b>% Recovery</b>
Trifluorotoluene	70 130	80

Analytes reported as N.D. were not present above the stated limit of detection.

**SEQUOIA ANALYTICAL - ELAP #1210**

  
Peggy Penner  
Project Manager







Blaine Technical Services  
1680 Rogers Avenue  
San Jose, CA 95112

Client Proj. ID: Chevron 9-0020/961216-F1  
Sample Descript: MW-16  
Matrix: LIQUID  
Analysis Method: 8015Mod/8020  
Lab Number: 9612A36-05

Sampled: 12/16/96  
Received: 12/17/96  
Analyzed: 12/19/96  
Reported: 12/30/96

QC Batch Number: GC121896BTEX02A  
Instrument ID: GCHP2

**Total Purgeable Petroleum Hydrocarbons (TPPH) with BTEX and MTBE**

Analyte	Detection Limit ug/L	Sample Results ug/L
TPPH as Gas	500	3100
Methyl t-Butyl Ether	25	N.D.
Benzene	5.0	500
Toluene	5.0	25
Ethyl Benzene	5.0	23
Xylenes (Total)	5.0	52
Chromatogram Pattern:		Gas
<b>Surrogates</b>	<b>Control Limits %</b>	<b>% Recovery</b>
Trifluorotoluene	70 130	82

Analytes reported as N.D. were not present above the stated limit of detection.

**SEQUOIA ANALYTICAL - ELAP #1210**

  
Peggy Penner  
Project Manager





Blaine Technical Services  
1680 Rogers Avenue  
San Jose, CA 95112

Client Proj. ID: Chevron 9-0020/961216-F1  
Sample Descript: TB  
Matrix: LIQUID  
Analysis Method: 8015Mod/8020  
Lab Number: 9612A36-06

Sampled: 12/16/96  
Received: 12/17/96  
Analyzed: 12/19/96  
Reported: 12/30/96

QC Batch Number: GC121896BTEX02A  
Instrument ID: GCHP2

**Total Purgeable Petroleum Hydrocarbons (TPPH) with BTEX and MTBE**

Analyte	Detection Limit ug/L	Sample Results ug/L
TPPH as Gas	50	N.D.
Methyl t-Butyl Ether	2.5	N.D.
Benzene	0.50	N.D.
Toluene	0.50	N.D.
Ethyl Benzene	0.50	N.D.
Xylenes (Total)	0.50	N.D.
Chromatogram Pattern:		
<b>Surrogates</b>	<b>Control Limits %</b>	<b>% Recovery</b>
Trifluorotoluene	70 130	85

Analytes reported as N.D. were not present above the stated limit of detection.

**SEQUOIA ANALYTICAL - ELAP #1210**

  
Peggy Fenner  
Project Manager





Sequoia  
Analytical

680 Chesapeake Drive  
404 N. Wiget Lane  
819 Striker Avenue, Suite 8

Redwood City, CA 94063  
Walnut Creek, CA 94598  
Sacramento, CA 95834

(415) 364-9600  
(510) 988-9600  
(916) 921-9600

FAX (415) 364-9233  
FAX (510) 988-9673  
FAX (916) 921-0100

Blaine Technical Services  
1680 Rogers Avenue  
San Jose, CA 95112  
Attention: Jim Keller

Client Proj. ID: Chevron 9-0020/961216-F1

Received: 12/17/96

Lab Proj. ID: 9612A36

Reported: 12/30/96

### LABORATORY NARRATIVE

In order to properly interpret this report, it must be reproduced in its entirety. This report contains a total of 9 pages including the laboratory narrative, sample results, quality control, and related documents as required (cover page, COC, raw data, etc.).

TPPH Note: Sample 9612A36-01 was diluted 20-fold.  
Sample 9612A36-02 was diluted 4-fold.  
Sample 9612A36-05 was diluted 10-fold.

SEQUOIA ANALYTICAL

  
Peggy Penner  
Project Manager





Blaine Tech Services, Inc.  
1680 Rogers Avenue  
San Jose, CA 95112  
Attention: Jim Keller

Client Project ID: Chevron 9-0020/961216-F  
Matrix: Liquid

Work Order #: 9612A36 01,-03-06

Reported: Dec 31, 1996

**QUALITY CONTROL DATA REPORT**

Analyte:	Benzene	Toluene	Ethyl Benzene	Xylenes
QC Batch#:	GC121896BTEX02A	GC121896BTEX02A	GC121896BTEX02A	GC121896BTEX02A
Analy. Method:	EPA 8020	EPA 8020	EPA 8020	EPA 8020
Prep. Method:	EPA 5030	EPA 5030	EPA 5030	EPA 5030

Analyst:	D. Jirsa	D. Jirsa	D. Jirsa	D. Jirsa
MS/MSD #:	961274504	961274504	961274504	961274504
Sample Conc.:	N.D.	N.D.	N.D.	N.D.
Prepared Date:	12/18/96	12/18/96	12/18/96	12/18/96
Analyzed Date:	12/18/96	12/18/96	12/18/96	12/18/96
Instrument I.D.#:	GCHP02	GCHP02	GCHP02	GCHP02
Conc. Spiked:	10 µg/L	10 µg/L	10 µg/L	30 µg/L
Result:	9.3	9.4	9.6	31
MS % Recovery:	93	94	96	103
Dup. Result:	9.0	9.1	9.2	30
MSD % Recov.:	90	91	92	100
RPD:	3.3	3.2	4.3	3.3
RPD Limit:	0-25	0-25	0-25	0-25

LCS #:	BLK121896	BLK121896	BLK121896	BLK121896
Prepared Date:	12/18/96	12/18/96	12/18/96	12/18/96
Analyzed Date:	12/18/96	12/18/96	12/18/96	12/18/96
Instrument I.D.#:	GCHP02	GCHP02	GCHP02	GCHP02
Conc. Spiked:	10 µg/L	10 µg/L	10 µg/L	30 µg/L
LCS Result:	8.6	8.6	8.8	29
LCS % Recov.:	86	86	88	97

MS/MSD	60-140	60-140	60-140	60-140
LCS	70-130	70-130	70-130	70-130
Control Limits				

**SEQUOIA ANALYTICAL**

Peggy Penner  
Project Manager

**Please Note:**

The LCS is a control sample of known, interferent-free matrix that is analyzed using the same reagents, preparation, and analytical methods employed for the samples. The matrix spike is an aliquot of sample fortified with known quantities of specific compounds and subjected to the entire analytical procedure. If the recovery of analytes from the matrix spike does not fall within specified control limits due to matrix interference, the LCS recovery is to be used to validate the batch.

\*\* MS = Matrix Spike, MSD = MS Duplicate, RPD = Relative % Difference

9612A36.BLA <1>





Blaine Tech Services, Inc.  
1680 Rogers Avenue  
San Jose, CA 95112  
Attention: Jim Keller

Client Project ID: Chevron 9-0020/961216-F  
Matrix: Liquid

Work Order #: 9612A36-02

Reported: Dec 31, 1996

**QUALITY CONTROL DATA REPORT**

Analyte:	Benzene	Toluene	Ethyl Benzene	Xylenes
QC Batch#:	GC121996BTEX02A	GC121996BTEX02A	GC121996BTEX02A	GC121996BTEX02A
Analy. Method:	EPA 8020	EPA 8020	EPA 8020	EPA 8020
Prep. Method:	EPA 5030	EPA 5030	EPA 5030	EPA 5030

Analyst:	D. Jirsa	D. Jirsa	D. Jirsa	D. Jirsa
MS/MSD #:	961275003	961275003	961275003	961275003
Sample Conc.:	N.D.	N.D.	N.D.	N.D.
Prepared Date:	12/19/96	12/19/96	12/19/96	12/19/96
Analyzed Date:	12/19/96	12/19/96	12/19/96	12/19/96
Instrument I.D.#:	GCHP02	GCHP02	GCHP02	GCHP02
Conc. Spiked:	10 µg/L	10 µg/L	10 µg/L	30 µg/L
Result:	9.3	9.4	9.7	32
MS % Recovery:	93	94	97	107
Dup. Result:	9.3	9.4	9.6	31
MSD % Recov.:	93	94	96	103
RPD:	0.0	0.0	1.0	3.2
RPD Limit:	0-25	0-25	0-25	0-25

LCS #:	BLK121996	BLK121996	BLK121996	BLK121996
Prepared Date:	12/19/96	12/19/96	12/19/96	12/19/96
Analyzed Date:	12/19/96	12/19/96	12/19/96	12/19/96
Instrument I.D.#:	GCHP02	GCHP02	GCHP02	GCHP02
Conc. Spiked:	10 µg/L	10 µg/L	10 µg/L	30 µg/L
LCS Result:	9.0	9.1	9.3	30
LCS % Recov.:	90	91	93	100

MS/MSD	60-140	60-140	60-140	60-140
LCS	70-130	70-130	70-130	70-130
Control Limits				

**SEQUOIA ANALYTICAL**

Peggy Penner  
Project Manager

**Please Note:**

The LCS is a control sample of known, interferent-free matrix that is analyzed using the same reagents, preparation, and analytical methods employed for the samples. The matrix spike is an aliquot of sample fortified with known quantities of specific compounds and subjected to the entire analytical procedure. If the recovery of analytes from the matrix spike does not fall within specified control limits due to matrix interference, the LCS recovery is to be used to validate the batch.

\*\* MS=Matrix Spike, MSD=MS Duplicate, RPD=Relative % Difference

9612A36.BLA <2>





# **Field Data Sheets**







# CHEVRON WELL MONITORING DATA SHEET

Project #: 961216-F1	Station #: 9-0020
Sampler: TG	Date: 12/16/96
Well I.D.: mw-9	Well Diameter: (2) 3 4 6 8
Total Well Depth: 24.19	Depth to Water: 20.77
Depth to Free Product:	Thickness of Free Product (feet):
Referenced to: (PVC) Grade	D.O. Meter (if req'd): YSI HACH

Well Diameter	Multiplier	Well Diameter	Multiplier
2"	0.16	5"	1.02
3"	0.37	6"	1.47
4"	0.65	Other	radius <sup>2</sup> * 0.163

Purge Method:  Bailer      Sampling Method:  Bailer  
 Disposable Bailer       Disposable Bailer  
 Middleburg       Extraction Port  
 Electric Submersible      Other: \_\_\_\_\_  
 Extraction Pump

0.5	x	3	=	1.5	Gals.
1 Case Volume (Gals.)		Specified Volumes		Calculated Volume	

Time	Temp (°F)	pH	Cond.	Gals. Removed	Observations
906	66.4	6.6	840	0.5	odor
907	66.2	6.5	840	1.0	
908	66.2	6.5	880	1.5	

Did well dewater? Yes   (No)      Gallons actually evacuated: 1.5

Sampling Time: 915      Sampling Date: 12/16/96

Sample I.D.: mw-9      Laboratory: (Sequoia) GTEL N. Creek Assoc. Labs

Analyzed for: (TPH-G BTEX MTBE) TPH-D Other:

Duplicate I.D.:      Analyzed for: TPH-G BTEX MTBE TPH-D Other:

D.O. (if req'd):	Pre-purge:	mg/L	Post-purge:	mg/L
O.R.P. (if req'd):	Pre-purge:	mV	Post-purge:	mV



# CHEVRON WELL MONITORING DATA SHEET

Project #: <u>961216-F1</u>	Station #: <u>9-0020</u>
Sampler: <u>TG</u>	Date: <u>12/16/96</u>
Well I.D.: <u>mw-15</u>	Well Diameter: <u>(2)</u> 3 4 6 8 _____
Total Well Depth: <u>26.48</u>	Depth to Water: <u>20.23</u>
Depth to Free Product:	Thickness of Free Product (feet):
Referenced to: <u>(PVC)</u> Grade	D.O. Meter (if req'd): YSI HACH

Well Diameter	Multiplier	Well Diameter	Multiplier
2"	0.16	5"	1.02
3"	0.37	6"	1.47
4"	0.65	Other	radius <sup>2</sup> * 0.163

Purge Method: <u>Bailer</u>	Sampling Method: <u>Bailer</u>
<u>Disposable Bailer</u>	<u>Disposable Bailer</u>
<u>Middleburg</u>	<u>Extraction Port</u>
<u>Electric Submersible</u>	Other: _____
<u>Extraction Pump</u>	
Other: _____	

<u>1.0</u>	x	<u>3</u>	=	<u>3.0</u>	Gals.
1 Case Volume (Gals.)		Specified Volumes		Calculated Volume	

Time	Temp (°F)	pH	Cond.	Gals. Removed	Observations
<u>721</u>	<u>67.8</u>	<u>6.8</u>	<u>960</u>	<u>1.0</u>	
<u>723</u>	<u>67.6</u>	<u>6.8</u>	<u>620</u>	<u>2.0</u>	
<u>724</u>	<u>67.2</u>	<u>6.9</u>	<u>600</u>	<u>3.0</u>	

Did well dewater? Yes <u>(No)</u>	Gallons actually evacuated: <u>3.0</u>
Sampling Time: <u>730</u>	Sampling Date: <u>12/16/96</u>
Sample I.D.: <u>mw-15</u>	Laboratory: <u>(Sequoia)</u> GTEL N. Creek Assoc. Labs
Analyzed for: <u>(TPH-G BTEX MTBE)</u> TPH-D Other:	
Duplicate I.D.:	Analyzed for: TPH-G BTEX MTBE TPH-D Other:
D.O. (if req'd):	Pre-purge: <u>mg/L</u> Post-purge: <u>mg/L</u>
O.R.P. (if req'd):	Pre-purge: <u>mV</u> Post-purge: <u>mV</u>

# CHEVRON WELL MONITORING DATA SHEET

Project #: <u>961216-A</u>	Station #: <u>9-0020</u>
Sampler: <u>TG</u>	Date: <u>12/16/96</u>
Well I.D.: <u>mw-16</u>	Well Diameter: <u>(2)</u> 3 4 6 8 <u>    </u>
Total Well Depth: <u>26.51</u>	Depth to Water: <u>20.79</u>
Depth to Free Product:	Thickness of Free Product (feet):
Referenced to: <u>(PVC)</u> Grade	D.O. Meter (if req'd): YSI HACH

Well Diameter	Multiplier	Well Diameter	Multiplier
2"	0.16	5"	1.02
3"	0.37	6"	1.47
4"	0.65	Other	radius <sup>2</sup> * 0.163

Purge Method:  Bailer      Sampling Method:  Bailer  
 Disposable Bailer       Disposable Bailer  
 Middleburg       Extraction Port  
 Electric Submersible      Other: \_\_\_\_\_  
 Extraction Pump

<u>0.9</u>	x	<u>3</u>	=	<u>2.7</u>	Gals.
1 Case Volume (Gals.)		Specified Volumes		Calculated Volume	

Time	Temp (°F)	pH	Cond.	Gals. Removed	Observations
839	66.0	7.0	900	1.0	
841	66.0	7.0	840	2.0	
842	66.6	7.0	860	2.75	

Did well dewater? Yes  (No) Gallons actually evacuated: 2.75

Sampling Time: 850 Sampling Date: 12/16/96

Sample I.D.: mw-16 Laboratory: (Sequoia) GTEL N. Creek Assoc. Labs

Analyzed for: (TPH-G BTEX MTBE) TPH-D Other: \_\_\_\_\_

Duplicate I.D.: \_\_\_\_\_ Analyzed for: TPH-G BTEX MTBE TPH-D Other: \_\_\_\_\_

D.O. (if req'd):	Pre-purge:	mg/L	Post-purge:	mg/L
O.R.P. (if req'd):	Pre-purge:	mV	Post-purge:	mV