

STUD 3812



**Chevron**

August 22, 1995

**Chevron U.S.A. Products Company**  
6001 Bollinger Canyon Rd., Bldg. L  
P.O. Box 5004  
San Ramon, CA 94583-0804

**Site Assessment & Remediation Group**  
Phone (510) 842-9500

Ms. Jennifer Eberle  
Alameda County Health Care Services  
Department of Environmental Health  
1131 Harbor Bay Parkway, Suite 250  
Alameda, CA 94502-6577

**Re: Former Chevron Service Station #9-0020  
1633 Harrison Street, Oakland, CA**

Dear Ms. Eberle:

Enclosed is the Second Quarter 1995 Groundwater Monitoring report dated July 24, 1995, prepared by our consultant Blaine Tech Services, Inc. for the above referenced site. As confirmed in your letter of July 21, 1995, only wells MW-7, MW-9, MW-13, MW-15, and MW-16 are monitored and sampled on a quarterly basis.

As indicated in the report, ground water samples collected were analyzed for total petroleum hydrocarbons as gasoline (TPH-G), and BTEX. Dissolved concentrations of the constituents present in ground water are consistent with historic observations at the site. Depth to ground water was measured at approximately 19.3 feet to 19.8 feet below grade and the direction of flow is to the east-northeast.

The origin of dissolved hydrocarbons currently observed in MW-16 is unclear. It is anticipated that continued monitoring and sampling will yield insight into the source of hydrocarbons present in this well.

If you have any questions or comments, please feel free to contact me at (510) 842-8134.

Sincerely,  
CHEVRON U.S.A. PRODUCTS COMPANY

Mark A. Miller  
Site Assessment and Remediation Engineer

Enclosure

cc: Ms. B.C. Owen

The Oakland Housing Authority  
Attn.: Mr. Harold Davis  
1619 Harrison Street  
Oakland, CA 94612

ST AUG 24 PM 1:34

ENVIRONMENTAL

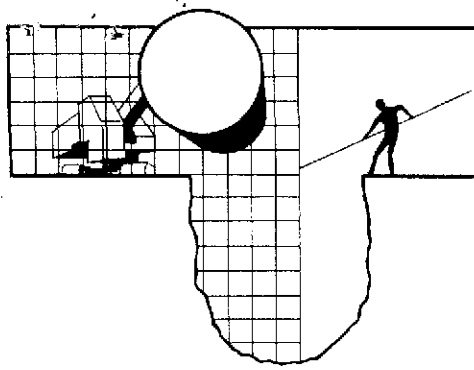

# BLAINE TECH SERVICES INC.

985 TIMOTHY DRIVE  
SAN JOSE, CA 95133  
(408) 995-5535  
FAX (408) 293-8773

July 24, 1995

Mark Miller  
Chevron U.S.A. Products Company  
P.O. Box 5004  
San Ramon, CA 94583-0804

## 2nd Quarter 1995 Monitoring at 9-0020

Second Quarter 1995 Groundwater Monitoring at  
Chevron Service Station Number 9-0020  
1633 Harrison Street  
Oakland, CA

Monitoring Performed on June 27, 1995

---

### Groundwater Sampling Report 950627-H-1

This report covers the routine quarterly monitoring of groundwater wells at this Chevron facility. Blaine Tech Services, Inc.'s work at the site includes inspection, gauging, evacuation, purgewater containment, sample collection and sample handling in accordance with standard procedures that conform to Regional Water Quality Control Board requirements.

Routine field data collection includes depth to water, total well depth, thickness of any separate immiscible layer, water column volume, calculated volume of a three-case volume purge, elapsed evacuation time, total volume of water removed, and standard water parameter instrument readings. Sample material is collected, contained, stored, and transported to the laboratory in conformance with EPA standards. Purgewater is, likewise, collected and transported to Chevron's Richmond Refinery for disposal.

Basic field information is presented alongside analytical values excerpted from the laboratory report in the cumulative table of **WELL DATA AND ANALYTICAL RESULTS**. The full analytical report for the most recent samples is located in the **Analytical Appendix**. The table also contains new groundwater elevation calculations taken from the computer plotted gradient map which is located in the **Professional Engineering Appendix**.

At a minimum, Blaine Tech Services, Inc. field personnel are certified upon completion of a forty-hour Hazardous Materials and Emergency Response training course per 29 CFR 1910.120. Field personnel are also enrolled in annual eight hour refresher courses.

Blaine Tech Services, Inc. conducts sampling and documentation assignments of this type as an independent third party. In order to avoid compromising the objectivity necessary for the proper and disinterested performance of this work, Blaine Tech Services, Inc. concentrates on objective data collection and does not participate in the interpretation of analytical results, the definition of geological or hydrological conditions, the formulation of recommendations, or the marketing of remedial systems.

Please call if you have any questions.

Yours truly,

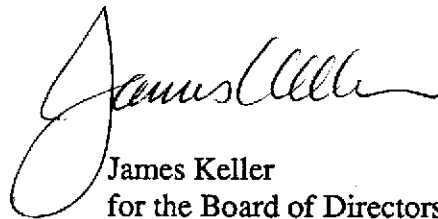

James Keller  
for the Board of Directors

JPK/dk

attachments: Professional Engineering Appendix  
Cumulative Table of Well Data and Analytical Results  
Analytical Appendix  
Field Data Sheets

# **Professional Engineering Appendix**

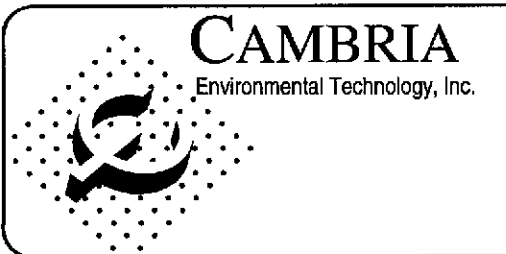
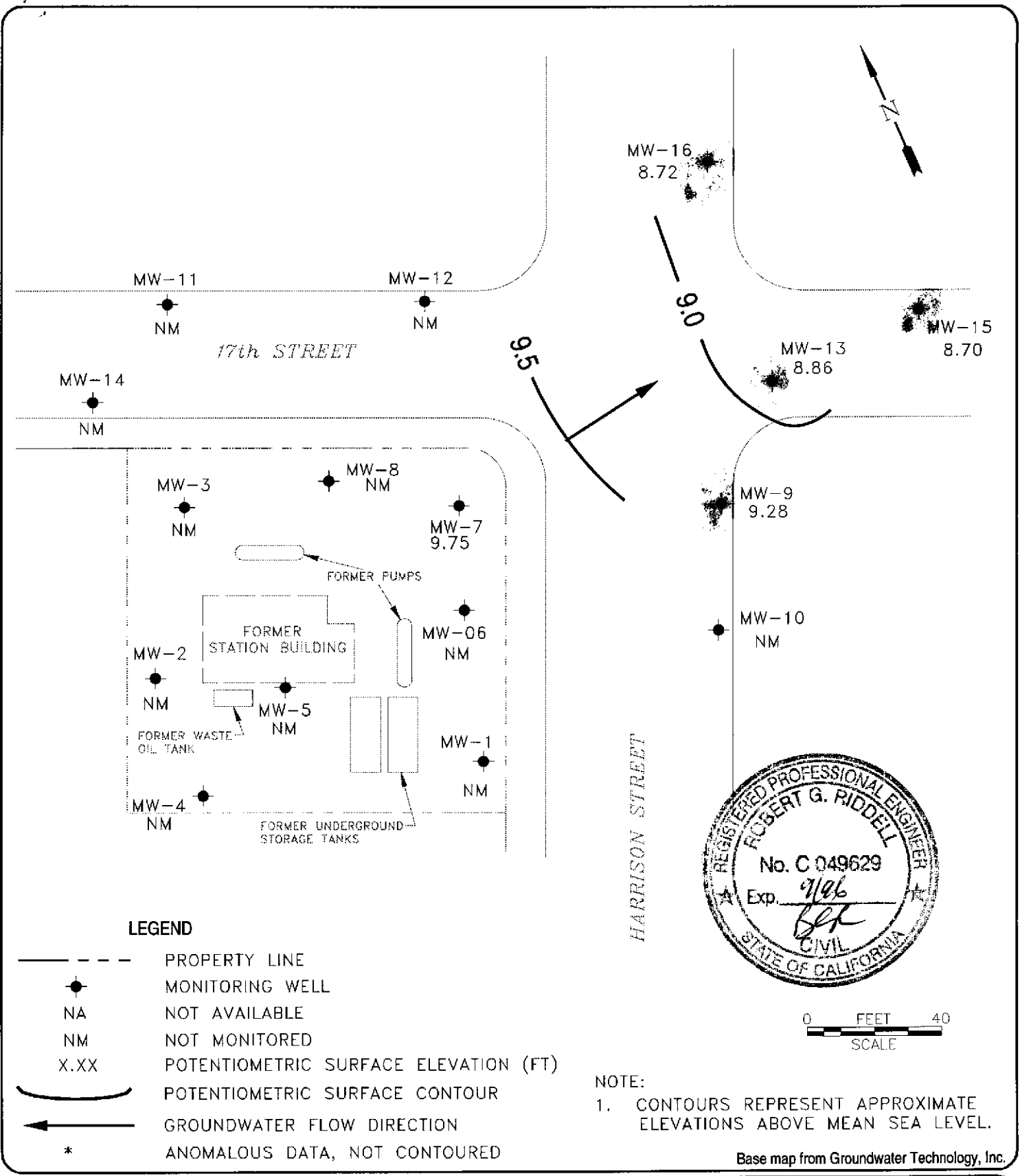

Chevron Station 9-0020  
1633 Harrison Street  
Oakland, California

\\CHEVRON\9-0020\0020-QM.DWG

Ground Water Elevation  
June 27, 1995

FIGURE  
**1**

# **Table of Well Data and Analytical Results**

## Cumulative Table of Well Data and Analytical Results

Vertical Measurements are in feet.

Analytical results are in parts per billion (ppb)

DATE	Well Head Elev.	Ground Water Elev.	Depth To Water	Notes	TPH-Gasoline	Benzene	Toluene	Ethyl-Benzene	Xylene	TOG
<b>MW-1</b>										
11/03/88	29.82	9.42	20.40	--	<1000	<1.0	<1.0	<1.0	<1.0	--
02/02/89	29.82	9.11	20.71	--	--	--	--	--	--	--
02/10/89	29.82	--	--	--	<100	<0.2	<0.2	<0.2	<0.4	--
04/23/89	29.82	9.48	20.34	--	--	--	--	--	--	--
04/24/89	29.82	--	--	--	<50	<0.5	<1.0	<1.0	<1.0	<3000
07/28/89	29.82	9.24	20.58	--	<50	<0.1	<0.5	<0.2	<0.5	<3000
10/30/89	29.82	9.30	20.52	--	<500	<0.3	<0.3	<0.3	<0.6	--
01/09/90	29.82	9.05	20.77	--	<50	<0.3	<0.3	<0.3	<0.6	--
04/18/90	29.82	8.87	20.95	--	<50	<0.3	<0.3	<0.3	<0.6	--
06/22/90	29.82	8.82	21.00	--	--	--	--	--	--	--
08/09/90	29.82	8.88	20.94	--	<50	<0.3	<0.3	<0.3	<0.6	--
11/13/90	29.82	8.84	20.98	--	<50	<0.5	<0.5	<0.5	<0.5	--
05/15/91	29.82	9.18	20.64	--	<50	<0.5	<0.5	<0.5	<0.5	--
08/27/91	29.82	9.03	20.79	--	110	<0.5	<0.5	<0.5	<0.5	--
11/15/91	29.82	9.07	20.75	--	<50	<0.5	<0.5	<0.5	<0.5	--
02/20/92	29.82	8.92	20.90	--	<50	0.5	0.6	<0.5	0.9	--
06/15/92	29.82	9.18	20.64	--	<50	<0.5	<0.5	<0.5	<0.5	--
12/16/92	29.82	8.98	20.84	--	<50	<0.5	<0.5	<0.5	<0.5	--
04/07/93	29.82	9.91	19.91	--	<50	<0.5	<0.5	<0.5	<1.5	--
06/09/93	29.82	9.97	19.85	--	--	--	--	--	--	--
09/10/93	29.82	--	--	--	--	--	--	--	--	--
09/27/93	29.82	9.47	20.35	--	<50	<0.5	<0.5	<0.5	<0.5	--
12/17/93	29.82	9.14	20.68	--	<50	<0.5	<0.5	<0.5	<0.5	--
03/10/94	29.82	9.25	20.57	--	<50	<0.5	<0.5	<0.5	<0.5	--
06/16/94	29.82	9.27	20.55	--	<50	<0.5	<0.5	<0.5	<0.5	--
09/07/94	29.82	9.13	20.69	--	<50	<0.5	<0.5	<0.5	<0.5	--
11/30/94	29.82	9.59	20.23	--	<50	<0.5	<0.5	<0.5	<0.5	--
03/22/95	29.82	10.37	19.45	--	<50	<0.5	<0.5	<0.5	<0.5	--

NO LONGER MONITORED OR SAMPLED

## Cumulative Table of Well Data and Analytical Results

Vertical Measurements are in feet.

Analytical results are in parts per billion (ppb)

DATE	Well Head Elev.	Ground Water Elev.	Depth To Water	Notes	TPH-Gasoline	Benzene	Toluene	Ethyl-Benzene	Xylene	TOG
<b>MW-2</b>										
11/03/88	30.59	9.70	20.89	--	<1000	<1.0	<1.0	<1.0	<1.0	--
02/02/89	30.59	9.38	21.21	--	--	--	--	--	--	--
02/10/89	30.59	--	--	--	<100	<0.2	<0.2	<0.2	<0.4	--
04/23/89	30.59	9.77	20.82	--	--	--	--	--	--	--
04/24/89	30.59	--	--	--	<50	<0.5	<1.0	<1.0	<1.0	<3000
07/28/89	30.59	9.57	21.02	--	<100	<0.2	<1.0	<0.2	<0.5	<3000
10/30/89	30.59	9.63	20.96	--	<500	<0.3	<0.3	<0.3	<0.6	--
01/09/90	30.59	9.34	21.25	--	<50	<0.3	<0.3	<0.3	<0.6	--
04/18/90	30.59	9.06	21.53	--	<50	<0.3	<0.3	<0.3	<0.6	--
06/22/90	30.59	9.02	21.57	--	--	--	--	--	--	--
08/09/90	30.59	9.04	21.55	--	<50	<0.3	<0.3	<0.3	<0.6	--
11/13/90	30.59	9.05	21.54	--	<50	<0.5	0.8	<0.5	0.9	--
05/15/91	30.59	9.44	21.15	--	83	<0.5	<0.5	<0.5	<0.5	--
08/27/91	30.59	9.32	21.27	--	97	<0.5	<0.5	<0.5	<0.5	--
11/15/91	30.59	9.29	21.30	--	<50	0.5	1.5	0.8	3.6	--
02/20/92	30.59	9.13	21.43	--	<50	<0.5	<0.5	<0.5	<0.5	--
06/15/92	30.59	9.41	21.18	--	<50	<0.5	<0.5	<0.5	<0.5	--
12/16/92	30.56	9.09	21.47	--	<50	<0.5	<0.5	<0.5	<0.5	--
04/07/93	30.56	10.03	20.53	--	66	<0.5	<0.5	<0.5	<1.5	--
06/09/93	30.56	10.11	20.45	--	<50	<0.5	<0.5	<0.5	<0.5	--
09/10/93	30.56	--	--	--	--	--	--	--	--	--
09/27/93	30.56	9.59	20.97	--	--	--	--	--	--	--
12/17/93	30.56	9.25	21.31	--	<50	<0.5	<0.5	<0.5	<0.5	--
03/10/94	30.56	9.33	21.23	--	<50	<0.5	<0.5	<0.5	<0.5	--
06/16/94	30.56	9.35	21.21	--	<50	<0.5	<0.5	<0.5	<0.5	--
09/07/94	30.56	9.22	21.34	--	<50	<0.5	<0.5	<0.5	<0.5	--
11/30/94	30.56	9.66	20.90	--	<50	<0.5	<0.5	<0.5	<0.5	--
03/22/95	30.56	10.22	20.34	--	<50	<0.5	<0.5	<0.5	<0.5	--

NO LONGER MONITORED OR SAMPLED



## Cumulative Table of Well Data and Analytical Results

Vertical Measurements are in feet.

Analytical results are in parts per billion (ppb)

DATE	Well Head Elev.	Ground Water Elev.	Depth To Water	Notes	TPH-Gasoline	Benzene	Toluene	Ethyl-Benzene	Xylene	TOG
<b>MW-3</b>										
11/03/88	30.09	9.55	20.54	--	<1000	<1.0	<1.0	<1.0	<1.0	--
02/02/89	30.09	9.24	20.85	--	--	--	--	--	--	--
02/10/89	30.09	--	--	--	<100	<0.2	<0.2	<0.2	<0.4	--
04/23/89	30.09	9.66	20.43	--	--	--	--	--	--	--
04/24/89	30.09	--	--	--	<50	<0.5	<1.0	<1.0	<1.0	<3000
07/28/89	30.09	9.45	20.64	--	<100	<0.2	<1.0	<0.2	<0.4	<3000
10/30/89	30.09	9.48	20.61	--	<500	<0.3	<0.3	<0.3	<0.6	--
01/09/90	30.09	9.21	20.88	--	<50	<0.3	<0.3	<0.3	<0.6	--
04/18/90	30.09	8.94	21.15	--	<50	<0.3	<0.3	<0.3	<0.6	--
06/22/90	30.09	8.89	21.20	--	--	--	--	--	--	--
08/09/90	30.09	8.91	21.18	--	<50	<0.3	<0.3	<0.3	<0.6	--
11/13/90	30.09	8.94	21.15	--	51	<0.5	<0.5	<0.5	<0.5	--
05/15/91	30.09	9.18	20.91	--	85	<0.5	<0.5	<0.5	<0.5	--
08/27/91	30.09	9.20	20.89	*	91	<0.5	<0.5	<0.5	<0.5	--
11/15/91	30.09	9.07	21.02	--	<50	<0.5	0.7	<0.5	1.3	--
02/20/92	30.09	9.02	21.07	--	<50	<0.5	<0.5	<0.5	0.9	--
06/15/92	30.09	9.27	20.82	--	50	<0.5	<0.5	<0.5	<0.5	--
12/16/92	30.08	9.07	21.07	--	<50	<0.5	<0.5	<0.5	<0.5	--
04/07/93	30.08	9.95	20.13	--	<50	<0.5	<0.5	<0.5	<1.5	--
06/09/93	30.08	10.03	20.05	--	<50	<0.5	<0.5	<0.5	<0.5	--
09/10/93	30.08	--	--	--	<50	<0.5	<0.5	<0.5	<0.5	--
09/27/93	30.08	9.50	20.58	--	--	--	--	--	--	--
12/17/93	30.08	9.07	21.01	--	<50	<0.5	<0.5	<0.5	<0.5	--
03/10/94	30.08	9.22	20.86	--	<50	<0.5	<0.5	<0.5	1.1	--
06/16/94	30.08	9.21	20.87	--	<50	<0.5	<0.5	<0.5	<0.5	--
09/07/94	30.08	9.11	20.97	--	<50	<0.5	<0.5	<0.5	<0.5	--
11/30/94	30.08	10.45	19.63	--	<50	<0.5	<0.5	<0.5	<0.5	--
03/22/95	30.08	10.27	19.81	--	<50	<0.5	<0.5	<0.5	<0.5	--

NO LONGER MONITORED OR SAMPLED

\* See Table 2 of Additional Analyses.

## Cumulative Table of Well Data and Analytical Results

Vertical Measurements are in feet.

Analytical results are in parts per billion (ppb)

DATE	Well Head Elev.	Ground Water Elev.	Depth To Water	Notes	TPH-Gasoline	Benzene	Toluene	Ethyl-Benzene	Xylene	TOG
<b>MW-4</b>										
04/23/89	31.17	9.84	21.33	--	--	--	--	--	--	--
04/24/89	31.17	--	--	--	<50	<0.5	<1.0	<1.0	<1.0	<3000
07/28/89	31.17	9.59	21.58	--	<50	<0.1	<0.5	<0.1	<0.2	<3000
10/30/89	31.17	9.63	21.54	--	<500	<0.3	<0.3	<0.3	<0.6	--
01/09/90	31.17	9.35	21.82	--	<50	<0.3	<0.3	<0.3	<0.6	--
04/18/90	31.17	9.08	22.09	--	<50	<0.3	<0.3	<0.3	<0.6	--
06/22/90	31.17	9.05	22.12	--	--	--	--	--	--	--
08/09/90	31.17	9.06	22.11	--	<50	<0.3	<0.3	<0.3	<0.6	--
11/13/90	31.17	9.07	22.10	--	<50	<0.5	1.0	0.5	1.0	--
05/15/91	31.17	9.46	21.71	--	<50	<0.5	<0.5	<0.5	<0.5	--
08/27/91	31.17	9.30	21.87	--	<50	<0.5	<0.5	<0.5	<0.5	--
11/15/91	31.17	9.37	21.80	--	97	<0.5	0.9	<0.5	1.9	--
02/20/92	31.17	9.18	21.99	--	<50	<0.5	<0.5	<0.5	<0.5	--
06/15/92	31.17	9.43	21.74	--	<50	<0.5	<0.5	<0.5	<0.5	--
12/16/92	31.17	9.12	22.05	--	<50	0.7	0.5	0.5	1.3	--
04/07/93	31.17	10.06	21.11	--	<50	<0.5	<0.5	<0.5	<1.5	--
06/09/93	31.17	--	--	--	--	--	--	--	--	--
09/10/93	31.17	--	--	--	--	--	--	--	--	--
09/27/93	31.17	9.63	21.54	--	<50	<0.5	<0.5	<0.5	<0.5	--
12/17/93	31.17	9.28	21.89	--	<50	<0.5	<0.5	<0.5	<0.5	--
03/10/94	31.17	--	--	--	--	--	--	--	--	--
06/16/94	31.17	10.63	20.54	--	--	--	--	--	--	--
09/07/94	31.17	9.27	21.90	--	<50	<0.5	<0.5	<0.5	<0.5	--
11/30/94	31.17	9.83	21.34	--	<50	<0.5	<0.5	<0.5	<0.5	--
03/21/95	31.17	10.55	20.62	--	<50	<0.5	<0.5	<0.5	<0.5	--

NO LONGER MONITORED OR SAMPLED

## Cumulative Table of Well Data and Analytical Results

Vertical Measurements are in feet.

Analytical results are in parts per billion (ppb)

DATE	Well Head Elev.	Ground Water Elev.	Depth To Water	Notes	TPH-Gasoline	Benzene	Toluene	Ethyl-Benzene	Xylene	TOG
<b>MW-5</b>										
04/23/89	30.28	9.66	20.62	--	--	--	--	--	--	--
04/24/89	30.28	--	--	--	<50	<0.5	<1.0	<1.0	<1.0	<3000
07/28/89	30.28	9.42	20.86	--	<100	<0.2	<1.0	<0.2	<0.4	<3000
10/30/89	30.28	9.46	20.82	--	<500	<0.3	<0.3	<0.3	<0.6	--
01/09/90	30.28	9.21	21.07	--	<50	<0.3	<0.3	<0.3	<0.6	--
04/18/90	30.28	8.93	21.35	--	<50	<0.3	<0.3	<0.3	<0.6	--
06/22/90	30.28	8.90	21.38	--	--	--	--	--	--	--
08/09/90	30.28	8.92	21.36	--	<50	<0.3	<0.3	<0.3	<0.6	--
11/13/90	30.28	8.93	21.35	--	<50	<0.5	1.0	<0.5	1.0	--
05/15/91	30.28	8.99	21.29	--	<50	<0.5	<0.5	<0.5	<0.5	--
08/27/91	30.28	9.17	21.11	--	94	3.0	5.0	1.5	5.5	--
11/15/91	30.28	9.10	21.18	--	<50	0.9	1.7	<0.5	2.2	--
02/20/92	30.28	9.03	21.25	--	<50	<0.5	<0.5	<0.5	<0.5	--
06/15/92	30.28	9.28	21.00	--	<50	<0.5	<0.5	<0.5	<0.5	--
12/16/92	30.28	9.05	21.23	--	<50	<0.5	<0.5	<0.5	<0.5	--
04/07/93	30.28	9.97	20.31	--	<50	<0.5	<0.5	<0.5	<1.5	--
06/09/93	30.28	--	--	--	--	--	--	--	--	--
09/10/93	30.28	--	--	--	--	--	--	--	--	--
09/27/93	30.28	9.52	20.76	--	--	--	--	--	--	--

NO LONGER MONITORED OR SAMPLED

## Cumulative Table of Well Data and Analytical Results

Vertical Measurements are in feet.

Analytical results are in parts per billion (ppb)

DATE	Well Head Elev.	Ground Water Elev.	Depth To Water	Notes	TPH-Gasoline	Benzene	Toluene	Ethyl-Benzene	Xylene	TOG
<b>MW-6</b>										
04/23/89	29.46	9.41	20.05	--	--	--	--	--	--	--
04/24/89	29.46	--	--	--	<50	<0.5	<1.0	<1.0	<1.0	<3.0
07/28/89	29.46	9.16	20.30	--	<100	<0.2	<1.0	<0.2	<0.4	<3.0
10/30/89	29.46	9.14	20.32	--	<500	<0.3	<0.3	<0.3	<0.6	--
01/09/90	29.46	8.95	20.51	--	<50	<0.3	<0.3	<0.3	<0.6	--
04/18/90	29.46	8.74	20.72	--	<50	<0.3	<0.3	<0.3	<0.6	--
06/22/90	29.46	8.69	20.77	--	--	--	--	--	--	--
08/09/90	29.46	8.72	20.74	--	<50	<0.3	<0.3	<0.3	<0.6	--
11/13/90	29.46	8.71	20.75	--	<50	3.0	5.0	0.5	2.0	--
05/15/91	29.46	8.85	20.61	--	<50	<0.5	<0.5	<0.5	<0.5	--
08/27/91	29.46	8.93	20.53	--	180	6.1	12	3.8	14	--
11/15/91	29.46	8.93	20.53	--	<50	<0.5	0.6	<0.5	<0.5	--
02/20/92	29.46	8.77	20.69	--	<50	0.9	1.1	<0.5	1.4	--
06/15/92	29.46	9.08	20.38	--	<50	<0.5	<0.5	<0.5	<0.5	--
12/16/92	29.45	8.88	20.57	--	<50	<0.5	<0.5	<0.5	<0.5	--
04/07/93	29.45	9.86	19.59	--	<50	<0.5	<0.5	<0.5	<1.5	--
06/09/93	29.45	9.95	19.50	--	<50	<0.5	<0.5	<0.5	<0.5	--
09/10/93	29.45	--	--	--	--	--	--	--	--	--
09/27/93	29.45	9.38	20.07	--	--	--	--	--	--	--

NO LONGER MONITORED OR SAMPLED

## Cumulative Table of Well Data and Analytical Results

Vertical Measurements are in feet.

Analytical results are in parts per billion (ppb)

DATE	Well Head Elev.	Ground Water Elev.	Depth To Water	Notes	TPH-Gasoline	Benzene	Toluene	Ethyl-Benzene	Xylene	TOG
<b>MW-7</b>										
04/23/89	29.01	10.02	18.99	--	--	--	--	--	--	--
04/24/89	29.01	--	--	*	8400	100	260	160	1300	<3.0
07/28/89	29.01	9.07	19.94	--	7000	230	90	70	440	<3000
07/28/89	29.01	--	--	Duplicate	6000	280	180	58	430	--
10/30/89	29.01	9.04	19.97	--	10,000	570	55	160	400	--
10/30/89	29.01	--	--	Duplicate	9900	520	82	180	410	--
01/09/90	29.01	8.86	20.15	--	3400	290	72	9.0	200	--
04/18/90	29.01	8.64	20.37	--	6800	350	140	110	400	--
06/22/90	29.01	8.61	20.40	--	--	--	--	--	--	--
08/09/90	29.01	8.63	20.38	--	11,000	360	130	14	660	--
11/13/90	29.01	8.60	20.41	--	6500	230	110	97	460	--
05/15/91	29.01	8.54	20.47	--	4600	180	55	46	300	--
08/27/91	29.01	8.87	20.14	--	7000	220	53	63	340	--
11/15/91	29.01	8.79	20.22	--	3300	150	19	4.9	200	--
02/20/92	29.01	8.69	20.32	--	5200	520	150	100	380	--
06/15/92	29.01	9.03	19.98	--	10,000	760	430	320	1100	--
12/16/92	29.01	8.87	20.14	--	11,000	810	350	280	1100	--
04/07/93	29.01	9.87	19.14	--	150	1.4	0.9	0.9	4.5	--
06/09/93	29.01	9.96	19.05	--	180	4.0	1.0	1.0	3.0	--
09/10/93	29.01	--	--	--	--	--	--	--	--	--
09/27/93	29.01	--	--	--	--	--	--	--	--	--
12/17/93	29.01	--	--	--	--	--	--	--	--	--
03/10/94	29.01	--	--	--	--	--	--	--	--	--
06/16/94	29.01	--	--	--	--	--	--	--	--	--
09/07/94	29.01	--	--	--	--	--	--	--	--	--
11/30/94	29.01	--	--	Inaccessible	--	--	--	--	--	--
01/17/95	29.01	17.39	11.62	--	2700	140	65	44	200	--
03/22/95	29.01	11.33	17.68	--	160	3.4	<0.5	1.1	0.77	--
04/27/95	29.01	9.75	19.26	--	<50	<0.5	<0.5	<0.5	<0.5	--

\* See Table 2 of Additional Analyses.

## Cumulative Table of Well Data and Analytical Results

Vertical Measurements are in feet.

Analytical results are in parts per billion (ppb)

DATE	Well Head Elev.	Ground Water Elev.	Depth To Water	Notes	TPH-Gasoline	Benzene	Toluene	Ethyl-Benzene	Xylene	TOG
<b>MW-8</b>										
04/23/89	29.57	9.43	20.14	--	--	--	--	--	--	--
04/24/89	29.57	--	--	--	<50	<0.5	<1.0	<1.0	<1.0	3000
04/24/89	29.57	--	--	Duplicate	<50	<0.5	<1.0	<1.0	<1.0	--
07/28/89	29.57	9.20	20.37	--	<100	<0.2	<1.0	<0.2	<0.4	<3000
10/30/89	29.57	9.25	20.32	--	<500	<0.3	<0.3	<0.3	<0.6	--
01/09/90	29.57	8.97	20.60	--	<50	<0.3	<0.3	<0.3	<0.6	--
04/18/90	29.57	8.70	20.87	--	<50	<0.3	<0.3	<0.3	<0.6	--
06/22/90	29.57	9.23	20.34	--	--	--	--	--	--	--
08/09/90	29.57	8.68	20.89	--	<50	<0.3	<0.3	<0.3	<0.6	--
11/13/90	29.57	8.71	20.86	--	<50	<0.5	0.8	<0.5	2.0	--
05/15/91	29.57	9.08	20.49	--	<50	<0.5	<0.5	<0.5	<0.5	--
08/27/91	29.57	8.97	20.60	--	73	<0.5	<0.5	<0.5	<0.5	--
11/15/91	29.57	8.95	20.62	--	<50	<0.5	0.7	<0.5	2.1	--
02/20/92	29.57	8.77	20.80	--	<50	<0.5	<0.5	<0.5	<0.5	--
06/15/92	29.57	9.09	20.48	--	<50	<0.5	<0.5	<0.5	<0.5	--
12/16/92	29.57	8.89	20.68	--	<50	<0.5	<0.5	<0.5	<0.5	--
04/07/93	29.57	9.87	19.70	--	<50	<0.5	<0.5	<0.5	<1.5	--
06/09/93	29.57	9.97	19.60	--	<50	<0.5	<0.5	<0.5	<0.5	--
09/10/93	29.57	--	--	--	--	--	--	--	--	--
09/27/93	29.57	9.35	20.22	--	--	--	--	--	--	--

NO LONGER MONITORED OR SAMPLED

## Cumulative Table of Well Data and Analytical Results

Vertical Measurements are in feet.

Analytical results are in parts per billion (ppb)

DATE	Well Head Elev.	Ground Water Elev.	Depth To Water	Notes	TPH-Gasoline	Benzene	Toluene	Ethyl-Benzene	Xylene	TOG
<b>MW-9</b>										
06/22/90	28.67	7.87	20.80	--	5700	47	31	280	530	<1000
08/09/90	28.67	7.93	20.74	--	8000	<0.3	17	210	480	--
11/13/90	28.67	7.89	20.78	--	6400	<3.0	20	240	450	--
05/15/91	28.67	8.19	20.48	--	5700	2.0	16	190	390	--
08/27/91	28.67	8.12	20.55	--	6700	<3.0	31	180	350	--
11/15/91	28.67	8.10	20.57	--	4000	8.8	26	150	280	--
02/20/92	28.67	6.90	21.77	--	3400	13	30	230	460	--
06/15/92	28.67	8.30	20.37	--	4500	19	72	280	560	--
12/16/92	28.68	8.39	20.29	--	9900	380	220	380	1300	--
04/07/93	28.68	9.36	19.32	--	8700	51	150	360	1000	--
06/09/93	28.68	9.52	19.16	--	8900	170	160	350	1100	--
09/10/93	28.68	--	--	--	4600	110	63	190	350	--
09/27/93	28.68	8.74	19.94	--	--	--	--	--	--	--
12/17/93	28.68	8.37	20.31	--	4600	92	85	180	300	--
03/10/94	28.68	8.38	20.30	--	3300	8.0	29	120	170	--
06/16/94	28.68	8.42	20.26	--	2900	4.8	16	85	64	--
09/07/94	28.68	8.27	20.41	--	2900	<0.5	9.9	70	75	--
11/30/94	28.68	8.70	19.98	--	2100	<5.0	<5.0	53	51	--
03/22/95	28.68	9.27	19.41	--	2200	<5.0	5.3	26	69	--
06/27/95	28.68	9.28	19.40	--	2900	74	10	68	99	--

ABOVE  
MCL'S

## Cumulative Table of Well Data and Analytical Results

Vertical Measurements are in feet.

Analytical results are in parts per billion (ppb)

DATE	Well Head Elev.	Ground Water Elev.	Depth To Water	Notes	TPH-Gasoline	Benzene	Toluene	Ethyl-Benzene	Xylene	TOG
<b>MW-10</b>										
06/22/90	28.60	8.12	20.48	--	<50	<0.5	<0.5	<0.5	<0.5	<1000
08/09/90	28.60	8.15	20.45	--	<50	<0.3	<0.3	<0.3	<0.6	--
11/13/90	28.60	8.13	20.47	--	<50	<0.5	2.0	0.5	2.0	--
05/15/91	28.60	8.45	20.15	--	<50	<0.5	<0.5	<0.5	<0.5	--
08/27/91	28.60	8.33	20.27	--	<50	<0.5	<0.5	<0.5	<0.5	--
11/15/91	28.60	8.27	20.33	--	<50	<0.5	<0.5	<0.5	<0.5	--
02/20/92	28.60	7.15	21.45	--	<50	2.0	2.2	<0.5	2.1	--
06/15/92	28.60	7.30	21.30	--	<50	<0.5	<0.5	<0.5	<0.5	--
12/16/92	28.62	8.45	20.17	--	<50	<0.5	<0.5	<0.5	<0.5	--
04/07/93	28.62	9.41	19.26	--	<50	<0.5	<0.5	<0.5	<1.5	--
06/09/93	28.62	9.55	19.07	--	<50	<0.5	<0.5	<0.5	<0.5	--
09/10/93	28.62	--	--	--	<50	<0.5	<0.5	<0.5	<0.5	--
09/24/93	28.62	8.90	19.72	--	--	--	--	--	--	--
12/17/93	28.62	8.55	20.07	--	<50	<0.5	<0.5	<0.5	<0.5	--
03/10/94	28.62	8.65	19.97	--	<50	<0.5	<0.5	<0.5	<0.5	--
06/16/94	28.62	8.64	19.98	--	<50	<0.5	<0.5	<0.5	<0.5	--
09/07/94	28.62	8.50	20.12	--	<50	<0.5	<0.5	<0.5	<0.5	--
11/30/94	28.62	8.92	19.70	--	<50	<0.5	<0.5	<0.5	<0.5	--
03/22/95	28.62	9.70	18.92	--	<50	<0.5	<0.5	<0.5	<0.5	--

NO LONGER MONITORED OR SAMPLED



## Cumulative Table of Well Data and Analytical Results

Vertical Measurements are in feet.

Analytical results are in parts per billion (ppb)

DATE	Well Head Elev.	Ground Water Elev.	Depth To Water	Notes	TPH-Gasoline	Benzene	Toluene	Ethyl-Benzene	Xylene	TOG
<b>MW-11</b>										
06/22/90	29.37	8.34	21.03	--	<50	<0.5	<0.5	<0.5	<0.5	<1000
08/09/90	29.37	8.35	21.02	--	<50	<0.3	<0.3	<0.3	<0.6	--
11/13/90	29.37	8.44	20.93	--	76	0.6	1.0	0.9	4.0	--
05/15/91	29.37	8.76	20.61	--	78	<0.5	<0.5	<0.5	<0.5	--
08/27/91	29.37	8.67	20.70	--	110	<0.5	<0.5	<0.5	<0.5	--
11/15/91	29.37	8.69	20.68	--	<50	<0.5	<0.5	<0.5	<0.5	--
02/20/92	29.37	7.46	21.91	--	<50	1.9	2.1	1.0	4.4	--
06/15/92	29.37	8.81	20.56	--	--	--	--	--	--	--
12/16/92	29.39	8.64	20.75	--	<50	<0.5	<0.5	<0.5	<0.5	--
04/07/93	29.39	9.56	19.83	--	<50	<0.5	<0.5	<0.5	<1.5	--
06/09/93	29.39	9.72	19.67	--	<50	<0.5	<0.5	<0.5	<0.5	--
09/10/93	29.39	--	--	--	--	--	--	--	--	--
09/27/93	29.39	9.06	20.33	--	<50	<0.5	<0.5	<0.5	<0.5	--
12/17/93	29.39	8.66	20.73	--	<50	<0.5	<0.5	<0.5	<0.5	--
03/10/94	29.39	8.70	20.69	--	--	--	--	--	--	--
06/16/94	29.39	8.83	20.56	--	<50	<0.5	<0.5	<0.5	<0.5	--

NO LONGER MONITORED OR SAMPLED

### MW-12

06/22/90	28.43	7.98	20.45	--	<50	<0.5	<0.5	<0.5	<0.5	<1000
08/09/90	28.43	8.00	20.43	--	<50	<0.3	<0.3	<0.3	<0.6	--
11/13/90	28.43	7.98	20.45	--	<50	<0.5	<0.5	<0.5	<0.5	--
05/15/91	28.43	8.36	20.07	--	<50	<0.5	<0.5	<0.5	<0.5	--
08/27/91	28.43	8.28	20.15	--	56	<0.5	<0.5	<0.5	<0.5	--
11/15/91	28.43	8.18	20.25	--	<50	<0.5	<0.5	<0.5	<0.5	--
02/20/92	28.43	7.06	21.37	--	<50	2.5	3.1	0.7	3.0	--
06/15/92	28.43	8.53	19.90	--	<50	<0.5	<0.5	<0.5	<0.5	--
12/16/92	28.43	8.63	19.80	--	<50	<0.5	<0.5	<0.5	<0.5	--
04/07/93	28.43	9.68	18.75	--	<50	<0.5	<0.5	<0.5	<1.5	--
06/09/93	28.43	--	--	--	--	--	--	--	--	--
09/10/93	28.43	--	--	--	--	--	--	--	--	--
09/27/93	28.43	8.80	19.63	--	--	--	--	--	--	--

NO LONGER MONITORED OR SAMPLED

## Cumulative Table of Well Data and Analytical Results

Vertical Measurements are in feet.

Analytical results are in parts per billion (ppb)

DATE	Well Head Elev.	Ground Water Elev.	Depth To Water	Notes	TPH-Gasoline	Benzene	Toluene	Ethyl-Benzene	Xylene	TOG
<b>MW-13</b>										
11/15/91	28.63	7.56	21.07	*	3100	68	40	110	270	--
02/20/92	28.63	6.46	22.17	--	3100	120	50	240	400	--
06/15/92	28.63	7.96	20.67	--	3200	35	33	210	300	--
12/16/92	28.62	8.28	20.34	--	87,000	1400	540	2400	11,000	--
04/07/93	28.62	9.21	19.41	--	1500	72	12	70	160	--
06/09/93	28.62	9.42	19.20	--	210	6.0	2.0	7.0	16	--
09/10/93	28.62	--	--	--	73	3.0	<0.5	2.0	3.0	--
09/27/93	28.62	8.27	20.35	--	--	--	--	--	--	--
12/17/93	28.62	7.86	20.76	--	640	43	12	12	37	--
03/10/94	28.62	7.93	20.69	--	540	44	22	10	69	--
06/16/94	28.62	7.95	20.67	--	1800	63	12	18	64	--
09/07/94	28.62	7.79	20.83	--	1400	59	12	22	50	--
11/30/94	28.62	8.21	20.41	--	700	36	4.4	18	31	--
03/22/95	28.62	8.80	19.82	--	190	1.4	1.4	<0.5	<0.5	--
06/27/95	28.62	8.86	19.76	--	220	1.8	<0.5	<0.5	0.84	--
<b>MW-14</b>										
11/15/91	29.46	9.13	20.33	--	<50	<0.5	<0.5	<0.5	<0.5	--
02/20/92	29.46	8.05	21.41	--	<50	1.3	1.8	1.1	5.2	--
06/15/92	29.46	--	--	--	--	--	--	--	--	--
12/16/92	29.45	8.79	20.66	--	<50	<0.5	<0.5	<0.5	<0.5	--
04/07/93	29.45	--	--	--	--	--	--	--	--	--
06/09/93	29.45	--	--	--	--	--	--	--	--	--
09/10/93	29.45	--	--	--	--	--	--	--	--	--
09/27/93	29.45	9.19	20.26	--	--	--	--	--	--	--

NO LONGER MONITORED OR SAMPLED

\* See Table 2 of Additional Analyses.

## Cumulative Table of Well Data and Analytical Results

Vertical Measurements are in feet.

Analytical results are in parts per billion (ppb)

DATE	Well Head Elev.	Ground Water Elev.	Depth To Water	Notes	TPH-Gasoline	Benzene	Toluene	Ethyl-Benzene	Xylene	TOG
<b>MW-15</b>										
12/16/92	28.04	8.30	19.74	--	<50	<0.5	<0.5	<0.5	<0.5	--
04/07/93	28.04	9.24	18.80	--	<50	1.3	<0.5	<0.5	<1.5	--
06/09/93	28.04	9.44	18.60	--	<50	<0.5	<0.5	<0.5	<0.5	--
09/10/93	28.04	--	--	--	--	--	--	--	--	--
09/27/93	28.04	8.11	19.93	--	<50	2.0	<0.5	<0.5	<0.5	--
12/17/93	28.04	7.72	20.32	--	<50	<0.5	<0.5	<0.5	<0.5	--
03/10/94	28.04	7.75	20.29	--	<50	<0.5	<0.5	<0.5	<0.5	--
06/16/94	28.04	7.73	20.31	--	<50	<0.5	<0.5	<0.5	<0.5	--
09/07/94	28.04	7.61	20.43	--	<50	<0.5	<0.5	<0.5	<0.5	--
11/30/94	28.04	8.03	20.01	--	<50	<0.5	<0.5	<0.5	<0.5	--
03/22/95	28.04	8.57	19.47	--	69	4.9	<0.5	<0.5	<0.5	--
<del>06/27/95</del>	28.04	8.70	19.34	--	<50	<del>3.8</del>	<0.5	1.4	<0.5	--
<b>MW-16</b>										
12/16/92	28.32	8.74	19.58	--	--	--	--	--	--	--
12/21/92	28.32	--	--	--	<50	<0.5	<0.5	<0.5	<0.5	--
04/07/93	28.32	9.91	18.41	--	<50	<0.5	6.8	<0.5	<0.5	--
06/09/93	28.32	10.07	18.25	--	<50	<0.5	<0.5	<0.5	<0.5	--
09/10/93	28.32	--	--	--	<50	<0.5	<0.5	<0.5	<0.5	--
09/27/93	28.32	8.16	20.16	--	--	--	--	--	--	--
12/17/93	28.32	--	--	--	--	--	--	--	--	--
03/10/94	28.32	7.77	20.55	--	<50	<0.5	<0.5	<0.5	<0.5	--
06/16/94	28.32	7.67	20.65	--	<50	0.9	0.7	<0.5	<0.5	--
09/07/94	28.32	7.59	20.73	--	150	1.3	0.8	1.2	3.6	--
11/30/94	28.32	8.04	20.28	--	4200	300	<5.0	34	350	--
03/22/95	28.32	8.65	19.67	--	2900	180	5.7	21	91	--
<del>06/27/95</del>	28.32	8.72	19.60	--	<del>2000</del>	<del>300</del>	10	27	48	--

## Cumulative Table of Well Data and Analytical Results

Vertical Measurements are in feet.

Analytical results are in parts per billion (ppb)

DATE	Well Head Elev.	Ground Water Elev.	Depth To Water	Notes	TPH-Gasoline	Benzene	Toluene	Ethyl-Benzene	Xylene	TOG
<b>TRIP BLANK</b>										
11/03/88	--	--	--	--	--	<1.0	<1.0	<1.0	<1.0	--
02/10/89	--	--	--	--	<50	<0.1	<0.1	<0.1	<0.2	--
04/24/89	--	--	--	--	<50	<0.5	<0.5	<1.0	<1.0	--
07/28/89	--	--	--	--	<50	<0.1	<0.1	<0.1	<0.2	--
10/30/89	--	--	--	--	<500	<0.3	<0.3	<0.3	<0.6	--
01/09/90	--	--	--	--	<50	<0.3	<0.3	<0.3	<0.6	--
04/18/90	--	--	--	--	<50	<0.3	<0.3	<0.3	<0.6	--
06/22/90	--	--	--	--	<50	<0.5	<0.5	<0.5	<0.5	--
08/09/90	--	--	--	--	<50	<0.3	<0.3	<0.3	<0.6	--
11/13/90	--	--	--	--	<50	<0.5	<0.5	<0.5	<0.5	--
05/15/91	--	--	--	--	<50	<0.5	<0.5	<0.5	<0.5	--
08/27/91	--	--	--	--	<50	<0.5	<0.5	<0.5	<0.5	--
11/15/91	--	--	--	--	<50	<0.5	<0.5	<0.5	<0.5	--
02/20/92	--	--	--	--	<50	<0.5	<0.5	<0.5	<0.5	--
06/15/92	--	--	--	--	<50	<0.5	<0.5	<0.5	<0.5	--
12/16/92	--	--	--	--	<50	<0.5	<0.5	<0.5	<0.5	--
04/07/93	--	--	--	--	<50	<0.5	<0.5	<0.5	<1.5	--
06/09/93	--	--	--	--	<50	<0.5	<0.5	<0.5	<0.5	--
09/10/93	--	--	--	--	<50	<0.5	<0.5	<0.5	<0.5	--
09/27/93	--	--	--	--	<50	<0.5	<0.5	<0.5	<0.5	--
12/17/93	--	--	--	--	<50	<0.5	<0.5	<0.5	<0.5	--
03/10/94	--	--	--	--	<50	<0.5	0.6	<0.5	0.6	--
06/16/94	--	--	--	--	<50	<0.5	<0.5	<0.5	<0.5	--
09/07/94	--	--	--	--	<50	<0.5	<0.5	<0.5	<0.5	--
11/30/94	--	--	--	--	<50	<0.5	<0.5	<0.5	<0.5	--
01/17/95	--	--	--	--	<50	<0.5	<0.5	<0.5	<0.5	--
03/22/95	--	--	--	--	<50	<0.5	<0.5	<0.5	<0.5	--
06/27/95	--	--	--	--	<50	<0.5	<0.5	<0.5	<0.5	--

## Cumulative Table of Well Data and Analytical Results

### TABLE OF ADDITIONAL ANALYSES

Vertical Measurements are in feet.

Analytical values are in parts per billion (ppb)

DATE	Carbon Tet	Chloro-form	PCE	TCE	1, 2,-DCE	t-1, 2-DCE	c-1, 2-DCE	1, 1, 1-TCA	1,2-DCA	1, 2-DCP	MC
<b>MW-1</b>											
11/03/88	18	7.0	<1.0	<1.0	--	<1.0	--	<1.0	<1.0	--	--
02/10/89	17	6.0	<0.2	<0.2	--	<0.2	<0.2	<0.2	<0.2	--	--
04/24/89	16	6.0	<1.0	<1.0	<1.0	--	--	<1.0	<1.0	--	--
07/28/89	20	6.4	<0.1	<0.1	--	<0.1	<0.1	0.3	<0.1	--	--
10/30/89	11	4.9	<0.5	<0.5	<0.5	--	--	<0.5	<0.5	--	--
01/09/90	24	7.2	<0.5	<0.5	<0.5	--	--	<0.5	<0.5	--	--
04/18/90	23	5.5	<0.5	<0.5	<0.5	--	--	1.4	<0.5	<0.5	<0.5
08/09/90	32	11	0.7	<0.5	<0.5	--	--	<0.5	<0.5	<0.5	<0.5
11/13/90	24	7.0	60.7	<0.5	--	<0.5	<0.5	<0.5	<0.5	<0.5	<0.5
05/15/91	15	5.0	<0.5	<0.5	--	<0.5	<0.5	<0.5	<0.5	<0.5	<0.5
08/27/91	18	4.2	<0.5	<0.5	--	--	<0.5	<0.5	<0.5	<0.5	<0.5
11/15/91	21	7.9	<0.5	<0.5	--	<0.5	<0.5	<0.5	<0.5	<0.5	<0.5
02/20/92	24	7.5	<0.5	<0.5	--	<0.5	<0.5	<0.5	<0.5	<0.5	<0.5
06/15/92	10	3.2	<0.5	<0.5	--	<0.5	<0.5	<0.5	<0.5	<0.5	<0.5
<b>MW-2</b>											
11/03/88	3.0	2.0	34	3.0	--	10	--	<1.0	<1.0	--	--
02/10/89	1.4	1.0	17.2	<0.2	--	<0.2	6.3	<0.2	<0.2	--	--
04/24/89	2.0	2.0	38	3.0	9.0	--	--	<1.0	<1.0	--	--
07/28/89	3.7	2.0	46	2.6	--	<0.2	<0.2	<0.2	<0.2	--	--
10/30/89	1.4	2.6	53	1.1	14	--	--	<0.5	<0.5	--	--
01/09/90	3.6	3.9	78	5.3	16	--	--	<0.5	<0.5	--	--
04/18/90	1.5	2.7	130	3.9	19	--	--	<0.5	<0.5	<0.5	<0.5
08/09/90	2.1	2.1	74	6.1	15	--	--	<0.5	<0.5	<0.5	<0.5
11/13/90	<0.5	2.0	40	4.0	--	<0.5	10	<0.5	<0.5	<0.5	<0.5
05/15/91	2.0	2.0	56	6.0	--	<0.5	15	<0.5	<0.5	<0.5	<0.5
08/27/91	1.1	0.9	46	3.9	--	--	8.0	<0.5	<0.5	<0.5	<0.5
11/15/91	0.6	1.1	58	3.1	--	<0.5	6.3	<0.5	<0.5	<0.5	<0.5
02/20/92	11	<2.5	62	3.1	--	<2.5	4.3	<2.5	<2.5	<2.5	<2.5
06/15/92	<0.5	1.2	45	3.1	--	<0.5	4.8	<0.5	<0.5	<0.5	<0.5

## Cumulative Table of Well Data and Analytical Results

Vertical Measurements are in feet.

Analytical values are in parts per billion (ppb)

DATE	Carbon Tet	Chloro-form	PCE	TCE	1, 2,-DCE	t-1, 2-DCE	c-1, 2-DCE	1, 1, 1-TCA	1,2-DCA	1, 2-DCP	MC
<b>MW-3</b>											
11/03/88	8.0	6.0	84	3.0	--	5.0	--	<1.0	<1.0	--	--
02/10/89	5.8	4.0	53	1.9	--	<0.2	9.0	<0.2	<0.2	--	--
04/24/89	7.0	6.0	110	3.0	11	--	--	<1.0	<1.0	--	--
07/28/89	8.6	5.0	49	2.1	--	<0.2	11	<0.2	<0.1	--	--
10/30/89	5.6	5.3	62	0.7	8.2	--	--	<0.5	<0.5	--	--
01/09/90	8.6	6.1	81	73.8	8.7	--	--	<0.5	<0.5	--	--
04/18/90	7.6	5.8	120	2.4	11	--	--	<0.5	<0.5	<0.5	<0.5
08/09/90	11	6.7	81	5.1	11	--	--	<0.5	<0.5	<0.5	<0.5
11/13/90	7.0	5.0	43	4.0	--	<0.5	9.0	<0.5	<0.5	<0.5	<0.5
05/15/91	6.0	4.0	46	3.0	--	<0.5	8.0	<0.5	<0.5	<0.5	<0.5
08/27/91	5.5	3.8	43	2.6	--	--	8.1	<0.5	<0.5	<0.5	<0.5
11/15/91	6.3	5.0	67	3.4	--	0.8	7.4	0.9	<0.5	<0.5	<0.5
02/20/92	2.8	4.0	96	3.0	--	<2.5	6.1	<2.5	<2.5	<2.5	<0.5
06/15/92	5.0	3.9	86	2.9	--	<0.5	7.5	<0.5	<0.5	<0.5	<0.5
<b>MW-4</b>											
04/24/89	35	11	<1.0	<1.0	<1.0	--	--	<1.0	<1.0	--	--
07/28/89	32	9.3	<0.1	<0.1	--	<0.1	<0.1	<0.1	<0.1	--	--
10/30/89	32	8.5	<0.5	<0.5	<0.5	--	--	<0.5	<0.5	--	--
01/09/90	36	9.8	<0.5	<0.5	<0.5	--	--	<0.5	<0.5	--	--
04/18/90	41	9.5	<0.5	<0.5	<0.5	--	--	<0.5	<0.5	<0.5	<0.5
08/09/90	38	11	<0.5	<0.5	<0.5	--	--	<0.5	<0.5	<0.5	<0.5
11/13/90	40	11	<0.5	<0.5	--	<0.5	<0.5	<0.5	<0.5	<0.5	<0.5
05/15/91	35	10	<0.5	<0.5	--	<0.5	<0.5	<0.5	<0.5	<0.5	<0.5
08/27/91	28	6.1	<0.5	<0.5	--	--	<0.5	<0.5	<0.5	<0.5	<0.5
11/15/91	23	9.1	<0.5	<0.5	--	<0.5	<0.5	<0.5	<0.5	<0.5	<0.5
02/20/92	400	140	<0.5	<0.5	--	<0.5	<0.5	<0.5	<0.5	<0.5	<0.5
06/15/92	38	11	<0.5	<0.5	--	<0.5	<0.5	<0.5	<0.5	<0.5	<0.5

## Cumulative Table of Well Data and Analytical Results

Vertical Measurements are in feet.

Analytical values are in parts per billion (ppb)

DATE	Carbon Tet	Chloro-form	PCE	TCE	1, 2,-DCE	t-1, 2-DCE	c-1, 2-DCE	1, 1, 1-TCA	1,2-DCA	1, 2-DCP	MC
<b>MW-5</b>											
04/24/89	4.0	5.0	4.0	<1.0	2.0	--	--	<1.0	<1.0	--	--
07/28/89	5.6	4.0	5.3	0.3	--	<0.2	2.3	0.5	<0.2	--	--
10/30/89	2.9	2.0	2.7	<0.5	0.86	--	--	<0.5	<0.5	--	--
01/09/90	8.2	4.6	7.8	0.6	3.1	--	--	<0.5	<0.5	--	--
04/18/90	6.3	2.8	2.6	<0.5	1.7	--	--	<0.5	<0.5	<0.5	<0.5
08/09/90	11	4.8	6.0	<0.5	2.3	--	--	<0.5	<0.5	<0.5	<0.5
11/13/90	7.0	3.0	5.0	<0.5	--	<0.5	1	<0.5	<0.5	<0.5	<0.5
05/15/91	4.0	2.0	3.0	<0.5	--	<0.5	0.8	<0.5	<0.5	<0.5	<0.5
08/27/91	3.3	1.1	2.3	<0.5	--	--	<0.5	<0.5	<0.5	<0.5	<0.5
11/15/91	5.7	2.8	5.5	<0.5	--	<0.5	1.7	<0.5	<0.5	<0.5	<0.5
02/20/92	4.0	2.0	3.9	<0.5	--	<0.5	0.7	<0.5	<0.5	<0.5	<0.5
06/15/92	4.0	2.0	5.0	<0.5	--	<0.5	1.4	<0.5	<0.5	<0.5	<0.5
<b>MW-6</b>											
04/24/89	13	7.0	<1.0	<1.0	<1.0	--	--	<1.0	<1.0	--	--
07/28/89	9.6	4.0	<0.2	<0.2	--	<0.2	<0.2	0.5	0.6	--	--
10/30/89	8.2	3.6	<0.5	<0.5	<0.5	--	--	<0.5	<0.5	--	--
01/09/90	10	4.2	<0.5	<0.5	<0.5	--	--	<0.5	1.8	--	--
04/18/90	11	3.8	<0.5	<0.5	<0.5	--	--	<0.5	<0.5	<0.5	<0.5
08/09/90	20	6.6	<0.5	<0.5	<0.5	--	--	<0.5	<0.5	<0.5	<0.5
11/13/90	15	5.0	<0.5	<0.5	--	<0.5	<0.5	<0.5	<0.5	<0.5	<0.5
05/15/91	11	4.0	<0.5	<0.5	--	<0.5	<0.5	<0.5	<0.5	<0.5	<0.5
08/27/91	8.0	2.2	2.4	<0.5	--	--	<0.5	<0.5	<0.5	<0.5	<0.5
11/15/91	13	5.4	<0.5	<0.5	--	<0.5	<0.5	<0.5	0.8	<0.5	<0.5
02/20/92	11	4.0	<0.5	<0.5	--	<0.5	<0.5	<0.5	<0.5	<0.5	<0.5
06/15/92	9.6	4.2	<0.5	<0.5	--	<0.5	<0.5	<0.5	<0.5	<0.5	<0.5

## Cumulative Table of Well Data and Analytical Results

Vertical Measurements are in feet.

Analytical values are in parts per billion (ppb)

DATE	Carbon Tet	Chloro-form	PCE	TCE	1, 2,-DCE	t-1, 2-DCE	c-1, 2-DCE	1, 1, 1-TCA	1,2-DCA	1, 2-DCP	MC
<b>MW-7</b>											
04/24/89	3.0	9.0	<1.0	<1.0	<1.0	--	--	<1.0	<1.0	--	--
07/28/89	<2.0	<10	<2.0	<2.0	--	<2.0	<2.0	<10	6.0	--	--
07/28/89	<5.0	<20	<5.0	<5.0	--	<5.0	<0.5	<5.0	<5.0	--	--
10/30/89	<1.0	3.9	<1.0	<1.0	<1.0	--	--	<1.0	6.4	--	--
10/30/89	<1.0	3.1	<1.0	<1.0	<1.0	--	--	<1.0	6.2	--	--
01/09/90	<0.5	3.0	<0.5	<0.5	<0.5	--	--	<0.5	8.4	--	--
04/18/90	<0.5	3.2	<0.5	<0.5	<0.5	--	--	<0.5	7.7	0.6	0.6
08/09/90	3.3	7.7	<0.5	<0.5	<0.5	--	--	<0.5	8.4	<0.5	1.8
11/13/90	0.6	3.0	<0.5	<0.5	--	<0.5	<0.5	<0.5	4.0	<0.5	<0.5
05/15/91	2.0	2.0	<0.5	<0.5	--	<0.5	<0.5	<0.5	3.0	<0.5	<0.5
08/27/91	0.7	2.8	<0.5	<0.5	--	--	<0.5	<0.5	2.7	<0.5	<0.5
11/15/91	0.8	2.7	<0.5	<0.5	--	<0.5	<0.5	<0.5	3.1	<0.5	0.8
02/20/92	2.2	1.9	<0.5	<0.5	--	<0.5	<0.5	<0.5	3.3	<0.5	<0.5
06/15/92	1.1	1.8	<0.5	<0.5	--	<0.5	<0.5	<0.5	4.5	<0.5	<0.5
<b>MW-8</b>											
04/24/89	2.0	3.0	6.0	<1.0	4.0	--	--	<1.0	<1.0	--	--
04/24/89	2.0	2.0	6.0	<1.0	3.0	--	--	<1.0	<1.0	--	--
07/28/89	2.3	2.0	5.6	<0.2	--	<0.2	3.8	<0.2	<0.2	--	--
10/30/89	2.5	2.6	8.0	<0.5	5.5	--	--	<0.5	<0.5	--	--
01/09/90	4.9	3.9	19	0.9	6.6	--	--	<0.5	<0.5	--	--
04/18/90	3.8	2.8	17	0.6	5.7	--	--	<0.5	<0.5	<0.5	<0.5
08/09/90	5.3	4.4	27	1.2	9.2	--	--	<0.5	<0.5	<0.5	<0.5
11/13/90	3.0	2.0	21	0.7	--	<0.5	6.0	<0.5	<0.5	<0.5	<0.5
05/15/91	2.0	2.0	30	0.9	--	<0.5	6.0	<0.5	<0.5	<0.5	<0.5
08/27/91	1.4	1.1	32	1.0	--	--	4.7	<0.5	<0.5	<0.5	<0.5
11/15/91	1.5	1.9	50	<0.5	--	<0.5	5.8	<0.5	<0.5	2.0	<0.5
02/20/92	1.3	2.3	68	2.4	--	<0.5	7.6	<0.5	<0.5	<0.5	<0.5
06/15/92	0.7	1.9	46	1.6	--	<0.5	5.6	<0.5	--	<0.5	<0.5



## Cumulative Table of Well Data and Analytical Results

Vertical Measurements are in feet.

Analytical values are in parts per billion (ppb)

DATE	Carbon Tet	Chloro-form	PCE	TCE	1, 2,-DCE	t-1, 2-DCE	c-1, 2-DCE	1, 1, 1-TCA	1,2-DCA	1, 2-DCP	MC
<b>MW-9</b>											
06/22/90	<0.5	<0.5	<0.5	<0.5	--	<0.5	--	<0.5	<0.5	<0.5	<0.5
08/09/90	<0.5	<0.5	<0.5	<0.5	<0.5	--	--	<0.5	0.71	<0.5	<0.5
11/13/90	<0.5	<0.5	<0.5	<0.5	--	<0.5	<0.5	<0.5	1.0	<0.5	<0.5
05/15/91	<0.5	<0.5	<0.5	<0.5	--	<0.5	<0.5	<0.5	0.5	<0.5	<0.5
08/27/91	<0.5	<0.5	<0.5	<0.5	--	--	<0.5	<0.5	<0.5	<0.5	<0.5
11/15/91	<0.5	<0.5	<0.5	<0.5	--	<0.5	<0.5	<0.5	0.6	<0.5	<0.5
02/20/92	<0.5	<0.5	<0.5	<0.5	--	<0.5	<0.5	<0.5	<0.5	<0.5	<0.5
06/15/92	<0.5	<0.5	<0.5	<0.5	--	<0.5	<0.5	<0.5	<0.5	<0.5	<0.5
<b>MW-10</b>											
06/22/90	9.6	8.9	<0.5	<0.5	--	<0.5	--	<0.5	<0.5	<0.5	<0.5
08/09/90	11	7.8	<0.5	<0.5	<0.5	--	--	<0.5	<0.5	<0.5	<0.5
11/13/90	5.0	4.0	<0.5	<0.5	--	<0.5	<0.5	<0.5	<0.5	<0.5	<0.5
05/15/91	5.0	4.0	<0.5	<0.5	--	<0.5	<0.5	<0.5	<0.5	<0.5	<0.5
08/27/91	6.9	3.4	<0.5	<0.5	--	--	<0.5	<0.5	<0.5	<0.5	<0.5
11/15/91	2.7	3.3	<0.5	<0.5	--	<0.5	<0.5	<0.5	<0.5	<0.5	<0.5
02/20/92	3.3	3.4	3.0	<0.5	--	<0.5	<0.5	<0.5	<0.5	<0.5	<0.5
06/15/92	4.5	2.9	<0.5	<0.5	--	<0.5	<0.5	<0.5	<0.5	<0.5	<0.5
<b>MW-11</b>											
06/22/90	4.6	6.5	73	1.3	--	<0.5	8.9	<0.5	<0.5	<0.5	<0.5
08/09/90	8.1	6.8	84	2.0	4.6	--	--	<0.5	<0.5	<0.5	<0.5
11/13/90	<0.5	<0.5	39	<0.5	--	<0.5	2.0	5	<0.5	<0.5	<0.5
05/15/91	1.0	3.0	7	0.5	--	<0.5	2.0	<0.5	<0.5	<0.5	<0.5
08/27/91	4.1	3.3	73	1.0	--	--	2.4	<0.5	<0.5	<0.5	<0.5
11/15/91	3.3	3.6	64	0.9	--	<0.5	2.3	<0.5	<0.5	<0.5	<0.5
02/20/92	<2.5	<2.5	62	<2.5	--	<2.5	<2.5	<2.5	<2.5	<2.5	<2.5
06/15/92	--	---	---	--	--	--	--	--	--	--	--

## Cumulative Table of Well Data and Analytical Results

Vertical Measurements are in feet.

Analytical values are in parts per billion (ppb)

DATE	Carbon Tet	Chloro-form	PCE	TCE	1, 2,-DCE	t-1, 2-DCE	c-1, 2-DCE	1, 1, 1-TCA	1,2-DCA	1, 2-DCP	MC
<b>MW-12</b>											
06/22/90	6.0	7.3	7.4	<0.5	--	<0.5	13	<0.5	<0.5	<0.5	<0.5
08/09/90	8.0	7.0	6.7	<0.5	5.8	--	--	<0.5	<0.5	<0.5	<0.5
11/13/90	<0.5	<0.5	9.0	<0.5	--	<0.5	3.0	3.0	<0.5	<0.5	<0.5
05/15/91	4.0	4.0	10	<0.5	--	<0.5	3.0	<0.5	<0.5	<0.5	<0.5
08/27/91	3.1	2.6	10	<0.5	--	--	2.3	<0.5	<0.5	<0.5	<0.5
11/15/91	1.9	3.5	8.9	<0.5	--	<0.5	5.9	<0.5	<0.5	<0.5	<0.5
02/20/92	3.3	3.4	3.7	<0.5	--	<0.5	<0.5	<0.5	<0.5	<0.5	<0.5
06/15/92	2.2	3.7	13	<0.5	--	<0.5	4.5	<0.5	<0.5	<0.5	<0.5
<b>MW-13</b>											
11/15/91	<0.5	<0.5	<0.5	--	<0.5	<0.5	<0.5	<0.5	<0.5	<0.5	<0.5
02/20/92	<0.5	<0.5	<0.5	--	<0.5	<0.5	<0.5	<0.5	<0.5	<0.5	<0.5
06/15/92	<0.5	<0.5	<0.5	--	--	<0.5	<0.5	<0.5	<0.5	<0.5	<0.5
<b>MW-14</b>											
11/15/91	<0.5	5.5	33	<0.5	--	<0.5	<0.5	<0.5	<0.5	<0.5	<0.5
02/20/92	<0.5	4.3	38	<0.5	--	<0.5	<0.5	<0.5	<0.5	<0.5	<0.5
06/15/92	--	---	---	--	--	--	--	--	--	--	--

## Cumulative Table of Well Data and Analytical Results

Vertical Measurements are in feet.

Analytical values are in parts per billion (ppb)

DATE	Carbon Tet	Chloro-form	PCE	TCE	1, 2,-DCE	t-1, 2-DCE	c-1, 2-DCE	1, 1, 1-TCA	1,2-DCA	1, 2-DCP	MC
<b>TRIP BLANK</b>											
11/03/88	<1.0	<1.0	<1.0	<1.0	--	<1.0	--	<1.0	<1.0	--	--
02/10/89	<0.1	<0.5	<0.1	<0.1	--	<0.1	<0.1	<0.1	<0.1	--	--
04/24/89	<1.0	<1.0	<1.0	<1.0	<1.0	--	--	<1.0	<1.0	--	--
07/28/89	<0.1	<0.5	<0.1	<0.5	<0.1	--	<0.1	<0.1	<0.1	--	--
10/30/89	<0.5	<0.5	<0.5	<0.5	<0.5	--	--	<0.5	<0.5	--	--
01/09/90	<0.5	<0.5	<0.5	<0.5	<0.5	--	--	<0.5	<0.5	--	--
04/18/90	<0.5	<0.5	<0.5	<0.5	<0.5	--	--	<0.5	<0.5	<0.5	<0.5
06/22/90	<0.5	<0.5	<0.5	<0.5	--	<0.5	--	<0.5	<0.5	<0.5	<0.5
08/09/90	<0.5	<0.5	<0.5	<0.5	<0.5	--	--	<0.5	<0.5	<0.5	<0.5
11/13/90	<0.5	0.5	<0.5	<0.5	--	<0.5	<0.5	<0.5	<0.5	<0.5	<0.5
05/15/91	--	--	--	--	--	--	--	--	--	--	--
08/27/91	--	--	--	--	--	--	--	--	--	--	--
11/15/91	<0.5	<0.5	<0.5	<0.5	--	<0.5	<0.5	<0.5	<0.5	<0.5	--
02/20/92	<0.5	<0.5	<0.5	<0.5	--	<0.5	<0.5	<0.5	<0.5	<0.5	--
06/15/92	<0.5	<0.5	<0.5	<0.5	--	<0.5	<0.5	<0.5	<0.5	<0.5	<0.5

## Cumulative Table of Well Data and Analytical Results

**TABLE 2 OF ADDITIONAL ANALYSES**

Vertical Measurements are in feet.

Analytical values are in parts per billion (ppb)

DATE	2-butanone	Acetone	1, 1- DCE	1, 1- DCA	Chloro- benzene	Freon 11
<b>MW-3</b> 08/27/91	--	--	1.3	0.5	0.7	1.4
<b>MW-7</b> 04/24/89	160	5.0	--	--	--	--
<b>MW-13</b> 11/15/91	--	--	--	0.6	--	--

Note: Blaine Tech Services, Inc. began routine monitoring of the groundwater wells at this site on November 1, 1994.  
Earlier field data and analytical results are drawn from the September 27, 1994 Groundwater Technology, Inc. report.

**ABBREVIATIONS:**

TPH = Total Petroleum Hydrocarbons  
 TOG = Total Oil and Grease  
 Carbon Tet = Carbon Tetrachloride  
 PCE = Tetrachloroethene  
 TCE = Trichloroethene  
 1,2-DCE = 1,2-Dichloroethene  
 t-1,2-DCE = trans-1,2-Dichloroethene  
 c-1,2-DCE = cis-1,2-Dichloroethene  
 1,1,1-TCA = 1,1,1-Trichloroethane  
 1,2-DCA = 1,2-Dichloroethane  
 1,2-DCP = 1,2-Dichloropropane  
 1,1-DCE = 1,1-Dichloroethene  
 MC = Methylene chloride

# **Analytical Appendix**



Blaine Technical Services 985 Timothy Drive San Jose, CA 95133	Client Proj. ID: Chevron 9-0020/950627-H1 Sample Descript: MW-7 Matrix: LIQUID Analysis Method: 8015Mod/8020 Lab Number: 9506142-01	Sampled: 06/27/95 Received: 06/28/95 Analyzed: 06/29/95 Reported: 07/10/95
--	---	---

QC Batch Number: GC062995BTEX02A  
Instrument ID: GCHP02

**Total Purgeable Petroleum Hydrocarbons (TPPH) with BTEX**

Analyte	Detection Limit ug/L	Sample Results ug/L
TPPH as Gas	50	N.D.
Benzene	0.50	N.D.
Toluene	0.50	N.D.
Ethyl Benzene	0.50	N.D.
Xylenes (Total)	0.50	N.D.
Chromatogram Pattern:		
<b>Surrogates</b>	<b>Control Limits %</b>	<b>% Recovery</b>
Trifluorotoluene	70                      130	87

Analytes reported as N.D. were not present above the stated limit of detection.

**SEQUOIA ANALYTICAL - ELAP #1210**



Peggy Penner  
Project Manager





Blaine Technical Services  
985 Timothy Drive  
San Jose, CA 95133

Client Proj. ID: Chevron 9-0020/950627-H1  
Sample Descript: MW-9  
Matrix: LIQUID  
Analysis Method: 8015Mod/8020  
Lab Number: 9506142-02

Sampled: 06/27/95  
Received: 06/28/95  
Analyzed: 06/29/95  
Reported: 07/10/95

QC Batch Number: GC062995BTEX02A  
Instrument ID: GCHP02

**Total Purgeable Petroleum Hydrocarbons (TPPH) with BTEX**

Analyte	Detection Limit ug/L	Sample Results ug/L
TPPH as Gas	500	2900
Benzene	5.0	7.4
Toluene	5.0	10
Ethyl Benzene	5.0	68
Xylenes (Total)	5.0	99
Chromatogram Pattern:		Gas

Surrogates	Control Limits %	% Recovery
Trifluorotoluene	70 130	86

Analytes reported as N.D. were not present above the stated limit of detection.

**SEQUOIA ANALYTICAL - ELAP #1210**

  
\_\_\_\_\_  
Peggy Penner  
Project Manager





Blaine Technical Services  
985 Timothy Drive  
San Jose, CA 95133  
  
Attention: Jim Keller

Client Proj. ID: Chevron 9-0020/950627-H1  
Sample Descript: MW-13  
Matrix: LIQUID  
Analysis Method: 8015Mod/8020  
Lab Number: 9506142-03

Sampled: 06/27/95  
Received: 06/28/95  
  
Analyzed: 06/30/95  
Reported: 07/10/95

QC Batch Number: GC062995BTEX02A  
Instrument ID: GCHP02

**Total Purgeable Petroleum Hydrocarbons (TPPH) with BTEX**

Analyte	Detection Limit ug/L	Sample Results ug/L
TPPH as Gas	50	220
Benzene	0.50	1.8
Toluene	0.50	N.D.
Ethyl Benzene	0.50	N.D.
Xylenes (Total)	0.50	0.84
Chromatogram Pattern:		Gas

Surrogates	Control Limits %	% Recovery
Trifluorotoluene	70 130	96

Analytes reported as N.D. were not present above the stated limit of detection.

**SEQUOIA ANALYTICAL** - ELAP #1210

Peggy Penner  
Project Manager







Blaine Technical Services 985 Timothy Drive San Jose, CA 95133	Client Proj. ID: Chevron 9-0020/950627-H1 Sample Descript: MW-15 Matrix: LIQUID Analysis Method: 8015Mod/8020 Lab Number: 9506142-04	Sampled: 06/27/95 Received: 06/28/95 Analyzed: 06/30/95 Reported: 07/10/95
--	--	---

QC Batch Number: GC062995BTEX02A  
Instrument ID: GCHP02

**Total Purgeable Petroleum Hydrocarbons (TPPH) with BTEX**

Analyte	Detection Limit ug/L	Sample Results ug/L
TPPH as Gas	50	N.D.
<b>Benzene</b>	<b>0.50</b>	<b>3.9</b>
Toluene	0.50	N.D.
<b>Ethyl Benzene</b>	<b>0.50</b>	<b>1.4</b>
Xylenes (Total)	0.50	N.D.
Chromatogram Pattern:		

Surrogates	Control Limits %	% Recovery
Trifluorotoluene	70 130	81

Analytes reported as N.D. were not present above the stated limit of detection.

**SEQUOIA ANALYTICAL** - ELAP #1210

  
Peggy Penner  
Project Manager





Blaine Technical Services 985 Timothy Drive San Jose, CA 95133	Client Proj. ID: Chevron 9-0020/950627-H1 Sample Descript: MW-16 Matrix: LIQUID Analysis Method: 8015Mod/8020 Lab Number: 9506142-05	Sampled: 06/27/95 Received: 06/28/95 Analyzed: 06/30/95 Reported: 07/10/95
--	--	---

QC Batch Number: GC063095BTEX20A  
Instrument ID: GCHP20

### Total Purgeable Petroleum Hydrocarbons (TPPH) with BTEX

Analyte	Detection Limit ug/L	Sample Results ug/L
TPPH as Gas	500	2000
Benzene	5.0	330
Toluene	5.0	10
Ethyl Benzene	5.0	27
Xylenes (Total)	5.0	48
Chromatogram Pattern: Unidentified HC		Gas < C8
<b>Surrogates</b>	<b>Control Limits %</b>	<b>% Recovery</b>
Trifluorotoluene	70 130	114

Analytes reported as N.D. were not present above the stated limit of detection.

SEQUOIA ANALYTICAL - ELAP #1210



\_\_\_\_\_  
Peggy Penner  
Project Manager





Blaine Technical Services 985 Timothy Drive San Jose, CA 95133	Client Proj. ID: Chevron 9-0020/950627-H1 Sample Descript: TB Matrix: LIQUID Analysis Method: 8015Mod/8020 Lab Number: 9506142-06	Sampled: 06/27/95 Received: 06/28/95 Analyzed: 06/30/95 Reported: 07/10/95
Attention: Jim Keller		

QC Batch Number: GC062995BTEX02A  
Instrument ID: GCHP02

**Total Purgeable Petroleum Hydrocarbons (TPPH) with BTEX**

Analyte	Detection Limit ug/L	Sample Results ug/L
TPPH as Gas	50	N.D.
Benzene	0.50	N.D.
Toluene	0.50	N.D.
Ethyl Benzene	0.50	N.D.
Xylenes (Total)	0.50	N.D.
Chromatogram Pattern:		
<b>Surrogates</b>	<b>Control Limits %</b>	<b>% Recovery</b>
Trifluorotoluene	70 130	75

Analytes reported as N.D. were not present above the stated limit of detection.

**SEQUOIA ANALYTICAL** - ELAP #1210

  
Peggy Penner  
Project Manager





Blaine Technical Services  
985 Timothy Drive  
San Jose, CA 95133  
Attention: Jim Keller

Client Proj. ID: Chevron 9-0020/950627-H1

Received: 06/28/95

Lab Proj. ID: 9506I42

Reported: 07/10/95

### LABORATORY NARRATIVE

TPPH Note: Sample 9506I42-02 was diluted 10-fold.  
Sample 9506I42-05 was diluted 10-fold.

**SEQUOIA ANALYTICAL**

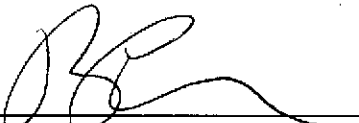
  
Peggy Penner  
Project Manager





Blaine Tech Services, Inc. 985 Timothy Drive San Jose, CA 95133 Attention: Jim Keller	Client Project ID: <b>Chevron 9-0020/950627-H1</b> Matrix: <b>Liquid</b> Work Order #: <b>9506142 -01- 04, 06</b>	Reported: <b>Jul 11, 1995</b>
--	---	-------------------------------

**QUALITY CONTROL DATA REPORT**

Analyte:	Benzene	Toluene	Ethyl Benzene	Xylenes
QC Batch#:	GC062995BTEX02A	GC062995BTEX02A	GC062995BTEX02A	GC062995BTEX02A
Analy. Method:	EPA 8020	EPA 8020	EPA 8020	EPA 8020
Prep. Method:	EPA 5030	EPA 5030	EPA 5030	EPA 5030

Analyst:	J. Woo	J. Woo	J. Woo	J. Woo
MS/MSD #:	9506B5711	9506B5711	9506B5711	9506B5711
Sample Conc.:	N.D.	N.D.	N.D.	N.D.
Prepared Date:	6/29/95	6/29/95	6/29/95	6/29/95
Analyzed Date:	6/29/95	6/29/95	6/29/95	6/29/95
Instrument I.D.#:	GCHP2	GCHP2	GCHP2	GCHP2
Conc. Spiked:	10 µg/L	10 µg/L	10 µg/L	30 µg/L
Result:	9.3	9.4	9.4	28
MS % Recovery:	93	94	94	93
Dup. Result:	9.3	9.3	9.2	28
MSD % Recov.:	93	93	92	93
RPD:	0.0	1.1	2.2	0.0
RPD Limit:	0-50	0-50	0-50	0-50

LCS #:	-	-	-	-
Prepared Date:	-	-	-	-
Analyzed Date:	-	-	-	-
Instrument I.D.#:	-	-	-	-
Conc. Spiked:	-	-	-	-
LCS Result:	-	-	-	-
LCS % Recov.:	-	-	-	-

MS/MSD	71-133	72-128	72-130	71-120
LCS				
Control Limits				

**Please Note:**

The LCS is a control sample of known, interferent-free matrix that is analyzed using the same reagents, preparation, and analytical methods employed for the samples. The matrix spike is an aliquot of sample fortified with known quantities of specific compounds and subjected to the entire analytical procedure. If the recovery of analytes from the matrix spike does not fall within specified control limits due to matrix interference, the LCS recovery is to be used to validate the batch.

**SEQUOIA ANALYTICAL**

*Peggy Penner*  
Peggy Penner  
Project Manager

\*\* MS=Matrix Spike, MSD=MS Duplicate, RPD=Relative % Difference

9506142.BLA <1>





Blaine Tech Services, Inc.  
985 Timothy Drive  
San Jose, CA 95133  
Attention: Jim Keller

Client Project ID: Chevron 9-0020/950627-H1  
Matrix: Liquid

Work Order #: 9506142-05

Reported: Jul 11, 1995

**QUALITY CONTROL DATA REPORT**

Analyte:	Benzene	Toluene	Ethyl Benzene	Xylenes
QC Batch#:	GC063095BTEX20A	GC063095BTEX20A	GC063095BTEX20A	GC063095BTEX20A
Analy. Method:	EPA 8020	EPA 8020	EPA 8020	EPA 8020
Prep. Method:	EPA 5030	EPA 5030	EPA 5030	EPA 5030

Analyst:	J. Woo	J. Woo	J. Woo	J. Woo
MS/MSD #:	9506C4107	9506C4107	9506C4107	9506C4107
Sample Conc.:	N.D.	N.D.	N.D.	N.D.
Prepared Date:	6/30/95	6/30/95	6/30/95	6/30/95
Analyzed Date:	6/30/95	6/30/95	6/30/95	6/30/95
Instrument I.D.#:	GCHP20	GCHP20	GCHP20	GCHP20
Conc. Spiked:	10 µg/L	10 µg/L	10 µg/L	30 µg/L
Result:	9.8	9.7	9.5	29
MS % Recovery:	98	97	95	97
Dup. Result:	10	9.1	9.0	29
MSD % Recov.:	100	91	90	97
RPD:	2.0	6.4	5.4	0.0
RPD Limit:	0-50	0-50	0-50	0-50

LCS #:	-	-	-	-
Prepared Date:	-	-	-	-
Analyzed Date:	-	-	-	-
Instrument I.D.#:	-	-	-	-
Conc. Spiked:	-	-	-	-
LCS Result:	-	-	-	-
LCS % Recov.:	-	-	-	-

MS/MSD LCS Control Limits	71-133	72-128	72-130	71-120

SEQUOIA ANALYTICAL

*Peggy Penner*  
Peggy Penner  
Project Manager

**Please Note:**  
The LCS is a control sample of known, interferent-free matrix that is analyzed using the same reagents, preparation, and analytical methods employed for the samples. The matrix spike is an aliquot of sample fortified with known quantities of specific compounds and subjected to the entire analytical procedure. If the recovery of analytes from the matrix spike does not fall within specified control limits due to matrix interference, the LCS recovery is to be used to validate the batch.

\*\* MS= Matrix Spike, MSD= MS Duplicate, RPD= Relative % Difference

9506142.BLA <2>



Fax copy of Lab report and COC to Chevron Contact:  No

### Chain-of-Custody-Record

<b>Chevron U.S.A. Inc.</b> P.O. BOX 5004 San Ramon, CA 94583 FAX (415)842-9591	Chevron Facility Number <u>9-0020</u> Facility Address <u>1633 Harrison St., Oakland, CA</u>	Chevron Contact (Name) <u>Mark Miller</u> (Phone) <u>(510) 842-8134</u>
	Consultant Project Number <u>950627-H1</u> Consultant Name <u>Blaine Tech Services, Inc.</u> Address <u>985 Timothy Dr., San Jose, CA 95133</u>	Laboratory Name <u>Sequoia</u> Laboratory Release Number <u>2172400</u>
	Project Contact (Name) <u>Jim Keller</u> (Phone) <u>08-995-5535</u> (Fax Number) <u>408-293-8773</u>	Samples Collected by (Name) <u>TROY N. HORNER</u> Collection Date <u>6/27/95</u> Signature <u>Troy N. Horner</u>

Sample Number	Lab Sample Number	Number of Containers	Matrix S = Soil W = Water C = Charcoal	Type G = Grab C = Composite D = Discrete	Time	Sample Preservation	Iced (Yes or No)	Analyses To Be Performed										DO NOT BILL FOR TB-LB	Remarks
								ETEX + TPH GAS (6020 + 6015)	TPH Diesel (6015)	Oil and Grease (6520)	Purgeable Halocarbons (6010)	Purgeable Aromatics (6020)	Purgeable Organics (6240)	Extractable Organics (6270)	Metals Cd, Cr, Pb, Zn, Ni (ICAP or AA)				
MW-7		3	W		0801	HCL	Y	X											01 A-C
MW-7		3	W		0828	HCL	Y	X											02
MW-13		3	W		0817	HCL	Y	X											03
MW-15		3	W		0144	HCL	Y	X											04
MW-16		3	W		0856	HCL	Y	X											05
TB		2	W			HCL	Y	X											06 A,B

9506I42

Relinquished By (Signature) <u>Troy N. Horner</u>	Organization <u>BTS</u>	Date/Time <u>6/28 10:15</u>	Received By (Signature) <u>[Signature]</u>	Organization <u>SEN</u>	Date/Time <u>6/28 10:15</u>	Turn Around Time (Circle Choice) 24 Hrs. 48 Hrs. 5 Days <u>10 Days</u> As Contracted
Relinquished By (Signature) <u>[Signature]</u>	Organization <u>SEN</u>	Date/Time <u>6/28 11:50</u>	Received By (Signature) <u>[Signature]</u>	Organization <u>[Blank]</u>	Date/Time <u>[Blank]</u>	
Relinquished By (Signature) <u>[Signature]</u>	Organization <u>[Blank]</u>	Date/Time <u>[Blank]</u>	Received For Laboratory By (Signature) <u>[Signature]</u>	Organization <u>[Blank]</u>	Date/Time <u>6/28/95 11:50</u>	

COC-3.DWG/03 B1/MCH

# **Field Data Sheets**





# CHEVRON WELL MONITORING DATA SHEET

Project #: <u>950627-H1</u>	Station #: <u>9-0020</u>
Sampler: <u>TNH</u>	Start Date: <u>8/27/95</u>
Well I.D.: <u>MW-7</u>	Well Diameter: (circle one) 2 3 <u>4</u> 6
Total Well Depth: Before <u>26.49</u> After	Depth to Water: Before <u>17.26</u> After
Depth to Free Product:	Thickness of Free Product (feet):
Measurements referenced to: <u>PVC</u>	Grade Other:

Well Diameter	VCF	Well Diameter	VCF
1"	0.04	6"	1.47
2"	0.16	8"	2.61
3"	0.37	10"	4.08
4"	0.65	12"	5.87
5"	1.02	16"	10.43

<u>4.7</u>	x	<u>3</u>	=	<u>14.1</u>
1 Case Volume		Specified Volumes		gallons

Purging: Bailer Disposable Bailer Middleburg Electric Submersible <input checked="" type="checkbox"/> Extraction Pump Other _____	Sampling: Bailer Disposable Bailer <input checked="" type="checkbox"/> Extraction Port Other _____
--	---

TIME	TEMP. (F)	pH	COND.	TURBIDITY:	VOLUME REMOVED:	OBSERVATIONS:
<u>7:55</u>	<u>62.4</u>	<u>6.6</u>	<u>800</u>	<u>————</u>	<u>5</u>	
<u>7:56</u>	<u>65.5</u>	<u>6.8</u>	<u>700</u>	<u>————</u>	<u>10</u>	
<u>7:57</u>	<u>65.5</u>	<u>7.0</u>	<u>680</u>	<u>————</u>	<u>15</u>	

Did Well Dewater? NO If yes, gals. Gallons Actually Evacuated: 15

Sampling Time: 801 Sampling Date: 8/27/95

Sample I.D.: MW-7 Laboratory: SEQR

Analyzed for: (Circle) TPH-G BTEX TPH-D OTHER:

Duplicate I.D.: Cleaning Blank I.D.:

Analyzed for: (Circle) TPH-G BTEX TPH-D OTHER:

# CHEVRON WELL MONITORING DATA SHEET

Project #: <u>950627-H1</u>	Station #: <u>9-0020</u>
Sampler: <u>TNH</u>	Start Date: <u>6/27/95</u>
Well I.D.: <u>MW-9</u>	Well Diameter: (circle one) <u>(2)</u> 3 4 6
Total Well Depth: Before <u>23.66</u> After	Depth to Water: Before <u>19.40</u> After
Depth to Free Product:	Thickness of Free Product (feet):
Measurements referenced to: <u>(PVC)</u> Grade Other:	

Well Diameter	VCF	Well Diameter	VCF
1"	0.04	6"	1.47
2"	0.16	8"	2.61
3"	0.37	10"	4.08
4"	0.65	12"	5.87
5"	1.02	16"	10.43

<u>.68</u>	x	<u>3</u>	=	<u>2.0</u>
1 Case Volume		Specified Volumes		gallons

Purging: Bailer  
 Disposable Bailer   
 Middleburg  
 Electric Submersible  
 Extraction Pump  
 Other \_\_\_\_\_

Sampling: Bailer  
 Disposable Bailer   
 Extraction Port  
 Other \_\_\_\_\_

TIME	TEMP. (F)	pH	COND.	TURBIDITY:	VOLUME REMOVED:	OBSERVATIONS:
<u>0831</u>	<u>67.4</u>	<u>6.9</u>	<u>680</u>	<u>—————</u>	<u>1</u>	<u>ODOR</u>
<u>0832</u>	<u>67.5</u>	<u>6.9</u>	<u>640</u>	<u>—————</u>	<u>1.5</u>	
<u>0833</u>	<u>67.5</u>	<u>6.9</u>	<u>640</u>	<u>—————</u>	<u>2.0</u>	

Did Well Dewater? NO If yes, gals. Gallons Actually Evacuated: 2.0

Sampling Time: 0838 Sampling Date: 6/27/95

Sample I.D.: MW-9 Laboratory: SEQ

Analyzed for: (TPH-G) (BTEX) TPH-D OTHER:

Duplicate I.D.: Cleaning Blank I.D.:

Analyzed for: TPH-G BTEX TPH-D OTHER:

# CHEVRON WELL MONITORING DATA SHEET

Project #: <u>950627-H1</u>	Station #: <u>9-0020</u>
Sampler: <u>TNH</u>	Start Date: <u>6/27/95</u>
Well I.D.: <u>MW-13</u>	Well Diameter: (circle one) <u>(2)</u> 3 4 6
Total Well Depth: Before <u>27.42</u> After	Depth to Water: Before <u>19.76</u> After
Depth to Free Product:	Thickness of Free Product (feet):
Measurements referenced to: <u>(PVC)</u> Grade Other:	

Well Diameter	VCF	Well Diameter	VCF
1"	0.04	6"	1.47
2"	0.16	8"	2.61
3"	0.37	10"	4.08
4"	0.65	12"	5.87
5"	1.02	16"	10.43

<u>1.2</u>	x	<u>3</u>	=	<u>3.6</u>
1 Case Volume		Specified Volumes		gallons

Purging: Bailer  
 Disposable Bailer    
 Middleburg  
 Electric Submersible  
 Extraction Pump  
 Other \_\_\_\_\_

Sampling: Bailer  
 Disposable Bailer    
 Extraction Port  
 Other \_\_\_\_\_

TIME	TEMP. (F)	PH	COND.	TURBIDITY:	VOLUME REMOVED:	OBSERVATIONS:
<u>0809</u>	<u>65.3</u>	<u>7.0</u>	<u>640</u>	<u>---</u>	<u>2</u>	
<u>0812</u>	<u>65.6</u>	<u>6.9</u>	<u>660</u>	<u>---</u>	<u>3</u>	
<u>0814</u>	<u>65.6</u>	<u>6.8</u>	<u>660</u>	<u>---</u>	<u>4</u>	

Did Well Dewater? NO If yes, gals. Gallons Actually Evacuated: 4.0

Sampling Time: 0817 Sampling Date: 6/27/95

Sample I.D.: MW-13 Laboratory: SEQ

Analyzed for: (TPH-G) (BTEX) TPH-D OTHER:

Duplicate I.D.: Cleaning Blank I.D.:

Analyzed for: TPH-G BTEX TPH-D OTHER:  
 (Circle)

# CHEVRON WELL MONITORING DATA SHEET

Project #: <u>950627-H1</u>	Station #: <u>9-0020</u>
Sampler: <u>TNH</u>	Start Date: <u>6/27/95</u>
Well I.D.: <u>MW-15</u>	Well Diameter: (circle one) <u>(2)</u> 3 4 6
Total Well Depth: Before <u>26.24</u> After	Depth to Water: Before <u>19.34</u> After
Depth to Free Product:	Thickness of Free Product (feet):
Measurements referenced to: <u>(PVC)</u>	Grade Other:

Well Diameter	VCF	Well Diameter	VCF
1"	0.04	6"	1.47
2"	0.16	8"	2.61
3"	0.37	10"	4.08
4"	0.65	12"	5.87
5"	1.02	16"	10.43

<u>1.1</u>	x	<u>3</u>	=	<u>3.3</u>
1 Case Volume		Specified Volumes		gallons

Purging: Bailer Disposable Bailer <input checked="" type="checkbox"/> Middleburg Electric Submersible Extraction Pump Other _____	Sampling: Bailer Disposable Bailer <input checked="" type="checkbox"/> Extraction Port Other _____
--	---

TIME	TEMP. (F)	pH	COND.	TURBIDITY:	VOLUME REMOVED:	OBSERVATIONS:
<u>735</u>	<u>65.3</u>	<u>7.0</u>	<u>1000</u>	_____	<u>1.5</u>	
<u>737</u>	<u>65.4</u>	<u>6.6</u>	<u>500</u>	_____	<u>2.5</u>	
<u>740</u>	<u>65.2</u>	<u>6.4</u>	<u>480</u>	_____	<u>3.5</u>	

Did Well Dewater? <u>NO</u> If yes, gals.	Gallons Actually Evacuated: <u>3.5</u>
Sampling Time: <u>744</u>	Sampling Date: <u>6/27/95</u>
Sample I.D.: <u>MW-15</u>	Laboratory: <u>SEQ</u>
Analyzed for: <u>(TPH-G)</u> <u>(BTEX)</u> TPH-D OTHER:	
Duplicate I.D.:	Cleaning Blank I.D.:
Analyzed for: TPH-G BTEX TPH-D OTHER:	