



Chevron

December 13, 1995

Chevron U.S.A. Products Company
6001 Bollinger Canyon Rd., Bldg. L
P.O. Box 5004
San Ramon, CA 94583-0804

Ms. Jennifer Eberle
Alameda County Health Care Services
Department of Environmental Health
1131 Harbor Bay Parkway, Suite 250
Alameda, CA 94502-6577

Mark A. Miller
SAR Engineer
Phone No. 510 842-8134
Fax No. 510 842-8252

**Re: Former Chevron Service Station #9-0020
1633 Harrison Street, Oakland, CA**

Dear Ms. Eberle:

Enclosed is the Third Quarter 1995 Groundwater Monitoring Report dated November 3, 1995, prepared by our consultant Blaine Tech Services, Inc. for the above referenced site. As confirmed in your letter of July 21, 1995, only wells MW-7, MW-9, MW-13, MW-15, and MW-16 are monitored and sampled on a quarterly basis.

As indicated in the report, ground water samples collected were analyzed for total petroleum hydrocarbons as gasoline (TPH-G), and BTEX. Dissolved concentrations of the constituents present in ground water are consistent with historic observations at the site. Depth to ground water was measured at approximately 19.3 feet to 20.0 feet below grade and the direction of flow is to the east-northeast.

The origin of dissolved hydrocarbons currently observed in MW-16 is unclear. It is anticipated that continued monitoring and sampling will yield insight into the source of hydrocarbons present in this well. **A parked car prevented monitoring and sampling this well during the past quarter.** We will instruct our consultant to be sure this well is monitored and sampled during subsequent quarters.

If you have any questions or comments, please feel free to contact me at (510) 842-8134.

Sincerely,
CHEVRON U.S.A. PRODUCTS COMPANY

Mark A. Miller
Site Assessment and Remediation Engineer

Enclosure

cc: Ms. B.C. Owen

The Oakland Housing Authority
Attn.: Mr. Harold Davis
1619 Harrison Street
Oakland, CA 94612



RECEIVED
ENVIRONMENTAL
HEALTH SERVICES
DIVISION
NOV 15 1995

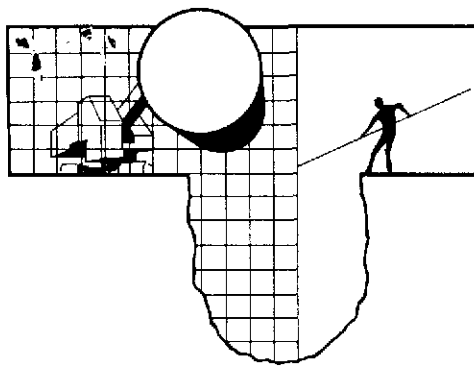

November 3, 1995

Mark Miller
Chevron U.S.A. Products Company
P.O. Box 5004
San Ramon, CA 94583-0804

3rd Quarter 1995 Monitoring at 9-0020

Third Quarter 1995 Groundwater Monitoring at
Chevron Service Station Number 9-0020
1633 Harrison Street
Oakland, CA

Monitoring Performed on September 28, 1995

Groundwater Sampling Report 950928-D-1

This report covers the routine quarterly monitoring of groundwater wells at this Chevron facility. Blaine Tech Services, Inc.'s work at the site includes inspection, gauging, evacuation, purgewater containment, sample collection and sample handling in accordance with standard procedures that conform to Regional Water Quality Control Board requirements.

Routine field data collection includes depth to water, total well depth, thickness of any separate immiscible layer, water column volume, calculated volume of a three-case volume purge, elapsed evacuation time, total volume of water removed, and standard water parameter instrument readings. Sample material is collected, contained, stored, and transported to the laboratory in conformance with EPA standards. Purgewater is, likewise, collected and transported to Chevron's Richmond Refinery for disposal.

Basic field information is presented alongside analytical values excerpted from the laboratory report in the cumulative table of **WELL DATA AND ANALYTICAL RESULTS**. The full analytical report for the most recent samples is located in the **Analytical Appendix**. The table also contains new groundwater elevation calculations taken from the computer plotted gradient map which is located in the **Professional Engineering Appendix**.

At a minimum, Blaine Tech Services, Inc. field personnel are certified upon completion of a forty-hour Hazardous Materials and Emergency Response training course per 29 CFR 1910.120. Field personnel are also enrolled in annual eight hour refresher courses.

Blaine Tech Services, Inc. conducts sampling and documentation assignments of this type as an independent third party. In order to avoid compromising the objectivity necessary for the proper and disinterested performance of this work, Blaine Tech Services, Inc. concentrates on objective data collection and does not participate in the interpretation of analytical results, the definition of geological or hydrological conditions, the formulation of recommendations, or the marketing of remedial systems.

Please call if you have any questions.

Yours truly,

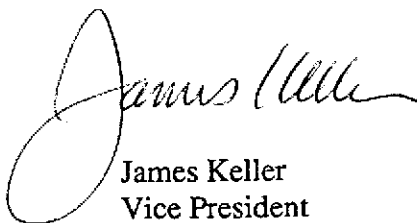
A handwritten signature in cursive script that reads "James Keller". The signature is written in black ink and is positioned above the printed name and title.

James Keller
Vice President

JPK/dk

attachments: Professional Engineering Appendix
Cumulative Table of Well Data and Analytical Results
Analytical Appendix
Field Data Sheets

Professional Engineering Appendix

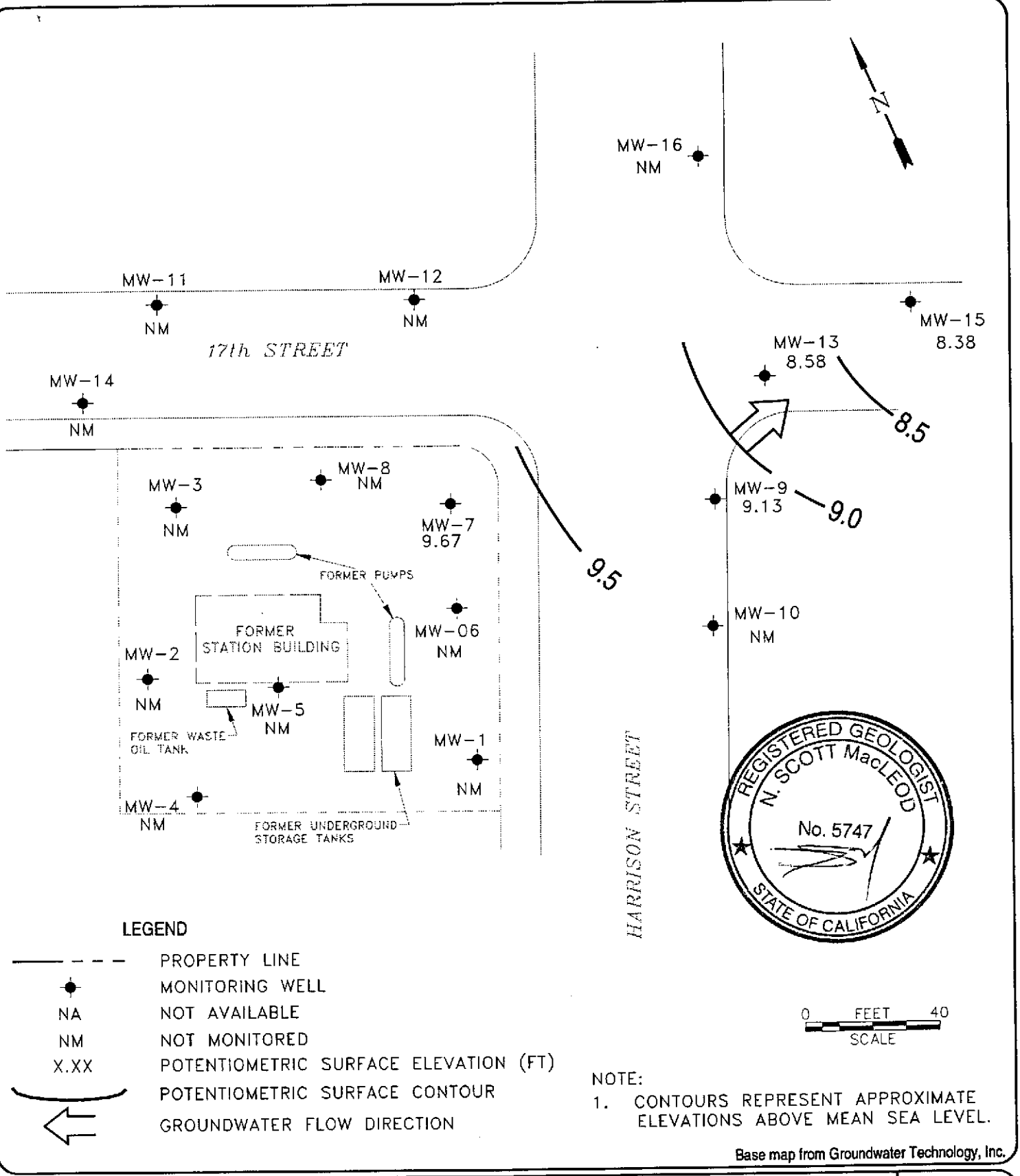

LEGEND

- PROPERTY LINE
- MONITORING WELL
- NA NOT AVAILABLE
- NM NOT MONITORED
- X.XX POTENTIOMETRIC SURFACE ELEVATION (FT)
- ← POTENTIOMETRIC SURFACE CONTOUR
- ← GROUNDWATER FLOW DIRECTION

NOTE:
 1. CONTOURS REPRESENT APPROXIMATE ELEVATIONS ABOVE MEAN SEA LEVEL.

Base map from Groundwater Technology, Inc.

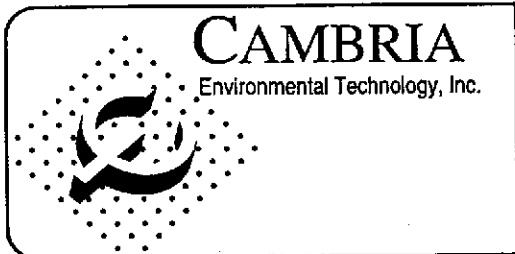

Chevron Station 9-0020
 1633 Harrison Street
 Oakland, California
 \CHEVRON9-0020\0020-QM.DWG

Ground Water Elevation
 September 28, 1995

FIGURE
1

**Table of
Well Data and
Analytical Results**

Cumulative Table of Well Data and Analytical Results

Vertical Measurements are in feet.

Analytical results are in parts per billion (ppb)

DATE	Well Head Elev.	Ground Water Elev.	Depth To Water	Notes	TPH-Gasoline	Benzene	Toluene	Ethyl-Benzene	Xylene	TOG
MW-1										
11/03/88	29.82	9.42	20.40	--	<1000	<1.0	<1.0	<1.0	<1.0	--
02/02/89	29.82	9.11	20.71	--	--	--	--	--	--	--
02/10/89	29.82	--	--	--	<100	<0.2	<0.2	<0.2	<0.4	--
04/23/89	29.82	9.48	20.34	--	--	--	--	--	--	--
04/24/89	29.82	--	--	--	<50	<0.5	<1.0	<1.0	<1.0	<3000
07/28/89	29.82	9.24	20.58	--	<50	<0.1	<0.5	<0.2	<0.5	<3000
10/30/89	29.82	9.30	20.52	--	<500	<0.3	<0.3	<0.3	<0.6	--
01/09/90	29.82	9.05	20.77	--	<50	<0.3	<0.3	<0.3	<0.6	--
04/18/90	29.82	8.87	20.95	--	<50	<0.3	<0.3	<0.3	<0.6	--
06/22/90	29.82	8.82	21.00	--	--	--	--	--	--	--
08/09/90	29.82	8.88	20.94	--	<50	<0.3	<0.3	<0.3	<0.6	--
11/13/90	29.82	8.84	20.98	--	<50	<0.5	<0.5	<0.5	<0.5	--
05/15/91	29.82	9.18	20.64	--	<50	<0.5	<0.5	<0.5	<0.5	--
08/27/91	29.82	9.03	20.79	--	110	<0.5	<0.5	<0.5	<0.5	--
11/15/91	29.82	9.07	20.75	--	<50	<0.5	<0.5	<0.5	<0.5	--
02/20/92	29.82	8.92	20.90	--	<50	0.5	0.6	<0.5	0.9	--
06/15/92	29.82	9.18	20.64	--	<50	<0.5	<0.5	<0.5	<0.5	--
12/16/92	29.82	8.98	20.84	--	<50	<0.5	<0.5	<0.5	<0.5	--
04/07/93	29.82	9.91	19.91	--	<50	<0.5	<0.5	<0.5	<1.5	--
06/09/93	29.82	9.97	19.85	--	--	--	--	--	--	--
09/10/93	29.82	--	--	--	--	--	--	--	--	--
09/27/93	29.82	9.47	20.35	--	<50	<0.5	<0.5	<0.5	<0.5	--
12/17/93	29.82	9.14	20.68	--	<50	<0.5	<0.5	<0.5	<0.5	--
03/10/94	29.82	9.25	20.57	--	<50	<0.5	<0.5	<0.5	<0.5	--
06/16/94	29.82	9.27	20.55	--	<50	<0.5	<0.5	<0.5	<0.5	--
09/07/94	29.82	9.13	20.69	--	<50	<0.5	<0.5	<0.5	<0.5	--
11/30/94	29.82	9.59	20.23	--	<50	<0.5	<0.5	<0.5	<0.5	--
03/22/95	29.82	10.37	19.45	--	<50	<0.5	<0.5	<0.5	<0.5	--

NO LONGER MONITORED OR SAMPLED

Cumulative Table of Well Data and Analytical Results

Vertical Measurements are in feet.

Analytical results are in parts per billion (ppb)

DATE	Well Head Elev.	Ground Water Elev.	Depth To Water	Notes	TPH-Gasoline	Benzene	Toluene	Ethyl-Benzene	Xylene	TOG
MW-2										
11/03/88	30.59	9.70	20.89	--	<1000	<1.0	<1.0	<1.0	<1.0	--
02/02/89	30.59	9.38	21.21	--	--	--	--	--	--	--
02/10/89	30.59	--	--	--	<100	<0.2	<0.2	<0.2	<0.4	--
04/23/89	30.59	9.77	20.82	--	--	--	--	--	--	--
04/24/89	30.59	--	--	--	<50	<0.5	<1.0	<1.0	<1.0	<3000
07/28/89	30.59	9.57	21.02	--	<100	<0.2	<1.0	<0.2	<0.5	<3000
10/30/89	30.59	9.63	20.96	--	<500	<0.3	<0.3	<0.3	<0.6	--
01/09/90	30.59	9.34	21.25	--	<50	<0.3	<0.3	<0.3	<0.6	--
04/18/90	30.59	9.06	21.53	--	<50	<0.3	<0.3	<0.3	<0.6	--
06/22/90	30.59	9.02	21.57	--	--	--	--	--	--	--
08/09/90	30.59	9.04	21.55	--	<50	<0.3	<0.3	<0.3	<0.6	--
11/13/90	30.59	9.05	21.54	--	<50	<0.5	0.8	<0.5	0.9	--
05/15/91	30.59	9.44	21.15	--	83	<0.5	<0.5	<0.5	<0.5	--
08/27/91	30.59	9.32	21.27	--	97	<0.5	<0.5	<0.5	<0.5	--
11/15/91	30.59	9.29	21.30	--	<50	0.5	1.5	0.8	3.6	--
02/20/92	30.59	9.13	21.43	--	<50	<0.5	<0.5	<0.5	<0.5	--
06/15/92	30.59	9.41	21.18	--	<50	<0.5	<0.5	<0.5	<0.5	--
12/16/92	30.56	9.09	21.47	--	<50	<0.5	<0.5	<0.5	<0.5	--
04/07/93	30.56	10.03	20.53	--	66	<0.5	<0.5	<0.5	<1.5	--
06/09/93	30.56	10.11	20.45	--	<50	<0.5	<0.5	<0.5	<0.5	--
09/10/93	30.56	--	--	--	--	--	--	--	--	--
09/27/93	30.56	9.59	20.97	--	--	--	--	--	--	--
12/17/93	30.56	9.25	21.31	--	<50	<0.5	<0.5	<0.5	<0.5	--
03/10/94	30.56	9.33	21.23	--	<50	<0.5	<0.5	<0.5	<0.5	--
06/16/94	30.56	9.35	21.21	--	<50	<0.5	<0.5	<0.5	<0.5	--
09/07/94	30.56	9.22	21.34	--	<50	<0.5	<0.5	<0.5	<0.5	--
11/30/94	30.56	9.66	20.90	--	<50	<0.5	<0.5	<0.5	<0.5	--
03/22/95	30.56	10.22	20.34	--	<50	<0.5	<0.5	<0.5	<0.5	--

NO LONGER MONITORED OR SAMPLED

Cumulative Table of Well Data and Analytical Results

Vertical Measurements are in feet.

Analytical results are in parts per billion (ppb)

DATE	Well Head Elev.	Ground Water Elev.	Depth To Water	Notes	TPH-Gasoline	Benzene	Toluene	Ethyl-Benzene	Xylene	TOG
MW-3										
11/03/88	30.09	9.55	20.54	--	<1000	<1.0	<1.0	<1.0	<1.0	--
02/02/89	30.09	9.24	20.85	--	--	--	--	--	--	--
02/10/89	30.09	--	--	--	<100	<0.2	<0.2	<0.2	<0.4	--
04/23/89	30.09	9.66	20.43	--	--	--	--	--	--	--
04/24/89	30.09	--	--	--	<50	<0.5	<1.0	<1.0	<1.0	<3000
07/28/89	30.09	9.45	20.64	--	<100	<0.2	<1.0	<0.2	<0.4	<3000
10/30/89	30.09	9.48	20.61	--	<500	<0.3	<0.3	<0.3	<0.6	--
01/09/90	30.09	9.21	20.88	--	<50	<0.3	<0.3	<0.3	<0.6	--
04/18/90	30.09	8.94	21.15	--	<50	<0.3	<0.3	<0.3	<0.6	--
06/22/90	30.09	8.89	21.20	--	--	--	--	--	--	--
08/09/90	30.09	8.91	21.18	--	<50	<0.3	<0.3	<0.3	<0.6	--
11/13/90	30.09	8.94	21.15	--	51	<0.5	<0.5	<0.5	<0.5	--
05/15/91	30.09	9.18	20.91	--	85	<0.5	<0.5	<0.5	<0.5	--
08/27/91	30.09	9.20	20.89	*	91	<0.5	<0.5	<0.5	<0.5	--
11/15/91	30.09	9.07	21.02	--	<50	<0.5	0.7	<0.5	1.3	--
02/20/92	30.09	9.02	21.07	--	<50	<0.5	<0.5	<0.5	0.9	--
06/15/92	30.09	9.27	20.82	--	50	<0.5	<0.5	<0.5	<0.5	--
12/16/92	30.08	9.07	21.07	--	<50	<0.5	<0.5	<0.5	<0.5	--
04/07/93	30.08	9.95	20.13	--	<50	<0.5	<0.5	<0.5	<1.5	--
06/09/93	30.08	10.03	20.05	--	<50	<0.5	<0.5	<0.5	<0.5	--
09/10/93	30.08	--	--	--	<50	<0.5	<0.5	<0.5	<0.5	--
09/27/93	30.08	9.50	20.58	--	--	--	--	--	--	--
12/17/93	30.08	9.07	21.01	--	<50	<0.5	<0.5	<0.5	<0.5	--
03/10/94	30.08	9.22	20.86	--	<50	<0.5	<0.5	<0.5	1.1	--
06/16/94	30.08	9.21	20.87	--	<50	<0.5	<0.5	<0.5	<0.5	--
09/07/94	30.08	9.11	20.97	--	<50	<0.5	<0.5	<0.5	<0.5	--
11/30/94	30.08	10.45	19.63	--	<50	<0.5	<0.5	<0.5	<0.5	--
03/22/95	30.08	10.27	19.81	--	<50	<0.5	<0.5	<0.5	<0.5	--

NO LONGER MONITORED OR SAMPLED

* See Table 2 of Additional Analyses.

Cumulative Table of Well Data and Analytical Results

Vertical Measurements are in feet.

Analytical results are in parts per billion (ppb)

DATE	Well Head Elev.	Ground Water Elev.	Depth To Water	Notes	TPH-Gasoline	Benzene	Toluene	Ethyl-Benzene	Xylene	TOG
MW-4										
04/23/89	31.17	9.84	21.33	--	--	--	--	--	--	--
04/24/89	31.17	--	--	--	<50	<0.5	<1.0	<1.0	<1.0	<3000
07/28/89	31.17	9.59	21.58	--	<50	<0.1	<0.5	<0.1	<0.2	<3000
10/30/89	31.17	9.63	21.54	--	<500	<0.3	<0.3	<0.3	<0.6	--
01/09/90	31.17	9.35	21.82	--	<50	<0.3	<0.3	<0.3	<0.6	--
04/18/90	31.17	9.08	22.09	--	<50	<0.3	<0.3	<0.3	<0.6	--
06/22/90	31.17	9.05	22.12	--	--	--	--	--	--	--
08/09/90	31.17	9.06	22.11	--	<50	<0.3	<0.3	<0.3	<0.6	--
11/13/90	31.17	9.07	22.10	--	<50	<0.5	1.0	0.5	1.0	--
05/15/91	31.17	9.46	21.71	--	<50	<0.5	<0.5	<0.5	<0.5	--
08/27/91	31.17	9.30	21.87	--	<50	<0.5	<0.5	<0.5	<0.5	--
11/15/91	31.17	9.37	21.80	--	97	<0.5	0.9	<0.5	1.9	--
02/20/92	31.17	9.18	21.99	--	<50	<0.5	<0.5	<0.5	<0.5	--
06/15/92	31.17	9.43	21.74	--	<50	<0.5	<0.5	<0.5	<0.5	--
12/16/92	31.17	9.12	22.05	--	<50	0.7	0.5	0.5	1.3	--
04/07/93	31.17	10.06	21.11	--	<50	<0.5	<0.5	<0.5	<1.5	--
06/09/93	31.17	--	--	--	--	--	--	--	--	--
09/10/93	31.17	--	--	--	--	--	--	--	--	--
09/27/93	31.17	9.63	21.54	--	<50	<0.5	<0.5	<0.5	<0.5	--
12/17/93	31.17	9.28	21.89	--	<50	<0.5	<0.5	<0.5	<0.5	--
03/10/94	31.17	--	--	--	--	--	--	--	--	--
06/16/94	31.17	10.63	20.54	--	--	--	--	--	--	--
09/07/94	31.17	9.27	21.90	--	<50	<0.5	<0.5	<0.5	<0.5	--
11/30/94	31.17	9.83	21.34	--	<50	<0.5	<0.5	<0.5	<0.5	--
03/21/95	31.17	10.55	20.62	--	<50	<0.5	<0.5	<0.5	<0.5	--

NO LONGER MONITORED OR SAMPLED

Cumulative Table of Well Data and Analytical Results

Vertical Measurements are in feet.

Analytical results are in parts per billion (ppb)

DATE	Well Head Elev.	Ground Water Elev.	Depth To Water	Notes	TPH-Gasoline	Benzene	Toluene	Ethyl-Benzene	Xylene	TOG
MW-5										
04/23/89	30.28	9.66	20.62	--	--	--	--	--	--	--
04/24/89	30.28	--	--	--	<50	<0.5	<1.0	<1.0	<1.0	<3000
07/28/89	30.28	9.42	20.86	--	<100	<0.2	<1.0	<0.2	<0.4	<3000
10/30/89	30.28	9.46	20.82	--	<500	<0.3	<0.3	<0.3	<0.6	--
01/09/90	30.28	9.21	21.07	--	<50	<0.3	<0.3	<0.3	<0.6	--
04/18/90	30.28	8.93	21.35	--	<50	<0.3	<0.3	<0.3	<0.6	--
06/22/90	30.28	8.90	21.38	--	--	--	--	--	--	--
08/09/90	30.28	8.92	21.36	--	<50	<0.3	<0.3	<0.3	<0.6	--
11/13/90	30.28	8.93	21.35	--	<50	<0.5	1.0	<0.5	1.0	--
05/15/91	30.28	8.99	21.29	--	<50	<0.5	<0.5	<0.5	<0.5	--
08/27/91	30.28	9.17	21.11	--	94	3.0	5.0	1.5	5.5	--
11/15/91	30.28	9.10	21.18	--	<50	0.9	1.7	<0.5	2.2	--
02/20/92	30.28	9.03	21.25	--	<50	<0.5	<0.5	<0.5	<0.5	--
06/15/92	30.28	9.28	21.00	--	<50	<0.5	<0.5	<0.5	<0.5	--
12/16/92	30.28	9.05	21.23	--	<50	<0.5	<0.5	<0.5	<0.5	--
04/07/93	30.28	9.97	20.31	--	<50	<0.5	<0.5	<0.5	<1.5	--
06/09/93	30.28	--	--	--	--	--	--	--	--	--
09/10/93	30.28	--	--	--	--	--	--	--	--	--
09/27/93	30.28	9.52	20.76	--	--	--	--	--	--	--

NO LONGER MONITORED OR SAMPLED

Cumulative Table of Well Data and Analytical Results

Vertical Measurements are in feet.

Analytical results are in parts per billion (ppb)

DATE	Well Head Elev.	Ground Water Elev.	Depth To Water	Notes	TPH-Gasoline	Benzene	Toluene	Ethyl-Benzene	Xylene	TOG
MW-6										
04/23/89	29.46	9.41	20.05	--	--	--	--	--	--	--
04/24/89	29.46	--	--	--	<50	<0.5	<1.0	<1.0	<1.0	<3.0
07/28/89	29.46	9.16	20.30	--	<100	<0.2	<1.0	<0.2	<0.4	<3.0
10/30/89	29.46	9.14	20.32	--	<500	<0.3	<0.3	<0.3	<0.6	--
01/09/90	29.46	8.95	20.51	--	<50	<0.3	<0.3	<0.3	<0.6	--
04/18/90	29.46	8.74	20.72	--	<50	<0.3	<0.3	<0.3	<0.6	--
06/22/90	29.46	8.69	20.77	--	--	--	--	--	--	--
08/09/90	29.46	8.72	20.74	--	<50	<0.3	<0.3	<0.3	<0.6	--
11/13/90	29.46	8.71	20.75	--	<50	3.0	5.0	0.5	2.0	--
05/15/91	29.46	8.85	20.61	--	<50	<0.5	<0.5	<0.5	<0.5	--
08/27/91	29.46	8.93	20.53	--	180	6.1	12	3.8	14	--
11/15/91	29.46	8.93	20.53	--	<50	<0.5	0.6	<0.5	<0.5	--
02/20/92	29.46	8.77	20.69	--	<50	0.9	1.1	<0.5	1.4	--
06/15/92	29.46	9.08	20.38	--	<50	<0.5	<0.5	<0.5	<0.5	--
12/16/92	29.45	8.88	20.57	--	<50	<0.5	<0.5	<0.5	<0.5	--
04/07/93	29.45	9.86	19.59	--	<50	<0.5	<0.5	<0.5	<1.5	--
06/09/93	29.45	9.95	19.50	--	<50	<0.5	<0.5	<0.5	<0.5	--
09/10/93	29.45	--	--	--	--	--	--	--	--	--
09/27/93	29.45	9.38	20.07	--	--	--	--	--	--	--

NO LONGER MONITORED OR SAMPLED

Cumulative Table of Well Data and Analytical Results

Vertical Measurements are in feet.

Analytical results are in parts per billion (ppb)

DATE	Well Head Elev.	Ground Water Elev.	Depth To Water	Notes	TPH-Gasoline	Benzene	Toluene	Ethyl-Benzene	Xylene	TOG
MW-7										
04/23/89	29.01	10.02	18.99	--	--	--	--	--	--	--
04/24/89	29.01	--	--	*	8400	100	260	160	1300	<3.0
07/28/89	29.01	9.07	19.94	--	7000	230	90	70	440	<3000
07/28/89	29.01	--	--	Duplicate	6000	280	180	58	430	--
10/30/89	29.01	9.04	19.97	--	10,000	570	55	160	400	--
10/30/89	29.01	--	--	Duplicate	9900	520	82	180	410	--
01/09/90	29.01	8.86	20.15	--	3400	290	72	9.0	200	--
04/18/90	29.01	8.64	20.37	--	6800	350	140	110	400	--
06/22/90	29.01	8.61	20.40	--	--	--	--	--	--	--
08/09/90	29.01	8.63	20.38	--	11,000	360	130	14	660	--
11/13/90	29.01	8.60	20.41	--	6500	230	110	97	460	--
05/15/91	29.01	8.54	20.47	--	4600	180	55	46	300	--
08/27/91	29.01	8.87	20.14	--	7000	220	53	63	340	--
11/15/91	29.01	8.79	20.22	--	3300	150	19	4.9	200	--
02/20/92	29.01	8.69	20.32	--	5200	520	150	100	380	--
06/15/92	29.01	9.03	19.98	--	10,000	760	430	320	1100	--
12/16/92	29.01	8.87	20.14	--	11,000	810	350	280	1100	--
04/07/93	29.01	9.87	19.14	--	150	1.4	0.9	0.9	4.5	--
06/09/93	29.01	9.96	19.05	--	180	4.0	1.0	1.0	3.0	--
09/10/93	29.01	--	--	--	--	--	--	--	--	--
09/27/93	29.01	--	--	--	--	--	--	--	--	--
12/17/93	29.01	--	--	--	--	--	--	--	--	--
03/10/94	29.01	--	--	--	--	--	--	--	--	--
06/16/94	29.01	--	--	--	--	--	--	--	--	--
09/07/94	29.01	--	--	--	--	--	--	--	--	--
11/30/94	29.01	--	--	Inaccessible	--	--	--	--	--	--
01/17/95	29.01	17.39	11.62	--	2700	140	65	44	200	--
03/22/95	29.01	11.33	17.68	--	160	3.4	<0.5	1.1	0.77	--
06/27/95	29.01	9.75	19.26	--	<50	<0.5	<0.5	<0.5	<0.5	--
09/28/95	29.01	9.67	19.34	--	1500	84	24	26	130	--

* See Table 2 of Additional Analyses.

Cumulative Table of Well Data and Analytical Results

Vertical Measurements are in feet.

Analytical results are in parts per billion (ppb)

DATE	Well Head Elev.	Ground Water Elev.	Depth To Water	Notes	TPH-Gasoline	Benzene	Toluene	Ethyl-Benzene	Xylene	TOG
MW-8										
04/23/89	29.57	9.43	20.14	--	--	--	--	--	--	--
04/24/89	29.57	--	--	--	<50	<0.5	<1.0	<1.0	<1.0	3000
04/24/89	29.57	--	--	Duplicate	<50	<0.5	<1.0	<1.0	<1.0	--
07/28/89	29.57	9.20	20.37	--	<100	<0.2	<1.0	<0.2	<0.4	<3000
10/30/89	29.57	9.25	20.32	--	<500	<0.3	<0.3	<0.3	<0.6	--
01/09/90	29.57	8.97	20.60	--	<50	<0.3	<0.3	<0.3	<0.6	--
04/18/90	29.57	8.70	20.87	--	<50	<0.3	<0.3	<0.3	<0.6	--
06/22/90	29.57	9.23	20.34	--	--	--	--	--	--	--
08/09/90	29.57	8.68	20.89	--	<50	<0.3	<0.3	<0.3	<0.6	--
11/13/90	29.57	8.71	20.86	--	<50	<0.5	0.8	<0.5	2.0	--
05/15/91	29.57	9.08	20.49	--	<50	<0.5	<0.5	<0.5	<0.5	--
08/27/91	29.57	8.97	20.60	--	73	<0.5	<0.5	<0.5	<0.5	--
11/15/91	29.57	8.95	20.62	--	<50	<0.5	0.7	<0.5	2.1	--
02/20/92	29.57	8.77	20.80	--	<50	<0.5	<0.5	<0.5	<0.5	--
06/15/92	29.57	9.09	20.48	--	<50	<0.5	<0.5	<0.5	<0.5	--
12/16/92	29.57	8.89	20.68	--	<50	<0.5	<0.5	<0.5	<0.5	--
04/07/93	29.57	9.87	19.70	--	<50	<0.5	<0.5	<0.5	<1.5	--
06/09/93	29.57	9.97	19.60	--	<50	<0.5	<0.5	<0.5	<0.5	--
09/10/93	29.57	--	--	--	--	--	--	--	--	--
09/27/93	29.57	9.35	20.22	--	--	--	--	--	--	--

NO LONGER MONITORED OR SAMPLED

Cumulative Table of Well Data and Analytical Results

Vertical Measurements are in feet.

Analytical results are in parts per billion (ppb)

DATE	Well Head Elev.	Ground Water Elev.	Depth To Water	Notes	TPH-Gasoline	Benzene	Toluene	Ethyl-Benzene	Xylene	TOG
MW-9										
06/22/90	28.67	7.87	20.80	--	5700	47	31	280	530	<1000
08/09/90	28.67	7.93	20.74	--	8000	<0.3	17	210	480	--
11/13/90	28.67	7.89	20.78	--	6400	<3.0	20	240	450	--
05/15/91	28.67	8.19	20.48	--	5700	2.0	16	190	390	--
08/27/91	28.67	8.12	20.55	--	6700	<3.0	31	180	350	--
11/15/91	28.67	8.10	20.57	--	4000	8.8	26	150	280	--
02/20/92	28.67	6.90	21.77	--	3400	13	30	230	460	--
06/15/92	28.67	8.30	20.37	--	4500	19	72	280	560	--
12/16/92	28.68	8.39	20.29	--	9900	380	220	380	1300	--
04/07/93	28.68	9.36	19.32	--	8700	51	150	360	1000	--
06/09/93	28.68	9.52	19.16	--	8900	170	160	350	1100	--
09/10/93	28.68	--	--	--	4600	110	63	190	350	--
09/27/93	28.68	8.74	19.94	--	--	--	--	--	--	--
12/17/93	28.68	8.37	20.31	--	4600	92	85	180	300	--
03/10/94	28.68	8.38	20.30	--	3300	8.0	29	120	170	--
06/16/94	28.68	8.42	20.26	--	2900	4.8	16	85	64	--
09/07/94	28.68	8.27	20.41	--	2900	<0.5	9.9	70	75	--
11/30/94	28.68	8.70	19.98	--	2100	<5.0	<5.0	53	51	--
03/22/95	28.68	9.27	19.41	--	2200	<5.0	5.3	26	69	--
06/27/95	28.68	9.28	19.40	--	2900	7.4	10	68	99	--
09/28/95	28.68	9.13	19.55	--	4000	32	<10	36	44	--

Cumulative Table of Well Data and Analytical Results

Vertical Measurements are in feet.

Analytical results are in parts per billion (ppb)

DATE	Well Head Elev.	Ground Water Elev.	Depth To Water	Notes	TPH-Gasoline	Benzene	Toluene	Ethyl-Benzene	Xylene	TOG
MW-10										
06/22/90	28.60	8.12	20.48	--	<50	<0.5	<0.5	<0.5	<0.5	<1000
08/09/90	28.60	8.15	20.45	--	<50	<0.3	<0.3	<0.3	<0.6	--
11/13/90	28.60	8.13	20.47	--	<50	<0.5	2.0	0.5	2.0	--
05/15/91	28.60	8.45	20.15	--	<50	<0.5	<0.5	<0.5	<0.5	--
08/27/91	28.60	8.33	20.27	--	<50	<0.5	<0.5	<0.5	<0.5	--
11/15/91	28.60	8.27	20.33	--	<50	<0.5	<0.5	<0.5	<0.5	--
02/20/92	28.60	7.15	21.45	--	<50	2.0	2.2	<0.5	2.1	--
06/15/92	28.60	7.30	21.30	--	<50	<0.5	<0.5	<0.5	<0.5	--
12/16/92	28.62	8.45	20.17	--	<50	<0.5	<0.5	<0.5	<0.5	--
04/07/93	28.62	9.41	19.26	--	<50	<0.5	<0.5	<0.5	<1.5	--
06/09/93	28.62	9.55	19.07	--	<50	<0.5	<0.5	<0.5	<0.5	--
09/10/93	28.62	--	--	--	<50	<0.5	<0.5	<0.5	<0.5	--
09/24/93	28.62	8.90	19.72	--	--	--	--	--	--	--
12/17/93	28.62	8.55	20.07	--	<50	<0.5	<0.5	<0.5	<0.5	--
03/10/94	28.62	8.65	19.97	--	<50	<0.5	<0.5	<0.5	<0.5	--
06/16/94	28.62	8.64	19.98	--	<50	<0.5	<0.5	<0.5	<0.5	--
09/07/94	28.62	8.50	20.12	--	<50	<0.5	<0.5	<0.5	<0.5	--
11/30/94	28.62	8.92	19.70	--	<50	<0.5	<0.5	<0.5	<0.5	--
03/22/95	28.62	9.70	18.92	--	<50	<0.5	<0.5	<0.5	<0.5	--

NO LONGER MONITORED OR SAMPLED

Cumulative Table of Well Data and Analytical Results

Vertical Measurements are in feet.

Analytical results are in parts per billion (ppb)

DATE	Well Head Elev.	Ground Water Elev.	Depth To Water	Notes	TPH-Gasoline	Benzene	Toluene	Ethyl-Benzene	Xylene	TOG
MW-11										
06/22/90	29.37	8.34	21.03	--	<50	<0.5	<0.5	<0.5	<0.5	<1000
08/09/90	29.37	8.35	21.02	--	<50	<0.3	<0.3	<0.3	<0.6	--
11/13/90	29.37	8.44	20.93	--	76	0.6	1.0	0.9	4.0	--
05/15/91	29.37	8.76	20.61	--	78	<0.5	<0.5	<0.5	<0.5	--
08/27/91	29.37	8.67	20.70	--	110	<0.5	<0.5	<0.5	<0.5	--
11/15/91	29.37	8.69	20.68	--	<50	<0.5	<0.5	<0.5	<0.5	--
02/20/92	29.37	7.46	21.91	--	<50	1.9	2.1	1.0	4.4	--
06/15/92	29.37	8.81	20.56	--	--	--	--	--	--	--
12/16/92	29.39	8.64	20.75	--	<50	<0.5	<0.5	<0.5	<0.5	--
04/07/93	29.39	9.56	19.83	--	<50	<0.5	<0.5	<0.5	<1.5	--
06/09/93	29.39	9.72	19.67	--	<50	<0.5	<0.5	<0.5	<0.5	--
09/10/93	29.39	--	--	--	--	--	--	--	--	--
09/27/93	29.39	9.06	20.33	--	<50	<0.5	<0.5	<0.5	<0.5	--
12/17/93	29.39	8.66	20.73	--	<50	<0.5	<0.5	<0.5	<0.5	--
03/10/94	29.39	8.70	20.69	--	--	--	--	--	--	--
06/16/94	29.39	8.83	20.56	--	<50	<0.5	<0.5	<0.5	<0.5	--

NO LONGER MONITORED OR SAMPLED

MW-12

06/22/90	28.43	7.98	20.45	--	<50	<0.5	<0.5	<0.5	<0.5	<1000
08/09/90	28.43	8.00	20.43	--	<50	<0.3	<0.3	<0.3	<0.6	--
11/13/90	28.43	7.98	20.45	--	<50	<0.5	<0.5	<0.5	<0.5	--
05/15/91	28.43	8.36	20.07	--	<50	<0.5	<0.5	<0.5	<0.5	--
08/27/91	28.43	8.28	20.15	--	56	<0.5	<0.5	<0.5	<0.5	--
11/15/91	28.43	8.18	20.25	--	<50	<0.5	<0.5	<0.5	<0.5	--
02/20/92	28.43	7.06	21.37	--	<50	2.5	3.1	0.7	3.0	--
06/15/92	28.43	8.53	19.90	--	<50	<0.5	<0.5	<0.5	<0.5	--
12/16/92	28.43	8.63	19.80	--	<50	<0.5	<0.5	<0.5	<0.5	--
04/07/93	28.43	9.68	18.75	--	<50	<0.5	<0.5	<0.5	<1.5	--
06/09/93	28.43	--	--	--	--	--	--	--	--	--
09/10/93	28.43	--	--	--	--	--	--	--	--	--
09/27/93	28.43	8.80	19.63	--	--	--	--	--	--	--

NO LONGER MONITORED OR SAMPLED

Cumulative Table of Well Data and Analytical Results

Vertical Measurements are in feet.

Analytical results are in parts per billion (ppb)

DATE	Well Head Elev.	Ground Water Elev.	Depth To Water	Notes	TPH-Gasoline	Benzene	Toluene	Ethyl-Benzene	Xylene	TOG
MW-13										
11/15/91	28.63	7.56	21.07	*	3100	68	40	110	270	--
02/20/92	28.63	6.46	22.17	--	3100	120	50	240	400	--
06/15/92	28.63	7.96	20.67	--	3200	35	33	210	300	--
12/16/92	28.62	8.28	20.34	--	87,000	1400	540	2400	11,000	--
04/07/93	28.62	9.21	19.41	--	1500	72	12	70	160	--
06/09/93	28.62	9.42	19.20	--	210	6.0	2.0	7.0	16	--
09/10/93	28.62	--	--	--	73	3.0	<0.5	2.0	3.0	--
09/27/93	28.62	8.27	20.35	--	--	--	--	--	--	--
12/17/93	28.62	7.86	20.76	--	640	43	12	12	37	--
03/10/94	28.62	7.93	20.69	--	540	44	22	10	69	--
06/16/94	28.62	7.95	20.67	--	1800	63	12	18	64	--
09/07/94	28.62	7.79	20.83	--	1400	59	12	22	50	--
11/30/94	28.62	8.21	20.41	--	700	36	4.4	18	31	--
03/22/95	28.62	8.80	19.82	--	190	1.4	1.4	<0.5	<0.5	--
06/27/95	28.62	8.86	19.76	--	220	1.8	<0.5	<0.5	0.84	--
09/28/95	28.62	8.58	20.04	--	160	3.2	<0.5	0.97	2.2	--
MW-14										
11/15/91	29.46	9.13	20.33	--	<50	<0.5	<0.5	<0.5	<0.5	--
02/20/92	29.46	8.05	21.41	--	<50	1.3	1.8	1.1	5.2	--
06/15/92	29.46	--	--	--	--	--	--	--	--	--
12/16/92	29.45	8.79	20.66	--	<50	<0.5	<0.5	<0.5	<0.5	--
04/07/93	29.45	--	--	--	--	--	--	--	--	--
06/09/93	29.45	--	--	--	--	--	--	--	--	--
09/10/93	29.45	--	--	--	--	--	--	--	--	--
09/27/93	29.45	9.19	20.26	--	--	--	--	--	--	--

NO LONGER MONITORED OR SAMPLED

* See Table 2 of Additional Analyses.

Cumulative Table of Well Data and Analytical Results

Vertical Measurements are in feet.

Analytical results are in parts per billion (ppb)

DATE	Well Head Elev.	Ground Water Elev.	Depth To Water	Notes	TPH-Gasoline	Benzene	Toluene	Ethyl-Benzene	Xylene	TOG
MW-15										
12/16/92	28.04	8.30	19.74	--	<50	<0.5	<0.5	<0.5	<0.5	--
04/07/93	28.04	9.24	18.80	--	<50	1.3	<0.5	<0.5	<1.5	--
06/09/93	28.04	9.44	18.60	--	<50	<0.5	<0.5	<0.5	<0.5	--
09/10/93	28.04	--	--	--	--	--	--	--	--	--
09/27/93	28.04	8.11	19.93	--	<50	2.0	<0.5	<0.5	<0.5	--
12/17/93	28.04	7.72	20.32	--	<50	<0.5	<0.5	<0.5	<0.5	--
03/10/94	28.04	7.75	20.29	--	<50	<0.5	<0.5	<0.5	<0.5	--
06/16/94	28.04	7.73	20.31	--	<50	<0.5	<0.5	<0.5	<0.5	--
09/07/94	28.04	7.61	20.43	--	<50	<0.5	<0.5	<0.5	<0.5	--
11/30/94	28.04	8.03	20.01	--	<50	<0.5	<0.5	<0.5	<0.5	--
03/22/95	28.04	8.57	19.47	--	69	4.9	<0.5	<0.5	<0.5	--
06/27/95	28.04	8.70	19.34	--	<50	3.9	<0.5	1.4	<0.5	--
09/28/95	28.04	8.38	19.66	--	<50	0.82	<0.5	<0.5	<0.5	--
MW-16										
12/16/92	28.32	8.74	19.58	--	--	--	--	--	--	--
12/21/92	28.32	--	--	--	<50	<0.5	<0.5	<0.5	<0.5	--
04/07/93	28.32	9.91	18.41	--	<50	<0.5	6.8	<0.5	<0.5	--
06/09/93	28.32	10.07	18.25	--	<50	<0.5	<0.5	<0.5	<0.5	--
09/10/93	28.32	--	--	--	<50	<0.5	<0.5	<0.5	<0.5	--
09/27/93	28.32	8.16	20.16	--	--	--	--	--	--	--
12/17/93	28.32	--	--	--	--	--	--	--	--	--
03/10/94	28.32	7.77	20.55	--	<50	<0.5	<0.5	<0.5	<0.5	--
06/16/94	28.32	7.67	20.65	--	<50	0.9	0.7	<0.5	<0.5	--
09/07/94	28.32	7.59	20.73	--	150	1.3	0.8	1.2	3.6	--
11/30/94	28.32	8.04	20.28	--	4200	300	<5.0	34	350	--
03/22/95	28.32	8.65	19.67	--	2900	180	5.7	21	91	--
06/27/95	28.32	8.72	19.60	--	2000	330	10	27	48	--
09/28/95	28.32	--	--	Inaccessible	--	--	--	--	--	--

Cumulative Table of Well Data and Analytical Results

Vertical Measurements are in feet.

Analytical results are in parts per billion (ppb)

DATE	Well Head Elev.	Ground Water Elev.	Depth To Water	Notes	TPH-Gasoline	Benzene	Toluene	Ethyl-Benzene	Xylene	TOG
TRIP BLANK										
11/03/88	--	--	--	--	--	<1.0	<1.0	<1.0	<1.0	--
02/10/89	--	--	--	--	<50	<0.1	<0.1	<0.1	<0.2	--
04/24/89	--	--	--	--	<50	<0.5	<0.5	<1.0	<1.0	--
07/28/89	--	--	--	--	<50	<0.1	<0.1	<0.1	<0.2	--
10/30/89	--	--	--	--	<500	<0.3	<0.3	<0.3	<0.6	--
01/09/90	--	--	--	--	<50	<0.3	<0.3	<0.3	<0.6	--
04/18/90	--	--	--	--	<50	<0.3	<0.3	<0.3	<0.6	--
06/22/90	--	--	--	--	<50	<0.5	<0.5	<0.5	<0.5	--
08/09/90	--	--	--	--	<50	<0.3	<0.3	<0.3	<0.6	--
11/13/90	--	--	--	--	<50	<0.5	<0.5	<0.5	<0.5	--
05/15/91	--	--	--	--	<50	<0.5	<0.5	<0.5	<0.5	--
08/27/91	--	--	--	--	<50	<0.5	<0.5	<0.5	<0.5	--
11/15/91	--	--	--	--	<50	<0.5	<0.5	<0.5	<0.5	--
02/20/92	--	--	--	--	<50	<0.5	<0.5	<0.5	<0.5	--
06/15/92	--	--	--	--	<50	<0.5	<0.5	<0.5	<0.5	--
12/16/92	--	--	--	--	<50	<0.5	<0.5	<0.5	<0.5	--
04/07/93	--	--	--	--	<50	<0.5	<0.5	<0.5	<1.5	--
06/09/93	--	--	--	--	<50	<0.5	<0.5	<0.5	<0.5	--
09/10/93	--	--	--	--	<50	<0.5	<0.5	<0.5	<0.5	--
09/27/93	--	--	--	--	<50	<0.5	<0.5	<0.5	<0.5	--
12/17/93	--	--	--	--	<50	<0.5	<0.5	<0.5	<0.5	--
03/10/94	--	--	--	--	<50	<0.5	0.6	<0.5	0.6	--
06/16/94	--	--	--	--	<50	<0.5	<0.5	<0.5	<0.5	--
09/07/94	--	--	--	--	<50	<0.5	<0.5	<0.5	<0.5	--
11/30/94	--	--	--	--	<50	<0.5	<0.5	<0.5	<0.5	--
01/17/95	--	--	--	--	<50	<0.5	<0.5	<0.5	<0.5	--
03/22/95	--	--	--	--	<50	<0.5	<0.5	<0.5	<0.5	--
06/27/95	--	--	--	--	<50	<0.5	<0.5	<0.5	<0.5	--
09/28/95	--	--	--	--	<50	<0.5	<0.5	<0.5	<0.5	--

Cumulative Table of Well Data and Analytical Results

TABLE OF ADDITIONAL ANALYSES

Vertical Measurements are in feet.

Analytical values are in parts per billion (ppb)

DATE	Carbon Tet	Chloro-form	PCE	TCE	1, 2,-DCE	t-1, 2-DCE	c-1, 2-DCE	1, 1, 1-TCA	1,2-DCA	1, 2-DCP	MC
MW-1											
11/03/88	18	7.0	<1.0	<1.0	--	<1.0	--	<1.0	<1.0	--	--
02/10/89	17	6.0	<0.2	<0.2	--	<0.2	<0.2	<0.2	<0.2	--	--
04/24/89	16	6.0	<1.0	<1.0	<1.0	--	--	<1.0	<1.0	--	--
07/28/89	20	6.4	<0.1	<0.1	--	<0.1	<0.1	0.3	<0.1	--	--
10/30/89	11	4.9	<0.5	<0.5	<0.5	--	--	<0.5	<0.5	--	--
01/09/90	24	7.2	<0.5	<0.5	<0.5	--	--	<0.5	<0.5	--	--
04/18/90	23	5.5	<0.5	<0.5	<0.5	--	--	1.4	<0.5	<0.5	<0.5
08/09/90	32	11	0.7	<0.5	<0.5	--	--	<0.5	<0.5	<0.5	<0.5
11/13/90	24	7.0	60.7	<0.5	--	<0.5	<0.5	<0.5	<0.5	<0.5	<0.5
05/15/91	15	5.0	<0.5	<0.5	--	<0.5	<0.5	<0.5	<0.5	<0.5	<0.5
08/27/91	18	4.2	<0.5	<0.5	--	--	<0.5	<0.5	<0.5	<0.5	<0.5
11/15/91	21	7.9	<0.5	<0.5	--	<0.5	<0.5	<0.5	<0.5	<0.5	<0.5
02/20/92	24	7.5	<0.5	<0.5	--	<0.5	<0.5	<0.5	<0.5	<0.5	<0.5
06/15/92	10	3.2	<0.5	<0.5	--	<0.5	<0.5	<0.5	<0.5	<0.5	<0.5
MW-2											
11/03/88	3.0	2.0	34	3.0	--	10	--	<1.0	<1.0	--	--
02/10/89	1.4	1.0	17.2	<0.2	--	<0.2	6.3	<0.2	<0.2	--	--
04/24/89	2.0	2.0	38	3.0	9.0	--	--	<1.0	<1.0	--	--
07/28/89	3.7	2.0	46	2.6	--	<0.2	<0.2	<0.2	<0.2	--	--
10/30/89	1.4	2.6	53	1.1	14	--	--	<0.5	<0.5	--	--
01/09/90	3.6	3.9	78	5.3	16	--	--	<0.5	<0.5	--	--
04/18/90	1.5	2.7	130	3.9	19	--	--	<0.5	<0.5	<0.5	<0.5
08/09/90	2.1	2.1	74	6.1	15	--	--	<0.5	<0.5	<0.5	<0.5
11/13/90	<0.5	2.0	40	4.0	--	<0.5	10	<0.5	<0.5	<0.5	<0.5
05/15/91	2.0	2.0	56	6.0	--	<0.5	15	<0.5	<0.5	<0.5	<0.5
08/27/91	1.1	0.9	46	3.9	--	--	8.0	<0.5	<0.5	<0.5	<0.5
11/15/91	0.6	1.1	58	3.1	--	<0.5	6.3	<0.5	<0.5	<0.5	<0.5
02/20/92	11	<2.5	62	3.1	--	<2.5	4.3	<2.5	<2.5	<2.5	<2.5
06/15/92	<0.5	1.2	45	3.1	--	<0.5	4.8	<0.5	<0.5	<0.5	<0.5

Cumulative Table of Well Data and Analytical Results

Vertical Measurements are in feet.

Analytical values are in parts per billion (ppb)

DATE	Carbon Tet	Chloro-form	PCE	TCE	1, 2,-DCE	t-1, 2-DCE	c-1, 2-DCE	1, 1, 1-TCA	1,2-DCA	1, 2-DCP	MC
MW-3											
11/03/88	8.0	6.0	84	3.0	--	5.0	--	<1.0	<1.0	--	--
02/10/89	5.8	4.0	53	1.9	--	<0.2	9.0	<0.2	<0.2	--	--
04/24/89	7.0	6.0	110	3.0	11	--	--	<1.0	<1.0	--	--
07/28/89	8.6	5.0	49	2.1	--	<0.2	11	<0.2	<0.1	--	--
10/30/89	5.6	5.3	62	0.7	8.2	--	--	<0.5	<0.5	--	--
01/09/90	8.6	6.1	81	73.8	8.7	--	--	<0.5	<0.5	--	--
04/18/90	7.6	5.8	120	2.4	11	--	--	<0.5	<0.5	<0.5	<0.5
08/09/90	11	6.7	81	5.1	11	--	--	<0.5	<0.5	<0.5	<0.5
11/13/90	7.0	5.0	43	4.0	--	<0.5	9.0	<0.5	<0.5	<0.5	<0.5
05/15/91	6.0	4.0	46	3.0	--	<0.5	8.0	<0.5	<0.5	<0.5	<0.5
08/27/91	5.5	3.8	43	2.6	--	--	8.1	<0.5	<0.5	<0.5	<0.5
11/15/91	6.3	5.0	67	3.4	--	0.8	7.4	0.9	<0.5	<0.5	<0.5
02/20/92	2.8	4.0	96	3.0	--	<2.5	6.1	<2.5	<2.5	<2.5	<0.5
06/15/92	5.0	3.9	86	2.9	--	<0.5	7.5	<0.5	<0.5	<0.5	<0.5
MW-4											
04/24/89	35	11	<1.0	<1.0	<1.0	--	--	<1.0	<1.0	--	--
07/28/89	32	9.3	<0.1	<0.1	--	<0.1	<0.1	<0.1	<0.1	--	--
10/30/89	32	8.5	<0.5	<0.5	<0.5	--	--	<0.5	<0.5	--	--
01/09/90	36	9.8	<0.5	<0.5	<0.5	--	--	<0.5	<0.5	--	--
04/18/90	41	9.5	<0.5	<0.5	<0.5	--	--	<0.5	<0.5	<0.5	<0.5
08/09/90	38	11	<0.5	<0.5	<0.5	--	--	<0.5	<0.5	<0.5	<0.5
11/13/90	40	11	<0.5	<0.5	--	<0.5	<0.5	<0.5	<0.5	<0.5	<0.5
05/15/91	35	10	<0.5	<0.5	--	<0.5	<0.5	<0.5	<0.5	<0.5	<0.5
08/27/91	28	6.1	<0.5	<0.5	--	--	<0.5	<0.5	<0.5	<0.5	<0.5
11/15/91	23	9.1	<0.5	<0.5	--	<0.5	<0.5	<0.5	<0.5	<0.5	<0.5
02/20/92	400	140	<0.5	<0.5	--	<0.5	<0.5	<0.5	<0.5	<0.5	<0.5
06/15/92	38	11	<0.5	<0.5	--	<0.5	<0.5	<0.5	<0.5	<0.5	<0.5

Cumulative Table of Well Data and Analytical Results

Vertical Measurements are in feet.

Analytical values are in parts per billion (ppb)

DATE	Carbon Tet	Chloro-form	PCE	TCE	1, 2,-DCE	t-1, 2-DCE	c-1, 2-DCE	1, 1, 1-TCA	1,2-DCA	1, 2-DCP	MC
MW-5											
04/24/89	4.0	5.0	4.0	<1.0	2.0	--	--	<1.0	<1.0	--	--
07/28/89	5.6	4.0	5.3	0.3	--	<0.2	2.3	0.5	<0.2	--	--
10/30/89	2.9	2.0	2.7	<0.5	0.86	--	--	<0.5	<0.5	--	--
01/09/90	8.2	4.6	7.8	0.6	3.1	--	--	<0.5	<0.5	--	--
04/18/90	6.3	2.8	2.6	<0.5	1.7	--	--	<0.5	<0.5	<0.5	<0.5
08/09/90	11	4.8	6.0	<0.5	2.3	--	--	<0.5	<0.5	<0.5	<0.5
11/13/90	7.0	3.0	5.0	<0.5	--	<0.5	1	<0.5	<0.5	<0.5	<0.5
05/15/91	4.0	2.0	3.0	<0.5	--	<0.5	0.8	<0.5	<0.5	<0.5	<0.5
08/27/91	3.3	1.1	2.3	<0.5	--	--	<0.5	<0.5	<0.5	<0.5	<0.5
11/15/91	5.7	2.8	5.5	<0.5	--	<0.5	1.7	<0.5	<0.5	<0.5	<0.5
02/20/92	4.0	2.0	3.9	<0.5	--	<0.5	0.7	<0.5	<0.5	<0.5	<0.5
06/15/92	4.0	2.0	5.0	<0.5	--	<0.5	1.4	<0.5	<0.5	<0.5	<0.5
MW-6											
04/24/89	13	7.0	<1.0	<1.0	<1.0	--	--	<1.0	<1.0	--	--
07/28/89	9.6	4.0	<0.2	<0.2	--	<0.2	<0.2	0.5	0.6	--	--
10/30/89	8.2	3.6	<0.5	<0.5	<0.5	--	--	<0.5	<0.5	--	--
01/09/90	10	4.2	<0.5	<0.5	<0.5	--	--	<0.5	1.8	--	--
04/18/90	11	3.8	<0.5	<0.5	<0.5	--	--	<0.5	<0.5	<0.5	<0.5
08/09/90	20	6.6	<0.5	<0.5	<0.5	--	--	<0.5	<0.5	<0.5	<0.5
11/13/90	15	5.0	<0.5	<0.5	--	<0.5	<0.5	<0.5	<0.5	<0.5	<0.5
05/15/91	11	4.0	<0.5	<0.5	--	<0.5	<0.5	<0.5	<0.5	<0.5	<0.5
08/27/91	8.0	2.2	2.4	<0.5	--	--	<0.5	<0.5	<0.5	<0.5	<0.5
11/15/91	13	5.4	<0.5	<0.5	--	<0.5	<0.5	<0.5	0.8	<0.5	<0.5
02/20/92	11	4.0	<0.5	<0.5	--	<0.5	<0.5	<0.5	<0.5	<0.5	<0.5
06/15/92	9.6	4.2	<0.5	<0.5	--	<0.5	<0.5	<0.5	<0.5	<0.5	<0.5

Cumulative Table of Well Data and Analytical Results

Vertical Measurements are in feet.

Analytical values are in parts per billion (ppb)

DATE	Carbon Tet	Chloro-form	PCE	TCE	1, 2,-DCE	t-1, 2-DCE	c-1, 2-DCE	1, 1, 1-TCA	1,2-DCA	1, 2-DCP	MC
MW-7											
04/24/89	3.0	9.0	<1.0	<1.0	<1.0	--	--	<1.0	<1.0	--	--
07/28/89	<2.0	<10	<2.0	<2.0	--	<2.0	<2.0	<10	6.0	--	--
07/28/89	<5.0	<20	<5.0	<5.0	--	<5.0	<0.5	<5.0	<5.0	--	--
10/30/89	<1.0	3.9	<1.0	<1.0	<1.0	--	--	<1.0	6.4	--	--
10/30/89	<1.0	3.1	<1.0	<1.0	<1.0	--	--	<1.0	6.2	--	--
01/09/90	<0.5	3.0	<0.5	<0.5	<0.5	--	--	<0.5	8.4	--	--
04/18/90	<0.5	3.2	<0.5	<0.5	<0.5	--	--	<0.5	7.7	0.6	0.6
08/09/90	3.3	7.7	<0.5	<0.5	<0.5	--	--	<0.5	8.4	<0.5	1.8
11/13/90	0.6	3.0	<0.5	<0.5	--	<0.5	<0.5	<0.5	4.0	<0.5	<0.5
05/15/91	2.0	2.0	<0.5	<0.5	--	<0.5	<0.5	<0.5	3.0	<0.5	<0.5
08/27/91	0.7	2.8	<0.5	<0.5	--	--	<0.5	<0.5	2.7	<0.5	<0.5
11/15/91	0.8	2.7	<0.5	<0.5	--	<0.5	<0.5	<0.5	3.1	<0.5	0.8
02/20/92	2.2	1.9	<0.5	<0.5	--	<0.5	<0.5	<0.5	3.3	<0.5	<0.5
06/15/92	1.1	1.8	<0.5	<0.5	--	<0.5	<0.5	<0.5	4.5	<0.5	<0.5
MW-8											
04/24/89	2.0	3.0	6.0	<1.0	4.0	--	--	<1.0	<1.0	--	--
04/24/89	2.0	2.0	6.0	<1.0	3.0	--	--	<1.0	<1.0	--	--
07/28/89	2.3	2.0	5.6	<0.2	--	<0.2	3.8	<0.2	<0.2	--	--
10/30/89	2.5	2.6	8.0	<0.5	5.5	--	--	<0.5	<0.5	--	--
01/09/90	4.9	3.9	19	0.9	6.6	--	--	<0.5	<0.5	--	--
04/18/90	3.8	2.8	17	0.6	5.7	--	--	<0.5	<0.5	<0.5	<0.5
08/09/90	5.3	4.4	27	1.2	9.2	--	--	<0.5	<0.5	<0.5	<0.5
11/13/90	3.0	2.0	21	0.7	--	<0.5	6.0	<0.5	<0.5	<0.5	<0.5
05/15/91	2.0	2.0	30	0.9	--	<0.5	6.0	<0.5	<0.5	<0.5	<0.5
08/27/91	1.4	1.1	32	1.0	--	--	4.7	<0.5	<0.5	<0.5	<0.5
11/15/91	1.5	1.9	50	<0.5	--	<0.5	5.8	<0.5	<0.5	2.0	<0.5
02/20/92	1.3	2.3	68	2.4	--	<0.5	7.6	<0.5	<0.5	<0.5	<0.5
06/15/92	0.7	1.9	46	1.6	--	<0.5	5.6	<0.5	--	<0.5	<0.5

Cumulative Table of Well Data and Analytical Results

Vertical Measurements are in feet.

Analytical values are in parts per billion (ppb)

DATE	Carbon Tet	Chloro-form	PCE	TCE	1, 2,-DCE	t-1, 2-DCE	c-1, 2-DCE	1, 1, 1-TCA	1,2-DCA	1, 2-DCP	MC
MW-9											
06/22/90	<0.5	<0.5	<0.5	<0.5	--	<0.5	--	<0.5	<0.5	<0.5	<0.5
08/09/90	<0.5	<0.5	<0.5	<0.5	<0.5	--	--	<0.5	0.71	<0.5	<0.5
11/13/90	<0.5	<0.5	<0.5	<0.5	--	<0.5	<0.5	<0.5	1.0	<0.5	<0.5
05/15/91	<0.5	<0.5	<0.5	<0.5	--	<0.5	<0.5	<0.5	0.5	<0.5	<0.5
08/27/91	<0.5	<0.5	<0.5	<0.5	--	--	<0.5	<0.5	<0.5	<0.5	<0.5
11/15/91	<0.5	<0.5	<0.5	<0.5	--	<0.5	<0.5	<0.5	0.6	<0.5	<0.5
02/20/92	<0.5	<0.5	<0.5	<0.5	--	<0.5	<0.5	<0.5	<0.5	<0.5	<0.5
06/15/92	<0.5	<0.5	<0.5	<0.5	--	<0.5	<0.5	<0.5	<0.5	<0.5	<0.5
MW-10											
06/22/90	9.6	8.9	<0.5	<0.5	--	<0.5	--	<0.5	<0.5	<0.5	<0.5
08/09/90	11	7.8	<0.5	<0.5	<0.5	--	--	<0.5	<0.5	<0.5	<0.5
11/13/90	5.0	4.0	<0.5	<0.5	--	<0.5	<0.5	<0.5	<0.5	<0.5	<0.5
05/15/91	5.0	4.0	<0.5	<0.5	--	<0.5	<0.5	<0.5	<0.5	<0.5	<0.5
08/27/91	6.9	3.4	<0.5	<0.5	--	--	<0.5	<0.5	<0.5	<0.5	<0.5
11/15/91	2.7	3.3	<0.5	<0.5	--	<0.5	<0.5	<0.5	<0.5	<0.5	<0.5
02/20/92	3.3	3.4	3.0	<0.5	--	<0.5	<0.5	<0.5	<0.5	<0.5	<0.5
06/15/92	4.5	2.9	<0.5	<0.5	--	<0.5	<0.5	<0.5	<0.5	<0.5	<0.5
MW-11											
06/22/90	4.6	6.5	73	1.3	--	<0.5	8.9	<0.5	<0.5	<0.5	<0.5
08/09/90	8.1	6.8	84	2.0	4.6	--	--	<0.5	<0.5	<0.5	<0.5
11/13/90	<0.5	<0.5	39	<0.5	--	<0.5	2.0	5	<0.5	<0.5	<0.5
05/15/91	1.0	3.0	7	0.5	--	<0.5	2.0	<0.5	<0.5	<0.5	<0.5
08/27/91	4.1	3.3	73	1.0	--	--	2.4	<0.5	<0.5	<0.5	<0.5
11/15/91	3.3	3.6	64	0.9	--	<0.5	2.3	<0.5	<0.5	<0.5	<0.5
02/20/92	<2.5	<2.5	62	<2.5	--	<2.5	<2.5	<2.5	<2.5	<2.5	<2.5
06/15/92	--	---	---	--	--	--	--	--	--	--	--

Cumulative Table of Well Data and Analytical Results

Vertical Measurements are in feet.

Analytical values are in parts per billion (ppb)

DATE	Carbon Tet	Chloro-form	PCE	TCE	1, 2,-DCE	t-1, 2-DCE	c-1, 2-DCE	1, 1, 1-TCA	1,2-DCA	1, 2-DCP	MC
MW-12											
06/22/90	6.0	7.3	7.4	<0.5	--	<0.5	13	<0.5	<0.5	<0.5	<0.5
08/09/90	8.0	7.0	6.7	<0.5	5.8	--	--	<0.5	<0.5	<0.5	<0.5
11/13/90	<0.5	<0.5	9.0	<0.5	--	<0.5	3.0	3.0	<0.5	<0.5	<0.5
05/15/91	4.0	4.0	10	<0.5	--	<0.5	3.0	<0.5	<0.5	<0.5	<0.5
08/27/91	3.1	2.6	10	<0.5	--	--	2.3	<0.5	<0.5	<0.5	<0.5
11/15/91	1.9	3.5	8.9	<0.5	--	<0.5	5.9	<0.5	<0.5	<0.5	<0.5
02/20/92	3.3	3.4	3.7	<0.5	--	<0.5	<0.5	<0.5	<0.5	<0.5	<0.5
06/15/92	2.2	3.7	13	<0.5	--	<0.5	4.5	<0.5	<0.5	<0.5	<0.5
MW-13											
11/15/91	<0.5	<0.5	<0.5	--	<0.5	<0.5	<0.5	<0.5	<0.5	<0.5	<0.5
02/20/92	<0.5	<0.5	<0.5	--	<0.5	<0.5	<0.5	<0.5	<0.5	<0.5	<0.5
06/15/92	<0.5	<0.5	<0.5	--	--	<0.5	<0.5	<0.5	<0.5	<0.5	<0.5
MW-14											
11/15/91	<0.5	5.5	33	<0.5	--	<0.5	<0.5	<0.5	<0.5	<0.5	<0.5
02/20/92	<0.5	4.3	38	<0.5	--	<0.5	<0.5	<0.5	<0.5	<0.5	<0.5
06/15/92	--	---	---	--	--	--	--	--	--	--	--

Cumulative Table of Well Data and Analytical Results

Vertical Measurements are in feet.

Analytical values are in parts per billion (ppb)

DATE	Carbon Tet	Chloro-form	PCE	TCE	1, 2,-DCE	t-1, 2-DCE	c-1, 2-DCE	1, 1, 1-TCA	1,2-DCA	1, 2-DCP	MC
TRIP BLANK											
11/03/88	<1.0	<1.0	<1.0	<1.0	--	<1.0	--	<1.0	<1.0	--	--
02/10/89	<0.1	<0.5	<0.1	<0.1	--	<0.1	<0.1	<0.1	<0.1	--	--
04/24/89	<1.0	<1.0	<1.0	<1.0	<1.0	--	--	<1.0	<1.0	--	--
07/28/89	<0.1	<0.5	<0.1	<0.5	<0.1	--	<0.1	<0.1	<0.1	--	--
10/30/89	<0.5	<0.5	<0.5	<0.5	<0.5	--	--	<0.5	<0.5	--	--
01/09/90	<0.5	<0.5	<0.5	<0.5	<0.5	--	--	<0.5	<0.5	--	--
04/18/90	<0.5	<0.5	<0.5	<0.5	<0.5	--	--	<0.5	<0.5	<0.5	<0.5
06/22/90	<0.5	<0.5	<0.5	<0.5	--	<0.5	--	<0.5	<0.5	<0.5	<0.5
08/09/90	<0.5	<0.5	<0.5	<0.5	<0.5	--	--	<0.5	<0.5	<0.5	<0.5
11/13/90	<0.5	0.5	<0.5	<0.5	--	<0.5	<0.5	<0.5	<0.5	<0.5	<0.5
05/15/91	--	--	--	--	--	--	--	--	--	--	--
08/27/91	--	--	--	--	--	--	--	--	--	--	--
11/15/91	<0.5	<0.5	<0.5	<0.5	--	<0.5	<0.5	<0.5	<0.5	<0.5	--
02/20/92	<0.5	<0.5	<0.5	<0.5	--	<0.5	<0.5	<0.5	<0.5	<0.5	--
06/15/92	<0.5	<0.5	<0.5	<0.5	--	<0.5	<0.5	<0.5	<0.5	<0.5	<0.5

Cumulative Table of Well Data and Analytical Results

TABLE 2 OF ADDITIONAL ANALYSES

Vertical Measurements are in feet.

Analytical values are in parts per billion (ppb)

DATE	2-butanone	Acetone	1, 1-DCE	1, 1-DCA	Chloro-benzene	Freon 11
MW-3 08/27/91	--	--	1.3	0.5	0.7	1.4
MW-7 04/24/89	160	5.0	--	--	--	--
MW-13 11/15/91	--	--	--	0.6	--	--

Note: Blaine Tech Services, Inc. began routine monitoring of the groundwater wells at this site on November 1, 1994.
Earlier field data and analytical results are drawn from the September 27, 1994 Groundwater Technology, Inc. report.

ABBREVIATIONS:

TPH = Total Petroleum Hydrocarbons
 TOG = Total Oil and Grease
 Carbon Tet = Carbon Tetrachloride
 PCE = Tetrachloroethene
 TCE = Trichloroethene
 1,2-DCE = 1,2-Dichloroethene
 t-1,2-DCE = trans-1,2-Dichloroethene
 c-1,2-DCE = cis-1,2-Dichloroethene
 1,1,1-TCA = 1,1,1-Trichloroethane
 1,2-DCA = 1,2-Dichloroethane
 1,2-DCP = 1,2-Dichloropropane
 1,1-DCE = 1,1-Dichloroethene
 MC = Methylene chloride

Analytical Appendix



Blaine Technical Services 985 Timothy Drive San Jose, CA 95133	Client Proj. ID: Chevron 9-0020/950928-D1 Sample Descript: MW-7 Matrix: LIQUID Analysis Method: 8015Mod/8020 Lab Number: 9509J79-01	Sampled: 09/28/95 Received: 09/29/95 Analyzed: 10/04/95 Reported: 10/09/95
Attention: Jim Keller		

QC Batch Number: GC100495BTEX22A
Instrument ID: GCHP22

Total Purgeable Petroleum Hydrocarbons (TPPH) with BTEX

Analyte	Detection Limit ug/L	Sample Results ug/L
TPPH as Gas	250	1500
Benzene	2.5	84
Toluene	2.5	24
Ethyl Benzene	2.5	26
Xylenes (Total)	2.5	130
Chromatogram Pattern:		Gas
Surrogates	Control Limits %	% Recovery
Trifluorotoluene	70 130	96

Analytes reported as N.D. were not present above the stated limit of detection.

SEQUOIA ANALYTICAL - ELAP #1210

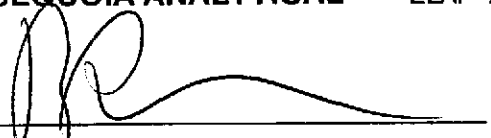
Peggy Penner
Project Manager





Blaine Technical Services
985 Timothy Drive
San Jose, CA 95133

Client Proj. ID: Chevron 9-0020/950928-D1
Sample Descript: MW-9
Matrix: LIQUID
Analysis Method: 8015Mod/8020
Lab Number: 9509J79-02

Sampled: 09/28/95
Received: 09/29/95
Analyzed: 10/03/95
Reported: 10/09/95

Attention: Jim Keller

QC Batch Number: GC100395BTEX07A
Instrument ID: GCHP07

Total Purgeable Petroleum Hydrocarbons (TPPH) with BTEX

Analyte	Detection Limit ug/L	Sample Results ug/L
TPPH as Gas	1000	4000
Benzene	10	32
Toluene	10	N.D.
Ethyl Benzene	10	36
Xylenes (Total)	10	44
Chromatogram Pattern:		Gas
Surrogates	Control Limits %	% Recovery
Trifluorotoluene	70 130	93

Analytes reported as N.D. were not present above the stated limit of detection.

SEQUOIA ANALYTICAL - ELAP #1210

Peggy Penner
Project Manager





Blaine Technical Services
985 Timothy Drive
San Jose, CA 95133

Attention: Jim Keller

Client Proj. ID: Chevron 9-0020/950928-D1
Sample Descript: MW-13
Matrix: LIQUID
Analysis Method: 8015Mod/8020
Lab Number: 9509J79-03

Sampled: 09/28/95
Received: 09/29/95

Analyzed: 10/03/95
Reported: 10/09/95

QC Batch Number: GC100395BTEX22A
Instrument ID: GCHP22

Total Purgeable Petroleum Hydrocarbons (TPPH) with BTEX

Analyte	Detection Limit ug/L	Sample Results ug/L
TPPH as Gas	50	160
Benzene	0.50	3.2
Toluene	0.50	N.D.
Ethyl Benzene	0.50	0.97
Xylenes (Total)	0.50	2.2
Chromatogram Pattern:		Gas

Surrogates	Control Limits %	% Recovery
Trifluorotoluene	70 130	90

Analytes reported as N.D. were not present above the stated limit of detection.

SEQUOIA ANALYTICAL - ELAP #1210

Peggy Penner
Project Manager





Blaine Technical Services
985 Timothy Drive
San Jose, CA 95133

Attention: Jim Keller

Client Proj. ID: Chevron 9-0020/950928-D1
Sample Descript: MW-15
Matrix: LIQUID
Analysis Method: 8015Mod/8020
Lab Number: 9509J79-04

Sampled: 09/28/95
Received: 09/29/95

Analyzed: 10/03/95
Reported: 10/09/95

QC Batch Number: GC100395BTEX22A
Instrument ID: GCHP22

Total Purgeable Petroleum Hydrocarbons (TPPH) with BTEX

Analyte	Detection Limit ug/L	Sample Results ug/L
TPPH as Gas	50	N.D.
Benzene	0.50	0.82
Toluene	0.50	N.D.
Ethyl Benzene	0.50	N.D.
Xylenes (Total)	0.50	N.D.
Chromatogram Pattern:		
Surrogates	Control Limits %	% Recovery
Trifluorotoluene	70 130	103

Analytes reported as N.D. were not present above the stated limit of detection.

SEQUOIA ANALYTICAL - ELAP #1210

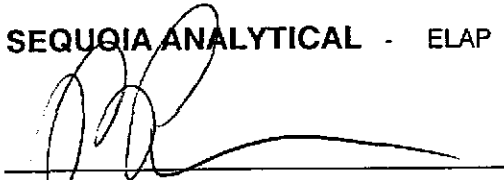
Peggy Penner
Project Manager





Blaine Technical Services 985 Timothy Drive San Jose, CA 95133 Attention: Jim Keller	Client Proj. ID: Chevron 9-0020/950928-D1 Sample Descript: TB Matrix: LIQUID Analysis Method: 8015Mod/8020 Lab Number: 9509J79-05	Sampled: 09/28/95 Received: 09/29/95 Analyzed: 10/03/95 Reported: 10/09/95
---	---	---

QC Batch Number: GC100395BTEX22A
Instrument ID: GCHP22

Total Purgeable Petroleum Hydrocarbons (TPPH) with BTEX

Analyte	Detection Limit ug/L	Sample Results ug/L
TPPH as Gas	50	N.D.
Benzene	0.50	N.D.
Toluene	0.50	N.D.
Ethyl Benzene	0.50	N.D.
Xylenes (Total)	0.50	N.D.
Chromatogram Pattern:		
Surrogates	Control Limits %	% Recovery
Trifluorotoluene	70 130	97

Analytes reported as N.D. were not present above the stated limit of detection.

SEQUOIA ANALYTICAL - ELAP #1210

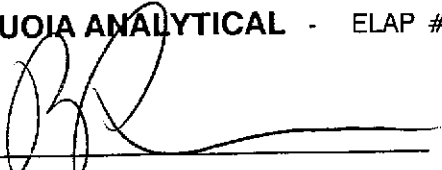
Peggy Penner
Project Manager





**Sequoia
Analytical**

680 Chesapeake Drive
404 N. Wiget Lane
819 Striker Avenue, Suite 8

Redwood City, CA 94063
Walnut Creek, CA 94598
Sacramento, CA 95834

(415) 364-9600
(510) 988-9600
(916) 921-9600

FAX (415) 364-9233
FAX (510) 988-9673
FAX (916) 921-0100

Blaine Technical Services
985 Timothy Drive
San Jose, CA 95133
Attention: Jim Keller

Client Proj. ID: Chevron 9-0020/950928-D1

Lab Proj. ID: 9509J79

Received: 09/29/95

Reported: 10/09/95

LABORATORY NARRATIVE

TPPH Note: Sample 9509J79-01 was diluted 5-fold.
Sample 9509J79-02 was diluted 20-fold.

SEQUOIA ANALYTICAL

Peggy Penner
Project Manager





Blaine Tech Services, Inc. Client Project ID: Chevron 9-0020/950928-D1
985 Timothy Drive Matrix: Liquid
San Jose, CA 95133
Attention: Jim Keller Work Order #: 9509J79 -01, 03-05 Reported: Oct 11, 1995

QUALITY CONTROL DATA REPORT

Analyte:	Benzene	Toluene	Ethyl Benzene	Xylenes
QC Batch#:	GC100395BTEX22A	GC100395BTEX22A	GC100395BTEX22A	GC100395BTEX22A
Analy. Method:	EPA 8020	EPA 8020	EPA 8020	EPA 8020
Prep. Method:	EPA 5030	EPA 5030	EPA 5030	EPA 5030

Analyst:	R. Lee	R. Lee	R. Lee	R. Lee
MS/MSD #:	9509J7702	9509J7702	9509J7702	9509J7702
Sample Conc.:	N.D.	N.D.	N.D.	N.D.
Prepared Date:	10/3/95	10/3/95	10/3/95	10/3/95
Analyzed Date:	10/3/95	10/3/95	10/3/95	10/3/95
Instrument I.D.#:	GCHP22	GCHP22	GCHP22	GCHP22
Conc. Spiked:	10 µg/L	10 µg/L	10 µg/L	30 µg/L
Result:	9.1	9.0	9.3	27
MS % Recovery:	91	90	93	90
Dup. Result:	8.7	8.6	8.9	25
MSD % Recov.:	87	86	89	83
RPD:	4.5	4.5	4.4	7.7
RPD Limit:	0-50	0-50	0-50	0-50

LCS #:	-	-	-	-
Prepared Date:	-	-	-	-
Analyzed Date:	-	-	-	-
Instrument I.D.#:	-	-	-	-
Conc. Spiked:	-	-	-	-
LCS Result:	-	-	-	-
LCS % Recov.:	-	-	-	-

MS/MSD	71-133	72-128	72-130	71-120
LCS				
Control Limits				

SEQUOIA ANALYTICAL

Peggy Penner
Project Manager

Please Note:

The LCS is a control sample of known, interferent-free matrix that is analyzed using the same reagents, preparation, and analytical methods employed for the samples. The matrix spike is an aliquot of sample fortified with known quantities of specific compounds and subjected to the entire analytical procedure. If the recovery of analytes from the matrix spike does not fall within specified control limits due to matrix interference, the LCS recovery is to be used to validate the batch.

** MS= Matrix Spike, MSD=MS Duplicate, RPD=Relative % Difference

9509J79.BLA <1>





Blaine Tech Services, Inc.
985 Timothy Drive
San Jose, CA 95133
Attention: Jim Keller

Client Project ID: Chevron 9-0020/950928-D1
Matrix: Liquid

Work Order #: 9509J79-02

Reported: Oct 11, 1995

QUALITY CONTROL DATA REPORT

Analyte:	Benzene	Toluene	Ethyl Benzene	Xylenes
QC Batch#:	GC100395BTEX07A	GC100395BTEX07A	GC100395BTEX07A	GC100395BTEX07A
Analy. Method:	EPA 8020	EPA 8020	EPA 8020	EPA 8020
Prep. Method:	EPA 5030	EPA 5030	EPA 5030	EPA 5030

Analyst:	R. Geckler	R. Geckler	R. Geckler	R. Geckler
MS/MSD #:	9509J7602	9509J7602	9509J7602	9509J7602
Sample Conc.:	N.D.	N.D.	N.D.	N.D.
Prepared Date:	10/3/95	10/3/95	10/3/95	10/3/95
Analyzed Date:	10/3/95	10/3/95	10/3/95	10/3/95
Instrument I.D.#:	GCHP7	GCHP7	GCHP7	GCHP7
Conc. Spiked:	10 µg/L	10 µg/L	10 µg/L	30 µg/L
Result:	10	10	10	30
MS % Recovery:	100	100	100	100
Dup. Result:	9.6	9.5	9.5	29
MSD % Recov.:	96	95	95	97
RPD:	4.1	5.1	5.1	3.4
RPD Limit:	0-50	0-50	0-50	0-50

LCS #:	-	-	-	-
Prepared Date:	-	-	-	-
Analyzed Date:	-	-	-	-
Instrument I.D.#:	-	-	-	-
Conc. Spiked:	-	-	-	-
LCS Result:	-	-	-	-
LCS % Recov.:	-	-	-	-

MS/MSD				
LCS	71-133	72-128	72-130	71-120
Control Limits				

Please Note:

The LCS is a control sample of known, interferent-free matrix that is analyzed using the same reagents, preparation, and analytical methods employed for the samples. The matrix spike is an aliquot of sample fortified with known quantities of specific compounds and subjected to the entire analytical procedure. If the recovery of analytes from the matrix spike does not fall within specified control limits due to matrix interference, the LCS recovery is to be used to validate the batch.

SEQUOIA ANALYTICAL

Peggy Penner
Peggy Penner
Project Manager

** MS= Matrix Spike, MSD=MS Duplicate, RPD=Relative % Difference

9509J79.BLA <2>



Field Data Sheets

CHEVRON WELL MONITORING DATA SHEET

Project #: <u>950928-D1</u>	Station #: <u>9-0020</u>
Sampler: <u>MD</u>	Start Date: <u>9-28-95</u>
Well I.D.: <u>MW-7</u>	Well Diameter: (circle one) 2 3 <u>4</u> 6
Total Well Depth: Before <u>26.37</u> After	Depth to Water: Before <u>19.84</u> After
Depth to Free Product:	Thickness of Free Product (feet):
Measurements referenced to: <u>PVC</u>	Grade Other:

Well Diameter	VCF	Well Diameter	VCF
1"	0.04	6"	1.47
2"	0.16	8"	2.61
3"	0.37	10"	4.08
4"	0.65	12"	5.87
5"	1.02	16"	10.43

<u>4.5</u>	x	<u>3</u>	=	<u>13.7</u>
1 Case Volume		Specified Volumes		gallons

Purging: Bailer Disposable Bailer Middleburg Electric Submersible <input checked="" type="checkbox"/> Extraction Pump Other _____	Sampling: Bailer Disposable Bailer <input checked="" type="checkbox"/> Extraction Port Other _____
--	---

TIME	TEMP. (F)	pH	COND.	TURBIDITY:	VOLUME REMOVED:	OBSERVATIONS:
<u>1445</u>	<u>60.2</u>	<u>7.8</u>	<u>800</u>	<u>—</u>	<u>4</u>	<u>ODOR</u>
<u>1446</u>	<u>59.6</u>	<u>7.5</u>	<u>680</u>	<u>—</u>	<u>9</u>	
<u>1447</u>	<u>59.2</u>	<u>7.4</u>	<u>700</u>	<u>—</u>	<u>14</u>	

Did Well Dewater? N If yes, gals. Gallons Actually Evacuated: 14.0

Sampling Time: 1455 Sampling Date: 9-28-95

Sample I.D.: MW-7 Laboratory: SEQ

Analyzed for: (Circle) TPH-G BTEX TPH-D OTHER:

Duplicate I.D.: Cleaning Blank I.D.:

Analyzed for: (Circle) TPH-G BTEX TPH-D OTHER:

CHEVRON WELL MONITORING DATA SHEET

Project #: <u>950928-D1</u>	Station #: <u>9-8020</u>
Sampler: <u>MD</u>	Start Date: <u>9-28-95</u>
Well I.D.: <u>MW-9</u>	Well Diameter: (circle one) <u>(2)</u> 3 4 6
Total Well Depth: Before <u>23.59</u> After	Depth to Water: Before <u>19.55</u> After
Depth to Free Product:	Thickness of Free Product (feet):
Measurements referenced to: <u>PVC</u>	Grade Other:

Well Diameter	VCF	Well Diameter	VCF
1"	0.04	6"	1.47
2"	0.16	8"	2.61
3"	0.37	10"	4.08
4"	0.65	12"	5.87
5"	1.02	16"	10.43

<u>.6</u>	\times	<u>3</u>	$=$	<u>1.9</u>	gallons
1 Case Volume Specified Volumes =					

Purging: Bailer Disposable Bailer <input checked="" type="checkbox"/> Middleburg Electric Submersible Extraction Pump Other _____	Sampling: Bailer Disposable Bailer <input checked="" type="checkbox"/> Extraction Port Other _____
--	---

TIME	TEMP. (F)	pH	COND.	TURBIDITY:	VOLUME REMOVED:	OBSERVATIONS:
<u>1420</u>	<u>61.0</u>	<u>7.7</u>	<u>820</u>	<u>—</u>	<u>.75</u>	<u>ODOR</u>
<u>1422</u>	<u>59.6</u>	<u>7.6</u>	<u>800</u>	<u>—</u>	<u>1.25</u>	
<u>1424</u>	<u>59.4</u>	<u>7.4</u>	<u>750</u>	<u>—</u>	<u>2.0</u>	

Did Well Dewater? N If yes, gals. Gallons Actually Evacuated: 2.0

Sampling Time: 1430 Sampling Date: 9-28-95

Sample I.D.: MW-9 Laboratory: GEQ

Analyzed for: TPH-G BTEX TPH-D OTHER:

Duplicate I.D.: Cleaning Blank I.D.:

Analyzed for: TPH-G BTEX TPH-D OTHER:
(Circle)

CHEVRON WELL MONITORING DATA SHEET

Project #: <u>950928-D1</u>	Station #: <u>9-0020</u>
Sampler: <u>MD</u>	Start Date: <u>9-28-95</u>
Well I.D.: <u>MW-13</u>	Well Diameter: (circle one) <u>2</u> 3 4 6
Total Well Depth: Before <u>27.54</u> After	Depth to Water: Before <u>20.04</u> After
Depth to Free Product:	Thickness of Free Product (feet):
Measurements referenced to: <u>PVC</u>	Grade Other:

Well Diameter	VCF	Well Diameter	VCF
1"	0.04	6"	1.47
2"	0.16	8"	2.61
3"	0.37	10"	4.08
4"	0.65	12"	5.87
5"	1.02	16"	10.43

<u>1.2</u>	\times	<u>3</u>	$=$	<u>3.6</u>	gallons
1 Case Volume		Specified Volumes			

Purging: Bailer Disposable Bailer <input checked="" type="checkbox"/> Middleburg Electric Submersible Extraction Pump Other _____	Sampling: Bailer Disposable Bailer <input checked="" type="checkbox"/> Extraction Port Other _____
--	---

TIME	TEMP. (F)	pH	COND.	TURBIDITY:	VOLUME REMOVED:	OBSERVATIONS:
<u>11:00</u>	<u>64.4</u>	<u>7.8</u>	<u>960</u>	<u>—</u>	<u>1</u>	<u>Slight odor</u>
<u>11:02</u>	<u>59.8</u>	<u>7.6</u>	<u>960</u>	<u>—</u>	<u>2.5</u>	
<u>11:04</u>	<u>59.2</u>	<u>7.4</u>	<u>950</u>	<u>—</u>	<u>4.0</u>	

Did Well Dewater? N If yes, gals. Gallons Actually Evacuated: 4.0

Sampling Time: 11:10 Sampling Date: 9-28-95

Sample I.D.: MW-13 Laboratory: SEQ

Analyzed for: TPH-G BTEX TPH-D OTHER:

Duplicate I.D.: Cleaning Blank I.D.:

Analyzed for: TPH-G BTEX TPH-D OTHER:
(Circle)

CHEVRON WELL MONITORING DATA SHEET

Project #: <u>950928-D1</u>	Station #: <u>9-0020</u>
Sampler: <u>MD</u>	Start Date: <u>9-28-95</u>
Well I.D.: <u>MW-15</u>	Well Diameter: (circle one) <u>2</u> 3 4 6
Total Well Depth: Before <u>26-20</u> After	Depth to Water: Before <u>19.66</u> After
Depth to Free Product:	Thickness of Free Product (feet):
Measurements referenced to: <u>PVC</u>	Grade Other:

Well Diameter	VCF	Well Diameter	VCF
1"	0.04	6"	1.47
2"	0.16	8"	2.61
3"	0.37	10"	4.08
4"	0.65	12"	5.87
5"	1.02	16"	10.43

<u>1.0</u>	\times	<u>3</u>	$=$	<u>3.0</u>	gallons
1 Case Volume		Specified Volumes			

Purging: Bailer
 Disposable Bailer
 Middleburg
 Electric Submersible
 Extraction Pump
 Other _____

Sampling: Bailer
 Disposable Bailer
 Extraction Port
 Other _____

TIME	TEMP. (F)	pH	COND.	TURBIDITY:	VOLUME REMOVED:	OBSERVATIONS:
<u>1350</u>	<u>60.2</u>	<u>7.8</u>	<u>600</u>	<u>—</u>	<u>1</u>	
<u>1352</u>	<u>59.2</u>	<u>7.7</u>	<u>540</u>	<u>—</u>	<u>2</u>	
<u>1354</u>	<u>59.2</u>	<u>7.6</u>	<u>520</u>	<u>—</u>	<u>3</u>	

Did Well Dewater? N If yes, gals. Gallons Actually Evacuated: 3.0

Sampling Time: 1400 Sampling Date: 9-28-95

Sample I.D.: MW-15 Laboratory: SEQ

Analyzed for: TPH-G BTEX TPH-D OTHER:

Duplicate I.D.: Cleaning Blank I.D.:

Analyzed for: TPH-G BTEX TPH-D OTHER:
 (Circle)

CHEVRON WELL MONITORING DATA SHEET

Project #: <u>950928-D1</u>	Station #: <u>9-0070</u>
Sampler: <u>BD</u>	Start Date: _____
Well I.D.: <u>MW-16</u>	Well Diameter: (circle one) 2 3 4 6 _____
Total Well Depth: Before _____ After _____	Depth to Water: Before _____ After _____
Depth to Free Product: _____	Thickness of Free Product (feet): _____
Measurements referenced to:	PVC Grade Other: _____

Well Diameter	VCF	Well Diameter	VCF
1"	0.04	6"	1.47
2"	0.16	8"	2.61
3"	0.37	10"	4.08
4"	0.65	12"	5.87
5"	1.02	16"	10.43

_____	X	_____	=	_____ gallons
1 Case Volume		Specified Volumes		

Purging: Bailer Disposable Bailer Middleburg Electric Submersible Extraction Pump Other _____	Sampling: Bailer Disposable Bailer Extraction Port Other _____
--	---

TIME	TEMP. (F)	pH	COND.	TURBIDITY:	VOLUME REMOVED:	OBSERVATIONS:
INACCESSIBLE CAR PARKED OVER WELL						

Did Well Dewater? _____	If yes, gals. _____	Gallons Actually Evacuated: _____
Sampling Time: _____	Sampling Date: _____	
Sample I.D.: _____	Laboratory: _____	
Analyzed for: TPH-G BTEX TPH-D OTHER:		
(Circle)		
Duplicate I.D.: _____	Cleaning Blank I.D.: _____	
Analyzed for: TPH-G BTEX TPH-D OTHER:		
(Circle)		