



Chevron

April 13, 1994

Ms. Jennifer Eberle
Alameda County Health Care Services
Department of Environmental Health
80 Swan Way, Room 200
Oakland, CA 94621

Chevron U.S.A. Products Company
2410 Camino Ramon
San Ramon, CA 94583
P.O. Box 5004
San Ramon, CA 94583-0804

Marketing Department
Phone 510 842 9500

**Re: Former Chevron Service Station #9-0020
1633 Harrison Street, Oakland, CA**

Dear Ms. Eberle:

Enclosed is the Groundwater Monitoring and Sampling Activities report dated January 28, 1994, prepared by our consultant Groundwater Technology, Inc. for the above referenced site. As indicated in the report, ground water samples collected were analyzed for total petroleum hydrocarbons as gasoline (TPH-G), and BTEX. Monitor well MW-16 was not accessible during this monitoring event due to a vehicle parked over the well. Monitor well MW-7 could not be sampled due to remediation equipment in the well. Per prior agreement between Chevron and Alameda County Health Care Services, monitor wells MW-5, MW-6, MW-8, MW-12, and MW-14 were not sampled.

Benzene was detected in monitor wells MW-9 and MW-13 at concentrations of 92 and 43 ppb, respectively. Depth to ground water was measured at approximately 20 feet below grade and the direction of flow is to the northeast.

We are currently evaluating the feasibility and cost-effectiveness of continued operation of the dewatering and soil vapor extraction remedial systems. Chevron will continue to monitor and sample this site on a quarterly basis. If you have any questions or comments, please do not hesitate to contact me at (510) 842-8134.

Sincerely,
CHEVRON U.S.A. PRODUCTS COMPANY

Mark A. Miller
Site Assessment and Remediation Engineer

Enclosure

cc: Mr. Rich Hiatt, RWQCB - Bay Area
Ms. B.C. Owen

The Oakland Housing Authority
Attn: Mr. Harold Davis
1619 Harrison Street
Oakland, CA 94612

File: 9-0020 QM2

54 APR 15 PM 2:15
ALCO
HAZMAT

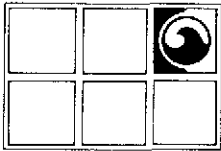

GROUNDWATER TECHNOLOGY, INC.

4057 Port Chicago Highway, Concord, CA 94520 (415) 671-2387

FAX: (415) 685-9148

January 28, 1994

Project No. 020104081

Mr. Mark Miller
Chevron U.S.A. Products Company
2410 Camino Ramon
San Ramon, CA 94583-0804

SUBJECT: *Groundwater Monitoring and Sampling Activities*
Chevron Service Station No. 9-0020
1633 Harrison Street, Oakland, California

Dear Mr. Miller:

Groundwater Technology, Inc. presents the attached quarterly groundwater monitoring and sampling data collected on December 17, 1993. Nine of the sixteen groundwater monitoring wells at this site were gauged to measure depth to groundwater (DTW) and to check for the presence of separate-phase hydrocarbons on December 17, 1993. Monitoring wells MW-5, MW-6, MW-8, MW-12, and MW-14 were not included in the monitoring and sampling programs as per the Alameda County Health Care Services Agency letter dated July 14, 1993. Separate-phase hydrocarbons were not detected in the monitoring wells. Monitoring well MW-7 was not gauged or sampled because of a pump in the well. Access to monitoring well MW-16 was blocked by a vehicle after gauging. A potentiometric surface map (Figure 1) and a summary of groundwater monitoring data collected (Table 1) are presented in Attachments 1 and 2, respectively. After the DTW was measured, monitoring wells MW-1, MW-2, MW-3, MW-4, MW-9, MW-10, MW-11, MW-13, and MW-15 were purged and sampled on December 17, 1993. Field data sheets are presented in Attachment 3. The groundwater samples collected were analyzed for benzene, toluene, ethylbenzene, and xylenes and for total petroleum hydrocarbons-as-gasoline. Results of the chemical analyses are summarized in Table 1. The laboratory report and chain-of-custody record are included in Attachment 4. Table 2 contains historical groundwater analytical results for halogenated volatile organics. Monitoring-well purge water was transported by Groundwater Technology to the Chevron Terminal in Richmond, California, for recycling.

Groundwater Technology is pleased to assist Chevron on this project. If you have any questions or comments, please contact our Concord office at (510) 671-2387.

Sincerely,
Groundwater Technology, Inc.
Written/Submitted by

Tim Watchers
Project Manager

Attachment 1 Figures
Attachment 2 Tables
Attachment 3 Field Data Sheets
Attachment 4 Laboratory Report

For:
Wendell W. Lattz
Vice President, General Manager
West Region

PR *mac*

4081R014.010

ATTACHMENT 1

Figure



LEGEND

- ◆ MONITORING WELL
- ★ EXTRACTION WELL
- () POTENTIOMETRIC SURFACE ELEVATION
- POTENTIOMETRIC SURFACE CONTOUR
- ← ESTIMATED GROUNDWATER FLOW DIRECTION
- (NA) NOT AVAILABLE
- SUSPENDED FROM THE MONITORING AND SAMPLING PROGRAM PER ACHCSA (7/14/93)

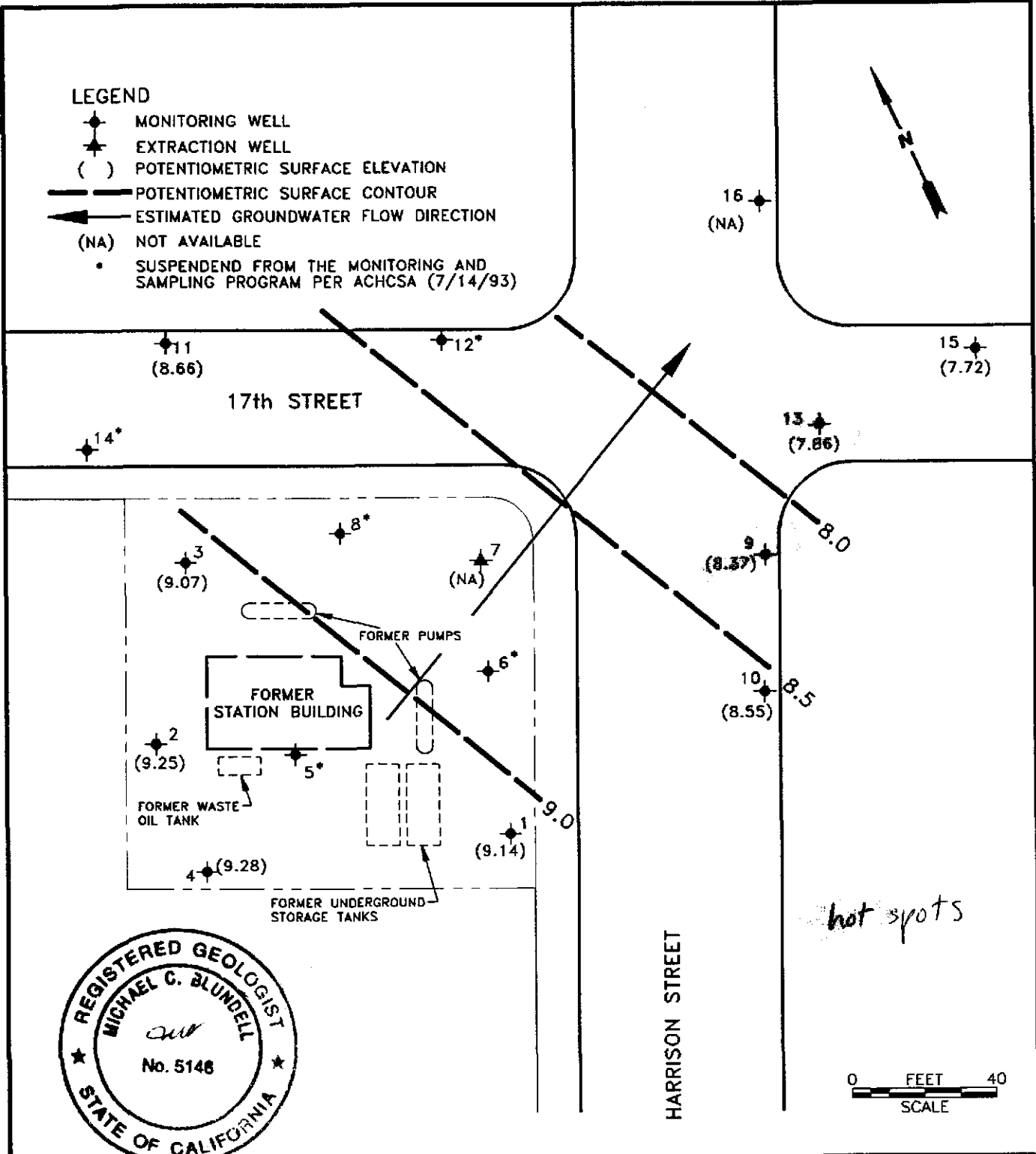

hot spots

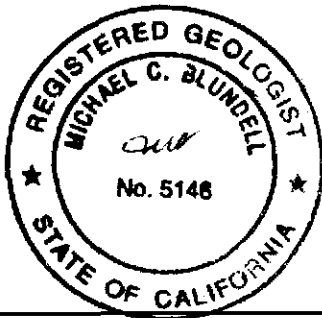

GROUNDWATER TECHNOLOGY

4057 PORT CHICAGO HWY.
CONCORD, CA 94520
(510) 671-2387

**POTENTIOMETRIC SURFACE MAP
(12/17/93)**

CLIENT: CHEVRON U.S.A. PRODUCTS CO. SERVICE STATION No. 9-0020		LOCATION: 1633 HARRISON STREET OAKLAND, CALIFORNIA		REV. NO.: 0	DATE: 1/19/94
PM <i>[Signature]</i>	PE/RG <i>[Signature]</i>	DESIGNED TW	DETAILED CY	ACAD FILE: PSM194	PROJECT NO.: 020204084
					FIGURE: 1

ATTACHMENT 2

Tables



TABLE 1
HISTORICAL GROUNDWATER ANALYTICAL RESULTS AND MONITORING DATA
Chevron Service Station No. 9-0020
1633 Harrison Street, Oakland, California

Well ID/ Elevation	Date	TPH-G	Benzene	Toluene	Ethyl- benzene	Xylenes	TOG	DTW (ft)	SPT (ft)	WTE (ft)
MW-1 29.82	11/03/88	<1,000 ¹	<1.0	<1.0	<1.0	<1.0	---	20.40	0.0	9.42
	02/02/89	---	---	---	---	---	---	20.71	0.0	9.11
	02/10/89	<100	<0.2	<0.2	<0.2	<0.4	---	---	---	---
	04/23/89	---	---	---	---	---	---	20.34	0.0	9.48
	04/24/89	<50	<0.5	<1.0	<1.0	<1.0	<3,000	---	---	---
	07/28/89	<50	<0.1	<0.5	<0.2	<0.5	<3,000	20.58	0.0	9.24
	10/30/89	<500	<0.3	<0.3	<0.3	<0.6	---	20.52	0.0	9.30
	01/09/90	<50	<0.3	<0.3	<0.3	<0.6	---	20.77	0.0	9.05
	04/18/90	<50	<0.3	<0.3	<0.3	<0.6	---	20.95	0.0	8.87
	06/22/90	---	---	---	---	---	---	21.00	0.0	8.82
	08/09/90	<50	<0.3	<0.3	<0.3	<0.6	---	20.94	0.0	8.88
	11/13/90	<50	<0.5	<0.5	<0.5	<0.5	---	20.98	0.0	8.84
	05/15/91	<50	<0.5	<0.5	<0.5	<0.5	---	20.64	0.0	9.18
	08/27/91	110 ²	<0.5	<0.5	<0.5	<0.5	---	20.79	0.0	9.03
29.82	11/15/91	<50	<0.5	<0.5	<0.5	<0.5	---	20.75	0.0	9.07
	02/20/92	<50	0.5	0.6	<0.5	0.9	---	20.90	0.0	8.92
	06/15/92	<50	<0.5	<0.5	<0.5	<0.5	---	20.64	0.0	9.18
	12/16/92	<50	<0.5	<0.5	<0.5	<0.5	---	20.84	0.0	8.98
	04/07/93	<50	<0.5	<0.5	<0.5	<1.5	---	19.91	0.0	9.91
	06/09/93	---	---	---	---	---	---	19.85	0.0	9.97
	09/10/93	---	---	---	---	---	---	---	---	---
	09/27/93	<50	<0.5	<0.5	<0.5	<0.5	---	20.35	0.0	9.47
12/17/93	<50	<0.5	<0.5	<0.5	<0.5	---	20.68	0.0	9.14	

TABLE 1
HISTORICAL GROUNDWATER ANALYTICAL RESULTS AND MONITORING DATA
Chevron Service Station No. 9-0020
1633 Harrison Street, Oakland, California

Well ID/ Elevation	Date	TPH-G	Benzene	Toluene	Ethyl- benzene	Xylenes	TOG	DTW (ft)	SPT (ft)	WTE (ft)
MW-2 30.59	11/03/88	<1,000 ¹	<1.0	<1.0	<1.0	<1.0	---	20.89	0.0	9.70
	02/02/89	---	---	---	---	---	---	21.21	0.0	9.38
	02/10/89	<100	<0.2	<0.2	<0.2	<0.4	---	---	---	---
	04/23/89	---	---	---	---	---	---	20.82	0.0	9.77
	04/24/89	<50	<0.5	<1.0	<1.0	<1.0	<3,000	---	---	---
	07/28/89	<100	<0.2	<1.0	<0.2	<0.4	<3,000	21.02	0.0	9.57
	10/30/89	<500	<0.3	<0.3	<0.3	<0.6	---	20.96	0.0	9.63
	01/09/90	<50	<0.3	<0.3	<0.3	<0.6	---	21.25	0.0	9.34
	04/18/90	<50	<0.3	<0.3	<0.3	<0.6	---	21.53	0.0	9.06
	06/22/92	---	---	---	---	---	---	21.57	0.0	9.02
	08/09/90	<50	<0.3	<0.3	<0.3	<0.6	---	21.55	0.0	9.04
	11/13/90	<50	<0.5	0.8	<0.5	0.9	---	21.54	0.0	9.05
	05/15/91	83 ²	<0.5	<0.5	<0.5	<0.5	---	21.15	0.0	9.44
30.56	08/27/91	97 ²	<0.5	<0.5	<0.5	<0.5	---	21.27	0.0	9.32
	11/15/91	<50	0.5	1.5	0.8	3.6	---	21.30	0.0	9.29
	02/20/92	<50	<0.5	<0.5	<0.5	<0.5	---	21.43	0.0	9.13
	06/15/92	<50	<0.5	<0.5	<0.5	<0.5	---	21.18	0.0	9.41
	12/16/92	<50	<0.5	<0.5	<0.5	<0.5	---	21.47	0.0	9.09
	04/07/93	66*	<0.5	<0.5	<0.5	<1.5	---	20.53	0.0	10.03
	06/09/93	<50	<0.5	<0.5	<0.5	<0.5	---	20.45	0.0	10.11
	09/10/93	---	---	---	---	---	---	---	---	---
	09/27/93	---	---	---	---	---	---	20.97	0.0	9.59
12/17/93	<50	<0.5	<0.5	<0.5	<0.5	---	21.31	0.0	9.25	

TABLE 1
HISTORICAL GROUNDWATER ANALYTICAL RESULTS AND MONITORING DATA
Chevron Service Station No. 9-0020
1633 Harrison Street, Oakland, California

Well ID/ Elevation	Date	TPH-G	Benzene	Toluene	Ethyl- benzene	Xylenes	TOG	DTW (ft)	SPT (ft)	WTE (ft)
MW-3 30.09	11/03/88	<1,000 ¹	<1.0	<1.0	<1.0	<1.0	---	20.54	0.0	9.55
	02/02/89	---	---	---	---	---	---	20.85	0.0	9.24
	02/10/89	<100	<0.2	<0.2	<0.2	<0.4	---	---	---	---
	04/23/89	---	---	---	---	---	---	20.43	0.0	9.66
	04/24/92	<50	<0.5	<1.0	<1.0	<1.0	<3,000	---	---	---
	07/28/89	<100	<0.2	<1.0	<0.2	<0.4	<3,000	20.64	0.0	9.45
	10/30/89	<500	<0.3	<0.3	<0.3	<0.6	---	20.61	0.0	9.48
	01/09/90	<50	<0.3	<0.3	<0.3	<0.6	---	20.88	0.0	9.21
	04/18/90	<50	<0.3	<0.3	<0.3	<0.6	---	21.15	0.0	8.94
	06/22/90	---	---	---	---	---	---	21.20	0.0	8.89
	08/09/90	<50	<0.3	<0.3	<0.3	<0.6	---	21.18	0.0	8.91
	11/13/90	5 ¹	<0.5	<0.5	<0.5	<0.5	---	21.15	0.0	8.94
	05/15/91	85 ²	<0.5	<0.5	<0.5	<0.5	---	20.91	0.0	9.18
30.08	08/27/91	9 ¹	<0.5	<0.5	<0.5	<0.5	---	20.89	0.0	9.20
	11/15/91	<50	<0.5	0.7	<0.5	1.3	---	21.02	0.0	9.07
	02/02/92	<50	<0.5	<0.5	<0.5	0.9	---	21.07	0.0	9.02
	06/15/92	50 ²	<0.5	<0.5	<0.5	<0.5	---	20.82	0.0	9.27
	12/16/92	<50	<0.5	<0.5	<0.5	<0.5	---	21.07	0.0	9.07
	04/07/93	<50	<0.5	<0.5	<0.5	<1.5	---	20.13	0.0	9.95
	06/09/93	<50	<0.5	<0.5	<0.5	<0.5	---	20.05	0.0	10.03
	09/10/93	<50	<0.5	<0.5	<0.5	<0.5	---	---	---	---
	09/27/93	---	---	---	---	---	---	20.58	0.0	9.50
	12/17/93	<50 ⁵	<0.5	<0.5	<0.5	<0.5	---	21.01	0.0	9.07

TABLE 1
HISTORICAL GROUNDWATER ANALYTICAL RESULTS AND MONITORING DATA
Chevron Service Station No. 9-0020
1633 Harrison Street, Oakland, California

Well ID/ Elevation	Date	TPH-G	Benzene	Toluene	Ethyl- benzene	Xylenes	TOG	DTW (ft)	SPT (ft)	WTE (ft)	
MW-4	04/23/89	---	---	---	---	---	---	21.33	0.0	9.84	
31.17	04/24/89	<50	<0.5	<1.0	<1.0	<1.0	<3,000	---	---	---	
	07/28/89	<50	<0.1	<0.5	<0.1	<0.2	<3,000	21.58	0.0	9.59	
	10/30/89	<500	<0.3	<0.3	<0.3	<0.6	---	21.54	0.0	9.63	
	01/09/90	<50	<0.3	<0.3	<0.3	<0.6	---	21.82	0.0	9.35	
	04/18/90	<50	<0.3	<0.3	<0.3	<0.6	---	22.09	0.0	9.08	
	06/22/90	---	---	---	---	---	---	22.12	0.0	9.05	
	08/09/90	<50	<0.3	<0.3	<0.3	<0.6	---	22.11	0.0	9.06	
	11/13/90	<50	<0.5	1	0.5	1	---	22.10	0.0	9.07	
	05/15/91	<50	<0.5	<0.5	<0.5	<0.5	---	21.71	0.0	9.46	
	08/27/91	<50	<0.5	<0.5	<0.5	<0.5	---	21.87	0.0	9.30	
	11/15/91	97	<0.5	0.9	<0.5	1.9	---	21.80	0.0	9.37	
	02/20/92	<50	<0.5	<0.5	<0.5	<0.5	---	21.99	0.0	9.18	
	31.17	06/15/92	<50	<0.5	<0.5	<0.5	<0.5	---	21.74	0.0	9.43
		12/16/92	<50	0.7	0.5	0.5	1.3	---	22.05	0.0	9.12
04/07/93		<50	<0.5	<0.5	<0.5	<1.5	---	21.11	0.0	10.06	
06/09/93		---	---	---	---	---	---	---	---	---	
09/10/93		---	---	---	---	---	---	---	---	---	
09/27/93	<50	<0.5	<0.5	<0.5	<0.5	---	21.54	0.0	9.63		
12/17/93	<50	<0.5	<0.5	<0.5	<0.5	---	21.89	0.0	9.28		

TABLE 1
HISTORICAL GROUNDWATER ANALYTICAL RESULTS AND MONITORING DATA
Chevron Service Station No. 9-0020
1633 Harrison Street, Oakland, California

Well ID/ Elevation	Date	TPH-G	Benzene	Toluene	Ethyl- benzene	Xylenes	TOG	DTW (ft)	SPT (ft)	WTE (ft)
MW-5	04/23/89	---	---	---	---	---	---	20.62	0.0	9.66
	04/24/89	<50	<0.5	<1.0	<1.0	<1.0	<3,000	---	0.0	---
30.28	07/28/89	<100	<0.2	<1.0	<0.2	<0.4	<3,000	20.86	0.0	9.42
	10/30/89	<500	<0.3	<0.3	<0.3	<0.6	---	20.82	0.0	9.46
	01/09/90	<50	<0.3	<0.3	<0.3	<0.6	---	21.07	0.0	9.21
	04/18/90	<50	<0.3	<0.3	<0.3	<0.6	---	21.35	0.0	8.93
	06/22/90	---	---	---	---	---	---	21.38	0.0	8.90
	08/09/90	<50	<0.3	<0.3	<0.3	<0.6	---	21.36	0.0	8.92
	11/13/90	<50	<0.5	1	<0.5	1	---	21.35	0.0	8.93
	05/15/91	<50	<0.5	<0.5	<0.5	<0.5	---	21.29	0.0	8.99
	08/27/91	94	3.0	5.0	1.5	5.5	---	21.11	0.0	9.17
	11/15/91	<50	0.9	1.7	<0.5	2.2	---	21.18	0.0	9.10
	02/20/92	<50	<0.5	<0.5	<0.5	<0.5	---	21.25	0.0	9.03
	06/15/92	<50	<0.5	<0.5	<0.5	<0.5	---	21.00	0.0	9.28
	12/16/92	<50	<0.5	<0.5	<0.5	<0.5	---	21.23	0.0	9.05
	04/07/93	<50	<0.5	<0.5	<0.5	<1.5	---	20.31	0.0	9.97
	06/09/93	---	---	---	---	---	---	---	---	---
09/10/93	---	---	---	---	---	---	---	---	---	
09/27/93	---	---	---	---	---	---	20.76	0.0	9.52	
12/17/93	---	---	---	---	---	---	---	---	---	

TABLE 1
HISTORICAL GROUNDWATER ANALYTICAL RESULTS AND MONITORING DATA
Chevron Service Station No. 9-0020
1633 Harrison Street, Oakland, California

Well ID/ Elevation	Date	TPH-G	Benzene	Toluene	Ethyl- benzene	Xylenes	TOG	DTW (ft)	SPT (ft)	WTE (ft)
MW-6	04/23/89	---	---	---	---	---	---	20.05	0.0	9.41
	04/24/89	<50	<0.5	<1.0	<1.0	<1.0	<3	---	---	---
	07/28/89	<100	<0.2	<1.0	<0.2	<0.4	<3	20.30	0.0	9.16
29.46	10/30/89	<500	<0.3	<0.3	<0.3	<0.6	---	20.32	0.0	9.14
	01/09/90	<50	<0.3	<0.3	<0.3	<0.6	---	20.51	0.0	8.95
	04/18/90	<50	<0.3	<0.3	<0.3	<0.6	---	20.72	0.0	8.74
	06/22/90	---	---	---	---	---	---	20.77	0.0	8.69
	08/09/90	<50	<0.3	<0.3	<0.3	<0.6	---	20.74	0.0	8.72
	11/13/90	<50	3	5	0.5	2	---	20.75	0.0	8.71
	05/15/91	<50	<0.5	<0.5	<0.5	<0.5	---	20.61	0.0	8.85
	08/27/91	180	6.1	12	3.8	14	---	20.53	0.0	8.93
	11/15/91	<50	<0.5	0.6	<0.5	<0.5	---	20.53	0.0	8.93
	02/20/92	<50	0.9	1.1	<0.5	1.4	---	20.69	0.0	8.77
	06/15/92	<50	<0.5	<0.5	<0.5	<0.5	---	20.38	0.0	9.08
29.45	12/16/92	<50	<0.5	<0.5	<0.5	<0.5	---	20.57	0.0	8.88
	04/07/93	<50	<0.5	<0.5	<0.5	<1.5	---	19.59	0.0	9.86
	06/09/93	<50	<0.5	<0.5	<0.5	<0.5	---	19.50	0.0	9.95
	09/10/93	---	---	---	---	---	---	---	---	---
	09/27/93	---	---	---	---	---	---	20.07	0.0	9.38
	12/17/93	---	---	---	---	---	---	---	---	---

TABLE 1
HISTORICAL GROUNDWATER ANALYTICAL RESULTS AND MONITORING DATA
Chevron Service Station No. 9-0020
1633 Harrison Street, Oakland, California

Well ID/ Elevation	Date	TPH-G	Benzene	Toluene	Ethyl- benzene	Xylenes	TOG	DTW (ft)	SPT (ft)	WTE (ft)
MW-7	04/23/89	---	---	---	---	---	---	18.99	0.0	10.02
	04/24/89	8,400 ³	100	260	160	1,300	3 ^d	---	---	---
29.01	07/28/89	7,000 ³	230	90	70	440	<3,000	19.94	0.0	9.07
(D)	07/28/89	6,000 ³	280	180	58	430	---	---	---	---
	10/30/89	10,000 ³	570	55	160	400	---	19.97	0.0	9.04
(D)	10/30/89	9,900 ³	520	82	180	410	---	---	---	---
	01/09/90	3,400 ³	290	72	9	200	---	20.15	0.0	8.86
	04/18/90	6,800 ³	350	140	110	400	---	20.37	0.0	8.64
	06/22/90	---	---	---	---	---	---	20.40	0.0	8.61
	08/09/90	11,000 ³	360	130	14	660	---	20.38	0.0	8.63
	11/13/90	6,500	230	110	97	460	---	20.41	0.0	8.60
	05/15/91	4,600	180	55	46	300	---	20.47	0.0	8.54
	08/27/91	7,000	220	53	63	340	---	20.14	0.0	8.87
	11/15/91	3,300	150	19	4.9	200	---	20.22	0.0	8.79
	02/20/92	5,200	520	150	100	380	---	20.32	0.0	8.69
	06/15/92	10,000	760	430	320	1,100	---	19.98	0.0	9.03
29.01	12/16/92	11,000	810	350	280	1,100	---	20.14	0.0	8.87
	04/07/93	150	1.4	0.9	0.9	4.5	---	19.14	0.0	9.87
	06/09/93	180	4	1	1	3	---	19.05	0.0	9.96
	09/10/93	---	---	---	---	---	---	---	---	---
	09/27/93	---	---	---	---	---	---	---	---	---
	12/17/93	---	---	---	---	---	---	---	---	---

remed. equipment in well.

TABLE 1
HISTORICAL GROUNDWATER ANALYTICAL RESULTS AND MONITORING DATA
Chevron Service Station No. 9-0020
1633 Harrison Street, Oakland, California

Well ID/ Elevation	Date	TPH-G	Benzene	Toluene	Ethyl- benzene	Xylenes	TOG	DTW (ft)	SPT (ft)	WTE (ft)
MW-8	04/23/89	---	---	---	---	---	---	20.14	0.0	9.43
	04/24/89	<50	<0.5	<1.0	<1.0	<1.0	3,000	---	---	---
29.57	04/24/89	<50	<0.5	<1.0	<1.0	<1.0	---	---	---	---
	07/28/89	<100	<0.2	<1.0	<0.2	<0.4	<3,000	20.37	0.0	9.20
	10/30/89	<500	<0.3	<0.3	<0.3	<0.6	---	20.32	0.0	9.25
	01/09/90	<50	<0.3	<0.3	<0.3	<0.6	---	20.60	0.0	8.97
	04/18/90	<50	<0.3	<0.3	<0.3	<0.6	---	20.87	0.0	8.70
	06/22/90	---	---	---	---	---	---	20.34	0.0	9.23
	08/09/90	<50	<0.3	<0.3	<0.3	<0.6	---	20.89	0.0	8.68
	11/13/90	<50	<0.5	0.8	<0.5	2	---	20.86	0.0	8.71
	05/15/91	<50	<0.5	<0.5	<0.5	<0.5	---	20.49	0.0	9.08
	08/27/91	73 ²	<0.5	<0.5	<0.5	<0.5	---	20.60	0.0	8.97
	11/15/91	<50	<0.5	0.7	<0.5	2.1	---	20.62	0.0	8.95
	02/20/92	<50	<0.5	<0.5	<0.5	<0.5	---	20.80	0.0	8.77
	06/15/92	<50	<0.5	<0.5	<0.5	<0.5	---	20.48	0.0	9.09
29.57	12/16/92	<50	<0.5	<0.5	<0.5	<0.5	---	20.68	0.0	8.89
	04/07/93	<50	<0.5	<0.5	<0.5	<1.5	---	19.70	0.0	9.87
	06/09/93	<50	<0.5	<0.5	<0.5	<0.5	---	19.60	0.0	9.97
	09/10/93	---	---	---	---	---	---	---	---	---
	09/27/93	---	---	---	---	---	---	20.22	0.0	9.35
	12/17/93	---	---	---	---	---	---	---	---	---

TABLE 1
HISTORICAL GROUNDWATER ANALYTICAL RESULTS AND MONITORING DATA
Chevron Service Station No. 9-0020
1633 Harrison Street, Oakland, California

Well ID/ Elevation	Date	TPH-G	Benzene	Toluene	Ethyl- benzene	Xylenes	TOG	DTW (ft)	SPT (ft)	WTE (ft)
MW-9 28.67 28.68	06/22/90	5,700 ³	47	31	280	530	<1,000	20.80	0.0	7.87
	08/09/90	8,000 ³	<0.3	17	210	480	---	20.74	0.0	7.93
	11/13/90	6,400	<3	20	240	450	---	20.78	0.0	7.89
	05/15/91	5,700	2	16	190	390	---	20.48	0.0	8.19
	08/27/91	6,700	<3	31	180	350	---	20.55	0.0	8.12
	11/15/91	4,000	8.8	26	150	280	---	20.57	0.0	8.10
	02/20/92	3,400	13	30	230	460	---	21.77	0.0	6.90
	06/15/92	4,500	19	72	280	560	---	20.37	0.0	8.30
	12/16/92	9,900	380	220	380	1,300	---	20.29	0.0	8.39
	04/07/93	8,700	51	150	360	1,000	---	19.32	0.0	9.36
	06/09/93	8,900	170	160	350	1,100	---	19.16	0.0	9.52
	09/10/93	4,600	110	63	190	350	---	---	---	---
	09/27/93	---	---	---	---	---	---	19.94	0.0	8.74
12/17/93	4,600	92	85	180	300	---	20.31	0.0	8.37	
MW-10 28.60 28.62	06/22/90	<50 ³	<0.5	<0.5	<0.5	<0.5	<1,000	20.48	0.0	8.12
	08/09/90	<50	<0.3	<0.3	<0.3	<0.6	---	20.45	0.0	8.15
	11/13/90	<50	<0.5	2	0.5	2	---	20.47	0.0	8.13
	05/15/91	<50	<0.5	<0.5	<0.5	<0.5	---	20.15	0.0	8.45
	08/27/91	<50	<0.5	<0.5	<0.5	<0.5	---	20.27	0.0	8.33
	11/15/91	<50	<0.5	<0.5	<0.5	<0.5	---	20.33	0.0	8.27
	02/20/92	<50	2.0	2.2	<0.5	2.1	---	21.45	0.0	7.15
	06/15/92	<50	<0.5	<0.5	<0.5	<0.5	---	21.30	0.0	7.30
	12/16/92	<50	<0.5	<0.5	<0.5	<0.5	---	20.17	0.0	8.45
	04/07/93	<50	<0.5	<0.5	<0.5	<1.5	---	19.26	0.0	9.41
	06/09/93	<50	<0.5	<0.5	<0.5	<0.5	---	19.07	0.0	9.55
	09/10/93	<50	<0.5	<0.5	<0.5	<0.5	---	---	---	---
	09/24/93	---	---	---	---	---	---	19.72	0.0	8.90
12/17/93	<50	<0.5	<0.5	<0.5	<0.5	---	20.07	0.0	8.55	

TABLE 1
HISTORICAL GROUNDWATER ANALYTICAL RESULTS AND MONITORING DATA
Chevron Service Station No. 9-0020
1633 Harrison Street, Oakland, California

Well ID/ Elevation	Date	TPH-G	Benzene	Toluene	Ethyl- benzene	Xylenes	TOG	DTW (ft)	SPT (ft)	WTE (ft)
MW-11 29.37 29.39	06/22/90	<50 ³	<0.5	<0.5	<0.5	<0.5	<1,000	21.03	0.0	8.34
	08/09/90	<50	<0.3	<0.3	<0.3	<0.6	--	21.02	0.0	8.35
	11/13/90	76	0.6	1	0.9	4	--	20.93	0.0	8.44
	05/15/91	78 ²	<0.5	<0.5	<0.5	<0.5	--	20.61	0.0	8.76
	08/27/91	110 ²	<0.5	<0.5	<0.5	<0.5	--	20.70	0.0	8.67
	11/15/91	<50	<0.5	<0.5	<0.5	<0.5	--	20.68	0.0	8.69
	02/20/92	<50	1.9	2.1	1.0	4.4	--	21.91	0.0	7.46
	06/15/92	--	--	--	--	--	--	20.56	0.0	8.81
	12/16/92	<50	<0.5	<0.5	<0.5	<0.5	--	20.75	0.0	8.64
	04/07/93	<50	<0.5	<0.5	<0.5	<1.5	--	19.83	0.0	9.56
	06/09/93	<50	<0.5	<0.5	<0.5	<0.5	--	19.67	0.0	9.72
	09/10/93	--	--	--	--	--	--	--	--	--
	09/27/93	<50	<0.5	<0.5	<0.5	<0.5	--	20.33	0.0	9.06
12/17/93	<50	<0.5	<0.5	<0.5	<0.5	--	20.73	0.0	8.66	
MW-12 28.43 28.43	06/22/90	<50 ³	<0.5	<0.5	<0.5	<0.5	<1,000	20.45	0.0	7.98
	08/09/90	<50	<0.3	<0.3	<0.3	<0.6	--	20.43	0.0	8.00
	11/13/90	<50	<0.5	<0.5	<0.5	<0.5	--	20.45	0.0	7.98
	05/15/91	<50	<0.5	<0.5	<0.5	<0.5	--	20.07	0.0	8.36
	08/27/91	56 ²	<0.5	<0.5	<0.5	<0.5	--	20.15	0.0	8.28
	11/15/91	<50	<0.5	<0.5	<0.5	<0.5	--	20.25	0.0	8.18
	02/20/92	<50	2.5	3.1	0.7	3.0	--	21.37	0.0	7.06
	06/15/92	<50	<0.5	<0.5	<0.5	<0.5	--	19.90	0.0	8.53
	12/16/92	<50	<0.5	<0.5	<0.5	<0.5	--	19.80	0.0	8.63
	04/07/93	<50	<0.5	<0.5	<0.5	<1.5	--	18.75	0.0	9.68
	06/09/93	--	--	--	--	--	--	--	--	--
	09/10/93	--	--	--	--	--	--	--	--	--
	09/27/93	--	--	--	--	--	--	19.63	0.0	8.80
12/17/93	--	--	--	--	--	--	--	--	--	

TABLE 1
HISTORICAL GROUNDWATER ANALYTICAL RESULTS AND MONITORING DATA
Chevron Service Station No. 9-0020
1633 Harrison Street, Oakland, California

Well ID/ Elevation	Date	TPH-G	Benzene	Toluene	Ethyl- benzene	Xylenes	TOG	DTW (ft)	SPT (ft)	WTE (ft)
MW-13 28.63 28.62	11/15/91	3,100	68	40	110	270	---	21.07	0.0	7.56
	02/20/92	3,100	120	50	240	400	---	22.17	0.0	6.46
	06/15/92	3,200	35	33	210	300	---	20.67	0.0	7.96
	12/16/92	87,000	1,400	540	2,400	11,000	---	20.34	0.0	8.28
	04/07/93	1,500	72	12	70	160	---	19.41	0.0	9.21
	06/09/93	210	6	2	7	16	---	19.20	0.0	9.42
	09/10/93	73	3	<0.5	2	3	---	---	---	---
	09/27/93	---	---	---	---	---	---	20.35	0.0	8.27
	12/17/93	640	43	12	12	37	---	20.76	0.0	7.86
MW-14 29.46 29.45	11/15/91	<50	<0.5	<0.5	<0.5	<0.5	---	20.33	0.0	9.13
	02/20/92	<50	1.3	1.8	1.1	5.2	---	21.41	0.0	8.05
	06/15/92	---	---	---	---	---	---	---	---	---
	12/16/92	<50	<0.5	<0.5	<0.5	<0.5	---	20.66	0.0	8.79
	04/07/93	---	---	---	---	---	---	---	---	---
	06/09/93	---	---	---	---	---	---	---	---	---
	09/10/93	---	---	---	---	---	---	---	---	---
	09/27/93	---	---	---	---	---	---	20.26	0.0	9.19
	12/17/93	---	---	---	---	---	---	---	---	---
MW-15 28.04	12/16/92	<50	<0.5	<0.5	<0.5	<0.5	---	19.74	0.0	8.30
	04/07/93	<50	1.3	<0.5	<0.5	<1.5	---	18.80	0.0	9.24
	06/09/93	<50	<0.5	<0.5	<0.5	<0.5	---	18.60	0.0	9.44
	09/10/93	---	---	---	---	---	---	---	---	---
	09/27/93	<50	2	<0.5	<0.5	<0.5	---	19.93	0.0	8.11
	12/18/93	<50	<0.5	<0.5	<0.5	<0.5	---	20.32	0.0	7.72
MW-16 28.32	12/16/92	---	---	---	---	---	---	19.58	0.0	8.74
	12/21/92	<50	<0.5	<0.5	<0.5	<0.5	---	---	---	---
	04/07/93	<50	<0.5	6.8	<0.5	<0.5	---	18.41	0.0	9.91
	06/09/93	<50	<0.5	<0.5	<0.5	<0.5	---	18.25	0.0	10.07
	09/10/93	<50	<0.5	<0.5	<0.5	<0.5	---	---	---	---
	09/27/93	---	---	---	---	---	---	20.16	0.0	8.16
	12/17/93	---	---	---	---	---	---	---	---	---

car parked over pt.

TABLE 1
HISTORICAL GROUNDWATER ANALYTICAL RESULTS AND MONITORING DATA
Chevron Service Station No. 9-0020
1633 Harrison Street, Oakland, California

Well ID/ Elevation	Date	TPH-G	Benzene	Toluene	Ethyl- benzene	Xylenes	TOG	DTW (ft)	SPT (ft)	WTE (ft)
TB/LB	11/03/88	--	<1.0	<1.0	<1.0	<1.0	--	--	--	--
	02/10/89	<50	<0.1	<0.1	<0.1	<0.2	--	--	--	--
	04/24/89	<50	<0.5	<0.5	<1.0	<1.0	--	--	--	--
	07/28/89	<50	<0.1	<0.1	<0.1	<0.2	--	--	--	--
	10/30/89	<500	<0.3	<0.3	<0.3	<0.6	--	--	--	--
	01/09/90	<50	<0.3	<0.3	<0.3	<0.6	--	--	--	--
	04/18/90	<50	<0.3	<0.3	<0.3	<0.6	--	--	--	--
	06/22/90	<50	<0.5	<0.5	<0.5	<0.5	--	--	--	--
	08/09/90	<50	<0.3	<0.3	<0.3	<0.6	--	--	--	--
	11/13/90	<50	<0.5	<0.5	<0.5	<0.5	--	--	--	--
	05/15/91	<50	<0.5	<0.5	<0.5	<0.5	--	--	--	--
	08/27/91	<50	<0.5	<0.5	<0.5	<0.5	--	--	--	--
	11/15/91	<50	<0.5	<0.5	<0.5	<0.5	--	--	--	--
	02/20/92	<50	<0.5	<0.5	<0.5	<0.5	--	--	--	--
	06/15/92	<50	<0.5	<0.5	<0.5	<0.5	--	--	--	--
	12/16/92	<50	<0.5	<0.5	<0.5	<0.5	--	--	--	--
	04/07/93	<50	<0.5	<0.5	<0.5	<1.5	--	--	--	--
	06/09/93	<50	<0.5	<0.5	<0.5	<0.5	--	--	--	--
09/10/93	<50	<0.5	<0.5	<0.5	<0.5	--	--	--	--	
09/27/93	<50	<0.5	<0.5	<0.5	<0.5	--	--	--	--	
12/17/93	<50	<0.5	<0.5	<0.5	<0.5	--	--	--	--	
RB	12/17/93	<50	<0.5	<0.5	<0.5	<0.5	--	--	--	--

NOTES FOR TABLE 1
CHEVRON SERVICE STATION No. 9-6991
1633 HARRISON STREET, OAKLAND, CALIFORNIA

Concentrations in parts per billion.

All elevations are presented as feet above mean sea level.

- TPH-G = Total petroleum hydrocarbons-as-gasoline
TOG = Total oil and grease
DTW = Depth to groundwater
SPT = Separate-phase hydrocarbon thickness
WTE = Water-table elevation
TB-LB = Trip blank/Lab blank
RB = Rinsate blank
-- = Not applicable, not sampled, not measured
(D) = Duplicate analysis
* = Gasoline range concentration reported. The chromatogram indicates only a single peak in the gasoline range.
1 = Analyzed for total fuel hydrocarbons
2 = Laboratory reported that peaks did not match typical gasoline pattern.
3 = Fuel characterized as gasoline
4 = Acetone and 2-butanone were detected at 5 ppb and 160 ppb, respectively.
5 = Uncategorized compound is not included in the gasoline hydrocarbon concentration.

TABLE 2
HISTORICAL GROUNDWATER ANALYTICAL RESULTS FOR HALOGENATED VOLATILE ORGANICS
Chevron Service Station No. 9-0020
1633 Harrison Street, Oakland, California

Well ID	Date	Carbon Tet	Chloro-form	PCE	TCE	1,2-DCE	t-1,2-DCE	c-1,2-DCE	1,1,1-TCA	1,2-DCA	1,2-DCP	MC	Other ^a HVOCs
MW-1	11/03/88	18.0	7.0	<1.0	<1.0	—	<1.0	—	<1.0	<1.0	—	—	—
	02/10/89	17.0	6.0	<0.2	<0.2	—	<0.2	<0.2	<0.2	<0.2	—	—	—
	04/24/89	16.0	6.0	<1.0	<1.0	<1.0	—	—	<1.0	<1.0	—	—	—
	07/28/89	20.0	6.4	<0.1	<0.1	—	<0.1	<0.1	0.3	<0.1	—	—	—
	10/30/89	11.0	4.9	<0.5	<0.5	<0.5	—	—	<0.5	<0.5	—	—	—
	01/09/90	24.0	7.2	<0.5	<0.5	<0.5	—	—	<0.5	<0.5	—	—	—
	04/18/90	23.0	5.5	<0.5	<0.5	<0.5	—	—	1.4	<0.5	<0.5	<0.5	—
	08/09/90	32.0	11.0	0.7	<0.5	<0.5	—	—	<0.5	<0.5	<0.5	<0.5	—
	11/13/90	24	7	60.7	<0.5	—	<0.5	<0.5	<0.5	<0.5	<0.5	<0.5	—
	05/15/91	15	5	<0.5	<0.5	—	<0.5	<0.5	<0.5	<0.5	<0.5	<0.5	ND
	08/27/91	18	4.2	<0.5	<0.5	—	—	<0.5	<0.5	<0.5	<0.5	<0.5	ND
	11/15/91	21	7.9	<0.5	<0.5	—	<0.5	<0.5	<0.5	<0.5	<0.5	<0.5	ND
	02/20/92	24	7.5	<0.5	<0.5	—	<0.5	<0.5	<0.5	<0.5	<0.5	<0.5	ND
	06/15/92	10	3.2	<0.5	<0.5	—	<0.5	<0.5	<0.5	<0.5	<0.5	<0.5	ND
MW-2	11/03/88	3.0	2.0	34.0	3.0	—	10.0	—	<1.0	<1.0	—	—	—
	02/10/89	1.4	1.0	17.2	<0.2	—	<0.2	6.3	<0.2	<0.2	—	—	—
	04/24/89	2.0	2.0	38.0	3.0	9.0	—	—	<1.0	<1.0	—	—	—
	07/28/89	3.7	2.0	46.0	2.6	—	<0.2	<0.2	<0.2	<0.2	—	—	—
	10/30/89	1.4	2.6	53.0	1.1	14.0	—	—	<0.5	<0.5	—	—	—
	01/09/90	3.6	3.9	78.0	5.3	16.0	—	—	<0.5	<0.5	—	—	—
	04/18/90	1.5	2.7	130.0	3.9	19.0	—	—	<0.5	<0.5	<0.5	<0.5	—
	08/09/90	2.1	2.1	74.0	6.1	15.0	—	—	<0.5	<0.5	<0.5	<0.5	—
	11/13/90	<0.5	2	40	4	—	<0.5	10	<0.5	<0.5	<0.5	<0.5	—
	05/15/91	2	2	56	6	—	<0.5	15	<0.5	<0.5	<0.5	<0.5	ND
	08/27/91	1.1	0.9	46	3.9	—	—	8.0	<0.5	<0.5	<0.5	<0.5	ND
	11/15/91	0.6	1.1	58	3.1	—	<0.5	6.3	<0.5	<0.5	<0.5	<0.5	ND
	02/20/92	11	<2.5	62	3.1	—	<2.5	4.3	<2.5	<2.5	<2.5	<2.5	ND
	06/15/92	<0.5	1.2	45	3.1	—	<0.5	4.8	<0.5	<0.5	<0.5	<0.5	ND

TABLE 2
HISTORICAL GROUNDWATER ANALYTICAL RESULTS FOR HALOGENATED VOLATILE ORGANICS
Chevron Service Station No. 9-0020
1633 Harrison Street, Oakland, California

Well ID	Date	Carbon Tet	Chloro-form	PCE	TCE	1,2-DCE	t-1,2-DCE	c-1,2-DCE	1,1,1-TCA	1,2-DCA	1,2-DCP	MC	Other ^a HVOCs	
MW-3	11/03/88	8.0	6.0	84.0	3.0	--	5.0	--	<1.0	<1.0	--	--	--	
	02/10/89	5.8	4.0	53.0	1.9	--	<0.2	9.0	<0.2	<0.2	--	--	--	
	04/24/89	7.0	6.0	110.0	3.0	11.0	--	--	<1.0	<1.0	--	--	--	
	07/28/89	8.6	5.0	49.0	2.1	--	<0.2	11.0	<0.2	<0.1	--	--	--	
	10/30/89	5.6	5.3	62.0	0.7	8.2	--	--	<0.5	<0.5	--	--	--	
	01/09/90	8.6	6.1	81.0	73.8	8.7	--	--	<0.5	<0.5	--	--	--	
	04/18/90	7.6	5.8	120.0	2.4	11.0	--	--	<0.5	<0.5	<0.5	<0.5	--	
	08/09/90	11.0	6.7	81.0	5.1	11.0	--	--	<0.5	<0.5	<0.5	<0.5	<0.5	--
	11/13/90	7	5	43	4	--	<0.5	9	<0.5	<0.5	<0.5	<0.5	<0.5	--
	05/15/91	6	4	46	3	--	<0.5	8	<0.5	<0.5	<0.5	<0.5	<0.5	ND
	08/27/91	5.5	3.8	43	2.6	--	--	8.1	<0.5	<0.5	<0.5	<0.5	<0.5	c,d,e,f
	11/15/91	6.3	5.0	67	3.4	--	0.8	7.4	0.9	<0.5	<0.5	<0.5	<0.5	ND
	02/20/92	2.8	4.0	96	3.0	--	<2.5	6.1	<2.5	<2.5	<2.5	<2.5	<0.5	ND
	06/15/92	5.0	3.9	86	2.9	--	<0.5	7.5	<0.5	<0.5	<0.5	<0.5	<0.5	ND
MW-4	04/24/89	35.0	11.0	<1.0	<1.0	<1.0	--	--	<1.0	<1.0	--	--	--	
	07/28/89	32.0	9.3	<0.1	<0.1	--	<0.1	<0.1	<0.1	<0.1	--	--	--	
	10/30/89	32.0	8.5	<0.5	<0.5	<0.5	--	--	<0.5	<0.5	--	--	--	
	01/09/90	36.0	9.8	<0.5	<0.5	<0.5	--	--	<0.5	<0.5	--	--	--	
	04/18/90	41.0	9.5	<0.5	<0.5	<0.5	--	--	<0.5	<0.5	<0.5	<0.5	--	
	08/09/90	38.0	11.0	<0.5	<0.5	<0.5	--	--	<0.5	<0.5	<0.5	<0.5	--	
	11/13/90	40	11	<0.5	<0.5	--	<0.5	<0.5	<0.5	<0.5	<0.5	<0.5	<0.5	--
	05/15/91	35	10	<0.5	<0.5	--	<0.5	<0.5	<0.5	<0.5	<0.5	<0.5	<0.5	ND
	08/27/91	28	6.1	<0.5	<0.5	--	--	<0.5	<0.5	<0.5	<0.5	<0.5	<0.5	ND
	11/15/91	23	9.1	<0.5	<0.5	--	<0.5	<0.5	<0.5	<0.5	<0.5	<0.5	<0.5	ND
	02/20/92	400	140	<0.5	<0.5	--	<0.5	<0.5	<0.5	<0.5	<0.5	<0.5	<0.5	ND
06/15/92	38	11	<0.5	<0.5	--	<0.5	<0.5	<0.5	<0.5	<0.5	<0.5	<0.5	ND	

TABLE 2
HISTORICAL GROUNDWATER ANALYTICAL RESULTS FOR HALOGENATED VOLATILE ORGANICS
Chevron Service Station No. 9-0020
1633 Harrison Street, Oakland, California

Well ID	Date	Carbon Tet	Chloro-form	PCE	TCE	1,2-DCE	t-1,2-DCE	c-1,2-DCE	1,1,1-TCA	1,2-DCA	1,2-DCP	MC	Other ^A HVOCs
MW-5	04/24/89	4.0	5.0	4.0	<1.0	2.0	--	--	<1.0	<1.0	--	--	--
	07/28/89	5.6	4.0	5.3	0.3	--	0.2	2.3	0.5	<0.2	--	--	--
	10/30/89	2.9	2.0	2.7	<0.5	0.86	--	--	<0.5	<0.5	--	--	--
	01/09/90	8.2	4.6	7.8	0.6	3.1	--	--	<0.5	<0.5	--	--	--
	04/18/90	6.3	2.8	2.6	<0.5	1.7	--	--	<0.5	<0.5	<0.5	<0.5	--
	08/09/90	11.0	4.8	6.0	<0.5	2.3	--	--	<0.5	<0.5	<0.5	<0.5	--
	11/13/90	7	3	5	<0.5	--	<0.5	1	<0.5	<0.5	<0.5	<0.5	--
	05/15/91	4	2	3	<0.5	--	<0.5	0.8	<0.5	<0.5	<0.5	<0.5	ND
	08/27/91	3.3	1.1	2.3	<0.5	--	--	<0.5	<0.5	<0.5	<0.5	<0.5	<0.5
	11/15/91	5.7	2.8	5.5	<0.5	--	<0.5	1.7	<0.5	<0.5	<0.5	<0.5	ND
	02/20/92	4.0	2.0	3.9	<0.5	--	<0.5	0.7	<0.5	<0.5	<0.5	<0.5	ND
	06/15/92	4.0	2.0	5.0	<0.5	--	<0.5	1.4	<0.5	<0.5	<0.5	<0.5	ND
MW-6	04/24/89	13.0	7.0	<1.0	<1.0	<1.0	--	--	<1.0	<1.0	--	--	--
	07/28/89	9.6	4.0	<0.2	<0.2	--	<0.2	<0.2	0.5	0.6	--	--	--
	10/30/89	8.2	3.6	<0.5	<0.5	<0.5	--	--	<0.5	<0.5	--	--	--
	01/09/90	10.0	4.2	<0.5	<0.5	<0.5	--	--	<0.5	1.8	--	--	--
	04/18/90	11.0	3.8	<0.5	<0.5	<0.5	--	--	<0.5	<0.5	<0.5	<0.5	--
	08/09/90	20.0	6.6	<0.5	<0.5	<0.5	--	--	<0.5	<0.5	<0.5	<0.5	--
	11/13/90	15	5	<0.5	<0.5	--	<0.5	<0.5	<0.5	<0.5	<0.5	<0.5	--
	05/15/91	11	4	<0.5	<0.5	--	<0.5	<0.5	<0.5	<0.5	<0.5	<0.5	ND
	08/27/91	8.0	2.2	2.4	<0.5	--	--	<0.5	<0.5	<0.5	<0.5	<0.5	ND
	11/15/91	13	5.4	<0.5	<0.5	--	<0.5	<0.5	<0.5	0.8	<0.5	<0.5	ND
	02/20/92	11	4.0	<0.5	<0.5	--	<0.5	<0.5	<0.5	<0.5	<0.5	<0.5	ND
	06/15/92	9.6	4.2	<0.5	<0.5	--	<0.5	<0.5	<0.5	<0.5	<0.5	<0.5	ND

TABLE 2
HISTORICAL GROUNDWATER ANALYTICAL RESULTS FOR HALOGENATED VOLATILE ORGANICS
Chevron Service Station No. 9-0020
1633 Harrison Street, Oakland, California

Well ID	Date	Carbon Tet	Chloro-form	PCE	TCE	1,2-DCE	1,1,2-DCE	c-1,2-DCE	1,1,1-TCA	1,2-DCA	1,2-DCP	MC	Other ^a HVOCs
MW-7	04/24/89	3.0	9.0	<1.0	<1.0	<1.0	---	---	<1.0	<1.0	---	---	---
	07/28/89	<2.0	<10.0	<2.0	<2.0	---	<2.0	<2.0	<10.0	6.0	---	---	---
	07/28/89 _b	<5.0	<20.0	<5.0	<5.0	---	<5.0	<0.5	<5.0	<5.0	---	---	---
	10/30/89	<1.0	3.9	<1.0	<1.0	<1.0	---	---	<1.0	6.4	---	---	---
	10/30/89 _b	<1.0	3.1	<1.0	<1.0	<1.0	---	---	<1.0	6.2	---	---	---
		<0.5	3.0	<0.5	<0.5	<0.5	---	---	<0.5	8.4	---	---	---
	01/09/90	<0.5	3.2	<0.5	<0.5	<0.5	---	---	<0.5	7.7	0.6	0.6	---
	04/18/90	3.3	7.7	<0.5	<0.5	<0.5	---	---	<0.5	8.4	<0.5	1.8	---
	08/09/90	0.6	3	<0.5	<0.5	---	<0.5	<0.5	<0.5	4	<0.5	<0.5	---
	11/13/90	2	2	<0.5	<0.5	---	<0.5	<0.5	<0.5	3	<0.5	<0.5	ND
	05/15/91	0.7	2.8	<0.5	<0.5	---	---	<0.5	<0.5	2.7	<0.5	<0.5	ND
	08/27/91	0.8	2.7	<0.5	<0.5	---	<0.5	<0.5	<0.5	3.1	<0.5	0.8	ND
	11/15/91	2.2	1.9	<0.5	<0.5	---	<0.5	<0.5	<0.5	3.3	<0.5	<0.5	ND
	02/20/92	1.1	1.8	<0.5	<0.5	---	<0.5	<0.5	<0.5	4.5	<0.5	<0.5	ND
	06/15/92												
MW-8	04/24/89	2.0	3.0	6.0	<1.0	4.0	---	---	<1.0	<1.0	---	---	---
	04/24/89 _b	2.0	2.0	6.0	<1.0	3.0	---	---	<1.0	<1.0	---	---	---
		2.3	2.0	5.6	<0.2	---	<0.2	3.8	<0.2	<0.2	---	---	---
	07/28/89	2.5	2.6	8.0	<0.5	5.5	---	---	<0.5	<0.5	---	---	---
	10/30/89	4.9	3.9	19.0	0.9	6.6	---	---	<0.5	<0.5	---	---	---
	01/09/90	3.8	2.8	17.0	0.6	5.7	---	---	<0.5	<0.5	<0.5	<0.5	---
	04/18/90	5.3	4.4	27.0	1.2	9.2	---	---	<0.5	<0.5	<0.5	<0.5	---
	08/09/90	3	2	21	0.7	---	<0.5	6	<0.5	<0.5	<0.5	<0.5	---
	11/13/90	2	2	30	0.9	---	<0.5	6	<0.5	<0.5	<0.5	<0.5	ND
	05/15/91	1.4	1.1	32	1.0	---	---	4.7	<0.5	<0.5	<0.5	<0.5	ND
	08/27/91	1.5	1.9	50	<0.5	---	<0.5	5.8	<0.5	<0.5	2.0	<0.5	ND
	11/15/91	1.3	2.3	68	2.4	---	<0.5	7.6	<0.5	<0.5	<0.5	<0.5	ND
	02/20/92	0.7	1.9	46	1.6	---	<0.5	5.6	<0.5	---	<0.5	<0.5	ND
	06/15/92												

TABLE 2
HISTORICAL GROUNDWATER ANALYTICAL RESULTS FOR HALOGENATED VOLATILE ORGANICS
Chevron Service Station No. 9-0020
1633 Harrison Street, Oakland, California

Well ID	Date	Carbon Tet	Chloro-form	PCE	TCE	1,2-DCE	t-1,2-DCE	c-1,2-DCE	1,1,1-TCA	1,2-DCA	1,2-DCP	MC	Other ^A HVOCs
MW-9	06/22/90	<0.5	<0.5	<0.5	<0.5	--	<0.5	--	<0.5	<0.5	<0.5	<0.5	--
	08/09/90	<0.5	<0.5	<0.5	<0.5	<0.5	--	--	<0.5	0.71	<0.5	<0.5	--
	11/13/90	<0.5	<0.5	<0.5	<0.5	--	<0.5	<0.5	<0.5	1	<0.5	<0.5	--
	05/15/91	<0.5	<0.5	<0.5	<0.5	--	<0.5	<0.5	<0.5	0.5	<0.5	<0.5	ND
	08/27/91	<0.5	<0.5	<0.5	<0.5	--	--	<0.5	<0.5	<0.5	<0.5	<0.5	ND
	11/15/91	<0.5	<0.5	<0.5	<0.5	--	<0.5	<0.5	<0.5	0.6	<0.5	<0.5	ND
	02/20/92	<0.5	<0.5	<0.5	<0.5	--	<0.5	<0.5	<0.5	<0.5	<0.5	<0.5	ND
	06/15/92	<0.5	<0.5	<0.5	<0.5	--	<0.5	<0.5	<0.5	<0.5	<0.5	<0.5	ND
MW-10	06/22/90	9.6	8.9	<0.5	<0.5	--	<0.5	--	<0.5	<0.5	<0.5	<0.5	--
	08/09/90	11.0	7.8	<0.5	<0.5	<0.5	--	--	<0.5	<0.5	<0.5	<0.5	--
	11/13/90	5	4	<0.5	<0.5	--	<0.5	<0.5	<0.5	<0.5	<0.5	<0.5	--
	05/15/91	5	4	<0.5	<0.5	--	<0.5	<0.5	<0.5	<0.5	<0.5	<0.5	ND
	08/27/91	6.9	3.4	<0.5	<0.5	--	--	<0.5	<0.5	<0.5	<0.5	<0.5	ND
	11/15/91	2.7	3.3	<0.5	<0.5	--	<0.5	<0.5	<0.5	<0.5	<0.5	<0.5	ND
	02/20/92	3.3	3.4	3.0	<0.5	--	<0.5	<0.5	<0.5	<0.5	<0.5	<0.5	ND
	06/15/92	4.5	2.9	<0.5	<0.5	--	<0.5	<0.5	<0.5	<0.5	<0.5	<0.5	ND
MW-11	06/22/90	4.6	6.5	73	1.3	--	<0.5	8.9	<0.5	<0.5	<0.5	<0.5	--
	08/09/90	8.1	6.8	84	2.0	4.6	--	--	<0.5	<0.5	<0.5	<0.5	--
	11/13/90	<0.5	<0.5	39	<0.5	--	<0.5	2	5	<0.5	<0.5	<0.5	--
	05/15/91	1	3	7	0.5	--	<0.5	2	<0.5	<0.5	<0.5	<0.5	ND
	08/27/91	4.1	3.3	73	1.0	--	--	2.4	<0.5	<0.5	<0.5	<0.5	ND
	11/15/91	3.3	3.6	64	0.9	--	<0.5	2.3	<0.5	<0.5	<0.5	<0.5	ND
	02/20/92	<2.5	<2.5	62	<2.5	--	<2.5	<2.5	<2.5	<2.5	<2.5	<2.5	ND
	06/15/92	--	--	--	--	--	--	--	--	--	--	--	--

TABLE 2
HISTORICAL GROUNDWATER ANALYTICAL RESULTS FOR HALOGENATED VOLATILE ORGANICS
Chevron Service Station No. 9-0020
1633 Harrison Street, Oakland, California

Well ID	Date	Carbon Tet	Chloro-form	PCE	TCE	1,2-DCE	t-1,2-DCE	c-1,2-DCE	1,1,1-TCA	1,2-DCA	1,2-DCP	MC	Other ^a HVOCs
MW-12	06/22/90	6.0	7.3	7.4	<0.5	---	<0.5	13	<0.5	<0.5	<0.5	<0.5	---
	08/09/90	8.0	7.0	6.7	<0.5	5.8	---	---	<0.5	<0.5	<0.5	<0.5	---
	11/13/90	<0.5	<0.5	9	<0.5	---	<0.5	3	3	<0.5	<0.5	<0.5	---
	05/15/91	4	4	10	<0.5	---	<0.5	3	<0.5	<0.5	<0.5	<0.5	ND
	08/27/91	3.1	2.6	10	<0.5	---	---	2.3	<0.5	<0.5	<0.5	<0.5	ND
	11/15/91	1.9	3.5	8.9	<0.5	---	<0.5	5.9	<0.5	<0.5	<0.5	<0.5	ND
	02/20/92	3.3	3.4	3.7	<0.5	---	<0.5	<0.5	<0.5	<0.5	<0.5	<0.5	ND
	06/15/92	2.2	3.7	13	<0.5	---	<0.5	4.5	<0.5	<0.5	<0.5	<0.5	ND
MW-13	11/15/91	<0.5	<0.5	<0.5	---	<0.5	<0.5	<0.5	<0.5	<0.5	<0.5	<0.5	^g
	02/20/92	<0.5	<0.5	<0.5	---	<0.5	<0.5	<0.5	<0.5	<0.5	<0.5	<0.5	ND
	06/15/92	<0.5	<0.5	<0.5	---	---	<0.5	<0.5	<0.5	<0.5	<0.5	<0.5	ND
MW-14	11/15/91	<0.5	5.5	33	<0.5	---	<0.5	<0.5	<0.5	<0.5	<0.5	<0.5	ND
	02/20/92	<0.5	4.3	38	<0.5	---	<0.5	<0.5	<0.5	<0.5	<0.5	<0.5	ND
	06/15/92	---	---	---	---	---	---	---	---	---	---	---	---

**TABLE 2
HISTORICAL GROUNDWATER ANALYTICAL RESULTS FOR HALOGENATED VOLATILE ORGANICS
Chevron Service Station No. 9-0020
1633 Harrison Street, Oakland, California**

Well ID	Date	Carbon Tet	Chloroform	PCE	TCE	1,2-DCE	t-1,2-DCE	c-1,2-DCE	1,1,1-TCA	1,2-DCA	1,2-DCP	MC	Other ^a HVOCs
Trip Blank	11/03/88	<1.0	<1.0	<1.0	<1.0	---	<1.0	---	<1.0	<1.0	---	---	---
	02/10/89	<0.1	<0.5	<0.1	<0.1	---	<0.1	<0.1	<0.1	<0.1	---	---	---
	04/24/89	<1.0	<1.0	<1.0	<1.0	<1.0	---	---	<1.0	<1.0	---	---	---
	07/28/89	<0.1	<0.5	<0.1	<0.5	<0.1	---	<0.1	<0.1	<0.1	---	---	---
	10/30/89	<0.5	<0.5	<0.5	<0.5	<0.5	---	---	<0.5	<0.5	---	---	---
	01/09/90	<0.5	<0.5	<0.5	<0.5	<0.5	---	---	<0.5	<0.5	---	---	---
	04/18/90	<0.5	<0.5	<0.5	<0.5	<0.5	---	---	<0.5	<0.5	<0.5	<0.5	---
	06/22/90	<0.5	<0.5	<0.5	<0.5	---	<0.5	---	<0.5	<0.5	<0.5	<0.5	---
	08/09/90	<0.5	<0.5	<0.5	<0.5	<0.5	---	---	<0.5	<0.5	<0.5	<0.5	---
	11/13/90	<0.5	<0.5	<0.5	<0.5	---	<0.5	<0.5	<0.5	<0.5	<0.5	<0.5	---
	05/15/91	---	---	---	---	---	---	---	---	---	---	---	---
	08/27/91	---	---	---	---	---	---	---	---	---	---	---	---
	11/15/91	<0.5	<0.5	<0.5	<0.5	---	<0.5	<0.5	<0.5	<0.5	<0.5	---	ND
	02/20/92	<0.5	<0.5	<0.5	<0.5	---	<0.5	<0.5	<0.5	<0.5	<0.5	---	ND
	06/15/92	<0.5	<0.5	<0.5	<0.5	---	<0.5	<0.5	<0.5	<0.5	<0.5	<0.5	ND

Carbon Tet = Carbon Tetrachloride
PCE = Tetrachloroethene
TCE = Trichloroethene
1,2-DCE = 1,2-Dichloroethene
t-1,2-DCE = trans-1,2-Dichloroethene
c-1,2-DCE = cis-1,2-Dichloroethene
1,1,1-TCA = 1,1,1-Trichloroethane
1,2-DCA = 1,2-Dichloroethane
1,2-DCP = 1,2-Dichloropropane
MC = Methylene chloride (dichloromethane)

Other HVOCs = Other halogenated volatile organic compounds
--- = Not applicable, not analyzed, not sampled
ND = Not detected above method detection limit
a = The tabulated analytical results for ground water prior to May 15, 1991 do not specify whether other HVOCs were detected
b = Duplicate analyses
c = Trichlorofluoromethane was detected at 1.4 ppb
d = 1,1-Dichloroethene was detected at 1.3 ppb
e = 1,1-Dichloroethane was detected at 0.5 ppb
f = Chlorobenzene was detected at 0.7 ppb
g = 1,1-Dichloroethane was detected at 0.6 ppb

ATTACHMENT 3

Field Data Sheets

Project Name: Chv. Harrison
 Project Number: 020204081.0610
 Site Address: 1633 Harrison Oakland

Date: 12-16-93
 Page 1 of 1
 Project Manager: Jim Watchers

Well ID MW-1
 Well Dia 4.6
2
29.00'

DTW Measurements
 Initial 20.0 ft Calc Well Volume = 16.30 gal
 Recha ft Well Volume = 5.43 gal
8.32 x .653

Purged Method	Pump Depth	ft
<input type="checkbox"/> Peristaltic	<input type="checkbox"/> Hand Bailed	
<input type="checkbox"/> Gear Drive	<input type="checkbox"/> Air Lift	
<input checked="" type="checkbox"/> Submersible	<input type="checkbox"/> Other	

Instruments Used	
<input checked="" type="checkbox"/> YSI 3650 pH/C/m/mbo	OMEGA Cond.
<input type="checkbox"/> HYDAC pH/F/m/mbo	DRT-15C TURBID
<input type="checkbox"/> OMEGA pH/C	Other

Jason D Stimar
 Pump on @ 11:00 6pm @ 1.2 Pump set @ 28:00

TIME	TEMP	Conductivity	pH	PURGE VOLUME gallons	TURBIDITY	COMMENTS
	<input checked="" type="checkbox"/> C <input type="checkbox"/> F					
1106	7.8	631	9.87	6.0	N/A	Light Brown
1112	7.8	632	9.85	12.0	N/A	Light Brown
1118	7.8	628	9.76	18.0	N/A	Light Brown

Project Name: Chv. Harrison
 Project Number: 020204081.0610
 Site Address: 1633 Harrison Oakland

Date: 12-16-93
 Page 1 of 1
 Project Manager: Jim Watchers

Jason D Stivar

Well ID mw-2
 Well Dia 4.0"

DTW Measurements
 Initial 21.31 ft Calc Well Volume = 13.49 gal
 Recha ft Well Volume = 4.49 gal
6.89 x .653

28.20

Purged Method	Pump Depth	ft
<input type="checkbox"/> Peristaltic	<input type="checkbox"/> Hand Balled	
<input type="checkbox"/> Gear Drive	<input type="checkbox"/> Air Lift	
<input checked="" type="checkbox"/> Submersible	<input type="checkbox"/> Other	

Instruments Used	
<input checked="" type="checkbox"/> YSI 3650 pH/C/mmbo	OMEGA Cond:
<input type="checkbox"/> HYDAC pH/F/umbo	DRT-15C TURBID
<input type="checkbox"/> OMEGA pH/C	Other

Pump on @ 1242 6 PM @ 1.2 Pump set @ 2650

TIME	TEMP	Conductivity	pH	PURGE VOLUME gallons	TURBIDITY	COMMENTS
	<input checked="" type="checkbox"/> C <input type="checkbox"/> F					
1246	9.1	449	8.52	5.0	N/A	Light Brown
1250	9.2	450	8.46	10.0	N/A	Light Brown
1254	9.4	448	8.45	15.0	N/A	Light Brown

Project Name: Chr. Harrison
 Project Number: 020204081.0610
 Site Address: 1633 Harrison Oakland

Date: 12-16-93
 Page 1 of 1
 Project Manager: Jim Watchers

Jason D Stinar

Well ID: MW-3
 Well Dia: 4.0"

DTW Measurements
 Initial 21.0 ft Calc Well Volume = 21.15 gal
 Recharge 10.80 ft Well Volume = 7.05 gal
10.80 x 2/3 = 6.53

31.80

Purged Method	Pump Depth	ft
<input type="checkbox"/> Peristaltic		
<input type="checkbox"/> Gear Drive		Hand Bailed
<input checked="" type="checkbox"/> Submersible		Air Lift
		Other

<input checked="" type="checkbox"/> Instruments Used
YSI 3650 pH/C/m/mbo
HYDAC pH/F/umbo
OMEGA pH/C
OMEGA Cond.
DRT-15C TURBID
Other

Pump on @ 1148 6PM @ 2.3 Pump off @ 30.00

TIME	TEMP	Conductivity	pH	PURGE VOLUME gallons	TURBIDITY	COMMENTS
	C F					
1151	8.2	608	8.70	8.00	N/A	Light Brown
1154	8.2	611	8.64	16.00	N/A	LIGHT BROWN
1157	8.4	615	8.58	23.00	N/A	LIGHT BROWN

Project Name: Chr. Harrison
 Project Number: 020204081.0610
 Site Address: 1633 Harrison Oakland

Date: 12-16-93
 Page 1 of 1
 Project Manager: Jim Watchers

Well ID: mw-4
 Well Dia: 4.0"

DTW Measurements
 Initial 21.89 ft Calc Well Volume = 22.6 gal
 Recha 11.51 x .653 ft Well Volume = 7.52 gal

33.40'

Purged Method	Pump Depth	ft
<input type="checkbox"/> Peristaltic	<input checked="" type="checkbox"/>	Hand Bailed
<input type="checkbox"/> Gear Drive		Air Lift
<input type="checkbox"/> Submersible		Other

Instruments Used	
<input checked="" type="checkbox"/> YSI 3650 pH/C/m/mbo	OMEGA Cond.
<input type="checkbox"/> HYDAC pH/F/umbo	DRT-15C TURBID
<input type="checkbox"/> OMEGA pH/C	Other

Jason D Stinar

TIME	TEMP	Conductivity	pH	PURGE VOLUME gallons	TURBIDITY	COMMENTS
	<input checked="" type="checkbox"/> C <input type="checkbox"/> F					
1017	15.0	673	7.69	12.0	N/A	Blown H ₂ O
1023	17.4	701	7.85	17.0	N/A	"
1029	16.9	686	7.92	24.0	N/A	"

Project Name: Chv. Harrison
 Project Number: 020204081.0610
 Site Address: 1633 Harrison Oakland
Clayton Gonzales

Date: 12-16-93
 Page 1 of 1
 Project Manager: Jim Watchers

Well ID mw-11
 Well Dia 2.0"

DTW Measurements
 Initial 20.73 ft Calc Well Volume = 2.2 gal
 Recha ft Well Volume = 74 gal

25.30

4.57 x .163

Purged Method	Pump Depth	_____ ft
<input type="checkbox"/> Peristaltic	<input checked="" type="checkbox"/> Hand Bailed	
<input type="checkbox"/> Gear Drive	<input type="checkbox"/> Air Lift	
<input type="checkbox"/> Submersible	<input type="checkbox"/> Other	

Instruments Used	
<input checked="" type="checkbox"/> YSI 3650 pH/C/m/mbo	OMEGA Cond:
<input type="checkbox"/> HYDAC pH/F/umbo	DRT-15C TURBID
<input type="checkbox"/> OMEGA pH/C	Other

TIME	TEMP	Conductivity	pH	PURGE VOLUME gallons	TURBIDITY	COMMENTS
	<u>4</u> C F					
11:25	18.8	.391	6.65	0.5	N/A	Murky water
11:26	18.7	.391	6.64	1	N/A	
11:27	18.7	.391	6.65	2.2	N/A	

ATTACHMENT 4

Laboratory Report





Northwest Region

4080-C Pike Lane
Concord, CA 94520
(510) 685-7852
(800) 544-3422 from inside California
(800) 423-7143 from outside California
(510) 825-0720 (FAX)

Client Number: 020204084
Consultant Project Number: 020204084
Facility Number: 9-0020
Project ID: 1633 Harrison Street
Oakland
Work Order Number: C3-12-0349

January 5, 1994

Tim Watchers
Groundwater Technology, Inc.
4057 Port Chicago Hwy.
Concord, CA 94520

Enclosed please find the analytical results for samples received by GTEL Environmental Laboratories, Inc. on 12/20/93.

A formal Quality Assurance/Quality Control (QA/QC) program is maintained by GTEL, which is designed to meet or exceed the EPA requirements. Analytical work for this project met QA/QC criteria, unless otherwise stated in the footnotes.

GTEL is certified by the California State Department of Health Services, Laboratory certification number E1075, to perform analyses for drinking water, wastewater, and hazardous waste materials according to EPA protocols.

If you have any questions concerning this analysis or if we can be of further assistance, please call our Customer Service Representative.

Sincerely,
GTEL Environmental Laboratories, Inc.

A handwritten signature in cursive script that reads "Bill Smitola".

for

Rashmi Shah
Laboratory Director

Client Number: 020204084
 Consultant Project Number: 020204084
 Facility Number: 9-0020
 Project ID: 1633 Harrison Street
 Oakland
 Work Order Number: C3-12-0349

Table 1

ANALYTICAL RESULTS

**Aromatic Volatile Organics and
 Total Petroleum Hydrocarbons as Gasoline in Water**

EPA Methods 5030, 8020, and Modified 8015^a

GTEL Sample Number		01	02	03	05
Client Identification		TBLB	RBMW4	MW4	MW1
Date Sampled		12/17/93	12/17/93	12/17/93	12/17/93
Date Analyzed		12/29/93	12/29/93	12/29/93	12/29/93
Analyte	Detection Limit, ug/L	Concentration, ug/L			
Benzene	0.5	<0.5	<0.5	<0.5	<0.5
Toluene	0.5	<0.5	<0.5	<0.5	<0.5
Ethylbenzene	0.5	<0.5	<0.5	<0.5	<0.5
Xylene, total	0.5	<0.5	<0.5	<0.5	<0.5
TPH as Gasoline	50	<50	<50	<50	<50
Detection Limit Multiplier		1	1	1	1
BFB surrogate, % recovery		99.3	98.3	98.6	98.4

a. Test Methods for Evaluating Solid Waste, SW-846, Third Edition, Revision 0, US EPA November 1986. Modification for TPH as gasoline as per California State Water Resources Control Board LUFT Manual protocols, May 1988 revision. Bromofluorobenzene surrogate recovery acceptability limits are 70 - 130%.

Client Number: 020204084
 Consultant Project Number: 020204084
 Facility Number: 9-0020
 Project ID: 1633 Harrison Street
 Oakland
 Work Order Number: C3-12-0349

Table 1 (Continued)

ANALYTICAL RESULTS

**Aromatic Volatile Organics and
 Total Petroleum Hydrocarbons as Gasoline in Water**

EPA Methods 5030, 8020, and Modified 8015^a

GTEL Sample Number		07 ^b	09 ^b	11	13
Client Identification		MW3	MW11	MW15	MW10
Date Sampled		12/17/93	12/17/93	12/17/93	12/17/93
Date Analyzed		12/29/93	12/29/93	12/29/93	12/29/93
Analyte	Detection Limit, ug/L	Concentration, ug/L			
Benzene	0.5	<0.5	<0.5	<0.5	<0.5
Toluene	0.5	<0.5	<0.5	<0.5	<0.5
Ethylbenzene	0.5	<0.5	<0.5	<0.5	<0.5
Xylene, total	0.5	<0.5	<0.5	<0.5	<0.5
TPH as Gasoline	50	<50	<50	<50	<50
Detection Limit Multiplier		1	1	1	1
BFB surrogate, % recovery		98.0	98.4	98.9	99.2

- a. Test Methods for Evaluating Solid Waste, SW-846, Third Edition, Revision 0, US EPA November 1986. Modification for TPH as gasoline as per California State Water Resources Control Board LUFT Manual protocols, May 1988 revision. Bromofluorobenzene surrogate recovery acceptability limits are 70 - 130%.
- b. Uncategorized compound is not included in the gasoline hydrocarbon concentration.

Client Number: 020204084
 Consultant Project Number: 020204084
 Facility Number: 9-0020
 Project ID: 1633 Harrison Street
 Oakland
 Work Order Number: C3-12-0349

Table 1 (Continued)

ANALYTICAL RESULTS

**Aromatic Volatile Organics and
 Total Petroleum Hydrocarbons as Gasoline in Water**

EPA Methods 5030, 8020, and Modified 8015^a

GTEL Sample Number		15	17	19	Q122893
Client Identification		MW2	MW13	MW9	METHOD BLANK
Date Sampled		12/17/93	12/17/93	12/17/93	--
Date Analyzed		12/29/93	12/29/93	12/29/93	12/28/93
Analyte	Detection Limit, ug/L	Concentration, ug/L			
Benzene	0.5	<0.5	43	92	<0.5
Toluene	0.5	<0.5	12	85	<0.5
Ethylbenzene	0.5	<0.5	12	180	<0.5
Xylene, total	0.5	<0.5	37	300	<0.5
TPH as Gasoline	50	<50	640	4600	<50
Detection Limit Multiplier		1	1	1	1
BFB surrogate, % recovery		98.4	87.1	104	96.0

a. Test Methods for Evaluating Solid Waste, SW-846, Third Edition, Revision 0, US EPA November 1986. Modification for TPH as gasoline as per California State Water Resources Control Board LUFT Manual protocols, May 1988 revision. Bromofluorobenzene surrogate recovery acceptability limits are 70 - 130%.

Client Number: 020204084
Consultant Project Number: 020204084
Facility Number: 9-0020
Project ID: 1633 Harrison Street
Oakland
Work Order Number: C3-12-0349

QC Matrix Spike and Duplicate Spike Results

Matrix: Water

Analyte	Sample ID	Spike Amount	Units	Recovery, %	Duplicate Recovery, %	RPD, %	Control Limits
Modified EPA 8020:							
Benzene	C3120335-03	20	ug/L	100	104	3.92	55 - 129
Toluene	C3120335-03	20	ug/L	99.5	103	3.45	72 - 149
Ethylbenzene	C3120335-03	20	ug/L	97.0	101	4.04	75 - 138
Xylene, total	C3120335-03	60	ug/L	101	106	4.85	74 - 147

Fax copy of Lab Report and COC to Chevron Contact: Yes No

Chain-of-Custody-Report

Chevron U.S.A. Inc. P.O. BOX 5004 San Ramon, CA 94583 FAX (415)842-9591	Chevron Facility Number <u>9-0020</u> Facility Address <u>1633 Harrison St Oakland</u> Consultant Project Number <u>020204054.0610</u> Consultant Name <u>Mumudwater Technology</u> Address <u>4057 Port Chicago Hwy Concord</u> Project Contact (Name) <u>Jim Waters</u> (Phone) <u>671-2387</u> (Fax Number) _____	Chevron Contact (Name) _____ (Phone) _____ Laboratory Name <u>GTEL</u> Laboratory Release Number _____ Samples Collected by (Name) <u>Clayton Gonzales / Jason Stolar</u> Collection Date <u>12-17-93</u> Signature <u>Clayton Gonzales</u>
--	--	---

Sample Number	Lab Sample Number	Number of Containers	Matrix S = Soil W = Water A = Air C = Charcoal	Type G = Grab C = Composite D = Discrete	Time	Sample Preservation	Iod (Yes or No)	Analytes To Be Performed											Remarks				
								BTEX + TPH GAS (8020 + 8015)	TPH Diesel (8015)	Oil and Grease (5520)	Purgeable Halocarbons (8010)	Purgeable Aromatics (8020)	Purgeable Organics (8240)	Extractable Organics (8270)	Metals Cd, Cr, Pb, Zn, Ni (ICAP or AA)	Hold							
✓ TBLB	01	21	W			HCL	Y	X															
✓ RBW4	02	1		G	10:33			X															
✓ MW4	03	3			10:33			X															
RBW1	04	1			11:35																	X	
✓ MW1	05	3			11:40			X															
RBW3	06	1			11:59																	X	
✓ MW3	07	3			11:59			X															
RBW11	08	1			11:40																	X	
✓ MW11	09	3			11:45			X															
RBW5	10	1			12:40																	X	
✓ MW15	11	3			12:45			X															
RBW10	12	1			1:10																	X	C3120349
✓ MW10	13	3			1:15			X															D Box T Box

NOTE:
 Do NOT BILL
 TB-LB SAMPLE
 SEAR INFEAT
 ON ICSEAT SE

Relinquished By (Signature) <u>Jason Stolar</u>	Organization <u>GTE</u>	Date/Time <u>12/17/93</u>	Received By (Signature) <u>R.A. Shenna</u>	Organization <u>GTE</u>	Date/Time <u>12/18/93</u>	Turn Around Time (Circle Choice) <input type="checkbox"/> 24 Hrs. <input type="checkbox"/> 48 Hrs. <input type="checkbox"/> 5 Days <input type="checkbox"/> 10 Days <input type="checkbox"/> As Contracted
Relinquished By (Signature) <u>R.A. Shenna</u>	Organization <u>GTE</u>	Date/Time <u>12/20/93</u>	Received By (Signature) <u>Jim Waters</u>	Organization <u>GTEL</u>	Date/Time <u>12/20/93</u>	
Relinquished By (Signature)	Organization	Date/Time	Received For Laboratory (Signature)		Date/Time	

