

Detterman, Mark, Env. Health

From: Lee, Nathan [nlee@croworld.com]
Sent: Friday, January 07, 2011 11:52 AM
To: Detterman, Mark, Env. Health
Cc: Patten, David R.
Subject: 9-0020 Debris Pit Confirmation Samples
Attachments: 311956-Debris Pit Sampling Location (2).pdf; 311956-Analyticals by Lancaster.pdf; 311956-Analyticals by McCambell (1).pdf

Mark,

As you requested attached is the site field map showing the sampling locations that were submitted to be analyzed and the analytical reports that we have received so far. The results are for the samples collected from the side walls and bottom of the debris pit and the sample collected in the area of the former Used-Oil UST excavation (Sample EX-9).

The field figure also shows the sample locations collected from the stock pile and the sample collect from under the piping that was collected yesterday. These results will be ready sometime later today.

Nathan Lee, P.G.
Conestoga-Rovers & Associates (CRA)

5900 Hollis Street, Suite A
Emeryville, CA 94608

Phone: 510.420.3333

Fax: 510.420.9170

Cell: 510.385.2499

Email: nlee@CRAworld.com

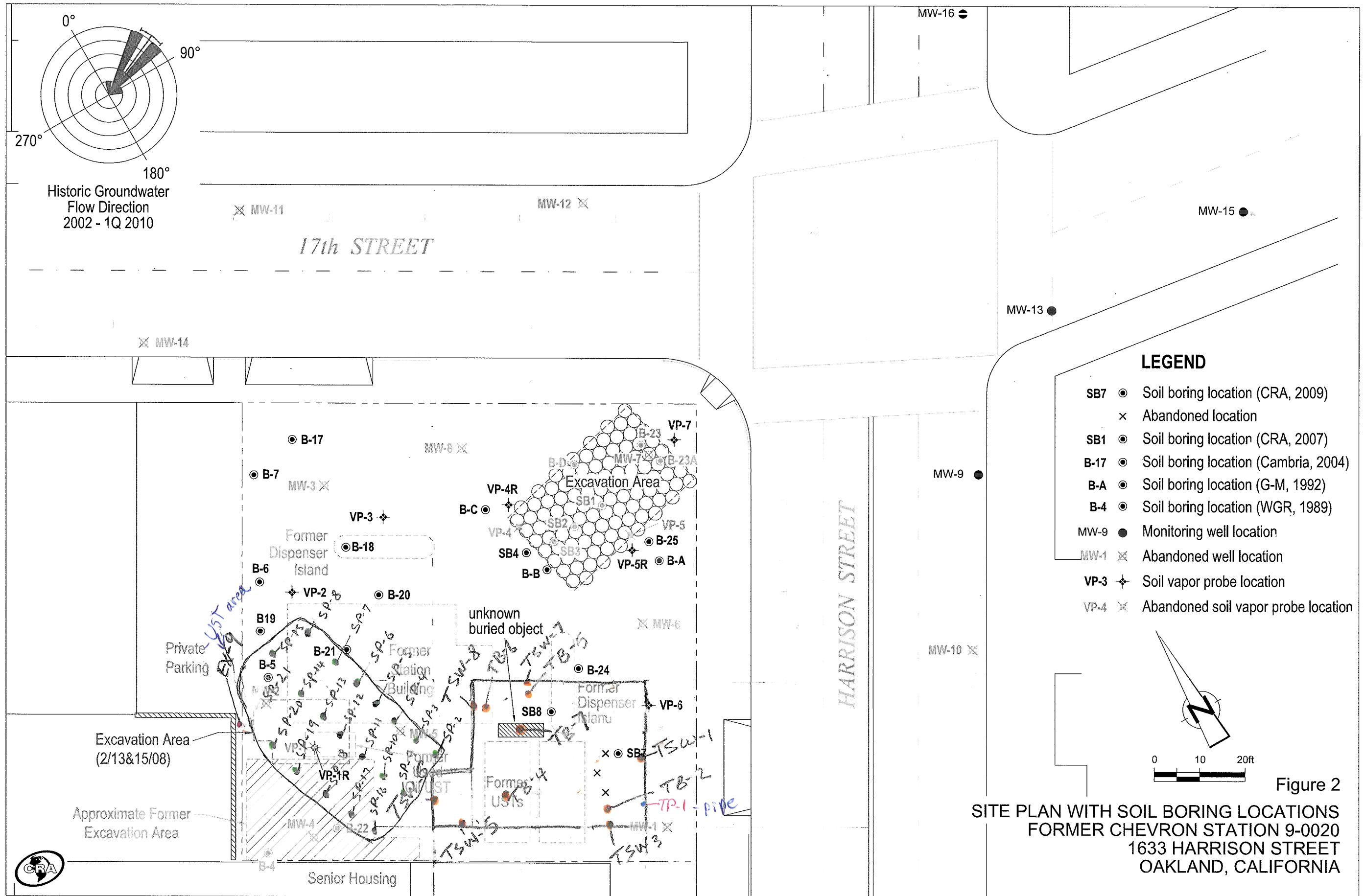

Figure 2
 SITE PLAN WITH SOIL BORING LOCATIONS
 FORMER CHEVRON STATION 9-0020
 1633 HARRISON STREET
 OAKLAND, CALIFORNIA

ANALYTICAL RESULTS

Prepared by:

Lancaster Laboratories
2425 New Holland Pike
Lancaster, PA 17605-2425

Prepared for:

ChevronTexaco
6001 Bollinger Canyon Rd L4310
San Ramon CA 94583

January 06, 2011

Project: 90020

Submittal Date: 01/05/2011
Group Number: 1227819
PO Number: 0015061031
Release Number: PATTEN
State of Sample Origin: CAClient Sample DescriptionTSW-1-S-11-110103 Grab Soil
TSW-3-S-11-110104 Grab Soil
TSW-5-S-9-110104 Grab Soil
TSW-6-S-9-110104 Grab Soil
TB-2-S-10.5-110104 Grab Soil
TB-4-S-10-110104 Grab Soil
EX-9-S-5-110104 Grab SoilLancaster Labs (LLI) #6177762
6177763
6177764
6177765
6177766
6177767
6177768

The specific methodologies used in obtaining the enclosed analytical results are indicated on the Laboratory Sample Analysis Record.

ELECTRONIC COPY TO
Chevron

Attn: CRA EDD

ELECTRONIC COPY TO
CRA

Attn: Nathan Lee

ELECTRONIC COPY TO
Conestoaga-Rovers & Associates

Attn: Belew Yifru

Questions? Contact your Client Services Representative
Natalie R Luciano at (717) 656-2300 Ext. 1881

Respectfully Submitted,



Robin C. Runkle
Senior Specialist



Analysis Report

2425 New Holland Pike, PO Box 12425, Lancaster, PA 17605-2425 • 717-656-2300 Fax: 717-656-2681 • www.lancasterlabs.com

Sample Description: TSW-1-S-11-110103 Grab Soil
Facility# 90020 CRAW
 1633 Harrison St-Oakland T0600100304 TSW-1

LLI Sample # SW 6177762
LLI Group # 1227819
Account # 10880

Project Name: 90020

Collected: 01/03/2011 11:30

ChevronTexaco

Submitted: 01/05/2011 09:00

6001 Bollinger Canyon Rd L4310

Reported: 01/06/2011 16:57

San Ramon CA 94583

HSO01

| CAT No. | Analysis Name | CAS Number | As Received Result | As Received Method Detection Limit* | As Received Limit of Quantitation | Dilution Factor |
|------------------------------------|-------------------------------|------------|--------------------|-------------------------------------|-----------------------------------|-----------------|
| GC/MS Volatiles | | | | | | |
| 10950 | Benzene | 71-43-2 | N.D. | 0.0005 | 0.005 | 0.99 |
| 10950 | Ethylbenzene | 100-41-4 | N.D. | 0.001 | 0.005 | 0.99 |
| 10950 | Methyl Tertiary Butyl Ether | 1634-04-4 | N.D. | 0.0005 | 0.005 | 0.99 |
| 10950 | Toluene | 108-88-3 | N.D. | 0.001 | 0.005 | 0.99 |
| 10950 | Xylene (Total) | 1330-20-7 | N.D. | 0.001 | 0.005 | 0.99 |
| GC Volatiles | | | | | | |
| 01725 | TPH-GRO N. CA soil C6-C12 | n.a. | N.D. | 1.0 | 1.0 | 25.85 |
| GC Extractable TPH w/Si Gel | | | | | | |
| 02222 | TPH-DRO soil C10-C28 w/Si Gel | n.a. | 20 | 4.0 | 12 | 1 |

General Sample Comments

State of California Lab Certification No. 2501

All QC is compliant unless otherwise noted. Please refer to the Quality Control Summary for overall QC performance data and associated samples.

Laboratory Sample Analysis Record

| CAT No. | Analysis Name | Method | Trial# | Batch# | Analysis Date and Time | Analyst | Dilution Factor |
|---------|-------------------------------|-----------------------|--------|--------------|------------------------|-------------------|-----------------|
| 10950 | BTEX/MTBE 8260 Soil | SW-846 8260B | 1 | B110051AA | 01/05/2011 17:00 | Laura M Krieger | 0.99 |
| 00374 | GC/MS - Bulk Sample Prep | SW-846 5030A | 1 | 201100523446 | 01/05/2011 14:52 | Larry E Bevins | n.a. |
| 00374 | GC/MS - Bulk Sample Prep | SW-846 5030A | 2 | 201100523446 | 01/05/2011 14:52 | Larry E Bevins | n.a. |
| 06646 | GC/MS HL Bulk Sample Prep | SW-846 5030A | 1 | 201100523446 | 01/05/2011 14:28 | Larry E Bevins | n.a. |
| 01725 | TPH-GRO N. CA soil C6-C12 | SW-846 8015B modified | 1 | 11006A34A | 01/06/2011 11:55 | Elizabeth J Marin | 25.85 |
| 01150 | GC - Bulk Soil Prep | SW-846 5030A | 1 | 201100523446 | 01/05/2011 14:28 | Larry E Bevins | n.a. |
| 02222 | TPH-DRO soil C10-C28 w/Si Gel | SW-846 8015B | 1 | 110050014A | 01/06/2011 11:13 | Melissa McDermott | 1 |
| 11210 | DRO by 8015 Microwave w/ SG | SW-846 3550B | 1 | 110050014A | 01/05/2011 17:40 | Sally L Appleyard | 1 |

*=This limit was used in the evaluation of the final result



Analysis Report

2425 New Holland Pike, PO Box 12425, Lancaster, PA 17605-2425 • 717-656-2300 Fax: 717-656-2681 • www.lancasterlabs.com

Sample Description: TSW-3-S-11-110104 Grab Soil
Facility# 90020 CRAW
1633 Harrison St-Oakland T0600100304 TSW-3

LLI Sample # SW 6177763
LLI Group # 1227819
Account # 10880

Project Name: 90020

Collected: 01/04/2011 09:00

ChevronTexaco

Submitted: 01/05/2011 09:00

6001 Bollinger Canyon Rd L4310

Reported: 01/06/2011 16:57

San Ramon CA 94583

HSO03

| CAT No. | Analysis Name | CAS Number | As Received Result | As Received Method Detection Limit* | As Received Limit of Quantitation | Dilution Factor |
|---|-------------------------------|------------|--------------------|-------------------------------------|-----------------------------------|-----------------|
| GC/MS Volatiles SW-846 8260B | | | | | | |
| 10950 | Benzene | 71-43-2 | N.D. | 0.0005 | 0.005 | 1.05 |
| 10950 | Ethylbenzene | 100-41-4 | N.D. | 0.001 | 0.005 | 1.05 |
| 10950 | Methyl Tertiary Butyl Ether | 1634-04-4 | N.D. | 0.0005 | 0.005 | 1.05 |
| 10950 | Toluene | 108-88-3 | N.D. | 0.001 | 0.005 | 1.05 |
| 10950 | Xylene (Total) | 1330-20-7 | N.D. | 0.001 | 0.005 | 1.05 |
| GC Volatiles SW-846 8015B modified | | | | | | |
| 01725 | TPH-GRO N. CA soil C6-C12 | n.a. | N.D. | 1 | 1 | 23.83 |
| GC Extractable TPH SW-846 8015B | | | | | | |
| w/Si Gel | | | | | | |
| 02222 | TPH-DRO soil C10-C28 w/Si Gel | n.a. | 27 | 4.0 | 12 | 1 |

General Sample Comments

State of California Lab Certification No. 2501

All QC is compliant unless otherwise noted. Please refer to the Quality Control Summary for overall QC performance data and associated samples.

Laboratory Sample Analysis Record

| CAT No. | Analysis Name | Method | Trial# | Batch# | Analysis Date and Time | Analyst | Dilution Factor |
|---------|-------------------------------|-----------------------|--------|--------------|------------------------|-------------------|-----------------|
| 10950 | BTEX/MTBE 8260 Soil | SW-846 8260B | 1 | B110051AA | 01/05/2011 17:22 | Laura M Krieger | 1.05 |
| 00374 | GC/MS - Bulk Sample Prep | SW-846 5030A | 1 | 201100523446 | 01/05/2011 14:52 | Larry E Bevins | n.a. |
| 00374 | GC/MS - Bulk Sample Prep | SW-846 5030A | 2 | 201100523446 | 01/05/2011 14:52 | Larry E Bevins | n.a. |
| 06646 | GC/MS HL Bulk Sample Prep | SW-846 5030A | 1 | 201100523446 | 01/05/2011 14:32 | Larry E Bevins | n.a. |
| 01725 | TPH-GRO N. CA soil C6-C12 | SW-846 8015B modified | 1 | 11006A34A | 01/06/2011 12:31 | Elizabeth J Marin | 23.83 |
| 01150 | GC - Bulk Soil Prep | SW-846 5030A | 1 | 201100523446 | 01/05/2011 14:32 | Larry E Bevins | n.a. |
| 02222 | TPH-DRO soil C10-C28 w/Si Gel | SW-846 8015B | 1 | 110050014A | 01/06/2011 07:33 | Melissa McDermott | 1 |
| 11210 | DRO by 8015 Microwave w/ SG | SW-846 3550B | 1 | 110050014A | 01/05/2011 17:40 | Sally L Appleyard | 1 |

*=This limit was used in the evaluation of the final result



Analysis Report

2425 New Holland Pike, PO Box 12425, Lancaster, PA 17605-2425 • 717-656-2300 Fax: 717-656-2681 • www.lancasterlabs.com

Sample Description: TSW-5-S-9-110104 Grab Soil
Facility# 90020 CRAW
 1633 Harrison St-Oakland T0600100304 TSW-5

LLI Sample # SW 6177764
LLI Group # 1227819
Account # 10880

Project Name: 90020

Collected: 01/04/2011 09:55

ChevronTexaco

Submitted: 01/05/2011 09:00

6001 Bollinger Canyon Rd L4310

Reported: 01/06/2011 16:57

San Ramon CA 94583

HSO05

| CAT No. | Analysis Name | CAS Number | As Received Result | As Received Method Detection Limit* | As Received Limit of Quantitation | Dilution Factor |
|---|-------------------------------|------------|--------------------|-------------------------------------|-----------------------------------|-----------------|
| GC/MS Volatiles SW-846 8260B | | | | | | |
| 10950 | Benzene | 71-43-2 | N.D. | 0.0005 | 0.005 | 1.05 |
| 10950 | Ethylbenzene | 100-41-4 | N.D. | 0.001 | 0.005 | 1.05 |
| 10950 | Methyl Tertiary Butyl Ether | 1634-04-4 | N.D. | 0.0005 | 0.005 | 1.05 |
| 10950 | Toluene | 108-88-3 | N.D. | 0.001 | 0.005 | 1.05 |
| 10950 | Xylene (Total) | 1330-20-7 | N.D. | 0.001 | 0.005 | 1.05 |
| GC Volatiles SW-846 8015B modified | | | | | | |
| 01725 | TPH-GRO N. CA soil C6-C12 | n.a. | N.D. | 1.0 | 1.0 | 25.48 |
| GC Extractable TPH SW-846 8015B | | | | | | |
| w/Si Gel | | | | | | |
| 02222 | TPH-DRO soil C10-C28 w/Si Gel | n.a. | 42 | 8.0 | 24 | 2 |

General Sample Comments

State of California Lab Certification No. 2501

All QC is compliant unless otherwise noted. Please refer to the Quality Control Summary for overall QC performance data and associated samples.

Laboratory Sample Analysis Record

| CAT No. | Analysis Name | Method | Trial# | Batch# | Analysis Date and Time | Analyst | Dilution Factor |
|---------|-------------------------------|-----------------------|--------|--------------|------------------------|-------------------|-----------------|
| 10950 | BTEX/MTBE 8260 Soil | SW-846 8260B | 1 | B110051AA | 01/05/2011 17:44 | Laura M Krieger | 1.05 |
| 00374 | GC/MS - Bulk Sample Prep | SW-846 5030A | 1 | 201100523446 | 01/05/2011 14:52 | Larry E Bevins | n.a. |
| 00374 | GC/MS - Bulk Sample Prep | SW-846 5030A | 2 | 201100523446 | 01/05/2011 14:52 | Larry E Bevins | n.a. |
| 06646 | GC/MS HL Bulk Sample Prep | SW-846 5030A | 1 | 201100523446 | 01/05/2011 14:35 | Larry E Bevins | n.a. |
| 01725 | TPH-GRO N. CA soil C6-C12 | SW-846 8015B modified | 1 | 11006A34A | 01/06/2011 13:08 | Elizabeth J Marin | 25.48 |
| 01150 | GC - Bulk Soil Prep | SW-846 5030A | 1 | 201100523446 | 01/05/2011 14:36 | Larry E Bevins | n.a. |
| 02222 | TPH-DRO soil C10-C28 w/Si Gel | SW-846 8015B | 1 | 110050014A | 01/06/2011 08:16 | Melissa McDermott | 2 |
| 11210 | DRO by 8015 Microwave w/ SG | SW-846 3550B | 1 | 110050014A | 01/05/2011 17:40 | Sally L Appleyard | 1 |

*=This limit was used in the evaluation of the final result



Analysis Report

2425 New Holland Pike, PO Box 12425, Lancaster, PA 17605-2425 • 717-656-2300 Fax: 717-656-2681 • www.lancasterlabs.com

Sample Description: TSW-6-S-9-110104 Grab Soil
Facility# 90020 CRAW
 1633 Harrison St-Oakland T0600100304 TSW-6

LLI Sample # SW 6177765
LLI Group # 1227819
Account # 10880

Project Name: 90020

Collected: 01/04/2011 10:00

ChevronTexaco

Submitted: 01/05/2011 09:00

6001 Bollinger Canyon Rd L4310

Reported: 01/06/2011 16:57

San Ramon CA 94583

HSO06

| CAT No. | Analysis Name | CAS Number | As Received Result | As Received Method Detection Limit* | As Received Limit of Quantitation | Dilution Factor |
|------------------------------------|-------------------------------|------------|--------------------|-------------------------------------|-----------------------------------|-----------------|
| GC/MS Volatiles | | | | | | |
| | SW-846 8260B | | mg/kg | mg/kg | mg/kg | |
| 10950 | Benzene | 71-43-2 | N.D. | 0.0005 | 0.005 | 1.03 |
| 10950 | Ethylbenzene | 100-41-4 | N.D. | 0.001 | 0.005 | 1.03 |
| 10950 | Methyl Tertiary Butyl Ether | 1634-04-4 | N.D. | 0.0005 | 0.005 | 1.03 |
| 10950 | Toluene | 108-88-3 | N.D. | 0.001 | 0.005 | 1.03 |
| 10950 | Xylene (Total) | 1330-20-7 | N.D. | 0.001 | 0.005 | 1.03 |
| GC Volatiles | | | | | | |
| | SW-846 8015B modified | | mg/kg | mg/kg | mg/kg | |
| 01725 | TPH-GRO N. CA soil C6-C12 | n.a. | N.D. | 1 | 1 | 24.2 |
| GC Extractable TPH w/Si Gel | | | | | | |
| | SW-846 8015B | | mg/kg | mg/kg | mg/kg | |
| 02222 | TPH-DRO soil C10-C28 w/Si Gel | n.a. | N.D. | 4.0 | 12 | 1 |

General Sample Comments

State of California Lab Certification No. 2501

All QC is compliant unless otherwise noted. Please refer to the Quality Control Summary for overall QC performance data and associated samples.

Laboratory Sample Analysis Record

| CAT No. | Analysis Name | Method | Trial# | Batch# | Analysis Date and Time | Analyst | Dilution Factor |
|---------|-------------------------------|-----------------------|--------|--------------|------------------------|-------------------|-----------------|
| 10950 | BTEX/MTBE 8260 Soil | SW-846 8260B | 1 | B110051AA | 01/05/2011 18:07 | Laura M Krieger | 1.03 |
| 00374 | GC/MS - Bulk Sample Prep | SW-846 5030A | 1 | 201100523446 | 01/05/2011 14:52 | Larry E Bevins | n.a. |
| 00374 | GC/MS - Bulk Sample Prep | SW-846 5030A | 2 | 201100523446 | 01/05/2011 14:52 | Larry E Bevins | n.a. |
| 06646 | GC/MS HL Bulk Sample Prep | SW-846 5030A | 1 | 201100523446 | 01/05/2011 14:38 | Larry E Bevins | n.a. |
| 01725 | TPH-GRO N. CA soil C6-C12 | SW-846 8015B modified | 1 | 11006A34A | 01/06/2011 13:43 | Elizabeth J Marin | 24.2 |
| 01150 | GC - Bulk Soil Prep | SW-846 5030A | 1 | 201100523446 | 01/05/2011 14:39 | Larry E Bevins | n.a. |
| 02222 | TPH-DRO soil C10-C28 w/Si Gel | SW-846 8015B | 1 | 110050014A | 01/06/2011 09:23 | Melissa McDermott | 1 |
| 11210 | DRO by 8015 Microwave w/ SG | SW-846 3550B | 1 | 110050014A | 01/05/2011 17:40 | Sally L Appleyard | 1 |

*=This limit was used in the evaluation of the final result



Analysis Report

2425 New Holland Pike, PO Box 12425, Lancaster, PA 17605-2425 • 717-656-2300 Fax: 717-656-2681 • www.lancasterlabs.com

Sample Description: TB-2-S-10.5-110104 Grab Soil
Facility# 90020 CRAW
1633 Harrison St-Oakland T0600100304 TB-2

LLI Sample # SW 6177766
LLI Group # 1227819
Account # 10880

Project Name: 90020

Collected: 01/04/2011 09:05

ChevronTexaco

Submitted: 01/05/2011 09:00

6001 Bollinger Canyon Rd L4310

Reported: 01/06/2011 16:57

San Ramon CA 94583

HSO02

| CAT No. | Analysis Name | CAS Number | As Received Result | As Received Method Detection Limit* | As Received Limit of Quantitation | Dilution Factor |
|------------------------------------|-------------------------------|------------|--------------------|-------------------------------------|-----------------------------------|-----------------|
| GC/MS Volatiles | | | | | | |
| 10950 | Benzene | 71-43-2 | N.D. | 0.0005 | 0.005 | 1.09 |
| 10950 | Ethylbenzene | 100-41-4 | N.D. | 0.001 | 0.005 | 1.09 |
| 10950 | Methyl Tertiary Butyl Ether | 1634-04-4 | N.D. | 0.0005 | 0.005 | 1.09 |
| 10950 | Toluene | 108-88-3 | N.D. | 0.001 | 0.005 | 1.09 |
| 10950 | Xylene (Total) | 1330-20-7 | N.D. | 0.001 | 0.005 | 1.09 |
| GC Volatiles | | | | | | |
| 01725 | TPH-GRO N. CA soil C6-C12 | n.a. | N.D. | 1.0 | 1.0 | 25.64 |
| GC Extractable TPH w/Si Gel | | | | | | |
| 02222 | TPH-DRO soil C10-C28 w/Si Gel | n.a. | 53 | 4.0 | 12 | 1 |

General Sample Comments

State of California Lab Certification No. 2501

All QC is compliant unless otherwise noted. Please refer to the Quality Control Summary for overall QC performance data and associated samples.

Laboratory Sample Analysis Record

| CAT No. | Analysis Name | Method | Trial# | Batch# | Analysis Date and Time | Analyst | Dilution Factor |
|---------|-------------------------------|-----------------------|--------|--------------|------------------------|-------------------|-----------------|
| 10950 | BTEX/MTBE 8260 Soil | SW-846 8260B | 1 | B110051AA | 01/05/2011 18:52 | Laura M Krieger | 1.09 |
| 00374 | GC/MS - Bulk Sample Prep | SW-846 5030A | 1 | 201100523446 | 01/05/2011 14:52 | Larry E Bevins | n.a. |
| 00374 | GC/MS - Bulk Sample Prep | SW-846 5030A | 2 | 201100523446 | 01/05/2011 14:52 | Larry E Bevins | n.a. |
| 06646 | GC/MS HL Bulk Sample Prep | SW-846 5030A | 1 | 201100523446 | 01/05/2011 14:42 | Larry E Bevins | n.a. |
| 01725 | TPH-GRO N. CA soil C6-C12 | SW-846 8015B modified | 1 | 11006A34A | 01/06/2011 14:18 | Elizabeth J Marin | 25.64 |
| 01150 | GC - Bulk Soil Prep | SW-846 5030A | 1 | 201100523446 | 01/05/2011 14:43 | Larry E Bevins | n.a. |
| 02222 | TPH-DRO soil C10-C28 w/Si Gel | SW-846 8015B | 1 | 110050014A | 01/06/2011 07:55 | Melissa McDermott | 1 |
| 11210 | DRO by 8015 Microwave w/ SG | SW-846 3550B | 1 | 110050014A | 01/05/2011 17:40 | Sally L Appleyard | 1 |

*=This limit was used in the evaluation of the final result



Analysis Report

2425 New Holland Pike, PO Box 12425, Lancaster, PA 17605-2425 • 717-656-2300 Fax: 717-656-2681 • www.lancasterlabs.com

Sample Description: TB-4-S-10-110104 Grab Soil
Facility# 90020 CRAW
 1633 Harrison St-Oakland T0600100304 TB-4

LLI Sample # SW 6177767
LLI Group # 1227819
Account # 10880

Project Name: 90020

Collected: 01/04/2011 09:50

ChevronTexaco

Submitted: 01/05/2011 09:00

6001 Bollinger Canyon Rd L4310

Reported: 01/06/2011 16:57

San Ramon CA 94583

HSO04

| CAT No. | Analysis Name | CAS Number | As Received Result | As Received Method Detection Limit* | As Received Limit of Quantitation | Dilution Factor |
|------------------------------------|-------------------------------|------------|--------------------|-------------------------------------|-----------------------------------|-----------------|
| GC/MS Volatiles | | | | | | |
| 10950 | Benzene | 71-43-2 | N.D. | 0.0005 | 0.005 | 1.05 |
| 10950 | Ethylbenzene | 100-41-4 | N.D. | 0.001 | 0.005 | 1.05 |
| 10950 | Methyl Tertiary Butyl Ether | 1634-04-4 | N.D. | 0.0005 | 0.005 | 1.05 |
| 10950 | Toluene | 108-88-3 | N.D. | 0.001 | 0.005 | 1.05 |
| 10950 | Xylene (Total) | 1330-20-7 | N.D. | 0.001 | 0.005 | 1.05 |
| GC Volatiles | | | | | | |
| 01725 | TPH-GRO N. CA soil C6-C12 | n.a. | N.D. | 1.0 | 1.0 | 25.77 |
| GC Extractable TPH w/Si Gel | | | | | | |
| 02222 | TPH-DRO soil C10-C28 w/Si Gel | n.a. | N.D. | 4.0 | 12 | 1 |

General Sample Comments

State of California Lab Certification No. 2501

All QC is compliant unless otherwise noted. Please refer to the Quality Control Summary for overall QC performance data and associated samples.

Laboratory Sample Analysis Record

| CAT No. | Analysis Name | Method | Trial# | Batch# | Analysis Date and Time | Analyst | Dilution Factor |
|---------|-------------------------------|-----------------------|--------|--------------|------------------------|-------------------|-----------------|
| 10950 | BTEX/MTBE 8260 Soil | SW-846 8260B | 1 | B110051AA | 01/05/2011 19:14 | Laura M Krieger | 1.05 |
| 00374 | GC/MS - Bulk Sample Prep | SW-846 5030A | 1 | 201100523446 | 01/05/2011 14:52 | Larry E Bevins | n.a. |
| 00374 | GC/MS - Bulk Sample Prep | SW-846 5030A | 2 | 201100523446 | 01/05/2011 14:52 | Larry E Bevins | n.a. |
| 06646 | GC/MS HL Bulk Sample Prep | SW-846 5030A | 1 | 201100523446 | 01/05/2011 14:45 | Larry E Bevins | n.a. |
| 01725 | TPH-GRO N. CA soil C6-C12 | SW-846 8015B modified | 1 | 11006A34A | 01/06/2011 14:55 | Elizabeth J Marin | 25.77 |
| 01150 | GC - Bulk Soil Prep | SW-846 5030A | 1 | 201100523446 | 01/05/2011 14:46 | Larry E Bevins | n.a. |
| 02222 | TPH-DRO soil C10-C28 w/Si Gel | SW-846 8015B | 1 | 110050014A | 01/06/2011 09:45 | Melissa McDermott | 1 |
| 11210 | DRO by 8015 Microwave w/ SG | SW-846 3550B | 1 | 110050014A | 01/05/2011 17:40 | Sally L Appleyard | 1 |

*=This limit was used in the evaluation of the final result



Analysis Report

2425 New Holland Pike, PO Box 12425, Lancaster, PA 17605-2425 • 717-656-2300 Fax: 717-656-2681 • www.lancasterlabs.com

Sample Description: **EX-9-S-5-110104 Grab Soil**
Facility# **90020 CRAW**
1633 Harrison St-Oakland T0600100304 EX-9

LLI Sample # **SW 6177768**
LLI Group # **1227819**
Account # **10880**

Project Name: **90020**

Collected: 01/04/2011 10:50

ChevronTexaco

Submitted: 01/05/2011 09:00

6001 Bollinger Canyon Rd L4310

Reported: 01/06/2011 16:57

San Ramon CA 94583

HSO09

| CAT No. | Analysis Name | CAS Number | As Received Result | As Received Method Detection Limit* | As Received Limit of Quantitation | Dilution Factor |
|---|-------------------------------|------------|--------------------|-------------------------------------|-----------------------------------|-----------------|
| GC/MS Volatiles SW-846 8260B | | | | | | |
| 10950 | Benzene | 71-43-2 | N.D. | 0.0005 | 0.005 | 1.08 |
| 10950 | Ethylbenzene | 100-41-4 | N.D. | 0.001 | 0.005 | 1.08 |
| 10950 | Methyl Tertiary Butyl Ether | 1634-04-4 | N.D. | 0.0005 | 0.005 | 1.08 |
| 10950 | Toluene | 108-88-3 | N.D. | 0.001 | 0.005 | 1.08 |
| 10950 | Xylene (Total) | 1330-20-7 | N.D. | 0.001 | 0.005 | 1.08 |
| GC Volatiles SW-846 8015B modified | | | | | | |
| 01725 | TPH-GRO N. CA soil C6-C12 | n.a. | N.D. | 1 | 1 | 24.93 |
| GC Extractable TPH SW-846 8015B modified | | | | | | |
| 02516 | Total TPH | n.a. | N.D. | 10 | 30 | 1 |
| 02516 | TPH Motor Oil C16-C36 | n.a. | N.D. | 10 | 30 | 1 |
| TPH quantitation is based on peak area comparison of the sample pattern to that of a hydrocarbon component mix calibration in a range that includes C8 (n-octane) through C40 (n-tetracontane) normal hydrocarbons. | | | | | | |
| GC Extractable TPH SW-846 8015B | | | | | | |
| w/Si Gel | | | | | | |
| 02222 | TPH-DRO soil C10-C28 w/Si Gel | n.a. | N.D. | 4.0 | 12 | 1 |
| Metals SW-846 6010B | | | | | | |
| 06949 | Cadmium | 7440-43-9 | 0.550 | 0.135 | 0.481 | 1 |
| 06951 | Chromium | 7440-47-3 | 16.4 | 0.567 | 1.44 | 1 |
| 06955 | Lead | 7439-92-1 | 2.60 | 0.577 | 1.44 | 1 |
| 06961 | Nickel | 7440-02-0 | 84.2 | 0.183 | 0.962 | 1 |
| 06972 | Zinc | 7440-66-6 | 38.8 | 0.635 | 1.92 | 1 |

General Sample Comments

State of California Lab Certification No. 2501

All QC is compliant unless otherwise noted. Please refer to the Quality Control Summary for overall QC performance data and associated samples.

Laboratory Sample Analysis Record

| CAT No. | Analysis Name | Method | Trial# | Batch# | Analysis Date and Time | Analyst | Dilution Factor |
|---------|---------------------------|-----------------------|--------|--------------|------------------------|-------------------|-----------------|
| 10950 | BTEX/MTBE 8260 Soil | SW-846 8260B | 1 | B110051AA | 01/05/2011 20:43 | Laura M Krieger | 1.08 |
| 00374 | GC/MS - Bulk Sample Prep | SW-846 5030A | 1 | 201100523446 | 01/05/2011 14:52 | Larry E Bevins | n.a. |
| 00374 | GC/MS - Bulk Sample Prep | SW-846 5030A | 2 | 201100523446 | 01/05/2011 14:52 | Larry E Bevins | n.a. |
| 06646 | GC/MS HL Bulk Sample Prep | SW-846 5030A | 1 | 201100523446 | 01/05/2011 14:49 | Larry E Bevins | n.a. |
| 01725 | TPH-GRO N. CA soil C6-C12 | SW-846 8015B modified | 1 | 11006A34A | 01/06/2011 15:31 | Elizabeth J Marin | 24.93 |

*=This limit was used in the evaluation of the final result

Sample Description: EX-9-S-5-110104 Grab Soil
Facility# 90020 CRAW
 1633 Harrison St-Oakland T0600100304 EX-9

LLI Sample # SW 6177768
LLI Group # 1227819
Account # 10880

Project Name: 90020

Collected: 01/04/2011 10:50

ChevronTexaco

Submitted: 01/05/2011 09:00

6001 Bollinger Canyon Rd L4310

Reported: 01/06/2011 16:57

San Ramon CA 94583

HSO09

Laboratory Sample Analysis Record

| CAT No. | Analysis Name | Method | Trial# | Batch# | Analysis Date and Time | | Analyst | Dilution Factor |
|---------|-------------------------------|-----------------------|--------|--------------|------------------------|-------|--------------------|-----------------|
| | | | | | | | | |
| 01150 | GC - Bulk Soil Prep | SW-846 5030A | 1 | 201100523446 | 01/05/2011 | 14:50 | Larry E Bevins | n.a. |
| 02516 | TPH Fuels by GC (Soils) | SW-846 8015B modified | 1 | 110050015A | 01/06/2011 | 08:06 | Heather E Williams | 1 |
| 02222 | TPH-DRO soil C10-C28 w/Si Gel | SW-846 8015B | 1 | 110050014A | 01/06/2011 | 10:07 | Melissa McDermott | 1 |
| 11210 | DRO by 8015 Microwave w/ SG | SW-846 3550B | 1 | 110050014A | 01/05/2011 | 17:40 | Sally L Appleyard | 1 |
| 11218 | TPH Fuels Soils Extraction | SW-846 3550B | 1 | 110050015A | 01/05/2011 | 17:40 | Sally L Appleyard | 1 |
| 06949 | Cadmium | SW-846 6010B | 1 | 110055708002 | 01/06/2011 | 05:48 | Joanne M Gates | 1 |
| 06951 | Chromium | SW-846 6010B | 1 | 110055708002 | 01/06/2011 | 05:48 | Joanne M Gates | 1 |
| 06955 | Lead | SW-846 6010B | 1 | 110055708002 | 01/06/2011 | 09:33 | Joanne M Gates | 1 |
| 06961 | Nickel | SW-846 6010B | 1 | 110055708002 | 01/06/2011 | 05:48 | Joanne M Gates | 1 |
| 06972 | Zinc | SW-846 6010B | 1 | 110055708002 | 01/06/2011 | 05:48 | Joanne M Gates | 1 |
| 05708 | SW SW846 ICP Digest | SW-846 3050B | 1 | 110055708002 | 01/05/2011 | 19:30 | Mirit S Shenouda | 1 |

Quality Control Summary

 Client Name: ChevronTexaco
 Reported: 01/06/11 at 04:57 PM

Group Number: 1227819

Matrix QC may not be reported if site-specific QC samples were not submitted. In these situations, to demonstrate precision and accuracy at a batch level, a LCS/LCSD was performed, unless otherwise specified in the method.

Laboratory Compliance Quality Control

| <u>Analysis Name</u> | <u>Blank Result</u> | <u>Blank MDL**</u> | <u>Blank LOQ</u> | <u>Report Units</u> | <u>LCS %REC</u> | <u>LCSD %REC</u> | <u>LCS/LCSD Limits</u> | <u>RPD</u> | <u>RPD Max</u> |
|-------------------------------|-----------------------------------|--------------------|------------------|---------------------|-----------------|------------------|------------------------|------------|----------------|
| Batch number: B110051AA | Sample number(s): 6177762-6177768 | | | | | | | | |
| Benzene | N.D. | 0.0005 | 0.005 | mg/kg | 105 | 103 | 80-120 | 2 | 30 |
| Ethylbenzene | N.D. | 0.001 | 0.005 | mg/kg | 93 | 95 | 80-120 | 2 | 30 |
| Methyl Tertiary Butyl Ether | N.D. | 0.0005 | 0.005 | mg/kg | 98 | 101 | 74-121 | 4 | 30 |
| Toluene | N.D. | 0.001 | 0.005 | mg/kg | 95 | 94 | 80-120 | 2 | 30 |
| Xylene (Total) | N.D. | 0.001 | 0.005 | mg/kg | 95 | 98 | 80-120 | 3 | 30 |
| Batch number: 11006A34A | Sample number(s): 6177762-6177768 | | | | | | | | |
| TPH-GRO N. CA soil C6-C12 | N.D. | 1.0 | 1.0 | mg/kg | 97 | 95 | 67-119 | 2 | 30 |
| Batch number: 110050015A | Sample number(s): 6177768 | | | | | | | | |
| Total TPH | N.D. | 10. | 30 | mg/kg | 107 | | 72-125 | | |
| TPH Motor Oil C16-C36 | N.D. | 10. | 30 | mg/kg | | | | | |
| Batch number: 110050014A | Sample number(s): 6177762-6177768 | | | | | | | | |
| TPH-DRO soil C10-C28 w/Si Gel | N.D. | 4.0 | 12 | mg/kg | 103 | | 76-117 | | |
| Batch number: 110055708002 | Sample number(s): 6177768 | | | | | | | | |
| Cadmium | N.D. | 0.135 | 0.481 | mg/kg | 99 | | 90-114 | | |
| Chromium | N.D. | 0.567 | 1.44 | mg/kg | 97 | | 85-110 | | |
| Lead | N.D. | 0.577 | 1.44 | mg/kg | 96 | | 80-120 | | |
| Nickel | N.D. | 0.183 | 0.962 | mg/kg | 100 | | 90-114 | | |
| Zinc | N.D. | 0.635 | 1.92 | mg/kg | 96 | | 90-110 | | |

Sample Matrix Quality Control

Unspiked (UNSPK) = the sample used in conjunction with the matrix spike
 Background (BKG) = the sample used in conjunction with the duplicate

| <u>Analysis Name</u> | <u>MS %REC</u> | <u>MSD %REC</u> | <u>MS/MSD Limits</u> | <u>RPD</u> | <u>RPD MAX</u> | <u>BKG Conc</u> | <u>DUP Conc</u> | <u>DUP RPD</u> | <u>Dup RPD Max</u> |
|-----------------------------|---|-----------------|----------------------|------------|----------------|-----------------|-----------------|----------------|--------------------|
| Batch number: B110051AA | Sample number(s): 6177762-6177768 UNSPK: 6177763 | | | | | | | | |
| Benzene | 107 | | 55-143 | | | | | | |
| Ethylbenzene | 95 | | 44-141 | | | | | | |
| Methyl Tertiary Butyl Ether | 94 | | 55-129 | | | | | | |
| Toluene | 99 | | 50-146 | | | | | | |
| Xylene (Total) | 95 | | 44-136 | | | | | | |
| Batch number: 110050015A | Sample number(s): 6177768 UNSPK: 6177768 BKG: 6177768 | | | | | | | | |
| Total TPH | 101 | | 49-123 | | | N.D. | N.D. | 0 (1) | 20 |
| TPH Motor Oil C16-C36 | | | | | | N.D. | N.D. | 0 (1) | 20 |
| Batch number: 110050014A | Sample number(s): 6177762-6177768 UNSPK: 6177768 BKG: 6177768 | | | | | | | | |

*- Outside of specification

** - This limit was used in the evaluation of the final result for the blank

- (1) The result for one or both determinations was less than five times the LOQ.
- (2) The unspiked result was more than four times the spike added.

Quality Control Summary

 Client Name: ChevronTexaco
 Reported: 01/06/11 at 04:57 PM

Group Number: 1227819

Sample Matrix Quality Control

 Unspiked (UNSPK) = the sample used in conjunction with the matrix spike
 Background (BKG) = the sample used in conjunction with the duplicate

| <u>Analysis Name</u> | <u>MS</u> <u>%REC</u> | <u>MSD</u> <u>%REC</u> | <u>MS/MSD</u> <u>Limits</u> | <u>RPD</u> | <u>RPD</u> <u>MAX</u> | <u>BKG</u> <u>Conc</u> | <u>DUP</u> <u>Conc</u> | <u>DUP</u> <u>RPD</u> | <u>Dup</u> <u>RPD</u> <u>Max</u> |
|-------------------------------|---|---------------------------|--------------------------------|------------|--------------------------|---------------------------|---------------------------|--------------------------|-------------------------------------|
| TPH-DRO soil C10-C28 w/Si Gel | 108 | | 30-159 | | | N.D. | N.D. | 0 (1) | 20 |
| Batch number: 110055708002 | Sample number(s): 6177768 UNSPK: 6177768 BKG: 6177768 | | | | | | | | |
| Cadmium | 90 | 92 | 75-125 | 4 | 20 | 0.550 | 0.952 | 54* (1) | 20 |
| Chromium | 99 | 100 | 75-125 | 2 | 20 | 16.4 | 14.3 | 14 | 20 |
| Lead | 89 | 91 | 75-125 | 4 | 20 | 2.60 | 2.77 | 6 (1) | 20 |
| Nickel | 84 | 76 | 75-125 | 2 | 20 | 84.2 | 73.6 | 13 | 20 |
| Zinc | 97 | 101 | 75-125 | 4 | 20 | 38.8 | 41.1 | 6 | 20 |

Surrogate Quality Control

Surrogate recoveries which are outside of the QC window are confirmed unless attributed to dilution or otherwise noted on the Analysis Report.

 Analysis Name: VOCs by 8260B - Solid
 Batch number: B110051AA

| | Dibromofluoromethane | 1,2-Dichloroethane-d4 | Toluene-d8 | 4-Bromofluorobenzene |
|---------|----------------------|-----------------------|------------|----------------------|
| 6177762 | 106 | 107 | 93 | 92 |
| 6177763 | 106 | 104 | 94 | 89 |
| 6177764 | 107 | 103 | 97 | 84 |
| 6177765 | 107 | 103 | 94 | 90 |
| 6177766 | 106 | 104 | 95 | 89 |
| 6177767 | 108 | 103 | 94 | 89 |
| 6177768 | 109 | 108 | 93 | 92 |
| Blank | 105 | 103 | 93 | 90 |
| LCS | 101 | 104 | 97 | 101 |
| LCSD | 102 | 105 | 97 | 101 |
| MS | 101 | 100 | 99 | 99 |
| Limits: | 71-114 | 70-109 | 70-123 | 70-111 |

 Analysis Name: TPH-GRO N. CA soil C6-C12
 Batch number: 11006A34A
 Trifluorotoluene-F

| | |
|---------|--------|
| 6177762 | 82 |
| 6177763 | 82 |
| 6177764 | 86 |
| 6177765 | 78 |
| 6177766 | 79 |
| 6177767 | 81 |
| 6177768 | 88 |
| Blank | 90 |
| LCS | 88 |
| LCSD | 84 |
| Limits: | 61-122 |

Analysis Name: TPH-DRO soil C10-C28 w/Si Gel

*- Outside of specification

**-This limit was used in the evaluation of the final result for the blank

- (1) The result for one or both determinations was less than five times the LOQ.
- (2) The unspiked result was more than four times the spike added.

Quality Control Summary

Client Name: ChevronTexaco
Reported: 01/06/11 at 04:57 PM

Group Number: 1227819

Surrogate Quality Control

Batch number: 110050014A
Orthoterphenyl

| | |
|---------|-----|
| 6177762 | 95 |
| 6177763 | 98 |
| 6177764 | 91 |
| 6177765 | 99 |
| 6177766 | 98 |
| 6177767 | 98 |
| 6177768 | 104 |
| Blank | 105 |
| DUP | 103 |
| LCS | 115 |
| MS | 122 |

Limits: 59-129

Analysis Name: TPH Fuels by GC (Soils)
Batch number: 110050015A
Chlorobenzene Orthoterphenyl

| | | |
|---------|-----|------|
| 6177768 | 114 | 115 |
| Blank | 108 | 106 |
| DUP | 108 | 104 |
| LCS | 102 | 130* |
| MS | 99 | 123 |

Limits: 49-125 59-129

*- Outside of specification

** - This limit was used in the evaluation of the final result for the blank

- (1) The result for one or both determinations was less than five times the LOQ.
- (2) The unspiked result was more than four times the spike added.

Chevron California Region Analysis Request/Chain of Custody



010411-07 P.10F2
Acct. #: 10880

For Lancaster Laboratories use only
Sample #: 6177762-68

SCR#: 249402
C# 1227819

| Facility #: <u>9-0020</u> Site Address: <u>1633 HARRISON ST OAKLAND CA</u> Chevron PM: <u>DAVE PATTEN</u> Lead Consultant: <u>CRA</u> Consultant/Office: <u>EMERYVILLE</u> Consultant Prj. Mgr.: <u>NATHAN LEE</u> Consultant Phone #: <u>510 420 0700</u> Fax #: <u>510 420 9170</u> Sampler: _____ Service Order #: _____ <input type="checkbox"/> Non SAR: _____ | | | | | | | Analyses Requested | | | | | | | | | | Preservative Codes | | Preservative Codes H = HCl T = Thiosulfate N = HNO ₃ B = NaOH S = H ₂ SO ₄ O = Other | | | | | | | |
|--|--------|---------------|-----------|----------------|----------------|---------------|--|-----------|----------------------------|---|------------------|---|----------------|--|--|--------------------------------|---------------------------|--|--|--|--|--|--|--|--|--|
| | | | | | | | Grab | Composite | Total Number of Containers | BTEX + MTBE 8260 <input type="checkbox"/> 8021 <input type="checkbox"/> | TPH 8015 MOD GRO | TPH 8015 MOD DRO <input checked="" type="checkbox"/> Silica Gel Cleanup | 8260 full scan | Oxygenates | Lead 7420 <input type="checkbox"/> 7421 <input type="checkbox"/> 6010B | TPH MOD WITH SILICAGEL CLEANUP | Cd, Cr, Ni, Zn | | | | | | | | | |
| Field Point Name | Matrix | Repeat Sample | Top Depth | Year Month Day | Time Collected | New Field Pt. | Grab | Composite | Total Number of Containers | BTEX + MTBE 8260 <input type="checkbox"/> 8021 <input type="checkbox"/> | TPH 8015 MOD GRO | TPH 8015 MOD DRO <input checked="" type="checkbox"/> Silica Gel Cleanup | 8260 full scan | Oxygenates | Lead 7420 <input type="checkbox"/> 7421 <input type="checkbox"/> 6010B | TPH MOD WITH SILICAGEL CLEANUP | Cd, Cr, Ni, Zn | | | | | | | | | |
| TSW-1 | SOIL | N | 11 | 2011-1-03 | 11:30 | | X | | 1 | X | X | X | | | | | | | | | | | | | | |
| TSW-3 | SOIL | N | 11 | 2011-1-04 | 9:00 | | X | | 1 | X | X | X | | | | | | | | | | | | | | |
| TSW-4 | | | 9 | | 9:40 | BY | | | | | | | | | | | | | | | | | | | | |
| TSW-5 | | | 9 | | 9:55 | | | | | | | | | | | | | | | | | | | | | |
| TSW-6 | | | 9 | | 10:00 | | | | | | | | | | | | | | | | | | | | | |
| TB-2 | | | 10.5 | | 9:05 | | | | | | | | | | | | | | | | | | | | | |
| TB-4 | | | 10 | | 9:50 | | | | | | | | | | | | | | | | | | | | | |
| EX-9 | SOL | N | 5 | 2011-1-04 | 10:50 | | X | | 1 | X | X | X | | | X | X | X | | | | | | | | | |
| | | | | | | | Comments / Remarks HOLD SAMPLE FOR POSSIBLE FURTHER ANALYSES SEND RESULTS TO: nlee@croworld.com byjtru@croworld.com EDF DATA TO: dohare@croworld.com | | | | | | | | | | | | | | | | | | | |
| Turnaround Time Requested (TAT) (please circle) STD. TAT 72 hour 48 hour 24 hour 4 day 5 day | | | | | | | Relinquished by: <u>BELEW YIFRU</u> Date: <u>1/4/11</u> Time: <u>2:30</u> Received by: <u>SECURE LOCATION</u> Date: _____ Time: _____ | | | | | | | Relinquished by: <u>BELEW YIFRU</u> Date: <u>1/4/11</u> Time: <u>12:45</u> Received by: <u>A. Schyler</u> Date: <u>04 JAN 11</u> Time: <u>1445</u> | | | | | | | | | | | | |
| Data Package Options (please circle if required) QC Summary Type I - Full Type VI (Raw Data) <input type="checkbox"/> Coelt Deliverable not needed WIP (RWQCB) Disk | | | | | | | Relinquished by: <u>A. Schyler</u> Date: <u>04 JAN 11</u> Time: <u>1636</u> Received by: <u>FED EX</u> Date: _____ Time: _____ | | | | | | | Relinquished by Commercial Carrier: UPS <u>FEDEX</u> Other _____ Temperature Upon Receipt: <u>16-20 C</u> Custody/Seals Intact? <u>Yes</u> No | | | | | | | | | | | | |

Explanation of Symbols and Abbreviations

The following defines common symbols and abbreviations used in reporting technical data:

| | | | |
|-------------------------|--|-----------------|----------------------------------|
| RL | Reporting Limit | BMQL | Below Minimum Quantitation Level |
| N.D. | none detected | MPN | Most Probable Number |
| TNTC | Too Numerous To Count | CP Units | cobalt-chloroplatinate units |
| IU | International Units | NTU | nephelometric turbidity units |
| umhos/cm | micromhos/cm | ng | nanogram(s) |
| C | degrees Celsius | F | degrees Fahrenheit |
| meq | milliequivalents | lb. | pound(s) |
| g | gram(s) | kg | kilogram(s) |
| ug | microgram(s) | mg | milligram(s) |
| ml | milliliter(s) | l | liter(s) |
| m3 | cubic meter(s) | ul | microliter(s) |
| < | less than - The number following the sign is the <u>limit of quantitation</u> , the smallest amount of analyte which can be reliably determined using this specific test. | | |
| > | greater than | | |
| J | estimated value – The result is \geq the Method Detection Limit (MDL) and $<$ the Limit of Quantitation (LOQ). | | |
| ppm | parts per million - One ppm is equivalent to one milligram per kilogram (mg/kg), or one gram per million grams. For aqueous liquids, ppm is usually taken to be equivalent to milligrams per liter (mg/l), because one liter of water has a weight very close to a kilogram. For gases or vapors, one ppm is equivalent to one microliter of gas per liter of gas. | | |
| ppb | parts per billion | | |
| Dry weight basis | Results printed under this heading have been adjusted for moisture content. This increases the analyte weight concentration to approximate the value present in a similar sample without moisture. All other results are reported on an as-received basis. | | |

U.S. EPA CLP Data Qualifiers:

| Organic Qualifiers | Inorganic Qualifiers |
|--|--|
| A TIC is a possible aldol-condensation product | B Value is $<$ CRDL, but \geq IDL |
| B Analyte was also detected in the blank | E Estimated due to interference |
| C Pesticide result confirmed by GC/MS | M Duplicate injection precision not met |
| D Compound quantitated on a diluted sample | N Spike sample not within control limits |
| E Concentration exceeds the calibration range of the instrument | S Method of standard additions (MSA) used for calculation |
| N Presumptive evidence of a compound (TICs only) | U Compound was not detected |
| P Concentration difference between primary and confirmation columns $>$ 25% | W Post digestion spike out of control limits |
| U Compound was not detected | * Duplicate analysis not within control limits |
| X,Y,Z Defined in case narrative | + Correlation coefficient for MSA $<$ 0.995 |

Analytical test results meet all requirements of NELAC unless otherwise noted under the individual analysis.

Measurement uncertainty values, as applicable, are available upon request.

Tests results relate only to the sample tested. Clients should be aware that a critical step in a chemical or microbiological analysis is the collection of the sample. Unless the sample analyzed is truly representative of the bulk of material involved, the test results will be meaningless. If you have questions regarding the proper techniques of collecting samples, please contact us. We cannot be held responsible for sample integrity, however, unless sampling has been performed by a member of our staff. This report shall not be reproduced except in full, without the written approval of the laboratory.

WARRANTY AND LIMITS OF LIABILITY - In accepting analytical work, we warrant the accuracy of test results for the sample as submitted. THE FOREGOING EXPRESS WARRANTY IS EXCLUSIVE AND IS GIVEN IN LIEU OF ALL OTHER WARRANTIES, EXPRESSED OR IMPLIED. WE DISCLAIM ANY OTHER WARRANTIES, EXPRESSED OR IMPLIED, INCLUDING A WARRANTY OF FITNESS FOR PARTICULAR PURPOSE AND WARRANTY OF MERCHANTABILITY. IN NO EVENT SHALL LANCASTER LABORATORIES BE LIABLE FOR INDIRECT, SPECIAL, CONSEQUENTIAL, OR INCIDENTAL DAMAGES INCLUDING, BUT NOT LIMITED TO, DAMAGES FOR LOSS OF PROFIT OR GOODWILL REGARDLESS OF (A) THE NEGLIGENCE (EITHER SOLE OR CONCURRENT) OF LANCASTER LABORATORIES AND (B) WHETHER LANCASTER LABORATORIES HAS BEEN INFORMED OF THE POSSIBILITY OF SUCH DAMAGES. We accept no legal responsibility for the purposes for which the client uses the test results. No purchase order or other order for work shall be accepted by Lancaster Laboratories which includes any conditions that vary from the Standard Terms and Conditions, and Lancaster hereby objects to any conflicting terms contained in any acceptance or order submitted by client.



McC Campbell Analytical, Inc.

"When Quality Counts"

1534 Willow Pass Road, Pittsburg, CA 94565-1701
Web: www.mcccampbell.com E-mail: main@mcccampbell.com
Telephone: 877-252-9262 Fax: 925-252-9269

| | | |
|--|------------------------------------|--------------------------|
| Conestoga-Rovers & Associates 5900 Hollis St, Suite A Emeryville, CA 94608 | Client Project ID: #311956; 9-0020 | Date Sampled: 01/05/11 |
| | | Date Received: 01/05/11 |
| | Client Contact: Nathan Lee | Date Reported: 01/06/11 |
| | Client P.O.: | Date Completed: 01/06/11 |

WorkOrder: 1101063

January 06, 2011

Dear Nathan:

Enclosed within are:

- 1) The results of the **5** analyzed samples from your project: **#311956; 9-0020**,
- 2) A QC report for the above samples,
- 3) A copy of the chain of custody, and
- 4) An invoice for analytical services.

All analyses were completed satisfactorily and all QC samples were found to be within our control limits.

If you have any questions or concerns, please feel free to give me a call. Thank you for choosing

McC Campbell Analytical Laboratories for your analytical needs.

Best regards,

Angela Rydelius
Laboratory Manager
McC Campbell Analytical, Inc.



McCAMPBELL ANALYTICAL, INC.

1534 WILLOW PASS ROAD
PITTSBURG, CA 94565-1701

Website: www.mccampbell.com Email: main@mccampbell.com
Telephone: (877) 252-9262 Fax: (925) 252-9269

1101063
DUPLICATE

CHAIN OF CUSTODY RECORD

TURN AROUND TIME

RUSH 24 HR 48 HR 72 HR 5 DAY

GeoTracker EDF PDF Excel Write On (DW)

Check if sample is effluent and "J" flag is required

Report To: alee@craworld.com Bill To: 311956/A10
 Company: Coneftoga - Rovers & Associates
 E-Mail: NLEE@craworld.com
 Tele: (510) 385-2499 Fax: (510) 420-9170
 Project #: 311956 Project Name: 9-0020
 Project Location: 1633 Harrison Street, Oakland, CA
 Sampler Signature: _____

| SAMPLE ID | LOCATION/ Field Point Name | SAMPLING | | # Containers | Type Containers | MATRIX | | | | | METHOD PRESERVED | | | | Analysis Request | Other | Comments |
|-----------|----------------------------------|----------|------|--------------|-----------------|--------|------|-----|--------|-------|------------------|-----|------------------|-------|------------------|-------|---|
| | | Date | Time | | | Water | Soil | Air | Sludge | Other | ICE | HCL | HNO ₃ | Other | | | |
| TB-5 | | 4/5/11 | 0825 | 1 | | X | | | | | | | | | | | **Indicate here if these samples are potentially dangerous to handle: |
| TSW-7 | | 4/5/11 | 0828 | 1 | | X | | | | | | | | | | | |
| TSW-8 | | 4/5/11 | 0830 | 1 | | X | | | | | | | | | | | |
| TB-6 | | 4/5/11 | 0833 | 1 | | X | | | | | | | | | | | |
| TB-7 | | 4/5/11 | 0835 | 1 | | X | | | | | | | | | | | |

BTEX & TPH as Gas (8015) WITH SILICAGEL CLEAN UP
 TPH as Diesel (8015)
 Total Petroleum Oil & Grease (1664 / 5520 E/B&F)
 Total Petroleum Hydrocarbons (418.1)
 EPA 502.2 / 601 / 8010 / 8021 (HVOCs)
 MTBE / BTEX ONLY (EPA 602-8081) 8260
 EPA 505 / 608 / 8081 (CI Pesticides)
 EPA 608 / 8082 PCB's ONLY; Aroclors / Congeners
 EPA 507 / 8141 (NP Pesticides)
 EPA 515 / 8151 (Acidic CI Herbicides)
 EPA 524.2 / 624 / 8260 (VOCs)
 EPA 525.2 / 625 / 8270 (SVOCs)
 EPA 8270 SIM / 8310 (PAHs / PNAs)
 CAM 17 Metals (200.7 / 200.8 / 6010 / 6020)
 LUFT 5 Metals (200.7 / 200.8 / 6010 / 6020)
 Lead (200.7 / 200.8 / 6010 / 6020)
 Filter sample for DISSOLVED metals analysis

**MAI clients MUST disclose any dangerous chemicals known to be present in their submitted samples in concentrations that may cause immediate harm or serious future health endangerment as a result of brief, gloved, open air, sample handling by MAI staff. Non-disclosure incurs an immediate \$250 surcharge and the client is subject to full legal liability for harm suffered. Thank you for your understanding and for allowing us to work safely.

| | | | | | |
|-------------------------------------|---------------------|-------------------|--------------------------------|--|-----------|
| Relinquished By: <u>BELEW YIFRU</u> | Date: <u>4/5/11</u> | Time: <u>1235</u> | Received By: <u>Mike Valle</u> | ICE/° <u>5.22</u> ✓ GOOD CONDITION ✓ HEAD SPACE ABSENT ✓ DECHLORINATED IN LAB ✓ APPROPRIATE CONTAINERS ✓ PRESERVED IN LAB ✓ VOAS O&G METALS OTHER PRESERVATION pH<2 | COMMENTS: |
| Relinquished By: | Date: | Time: | Received By: | | |
| Relinquished By: | Date: | Time: | Received By: | | |

RESULTS ALSO TO byifru@craworld.com

EDF DATA TO dohare@craworld.com

McC Campbell Analytical, Inc.



1534 Willow Pass Rd
 Pittsburg, CA 94565-1701
 (925) 252-9262

CHAIN-OF-CUSTODY RECORD

WorkOrder: 1101063

ClientCode: CETE

WaterTrax
 WriteOn
 EDF
 Excel
 Fax
 Email
 HardCopy
 ThirdParty
 J-flag

Report to:
 Nathan Lee
 Conestoga-Rovers & Associates
 5900 Hollis St, Suite A
 Emeryville, CA 94608
 (510) 420-0700 FAX (510) 420-9170

Email: nlee@craworld.com
 cc: byifru@craworld.com
 PO:
 ProjectNo: #311956; 9-0020

Bill to:
 Accounts Payable
 Conestoga-Rovers & Associates
 5900 Hollis St, Ste. A
 Emeryville, CA 94608

Requested TAT: 1 day
Date Received: 01/05/2011
Date Printed: 01/05/2011

| Lab ID | Client ID | Matrix | Collection Date | Hold | Requested Tests (See legend below) | | | | | | | | | | | | |
|-------------|-----------|--------|-----------------|--------------------------|------------------------------------|---|---|---|---|---|---|---|---|----|----|----|--|
| | | | | | 1 | 2 | 3 | 4 | 5 | 6 | 7 | 8 | 9 | 10 | 11 | 12 | |
| 1101063-001 | TB-5 | Soil | 1/5/2011 8:25 | <input type="checkbox"/> | A | A | A | | | | | | | | | | |
| 1101063-002 | TSW-7 | Soil | 1/5/2011 8:28 | <input type="checkbox"/> | A | A | | | | | | | | | | | |
| 1101063-003 | TSW-8 | Soil | 1/5/2011 8:30 | <input type="checkbox"/> | A | A | | | | | | | | | | | |
| 1101063-004 | TB-6 | Soil | 1/5/2011 8:33 | <input type="checkbox"/> | A | A | | | | | | | | | | | |
| 1101063-005 | TB-7 | Soil | 1/5/2011 8:35 | <input type="checkbox"/> | A | A | | | | | | | | | | | |

Test Legend:

| | | | | | | | | | |
|----|-----------|----|---------------|---|--------------|---|--|----|--|
| 1 | G-MBTEX_S | 2 | MBTEX-8260B_S | 3 | PREFD REPORT | 4 | | 5 | |
| 6 | | 7 | | 8 | | 9 | | 10 | |
| 11 | | 12 | | | | | | | |

The following SampIDs: 001A, 002A, 003A, 004A, 005A contain testgroup.

Prepared by: Melissa Valles

Comments:

NOTE: Soil samples are discarded 60 days after results are reported unless other arrangements are made (Water samples are 30 days).
 Hazardous samples will be returned to client or disposed of at client expense.



Sample Receipt Checklist

Client Name: **Conestoga-Rovers & Associates**

Date and Time Received: **1/5/2011 12:40:07 PM**

Project Name: **#311956; 9-0020**

Checklist completed and reviewed by: **Melissa Valles**

WorkOrder N°: **1101063** Matrix Soil

Carrier: Client Drop-In

Chain of Custody (COC) Information

- Chain of custody present? Yes No
- Chain of custody signed when relinquished and received? Yes No
- Chain of custody agrees with sample labels? Yes No
- Sample IDs noted by Client on COC? Yes No
- Date and Time of collection noted by Client on COC? Yes No
- Sampler's name noted on COC? Yes No

Sample Receipt Information

- Custody seals intact on shipping container/cooler? Yes No NA
- Shipping container/cooler in good condition? Yes No
- Samples in proper containers/bottles? Yes No
- Sample containers intact? Yes No
- Sufficient sample volume for indicated test? Yes No

Sample Preservation and Hold Time (HT) Information

- All samples received within holding time? Yes No
 - Container/Temp Blank temperature Cooler Temp: 5.2°C NA
 - Water - VOA vials have zero headspace / no bubbles? Yes No No VOA vials submitted
 - Sample labels checked for correct preservation? Yes No
 - Metal - pH acceptable upon receipt (pH<2)? Yes No NA
 - Samples Received on Ice? Yes No
- (Ice Type: WET ICE)

* NOTE: If the "No" box is checked, see comments below.

Client contacted:

Date contacted:

Contacted by:

Comments:



McC Campbell Analytical, Inc.

"When Quality Counts"

1534 Willow Pass Road, Pittsburg, CA 94565-1701
Web: www.mcccampbell.com E-mail: main@mcccampbell.com
Telephone: 877-252-9262 Fax: 925-252-9269

| | | |
|--|------------------------------------|--------------------------|
| Conestoga-Rovers & Associates 5900 Hollis St, Suite A Emeryville, CA 94608 | Client Project ID: #311956; 9-0020 | Date Sampled: 01/05/11 |
| | | Date Received: 01/05/11 |
| | Client Contact: Nathan Lee | Date Extracted: 01/05/11 |
| | Client P.O.: | Date Analyzed 01/05/11 |

Gasoline Range (C6-C12) Volatile Hydrocarbons as Gasoline*

Extraction method SW5030B

Analytical methods SW8015Bm

Work Order: 1101063

| Lab ID | Client ID | Matrix | TPH(g) | DF | % SS | Comments |
|--------|-----------|--------|--------|----|------|----------|
| 001A | TB-5 | S | ND | 1 | 98 | |
| 002A | TSW-7 | S | ND | 1 | 97 | |
| 003A | TSW-8 | S | ND | 1 | 97 | |
| 004A | TB-6 | S | ND | 1 | 96 | |
| 005A | TB-7 | S | ND | 1 | 100 | |
| | | | | | | |
| | | | | | | |
| | | | | | | |
| | | | | | | |
| | | | | | | |
| | | | | | | |
| | | | | | | |
| | | | | | | |
| | | | | | | |
| | | | | | | |
| | | | | | | |
| | | | | | | |
| | | | | | | |
| | | | | | | |
| | | | | | | |
| | | | | | | |
| | | | | | | |

| | | | |
|--|---|-----|-------|
| Reporting Limit for DF =1; ND means not detected at or above the reporting limit | W | NA | NA |
| | S | 1.0 | mg/Kg |

* water and vapor samples are reported in µg/L, soil/sludge/solid samples in mg/kg, wipe samples in µg/wipe, product/oil/non-aqueous liquid samples and all TCLP & SPLP extracts in mg/L.

cluttered chromatogram; sample peak coelutes w/surrogate peak; low surrogate recovery due to matrix interference.

%SS = Percent Recovery of Surrogate Standard; DF = Dilution Factor

+The following descriptions of the TPH chromatogram are cursory in nature and McC Campbell Analytical is not responsible for their interpretation:

 Angela Rydelius, Lab Manager



McC Campbell Analytical, Inc.

"When Quality Counts"

1534 Willow Pass Road, Pittsburg, CA 94565-1701
Web: www.mcccampbell.com E-mail: main@mcccampbell.com
Telephone: 877-252-9262 Fax: 925-252-9269

| | | |
|--|------------------------------------|--------------------------|
| Conestoga-Rovers & Associates 5900 Hollis St, Suite A Emeryville, CA 94608 | Client Project ID: #311956; 9-0020 | Date Sampled: 01/05/11 |
| | | Date Received: 01/05/11 |
| | Client Contact: Nathan Lee | Date Extracted: 01/05/11 |
| | Client P.O.: | Date Analyzed: 01/05/11 |

MTBE and BTEX by GC/MS*

Extraction Method: SW5030B

Analytical Method: SW8260B

Work Order: 1101063

| | | | | | | |
|-----------|--------------|--------------|--------------|--------------|------------------------------|--|
| Lab ID | 1101063-001A | 1101063-002A | 1101063-003A | 1101063-004A | Reporting Limit for DF =1 | |
| Client ID | TB-5 | TSW-7 | TSW-8 | TB-6 | | |
| Matrix | S | S | S | S | | |
| DF | 1 | 1 | 1 | 1 | | |

| Compound | Concentration | | | | mg/kg | ug/L |
|-----------------------------|---------------|----|----|----|-------|-------|
| | Benzene | ND | ND | ND | ND | 0.005 |
| Ethylbenzene | ND | ND | ND | ND | 0.005 | NA |
| Methyl-t-butyl ether (MTBE) | ND | ND | ND | ND | 0.005 | NA |
| Toluene | ND | ND | ND | ND | 0.005 | NA |
| Xylenes | ND | ND | ND | ND | 0.005 | NA |

Surrogate Recoveries (%)

| | | | | | |
|-------|-----|-----|-----|-----|--|
| %SS1: | 99 | 97 | 97 | 97 | |
| %SS2: | 103 | 103 | 103 | 104 | |

Comments

* water and vapor samples are reported in µg/L, soil/sludge/solid samples in mg/kg, product/oil/non-aqueous liquid samples and all TCLP & SPLP extracts are reported in mg/L, wipe samples in µg/wipe.

ND means not detected above the reporting limit/method detection limit; N/A means analyte not applicable to this analysis.

surrogate diluted out of range or coelutes with another peak; &) low surrogate due to matrix interference.

%SS = Percent Recovery of Surrogate Standard

DF = Dilution Factor



McC Campbell Analytical, Inc.

"When Quality Counts"

1534 Willow Pass Road, Pittsburg, CA 94565-1701
Web: www.mcccampbell.com E-mail: main@mcccampbell.com
Telephone: 877-252-9262 Fax: 925-252-9269

| | | |
|--|------------------------------------|--------------------------|
| Conestoga-Rovers & Associates 5900 Hollis St, Suite A Emeryville, CA 94608 | Client Project ID: #311956; 9-0020 | Date Sampled: 01/05/11 |
| | | Date Received: 01/05/11 |
| | Client Contact: Nathan Lee | Date Extracted: 01/05/11 |
| | Client P.O.: | Date Analyzed: 01/05/11 |

MTBE and BTEX by GC/MS*

Extraction Method: SW5030B

Analytical Method: SW8260B

Work Order: 1101063

| | | | | | | |
|-----------|--------------|--|--|--|------------------------------|--|
| Lab ID | 1101063-005A | | | | Reporting Limit for DF =1 | |
| Client ID | TB-7 | | | | | |
| Matrix | S | | | | | |
| DF | 1 | | | | | |

| Compound | Concentration | | | | mg/kg | ug/L |
|-----------------------------|---------------|--|--|--|-------|------|
| Benzene | ND | | | | 0.005 | NA |
| Ethylbenzene | ND | | | | 0.005 | NA |
| Methyl-t-butyl ether (MTBE) | ND | | | | 0.005 | NA |
| Toluene | ND | | | | 0.005 | NA |
| Xylenes | ND | | | | 0.005 | NA |

Surrogate Recoveries (%)

| | | | | | |
|-------|-----|--|--|--|--|
| %SS1: | 97 | | | | |
| %SS2: | 103 | | | | |

Comments

* water and vapor samples are reported in µg/L, soil/sludge/solid samples in mg/kg, product/oil/non-aqueous liquid samples and all TCLP & SPLP extracts are reported in mg/L, wipe samples in µg/wipe.

ND means not detected above the reporting limit/method detection limit; N/A means analyte not applicable to this analysis.

surrogate diluted out of range or coelutes with another peak; &) low surrogate due to matrix interference.

%SS = Percent Recovery of Surrogate Standard

DF = Dilution Factor



McC Campbell Analytical, Inc.

"When Quality Counts"

1534 Willow Pass Road, Pittsburg, CA 94565-1701
Web: www.mccampbell.com E-mail: main@mccampbell.com
Telephone: 877-252-9262 Fax: 925-252-9269

| | | |
|--|------------------------------------|--------------------------|
| Conestoga-Rovers & Associates 5900 Hollis St, Suite A Emeryville, CA 94608 | Client Project ID: #311956; 9-0020 | Date Sampled: 01/05/11 |
| | | Date Received: 01/05/11 |
| | Client Contact: Nathan Lee | Date Extracted: 01/05/11 |
| | Client P.O.: | Date Analyzed 01/05/11 |

Total Extractable Petroleum Hydrocarbons with Silica Gel Clean-Up*

Extraction method SW3550B/3630C

Analytical methods: SW8015B

Work Order: 1101063

| Lab ID | Client ID | Matrix | TPH-Diesel (C10-C23) | DF | % SS | Comments |
|--------------|-----------|--------|-------------------------|----|------|----------|
| 1101063-001A | TB-5 | S | ND | 1 | 110 | |
| 1101063-002A | TSW-7 | S | ND | 1 | 107 | |
| 1101063-003A | TSW-8 | S | ND | 1 | 108 | |
| 1101063-004A | TB-6 | S | ND | 1 | 111 | |
| 1101063-005A | TB-7 | S | 4.7 | 1 | 107 | e7,e2 |
| | | | | | | |
| | | | | | | |
| | | | | | | |
| | | | | | | |
| | | | | | | |
| | | | | | | |
| | | | | | | |
| | | | | | | |
| | | | | | | |
| | | | | | | |
| | | | | | | |
| | | | | | | |
| | | | | | | |
| | | | | | | |
| | | | | | | |
| | | | | | | |
| | | | | | | |
| | | | | | | |
| | | | | | | |

| | | | |
|--|---|-----|-------|
| Reporting Limit for DF =1; ND means not detected at or above the reporting limit | W | NA | NA |
| | S | 1.0 | mg/Kg |

* water samples are reported in µg/L, wipe samples in µg/wipe, soil/solid/sludge samples in mg/kg, product/oil/non-aqueous liquid samples in mg/L, and all DISTLC / STLC / SPLP / TCLP extracts are reported in µg/L.

cluttered chromatogram resulting in coeluted surrogate and sample peaks, or; surrogate peak is on elevated baseline, or; surrogate has been diminished by dilution of original extract.

%SS = Percent Recovery of Surrogate Standard. DF = Dilution Factor

+The following descriptions of the TPH chromatogram are cursory in nature and McC Campbell Analytical is not responsible for their interpretation:

e2) diesel range compounds are significant; no recognizable pattern
e7) oil range compounds are significant



QC SUMMARY REPORT FOR SW8021B/8015Bm

W.O. Sample Matrix: Soil

QC Matrix: Soil

BatchID: 55378

WorkOrder 1101063

| Analyte | EPA Method SW8015Bm | | Extraction SW5030B | | | | | | Spiked Sample ID: 1012952-001A | | | |
|------------------------|---------------------|--------|--------------------|--------|--------|--------|--------|----------|--------------------------------|-----|----------|-----|
| | Sample | Spiked | MS | MSD | MS-MSD | LCS | LCSD | LCS-LCSD | Acceptance Criteria (%) | | | |
| | mg/Kg | mg/Kg | % Rec. | % Rec. | % RPD | % Rec. | % Rec. | % RPD | MS / MSD | RPD | LCS/LCSD | RPD |
| TPH(btex) ^f | ND | 0.60 | 98.3 | 101 | 2.32 | 99.7 | 85.4 | 15.5 | 70 - 130 | 20 | 70 - 130 | 20 |
| MTBE | ND | 0.10 | 106 | 109 | 2.28 | 103 | 111 | 6.87 | 70 - 130 | 20 | 70 - 130 | 20 |
| Benzene | ND | 0.10 | 100 | 100 | 0 | 101 | 101 | 0 | 70 - 130 | 20 | 70 - 130 | 20 |
| Toluene | ND | 0.10 | 97.2 | 96.5 | 0.678 | 97.8 | 96.7 | 1.16 | 70 - 130 | 20 | 70 - 130 | 20 |
| Ethylbenzene | ND | 0.10 | 98.2 | 97.6 | 0.590 | 99 | 96.9 | 2.20 | 70 - 130 | 20 | 70 - 130 | 20 |
| Xylenes | ND | 0.30 | 100 | 100 | 0 | 101 | 99.3 | 2.07 | 70 - 130 | 20 | 70 - 130 | 20 |
| %SS: | 106 | 0.10 | 111 | 105 | 5.84 | 109 | 107 | 1.89 | 70 - 130 | 20 | 70 - 130 | 20 |

All target compounds in the Method Blank of this extraction batch were ND less than the method RL with the following exceptions:
NONE

BATCH 55378 SUMMARY

| Lab ID | Date Sampled | Date Extracted | Date Analyzed | Lab ID | Date Sampled | Date Extracted | Date Analyzed |
|--------------|------------------|----------------|-------------------|--------------|------------------|----------------|------------------|
| 1101063-001A | 01/05/11 8:25 AM | 01/05/11 | 01/05/11 6:14 PM | 1101063-002A | 01/05/11 8:28 AM | 01/05/11 | 01/05/11 6:44 PM |
| 1101063-003A | 01/05/11 8:30 AM | 01/05/11 | 01/05/11 8:14 PM | 1101063-004A | 01/05/11 8:33 AM | 01/05/11 | 01/05/11 9:44 PM |
| 1101063-005A | 01/05/11 8:35 AM | 01/05/11 | 01/05/11 10:14 PM | | | | |

MS = Matrix Spike; MSD = Matrix Spike Duplicate; LCS = Laboratory Control Sample; LCSD = Laboratory Control Sample Duplicate; RPD = Relative Percent Deviation.

% Recovery = 100 * (MS-Sample) / (Amount Spiked); RPD = 100 * (MS - MSD) / ((MS + MSD) / 2).

MS / MSD spike recoveries and / or %RPD may fall outside of laboratory acceptance criteria due to one or more of the following reasons: a) the sample is inhomogenous AND contains significant concentrations of analyte relative to the amount spiked, or b) the spiked sample's matrix interferes with the spike recovery.

£ TPH(btex) = sum of BTEX areas from the FID.

cluttered chromatogram; sample peak coelutes with surrogate peak.

N/A = not enough sample to perform matrix spike and matrix spike duplicate.

NR = matrix interference and/or analyte concentration in sample exceeds spike amount for soil matrix or exceeds 2x spike amount for water matrix or sample diluted due to high matrix or analyte content.



QC SUMMARY REPORT FOR SW8260B

W.O. Sample Matrix: Soil

QC Matrix: Soil

BatchID: 55425

WorkOrder 1101063

| EPA Method SW8260B | | Extraction SW5030B | | | | | | | Spiked Sample ID: 1101038-001A | | | |
|-----------------------------|--------|--------------------|--------|--------|--------|--------|--------|----------|--------------------------------|-----|----------|-----|
| Analyte | Sample | Spiked | MS | MSD | MS-MSD | LCS | LCSD | LCS-LCSD | Acceptance Criteria (%) | | | |
| | mg/Kg | mg/Kg | % Rec. | % Rec. | % RPD | % Rec. | % Rec. | % RPD | MS / MSD | RPD | LCS/LCSD | RPD |
| Benzene | ND | 0.050 | 112 | 110 | 1.53 | 111 | 109 | 1.60 | 70 - 130 | 30 | 70 - 130 | 30 |
| Methyl-t-butyl ether (MTBE) | ND | 0.050 | 102 | 104 | 2.55 | 104 | 103 | 0.909 | 70 - 130 | 30 | 70 - 130 | 30 |
| Toluene | ND | 0.050 | 121 | 120 | 1.24 | 118 | 117 | 1.06 | 70 - 130 | 30 | 70 - 130 | 30 |
| %SS1: | 95 | 0.13 | 114 | 116 | 1.10 | 113 | 111 | 1.65 | 70 - 130 | 30 | 70 - 130 | 30 |
| %SS2: | 103 | 0.13 | 107 | 108 | 1.52 | 106 | 107 | 1.20 | 70 - 130 | 30 | 70 - 130 | 30 |

All target compounds in the Method Blank of this extraction batch were ND less than the method RL with the following exceptions:
NONE

BATCH 55425 SUMMARY

| Lab ID | Date Sampled | Date Extracted | Date Analyzed | Lab ID | Date Sampled | Date Extracted | Date Analyzed |
|--------------|------------------|----------------|------------------|--------------|------------------|----------------|------------------|
| 1101063-001A | 01/05/11 8:25 AM | 01/05/11 | 01/05/11 4:22 PM | 1101063-002A | 01/05/11 8:28 AM | 01/05/11 | 01/05/11 5:04 PM |
| 1101063-003A | 01/05/11 8:30 AM | 01/05/11 | 01/05/11 5:46 PM | 1101063-004A | 01/05/11 8:33 AM | 01/05/11 | 01/05/11 6:28 PM |
| 1101063-005A | 01/05/11 8:35 AM | 01/05/11 | 01/05/11 9:20 PM | | | | |

MS = Matrix Spike; MSD = Matrix Spike Duplicate; LCS = Laboratory Control Sample; LCSD = Laboratory Control Sample Duplicate; RPD = Relative Percent Deviation.

% Recovery = 100 * (MS-Sample) / (Amount Spiked); RPD = 100 * (MS - MSD) / ((MS + MSD) / 2).

MS / MSD spike recoveries and / or %RPD may fall outside of laboratory acceptance criteria due to one or more of the following reasons: a) the sample is inhomogenous AND contains significant concentrations of analyte relative to the amount spiked, or b) the spiked sample's matrix interferes with the spike recovery.

N/A = not enough sample to perform matrix spike and matrix spike duplicate.

NR = analyte concentration in sample exceeds spike amount for soil matrix or exceeds 2x spike amount for water matrix or sample diluted due to high matrix or analyte content.

Laboratory extraction solvents such as methylene chloride and acetone may occasionally appear in the method blank at low levels.



QC SUMMARY REPORT FOR SW8015B

W.O. Sample Matrix: Soil

QC Matrix: Soil

BatchID: 55379

WorkOrder 1101063

| EPA Method SW8015B | | Extraction SW3550B/3630C | | | | | | | Spiked Sample ID: 1012958-002A | | | |
|----------------------|--------|--------------------------|--------|--------|--------|--------|--------|----------|--------------------------------|-----|----------|-----|
| Analyte | Sample | Spiked | MS | MSD | MS-MSD | LCS | LCSD | LCS-LCSD | Acceptance Criteria (%) | | | |
| | mg/Kg | mg/Kg | % Rec. | % Rec. | % RPD | % Rec. | % Rec. | % RPD | MS / MSD | RPD | LCS/LCSD | RPD |
| TPH-Diesel (C10-C23) | ND | 40 | 128 | 128 | 0 | 94 | 94.4 | 0.390 | 70 - 130 | 30 | 70 - 130 | 30 |
| %SS: | 118 | 25 | 111 | 111 | 0 | 99 | 100 | 0.301 | 70 - 130 | 30 | 70 - 130 | 30 |

All target compounds in the Method Blank of this extraction batch were ND less than the method RL with the following exceptions:
NONE

BATCH 55379 SUMMARY

| Lab ID | Date Sampled | Date Extracted | Date Analyzed | Lab ID | Date Sampled | Date Extracted | Date Analyzed |
|--------------|------------------|----------------|------------------|--------------|------------------|----------------|------------------|
| 1101063-001A | 01/05/11 8:25 AM | 01/05/11 | 01/05/11 4:11 PM | 1101063-002A | 01/05/11 8:28 AM | 01/05/11 | 01/05/11 5:21 PM |
| 1101063-003A | 01/05/11 8:30 AM | 01/05/11 | 01/05/11 3:02 PM | 1101063-004A | 01/05/11 8:33 AM | 01/05/11 | 01/05/11 3:00 PM |
| 1101063-005A | 01/05/11 8:35 AM | 01/05/11 | 01/05/11 4:11 PM | | | | |

MS = Matrix Spike; MSD = Matrix Spike Duplicate; LCS = Laboratory Control Sample; LCSD = Laboratory Control Sample Duplicate; RPD = Relative Percent Deviation.

% Recovery = 100 * (MS-Sample) / (Amount Spiked); RPD = 100 * (MS - MSD) / ((MS + MSD) / 2).

MS / MSD spike recoveries and / or %RPD may fall outside of laboratory acceptance criteria due to one or more of the following reasons: a) the sample is inhomogenous AND contains significant concentrations of analyte relative to the amount spiked, or b) the spiked sample's matrix interferes with the spike recovery.

N/A = not enough sample to perform matrix spike and matrix spike duplicate.

NR = analyte concentration in sample exceeds spike amount for soil matrix or exceeds 2x spike amount for water matrix or sample diluted due to high matrix or analyte content.