

5710382



Chevron

RECEIVED
FEB 26 11 07 AM '98
February 24, 1998

Chevron Products Company
P.O. Box 6004
San Ramon, CA 94583

Mr. Thomas Peacock
Alameda County Health Care Services
Department of Environmental Health
1131 Harbor Bay Parkway, Suite 250
Alameda, CA 94502-6577

**Re: Former Chevron Service Station #9-0020
1633 Harrison Street, Oakland, California**

Dear Mr. Peacock:

Enclosed is the Well Abandonment Report that was prepared by our consultant Pacific Environmental Group, Inc., for the above noted site. Eleven groundwater-monitoring wells were over-drilled and filled with neat cement by tremie method.

Five groundwater-monitoring wells still remain at the site and are monitored semi-annually.

If you have any questions or comments call me at (510) 842-9136.

Sincerely,
CHEVRON PRODUCTS COMPANY

Philip R. Briggs
Site Assessment and Remediation Project Manager

Enclosure

Cc. Ms. Bette Owen, Chevron

The Oakland Housing Authority
Attn: Mr. Howard Davis
1619 Harrison Street
Oakland, CA 94612





PACIFIC
ENVIRONMENTAL
GROUP, INC.

February 19, 1998
Project 920-111.6A

Mr. Robert Foss
Chevron Products Company
P.O. Box 6004
San Ramon, California 94583

Re: **Well Abandonments**
Alameda County

Dear Mr. Foss:

This letter, prepared by Pacific Environmental Group (PEG) on behalf of Chevron Products Company (Chevron), presents the results of well abandonment activities at six sites in Alameda County. All work was done in accordance with the permits obtained from the Alameda County Public Works Department (ACPWD) and the Alameda County Water District (ACWD). Site maps are presented as Attachment A. Copies of the Well Completion Reports for each site are presented as Attachment B.

Specific work completed for the respective site is described below.

SITES

- **Coliseum Way, Oakland:** On October 15, 1997, seven groundwater monitoring wells (MW-1, MW-4, MW-7 through MW-9, MW-12 and MW-13) were abandoned at former Gulf Oil Bulk Asphalt Plant located at 6345 Coliseum Way in Oakland, California. Wells MW-4, MW-7 through MW-9, MW-12 and MW-13 were over-drilled and filled with neat cement by tremie method. Well MW-1 was pressure-grouted due to limited access. Wells MW-3 and MW-11, located in an adjacent field, were covered by dirt and mud and could not be found at that time. Wells MW-3 and MW-11 will be located by Gettler-Ryan. Abandonment of Wells MW-3 and MW-11 will be documented in a future report. Well abandonment data is presented in Table 1.
- **San Lorenzo:** On October 16, 1997, six groundwater monitoring wells (C-1 through C-3, and C-5 through C-7) were abandoned at former Chevron Service Station 9-5630 at 997 Grant Avenue in San Lorenzo, California. All wells were over-drilled and filled with neat cement by tremie method. Well abandonment data is presented in Table 2.

- **Alameda:** On November 12, 1997, five groundwater monitoring wells (C-1 through C-5) were abandoned at Chevron Service Station 9-4463 located at 1801 Park Street in Alameda, California. All wells were over-drilled and filled with neat cement by tremie method. Well abandonment data is presented in Table 3.
- **Fremont:** On November 13, 1997, five groundwater monitoring wells (MW-4 through MW-8) were abandoned at former Chevron Service Station 9-1699 located at 39130 Argonaut Way in Fremont, California. All wells were over-drilled and filled with neat cement by tremie method. Well abandonments were observed by Mr. Ken Peterson of the ACWD. Well abandonment data is presented in Table 4.
- **Harrison Street, Oakland:** On January 17, 1998, eleven groundwater monitoring wells (MW-1 through MW-6, MW-8, MW-10 through MW-12, and MW-14) were abandoned at former Chevron Station ~~9-0020~~ located at 1633 Harrison Street in Oakland, California. All wells were over-drilled and filled with neat cement by tremie method. Well abandonment data is presented in Table 5.

If you have any questions or comments concerning this letter, please call us at (916) 858-2350.

Sincerely,

Pacific Environmental Group, Inc.

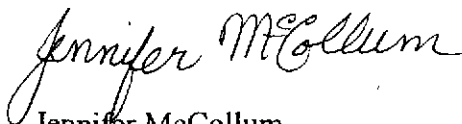

Jennifer McCollum
Staff Scientist



Christine Brown
Senior Geologist
RG 4556

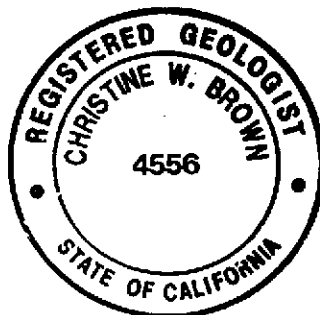

Attachments: Table 1 - Well Abandonment Data, Oakland
Table 2 - Well Abandonment Data, San Lorenzo
Table 3 - Well Abandonment Data, Alameda
Table 4 - Well Abandonment Data, Fremont
Table 5 - Well Abandonment Data, Oakland
Attachment A - Site Maps
Attachment B - Well Completion Reports

cc: Mr. Alvin Kan, Alameda County Public Works
Mr. Ken Peterson, Alameda County Water District
Mr. Phil Briggs, Chevron Products Company

**Table 5
Well Destruction Information**

Former Chevron Service Station ~~9-0200~~ **9-0020**
1633 Harrison Street
Oakland, California

Well ID	Permit Number	Well Diameter (inches)	Tagged Depth (feet)	Drilled Depth (feet)	Amount of Grout (gallons)	Method
MW-1	97WR094	4	25	26	100	Drilled out
MW-2	97WR094	4	28	29	100	Drilled out
MW-3	97WR094	4	32	33	100	Drilled out
MW-4	97WR094	4	25	26	100	Drilled out
MW-5	97WR094	4	31	32	100	Drilled out
MW-6	97WR094	4	26	27	100	Drilled out
MW-8	97WR094	4	26	27	100	Drilled out
MW-10	97WR094	2	23	25	50	Drilled out
MW-11	97WR094	2	25	26	50	Drilled out
MW-12	97WR094	2	24	25	50	Drilled out
MW-14	97WR094	2	25	26	50	Drilled out

ATTACHMENT A

SITE MAPS

EXPLANATION

- MW-16 MONITORING WELL LOCATION AND WELL NUMBER
- 8.52 GROUND-WATER ELEVATION IN FEET ABOVE MEAN SEA LEVEL
- NM NOT MEASURED
- 9.0 GROUND-WATER ELEVATION CONTOUR 10 FEET ABOVE MEAN SEA LEVEL
- 0.01 APPROXIMATE DIRECTION OF GROUND-WATER FLOW (ARROW INDICATED IN FEET PER DAY)

* Do Not Destroy

MW-7, -9, -13, -16, -15

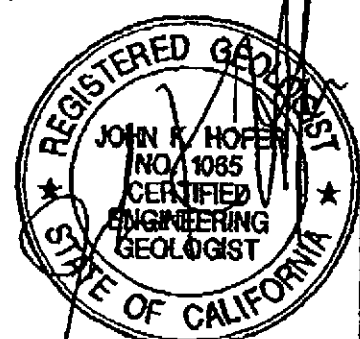
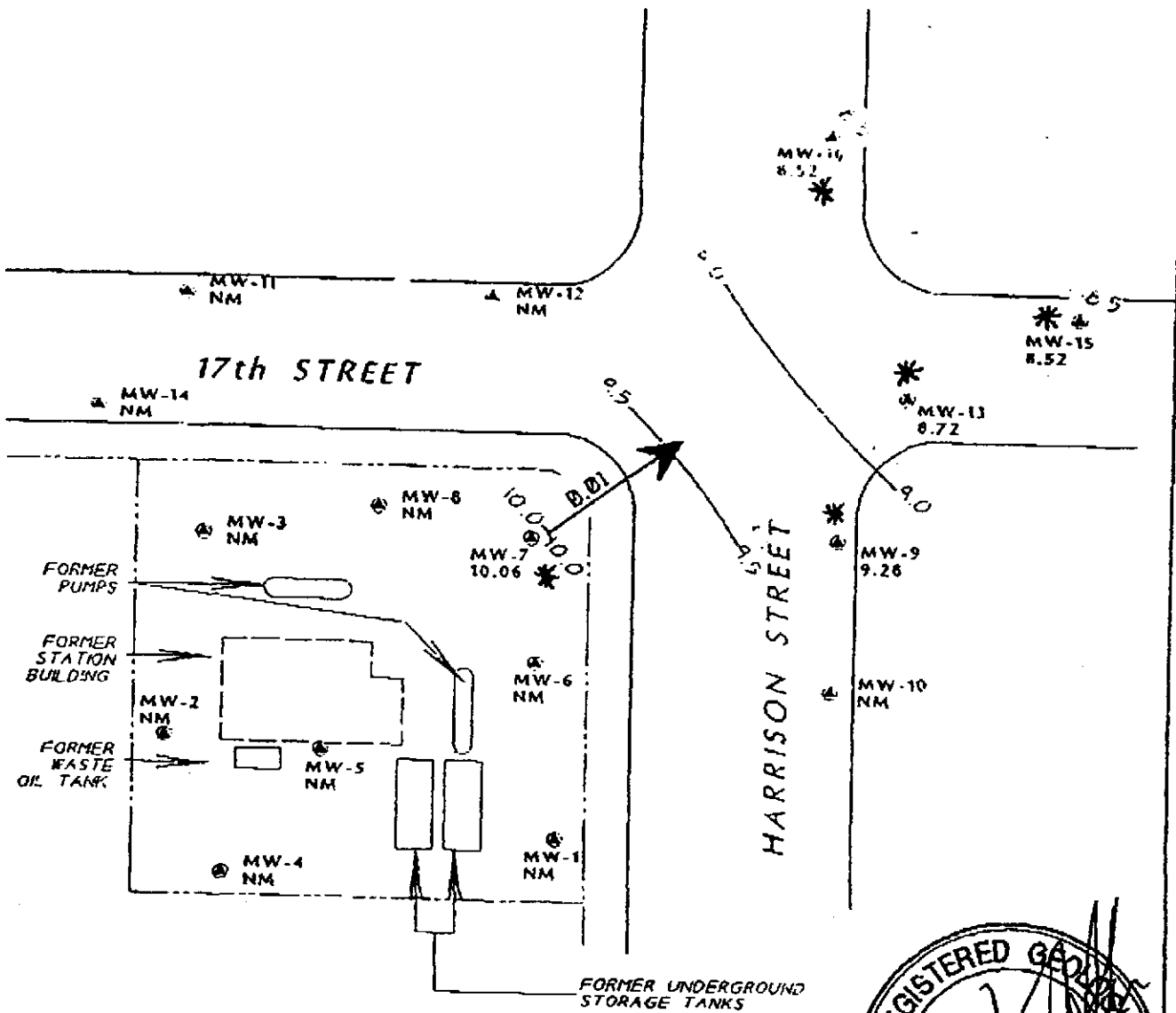
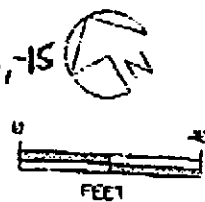

TITLE : GROUND-WATER ELEVATION CONTOUR MAP - MARCH 20, 1997

LOCATION : CHEVRON SERVICE STATION 9-0020
1633 HARRISON STREET, OAKLAND, CALIFORNIA

SOURCE : CAMBRIA ENVIRONMENTAL TECHNOLOGY, INC



GEOCONSULTANTS, INC
SAN JOSE, CALIFORNIA
Project No. G758-09
Chevron/Alameda 1633097

CONFIDENTIAL

STATE OF CALIFORNIA DWR
WELL COMPLETION REPORT
(WELL LOGS)

REMOVED