

March 2, 2004

Mr. Don Hwang – Hazardous Materials Specialist
Local Oversight Program
Alameda County Health Care Services Agency
Environmental Health Services – Environmental Protection
1131 Harbor Bay Parkway, Suite 250
Alameda, California 94502-6577

Alameda County
MAR 05 2004
Environmental Health

Subject: Workplan for Additional Site Characterization
Oakland Auto Works (Former Vogue Tyres) – 240 W. MacArthur Blvd., Oakland, CA
ACEH Fuel Leak Case No. R00000142

Dear Mr. Hwang:

Stellar Environmental Solutions, Inc. (SES) is submitted the attached five (5) figures, which your agency previously requested as supporting documentation for the referenced technical workplan. Attached are:

- Site plan showing cross-section lines, and proposed boreholes (with borehole names)
- Geologic cross-section with previous analytical results, utility conduits, and proposed boreholes
- Site vicinity plan showing underground utilities that might be potential preferential pathways
- Maps (2) showing gasoline and MTBE isoconcentration contours, respectively, for the subject site and the adjacent Shell Service station

We hope that this information will be helpful in obtaining your final approval of the workplan, which we will discuss in the upcoming meeting (not yet scheduled) that you have requested be conducted. Please call if you have any questions.

Sincerely,

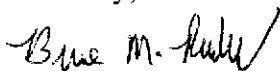

Bruce M. Rucker, R.G., R.E.A.
Project Manager

cc: Mr. Glen Poy-Wing (responsible party)

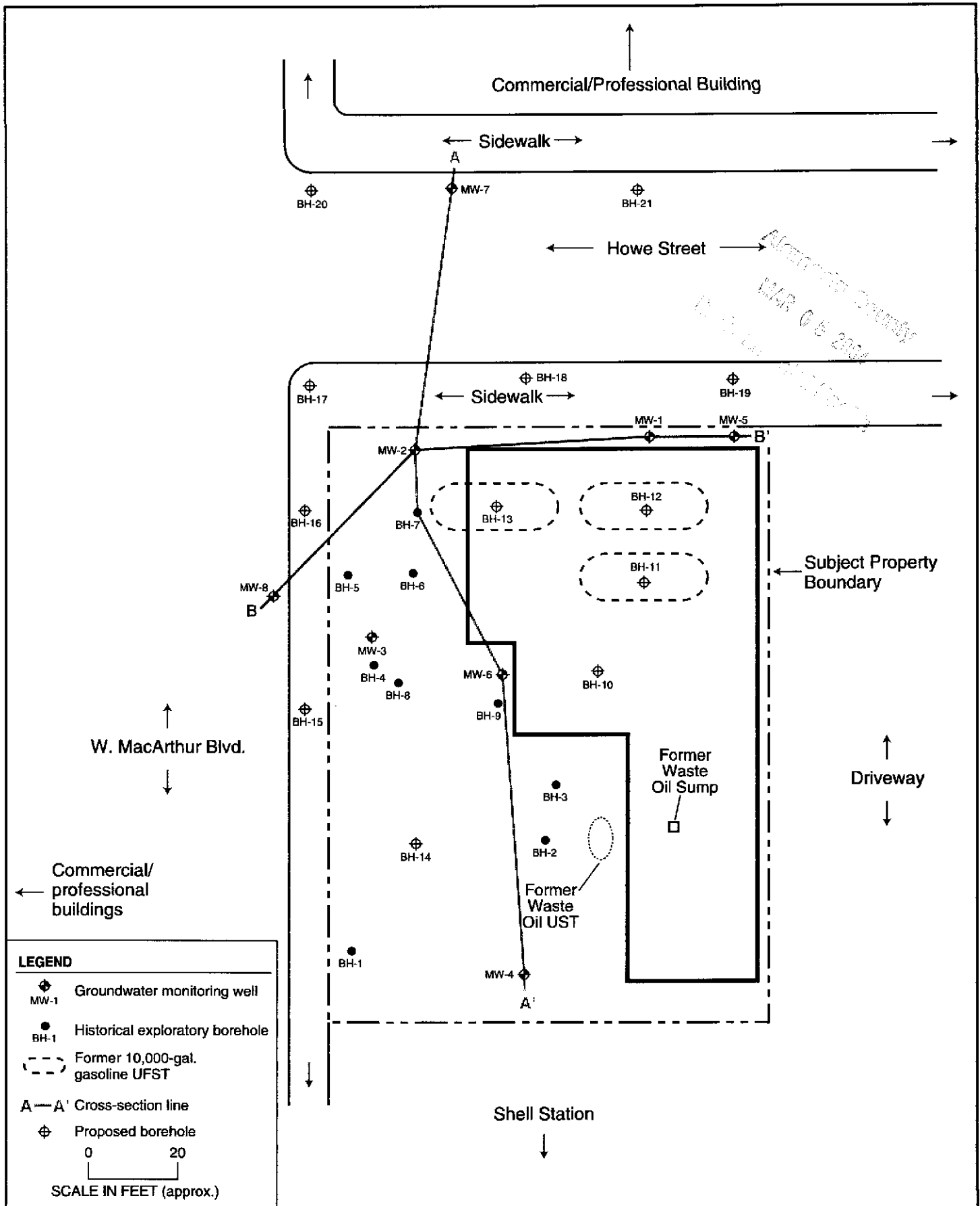

2003-43-27

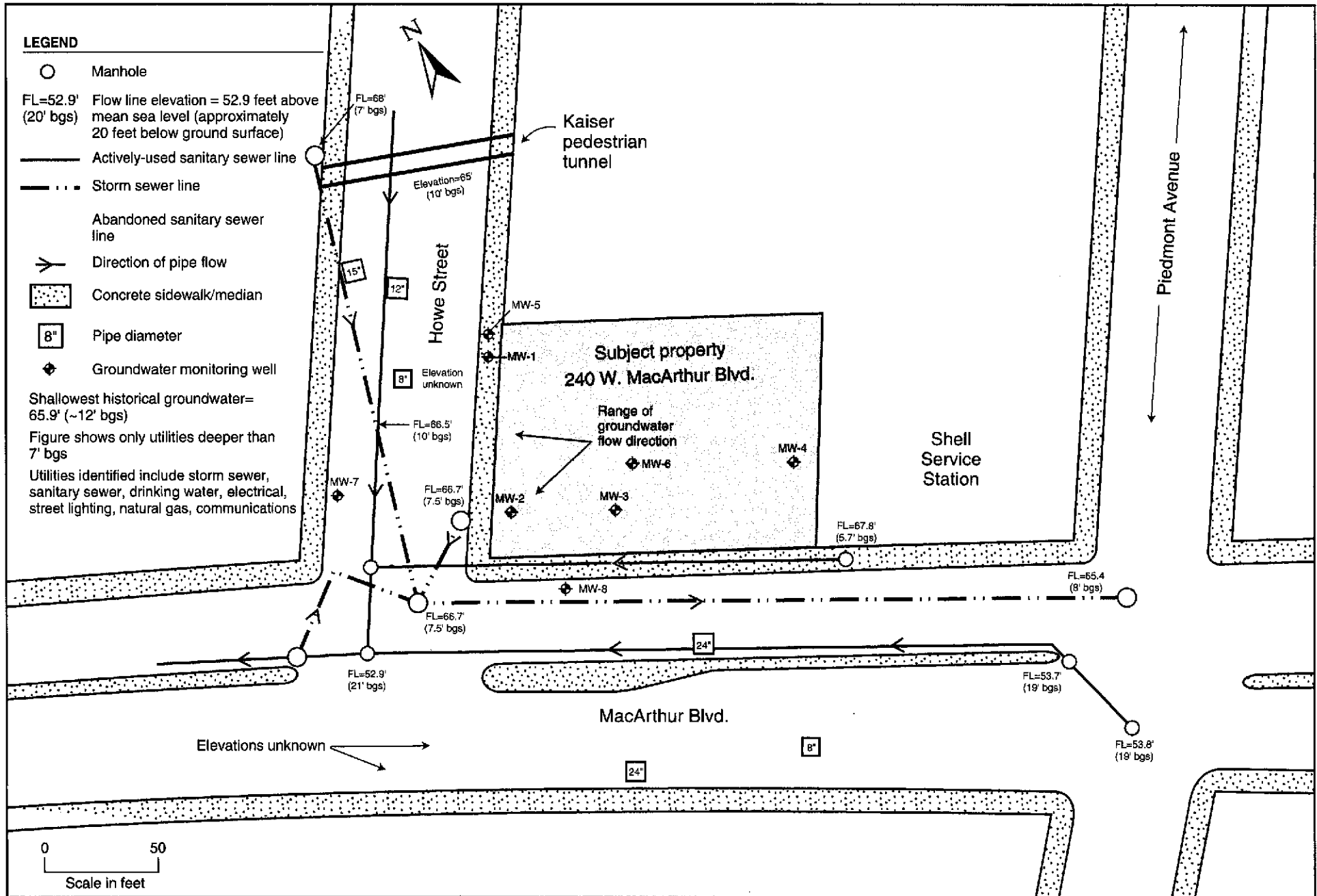

POTENTIAL PREFERENTIAL PATHWAY/UTILITY LOCATION MAP
240 W. MacArthur Blvd., Oakland

Figure 2

by: MJC FEBRUARY 2004

Stellar Environmental Solutions, Inc.
 Geoscience & Engineering Consulting

2003-43-25

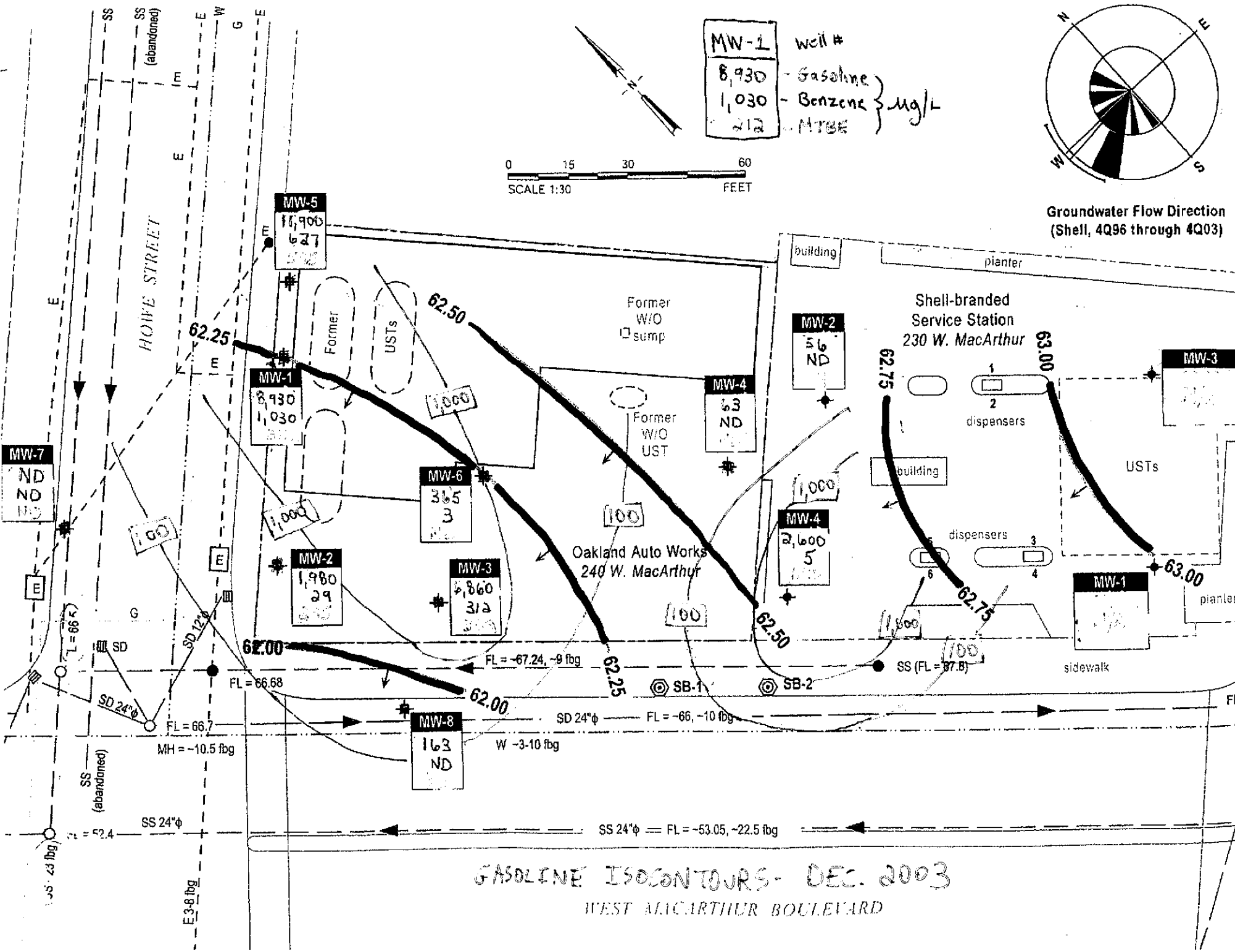

| | |
|-------|------------|
| MW-1 | Well # |
| 8,930 | - Gasoline |
| 1,030 | - Benzene |
| 212 | - MTBE |

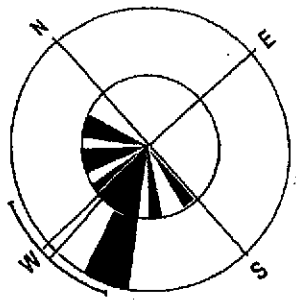
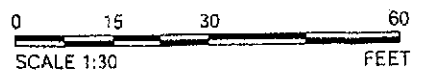

Groundwater Flow Direction
(Shell, 4Q96 through 4Q03)

GASOLINE ISOCONTOURS - DEC. 2003
WEST MACARTHUR BOULEVARD

MW-5
11,900
627
528

MW-1
8,930
1,030
212

MW-6
365
3
1,000

MW-3
4,860
312
529

MW-2
1,980
29
525

MW-4
63
ND
1,000

MW-2
56
ND
1,000

MW-4
2,600
5
1,000

MW-3
2,600
5
1,000

MW-3
2,600
5
1,000

MW-8
163
ND
1,000

MW-7
ND
ND
1,000

SS (abandoned)
24"φ
FL = 52.4

MH = -10.5 fbg

FL = 66.68

FL = 66.7

FL = -67.24, -9 fbg

SB-1

SB-2

FL = -66, -10 fbg

SS 24"φ FL = -53.05, -22.5 fbg

E 3'-8 fbg

HOWE STREET

Oakland Auto Works
240 W. MacArthur

Shell-branded
Service Station
230 W. MacArthur

Former
W/O
sump

Former
W/O
UST

Former
USTs

Former
USTs

USTs

planter

sidewalk

dispensers

dispensers

planter

building

building

1
2

3
4

5
6

1
2

3
4

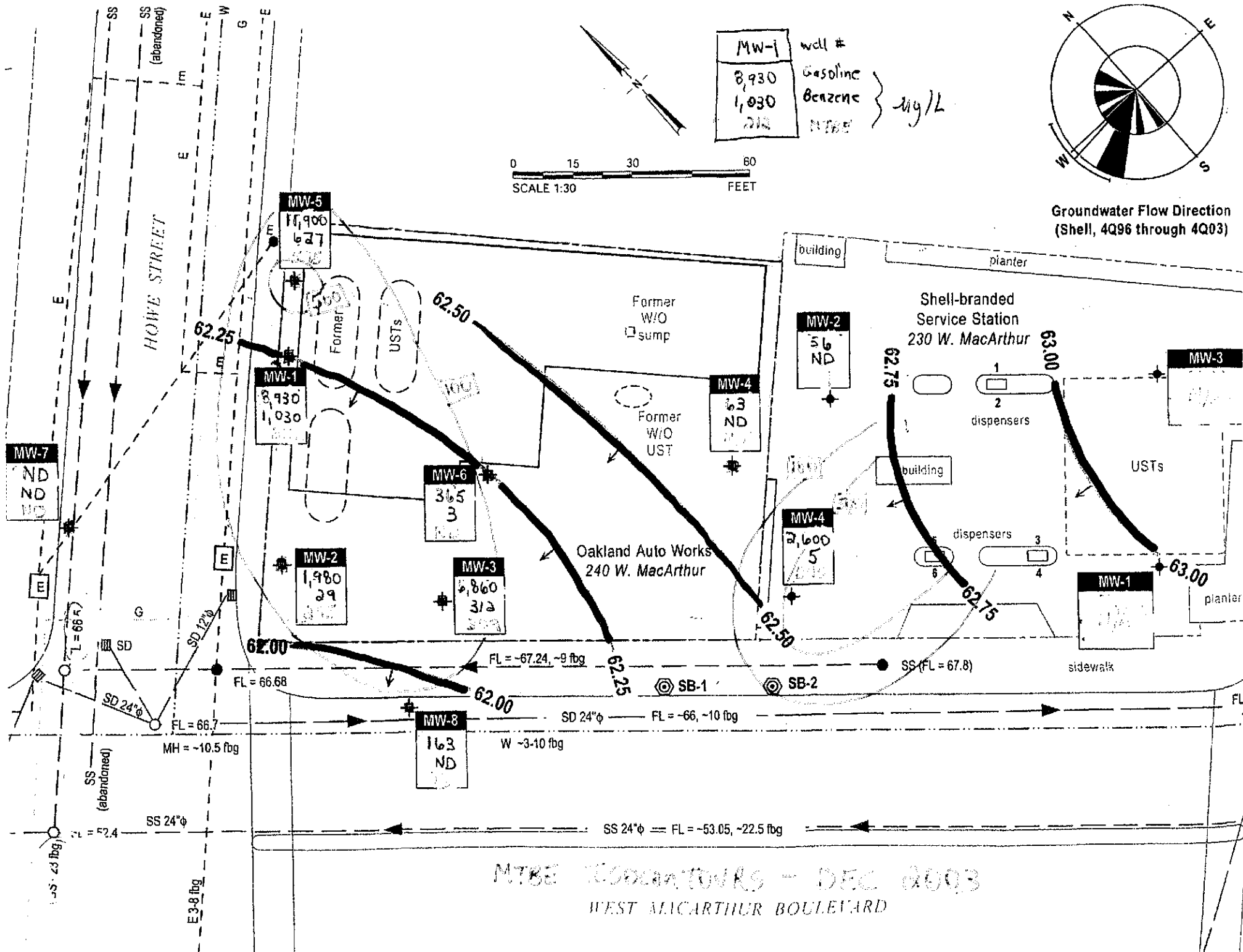

| | |
|-------|----------|
| MW-1 | well # |
| 8,930 | Gasoline |
| 1,030 | Benzene |
| 212 | MTBE |

} mg/L

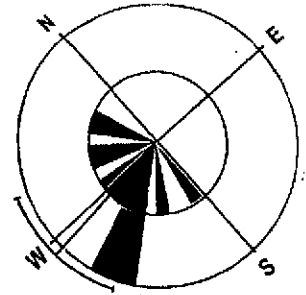
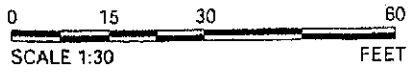

Groundwater Flow Direction
(Shell, 4Q96 through 4Q03)

MTBE MONITORINGS - DEC 2003
WEST MACARTHUR BOULEVARD

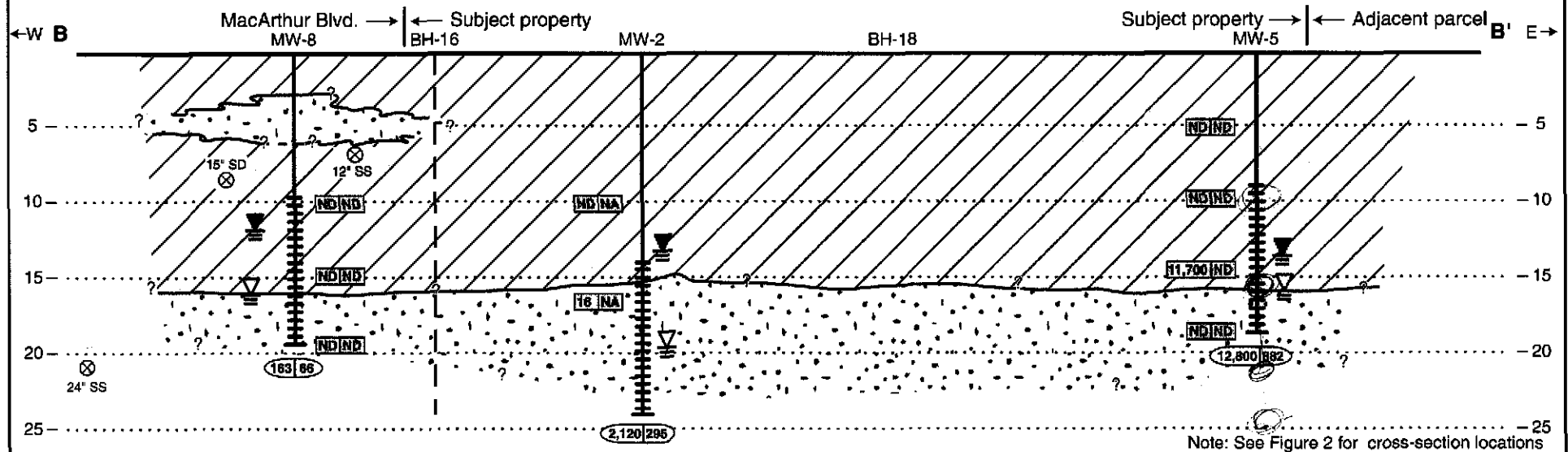
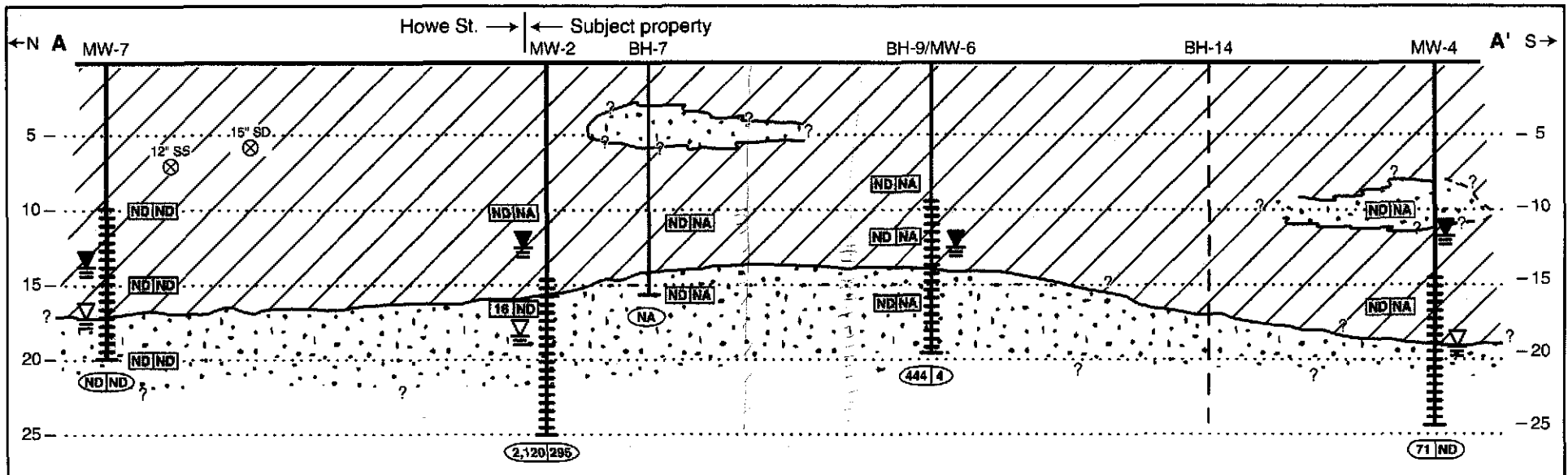

Note: All depths are relative to ground surface at that location, and do not correspond to actual elevations between boreholes.

0 20
Horizontal scale (in feet)

ND = Not detected
NA = Not analyzed

Inferred higher permeability soils (sand with little or no fines; gravel)

Inferred lower permeability soils (clay, silt, silty sand)

Sanitary sewer (SS) or storm drain (SD) with diameter in inches

Soil results (gas/MTBE) in mg/Kg

Proposed borehole

Monitoring well showing screened interval

Highest water level in well

Water level during drilling

Dec. 2003 groundwater result (gas/MTBE) in $\mu\text{g/L}$

Note: See Figure 2 for cross-section locations

2003-43-26

★ Stellar Environmental Solutions, Inc.
Geoscience & Engineering Consulting

GEOLOGIC CROSS SECTIONS A-A' AND B-B'
240 W. MacArthur Blvd., Oakland, CA

Figure 3

by: MJC

FEBRUARY 2004