



Chevron

Chevron Products Company
6001 Bollinger Canyon Road
Building L, Room 1080
PO Box 6004
San Ramon, CA 94583-0904

Philip R. Briggs
Project Manager
Site Assessment & Remediation
Phone 925 842-9136
Fax 925 842-8370

Mr. Don Hwang
Alameda County Health Care Services
Department of Environmental Health
1131 Harbor Bay Parkway, Suite 250
Alameda, CA 94502-6577

Re: Former Chevron Service Station #9-0019
210 Grand Avenue
Oakland, California

Dear Mr. Hwang:

Enclosed is the First Quarter Groundwater Monitoring report for 1999, prepared by our consultant Blaine Tech Services, Inc. for the above noted facility. The ground water samples were analyzed for TPH-g, BTEX, and MtBE. Monitoring wells MW-4 and MW-5 are sampled semi-annually (1st & 3rd quarters), while wells MW-6 and MW-7 will only be gauged to establish water gradient. Note that wells MW-1, MW-2 and MW-3 have been abandoned.

In the last sampling event, monitoring well MW-4 detected concentrations of all the constituents, which appeared to be an anomaly, since no constituents had been detected in that well for the seven prior sampling events. It was noted that additional sampling would be required to establish any pattern. In this sampling event no constituents were detected in well MW-4, so it appears that the previous sampling results was an anomaly.

The concentration of benzene declined in well MW-5 from the last sampling event. It appears that the ORC that has been added to MW-5 is having an effect on the hydrocarbons in the groundwater around this well. However, Chevron will add additional ORC to this well prior to the next sampling event, as the D.O. reading was 1.2 mg/l, which is too low to maintain the natural attenuation occurring at this well.

The depth of the groundwater varied from 1.75 feet to 5.35 feet below grade with a direction of flow northwesterly.

June 10, 1999
Mr. Don Hwang
Former Chevron Service Station # 9-0019
Page2

If you have any questions or comments, call me at (925) 842-9136.

Sincerely,
CHEVRON PRODUCTS COMPANY



Philip R. Briggs
Site Assessment and Remediation Project Manager

Enclosure

cc: Ms. Bette Owen, Chevron

Mr. Ron Basarich
City of Oakland
Real Estate Department
1330 Broadway, Suite 101
Oakland, CA 94612

Mr. Andrew Clark-Clough
City of Oakland
Environmental Affairs Division
1333 Broadway, Suite 330
Oakland, CA 94612

BLAINE
TECH SERVICES INC



1680 ROGERS AVENUE
SAN JOSE, CALIFORNIA 95112-1105
(408) 573-7771 FAX
(408) 573-0555 PHONE

ENVIRONMENTAL
PROTECTION

99 JUN 14 PM 3:50

May 26, 1999

Phil Briggs
Chevron U.S.A. Products Company
P.O. Box 6004
San Ramon, CA 94583-0904

1st Quarter 1999 Monitoring at 9-0019

First Quarter 1999 Groundwater Monitoring at
Former Chevron Service Station Number 9-0019
210 Grand Avenue
Oakland, CA

Monitoring Performed on March 11, 1999

Groundwater Sampling Report 990311-K-5

This report covers the routine monitoring of groundwater wells at this Chevron facility. Blaine Tech Services, Inc.'s work at the site includes inspection, gauging, evacuation, purgewater containment, sample collection and sample handling in accordance with standard procedures that conform to Regional Water Quality Control Board requirements.

Routine field data collection includes depth to water, total well depth, thickness of any separate immiscible layer, water column volume, calculated volume of a three-case volume purge, elapsed evacuation time, total volume of water removed, and standard water parameter instrument readings. Sample material is collected, contained, stored, and transported to the laboratory in conformance with EPA standards. Purgewater is, likewise, collected and transported to McKittrick Waste Treatment Site for disposal.

Basic field information is presented alongside analytical values excerpted from the laboratory report in the cumulative table of **WELL DATA AND ANALYTICAL RESULTS**. The full analytical report for the most recent samples is located in the **Analytical Appendix**. The table also contains new groundwater elevation calculations taken from the computer plotted gradient

map which is located in the **Professional Engineering Appendix**.

At a minimum, Blaine Tech Services, Inc. field personnel are certified upon completion of a forty-hour Hazardous Materials and Emergency Response training course per 29 CFR 1910.120. Field personnel are also enrolled in annual eight hour refresher courses.

Blaine Tech Services, Inc. conducts sampling and documentation assignments of this type as an independent third party. In order to avoid compromising the objectivity necessary for the proper and disinterested performance of this work, Blaine Tech Services, Inc. concentrates on objective data collection and does not participate in the interpretation of analytical results, the definition of geological or hydrological conditions, the formulation of recommendations, or the marketing of remedial systems.

Please call if you have any questions.

Yours truly,



Christine Lillie
Project Coordinator

CAL/sb

attachments: Professional Engineering Appendix
Cumulative Table of Well Data and Analytical Results
Analytical Appendix
Field Data Sheets

Professional Engineering Appendix

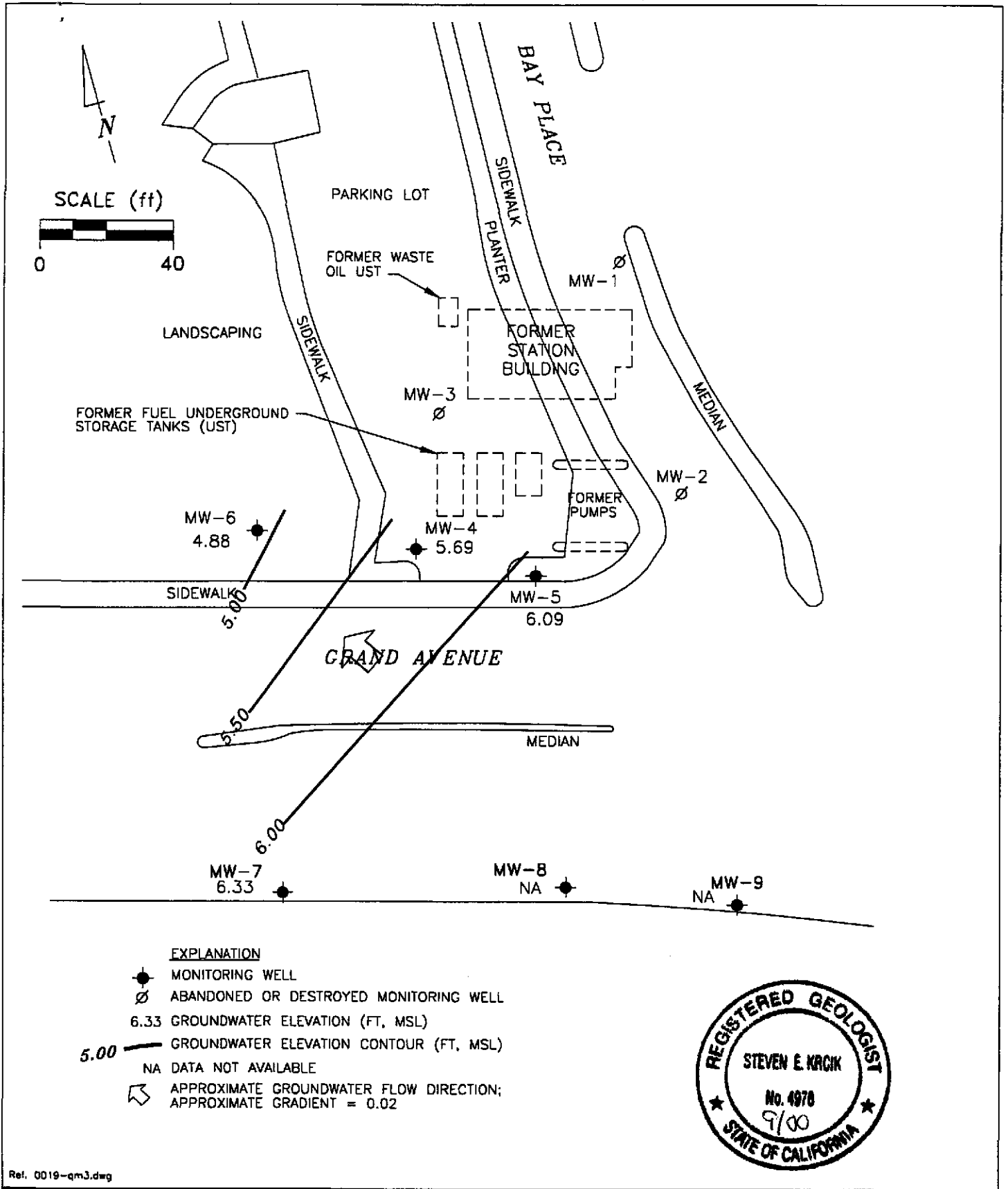

Ref. 0019-qm3.dwg

PREPARED BY

RRM
engineering contracting firm

Former Chevron Station 9-0019
210 Grand Avenue
Oakland, California

GROUNDWATER ELEVATION CONTOUR MAP,
MARCH 11, 1999

FIGURE:

1

PROJECT:

DAC04

Table of Well Data and Analytical Results

Cumulative Table of Well Data and Analytical Results

Vertical Measurements are in feet.

Analytical results are in parts per billion (ppb)

DATE	Well Head Elev.	Ground Water Elev.	Depth To Water	Notes	TPH-Gasoline	Benzene	Toluene	Ethyl-Benzene	Xylene	TOG	Chloro-form	1,2-DCA	Freon	1,1,1-TCA	PCE	1,2-DCPA	1,2-DCE	MTBE	
MW-1																			
03/14/89	9.63	2.89	6.74	--	600	<0.2	<0.2	3.2	1.7	<3000	1.0	<0.2	<20	<0.2	--	--	--	--	
06/08/89	9.63	2.49	7.14	--	<50	<0.1	<0.5	<0.1	<0.2	--	<0.5	<0.1	<20	<0.1	--	--	--	--	
	9.63	2.42	7.21	--	<50	<0.2	<1.0	<0.2	<0.4	--	<1.0	<0.2	<1.0	0.7	--	--	--	--	
12/08/89	9.63	2.34	7.29	--	<50	<0.3	<0.3	<0.3	<0.6	--	<0.5	<0.5	--	<0.5	--	--	--	--	
03/19/90	9.63	2.63	7.00	--	190	0.8	<0.3	7.0	3.0	--	<0.5	<0.5	--	<0.5	--	--	--	--	
07/06/90	9.63	2.50	7.13	--	<50	<0.3	<0.3	<0.3	<0.6	--	<0.5	<0.5	--	<0.5	--	--	--	--	
10/03/90	9.63	2.10	7.53	--	<50	<0.3	<0.3	<0.3	<0.6	--	<0.5	<0.5	--	<0.5	--	--	--	--	
08/23/91	9.63	2.57	7.06	--	150	5.0	11	3.5	10	--	<0.5	<0.5	--	<0.5	--	--	--	--	
11/22/91	9.63	2.16	7.47	--	86	7.2	11	2.9	13	--	<0.5	<0.5	<0.5	<0.5	--	--	--	--	
02/26/92	9.63	2.94	6.69	--	<50	<0.5	<0.5	<0.5	1.4	--	<0.5	<0.5	<0.5	<0.5	--	--	--	--	
05/22/92	9.63	2.67	6.96	--	<50	<0.5	<0.5	<0.5	<0.5	--	<0.5	<0.5	<0.5	<0.5	--	--	--	--	
09/29/92	9.63	2.44	7.19	--	<50	<0.5	<0.5	<0.5	<0.5	--	<0.5	<0.5	--	<0.5	--	--	--	--	
12/23/92	9.63	2.60	7.03	--	<50	<0.5	<0.5	<0.5	<0.5	--	--	--	--	--	--	--	--	--	
03/22/93	9.63	3.03	6.60	--	<50	<0.5	<0.5	<0.5	<0.5	--	--	--	--	--	--	--	--	--	
06/07/93	9.63	2.66	6.97	--	<50	<0.5	<0.5	<0.5	<0.5	--	--	--	--	--	--	--	--	--	
09/10/93	9.63	2.55	7.08	--	<50	<0.5	<0.5	<0.5	<0.5	--	--	--	--	--	--	--	--	--	
03/07/94	9.63	2.80	6.83	--	<50	<0.5	<0.5	<0.5	1.0	--	--	--	--	--	--	--	--	--	
06/16/94	9.63	2.60	7.03	--	<50	<0.5	<0.5	<0.5	<0.5	--	--	--	--	--	--	--	--	--	
09/08/94	9.63	2.53	7.10	--	<50	1.3	1.5	<0.5	1.7	--	--	--	--	--	--	--	--	--	
11/29/94	9.63	2.81	6.82	--	<50	<0.5	<0.5	<0.5	<0.5	--	--	--	--	--	--	--	--	--	
03/21/95	9.63	3.73	5.90	--	<50	<0.5	<0.5	<0.5	<0.5	--	--	--	--	--	--	--	--	--	
06/27/95	9.63	2.69	6.94	--	<50	<0.5	<0.5	<0.5	<0.5	--	--	--	--	--	--	--	--	--	
09/27/95	9.63	2.13	7.50	--	--	--	--	--	--	--	--	--	--	--	--	--	--	--	
12/29/95	--	--	--	Abandoned	--	--	--	--	--	--	--	--	--	--	--	--	--	--	

Cumulative Table of Well Data and Analytical Results

..

Vertical Measurements are in feet.

Analytical results are in parts per billion (ppb)

DATE	Well Head Elev.	Ground Water Elev.	Depth To Water	Notes	TPH-Gasoline	Benzene	Toluene	Ethyl-Benzene	Xylene	TOG	Chloroform	1, 2-DCA	Freon	1, 1, 1-TCA	PCE	1, 2-DCPA	1, 2-DCE	MTBE
MW-2																		
03/14/89	8.99	2.91	6.08	--	<100	6.7	7.1	0.5	4.6	<3000	<1.0	0.7	<20	<0.2	--	--	--	--
06/08/89	8.99	3.77	5.22	--	--	--	--	--	--	--	--	--	--	<0.2	--	--	--	--
06/09/89	8.99	--	--	--	<100	<0.2	<1.0	<0.2	<0.4	--	<1.0	<0.2	<20	<0.2	--	--	--	--
09/14/89	8.99	3.04	5.95	--	<50	<0.2	<1.0	<0.2	<0.4	--	<1.0	<0.2	<1.0	<0.2	--	--	--	--
12/08/89	8.99	-0.26	9.25	--	<50	<0.3	<0.3	<0.3	<0.6	--	<0.5	<0.5	--	<0.5	--	--	--	--
03/19/90	8.99	3.07	5.92	--	<50	<0.3	<0.3	<0.3	<0.6	--	<0.5	<0.5	--	<0.5	--	--	--	--
07/06/90	9.01	2.22	6.79	--	<50	<0.3	<0.3	<0.3	<0.6	--	<0.5	<0.5	--	<0.5	--	--	--	--
10/03/90	9.01	--	--	--	--	--	--	--	--	--	--	--	--	--	--	--	--	--
08/23/91	9.01	--	--	--	--	--	--	--	--	--	--	--	--	--	--	--	--	--
11/15/91	9.01	--	--	Well Destroyed	--	--	--	--	--	--	--	--	--	--	--	--	--	--

Cumulative Table of Well Data and Analytical Results

Vertical Measurements are in feet.

Analytical results are in parts per billion (ppb)

DATE	Well Head Elev.	Ground Water Elev.	Depth To Water	Notes	TPH-Gasoline	Benzene	Toluene	Ethyl-Benzene	Xylene	TOG	Chloro-form	1, 2-DCA	Freon	1, 1, 1-TCA	PCE	1, 2-DCPA	1, 2-DCE	MTBE	
MW-3																			
03/14/89	8.19	2.16	6.02	--	<100	2.1	0.8	<0.2	2.0	<3000	<1.0	3.0	<20	<0.2	--	--	--	--	
06/08/89	8.19	2.30	5.88	--	--	--	--	--	--	--	--	--	--	--	--	--	--	--	
06/09/89	8.19	--	--	--	<100	<0.5	<1.0	<0.2	<0.4	--	<1.0	3.3	<20	<0.2	--	--	--	--	
09/14/89	8.19	1.88	6.30	--	<50	<0.2	<1.0	<0.2	<0.4	--	<1.0	2.2	<1.0	<0.2	--	--	--	--	
12/08/89	8.19	-1.34	9.52	--	<50	<0.3	<0.3	<0.3	<0.6	--	<0.5	1.3	--	<0.5	--	--	--	--	
03/19/90	8.19	2.01	6.17	--	<50	<0.3	<0.3	<0.3	<0.6	--	0.5	1.3	--	<0.5	--	--	--	--	
07/06/90	8.19	0.67	7.52	--	<50	<0.3	<0.3	<0.3	<0.6	--	<0.5	<0.5	--	<0.5	--	--	--	--	
10/03/90	8.19	0.88	7.31	--	<50	<0.3	<0.3	<0.3	<0.6	--	<0.5	0.83	--	<0.5	--	--	--	--	
08/23/91	8.19	2.53	5.65	--	220	16	22	5.5	16	--	<0.5	0.6	--	<0.5	--	--	--	--	
11/22/91	8.19	1.41	6.78	--	<50	<0.5	<0.5	<0.5	0.6	--	0.6	1.0	<0.5	<0.5	--	--	--	--	
02/26/92	8.19	3.54	4.65	--	<50	4.5	<0.5	<0.5	<0.5	--	<0.5	<0.5	<0.5	<0.5	--	--	--	--	
05/22/92	8.19	2.63	5.56	--	<50	<0.5	<0.5	<0.5	<0.5	--	<0.5	<0.5	<0.5	<0.5	--	--	--	--	
09/29/92	8.19	1.96	6.23	--	<50	<0.5	<0.5	<0.5	<0.5	--	<0.5	<0.5	--	<0.5	--	--	--	--	
12/23/92	8.19	2.37	5.82	--	<50	<0.5	<0.5	<0.5	<0.5	--	<0.5	<0.5	--	<0.5	--	--	--	--	
03/22/93	8.19	3.27	4.92	--	<50	7.0	<0.5	<0.5	<0.5	--	<0.5	<0.5	--	<0.5	--	--	--	--	
06/07/93	8.19	2.50	5.69	--	<50	<0.5	<0.5	<0.5	<0.5	--	<0.5	<0.5	--	<0.5	--	--	--	--	
09/10/93	8.19	2.15	6.04	--	<50	<0.5	<0.5	<0.5	<0.5	--	<0.5	<0.5	--	<0.5	--	--	--	--	
03/07/94	8.19	3.04	5.15	--	<50	1.0	<0.5	<0.5	<0.5	--	<0.5	<0.5	--	<0.5	--	--	--	--	
06/16/94	8.19	2.30	5.89	--	<50	<0.5	<0.5	<0.5	<0.5	--	<0.5	<0.5	--	<0.5	--	--	--	--	
09/08/94	8.19	2.13	6.06	--	<50	<0.5	<0.5	<0.5	<0.5	--	<0.5	<0.5	--	<0.5	1.0	--	--	--	
11/29/94	8.19	3.00	5.19	--	<50	<0.5	<0.5	<0.5	<0.5	--	<0.5	<0.5	<0.5	<0.5	<0.5	<0.5	--	--	
03/21/95	8.19	4.43	3.76	--	<50	<0.5	<0.5	<0.5	<0.5	--	<0.5	<0.5	<0.5	<0.5	<0.5	<0.5	--	--	
06/27/95	8.19	3.09	5.10	--	<50	<0.5	<0.5	<0.5	<0.5	--	<0.5	<0.5	<0.5	<0.5	<0.5	<0.5	--	--	
09/27/95	8.19	2.94	5.25	--	--	--	--	--	--	--	--	--	--	--	--	--	--	--	
12/29/95	--	--	--	Abandoned	--	--	--	--	--	--	--	--	--	--	--	--	--	--	

Cumulative Table of Well Data and Analytical Results

Vertical Measurements are in feet.

Analytical results are in parts per billion (ppb)

DATE	Well Head Elev.	Ground Water Elev.	Depth To Water	Notes	TPH-Gasoline	Benzene	Toluene	Ethyl-Benzene	Xylene	TOG	Chloro-form	1, 2-DCA	Freon	1, 1, 1-TCA	PCE	1, 2-DCPA	1, 2-DCE	MTBE
MW-4																		
03/14/89	7.60	2.08	5.52	--	3000	810	200	30	130	<3000	<20	<5.0	<20	<5.0	--	--	--	--
06/08/89	7.60	3.41	4.19	--	--	--	--	--	--	--	--	--	--	--	--	--	--	--
06/09/89	7.60	--	--	--	900	440	13	22	40	--	<20	<5.0	60	<5.0	--	--	--	--
09/14/89	7.60	2.80	4.80	--	540	220	2.0	6.1	9.3	--	<1.0	2.3	<1.0	<0.2	--	--	--	--
12/08/89	7.60	2.74	4.86	--	150	18	<0.3	1.0	<0.6	--	<0.5	1.9	--	<0.5	--	--	--	--
03/19/90	7.60	2.95	4.65	--	270	50	<0.3	0.7	<0.6	--	<0.5	0.8	--	<0.5	--	--	--	--
07/06/90	7.59	1.17	6.42	--	140	0.7	<0.3	0.5	<0.6	--	<0.5	0.79	--	<0.5	--	--	--	--
10/03/90	7.59	1.20	6.39	--	180	<0.3	<0.3	2.0	<0.6	--	<0.5	0.5	--	<0.5	--	--	--	--
08/23/91	7.59	3.17	4.42	--	400	9.9	6.8	3.1	7.1	--	<0.5	<0.5	--	<0.5	--	--	--	--
11/22/91	7.59	2.21	5.38	--	130	3.4	1.3	3.5	6.0	--	<0.5	<0.5	<0.5	<0.5	--	--	--	--
02/26/92	7.59	4.94	2.65	--	520	15	2.7	6.1	8.6	--	<0.5	<0.5	<0.5	<0.5	--	--	--	--
05/22/92	7.59	3.63	3.96	--	460	20	2.8	5.0	6.9	--	<0.5	<0.5	<0.5	<0.5	--	--	--	--
09/29/92	7.59	2.91	4.68	--	160	1.1	1.7	0.8	2.8	--	<0.5	<0.5	--	<0.5	--	--	--	--
12/23/92	7.59	3.96	3.63	--	110	0.7	0.5	0.9	1.7	--	--	--	--	--	--	--	--	--
03/22/93	7.59	4.69	2.90	--	930	9.0	3.0	7.0	8.0	--	--	--	--	--	--	--	--	--
06/07/93	7.59	3.70	3.89	--	240	2.0	0.9	3.0	3.0	--	--	--	--	--	--	--	--	--
09/10/93	7.59	3.07	4.52	--	<50	<0.5	<0.5	0.8	<0.5	--	--	--	--	--	--	--	--	--
03/07/94	7.59	4.44	3.15	--	550	3.0	3.0	8.0	12	--	--	--	--	--	--	--	--	--
06/16/94	7.59	3.51	4.08	--	150	<0.5	0.6	1.5	0.7	--	--	--	--	--	--	--	--	--
09/08/94	7.59	3.04	4.55	--	<50	<0.5	<0.5	<0.5	1.2	--	--	--	--	--	--	--	--	--
11/29/94	7.59	4.74	2.85	--	130	<0.5	1.1	<0.5	0.58	--	--	--	--	--	--	--	--	--
03/21/95	7.59	5.89	1.70	--	720	2.2	<2.0	5.9	<2.0	--	--	--	--	--	--	--	--	--
06/27/95	7.59	4.21	3.38	--	100	<0.5	<0.5	<0.5	<0.5	--	--	--	--	--	--	--	--	--
09/27/95	7.59	3.84	3.75	--	<50	<0.5	<0.5	<0.5	<0.5	--	--	--	--	--	--	--	--	--
12/29/95	7.59	--	--	Inaccessible	--	--	--	--	--	--	--	--	--	--	--	--	--	--
10/10/96	7.59	3.71	3.88	--	<50	<0.5	<0.5	<0.5	<0.5	--	--	--	--	--	--	--	--	<2.5
12/19/96	7.59	2.53	5.06	--	<50	<0.5	<0.5	<0.5	<0.5	--	--	--	--	--	--	--	--	<2.5
03/22/97	7.59	3.42	4.17	--	<50	<0.5	<0.5	<0.5	<0.5	--	--	--	--	--	--	--	--	<2.5
06/29/97	10.03	5.76	4.27	--	<50	<0.5	<0.5	<0.5	<0.5	--	--	--	--	--	--	--	--	<2.5
09/12/97	10.03	5.61	4.42	--	<50	<0.5	<0.5	<0.5	<0.5	--	--	--	--	--	--	--	--	<2.5
12/05/97	10.03	5.57	4.46	--	<50	<0.5	<0.5	<0.5	<0.5	--	--	--	--	--	--	--	--	<2.5
02/21/98	10.03	5.92	4.11	--	<50	<0.5	<0.5	<0.5	<0.5	--	--	--	--	--	--	--	--	<2.5
08/17/98	10.03	5.61	4.42	--	120	5.4	7.8	3.0	28	--	--	--	--	--	--	--	--	7.4
03/11/99	10.03	5.69	4.34	--	<50	<0.5	<0.5	<0.5	<0.5	--	--	--	--	--	--	--	--	<2.0

Cumulative Table of Well Data and Analytical Results

Vertical Measurements are in feet.

Analytical results are in parts per billion (ppb)

DATE	Well Head Elev.	Ground Water Elev.	Depth To Water	Notes	TPH-Gasoline	Benzene	Toluene	Ethyl-Benzene	Xylene	TOG	Chloro-form	1, 2-DCA	Freon	1, 1, 1-TCA	PCE	1, 2-DCPA	1, 2-DCE	MTBE
MW-5																		
03/14/89	8.35	1.37	6.98	--	20,000	6600	1600	270	1100	<3000	<100	<20	<20	<20	--	--	--	--
06/08/89	8.35	3.62	4.73	--	--	--	--	--	--	--	--	--	--	--	--	--	--	--
06/09/89	8.35	--	--	--	15,000	>2800	270	240	640	--	<20	28	<20	<5.0	--	--	--	--
06/09/89	8.35	--	--	Duplicate	12,000	5100	300	240	700	--	<200	<50	<20	<50	--	--	--	--
09/14/89	8.35	2.98	5.37	--	15,000	>730	>320	>290	440	--	<10	<2.0	<20	<2.0	--	--	--	--
09/14/89	8.35	--	--	Duplicate	15,000	3300	450	490	730	--	<100	<20	100	<20	--	--	--	--
09/14/89	8.35	--	--	Triplicate	16,000	3100	550	400	690	--	<50	<10	<50	<10	--	--	--	--
12/08/89	8.35	-0.78	9.13	--	20,000	4600	640	390	1300	--	<0.5	27	--	<0.5	--	--	--	--
03/19/90	8.35	3.23	5.12	--	25,000	6500	1200	450	2200	--	<0.5	10	--	0.7	--	--	--	--
07/06/90	8.35	2.54	5.81	--	30,000	5600	890	210	1400	--	<0.5	<0.5	--	<0.5	1.2	--	--	--
10/03/90	8.35	1.45	6.90	--	29,000	6000	790	270	1500	--	<0.5	<0.5	--	<0.5	--	2.0	--	--
08/23/91	8.35	3.30	5.05	--	36,000	6100	1200	460	2600	--	<0.5	3.9	--	<0.5	--	0.9	--	--
11/22/91	8.35	2.10	6.25	--	21,000	8000	1500	530	2600	--	<0.5	3.9	<0.5	<0.5	1.0	0.8	--	--
02/26/92	8.35	5.35	3.00	--	43,000	14,000	1600	640	4700	--	<0.5	2.0	<0.5	<0.5	--	--	--	--
05/22/92	8.35	3.86	4.49	--	72,000	18,000	8100	920	10,000	--	<0.5	6.8	<0.5	<0.5	--	--	--	--
09/29/92	8.35	3.50	4.85	--	54,000	14,000	1400	740	8100	--	<0.5	4.4	--	<0.5	--	--	--	--
12/23/92	8.35	4.77	3.58	--	38,000	8400	910	530	5300	--	<0.5	2.9	--	<0.5	--	--	--	--
03/22/93	8.35	--	--	--	--	--	--	--	--	--	--	--	--	--	--	--	--	--
06/07/93	8.35	-3.82	12.17	--	24,000	3000	280	360	1200	--	<0.5	<0.5	--	<0.5	--	--	--	--
09/10/93	8.35	-0.15	8.50	--	8900	860	160	100	320	--	<5.0	<5.0	--	<5.0	--	--	--	--
03/07/94	8.35	5.30	3.05	--	9600	2100	380	120	290	--	<12.5	<12.5	--	<12.5	--	--	--	--
06/16/94	8.35	2.64	5.71	--	--	--	--	--	--	--	--	--	--	--	--	--	--	--
07/08/94	8.35	2.43	5.92	--	10,000	3600	360	210	460	--	<0.5	<0.5	--	<0.5	1.2	--	2.0	--
09/08/94	8.35	3.04	5.31	--	14,000	2800	270	170	360	--	<0.5	2.8	--	<0.5	--	--	--	--
11/29/94	8.35	5.72	2.63	--	11,000	2800	280	130	300	--	<5.0	<5.0	<5.0	<5.0	<5.0	<5.0	--	--
03/21/95	8.35	7.41	0.94	--	6700	1400	120	100	260	--	<0.5	0.59	<0.5	<0.5	<0.5	<0.5	--	--
06/27/95	8.35	6.01	2.34	--	18,000	6100	480	600	990	--	<10	<10	<10	<10	<10	<10	--	--
09/27/95	8.35	4.65	3.70	--	15,000	3600	140	210	310	--	<25	<25	<25	<25	<25	<25	--	--
12/29/95	8.35	--	--	Inaccessible	--	--	--	--	--	--	--	--	--	--	--	--	--	--
10/10/96	8.35	4.31	4.04	--	5700	1800	53	530	84	--	--	--	--	--	--	--	--	<100

CONTINUED ON NEXT PAGE

Cumulative Table of Well Data and Analytical Results

Vertical Measurements are in feet.

Analytical results are in parts per billion (ppb)

DATE	Well Head Elev.	Ground Water Elev.	Depth To Water	Notes	TPH- Gasoline	Benzene	Toluene	Ethyl- Benzene	Xylene	TOG	Chloro- form	1, 2- DCA	Freon	1, 1, 1- TCA	PCE	1, 2- DCPA	1, 2- DCE	MTBE	
MW-5 (CONT'D)																			
12/19/96	8.35	--	--	Inaccessible	--	--	--	--	--	--	--	--	--	--	--	--	--	--	--
03/22/97	8.35	--	--	Inaccessible	--	--	--	--	--	--	--	--	--	--	--	--	--	--	--
04/03/97	--	--	4.46	--	21,000	6800	4100	610	1900	--	--	--	--	--	--	--	--	--	530
06/29/97	10.99	5.90	5.09	--	16,000	5300	1900	530	1600	--	--	--	--	--	--	--	--	--	<250
09/12/97	10.99	5.98	5.01	--	6100	1900	510	120	390	--	--	--	--	--	--	--	--	--	<25
12/05/97	10.99	5.36	5.63	--	52,000	11,000	7700	1400	3600	--	--	--	--	--	--	--	--	--	920
02/21/98	10.99	6.34	4.65	--	55,000	13,000	11,000	450	3300	--	--	--	--	--	--	--	--	--	1200
06/24/98	10.99	5.51	5.48	ORC Installed	--	--	--	--	--	--	--	--	--	--	--	--	--	--	--
08/17/98	10.99	6.05	4.94	--	5700	4100	1500	210	81	--	--	--	--	--	--	--	--	--	<50
03/11/99	10.99	6.09	4.90	--	11,400	1590	2610	351	1200	--	--	--	--	--	--	--	--	--	58.2

Cumulative Table of Well Data and Analytical Results

Vertical Measurements are in feet.

Analytical results are in parts per billion (ppb)

DATE	Well Head Elev.	Ground Water Elev.	Depth To Water	Notes	TPH-Gasoline	Benzene	Toluene	Ethyl-Benzene	Xylene	TOG	Chloro-form	1, 2-DCA	Freon	1, 1, 1-TCA	PCE	1, 2-DCPA	1, 2-DCE	MTBE	
MW-6																			
07/06/90	6.56	-2.53	9.09	--	210	<0.3	<0.3	3.0	7.0	--	<0.5	<0.5	--	<0.5	--	--	--	--	
10/03/90	6.56	0.78	5.78	--	320	<0.3	0.3	1.0	<0.6	--	<0.5	<0.5	--	<0.5	--	--	--	--	
08/23/91	6.56	-0.93	7.49	--	320	1.7	<0.5	2.1	<0.5	--	<0.5	<0.5	--	<0.5	--	--	--	--	
11/22/91	6.56	-1.07	7.63	--	190	1.9	2.2	5.4	7.7	--	<0.5	<0.5	<0.5	<0.5	--	--	--	--	
02/26/92	6.56	1.01	5.55	--	120	2.0	1.5	3.5	5.1	--	<0.5	<0.5	<0.5	<0.5	--	--	--	--	
05/22/92	6.56	-0.38	6.94	--	160	1.1	0.6	0.9	1.0	--	<0.5	<0.5	<0.5	<0.5	--	--	--	--	
09/29/92	6.56	-0.24	6.80	--	65	0.5	1.4	0.5	0.64	--	<0.5	<0.5	--	<0.5	--	--	--	--	
12/23/92	6.56	0.57	5.99	--	140	0.7	0.7	0.9	2.1	--	--	--	--	--	--	--	--	--	
03/22/93	6.56	-0.51	7.07	--	71	<0.5	<0.5	<0.5	<0.5	--	--	--	--	--	--	--	--	--	
06/07/93	6.56	-1.05	7.61	--	85	<0.5	<0.5	2.0	1.0	--	--	--	--	--	--	--	--	--	
09/10/93	6.56	1.88	4.68	--	<50	<0.5	<0.5	1.0	<0.5	--	--	--	--	--	--	--	--	--	
03/07/94	6.56	1.34	5.22	--	<50	<0.5	<0.5	<0.5	0.8	--	--	--	--	--	--	--	--	--	
06/16/94	6.56	2.39	4.17	--	<50	<0.5	<0.5	<0.5	<0.5	--	--	--	--	--	--	--	--	--	
09/08/94	6.56	1.96	4.60	--	70	<0.5	0.6	<0.5	2.3	--	--	--	--	--	--	--	--	--	
11/29/94	6.56	0.03	6.53	--	120	<0.5	<0.5	1.3	<0.5	--	--	--	--	--	--	--	--	--	
03/21/95	6.56	-0.47	7.03	--	<50	<0.5	<0.5	<0.5	<0.5	--	--	--	--	--	--	--	--	--	
06/27/95	6.56	0.20	6.36	--	84	<0.5	<0.5	<0.5	1.1	--	--	--	--	--	--	--	--	--	
09/27/95	6.56	2.21	4.35	--	<50	<0.5	<0.5	<0.5	<0.5	--	--	--	--	--	--	--	--	--	
12/29/95	6.56	0.41	6.15	--	<50	<0.5	<0.5	<0.5	<0.5	--	--	--	--	--	--	--	--	3.2	
03/28/96	6.56	--	--	Inaccessible	--	--	--	--	--	--	--	--	--	--	--	--	--	--	
04/04/96	6.56	2.75	3.81	--	<50	<0.5	<0.5	<0.5	<0.5	--	--	--	--	--	--	--	--	<2.5	
06/21/96	6.56	1.64	4.92	--	130	<0.5	<0.5	<0.5	0.66	--	--	--	--	--	--	--	--	<2.5	
09/26/96	6.56	-0.18	6.74	--	130	<0.5	0.52	0.92	1.0	--	--	--	--	--	--	--	--	<2.5	
12/19/96	6.56	--	--	Inaccessible	--	--	--	--	--	--	--	--	--	--	--	--	--	--	
03/22/97	6.56	--	--	Inaccessible	--	--	--	--	--	--	--	--	--	--	--	--	--	--	
06/29/97	10.23	3.45	6.78	--	<50	<0.5	<0.5	<0.5	<0.5	--	--	--	--	--	--	--	--	<2.5	
09/12/97	10.23	3.97	6.26	--	<50	<0.5	<0.5	<0.5	<0.5	--	--	--	--	--	--	--	--	<2.5	
12/05/97	10.23	3.95	6.28	--	<50	<0.5	<0.5	<0.5	<0.5	--	--	--	--	--	--	--	--	<2.5	
02/21/98	10.23	3.88	6.35	--	<50	<0.5	<0.5	<0.5	<0.5	--	--	--	--	--	--	--	--	<2.5	
08/17/98	10.23	4.33	5.90	No longer sampled	--	--	--	--	--	--	--	--	--	--	--	--	--	--	
03/11/99	10.23	4.88	5.35	--	--	--	--	--	--	--	--	--	--	--	--	--	--	--	

Cumulative Table of Well Data and Analytical Results

Vertical Measurements are in feet.

Analytical results are in parts per billion (ppb)

DATE	Well Head Elev.	Ground Water Elev.	Depth To Water	Notes	TPH-Gasoline	Benzene	Toluene	Ethyl-Benzene	Xylene	TOG	Chloro-form	1,2-DCA	Freon	1,1,1-TCA	PCE	1,2-DCPA	1,2-DCE	MTBE	
MW-7																			
07/06/90	4.99	-0.86	5.85	--	<50	<0.3	<0.3	<0.3	<0.6	<1000	<0.5	<0.5	--	<0.5	--	--	--	--	
10/03/90	4.99	-1.26	6.25	--	<50	<1.5	<1.5	<1.5	<3.0	--	<0.5	<0.5	--	<0.5	--	--	--	--	
08/23/91	4.99	-0.51	5.50	--	<50	<0.5	<0.5	<0.5	<0.5	--	<0.5	<0.5	--	<0.5	--	--	--	--	
11/22/91	4.99	-0.74	5.73	--	<50	<0.5	<0.5	<0.5	<0.5	--	<0.5	<0.5	<0.5	<0.5	--	--	--	--	
02/26/92	4.99	0.15	4.84	--	<50	<0.5	<0.5	<0.5	<0.5	--	<0.5	<0.5	<0.5	<0.5	--	--	--	--	
05/22/92	4.99	0.10	4.89	--	<50	<0.5	<0.5	<0.5	<0.5	--	<0.5	<0.5	<0.5	<0.5	--	--	--	--	
09/29/92	4.99	-0.56	5.55	--	<50	<0.5	<0.5	<0.5	0.6	--	<0.5	<0.5	--	<0.5	--	--	--	--	
12/23/92	4.99	0.12	4.87	--	<50	<0.5	<0.5	<0.5	<0.5	--	--	--	--	--	--	--	--	--	
03/22/93	4.99	0.94	4.05	--	<50	<0.5	<0.5	<0.5	<0.5	--	--	--	--	--	--	--	--	--	
06/07/93	4.99	0.36	4.63	--	<50	<0.5	<0.5	<0.5	<0.5	--	--	--	--	--	--	--	--	--	
09/10/93	4.99	-0.57	5.56	--	<50	<0.5	<0.5	<0.5	<0.5	--	--	--	--	--	--	--	--	--	
03/07/94	4.99	0.34	4.65	--	<50	<0.5	<0.5	<0.5	<0.5	--	--	--	--	--	--	--	--	--	
06/16/94	4.99	-0.08	5.07	--	<50	<0.5	<0.5	<0.5	<0.5	--	--	--	--	--	--	--	--	--	
09/08/94	4.99	-0.34	5.33	--	250	34	40	4.4	26	--	--	--	--	--	--	--	--	--	
11/29/94	4.99	0.12	4.87	--	<50	<0.5	<0.5	<0.5	<0.5	--	--	--	--	--	--	--	--	--	
03/21/95	4.99	1.31	3.68	--	<50	<0.5	<0.5	<0.5	<0.5	--	--	--	--	--	--	--	--	--	
06/27/95	4.99	0.53	4.46	--	<50	<0.5	<0.5	<0.5	<0.5	--	--	--	--	--	--	--	--	--	
12/29/95	4.99	1.24	3.75	--	<50	<0.5	<0.5	<0.5	<0.5	--	--	--	--	--	--	--	--	<2.5	
03/28/96	4.99	1.74	3.25	--	<50	<0.5	<0.5	<0.5	<0.5	--	--	--	--	--	--	--	--	<2.5	
06/21/96	4.99	0.66	4.33	--	<50	<0.5	1.2	<0.5	<0.5	--	--	--	--	--	--	--	--	5.3	
09/26/96	4.99	0.04	4.95	--	<50	<0.5	<0.5	<0.5	<0.5	--	--	--	--	--	--	--	--	<2.5	
12/19/96	4.99	1.81	3.18	--	<50	<0.5	<0.5	<0.5	<0.5	--	--	--	--	--	--	--	--	<2.5	
03/22/97	4.99	2.26	2.73	--	<50	<0.5	<0.5	<0.5	<0.5	--	--	--	--	--	--	--	--	<2.5	
06/29/97	8.08	4.04	4.04	--	<50	<0.5	<0.5	<0.5	<0.5	--	--	--	--	--	--	--	--	<2.5	
09/12/97	8.08	6.04	2.04	--	<50	<0.5	<0.5	<0.5	<0.5	--	--	--	--	--	--	--	--	<2.5	
12/05/97	8.08	5.68	2.40	--	<50	<0.5	<0.5	<0.5	<0.5	--	--	--	--	--	--	--	--	<2.5	
02/21/98	8.08	--	--	Inaccessible	--	--	--	--	--	--	--	--	--	--	--	--	--	--	
08/17/98	8.08	3.46	4.62	No longer sampled	--	--	--	--	--	--	--	--	--	--	--	--	--	--	
03/11/99	8.08	6.33	1.75	--	--	--	--	--	--	--	--	--	--	--	--	--	--	--	

Cumulative Table of Well Data and Analytical Results

Vertical Measurements are in feet.

Analytical results are in parts per billion (ppb)

DATE	Well Head Elev.	Ground Water Elev.	Depth To Water	Notes	TPH-Gasoline	Benzene	Toluene	Ethyl-Benzene	Xylene	TOG	Chloro-form	1, 2-DCA	Freon	1, 1, 1-TCA	PCE	1, 2-DCPA	1, 2-DCE	MTBE	
MW-8																			
07/06/90	6.77	2.79	3.98	--	<50	<0.3	<0.3	<0.3	<0.6	<1000	<0.5	<0.5	--	<0.5	--	--	--	--	
10/03/90	6.77	2.04	4.73	--	<50	<0.3	<0.3	<0.3	<0.6	--	<0.5	<0.5	--	<0.5	--	--	--	--	
08/23/91	6.77	2.01	4.76	--	<50	<0.5	<0.5	<0.5	<0.5	--	<0.5	<0.5	--	<0.5	--	--	--	--	
11/22/91	6.77	1.04	5.73	--	<50	<0.5	<0.5	<0.5	<0.5	--	<0.5	<0.5	<0.5	<0.5	--	--	--	--	
02/26/92	6.77	2.47	4.30	--	<50	<0.5	<0.5	<0.5	<0.5	--	<0.5	<0.5	<0.5	<0.5	--	--	--	--	
05/22/92	6.77	3.11	3.66	--	<50	<0.5	<0.5	<0.5	<0.5	--	<0.5	<0.5	<0.5	<0.5	--	--	--	--	
09/29/92	6.77	--	--	--	--	--	--	--	--	--	--	--	--	--	--	--	--	--	
12/23/92	6.77	3.94	2.83	--	<50	<0.5	7.2	0.6	2.5	--	--	--	--	--	--	--	--	--	
03/22/93	6.77	2.39	4.38	--	<50	<0.5	<0.5	<0.5	<0.5	--	--	--	--	--	--	--	--	--	
06/07/93	6.77	1.60	5.17	--	<50	<0.5	<0.5	<0.5	<0.5	--	--	--	--	--	--	--	--	--	
09/10/93	6.77	1.61	5.16	--	<50	<0.5	<0.5	<0.5	<0.5	--	--	--	--	--	--	--	--	--	
03/07/94	6.77	2.06	4.71	--	<50	<0.5	<0.5	<0.5	<0.5	--	--	--	--	--	--	--	--	--	
06/16/94	6.77	2.62	4.15	--	<50	<0.5	<0.5	<0.5	<0.5	--	--	--	--	--	--	--	--	--	
09/08/94	6.77	1.66	5.11	--	<50	<0.5	<0.5	<0.5	<0.5	--	--	--	--	--	--	--	--	--	
11/29/94	6.77	1.94	4.83	--	<50	<0.5	<0.5	<0.5	<0.5	--	--	--	--	--	--	--	--	--	
03/21/95	6.77	0.94	5.83	--	<50	<0.5	<0.5	<0.5	<0.5	--	--	--	--	--	--	--	--	--	
06/27/95	6.77	0.57	6.20	--	<50	<0.5	<0.5	<0.5	<0.5	--	--	--	--	--	--	--	--	--	
09/27/95	6.77	1.62	5.15	--	--	--	--	--	--	--	--	--	--	--	--	--	--	--	
12/29/95	6.77	2.22	4.55	--	--	--	--	--	--	--	--	--	--	--	--	--	--	--	
03/28/96	6.77	2.55	4.22	--	--	--	--	--	--	--	--	--	--	--	--	--	--	--	
06/21/96	6.77	3.41	3.36	--	--	--	--	--	--	--	--	--	--	--	--	--	--	--	
09/26/96	6.77	2.65	4.12	--	--	--	--	--	--	--	--	--	--	--	--	--	--	--	
12/19/96	6.77	3.83	2.94	--	--	--	--	--	--	--	--	--	--	--	--	--	--	--	
03/22/97	6.77	3.88	2.89	--	--	--	--	--	--	--	--	--	--	--	--	--	--	--	
06/29/97	9.88	6.92	2.96	--	--	--	--	--	--	--	--	--	--	--	--	--	--	--	
09/12/97	9.88	7.11	2.77	--	--	--	--	--	--	--	--	--	--	--	--	--	--	--	
12/05/97	9.88	7.16	2.72	--	--	--	--	--	--	--	--	--	--	--	--	--	--	--	
02/21/98	9.88	--	--	Inaccessible	--	--	--	--	--	--	--	--	--	--	--	--	--	--	

NO LONGER MONITORED OR SAMPLED

Cumulative Table of Well Data and Analytical Results

Vertical Measurements are in feet.

Analytical results are in parts per billion (ppb)

DATE	Well Head Elev.	Ground Water Elev.	Depth To Water	Notes	TPH- Gasoline	Benzene	Toluene	Ethyl- Benzene	Xylene	TOG	Chloro- form	1, 2- DCA	Freon	1, 1, 1- TCA	PCE	1, 2- DCPA	1, 2- DCE	MTBE
MW-9																		
07/06/90	7.63	3.02	4.61	--	<50	<0.3	<0.3	<0.3	<0.6	<1000	<0.5	<0.5	--	<0.5	--	--	--	--
10/03/90	7.63	2.49	5.14	--	<50	<0.3	<0.3	<0.3	<0.6	--	<0.5	<0.5	--	<0.5	--	--	--	--
08/23/91	7.63	2.18	5.45	--	<50	<0.5	<0.5	<0.5	<0.5	--	<0.5	<0.5	--	<0.5	--	--	--	--
11/22/91	7.63	2.15	5.48	--	<50	<0.5	<0.5	<0.5	<0.5	--	<0.5	<0.5	<0.5	<0.5	--	--	--	--
02/26/92	7.63	5.00	2.63	--	<50	<0.5	<0.5	<0.5	<0.5	--	<0.5	<0.5	<0.5	<0.5	--	--	--	--
05/22/92	7.63	3.63	4.00	--	<50	<0.5	<0.5	<0.5	<0.5	--	<0.5	<0.5	<0.5	<0.5	--	--	--	--
09/29/92	7.63	2.93	4.70	--	<50	<0.5	<0.5	<0.5	<0.5	--	<0.5	<0.5	--	<0.5	--	--	--	--
12/23/92	7.63	3.87	3.76	--	<50	<0.5	<0.5	<0.5	<0.5	--	--	--	--	--	--	--	--	--
03/22/93	7.63	5.52	2.11	--	<50	<0.5	<0.5	<0.5	<0.5	--	--	--	--	--	--	--	--	--
06/07/93	7.63	4.35	3.28	--	<50	<0.5	<0.5	<0.5	<0.5	--	--	--	--	--	--	--	--	--
09/10/93	7.63	2.45	5.18	--	<50	<0.5	<0.5	<0.5	<0.5	--	--	--	--	--	--	--	--	--
03/07/94	7.63	4.61	3.02	--	<50	<0.5	<0.5	<0.5	<0.5	--	--	--	--	--	--	--	--	--
06/16/94	7.63	3.50	4.13	--	<50	<0.5	<0.5	<0.5	<0.5	--	--	--	--	--	--	--	--	--
09/08/94	7.63	2.84	4.79	--	<50	<0.5	<0.5	<0.5	<0.5	--	--	--	--	--	--	--	--	--
11/29/94	7.63	3.71	3.92	--	<50	<0.5	<0.5	<0.5	<0.5	--	--	--	--	--	--	--	--	--
03/21/95	7.63	0.14	7.49	Insuff. water	--	--	--	--	--	--	--	--	--	--	--	--	--	--
06/27/95	7.63	5.73	1.90	--	<50	<0.5	<0.5	<0.5	<0.5	--	--	--	--	--	--	--	--	--
09/27/95	7.63	3.68	3.95	--	--	--	--	--	--	--	--	--	--	--	--	--	--	--
12/29/95	7.63	5.08	2.55	--	--	--	--	--	--	--	--	--	--	--	--	--	--	--
03/28/96	7.63	5.43	2.20	--	--	--	--	--	--	--	--	--	--	--	--	--	--	--
06/21/96	7.63	4.98	2.65	--	--	--	--	--	--	--	--	--	--	--	--	--	--	--
09/26/96	7.63	4.27	3.36	--	--	--	--	--	--	--	--	--	--	--	--	--	--	--
12/19/96	7.63	5.02	2.61	--	--	--	--	--	--	--	--	--	--	--	--	--	--	--
03/22/97	7.63	5.30	2.33	--	--	--	--	--	--	--	--	--	--	--	--	--	--	--
06/29/97	10.74	7.85	2.89	--	--	--	--	--	--	--	--	--	--	--	--	--	--	--
09/12/97	10.74	7.33	3.41	--	--	--	--	--	--	--	--	--	--	--	--	--	--	--
12/05/97	10.74	8.00	2.74	--	--	--	--	--	--	--	--	--	--	--	--	--	--	--
02/21/98	10.74	--	--	Inaccessible	--	--	--	--	--	--	--	--	--	--	--	--	--	--

NO LONGER MONITORED OR SAMPLED

Cumulative Table of Well Data and Analytical Results

Vertical Measurements are in feet.

Analytical results are in parts per billion (ppb)

DATE	Well Head Elev.	Ground Water Elev.	Depth To Water	Notes	TPH- Gasoline	Benzene	Toluene	Ethyl- Benzene	Xylene	TOG	Chloro- form	1, 2- DCA	Freon	1, 1, 1- TCA	PCE	1, 2- DCPA	1, 2- DCE	MTBE
TRIP BLANK																		
12/08/89	--	--	--	--	<100	<0.1	<0.2	<0.1	<0.2	--	<0.5	<0.1	--	<0.1	--	--	--	--
06/09/89	--	--	--	--	<50	<0.5	<0.5	<0.1	<0.2	--	<0.5	<0.1	<20	<0.1	--	--	--	--
09/14/89	--	--	--	--	<50	<0.1	<0.5	<0.1	<0.2	--	<0.5	<0.1	<0.5	<0.1	--	--	--	--
12/08/89	--	--	--	--	<50	<0.3	<0.3	<0.3	<0.6	--	4.4	<0.5	--	1.9	--	--	--	--
03/19/90	--	--	--	--	<50	<0.3	<0.3	<0.3	<0.6	--	<0.5	<0.5	--	<0.5	--	--	--	--
07/06/90	--	--	--	--	<50	<0.3	<0.3	<0.3	<0.6	--	<0.5	<0.5	--	<0.5	--	--	--	--
10/03/90	--	--	--	--	<50	<0.3	<0.3	<0.3	1.0	--	<0.5	<0.5	--	<0.5	--	--	--	--
08/23/91	--	--	--	--	<50	<0.5	<0.5	<0.5	<0.5	--	--	--	--	--	--	--	--	--
11/22/91	--	--	--	--	<50	<0.5	<0.5	<0.5	<0.5	--	--	--	<0.5	--	--	--	--	--
02/26/92	--	--	--	--	<50	<0.5	<0.5	<0.5	<0.5	--	--	--	--	--	--	--	--	--
05/22/92	--	--	--	--	<50	<0.5	<0.5	<0.5	<0.5	--	--	--	--	--	--	--	--	--
09/29/92	--	--	--	--	<50	<0.5	<0.5	<0.5	<0.5	--	--	--	--	--	--	--	--	--
12/23/92	--	--	--	--	<50	<0.5	<0.5	<0.5	<0.5	--	--	--	--	--	--	--	--	--
03/22/93	--	--	--	--	<50	<0.5	<0.5	<0.5	<0.5	--	--	--	--	--	--	--	--	--
06/07/93	--	--	--	--	<50	<0.5	<0.5	<0.5	1.0	--	--	--	--	--	--	--	--	--
09/10/93	--	--	--	--	<50	<0.5	<0.5	<0.5	<0.5	--	--	--	--	--	--	--	--	--
03/07/94	--	--	--	--	<50	<0.5	<0.5	<0.5	<0.5	--	--	--	--	--	--	--	--	--
06/16/94	--	--	--	--	<50	<0.5	<0.5	<0.5	<0.5	--	--	--	--	--	--	--	--	--
09/08/94	--	--	--	--	<50	<0.5	<0.5	<0.5	<0.5	--	--	--	--	--	--	--	--	--
11/29/94	--	--	--	--	<50	<0.5	<0.5	<0.5	<0.5	--	--	--	--	--	--	--	--	--
03/21/95	--	--	--	--	<50	<0.5	<0.5	<0.5	<0.5	--	--	--	--	--	--	--	--	--
06/27/95	--	--	--	--	<50	<0.5	<0.5	<0.5	<0.5	--	--	--	--	--	--	--	--	--
09/27/95	--	--	--	--	<50	<0.5	<0.5	<0.5	<0.5	--	--	--	--	--	--	--	--	--
12/29/95	--	--	--	--	<50	<0.5	<0.5	<0.5	<0.5	--	--	--	--	--	--	--	--	--
03/28/96	--	--	--	--	<50	<0.5	<0.5	<0.5	<0.5	--	--	--	--	--	--	--	--	<2.5
06/21/96	--	--	--	--	<50	<0.5	<0.5	<0.5	<0.5	--	--	--	--	--	--	--	--	--
09/26/96	--	--	--	--	<50	<0.5	<0.5	<0.5	<0.5	--	--	--	--	--	--	--	--	--
12/19/96	--	--	--	--	<50	<0.5	<0.5	<0.5	<0.5	--	--	--	--	--	--	--	--	<2.5
03/22/97	--	--	--	--	<50	<0.5	<0.5	<0.5	<0.5	--	--	--	--	--	--	--	--	<2.5
06/29/97	--	--	--	--	<50	<0.5	<0.5	<0.5	<0.5	--	--	--	--	--	--	--	--	<2.5

CONTINUED ON NEXT PAGE

Cumulative Table of Well Data and Analytical Results

Vertical Measurements are in feet.

Analytical results are in parts per billion (ppb)

DATE	Well Head Elev.	Ground Water Elev.	Depth To Water	Notes	TPH- Gasoline	Benzene	Toluene	Ethyl- Benzene	Xylene	TOG	Chloro- form	1, 2- DCA	Freon	1, 1, 1- TCA	PCE	1, 2- DCPA	1, 2- DCE	MTBE	
TRIP BLANK (CONT'D)																			
09/12/97	--	--	--	--	<50	<0.5	<0.5	<0.5	<0.5	--	--	--	--	--	--	--	--	--	<2.5
12/05/97	--	--	--	--	<50	<0.5	<0.5	<0.5	<0.5	--	--	--	--	--	--	--	--	--	<2.5
02/21/98	--	--	--	--	<50	<0.5	<0.5	<0.5	<0.5	--	--	--	--	--	--	--	--	--	<2.5
08/17/98	--	--	--	--	<50	<0.5	<0.5	<0.5	<0.5	--	--	--	--	--	--	--	--	--	<2.5
03/11/99	--	--	--	--	<50	<0.5	<0.5	<0.5	<0.5	--	--	--	--	--	--	--	--	--	<2.0

Note: Blaine Tech Services, Inc. began routine monitoring of the groundwater wells at this site on November 1, 1994.
 Earlier field data and analytical results are drawn from the September 27, 1994 Groundwater Technology, Inc. report.
 Resurvey of wells was performed by Ron Archer Civil Engineer Inc. on July 22, 1997.

ABBREVIATIONS:

TPH = Total Petroleum Hydrocarbons
 TOG = Total Oil and Grease
 1,2-DCA = 1,2-Dichloroethane
 1,1,1-TCA = 1,1,1-Trichloroethane

PCE = Trichloroethene
 1,2-DCPA = 1,2-Dichloropropane
 1,2-DCE = 1,2-Dichloroethene
 MTBE = Methyl t-butyl Ether

Analytical Appendix



Sequoia
Analytical

680 Chesapeake Drive
404 N. Wiget Lane
819 Striker Avenue, Suite 8
1455 McDowell Blvd. North, Ste. D

Redwood City, CA 94063
Walnut Creek, CA 94598
Sacramento, CA 95834
Petaluma, CA 94954

(650) 364-9600
(925) 988-9600
(916) 921-9600
(707) 792-1865

FAX (650) 364-9233
FAX (925) 988-9673
FAX (916) 921-0100
FAX (707) 792-0342

March 26, 1999

Christine Lillie
Blaine Tech/Chevron
1680 Rogers Ave.
San Jose, CA 95112

RE: Chevron/P903467

Dear Christine Lillie

Enclosed are the results of analyses for sample(s) received by the laboratory on March 15, 1999. If you have any questions concerning this report, please feel free to contact me.

Sincerely,

Scott Forbes
Project Manager

CA ELAP Certificate Number 2245





**Sequoia
Analytical**

680 Chesapeake Drive
404 N. Wiget Lane
819 Striker Avenue, Suite 8
1455 McDowell Blvd. North, Ste. D

Redwood City, CA 94063
Walnut Creek, CA 94598
Sacramento, CA 95834
Petaluma, CA 94954

(650) 364-9600
(925) 988-9600
(916) 921-9600
(707) 792-1865

FAX (650) 364-9233
FAX (925) 988-9673
FAX (916) 921-0100
FAX (707) 792-0342

Blaine Tech/Chevron 1680 Rogers Ave. San Jose, CA 95112	Project: Chevron Project Number: 9-0019/990311-K5 Project Manager: Christine Lillie	Sampled: 3/11/99 Received: 3/15/99 Reported: 3/26/99
---	---	--

ANALYTICAL REPORT FOR P903467

Sample Description	Laboratory Sample Number	Sample Matrix	Date Sampled
MW-4	P903467-01	Water	3/11/99
MW-5	P903467-02	Water	3/11/99
TB	P903467-03	Water	3/11/99





Blaine Tech/Chevron 1680 Rogers Ave. San Jose, CA 95112	Project: Chevron Project Number: 9-0019/990311-K5 Project Manager: Christine Lillie	Sampled: 3/11/99 Received: 3/15/99 Reported: 3/26/99
---	---	--

**Total Petroleum Hydrocarbons as Gasoline and BTEX by EPA 8015M/8020M
Sequoia Analytical - Petaluma**

Analyte	Batch Number	Date Prepared	Date Analyzed	Surrogate Limits	Reporting Limit	Result	Units	Notes*
				<u>P903467-01</u>			<u>Water</u>	
MW-4								
Gasoline	9030581	3/24/99	3/24/99		50.0	ND	ug/l	
Benzene	"	"	"		0.500	ND	"	
Toluene	"	"	"		0.500	ND	"	
Ethylbenzene	"	"	"		0.500	ND	"	
Xylenes (total)	"	"	"		0.500	ND	"	
Methyl tert-butyl ether	"	"	"		2.00	ND	"	
Surrogate: a,a,a-Trifluorotoluene	"	"	"	65.0-135		103	%	
Surrogate: 4-Bromofluorobenzene	"	"	"	65.0-135		95.7	"	
				<u>P903467-02</u>			<u>Water</u>	
MW-5								
Gasoline	9030581	3/24/99	3/24/99		500	11400	ug/l	
Benzene	"	"	"		5.00	1590	"	
Toluene	"	"	"		5.00	2610	"	
Ethylbenzene	"	"	"		5.00	351	"	
Xylenes (total)	"	"	"		5.00	1200	"	
Methyl tert-butyl ether	"	"	"		20.0	58.2	"	
Surrogate: a,a,a-Trifluorotoluene	"	"	"	65.0-135		97.7	%	
Surrogate: 4-Bromofluorobenzene	"	"	"	65.0-135		103	"	
				<u>P903467-03</u>			<u>Water</u>	
TB								
Gasoline	9030581	3/24/99	3/24/99		50.0	ND	ug/l	
Benzene	"	"	"		0.500	ND	"	
Toluene	"	"	"		0.500	ND	"	
Ethylbenzene	"	"	"		0.500	ND	"	
Xylenes (total)	"	"	"		0.500	ND	"	
Methyl tert-butyl ether	"	"	"		2.00	ND	"	
Surrogate: a,a,a-Trifluorotoluene	"	"	"	65.0-135		95.7	%	
Surrogate: 4-Bromofluorobenzene	"	"	"	65.0-135		103	"	





Blaine Tech/Chevron 1680 Rogers Ave. San Jose, CA 95112	Project: Chevron Project Number: 9-0019/990311-K5 Project Manager: Christine Lillie	Sampled: 3/11/99 Received: 3/15/99 Reported: 3/26/99
---	---	--

**Total Petroleum Hydrocarbons as Gasoline and BTEX by EPA 8015M/8020M/Quality Control
Sequoia Analytical - Petaluma**

Analyte	Date Analyzed	Spike Level	Sample Result	QC Result	Units	Reporting Limit Recov. Limits	Recov. %	RPD Limit	RPD %	Notes*
Batch: 9030581		Date Prepared: 3/24/99		Extraction Method: EPA 5030 waters						
Blank		9030581-BLK1								
Gasoline	3/24/99			ND	ug/l	50.0				
Benzene	"			ND	"	0.500				
Toluene	"			ND	"	0.500				
Ethylbenzene	"			ND	"	0.500				
Xylenes (total)	"			ND	"	0.500				
Methyl tert-butyl ether	"			ND	"	2.00				
Surrogate: a,a,a-Trifluorotoluene	"	300		286	"	65.0-135	95.3			
Surrogate: 4-Bromofluorobenzene	"	300		305	"	65.0-135	102			
LCS		9030581-BS1								
Gasoline	3/24/99	1000		975	ug/l	65.0-135	97.5			
Surrogate: 4-Bromofluorobenzene	"	300		308	"	65.0-135	103			
Matrix Spike		9030581-MS1		P903467-01						
Gasoline	3/24/99	1000	ND	1080	ug/l	65.0-135	108			
Surrogate: 4-Bromofluorobenzene	"	300		299	"	65.0-135	99.7			
Matrix Spike Dup		9030581-MSD1		P903467-01						
Gasoline	3/24/99	1000	ND	968	ug/l	65.0-135	96.8	20.0	10.9	
Surrogate: 4-Bromofluorobenzene	"	300		308	"	65.0-135	103			





Blaine Tech/Chevron 1680 Rogers Ave. San Jose, CA 95112	Project: Chevron Project Number: 9-0019/990311-K5 Project Manager: Christine Lillie	Sampled: 3/11/99 Received: 3/15/99 Reported: 3/26/99
---	---	--

Notes and Definitions

#	Note
---	------

- DET Analyte DETECTED
- ND Analyte NOT DETECTED at or above the reporting limit
- NR Not Reported
- dry Sample results reported on a dry weight basis
- Recov. Recovery
- RPD Relative Percent Difference



Field Data Sheets

CHEVRON WELL MONITORING DATA SHEET

Project #: <u>990311-K5</u>	Station #: <u>9-0019</u>
Sampler: <u>Mark</u>	Date: <u>3/11/99</u>
Well I.D.: <u>4-5</u>	Well Diameter: 2 3 <u>4</u> 6 8
Total Well Depth: <u>9.74</u>	Depth to Water: <u>4.90</u>
Depth to Free Product:	Thickness of Free Product (feet):
Referenced to: <u>PVC</u> Grade	D.O. Meter (if req'd): <u>YSI</u> HACH

Well Diameter	Multiplier	Well Diameter	Multiplier
2"	0.16	5"	1.02
3"	0.37	6"	1.47
4"	0.65	Other	radius ² * 0.163

Purge Method: Bailer Sampling Method: Bailer

Disposable Bailer Disposable Bailer

Middleburg Extraction Port

Electric Submersible Other: _____

Extraction Pump

Other: _____

<u>3.1</u>	x	<u>3</u>	=	<u>9.3</u> Gals.
1 Case Volume (Gals.)		Specified Volumes		Calculated Volume

Time	Temp (°F)	pH	Cond.	Gals. Removed	Observations
<u>1417</u>	<u>65.0</u>	<u>7.1</u>	<u>1497</u>	<u>3</u>	<u>slight odor</u>
<u>1418</u>	<u>65.2</u>	<u>7.1</u>	<u>1503</u>	<u>6</u>	
<u>1419</u>	<u>65.6</u>	<u>7.1</u>	<u>1512</u>	<u>10</u>	

Did well dewater? Yes No Gallons actually evacuated: 10

Sampling Time: 1425 Sampling Date: 3/11

Sample I.D.: 4-5 Laboratory: Sequon GTEL N. Creek Assoc. Labs

Analyzed for: TPH-G BTEX MTBE TPH-D Other:

Duplicate I.D.: Analyzed for: TPH-G BTEX MTBE TPH-D Other:

D.O. (if req'd):	Pre-purge: <u>1.2</u> mg/L	Post-purge: _____ mg/L
O.R.P. (if req'd):	Pre-purge: _____ mV	Post-purge: _____ mV