

BLAINE TECH SERVICES, INC. ENVIRONMENTAL PROTECTION

985 TIMOTHY DRIVE
SAN JOSE, CA 95133
(408) 995-5535
FAX (408) 293-8773

JAN 28 AM 2:52

November 12, 1996

Phil Briggs
Chevron U.S.A. Products Company
P.O. Box 5004
San Ramon, CA 94583-0804

extra copy

3rd Quarter 1996 Monitoring at 9-0019

Third Quarter 1996 Groundwater Monitoring at
Chevron Service Station Number 9-0019
210 Grand Avenue
Oakland, CA

Monitoring Performed on September 26, 1996

Groundwater Sampling Report 960926-D-2

This report covers the routine quarterly monitoring of groundwater wells at this Chevron facility. Blaine Tech Services, Inc.'s work at the site includes inspection, gauging, evacuation, purgewater containment, sample collection and sample handling in accordance with standard procedures that conform to Regional Water Quality Control Board requirements.

Routine field data collection includes depth to water, total well depth, thickness of any separate immiscible layer, water column volume, calculated volume of a three-case volume purge, elapsed evacuation time, total volume of water removed, and standard water parameter instrument readings. Sample material is collected, contained, stored, and transported to the laboratory in conformance with EPA standards. Purgewater is, likewise, collected and transported to McKittrick Waste Treatment Site for disposal.

Basic field information is presented alongside analytical values excerpted from the laboratory report in the cumulative table of **WELL DATA AND ANALYTICAL RESULTS**. The full analytical report for the most recent samples is located in the **Analytical Appendix**. The table also contains new groundwater elevation calculations taken from the computer plotted gradient map which is located in the **Professional Engineering Appendix**.

At a minimum, Blaine Tech Services, Inc. field personnel are certified upon completion of a forty-hour Hazardous Materials and Emergency Response training course per 29 CFR 1910.120. Field personnel are also enrolled in annual eight hour refresher courses.

Blaine Tech Services, Inc. conducts sampling and documentation assignments of this type as an independent third party. In order to avoid compromising the objectivity necessary for the proper and disinterested performance of this work, Blaine Tech Services, Inc. concentrates on objective data collection and does not participate in the interpretation of analytical results, the definition of geological or hydrological conditions, the formulation of recommendations, or the marketing of remedial systems.

Please call if you have any questions.

Yours truly,

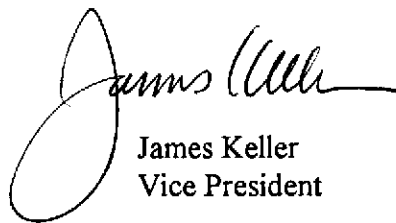

James Keller
Vice President

JPK/cg

attachments: Professional Engineering Appendix
Cumulative Table of Well Data and Analytical Results
Analytical Appendix
Field Data Sheets

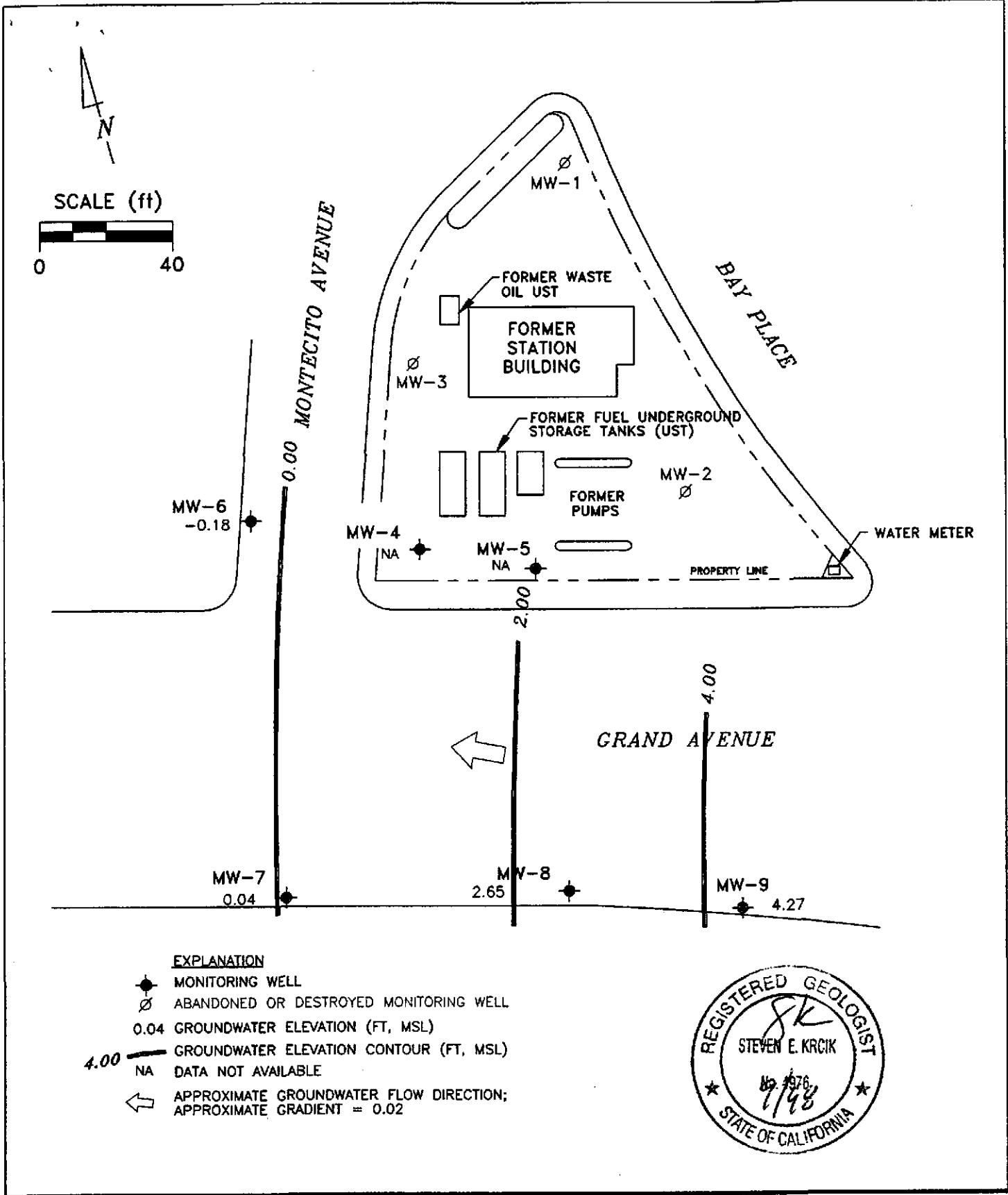

PREPARED BY

RRM INC.

Chevron Station 9-0019

210 Grand Avenue
Oakland, California

**GROUNDWATER ELEVATION
CONTOUR MAP, SEPTEMBER 26, 1996**

FIGURE:

1

PROJECT:

DAC04

Cumulative Table of Well Data and Analytical Results

Vertical Measurements are in feet.

Analytical results are in parts per billion (ppb)

DATE	Well Head Elev.	Ground Water Elev.	Depth To Water	Notes	TPH- Gasoline	Benzene	Toluene	Ethyl- Benzene	Xylene	TOG	Chloro- form	1, 2- DCA	Freon	1, 1, 1- TCA	PCE	1, 2- DCPA	1, 2- DCE	MTBE
MW-1																		
03/14/89	9.63	2.89	6.74	--	600	<0.2	<0.2	3.2	1.7	<3000	1.0	<0.2	<20	<0.2	--	--	--	--
06/08/89	9.63	2.49	7.14	--	<50	<0.1	<0.5	<0.1	<0.2	--	<0.5	<0.1	<20	<0.1	--	--	--	--
09/14/89	9.63	2.42	7.21	--	<50	<0.2	<1.0	<0.2	<0.4	--	<1.0	<0.2	<1.0	0.7	--	--	--	--
12/08/89	9.63	2.34	7.29	--	<50	<0.3	<0.3	<0.3	<0.6	--	<0.5	<0.5	--	<0.5	--	--	--	--
03/19/90	9.63	2.63	7.00	--	190	0.8	<0.3	7.0	3.0	--	<0.5	<0.5	--	<0.5	--	--	--	--
07/06/90	9.63	2.50	7.13	--	<50	<0.3	<0.3	<0.3	<0.6	--	<0.5	<0.5	--	<0.5	--	--	--	--
10/03/90	9.63	2.10	7.53	--	<50	<0.3	<0.3	<0.3	<0.6	--	<0.5	<0.5	--	<0.5	--	--	--	--
08/23/91	9.63	2.57	7.06	--	150	5.0	11	3.5	10	--	<0.5	<0.5	--	<0.5	--	--	--	--
11/22/91	9.63	2.16	7.47	--	86	7.2	11	2.9	13	--	<0.5	<0.5	<0.5	<0.5	--	--	--	--
02/26/92	9.63	2.94	6.69	--	<50	<0.5	<0.5	<0.5	1.4	--	<0.5	<0.5	<0.5	<0.5	--	--	--	--
05/22/92	9.63	2.67	6.96	--	<50	<0.5	<0.5	<0.5	<0.5	--	<0.5	<0.5	<0.5	<0.5	--	--	--	--
09/29/92	9.63	2.44	7.19	--	<50	<0.5	<0.5	<0.5	<0.5	--	<0.5	<0.5	--	<0.5	--	--	--	--
12/23/92	9.63	2.60	7.03	--	<50	<0.5	<0.5	<0.5	<0.5	--	--	--	--	--	--	--	--	--
03/22/93	9.63	3.03	6.60	--	<50	<0.5	<0.5	<0.5	<0.5	--	--	--	--	--	--	--	--	--
06/07/93	9.63	2.66	6.97	--	<50	<0.5	<0.5	<0.5	<0.5	--	--	--	--	--	--	--	--	--
09/10/93	9.63	2.55	7.08	--	<50	<0.5	<0.5	<0.5	<0.5	--	--	--	--	--	--	--	--	--
03/07/94	9.63	2.80	6.83	--	<50	<0.5	<0.5	<0.5	<0.5	--	--	--	--	--	--	--	--	--
06/16/94	9.63	2.60	7.03	--	<50	<0.5	<0.5	<0.5	<0.5	--	--	--	--	--	--	--	--	--
09/08/94	9.63	2.53	7.10	--	<50	1.3	1.5	<0.5	1.7	--	--	--	--	--	--	--	--	--
11/29/94	9.63	2.81	6.82	--	<50	<0.5	<0.5	<0.5	<0.5	--	--	--	--	--	--	--	--	--
03/21/95	9.63	3.73	5.90	--	<50	<0.5	<0.5	<0.5	<0.5	--	--	--	--	--	--	--	--	--
06/27/95	9.63	2.69	6.94	--	<50	<0.5	<0.5	<0.5	<0.5	--	--	--	--	--	--	--	--	--
09/27/95	9.63	2.13	7.50	--	--	--	--	--	--	--	--	--	--	--	--	--	--	--
12/29/95	--	--	--	Abandoned	--	--	--	--	--	--	--	--	--	--	--	--	--	--

Cumulative Table of Well Data and Analytical Results

Vertical Measurements are in feet.

Analytical results are in parts per billion (ppb)

DATE	Well Head Elev.	Ground Water Elev.	Depth To Water	Notes	TPH- Gasoline	Benzene	Toluene	Ethyl- Benzene	Xylene	TOG	Chloro- form	1, 2- DCA	Freon	1, 1, 1- TCA	PCE	1, 2- DCPA	1, 2- DCE	MTBE	
MW-2																			
03/14/89	8.99	2.91	6.08	--	<100	6.7	7.1	0.5	4.6	<3000	<1.0	0.7	<20	<0.2	--	--	--	--	
06/08/89	8.99	3.77	5.22	--	--	--	--	--	--	--	--	--	--	<0.2	--	--	--	--	
06/09/89	8.99	--	--	--	<100	<0.2	<1.0	<0.2	<0.4	--	<1.0	<0.2	<20	<0.2	--	--	--	--	
09/14/89	8.99	3.04	5.95	--	<50	<0.2	<1.0	<0.2	<0.4	--	<1.0	<0.2	<1.0	<0.2	--	--	--	--	
12/08/89	8.99	-0.26	9.25	--	<50	<0.3	<0.3	<0.3	<0.6	--	<0.5	<0.5	--	<0.5	--	--	--	--	
03/19/90	8.99	3.07	5.92	--	<50	<0.3	<0.3	<0.3	<0.6	--	<0.5	<0.5	--	<0.5	--	--	--	--	
07/06/90	9.01	2.22	6.79	--	<50	<0.3	<0.3	<0.3	<0.6	--	<0.5	<0.5	--	<0.5	--	--	--	--	
10/03/90	9.01	--	--	--	--	--	--	--	--	--	--	--	--	--	--	--	--	--	
08/23/91	9.01	--	--	--	--	--	--	--	--	--	--	--	--	--	--	--	--	--	
11/15/91	9.01	--	--	Well Destroyed	--	--	--	--	--	--	--	--	--	--	--	--	--	--	

Cumulative Table of Well Data and Analytical Results

Vertical Measurements are in feet.

Analytical results are in parts per billion (ppb)

DATE	Well Head Elev.	Ground Water Elev.	Depth To Water	Notes	TPH- Gasoline	Benzene	Toluene	Ethyl- Benzene	Xylene	TOG	Chloro- form	1, 2- DCA	Freon	1, 1, 1- TCA	PCE	1, 2- DCPA	1, 2- DCE	MTBE
MW-3																		
03/14/89	8.19	2.16	6.02	--	<100	2.1	0.8	<0.2	2.0	<3000	<1.0	3.0	<20	<0.2	--	--	--	--
06/08/89	8.19	2.30	5.88	--	--	--	--	--	--	--	--	--	--	--	--	--	--	--
06/09/89	8.19	--	--	--	<100	<0.5	<1.0	<0.2	<0.4	--	<1.0	3.3	<20	<0.2	--	--	--	--
09/14/89	8.19	1.88	6.30	--	<50	<0.2	<1.0	<0.2	<0.4	--	<1.0	2.2	<1.0	<0.2	--	--	--	--
12/08/89	8.19	-1.34	9.52	--	<50	<0.3	<0.3	<0.3	<0.6	--	<0.5	1.3	--	<0.5	--	--	--	--
03/19/90	8.19	2.01	6.17	--	<50	<0.3	<0.3	<0.3	<0.6	--	0.5	1.3	--	<0.5	--	--	--	--
07/06/90	8.19	0.67	7.52	--	<50	<0.3	<0.3	<0.3	<0.6	--	<0.5	<0.5	--	<0.5	--	--	--	--
10/03/90	8.19	0.88	7.31	--	<50	<0.3	<0.3	<0.3	<0.6	--	<0.5	0.83	--	<0.5	--	--	--	--
08/23/91	8.19	2.53	5.65	--	220	16	22	5.5	16	--	<0.5	0.6	--	<0.5	--	--	--	--
11/22/91	8.19	1.41	6.78	--	<50	<0.5	<0.5	<0.5	0.6	--	0.6	1.0	<0.5	<0.5	--	--	--	--
02/26/92	8.19	3.54	4.65	--	<50	4.5	<0.5	<0.5	<0.5	--	<0.5	<0.5	<0.5	<0.5	--	--	--	--
05/22/92	8.19	2.63	5.56	--	<50	<0.5	<0.5	<0.5	<0.5	--	<0.5	<0.5	<0.5	<0.5	--	--	--	--
09/29/92	8.19	1.96	6.23	--	<50	<0.5	<0.5	<0.5	<0.5	--	<0.5	<0.5	--	<0.5	--	--	--	--
12/23/92	8.19	2.37	5.82	--	<50	<0.5	<0.5	<0.5	<0.5	--	<0.5	<0.5	--	<0.5	--	--	--	--
03/22/93	8.19	3.27	4.92	--	<50	7.0	<0.5	<0.5	<0.5	--	<0.5	<0.5	--	<0.5	--	--	--	--
06/07/93	8.19	2.50	5.69	--	<50	<0.5	<0.5	<0.5	<0.5	--	<0.5	<0.5	--	<0.5	--	--	--	--
09/10/93	8.19	2.15	6.04	--	<50	<0.5	<0.5	<0.5	<0.5	--	<0.5	<0.5	--	<0.5	--	--	--	--
03/07/94	8.19	3.04	5.15	--	<50	1.0	<0.5	<0.5	<0.5	--	<0.5	<0.5	--	<0.5	--	--	--	--
06/16/94	8.19	2.30	5.89	--	<50	<0.5	<0.5	<0.5	<0.5	--	<0.5	<0.5	--	<0.5	--	--	--	--
09/08/94	8.19	2.13	6.06	--	<50	<0.5	<0.5	<0.5	<0.5	--	<0.5	<0.5	--	<0.5	1.0	--	--	--
11/29/94	8.19	3.00	5.19	--	<50	<0.5	<0.5	<0.5	<0.5	--	<0.5	<0.5	<0.5	<0.5	<0.5	<0.5	--	--
03/21/95	8.19	4.43	3.76	--	<50	<0.5	<0.5	<0.5	<0.5	--	<0.5	<0.5	<0.5	<0.5	<0.5	<0.5	--	--
06/27/95	8.19	3.09	5.10	--	<50	<0.5	<0.5	<0.5	<0.5	--	<0.5	<0.5	<0.5	<0.5	<0.5	<0.5	--	--
09/27/95	8.19	2.94	5.25	--	--	--	--	--	--	--	--	--	--	--	--	--	--	--
12/29/95	--	--	--	Abandoned	--	--	--	--	--	--	--	--	--	--	--	--	--	--

Cumulative Table of Well Data and Analytical Results

Vertical Measurements are in feet.

Analytical results are in parts per billion (ppb)

DATE	Well Head Elev.	Ground Water Elev.	Depth To Water	Notes	TPH- Gasoline	Benzene	Toluene	Ethyl- Benzene	Xylene	TOG	Chloro- form	1, 2- DCA	Freon	1, 1, 1- TCA	PCE	1, 2- DCPA	1, 2- DCE	MTBE
MW-4																		
03/14/89	7.60	2.08	5.52	--	3000	810	200	30	130	<3000	<20	<5.0	<20	<5.0	--	--	--	--
06/08/89	7.60	3.41	4.19	--	--	--	--	--	--	--	--	--	--	--	--	--	--	--
06/09/89	7.60	--	--	--	900	440	13	22	40	--	<20	<5.0	60	<5.0	--	--	--	--
09/14/89	7.60	2.80	4.80	--	540	220	2.0	6.1	9.3	--	<1.0	2.3	<1.0	<0.2	--	--	--	--
12/08/89	7.60	2.74	4.86	--	150	18	<0.3	1.0	<0.6	--	<0.5	1.9	--	<0.5	--	--	--	--
03/19/90	7.60	2.95	4.65	--	270	50	<0.3	0.7	<0.6	--	<0.5	0.8	--	<0.5	--	--	--	--
07/06/90	7.59	1.17	6.42	--	140	0.7	<0.3	0.5	<0.6	--	<0.5	0.79	--	<0.5	--	--	--	--
10/03/90	7.59	1.20	6.39	--	180	<0.3	<0.3	2.0	<0.6	--	<0.5	0.5	--	<0.5	--	--	--	--
08/23/91	7.59	3.17	4.42	--	400	9.9	6.8	3.1	7.1	--	<0.5	<0.5	--	<0.5	--	--	--	--
11/22/91	7.59	2.21	5.38	--	130	3.4	1.3	3.5	6.0	--	<0.5	<0.5	<0.5	<0.5	--	--	--	--
02/26/92	7.59	4.94	2.65	--	520	15	2.7	6.1	8.6	--	<0.5	<0.5	<0.5	<0.5	--	--	--	--
05/22/92	7.59	3.63	3.96	--	460	20	2.8	5.0	6.9	--	<0.5	<0.5	<0.5	<0.5	--	--	--	--
09/29/92	7.59	2.91	4.68	--	160	1.1	1.7	0.8	2.8	--	<0.5	<0.5	--	<0.5	--	--	--	--
12/23/92	7.59	3.96	3.63	--	110	0.7	0.5	0.9	1.7	--	--	--	--	--	--	--	--	--
03/22/93	7.59	4.69	2.90	--	930	9.0	3.0	7.0	8.0	--	--	--	--	--	--	--	--	--
06/07/93	7.59	3.70	3.89	--	240	2.0	0.9	3.0	3.0	--	--	--	--	--	--	--	--	--
09/10/93	7.59	3.07	4.52	--	<50	<0.5	<0.5	0.8	<0.5	--	--	--	--	--	--	--	--	--
03/07/94	7.59	4.44	3.15	--	550	3.0	3.0	8.0	12	--	--	--	--	--	--	--	--	--
06/16/94	7.59	3.51	4.08	--	150	<0.5	0.6	1.5	0.7	--	--	--	--	--	--	--	--	--
09/08/94	7.59	3.04	4.55	--	<50	<0.5	<0.5	<0.5	1.2	--	--	--	--	--	--	--	--	--
11/29/94	7.59	4.74	2.85	--	130	<0.5	1.1	<0.5	0.58	--	--	--	--	--	--	--	--	--
03/21/95	7.59	5.89	1.70	--	720	2.2	<2.0	5.9	<2.0	--	--	--	--	--	--	--	--	--
06/27/95	7.59	4.21	3.38	--	100	<0.5	<0.5	<0.5	<0.5	--	--	--	--	--	--	--	--	--
09/27/95	7.59	3.84	3.75	--	<50	<0.5	<0.5	<0.5	<0.5	--	--	--	--	--	--	--	--	--
12/29/95	7.59	--	--	Inaccessible	--	--	--	--	--	--	--	--	--	--	--	--	--	--
10/10/96	7.59	3.71	3.88	--	<50	<0.5	<0.5	<0.5	<0.5	--	--	--	--	--	--	--	--	<2.5

Cumulative Table of Well Data and Analytical Results

Vertical Measurements are in feet.

Analytical results are in parts per billion (ppb)

DATE	Well Head Elev.	Ground Water Elev.	Depth To Water	Notes	TPH- Gasoline	Benzene	Toluene	Ethyl- Benzene	Xylene	TOG	Chloro- form	1, 2- DCA	Freon	1, 1, 1- TCA	PCE	1, 2- DCPA	1, 2- DCE	MTBE	
MW-5																			
03/14/89	8.35	1.37	6.98	--	20,000	6600	1600	270	1100	<3000	<100	<20	<20	<20	--	--	--	--	
06/08/89	8.35	3.62	4.73	--	--	--	--	--	--	--	--	--	--	--	--	--	--	--	
06/09/89	8.35	--	--	--	15,000	>2800	270	240	640	--	<20	28	<20	<5.0	--	--	--	--	
06/09/89	8.35	--	--	Duplicate	12,000	5100	300	240	700	--	<200	<50	<20	<50	--	--	--	--	
09/14/89	8.35	2.98	5.37	--	15,000	>730	>320	>290	440	--	<10	<2.0	<20	<2.0	--	--	--	--	
09/14/89	8.35	--	---	Duplicate	15,000	3300	450	490	730	--	<100	<20	100	<20	--	--	--	--	
09/14/89	8.35	--	---	TriPLICATE	16,000	3100	550	400	690	--	<50	<10	<50	<10	--	--	--	--	
12/08/89	8.35	-0.78	9.13	--	20,000	4600	640	390	1300	--	<0.5	27	--	<0.5	--	--	--	--	
03/19/90	8.35	3.23	5.12	--	25,000	6500	1200	450	2200	--	<0.5	10	--	0.7	--	--	--	--	
07/06/90	8.35	2.54	5.81	--	30,000	5600	890	210	1400	--	<0.5	<0.5	--	<0.5	1.2	--	--	--	
10/03/90	8.35	1.45	6.90	--	29,000	6000	790	270	1500	--	<0.5	<0.5	--	<0.5	--	2.0	--	--	
08/23/91	8.35	3.30	5.05	--	36,000	6100	1200	460	2600	--	<0.5	3.9	--	<0.5	--	0.9	--	--	
11/22/91	8.35	2.10	6.25	--	21,000	8000	1500	530	2600	--	<0.5	3.9	<0.5	<0.5	1.0	0.8	--	--	
02/26/92	8.35	5.35	3.00	--	43,000	14,000	1600	640	4700	--	<0.5	2.0	<0.5	<0.5	--	--	--	--	
05/22/92	8.35	3.86	4.49	--	72,000	18,000	8100	920	10000	--	<0.5	6.8	<0.5	<0.5	--	--	--	--	
09/29/92	8.35	3.50	4.85	--	54,000	14,000	1400	740	8100	--	<0.5	4.4	--	<0.5	--	--	--	--	
12/23/92	8.35	4.77	3.58	--	38,000	8400	910	530	5300	--	<0.5	2.9	--	<0.5	--	--	--	--	
03/22/93	8.35	--	--	--	--	--	--	--	--	--	--	--	--	--	--	--	--	--	
06/07/93	8.35	-3.82	12.17	--	24,000	3000	280	360	1200	--	<0.5	<0.5	--	<0.5	--	--	--	--	
09/10/93	8.35	-0.15	8.50	--	8900	860	160	100	320	--	<5.0	<5.0	--	<5.0	--	--	--	--	
03/07/94	8.35	5.30	3.05	--	9600	2100	380	120	290	--	<12.5	<12.5	--	<12.5	--	--	--	--	
06/16/94	8.35	2.64	5.71	--	--	--	--	--	--	--	--	--	--	--	--	--	--	--	
07/08/94	8.35	2.43	5.92	--	10,000	3600	360	210	460	--	<0.5	<0.5	--	<0.5	1.2	--	2.0	--	
09/08/94	8.35	3.04	5.31	--	14,000	2800	270	170	360	--	<0.5	2.8	--	<0.5	--	--	--	--	
11/29/94	8.35	5.72	2.63	--	11,000	2800	280	130	300	--	<5.0	<5.0	<5.0	<5.0	<5.0	<5.0	--	--	
03/21/95	8.35	7.41	0.94	--	6700	1400	120	100	260	--	<0.5	0.59	<0.5	<0.5	<0.5	<0.5	--	--	
06/27/95	8.35	6.01	2.34	--	18,000	6100	480	600	990	--	<10	<10	<10	<10	<10	<10	--	--	
09/27/95	8.35	4.65	3.70	--	15,000	3600	140	210	310	--	<25	<25	<25	<25	<25	<25	--	--	
12/29/95	8.35	--	--	Inaccessible	--	--	--	--	--	--	--	--	--	--	--	--	--	--	
10/10/96	8.35	4.31	4.04	--	5700	1800	53	530	84	--	--	--	--	--	--	--	--	<100	

Cumulative Table of Well Data and Analytical Results

Vertical Measurements are in feet.

Analytical results are in parts per billion (ppb)

DATE	Well Head Elev.	Ground Water Elev.	Depth To Water	Notes	TPH- Gasoline	Benzene	Toluene	Ethyl- Benzene	Xylene	TOG	Chloro- form	1, 2- DCA	Freon	1, 1, 1- TCA	PCE	1, 2- DCPA	1, 2- DCE	MTBE	
MW-6																			
07/06/90	6.56	-2.53	9.09	--	210	<0.3	<0.3	3.0	7.0	--	<0.5	<0.5	--	<0.5	--	--	--	--	
10/03/90	6.56	0.78	5.78	--	320	<0.3	0.3	1.0	<0.6	--	<0.5	<0.5	--	<0.5	--	--	--	--	
08/23/91	6.56	-0.93	7.49	--	320	1.7	<0.5	2.1	<0.5	--	<0.5	<0.5	--	<0.5	--	--	--	--	
11/22/91	6.56	-1.07	7.63	--	190	1.9	2.2	5.4	7.7	--	<0.5	<0.5	<0.5	<0.5	--	--	--	--	
02/26/92	6.56	1.01	5.55	--	120	2.0	1.5	3.5	5.1	--	<0.5	<0.5	<0.5	<0.5	--	--	--	--	
05/22/92	6.56	-0.38	6.94	--	160	1.1	0.6	0.9	1.0	--	<0.5	<0.5	<0.5	<0.5	--	--	--	--	
09/29/92	6.56	-0.24	6.80	--	65	0.5	1.4	0.5	0.64	--	<0.5	<0.5	--	<0.5	--	--	--	--	
12/23/92	6.56	0.57	5.99	--	140	0.7	0.7	0.9	2.1	--	--	--	--	--	--	--	--	--	
03/22/93	6.56	-0.51	7.07	--	71	<0.5	<0.5	<0.5	<0.5	--	--	--	--	--	--	--	--	--	
06/07/93	6.56	-1.05	7.61	--	85	<0.5	<0.5	2.0	1.0	--	--	--	--	--	--	--	--	--	
09/10/93	6.56	1.88	4.68	--	<50	<0.5	<0.5	1.0	<0.5	--	--	--	--	--	--	--	--	--	
03/07/94	6.56	1.34	5.22	--	<50	<0.5	<0.5	<0.5	0.8	--	--	--	--	--	--	--	--	--	
06/16/94	6.56	2.39	4.17	--	<50	<0.5	<0.5	<0.5	<0.5	--	--	--	--	--	--	--	--	--	
09/08/94	6.56	1.96	4.60	--	70	<0.5	0.6	<0.5	2.3	--	--	--	--	--	--	--	--	--	
11/29/94	6.56	0.03	6.53	--	120	<0.5	<0.5	1.3	<0.5	--	--	--	--	--	--	--	--	--	
03/21/95	6.56	-0.47	7.03	--	<50	<0.5	<0.5	<0.5	<0.5	--	--	--	--	--	--	--	--	--	
06/27/95	6.56	0.20	6.36	--	84	<0.5	<0.5	<0.5	1.1	--	--	--	--	--	--	--	--	--	
09/27/95	6.56	2.21	4.35	--	<50	<0.5	<0.5	<0.5	<0.5	--	--	--	--	--	--	--	--	--	
12/29/95	6.56	0.41	6.15	--	<50	<0.5	<0.5	<0.5	<0.5	--	--	--	--	--	--	--	--	3.2	
03/28/96	6.56	--	--	Inaccessible	--	--	--	--	--	--	--	--	--	--	--	--	--	--	
04/04/96	6.56	2.75	3.81	--	<50	<0.5	<0.5	<0.5	<0.5	--	--	--	--	--	--	--	--	<2.5	
06/21/96	6.56	1.64	4.92	--	130	<0.5	<0.5	<0.5	0.66	--	--	--	--	--	--	--	--	<2.5	
09/26/96	6.56	-0.18	6.74	--	130	<0.5	0.52	0.92	1.0	--	--	--	--	--	--	--	--	<2.5	

Cumulative Table of Well Data and Analytical Results

Vertical Measurements are in feet.

Analytical results are in parts per billion (ppb)

DATE	Well Head Elev.	Ground Water Elev.	Depth To Water	Notes	TPH- Gasoline	Benzene	Toluene	Ethyl- Benzene	Xylene	TOG	Chloro- form	1, 2- DCA	Freon	1, 1, 1- TCA	PCE	1, 2- DCPA	1, 2- DCE	MTBE
MW-7																		
07/06/90	4.99	-0.86	5.85	--	<50	<0.3	<0.3	<0.3	<0.6	<1000	<0.5	<0.5	--	<0.5	--	--	--	--
10/03/90	4.99	-1.26	6.25	--	<50	<1.5	<1.5	<1.5	<3.0	--	<0.5	<0.5	--	<0.5	--	--	--	--
08/23/91	4.99	-0.51	5.50	--	<50	<0.5	<0.5	<0.5	<0.5	--	<0.5	<0.5	--	<0.5	--	--	--	--
11/22/91	4.99	-0.74	5.73	--	<50	<0.5	<0.5	<0.5	<0.5	--	<0.5	<0.5	<0.5	<0.5	--	--	--	--
02/26/92	4.99	0.15	4.84	--	<50	<0.5	<0.5	<0.5	<0.5	--	<0.5	<0.5	<0.5	<0.5	--	--	--	--
05/22/92	4.99	0.10	4.89	--	<50	<0.5	<0.5	<0.5	<0.5	--	<0.5	<0.5	<0.5	<0.5	--	--	--	--
09/29/92	4.99	-0.56	5.55	--	<50	<0.5	<0.5	<0.5	0.6	--	<0.5	<0.5	--	<0.5	--	--	--	--
12/23/92	4.99	0.12	4.87	--	<50	<0.5	<0.5	<0.5	<0.5	--	--	--	--	--	--	--	--	--
03/22/93	4.99	0.94	4.05	--	<50	<0.5	<0.5	<0.5	<0.5	--	--	--	--	--	--	--	--	--
06/07/93	4.99	0.36	4.63	--	<50	<0.5	<0.5	<0.5	<0.5	--	--	--	--	--	--	--	--	--
09/10/93	4.99	-0.57	5.56	--	<50	<0.5	<0.5	<0.5	<0.5	--	--	--	--	--	--	--	--	--
03/07/94	4.99	0.34	4.65	--	<50	<0.5	<0.5	<0.5	<0.5	--	--	--	--	--	--	--	--	--
06/16/94	4.99	-0.08	5.07	--	<50	<0.5	<0.5	<0.5	<0.5	--	--	--	--	--	--	--	--	--
09/08/94	4.99	-0.34	5.33	--	250	34	40	4.4	26	--	--	--	--	--	--	--	--	--
11/29/94	4.99	0.12	4.87	--	<50	<0.5	<0.5	<0.5	<0.5	--	--	--	--	--	--	--	--	--
03/21/95	4.99	1.31	3.68	--	<50	<0.5	<0.5	<0.5	<0.5	--	--	--	--	--	--	--	--	--
06/27/95	4.99	0.53	4.46	--	<50	<0.5	<0.5	<0.5	<0.5	--	--	--	--	--	--	--	--	--
12/29/95	4.99	1.24	3.75	--	<50	<0.5	<0.5	<0.5	<0.5	--	--	--	--	--	--	--	--	<2.5
03/28/96	4.99	1.74	3.25	--	<50	<0.5	<0.5	<0.5	<0.5	--	--	--	--	--	--	--	--	<2.5
06/21/96	4.99	0.66	4.33	--	<50	<0.5	1.2	<0.5	<0.5	--	--	--	--	--	--	--	--	5.3
09/26/96	4.99	0.04	4.95	--	<50	<0.5	<0.5	<0.5	<0.5	--	--	--	--	--	--	--	--	<2.5

Cumulative Table of Well Data and Analytical Results

Vertical Measurements are in feet.

Analytical results are in parts per billion (ppb)

DATE	Well Head Elev.	Ground Water Elev.	Depth To Water	Notes	TPH- Gasoline	Benzene	Toluene	Ethyl- Benzene	Xylene	TOG	Chloro- form	1, 2- DCA	Freon	1, 1, 1- TCA	PCE	1, 2- DCPA	1, 2- DCE	MTBE
MW-8																		
07/06/90	6.77	2.79	3.98	--	<50	<0.3	<0.3	<0.3	<0.6	<1000	<0.5	<0.5	--	<0.5	--	--	--	--
10/03/90	6.77	2.04	4.73	--	<50	<0.3	<0.3	<0.3	<0.6	--	<0.5	<0.5	--	<0.5	--	--	--	--
08/23/91	6.77	2.01	4.76	--	<50	<0.5	<0.5	<0.5	<0.5	--	<0.5	<0.5	--	<0.5	--	--	--	--
11/22/91	6.77	1.04	5.73	--	<50	<0.5	<0.5	<0.5	<0.5	--	<0.5	<0.5	<0.5	<0.5	--	--	--	--
02/26/92	6.77	2.47	4.30	--	<50	<0.5	<0.5	<0.5	<0.5	--	<0.5	<0.5	<0.5	<0.5	--	--	--	--
05/22/92	6.77	3.11	3.66	--	<50	<0.5	<0.5	<0.5	<0.5	--	<0.5	<0.5	<0.5	<0.5	--	--	--	--
09/29/92	6.77	--	--	--	--	--	--	--	--	--	--	--	--	--	--	--	--	--
12/23/92	6.77	3.94	2.83	--	<50	<0.5	7.2	0.6	2.5	--	--	--	--	--	--	--	--	--
03/22/93	6.77	2.39	4.38	--	<50	<0.5	<0.5	<0.5	<0.5	--	--	--	--	--	--	--	--	--
06/07/93	6.77	1.60	5.17	--	<50	<0.5	<0.5	<0.5	<0.5	--	--	--	--	--	--	--	--	--
09/10/93	6.77	1.61	5.16	--	<50	<0.5	<0.5	<0.5	<0.5	--	--	--	--	--	--	--	--	--
03/07/94	6.77	2.06	4.71	--	<50	<0.5	<0.5	<0.5	<0.5	--	--	--	--	--	--	--	--	--
06/16/94	6.77	2.62	4.15	--	<50	<0.5	<0.5	<0.5	<0.5	--	--	--	--	--	--	--	--	--
09/08/94	6.77	1.66	5.11	--	<50	<0.5	<0.5	<0.5	<0.5	--	--	--	--	--	--	--	--	--
11/29/94	6.77	1.94	4.83	--	<50	<0.5	<0.5	<0.5	<0.5	--	--	--	--	--	--	--	--	--
03/21/95	6.77	0.94	5.83	--	<50	<0.5	<0.5	<0.5	<0.5	--	--	--	--	--	--	--	--	--
06/27/95	6.77	0.57	6.20	--	<50	<0.5	<0.5	<0.5	<0.5	--	--	--	--	--	--	--	--	--
09/27/95	6.77	1.62	5.15	--	--	--	--	--	--	--	--	--	--	--	--	--	--	--
12/29/95	6.77	2.22	4.55	--	--	--	--	--	--	--	--	--	--	--	--	--	--	--
03/28/96	6.77	2.55	4.22	--	--	--	--	--	--	--	--	--	--	--	--	--	--	--
06/21/96	6.77	3.41	3.36	--	--	--	--	--	--	--	--	--	--	--	--	--	--	--
09/26/96	6.77	2.65	4.12	--	--	--	--	--	--	--	--	--	--	--	--	--	--	--

Cumulative Table of Well Data and Analytical Results

Vertical Measurements are in feet.

Analytical results are in parts per billion (ppb)

DATE	Well Head Elev.	Ground Water Elev.	Depth To Water	Notes	TPH-Gasoline	Benzene	Toluene	Ethyl-Benzene	Xylene	TOG	Chloroform	1,2-DCA	Freon	1,1,1-TCA	PCE	1,2-DCPA	1,2-DCE	MTBE	
MW-9																			
07/06/90	7.63	3.02	4.61	--	<50	<0.3	<0.3	<0.3	<0.6	<1000	<0.5	<0.5	--	<0.5	--	--	--	--	
10/03/90	7.63	2.49	5.14	--	<50	<0.3	<0.3	<0.3	<0.6	--	<0.5	<0.5	--	<0.5	--	--	--	--	
08/23/91	7.63	2.18	5.45	--	<50	<0.5	<0.5	<0.5	<0.5	--	<0.5	<0.5	--	<0.5	--	--	--	--	
11/22/91	7.63	2.15	5.48	--	<50	<0.5	<0.5	<0.5	<0.5	--	<0.5	<0.5	<0.5	<0.5	--	--	--	--	
02/26/92	7.63	5.00	2.63	--	<50	<0.5	<0.5	<0.5	<0.5	--	<0.5	<0.5	<0.5	<0.5	--	--	--	--	
05/22/92	7.63	3.63	4.00	--	<50	<0.5	<0.5	<0.5	<0.5	--	<0.5	<0.5	<0.5	<0.5	--	--	--	--	
09/29/92	7.63	2.93	4.70	--	<50	<0.5	<0.5	<0.5	<0.5	--	<0.5	<0.5	--	<0.5	--	--	--	--	
12/23/92	7.63	3.87	3.76	--	<50	<0.5	<0.5	<0.5	<0.5	--	--	--	--	--	--	--	--	--	
03/22/93	7.63	5.52	2.11	--	<50	<0.5	<0.5	<0.5	<0.5	--	--	--	--	--	--	--	--	--	
06/07/93	7.63	4.35	3.28	--	<50	<0.5	<0.5	<0.5	<0.5	--	--	--	--	--	--	--	--	--	
09/10/93	7.63	2.45	5.18	--	<50	<0.5	<0.5	<0.5	<0.5	--	--	--	--	--	--	--	--	--	
03/07/94	7.63	4.61	3.02	--	<50	<0.5	<0.5	<0.5	<0.5	--	--	--	--	--	--	--	--	--	
06/16/94	7.63	3.50	4.13	--	<50	<0.5	<0.5	<0.5	<0.5	--	--	--	--	--	--	--	--	--	
09/08/94	7.63	2.84	4.79	--	<50	<0.5	<0.5	<0.5	<0.5	--	--	--	--	--	--	--	--	--	
11/29/94	7.63	3.71	3.92	--	<50	<0.5	<0.5	<0.5	<0.5	--	--	--	--	--	--	--	--	--	
03/21/95	7.63	0.14	7.49	Insuff. water	--	--	--	--	--	--	--	--	--	--	--	--	--	--	
06/27/95	7.63	5.73	1.90	--	<50	<0.5	<0.5	<0.5	<0.5	--	--	--	--	--	--	--	--	--	
09/27/95	7.63	3.68	3.95	--	--	--	--	--	--	--	--	--	--	--	--	--	--	--	
12/29/95	7.63	5.08	2.55	--	--	--	--	--	--	--	--	--	--	--	--	--	--	--	
03/28/96	7.63	5.43	2.20	--	--	--	--	--	--	--	--	--	--	--	--	--	--	--	
06/21/96	7.63	4.98	2.65	--	--	--	--	--	--	--	--	--	--	--	--	--	--	--	
09/26/96	7.63	4.27	3.36	--	--	--	--	--	--	--	--	--	--	--	--	--	--	--	

Cumulative Table of Well Data and Analytical Results

Vertical Measurements are in feet.

Analytical results are in parts per billion (ppb)

DATE	Well Head Elev.	Ground Water Elev.	Depth To Water	Notes	TPH- Gasoline	Benzene	Toluene	Ethyl- Benzene	Xylene	TOG	Chloro- form	1, 2- DCA	Freon	1, 1, 1- TCA	PCE	1, 2- DCPA	1, 2- DCE	MTBE	
TRIP BLANK																			
12/08/89	--	--	--	--	<100	<0.1	<0.2	<0.1	<0.2	--	<0.5	<0.1	--	<0.1	--	--	--	--	
06/09/89	--	--	--	--	<50	<0.5	<0.5	<0.1	<0.2	--	<0.5	<0.1	<20	<0.1	--	--	--	--	
09/14/89	--	--	--	--	<50	<0.1	<0.5	<0.1	<0.2	--	<0.5	<0.1	<0.5	<0.1	--	--	--	--	
12/08/89	--	--	--	--	<50	<0.3	<0.3	<0.3	<0.6	--	4.4	<0.5	--	1.9	--	--	--	--	
03/19/90	--	--	--	--	<50	<0.3	<0.3	<0.3	<0.6	--	<0.5	<0.5	--	<0.5	--	--	--	--	
07/06/90	--	--	--	--	<50	<0.3	<0.3	<0.3	<0.6	--	<0.5	<0.5	--	<0.5	--	--	--	--	
10/03/90	--	--	--	--	<50	<0.3	<0.3	<0.3	1.0	--	<0.5	<0.5	--	<0.5	--	--	--	--	
08/23/91	--	--	--	--	<50	<0.5	<0.5	<0.5	<0.5	--	--	--	--	--	--	--	--	--	
11/22/91	--	--	--	--	<50	<0.5	<0.5	<0.5	<0.5	--	--	--	<0.5	--	--	--	--	--	
02/26/92	--	--	--	--	<50	<0.5	<0.5	<0.5	<0.5	--	--	--	--	--	--	--	--	--	
05/22/92	--	--	--	--	<50	<0.5	<0.5	<0.5	<0.5	--	--	--	--	--	--	--	--	--	
09/29/92	--	--	--	--	<50	<0.5	<0.5	<0.5	<0.5	--	--	--	--	--	--	--	--	--	
12/23/92	--	--	--	--	<50	<0.5	<0.5	<0.5	<0.5	--	--	--	--	--	--	--	--	--	
03/22/93	--	--	--	--	<50	<0.5	<0.5	<0.5	<0.5	--	--	--	--	--	--	--	--	--	
06/07/93	--	--	--	--	<50	<0.5	<0.5	<0.5	1.0	--	--	--	--	--	--	--	--	--	
09/10/93	--	--	--	--	<50	<0.5	<0.5	<0.5	<0.5	--	--	--	--	--	--	--	--	--	
03/07/94	--	--	--	--	<50	<0.5	<0.5	<0.5	<0.5	--	--	--	--	--	--	--	--	--	
06/16/94	--	--	--	--	<50	<0.5	<0.5	<0.5	<0.5	--	--	--	--	--	--	--	--	--	
09/08/94	--	--	--	--	<50	<0.5	<0.5	<0.5	<0.5	--	--	--	--	--	--	--	--	--	
11/29/94	--	--	--	--	<50	<0.5	<0.5	<0.5	<0.5	--	--	--	--	--	--	--	--	--	
03/21/95	--	--	--	--	<50	<0.5	<0.5	<0.5	<0.5	--	--	--	--	--	--	--	--	--	
06/27/95	--	--	--	--	<50	<0.5	<0.5	<0.5	<0.5	--	--	--	--	--	--	--	--	--	
09/27/95	--	--	--	--	<50	<0.5	<0.5	<0.5	<0.5	--	--	--	--	--	--	--	--	--	
12/29/95	--	--	--	--	<50	<0.5	<0.5	<0.5	<0.5	--	--	--	--	--	--	--	--	--	
03/28/96	--	--	--	--	<50	<0.5	<0.5	<0.5	<0.5	--	--	--	--	--	--	--	--	<2.5	
06/21/96	--	--	--	--	<50	<0.5	<0.5	<0.5	<0.5	--	--	--	--	--	--	--	--	--	
09/26/96	--	--	--	--	<50	<0.5	<0.5	<0.5	<0.5	--	--	--	--	--	--	--	--	--	

Note: Blaine Tech Services, Inc. began routine monitoring of the groundwater wells at this site on November 1, 1994.

Earlier field data and analytical results are drawn from the September 27, 1994 Groundwater Technology, Inc. report.

ABBREVIATIONS:

TPH = Total Petroleum Hydrocarbons
 TOG = Total Oil and Grease
 1,2-DCA = 1,2-Dichloroethane
 1,1,1-TCA = 1,1,1-Trichloroethane

PCE = Trichloroethene
 1,2-DCPA = 1,2-Dichloropropane
 1,2-DCE = 1,2-Dichloroethene
 MTBE = Methyl t-butyl ether



Blaine Technical Services 985 Timothy Drive San Jose, CA 95133	Client Proj. ID: Chevron 9-0019/960926-D2 Sample Descript: MW-6 Matrix: LIQUID Analysis Method: 8015Mod/8020 Lab Number: 9609G87-01	Sampled: 09/26/96 Received: 09/27/96 Analyzed: 10/01/96 Reported: 10/05/96
Attention: Jim Keller		

QC Batch Number: GC100196BTEX02A
Instrument ID: GCHP2

Total Purgeable Petroleum Hydrocarbons (TPPH) with BTEX and MTBE

Analyte	Detection Limit ug/L	Sample Results ug/L
TPPH as Gas	50	130
Methyl t-Butyl Ether	2.5	N.D.
Benzene	0.50	N.D.
Toluene	0.50	0.52
Ethyl Benzene	0.50	0.92
Xylenes (Total)	0.50	1.0
Chromatogram Pattern: Weathered Gas		C7-C12
Surrogates	Control Limits %	% Recovery
Trifluorotoluene	70 130	105

Analytes reported as N.D. were not present above the stated limit of detection.

SEQUOIA ANALYTICAL - ELAP #1210

Peggy Penner
Project Manager





Blaine Technical Services 985 Timothy Drive San Jose, CA 95133	Client Proj. ID: Chevron 9-0019/960926-D2 Sample Descript: MW-7 Matrix: LIQUID Analysis Method: 8015Mod/8020 Lab Number: 9609G87-02	Sampled: 09/26/96 Received: 09/27/96 Analyzed: 10/01/96 Reported: 10/05/96
Attention: Jim Keller		

QC Batch Number: GC100196BTEX02A
Instrument ID: GCHP2

Total Purgeable Petroleum Hydrocarbons (TPPH) with BTEX and MTBE

Analyte	Detection Limit ug/L	Sample Results ug/L
TPPH as Gas	50	N.D.
Methyl t-Butyl Ether	2.5	N.D.
Benzene	0.50	N.D.
Toluene	0.50	N.D.
Ethyl Benzene	0.50	N.D.
Xylenes (Total)	0.50	N.D.
Chromatogram Pattern:		
Surrogates	Control Limits %	% Recovery
Trifluorotoluene	70 130	101

Analytes reported as N.D. were not present above the stated limit of detection.

SEQUOIA ANALYTICAL - ELAP #1210

Peggy Penner
Project Manager





Blaine Technical Services 985 Timothy Drive San Jose, CA 95133	Client Proj. ID: Chevron 9-0019/960926-D2 Sample Descript: TB Matrix: LIQUID Analysis Method: 8015Mod/8020 Lab Number: 9609G87-03	Sampled: 09/26/96 Received: 09/27/96 Analyzed: 10/01/96 Reported: 10/05/96
Attention: Jim Keller		

QC Batch Number: GC100196BTEX02A
Instrument ID: GCHP2

Total Purgeable Petroleum Hydrocarbons (TPPH) with BTEX

Analyte	Detection Limit ug/L	Sample Results ug/L
TPPH as Gas	50	N.D.
Benzene	0.50	N.D.
Toluene	0.50	N.D.
Ethyl Benzene	0.50	N.D.
Xylenes (Total)	0.50	N.D.
Chromatogram Pattern:		
Surrogates	Control Limits %	% Recovery
Trifluorotoluene	70 130	94

Analytes reported as N.D. were not present above the stated limit of detection.

SEQUOIA ANALYTICAL - ELAP #1210

Peggy Renner
Project Manager





Blaine Tech Services, Inc.
 985 Timothy Drive
 San Jose, CA 95133
 Attention: Jim Keller

Client Project ID: Chevron 9-0019 / 960926-D2
 Matrix: Liquid

Work Order #: 9609G87 -01-03

Reported: Oct 9, 1996

QUALITY CONTROL DATA REPORT

Analyte:	Benzene	Toluene	Ethyl Benzene	Xylenes
QC Batch#:	GC100196BTEX02A	GC100196BTEX02A	GC100196BTEX02A	GC100196BTEX02A
Analy. Method:	EPA 8020	EPA 8020	EPA 8020	EPA 8020
Prep. Method:	EPA 5030	EPA 5030	EPA 5030	EPA 5030

Analyst:	R. Burton	R. Burton	R. Burton	R. Burton
MS/MSD #:	9609A1910	9609A1910	9609A1910	9609A1910
Sample Conc.:	N.D.	N.D.	N.D.	N.D.
Prepared Date:	10/1/96	10/1/96	10/1/96	10/1/96
Analyzed Date:	10/1/96	10/1/96	10/1/96	10/1/96
Instrument I.D.#:	GCHP2	GCHP2	GCHP2	GCHP2
Conc. Spiked:	10 µg/L	10 µg/L	10 µg/L	30 µg/L
Result:	12	10	9.7	27
MS % Recovery:	120	100	97	90
Dup. Result:	11	9.3	8.9	25
MSD % Recov.:	110	93	89	83
RPD:	8.7	7.3	8.6	7.7
RPD Limit:	0-25	0-25	0-25	0-25

LCS #:	BLK100196	BLK100196	BLK100196	BLK100196
Prepared Date:	10/1/96	10/1/96	10/1/96	10/1/96
Analyzed Date:	10/1/96	10/1/96	10/1/96	10/1/96
Instrument I.D.#:	GCHP2	GCHP2	GCHP2	GCHP2
Conc. Spiked:	10 µg/L	10 µg/L	10 µg/L	30 µg/L
LCS Result:	12	10	9.8	27
LCS % Recov.:	120	100	98	90

MS/MSD	60-140	60-140	60-140	60-140
LCS	70-130	70-130	70-130	70-130
Control Limits				

SEQUOIA ANALYTICAL

Peggy Penner
 Project Manager

Please Note:

The LCS is a control sample of known, interferent-free matrix that is analyzed using the same reagents, preparation, and analytical methods employed for the samples. The matrix spike is an aliquot of sample fortified with known quantities of specific compounds and subjected to the entire analytical procedure. If the recovery of analytes from the matrix spike does not fall within specified control limits due to matrix interference, the LCS recovery is to be used to validate the batch.

** MS=Matrix Spike, MSD=MS Duplicate, RPD=Relative % Difference

9609G87.BLA <1>





Blaine Technical Services 985 Timothy Drive San Jose, CA 95133	Client Proj. ID: Chevron, 9-0019, 961010-J2 Sample Descript: MW-4 Matrix: LIQUID Analysis Method: 8015Mod/8020 Lab Number: 9610801-01	Sampled: 10/10/96 Received: 10/11/96 Analyzed: 10/16/96 Reported: 10/25/96
Attention: Jim Keller		

QC Batch Number: GC101696BTEX21A
Instrument ID: GCHP21

Total Purgeable Petroleum Hydrocarbons (TPPH) with BTEX and MTBE

Analyte	Detection Limit ug/L	Sample Results ug/L
TPPH as Gas	50	N.D.
Methyl t-Butyl Ether	2.5	N.D.
Benzene	0.50	N.D.
Toluene	0.50	N.D.
Ethyl Benzene	0.50	N.D.
Xylenes (Total)	0.50	N.D.
Chromatogram Pattern:		
Surrogates	Control Limits %	% Recovery
Trifluorotoluene	70 130	85

Analytes reported as N.D. were not present above the stated limit of detection.

SEQUOIA ANALYTICAL - ELAP #1210

Peggy Penner
Peggy Penner
Project Manager





Blaine Technical Services 985 Timothy Drive San Jose, CA 95133	Client Proj. ID: Chevron, 9-0019, 961010-J2 Sample Descript: MW-5 Matrix: LIQUID Analysis Method: 8015Mod/8020 Lab Number: 9610801-02	Sampled: 10/10/96 Received: 10/11/96 Analyzed: 10/17/96 Reported: 10/25/96
--	---	---

QC Batch Number: GC101796BTEX02A
Instrument ID: GCHP02

Total Purgeable Petroleum Hydrocarbons (TPPH) with BTEX and MTBE

Analyte	Detection Limit ug/L	Sample Results ug/L
TPPH as Gas	2000	5700
Methyl t-Butyl Ether	100	N.D.
Benzene	20	1800
Toluene	20	53
Ethyl Benzene	20	530
Xylenes (Total)	20	84
Chromatogram Pattern:		Gas
Surrogates	Control Limits %	% Recovery
Trifluorotoluene	70 130	84

Analytes reported as N.D. were not present above the stated limit of detection.

SEQUOIA ANALYTICAL - ELAP #1210

Shela Penner
Peggy Penner
Project Manager





Sequoia
Analytical

680 Chesapeake Drive
404 N. Wiget Lane
819 Striker Avenue, Suite 8

Redwood City, CA 94063
Walnut Creek, CA 94598
Sacramento, CA 95834

(415) 364-9600
(510) 988-9600
(916) 921-9600

FAX (415) 364-9233
FAX (510) 988-9673
FAX (916) 921-0100

Blaine Technical Services
985 Timothy Drive
San Jose, CA 95133
Attention: Jim Keller

Client Proj. ID: Chevron, 9-0019, 961010-J2
Lab Proj. ID: 9610801

Received: 10/11/96
Reported: 10/25/96

LABORATORY NARRATIVE

TPPH Note: Sample 9610801-02 was diluted 40-fold.

SEQUOIA ANALYTICAL

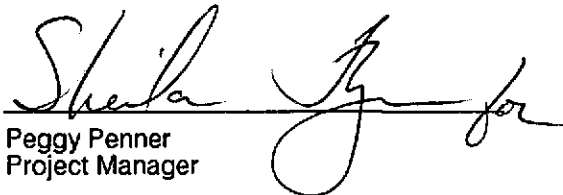
Peggy Penner
Project Manager





Blaine Tech Services, Inc.
985 Timothy Drive
San Jose, CA 95133
Attention: Jim Keller

Client Project ID: **Chevron 9-0019 / 961010-J2**
Matrix: **Liquid**

Work Order #: **9610801 -01**

Reported: **Oct 28, 1996**

QUALITY CONTROL DATA REPORT

Analyte:	Benzene	Toluene	Ethyl Benzene	Xylenes
QC Batch#:	GC101696BTEX21A	GC101696BTEX21A	GC101696BTEX21A	GC101696BTEX21A
Analy. Method:	EPA 8020	EPA 8020	EPA 8020	EPA 8020
Prep. Method:	EPA 5030	EPA 5030	EPA 5030	EPA 5030

Analyst:	G. Fish	G. Fish	G. Fish	G. Fish
MS/MSD #:	961057904	961057904	961057904	961057904
Sample Conc.:	N.D.	N.D.	N.D.	N.D.
Prepared Date:	10/16/96	10/16/96	10/16/96	10/16/96
Analyzed Date:	10/16/96	10/16/96	10/16/96	10/16/96
Instrument I.D.#:	GCHP21	GCHP21	GCHP21	GCHP21
Conc. Spiked:	10 µg/L	10 µg/L	10 µg/L	30 µg/L
Result:	9.0	8.5	8.5	25
MS % Recovery:	90	85	85	83
Dup. Result:	9.6	9.9	9.1	27
MSD % Recov.:	96	99	91	90
RPD:	6.5	15	6.8	7.7
RPD Limit:	0-25	0-25	0-25	0-25

LCS #:	BLK101696	BLK101696	BLK101696	BLK101696
Prepared Date:	10/16/96	10/16/96	10/16/96	10/16/96
Analyzed Date:	10/16/96	10/16/96	10/16/96	10/16/96
Instrument I.D.#:	GCHP21	GCHP21	GCHP21	GCHP21
Conc. Spiked:	10 µg/L	10 µg/L	10 µg/L	30 µg/L
LCS Result:	11	9.7	9.6	29
LCS % Recov.:	110	97	96	97

MS/MSD	60-140	60-140	60-140	60-140
LCS	70-130	70-130	70-130	70-130
Control Limits				

SEQUOIA ANALYTICAL

Peggy Penner
Project Manager

Please Note:
The LCS is a control sample of known, interferent-free matrix that is analyzed using the same reagents, preparation, and analytical methods employed for the samples. The matrix spike is an aliquot of sample fortified with known quantities of specific compounds and subjected to the entire analytical procedure. If the recovery of analytes from the matrix spike does not fall within specified control limits due to matrix interference, the LCS recovery is to be used to validate the batch.

** MS= Matrix Spike, MSD=MS Duplicate, RPD=Relative % Difference

9610801.BLA <1>





Blaine Tech Services, Inc.
 985 Timothy Drive
 San Jose, CA 95133
 Attention: Jim Keller

Client Project ID: Chevron 9-0019 / 961010-J2
 Matrix: Liquid

Work Order #: 9610801-02

Reported: Oct 28, 1996

QUALITY CONTROL DATA REPORT

Analyte:	Benzene	Toluene	Ethyl Benzene	Xylenes
QC Batch#:	GC101796BTEX02A	GC101796BTEX02A	GC101796BTEX02A	GC101796BTEX02A
Analy. Method:	EPA 8020	EPA 8020	EPA 8020	EPA 8020
Prep. Method:	EPA 5030	EPA 5030	EPA 5030	EPA 5030

Analyst:	Y. Arteaga	Y. Arteaga	Y. Arteaga	Y. Arteaga
MS/MSD #:	961057905	961057905	961057905	961057905
Sample Conc.:	N.D.	N.D.	N.D.	N.D.
Prepared Date:	10/17/96	10/17/96	10/17/96	10/17/96
Analyzed Date:	10/17/96	10/17/96	10/17/96	10/17/96
Instrument I.D.#:	GCHP2	GCHP2	GCHP2	GCHP2
Conc. Spiked:	10 µg/L	10 µg/L	10 µg/L	30 µg/L
Result:	14	12	12	32
MS % Recovery:	140	120	120	107
Dup. Result:	12	10	9.8	27
MSD % Recov.:	120	100	98	90
RPD:	15	18	20	17
RPD Limit:	0-25	0-25	0-25	0-25

LCS #:	BLK101796	BLK101796	BLK101796	BLK101796
Prepared Date:	10/17/96	10/17/96	10/17/96	10/17/96
Analyzed Date:	10/17/96	10/17/96	10/17/96	10/17/96
Instrument I.D.#:	GCHP2	GCHP2	GCHP2	GCHP2
Conc. Spiked:	10 µg/L	10 µg/L	10 µg/L	30 µg/L
LCS Result:	12	11	10	28
LCS % Recov.:	120	110	100	93

MS/MSD	60-140	60-140	60-140	60-140
LCS	70-130	70-130	70-130	70-130
Control Limits				

SEQUOIA ANALYTICAL

 Peggy Penner
 Project Manager

Please Note:
 The LCS is a control sample of known, interferent-free matrix that is analyzed using the same reagents, preparation, and analytical methods employed for the samples. The matrix spike is an aliquot of sample fortified with known quantities of specific compounds and subjected to the entire analytical procedure. If the recovery of analytes from the matrix spike does not fall within specified control limits due to matrix interference, the LCS recovery is to be used to validate the batch.

** MS= Matrix Spike, MSD= MS Duplicate, RPD= Relative % Difference

9610801.BLA <2>



Chevron Facility Number 9-0019
 Facility Address 210 Grand Ave., Oakland, CA
 Consultant Project Number 961010-52
 Consultant Name Blaine Tech Services, Inc.
 Address 985 Timothy Dr., San Jose, CA 95133
 Project Contact (Name) Jim Keller
 (Phone) 08 995-5535 (Fax Number) 408 293-8773

Chevron Contact (Name) Phil Briggs
 (Phone) (510) 842-9136
 Laboratory Name Sequoia
 Laboratory Release Number 2172420
 Samples Collected by (Name) Matt James
 Collection Date 10/10/96
 Signature _____

Sample Number	Lab Sample Number	Number of Containers	Matrix S = Soil A = Air W = Water C = Cholesterol	Type C = Grab G = Composite D = Discrete	Time	Sample Preservation	Leed (Yes or No)	Analytes To Be Performed <u>9610801</u>											Remarks						
								TEX + TPH GAS (8020 + 8015)	TPH Diesel (8015)	Oil and Grease (8020)	Purgeable Hydrocarbons (8010)	Purgeable Aromatics (8020)	Purgeable Organics (8240)	Extractable Organics (8270)	Metals Cd, Cr, Pb, Zn, Ni (ICAP or AA)	MTC									
MW-4	1	3	W	D	945	HCl	Y	X																	
MW5	2	3	W	D	100		Y	X																	

DO NOT BILL FOR TB-LB

Remarks

Relinquished By (Signature) _____	Organization <u>BTS</u>	Date/Time <u>10/11 1430</u>	Received By (Signature) _____	Organization <u>SEER</u>	Date/Time <u>10/11 1430</u>
Relinquished By (Signature) _____	Organization <u>SEER</u>	Date/Time <u>10/11 1706</u>	Received By (Signature) _____	Organization	Date/Time
Relinquished By (Signature) _____	Organization	Date/Time	Received For Laboratory By (Signature) <u>R. Cardenas</u>		Date/Time <u>10-11-96 1706</u>

Turn Around Time (Circle Choice)

24 Hrs.
 48 Hrs.
 5 Days
 10 Days
 As Contracted

7600-3.DWG/03 91/ACH

Field Data Sheets

CHEVRON WELL MONITORING DATA SHEET

Project #: <u>960926-95 D2</u>		Station #: <u>9-0029</u>	
Sampler: <u>MD</u>		Start Date: <u>9-26-96</u>	
Well I.D.: <u>MW-6</u>		Well Diameter: (circle one) <u>2</u> 3 4 6	
Total Well Depth: Before <u>9.30</u> After		Depth to Water: Before <u>6.74</u> After	
Depth to Free Product:		Thickness of Free Product (feet):	
Measurements referenced to: <u>PVC</u> Grade Other:			

Well Diameter	VCF	Well Diameter	VCF
1"	0.04	6"	1.47
2"	0.16	8"	2.61
3"	0.37	10"	4.08
4"	0.65	12"	5.87
5"	1.02	16"	10.43

<u>4</u>	\times	<u>3</u>	$=$	<u>1.2</u>	gallons
1 Case Volume Specified Volumes					

Purging: Bailer Disposable Bailer X Middleburg Electric Submersible Extraction Pump Other _____	Sampling: Bailer X Disposable Bailer Extraction Port Other _____
---	--

TIME	TEMP. (F)	pH	COND.	TURBIDITY:	VOLUME REMOVED:	OBSERVATIONS:
<u>1030</u>	<u>65.8</u>	<u>6.8</u>	<u>2000</u>	<u>—</u>	<u>.5</u>	
<u>1032</u>	<u>65.6</u>	<u>6.8</u>	<u>1800</u>	<u>—</u>	<u>1.0</u>	
<u>1034</u>	<u>65.6</u>	<u>6.8</u>	<u>1800</u>	<u>—</u>	<u>1.5</u>	

Did Well Dewater? N If yes, gals. Gallons Actually Evacuated: 1.5

Sampling Time: 10:40 Sampling Date: 9-26

Sample I.D.: MW-6 Laboratory: SEI

Analyzed for: (Circle) TPH-G BTEX TPH-D OTHER: MTBE

Duplicate I.D.: Cleaning Blank I.D.:

Analyzed for: (Circle) TPH-G BTEX TPH-D OTHER:

CHEVRON WELL MONITORING DATA SHEET

Project #: <u>960926-D2</u>	Station #: <u>9-0019</u>
Sampler: <u>MD</u>	Start Date: <u>9-25-96</u>
Well I.D.: <u>MW-7</u>	Well Diameter: (circle one) <u>2</u> 3 4 6
Total Well Depth: Before <u>9.84</u> After	Depth to Water: Before <u>4.95</u> After
Depth to Free Product:	Thickness of Free Product (feet):
Measurements referenced to: <u>PVC</u>	Grade Other:

Well Diameter	VCF	Well Diameter	VCF
1"	0.04	6"	1.47
2"	0.16	8"	2.61
3"	0.37	10"	4.08
4"	0.65	12"	5.87
5"	1.02	16"	10.43

<u>0.8</u>	\times	<u>3</u>	$=$	<u>2.3</u>
1 Case Volume		Specified Volumes		gallons

Purging: Bailer <input checked="" type="checkbox"/> Disposable Bailer <input checked="" type="checkbox"/> Middleburg Electric Submersible Extraction Pump Other _____	Sampling: Bailer Disposable Bailer <input checked="" type="checkbox"/> Extraction Port <input checked="" type="checkbox"/> Other _____
--	---

TIME	TEMP. (F)	PH	COND.	TURBIDITY:	VOLUME REMOVED:	OBSERVATIONS:
<u>1052</u>	<u>66.8</u>	<u>7.2</u>	<u>1600</u>	<u>—</u>	<u>1</u>	
<u>1054</u>	<u>66.2</u>	<u>7.0</u>	<u>1500</u>	<u>—</u>	<u>2</u>	
<u>1056</u>	<u>66.2</u>	<u>6.9</u>	<u>1500</u>	<u>—</u>	<u>2.5</u>	

Did Well Dewater? N If yes, gals. Gallons Actually Evacuated: 2.5

Sampling Time: <u>1100</u>	Sampling Date: <u>9-26</u>
Sample I.D.: <u>MW-7</u>	Laboratory: <u>SEI</u>
Analyzed for: <u>TPH-G</u> <u>BTEX</u> <u>TPH-D</u> OTHER: <u>MTBE</u>	
Duplicate I.D.:	Cleaning Blank I.D.:
Analyzed for: <u>TPH-G</u> <u>BTEX</u> <u>TPH-D</u> OTHER:	

CHEVRON WELL MONITORING DATA SHEET

Project #: 961010-52	Station #: 9-1009
Sampler: MS	Start Date: 10/10/90
Well I.D.: MW 34	Well Diameter: (circle one) 2 3 4 6
Total Well Depth: Before 14.30 After	Depth to Water: Before 3.88 After
Depth to Free Product:	Thickness of Free Product (feet):
Measurements referenced to: PVC Grade Other:	

Well Diameter	VCF	Well Diameter	VCF
1"	0.04	6"	1.47
2"	0.16	8"	2.61
3"	0.37	10"	4.08
4"	0.65	12"	5.87
5"	1.02	16"	10.43

<u>6.7</u>	x	<u>3</u>	=	<u>20.3</u>
1 Case Volume		Specified Volumes		gallons

Purging: Bailer
 Disposable Bailer
 Middleburg
 Electric Submersible
 Extraction Pump
 Other _____

Sampling: Bailer
 Disposable Bailer
 Extraction Port
 Other _____

TIME	TEMP. (F)	pH	COND.	TURBIDITY:	VOLUME REMOVED:	OBSERVATIONS:
935	73.4	7.8	1900	—	7	
937	74.0	6.9	1800	—	14	
939	74.4	6.9	1700	—	21	

Did Well Dewater? If yes, gals. Gallons Actually Evacuated: 21

Sampling Time: 945 Sampling Date: 10/10

Sample I.D.: 961010-52 Laboratory: SEQ

Analyzed for: **TPH-G BTEX** TPH-D OTHER: MS BE
 (Circle)

Duplicate I.D.: Cleaning Blank I.D.:

Analyzed for: TPH-G BTEX TPH-D OTHER:
 (Circle)