



Chevron

December 5, 1995

Chevron U.S.A. Products Company

6001 Bollinger Canyon Rd., Bldg. L
P.O. Box 5004
San Ramon, CA 94583-0804

Ms. Jennifer Eberle
Alameda County Health Care Services
Department of Environmental Health
1131 Harbor Bay Parkway, Suite 250
Alameda, CA 94502-6577

Mark A. Miller

SAR Engineer
Phone No. 510 842-8134
Fax No. 510 842-8252

RECEIVED
DEC 11 1995
ENVIRONMENTAL HEALTH
DEPARTMENT

**Re: Former Chevron Service Station #9-0019
210 Grand Avenue, Oakland, CA**

Dear Ms. Eberle:

Enclosed is the Third Quarter 1995 Groundwater Monitoring Report dated November 3, 1995, prepared by our consultant Blaine Tech Services, Inc. for the above referenced site. Per prior agreement between Chevron and your office, only monitor wells MW-4 through MW-7 are sampled on a quarterly basis. Depth to water measurements are collected from all wells to maintain knowledge of ground water flow direction and gradient.

As indicated in the report, ground water samples collected from all wells were analyzed for total petroleum hydrocarbons as gasoline (TPH-G) and BTEX. Concentrations of dissolved hydrocarbon constituents in the ground water samples collected were consistent with previous observations at the site. Depth to ground water was measured at approximately 3.7 to 7.5 feet below grade and the direction of flow is to the west-southwest.

Thank you for your letter of November 21, 1995, approving the removal of the ground water extraction system and the abandonment of monitor wells MW-1 and MW-3 to allow for pending development of the site. This work was recently performed and a report documenting field activities will be forwarded to your office shortly.

We agree that some source material does remain in soil and ground water in the vicinity of monitor wells MW-4 and MW-5. However, previous reports on excavation activities conducted at the site in 1990 and 1991 document that the majority of the source material has been removed. The excavation extended laterally to the edge of the property where MW-4 and MW-5 are located and further excavation was not reasonable. Current ground water monitoring information suggests that the dissolved hydrocarbon plume is stable or even shrinking over time. Based on this information, we do not feel that additional excavation will significantly benefit ground water quality in the area beyond natural attenuation and degradation mechanisms currently taking place.

If you have any questions or comments, please feel free to contact me at (510) 842-8134.



Ms. Jennifer Eberle
December 5, 1995
Page 2

Sincerely,
CHEVRON U.S.A. PRODUCTS COMPANY

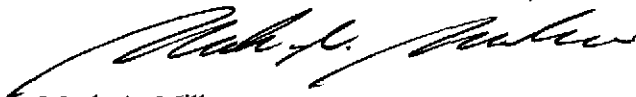

Mark A. Miller
Site Assessment and Remediation Engineer

Enclosure

cc: Ms. B.C. Owen

Mr. Ron Basarich
City of Oakland
Real Estate Department
1330 Broadway, Suite #101
Oakland, CA 94612

Mr. Andrew Clark-Clough
City of Oakland
Environmental Affairs Division
1333 Broadway, Suite 330
Oakland, CA 94612



BLAINE TECH SERVICES INC.

985 TIMOTHY DRIVE
SAN JOSE, CA 95133
(408) 995-5535
FAX (408) 293-8773

November 3, 1995

Mark Miller
Chevron U.S.A. Products Company
P.O. Box 5004
San Ramon, CA 94583-0804

3rd Quarter 1995 Monitoring at 9-0019

Third Quarter 1995 Groundwater Monitoring at
Chevron Service Station Number 9-0019
210 Grand Avenue
Oakland, CA

Monitoring Performed on September 27, 1995

Groundwater Sampling Report 950927-S-1

This report covers the routine quarterly monitoring of groundwater wells at this Chevron facility. Blaine Tech Services, Inc.'s work at the site includes inspection, gauging, evacuation, purgewater containment, sample collection and sample handling in accordance with standard procedures that conform to Regional Water Quality Control Board requirements.

Routine field data collection includes depth to water, total well depth, thickness of any separate immiscible layer, water column volume, calculated volume of a three-case volume purge, elapsed evacuation time, total volume of water removed, and standard water parameter instrument readings. Sample material is collected, contained, stored, and transported to the laboratory in conformance with EPA standards. Purgewater is, likewise, collected and transported to Chevron's Richmond Refinery for disposal.

Basic field information is presented alongside analytical values excerpted from the laboratory report in the cumulative table of **WELL DATA AND ANALYTICAL RESULTS**. The full analytical report for the most recent samples is located in the **Analytical Appendix**. The table also contains new groundwater elevation calculations taken from the computer plotted gradient map which is located in the **Professional Engineering Appendix**.

At a minimum, Blaine Tech Services, Inc. field personnel are certified upon completion of a forty-hour Hazardous Materials and Emergency Response training course per 29 CFR 1910.120. Field personnel are also enrolled in annual eight hour refresher courses.

Blaine Tech Services, Inc. conducts sampling and documentation assignments of this type as an independent third party. In order to avoid compromising the objectivity necessary for the proper and disinterested performance of this work, Blaine Tech Services, Inc. concentrates on objective data collection and does not participate in the interpretation of analytical results, the definition of geological or hydrological conditions, the formulation of recommendations, or the marketing of remedial systems.

Please call if you have any questions.

Yours truly,

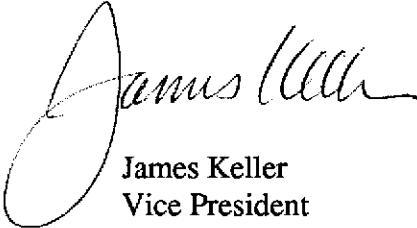

James Keller
Vice President

JPK/dk

attachments: Professional Engineering Appendix
Cumulative Table of Well Data and Analytical Results
Analytical Appendix
Field Data Sheets

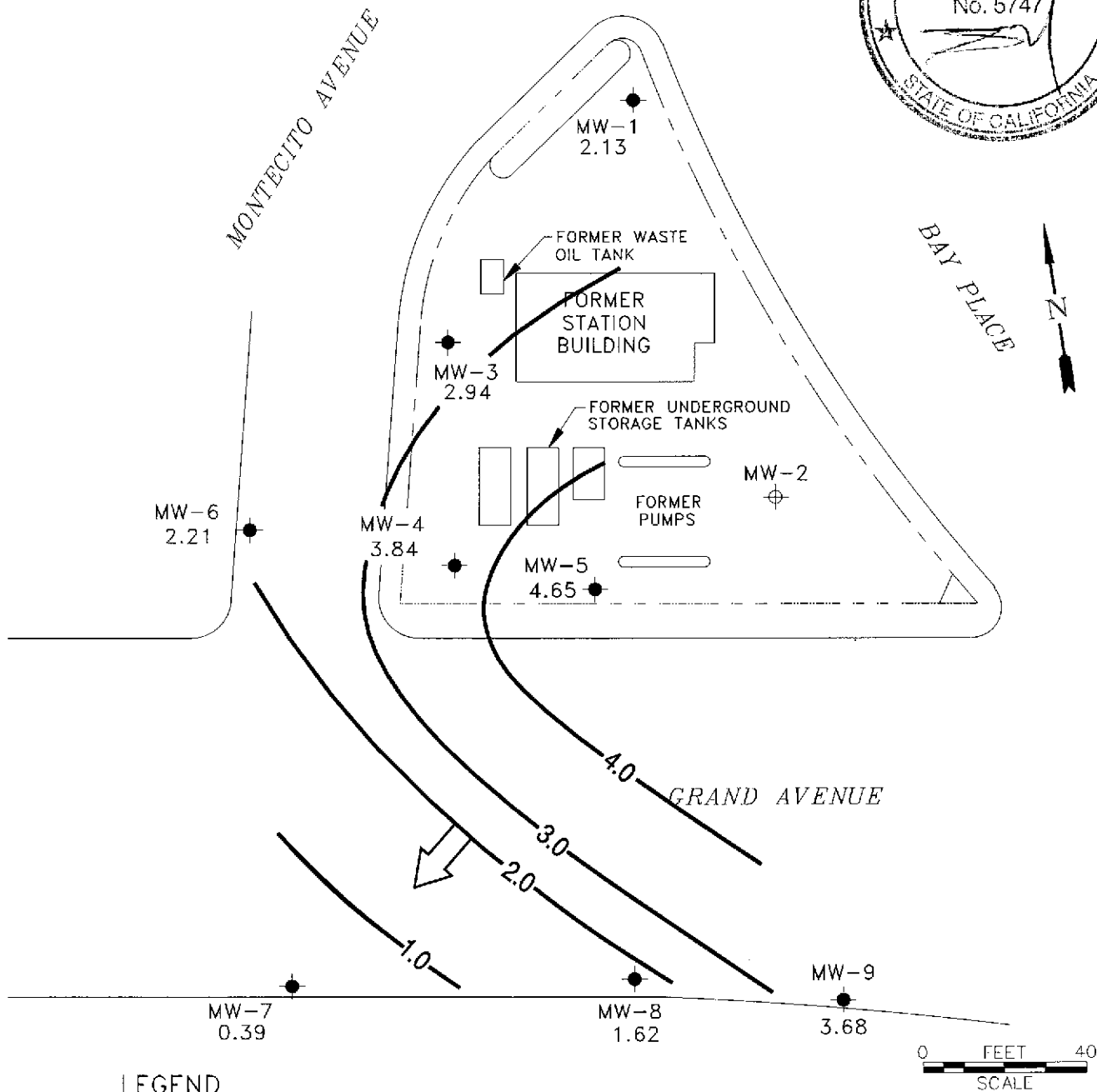

LEGEND

- MONITORING WELL
- POTENTIOMETRIC SURFACE ELEVATION (FT)
- POTENTIOMETRIC SURFACE CONTOUR
- GROUND WATER FLOW DIRECTION

Base map from Groundwater Technology, Inc.

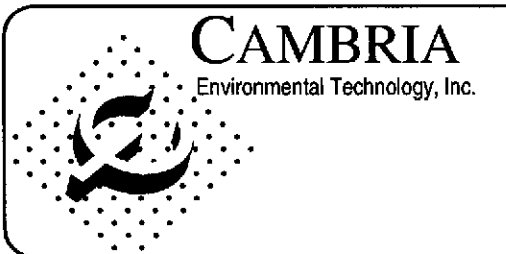

Chevron Station 9-0019
210 Grand Avenue
Oakland, California

\\CHEVRON\9-0019\0019-QM.DWG

Ground Water Elevations
September 27, 1995

FIGURE
1

Cumulative Table of Well Data and Analytical Results

Vertical Measurements are in feet.

Analytical results are in parts per billion (ppb)

DATE	Well Head Elev.	Ground Water Elev.	Depth To Water	Notes	TPH-Gasoline	Benzene	Toluene	Ethyl-Benzene	Xylene	TOG	Chloroform	1, 2-DCA	Freon	1, 1, 1-TCA	PCE	1, 2-DCPA	1, 2-DCE
MW-1																	
03/14/89	9.63	2.89	6.74	--	600	<0.2	<0.2	3.2	1.7	<3000	1.0	<0.2	<20	<0.2	--	--	--
06/08/89	9.63	2.49	7.14	--	<50	<0.1	<0.5	<0.1	<0.2	--	<0.5	<0.1	<20	<0.1	--	--	--
09/14/89	9.63	2.42	7.21	--	<50	<0.2	<1.0	<0.2	<0.4	--	<1.0	<0.2	<1.0	0.7	--	--	--
12/08/89	9.63	2.34	7.29	--	<50	<0.3	<0.3	<0.3	<0.6	--	<0.5	<0.5	--	<0.5	--	--	--
03/19/90	9.63	2.63	7.00	--	190	0.8	<0.3	7.0	3.0	--	<0.5	<0.5	--	<0.5	--	--	--
07/06/90	9.63	2.50	7.13	--	<50	<0.3	<0.3	<0.3	<0.6	--	<0.5	<0.5	--	<0.5	--	--	--
10/03/90	9.63	2.10	7.53	--	<50	<0.3	<0.3	<0.3	<0.6	--	<0.5	<0.5	--	<0.5	--	--	--
08/23/91	9.63	2.57	7.06	--	150	5.0	11	3.5	10	--	<0.5	<0.5	--	<0.5	--	--	--
11/22/91	9.63	2.16	7.47	--	86	7.2	11	2.9	13	--	<0.5	<0.5	<0.5	<0.5	--	--	--
02/26/92	9.63	2.94	6.69	--	<50	<0.5	<0.5	<0.5	1.4	--	<0.5	<0.5	<0.5	<0.5	--	--	--
05/22/92	9.63	2.67	6.96	--	<50	<0.5	<0.5	<0.5	<0.5	--	<0.5	<0.5	<0.5	<0.5	--	--	--
09/29/92	9.63	2.44	7.19	--	<50	<0.5	<0.5	<0.5	<0.5	--	<0.5	<0.5	--	<0.5	--	--	--
12/23/92	9.63	2.60	7.03	--	<50	<0.5	<0.5	<0.5	<0.5	--	--	--	--	--	--	--	--
03/22/93	9.63	3.03	6.60	--	<50	<0.5	<0.5	<0.5	<0.5	--	--	--	--	--	--	--	--
06/07/93	9.63	2.66	6.97	--	<50	<0.5	<0.5	<0.5	<0.5	--	--	--	--	--	--	--	--
09/10/93	9.63	2.55	7.08	--	<50	<0.5	<0.5	<0.5	<0.5	--	--	--	--	--	--	--	--
03/07/94	9.63	2.80	6.83	--	<50	<0.5	<0.5	<0.5	1.0	--	--	--	--	--	--	--	--
06/16/94	9.63	2.60	7.03	--	<50	<0.5	<0.5	<0.5	<0.5	--	--	--	--	--	--	--	--
09/08/94	9.63	2.53	7.10	--	<50	1.3	1.5	<0.5	1.7	--	--	--	--	--	--	--	--
11/29/94	9.63	2.81	6.82	--	<50	<0.5	<0.5	<0.5	<0.5	--	--	--	--	--	--	--	--
03/21/95	9.63	3.73	5.90	--	<50	<0.5	<0.5	<0.5	<0.5	--	--	--	--	--	--	--	--
06/27/95	9.63	2.69	6.94	--	<50	<0.5	<0.5	<0.5	<0.5	--	--	--	--	--	--	--	--
09/27/95	9.63	2.13	7.50	--	--	--	--	--	--	--	--	--	--	--	--	--	--

Cumulative Table of Well Data and Analytical Results

Vertical Measurements are in feet.

Analytical results are in parts per billion (ppb)

DATE	Well Head Elev.	Ground Water Elev.	Depth To Water	Notes	TPH-Gasoline	Benzene	Toluene	Ethyl-Benzene	Xylene	TOG	Chloro-form	1, 2-DCA	Freon	1, 1, 1-TCA	PCE	1, 2-DCPA	1, 2-DCE
MW-2																	
03/14/89	8.99	2.91	6.08	--	<100	6.7	7.1	0.5	4.6	<3000	<1.0	0.7	<20	<0.2	--	--	--
06/08/89	8.99	3.77	5.22	--	--	--	--	--	--	--	--	--	--	<0.2	--	--	--
06/09/89	8.99	--	--	--	<100	<0.2	<1.0	<0.2	<0.4	--	<1.0	<0.2	<20	<0.2	--	--	--
09/14/89	8.99	3.04	5.95	--	<50	<0.2	<1.0	<0.2	<0.4	--	<1.0	<0.2	<1.0	<0.2	--	--	--
12/08/89	8.99	-0.26	9.25	--	<50	<0.3	<0.3	<0.3	<0.6	--	<0.5	<0.5	--	<0.5	--	--	--
03/19/90	8.99	3.07	5.92	--	<50	<0.3	<0.3	<0.3	<0.6	--	<0.5	<0.5	--	<0.5	--	--	--
07/06/90	9.01	2.22	6.79	--	<50	<0.3	<0.3	<0.3	<0.6	--	<0.5	<0.5	--	<0.5	--	--	--
10/03/90	9.01	--	--	--	--	--	--	--	--	--	--	--	--	--	--	--	--
08/23/91	9.01	--	--	--	--	--	--	--	--	--	--	--	--	--	--	--	--
11/15/91	9.01	--	--	Well Destroyed	--	--	--	--	--	--	--	--	--	--	--	--	--
MW-3																	
03/14/89	8.19	2.16	6.02	--	<100	2.1	0.8	<0.2	2.0	<3000	<1.0	3.0	<20	<0.2	--	--	--
06/08/89	8.19	2.30	5.88	--	--	--	--	--	--	--	--	--	--	--	--	--	--
06/09/89	8.19	--	--	--	<100	<0.5	<1.0	<0.2	<0.4	--	<1.0	3.3	<20	<0.2	--	--	--
09/14/89	8.19	1.88	6.30	--	<50	<0.2	<1.0	<0.2	<0.4	--	<1.0	2.2	<1.0	<0.2	--	--	--
12/08/89	8.19	-1.34	9.52	--	<50	<0.3	<0.3	<0.3	<0.6	--	<0.5	1.3	--	<0.5	--	--	--
03/19/90	8.19	2.01	6.17	--	<50	<0.3	<0.3	<0.3	<0.6	--	0.5	1.3	--	<0.5	--	--	--
07/06/90	8.19	0.67	7.52	--	<50	<0.3	<0.3	<0.3	<0.6	--	<0.5	<0.5	--	<0.5	--	--	--
10/03/90	8.19	0.88	7.31	--	<50	<0.3	<0.3	<0.3	<0.6	--	<0.5	0.83	--	<0.5	--	--	--
08/23/91	8.19	2.53	5.65	--	220	16	22	5.5	16	--	<0.5	0.6	--	<0.5	--	--	--
11/22/91	8.19	1.41	6.78	--	<50	<0.5	<0.5	<0.5	0.6	--	0.6	1.0	<0.5	<0.5	--	--	--
02/26/92	8.19	3.54	4.65	--	<50	4.5	<0.5	<0.5	<0.5	--	<0.5	<0.5	<0.5	<0.5	--	--	--
05/22/92	8.19	2.63	5.56	--	<50	<0.5	<0.5	<0.5	<0.5	--	<0.5	<0.5	<0.5	<0.5	--	--	--
09/29/92	8.19	1.96	6.23	--	<50	<0.5	<0.5	<0.5	<0.5	--	<0.5	<0.5	--	<0.5	--	--	--
12/23/92	8.19	2.37	5.82	--	<50	<0.5	<0.5	<0.5	<0.5	--	<0.5	<0.5	--	<0.5	--	--	--
03/22/93	8.19	3.27	4.92	--	<50	7.0	<0.5	<0.5	<0.5	--	<0.5	<0.5	--	<0.5	--	--	--
06/07/93	8.19	2.50	5.69	--	<50	<0.5	<0.5	<0.5	<0.5	--	<0.5	<0.5	--	<0.5	--	--	--
09/10/93	8.19	2.15	6.04	--	<50	<0.5	<0.5	<0.5	<0.5	--	<0.5	<0.5	--	<0.5	--	--	--
03/07/94	8.19	3.04	5.15	--	<50	1.0	<0.5	<0.5	<0.5	--	<0.5	<0.5	--	<0.5	--	--	--
06/16/94	8.19	2.30	5.89	--	<50	<0.5	<0.5	<0.5	<0.5	--	<0.5	<0.5	--	<0.5	--	--	--
09/08/94	8.19	2.13	6.06	--	<50	<0.5	<0.5	<0.5	<0.5	--	<0.5	<0.5	--	<0.5	1.0	--	--
11/29/94	8.19	3.00	5.19	--	<50	<0.5	<0.5	<0.5	<0.5	--	<0.5	<0.5	<0.5	<0.5	<0.5	<0.5	--
03/21/95	8.19	4.43	3.76	--	<50	<0.5	<0.5	<0.5	<0.5	--	<0.5	<0.5	<0.5	<0.5	<0.5	<0.5	--
06/27/95	8.19	3.09	5.10	--	<50	<0.5	<0.5	<0.5	<0.5	--	<0.5	<0.5	<0.5	<0.5	<0.5	<0.5	--
09/27/95	8.19	2.94	5.25	--	--	--	--	--	--	--	--	--	--	--	--	--	--

Cumulative Table of Well Data and Analytical Results

Vertical Measurements are in feet.

Analytical results are in parts per billion (ppb)

DATE	Well Head Elev.	Ground Water Elev.	Depth To Water	Notes	TPH-Gasoline	Benzene	Toluene	Ethyl-Benzene	Xylene	TOG	Chloroform	1, 2-DCA	Freon	1, 1, 1-TCA	PCE	1, 2-DCPA	1, 2-DCE
MW-4																	
03/14/89	7.60	2.08	5.52	--	3000	810	200	30	130	<3000	<20	<5.0	<20	<5.0	--	--	--
06/08/89	7.60	3.41	4.19	--	--	--	--	--	--	--	--	--	--	--	--	--	--
06/09/89	7.60	--	--	--	900	440	13	22	40	--	<20	<5.0	60	<5.0	--	--	--
09/14/89	7.60	2.80	4.80	--	540	220	2.0	6.1	9.3	--	<1.0	2.3	<1.0	<0.2	--	--	--
12/08/89	7.60	2.74	4.86	--	150	18	<0.3	1.0	<0.6	--	<0.5	1.9	--	<0.5	--	--	--
03/19/90	7.60	2.95	4.65	--	270	50	<0.3	0.7	<0.6	--	<0.5	0.8	--	<0.5	--	--	--
07/06/90	7.59	1.17	6.42	--	140	0.7	<0.3	0.5	<0.6	--	<0.5	0.79	--	<0.5	--	--	--
10/03/90	7.59	1.20	6.39	--	180	<0.3	<0.3	2.0	<0.6	--	<0.5	0.5	--	<0.5	--	--	--
08/23/91	7.59	3.17	4.42	--	400	9.9	6.8	3.1	7.1	--	<0.5	<0.5	--	<0.5	--	--	--
11/22/91	7.59	2.21	5.38	--	130	3.4	1.3	3.5	6.0	--	<0.5	<0.5	<0.5	<0.5	--	--	--
02/26/92	7.59	4.94	2.65	--	520	15	2.7	6.1	8.6	--	<0.5	<0.5	<0.5	<0.5	--	--	--
05/22/92	7.59	3.63	3.96	--	460	20	2.8	5.0	6.9	--	<0.5	<0.5	<0.5	<0.5	--	--	--
09/29/92	7.59	2.91	4.68	--	160	1.1	1.7	0.8	2.8	--	<0.5	<0.5	--	<0.5	--	--	--
12/23/92	7.59	3.96	3.63	--	110	0.7	0.5	0.9	1.7	--	--	--	--	--	--	--	--
03/22/93	7.59	4.69	2.90	--	930	9.0	3.0	7.0	8.0	--	--	--	--	--	--	--	--
06/07/93	7.59	3.70	3.89	--	240	2.0	0.9	3.0	3.0	--	--	--	--	--	--	--	--
09/10/93	7.59	3.07	4.52	--	<50	<0.5	<0.5	0.8	<0.5	--	--	--	--	--	--	--	--
03/07/94	7.59	4.44	3.15	--	550	3.0	3.0	8.0	12	--	--	--	--	--	--	--	--
06/16/94	7.59	3.51	4.08	--	150	<0.5	0.6	1.5	0.7	--	--	--	--	--	--	--	--
09/08/94	7.59	3.04	4.55	--	<50	<0.5	<0.5	<0.5	1.2	--	--	--	--	--	--	--	--
11/29/94	7.59	4.74	2.85	--	130	<0.5	1.1	<0.5	0.58	--	--	--	--	--	--	--	--
03/21/95	7.59	5.89	1.70	--	720	2.2	<2.0	5.9	<2.0	--	--	--	--	--	--	--	--
06/27/95	7.59	4.21	3.38	--	100	<0.5	<0.5	<0.5	<0.5	--	--	--	--	--	--	--	--
09/27/95	7.59	3.84	3.75	--	<50	<0.5	<0.5	<0.5	<0.5	--	--	--	--	--	--	--	--

Cumulative Table of Well Data and Analytical Results

Vertical Measurements are in feet.

Analytical results are in parts per billion (ppb)

DATE	Well Head Elev.	Ground Water Elev.	Depth To Water	Notes	TPH- Gasoline	Benzene	Toluene	Ethyl- Benzene	Xylene	TOG	Chloro- form	1, 2- DCA	Freon	1, 1, 1- TCA	PCE	1, 2- DCPA	1, 2- DCE
MW-5																	
03/14/89	8.35	1.37	6.98	--	20,000	6600	1600	270	1100	<3000	<100	<20	<20	<20	--	--	--
06/08/89	8.35	3.62	4.73	--	--	--	--	--	--	--	--	--	--	--	--	--	--
06/09/89	8.35	--	--	--	15,000	>2800	270	240	640	--	<20	28	<20	<5.0	--	--	--
06/09/89	8.35	--	--	Duplicate	12,000	5100	300	240	700	--	<200	<50	<20	<50	--	--	--
09/14/89	8.35	2.98	5.37	--	15,000	>730	>320	>290	440	--	<10	<2.0	<20	<2.0	--	--	--
09/14/89	8.35	--	--	Duplicate	15,000	3300	450	490	730	--	<100	<20	100	<20	--	--	--
09/14/89	8.35	--	--	Triplicate	16,000	3100	550	400	690	--	<50	<10	<50	<10	--	--	--
12/08/89	8.35	-0.78	9.13	--	20,000	4600	640	390	1300	--	<0.5	27	--	<0.5	--	--	--
03/19/90	8.35	3.23	5.12	--	25,000	6500	1200	450	2200	--	<0.5	10	--	0.7	--	--	--
07/06/90	8.35	2.54	5.81	--	30,000	5600	890	210	1400	--	<0.5	<0.5	--	<0.5	1.2	--	--
10/03/90	8.35	1.45	6.90	--	29,000	6000	790	270	1500	--	<0.5	<0.5	--	<0.5	--	2.0	--
08/23/91	8.35	3.30	5.05	--	36,000	6100	1200	460	2600	--	<0.5	3.9	--	<0.5	--	0.9	--
11/22/91	8.35	2.10	6.25	--	21,000	8000	1500	530	2600	--	<0.5	3.9	<0.5	<0.5	1.0	0.8	--
02/26/92	8.35	5.35	3.00	--	43,000	14,000	1600	640	4700	--	<0.5	2.0	<0.5	<0.5	--	--	--
05/22/92	8.35	3.86	4.49	--	72,000	18,000	8100	920	10000	--	<0.5	6.8	<0.5	<0.5	--	--	--
09/29/92	8.35	3.50	4.85	--	54,000	14,000	1400	740	8100	--	<0.5	4.4	--	<0.5	--	--	--
12/23/92	8.35	4.77	3.58	--	38,000	8400	910	530	5300	--	<0.5	2.9	--	<0.5	--	--	--
03/22/93	8.35	--	--	--	--	--	--	--	--	--	--	--	--	--	--	--	--
06/07/93	8.35	-3.82	12.17	--	24,000	3000	280	360	1200	--	<0.5	<0.5	--	<0.5	--	--	--
09/10/93	8.35	-0.15	8.50	--	8900	860	160	100	320	--	<5.0	<5.0	--	<5.0	--	--	--
03/07/94	8.35	5.30	3.05	--	9600	2100	380	120	290	--	<12.5	<12.5	--	<12.5	--	--	--
06/16/94	8.35	2.64	5.71	--	--	--	--	--	--	--	--	--	--	--	--	--	--
07/08/94	8.35	2.43	5.92	--	10,000	3600	360	210	460	--	<0.5	<0.5	--	<0.5	1.2	--	2.0
09/08/94	8.35	3.04	5.31	--	14,000	2800	270	170	360	--	<0.5	2.8	--	<0.5	--	--	--
11/29/94	8.35	5.72	2.63	--	11,000	2800	280	130	300	--	<5.0	<5.0	<5.0	<5.0	<5.0	<5.0	--
03/21/95	8.35	7.41	0.94	--	6700	1400	120	100	260	--	<0.5	0.59	<0.5	<0.5	<0.5	<0.5	--
06/27/95	8.35	6.01	2.34	--	18,000	6100	480	600	990	--	<10	<10	<10	<10	<10	<10	--
09/27/95	8.35	4.65	3.70	--	15,000	3000	140	210	310	--	<25	<25	<25	<25	<25	<25	--

Cumulative Table of Well Data and Analytical Results

Vertical Measurements are in feet.

Analytical results are in parts per billion (ppb)

DATE	Well Head Elev.	Ground Water Elev.	Depth To Water	Notes	TPH-Gasoline	Benzene	Toluene	Ethyl-Benzene	Xylene	TOG	Chloroform	1, 2-DCA	Freon	1, 1, 1-TCA	PCE	1, 2-DCPA	1, 2-DCE
MW-6																	
07/06/90	6.56	-2.53	9.09	--	210	<0.3	<0.3	3.0	7.0	--	<0.5	<0.5	--	<0.5	--	--	--
10/03/90	6.56	0.78	5.78	--	320	<0.3	0.3	1.0	<0.6	--	<0.5	<0.5	--	<0.5	--	--	--
08/23/91	6.56	-0.93	7.49	--	320	1.7	<0.5	2.1	<0.5	--	<0.5	<0.5	--	<0.5	--	--	--
11/22/91	6.56	-1.07	7.63	--	190	1.9	2.2	5.4	7.7	--	<0.5	<0.5	<0.5	<0.5	--	--	--
02/26/92	6.56	1.01	5.55	--	120	2.0	1.5	3.5	5.1	--	<0.5	<0.5	<0.5	<0.5	--	--	--
05/22/92	6.56	-0.38	6.94	--	160	1.1	0.6	0.9	1.0	--	<0.5	<0.5	<0.5	<0.5	--	--	--
09/29/92	6.56	-0.24	6.80	--	65	0.5	1.4	0.5	0.64	--	<0.5	<0.5	--	<0.5	--	--	--
12/23/92	6.56	0.57	5.99	--	140	0.7	0.7	0.9	2.1	--	--	--	--	--	--	--	--
03/22/93	6.56	-0.51	7.07	--	71	<0.5	<0.5	<0.5	<0.5	--	--	--	--	--	--	--	--
06/07/93	6.56	-1.05	7.61	--	85	<0.5	<0.5	2.0	1.0	--	--	--	--	--	--	--	--
09/10/93	6.56	1.88	4.68	--	<50	<0.5	<0.5	1.0	<0.5	--	--	--	--	--	--	--	--
03/07/94	6.56	1.34	5.22	--	<50	<0.5	<0.5	<0.5	0.8	--	--	--	--	--	--	--	--
06/16/94	6.56	2.39	4.17	--	<50	<0.5	<0.5	<0.5	<0.5	--	--	--	--	--	--	--	--
09/08/94	6.56	1.96	4.60	--	70	<0.5	0.6	<0.5	2.3	--	--	--	--	--	--	--	--
11/29/94	6.56	0.03	6.53	--	120	<0.5	<0.5	1.3	<0.5	--	--	--	--	--	--	--	--
03/21/95	6.56	-0.47	7.03	--	<50	<0.5	<0.5	<0.5	<0.5	--	--	--	--	--	--	--	--
06/27/95	6.56	0.20	6.36	--	84	<0.5	<0.5	<0.5	1.1	--	--	--	--	--	--	--	--
09/27/95	6.56	2.21	4.35	--	<50	<0.5	<0.5	<0.5	<0.5	--	--	--	--	--	--	--	--

Cumulative Table of Well Data and Analytical Results

Vertical Measurements are in feet.

Analytical results are in parts per billion (ppb)

DATE	Well Head Elev.	Ground Water Elev.	Depth To Water	Notes	TPH-Gasoline	Benzene	Toluene	Ethyl-Benzene	Xylene	TOG	Chloroform	1, 2-DCA	Freon	1, 1, 1-TCA	PCE	1, 2-DCPA	1, 2-DCE
MW-7																	
07/06/90	4.99	-0.86	5.85	--	<50	<0.3	<0.3	<0.3	<0.6	<1000	<0.5	<0.5	--	<0.5	--	--	--
10/03/90	4.99	-1.26	6.25	--	<50	<1.5	<1.5	<1.5	<3.0	--	<0.5	<0.5	--	<0.5	--	--	--
08/23/91	4.99	-0.51	5.50	--	<50	<0.5	<0.5	<0.5	<0.5	--	<0.5	<0.5	--	<0.5	--	--	--
11/22/91	4.99	-0.74	5.73	--	<50	<0.5	<0.5	<0.5	<0.5	--	<0.5	<0.5	<0.5	<0.5	--	--	--
02/26/92	4.99	0.15	4.84	--	<50	<0.5	<0.5	<0.5	<0.5	--	<0.5	<0.5	<0.5	<0.5	--	--	--
05/22/92	4.99	0.10	4.89	--	<50	<0.5	<0.5	<0.5	<0.5	--	<0.5	<0.5	<0.5	<0.5	--	--	--
09/29/92	4.99	-0.56	5.55	--	<50	<0.5	<0.5	<0.5	0.6	--	<0.5	<0.5	--	<0.5	--	--	--
12/23/92	4.99	0.12	4.87	--	<50	<0.5	<0.5	<0.5	<0.5	--	--	--	--	--	--	--	--
03/22/93	4.99	0.94	4.05	--	<50	<0.5	<0.5	<0.5	<0.5	--	--	--	--	--	--	--	--
06/07/93	4.99	0.36	4.63	--	<50	<0.5	<0.5	<0.5	<0.5	--	--	--	--	--	--	--	--
09/10/93	4.99	-0.57	5.56	--	<50	<0.5	<0.5	<0.5	<0.5	--	--	--	--	--	--	--	--
03/07/94	4.99	0.34	4.65	--	<50	<0.5	<0.5	<0.5	<0.5	--	--	--	--	--	--	--	--
06/16/94	4.99	-0.08	5.07	--	<50	<0.5	<0.5	<0.5	<0.5	--	--	--	--	--	--	--	--
09/08/94	4.99	-0.34	5.33	--	250	34	40	4.4	26	--	--	--	--	--	--	--	--
11/29/94	4.99	0.12	4.87	--	<50	<0.5	<0.5	<0.5	<0.5	--	--	--	--	--	--	--	--
03/21/95	4.99	1.31	3.68	--	<50	<0.5	<0.5	<0.5	<0.5	--	--	--	--	--	--	--	--
06/27/95	4.99	0.53	4.46	--	<50	<0.5	<0.5	<0.5	<0.5	--	--	--	--	--	--	--	--
09/27/95	4.99	0.39	4.60	--	<50	<0.5	<0.5	<0.5	<0.5	--	--	--	--	--	--	--	--

Cumulative Table of Well Data and Analytical Results

Vertical Measurements are in feet.

Analytical results are in parts per billion (ppb)

DATE	Well Head Elev.	Ground Water Elev.	Depth To Water	Notes	TPH-Gasoline	Benzene	Toluene	Ethyl-Benzene	Xylene	TOG	Chloroform	1, 2-DCA	Freon	1, 1, 1-TCA	PCE	1, 2-DCPA	1, 2-DCE
MW-8																	
07/06/90	6.77	2.79	3.98	--	<50	<0.3	<0.3	<0.3	<0.6	<1000	<0.5	<0.5	--	<0.5	--	--	--
10/03/90	6.77	2.04	4.73	--	<50	<0.3	<0.3	<0.3	<0.6	--	<0.5	<0.5	--	<0.5	--	--	--
08/23/91	6.77	2.01	4.76	--	<50	<0.5	<0.5	<0.5	<0.5	--	<0.5	<0.5	--	<0.5	--	--	--
11/22/91	6.77	1.04	5.73	--	<50	<0.5	<0.5	<0.5	<0.5	--	<0.5	<0.5	<0.5	<0.5	--	--	--
02/26/92	6.77	2.47	4.30	--	<50	<0.5	<0.5	<0.5	<0.5	--	<0.5	<0.5	<0.5	<0.5	--	--	--
05/22/92	6.77	3.11	3.66	--	<50	<0.5	<0.5	<0.5	<0.5	--	<0.5	<0.5	<0.5	<0.5	--	--	--
09/29/92	6.77	--	--	--	--	--	--	--	--	--	--	--	--	--	--	--	--
12/23/92	6.77	3.94	2.83	--	<50	<0.5	7.2	0.6	2.5	--	--	--	--	--	--	--	--
03/22/93	6.77	2.39	4.38	--	<50	<0.5	<0.5	<0.5	<0.5	--	--	--	--	--	--	--	--
06/07/93	6.77	1.60	5.17	--	<50	<0.5	<0.5	<0.5	<0.5	--	--	--	--	--	--	--	--
09/10/93	6.77	1.61	5.16	--	<50	<0.5	<0.5	<0.5	<0.5	--	--	--	--	--	--	--	--
03/07/94	6.77	2.06	4.71	--	<50	<0.5	<0.5	<0.5	<0.5	--	--	--	--	--	--	--	--
06/16/94	6.77	2.62	4.15	--	<50	<0.5	<0.5	<0.5	<0.5	--	--	--	--	--	--	--	--
09/08/94	6.77	1.66	5.11	--	<50	<0.5	<0.5	<0.5	<0.5	--	--	--	--	--	--	--	--
11/29/94	6.77	1.94	4.83	--	<50	<0.5	<0.5	<0.5	<0.5	--	--	--	--	--	--	--	--
03/21/95	6.77	0.94	5.83	--	<50	<0.5	<0.5	<0.5	<0.5	--	--	--	--	--	--	--	--
06/27/95	6.77	0.57	6.20	--	<50	<0.5	<0.5	<0.5	<0.5	--	--	--	--	--	--	--	--
09/27/95	6.77	1.62	5.15	--	--	--	--	--	--	--	--	--	--	--	--	--	--

Cumulative Table of Well Data and Analytical Results

Vertical Measurements are in feet.

Analytical results are in parts per billion (ppb)

DATE	Well Head Elev.	Ground Water Elev.	Depth To Water	Notes	TPH-Gasoline	Benzene	Toluene	Ethyl-Benzene	Xylene	TOG	Chloroform	1, 2-DCA	Freon	1, 1, 1-TCA	PCE	1, 2-DCPA	1, 2-DCE
MW-9																	
07/06/90	7.63	3.02	4.61	--	<50	<0.3	<0.3	<0.3	<0.6	<1000	<0.5	<0.5	--	<0.5	--	--	--
10/03/90	7.63	2.49	5.14	--	<50	<0.3	<0.3	<0.3	<0.6	--	<0.5	<0.5	--	<0.5	--	--	--
08/23/91	7.63	2.18	5.45	--	<50	<0.5	<0.5	<0.5	<0.5	--	<0.5	<0.5	--	<0.5	--	--	--
11/22/91	7.63	2.15	5.48	--	<50	<0.5	<0.5	<0.5	<0.5	--	<0.5	<0.5	<0.5	<0.5	--	--	--
02/26/92	7.63	5.00	2.63	--	<50	<0.5	<0.5	<0.5	<0.5	--	<0.5	<0.5	<0.5	<0.5	--	--	--
05/22/92	7.63	3.63	4.00	--	<50	<0.5	<0.5	<0.5	<0.5	--	<0.5	<0.5	<0.5	<0.5	--	--	--
09/29/92	7.63	2.93	4.70	--	<50	<0.5	<0.5	<0.5	<0.5	--	<0.5	<0.5	--	<0.5	--	--	--
12/23/92	7.63	3.87	3.76	--	<50	<0.5	<0.5	<0.5	<0.5	--	--	--	--	--	--	--	--
03/22/93	7.63	5.52	2.11	--	<50	<0.5	<0.5	<0.5	<0.5	--	--	--	--	--	--	--	--
06/07/93	7.63	4.35	3.28	--	<50	<0.5	<0.5	<0.5	<0.5	--	--	--	--	--	--	--	--
09/10/93	7.63	2.45	5.18	--	<50	<0.5	<0.5	<0.5	<0.5	--	--	--	--	--	--	--	--
03/07/94	7.63	4.61	3.02	--	<50	<0.5	<0.5	<0.5	<0.5	--	--	--	--	--	--	--	--
06/16/94	7.63	3.50	4.13	--	<50	<0.5	<0.5	<0.5	<0.5	--	--	--	--	--	--	--	--
09/08/94	7.63	2.84	4.79	--	<50	<0.5	<0.5	<0.5	<0.5	--	--	--	--	--	--	--	--
11/29/94	7.63	3.71	3.92	--	<50	<0.5	<0.5	<0.5	<0.5	--	--	--	--	--	--	--	--
03/21/95	7.63	0.14	7.49	Insufficient water	--	--	--	--	--	--	--	--	--	--	--	--	--
06/27/95	7.63	5.73	1.90	--	<50	<0.5	<0.5	<0.5	<0.5	--	--	--	--	--	--	--	--
09/27/95	7.63	3.68	3.95	--	--	--	--	--	--	--	--	--	--	--	--	--	--

Cumulative Table of Well Data and Analytical Results

Vertical Measurements are in feet.

Analytical results are in parts per billion (ppb)

DATE	Well Head Elev.	Ground Water Elev.	Depth To Water	Notes	TPH- Gasoline	Benzene	Toluene	Ethyl- Benzene	Xylene	TOG	Chloro- form	1, 2- DCA	Freon	1, 1, 1- TCA	PCE	1, 2- DCPA	1, 2- DCE
TRIP BLANK																	
12/08/89	--	--	--	--	<100	<0.1	<0.2	<0.1	<0.2	--	<0.5	<0.1	--	<0.1	--	--	--
06/09/89	--	--	--	--	<50	<0.5	<0.5	<0.1	<0.2	--	<0.5	<0.1	<20	<0.1	--	--	--
09/14/89	--	--	--	--	<50	<0.1	<0.5	<0.1	<0.2	--	<0.5	<0.1	<0.5	<0.1	--	--	--
12/08/89	--	--	--	--	<50	<0.3	<0.3	<0.3	<0.6	--	4.4	<0.5	--	1.9	--	--	--
03/19/90	--	--	--	--	<50	<0.3	<0.3	<0.3	<0.6	--	<0.5	<0.5	--	<0.5	--	--	--
07/06/90	--	--	--	--	<50	<0.3	<0.3	<0.3	<0.6	--	<0.5	<0.5	--	<0.5	--	--	--
10/03/90	--	--	--	--	<50	<0.3	<0.3	<0.3	1.0	--	<0.5	<0.5	--	<0.5	--	--	--
08/23/91	--	--	--	--	<50	<0.5	<0.5	<0.5	<0.5	--	--	--	--	--	--	--	--
11/22/91	--	--	--	--	<50	<0.5	<0.5	<0.5	<0.5	--	--	--	<0.5	--	--	--	--
02/26/92	--	--	--	--	<50	<0.5	<0.5	<0.5	<0.5	--	--	--	--	--	--	--	--
05/22/92	--	--	--	--	<50	<0.5	<0.5	<0.5	<0.5	--	--	--	--	--	--	--	--
09/29/92	--	--	--	--	<50	<0.5	<0.5	<0.5	<0.5	--	--	--	--	--	--	--	--
12/23/92	--	--	--	--	<50	<0.5	<0.5	<0.5	<0.5	--	--	--	--	--	--	--	--
03/22/93	--	--	--	--	<50	<0.5	<0.5	<0.5	<0.5	--	--	--	--	--	--	--	--
06/07/93	--	--	--	--	<50	<0.5	<0.5	<0.5	1.0	--	--	--	--	--	--	--	--
09/10/93	--	--	--	--	<50	<0.5	<0.5	<0.5	<0.5	--	--	--	--	--	--	--	--
03/07/94	--	--	--	--	<50	<0.5	<0.5	<0.5	<0.5	--	--	--	--	--	--	--	--
06/16/94	--	--	--	--	<50	<0.5	<0.5	<0.5	<0.5	--	--	--	--	--	--	--	--
09/08/94	--	--	--	--	<50	<0.5	<0.5	<0.5	<0.5	--	--	--	--	--	--	--	--
11/29/94	--	--	--	--	<50	<0.5	<0.5	<0.5	<0.5	--	--	--	--	--	--	--	--
03/21/95	--	--	--	--	<50	<0.5	<0.5	<0.5	<0.5	--	--	--	--	--	--	--	--
06/27/95	--	--	--	--	<50	<0.5	<0.5	<0.5	<0.5	--	--	--	--	--	--	--	--
09/27/95	--	--	--	--	<50	<0.5	<0.5	<0.5	<0.5	--	--	--	--	--	--	--	--

Note: Blaine Tech Services, Inc. began routine monitoring of the groundwater wells at this site on November 1, 1994.

Earlier field data and analytical results are drawn from the September 27, 1994 Groundwater Technology, Inc. report.

ABBREVIATIONS:

TPH = Total Petroleum Hydrocarbons

TOG = Total Oil and Grease

1,2-DCA = 1,2-Dichloroethane

1,1,1-TCA = 1,1,1-Trichloroethane

PCE = Trichloroethene

1,2-DCPA = 1,2-Dichloropropane

1,2-DCE = 1,2-Dichloroethene



Blaine Technical Services 985 Timothy Drive San Jose, CA 95133	Client Proj. ID: Chevron, 9-0019, 950927-S1 Sample Descript: MW-4 Matrix: LIQUID Analysis Method: 8015Mod/8020 Lab Number: 9509J52-01	Sampled: 09/27/95 Received: 09/28/95 Analyzed: 10/02/95 Reported: 10/09/95
----------------------------------------------------------------------	---------------------------------------------------------------------------------------------------------------------------------------------------	-------------------------------------------------------------------------------------

QC Batch Number: GC100295BTEX03A
Instrument ID: GCHP03

Total Purgeable Petroleum Hydrocarbons (TPPH) with BTEX

Analyte	Detection Limit ug/L	Sample Results ug/L
TPPH as Gas	50	N.D.
Benzene	0.50	N.D.
Toluene	0.50	N.D.
Ethyl Benzene	0.50	N.D.
Xylenes (Total)	0.50	N.D.
Chromatogram Pattern:		
Surrogates	Control Limits %	% Recovery
Trifluorotoluene	70 130	76

Analytes reported as N.D. were not present above the stated limit of detection.

SEQUOIA ANALYTICAL - ELAP #1210



Peggy Penner
Project Manager





Blaine Technical Services 985 Timothy Drive San Jose, CA 95133 Attention: Jim Keller	Client Proj. ID: Chevron, 9-0019, 950927-S1 Sample Descript: MW-5 Matrix: LIQUID Analysis Method: 8015Mod/8020 Lab Number: 9509J52-02	Sampled: 09/27/95 Received: 09/28/95 Analyzed: 10/04/95 Reported: 10/09/95
-----------------------------------------------------------------------------------------------	---------------------------------------------------------------------------------------------------------------------------------------------------	-------------------------------------------------------------------------------------

QC Batch Number: GC100495BTEX02A
Instrument ID: GCHP02

Total Purgeable Petroleum Hydrocarbons (TPPH) with BTEX

Analyte	Detection Limit ug/L	Sample Results ug/L
TPPH as Gas	10000	15000
Benzene	100	3600
Toluene	100	140
Ethyl Benzene	100	210
Xylenes (Total)	100	310
Chromatogram Pattern:		Gas

Surrogates	Control Limits %	% Recovery
Trifluorotoluene	70 130	80

Analytes reported as N.D. were not present above the stated limit of detection.

SEQUOIA ANALYTICAL - ELAP #1210



Peggy Penner
Project Manager





Blaine Technical Services
985 Timothy Drive
San Jose, CA 95133

Attention: Jim Keller

Client Proj. ID: Chevron, 9-0019, 950927-S1
Sample Descript: MW-5
Matrix: LIQUID
Analysis Method: EPA 8010
Lab Number: 9509J52-02

Sampled: 09/27/95
Received: 09/28/95

Analyzed: 10/03/95
Reported: 10/09/95

QC Batch Number: GC100295801008A
Instrument ID: GCHP8

Halogenated Volatile Organics (EPA 8010)

Analyte	Detection Limit ug/L	Sample Results ug/L
Bromodichloromethane	25	N.D.
Bromoform	25	N.D.
Bromomethane	50	N.D.
Carbon Tetrachloride	25	N.D.
Chlorobenzene	25	N.D.
Chloroethane	50	N.D.
2-Chloroethylvinyl ether	50	N.D.
Chloroform	25	N.D.
Chloromethane	50	N.D.
Dibromochloromethane	25	N.D.
1,2-Dichlorobenzene	25	N.D.
1,3-Dichlorobenzene	25	N.D.
1,4-Dichlorobenzene	25	N.D.
1,1-Dichloroethane	25	N.D.
1,2-Dichloroethane	25	N.D.
1,1-Dichloroethene	25	N.D.
cis-1,2-Dichloroethene	25	N.D.
trans-1,2-Dichloroethene	25	N.D.
1,2-Dichloropropane	25	N.D.
cis-1,3-Dichloropropene	25	N.D.
trans-1,3-Dichloropropene	25	N.D.
Methylene chloride	250	N.D.
1,1,2,2-Tetrachloroethane	25	N.D.
Tetrachloroethene	25	N.D.
1,1,1-Trichloroethane	25	N.D.
1,1,2-Trichloroethane	25	N.D.
Trichloroethene	25	N.D.
Trichlorofluoromethane	25	N.D.
Vinyl chloride	50	N.D.
Surrogates	Control Limits %	% Recovery
1-Chloro-2-fluorobenzene	70 130	82

Analytes reported as N.D. were not present above the stated limit of detection.

SEQUOIA ANALYTICAL - ELAP #1210

Peggy Penner
Project Manager





Blaine Technical Services 985 Timothy Drive San Jose, CA 95133 Attention: Jim Keller	Client Proj. ID: Chevron, 9-0019, 950927-S1 Sample Descript: MW-6 Matrix: LIQUID Analysis Method: 8015Mod/8020 Lab Number: 9509J52-03	Sampled: 09/27/95 Received: 09/28/95 Analyzed: 10/02/95 Reported: 10/09/95
-----------------------------------------------------------------------------------------------	---------------------------------------------------------------------------------------------------------------------------------------------------	-------------------------------------------------------------------------------------

QC Batch Number: GC100295BTEX03A
Instrument ID: GCHP03

Total Purgeable Petroleum Hydrocarbons (TPPH) with BTEX

Analyte	Detection Limit ug/L	Sample Results ug/L
TPPH as Gas	50	N.D.
Benzene	0.50	N.D.
Toluene	0.50	N.D.
Ethyl Benzene	0.50	N.D.
Xylenes (Total)	0.50	N.D.
Chromatogram Pattern:		
Surrogates	Control Limits %	% Recovery
Trifluorotoluene	70 130	82

Analytes reported as N.D. were not present above the stated limit of detection.

SEQUOIA ANALYTICAL - ELAP #1210

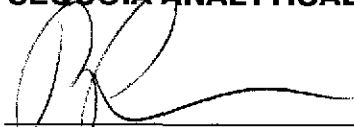
Peggy Penner
Project Manager





Blaine Technical Services 985 Timothy Drive San Jose, CA 95133 Attention: Jim Keller	Client Proj. ID: Chevron, 9-0019, 950927-S1 Sample Descript: MW-7 Matrix: LIQUID Analysis Method: 8015Mod/8020 Lab Number: 9509J52-04	Sampled: 09/27/95 Received: 09/28/95 Analyzed: 10/02/95 Reported: 10/09/95
-----------------------------------------------------------------------------------------------	---------------------------------------------------------------------------------------------------------------------------------------------------	-------------------------------------------------------------------------------------

QC Batch Number: GC100295BTEX03A
Instrument ID: GCHP03

Total Purgeable Petroleum Hydrocarbons (TPPH) with BTEX

Analyte	Detection Limit ug/L	Sample Results ug/L
TPPH as Gas	50	N.D.
Benzene	0.50	N.D.
Toluene	0.50	N.D.
Ethyl Benzene	0.50	N.D.
Xylenes (Total)	0.50	N.D.
Chromatogram Pattern:		
Surrogates	Control Limits %	% Recovery
Trifluorotoluene	70 130	85

Analytes reported as N.D. were not present above the stated limit of detection.

SEQUOIA ANALYTICAL - ELAP #1210



Peggy Penner
Project Manager





Blaine Technical Services
985 Timothy Drive
San Jose, CA 95133

Client Proj. ID: Chevron, 9-0019, 950927-S1
Sample Descript: TB
Matrix: LIQUID
Analysis Method: 8015Mod/8020
Lab Number: 9509J52-05

Sampled: 09/27/95
Received: 09/28/95
Analyzed: 10/02/95
Reported: 10/09/95

QC Batch Number: GC100295BTEX03A
Instrument ID: GCHP03

Total Purgeable Petroleum Hydrocarbons (TPPH) with BTEX

Analyte	Detection Limit ug/L	Sample Results ug/L
TPPH as Gas	50	N.D.
Benzene	0.50	N.D.
Toluene	0.50	N.D.
Ethyl Benzene	0.50	N.D.
Xylenes (Total)	0.50	N.D.
Chromatogram Pattern:		
Surrogates	Control Limits %	% Recovery
Trifluorotoluene	70 130	76

Analytes reported as N.D. were not present above the stated limit of detection.

SEQUOIA ANALYTICAL - ELAP #1210

Peggy Penner
Project Manager





**Sequoia
Analytical**

680 Chesapeake Drive
404 N. Wiget Lane
819 Striker Avenue, Suite 8

Redwood City, CA 94063
Walnut Creek, CA 94598
Sacramento, CA 95834

(415) 364-9600
(510) 988-9600
(916) 921-9600

FAX (415) 364-9233
FAX (510) 988-9673
FAX (916) 921-0100

Blaine Technical Services
985 Timothy Drive
San Jose, CA 95133
Attention: Jim Keller

Client Proj. ID: Chevron, 9-0019, 950927-S1

Received: 09/28/95

Lab Proj. ID: 9509J52

Reported: 10/09/95

LABORATORY NARRATIVE

TPPH Note: Sample 9509J52-02 was diluted 200-fold.

8010 Note: Sample 9509J52-02 was diluted 50-fold due to high boilers in the PID.

SEQUOIA ANALYTICAL

Peggy Penner
Project Manager





Blaine Tech Services, Inc. Client Project ID: Chevron 9-0019, 950927-S1
 985 Timothy Drive Matrix: Liquid
 San Jose, CA 95133
 Attention: Jim Keller Work Order #: 9509J52 -01, 03-05 Reported: Oct 10, 1995

QUALITY CONTROL DATA REPORT

Analyte:	Benzene	Toluene	Ethyl Benzene	Xylenes
QC Batch#:	GC100295BTEX03A	GC100295BTEX03A	GC100295BTEX03A	GC100295BTEX03A
Analy. Method:	EPA 8020	EPA 8020	EPA 8020	EPA 8020
Prep. Method:	EPA 5030	EPA 5030	EPA 5030	EPA 5030

Analyst:	R. Vincent	R. Vincent	R. Vincent	R. Vincent
MS/MSD #:	9509C0201	9509C0201	9509C0201	9509C0201
Sample Conc.:	N.D.	N.D.	N.D.	N.D.
Prepared Date:	10/2/95	10/2/95	10/2/95	10/2/95
Analyzed Date:	10/2/95	10/2/95	10/2/95	10/2/95
Instrument I.D.#:	GCHP3	GCHP3	GCHP3	GCHP3
Conc. Spiked:	10 µg/L	10 µg/L	10 µg/L	30 µg/L
Result:	9.2	9.3	9.3	27
MS % Recovery:	92	93	93	90
Dup. Result:	9.1	9.0	9.0	27
MSD % Recov.:	91	90	90	90
RPD:	1.1	3.3	3.3	0.0
RPD Limit:	0-50	0-50	0-50	0-50

LCS #:	-	-	-	-
Prepared Date:	-	-	-	-
Analyzed Date:	-	-	-	-
Instrument I.D.#:	-	-	-	-
Conc. Spiked:	-	-	-	-
LCS Result:	-	-	-	-
LCS % Recov.:	-	-	-	-

MS/MSD	71-133	72-128	72-130	71-120
LCS				
Control Limits				

Please Note:
 The LCS is a control sample of known, interferent-free matrix that is analyzed using the same reagents, preparation, and analytical methods employed for the samples. The matrix spike is an aliquot of sample fortified with known quantities of specific compounds and subjected to the entire analytical procedure. If the recovery of analytes from the matrix spike does not fall within specified control limits due to matrix interference, the LCS recovery is to be used to validate the batch.

SEQUOIA ANALYTICAL

Peggy Penner
 Peggy Penner
 Project Manager

** MS=Matrix Spike, MSD=MS Duplicate, RPD=Relative % Difference

9509J52.BLA <1>





Blaine Tech Services, Inc. 985 Timothy Drive San Jose, CA 95133 Attention: Jim Keller	Client Project ID: Chevron 9-0019, 950927-S1 Matrix: Liquid Work Order #: 9509J52-02	Reported: Oct 10, 1995
------------------------------------------------------------------------------------------------	--------------------------------------------------------------------------------------------	------------------------

QUALITY CONTROL DATA REPORT

Analyte:	Benzene	Toluene	Ethyl Benzene	Xylenes
QC Batch#:	GC100495BTEX02A	GC100495BTEX02A	GC100495BTEX02A	GC100495BTEX02A
Analy. Method:	EPA 8020	EPA 8020	EPA 8020	EPA 8020
Prep. Method:	EPA 5030	EPA 5030	EPA 5030	EPA 5030

Analyst:	J. Woo	J. Woo	J. Woo	J. Woo
MS/MSD #:	9509J5203	9509J5203	9509J5203	9509J5203
Sample Conc.:	N.D.	N.D.	N.D.	N.D.
Prepared Date:	10/4/95	10/4/95	10/4/95	10/4/95
Analyzed Date:	10/4/95	10/4/95	10/4/95	10/4/95
Instrument I.D.#:	GCHP2	GCHP2	GCHP2	GCHP2
Conc. Spiked:	10 µg/L	10 µg/L	10 µg/L	30 µg/L
Result:	9.5	9.2	9.2	28
MS % Recovery:	95	92	92	93
Dup. Result:	11	9.9	10	30
MSD % Recov.:	110	99	100	100
RPD:	15	7.3	8.3	6.9
RPD Limit:	0-50	0-50	0-50	0-50

LCS #:	-	-	-	-
Prepared Date:	-	-	-	-
Analyzed Date:	-	-	-	-
Instrument I.D.#:	-	-	-	-
Conc. Spiked:	-	-	-	-
LCS Result:	-	-	-	-
LCS % Recov.:	-	-	-	-

MS/MSD				
LCS	71-133	72-128	72-130	71-120
Control Limits				

Please Note:
The LCS is a control sample of known, interferent-free matrix that is analyzed using the same reagents, preparation, and analytical methods employed for the samples. The matrix spike is an aliquot of sample fortified with known quantities of specific compounds and subjected to the entire analytical procedure. If the recovery of analytes from the matrix spike does not fall within specified control limits due to matrix interference, the LCS recovery is to be used to validate the batch.

SEQUOIA ANALYTICAL

Peggy Penner
Project Manager

** MS = Matrix Spike, MSD = MS Duplicate, RPD = Relative % Difference

9509J52.BLA <2>





Blaine Tech Services, Inc.
985 Timothy Drive
San Jose, CA 95133
Attention: Jim Keller

Client Project ID: Chevron 9-0019, 950927-S1
Matrix: Liquid

Work Order #: 9509J52-02

Reported: Oct 10, 1995

QUALITY CONTROL DATA REPORT

Analyte:	1,1-Dichloro-ethene	Trichloro-ethene	Chloro-benzene
QC Batch#:	GC1002958010008A	GC1002958010008A	GC1002958010008A
Analy. Method:	EPA 8010	EPA 8010	EPA 8010
Prep. Method:	EPA 5030	EPA 5030	EPA 5030

Analyst:	H. Porter	H. Porter	H. Porter
MS/MSD #:	9509J5101	9509J5101	9509J5101
Sample Conc.:	N.D.	10	N.D.
Prepared Date:	10/2/95	10/2/95	10/2/95
Analyzed Date:	10/2/95	10/2/95	10/2/95
Instrument I.D.#:	GCHP8	GCHP8	GCHP8
Conc. Spiked:	25 µg/L	25 µg/L	25 µg/L

Result:	28	35	27
MS % Recovery:	112	100	108

Dup. Result:	28	35	27
MSD % Recov.:	112	100	108

RPD:	0.0	0.0	0.0
RPD Limit:	0-50	0-50	0-50

LCS #:	BLK100295	BLK100295	BLK100295
Prepared Date:	10/2/95	10/2/95	10/2/95
Analyzed Date:	10/2/95	10/2/95	10/2/95
Instrument I.D.#:	GCHP8	GCHP8	GCHP8
Conc. Spiked:	25 µg/L	25 µg/L	25 µg/L
LCS Result:	26	24	25
LCS % Recov.:	104	96	100

MS/MSD LCS Control Limits	28-167	35-146	38-150
---------------------------------	--------	--------	--------

Please Note:

The LCS is a control sample of known, interferent-free matrix that is analyzed using the same reagents, preparation, and analytical methods employed for the samples. The matrix spike is an aliquot of sample fortified with known quantities of specific compounds and subjected to the entire analytical procedure. If the recovery of analytes from the matrix spike does not fall within specified control limits due to matrix interference, the LCS recovery is to be used to validate the batch.

** MS = Matrix Spike, MSD = MS Duplicate, RPD = Relative % Difference

SEQUOIA ANALYTICAL

Peggy Penner
Project Manager



Chevron U.S.A. Inc.
P.O. BOX 5004
San Ramon, CA 94583
FAX (415)842-9591

Chevron Facility Number 9-0019
Facility Address 210 Grand Ave., Oakland, CA
Consultant Project Number 95092751
Consultant Name Blaine Tech Services, Inc.
Address 985 Timothy Dr., San Jose, CA 95133
Project Contact (Name) Jim Keller
(Phone) 408 995-5535 (Fax Number) 408 293-8773

Chevron Contact (Name) Mark Miller
(Phone) (510) 842-8134
Laboratory Name Sequoia
Laboratory Release Number 2172420
Samples Collected by (Name) SHAWN HOLL
Collection Date 09/27/95
Signature [Signature]

Sample Number	Lab Sample Number	Number of Containers	Matrix S = Soil W = Water A = Air C = Charcoal	Type G = Grab C = Composite D = Discrete	Time	Sample Preservation	Iced (Yes or No)	Analytes To Be Performed											DO NOT BILL FOR TB-LB		
								BTEX + TPH GAS (8020 + 8015)	TPH Diesel (8015)	Oil and Grease (5520)	Purgeable Halocarbons (8010)	Purgeable Aromatics (8020)	Purgeable Organics (8240)	Extractable Organics (8270)	Metals Cd, Cr, Pb, Zn, Ni (ICAP or AA)						
MW-4	-	3	W		1042	HCL	Y	X											9509	552	- 01
MW-5	-	6	W		1058	HCL	Y	X			X										- 02
MW-6	-	3	W		1010	HCL	Y	X													- 03
MW-7	-	3	W		1025	HCL	X	X													- 04
TB	-	2	W		LAB	HCL	Y	X													- 05

SEP 28 12 05

Relinquished By (Signature) <u>[Signature]</u>	Organization <u>BTS</u>	Date/Time <u>9-28-95 10:30</u>	Received By (Signature) <u>SR</u>	Organization <u>SEQ</u>	Date/Time <u>9-28-95 10:30</u>	Turn Around Time (Circle Choice) 24 Hrs. 48 Hrs. 5 Days <u>10 Days</u> As Contracted
Relinquished By (Signature) <u>[Signature]</u>	Organization <u>SEQ</u>	Date/Time <u>9-28-95 12:00 P</u>	Received By (Signature) _____	Organization _____	Date/Time _____	
Relinquished By (Signature) _____	Organization _____	Date/Time _____	Received For Laboratory By (Signature) <u>Tony M. Alchua</u>	Date/Time <u>9/28/95</u>		

1/1/95

Field Data Sheets

CHEVRON WELL MONITORING DATA SHEET

Project #: 95092751	Station #: 9-0019
Sampler: SNAUN	Start Date: 09/27/95
Well I.D.: MW-4	Well Diameter: (circle one) 2 3 4 6
Total Well Depth: Before 14.40 After	Depth to Water: Before 3.75 After
Depth to Free Product:	Thickness of Free Product (feet):
Measurements referenced to: PVC Grade Other:	

Well Diameter	VCF	Well Diameter	VCF
1"	0.04	6"	1.47
2"	0.16	8"	2.61
3"	0.37	10"	4.08
4"	0.65	12"	5.87
5"	1.02	16"	10.43

6.92	x	3	=	20.76
1 Case Volume		Specified Volumes		gallons

Purging: Bailer Disposable Bailer Middleburg Electric Submersible <input checked="" type="checkbox"/> Extraction Pump Other _____	Sampling: Bailer Disposable Bailer <input checked="" type="checkbox"/> Extraction Port Other _____
--------------------------------------------------------------------------------------------------------------------------------------------------	-------------------------------------------------------------------------------------------------------------

TIME	TEMP. (F)	pH	COND.	TURBIDITY:	VOLUME REMOVED:	OBSERVATIONS:
1031	74.8	7.0	1800	—	7	
1033	75.6	7.2	1800	—	14	
1038	75.4	6.8	1800	—	21	

Did Well Dewater? NO If yes, gals. Gallons Actually Evacuated: 21

Sampling Time: 1042 Sampling Date: 09/27/95

Sample I.D.: MW-4 Laboratory: SEQUOIA

Analyzed for: **TPH-G** **BTEX** TPH-D OTHER:

Duplicate I.D.: Cleaning Blank I.D.:

Analyzed for: TPH-G BTEX TPH-D OTHER:
SLOW RECHARGE LAST CW

CHEVRON WELL MONITORING DATA SHEET

Project #: <u>95012751</u>	Station #: <u>9-0019</u>
Sampler: <u>SNAWN</u>	Start Date: <u>09/27/95</u>
Well I.D.: <u>MW-5</u>	Well Diameter: (circle one) 2 3 <u>4</u> 6
Total Well Depth: Before <u>14.30</u> After	Depth to Water: Before <u>3.70</u> After
Depth to Free Product:	Thickness of Free Product (feet):
Measurements referenced to: <u>PVC</u>	Grade Other:

Well Diameter	VCF	Well Diameter	VCF
1"	0.04	6"	1.47
2"	0.16	8"	2.61
3"	0.37	10"	4.08
4"	0.65	12"	5.87
5"	1.02	16"	10.43

<u>6.89</u>	x	<u>3</u>	=	<u>20.67</u>
1 Case Volume		Specified Volumes		gallons

Purging: Bailer Disposable Bailer Middleburg Electric Submersible <input checked="" type="checkbox"/> X Extraction Pump Other _____	Sampling: Bailer Disposable Bailer <input checked="" type="checkbox"/> X Extraction Port Other _____
-----------------------------------------------------------------------------------------------------------------------------------------------------------	----------------------------------------------------------------------------------------------------------------------

TIME	TEMP. (F)	pH	COND.	TURBIDITY:	VOLUME REMOVED:	OBSERVATIONS:
<u>1047</u>	<u>77.4</u>	<u>6.8</u>	<u>1400</u>	<u>—</u>	<u>7</u>	<u>STRAW</u>
<u>1049</u>	<u>77.6</u>	<u>6.8</u>	<u>1400</u>	<u>—</u>	<u>14</u>	<u>OPAL</u>
<u>1051</u>	<u>77.2</u>	<u>6.8</u>	<u>1400</u>	<u>—</u>	<u>21</u>	

Did Well Dewater? <u>NO</u> If yes, gals.	Gallons Actually Evacuated: <u>21</u>
Sampling Time: <u>1058</u>	Sampling Date: <u>09/27/95</u>
Sample I.D.: <u>MW-5</u>	Laboratory: <u>SEQUOIA</u>
Analyzed for: (Circle) <u>TPH-G</u> <u>BTEX</u> TPH-D <u>OTHER</u> <u>8010</u>	
Duplicate I.D.:	Cleaning Blank I.D.:
Analyzed for: (Circle) TPH-G BTEX TPH-D OTHER:	

CHEVRON WELL MONITORING DATA SHEET

Project #: <u>95092751</u>	Station #: <u>9-0019</u>
Sampler: <u>SHAWN</u>	Start Date: <u>09/27/95</u>
Well I.D.: <u>MW-6</u>	Well Diameter: (circle one) <u>(2)</u> 3 4 6
Total Well Depth: Before <u>9.50</u> After	Depth to Water: Before <u>4.35</u> After
Depth to Free Product:	Thickness of Free Product (feet):
Measurements referenced to:	<u>PVC</u> Grade Other:

Well Diameter	VCF	Well Diameter	VCF
1"	0.04	6"	1.47
2"	0.16	8"	2.61
3"	0.37	10"	4.08
4"	0.65	12"	5.87
5"	1.02	16"	10.43

<u>82</u>	<u>x</u>	<u>3</u>	<u>=</u>	<u>247</u>
1 Case Volume		Specified Volumes		gallons

Purging: Bailer
 Disposable Bailer
 Middleburg
 Electric Submersible
 Extraction Pump
 Other _____

Sampling: Bailer
 Disposable Bailer
 Extraction Port
 Other _____

TIME	TEMP. (F)	pH	COND.	TURBIDITY:	VOLUME REMOVED:	OBSERVATIONS:
<u>1003</u>	<u>74.2</u>	<u>7.2</u>	<u>2000</u>	<u>—</u>	<u>.85</u>	
<u>1005</u>	<u>75.0</u>	<u>7.0</u>	<u>2000</u>	<u>—</u>	<u>1.70</u>	
<u>1007</u>	<u>74.2</u>	<u>7.0</u>	<u>2000</u>	<u>—</u>	<u>2.50</u>	

Did Well Dewater? NO If yes, gals. Gallons Actually Evacuated: 2.5

Sampling Time: 1010 Sampling Date: 09/27/95

Sample I.D.: MW-6 Laboratory: _____

Analyzed for: (Circle) TPH-G BTEX TPH-D OTHER: _____

Duplicate I.D.: _____ Cleaning Blank I.D.: _____

Analyzed for: (Circle) TPH-G BTEX TPH-D OTHER: _____

CHEVRON WELL MONITORING DATA SHEET

Project #: 95092751	Station #: 9-0019
Sampler: SWAWH	Start Date: 09/27/95
Well I.D.: MW-7	Well Diameter: (circle one) <u>2</u> 3 4 6
Total Well Depth: Before 9.95 After	Depth to Water: Before 4.60 After
Depth to Free Product:	Thickness of Free Product (feet):
Measurements referenced to: <u>PVC</u> Grade Other:	

Well Diameter	VCF	Well Diameter	VCF
1"	0.04	6"	1.47
2"	0.16	8"	2.61
3"	0.37	10"	4.08
4"	0.65	12"	5.87
5"	1.02	16"	10.43

<u>.85</u>	x	<u>3</u>	=	<u>2.56</u>
1 Case Volume		Specified Volumes		gallons

Purging: Bailer Disposable Bailer <input checked="" type="checkbox"/> Middleburg Electric Submersible Extraction Pump Other _____	Sampling: Bailer Disposable Bailer <input checked="" type="checkbox"/> Extraction Port Other _____
--------------------------------------------------------------------------------------------------------------------------------------------------	-------------------------------------------------------------------------------------------------------------

TIME	TEMP. (F)	pH	COND.	TURBIDITY:	VOLUME REMOVED:	OBSERVATIONS:
1019	71.0	6.2	3000	—	.85	
1020	70.8	6.4	3000	—	1.70	
1021	71.0	6.8	3000	—	2.60	

Did Well Dewater? NO If yes, gals. Gallons Actually Evacuated: 260

Sampling Time: <u>1025</u>	Sampling Date: <u>09/27/95</u>
Sample I.D.: <u>MW-7</u>	Laboratory: <u>SEAWH</u>
Analyzed for: <u>TPH-G</u> <u>BTEX</u> TPH-D OTHER:	
Duplicate I.D.:	Cleaning Blank I.D.:
Analyzed for: TPH-G BTEX TPH-D OTHER:	