

CAMBRIA Environmental Technology, Inc.

1144 65th Street, Suite C • Oakland, CA 94608 • (510) 420-0700 • Fax (510) 420-9170

TRANSMITTAL LETTER

TO: Jennifer Eberle

FROM: John Espinoza

COMPANY: ACDEH

DATE: August 20, 1995

SUBJECT: 1721 Webster Street, Oakland, CA

PROJECT NUMBER:

Jennifer:

Enclosed are the corrected Figure 1 and Table 1 from the Third Quarter 1995 Monitoring Report. Also included is the survey information from our subcontractor.

Please call if you have any questions.

Sincerely,
Cambria Environmental Technology, Inc.



John Espinoza
Staff Engineer

cc: Mr. Lee Douglas, Douglas Parking 1721 Webster Street, Oakland, CA 94612

95 AUG 22 PM 2:13

ENVIRONMENTAL
TECHNOLOGY, INC.

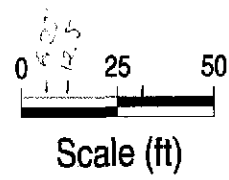
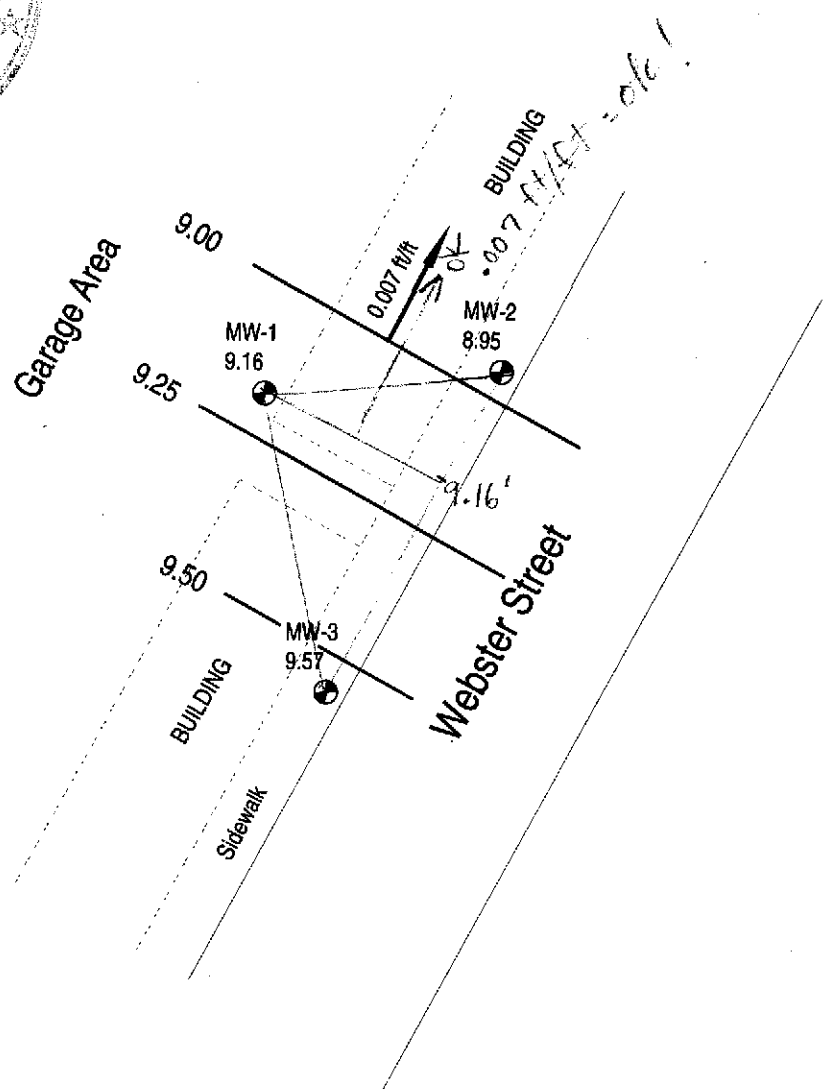
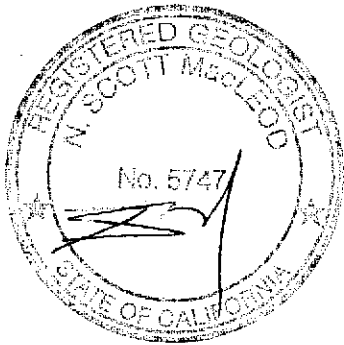

Base map from Piers Environmental Services

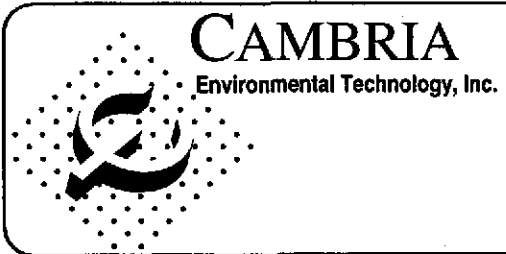

EXPLANATION	
	Ground Water Monitoring Well
X.XX	Ground Water Elevation
	Ground Water Elevation Contour
	Ground Water Flow Direction

Ground Water Elevation
July 11, 1995
1721 Webster Street
Oakland, California

FIGURE
1

$$\frac{\Delta H - M}{\Delta H - L} = \frac{.41}{.62} = \frac{X}{D_{\text{total}} \rightarrow \frac{1}{K}} \leftarrow \begin{matrix} 61.995' \\ = 62' \end{matrix}$$

$$\frac{X}{1.875''} = \frac{50'}{1''} = 93.75'$$

$$\text{to } 50' : \quad ? \quad \frac{?}{62'} = \frac{1''}{50'}$$

$$\frac{\text{rise}}{\text{run}} = \frac{9.16 - 8.95}{25 - 6.25} = \frac{.21'}{31.25} = .007'$$

? = 1.27''

Table 1. Ground Water Elevation and Analytic Data - 1721 Webster Street, Oakland, California

Well ID	Date	Well Elev. (ft)	G W Depth (ft)	G W Elev. (ft)	TPHg	Benzene	Toluene	Ethylbenzene (Concentrations in mg/l)	Xylenes	Notes
Gen Tech/Piers Environmental Data¹										
MW-1	12/02/94	29.25	19.42	9.83	nd	nd	nd	nd	nd	
	03/06/95	29.73	20.69	9.04	nd	nd	nd	nd	nd	
MW-2	12/02/94	27.10	19.50	7.60	61.3	3	3.9	0.16	4.5	
	03/06/95	27.10	18.49	8.61	98	8.4	16	2	2.6	
MW-3	12/02/94	29.50	22.15	7.35	394	1.2	nd	1.8	4	
	03/06/95	29.25	20.09	9.16	21	0.4	0.15	0.024	0.062	
Cambria Environmental Technology, Inc.										
MW-1	07/11/95	29.73	20.65	9.08	nd	nd	nd	nd	nd	
MW-2	07/11/95	27.10	18.45	8.65	38	3.1	7.5	0.94	3.7	a
MW-3	07/11/95	29.25	19.99	9.26	12	nd	0.01	0.016	0.099	b,c,d

Notes and Abbreviations

G W = Ground water

TPHg = Total petroleum hydrocarbons as gasoline per Modified EPA Method 8015.

Elev. = Elevation

¹ = From Gen Tech and Piers Environmental Quarterly Groundwater Monitoring Reports dated December 2, 1994 and March 6, 1995, respectively.

a - Unmodified or weakly modified gasoline is significant

b - Analytic laboratory reports that heavier gasoline range compounds are significant (possible aged gasoline)

c - Analytic laboratory reports that lighter gasoline range compounds (the most mobile fraction) are significant

d - Analytic laboratory reports that gasoline range compounds having broad chromatographic peaks are significant; possible biologically altered gasoline

*new survey
6-28-95
changes*